

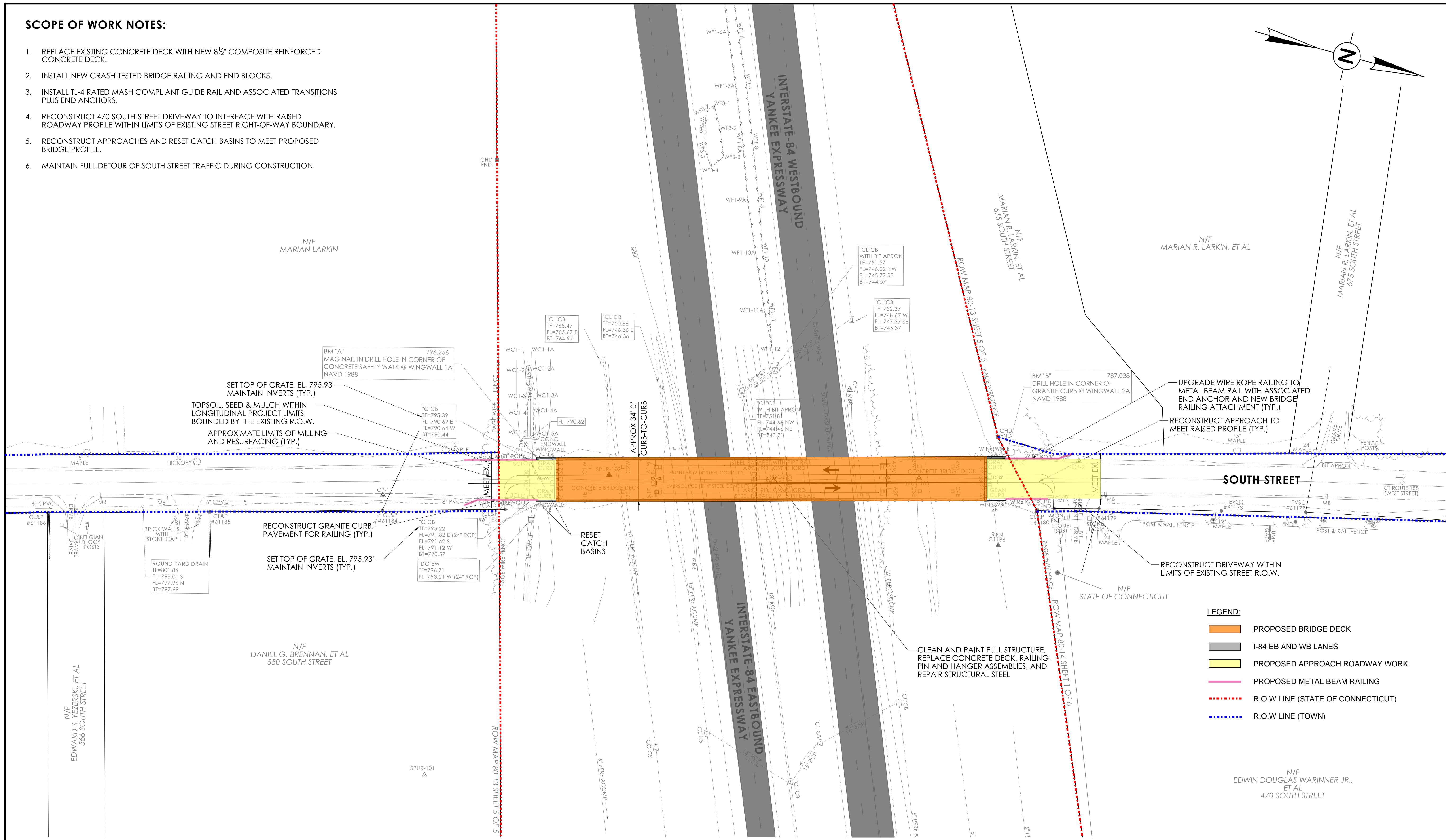

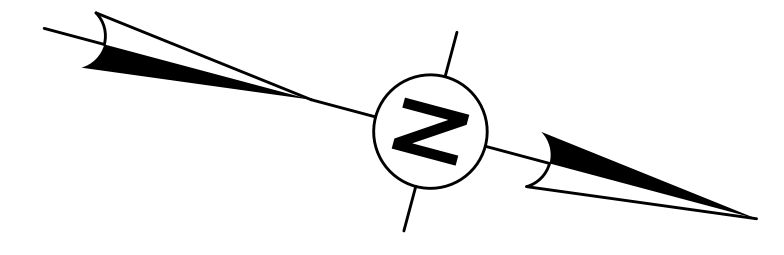

**SCOPE OF WORK NOTES:**

1. REPLACE EXISTING CONCRETE DECK WITH NEW 8½" COMPOSITE REINFORCED CONCRETE DECK.
2. INSTALL NEW CRASH-TESTED BRIDGE RAILING AND END BLOCKS.
3. INSTALL TL-4 RATED MASH COMPLIANT GUIDE RAIL AND ASSOCIATED TRANSITIONS PLUS END ANCHORS.
4. RECONSTRUCT 470 SOUTH STREET DRIVEWAY TO INTERFACE WITH RAISED ROADWAY PROFILE WITHIN LIMITS OF EXISTING STREET RIGHT-OF-WAY BOUNDARY.
5. RECONSTRUCT APPROACHES AND RESET CATCH BASINS TO MEET PROPOSED BRIDGE PROFILE.
6. MAINTAIN FULL DETOUR OF SOUTH STREET TRAFFIC DURING CONSTRUCTION.



- LEGEND:**
- PROPOSED BRIDGE DECK
  - I-84 EB AND WB LANES
  - PROPOSED APPROACH ROADWAY WORK
  - PROPOSED METAL BEAM RAILING
  - R.O.W LINE (STATE OF CONNECTICUT)
  - R.O.W LINE (TOWN)

**ROADWAY PLAN**  
SCALE: 1" = 40'

<p><b>PRELIMINARY DESIGN REVIEW</b></p>	<p>SCALE AS NOTED</p>	<p>SIGNATURE/BLOCK:</p>		<p>PROJECT NUMBER: 0080-0132 PROJECT DESCRIPTION: REHABILITATION OF BRIDGE NO. 01164, SOUTH STREET OVER I-84 TOWN(S): MIDDLEBURY DRAWING TITLE: ALTERNATIVE 1 ROADWAY PLAN</p>	<p>DRAWING NO. HWY-02 SHEET NO.</p>
<p>DESIGNER/DRAFTER: MRS      CHECKED BY: BNK</p>		<p>LASTED SAVED BY: msouthard    FILE NAME: 0080-0132_Br01164_AD-01_Alternative1-Plan.dgn PLOTTED DATE: 1/17/2024</p>			

**SCOPE OF WORK NOTES:**

1. SEE BRIDGE GENERAL PLAN AND ELEVATION FOR REPRESENTATIVE SUBSTRUCTURE ELEMENTS AND ADDITIONAL INFORMATION.

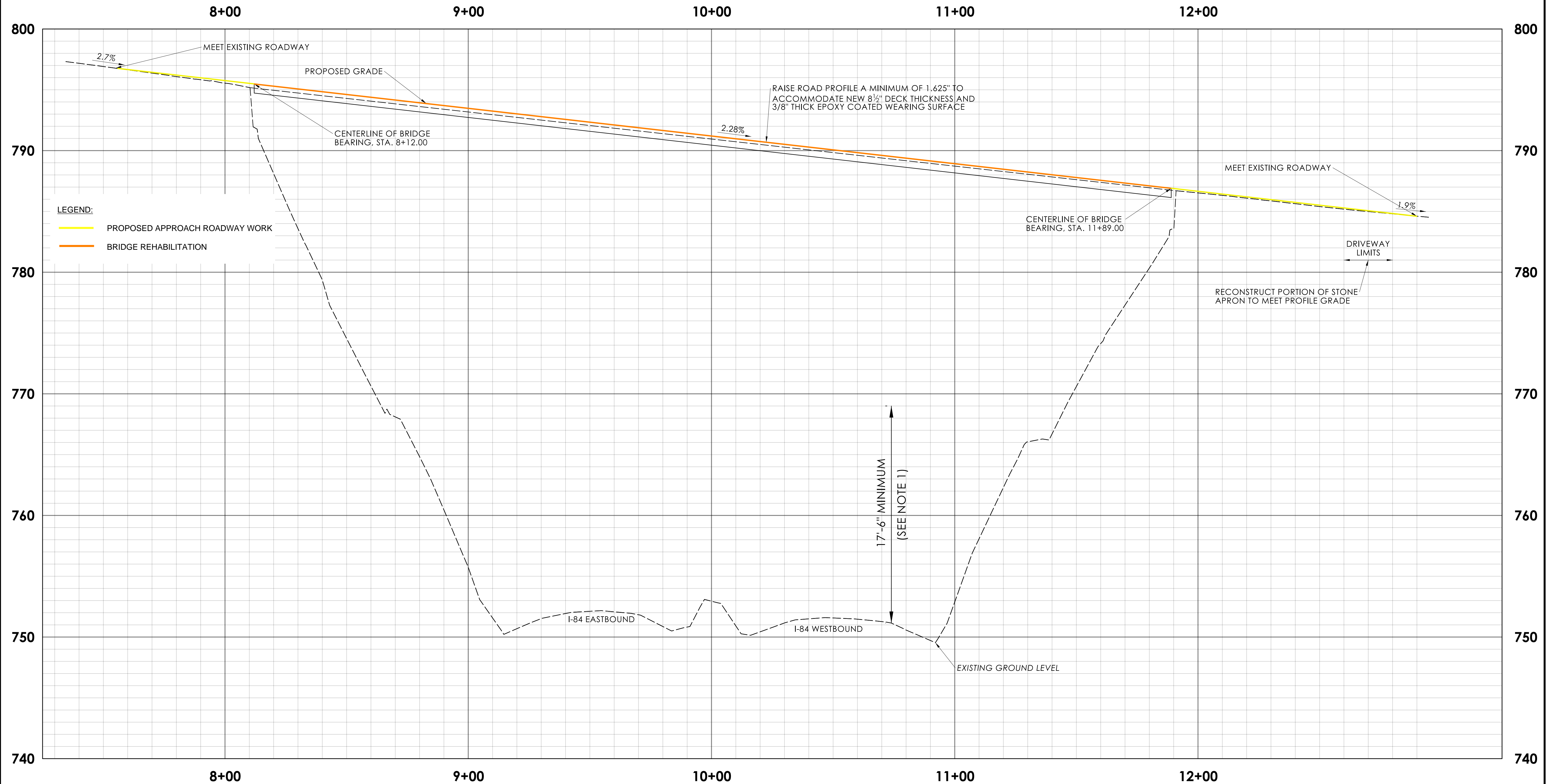

**LEGEND:**  
— PROPOSED APPROACH ROADWAY WORK  
— BRIDGE REHABILITATION

REV.	DATE	REVISION DESCRIPTION

**PRELIMINARY DESIGN REVIEW**

DESIGNER/DRAFTER: \_\_\_\_\_ CHECKED BY: \_\_\_\_\_  
 LASTED SAVED BY: jdiat FILE NAME: c:\users\jdiat\hprod\dms45326\0080-0132\_Br01164\_AD-01\_Alternative1-Profile.dgn  
 PLOTTED DATE: 1/17/2024

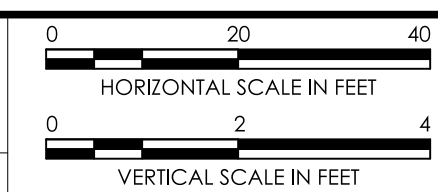

SIGNATURE/BLOCK: \_\_\_\_\_

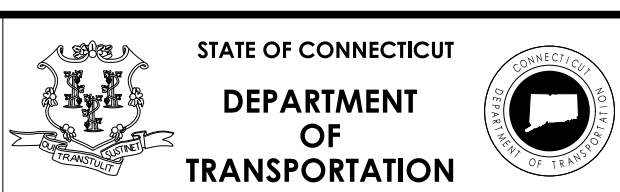

PROJECT NUMBER: 0080-0132  
 PROJECT DESCRIPTION: REHABILITATION OF BRIDGE NO. 01164, SOUTH STREET OVER I-84  
 TOWN(S): MIDDLEBURY  
 DRAWING TITLE: ALTERNATIVE 1 PROFILE

DRAWING NO. HWY-03  
 SHEET NO. \_\_\_\_\_

**SIGN SUMMARY**

- A** SOUTH STREET  
DETOUR  
6 X (30" X 10") = 12.5 S.F.  
6 X (30" X 24") = 30.0 S.F.
- B** SOUTH STREET  
DETOUR  
2 X (30" X 10") = 4.2 S.F.  
2 X (30" X 24") = 10.0 S.F.
- C** SOUTH STREET  
DETOUR  
4 X (30" X 10") = 8.3 S.F.  
4 X (30" X 24") = 20.0 S.F.
- D** END  
DETOUR  
2 X (24" X 18") = 6.0 S.F.
- E** SOUTH STREET  
BRIDGE CLOSED  
FOLLOW DETOUR  
4 X (60" X 30") = 50.0 S.F.
- F** SOUTH ST. BRIDGE  
CLOSED FROM  
MM/DD TO MM/DD  
4 X (72" X 48") = 96.0 S.F.  
  
TO BE INSTALLED TWO WEEKS PRIOR TO DETOUR  
AND TO BE REMOVED WHEN DETOUR IS IN EFFECT
- \*G** CONSTRUCTION  
AHEAD  
ROAD USE RESTRICTED  
STATE LIABILITY LIMITED  
GENERAL ERECTOR'S STATE LIAB.  
COMMISSIONER OF TRANSPORTATION  
2 X (30" X 24") = 10.0 S.F.
- H** ROAD WORK  
AHEAD  
FINES  
DOUBLED  
2 X (48" X 42") = 28.0 S.F.  
  
INSTALL WHEN DETOUR IN EFFECT
- \*I** ROAD  
WORK  
AHEAD  
2 X (36" X 36") = 18.0 S.F.
- \*J** STOP  
2 X (30" X 30") = 12.5 S.F.
- \*K** ROAD  
CLOSED  
2 X (48" X 30") = 20.0 S.F.
- L** LOCAL  
TRAFFIC  
ONLY  
2 X (30" X 24") = 10.0 S.F.

46 SIGNS TOTAL  
335.5 S.F. TOTAL

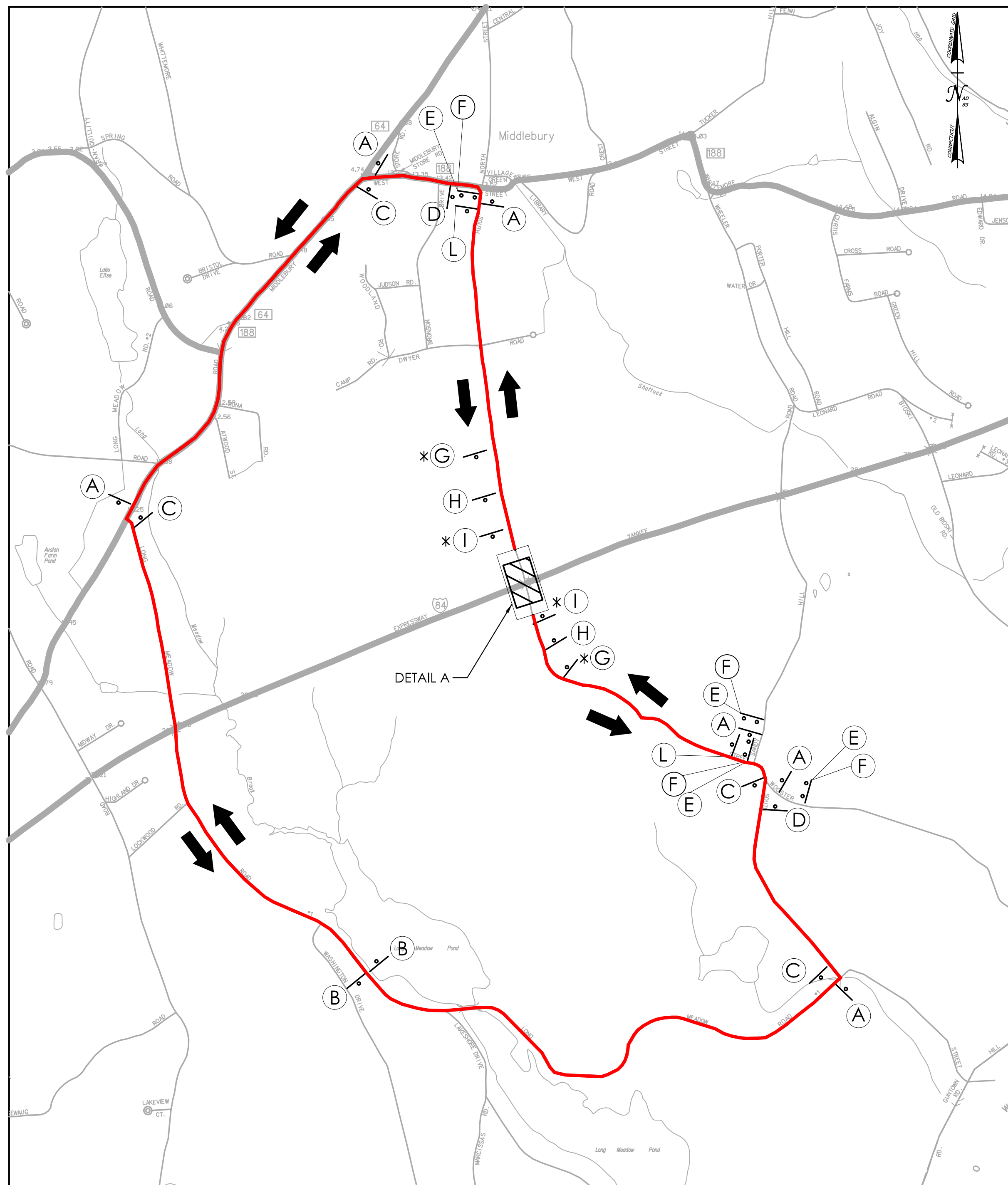
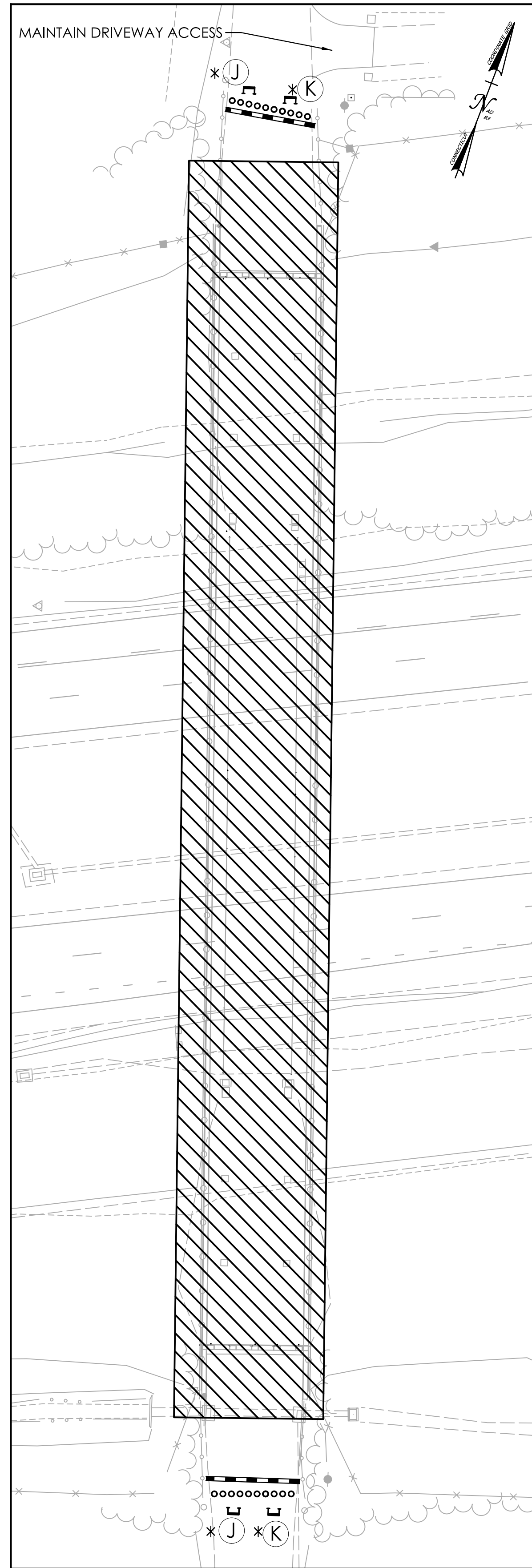

**DETOUR NOTES**

1. ALL SIGN LOCATIONS INDICATED ON THE PLAN ARE APPROXIMATE; EXACT LOCATIONS SHALL BE VERIFIED IN THE FIELD BY THE ENGINEER.
2. DETOUR SIGNS SHALL BE COVERED WHEN THE DETOUR IS NOT IN OPERATION.
3. DETOUR SIGNS SHALL BE REMOVED WHEN THE DETOUR IS NO LONGER REQUIRED.
4. EXISTING SIGNS WHICH CONFLICT WITH THE DETOUR ROUTE SHALL BE COVERED, REMOVED, OR REVISED AS DIRECTED BY THE ENGINEER.
5. INSTALL POST-MOUNTED SIGNS IN ACCORDANCE WITH STANDARD SHEETS TR\_1208-01 AND TR\_1208-02.
6. THE COST OF THE DETOUR SIGNS SHALL BE PAID FOR UNDER ITEM NO. 1220027 - CONSTRUCTION SIGNS.
7. ACCESS AND EGRESS TO ALL STREETS AND DRIVEWAYS MUST BE MAINTAINED AT ALL TIMES.
8. AT LEAST TWO WEEKS PRIOR TO IMPLEMENTATION OF CONSTRUCTION STAGING, THE CONTRACTOR SHALL NOTIFY THE ENGINEER WHO SHALL THEN NOTIFY THE TOWN OF MIDDLEBURY EMERGENCY SERVICES AND DEPARTMENT OF PUBLIC WORKS.
9. BARRICADE WARNING LIGHTS - HIGH INTENSITY SHALL BE MOUNTED ON ALL DIAMOND SHAPED POST-MOUNTED CONSTRUCTION SIGNS AND SIGNS MOUNTED TO TYPE III CONSTRUCTION BARRICADE CLOSING ROAD AND ARE PAYABLE UNDER ITEM NO. 0976002.
10. TWO WEEKS PRIOR TO INITIATING THE DETOUR, INSTALL SIGN "F" FROM THE SIGN SUMMARY. REMOVE SIGN "F" WHEN DETOUR IS INITIATED. REPLACE WITH SIGN E.
11. ANY EXISTING SIGNING DAMAGED BY THE CONTRACTOR SHALL BE REPLACED AT NO COST TO THE STATE.
12. CONSTRUCTION/DETOUR SIGNS ARE TO BE INSTALLED SO THAT THEY DO NOT BLOCK OR ARE NOT BLOCKED BY EXISTING SIGNS.

**LEGEND:**

- WORK ZONE
- DETOURED TRAFFIC FLOW
- DETOUR ROUTE

**LEGEND**

- WORK AREA
- DETOUR ROUTE
- CONSTRUCTION BARRICADE DETECTABLE
- SINGLE POST MOUNTED SIGN
- DOUBLE POST MOUNTED SIGN
- TEMPORARY TRAFFIC BARRIER
- BARRICADE WARNING LIGHTS HIGH INTENSITY
- TRAFFIC DRUM

REV.	DATE	REVISION DESCRIPTION

DESIGNER/DRAFTER: AG      CHECKED BY: JSM

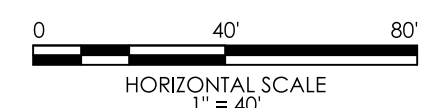

SIGNATURE/  
BLOCK:

**WV**  
ENGINEERS  
116 WASHINGTON AVE.  
NORTH HAVEN, 06473  
203-234-7862

PROJECT NUMBER: 0080-0132  
PROJECT DESCRIPTION: REHABILITATION OF BRIDGE NO. 01164 CARRYING SOUTH STREET OVER I-84  
TOWN(S): MIDDLEBURY  
DRAWING TITLE: DETOUR PLAN

DRAWING NO.  
DTR-01  
SHEET NO.