





**PLAN**

SCALE: 1"=20'

LEGEND	
	EXISTING PAVEMENT
	ROADWAY RECONSTRUCTION
	PROPOSED WINGWALL
	PROPOSED STRUCTURE

<b>BRIDGE REPLACEMENT</b>	
<b>WOODCHUCK HILL ROAD OVER LITTLE RIVER</b>	
<b>PROPOSED ALTERNATE B</b>	
CITY/TOWN: <b>CANTERBURY</b>	BRIDGE NO. <b>04600</b>
STATE PROJECT NO.: <b>0022-0107</b>	DATE: 4/25/2024

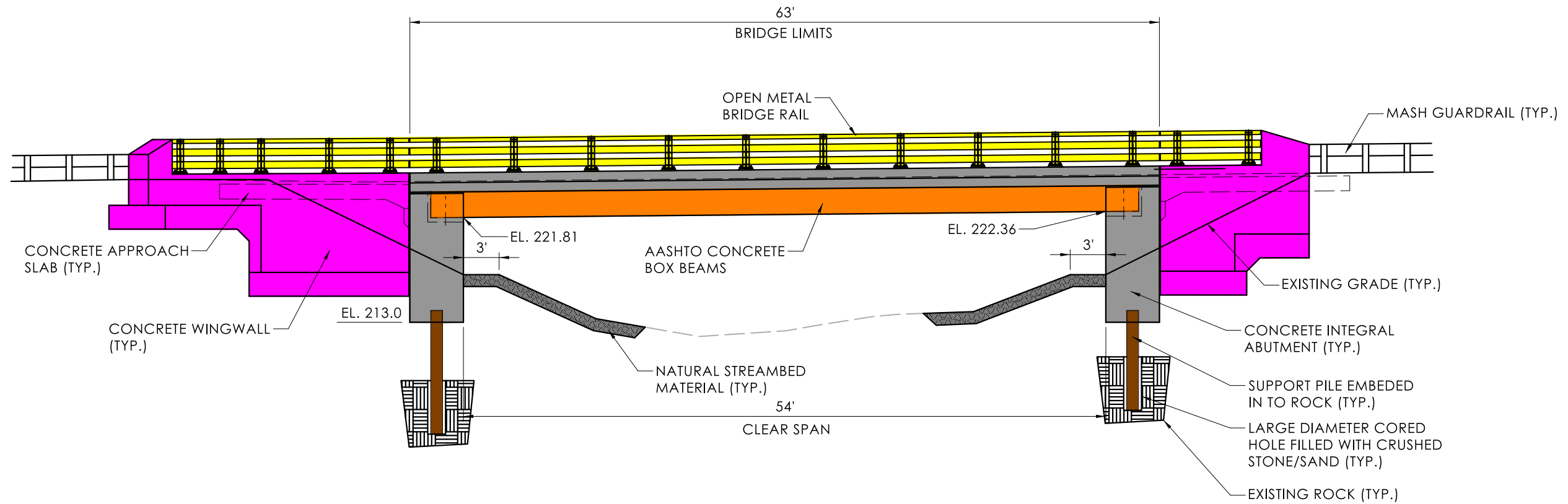

**LEGEND**

- PROPOSED STRUCTURE
- PROPOSED RAILING
- PROPOSED WINGWALLS
- PROPOSED AASHTO CONCRETE BOX BEAMS
- PROPOSED PILE FOUNDATION

**ELEVATION**

SCALE: 1"=10'

<b>BRIDGE REPLACEMENT WOODCHUCK HILL ROAD OVER LITTLE RIVER</b>	
<b>PROPOSED ALTERNATE B</b>	
CITY/TOWN: <b>CANTERBURY</b>	BRIDGE NO. <b>04600</b>
STATE PROJECT NO.: <b>0022-0107</b>	DATE: 4/25/2024

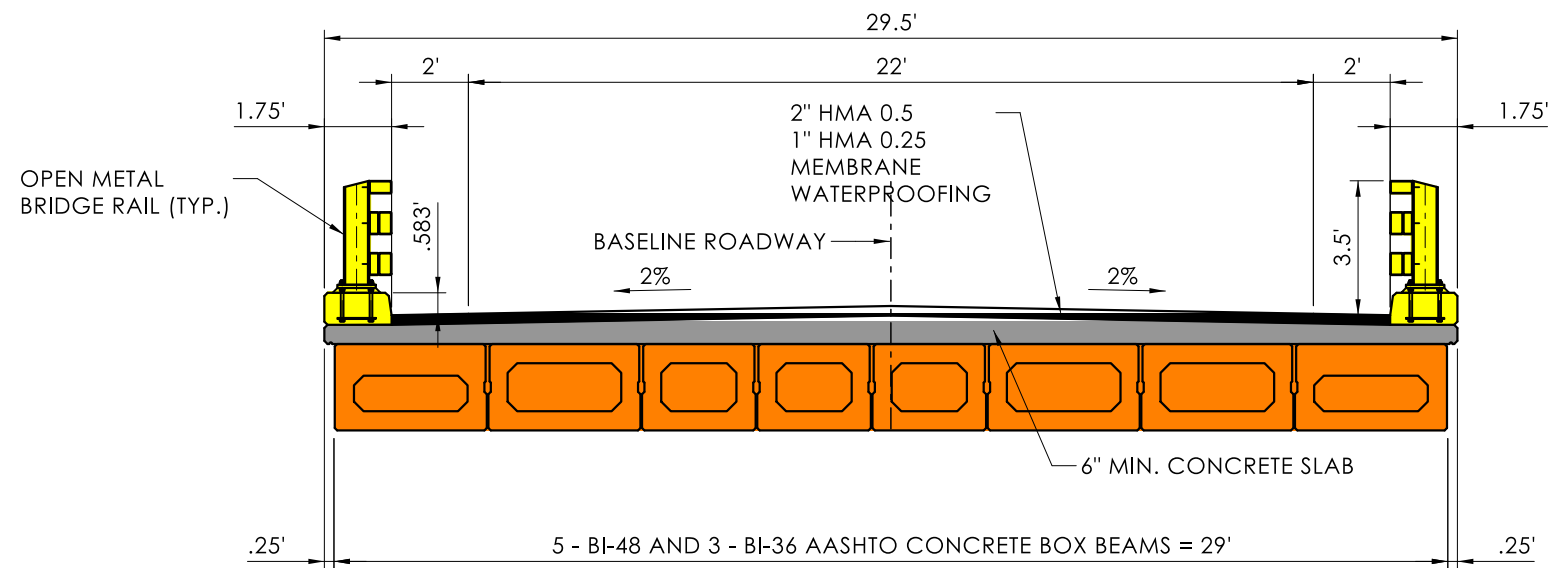

**LEGEND**

- PROPOSED SHEAR SLAB
- PROPOSED RAILING
- BITUMINOUS CONCRETE OVERLAY
- PROPOSED AASHTO CONCRETE BOX BEAMS

**TYPICAL SECTION**

SCALE: 1"=5'

<b>BRIDGE REPLACEMENT</b>	
<b>WOODCHUCK HILL ROAD OVER LITTLE RIVER</b>	
<b>PROPOSED ALTERNATE B</b>	
CITY/TOWN: <b>CANTERBURY</b>	BRIDGE NO. <b>04600</b>
STATE PROJECT NO.: <b>0022-0107</b>	DATE: 4/25/2024

230



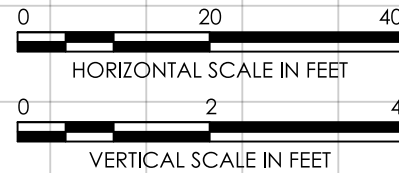
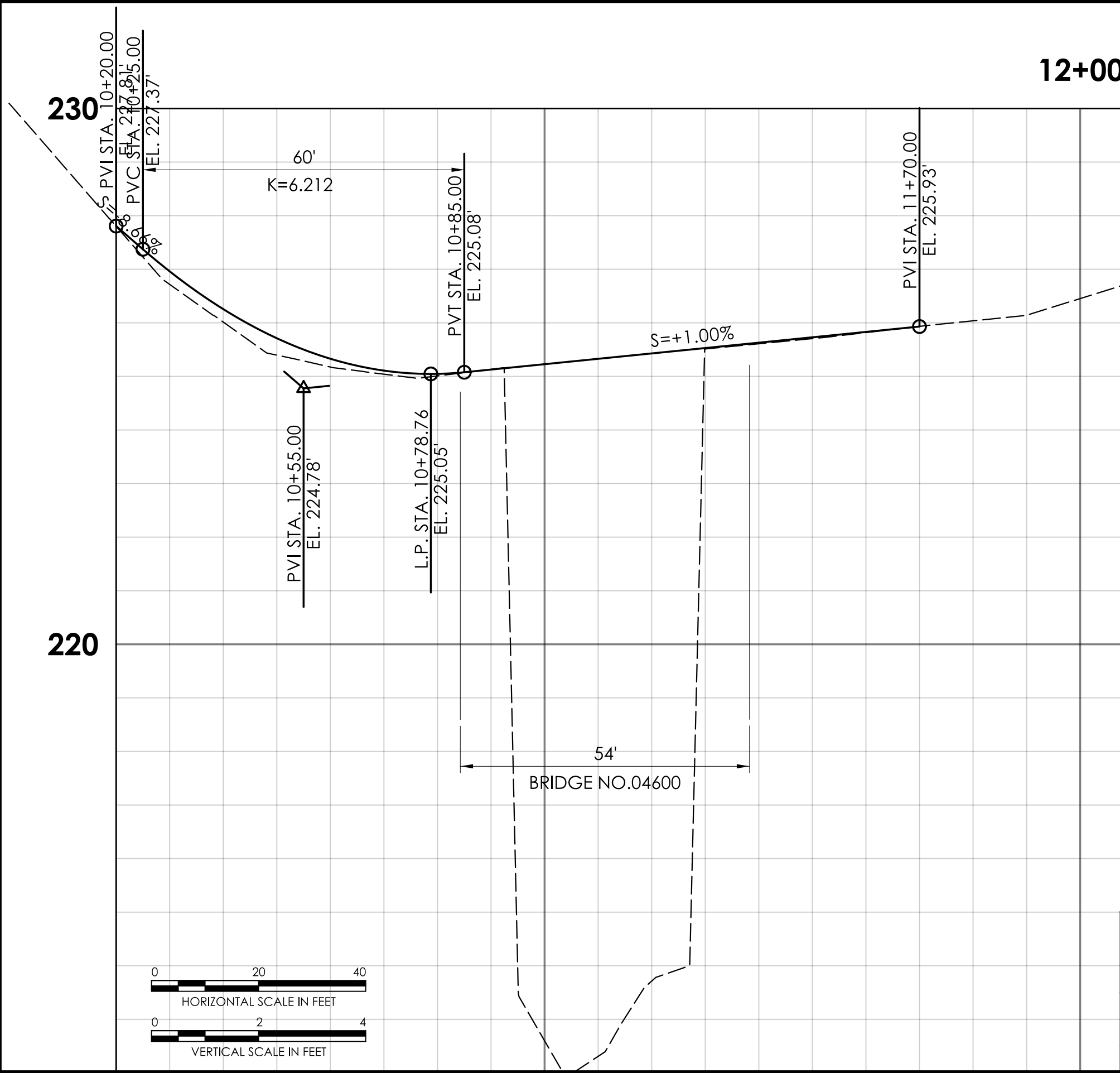

12+00

220

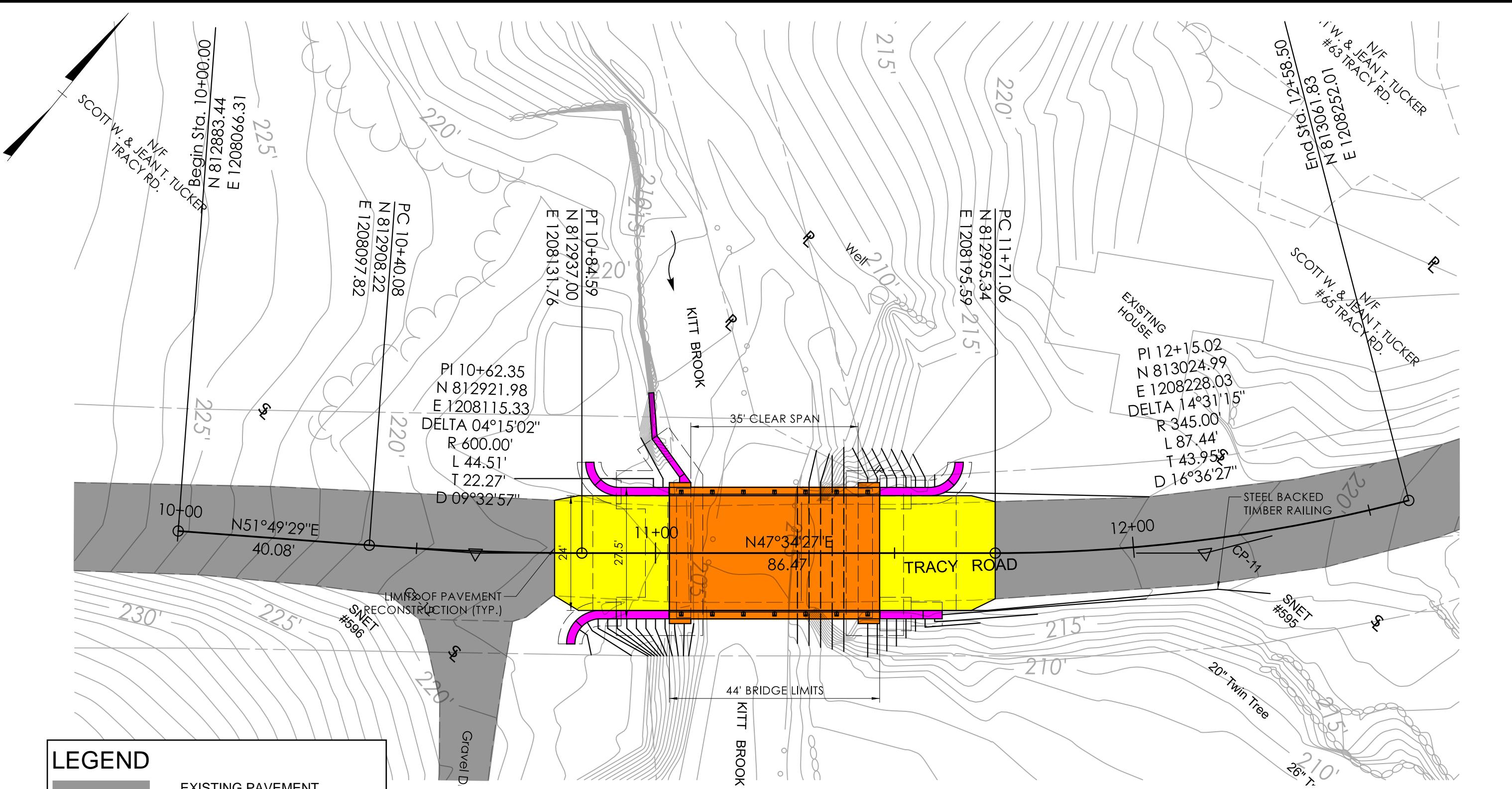

<b>BRIDGE REPLACEMENT WOODCHUCK HILL ROAD OVER LITTLE RIVER</b>	
<b>PROPOSED VERTICAL ALIGNMENT</b>	
CITY/TOWN: <b>CANTERBURY</b>	BRIDGE NO. <b>04600</b>
STATE PROJECT NO.: <b>0022-0107</b>	DATE: 4/25/2024



LEGEND	
	EXISTING PAVEMENT
	ROADWAY RECONSTRUCTION
	PROPOSED WINGWALL
	PROPOSED STRUCTURE

**PLAN**  
SCALE: 1"=20'

<b>BRIDGE REPLACEMENT TRACY ROAD OVER KITT BROOK</b>	
<b>PROPOSED ALTERNATE B</b>	
CITY/TOWN: <b>CANTERBURY</b>	BRIDGE NO. <b>05413</b>
STATE PROJECT NO.: <b>0022-0108</b>	DATE: 3/22/2024

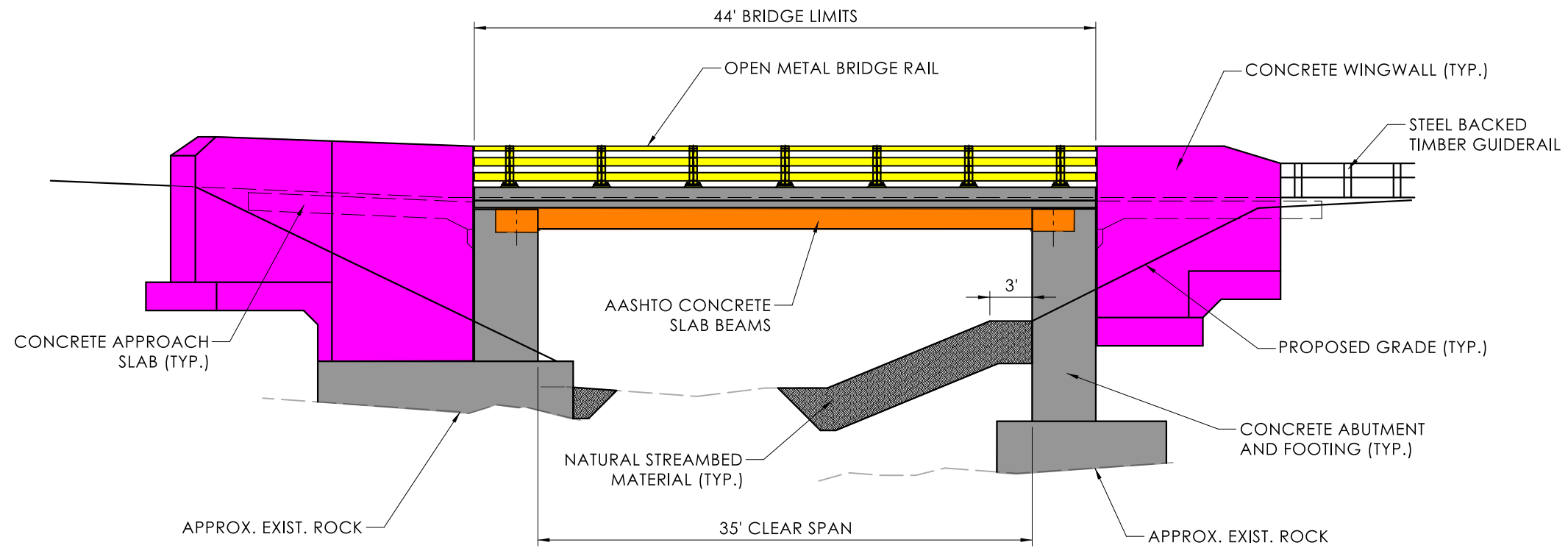

**LEGEND**

- PROPOSED STRUCTURE
- PROPOSED RAILING
- PROPOSED WINGWALLS
- PROPOSED AASHTO CONCRETE SLAB BEAMS
- PROPOSED PILE FOUNDATION

**ELEVATION**

SCALE: 1"=10'

<b>BRIDGE REPLACEMENT TRACY ROAD OVER KITT BROOK</b>	
<b>PROPOSED ALTERNATE B</b>	
CITY/TOWN: <b>CANTERBURY</b>	BRIDGE NO. <b>05413</b>
STATE PROJECT NO.: <b>0022-0108</b>	DATE: 3/22/2024

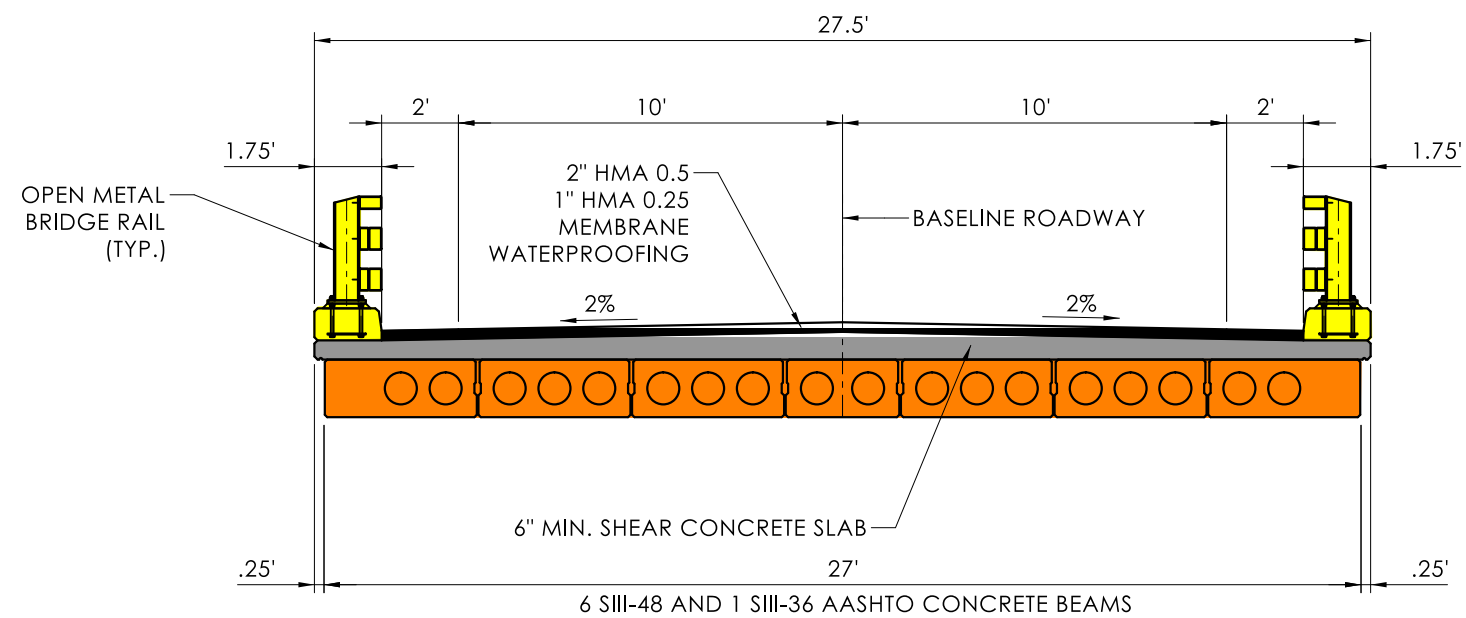

**LEGEND**

- PROPOSED SHEAR SLAB
- PROPOSED RAILING
- BITUMINOUS CONCRETE OVERLAY
- PROPOSED AASHTO CONCRETE SLAB BEAMS

**TYPICAL SECTION**

SCALE: 1"=5'

<b>BRIDGE REPLACEMENT TRACY ROAD OVER KITT BROOK</b>	
<b>PROPOSED ALTERNATE B</b>	
CITY/TOWN: <b>CANTERBURY</b>	BRIDGE NO. <b>05413</b>
STATE PROJECT NO.: <b>0022-0108</b>	DATE: 3/22/2024

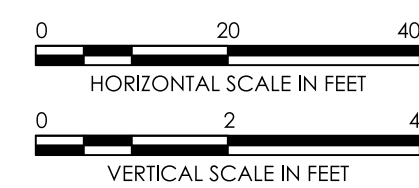
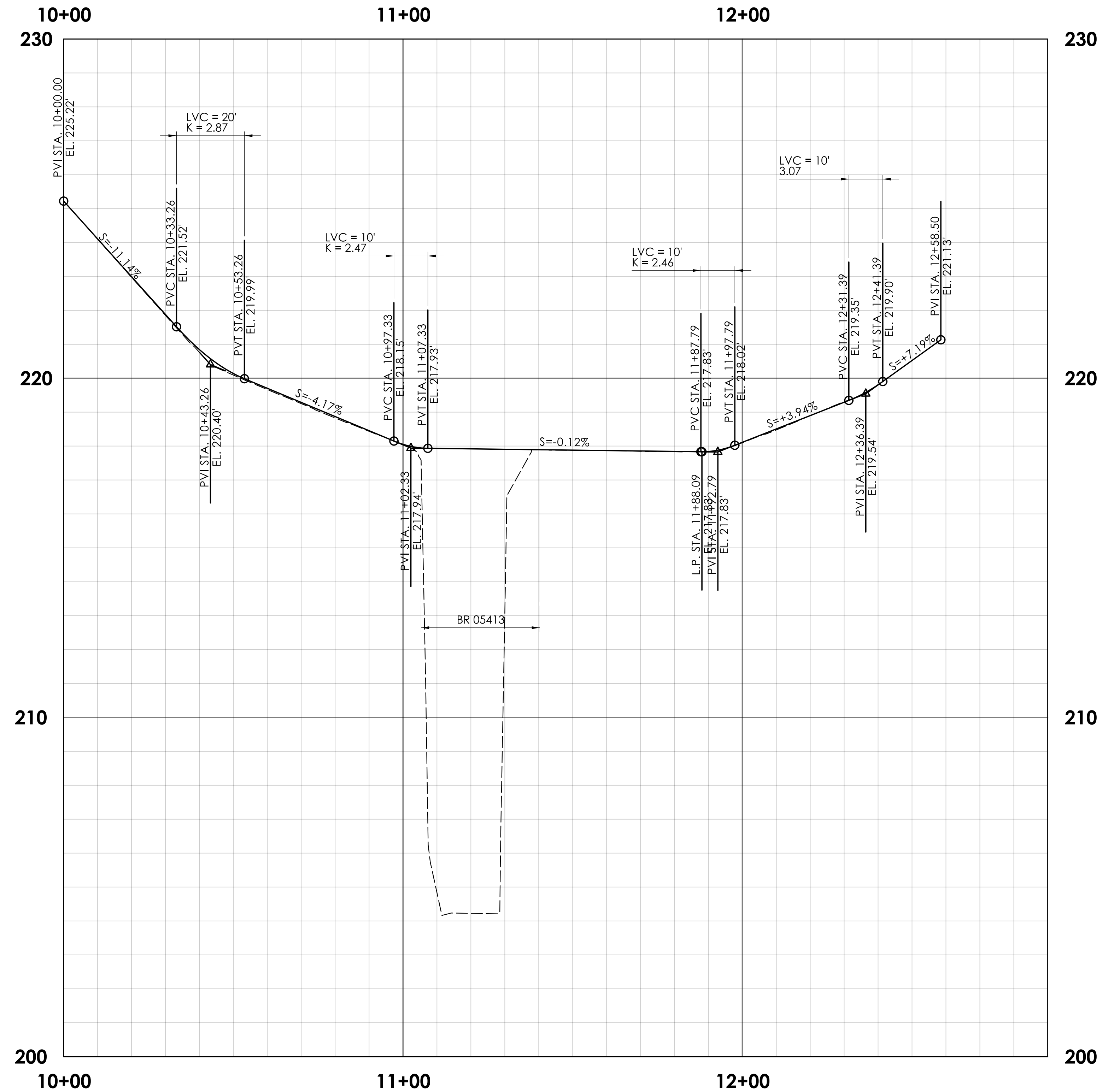

<b>BRIDGE REPLACEMENT TRACY ROAD OVER KITT BROOK</b>	
<b>PROFILE</b>	
CITY/TOWN: <b>CANTERBURY</b>	BRIDGE NO. <b>05413</b>
STATE PROJECT NO.: <b>0022-0108</b>	DATE: 3/22/2024