

PROJECT LOCATION

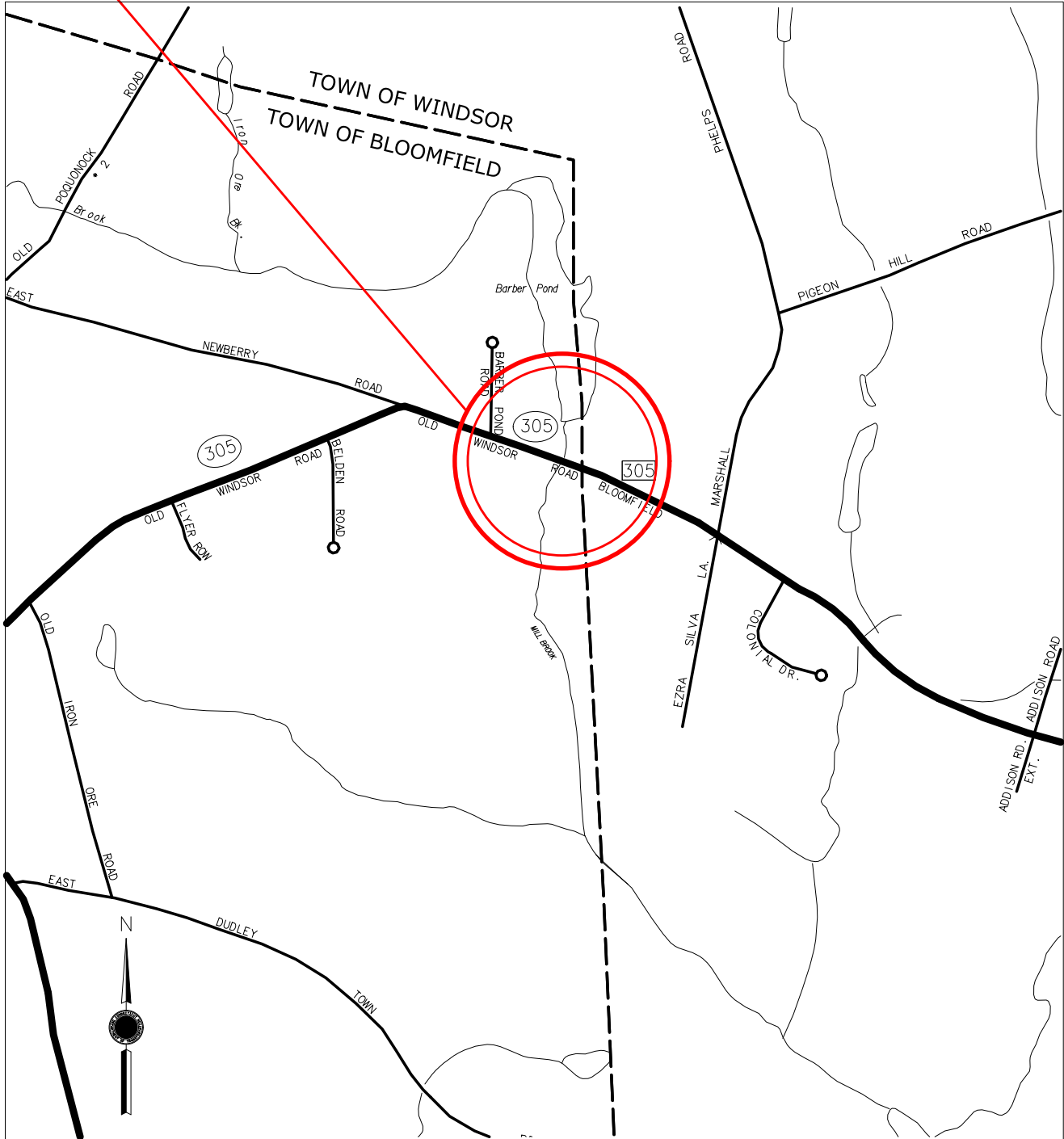

BLOOMFIELD CONNECTICUT

PREPARED BY THE
CONNECTICUT DEPARTMENT OF TRANSPORTATION

IN COOPERATION WITH THE
U.S. DEPARTMENT OF TRANSPORTATION
FEDERAL HIGHWAY ADMINISTRATION

LOCATION PLAN
CULVERT REPLACEMENT
ROUTE 305

STATE OF CONNECTICUT
DEPARTMENT OF TRANSPORTATION
OFFICE OF ENGINEERING

PROJECT NO.: 0011-0159
TOWN OF BLOOMFIELD
DATE: 07/15/2020

