

APPLICATION BY
 U.S. COAST GUARD
 CIVIL ENGINEERING
 CEU PROVIDENCE
 475 KILVERT ST, STE 100
 WARWICK, RI 02886

ISSUED FOR PERMITTING
 NOT FOR CONSTRUCTION

DREDGE BOAT BASIN
 USCG STA NEW HAVEN
 NEW HAVEN CT

FIGURE 1
 VICINITY MAP

USCG PROJECT NO.
 10612900

SCALE NTS

DATE DEC 2023

SHEET 1 OF 5

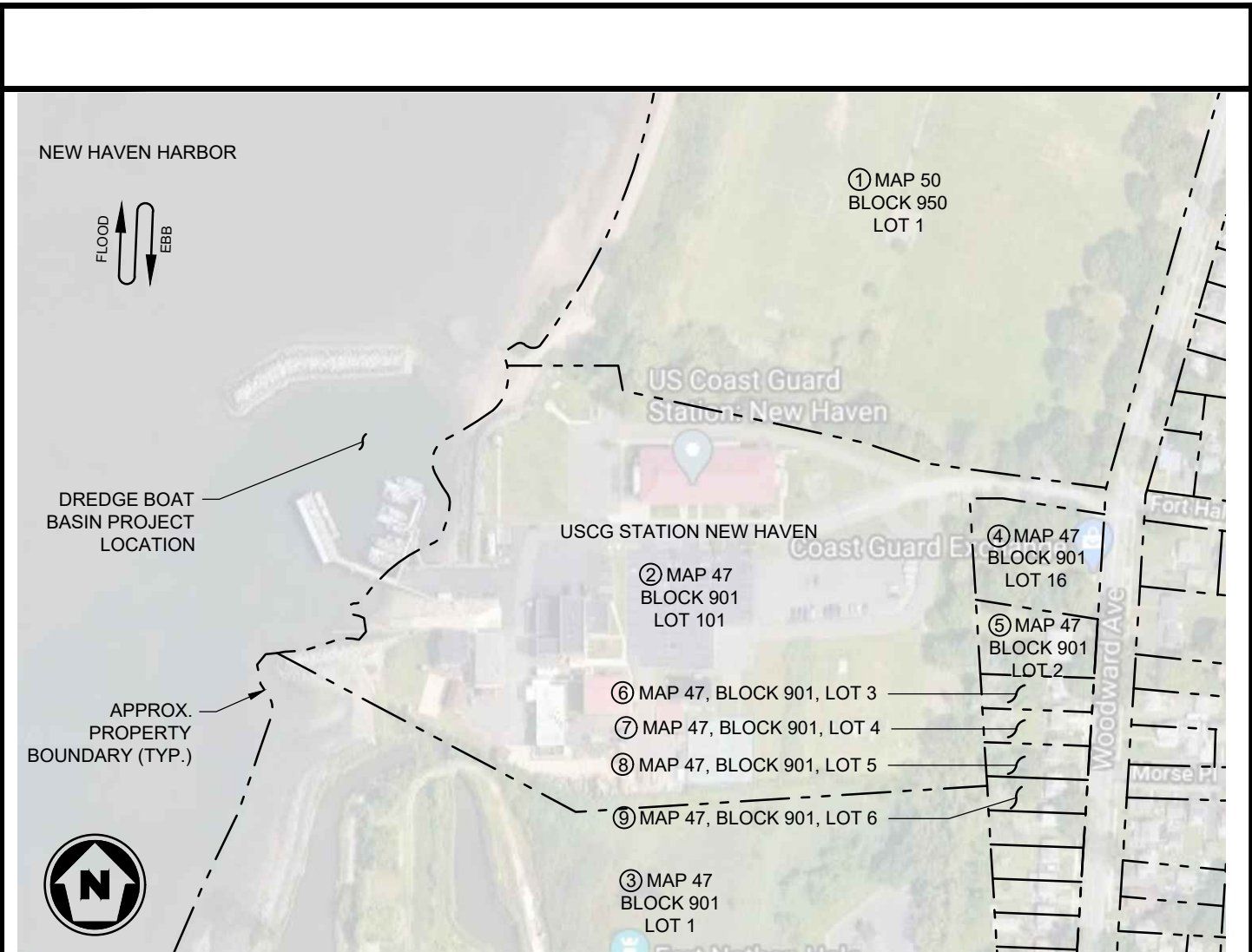

ABUTTING PROPERTY OWNERS:

- ① CITY OF NEW HAVEN, PARK DEPT - 720 EDGEWOOD AVE, NEW HAVEN, CT 06515
- ② UNITED STATES OF AMERICA - 120 WOODWARD AVE, NEW HAVEN, CT 06512
- ③ STATE OF CONNECTICUT - 165 CAPITOL AVE, HARTFORD, CT 06106
- ④ CITY OF NEW HAVEN, PARK DEPT - 720 EDGEWOOD AVE, NEW HAVEN, CT 06515
- ⑤ JOSEPH RYBARUK - 35 UNION AVE, EAST HAVEN, CT 06512
- ⑥ FULVIO GRANDETTI - 686 FOREST RD, NORTHFORD, CT 06472
- ⑦ JACQUELYN DIXON - 100 WOODWARD AVE, NEW HAVEN, CT 06512
- ⑧ LAURA A VEGA - 94 WOODWARD AVE, NEW HAVEN, CT 06512
- ⑨ ANNA MARIA MANDATO - 90 WOODWARD AVE, NEW HAVEN, CT 06512

NOTES:

1. THE AERIAL PHOTOGRAPHY SHOWN WAS OBTAINED FROM GOOGLE EARTH.
2. THE PROPERTY BOUNDARY DATA SHOWN WAS OBTAINED FROM THE CITY OF NEW HAVEN GIS VIEWER AND IS CONSIDERED APPROXIMATE.

APPLICATION BY
U.S. COAST GUARD
CIVIL ENGINEERING
CEU PROVIDENCE
475 KILVERT ST, STE 100
WARWICK, RI 02886

ISSUED FOR PERMITTING
NOT FOR CONSTRUCTION

DREDGE BOAT BASIN
USCG STA NEW HAVEN
NEW HAVEN CT

FIGURE 3

ABUTTING PROPERTIES MAP

USCG PROJECT NO.
10612900

SCALE NTS

DATE DEC 2023

SHEET 3 OF 5

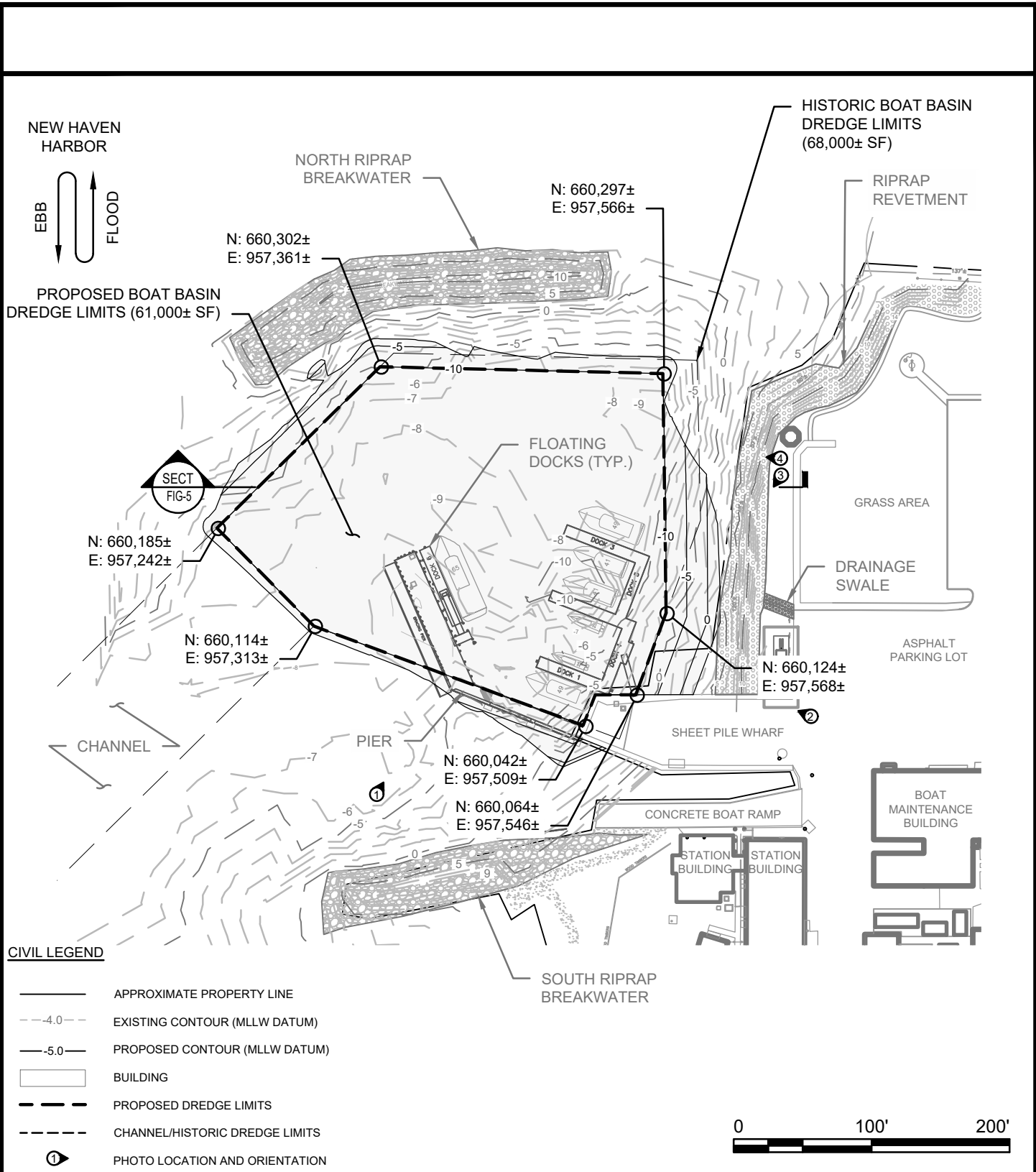

APPLICATION BY
 U.S. COAST GUARD
 CIVIL ENGINEERING
 CEU PROVIDENCE
 475 KILVERT ST, STE 100
 WARWICK, RI 02886

ISSUED FOR PERMITTING
 NOT FOR CONSTRUCTION

DREDGE BOAT BASIN
USCG STA NEW HAVEN
NEW HAVEN CT

FIGURE 4

BOAT BASIN DREDGE AREA

USCG PROJECT NO.
 10612900

SCALE 1" = 100'

DATE DEC 2023

SHEET 4 OF 5

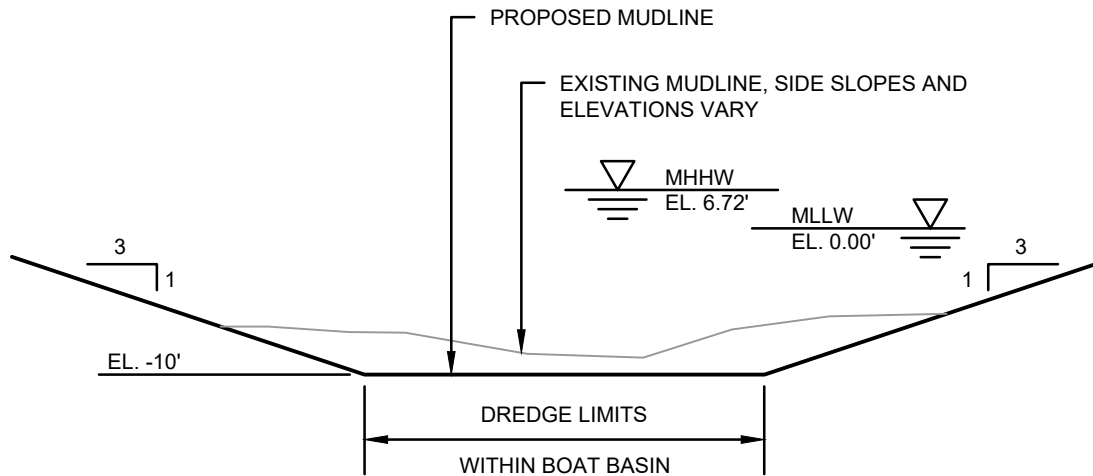

GENERAL NOTES:

1. DREDGING SHALL BE PERFORMED BY MECHANICAL DREDGING TECHNIQUES USING A CLAM SHELL OR FIXED BUCKET LOADING ON A DREDGE MATERIAL TRANSFER BARGE.
2. DREDGE MATERIAL SHALL BE DEWATERED AND DISPOSED OF OFF SITE. TEMPORARY OR PERMANENT UPLAND PLACEMENT ON USCG PROPERTY IS NOT PERMITTED.
3. THE EXISTING BATHYMETRIC CONTOUR DATA SHOWN WAS OBTAINED DURING A SURVEY COMPLETED BY THE USCG ON SEPTEMBER 8, 2020 AND IS CONSIDERED APPROXIMATE.
4. THE DATA DEPICTED ON THIS DRAWING SHOULD NOT BE USED FOR VOLUME CALCULATION PURPOSES.
5. THE SPECIFIED PRE-DREDGE AND POST-DREDGE SURVEYS SHALL BE USED FOR DETERMINING DREDGE VOLUMES. REFER TO THE PROJECT SPECIFICATIONS FOR MORE DETAILS.
6. THE CONTRACTOR SHALL NOT DREDGE WITHIN 25 FEET OF THE RIPRAP BREAKWATERS AND REVETMENT.
7. THE CONTRACTOR SHALL DREDGE TO THE SPECIFIED DREDGE DEPTH UP TO THE PERIMETER OF THE EXISTING FIXED TIMBER PIER, FIXED CONCRETE PIER, AND SHEET PILE WHARF. DREDGING BELOW FIXED PIERS IS NOT REQUIRED.
8. THE CONTRACTOR SHALL DREDGE TO THE SPECIFIED DREDGE DEPTH UP TO THE PERIMETER OF THE EXISTING FLOATING DOCKS WITHOUT RELOCATING THE FLOATING DOCKS. THE AREA BELOW THE FLOATING DOCKS SHALL BE DREDGED AS CLOSE AS POSSIBLE TO THE PROPOSED DREDGE DEPTH FROM THE PERIMETER OF THE FLOATING DOCKS.
9. THE CONTRACTOR SHALL NOT DAMAGE THE EXISTING WATERFRONT INFRASTRUCTURE (E.G., FLOATING DOCKS, GUIDE PILES, GANGWAYS, PIERS, RIPRAP BREAKWATERS/REVELEMENTS, ETC.). ANY DAMAGE IMPARTED TO THE EXISTING WATERFRONT INFRASTRUCTURE SHALL BE REPAIRED TO ITS PREVIOUS CONDITION AND FUNCTION BY THE CONTRACTOR AT NO COST TO THE GOVERNMENT.
10. THE CONTRACTOR SHALL COMPLETE THE REQUIRED DREDGING WITHIN NORMAL WORKING HOURS BETWEEN 0700 AND 1700 WITHOUT IMPACTING THE USCG OPERATIONS IN ANY WAY. THE CONTRACTOR SHALL COORDINATE WITH THE COR AND AND THE SEC LONG ISLAND SOUND FACILITY ENGINEER TO DEVELOP A MUTUALLY AGREED UPON SCHEDULE TO ACCOMPLISH THE PROPOSED DREDGING. THE CONTRACTOR SHALL RELOCATE ALL DREDGE EQUIPMENT AWAY FROM ALL BERTHING AREAS NO LATER THAN 1700 EACH WORKDAY TO ALLOW USCG BOATS TO RETURN TO THEIR NORMAL MOORING LOCATIONS.
11. IF NECESSARY, WORK OUTSIDE OF REGULAR WORKING HOURS MAY BE REQUESTED BY THE CONTRACTOR AND IS SUBJECT TO APPROVAL OF THE KO AND SEC LONG ISLAND SOUND FACILITY ENGINEER. SUBMIT REQUESTS TO THE KO IN WRITING AND INCLUDE DETAILS OF THE PROPOSED ALTERNATE WORK SCHEDULE.

APPLICATION BY
 U.S. COAST GUARD
 CIVIL ENGINEERING
 CEU PROVIDENCE
 475 KILVERT ST, STE 100
 WARWICK, RI 02886

ISSUED FOR PERMITTING
 NOT FOR CONSTRUCTION

DREDGE BOAT BASIN
 USCG STA NEW HAVEN
 NEW HAVEN CT

FIGURE 5

BOAT BASIN DREDGE SECTION

USCG PROJECT NO.
 10612900

SCALE NTS

DATE DEC 2023

SHEET 5 OF 5