

Centerline Communications
Ryan Clark
750 West Center Street, 3rd Flr
West Bridgewater, MA 02379
203-300-7310
rclark@clinellc.com

September 22, 2022

Members of the Siting Council
Connecticut Siting Council
Ten Franklin Square
New Britain, CT 06051

Notice of Exempt Modification
15 Pent Road Deep River, CT 06417
Latitude: 41.372825
Longitude: -72.434436
T-Mobile Site#: CT11237C

Dear Ms. Bachman:

T-Mobile currently maintains six (6) antennas at the 178-foot level of the existing 182-foot monopole tower at 15 Pent Road Deep River, CT 06417. The 182-foot tower is owned by Crown Castle and property is owned by Dzenis Jasavic. T-Mobile now intends to install/add a 48KW diesel generator to the their existing leased space within the existing compound.

Planned Modifications:

Install New:

(1) 48KW diesel generator

Existing to Remain:

(3) 1 5/8" hybrid lines

(6) RRU

(3) AIR6419 B41

(3) APXVAARR24_43-U-NA20

Existing Ground Equipment:

(4) Cabinets

This facility was approved by the local jurisdiction permit number 00-1-182 on August 18, 2000. We used the information from the previous filing. Please see attached.

Please accept this letter as notification pursuant to Regulations of Connecticut State Agencies § 16-50j-73, for construction that constitutes an exempt modification pursuant to R.C.S.A. § 16-50j-72(b)(2). In accordance with R.C.S.A. § 16-50j-73, a copy of this letter is being sent to Angus L. McDonald, Jr., Chief Elected Official and Planning and Zoning for the Town of Deep River, as well as the property owner and the tower owner.

The planned modifications to the facility fall squarely within those activities explicitly provided for in R.C.S.A. § 16-50j-72(b)(2).

1. The proposed modifications will not result in an increase in the height of the existing structure.
2. The proposed modifications will not require the extension of the site boundary.
3. The proposed modifications will not increase noise levels at the facility by six decibels or more, or to levels that exceed state and local criteria.
4. The operation of the replacement antennas will not increase radio frequency emissions at the facility to a level at or above the Federal Communications Commission safety standard.
5. The proposed modifications will not cause a change or alteration in the physical or environmental characteristics of the site.
6. The existing structure and its foundation can support the proposed loading.

For the foregoing reasons, T-Mobile respectfully submits that the proposed modifications to the above referenced telecommunications facility constitute an exempt modification under R.C.S.A. § 16-50j-72(b)(2).

Sincerely,

Ryan Clark

Mobile: 203-300-7310

Fax: 508-819-3017

Office: 750 West Center Street, Floor 3 West Bridgewater, MA 02379

Email: rclark@clinellc.com



🏠 750 West Center Street, Floor 3 / Suite 301
West Bridgewater, MA 02379 *Corporate Headquarters*

☎️ 781.713.4725

📠 617.249.0819

Attachments

cc: Angus L. McDonald, Jr., Chief Elected Official
Planning & Zoning for the Town of Deep River
Crown Castle- tower owner
Dzenis Jasavic- property owner

Exhibit A

Original Facility Approval

CT-11-237C

BUILDING PERMIT

JOB WEATHER CARD

DATE AUGUST 18, 2000 PERMIT NO. 00-1-182
APPLICANT VOICE STREAM WIRELESS ADDRESS 109 WILLEY, ROCKY HILL, CT. 06001
(NO.) (STREET) (CONTR'S LICENSE)

PERMIT TO CONSTRUCT ANTENNA TOWER STORY _____ NUMBER OF DWELLING UNITS 0
(TYPE OF IMPROVEMENT) NO. (PROPOSED USE)

AT (LOCATION) 19 BEAT ROAD, DEEP RIVER ZONING DISTRICT _____
(NO.) (STREET)
BETWEEN _____ AND _____
(CROSS STREET) (CROSS STREET)

SUBDIVISION _____ LOT _____ BLOCK _____ LOT SIZE _____

BUILDING IS TO BE _____ FT. WIDE BY _____ FT. LONG BY _____ FT. IN HEIGHT AND SHALL CONFORM IN CONSTRUCTION

TO TYPE _____ USE GROUP _____ BASEMENT WALLS OR FOUNDATION _____ (TYPE)

REMARKS: PERMIT ISSUED FOR THE CONSTRUCTION OF TOWER PER SUBMITTED APPLICATION AND DRAWINGS. ALL APPLICABLE CODES MUST BE MET AND INSPECTIONS REQUESTED. FIRST INSPECTION REQUIRED PRIOR TO POURING ANY CONCRETE.

AREA OR VOLUME _____ ESTIMATED COST \$ 75,000.00 PERMIT FEE \$ 750.00
(CUBIC/SQUARE FEET)

OWNER ROBERT STALSBERG BUILDING DEPT. _____
ADDRESS 19 BEAT ROAD, DEEP RIVER BY _____

THIS PERMIT CONVEYS NO RIGHT TO OCCUPY ANY STREET, ALLEY OR SIDEWALK OR ANY PART THEREOF, EITHER TEMPORARILY OR PERMANENTLY. ENCROACHMENTS ON PUBLIC PROPERTY, NOT SPECIFICALLY PERMITTED UNDER THE BUILDING CODE, MUST BE APPROVED BY THE JURISDICTION. STREET OR ALLEY GRADES AS WELL AS DEPTH AND LOCATION OF PUBLIC SEWERS MAY BE OBTAINED FROM THE DEPARTMENT OF PUBLIC WORKS. THE ISSUANCE OF THIS PERMIT DOES NOT RELEASE THE APPLICANT FROM THE CONDITIONS OF ANY APPLICABLE SUBDIVISION RESTRICTIONS.

- MINIMUM OF THREE CALLED INSPECTIONS REQUIRED FOR ALL CONSTRUCTION WORK:
1. FOUNDATIONS OR FOOTINGS.
 2. PRIOR TO COVERING STRUCTURAL MEMBERS (READY FOR LATH OR FINISH COVERING).
 3. FINAL INSPECTION BEFORE OCCUPANCY.

APPROVED PLANS MUST BE RETAINED ON JOB AND THIS CARD KEPT POSTED UNTIL FINAL INSPECTION HAS BEEN MADE. WHERE A CERTIFICATE OF OCCUPANCY IS REQUIRED, SUCH BUILDING SHALL NOT BE OCCUPIED UNTIL FINAL INSPECTION HAS BEEN MADE.

WHERE APPLICABLE SEPARATE PERMITS ARE REQUIRED FOR ELECTRICAL, PLUMBING AND MECHANICAL INSTALLATIONS.

POST THIS CARD SO IT IS VISIBLE FROM STREET

BUILDING INSPECTION APPROVALS	PLUMBING INSPECTION APPROVALS	ELECTRICAL INSPECTION APPROVALS
1	1	1
2	2	2
3	HEATING INSPECTING APPROVALS	REFRIGERATION INSPECTION APPROVALS
	1	1
OTHER	2	2

WORK SHALL NOT PROCEED UNTIL THE INSPECTOR HAS APPROVED THE VARIOUS STAGES OF CONSTRUCTION.

PERMIT WILL BECOME NULL AND VOID IF CONSTRUCTION WORK IS NOT STARTED WITHIN SIX MONTHS OF DATE THE PERMIT IS ISSUED AS NOTED ABOVE.

INSPECTIONS INDICATED ON THIS CARD CAN BE ARRANGED FOR BY TELEPHONE OR WRITTEN NOTIFICATION.

FORM NO. BOCA * BP 1994

Exhibit B

Property Card

15 PENT RD

Location 15 PENT RD

Mblu 58 / 34 / 1

Acct# 00155800

Owner JASAVIC DZENIS

Assessment \$294,210

Appraisal \$420,300

PID 1745

Building Count 2

Current Value

Appraisal			
Valuation Year	Improvements	Land	Total
2020	\$280,000	\$140,300	\$420,300

Assessment			
Valuation Year	Improvements	Land	Total
2020	\$196,000	\$98,210	\$294,210

Parcel Addresses

Additional Addresses
No Additional Addresses available for this parcel

Owner of Record

Owner JASAVIC DZENIS
Co-Owner
Address 15 PENT RD
DEEP RIVER , CT 06417

Sale Price \$0
Certificate
Book & Page 0249/0355
Sale Date 12/21/2020
Instrument 29

Ownership History

Ownership History					
Owner	Sale Price	Certificate	Book & Page	Instrument	Sale Date
JASAVIC DZENIS	\$0		0249/0355	29	12/21/2020
JASAVIC DZENIS	\$215,500		0249/0227	00	12/10/2020
BEKS HOLDINGS LLC	\$0		0245/0450	29	11/13/2019
BEKS HOLDINGS LLC	\$0		0245/0035	29	09/30/2019

Building Information

Building 1 : Section 1

Year Built: 1930
Living Area: 2,954

Building Attributes	
Field	Description
Style:	Colonial
Model	Residential
Grade:	Good
Stories:	2
Occupancy	1
Exterior Wall 1	Aluminum Sidng
Exterior Wall 2	
Roof Structure:	Gable/Hip
Roof Cover	Asph/F GlS/Cmp
Interior Wall 1	Plastered
Interior Wall 2	Cust Wd Panel
Interior Flr 1	Hardwood
Interior Flr 2	Carpet
Heat Fuel	Oil
Heat Type:	Hot Water
AC Type:	None
Total Bedrooms:	4 Bedrooms
Total Bthrms:	2
Total Half Baths:	1
Total Xtra Fixtrs:	1
Total Rooms:	12 Rooms
Bath Style:	Average
Kitchen Style:	Average
Num Kitchens	
Cndtn	
Num Park	
Fireplaces	
Fndtn Cndtn	
Basement	

Building Photo



(https://images.vgsi.com/photos/DeepRiverCTPhotos///0009/15PENTRD_9)

Building Layout

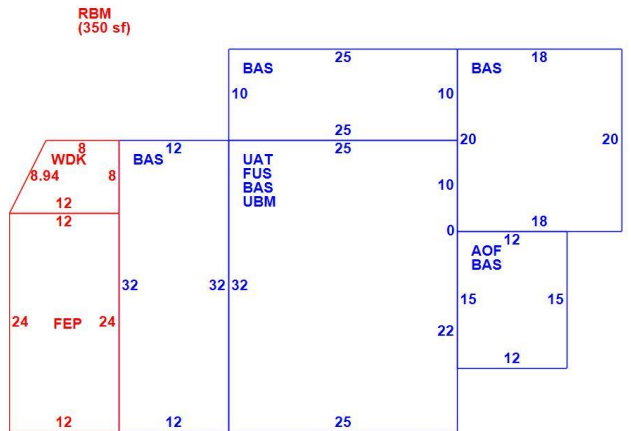

(ParcelSketch.ashx?pid=1745&bid=1745)

Building Sub-Areas (sq ft)			
Code	Description	Gross Area	Living Area
BAS	First Floor	1,974	1,974
FUS	Upper Story, Finished	800	800
AOF	Office, (Average)	180	180
FEP	Porch, Enclosed, Finished	288	0
RBM	Rec Room Bsmt	350	0
UAT	Attic, Unfinished	800	0
UBM	Basement, Unfinished	800	0
WDK	Deck, Wood	80	0
		5,272	2,954

Building 2 : Section 1

Year Built: 1948

Living Area: 408

Building Attributes : Bldg 2 of 2	
Field	Description
Style:	Warehouse
Model	Ind or Comm
Grade	Average
Stories:	1
Occupancy	1.00
Exterior Wall 1	Concr/Cinder
Exterior Wall 2	
Roof Structure	Gable/Hip
Roof Cover	Asph/F GlS/Cmp
Interior Wall 1	Minim/Masonry
Interior Wall 2	Cust Wd Panel
Interior Floor 1	Concr-Finished
Interior Floor 2	Carpet
Heating Fuel	None
Heating Type	None
AC Type	None
Struct Class	
Bldg Use	COMM WHSE
Total Rooms	
Total Bedrms	00
Total Baths	0
1st Floor Use:	3160
Heat/AC	NONE
Frame Type	MASONRY
Baths/Plumbing	AVERAGE
Ceiling/Wall	CEILING ONLY
Rooms/Prtns	AVERAGE
Wall Height	12.00
% Comn Wall	0.00

Building Photo



(https://images.vgsi.com/photos/DeepRiverCTPhotos///0009/PENTRD2_96)

Building Layout

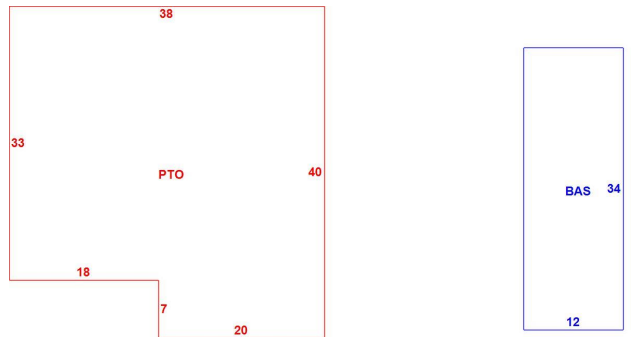

(ParcelSketch.ashx?pid=1745&bid=2279)

Building Sub-Areas (sq ft)			
Code	Description	Gross Area	Living Area
BAS	First Floor	408	408
PTO	Patio	1,394	0
		1,802	408

Land

Land Use

Use Code 0101
Description Single Fam MDL-01

Land Line Valuation

Size (Acres) 3.9
Assessed Value \$98,210

Zone R60
Neighborhood 0002

Appraised Value \$140,300

Outbuildings

Outbuildings		
Code	Description	Size
SHD1	SHED FRAME	30.00 S.F.
SHD2	W/LIGHTS ETC	80.00 S.F.
SPL3	GUNITE	800.00 S.F.

Exhibit C

Construction Drawings

GENERAL NOTES

- FOR THE PURPOSE OF CONSTRUCTION DRAWING, THE FOLLOWING DEFINITIONS SHALL APPLY:
CONTRACTOR - CENTERLINE COMMUNICATIONS
SUBCONTRACTOR - GENERAL CONTRACTOR (CONSTRUCTION)
OWNER - T-MOBILE MOBILITY
- PRIOR TO THE SUBMISSION OF BIDS, THE BIDDING SUBCONTRACTOR SHALL VISIT THE CELL SITE TO FAMILIARIZE WITH THE EXISTING CONDITIONS AND TO CONFIRM THAT THE WORK CAN BE ACCOMPLISHED AS SHOWN ON THE CONSTRUCTION DRAWINGS. ANY DISCREPANCY FOUND SHALL BE BROUGHT TO THE ATTENTION OF CONTRACTOR.
- ALL MATERIALS FURNISHED AND INSTALLED SHALL BE IN STRICT ACCORDANCE WITH ALL APPLICABLE CODES, REGULATIONS, AND ORDINANCES. SUBCONTRACTOR SHALL ISSUE ALL APPROPRIATE NOTICES AND COMPLY WITH ALL LAWS, ORDINANCES, RULES, REGULATIONS, AND LAWFUL ORDERS OF ANY PUBLIC AUTHORITY REGARDING THE PERFORMANCE OF THE WORK. ALL WORK CARRIED OUT SHALL COMPLY WITH ALL APPLICABLE MUNICIPAL AND UTILITY COMPANY SPECIFICATIONS AND LOCAL JURISDICTIONAL CODES, ORDINANCES AND APPLICABLE REGULATIONS.
- DRAWINGS PROVIDED HERE ARE NOT TO BE SCALED AND ARE INTENDED TO SHOW OUTLINE ONLY.
- UNLESS NOTED OTHERWISE, THE WORK SHALL INCLUDE FURNISHING MATERIALS, EQUIPMENT, APPURTENANCES, AND LABOR NECESSARY TO COMPLETE ALL INSTALLATIONS AS INDICATED ON THE DRAWINGS.
- "KITTING LIST" SUPPLIED WITH THE BID PACKAGE IDENTIFIES ITEMS THAT WILL BE SUPPLIED BY CONTRACTOR. ITEMS NOT INCLUDED IN THE BILL OF MATERIALS AND KITTING LIST SHALL BE SUPPLIED BY THE SUBCONTRACTOR.
- THE SUBCONTRACTOR SHALL INSTALL ALL EQUIPMENT AND MATERIALS IN ACCORDANCE WITH MANUFACTURER'S RECOMMENDATIONS UNLESS SPECIFICALLY STATED OTHERWISE.
- IF THE SPECIFIED EQUIPMENT CANNOT BE INSTALLED AS SHOWN ON THESE DRAWINGS, THE SUBCONTRACTOR SHALL PROPOSE AN ALTERNATIVE INSTALLATION SPACE FOR APPROVAL BY THE CONTRACTOR.
- SUBCONTRACTOR SHALL DETERMINE ACTUAL ROUTING OF CONDUIT, POWER AND T1 CABLES, GROUNDING CABLES AS SHOWN ON THE POWER, GROUNDING AND TELCO PLAN DRAWING. SUBCONTRACTOR SHALL UTILIZE EXISTING TRAYS AND/OR SHALL ADD NEW TRAYS AS NECESSARY. SUBCONTRACTOR SHALL CONFIRM THE ACTUAL ROUTING WITH THE CONTRACTOR.
- THE SUBCONTRACTOR SHALL PROTECT EXISTING IMPROVEMENTS, PAVEMENTS, CURBS, LANDSCAPING AND STRUCTURES. ANY DAMAGED PART SHALL BE REPAIRED AT SUBCONTRACTOR'S EXPENSE TO THE SATISFACTION OF OWNER.
- SUBCONTRACTOR SHALL LEGALLY AND PROPERLY DISPOSE OF ALL SCRAP MATERIALS SUCH AS COAXIAL CABLES AND OTHER ITEMS REMOVED FROM THE EXISTING FACILITY. ANTENNAS REMOVED SHALL BE RETURNED TO THE OWNER'S DESIGNATED LOCATION.
- SUBCONTRACTOR SHALL LEAVE PREMISES IN CLEAN CONDITION.
- ALL CONCRETE REPAIR WORK SHALL BE DONE IN ACCORDANCE WITH AMERICAN CONCRETE INSTITUTE (ACI) 301.
- ANY NEW CONCRETE NEEDED FOR THE CONSTRUCTION SHALL BE AIR-ENTRAINED AND SHALL HAVE 4000 PSI STRENGTH AT 28 DAYS. ALL CONCRETE WORK SHALL BE DONE IN ACCORDANCE WITH ACI 318 CODE REQUIREMENTS.

- ALL STRUCTURAL STEEL WORK SHALL BE DETAILED, FABRICATED AND ERECTED IN ACCORDANCE WITH AISC SPECIFICATIONS. ALL STRUCTURAL STEEL SHALL BE ASTM A36 (Fy = 36 ksi) UNLESS OTHERWISE NOTED. PIPES SHALL BE ASTM A53 TYPE E (Fy = 36 ksi). ALL STEEL EXPOSED TO WEATHER SHALL BE HOT DIPPED GALVANIZED. TOUCHUP ALL SCRATCHES AND OTHER MARKS IN THE FIELD AFTER STEEL IS ERECTED USING A COMPATIBLE ZINC RICH PAINT.
- CONSTRUCTION SHALL COMPLY WITH SPECIFICATIONS AND "GENERAL CONSTRUCTION SERVICES FOR CONSTRUCTION OF T-MOBILE MOBILITY SITES."
- SUBCONTRACTOR SHALL VERIFY ALL EXISTING DIMENSIONS AND CONDITIONS PRIOR TO COMMENCING ANY WORK. ALL DIMENSIONS OF EXISTING CONSTRUCTION SHOWN ON THE DRAWINGS MUST BE VERIFIED. SUBCONTRACTOR SHALL NOTIFY THE CONTRACTOR OF ANY DISCREPANCIES PRIOR TO ORDERING MATERIAL OR PROCEEDING WITH CONSTRUCTION.
- THE EXISTING CELL SITE IS IN FULL COMMERCIAL OPERATION. ANY CONSTRUCTION WORK BY SUBCONTRACTOR SHALL NOT DISRUPT THE EXISTING NORMAL OPERATION. ANY WORK ON EXISTING EQUIPMENT MUST BE COORDINATED WITH CONTRACTOR. ALSO, WORK SHOULD BE SCHEDULED FOR AN APPROPRIATE MAINTENANCE WINDOW USUALLY IN LOW TRAFFIC PERIODS AFTER MIDNIGHT.
- SINCE THE CELL SITE IS ACTIVE, ALL SAFETY PRECAUTIONS MUST BE TAKEN WHEN WORKING AROUND HIGH LEVELS OF ELECTROMAGNETIC RADIATION. EQUIPMENT SHOULD BE SHUTDOWN PRIOR TO PERFORMING ANY WORK THAT COULD EXPOSE THE WORKERS TO DANGER. PERSONAL RF EXPOSURE MONITORS ARE ADVISED TO BE WORN TO ALERT OF ANY DANGEROUS EXPOSURE LEVELS.
- APPLICABLE BUILDING CODES:
SUBCONTRACTOR'S WORK SHALL COMPLY WITH ALL APPLICABLE NATIONAL, STATE, AND LOCAL CODES AS ADOPTED BY THE LOCAL AUTHORITY HAVING JURISDICTION (AHJ) FOR THE LOCATION. THE EDITION OF THE AHJ ADOPTED CODES AND STANDARDS IN EFFECT ON THE DATE OF CONTRACT AWARD SHALL GOVERN THE DESIGN.

BUILDING CODE: IBC 2015 & CONNECTICUT STATE BUILDING CODE 2018
ELECTRICAL CODE: 2017 NATIONAL ELECTRICAL CODE
LIGHTNING CODE: NFPA 70-2017
- SUBCONTRACTOR'S WORK SHALL COMPLY WITH THE LATEST EDITION OF THE FOLLOWING STANDARDS:

AMERICAN CONCRETE INSTITUTE (ACI) 318; BUILDING CODE REQUIREMENTS FOR STRUCTURAL CONCRETE;

AMERICAN INSTITUTE OF STEEL CONSTRUCTION (AISC)

MANUAL OF STEEL CONSTRUCTION, ASD, FOURTEENTH EDITION;

TELECOMMUNICATIONS INDUSTRY ASSOCIATION (TIA) 222-G, STRUCTURAL STANDARDS FOR STEEL

ANTENNA TOWER AND ANTENNA SUPPORTING STRUCTURES; REFER TO ELECTRICAL DRAWINGS FOR SPECIFIC ELECTRICAL STANDARDS.
- FOR ANY CONFLICTS BETWEEN SECTIONS OF LISTED CODES AND STANDARDS REGARDING MATERIAL, METHODS OF CONSTRUCTION, OR OTHER REQUIREMENTS, THE MOST RESTRICTIVE REQUIREMENT SHALL GOVERN. WHERE THERE IS CONFLICT BETWEEN A GENERAL REQUIREMENT AND A SPECIFIC REQUIREMENT, THE SPECIFIC REQUIREMENT SHALL GOVERN.

RF NOTES

- ACTUAL LENGTHS SHALL BE DETERMINED PER SITE CONDITION BY SUBCONTRACTOR
- THE DESIGN IS BASED ON RF DATA SHEETS, SIGNED AND APPROVED.
- RADIO SIGNAL CABLE AND RACEWAY SHALL COMPLY WITH THE REQUIREMENTS OF THE NATIONAL ELECTRICAL CODE (NEC, NFPA 70), CHAPTER 8.
- ALL SPECIFIED MATERIAL FOR EACH LOCATION (E.G. OUT DOORS-OCCUPIED, INDOORS-UNOCCUPIED, PLENUMS, RISER SHAFTS, ETC.) SHALL BE APPROVED, LISTED, OR LABELED AS REQUIRED BY THE NEC.
- RADIO SIGNAL CABLE SHALL BE SUPPORTED AT MINIMUM OF EVERY THREE (3) FEET EXCEPT INSIDE MONOPOLES OR MONOPOLES WHERE CABLE AND CONNECTOR MANUFACTURERS SUPPORT RECOMMENDATIONS SHALL BE FOLLOWED. MANUFACTURER RECOMMENDATION CABLES SUPPORT ACCESSORIES SHALL BE USED.
- THE OUTDOOR CABLE SUPPORT SYSTEM SHALL BE PROVIDED WITH AN ICE SHIELD TO SUPPORT AND PROTECT ANTENNA CABLE RUNS.
- DRIP LOOPS SHALL BE REQUIRED ON ALL OUTSIDE CABLES. CABLES SHALL BE SLOPED AWAY FROM BUILDING OR OUTDOOR BTS CABINETS TO PREVENT WATER FROM ENTERING THROUGH THE COAXIAL CABLE PORT.
- ALL FEEDER LINE AND JUMPER CONNECTORS SHALL BE 7/16 DIN CABLE CONNECTORS THAT MEET IP68 STANDARDS.
- 7/16 DIN CONNECTORS REQUIRE NO ADDITIONAL WEATHER PROOFING IN INDOOR APPLICATIONS IF INSTALLED AND TORQUED PROPERLY. IN OUTDOOR APPLICATIONS WEATHER PROOFING IS REQUIRED AND THE FOLLOWING PROCEDURE SHOULD BE FOLLOWED.
- USING WEATHERPROOFING KIT APPROVED BY CABLE MANUFACTURER AND CONTRACTOR START TAPE APPROXIMATELY 5 INCHES FROM THE CONNECTOR, AND WRAP 2 INCHES TOWARD THE CONNECTOR, THEN REVERSE THE TAPE SO THAT THE STICKY SIDE IS UP. TAPE OVER THE CONNECTOR OR SURGE ARRESTOR UNTIL THREE (3) TO FOUR (4) INCHES BEYOND THE CONNECTOR AND REVERSE AGAIN WITH THE STICKY SIDE DOWN FOR ANOTHER INCH OR TWO. PASS THE BUTYL RUBBER AND FINISH WITH A FINAL LAYER OF TAPE.
- ANTENNAS SHALL BE PAINTED WHEN REQUIRED, BY THE LANDLORD OR AUTHORITY OF HAVING JURISDICTION IN ACCORDANCE WITH ANTENNA MANUFACTURERS' SURFACES PREPARATION AND PAINTING REQUIREMENTS.
- CABLE SHIELDS AND TOWER CONDUITS SHALL BE GROUNDED AT THE TOP OF THE TOWER WITHIN 10 FEET OF THEIR CONNECTORS, AND AT THE BOTTOM OF THE TOWER ABOUT 6 INCHES BEFORE THEY TURN TOWARD THE FACILITY. THEY SHALL BE GROUNDED AT THE MIDPOINT OF THE TOWERS THAT ARE BETWEEN 60 FEET AND 200 FEET HIGH, AND AT INTERVALS OF 60 FEET OR LESS ON TOWERS THAT ARE HIGHER THAN 200 FEET.

ANTENNA CABLE AND SCHEDULING NOTES

- SUBCONTRACTOR SHALL VERIFY THE ACTUAL LENGTH IN THE FIELD BEFORE INSTALLATION.
- TAG AND COLOR CODE ALL MAIN CABLES AT LOCATIONS PER T-MOBILE ANTENNA CABLE MARKING STANDARD:
 - TOP OF TOWER END OF MAIN COAX
 - BOTTOM OF TOWER END OF MAIN COAX
 - DIRECTLY BEFORE AND AFTER RF EQUIPMENT
 - END OF JUMPERS AT BTS EQUIPMENT
- ANTENNAS SHALL BE PROCURED AND INSTALLED WITH DOWN TILT MOUNTING BRACKETS SUPPLIED BY ANTENNA MANUFACTURER.
- PRIOR APPROVAL IS REQUIRED BEFORE PERFORMING ANY WORK ON EXISTING CELL SITE EQUIPMENT.

T-Mobile NORTHEAST LLC

T-MOBILE NORTHEAST, LLC.
35 GRIFFIN RD S
BLOOMFIELD, CT 06002
PHONE: (860) 629-1700



750 W CENTER ST, SUITE 301
WEST BRIDGEWATER, MA 02379
PHONE: 781.713.4725

REVISIONS

REV	DATE	DESCRIPTION	BY
0	09/22/22	ISSUED FOR CONSTRUCTION	SS
A	09/10/22	ISSUED FOR REVIEW	SS

DESIGNED BY: SS	APPROVED BY: WRD
--------------------	---------------------

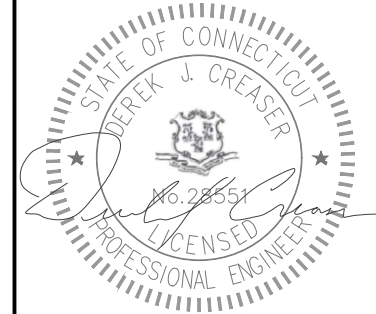

DATE: 09/22/2022

IT IS A VIOLATION OF LAW FOR ANY PERSON UNLESS THEY ARE ACTING UNDER THE DIRECTION OF A LICENSED PROFESSIONAL ENGINEER TO ALTER THIS DOCUMENT, UNLESS EXPLICITLY AGREED TO BY THE ENGINEER IN WRITING. THE ENGINEER DISCLAIMS ALL LIABILITY ASSOCIATED WITH THE REUSE, ALTERATION OR MODIFICATION OF THE CONTENTS HEREIN.

ABBREVIATIONS

AGL	ABOVE GRADE LEVEL	G.C.	GENERAL CONTRACTOR	RF	RADIO FREQUENCY
AWG	AMERICAN WIRE GAUGE	MGB	MASTER GROUND BUS		
BCW	BARE COPPER WIRE	MIN	MINIMUM	TBD	TO BE DETERMINED
BTS	BASE TRANSCEIVER STATION	PROPOSED	NEW	TBR	TO BE REMOVED
EXISTING	EXISTING	N.T.S.	NOT TO SCALE	TBRR	TO BE REMOVED AND REPLACED
EG	EQUIPMENT GROUND	REF	REFERENCE	TYP	TYPICAL
EGR	EQUIPMENT GROUND RING	REQ	REQUIRED		

SITE NAME:
CT11237C/DEEP RIVER/RT 9

SITE ID:
CT11237A

SITE ADDRESS:

15 PENT ROAD
DEEP RIVER, CT 06417
MIDDLESEX COUNTY

SHEET TITLE:
GENERAL NOTES

DRAWING:
GN-1

RAN EQUIPMENT

CABINET	EXISTING	PROPOSED
BATTERY	1	N/A
RBS 6201	1	N/A
200A PPC	1	N/A
RELOCATED EXISTING AAV	N/A	1
ATS	N/A	1

NOTE:
RAN EQUIPMENT IS BASED ON RFDS REVA DATED 08/26/22

**T-Mobile
NORTHEAST LLC**

T-MOBILE NORTHEAST, LLC.
35 GRIFFIN RD S
BLOOMFIELD, CT 06002
PHONE: (860) 629-1700



750 W CENTER ST, SUITE 301
WEST BRIDGEWATER, MA 02379
PHONE: 781.713.4725

REVISIONS

REV	DATE	DESCRIPTION	BY
0	09/22/22	ISSUED FOR CONSTRUCTION	SS
A	09/10/22	ISSUED FOR REVIEW	SS

DESIGNED BY: SS APPROVED BY: WRD

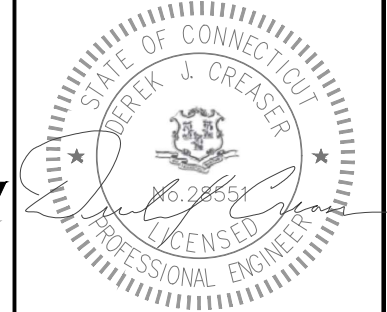

DATE: 09/22/2022

IT IS A VIOLATION OF LAW FOR ANY PERSON UNLESS THEY ARE ACTING UNDER THE DIRECTION OF A LICENSED PROFESSIONAL ENGINEER TO ALTER THIS DOCUMENT. UNLESS EXPLICITLY AGREED TO BY THE ENGINEER IN WRITING, THE ENGINEER DISCLAIMS ALL LIABILITY ASSOCIATED WITH THE REUSE, ALTERATION OR MODIFICATION OF THE CONTENTS HEREIN.

SITE NAME:

CT11237C/DEEP RIVER/RT 9

SITE ID:

CT11237A

SITE ADDRESS:

**15 PENT ROAD
DEEP RIVER, CT 06417
MIDDLESEX COUNTY**

SHEET TITLE:

**COMPOUND &
EQUIPMENT PLAN**

DRAWING:

A-1

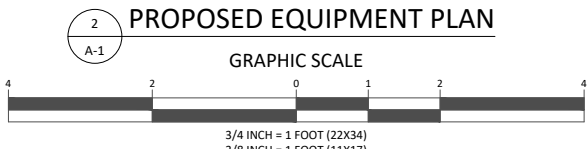
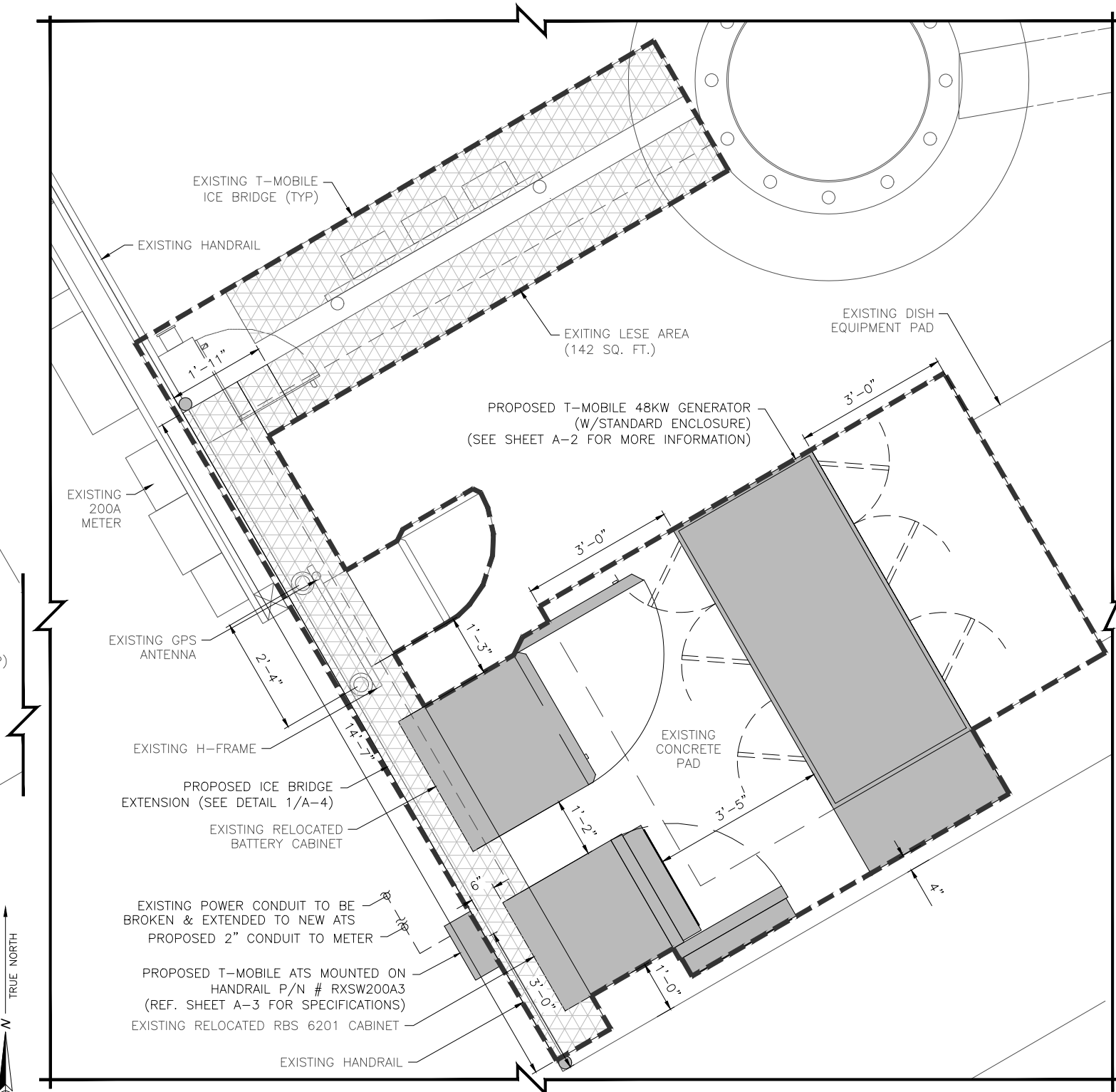
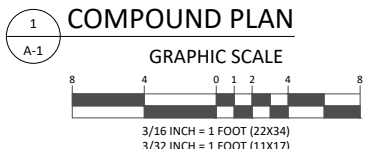
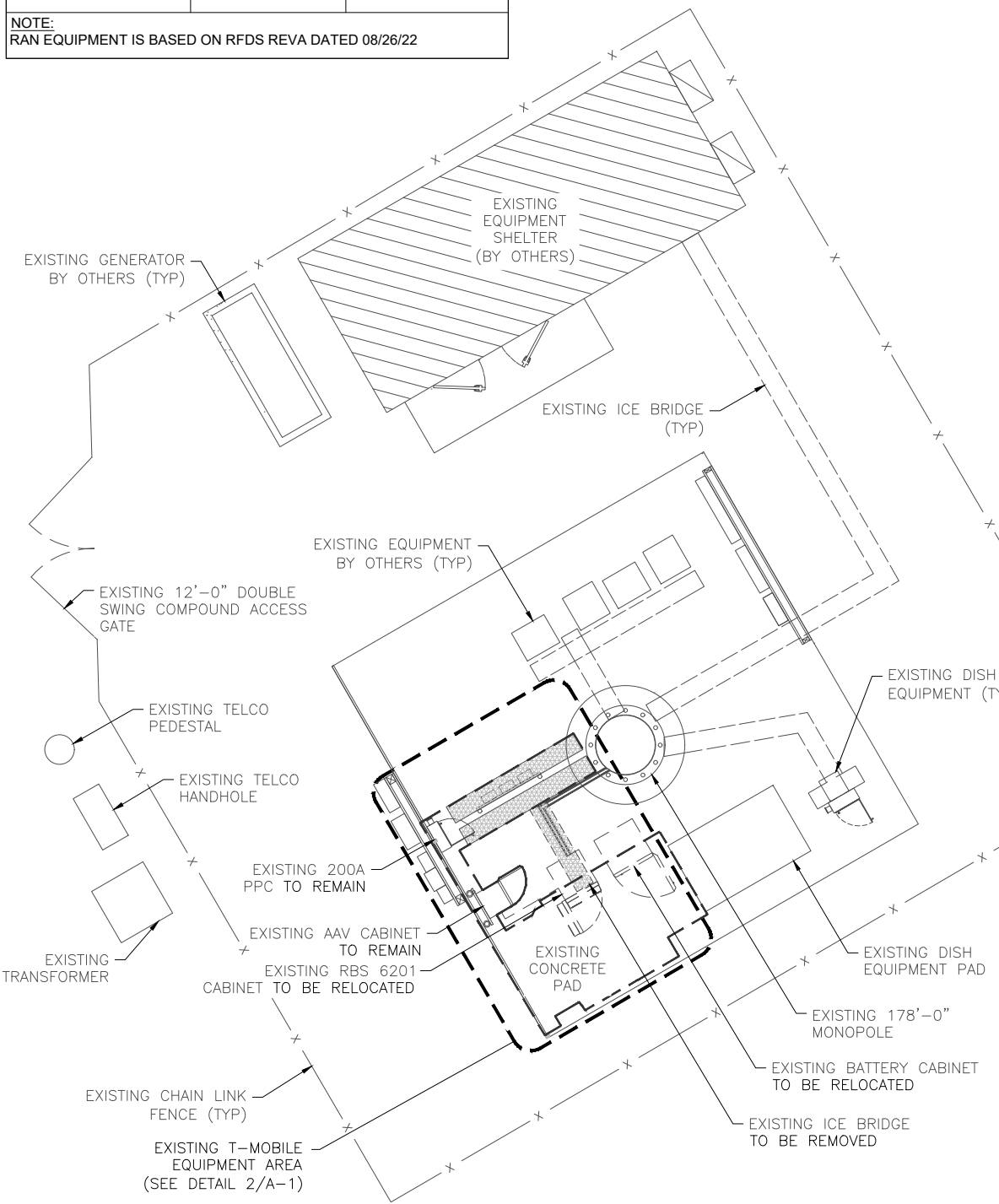

RD048 | 3.4L | 48kW

INDUSTRIAL DIESEL GENERATOR SET

EPA Certified Stationary Emergency



APPLICATION AND ENGINEERING DATA

ENGINE SPECIFICATIONS

General		Cooling System	
Make	Generac	Cooling System Type	Pressurized Closed Recovery
Cylinder #	4	Fan Type	Pusher
Type	In-Line	Fan Speed (rpm)	2,029
Displacement - i(fl)	207.48 (3.4)	Fan Diameter - mm (in)	22 (559)
Bore - in (mm)	3.86 (98)		
Stroke - in (mm)	4.45 (113)	Fuel System	
Compression Ratio	18.5:1	Fuel Type	Ultra Low Sulfur Diesel Fuel
Intake Air Method	Turbocharged/Aftercooled	Fuel Specification	ASTM
Cylinder Head	Cast Iron OHV	Fuel Pump Type	Mechanical Engine Driven Gear
Piston Type	Aluminum	Injector Type	Mechanical
		Fuel Supply Line (mm/in)	7.94 (0.31) ID
		Fuel Return Line (mm/in)	7.94 (0.31) ID
		Fuel Filtering (microns)	10
Engine Governing		Engine Electrical System	
Governor	Electronic	System Voltage	12 VDC
Frequency Regulation (Steady State)	±0.25%	Battery Charger Alternator	Standard
		Battery Size	Group 27F
		Battery Voltage	12 VDC
		Ground Polarity	Negative
Lubrication System			
Oil Pump Type	Gear		
Oil Filter Type	Full Flow Spin-On Canister		
Crankcase Capacity - L (qts)	7.0 (7.4)		

ALTERNATOR SPECIFICATIONS

Standard Model		Standard Excitation	
Standard Model	Generac	Standard Excitation	Direct
Poles	4	Bearings	Sealed Ball
Field Type	Rotating	Coupling	Flexible Disc
Insulation Class - Rotor	F	Prototype Short Circuit Test	Yes
Insulation Class - Stator	H	Voltage Regulator Type	Full Digital
Total Harmonic Distortion	<5%	Regulation Accuracy (Steady State)	±1.0%
Telephone Interference Factor (TIF)	<50		

RD048 | 3.4L | 48kW

INDUSTRIAL DIESEL GENERATOR SET

EPA Certified Stationary Emergency



DIMENSIONS AND WEIGHTS*

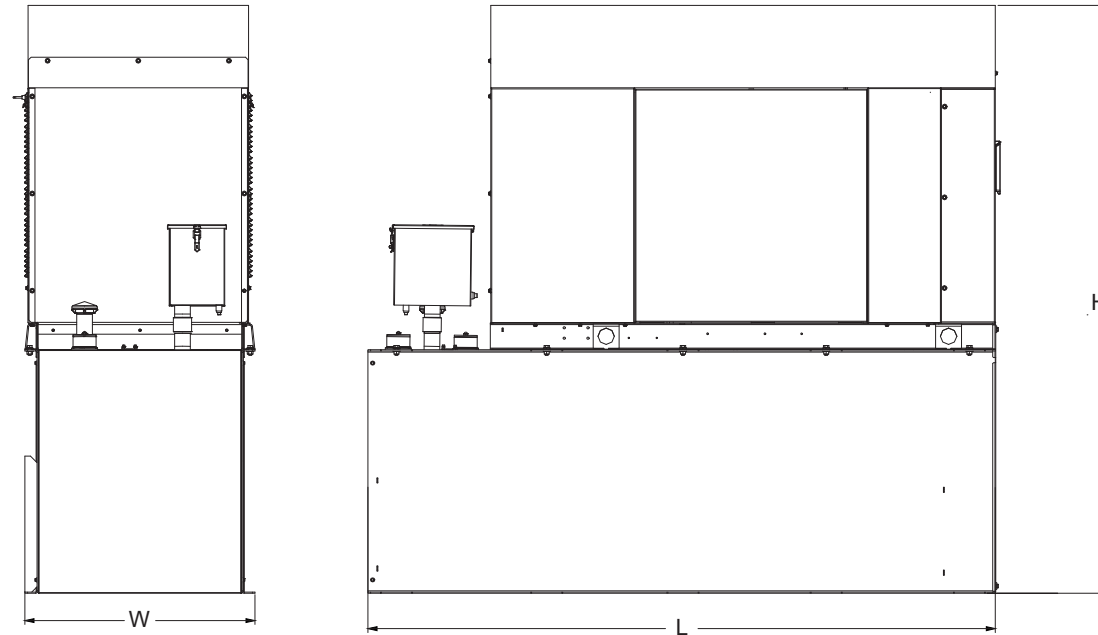

Weights and Dimensions

Unit Weight - lbs	Unit Weight with Skid - lbs	Dimensions (L x W x H) - in
2,915	2,954	103.4 (2,625) x 35.0 (888) x 90.0 (2,286)

48kW Fuel Consumption

Fuel Tank Gross Total Capacity	240
Fuel Tank Gross Usable Capacity	229
Fuel Tank Net Usable Capacity (Run Hours Based on Net Usable Capacity)	206
Run Hours 100% Load	52
Run Hours 75% Load	67
Run Hours 50% Load	96

* All measurements are approximate and for estimation purposes only.

Sound Emission Data

Rated Load Sound Output at 23ft - dB(A)5

YOUR FACTORY RECOGNIZED GENERAC INDUSTRIAL DEALER

Specification characteristics may change without notice. Dimensions and weights are for preliminary purposes only. Please consult a Generac Power Systems Industrial Dealer for detailed installation drawings.

Generac Power Systems, Inc. | P.O.Box 8 | Waukesha, WI 53189
P: (262) 544-4811 ©2018Generac Power Systems, Inc. All rights reserved. All specifications are subject to change without notice.

Part No 1000032700
Rev. 3 08/30/18

T-Mobile NORTHEAST LLC

T-MOBILE NORTHEAST, LLC.
35 GRIFFIN RD S
BLOOMFIELD, CT 06002
PHONE: (860) 629-1700



750 W CENTER ST, SUITE 301
WEST BRIDGEWATER, MA 02379
PHONE: 781.713.4725

REVISIONS

REV	DATE	DESCRIPTION	BY
0	09/22/22	ISSUED FOR CONSTRUCTION	SS
A	09/10/22	ISSUED FOR REVIEW	SS

DESIGNED BY: SS	APPROVED BY: WRD
--------------------	---------------------

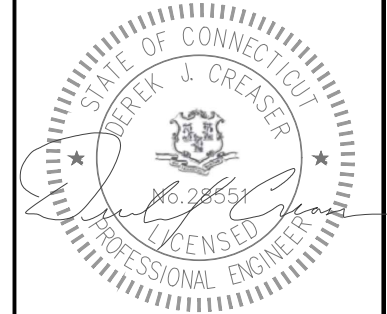

DATE: 09/22/2022

IT IS A VIOLATION OF LAW FOR ANY PERSON UNLESS THEY ARE ACTING UNDER THE DIRECTION OF A LICENSED PROFESSIONAL ENGINEER TO ALTER THIS DOCUMENT. UNLESS EXPLICITLY AGREED TO BY THE ENGINEER IN WRITING, THE ENGINEER DISCLAIMS ALL LIABILITY ASSOCIATED WITH THE REUSE, ALTERATION OR MODIFICATION OF THE CONTENTS HEREIN.

SITE NAME:	CT11237C/DEEP RIVER/RT 9
SITE ID:	CT11237A
SITE ADDRESS:	15 PENT ROAD DEEP RIVER, CT 06417 MIDDLESEX COUNTY

SHEET TITLE:
GENERATOR DETAIL

DRAWING:
A-2

SPEC SHEET

3 OF 6

SPEC SHEET

5 OF 6

Automatic Transfer Switches

GENERAC®

Service and non-Service rated Automatic Smart Transfer Switches

100 - 400 Amps, Single Phase

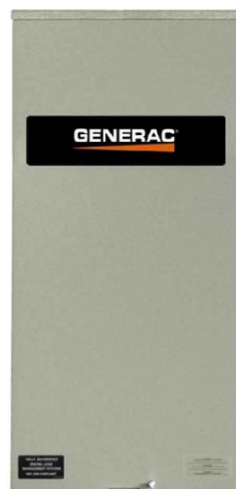

*CUL only applies to non-service rated switches

Automatic Transfer Switches

Automatic Transfer Switches

1 of 2 2 of 2

GENERAC®

Automatic Smart Transfer Switches

100-400 Amps, Single Phase

Functions

All timing and sensing functions originate in the generator controller

Utility voltage drop-out.....	<65%
Timer to generator start.....	10 second factory set, adjustable between 2-1500 seconds by a qualified dealer*
Engine warm up delay.....	5 seconds
Standby voltage sensor.....	65% for 5 seconds
Utility voltage pickup.....	>80%
Re-transfer time delay.....	15 seconds
Engine cool-down timer.....	60 seconds
Exerciser.....	.5 or 12 minutes adjustable weekly/Bi-weekly/Monthly**

The transfer switch can be operated manually without power applied.

*When used in conjunction with units utilizing Evolution™ controls **Adjustable via the controller

Specifications

Model	RXSC100A3	RXSC200A3
Amps	100	200
Voltage	120/240, 1Ø	120/240, 1Ø
Load Transition Type (Automatic)	Open Transition	Open Transition
Enclosure Type	NEMA/UL3R	NEMA/UL3R
UL Rating	UL/CUL	UL/CUL
Withstand Rating (Amps)	10,000	10,000
Lug Range	1/0 - #14	250 MCM - #6

Dimensions

Model	RXSC100A3	RXSC200A3
Height (in./mm)	H1	17.24/437.9
	H2	20/508
Width (in./mm)	W1	12.5/317.5
	W2	14.6/370.8
Depth (in./mm)		7.09/180.1
Weight (lbs./kilos)		20/9.07

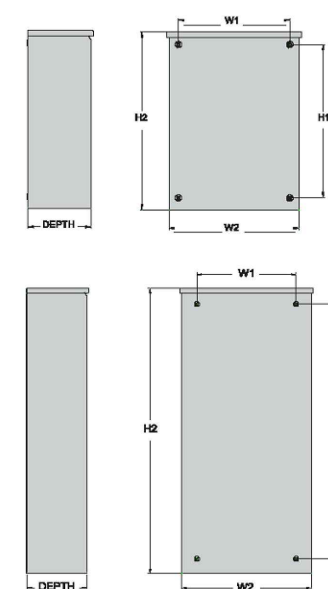

Description

Generac Automatic Transfer Switches are designed for use with single phase generators that utilize an Evolution™ or Nexus™ Controller. The 100, 200, and 400 amp open transition switches are available in single phase in both service equipment rated and non-service equipment rated configurations. The 150 and 300 amp open transition switches are only available in a service rated equipment configuration.

Standard Features

Service rated (RXSW) Generac Automatic Transfer Switches are housed in an aluminum NEMA/UL Type 3R enclosure*, with electrostatically applied and baked powder paint. The Heavy Duty Generac Contactor is a UL recognized device, designed for years of service. The controller at the generator handles all the timing, sensing, exercising functions, and transfer commands. All switches are covered by a 5 year limited warranty.

*Non-service rated (RXSC) switches are housed in a steel enclosure.

DPM Technology

Through the use of digital power technology (DPM), these switches have the capability to manage up to 4 individual HVAC (24 VAC controlled) loads with no additional hardware. When used in tandem with Smart Management Modules, up to 8 more loads can be managed as well, providing the most installation efficient power management options available.



Generac Power Systems, Inc. • 545 W29290 HWY. 59, Waukesha, WI 53189 • generac.com
©2017 Generac Power Systems, Inc. All rights reserved. All specifications are subject to change without notice. Bulletin 10000013459-A 04/24/17

T-Mobile

NORTHEAST LLC

T-MOBILE NORTHEAST, LLC.
35 GRIFFIN RD S
BLOOMFIELD, CT 06002
PHONE: (860) 629-1700



750 W CENTER ST, SUITE 301
WEST BRIDGEWATER, MA 02379
PHONE: 781.713.4725

REVISIONS

REV	DATE	DESCRIPTION	BY
0	09/22/22	ISSUED FOR CONSTRUCTION	SS
A	09/10/22	ISSUED FOR REVIEW	SS

DESIGNED BY: SS APPROVED BY: WRD

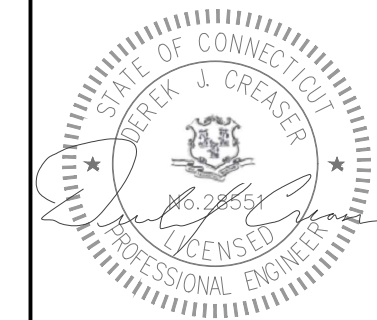

DATE: 09/22/2022

IT IS A VIOLATION OF LAW FOR ANY PERSON UNLESS THEY ARE ACTING UNDER THE DIRECTION OF A LICENSED PROFESSIONAL ENGINEER TO ALTER THIS DOCUMENT. UNLESS EXPLICITLY AGREED TO BY THE ENGINEER IN WRITING, THE ENGINEER DISCLAIMS ALL LIABILITY ASSOCIATED WITH THE REUSE, ALTERATION OR MODIFICATION OF THE CONTENTS HEREIN.

SITE NAME:
CT11237C/DEEP RIVER/RT 9
SITE ID:
CT11237A
SITE ADDRESS:
15 PENT ROAD
DEEP RIVER, CT 06417
MIDDLESEX COUNTY

SHEET TITLE:
ATS SPEC SHEET
DRAWING:
A-3

T-Mobile NORTHEAST LLC

T-MOBILE NORTHEAST, LLC.
35 GRIFFIN RD S
BLOOMFIELD, CT 06002
PHONE: (860) 629-1700



750 W CENTER ST, SUITE 301
WEST BRIDGEWATER, MA 02379
PHONE: 781.713.4725

REVISIONS

REV	DATE	DESCRIPTION	BY
0	09/22/22	ISSUED FOR CONSTRUCTION	SS
A	09/10/22	ISSUED FOR REVIEW	SS

DESIGNED BY: SS	APPROVED BY: WRD
--------------------	---------------------

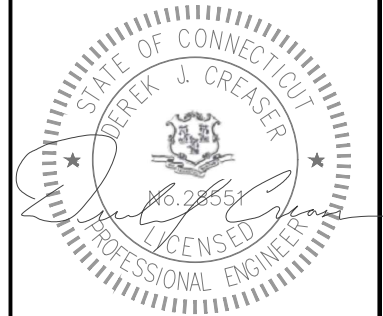

DATE: 09/22/2022

IT IS A VIOLATION OF LAW FOR ANY PERSON UNLESS THEY ARE ACTING UNDER THE DIRECTION OF A LICENSED PROFESSIONAL ENGINEER TO ALTER THIS DOCUMENT. UNLESS EXPLICITLY AGREED TO BY THE ENGINEER IN WRITING, THE ENGINEER DISCLAIMS ALL LIABILITY ASSOCIATED WITH THE REUSE, ALTERATION OR MODIFICATION OF THE CONTENTS HEREIN.

SITE NAME: CT11237C/DEEP RIVER/RT 9
SITE ID: CT11237A
SITE ADDRESS: 15 PENT ROAD DEEP RIVER, CT 06417 MIDDLESEX COUNTY

SHEET TITLE: DETAILS

DRAWING: A-4

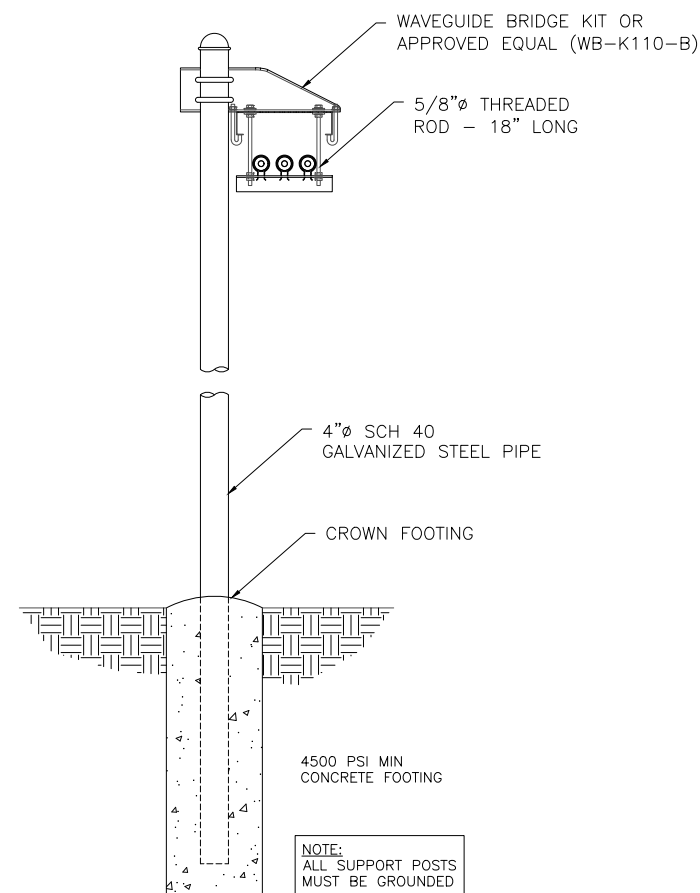

1 ICE BRIDGE DETAIL
A-4

ELECTRICAL NOTES

- SUBMITTAL OF BID INDICATES THAT THE CONTRACTOR IS COGNIZANT OF ALL JOB SITE CONDITIONS AND WORK TO BE PERFORMED UNDER THIS CONTRACT.
- CONTRACTOR SHALL PERFORM ALL VERIFICATIONS, OBSERVATION TESTS, AND EXAMINATION WORK PRIOR TO ORDERING OF ANY EQUIPMENT AND THE ACTUAL CONSTRUCTION. CONTRACTOR SHALL ISSUE A WRITTEN NOTICE OF ALL FINDINGS TO THE PROJECT MANAGER LISTING ALL MALFUNCTIONS, FAULTY EQUIPMENT AND DISCREPANCIES.
- THESE PLANS ARE DIAGRAMMATIC ONLY, FOLLOW AS CLOSELY AS POSSIBLE.
- CONTRACTOR SHALL COORDINATE ALL WORK BETWEEN TRADES AND ALL OTHER SCHEDULING AND PROVISIONARY CIRCUMSTANCES SURROUNDING THE PROJECT.
- CONTRACTOR SHALL PROVIDE ALL LABOR, MATERIALS, INSURANCE, EQUIPMENT, INSTALLATION CONSTRUCTION TOOLS, TRANSPORTATION, ETC., FOR COMPLETE AND FUNCTIONALLY OPERATING SYSTEMS ENERGIZED AND READY FOR USE THROUGHOUT AS INDICATED ON DRAWINGS, AS SPECIFIED HEREIN AND/OR AS OTHERWISE REQUIRED.
- ALL MATERIALS AND EQUIPMENT SHALL BE NEW AND IN PERFECT CONDITION WHEN INSTALLED AND SHALL BE OF THE BEST GRADE AND OF THE SAME MANUFACTURER THROUGHOUT FOR EACH CLASS OR GROUP OF EQUIPMENT. ELECTRICAL MATERIALS SHALL BE LISTED AND APPROVED BY UNDERWRITER'S LABORATORIES AND SHALL BEAR THE INSPECTION LABEL "J" WHERE SUBJECT TO

- SUCH APPROVAL. MATERIALS SHALL MEET WITH APPROVAL OF ALL GOVERNING BODIES HAVING JURISDICTION OVER THE CONSTRUCTION. MATERIALS SHALL BE MANUFACTURED IN ACCORDANCE WITH ALL CURRENT APPLICABLE STANDARDS ESTABLISHED BY ANSI, NEMA AND NBFU. ALL MATERIALS AND EQUIPMENT SHALL BE APPROVED FOR THEIR INTENDED USE AND LOCATION.
- ALL WORK SHALL COMPLY WITH ALL APPLICABLE GOVERNING STATE, COUNTY AND CITY CODES AND OSHA, NFPA, NEC & ASHRAE REQUIREMENTS.
 - ENTIRE JOB SHALL BE GUARANTEED FOR A PERIOD OF ONE (1) YEAR AFTER THE DATE OF JOB ACCEPTANCE. ALL WORK, MATERIAL AND EQUIPMENT FOUND TO BE FAULTY DURING THAT PERIOD SHALL BE CORRECTED AT ONCE, UPON WRITTEN NOTIFICATION, AT THE EXPENSE OF THE CONTRACTOR.
 - PROPERLY SEAL ALL PENETRATIONS. PROVIDE UL LISTED FIRE-STOPS WHERE PENETRATIONS ARE MADE THROUGH FIRE-RATED ASSEMBLIES. WATER-TIGHT USING SILICONE SEALANT.
 - DELIVER ALL BROCHURES, OPERATING MANUALS, CATALOGS AND SHOP DRAWINGS TO THE PROJECT MANAGER AT JOB COMPLETION. PROVIDE MAINTENANCE MANUALS FOR MECHANICAL EQUIPMENT. AFFIX MAINTENANCE LABELS TO MECHANICAL EQUIPMENT.
 - ALL CONDUCTORS SHALL BE COPPER. MINIMUM CONDUCTOR SIZE SHALL BE #12 AWG., UNLESS OTHERWISE NOTED. CONDUCTORS SHALL BE TYPE THHW, RATED IN ACCORDANCE WITH NEC 110-14(C).
 - ALL CIRCUIT BREAKERS, FUSES AND ELECTRICAL EQUIPMENT SHALL HAVE AN INTERRUPTING RATING NOT LESS THE MAXIMUM INTERRUPTING CURRENT TO WHICH

- THEY MAY BE SUBJECTED.
- THE ENTIRE ELECTRICAL INSTALLATION SHALL BE GROUNDED IN ACCORDANCE WITH THE NATIONAL ELECTRICAL CODE; ARTICLES 250 & 810 AND THE UTILITY COMPANY STANDARDS.
 - CONDUIT:
 - RIGID CONDUIT SHALL BE U.L. LABEL GALVANIZED ZINC COATED WITH ZINC INTERIOR AND SHALL BE USED WHEN INSTALLED IN OR UNDER CONCRETE SLABS, IN CONTACT WITH THE EARTH, UNDER PUBLIC ROADWAYS, IN MASONRY WALLS OR EXPOSED ON BUILDING EXTERIOR. RIGID CONDUIT IN CONTACT WITH EARTH SHALL BE 1/2 LAPPED WRAPPED WITH HUNTS WRAP PROCESS NO. 3.
 - ELECTRICAL METALLIC TUBING SHALL HAVE U.L. LABEL, FITTINGS SHALL BE GLAND RING COMPRESSION TYPE. EMT SHALL BE USED ONLY FOR INTERIOR RUNS.
 - LIQUID-TIGHT FLEXIBLE METAL CONDUIT SHALL BE U.L. LISTED AND SHALL BE USED AT FINAL CONNECTIONS TO MECHANICAL EQUIPMENT & RECTIFIERS AND WHERE PERMITTED BY CODE. ALL CONDUIT IN EXCESS OF SIX FEET IN LENGTH SHALL CONTAIN A FULL-SIZE GROUND CONDUCTOR.
 - CONDUIT RUNS SHALL BE SURFACE MOUNTED ON CEILINGS OR WALLS UNLESS NOTED OTHERWISE. ALL CONDUIT SHALL RUN PARALLEL OR PERPENDICULAR TO WALLS, FLOOR, CEILING, OR BEAMS. VERIFY EXACT ROUTING OF ALL EXPOSED CONDUIT WITH THE PROJECT MANAGER PRIOR TO INSTALLING.

- PVC CONDUIT MAY BE PROVIDED ONLY WHERE SHOWN, OR IN UNDERGROUND INSTALLATIONS. PROVIDE UV-RESISTANT CONDUIT WHERE EXPOSED TO THE ATMOSPHERE. PROVIDE GROUND CONDUCTOR IN ALL PVC RUNS; EXCEPT WHERE PERMITTED BY CODE TO OMIT.
- ALL ELECTRICAL EQUIPMENT SHALL BE LABELED WITH PERMANENT ENGRAVED PLASTIC LABELS. BACKGROUND SHALL BE BLACK WITH WHITE LETTERS; EXCEPT AS REQUIRED BY CODE TO FOLLOW A DIFFERENT SCHEME.
- UPON COMPLETION OF WORK, CONDUCT CONTINUITY, SHORT CIRCUIT, AND FALL OF POTENTIAL GROUNDING TESTS FOR APPROVAL. SUBMIT TEST REPORTS TO PROJECT MANAGER. GROUNDING SYSTEM RESISTANCE SHALL NOT EXCEED 5 OHMS. IF THE RESISTANCE VALUE IS EXCEEDED, NOTIFY THE PROJECT MANAGER FOR FURTHER INSTRUCTION ON METHODS FOR REDUCING THE RESISTANCE VALUE.
- CLEAN PREMISES OF ALL DEBRIS RESULTING FROM WORK AND LEAVE WORK IN A COMPLETE AND UNDAMAGED CONDITION. LEGALLY DISPOSE OF ALL REMOVED, UNUSED AND EXCESS MATERIAL GENERATED BY THE WORK OF THIS CONTRACT. DELIVER ITEMS INDICATED ON THE DRAWINGS TO THE OWNER IN GOOD CONDITION. OBTAIN SIGNED RECEIPT UPON DELIVERY.
- COORDINATE WITH UTILITY COMPANY FOR CONNECTION OF TEMPORARY AND PERMANENT POWER TO THE SITE. THE TEMPORARY POWER AND ALL HOOKUP COSTS SHALL BE PAID BY THE CONTRACTOR.
- VERIFY ALL EXISTING CIRCUITRY PRIOR TO REMOVAL AND NEW WORK. MAINTAIN POWER TO ALL OTHER AREAS & CIRCUITS NOT SCHEDULED FOR REMOVAL.
- RED LINED AS-BUILT PLANS SHALL BE PROVIDED TO THE CONSTRUCTION MANAGER.

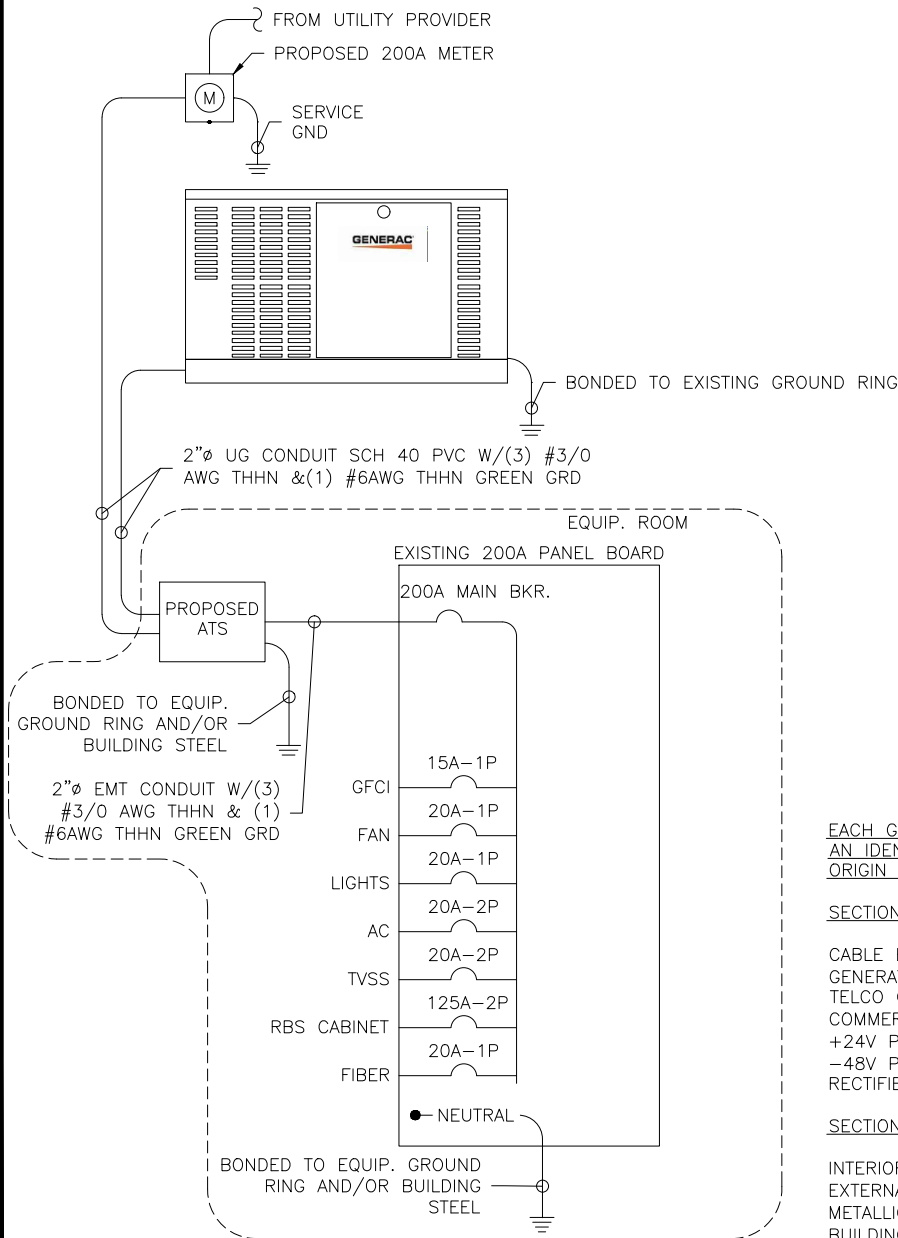

1 ONE LINE DIAGRAM
E-1

EACH GROUND CONDUCTOR TERMINATING ON ANY GROUND BAR SHALL HAVE AN IDENTIFICATION TAG ATTACHED AT EACH END THAT WILL IDENTIFY ITS ORIGIN AND DESTINATION.

SECTION "P" - SURGE PRODUCERS

- CABLE ENTRY PORTS (HATCH PLATES) (#2)
- GENERATOR FRAMEWORK (IF AVAILABLE) (#2)
- TELCO GROUND BAR
- COMMERCIAL POWER COMMON NEUTRAL/GROUND BOND (#2)
- +24V POWER SUPPLY RETURN BAR (#2)
- 48V POWER SUPPLY RETURN BAR (#2)
- RECTIFIER FRAMES.

SECTION "A" - SURGE ABSORBERS

- INTERIOR GROUND RING (#2)
- EXTERNAL EARTH GROUND FIELD (BURIED GROUND RING) (#2)
- METALLIC COLD WATER PIPE (IF AVAILABLE) (#2)
- BUILDING STEEL (IF AVAILABLE) (#2)

2 GROUND WIRE SCHEDULE
E-1

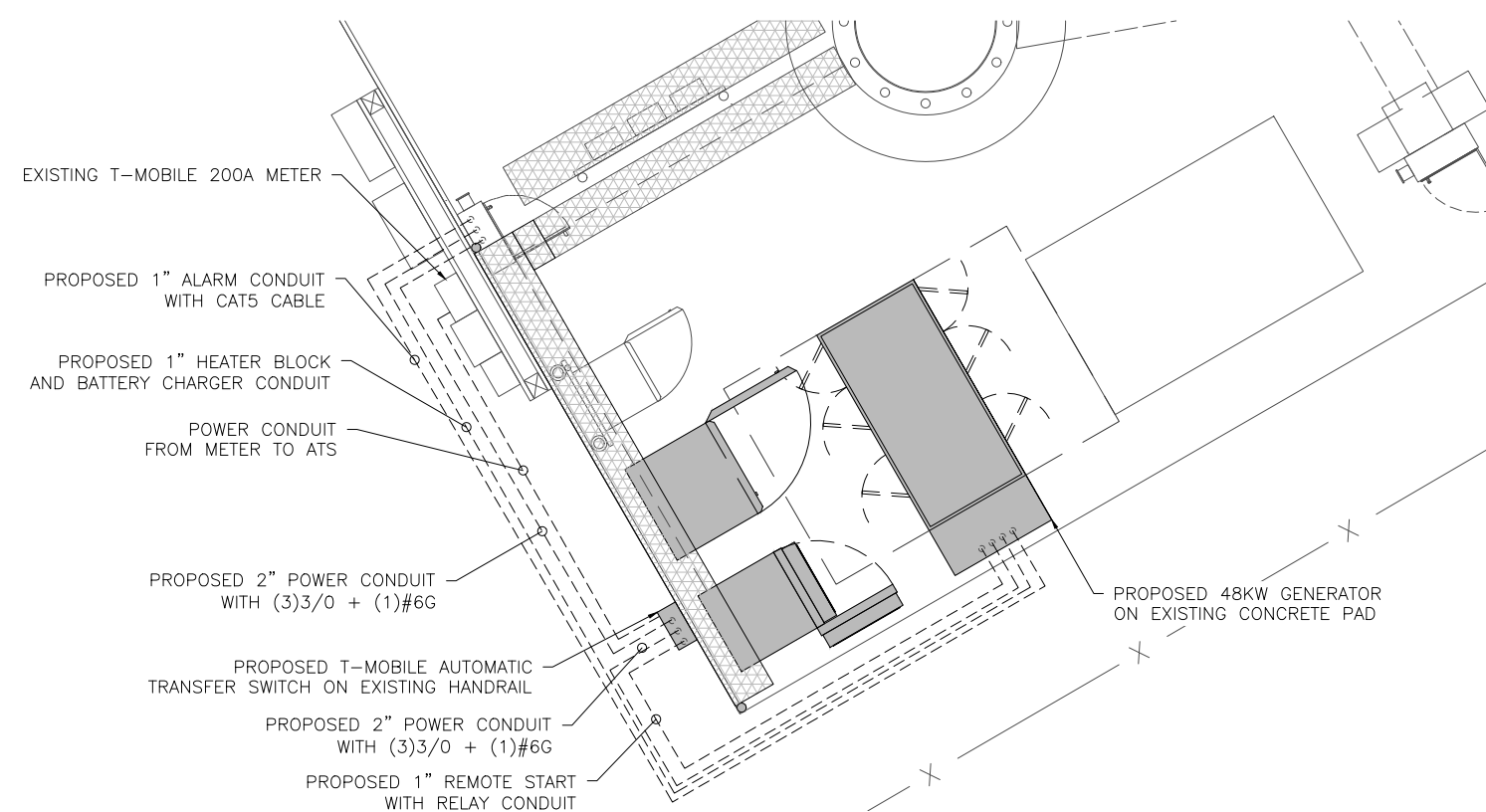

5 ELECTRICAL PLAN
E-1

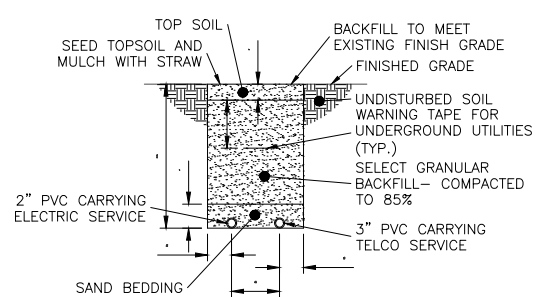

NOTE: EXCAVATE EXISTING SUBGRADE AS REQUIRED TO INSTALL CONDUITS IN ACCORDANCE WITH OSHA AND ALL APPLICABLE CODES.

3 TYPICAL TRENCH DETAIL
E-1

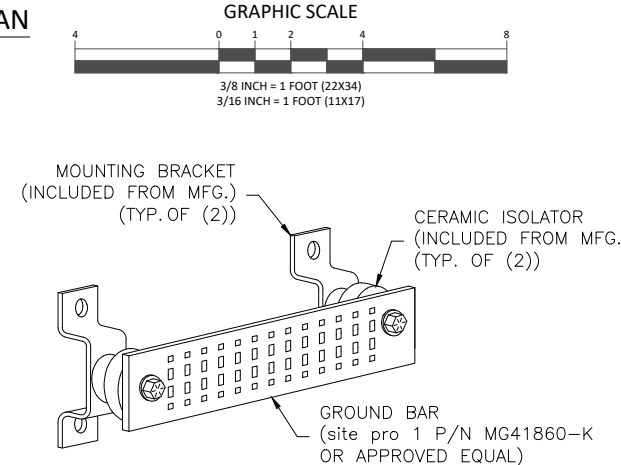

4 GROUND BAR DETAIL
E-1

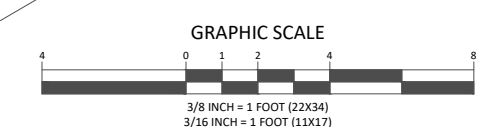

T-Mobile
NORTHEAST LLC

T-MOBILE NORTHEAST, LLC.
35 GRIFFIN RD S
BLOOMFIELD, CT 06002
PHONE: (860) 629-1700

CENTERLINE
ENGINEERING SERVICES, PA

750 W CENTER ST, SUITE 301
WEST BRIDGEWATER, MA 02379
PHONE: 781.713.4725

REVISIONS			
REV	DATE	DESCRIPTION	BY
0	09/22/22	ISSUED FOR CONSTRUCTION	SS
A	09/10/22	ISSUED FOR REVIEW	SS

DESIGNED BY: SS	APPROVED BY: WRD
--------------------	---------------------

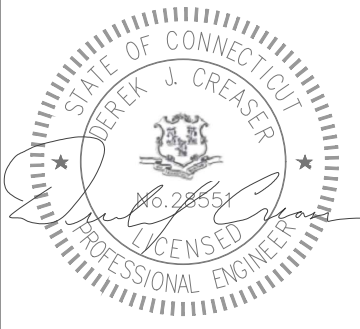

DATE: 09/22/2022

IT IS A VIOLATION OF LAW FOR ANY PERSON UNLESS THEY ARE ACTING UNDER THE DIRECTION OF A LICENSED PROFESSIONAL ENGINEER TO ALTER THIS DOCUMENT. UNLESS EXPLICITLY AGREED TO BY THE ENGINEER IN WRITING, THE ENGINEER DISCLAIMS ALL LIABILITY ASSOCIATED WITH THE REUSE, ALTERATION OR MODIFICATION OF THE CONTENTS HEREIN.

SITE NAME:
CT11237C/DEEP RIVER/RT 9

SITE ID:
CT11237A

SITE ADDRESS:
**15 PENT ROAD
DEEP RIVER, CT 06417
MIDDLESEX COUNTY**

SHEET TITLE:
ELECTRICAL PLAN & DETAILS

DRAWING:
E-1

GROUNDING NOTES:

- GROUNDING SHALL COMPLY WITH ARTICLE 250 OF THE NATIONAL ELECTRICAL CODE.
- ALL GROUNDING DEVICES SHALL BE U.L. APPROVED OR LISTED FOR THEIR INTENDED USE.
- ALL WIRES SHALL BE AWG THHN/THWN COPPER UNLESS NOTED OTHERWISE.
- GROUNDING CONNECTIONS TO GROUND RODS, GROUND RING WIRE, TOWER BASE AND FENCE POSTS SHALL BE EXOTHERMIC ("CADWELDS") UNLESS NOTED OTHERWISE. CLEAN SURFACES TO SHINY METAL. WHERE GROUND WIRES ARE CADWELDED TO GALVANIZED SURFACES, SPRAY CADWELD WITH GALVANIZING PAINT.
- GROUNDING CONNECTIONS TO GROUND BARS ARE TO BE TWO-HOLE BRASS MECHANICAL CONNECTORS WITH STAINLESS STEEL HARDWARE (INCLUDING SCREW SET) CLEAN GROUND BAR TO SHINY METAL. AFTER MECHANICAL CONNECTION, TREAT WITH PROTECTIVE ANTIOXIDANT COATING.
- GROUND COAXIAL CABLE SHIELDS AT BOTH ENDS WITH MANUFACTURER'S GROUNDING KITS.
- ROUTE GROUNDING CONDUCTORS THE SHORTEST AND STRAIGHTEST PATH POSSIBLE. BEND GROUNDING LEADS WITH A MINIMUM 12" RADIUS.
- INSTALL #2 AWG GREEN-INSULATED STRANDED WIRE FOR ABOVE GRADE GROUNDING AND #2 TINNED SOLID COPPER WIRE FOR BELOW GRADE GROUNDING UNLESS OTHERWISE NOTED.

- REFER TO GROUNDING PLAN FOR GROUND BAR LOCATIONS. GROUNDING CONNECTIONS SHALL BE EXOTHERMIC TYPE ("CADWELDS") TO ANTENNA MOUNTS AND GROUND RING. REMAINING GROUNDING CONNECTIONS SHALL BE COMPRESSION FITTINGS. CONNECTIONS TO GROUND BARS SHALL BE MADE WITH TWO-HOLE LUGS.
- THE GROUND ELECTRODE SYSTEM SHALL CONSIST OF DRIVEN GROUND RODS POSITION ACCORDING TO GROUNDING PLAN. THE GROUND RODS SHALL BE 5/8"x10'-0" COPPER CLAD STEEL INTERCONNECTED WITH #2 TINNED SOLID COPPER WIRE BURIED 36" BELOW GRADE. BURY GROUND RODS A MAXIMUM OF 15' APART, AND A MINIMUM OF 8' APART.
- IF ROCK IS ENCOUNTERED GROUND RODS SHALL BE PLACED AT AN OBLIQUE ANGLE NOT TO EXCEED 45°.
- EXOTHERMIC WELDS SHALL BE MADE IN ACCORDANCE WITH ERICO PRODUCTS BULLETIN A-AT.

- CONSTRUCTION OF GROUND RING AND CONNECTIONS TO EXISTING GROUND RING SYSTEM SHALL BE DOCUMENTED WITH PHOTOGRAPHS PRIOR TO BACKFILLING SITE. PROVIDE PHOTOS TO THE CONSTRUCTION MANAGER.
- ALL GROUND LEADS EXCEPT THOSE TO THE EQUIPMENT ARE TO BE #2 TINNED SOLID COPPER WIRE. ALL EXTERIOR GROUND BARS TINNED COPPER.
- PRIOR TO INSTALLING LUGS ON GROUND WIRES, APPLY THOMAS & BETTS KOPR-SHIELD (TM OF JET LUBE INC.). PRIOR TO BOLTING GROUND WIRE LUGS TO GROUND BARS, APPLY KOPR-SHIELD OR EQUAL.
- ENGAGE AN INDEPENDENT ELECTRICAL TESTING FIRM TO TEST AND VERIFY THAT IMPEDANCE DOES NOT EXCEED FIVE OHMS TO GROUND BY MEANS OF "FALL OF POTENTIAL TEST". TEST SHALL BE WITNESSED BY A T-MOBILE REPRESENTATIVE, AND RECORDED ON THE "GROUND RESISTANCE TEST" FORM.

- WHERE BARE COPPER GROUND WIRES ARE ROUTED FROM ANY CONNECTION ABOVE GRADE TO GROUND RING, INSTALL WIRE IN 3/4" PVC SLEEVE, FROM 1' BELOW GRADE AND SEAL TOP WITH SILICONE MATERIAL.
- PREPARE ALL BONDING SURFACES FOR GROUNDING CONNECTIONS BY REMOVING ALL PAINT AND CORROSION DOWN TO SHINY METAL. FOLLOWING CONNECTION, APPLY APPROPRIATE ANTI-OXIDIZATION PAINT.
- ANY SITE WHERE THE EQUIPMENT (BTS, CABLE BRIDGE, PPC, GENERATOR, ETC.) IS LOCATED WITHIN 6 FEET OF METAL FENCING, THE GROUND RING SHALL BE BONDED TO THE NEAREST FENCE POST USING (3) RUNS OF #2 BARE TINNED COPPER WIRE.

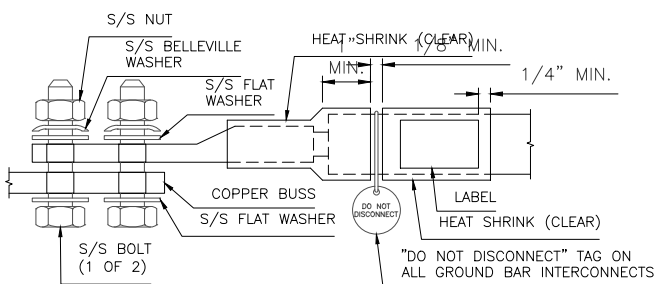
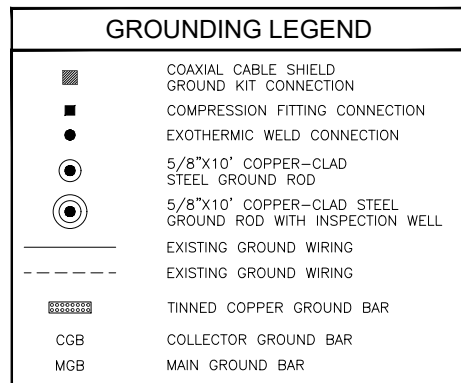

- NOTES:
- ALL HARDWARE 18-8 STAINLESS STEEL INCLUDING BELLEVILLES. COAT ALL SURFACES WITH ANTI-OXIDATION COMPOUND BEFORE MATING.
 - FOR GROUND BOND TO STEEL ONLY: INSERT A DRAGON TOOTH WASHER BETWEEN LUG AND STEEL, COAT ALL SURFACES WITH ANTI-OXIDATION COMPOUND.
 - COAT ALL BARRELS WITH ANTI-OXIDATION COMPOUND BEFORE CRIMPING.

1 GENERAL LUG DETAIL

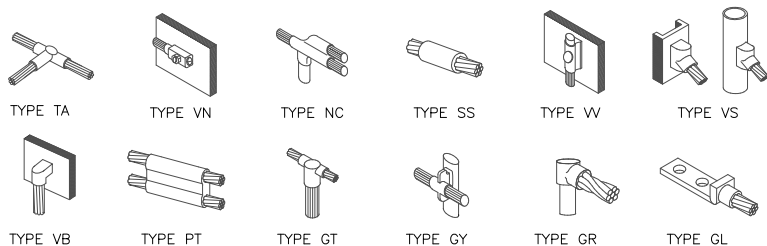

2 GROUNDING CONNECTION DETAILS

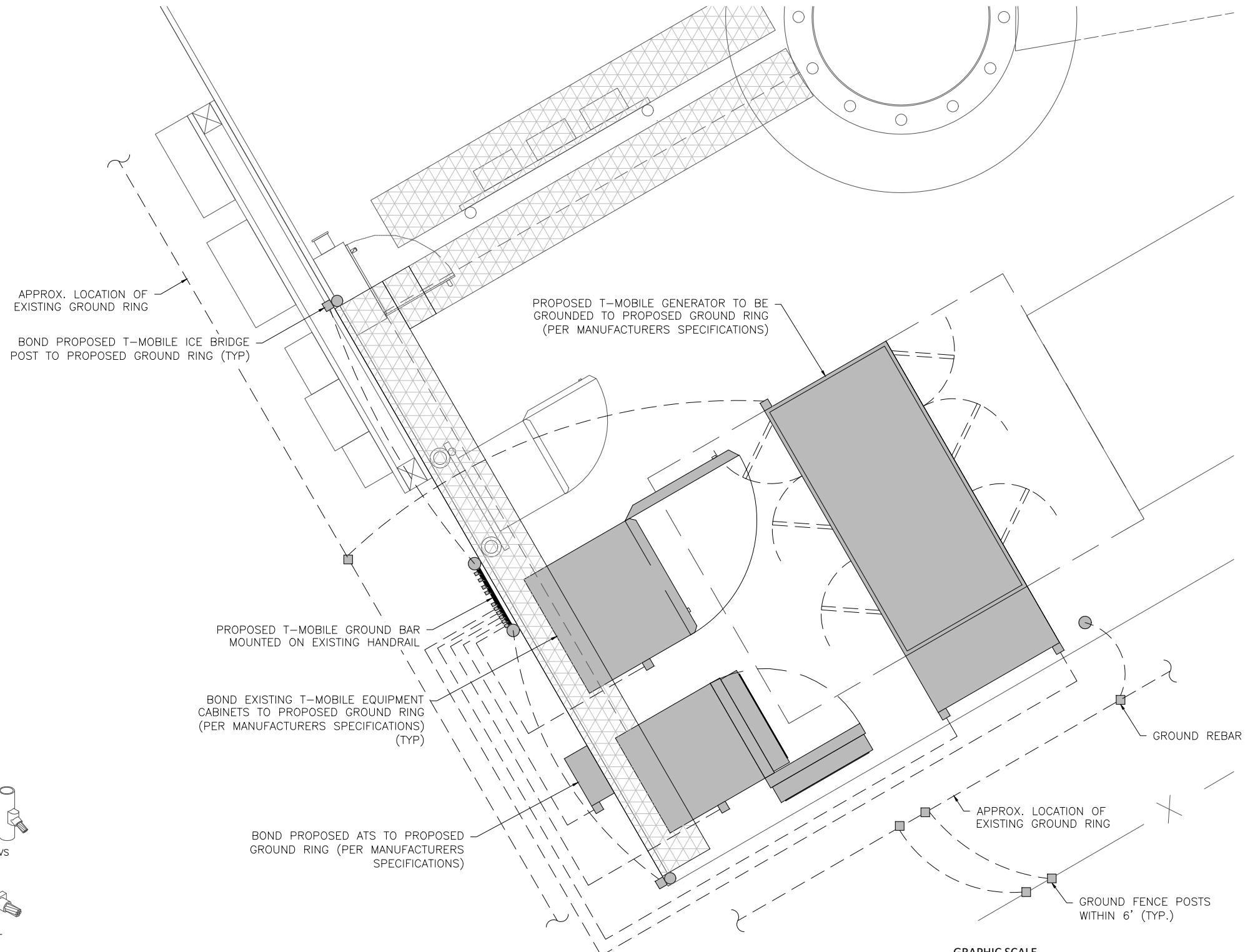

3 GROUNDING PLAN

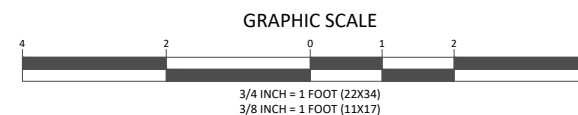

T-Mobile

NORTHEAST LLC

T-MOBILE NORTHEAST, LLC.
35 GRIFFIN RD S
BLOOMFIELD, CT 06002
PHONE: (860) 629-1700



750 W CENTER ST, SUITE 301
WEST BRIDGEWATER, MA 02379
PHONE: 781.713.4725

REVISIONS

REV	DATE	DESCRIPTION	BY
0	09/22/22	ISSUED FOR CONSTRUCTION	SS
A	09/10/22	ISSUED FOR REVIEW	SS

DESIGNED BY: SS	APPROVED BY: WRD
--------------------	---------------------



DATE: 09/22/2022

IT IS A VIOLATION OF LAW FOR ANY PERSON UNLESS THEY ARE ACTING UNDER THE DIRECTION OF A LICENSED PROFESSIONAL ENGINEER TO ALTER THIS DOCUMENT. UNLESS EXPLICITLY AGREED TO BY THE ENGINEER IN WRITING, THE ENGINEER DISCLAIMS ALL LIABILITY ASSOCIATED WITH THE REUSE, ALTERATION OR MODIFICATION OF THE CONTENTS HEREIN.

SITE NAME: CT11237C/DEEP RIVER/RT 9
SITE ID: CT11237A
SITE ADDRESS: 15 PENT ROAD DEEP RIVER, CT 06417 MIDDLESEX COUNTY

SHEET TITLE: GROUNDING PLAN
DRAWING: G-1

Exhibit D

Mailing Receipts/Proof of Notice

UPS CampusShip: View/Print Label

- 1. Ensure there are no other shipping or tracking labels attached to your package.** Select the Print button on the print dialog box that appears. Note: If your browser does not support this function select Print from the File menu to print the label.
- 2. Fold the printed label at the solid line below.** Place the label in a UPS Shipping Pouch. If you do not have a pouch, affix the folded label using clear plastic shipping tape over the entire label.
- 3. GETTING YOUR SHIPMENT TO UPS**
Customers with a Daily Pickup
 Your driver will pickup your shipment(s) as usual.

Customers without a Daily Pickup

Take your package to any location of The UPS Store®, UPS Access Point(TM) location, UPS Drop Box, UPS Customer Center, Staples® or Authorized Shipping Outlet near you. Items sent via UPS Return Services(SM) (including via Ground) are also accepted at Drop Boxes. To find the location nearest you, please visit the Resources area of CampusShip and select UPS Locations.

Schedule a same day or future day Pickup to have a UPS driver pickup all your CampusShip packages.

Hand the package to any UPS driver in your area.

UPS Access Point™
CVS STORE # 629
146 SOUTH ST
DANBURY ,CT 06810

UPS Access Point™
TIENDA ECUADOR
72 LAKE AVE
DANBURY ,CT 06810

UPS Access Point™
THE UPS STORE
42 LAKE AVENUE EXT
DANBURY ,CT 06811

FOLD HERE

1 OF 1 1 LBS DWT: 12.9,1 BRYAN CLARK CENTERLINE COMMUNICATIONS, LLC 117 CAROL STREET DANBURY CT 06810-8312	SHIP TO: ATTN: CONTRACT DEV. DOCUMENT EXECUT CROWN CASTLE 2000 CORPORATE DRIVE CANONSBURG PA 15317-8564	PA 153 0-10 	UPS GROUND TRACKING #: 1Z 9Y4 503 03 0797 4664 	BILLING: P/P 
--	---	--	--	---

This website uses cookies

We do this to better understand how visitors use our site and to offer you a more personal experience. Please see our [Privacy Notice \(https://www.ups.com/us/en/help-center/legal-terms-conditions/privacy-notice.page\)](https://www.ups.com/us/en/help-center/legal-terms-conditions/privacy-notice.page) for more information. You can manage your preferences by selecting [Cookie Settings](#).



UPS CampusShip: View/Print Label

- 1. **Ensure there are no other shipping or tracking labels attached to your package.** Select the Print button on the print dialog box that appears. Note: If your browser does not support this function select Print from the File menu to print the label.
- 2. **Fold the printed label at the solid line below.** Place the label in a UPS Shipping Pouch. If you do not have a pouch, affix the folded label using clear plastic shipping tape over the entire label.

3. GETTING YOUR SHIPMENT TO UPS
Customers with a Daily Pickup

Your driver will pickup your shipment(s) as usual.

Customers without a Daily Pickup

Take your package to any location of The UPS Store®, UPS Access Point(TM) location, UPS Drop Box, UPS Customer Center, Staples® or Authorized Shipping Outlet near you. Items sent via UPS Return Services(SM) (including via Ground) are also accepted at Drop Boxes. To find the location nearest you, please visit the Resources area of CampusShip and select UPS Locations.

Schedule a same day or future day Pickup to have a UPS driver pickup all your CampusShip packages.



Hand the package to any UPS driver in your area.

UPS Access Point™
 CVS STORE # 629
 146 SOUTH ST
 DANBURY ,CT 06810

UPS Access Point™
 TIENDA ECUADOR
 72 LAKE AVE
 DANBURY ,CT 06810

UPS Access Point™
 THE UPS STORE
 42 LAKE AVENUE EXT
 DANBURY ,CT 06811

FOLD HERE

1 OF 1 1 LBS DWT: 12.9,1 BRYAN CLARK CENTERLINE COMMUNICATIONS, LLC 117 CAROL STREET DANBURY CT 06810-8312	SHIP TO: FIRST SELECTMAN DEEP RIVER TOWN HALL 174 MAIN STREET DEEP RIVER CT 06417-2008	CT 063 5-02 	UPS GROUND TRACKING #: 1Z 9Y4 503 03 2367 6116 	BILLING: P/P 
--	--	--	--	---

This website uses cookies

We do this to better understand how visitors use our site and to offer you a more personal experience. Please see our [Privacy Notice \(https://www.ups.com/us/en/help-center/legal-terms-conditions/privacy-notice.page\)](https://www.ups.com/us/en/help-center/legal-terms-conditions/privacy-notice.page) for more information. You can manage your preferences by selecting [Cookie Settings](#).



UPS CampusShip: View/Print Label

- 1. Ensure there are no other shipping or tracking labels attached to your package.** Select the Print button on the print dialog box that appears. Note: If your browser does not support this function select Print from the File menu to print the label.
- 2. Fold the printed label at the solid line below.** Place the label in a UPS Shipping Pouch. If you do not have a pouch, affix the folded label using clear plastic shipping tape over the entire label.
- 3. GETTING YOUR SHIPMENT TO UPS**
Customers with a Daily Pickup
 Your driver will pickup your shipment(s) as usual.

Customers without a Daily Pickup



Take your package to any location of The UPS Store®, UPS Access Point(TM) location, UPS Drop Box, UPS Customer Center, Staples® or Authorized Shipping Outlet near you. Items sent via UPS Return Services(SM) (including via Ground) are also accepted at Drop Boxes. To find the location nearest you, please visit the Resources area of CampusShip and select UPS Locations.
 Schedule a same day or future day Pickup to have a UPS driver pickup all your CampusShip packages.
 Hand the package to any UPS driver in your area.

UPS Access Point™
 CVS STORE # 629
 146 SOUTH ST
 DANBURY ,CT 06810

UPS Access Point™
 TIENDA ECUADOR
 72 LAKE AVE
 DANBURY ,CT 06810

UPS Access Point™
 THE UPS STORE
 42 LAKE AVENUE EXT
 DANBURY ,CT 06811

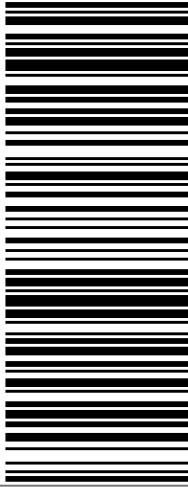
FOLD HERE

<p>1 OF 1</p> <p>1 LBS DWT: 12.9,1</p> <p>RYAN CLARK CENTERLINE COMMUNICATIONS, LLC 117 CAROL STREET DANBURY CT 06810-8312</p> <p>SHIP TO: PLANNING AND ZONING DEEP RIVER TOWN HALL 174 MAIN STREET DEEP RIVER CT 06417-2008</p>	<p>CT 063 5-02</p> 	<p>UPS GROUND</p> <p>TRACKING #: 1Z 9Y4 503 03 1964 1652</p> 	<p>BILLING: P/P</p> <p style="text-align: right;">CS 23.6.00. WNTNV50 39.0A 09/2022* </p>
---	---	---	--

This website uses cookies

We do this to better understand how visitors use our site and to offer you a more personal experience. Please see our [Privacy Notice \(https://www.ups.com/us/en/help-center/legal-terms-conditions/privacy-notice.page\)](https://www.ups.com/us/en/help-center/legal-terms-conditions/privacy-notice.page) for more information. You can manage your preferences by selecting [Cookie Settings](#).



UPS CampusShip: View/Print Label

- 1. **Ensure there are no other shipping or tracking labels attached to your package.** Select the Print button on the print dialog box that appears. Note: If your browser does not support this function select Print from the File menu to print the label.
- 2. **Fold the printed label at the solid line below.** Place the label in a UPS Shipping Pouch. If you do not have a pouch, affix the folded label using clear plastic shipping tape over the entire label.

3. GETTING YOUR SHIPMENT TO UPS
Customers with a Daily Pickup

Your driver will pickup your shipment(s) as usual.

Customers without a Daily Pickup

Take your package to any location of The UPS Store®, UPS Access Point(TM) location, UPS Drop Box, UPS Customer Center, Staples® or Authorized Shipping Outlet near you. Items sent via UPS Return Services(SM) (including via Ground) are also accepted at Drop Boxes. To find the location nearest you, please visit the Resources area of CampusShip and select UPS Locations.

Schedule a same day or future day Pickup to have a UPS driver pickup all your CampusShip packages.

Hand the package to any UPS driver in your area.

UPS Access Point™
 CVS STORE # 629
 146 SOUTH ST
 DANBURY ,CT 06810

UPS Access Point™
 TIENDA ECUADOR
 72 LAKE AVE
 DANBURY ,CT 06810

UPS Access Point™
 THE UPS STORE
 42 LAKE AVENUE EXT
 DANBURY ,CT 06811

FOLD HERE

<p>RYAN CLARK CENTERLINE COMMUNICATIONS, LLC 117 CAROL STREET DANBURY CT 06810-8312</p> <p>SHIP TO: DZENIS JASAVIC 15 PENT ROAD DEEP RIVER CT 06417-2048</p>	<p>1 OF 1</p> <p>1 LBS DWT: 12.9,1</p> <p>CT 063 5-02</p> 	<p>UPS GROUND</p> <p>TRACKING #: 1Z 9Y4 503 03 0290 9672</p> 	<p>BILLING: P/P</p>  <p>CS 23.6.00... WNTNV50 39.0A 09/2022*</p>
--	---	---	--

1 of 1

Service Alert due to Situation in Ukraine [...More \(/us/en/service-alerts.page?id=alert1\)](#)



Last Updated: 09/26/2022 11:56 A.M. EST



< Back to

09/26/2022
10:58 A.M.

On the Way
Drop-Off
Brookfield, CT, United States

☆
You
CEN
Esti
The

09/22/2022
2:37 P.M.

Label Created
Shipper created a label, UPS has not received the package yet.
United States

Close



Label Created



On the Way

Out for Delivery

Delivery

Feedback

Ship To

DEEP RIVER TOWN HALL
FIRST SELECTMAN
174 MAIN STREET
DEEP RIVER, CT 064172008 US

Get Updates >

Change My Delivery

[View Details](#)

Ask UPS

UPS Freight Less-than-Truckload ("LTL") transportation services are offered by TFI International Inc., its affiliates or divisions (including without limitation TForce Freight), which are not affiliated with United Parcel Service, Inc. or any of its affiliates, subsidiaries or related entities ("UPS"). UPS assumes no liability in connection with UPS Freight LTL transportation services or any other services offered or provided by TFI International Inc. or its affiliates, divisions, subsidiaries or related entities.



Last Updated: 09/26/2022 11:56 A.M. EST

<p>Legal</p> <p>09/26/2022 10:58 A.M.</p>	<p>On the Way</p> <p>Drop-Off Brookfield, CT, United States</p> <p style="text-align: right;">+</p>
<p>Copyriç</p> <p>09/22/2022 2:37 P.M.</p>	<p>Label Created</p> <p>Shipper created a label, UPS has not received the package yet. United States</p>

Close

Feedback

Ask UPS

1 of 1

Service Alert due to Situation in Ukraine [...More \(/us/en/service-alerts.page?id=alert1\)](#)



Last Updated: 09/26/2022 11:57 A.M. EST



< Back to

09/26/2022
10:58 A.M.

On the Way
Drop-Off
Brookfield, CT, United States

☆
You
CEN
Esti
The

09/22/2022
2:40 P.M.

Label Created
Shipper created a label, UPS has not received the package yet.
United States

Close



Label Created



On the Way

Out for Delivery

Delivery

Feedback

Ship To

DEEP RIVER TOWN HALL
PLANNING AND ZONING
174 MAIN STREET
DEEP RIVER, CT 064172008 US

Get Updates >

Change My Delivery

[View Details](#)

Ask UPS

UPS Freight Less-than-Truckload ("LTL") transportation services are offered by TFI International Inc., its affiliates or divisions (including without limitation TForce Freight), which are not affiliated with United Parcel Service, Inc. or any of its affiliates, subsidiaries or related entities ("UPS"). UPS assumes no liability in connection with UPS Freight LTL transportation services or any other services offered or provided by TFI International Inc. or its affiliates, divisions, subsidiaries or related entities.



Last Updated: 09/26/2022 11:57 A.M. EST

<p>Legal</p> <p>09/26/2022 10:58 A.M.</p>	<p>On the Way</p> <p>Drop-Off Brookfield, CT, United States</p> <p style="text-align: right;">+</p>
<p>Copyriç</p> <p>09/22/2022 2:40 P.M.</p>	<p>Label Created</p> <p>Shipper created a label, UPS has not received the package yet. United States</p>

Close

Feedback

Ask UPS

1 of 1

Service Alert due to Situation in Ukraine [...More \(/us/en/service-alerts.page?id=alert1\)](#)



Last Updated: 09/26/2022 11:58 A.M. EST



< Back to

09/26/2022
10:58 A.M.

On the Way
Drop-Off
Brookfield, CT, United States



You
CEN
Esti
The

09/22/2022
2:45 P.M.

Label Created
Shipper created a label, UPS has not received the package yet.
United States

Close



Label Created



On the Way

Out for Delivery

Delivery

Ship To

DZENIS JASAVIC
15 PENT ROAD
DEEP RIVER, CT 064172048 US

Get Updates >

Change My Delivery

[View Details](#)

Ask UPS

Feedback

UPS Freight Less-than-Truckload ("LTL") transportation services are offered by TFI International Inc., its affiliates or divisions (including without limitation TForce Freight), which are not affiliated with United Parcel Service, Inc. or any of its affiliates, subsidiaries or related entities ("UPS"). UPS assumes no liability in connection with UPS Freight LTL transportation services or any other services offered or provided by TFI International Inc. or its affiliates, divisions, subsidiaries or related entities.



Last Updated: 09/26/2022 11:58 A.M. EST

<p>Legal</p> <p>09/26/2022 10:58 A.M.</p>	<p>On the Way</p> <p>Drop-Off Brookfield, CT, United States</p> <p style="text-align: right;">+</p>
<p>Copyriç</p> <p>09/22/2022 2:45 P.M.</p>	<p>Label Created</p> <p>Shipper created a label, UPS has not received the package yet. United States</p>

Close

Feedback

Ask UPS

1 of 1

Service Alert due to Situation in Ukraine [...More \(/us/en/service-alerts.page?id=alert1\)](#)



Last Updated: 09/26/2022 11:58 A.M. EST



< Back to

09/26/2022
10:58 A.M.

On the Way
Drop-Off
Brookfield, CT, United States

☆
You
CEN
Esti
The

09/22/2022
2:42 P.M.

Label Created
Shipper created a label, UPS has not received the package yet.
United States

Close



Label Created



On the Way

Out for Delivery

Delivery

Feedback

Ship To

CROWN CASTLE
ATTN: CONTRACT DEV. DOCUMENT EXECUT
2000 CORPORATE DRIVE
CANONSBURG, PA 153178564 US

Get Updates >

Change My Delivery

[View Details](#)

Ask UPS

UPS Freight Less-than-Truckload ("LTL") transportation services are offered by TFI International Inc., its affiliates or divisions (including without limitation TForce Freight), which are not affiliated with United Parcel Service, Inc. or any of its affiliates, subsidiaries or related entities ("UPS"). UPS assumes no liability in connection with UPS Freight LTL transportation services or any other services offered or provided by TFI International Inc. or its affiliates, divisions, subsidiaries or related entities.



Last Updated: 09/26/2022 11:58 A.M. EST

<p>Legal</p> <p>09/26/2022 10:58 A.M.</p>	<p>On the Way</p> <p>Drop-Off Brookfield, CT, United States</p> <p style="text-align: right;">+</p>
<p>Copyriç</p> <p>09/22/2022 2:42 P.M.</p>	<p>Label Created</p> <p>Shipper created a label, UPS has not received the package yet. United States</p>

Close

Feedback

Ask UPS