

STATE OF CONNECTICUT
CONNECTICUT SITING COUNCIL

Ten Franklin Square, New Britain, CT 06051

Phone: (860) 827-2935 Fax: (860) 827-2950

E-Mail: siting.council@ct.gov

www.ct.gov/csc

November 4, 2013

Daniel Laub, Esq.
Cuddy & Feder LLP
445 Hamilton Avenue, 14th Floor
White Plains, NY 10601

RE: **DOCKET NO. 439** – Message Center Management, Inc. and New Cingular Wireless PCS, LLC application for a Certificate of Environmental Compatibility and Public Need for the construction, maintenance, and operation of a telecommunications facility located at Bates Woods Park, New London, Connecticut.

Dear Attorney Laub:

By its Decision and Order dated October 31, 2013, the Connecticut Siting Council (Council) granted a Certificate of Environmental Compatibility and Public Need (Certificate) to Message Center Management, Inc. for the construction, maintenance, and operation of a telecommunications facility located at Bates Woods Park, New London, Connecticut.

Enclosed are the Council's Certificate, Findings of Fact, Opinion, and Decision and Order.

Very truly yours,

Melanie Bachman
Acting Executive Director

MB/cm

Enclosures (4)

c: Parties and Intervenors (without Certificate enclosure)
State Documents Librarian (without Certificate enclosure)

LIST OF PARTIES AND INTERVENORS
SERVICE LIST

Status Granted	Status Holder (name, address & phone number)	Representative (name, address & phone number)
Applicant	Message Center Management New Cingular Wireless PCS, LLC	Daniel Laub, Esq. Christopher Fisher, Esq. Cuddy & Feder LLP 445 Hamilton Avenue, 14 th Floor White Plains, NY 10601 (914) 761-1300 (914) 761-5372 fax cfisher@cuddyfeder.com dlaub@cuddyfeder.com Michele Briggs AT&T 500 Enterprise Drive Rocky Hill, CT 06067-3900 michele.g.briggs@cingular.com Virginia King Message Center Management 40 Woodland Street Hartford, CT 06105 vking@mcmgmt.com

STATE OF CONNECTICUT)

ss. New Britain, Connecticut :

COUNTY OF HARTFORD)

I hereby certify that the foregoing is a true and correct copy of the Findings of Fact, Opinion, and Decision and Order issued by the Connecticut Siting Council, State of Connecticut.

ATTEST:

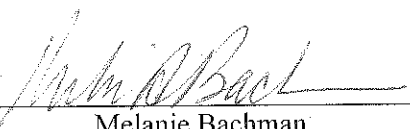

Melanie Bachman
Acting Executive Director
Connecticut Siting Council

I certify that a copy of the Findings of Fact, Opinion, and Decision and Order in Docket No. 439 has been forwarded by Certified First Class Return Receipt Requested mail, on November 4, 2013, to all parties and intervenors of record as listed on the attached service list, dated June 24, 2013.

ATTEST:



Carriann Mulcahy
Secretary II
Connecticut Siting Council

DOCKET NO. 439 – Message Center Management, Inc. and New Cingular Wireless PCS, LLC application for a Certificate of Environmental Compatibility and Public Need for the construction, maintenance, and operation of a telecommunications facility located at Bates Woods Park, New London, Connecticut. }

Connecticut

Siting

Council

October 31, 2013

Findings of Fact

Introduction

1. Message Center Management, Inc. and New Cingular Wireless PCS, LLC (collectively the Applicant), in accordance with provisions of Connecticut General Statutes (C.G.S.) § 16-50g, et seq., applied to the Connecticut Siting Council (Council) on June 21, 2013 for the construction, maintenance, and operation of a 115-foot wireless telecommunications facility at Bates Woods Park in New London, Connecticut (refer to Figure 1). (Applicant 1, pp. 1-2)
2. New Cingular Wireless PCS, LLC (AT&T) is a Delaware limited liability company with an office at 500 Enterprise Drive, Rocky Hill, Connecticut. The company's member corporation is licensed by the Federal Communications Commission (FCC) to construct and operate a personal wireless services system. AT&T does not conduct any other business in the State of Connecticut other than the provision of wireless services under FCC rules and regulations. (Applicant 1, pp. 2-3)
3. Message Center Management, Inc. (MCM) is a Connecticut company with an office in Hartford, Connecticut. MCM owns and operates numerous facilities throughout Connecticut. MCM would be the Certificate Holder and would construct and maintain the proposed facility. (Applicant 1, p. 2)
4. The party in this proceeding is the Applicant. (Transcript 1, September 10, 2013- 3:30 p.m. [Tr. 1], p. 4)
5. The purpose of the proposed facility is to provide reliable wireless telecommunications services in the Route 1, Route 85 and Interstate 95 area of New London. (Applicant 1, p. 8)
6. Pursuant to C.G.S. § 16-50m, the Council, after giving due notice thereof, held a public hearing on September 10, 2013, beginning at 3:30 p.m. and continuing at 7:00 p.m. at New London High School, 490 Jefferson Avenue, New London, Connecticut. (Council's Hearing Notice dated July 29, 2013; Tr. 1, p. 1)
7. The Council and its staff conducted an inspection of the proposed site on September 10, 2013, beginning at 2:30 p.m. During the field inspection, the Applicant flew a 4-foot diameter balloon to simulate the height of the proposed tower. The weather was breezy so the balloon was mostly at an angle rather than straight up. (Tr. 1, pp. 72-73)
8. Pursuant to C.G.S. § 16-50l (b), public notice of the application was published in The Day on June 17 and June 18, 2013. (Applicant 3)
9. Pursuant to C.G.S. § 16-50l(b), notice of the application was provided to all abutting property owners by certified mail. Return receipts for nine abutters were not received. The Applicant sent out a second notice via First Class Mail to these abutters. (Applicant 4, response 1)
10. Pursuant to C.G.S. § 16-50l (b), AT&T provided notice to all federal, state and local officials and agencies listed therein. (Applicant 1, p. 4)

State Agency Comment

11. Pursuant to C.G.S. § 16-50j (h), on July 29, 2013 and September 11, 2013, the following State agencies were solicited by the Council to submit written comments regarding the proposed facility: Department of Energy and Environmental Protection (DEEP); Department of Public Health (DPH); Council on Environmental Quality (CEQ); Public Utilities Regulatory Authority (PURA); Office of Policy and Management (OPM); Department of Economic and Community Development (DECD); Department of Agriculture (DOAg); Department of Transportation (DOT); and Department of Emergency Management and Public Protection (DESPP). (Record)
12. The DOT sent a no comment letter to the Council on August 5, 2013. No other agencies responded to the Council's solicitation. (Record)

Municipal Consultation/Site Selection

13. AT&T initially approached the City of New London (City) in 2010 for the potential installation of a rooftop facility at the New London High School, adjacent to Bates Woods Park, as T-Mobile is already located there. (Applicant 1, p. 11; Applicant 5)
14. The City advised AT&T the rooftop was not available because the school may be renovated or replaced in the future. (Applicant 1, pp. 11, 18, Applicant 5; Tr. 1, p. 11)
15. AT&T, with MCM, negotiated an agreement with the City that was finalized in early 2013 for a new facility within Bates Woods Park. (Applicant 1, pp. 11, 18; Applicant 5)
16. A technical report was filed with the City of New London and the Town of Waterford (within 2,500 feet) on January 25, 2013. (Applicant 1, p. 18)
17. A public information meeting was held in New London on March 20, 2013. Two area residents attended the meeting but did not express any concerns. (Applicant 1, p. 1; Tr. 1, p. 24)
18. The City of New London did not request additional information. The Town of Waterford did not comment on the proposal. (Applicant 1, pp. 18-19)
19. The City has reserved space at the top of the tower for the future installation of a whip antenna. The City has not identified what departments would be using the antenna or a date of installation. (Applicant 4, response 7)

Public Need for Service

20. In 1996, the United States Congress recognized a nationwide need for high quality wireless telecommunications services, including cellular telephone service. Through the Federal Telecommunications Act of 1996, Congress seeks to promote competition, encourage technical innovations, and foster lower prices for telecommunications services. (Council Administrative Notice Item No. 4)
21. In issuing cellular licenses, the Federal government has preempted the determination of public need for cellular service by the states, and has established design standards to ensure technical integrity and nationwide compatibility among all systems. AT&T is licensed by the Federal Communications Commission (FCC) to provide personal wireless communication service throughout the State. (Council Administrative Notice Item No. 4; Applicant 1, p. 89)

22. The Telecommunications Act of 1996 prohibits local and state entities from discriminating among providers of functionally equivalent services. (Council Administrative Notice Item No. 4)
23. The Telecommunications Act of 1996 prohibits any state or local entity from regulating telecommunications towers on the basis of the environmental effects, which include human health effects, of radio frequency emissions to the extent that such towers and equipment comply with FCC's regulations concerning such emissions. This Act also blocks the Council from prohibiting or acting with the effect of prohibiting the provision of personal wireless service. (Council Administrative Notice Item No. 4)
24. The Wireless Communications and Public Safety Act of 1999 (911 Act) was enacted by Congress to promote and enhance public safety by making 9-1-1 the universal emergency assistance number, by furthering deployment of wireless 9-1-1 capabilities, and by encouraging construction and operation of seamless ubiquitous and reliable networks for wireless services. Approximately 70 percent of 9-1-1 calls are made with a wireless device. (Council Administrative Notice Item No. 6; Applicant 1, p. 7)
25. Following the enactment of the 911 Act, the FCC mandated wireless carriers to provide enhanced 911 services (E911) to allow public safety dispatchers to determine a wireless caller's geographical location within several hundred feet. The proposed facility would become a component of AT&T's E911 network in this part of the state. (Council Administrative Notice Item No. 6; Applicant 1, p. 9)
26. In December 2009, President Barack Obama recognized cell phone towers as critical infrastructure vital to the United States. The Department of Homeland Security, in collaboration with other Federal stakeholders, State, local, and tribal governments, and private sector partners, has developed the National Infrastructure Protection Plan to establish a framework for securing our resources and maintaining their resilience from all hazards during an event or emergency. (Council Administrative Notice Item No. 11)
27. Pursuant to the tower sharing policy of the State of Connecticut under C.G.S. §16-50aa, if the Council finds that a request for shared use of a facility by a municipality or other person, firm, corporation or public agency is technically, legally, environmentally and economically feasible, and the Council finds that the request for shared use of a facility meets public safety concerns, the Council shall issue an order approving such shared use to avoid the unnecessary proliferation of towers in the state. (C.G.S. §16-50aa)

Existing and Proposed Wireless Coverage

28. AT&T's proposed installation would provide 850 MHz (cellular), 1900 MHz (PCS), and 700 MHz (LTE) service. (Applicant 1, Tab 4)
29. AT&T designs its system for -82 dBm in-vehicle coverage and -74 dBm in-building coverage. (Applicant 1, Tab 1)
30. AT&T's existing signal strength in the proposed service area ranges from less than -100 dBm to -82 dBm. (Applicant 4, response 4)
31. Existing AT&T sites cannot reliably provide coverage to the proposed service area. Adjacent AT&T sites that direct coverage into the proposed service area have unsatisfactory lost-call rates and data rate losses. (Applicant 1, Tab 1; Tr. 1, pp. 49-53)

32. The proposed site, with AT&T antennas at a centerline height of 112 feet, would provide 0.8 square miles of new coverage (-82 dBm) within the City as well as significantly increase the amount of available in-building data coverage (-74 dBm) in the areas of Jefferson Avenue, Route 1, Chester Street, Broad Street, Williams Street, and Vauxhall Street in New London and Fog Plain Road, Clark Lane in Waterford. Traffic counts on these roads range from 4,200 to 16,000 daily trips. (AT&T 1, Tab 1; Tr. 1, pp. 49-53)
33. Coverage from the proposed site would provide uninterrupted service for AT&T subscribers traveling these roads as well as enhanced signal penetration into residences, businesses and three area schools within the proposed service area. (Applicant 1, Tab 1, Tab 5)
34. United States Census data (2008) indicates 28,338 people live within the proposed coverage area. Although the coverage from the proposed site overlaps substantially with coverage from existing sites, a population of 3,292 persons would be within the new coverage area. (Applicant 1, Tab 1)
35. Providing coverage to the proposed service area via a distributed antenna system, repeater, or microcell is not practical given the limited service area for each of these systems. These systems are employed for limited, targeted areas such as within buildings, highway underpasses or in urban environments. (Applicant 1, p. 12)

Facility Description

36. The proposed facility would be located on a 124.75-acre parcel owned by the City of New London (refer to Figure 2). (Applicant 1, Tab 3)
37. The site property is developed as a recreational park (Bates Woods Park) and includes athletic fields, a small building and a parking area. (Applicant 1, Tab 3)
38. The tower site is located at the south edge of the east athletic field, in the location of an existing 90-foot tall light pole serving the field. (Applicant 1, p. 1, Tab 3)
39. The Applicant would replace an existing light pole with a 115-foot tall monopole capable of supporting two racks of field lights, two telecommunications carriers, and a municipal whip antenna. (Applicant 1, Tab 3)
40. AT&T would install up to twelve panel antennas on a platform at a centerline height of 112 feet above ground level. A conical ice shield would be installed above the lights to deflect ice falling from the antennas and associated mounting equipment. (Applicant 1, Tab 3)
41. Two racks of field lights would be mounted at approximately 90 feet, in keeping with the current field lighting pattern. (Applicant 1, Tab 3)
42. The tower would be constructed to support a 30-foot extension which would be able to accommodate three additional carriers. (Applicant 1, Tab 3)
43. T-Mobile would have to find a new site once the City moves ahead with renovation or replacement of the current high school. T-Mobile may locate at the 102-foot level of the tower although a lease has not been executed with the Applicant. (Applicant 4, responses 5, 6; Tr. 1, p. 11)

44. A generally rectangular, 3,190 square foot equipment compound would be constructed at the base of the tower. The compound would be able to accommodate equipment for five to six carriers, depending on carriers' specific needs. (Applicant 1, Tab 3)
45. AT&T would install a 12-foot by 20-foot equipment shelter within the compound. (Applicant 1, Tab 3)
46. The compound would be enclosed by an eight-foot high chain-link fence. (Applicant 1, Tab 3)
47. Access to the compound would be from an existing park maintenance driveway traversing the edge of the athletic field area. A small gravel parking area/compound access way would be installed adjacent to the driveway. (Applicant 1, Tab 3)
48. Utility service to the compound would be installed underground from an existing utility pole located in the park's parking lot and would run through a grassy area between the east and west athletic fields to the compound. (Applicant 1, Tab 3)
49. AT&T would install a diesel emergency generator on a concrete pad within the compound. The generator could supply 48 hours of run time before refueling is necessary. (Applicant 1, Tab 3; Applicant 4, response 8)
50. The Applicant does not intend to install an emergency generator that can service multiple carriers, stating there would be outages for all of the carriers if a single generator failed. (Applicant 4, response 8; Tr. 1, p. 71)
51. There are 11 single family residences and 3 multifamily residential buildings within 1,000 feet of the compound. (Applicant 1, Tab 3)
52. The nearest residence to the tower site is approximately 690 feet to the east on Ledge Road. (Applicant 1, Tab 3)
53. The nearest property line to the proposed tower site is approximately 570 feet to the west (new London Water Department property). (Applicant 1, Tab 3)
54. The nearest school is the New London High School, located 1,238 feet northeast of the tower site. (Applicant 1, Tab 3)
55. There are no day care facilities within 250 feet of the proposed site. The nearest licensed day care facility is over a mile away. (Applicant 4, response 10)
56. The estimated construction cost of the proposed facility is:
- | | |
|-------------------------------|-------------------|
| Radio equipment and antennas | \$250,000. |
| Site development/installation | 54,000. |
| Tower and foundation | 125,000. |
| <u>Utilities</u> | <u>23,500.</u> |
| <u>Total estimated cost</u> | <u>\$452,500.</u> |
- (Applicant 1, p. 19)

Environmental Concerns

57. The proposed site would have no effect on any properties eligible for or on the National Register of Historic Places. (Applicant 4, response 3)
58. There are no known state or federal endangered, or threatened, or species of special concern in the project area. (Applicant 1, Tab 4)
59. The site is at the edge of an existing athletic field. Two trees would be removed to develop the site. (Applicant 1, Tab 4)
60. Land use within a quarter-mile of the site includes multi and single-family residential, developed park land, open space and a school. (Applicant 1 Tab 3)
61. No wetlands would be directly impacted by the project. The nearest wetland is approximately 285 feet southeast of the site in a wooded portion of the park. This wetland is characterized as a stony seep wetland dominated by single-aged red maple. A second wetland is located 320 feet west of the site, adjacent to an existing paved park road and dog kennel. This wetland has been altered to function as a detention basin. (Applicant 1, Tab 3, Tab 4)
62. An approximate 11,630 square-foot area would be disturbed to develop the site. The site is on the edge of a slope and would require 87 cubic yards of cut and 370 yards of fill material, including 120 cubic yards of crushed stone material. (Applicant 1, Tab 3)
63. The south side of the site would feature a 1.5:1 slope with rip-rap protection. (Applicant 1, Tab 3)
64. Erosion and sedimentation controls consistent with the *2002 Connecticut Guidelines for Soil Erosion and Sediment Control*, as amended, and other best management practices would be established and maintained during construction. (Applicant 1, Tab 4)
65. Aircraft hazard obstruction marking or lighting of the tower would not be required. Aviation hazard lighting would be required for a facility height above 165 feet. (Applicant 1, p. 14; Tr. 1, p. 30)
66. The nearest Important Bird Area, a National Audubon Society designation that recognizes unique habitats that stand out from the surrounding landscape and typically support vulnerable or special concern species, is approximately 1.2 miles north of the proposed site. The designated area consists of a mature hemlock forest within the Connecticut College Arboretum. (Applicant 4, response 11)
67. The design of the proposed tower would comply with recommended guidelines of the United States Fish and Wildlife Service for minimizing the potential for telecommunications towers to impact bird species. The guidelines recommend that towers be less than 199 feet tall, avoid the use of aviation lighting, and avoid guy wires as tower supports. (Council Administrative Notice 13; AT&T 2, response 12)
68. Once the tower is constructed, osprey nesting on the antenna platforms could be an issue with maintenance of the facility. Any antenna work would have to be scheduled outside of osprey nesting season, generally May to September. (Tr. 1, pp. 17-18; 44, 45)

69. The cumulative worst-case maximum power density from the radio frequency emissions from the operation of the proposed AT&T antennas is calculated to be 11.2% of the standard for the General Public/Uncontrolled Maximum Permissible Exposure, as adopted by the FCC, at the base of the proposed 115-foot tower. This calculation was based on methodology prescribed by the FCC Office of Engineering and Technology Bulletin No. 65E, Edition 97-01 (August 1997) that assumes all antennas would be pointed at the base of the tower and all channels would be operating simultaneously, which creates the highest possible power density levels. Under normal operation, the antennas would be oriented outward, directing radio frequency emissions away from the tower, thus resulting in significantly lower power density levels in areas around the tower base. (Applicant 1, p. 14)

Visibility

70. The proposed tower would be visible year-round above the tree canopy from approximately 120-acres within a two-mile radius of the proposed site (refer to Figure 5). Most of this visibility would be from locations within 0.5 miles of the site that already have a view of the existing 90-foot light pole, including open athletic fields, school property, a multi-family housing complex and a cemetery. (Applicant 1, Tab 5)

71. Nine residences along Davis Farm Way, abutting Bates Woods Park to the west, would have year-round views of the upper 80 feet of the tower. (Applicant 1, Tab 5)

72. Approximately 128 acres within two miles of the site would have seasonal visibility of the proposed tower. Seasonal views would mostly be of the upper 80 feet of the tower. (Applicant 1, Tab 5)

73. Visibility of the proposed tower from specific locations within a two-mile radius of the site is as follows:

Specific Location	Photo location on Map*	Approx. Portion of Tower Visible (not including whip antenna)	Approx. Distance (miles)/Direction to Tower
Bates Woods Park Parking Lot	1	Entire structure	0.13/southeast
New London High School Parking Lot^	2	Entire structure	0.24/southwest
Jefferson Avenue	3	100 feet	0.32/southwest
St. Mary's Cemetery	4	40 feet	0.38/southeast
Michael Road	5	25 feet	0.32/southeast
Davis Farm Way^	6	80 feet	0.18/southeast
Clark Lane	7	45 feet	0.41/northeast

* Map is attached as Figure 5.

^ Photosimulation of tower from this location attached.

74. There are no State-designated scenic roads in New London or Waterford. (Council Administrative Notice 50)

75. The tower would not be visible from any known hiking trails maintained by the DEEP or the Connecticut Forest and Parks Association. (Council Administrative Notice 49)

76. The proposed tower would have a galvanized finish. Other light poles serving the fields have either a galvanized finish or a weathering steel finish. The Applicant could install a tower with a weathering steel finish. (Applicant 1, Tab 5; Tr. 1, pp. 31-32)



Figure 1: Site location in Bates Woods Park, New London. (Applicant 1, Tab 3)

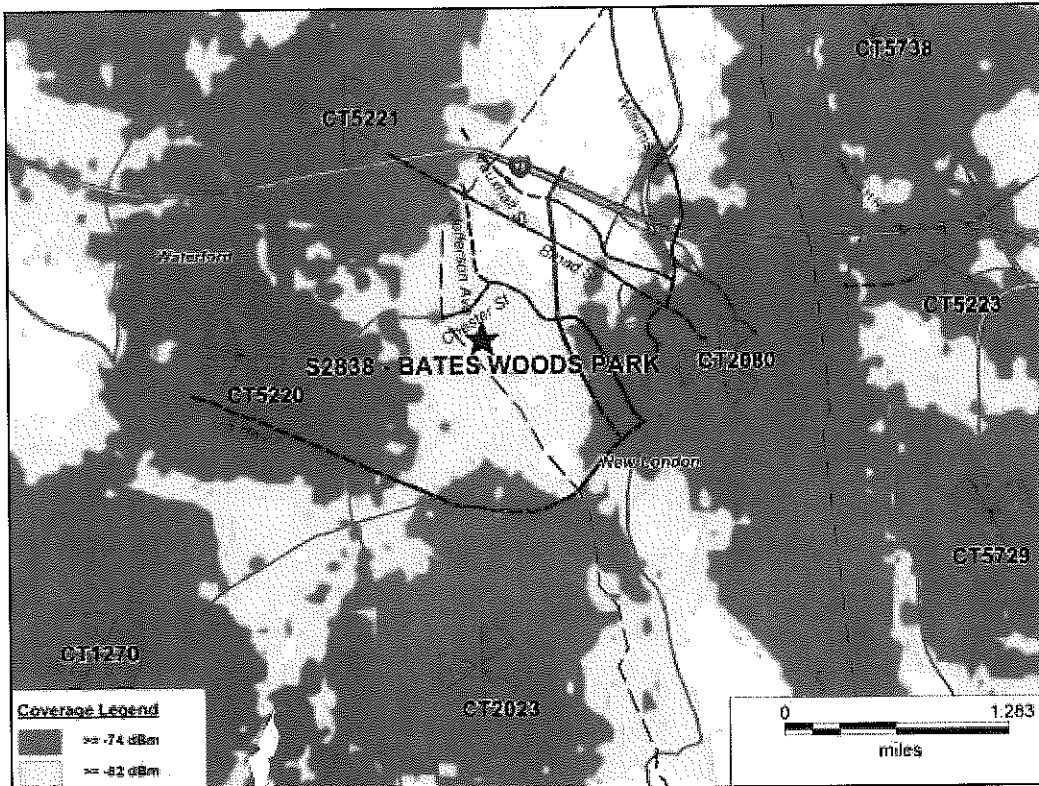

Figure 2: Existing AT&T coverage. (Applicant 1, Tab 1)

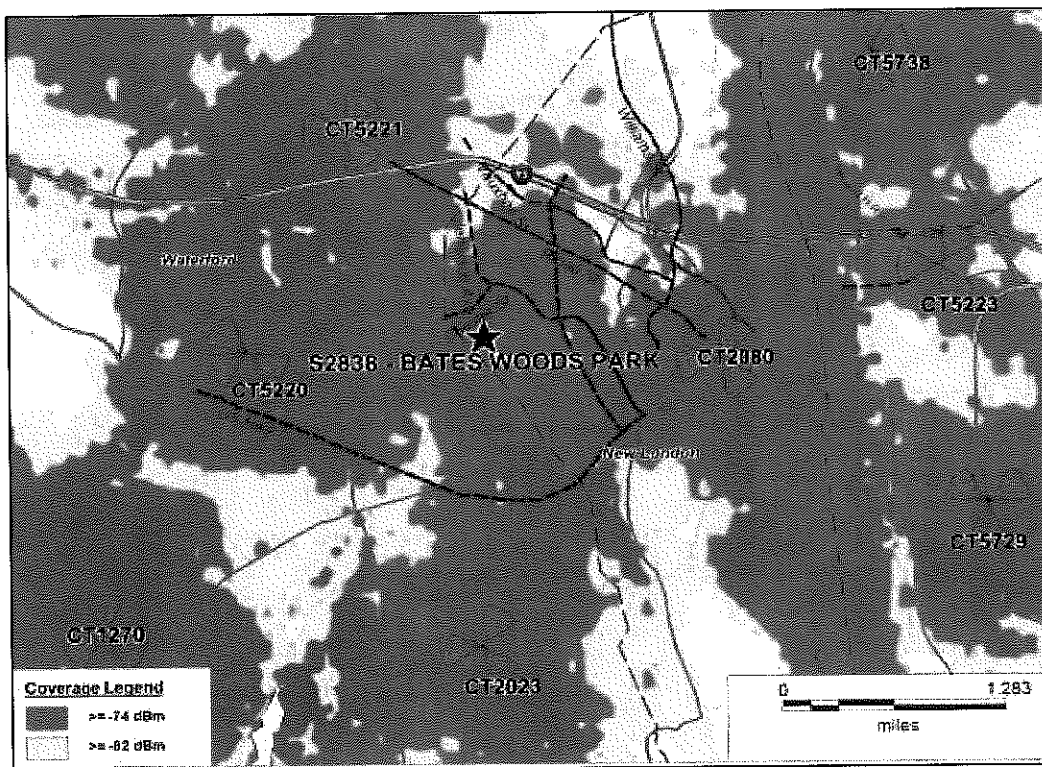
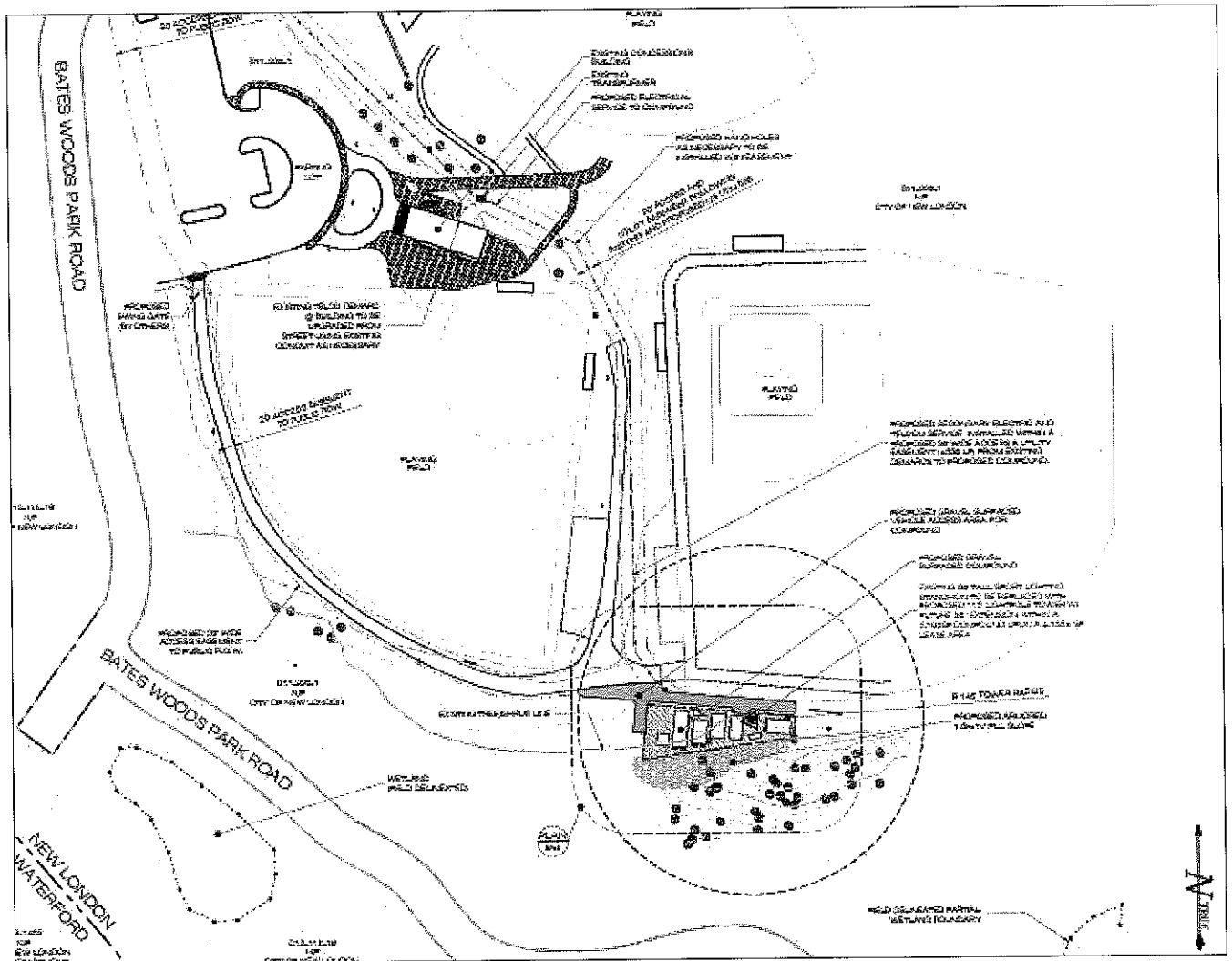

Figure 3: Existing and proposed AT&T coverage. (Applicant 1, Tab 1)



(Not to scale)

Figure 4: Proposed site plan. (Applicant 1, Tab 3)



Legend

- +** Proposed Tower
 - 2-Mile Study Area
 - Year-Round
 - ▨** Predicted Seasonal Visibility
 - ⋯** Predicted Year-Round Visibility
- (not to scale)

Figure 5: Projected visibility of the 150-foot tower. (Applicant 1, Tab 5)



Top photo : existing light pole.

Bottom photo: photo simulation of proposed tower

Location: Davis Farm Way, 0.18 miles north west of site. Visibility map location 6. (Applicant 1, Tab 5)



Top photo: existing light pole

Bottom photo: Photo simulation of proposed 115-foot tower.

Location: New London High School, 0.32 mile northeast of site. Visibility map location 3. (Applicant 1, Tab 5)

<p>DOCKET NO. 439 – Message Center Management, Inc. and New Cingular Wireless PCS, LLC application for a Certificate of Environmental Compatibility and Public Need for the construction, maintenance, and operation of a telecommunications facility located at Bates Woods Park, New London, Connecticut.</p>	<p>} Connecticut } Siting } Council</p>
--	---

October 31, 2013

Opinion

Message Center Management, Inc. (MCM) and New Cingular Wireless PCS, LLC (AT&T) applied to the Connecticut Siting Council (Council) for a Certificate of Environmental Compatibility and Public Need (Certificate) for the construction, maintenance and operation of a wireless telecommunications facility located at Bates Woods Park in New London, Connecticut. AT&T’s objective for this facility is to provide reliable wireless telecommunications services in the Route 1, Route 85 and Interstate 95 area of New London.

The proposed tower site is located in Bates Woods Park, a 124-acre recreational park owned by the City of New London that contains several athletic fields, a dog kennel, and wooded areas. MCM, as the Certificate holder, proposes to construct a 115-foot monopole at the edge of the west ball field, adjacent to a wooded area. The proposed tower is in the location of an existing 90-foot tall light pole serving the field. MCM would locate two racks of lights on the monopole, at an approximate height of 90 feet. AT&T would locate 12 panel antennas on a platform at a centerline height of 112 feet. T-Mobile Northeast has an existing facility on the roof of the New London High School adjacent to the park, and may locate at the 102-foot level of the tower depending on when the City undergoes a school renovation project.

Given the two racks of field lights on the pole and an ice shield above the lights, no other carriers would be able to locate at the facility; thus, MCM would build the tower to accommodate an extension up to 145 feet above ground level. If the extension was fully developed, three additional carriers could locate on the tower. Any proposed extension of the tower would need Council approval.

AT&T proposes to operate 850 MHz (cellular), 1900 MHz (PCS), and 700 MHz (LTE) service equipment at the site. AT&T does not have reliable coverage to the proposed service area, defined by AT&T as less than -82 dBm for roadways and -74 dBm for residential areas. AT&T’s existing signal strength in the proposed service area ranges from less than -100 dBm to -82 dBm. The proposed site would provide AT&T with 0.8 square miles of new coverage (-82 dBm) within the City as well as significantly increasing the amount of available in-building data coverage (-74 dBm) in the areas of Jefferson Avenue, Route 1, Chester Street, Broad Street, Williams Street, and Vauxhall Street in New London and Fog Plain Road, and Clark Lane in Waterford.

An equipment compound, generally rectangular in shape, would be constructed at the edge of the ball field. It would be located at the top of a slope that would be armored with rip-rap. Access would be from an existing park maintenance driveway traversing the edge of the athletic field area. A small gravel parking area/compound access way would be installed adjacent to the driveway. Utility service to the compound would be installed underground from an existing utility pole located in the park’s parking lot and would run through a grassy area between the east and west athletic fields to the compound.

AT&T, at this time the facility's sole tenant, plans to install an equipment shelter and a generator within the fenced compound. The site owner, MCM, has no current plan to install a generator that would accommodate others. Since co-location here is likely, however, the Council encourages MCM to collaborate with AT&T on considering a generator sized appropriately to accommodate multiple carriers, thus maximizing backup power in the event a power outage occurs.

Development of the site would require the removal of two trees. No wetlands would be directly affected by construction. The nearest wetland is located approximately 285 southeast of the site in a wooded portion of the park. The site would have no effect on historic, architectural, or archaeological resources listed on or eligible for the National Register of Historic Places. There are no known state or federal endangered, or threatened, or species of special concern in the project area.

Based on an examination of AT&T's coverage objectives and the physical and environmental impacts of the proposal, the Council finds the proposed site suitable. The site is supported by the City and would provide needed telecommunication services in a coastal area. Development of the site itself would have no adverse environmental effect, as it located in a previously disturbed area and would be accessed by an existing driveway.

The Council finds that the replacement of the existing 90-foot light pole with an 115-foot tower would have a minimal effect on visibility, given the number of existing light poles in the field area and the amount of tree cover nearby that offers sufficient screening to the surrounding area. Moreover, replacing an existing structure in like kind fulfills the legislature's policy of sharing structures, and thus avoiding the unnecessary proliferation of towers.

Views of the tower would be limited to open areas adjacent to the park and high school. Given that there are light poles in the park with two different finishes, galvanized and weathered steel, the Council will direct MCM to consult with the City to determine the City's preference for the final tower finish.

According to a methodology prescribed by the FCC Office of Engineering and Technology Bulletin No. 65E, Edition 97-01 (August 1997), the combined radio frequency power density levels of AT&T's antennas proposed to be installed on the tower have been calculated to amount to 11.2 percent of the FCC's General Public/Uncontrolled Maximum Permissible Exposure, as measured at the base of the tower. This percentage is well below federal and state standards established for the frequencies used by wireless companies. The Council will require that the power densities be recalculated in the event other carriers add antennas to the tower, including the Town's emergency communication antennas. Also, if federal or state standards change, the Council will require that the tower be brought into compliance with such standards. The Telecommunications Act of 1996 prohibits any state or local agency from regulating telecommunications towers on the basis of the environmental effects of radio frequency emissions to the extent that such towers and equipment comply with FCC's regulations concerning such emissions.

Based on the record in this proceeding, the Council finds that the effects associated with the construction, operation, and maintenance of the telecommunications facility at the proposed site, including effects on the natural environment; ecological integrity and balance; public health and safety; scenic, historic, and recreational values; forests and parks; air and water purity; and fish and wildlife are not disproportionate either alone or cumulatively with other effects when compared to need, are not in conflict with policies of the State concerning such effects, and are not sufficient reason to deny this application. Therefore, the Council will issue a Certificate for the construction, operation, and maintenance of a 115-foot monopole telecommunications facility at the proposed site.

DOCKET NO. 439 – Message Center Management, Inc. and New } Connecticut
 Cingular Wireless PCS, LLC application for a Certificate of }
 Environmental Compatibility and Public Need for the construction, } Siting
 maintenance, and operation of a telecommunications facility } Council
 located at Bates Woods Park, New London, Connecticut. }

October 31, 2013

Decision and Order

Pursuant to Connecticut General Statutes §16-50p and the foregoing Findings of Fact and Opinion, the Connecticut Siting Council (Council) finds that the effects associated with the construction, maintenance, and operation of a telecommunications facility, including effects on the natural environment; ecological integrity and balance; public health and safety; scenic, historic, and recreational values; forests and parks; air and water purity; and fish and wildlife are not disproportionate, either alone or cumulatively with other effects, when compared to need, are not in conflict with the policies of the State concerning such effects, and are not sufficient reason to deny the application, and therefore directs that a Certificate of Environmental Compatibility and Public Need, as provided by General Statutes § 16-50k, be issued to Message Center Management, Inc., hereinafter referred to as the Certificate Holder, for a telecommunications facility at Bates Woods Park, New London, Connecticut.

Unless otherwise approved by the Council, the facility shall be constructed, operated, and maintained substantially as specified in the Council’s record in this matter, and subject to the following conditions:

1. The tower shall be constructed as a monopole, no taller than necessary to provide the proposed telecommunications services, sufficient to accommodate the antennas of New Cingular Wireless PCS, LLC and other entities, both public and private, but such tower shall not exceed a height of 115 feet above ground level.
2. The Certificate Holder shall prepare a Development and Management (D&M) Plan for this site in compliance with Sections 16-50j-75 through 16-50j-77 of the Regulations of Connecticut State Agencies. The D&M Plan shall be served on the City of New London for comment, and all parties and intervenors as listed in the service list, and submitted to and approved by the Council prior to the commencement of facility construction and shall include:
 - a) a final site plan(s) of site development to include specifications for the tower, tower foundation, antennas, equipment compound, radio equipment, access road, utility line, emergency backup power, and landscaping; and
 - b) construction plans for site clearing, grading, landscaping, water drainage, and erosion and sedimentation controls consistent with the 2002 Connecticut Guidelines for Soil Erosion and Sediment Control, as amended.
 - c) determination of the final tower finish, upon consultation with the City of New London.
3. Prior to the commencement of operation, the Certificate Holder shall provide the Council worst-case modeling of the electromagnetic radio frequency power density of all proposed entities’ antennas at the closest point of uncontrolled access to the tower base, consistent with Federal Communications Commission, Office of Engineering and Technology, Bulletin No. 65, August 1997. The Certificate Holder shall ensure a recalculated report of the electromagnetic radio frequency power density be submitted to the Council if and when circumstances in operation cause a change in power density above the levels calculated and provided pursuant to this Decision and Order.

4. Upon the establishment of any new State or federal radio frequency standards applicable to frequencies of this facility, the facility granted herein shall be brought into compliance with such standards.
5. The Certificate Holder shall permit public or private entities to share space on the proposed tower for fair consideration, or shall provide any requesting entity with specific legal, technical, environmental, or economic reasons precluding such tower sharing.
6. Unless otherwise approved by the Council, if the facility authorized herein is not fully constructed with at least one fully operational wireless telecommunications carrier providing wireless service within eighteen months from the date of the mailing of the Council's Findings of Fact, Opinion, and Decision and Order (collectively called "Final Decision"), this Decision and Order shall be void, and the Certificate Holder shall dismantle the tower and remove all associated equipment or reapply for any continued or new use to the Council before any such use is made. The time between the filing and resolution of any appeals of the Council's Final Decision shall not be counted in calculating this deadline. Authority to monitor and modify this schedule, as necessary, is delegated to the Executive Director. The Certificate Holder shall provide written notice to the Executive Director of any schedule changes as soon as is practicable.
7. Any request for extension of the time period referred to in Condition 6 shall be filed with the Council not later than 60 days prior to the expiration date of this Certificate and shall be served on all parties and intervenors, as listed in the service list, and the City of New London. Any proposed modifications to this Decision and Order shall likewise be so served.
8. If the facility ceases to provide wireless services for a period of one year, this Decision and Order shall be void, and the Certificate Holder shall dismantle the tower and remove all associated equipment or reapply for any continued or new use to the Council before any such use is made.
9. Any nonfunctioning antenna, and associated antenna mounting equipment, on this facility shall be removed within 60 days of the date the antenna ceased to function.
10. In accordance with Section 16-50j-77 of the Regulations of Connecticut State Agencies, the Certificate Holder shall provide the Council with written notice two weeks prior to the commencement of site construction activities. In addition, the Certificate Holder shall provide the Council with written notice of the completion of site construction, and the commencement of site operation.
11. The Certificate Holder shall remit timely payments associated with annual assessments and invoices submitted by the Council for expenses attributable to the facility under Conn. Gen. Stat. §16-50v.
12. This Certificate may be transferred in accordance with Conn. Gen. Stat. §16-50k(b), provided both the Certificate Holder/transferor and the transferee are current with payments to the Council for their respective annual assessments and invoices under Conn. Gen. Stat. §16-50v. In addition, both the Certificate Holder/transferor and the transferee shall provide the Council a written agreement as to the entity responsible for any quarterly assessment charges under Conn. Gen. Stat. §16-50v(b)(2) that may be associated with this facility.

13. The Certificate Holder shall maintain the facility and associated equipment, including but not limited to, the tower, tower foundation, antennas, equipment compound, radio equipment, access road, utility line and landscaping in a reasonable physical and operational condition that is consistent with this Decision and Order and a Development and Management Plan to be approved by the Council.
14. If the Certificate Holder is a wholly-owned subsidiary of a corporation or other entity and is sold/transferred to another corporation or other entity, the Council shall be notified of such sale and/or transfer and of any change in contact information for the individual or representative responsible for management and operations of the Certificate Holder within 30 days of the sale and/or transfer.
15. This Certificate may be surrendered by the Certificate Holder upon written notification and approval by the Council.

We hereby direct that a copy of the Findings of Fact, Opinion, and Decision and Order be served on each person listed in the Service List, dated June 24, 2013, and notice of issuance published in The Day.

By this Decision and Order, the Council disposes of the legal rights, duties, and privileges of each party named or admitted to the proceeding in accordance with Section 16-50j-17 of the Regulations of Connecticut State Agencies.

CERTIFICATION

The undersigned members of the Connecticut Siting Council (Council) hereby certify that they have heard this case, or read the record thereof, in **DOCKET NO. 439** – Message Center Management, Inc. and New Cingular Wireless PCS, LLC application for a Certificate of Environmental Compatibility and Public Need for the construction, maintenance, and operation of a telecommunications facility located at Bates Woods Park, New London, Connecticut, and voted as follows to approve the proposed facility.

Council Members

Vote Cast



Robert Stein, Chairman

Yes

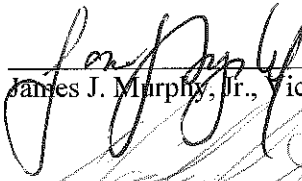

James J. Murphy, Jr., Vice Chairman

Yes

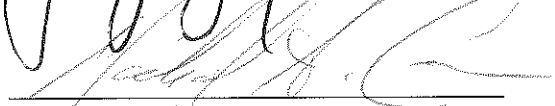

Chairman Arthur House
Designee: Michael Caron

Yes

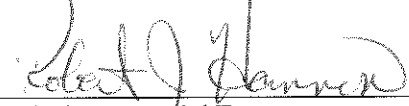

Commissioner Daniel Esty
Designee: Robert Hannon

Yes

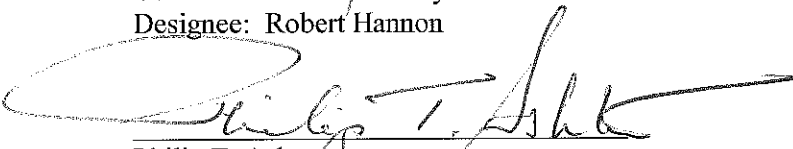

Philip T. Ashton

Yes

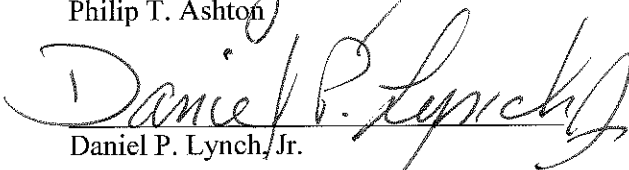

Daniel P. Lynch, Jr.

Yes

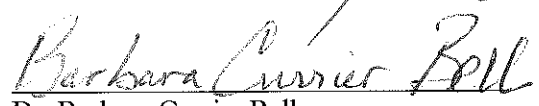

Dr. Barbara Currier Bell

Yes

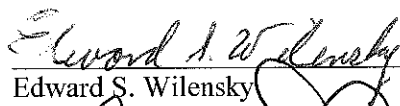

Edward S. Wilensky

Yes

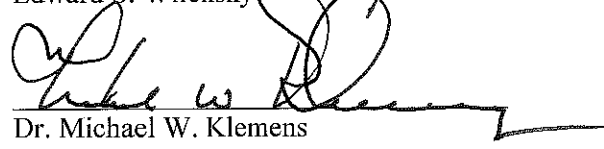

Dr. Michael W. Klemens

Abstain

Dated at New Britain, Connecticut, October 31, 2013.