

New York, New Haven & Hartford Railroad

Soils Chart	
Ce	Corstie muck
CfB	Chanton fine sandy loam, 3 to 8 percent slopes
CrC	Chanton-Halls fine sandy loams 3 to 15 percent slopes
HcA	Haven silt loam 0 to 3 percent slopes
HcB	Haven silt loam 3 to 8 percent slopes
Ru	Rumney fine sandy loam

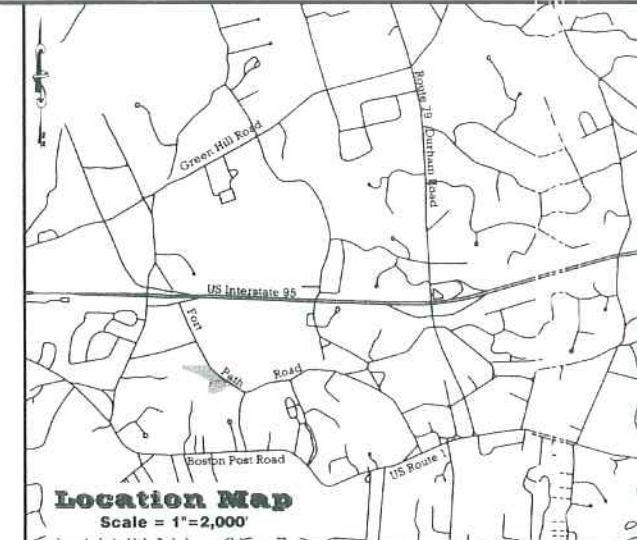

Wetland Flag Coordinates

Flag #	Northing	Easting	Elevation
WLF 1	66348.2147	103540.1944	
WLF 2	66343.6890	103537.0030	3.48
WLF 3	66300.2963	103540.3823	11.51
WLF 4	66374.3355	103542.5872	14.34
WLF 5	66370.4290	103544.1801	7.08
WLF 6	66370.2880	103541.0301	4.35
WLF 7	66370.8314	103539.2902	
WLF 8	66362.3450	103536.7571	7.45
WLF 9	66363.4145	103535.4756	13.82
WLF 10	66366.0106	103536.4266	9.36
WLF 11	66369.5622	103540.8301	12.48
WLF 12	66351.8036	103536.9881	
WLF 13	66349.2179	103536.8604	4.78
WLF 14	66342.8655	103536.4403	6.97
WLF 15	66341.6.2823	103542.3003	0.23
WLF 16	66337.3474	103535.3050	7.04
WLF 17	66342.6010	103538.2037	7.25
WLF 18	66342.9380	103539.2943	2.08
WLF 19	66343.1158	103542.4460	6.71
WLF 20	66352.5066	103544.4272	5.53
WLF 21	66353.9105	103548.1779	2.79
WLF 22	66355.7460	103550.0911	4.72
WLF 23	66353.2762	103551.9827	5.33
WLF 24	66365.0266	103566.2643	3.77
WLF 25	66362.7220	103566.4273	5.52
WLF 26	66344.3195	103560.8829	7.32
WLF 27	66366.2706	103562.0296	5.04
WLF 28	66362.5129	103562.3458	2.86
WLF 29	66372.3658	103569.2915	3.57
WLF 30	66374.2513	103565.2446	5.18
WLF 31	66370.2217	103572.5899	6.46
WLF 32	66372.8473	103576.2434	29.62
WLF 33	66376.6231	103579.6611	3.63
WLF 34	66372.3363	103581.0315	0.50
WLF 35	66374.0266	103583.6648	7.78
WLF 36	66374.1276	103583.2796	12.48
WLF 37	66375.4567	103580.6079	15.03
WLF 38	66369.6022	103580.8812	7.78
WLF 39	66367.7165	103580.4327	7.87
WLF 40	66369.2901	103580.1940	5.73
WLF 41	66381.0321	103532.2537	12.88
WLF 42	66362.2978	103538.3034	12.10
WLF 43	66354.4697	103530.4278	11.75
WLF 44	66364.3289	103534.3671	12.42
WLF 45	66363.4879	103524.2514	11.77
WLF 46	66362.3077	103524.3256	12.22
WLF 47	66341.5188	103522.3152	11.86
WLF 48	66344.1791	103518.9892	11.88
WLF 49	66357.1406	103512.8243	12.02
WLF 50	66360.0700	103514.4244	11.81
WLF 51	66357.0260	103534.3068	12.85
WLF 52	66359.1745	103549.2266	14.31
WLF 53	66363.7046	103524.2705	14.19
WLF 54	66410.1022	103495.5365	14.46
WLF 55	66402.2358	103495.5891	15.12
WLF 56	66402.2924	103492.1741	15.24
WLF 57	66401.9101	103490.8940	15.57
WLF 58	66410.3279	103495.5153	16.93
WLF 59	66415.1980	103487.1692	17.45
WLF 60	66416.3170	103485.2964	17.69
WLF 61	66405.4042	103480.1715	16.55

Notes:

- This Map Has Been Prepared in Accordance With Sections 20-3005-1 Through 20-3006-20 Of The Regulations Of Connecticut State Agencies "Minimum Standards For Surveys And Maps In The State Of Connecticut" As Enforced By The Connecticut Association Of Land Surveyors, Inc. On September 26, 1992. This Survey Is A General Location Survey, Conforming To Horizontal Accuracy Class A-2 Standards And Is Intended To Be Used To Delineate The Location Of The Wetlands Delineated By R. Richard Snarski And Field Located By The Office.
- Reference Is Made To The Following Map:
A. PERIMETER SURVEY PREPARED FOR THE SUNSHINE HOUSE ASSESSOR'S MAP NO. LOT 25 FORT PATH ROAD MADISON, CONNECTICUT. SCALE 1"=40'. DATED: 5-12-06. THOMAS A. STEVENS & ASSOCIATES, INC.
- OFFICIAL INLAND WETLANDS AND WATER COURSES MAP, MADISON, CONNECTICUT SCALE 1"=1,000'. DATE: MARCH 15, 1975.
- NATIONAL FLOOD INSURANCE PROGRAM (NFIP) FLOOD INSURANCE RATE MAP TOWN OF MADISON, CONNECTICUT, NEW HAVEN COUNTY, PANEL 11 OF 11, COMMUNITY-PANEL NUMBER 06079 001 C, MAP REVISED NOVEMBER 4, 1997 BY FEDERAL EMERGENCY MANAGEMENT AGENCY.
- SOIL SURVEY, NEW HAVEN COUNTY, CONNECTICUT, UNITED STATES DEPARTMENT OF AGRICULTURE, SOIL CONSERVATION SERVICE, IN COOPERATION WITH CONNECTICUT AGRICULTURAL EXPERIMENT STATION AND STORRS AGRICULTURAL EXPERIMENT.
- Lot Area - 353,129.92 Sq. Ft. Or 8.13 Acres.
- The Current Deeds Of Record Is Volume 726, Page 056.
- Five Rights As Contained In A Grant From George E. Whedon To Aetna Construction Company, Dated January 21, 1910 As Filed In Madison Land Records Volume 28, Page 395.
- Topographic Information Depicted On The Drawing Is Based On A Field Survey Conducted By This Office On 7-6-06 Thru 5-17-06. All Existing Features And Conditions Are Not Necessarily Depicted Or Noted Hereon. Property Line Information Shown On The Drawing Is Approximate Only And Is Provided For The Contractor's General Information.
- All Elevations Are Referenced To The National Geodetic Vertical Datum Of 1929.

Owner / Applicant

Owner: Louis A. Goddard Et Als
C/O Kingsley Goddard
353 Boston Post Road
Madison, Connecticut 06443

Applicant: The Sunshine House
C/O Amy Kunher
P. O. Box 4068
Madison, Connecticut 06443

Legend

- Property/Right of Way
- Easement
- Concrete Monument (Found)
- Iron Pipe/Rebar (Found)
- Drill Hole
- Stone Wall
- Fence Line
- Fence Post (Barbed Wire)
- Now or Formerly
- Flood Lines Per Ref. Map 2.C
- Town Wetlands Per Ref. Map 2.B
- S.C.S. Soils Type Boundary
- Edge Of Existing Tree Line
- Over Head Wires
- Inland Wetlands Per R. Snarski

Approved August 7, 2006

Approved By The Town Of Madison Inland Wetlands And Watercourses Agency.

Robert Brown 915106
Chairman Date

I HAVE REVIEWED THE WETLANDS BOUNDARIES AS SHOWN ON THIS PLAN AND AM OF THE OPINION THAT THEY REPRESENT THE SOIL BOUNDARIES MARKED BY ME IN THE FIELD.

R. Richard Snarski
R. RICHARD SNARSKI, CERTIFIED SOIL SCIENTIST #1975

Thomas A. Stevens & Associates, Inc.
Civil Engineers - Land Surveyors
141 Durham Road - Unit 24
Madison, CT 06443-0668
(203) 245-0149 (800) 859-0132
Facsimile (203) 245-0721
www.ctsurvey.org

Inland Wetlands Boundary Amendment Map
Prepared For
The Sunshine House
Assessor's Map 36, Lot 25
Fort Path Road
Madison, Connecticut

Date:	5-13-06
Drawing:	D-1053
Project:	4550
View:	HL
Scale:	
Drawn By:	Anthony Bolduc
Checked By:	Thomas Stevens
Approved By:	
Station:	Station 316 (Lined Projects) 214550 (Imp) 14550 (Imp)
Sheet:	1 of 1

4362

FILED 9-7-06

4812