

Map No. 6

Open Space & Recreation Plan

Avon, Connecticut

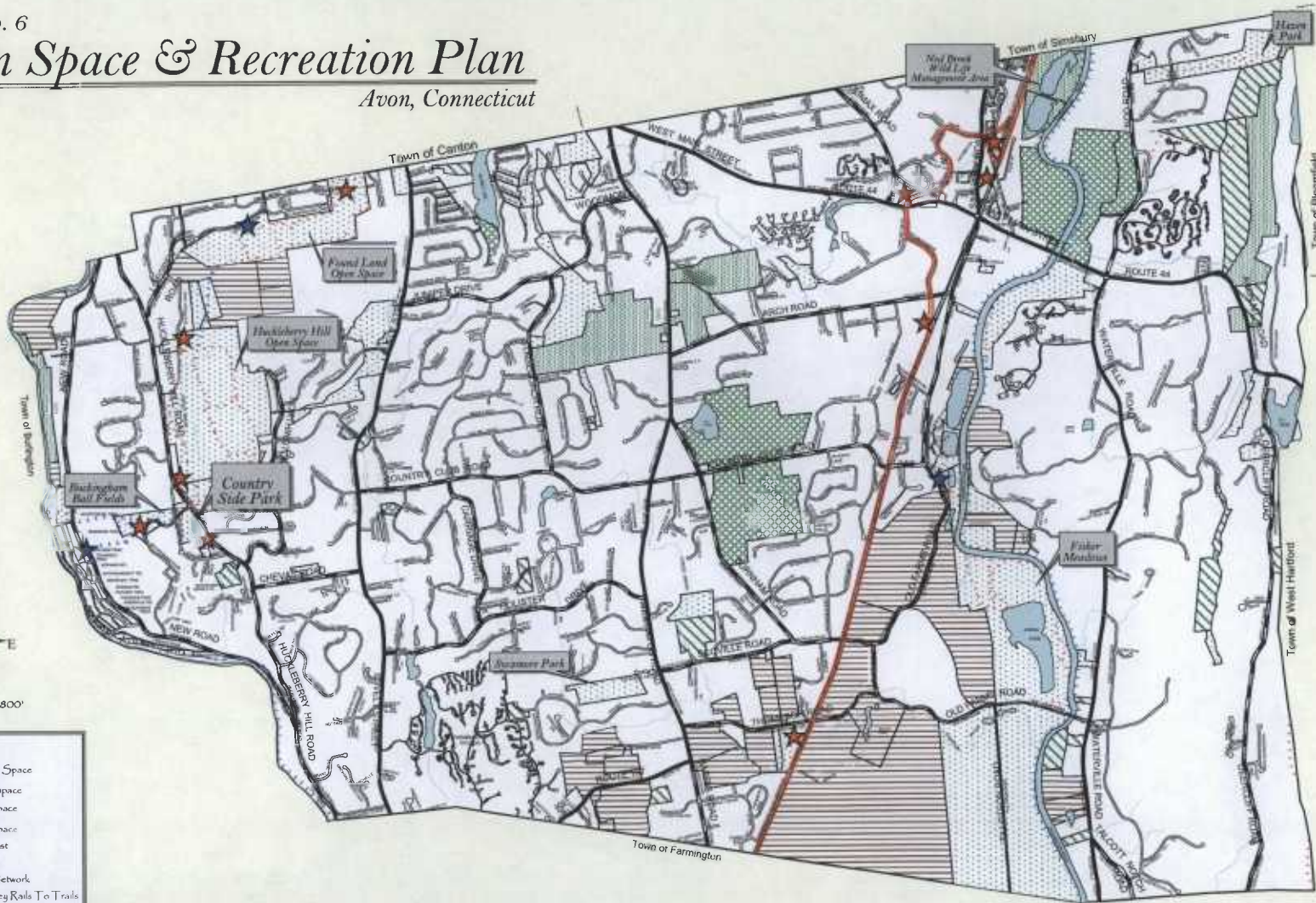

Scale: 1" = 2800'

- LEGEND:**
- Proposed Open Space
 - Private Open Space
 - State Open Space
 - Town Open Space
 - Avon Land Trust
 - Proposed Trails
 - Existing Trail Network
 - Farnington Valley Rails To Trails
 - Existing Public Trail Access
 - Proposed Public Trail Access

Map of site and town alternates (2)

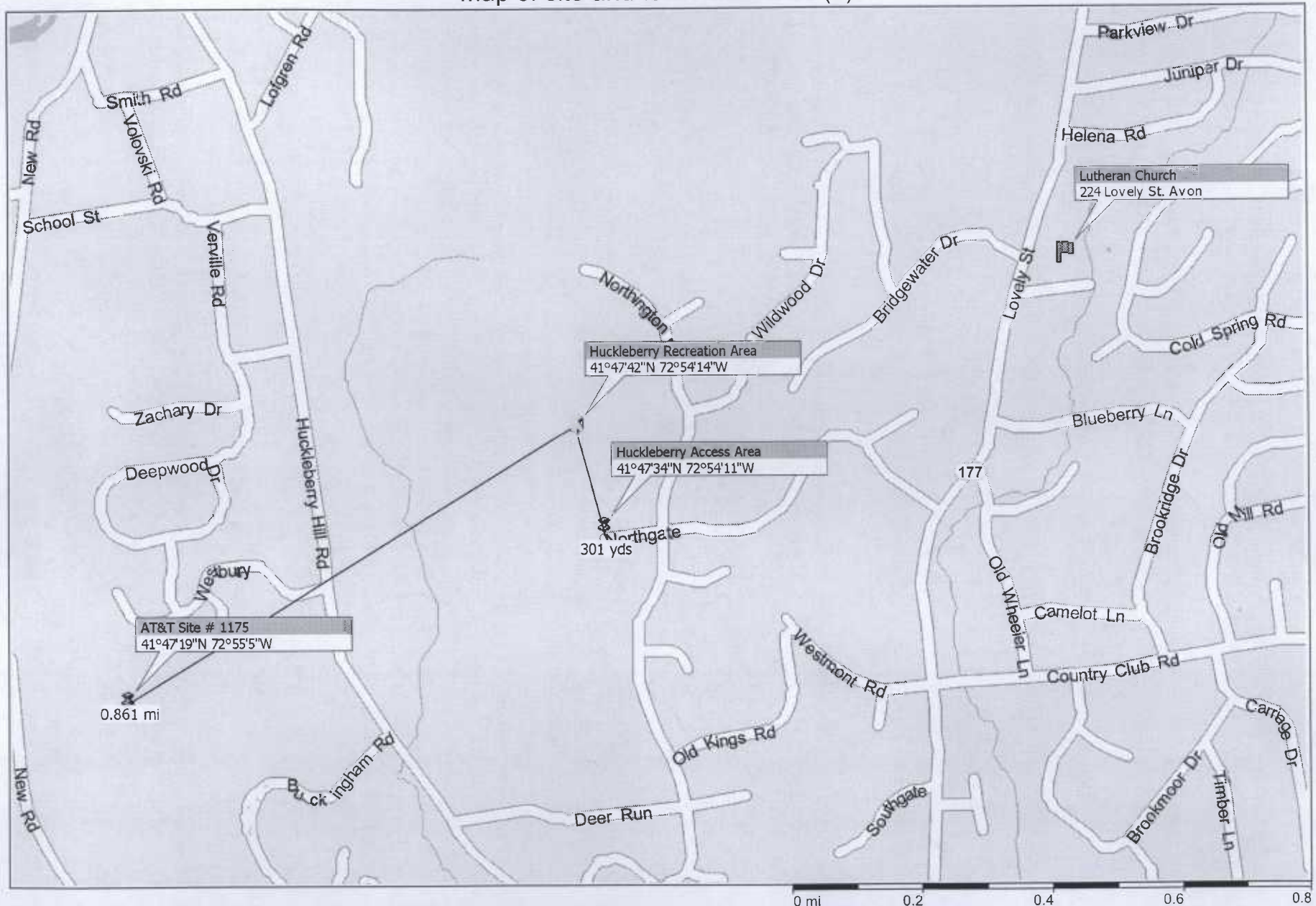

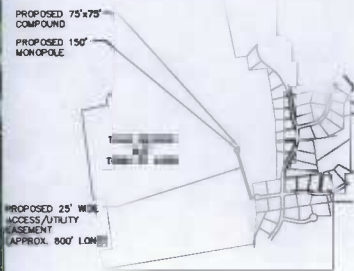

KEY PLAN
SCALE: N.T.S.



500 HARTFORD DR.
ROCKY HILL, CT 06067



151 COCKSCOCK LANE
133-210C 20 NORTH SHERBORN CT
LANDOVER, MA 01945 FAX: (978) 334-3543

PROJECT NO: CT1257 (SR2013)

DRAWN BY: RH

CHECKED BY: AT

SUBMITTALS	

THIS DOCUMENT IS THE CREATION, DESIGN, PROPERTY AND COPYRIGHTED WORK OF AT&T. ANY DUPLICATION OR USE WITHOUT EXPRESS WRITTEN CONSENT IS STRICTLY PROHIBITED. EASEMENTS AND USE BY GOVERNMENT AGENCIES FOR THE PURPOSES OF CONDUCTING THEIR LAWFULLY AUTHORIZED REGULATORY AND ADMINISTRATIVE FUNCTIONS IS SPECIFICALLY ALLOWED.

AVON
HUCKLEBERRY RECREATION AREA
AVON, CT 06007

ORTHO PHOTO

SHEET NUMBER

C-4

LOCUS PLAN
SCALE: 1"=100'-0"

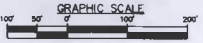

SOURCE:
TOWN OF AVON, CT ASSESSOR MAPS
& TOWN WEBSITE.
AERIAL PHOTOGRAPHY.

Current Coverage plus Huckleberry @ 100'

