

Figure ES-1: The Greater Springfield Reliability Project Potential Routes

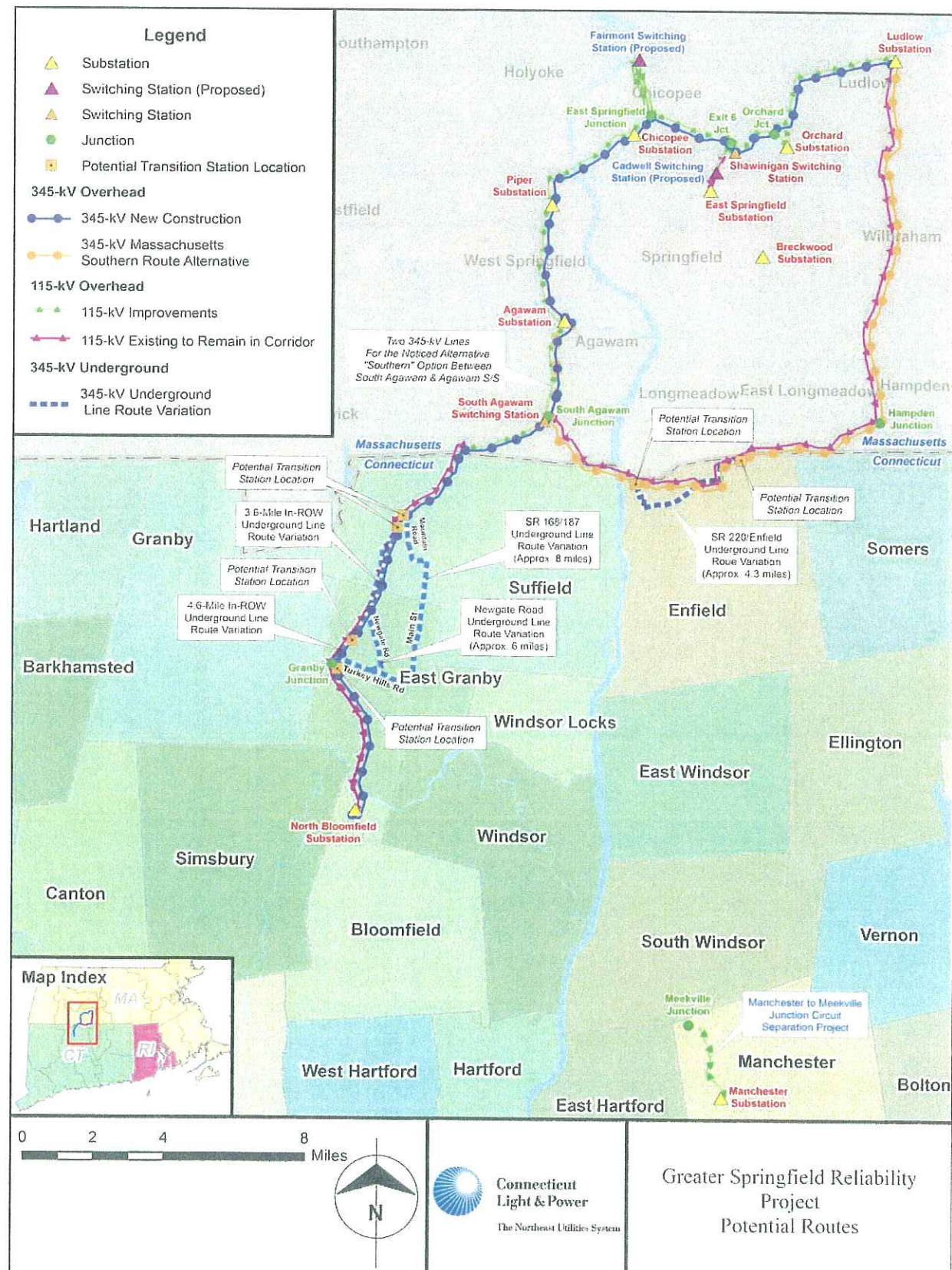

Exhibit CN-1



Figure ES-2: Connecticut Portion of the North Bloomfield to Agawam 345-kV Line Route

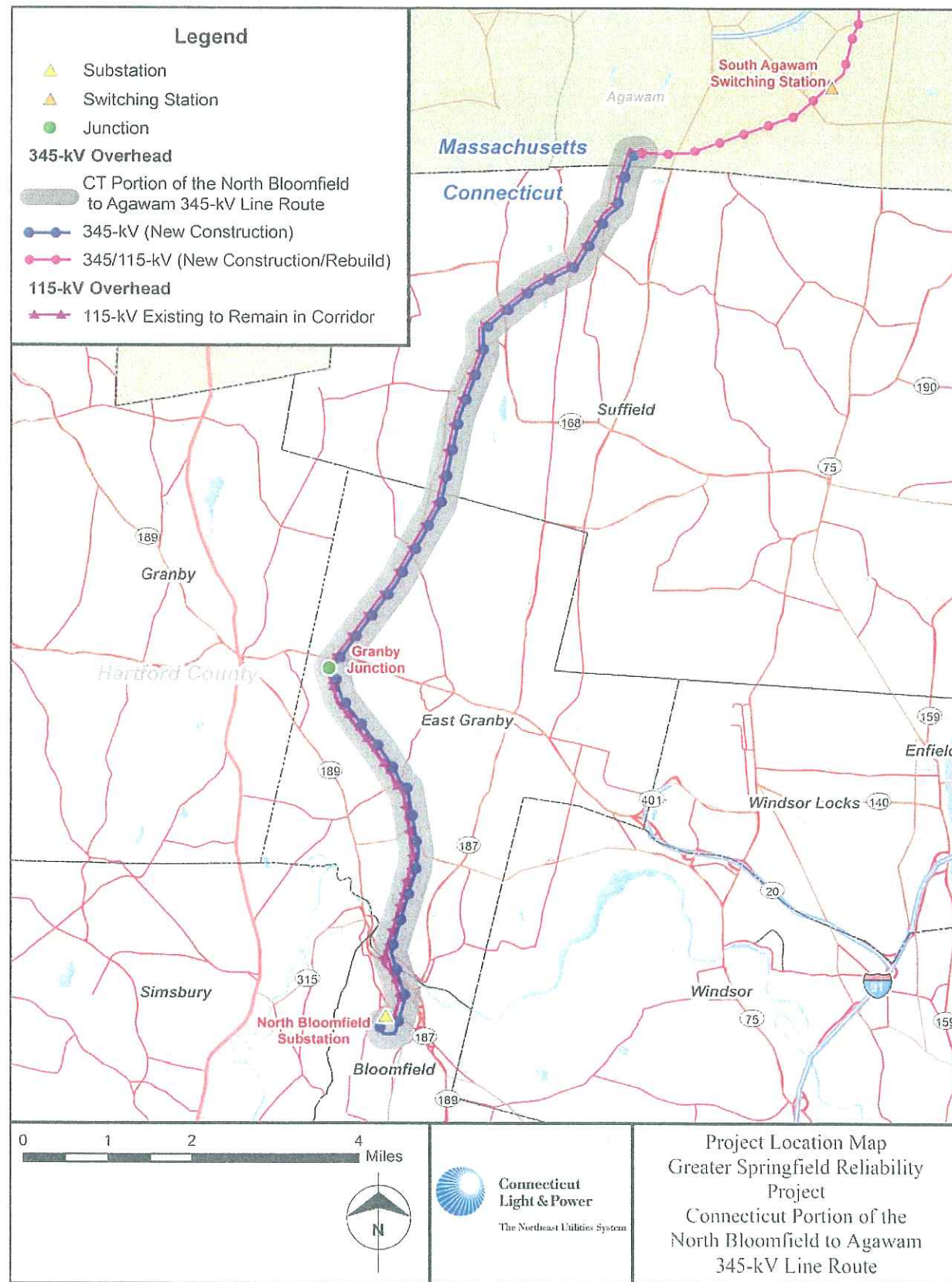

Exhibit CN-2

Figure O-3: Cross-Section XS-1: North Bloomfield Substation to Granby Junction

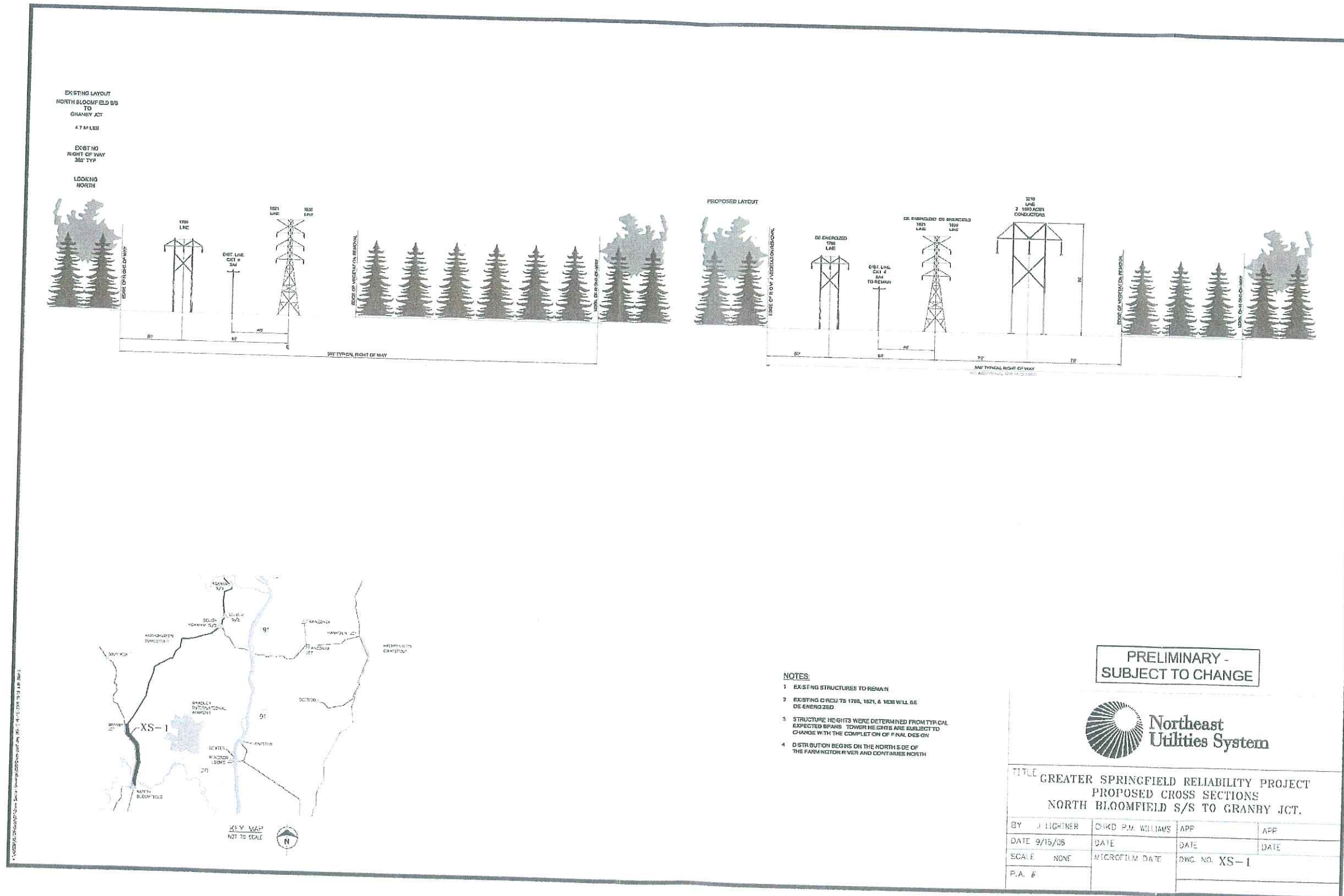



Figure O-5: Cross-Section XS-2: Granby Junction to CT/MA State Border

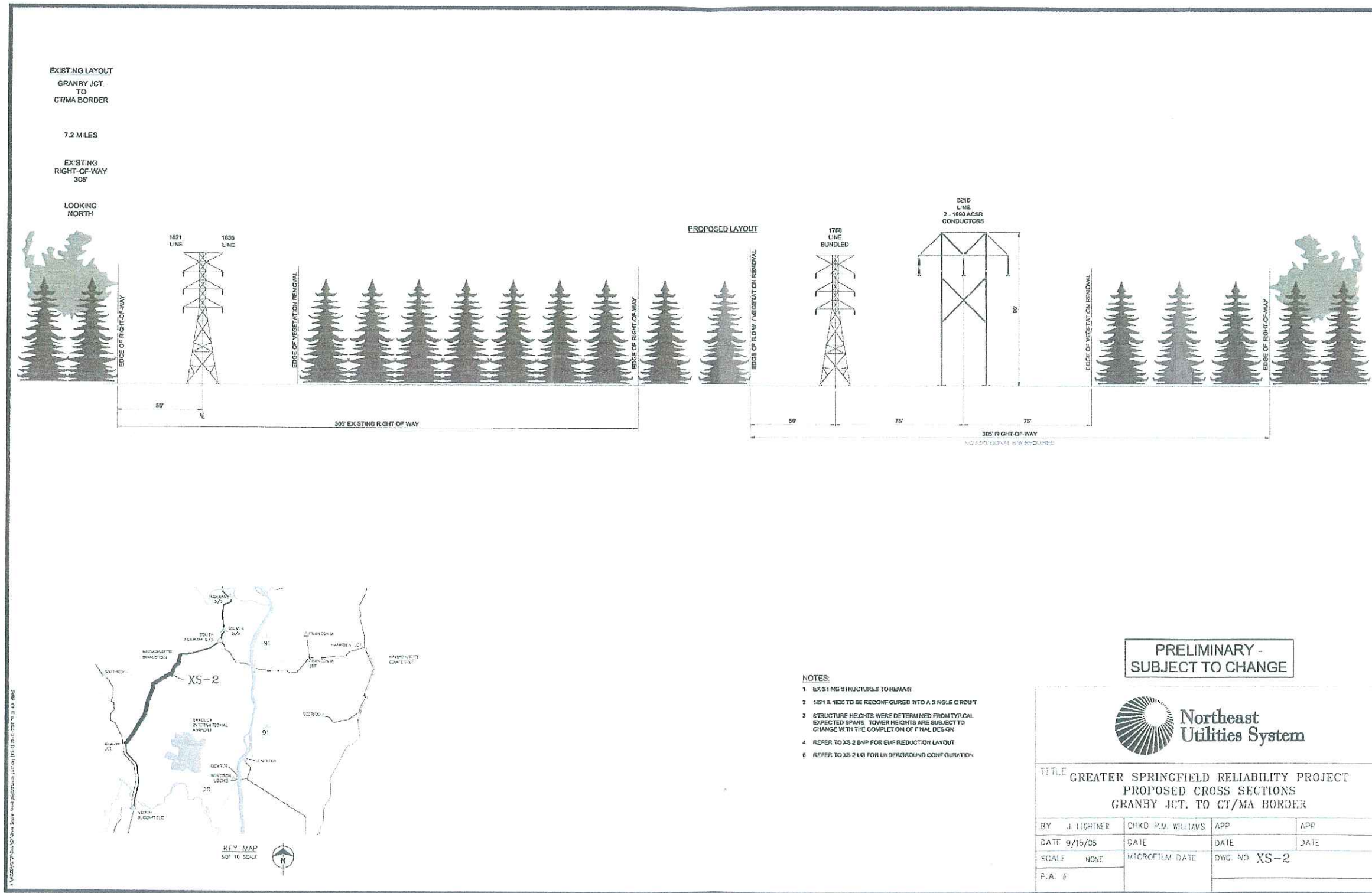
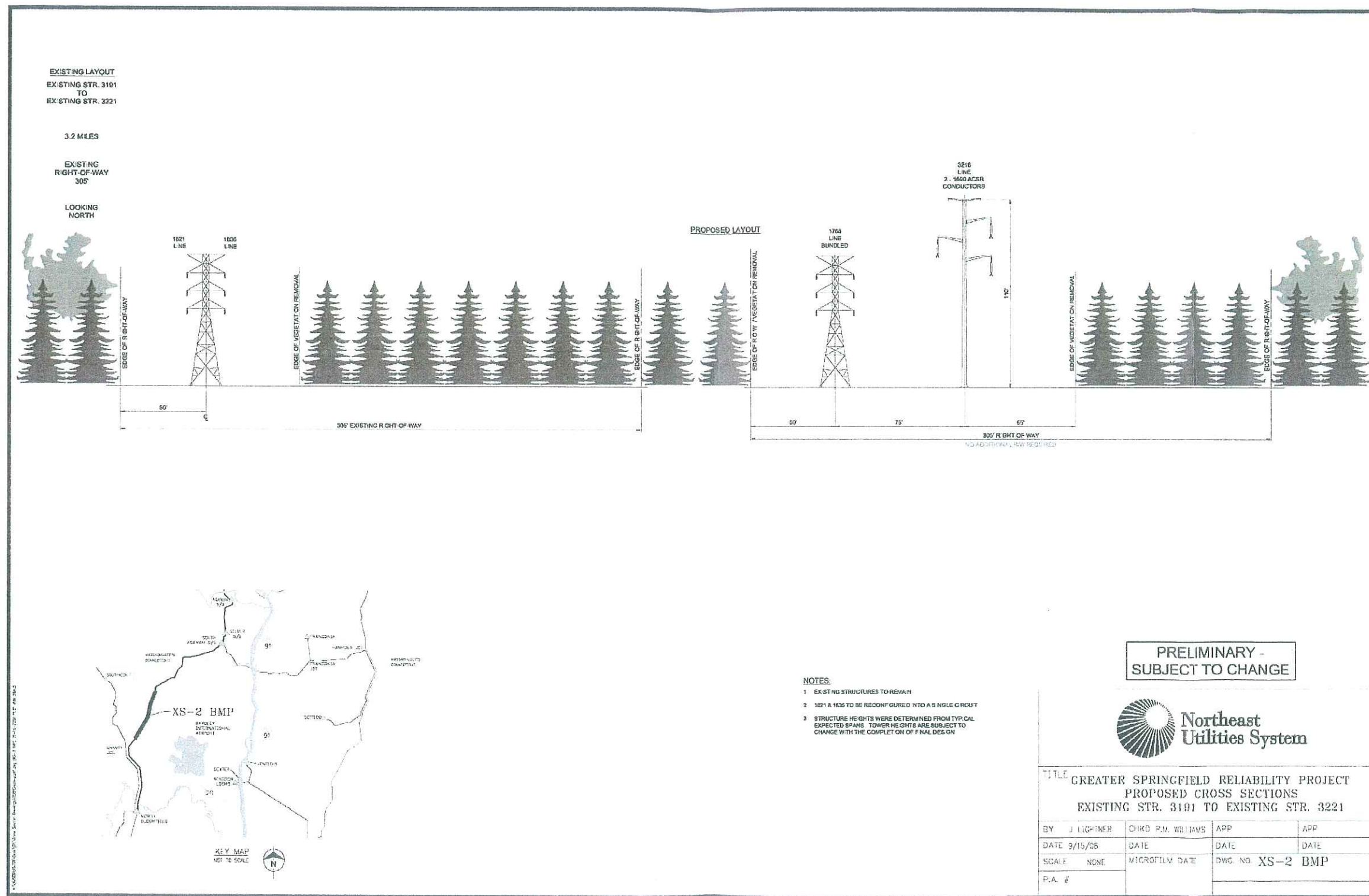

Figure O-7: Cross-Section XS-2: BMP – Existing Str. 3191 to Existing Str. 3221





Greater Springfield Reliability Project  
North Bloomfield Substation to Granby Junction in the Town of Bloomfield  
Transmission Rights-of-Way  
Typical Cross Section XS-1

The existing line structures will remain and a line of new 345-kV H-Frame structures would be installed.

(Existing Transmission Right-of-Way Configuration)



Existing electric transmission line structures looking southwest from State Highway 189, north of North Bloomfield Substation.

(Simulation of the Proposed Transmission Right-of-Way Configuration)



Proposed electric transmission line structures looking southwest from State Highway 189, north of North Bloomfield Substation.