

Daniel F. Caruso
Chairman

STATE OF CONNECTICUT

CONNECTICUT SITING COUNCIL

Ten Franklin Square, New Britain, CT 06051

Phone: (860) 827-2935 Fax: (860) 827-2950

E-Mail: siting.council@ct.gov

Internet: ct.gov/csc

February 1, 2008

TO: Council Members

FROM: S. Derek Phelps, Executive Director

RE: **DOCKET NO. 350** - Cellco Partnership d/b/a Verizon Wireless application for a Certificate of Environmental Compatibility and Public Need for the construction, maintenance and operation of a telecommunications facility located off Old Turnpike Road and Route 198, Woodstock, Connecticut.



The Connecticut Siting Council has scheduled a field review for this docket for Thursday, February 7, 2008, beginning at 2:00 p.m. Council members will meet at the proposed site located on Route 198, adjacent to the applicant's sign. Parking on Windswept Drive (off of Route 198) is suggested as Route 198 is busy and has limited space to park. Boots are suggested.

A public hearing is scheduled for Thursday, February 7, 2008, beginning at 3:00 p.m., and continued at 7:00 p.m., at the Woodstock Town Hall, Room 1, 415 Route 169, Woodstock, Connecticut.

SDP/MP

c: Robert L. Marconi, Assistant Attorney General
Secretary of the State
Parties & Intervenors
Ruth Girolomo, Post Reporting Services
Joseph Reese, Tech Theatrical Services, LLC
Lisa Fontaine, CSC



CONNECTICUT SITING COUNCIL
Affirmative Action / Equal Opportunity Employer

DIRECTIONS - DOCKET 350 - WOODSTOCK

Proposed Site: Route 198 (approx. 1,500 feet north of Old Turnpike Road)
Woodstock, Connecticut

Field Review Location: Route 198 (approx. 1,500 feet north of Old Turnpike Road)
Woodstock, Connecticut

Hearing Location: Woodstock Town Hall
415 Route 169
Woodstock, Connecticut
3:00 pm and 7:00 pm

Suggested Dinner Location: The Courthouse Bar & Grille
121 Main Street
Putnam, Connecticut

TO FIELD REVIEW – Route 198, Woodstock

From Northwest Connecticut (Norfolk area):

Take Route 44 East to Interstate 84 East.
Proceed on I-84 East.
Take Exit 73 (Route 190) off of I-84 East.
Turn right onto Buckley Highway (Route 190).
Proceed on Route 190 for about 1.9 miles.
Turn right onto Bigelow Hollow Road (Route 171).
Proceed on Route 171 for about 2.2 miles.
Continue straight onto Lawson Road (Route 197).
Proceed on Route 197 for about 1.8 miles.
Turn right onto Black Pond Road (Route 198).
Proceed on Route 198 for about 0.7 miles.
The site and the applicant's sign are on the left side.
Route 198 is narrow with limited space for parking.
Parking on Windswept Drive (ahead on the right) is suggested.

Via I-395 from points east of I-395 (Stonington area):

Take Interstate 95 South to I-395 North.
Proceed on I-395 North.
Take Exit 95 off of I-395 North.
Turn right on the end of the ramp onto Kennedy Drive.
Proceed straight on Kennedy Drive for roughly two miles.
Turn left onto Bridge Street. (It's a bridge that crosses the Quinebaug River.)
Proceed straight onto Woodstock Avenue (Route 171).
Continue on Route 171 to the Woodstock Town Line.
Continue on Route 171 for about 1.3 miles.
Continue straight onto Route 169 / 171.

Turn left onto Route 171 Somers Turnpike.
Continue on Route 171 for approximately 6.7 miles.
Turn right onto Route 198 (Black Pond Road).
The site and the applicant's sign are approximately 2.4 miles ahead on the right.
Route 198 is narrow with limited space for parking.
Parking on Windswept Drive (just before the site, on the left) is suggested.

Via I-395 from points west of I-395 (Milford, Fairfield area):

Take I-95 North to Exit 76 (I-395 North).
Proceed on I-395 North.
Take Exit 95 off of I-395 North.
Turn right on the end of the ramp onto Kennedy Drive.
Proceed straight on Kennedy Drive for roughly two miles.
Turn left onto Bridge Street. (It's a bridge that crosses the Quinebaug River.)
Proceed straight onto Woodstock Avenue (Route 171).
Continue on Route 171 to the Woodstock Town Line.
Continue on Route 171 for about 1.3 miles.
Continue straight onto Route 169 / 171.
Turn left onto Route 171 Somers Turnpike.
Continue on Route 171 for approximately 6.7 miles.
Turn right onto Route 198 (Black Pond Road).
The site and the applicant's sign are approximately 2.4 miles ahead on the right.
Route 198 is narrow with limited space for parking.
Parking on Windswept Drive (just before the site, on the left) is suggested.

From Northern Connecticut (Enfield area):

Take Interstate 91 South to I-84 East
Proceed on I-84 East.
Take Exit 73 (Route 190) off of I-84 East.
Turn right onto Buckley Highway (Route 190).
Proceed on Route 190 for about 1.9 miles.
Turn right onto Bigelow Hollow Road (Route 171).
Proceed on Route 171 for about 2.2 miles.
Continue straight onto Lawson Road (Route 197).
Proceed on Route 197 for about 1.8 miles.
Turn right onto Black Pond Road (Route 198).
Proceed on Route 198 for about 0.7 miles.
The site and the applicant's sign are on the left side.
Route 198 is narrow with limited space for parking.
Parking on Windswept Drive (ahead on the right) is suggested.

From Northern Connecticut (Enfield area) Alternate Route:

Take Route 190 West.
Proceed on Route 190 West for about 22 miles.
Turn right onto Route 171 (Bigelow Hollow Road) in Union.
Proceed on Route 171 for about 2.2 miles.
Continue straight onto Lawson Road (Route 197).

Proceed on Route 197 for about 1.8 miles.
Turn right onto Black Pond Road (Route 198).
Proceed on Route 198 for about 0.7 miles.
The site and the applicant's sign are on the left side.
Route 198 is narrow with limited space for parking.
Parking on Windswept Drive (ahead on the right) is suggested.

Via Interstate 84:

Proceed on I-84 East.
Take Exit 73 (Route 190) off of I-84 East.
Turn right onto Buckley Highway (Route 190).
Proceed on Route 190 for about 1.9 miles.
Turn right onto Bigelow Hollow Road (Route 171).
Proceed on Route 171 for about 2.2 miles.
Continue straight onto Lawson Road (Route 197).
Proceed on Route 197 for about 1.8 miles.
Turn right onto Black Pond Road (Route 198).
Proceed on Route 198 for about 0.7 miles.
The site and the applicant's sign are on the left side.
Route 198 is narrow with limited space for parking.
Parking on Windswept Drive (ahead on the right) is suggested.

**TO HEARING LOCATION – Woodstock Town Hall
Room 1
415 Route 169 (Norwich-Worcester Turnpike)
Woodstock, Connecticut**

From Site

Proceed south on Route 198 (Black Pond Road) passing by Old Turnpike Road.
Continue straight on Route 198 for about 2.4 miles.
Take a sharp left onto Somers Turnpike (Route 171).
Follow Route 171 (approx. 6.7 miles) until it intersects Route 169.
Turn left onto Route 169 (Norwich-Worcester Turnpike).
Proceed on Route 169 for about 0.7 miles.
The Woodstock Town Hall is on the right located at 415 Route 169.

Via Interstate 395 North or South

Proceed on I-395 North or South.
Take Exit 95 off of I-395.
Turn right on the end of the ramp onto Kennedy Drive.
Proceed straight on Kennedy Drive for roughly two miles.
Turn left onto Bridge Street. (It's a bridge that crosses the Quinebaug River.)

Proceed straight onto Woodstock Avenue (Route 171).
Continue on Route 171 to the Woodstock Town Line.
Continue on Route 171 for about 1.3 miles.
Continue straight onto Route 169 / 171.
Continue straight onto Route 169 (Norwich-Worcester Turnpike).
The hearing location is about 0.7 miles ahead on the right, located at 415 Route 169.

**TO: The Courthouse Bar & Grille – 121 Main Street, Putnam
From Hearing Location (Woodstock Town Hall)**

Turn left (south) onto Norwich-Worcester Turnpike (Route 169).
Proceed about 0.7 miles on Route 169.
Continue straight onto Route 169 / 171.
Continue straight / slight left onto Route 171 for about 2.7 miles.
Route 171 becomes Bridge Street.
Cross Quinebaug River via Bridge Street (Route 171).
Take first right onto Kennedy Drive.
Proceed on Kennedy Drive for about 0.1 miles.
Turn left onto Bundy Street.
Take slight right onto Main Street.
The Courthouse Bar & Grille Restaurant is located at 121 Main Street, Putnam.

MAP KEY:

Yellow – Directions to Site
Orange – Directions from Site to Hearing Location
Green – Directions from Hearing Location to Restaurant

Thompson

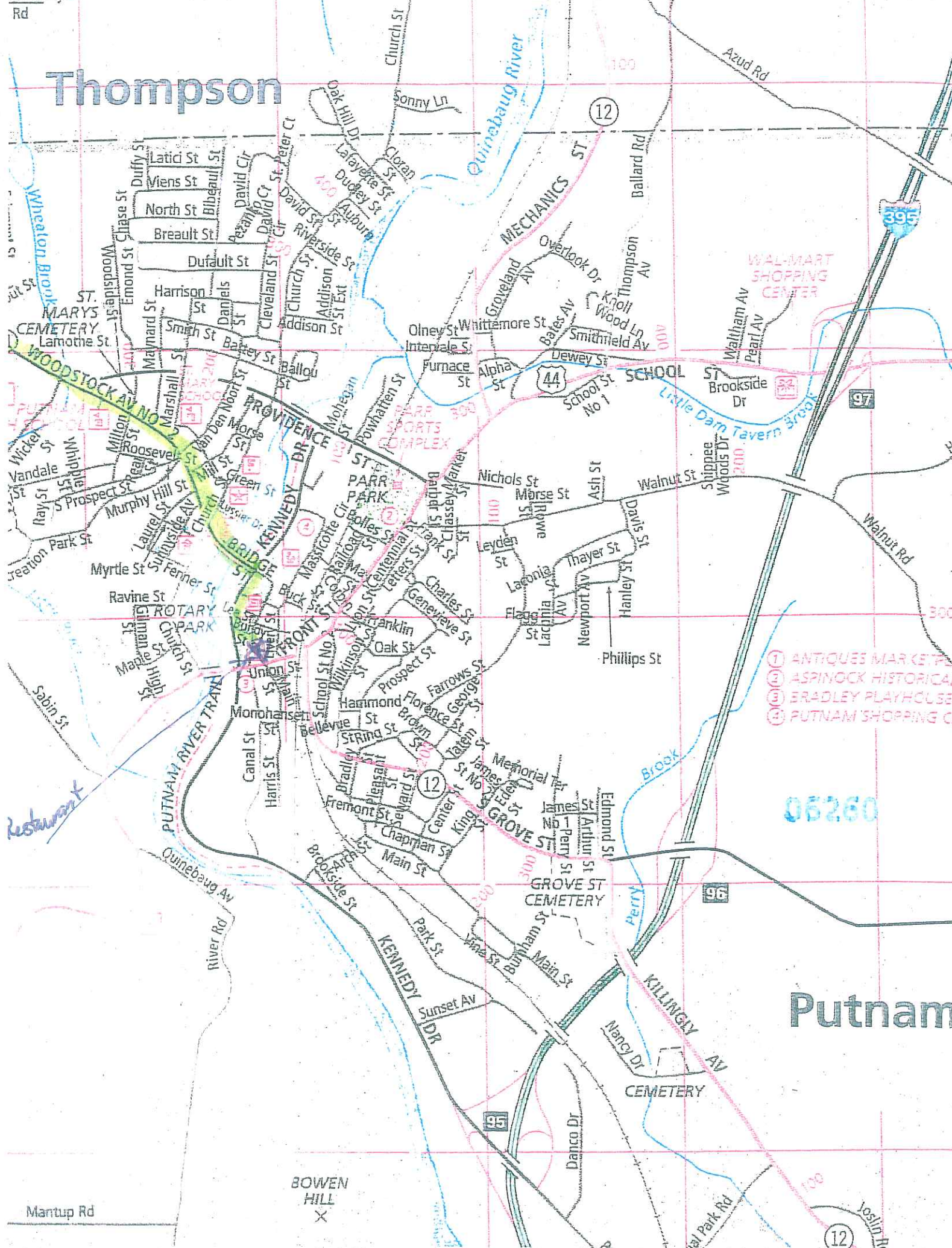

- ① ANTIQUES MARKET
- ② ASPINOCK HISTORICAL
- ③ BRADLEY PLAYHOUSE
- ④ PUTNAM SHOPPING C

05260

Putnam

BOWEN HILL

Mantup Rd

12

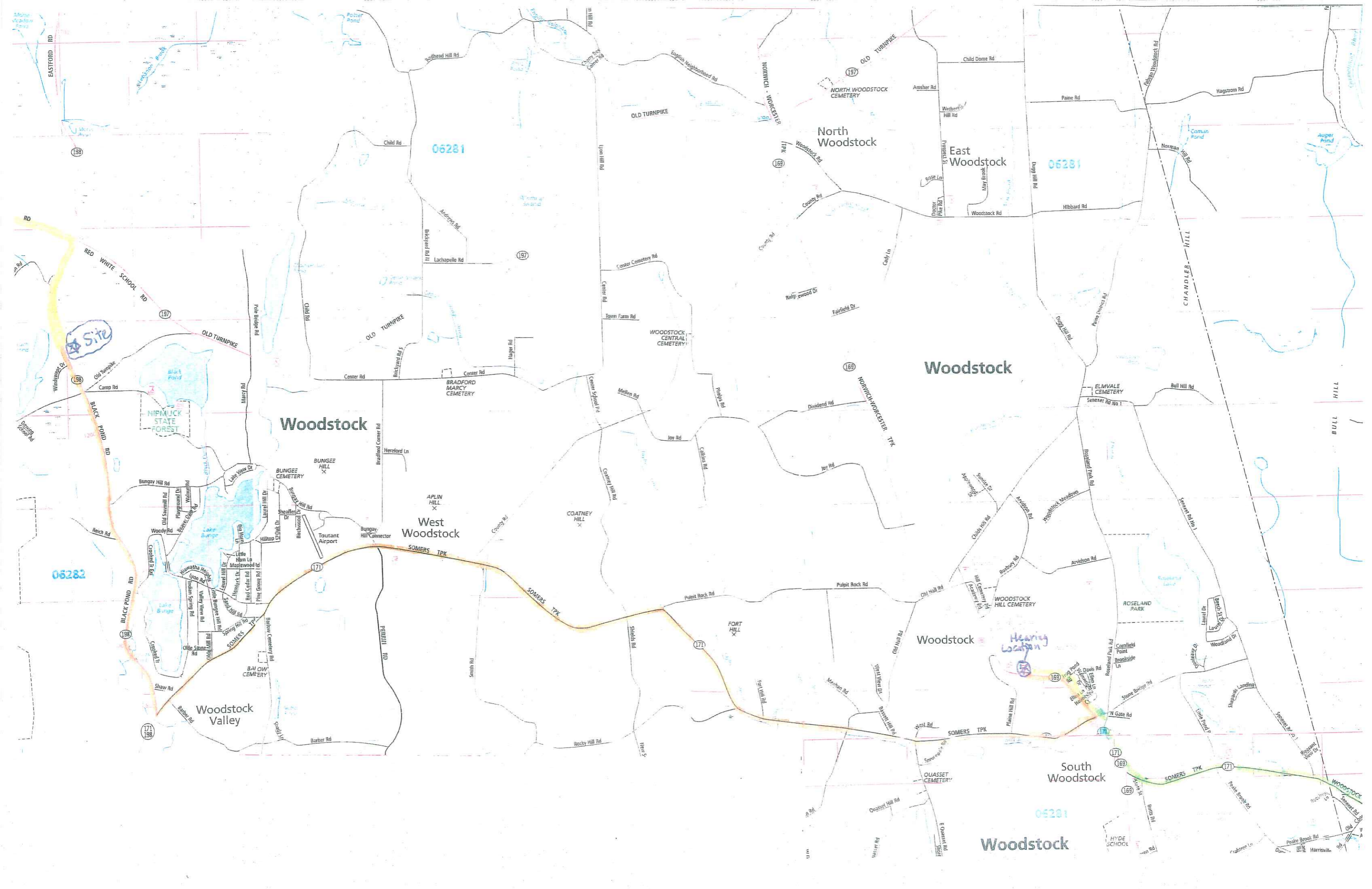

06281

06281

06282

06291

North Woodstock

East Woodstock

Woodstock

Woodstock

West Woodstock

Woodstock

South Woodstock

Woodstock

Site

Hearing Location

