

\\vhb\gis\proj\Wethersfield\42569.00\Project\Misc\PhotoMap\_Oct2020\_Update.mxd



**Gravel Pit Solar**

**East Windsor, Connecticut**

- |                               |                                     |                       |
|-------------------------------|-------------------------------------|-----------------------|
| Property Boundary             | Wetland Resource Areas              | Solar Array           |
| Adjacent Parcels              | Delineated Wetland Edge             | Equipment Pad         |
| Town Boundary                 | Vernal Pool                         | Substation            |
| Approximate Eversource ROW    | Stream/River                        | Boring Pit            |
| Approximate Railroad Boundary | Delineated Intermittent Watercourse | Potential Cable Route |
| Photo Survey Points           | Stormwater Trap                     | Proposed Road         |
| Flag Locations                |                                     | Fencing               |

**Photo Location Figure**

Source: VHB, CTDEEP, ESRI



Photo 1  
Site Entrance from Apothecaries Hall Road



Photo 2  
Charboneau Gravel Pit Looking South



Photo 3  
Apothecaries Hall Road Looking West



Photo 4  
Apothecaries Hall Road Looking East



Photo 5  
Stormwater Basin #68



Photo 6  
Stormwater Basin #75



Photo 7  
Stormwater Basin #70



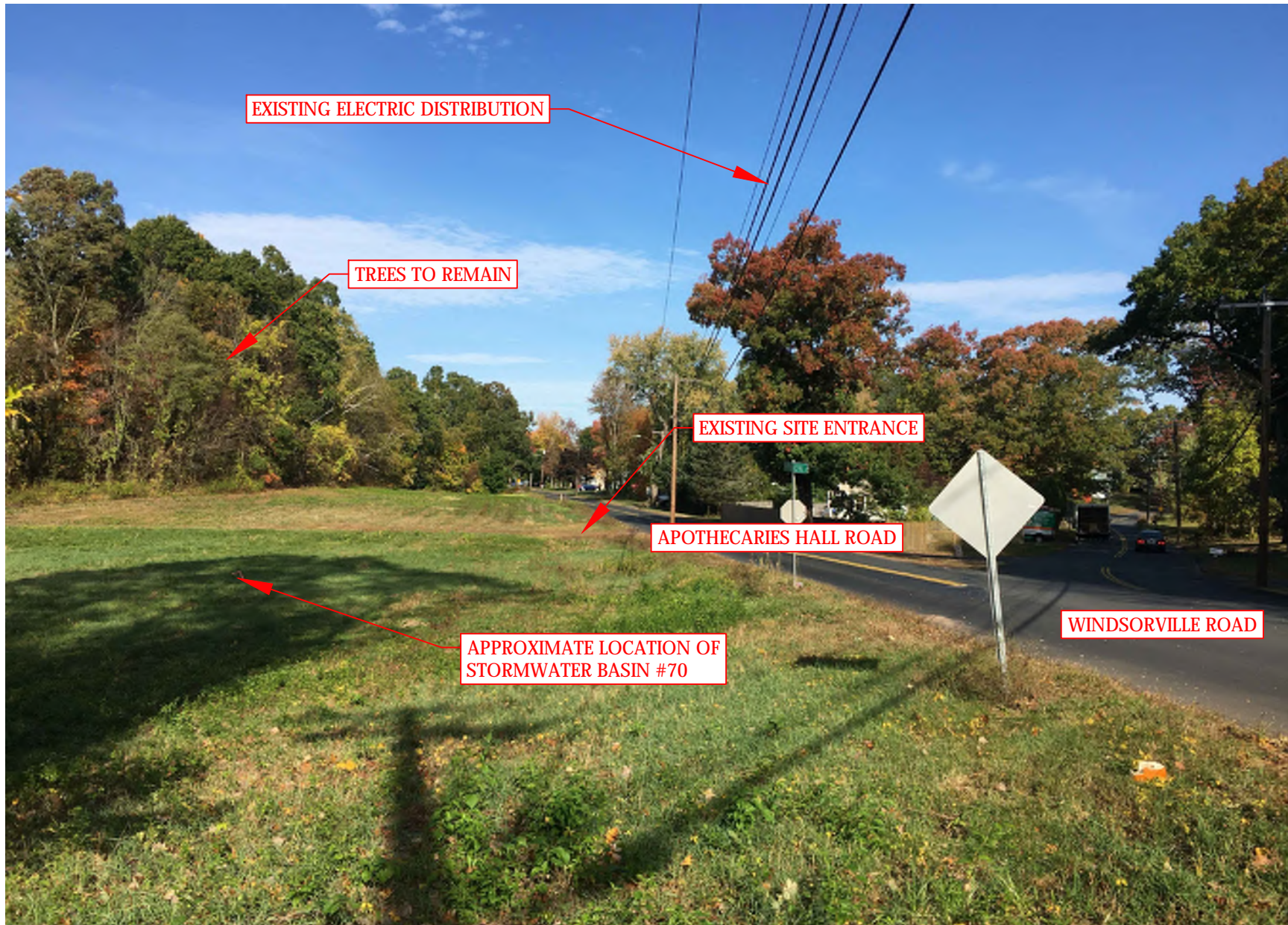

Photo 8  
Stormwater Basin #71



Photo 9  
Windsorville Road Site Entrance



Photo 10  
Proposed Site Gate



PROPOSED LOCATION  
OF SOLAR ARRAY

HUNG FLAG IS APPROXIMATE  
LOCATION OF FENCE GATE

EXISTING SITE ROAD

HUNG FLAG IS APPROXIMATE  
LOCATION OF FENCE

Photo 11  
Proposed Site Gate



**Photo 12**  
**Electrical Substation Gate**

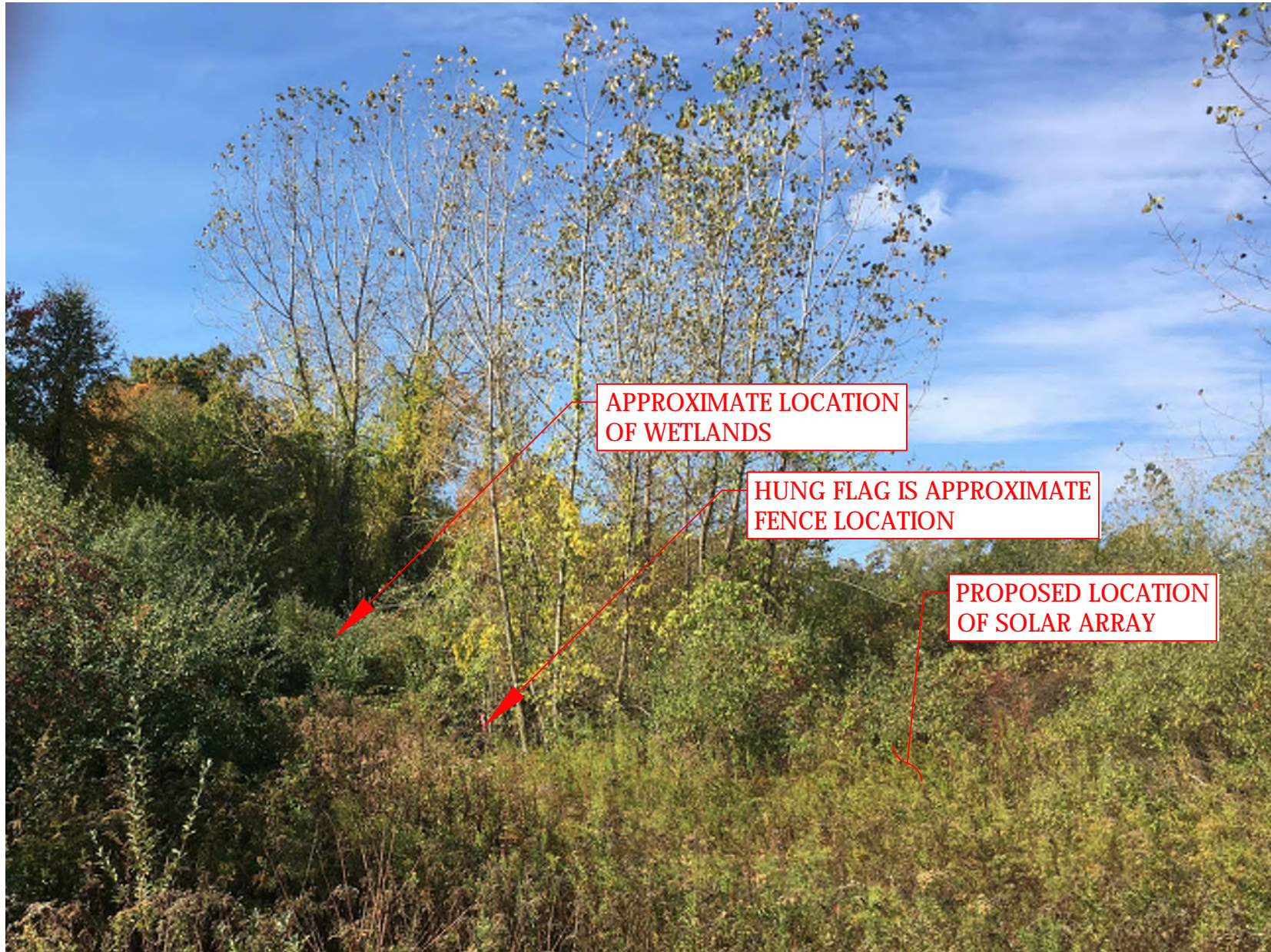

Photo 13  
Existing Wetlands #11



Photo 14  
Stormwater Basin #74



Photo 15  
Ketch Brook Looking South From Basin #74



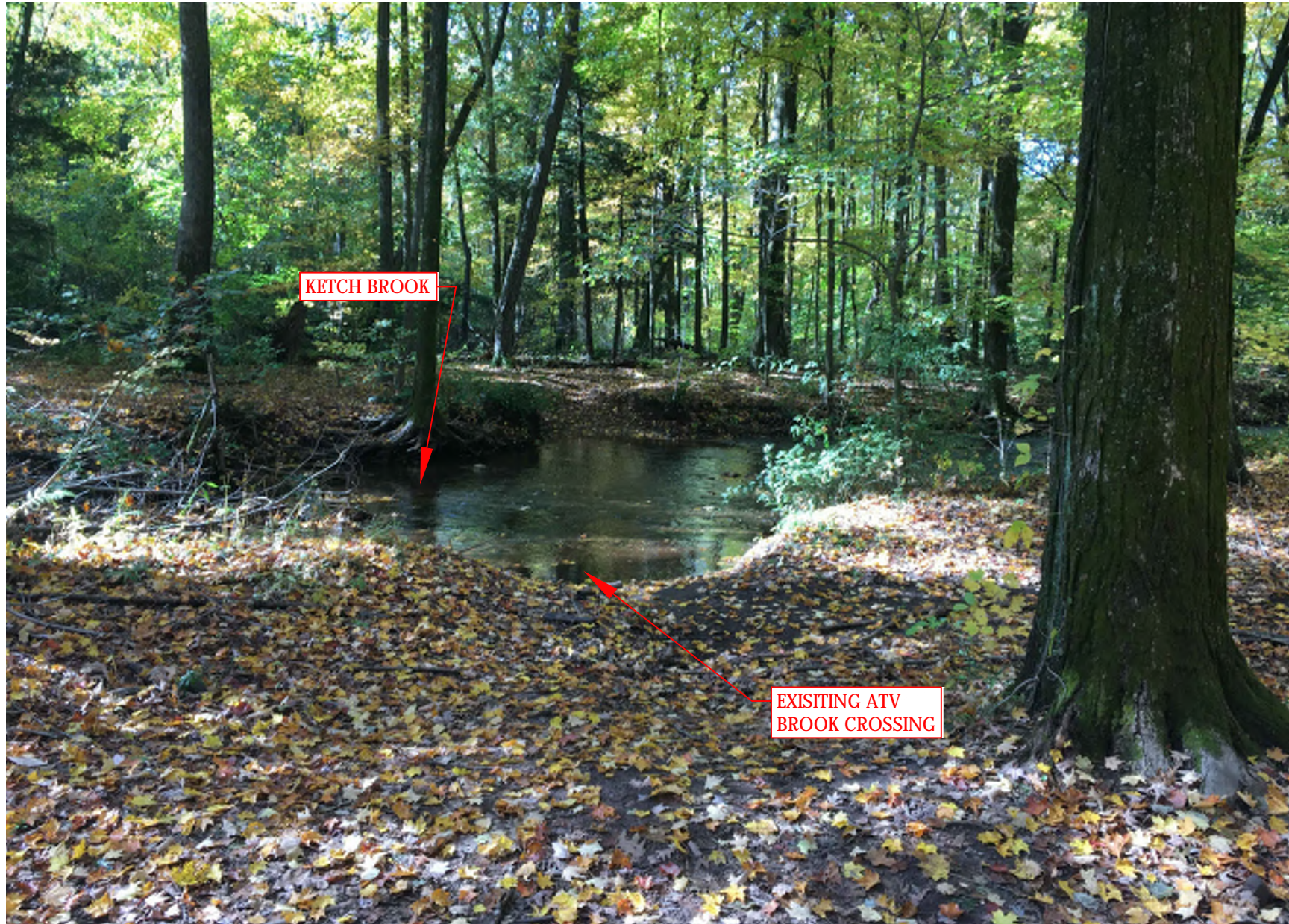

Photo 16  
Exisitng ATV Crossing



Photo 17  
Railroad Track Crossing Wetland #1



Photo 18  
Utility Line Boring Under Railroad Tracks



Photo 19  
Boring Pit and Utility Line



Photo 20  
Stormwater Basin #33



Photo 21  
Property Line Looking East



**Photo 22**  
**Stormwater Basin #3**



Photo 23  
Stormwater Basin #33





Photo 24  
Stormwater Basin #29



Photo 25  
Stormwater Basin #31



Photo 26  
Stormwater Basin #5 and #6



Photo 27  
Stormwater Basin #25



Photo 28  
Stormwater Basin #22

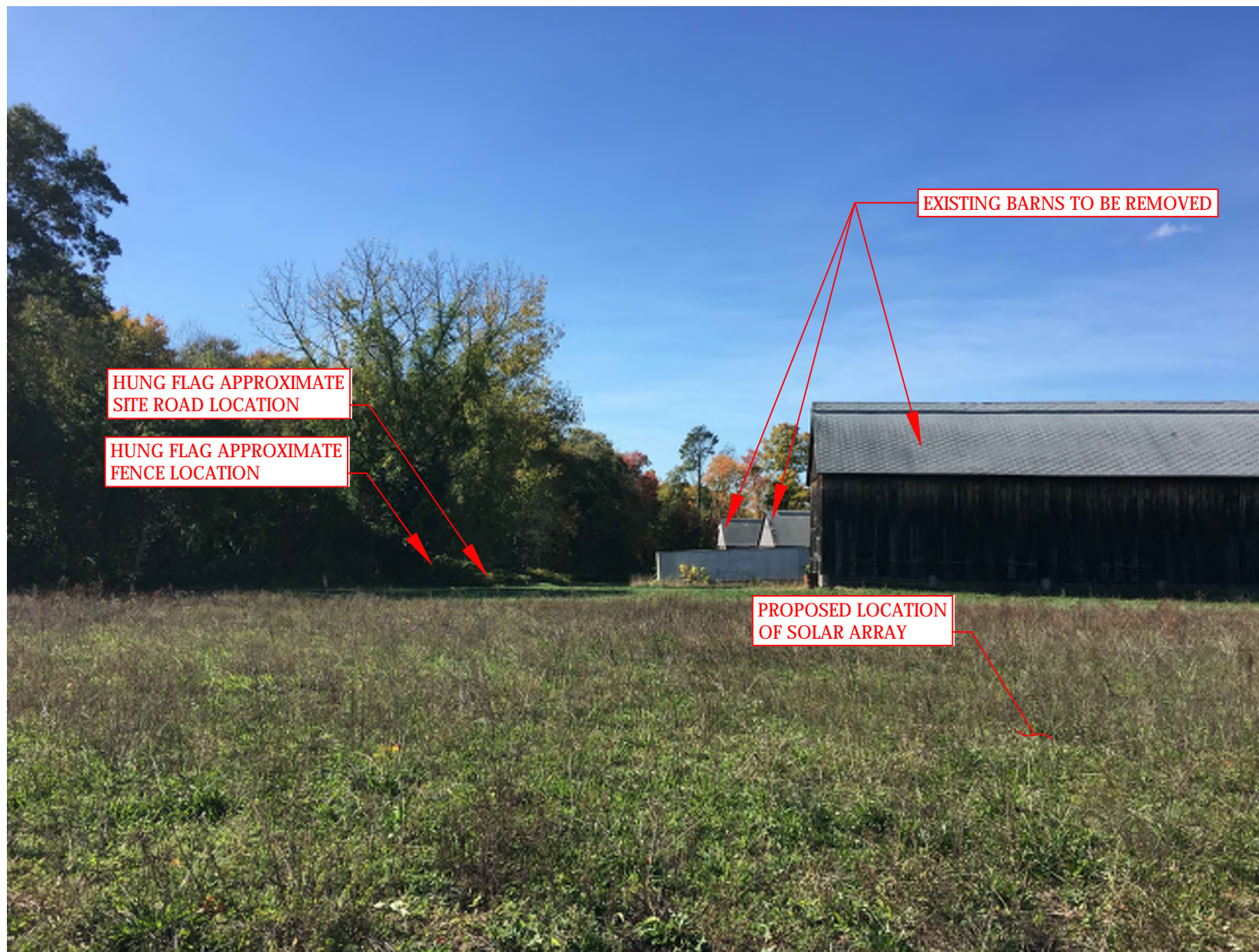

Photo 29  
Site Access Road Looking West



Photo 30  
Existing Roadway Berm



Photo 31  
Stormwater Basin #19





Photo 32  
Stormwater Basin #10



Photo 33  
Plantation Road Site Entrance

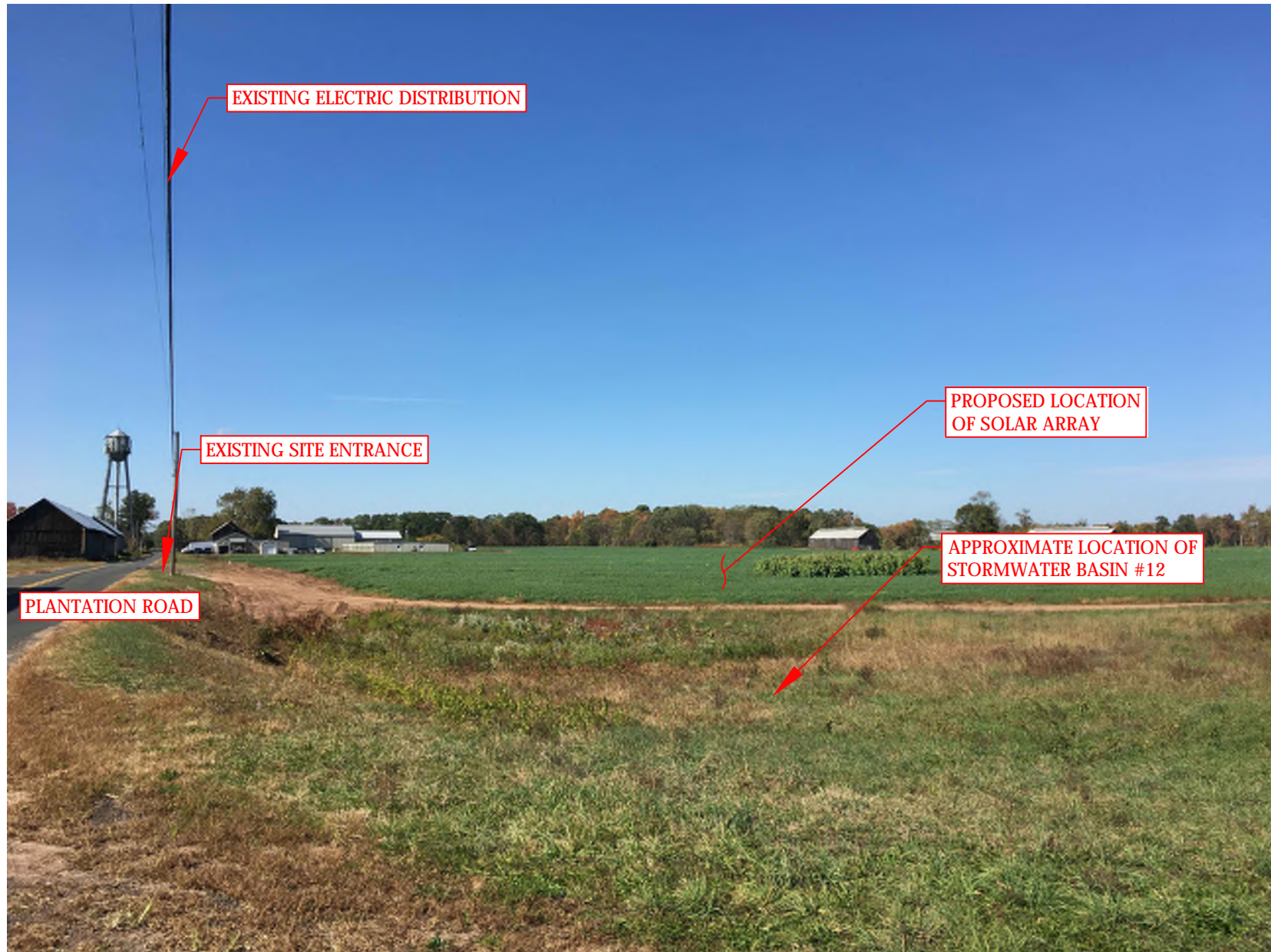

Photo 34  
Stormwater Basin #12



Photo 35  
Plantation Road Site Entrance



Photo 36  
Stormwater Basin #38



Photo 37  
Stormwater Basin #41 and #42



Photo 38  
Windsorville Road Looking South



Photo 39  
Stormwater Basin #46





Photo 40  
Entrance To Valley



Photo 41  
Site Access Road Looking East



Photo 42  
Stormwater Basin #49



Photo 43  
Stormwater Basin #47

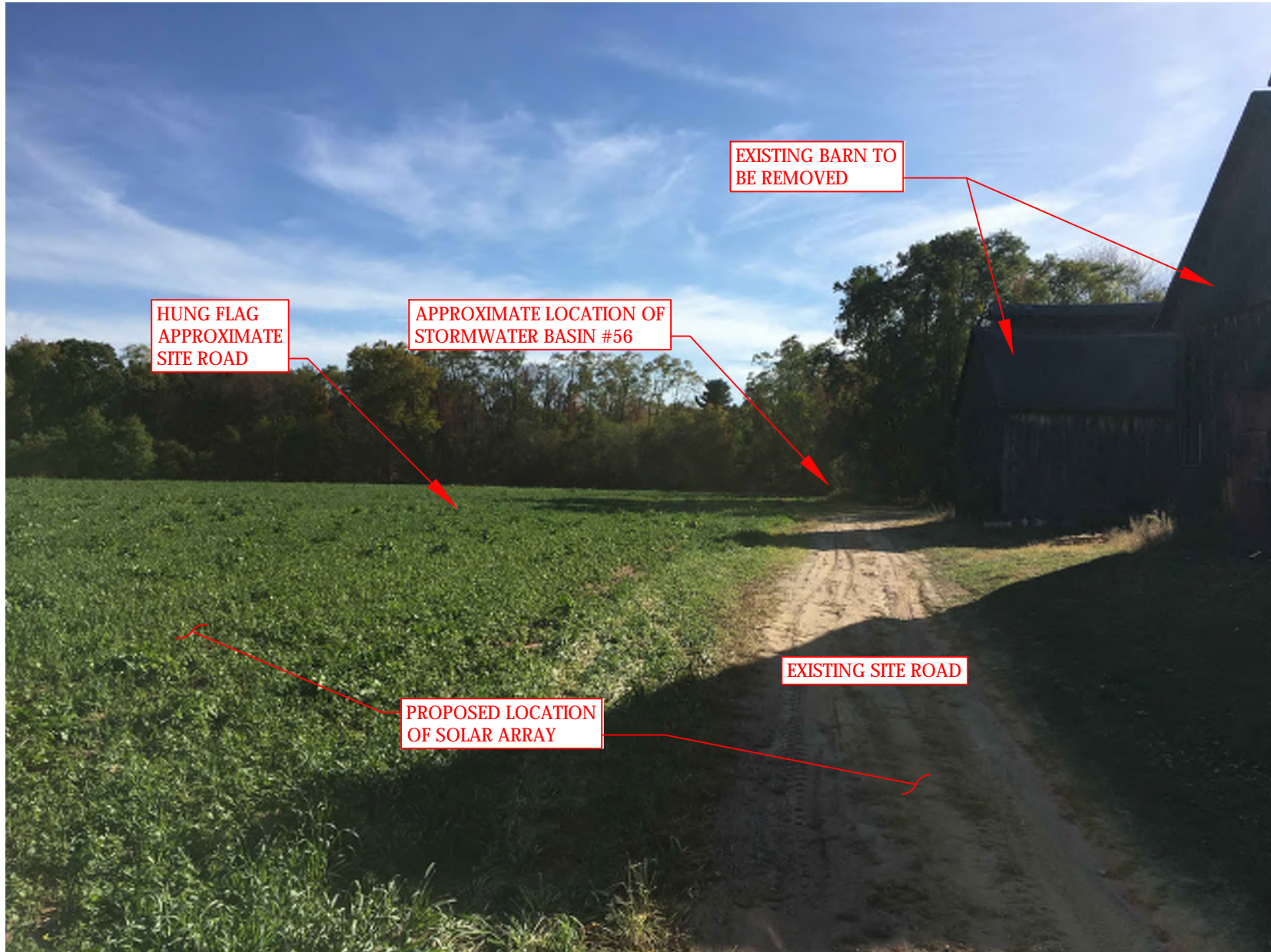

Photo 44  
Stormwater Basin #56



Photo 45  
Stormwater Basin #53



Photo 46  
Stormwater Basin #59



Photo 47  
Site Access Road Looking South





Photo 48  
Stormwater Basin #65 and #66

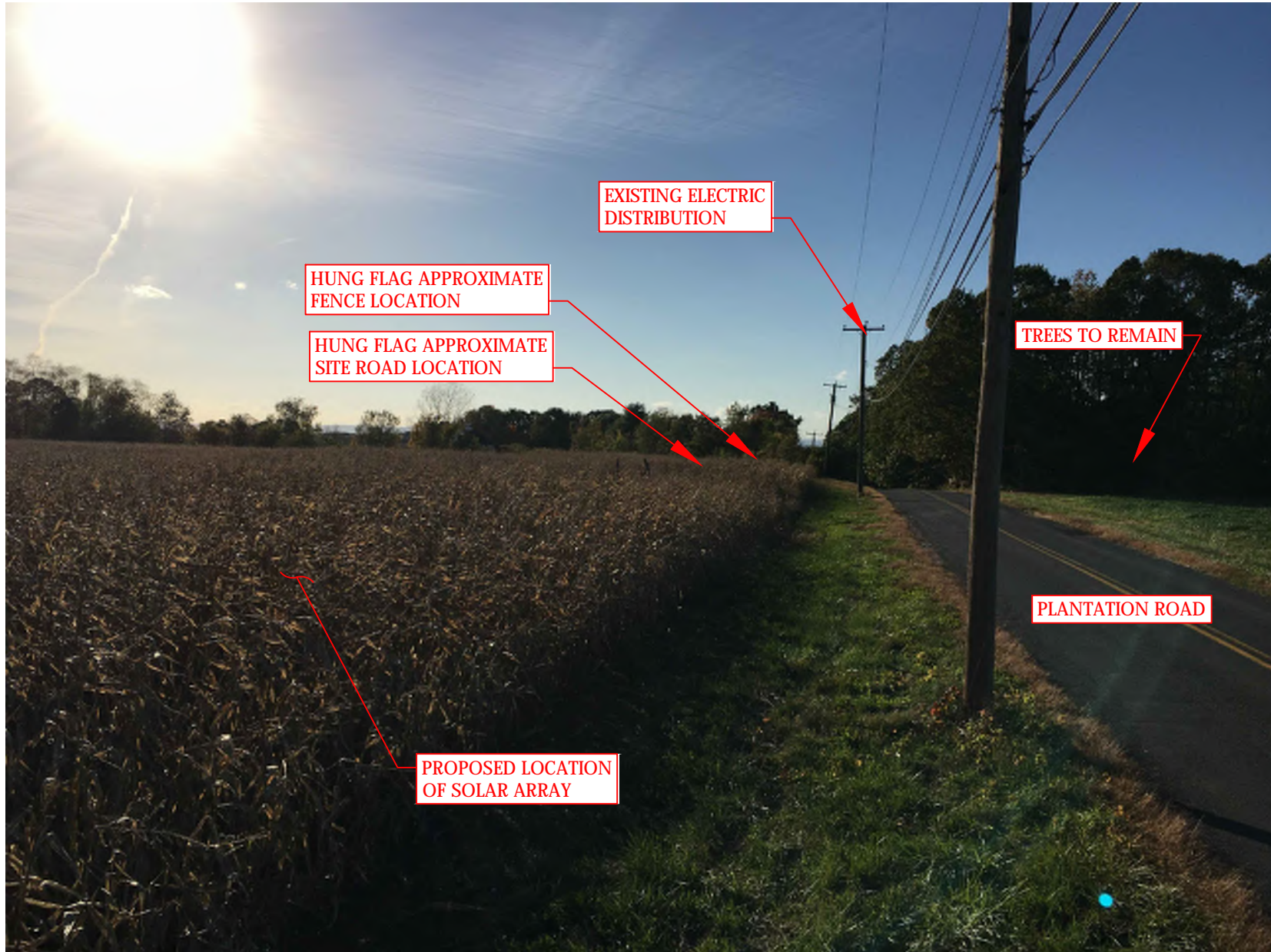

Photo 49  
Stormwater Basin #10



Photo 50  
Stormwater Basin #11



Photo 51  
Stormwater Basin #12

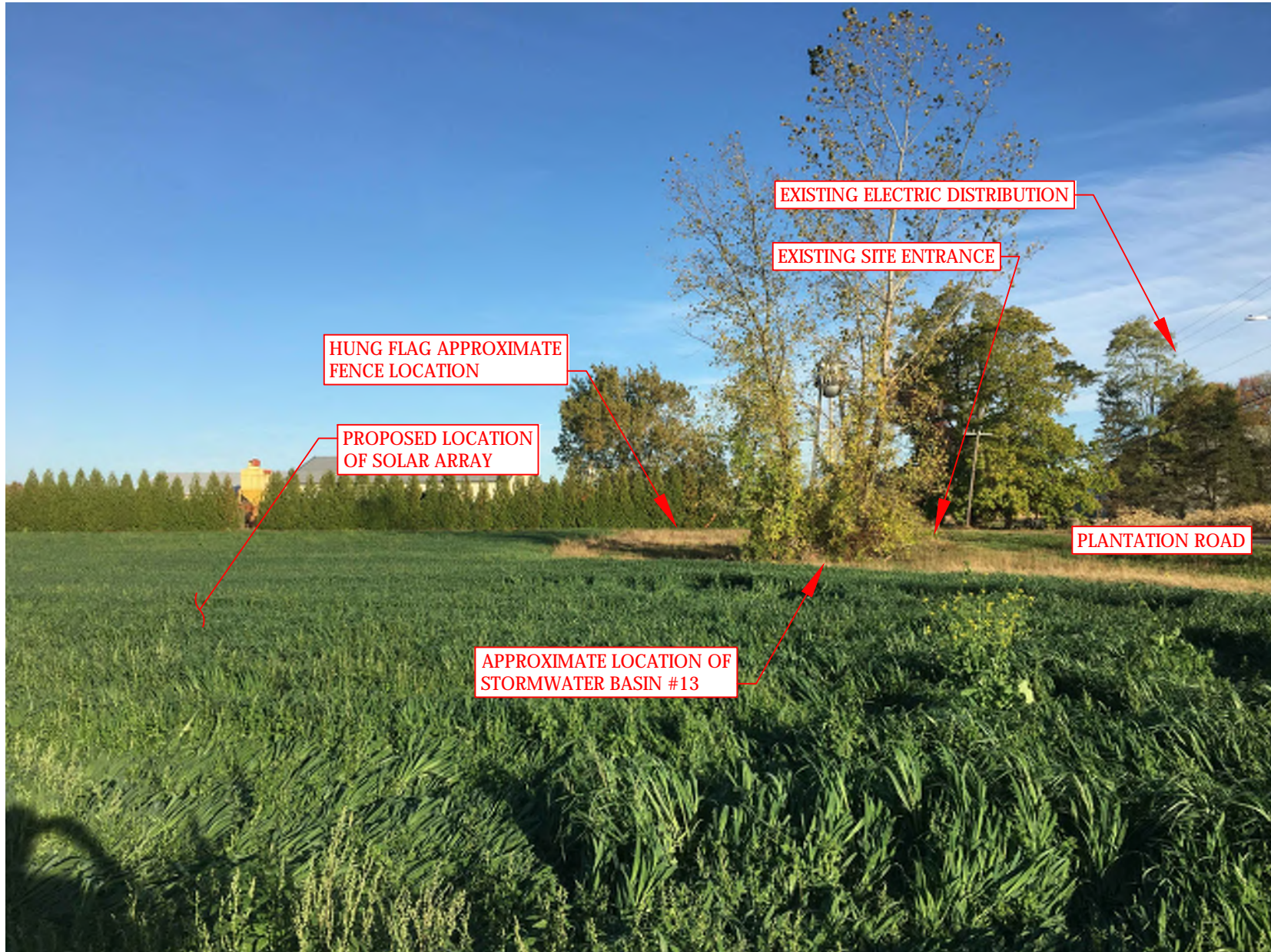

Photo 52  
Stormwater Basin #13