

**LEGEND**

- PROPOSED PAVEMENT
- PROPOSED STRUCTURE
- PROPOSED FILL
- PROPOSED CUT
- EXISTING RIGHT-OF-WAY

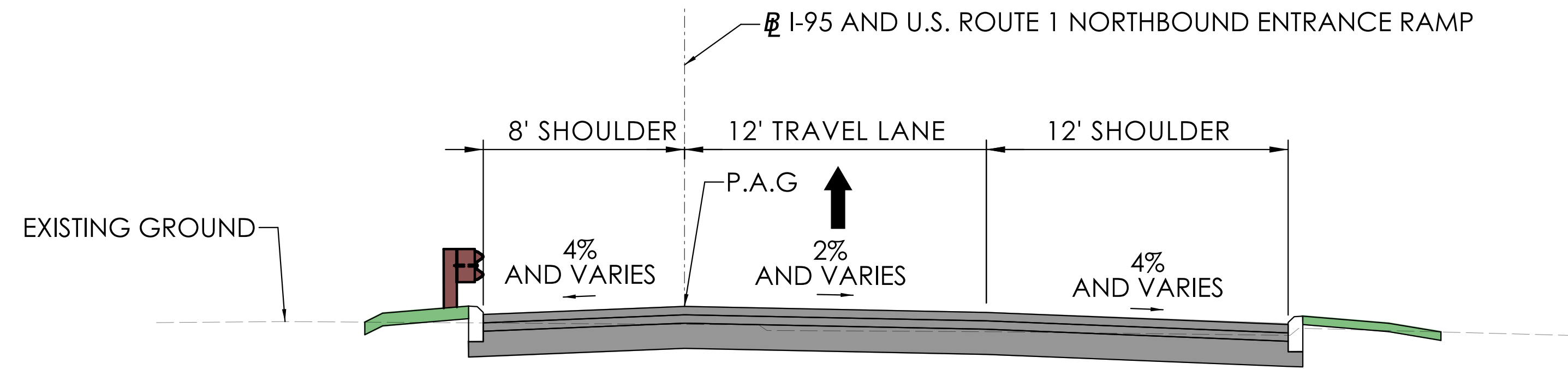

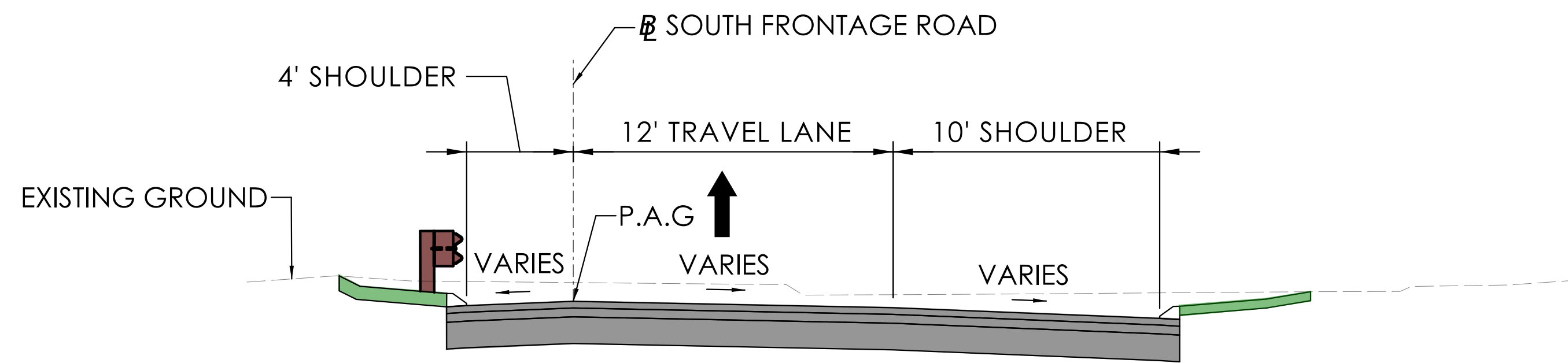

**I-95 AND U.S. ROUTE 1 NORTHBOUND ENTRANCE RAMP  
NOT TO SCALE**



**SOUTH FRONTAGE ROAD  
NOT TO SCALE**

**LEGEND**

-  PROPOSED BITUMINOUS PAVEMENT
-  PROPOSED GUIDE RAIL
-  PROPOSED TOPSOIL AND SEED

**NOTE:**  
SHOULDER AND TRAVEL LANE CROSS SLOPES WILL VARY AT LIMITS OF PROJECT TO MATCH EXISTING ROADWAY CROSS SLOPES.

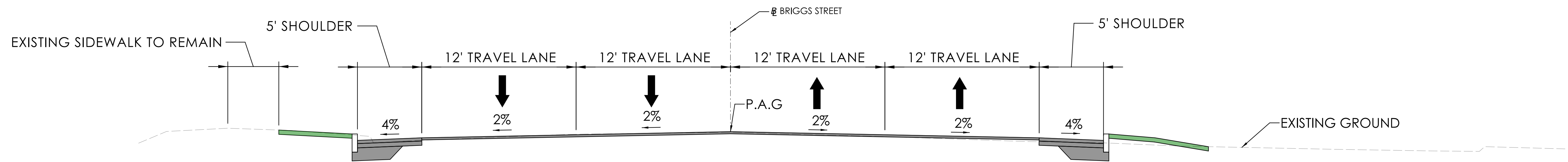

**BRIGGS STREET  
NOT TO SCALE**

REV.	DATE	REVISION DESCRIPTION

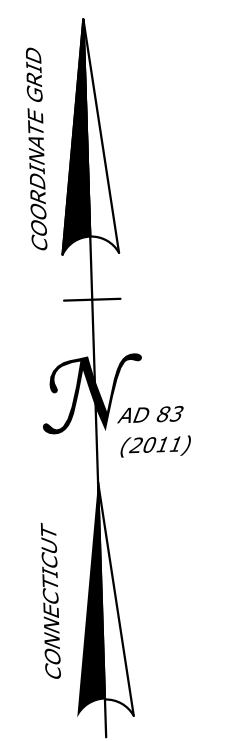

**LEGEND**

- EXISTING STRUCTURE
- PROPOSED STRUCTURE
- PROPOSED PAVEMENT

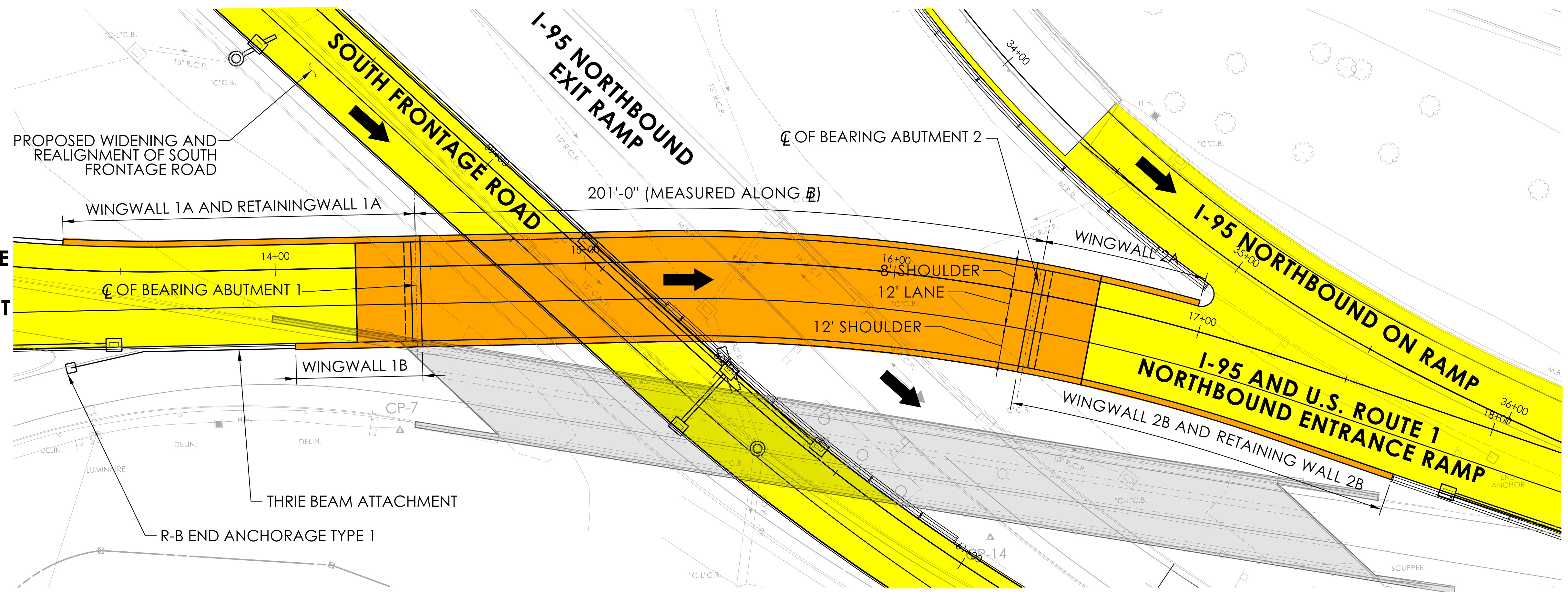

**GENERAL PLAN**

SCALE: 1" = 20'-0"

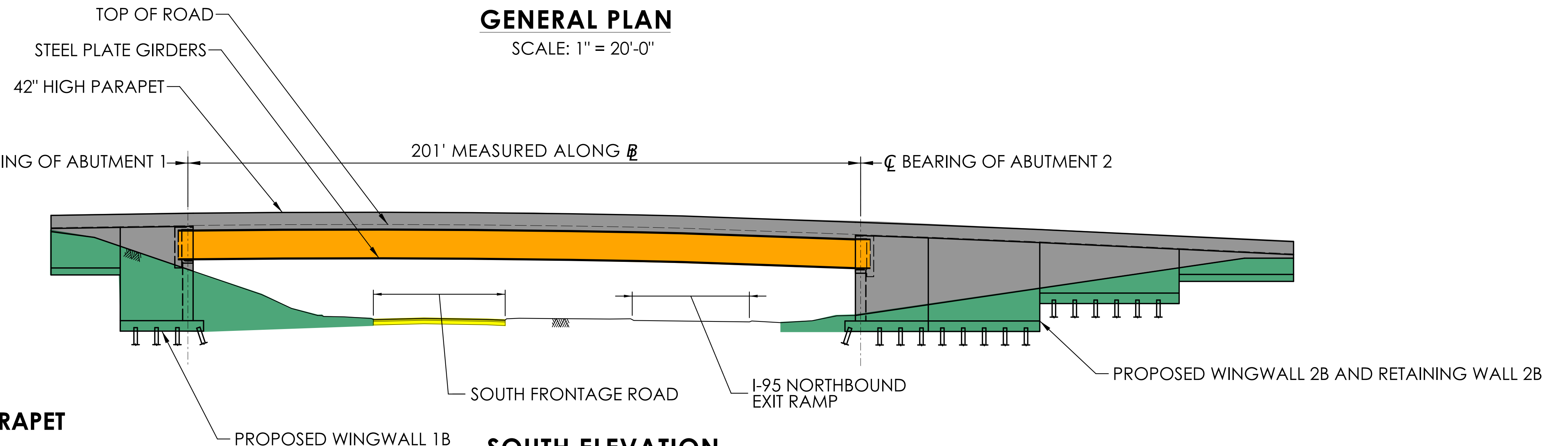

**SOUTH ELEVATION**

SCALE: 1" = 20'-0"

**LEGEND**

- PROPOSED BRIDGE WALLS, DECK AND PARAPET
- PROPOSED STEEL PLATE GIRDERS
- PROPOSED GRADE
- PROPOSED PAVEMENT

REV.	DATE	REVISION DESCRIPTION

PUBLIC INFORMATION MEETING

SCALE AS NOTED

SIGNATURE/  
BLOCK:

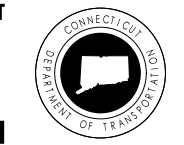
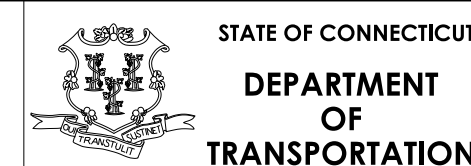

PROJECT NUMBER: 0094-0264

PROJECT DESCRIPTION: REPLACEMENT OF BRIDGE NO. 02572 OVER SOUTH FRONTAGE ROAD AND I-95 NORTHBOUND EXIT RAMP

TOWN(S): NEW LONDON

DRAWING TITLE: GENERAL PLAN AND ELEVATION

DRAWING NO.

STR-02

SHEET NO.

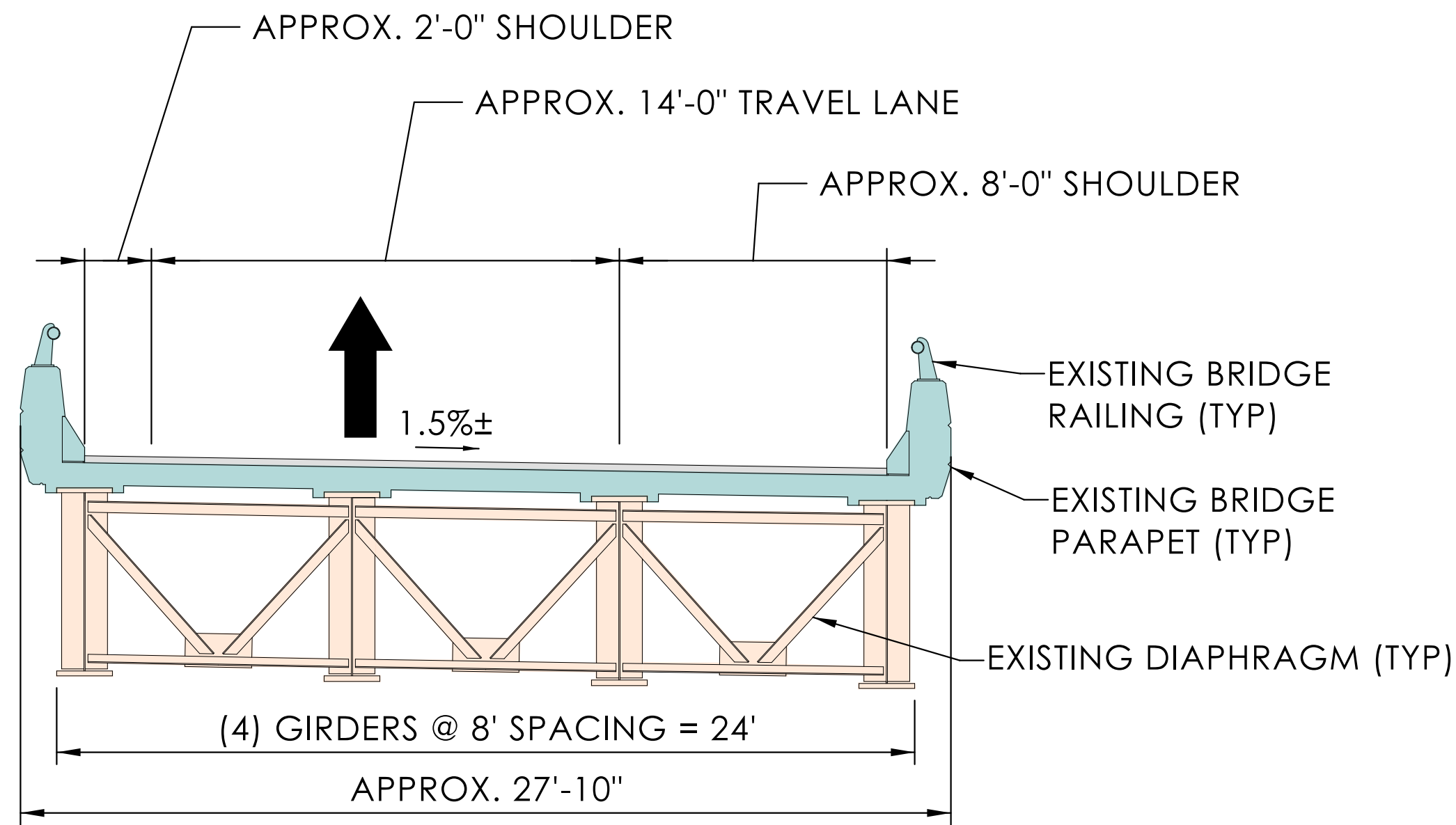

**EXISTING CROSS SECTION**  
SCALE: 1/4" = 1'-0"

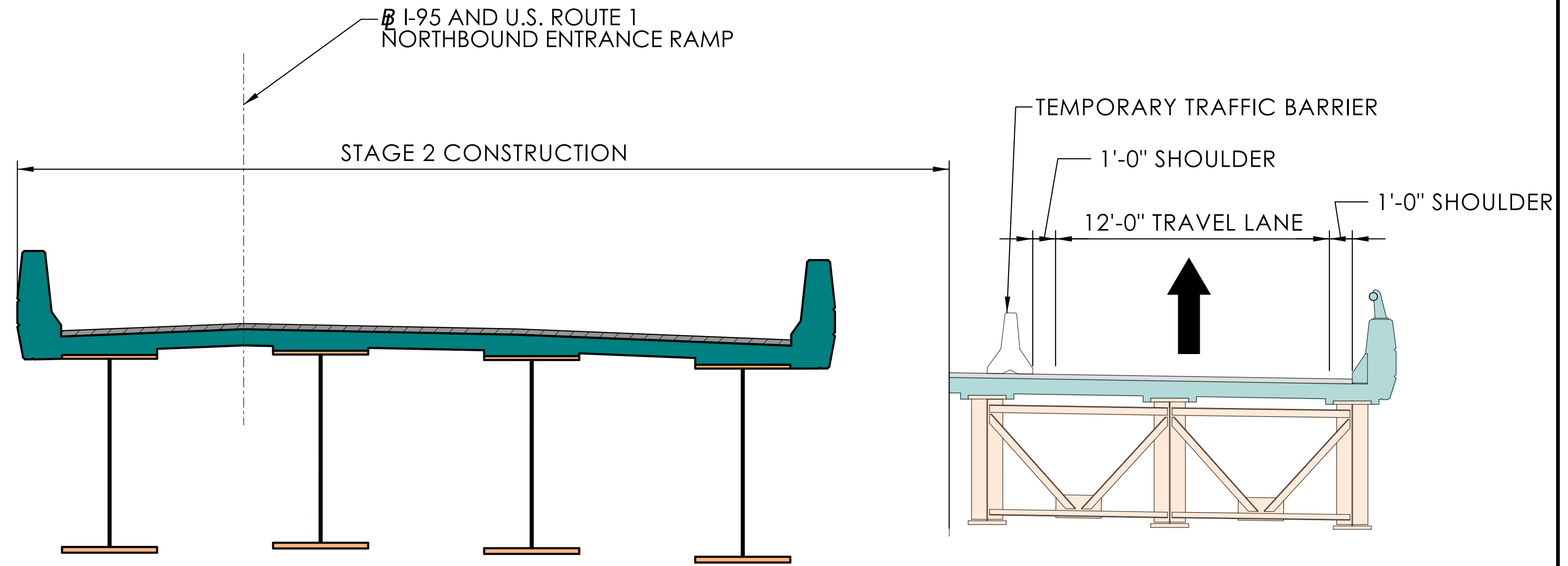

**STAGE 2 CROSS SECTION**  
SCALE: 1/4" = 1'-0"

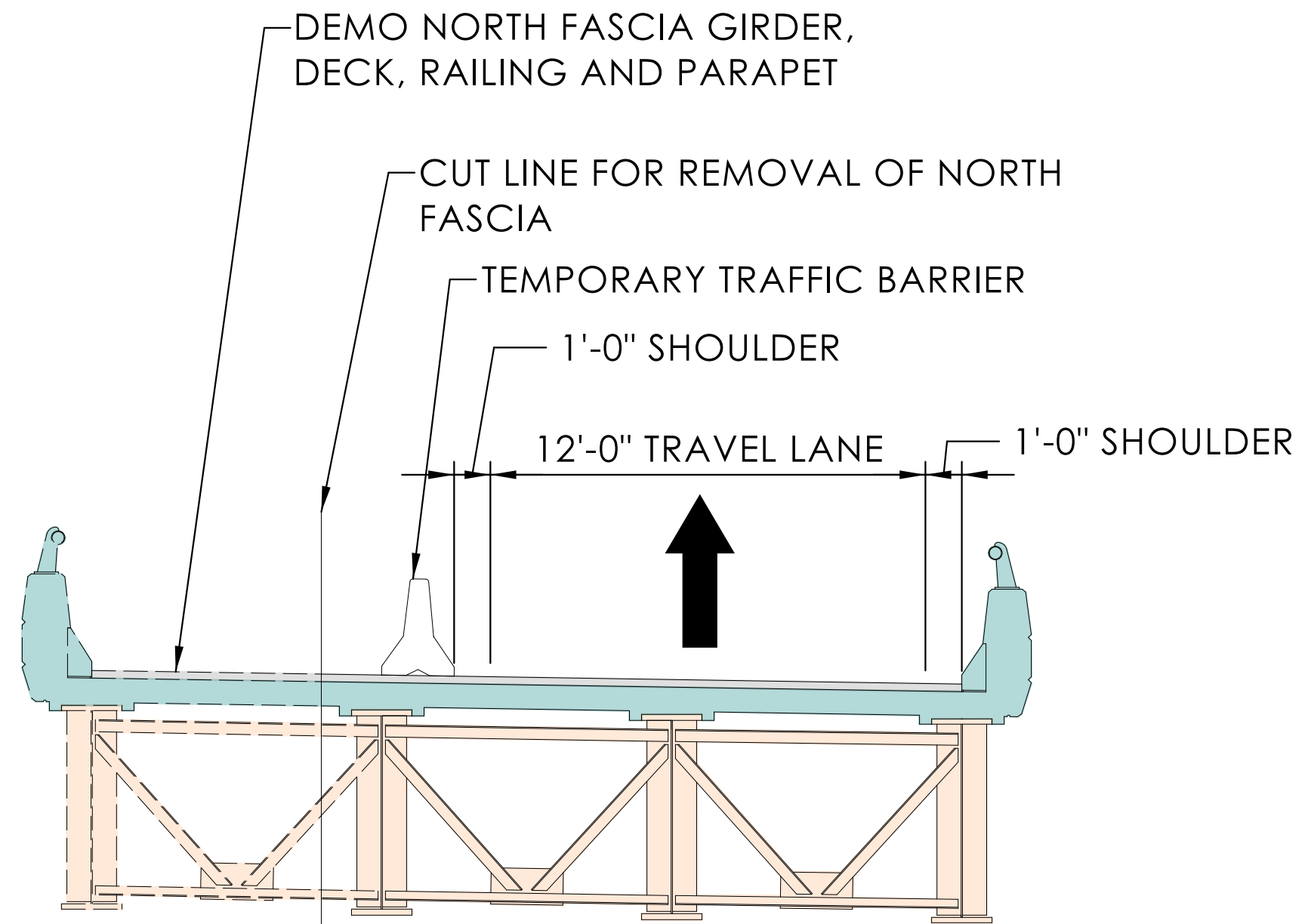

**STAGE 1 CROSS SECTION**  
SCALE: 1/4" = 1'-0"

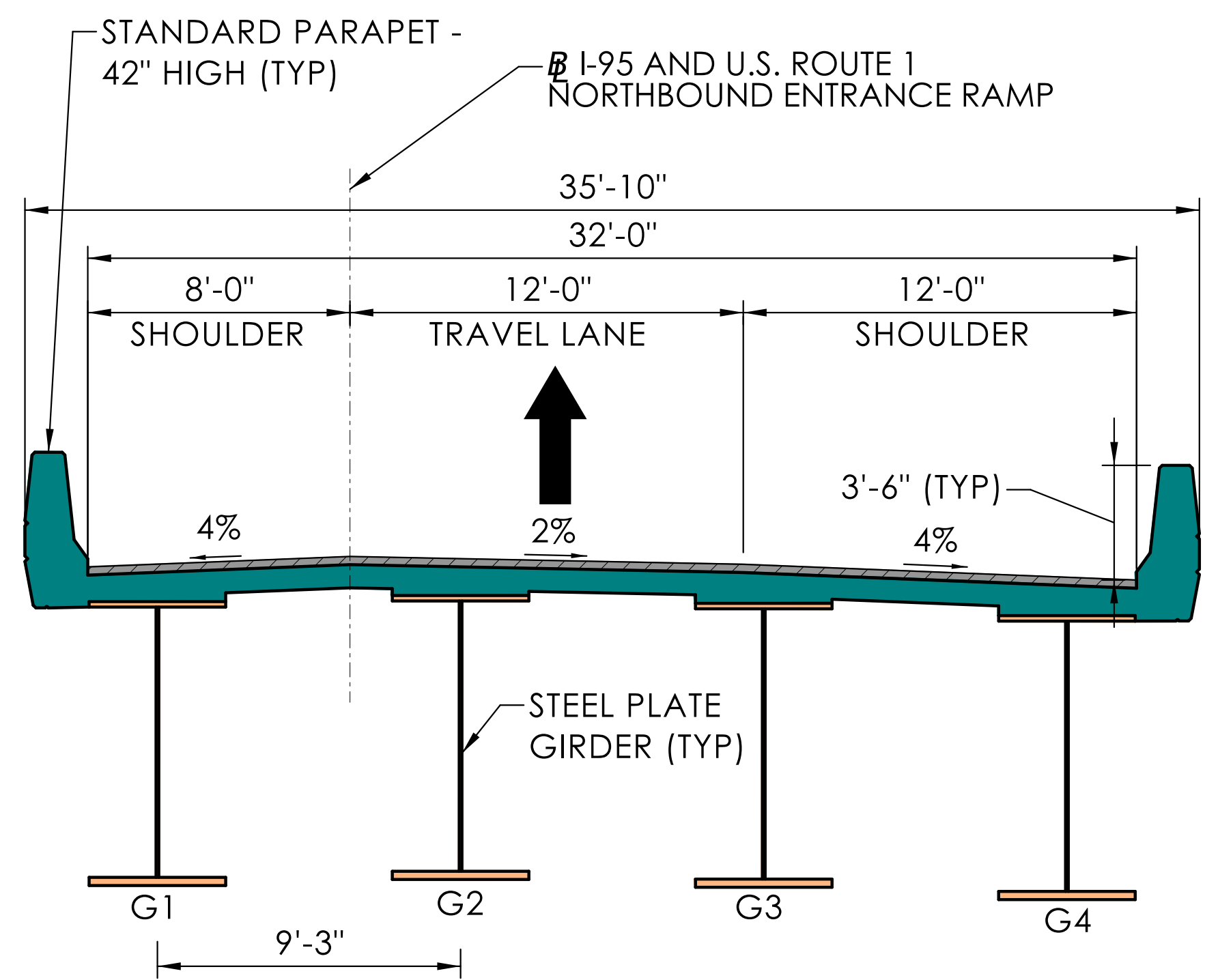

**PROPOSED CROSS SECTION**  
SCALE: 1/4" = 1'-0"

**LEGEND**

- PROPOSED BITUMINOUS OVERLAY
- PROPOSED STEEL GIRDERS
- PROPOSED DECK AND PARAPET
- EXISTING BITUMINOUS OVERLAY
- EXISTING STEEL GIRDERS/DIAPHRAGMS
- EXISTING DECK AND PARAPET

REV.	DATE	REVISION DESCRIPTION

DESIGNER/DRAFTER: AMW CHECKED BY: JVS  
 LASTED SAVED BY: ADA016 FILE NAME: K:\CT\_PROJECTS\0094-0264\VPIM\HW\_CP\_0094\_0264\_Bridge 02572 Layout Plan and Section.dgn  
 PLOTTED DATE: 6/15/2023



**SOUTH FRONTAGE ROAD DETOUR PLAN**

SCALE: 1"=400'

- (A) 80-1613 CONSTRUCTION AHEAD ROAD USE RESTRICTED STATE LIABILITY LIMITED GENERAL STATUTE SEC. 130-115, 130-145 COMMISSIONER OF TRANSPORTATION
- (B) 80-9928 SOUTH FRONTAGE ROAD CLOSED FOLLOW DETOUR
- (C) 80-9919 SOUTH FRONTAGE ROAD DETOUR (up arrow)
- (D) 80-9079 SOUTH FRONTAGE ROAD CLOSED TO THRU TRAFFIC FROM XX/XX TO XX/XX
- (E) 80-9708 END DETOUR
- (F) 80-9919 SOUTH FRONTAGE ROAD DETOUR (angled arrow)
- (G) 80-9710\*\* \*\* PROVIDE SIGN 80-9710 WITH ANGLED ARROW
- (H) 80-9919 SOUTH FRONTAGE ROAD DETOUR (right arrow)
- (I) 80-9919 SOUTH FRONTAGE ROAD DETOUR (left arrow)
- (J) 80-9918 ROAD WORK AHEAD (diamond)
- (K) 80-9603 ROAD WORK AHEAD (diamond)
- (L) 80-9838 2 RIGHT LANES CLOSED AHEAD (diamond)

**LEGEND**

- DETOUR ROUTE
- SINGLE POST SIGN
- DOUBLE POST SIGN
- ▬▬ TEMPORARY TRAFFIC BARRIER
- ▬▬ CONSTRUCTION BARRICADE TYPE III
- \* BARRICADE WARNING LIGHTS

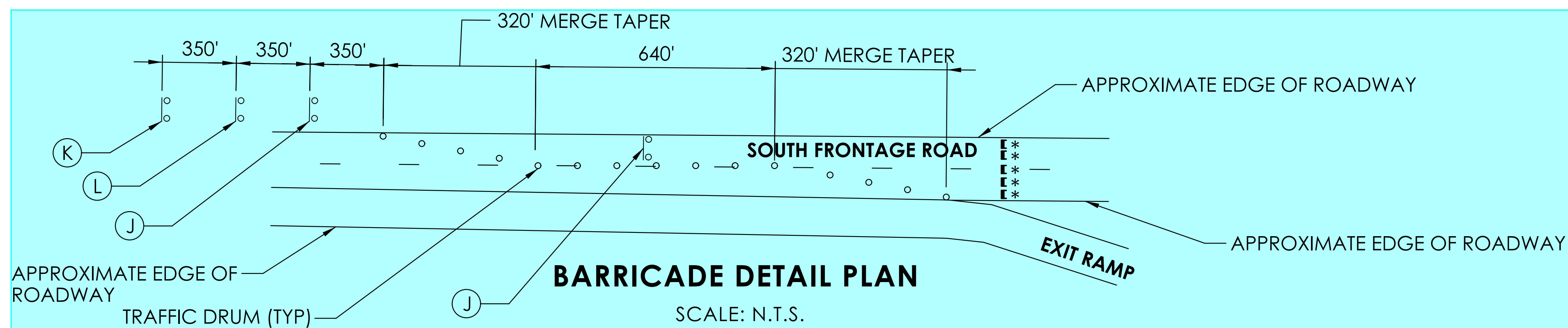

**BARRICADE DETAIL PLAN**

SCALE: N.T.S.

**PUBLIC INFORMATION MEETING**

SCALE AS NOTED

SIGNATURE/BLOCK:

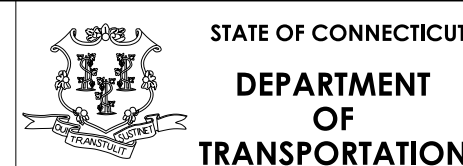

PROJECT NUMBER: 0094-0264

PROJECT DESCRIPTION: REPLACEMENT OF BRIDGE NO. 02572 OVER SOUTH FRONTAGE ROAD AND I-95 NORTHBOUND EXIT RAMP

TOWN(S): NEW LONDON

DRAWING TITLE: SOUTH FRONTAGE ROAD DETOUR PLAN

DRAWING NO. DET-01

SHEET NO.

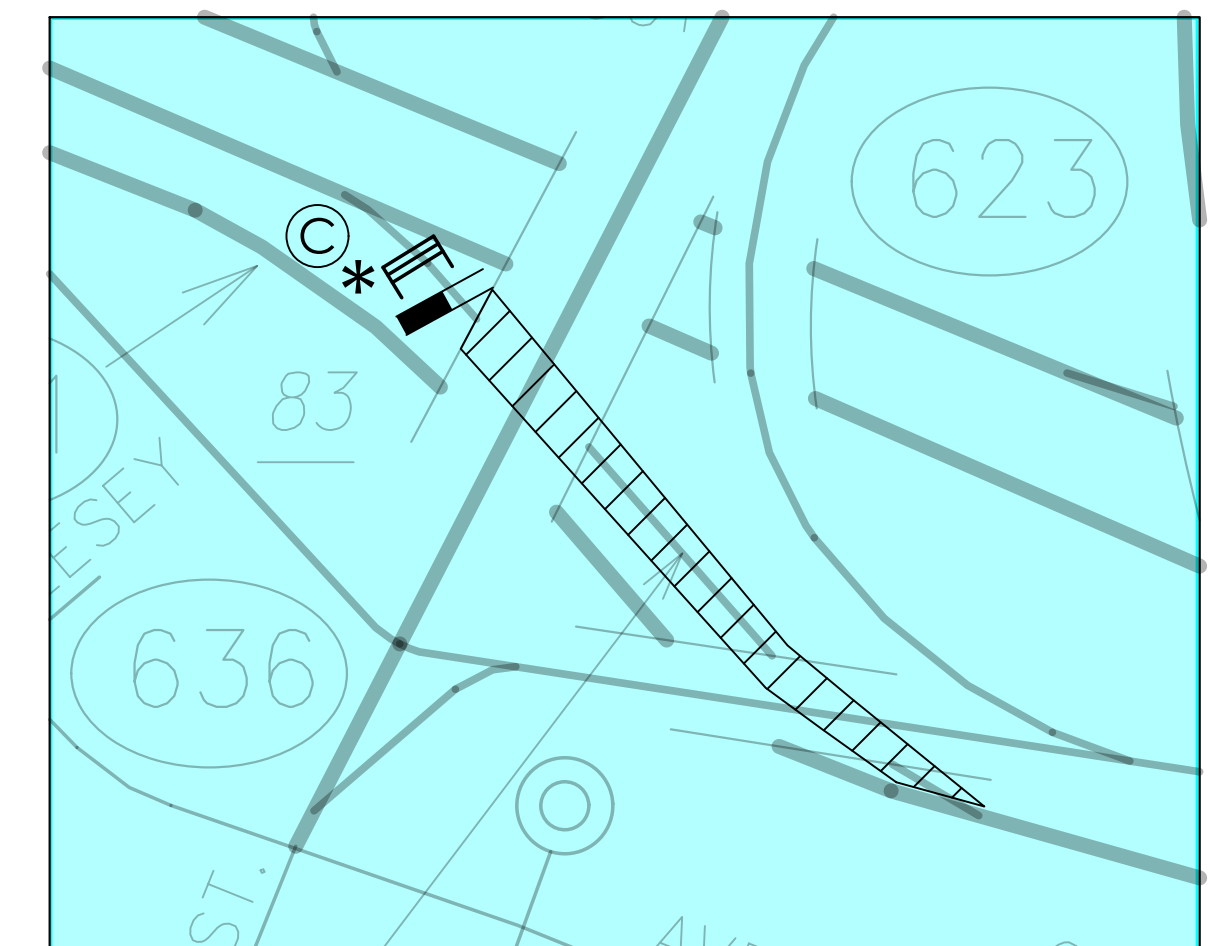
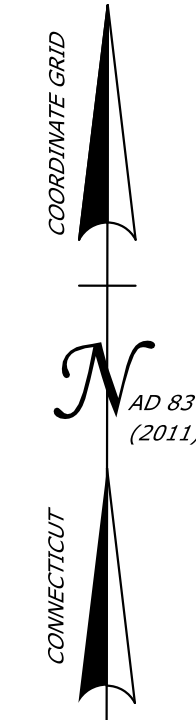
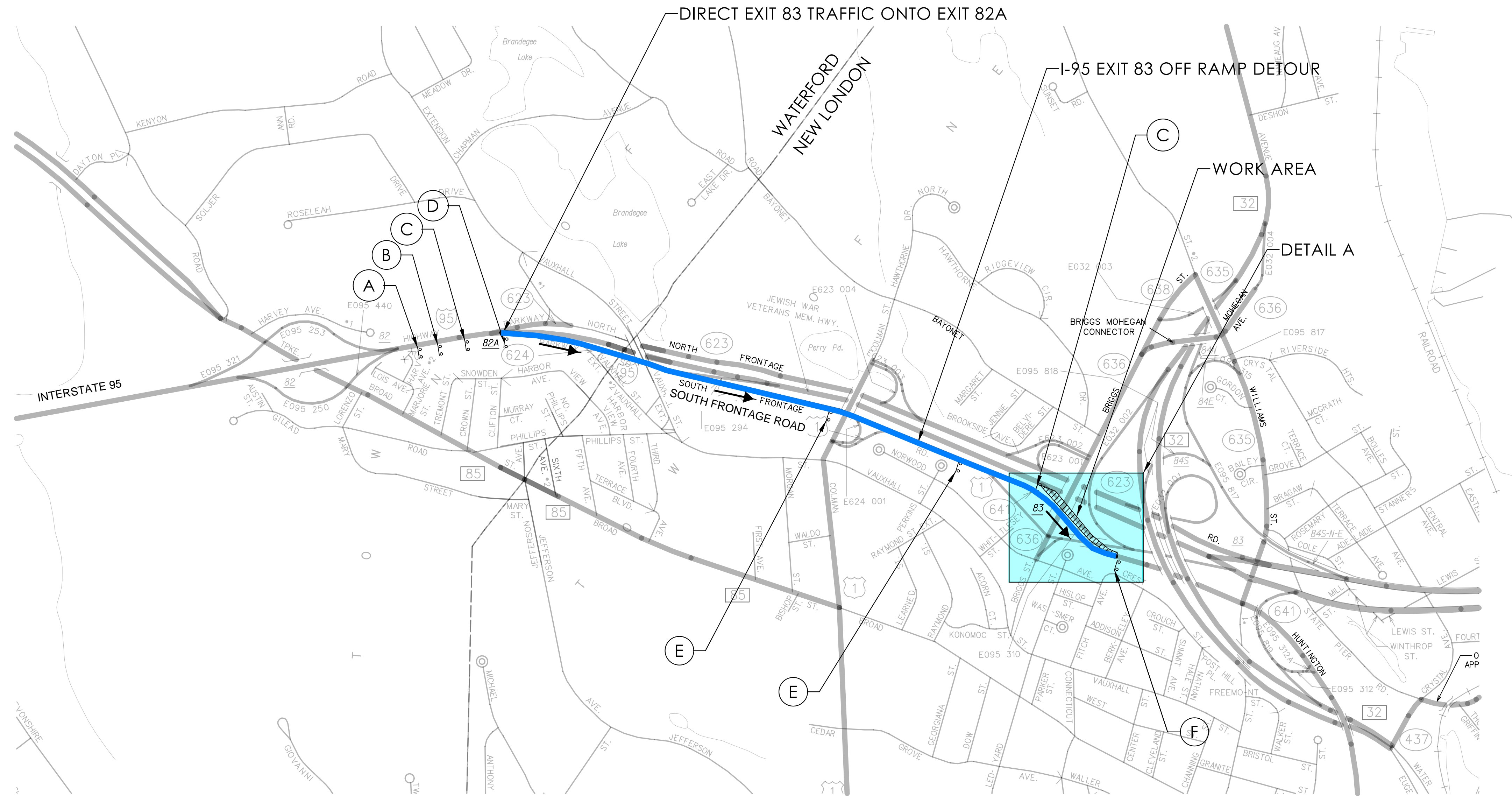

**I-95 EXIT 83 DETOUR PLAN**  
SCALE: 1"=600'

**DETAIL A**

<p>(A) 80-1613</p> <div style="border: 1px solid black; padding: 5px; width: fit-content;"> <p><b>CONSTRUCTION AHEAD</b> ROAD USE RESTRICTED STATE LIABILITY LIMITED <small>GENERAL STATUTE SEC. 130-115, 130-145 COMMISSIONER OF TRANSPORTATION</small></p> </div>	<p>(B) 80-9928</p> <div style="border: 1px solid black; padding: 5px; width: fit-content;"> <p><b>EXIT 83 CLOSED FOLLOW DETOUR</b></p> </div>	<p>(C) 80-9079</p> <div style="border: 1px solid black; padding: 5px; width: fit-content;"> <p><b>EXIT 83 CLOSED TO THRU TRAFFIC FROM XX/XX TO XX/XX</b></p> </div>
<p>(D) 80-9919 80-9710**</p> <div style="border: 1px solid black; padding: 5px; width: fit-content;"> <p><b>EXIT 83 DETOUR</b></p> <p><small>** PROVIDE SIGN 80-9710 WITH ANGLED ARROW</small></p> </div>	<p>(E) 80-9919 80-9710</p> <div style="border: 1px solid black; padding: 5px; width: fit-content;"> <p><b>EXIT 83 DETOUR</b></p> </div>	<p>(F) 80-9708</p> <div style="border: 1px solid black; padding: 5px; width: fit-content;"> <p><b>END DETOUR</b></p> </div>

**LEGEND**

- DETOUR ROUTE
- SINGLE POST SIGN
- DOUBLE POST SIGN
- TEMPORARY TRAFFIC BARRIER
- CONSTRUCTION BARRICADE TYPE III
- BARRICADE WARNING LIGHTS

REV.	DATE	REVISION DESCRIPTION