



20 Church Street
Hartford, CT 06103
Telephone: 860-525-5065
Fax: 860-527-4198
www.lockelord.com

Kathryn E. Boucher
Associate
Direct Telephone: 860-541-7714
Direct Fax: 860-955-1145
kathryn.boucher@lockelord.com

December 20, 2019

VIA ELECTRONIC MAIL AND OVERNIGHT MAIL

Melanie A. Bachman
Executive Director
Connecticut Siting Council
10 Franklin Square
New Britain, CT 06051

Re: Petition 1352 - Nutmeg Solar, LLC, petition for a declaratory ruling, pursuant to Connecticut General Statutes §4-176 and §16-50k, for the proposed construction, maintenance and operation of a 19.6-megawatt AC solar photovoltaic electric generating facility on approximately 162 acres comprised of 9 separate parcels located generally south of Bailey Road and east of Route 191 (Broad Brook Road), and associated electrical interconnection to Eversource Energy's Scitico Substation at 20 Bailey Road in Enfield, Connecticut

Dear Ms. Bachman:

On behalf of the petitioner, Nutmeg Solar, LLC, enclosed please find an original and 15 copies of responses to the Connecticut Siting Council's interrogatories in connection with the Development and Management plan as filed in the above-referenced proceeding.

Please do not hesitate to contact the undersigned or David Bogan of this office (860-541-7711) should you have any questions regarding this submission.

Very truly yours,

A handwritten signature in black ink that reads "Kate Boucher".

Kathryn E. Boucher

CERTIFICATION

I hereby certify that on December 20, 2019, the foregoing was delivered by regular mail, postage prepaid, in accordance with § 16-50j-12 of the Regulations of Connecticut State Agencies, to all parties and intervenors of record, as follows:

Maria Eldsen, Esq.
Town Attorney
Town of Enfield
820 Enfield Street
Enfield, CT 06082

A handwritten signature in black ink that reads "Kate Boucher". The signature is written in a cursive style with a large, stylized "K" and "B".

Kathryn E. Boucher
Commissioner of the Superior Court

**STATE OF CONNECTICUT
CONNECTICUT SITING COUNCIL**

Petition No. 1352

Company:
Nutmeg Solar, LLC

Witness:
Jessica B. Roberts

Submission Date:
December 20, 2019

Page 1 of 1

CSC-1 Condition No. 1(a) of the Council's Declaratory Ruling (Declaratory Ruling) dated April 26, 2019 requires, "The D&M Plan shall be served on the Towns of Enfield and Somers for comment..." Was a copy of the Development and Management Plan (D&M Plan) submitted to the Towns of Enfield and Somers? If no, please submit a copy to these two municipalities.

Response:

Copies of the D&M Plan were served on the Towns of Enfield and Somers on November 27, 2019.

See Attachment CSC-1 – Enfield and Somers Transmittal Letters.

**STATE OF CONNECTICUT
CONNECTICUT SITING COUNCIL**

Petition No. 1352

Company:
Nutmeg Solar, LLC

Witness:
Mitchell Thiem

Submission Date:
December 20, 2019

Page 1 of 1

CSC-2 Condition No. 1(a) of the Declaratory Ruling also requires, “A final site plan including, but not limited to, solar arrays, fence design, and the electrical connections to and including the Collector Substation.” Drawing Nos. C-024 and C-025 of the Development and Management Plan (D&M Plan) only depict the rectangular area for the Collector Substation with a note that states, “Refer to Electrical Drawings for Substation.” Please provide the site plan/electrical drawings of the Collector Substation. Include the substation structure/equipment heights and the connection to Eversource’s approved underground transmission line from Petition No. 1376.

Response:

A 115/34.5 kV Substation General Arrangement Plan and 115/34.5kV Substation Above Grade Section H-H are being submitted with this response.

See Attachment CSC-2 – 115/34.5 kV Substation General Arrangement Plan and 115/34.5kV Substation Above Grade Section H-H drawing sheets.

**STATE OF CONNECTICUT
CONNECTICUT SITING COUNCIL**

Petition No. 1352

Company:
Nutmeg Solar, LLC

Witness:
Mitchell Thiem

Submission Date:
December 20, 2019

Page 1 of 1

CSC-3 Finding of Fact #94 from Petition No. 1352 indicated that the project would have approximately 72,520 solar panels at 400 Watts DC each. Page 10 of the D&M Plan indicates that 405 Watt panels would be utilized. Provide the updated quantity of solar panels. Has the AC capacity of the project changed from the originally approved approximately 19.6 MW AC?

Response:

Currently 78,192 405 Watt panels are proposed for the project. The AC capacity of the project has not changed and is 19.6 MW AC at the point of interconnection.

TRANSMITTAL

Tighe&Bond

Project No.: R 317-3-09

VIA HAND DELIVERY

Date: November 27, 2019

Re: Nutmeg Solar Project Development and Management Plan (Enfield, CT)

To: Maria S. Elsdon, Esq.
Acting Town Attorney
Town of Enfield
820 Enfield Street
Enfield, CT 06082

Copy:

☐ FOR SIGNATURE ☒ FOR FILE ☐ AS REQUESTED ☒ FOR REVIEW ☐ PLEASE REPLY

NO. COPIES	DESCRIPTION
1	Copy – Development and Management Plan (Nutmeg Solar Project)

Enclosed please find an original and fifteen (15) copies of the Nutmeg Solar Development and Management Plan ("D&M Plan") as required by the Connecticut Siting Council in its April 25, 2019 Opinion, Decision and Order.

Should you have any questions, please contact me at (413) 875-1301/
BSHuntley@tighebond.com.

Very truly yours,
TIGHE & BOND, INC.



Brian Huntley, P.E.
Senior Project Manager/ Associate

RECEIVED
ENFIELD TOWN CLERK
2019 NOV 27 PM 4:19

TRANSMITTAL

Tighe&Bond

Project No.: R 317-3-09

VIA HAND DELIVERY

Date: November 27, 2019

Re: Nutmeg Solar Project Development and Management Plan (Enfield, CT)

To: C.G. 'Bud' Knorr, Jr.
First Selectman
Town of Somers
600 Main Street
Somers, CT 06071

Copy:

☐ FOR SIGNATURE ☒ FOR FILE ☐ AS REQUESTED ☒ FOR REVIEW ☐ PLEASE REPLY

NO. COPIES	DESCRIPTION
1	Copy – Development and Management Plan (Nutmeg Solar Project)

Enclosed please find an original and fifteen (15) copies of the Nutmeg Solar Development and Management Plan ("D&M Plan") as required by the Connecticut Siting Council in its April 25, 2019 Opinion, Decision and Order.

Should you have any questions, please contact me at (413) 875-1301/
BSHuntley@tighebond.com.

Very truly yours,
TIGHE & BOND, INC.

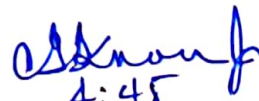

Brian Huntley, P.E.
Senior Project Manager/ Associate

4:45
11-27-19

RECEIVED
TOWN CLERK'S OFFICE
NOV 27 2019

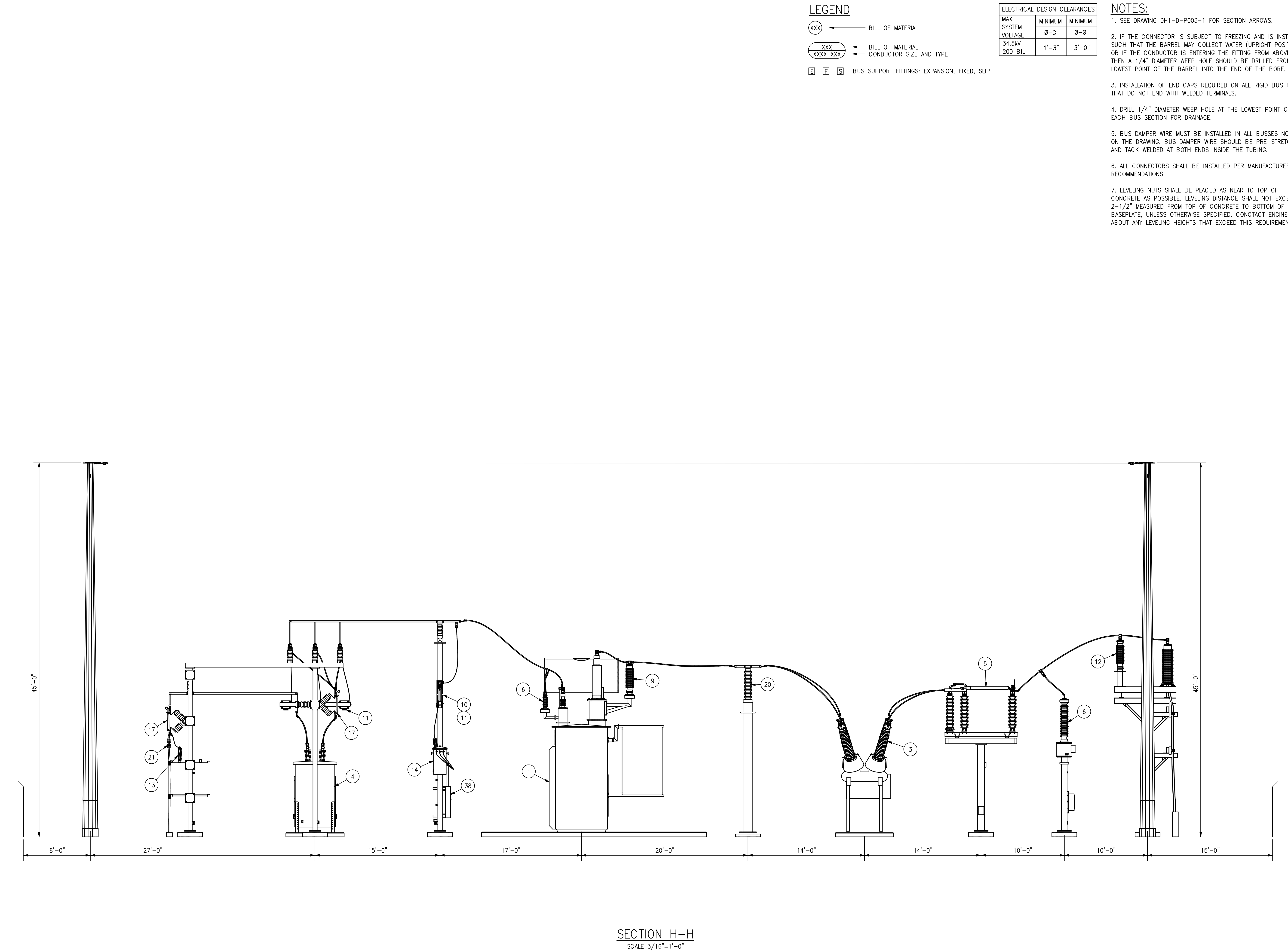

SECTION H-H
SCALE 3/16"=1'-0"

REV	DATE	BY	CKD	DESCRIPTION
A	11/06/19	TMC	KPN	LIGHTNING MAST ADDITION

PRELIMINARY
NOT FOR CONSTRUCTION

**BURNS
MEDONNELL**
9400 WARD PARKWAY
KANSAS CITY, MO 64114
816-333-9400

date	11/06/19	detailed	T. CRAFTON
designed	T. CRAFTON	checked	K. NUGENT

**NEXtera
ENERGY**
RESOURCES

CONNECTICUT
NUTMEG SOLAR
115/34.5kV SUBSTATION
ABOVE GRADE SECTION H-H

project	113040	contract	
drawing	NM1-D-P004-9	rev	A
file	NM1-D-P004-9.dwg		

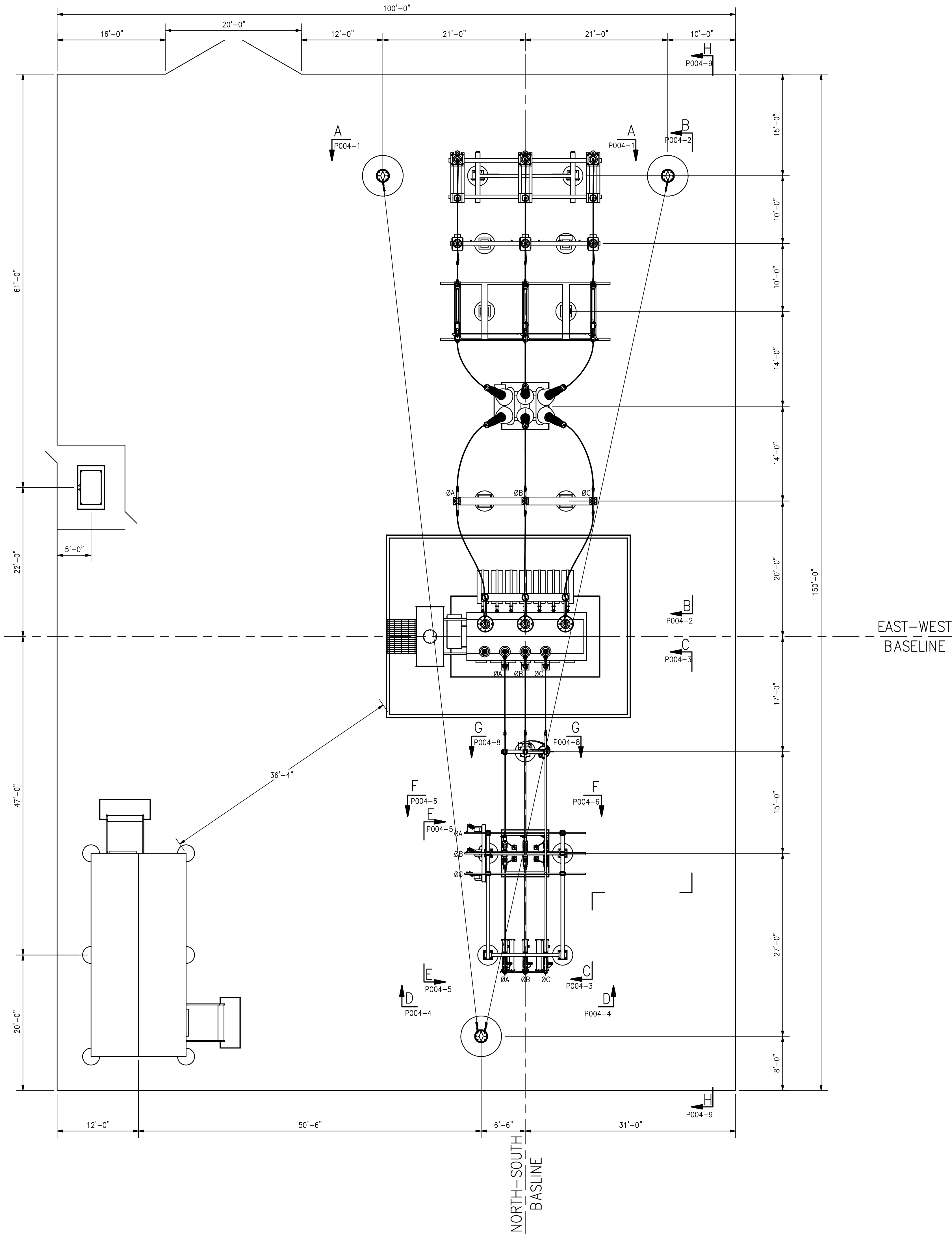
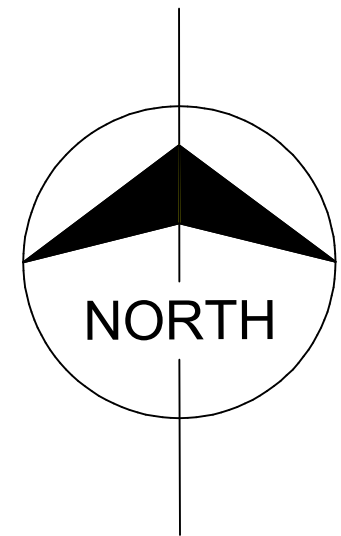

NOTES:

1. IF THE CONNECTOR IS SUBJECT TO FREEZING AND IS INSTALLED SUCH THAT THE BARREL MAY COLLECT WATER (UPRIGHT POSITION OR IF THE CONDUCTOR IS ENTERING THE FITTING FROM ABOVE), THEN A 1/4" DIAMETER WEEP HOLE SHOULD BE DRILLED FROM THE LOWEST POINT OF THE BARREL INTO THE END OF THE BORE.
2. DRILL 1/4" DIAMETER WEEP HOLE AT THE LOWEST POINT OF EACH BUS SECTION FOR DRAINAGE.
3. BUS DAMPER TO BE INSTALLED IN ALL BUSES NOTED ON THE DRAWING. BUS DAMPER WIRE SHOULD BE PRE-STRETCHED AND TACK WELDED AT BOTH ENDS INSIDE THE TUBING.

LEGEND

- ↑ X — INDICATES SECTION LETTER
P00X-X — INDICATES DRAWING NUMBER
- □ □ BUS SUPPORT FITTINGS: EXPANSION, FIXED, SLIP

ELECTRICAL DESIGN CLEARANCES		
MAX SYSTEM VOLTAGE	MINIMUM	MINIMUM
34.5KV	Ø-G	Ø-Ø
200 BIL	1'-3"	3'-0"
115KV	3'-5"	7'-0"
550 BIL		

PRELIMINARY
NOT FOR CONSTRUCTION

**BURNS
MEDONNELL**

9400 WARD PARKWAY
KANSAS CITY, MO 64114
816-333-9400

date	11/06/19	detailed	T. CRAFTON
designed	T. CRAFTON	checked	K. NUGENT

**NEXTERA
ENERGY**
RESOURCES

CONNECTICUT
NUTMEG SOLAR

115/34.5kV SUBSTATION
GENERAL ARRANGEMENT PLAN

project	113040	contract	
drawing	NM1-D-P003-1	rev	A
file	NM1-D-P003-1.dwg		