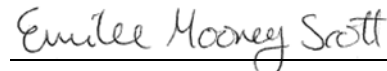

DURHAM MANUFACTURING COMPANY

**201 MAIN STREET
MAP 38, LOT 46
DURHAM, CONNECTICUT**

CERTIFICATION OF SERVICE: ABUTTING LANDOWNERS

I hereby certify that on this 16th day of March 2018, notice of the filing of the Durham Manufacturing Company Petition for Declaratory Ruling was sent first class mail, postage prepaid and via Certificate of Mailing, to those abutting landowners listed below and shown on Figure 1.

Emilee Mooney Scott

<u>Map/Lot</u>	<u>Property Address</u>	<u>Owner and Mailing Address</u>
38-29	36 Maiden Lane	Mary C. Newman 36 Maiden Lane Durham, CT 06422-2006
38-30	78 Maiden Lane	Julie A. Raymond 78 Maiden Lane Durham, CT 06422
38-31	96 Maiden Lane	Christina L. Lutjen 53 Lovers Lane Madison, CT 06443
38-34	93R Maiden Lane	Gregory J and Helen Putnam 93R Maiden Lane Durham, CT 06422-2009
38-36	63 Maiden Lane	Wilfredo S. Quijano 63 Maiden Lane Durham, CT 06422

<u>Map/Lot</u>	<u>Property Address</u>	<u>Owner and Mailing Address</u>
38-37	35 Maiden Lane	Rebecca P. Gerchey 35 Maiden Lane Durham, CT 06422
38-44	227 Main Street	Richard C. Kellish P.O. Box 282 Durham, CT 06422-0282
38-45	215 Main Street	Francis Earle Korn 215 Main St. Durham, CT 06422-2108
38-47 38-51	205 Main Street Pickett Lane	Town of Durham Attn: First Selectman Laura Francis 30 Townhouse Road P.O. Box 428 Durham, CT 06422
38-50	191 Main Street	Dr. Kathryn Veronesi Superintendent of Schools District 13 of the Regional School P.O. Box 190 Durham, CT 06422-0190
38-53	129 Maple Avenue 196 Main Street	Church of the Epiphany P.O. Box 337 Durham, CT 06422-0337
38-54	202 Main Street	Craig T. Price and Kathleen E. Morin 202 Main St. Durham, CT 06422-2106
38-55	208 Main Street	Bruce A. Chaplin 208 Main St. Durham, CT 06422-2106
38-56	216 Main Street	Church Basement Enterprises LLC 58 Virginia Rail Drive Marlborough, CT 06447

Figure 1: Map of Abutting Properties

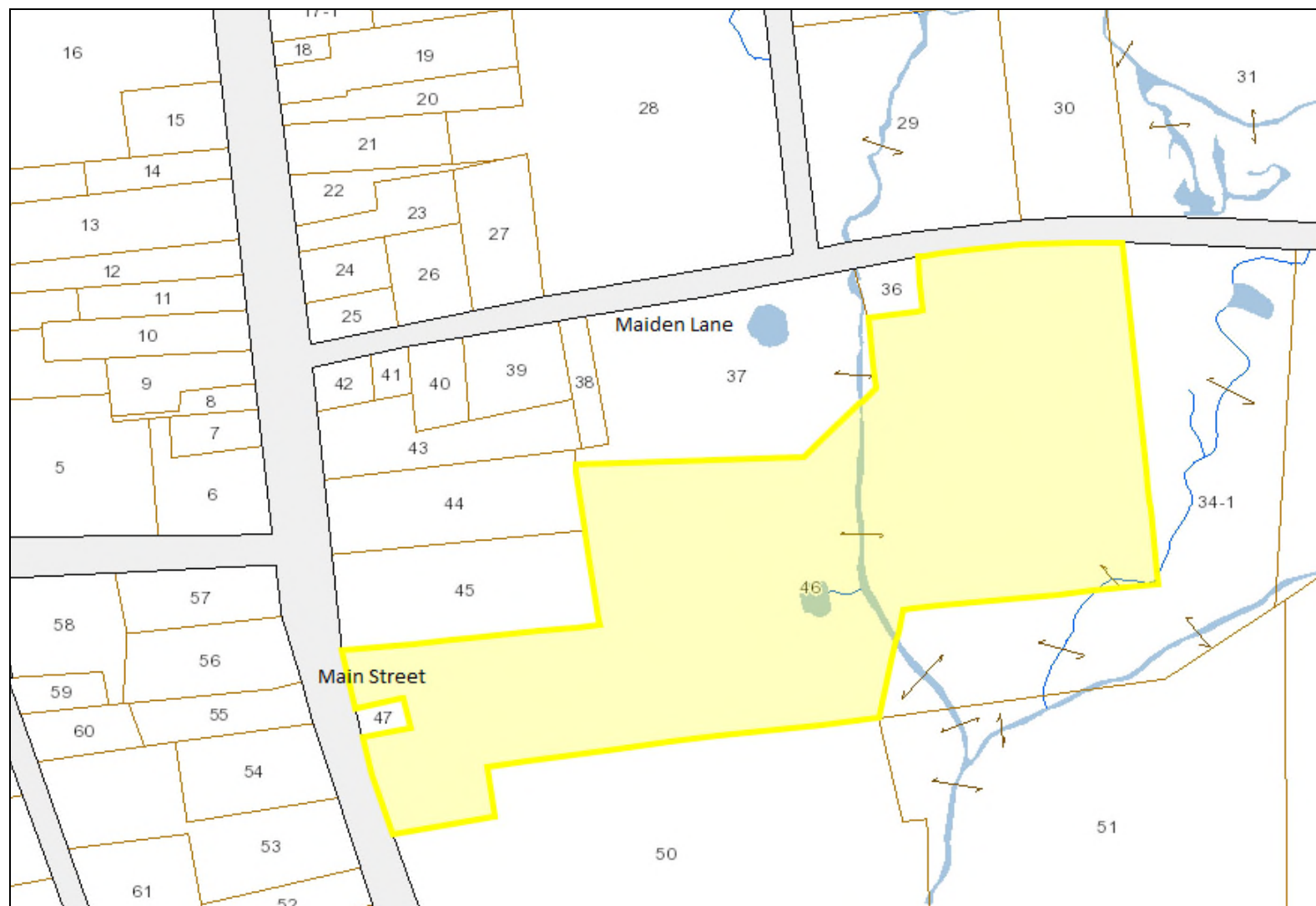

Note: Parcel 38-34-1 is owned by Durham Manufacturing Company