



# STATE OF CONNECTICUT

## CONNECTICUT SITING COUNCIL

Ten Franklin Square, New Britain, CT 06051

Phone: (860) 827-2935 Fax: (860) 827-2950

E-Mail: [siting.council@ct.gov](mailto:siting.council@ct.gov)

[www.ct.gov/csc](http://www.ct.gov/csc)

February 15, 2018

Bradley J. Parsons, PE, PMP  
All-Points Technology Corporation, P.C.  
3 Saddlebrook Drive  
Killingworth, CT 06419

RE: **PETITION NO. 1247** – C-TEC Solar, LLC declaratory ruling that no Certificate of Environmental Compatibility and Public Need is required for the proposed construction, maintenance, and operation of a 3.75 MW solar photovoltaic electric generating facility located at 1 Ballard Road, Thompson, Connecticut.

Dear Mr. Parsons:

The Connecticut Siting Council (Council) is in receipt of your request dated February 13, 2018 to revise the approved Phase II and Phase III Development and Management (D&M) Plans for the above-referenced project in accordance with the Council's January 19, 2017 D&M Plan Decision. In response to your February 13, 2018 request, pursuant to Regulations of Connecticut State Agencies §16-50j-62(b), Council staff hereby acknowledges receipt and approves the revisions to the Phase II and Phase III D&M Plans which consist of a reduction of the Future Phase ground mounted solar panel array from 4,056 to 3,976 panels, minor layout changes in the north and south sections of the array, a change from post mounts to ballast mounts for two rows to avoid impacting electrical conduits, and the addition of a 15-foot by 20-foot concrete pad for additional electrical equipment, northwest of the previously installed shed.

This approval applies only to the D&M Plan revision received on February 13, 2018. Any significant changes to the D&M Plan require advance Council notification and approval.

Thank you for your attention and cooperation.

Very truly yours,

Melanie A. Bachman  
Executive Director

MB/MP

c: Council Members  
Michael Libertine, All-Points Technology Corporation, P.C.  
The Honorable Ken L. Beausoleil, First Selectman, Town of Thompson  
Mary Ann Chinatti, Director of Planning and Development, Town of Thompson

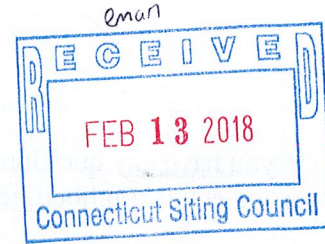

Connecticut Siting Council  
Ten Franklin Square  
New Britain, CT 06051  
Attn: Robert Stein, Chairman

February 13, 2018

Re: Request for Consideration of Changes  
Petition No. 1247

Dear Chairman Stein,

On September 1, 2016, the Connecticut Siting Council ("Council") issued a Declaratory Ruling to C-TEC Solar, LLC that no Certificate of Environmental Compatibility and Public Need is required for the construction, maintenance and operation of a 3.75 megawatt solar voltaic electric generating facility located at 1 Ballard Road, Thompson, Connecticut. Subsequently, the Council then considered and approved this project's Phase 1 Development and Management ("D&M") Plan on January 19, 2017, with the condition that a D&M Plan Revision shall be submitted for the Future Phase with the final site layout and fence design.

In accordance with the Regulations of Connecticut State Agencies Section 16-50j-62, we respectfully request the Council consider the following proposed changes.

1. D&M Plan Revision – The second phase of the project is being developed and the ground-mounted solar arrays necessitate minor changes to meet the electrical output requirements. The proposed D&M Plan Revision for Phase 2 include:
  - Reduction of the Phase 2 ground mounted solar panel array from 4,056 to 3,976 panels
  - Minor layout changes mainly in the north and south sections of the array;
  - Two rows will change from post mounted to ballast mounted as to not interfere with the Phase 1 electrical conduits;
  - Addition of concrete equipment pad for additional electrical equipment, northwest of previously installed shed.

The proposed D&M Plan Revision is depicted on the attached Barrette Farms – Phase 2 D&M Plan, dated January 31, 2018. We respectfully request the Council review and approve the modified D&M Plan.

**ALL-POINTS TECHNOLOGY CORPORATION, P.C.**

3 SADDLEBROOK DRIVE · KILLINGWORTH, CT 06419 · PHONE 860-663-1697 · FAX 860-663-0935

P.O. BOX 504 · 116 GRANDVIEW ROAD · CONWAY, NH 03818 · PHONE 603-496-5853 · FAX 603-447-2124

If you have any questions or require additional information, please contact me at (860) 983-5153 or via email at [mibertine@allpointstech.com](mailto:mibertine@allpointstech.com).

Thank you in advance for your consideration.

Sincerely,  
**All-Points Technology Corporation, P.C.**

A handwritten signature in black ink, appearing to read 'BJP', with a long horizontal line extending to the right.

Bradley J. Parsons, P.E. on behalf of

Michael Libertine  
Director of Siting and Permitting

Attachments

- D&M Plan Revision - Barrette Farms – Phase 2

Cc: Brandon Pizzoferrato – C-TEC Solar  
Melanie A. Bachman, Esq. – CSC  
Michael Libertine – APT

DEVELOPMENT & MANAGEMENT PLAN

# CCC-TECSOLAR

## BARRETTE FARMS SOLAR PANEL FACILITY PHASE 2

1 BALLARD ROAD  
THOMPSON, CT 06227

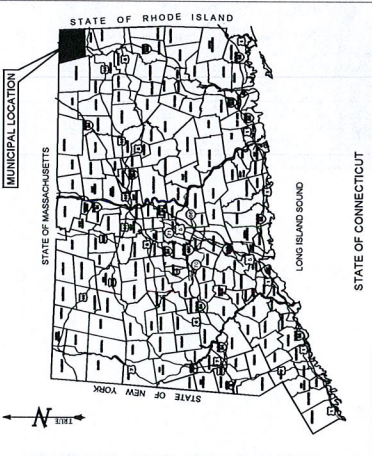

**DRAWING INDEX**

- CV-1 COVER SHEET & INDEX
- LOCATION SURVEY (BY OTHERS)
- LOCATION SURVEY (BY OTHERS)
- SP-0 OVERALL SITE PLAN
- SP-1 SITE PLAN
- DN-1 DETAIL SHEET
- DN-2 SEDIMENTATION & EROSION CONTROL NOTES
- DN-3 NOTES & SPECIFICATIONS

**SITE INFORMATION**

SITE NAME: BARRETTE FARMS  
PROJECT LOCATION: 1 BALLARD ROAD  
THOMPSON, CT 06277  
SITE TYPE/DESCRIPTION: ADD GROUND MOUNTED SOLAR PANEL ARRAYS, WI  
ASSOCIATED GRAVEL ACCESS DRIVE & EQUIPMENT,  
ADD CHAIN LINK FENCE GATE & ELECTRIC  
UTILITY FROM NEW FACILITY TO EXIST.  
ELECTRICAL GRID.

PROPERTY OWNER: BARRETTE, BERNARD J & LUCILLE T  
190 ROBINS ROAD  
THOMPSON, CT 06277

ENGINEER CONTACT: BRADLEY J. PARSONS  
(860) 668-6977 X208

LATITUDE: 41°56'39"N  
LONGITUDE: 72°52'30"W  
ELEVATION: 332.2' AMSL

ZONE: USZS (INDUSTRIAL)  
FEMA FIRM DESIGNATION: PANEL #000170014B - ZONE C  
TOTAL SITE ACREAGE: 49.25 ACRES  
TOTAL DISTURBED AREA: 14.14± ACRES

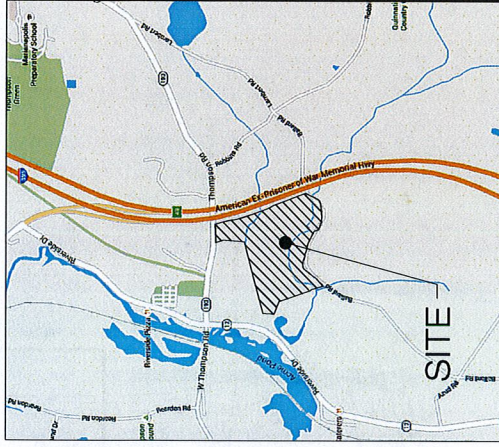

**LOCATION MAP**  
SCALE 1"=1000'

<b>CCC-TECSOLAR</b> 1 GRIFFIN ROAD SOUTH BLOOMFIELD, CT 06002 OFFICE: (860) 488-7174		<b>ALL-POINTS</b> 1500 WASHINGTON ST SUITE 100 BLOOMFIELD, CT 06002 PHONE: (860) 484-3100 WWW.ALL-POINTS.COM	
NO.	DATE	REVISION	
0	07/17/18	CSC NUMBER/DR. RUP	
1			
2			
3			
4			
5			
6			

DESIGN PROFESSIONALS OF RECORD	ALL-POINTS CORPORATION, P.C. 1500 WASHINGTON ST SUITE 100 BLOOMFIELD, CT 06002
NOTE	

CCC-TECSOLAR BARRETTE FARMS-PHASE 2 SITE 1 BALLARD ROAD THOMPSON, CT SHEET NUMBER: CV-1 DRAWN BY: RUP CHECKED BY: BMC DATE: 07/17/18	SHEET TITLE: COVER SHEET & INDEX	SHEET NUMBER: <b>CV-1</b>
--	--	------------------------------

**BBCTEC SOLAR**  
 1 GRIFFIN ROAD SOUTH  
 BLOOMFIELD, CT 06002  
 OFFICE: (860) 584-7174

**ALL POINTS**  
 TECHNOLOGY CORPORATION  
 23 SANDERSON DRIVE  
 SUITE 100  
 BLOOMFIELD, CT 06002  
 PHONE: (860) 584-8087  
 FAX: (860) 584-8088  
 WWW.ALLPOINTS.COM

NO.	DATE	REVISION
1		EXISTING LSE SUBMISSION, LUP
2		
3		
4		
5		
6		

DESIGN PROFESSIONALS OF RECORD  
**PROF. BRADLEY J. PARSONS, P.E.**  
 COMP. ALL POINTS TECHNOLOGY  
 ADD: 3 SANDERSON DRIVE  
 BLOOMFIELD, CT 06002

NOTE

C-TECSOLAR  
 BARRETTE FARMS-PHASE 2  
 10 HOLLAND ROAD  
 ADDRESS TRAIL  
 SUITE 100  
 BLOOMFIELD, CT 06002  
 DRAWN BY: BLP  
 CHECKED BY: BMC  
 DATE: 01/21/18

SHEET TITLE  
**OVERALL  
 SITE PLAN**

SHEET NUMBER  
**SP-0**

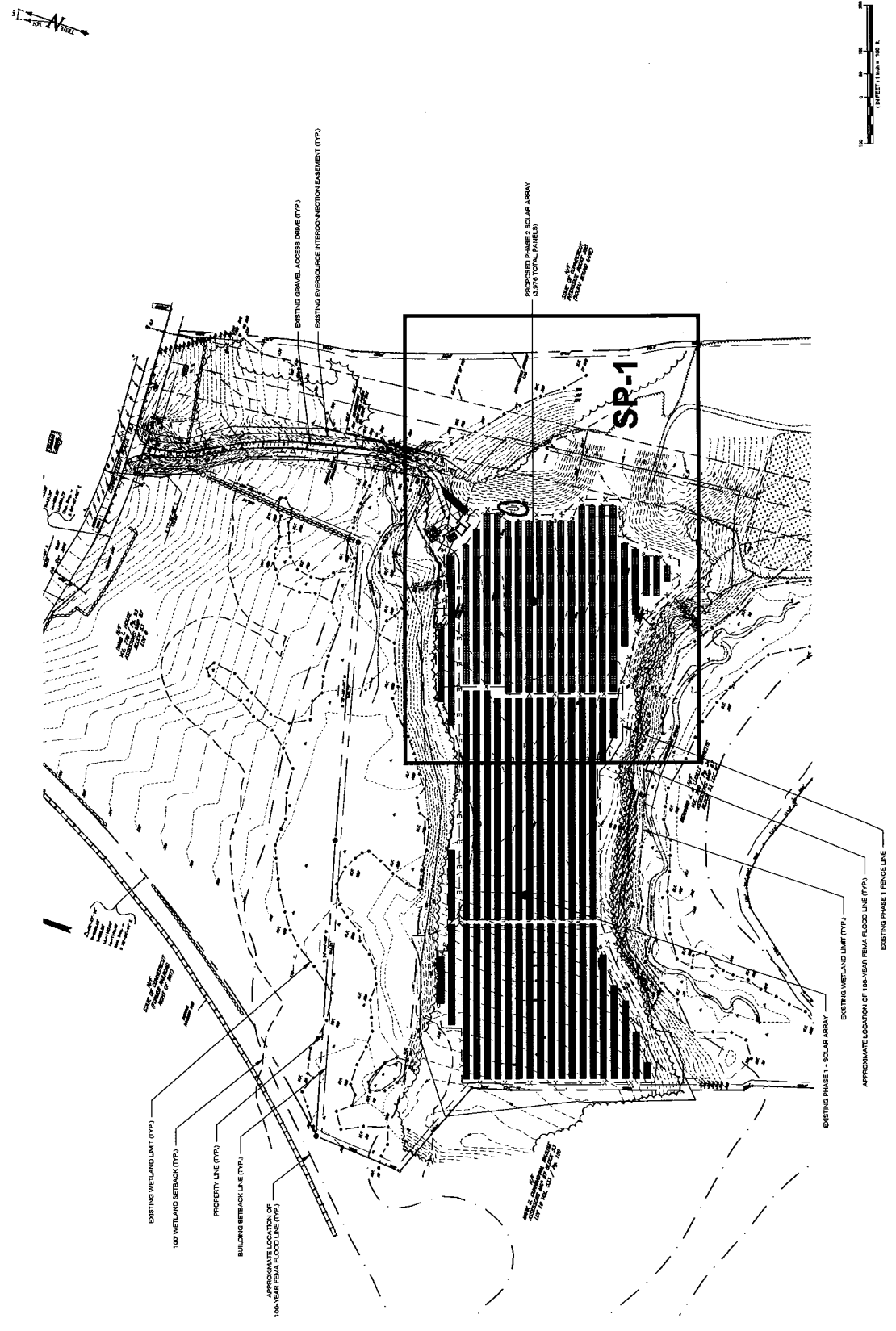

**C-TECSOLAR**  
 1 GRIFFIN ROAD SOUTH  
 SUITE 100  
 OFFICE: (860) 582-1774

**ALL-POINTS**  
 TECHNOLOGY CORPORATION  
 23 WASHINGTON STREET  
 SUITE 100  
 HARTFORD, CT 06103  
 PHONE: (860) 261-0000  
 WWW.ALLPOINTS.COM

NO.	DATE	REVISION
1		ISSUE FOR SUBMISSION, R.P.
2		
3		
4		
5		
6		

DESIGN PROFESSIONALS OF RECORD  
 PROF. BRADLEY J. HARRISON, P.E.  
 ALL-POINTS TECHNOLOGY CORPORATION  
 23 WASHINGTON STREET  
 SUITE 100  
 HARTFORD, CT 06103

NOTE

C-TECSOLAR  
 "BRANETTE FARMS PHASE 2"  
 100 UP LANE  
 ADDRESS: THOMPSON, CT

APR FILED NUMBER: CTW111  
 DRAWN BY: B.M.P.  
 CHECKED BY: B.M.C.  
 DATE: 01/09/18

SHEET TITLE  
**SITE PLAN**

SHEET NUMBER  
**SP-1**

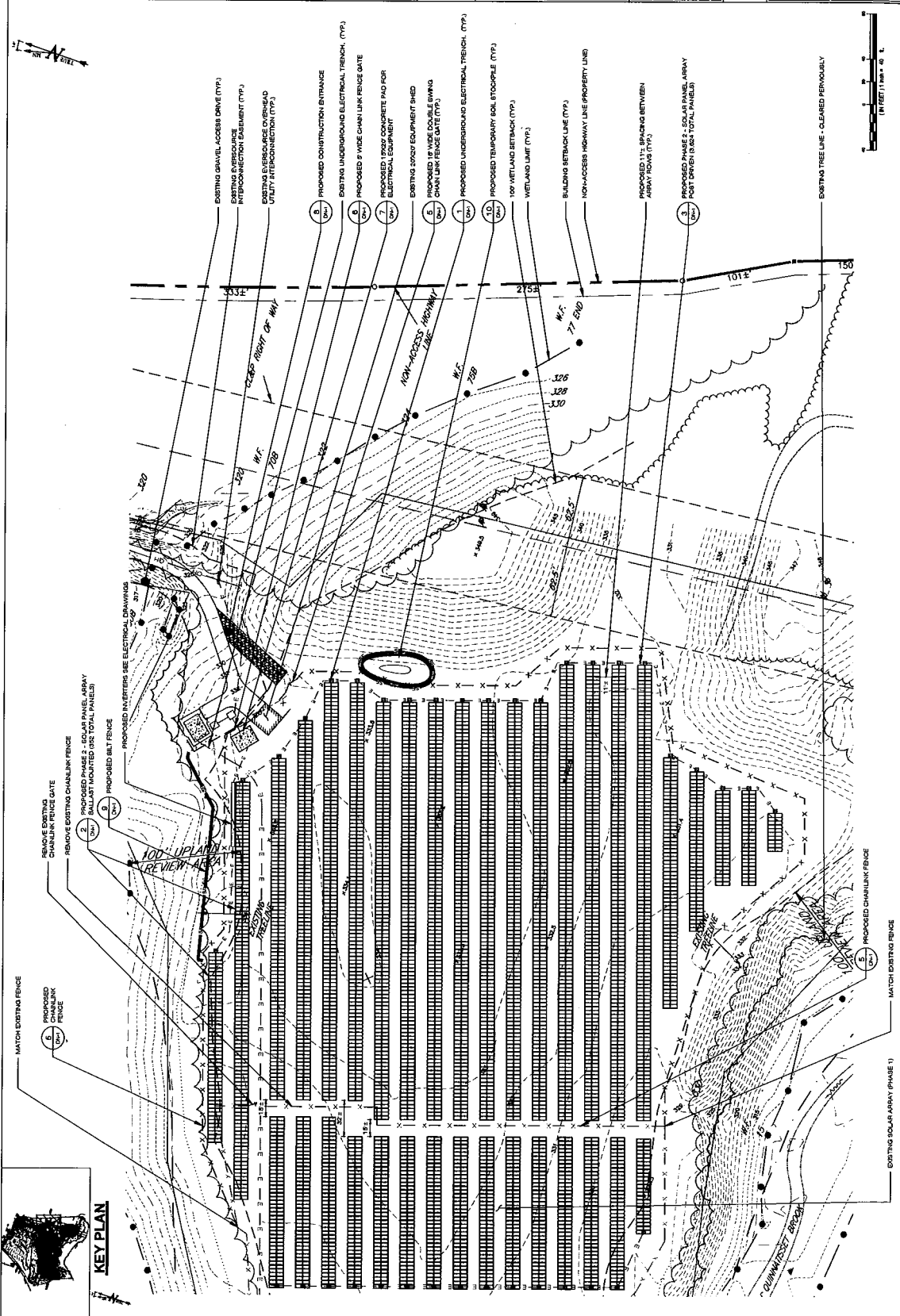

**KEY PLAN**

**HBC-TECSOLAR**  
 1 GREEN ROAD SOUTH  
 GREENSBORO, NC 27409  
 OFFICE: (800) 540-7174

**ALL-POINTS  
 TECHNOLOGY CORPORATION**  
 11111 WILSON ROAD  
 GREENSBORO, NC 27409  
 P.O. BOX 20000  
 WWW.ALLPOINTS.COM

NO.	DATE	REVISION
1	12/15/18	ISSUE FOR PERMITS
2	12/15/18	ISSUE FOR PERMITS
3	12/15/18	ISSUE FOR PERMITS
4	12/15/18	ISSUE FOR PERMITS
5	12/15/18	ISSUE FOR PERMITS

DESIGN PROFESSIONALS OF RECORD  
 PROF. BRADLEY A. PARKS, P.E.  
 COMPANY: ALL-POINTS TECHNOLOGY CORPORATION, P.C.  
 ADDRESS: 3 SADDLEBROOK DRIVE  
 GREENSBORO, NC 27409  
 NOTE:

CITECSOLAR  
 BARRETTTE PARRIS-PHASE 2  
 PROJECT NO. 18-000000  
 ADDRESS: THOMPSON, CT  
 APT. FILING NUMBER: CHA1111  
 DRAWN BY: BJP  
 CHECKED BY: BMC  
 DATE: 03/01/18

SHEET TITLE  
 DETAIL SHEET

SHEET NUMBER  
**DN-1**

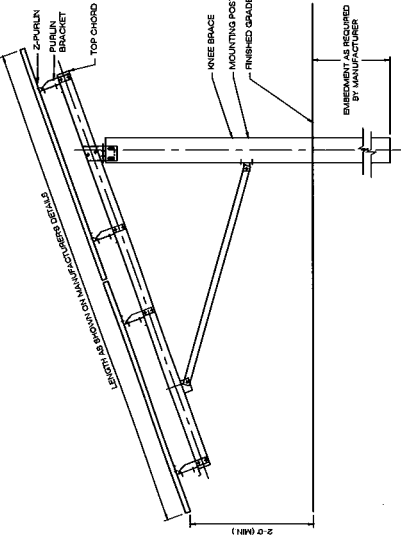

NOTE: SEE MANUFACTURER DETAIL SHEETS FOR ADDITIONAL INFORMATION REGARDING RACKING SYSTEM. RACKING SYSTEM IS TO BE INSTALLED IN ACCORDANCE WITH MANUFACTURER'S REQUIREMENTS.

**1. TYPICAL POST MOUNTED RACKING SYSTEM**  
 SCALE: 1/4"=1'-0"

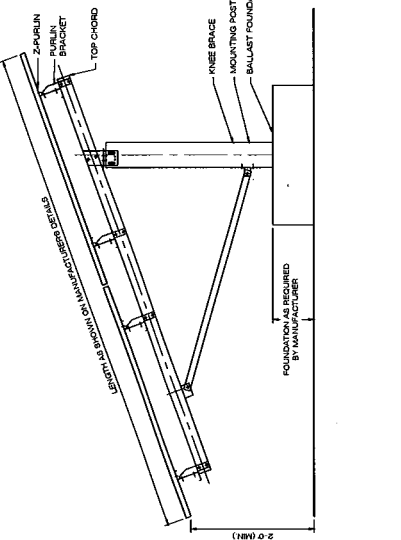

NOTE: SEE MANUFACTURER DETAIL SHEETS FOR ADDITIONAL INFORMATION REGARDING RACKING SYSTEM. RACKING SYSTEM IS TO BE INSTALLED IN ACCORDANCE WITH MANUFACTURER'S REQUIREMENTS.

**2. TYPICAL BALLAST MOUNTED RACKING SYSTEM**  
 SCALE: 1/4"=1'-0"

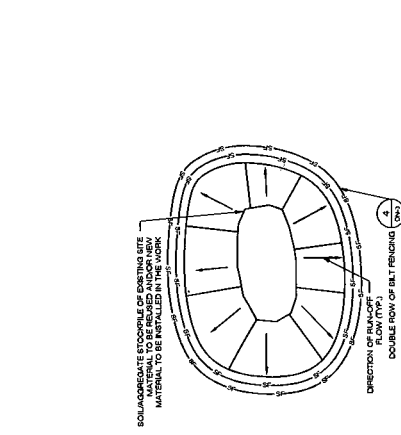

NOTES:  
 1. ALL DRAINAGE EXCAVATED MATERIAL MUST BE PROPERLY GRADED UP TO ALL EXISTING FINISH GRADES.  
 2. SLOPE GRADIENTS MUST BE IN ACCORDANCE WITH THE DRAWINGS.  
 3. STOCKPILE HEIGHTS TO PRE-EXISTING PROJECT CONDITION AND REESED AS REQUIRED.  
 4. STOCKPILE HEIGHTS MUST NOT EXCEED 35'. STOCKPILE SLOPES MUST BE 2:1 OR FLATTER.

**10. MATERIALS STOCKPILE DETAIL**  
 SCALE: 1/4"=1'-0"

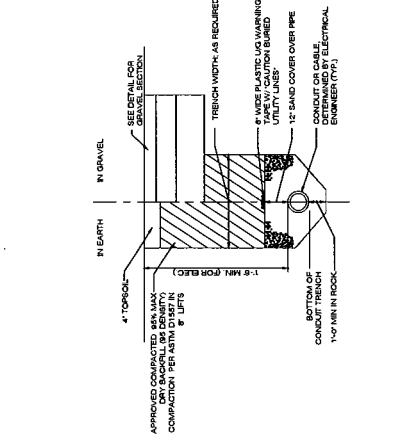

**1. ELECTRICAL TRENCH DETAIL**  
 SCALE: 1/4"=1'-0"

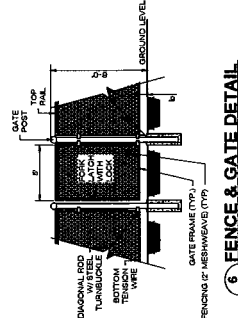

**6. FENCE & GATE DETAIL**  
 SCALE: 1/4"=1'-0"

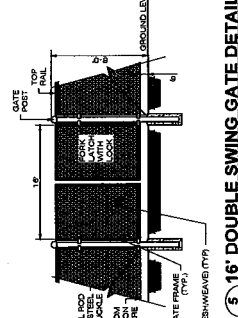

**5. 16' DOUBLE SWING GATE DETAIL**  
 SCALE: 1/4"=1'-0"

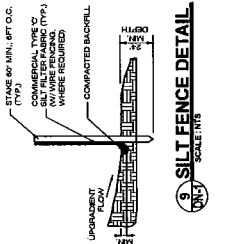

**9. SILT FENCE DETAIL**  
 SCALE: 1/4"=1'-0"

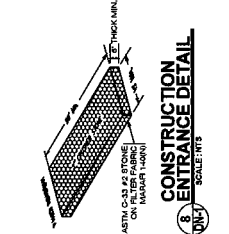

**8. CONSTRUCTION ENTRANCE DETAIL**  
 SCALE: 1/4"=1'-0"

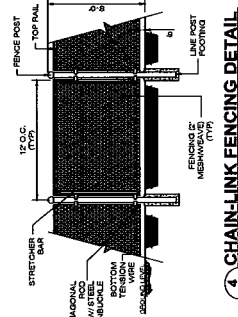

**4. CHAIN-LINK FENCING DETAIL**  
 SCALE: 1/4"=1'-0"

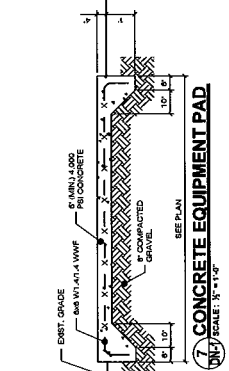

**7. CONCRETE EQUIPMENT PAD**  
 SCALE: 1/4"=1'-0"





