



May 31, 2017

**VIA ELECTRONIC MAIL AND OVERNIGHT MAIL**

Melanie A. Bachman  
Acting Executive Director  
State of Connecticut  
Connecticut Siting Council  
Ten Franklin Square  
New Britain, CT 06051

**Petition No. 1218 – PSEG Power Connecticut LLC  
Bridgeport Harbor Station Unit 5 – Bridgeport, Connecticut  
Monthly Progress Report No. 5 – May 2017**

Dear Ms. Bachman:

This is the May 2017 monthly progress report submittal to the Connecticut Siting Council (CSC) for the new combined cycle generating station designated by PSEG Power Connecticut LLC (PSEG) as the PSEG Bridgeport Harbor Station Unit 5 Combined Cycle Project (BHS 5, the Project or the Facility). Each monthly progress report documents compliance with the CSC's conditions as set forth in the CSC Decision and Order, as well as the two Development and Management Plan (D&MP) approvals. PSEG will continue to provide updates to design or construction plans via this monthly progress reporting process.

A complete CSC Condition Compliance Matrix is included in this report as **Exhibit 1** and will be included in future monthly progress reports to track the CSC's requirements.

**Construction Status Summary**

The project is on schedule. During May, construction progressed with the removal of old foundations, installation of sheet piling and initial fill activities. The old foundation removal is expected to be completed by mid-June. The sheetpile wall is complete. Installation of steel pipe foundation piles is projected to start in early June.

With the completion of the detail piling and rigid inclusion design based on site-specific load test data, the installation of rigid inclusions also commenced in May. Approximately 10% of the rigid inclusions have been installed.

Soil Erosion and Sediment Control installation is complete and is being effectively maintained. The stormwater infiltration trenches have been excavated and fabric / stone installation is in process.

**Connecticut Siting Council  
Bridgeport Harbor Station Unit 5 – Bridgeport, Connecticut  
Monthly Progress Report No. 5 – May 2017**

**Remediation Status Summary**

The second phase of remediation at the site is continuing. As noted in prior monthly submittals, the remaining remediation scope includes the placement of an orange geotextile warning fabric over the soils remaining onsite. To date, approximately 40% of the orange warning fabric has been installed. The material that will be placed under permanent structures (water and fuel oil tanks), in order to remain inaccessible, is stockpiled on-site and will be placed in its final locations as construction progresses. The remediation schedule for the tank farm area (completion in the fall of 2017) remains unchanged.

**Engineering and Regulatory Status Summary**

SNC-Lavalin (SNCL) is continuing with the detailed design for the Project, and major construction and equipment supply contracting remains on schedule. Engineering to support ongoing building permitting is also continuing on schedule to support the site field activities.

SNCL is finalizing underground utility designs to optimize routing, as detailed in the March 2017 Monthly Progress Report No. 3 to the CSC. Revised underground drawings will be provided to the CSC as they are developed and finalized via a D&MP Update (D&MP Update No. 1), targeted for submittal to the CSC in June 2017.

The changes to the stormwater underground conveyance system design were submitted to the Connecticut Department of Energy and Environmental Protection (CT DEEP) and the City of Bridgeport on May 24 for their review. On May 31, CT DEEP concurred that the changes were appropriate for incorporation into the Stormwater Pollution Control Plan. The City of Bridgeport review is in progress. A summary of the stormwater design is included in **Exhibit 2** to this submittal; details will be provided in PSEG's D&MP Update No.1 revision.

Similar to the proposed changes in the underground design detailed above, PSEG and SNCL have also conducted a review of the site water balance with the objective of reducing freshwater requirements and wastewater discharges, where possible, for the various plant operating scenarios. A revised water balance diagram and table of operating cases will also be included in PSEG's D&MP Update No. 1 (the prior water balance was provided in D&MP Phase 2, Exhibit 4).

The proposed changes in the water balance are collectively not significant, but they more accurately represent the anticipated plant operating scenarios. The water balance diagram has been optimized during final design to:

- Provide additional operational flexibility;
- Incorporate additional recycle / reuse opportunities under certain operating conditions;
- Reduce cooling tower and circulating water system fouling potential; and
- Incorporate seasonal variations in cooling tower evaporation rates based on vendor data.

As proposed, PSEG's optimized water balance refinements result in a minor reduction in average annual facility water supply requirements and maintains process wastewater discharge flow and quality characteristics within allowable ranges for discharge to the City of Bridgeport sewer system.

**Connecticut Siting Council  
Bridgeport Harbor Station Unit 5 – Bridgeport, Connecticut  
Monthly Progress Report No. 5 – May 2017**

As part of its ongoing engineering reviews, PSEG has determined that the low pressure natural gas supply to the site is not required. The low pressure gas was intended for firing the Auxiliary Boiler, but after a review of the available gas supply pressures and the gas conditioning / compression design, it has been determined that the high pressure gas supply to the site can be used for the low pressure requirements.

Updates to the natural resource and cultural resource reviews were submitted to CT DEEP in May. No changed conditions were identified and this routine annual re-review documents that conclusion. CT DEEP approved the natural resource review on May 18, 2017; the cultural resource submittal remains under CT DEEP review.

**Offsite Fabrication and Barge Delivery of Equipment / Fill**

The permit application to CT DEEP for the barge delivery of the Heat Recovery Steam Generator (HRSG) is targeted for submittal in June. Delivery of the HRSG and the stack sections to the site is scheduled in the March to May 2018 timeframe. The offloading plans have been reviewed with the CT DEEP, United States Army Corps of Engineers, United States Coast Guard, and the City of Bridgeport Harbor Commission / Harbor Master. Permits are anticipated by the end of 2017.

Fill deliveries by barge will be initiated in late June at the previously identified eastern location on the site. Off-loading of other large equipment from barges include the Combustion Turbine, the Steam Turbine, other ancillary power island equipment, and the Air Cooled Condenser components. These are also expected to be offloaded at the eastern locations. Delivery schedules vary by component.

**Onsite and Offsite Construction Support Facilities**

As previously discussed in prior Monthly Progress Reports and D&MP Phase 1 and Phase 2 submittals, PSEG has entered into a lease agreement and finalized plans to use portions of the adjacent Remington Shaver site for parking, site access, and temporary trailers. Site preparation activities by the owner are expected to begin in June and site access through the property is anticipated to start shortly. This is consistent with the prior submissions to the CSC.

Utilities for the onsite trailer area have been installed and trailer delivery and set-up is ongoing.

PSEG also expects to use existing PSEG-owned properties in the vicinity of the site consistent with their current uses for storage and satellite parking. Offsite areas at leased industrial properties at Pine and Wordin Streets in the City of Bridgeport (approximately one mile from the site) are being evaluated for use for off-hour staging.

**Exhibit 3** to this Monthly Progress Report depicts the various off-site temporary support properties planned for use. Note that the previously submitted (D&MP Phase 1 and 2) drawings are repeated in **Exhibit 3** for convenience.

**Connecticut Siting Council  
Bridgeport Harbor Station Unit 5 – Bridgeport, Connecticut  
Monthly Progress Report No. 5 – May 2017**

**Construction Schedule Update**

There have been no significant changes in the schedule for major activities from the prior reporting period. Minor changes are based on detailed equipment supply and engineering status.

1.	Forward Capacity Auction No. 10	February 10, 2016 (A)
2.	Completion of City of Bridgeport Land Use Permitting	November 1, 2016 (A)
3.	Completion of Non-Air CT DEEP Permitting	February 2017 (A)
4.	Initial City of Bridgeport Building Permit Submittals	February 2017 (A)
5.	Receipt of CT DEEP Final Air Permit	April 11, 2017 (A)
6.	Initiation of Field Construction Activities	April 12, 2017 (A)
a.	Temporary Construction Facilities	November 2016 (A)
b.	Site Work	April 12, 2017 (A)
c.	Foundations	June 2017
d.	Initial Equipment Deliveries	September 2017
e.	Major Equipment Delivery (Turbines, etc.)	November 2017
f.	GIS and Transformer Foundation Installation	June 2017
g.	Gas Turbine Generator (GTG) Installation	December 2017
h.	HRSG Delivery	March to May 2018
i.	Start-up Testing and Commissioning	September 2018
7.	Operational Testing (first GTG operations)	November 2018
8.	Balance of Plant Initial Start-up	September 2018
9.	Performance and Reliability Testing	March 2019
10.	Target Completion	April 2019
11.	Commercial Operations	June 2019

Note: "(A)" refers to ACTUAL

**Status of Prior-Approved Conditions**

Two prior approval conditions for submittal of documentation are addressed in this Monthly Progress Report No. 5. Specifically:

**CSC Conditions 1(p) and 12/23/16-06** - The containment measures for the backup generator engine oil and coolant shall be submitted to the Council.

PSEG is providing the Emergency Diesel Generator (EDG) enclosure / containment vendor data in **Exhibit 4** to this submittal. The 2KW EDG engine and related components are provided as a complete package and are contained within an enclosed building. D&MP Phase 2, Exhibit 3 discussed the fuel oil tank capacity and integral containment. The building enclosure spill containment is sized for approximately 250 gallons and is leak tight. It can contain the full inventory of lubricating oil (107 gallons) and / or coolant (125 gallons) should there be any mechanical failure on the EDG. The door and other openings are elevated to assure that leakage paths do not exist. The vendor supplied drawing is included as **Exhibit 4**, which shows the building in plan and elevation views.

**Connecticut Siting Council  
Bridgeport Harbor Station Unit 5 – Bridgeport, Connecticut  
Monthly Progress Report No. 5 – May 2017**

**CSC Condition 1(s) - Construction laydown area locations**

The discussion above in Onsite and Offsite Construction Support Facilities and in **Exhibit 3** to this submittal includes the information update related to offsite properties intended for use to support construction of BHS 5.

Note that CSC Condition 12/23/16-undesignated (The Council recommends that PSEG consult with Council staff regarding dust control measures for materials delivered by barge) will be addressed in the June Monthly Progress Report as the details of the barge delivery process are still in development.

If you have any questions or require clarification, please contact me at 973-856-0066 or the Project Senior Technical Director / Regulatory Lead, Jeff Pantazes at 856-359-7645.

Very truly yours



David Hinchey, Jr.

Manager Environmental - Major Permits & Technical Services  
PSEG Power LLC  
Fossil Environmental Affairs

**Enclosures - Exhibits:**

- 1. CSC Condition Compliance Matrix**
- 2. Stormwater System Underground Revision Summary**
- 3. Onsite and Offsite Construction Support Facilities**
- 4. Emergency Diesel Generator Enclosure/Containment Drawing**

C Harold Blinderman, Esq  
Franca L. DeRosa, Esq.  
Leilani M. Holgado, Esq.  
Karl Wintermeyer  
Scott Matheson  
Jonathan Howard  
Jeffrey Pantazes  
James R. Morrissey, Esq.

**Connecticut Siting Council  
Bridgeport Harbor Station Unit 5 – Bridgeport, Connecticut  
Monthly Progress Report No. 5 – May 2017**

**Exhibit 1 - CSC Condition Compliance Matrix**

**Connecticut Siting Council**  
**Bridgeport Harbor Station Unit 5 – Bridgeport, Connecticut**  
**Monthly Progress Report No. 5 – May 2017**

<b>CSC Requirement Number</b>	<b>CSC Requirement</b>	<b>D&amp;M Plan Phase 1 Construction Support Facilities</b>	<b>D&amp;M Plan Phase 2 BHS 5 Design</b>	<b>Subsequent Filing Report and Date Closure Status</b>
1(a)	Final site plan showing roads, structures, and other improvements on the site	Partial: construction execution planning process summary included as Exhibit 1. A general update on Project Scope and Design is included as Exhibit 15.	Final structures and other improvements, including buildings, stack, power block, and balance of plant (Exhibits 1 and 2)	Completed
1(b)	Consideration of waste heat as supply for thermal loop or nearby industrial user	N/A	Included (Exhibit 9)	Completed; see CSC Requirement Number 12/23/16-04 below for follow-up requirements.
1(c)	Lighting plan and details to minimize impact on off-site properties	Partial: construction lighting only – Exhibit 9	Final lighting plans (Exhibits 1 and 2)	Completed
1(d)	Final fuel dock rehabilitation plan	Update on status included as Exhibit 7	Status unchanged since D&MP Phase 1 – PSEG will provide an update of this portion of the project by September 30, 2017 after design is completed. See Exhibit 10.	Completed; see CSC Requirement Number 12/23/16-05 below for follow-up actions.
1(e)	Water and sewer connection routes	Partial: temporary construction sewer line connection and other utilities included in Exhibit 9. Note that the status of the UI Exempt Modification request is included as Exhibit 11.	Permanent utility routing included (Exhibits 1 and 2)	Completed
1(f)	Status of site remediation in existing fuel tank area and remaining remediation work - Which areas of contamination will be inaccessible? - Layer showing contaminated soil locations	Remedial Action Plan Addendum included as Exhibit 6. Status of remediation implementation included as Exhibit 5.  Unit 3 tank and unloader status included as Exhibit 4.	Status for remaining work will be included to document final soil placement locations. (Exhibits 7 and 8)	Open – PSEG will submit final remediation status to CSC with a target of October 31, 2017.
1(g)	Natural gas interconnection plan and gas compressor building design and location	N/A	Included (Exhibit 2)	Completed
1(h)	Final Erosion and Sediment Control Plans	Soil Erosion and Sediment Control Plans included in Exhibit 9 as noted in Exhibit 14.  The USACE Jurisdictional Determination is included as Exhibit 13.	SESC plans included in Exhibit 2; they were previously provided in D&MP Phase 1 as well.	Completed
1(i)	Final stormwater design	N/A	Included (Exhibit 2)	Completed

**Connecticut Siting Council**  
**Bridgeport Harbor Station Unit 5 – Bridgeport, Connecticut**  
**Monthly Progress Report No. 5 – May 2017**

<b>CSC Requirement Number</b>	<b>CSC Requirement</b>	<b>D&amp;M Plan Phase 1 Construction Support Facilities</b>	<b>D&amp;M Plan Phase 2 BHS 5 Design</b>	<b>Subsequent Filing Report and Date Closure Status</b>
1(j)	Stormwater Pollution Protection Plan	N/A	Included (Exhibit 15)	Completed
1(k)	Flood Mitigation Plan	N/A	Included (Exhibit 3)	Completed
1(l)	Final plans to demonstrate compliance with CT DEEP noise standards	N/A	Final Noise Study Report Included (Exhibit 14)	Completed
1(m)	Fuel storage and handling plan, including containment and spill protection measures	N/A	Spill Prevention Control and Countermeasures Plan included (Exhibit 18)	Completed
1(n)	Containment measures for step-up transformer dielectric fluids and ULSD storage tank	N/A	Included (Exhibit 3)	Completed
1(o)	Containment and/or protective measures for delivery and storage of hydrogen and aqueous ammonia	N/A	Included (Exhibits 3 and 20)	Completed
1(p)	Backup generator design and containment measures for fuel, oil, and coolant	N/A	Included (Exhibit 3)	Completed: Vendor data included in Exhibit 4 of the May 2017 Monthly Progress Report No. 5
1(q)	Dewatering plan to address groundwater issues during construction	N/A	Stormwater Pollution Control Plan for construction stormwater and dewatering included. (Exhibits 15 and 16)	Completed
1(r)	Detailed project schedules for all work activities and proposed typical construction days and hours	Partial: Schedule update Included as Exhibit 2 and permitting status included as Exhibit 3.	Work hours and schedule update included in Exhibits 3 and 6 respectively.	Completed
1(s)	Construction laydown area locations	Included in Exhibits 8 and 10 including access routings for high trucks.  In addition, the plans for barge delivery of equipment and unloading are included as Exhibit 12.	See Exhibit 3 for an update regarding a lease agreement for an adjoining property	Complete: Submitted information in D&MP Phases 1 and 2 was updated in May 2017 Monthly Progress Report No. 5.
1(t)	Site security measures	Partial: site security for construction discussed in Exhibit 1.	Partial: Site security measures (Exhibit 3)	Completed
1(u)	Final FAA lighting design for the stack and any FAA crane determinations	N/A	Included (Exhibit 3)	Completed



**Connecticut Siting Council**  
**Bridgeport Harbor Station Unit 5 – Bridgeport, Connecticut**  
**Monthly Progress Report No. 5 – May 2017**

<b>CSC Requirement Number</b>	<b>CSC Requirement</b>	<b>D&amp;M Plan Phase 1 Construction Support Facilities</b>	<b>D&amp;M Plan Phase 2 BHS 5 Design</b>	<b>Subsequent Filing Report and Date Closure Status</b>
1(v)	Decommissioning Plan as contingency plan, including infrastructure removal and site restoration plans	N/A	Included (Exhibit 19)	Completed
2	Submit FAA Determinations for temporary structures (cranes) and stack	N/A	N/A	Completed April 11, 2017 via memorandum to the CSC.
3	Submit local permits relative to the discharge of wastewater	N/A	N/A	Completed April 11, 2017 via memorandum to the CSC.
4	Submit final CT DEEP air emissions and water discharge permits	N/A	N/A	Completed April 11, 2017 via memorandum to the CSC.
5	The use of natural gas as a fuel pipeline / system cleaning medium for construction or any future facility modification shall be prohibited.	N/A	N/A	PSEG notes this condition and will retain it as "Open". The provisions of CSC Requirement Number 6 (below) address the specifics of compliance.
6	Submit the information included below in CSC requirement Numbers 6(i) to 6(viii) at least 15 days prior to fuel pipeline / system cleaning medium for construction or any future facility modification.*	N/A	N/A	Open
6(i)*	Identification of cleaning media to be used	N/A	Not currently available. An update will be provided by September 30, 2017.	Open
6(ii)*	Identification of any known hazards through use of selected cleaning media	N/A	Not currently available. An update will be provided by September 30, 2017.	Open
6(iii)*	Description of how known hazards will be mitigated, including applicable state or federal regulations	N/A	Not currently available. An update will be provided by September 30, 2017.	Open
6(iv)*	Identification and description of accepted industry practices or relevant regulations concerning proper use of such media	N/A	Not currently available. An update will be provided by September 30, 2017.	Open

**Connecticut Siting Council**  
**Bridgeport Harbor Station Unit 5 – Bridgeport, Connecticut**  
**Monthly Progress Report No. 5 – May 2017**

<b>CSC Requirement Number</b>	<b>CSC Requirement</b>	<b>D&amp;M Plan Phase 1 Construction Support Facilities</b>	<b>D&amp;M Plan Phase 2 BHS 5 Design</b>	<b>Subsequent Filing Report and Date Closure Status</b>
6(v)*	Detailed narratives/drawings showing location and procedures to be used during pipe cleaning process, including worker safety exclusion zones	N/A	Not currently available. An update will be provided by September 30, 2017.	Open
6(vi)*	Identification of contractor or personnel performing work, including description of past project experience and level of training/qualifications necessary for work	N/A	Not currently available. An update will be provided by September 30, 2017.	Open
6(vii)*	Contact information for special inspector (CT registered engineer with knowledge or experience with electric generating facilities) with written approval by local fire marshal and building inspector	N/A	Not currently available. An update will be provided by September 30, 2017.	Open
6(viii)*	Certification of notice regarding pipe cleaning operations (Submitted to all state agencies listed in CGS §16-50j(g), Dept of Consumer Protection, Dept of Labor, Dept of Emergency Services and Public Protection, Dept of Construction Services, Dept of Emergency Management and Homeland Security, and local fire marshal)	N/A	Not currently available. An update will be provided one month prior to the start date for pipe cleaning. An update will be provided by September 30, 2017 regarding the anticipated schedule.	Open
7	Compliance with specific codes and standards for any fuel pipeline / system cleaning operations related to construction or any future facility modification, as applicable. (Note: the Codes and Standards are listed in the Decision and Order)	N/A	N/A	PSEG notes this condition and will retain it as "Open". The provisions of CSC Requirement Number 6 (above) address the specifics of compliance.
8(i) <sup>†</sup>	Description of results of simulated emergency response activities	N/A	Not currently available. An update will be provided by September 30, 2017.	Open

**Connecticut Siting Council**  
**Bridgeport Harbor Station Unit 5 – Bridgeport, Connecticut**  
**Monthly Progress Report No. 5 – May 2017**

<b>CSC Requirement Number</b>	<b>CSC Requirement</b>	<b>D&amp;M Plan Phase 1 Construction Support Facilities</b>	<b>D&amp;M Plan Phase 2 BHS 5 Design</b>	<b>Subsequent Filing Report and Date Closure Status</b>
8(ii) <sup>†</sup>	Details of any facility site access system that accounts for all personnel entering and leaving the facility	N/A	Not currently available. An update will be provided by September 30, 2017.	Open
8(iii) <sup>†</sup>	Establishment of emergency responder/local community notification system for onsite emergencies and planned construction-related activities	N/A	Not currently available. An update will be provided by September 30, 2017.	Open
9	Unless otherwise approved by the Council, the facility must be constructed within five years of July 22, 2016 (by July 21, 2021) or re-approval by the Council is required.	N/A	N/A	Open: PSEG anticipates completion of BHS 5 by June 1, 2019.
10	Notify the Council within 45 days of the completion of construction.	N/A	N/A	Open
11	Maintain the facility in a reasonable physical and operational condition consistent with the Decision and Order and the approved D&MPs.	N/A	N/A	Noted
12	Provide the Council with a minimum of 30 days written notice when the facility will cease operations.	N/A	N/A	Noted
13	Remit timely payments associated with annual assessments and invoices submitted by the Council.	N/A	N/A	Noted
14	Notify the Council of any change in ownership or contact information within 30 days of the sale and / or transfer.	N/A	N/A	Noted
15	Submit any request for extension as noted in CSC Requirement Number 9 (above) not later than 60 days prior to the expiration, including notice to specific parties and the service list.	N/A	N/A	Noted

**Connecticut Siting Council**  
**Bridgeport Harbor Station Unit 5 – Bridgeport, Connecticut**  
**Monthly Progress Report No. 5 – May 2017**

<b>CSC Requirement Number</b>	<b>CSC Requirement</b>	<b>D&amp;M Plan Phase 1 Construction Support Facilities</b>	<b>D&amp;M Plan Phase 2 BHS 5 Design</b>	<b>Subsequent Filing Report and Date Closure Status</b>
16	The Declaratory Ruling may be transferred subject to being current with payments and an agreement to continue payments as required.	N/A	N/A	Noted
17	Retain a Special Inspector to assist the Fire Marshall to assure compliance with CGS §16-50ii	N/A	N/A	Noted. This will be addressed in the response to CSC Requirement Number 6(vii).
18	Deposit a fee into the Code Training Fund in accordance with CGS § 29-251c.	N/A	N/A	Open. PSEG will work with the City of Bridgeport to establish the timing and amount of the subject fee. This will be addressed in a future Monthly Progress Report prior to the completion of the project.
	<b>D&amp;MP Phase 1 Conditions</b>			
10/31/16-01	Use of off-road construction equipment that meet the latest EPA or California Air Resources Board standards, or in the alternative, equipment with the best available controls on diesel emissions, including but not limited to retrofitting with diesel oxidation catalysts, particulate filters and use of ultra-low sulfur fuel.			Completed: February 2017 Monthly Progress Report.
10/31/16-02	Compliance with the provisions of Section 22a-174-18(b)(3)(C) of the RCSA that limit the idling of mobile sources to 3 minutes.			Completed: February 2017 Monthly Progress Report.
10/31/16-03	The petitioner shall submit the specifications of the fill to the Council			Completed; December 2, 2016 response to Interrogatory CSC D&M-05.
	<b>D&amp;MP Phase 2 Conditions</b>			
12/23/16-01	Same as 10/31/16-01 above			Completed: February 2017 Monthly Progress Report.
12/23/16-02	Same as 10/31/2016-02 above			Completed: February 2017 Monthly Progress Report.

**Connecticut Siting Council**  
**Bridgeport Harbor Station Unit 5 – Bridgeport, Connecticut**  
**Monthly Progress Report No. 5 – May 2017**

<b>CSC Requirement Number</b>	<b>CSC Requirement</b>	<b>D&amp;M Plan Phase 1 Construction Support Facilities</b>	<b>D&amp;M Plan Phase 2 BHS 5 Design</b>	<b>Subsequent Filing Report and Date Closure Status</b>
12/23/2016	Compliance with the reporting requirements under Section 16-50j-62 of the RCSA			Ongoing via Monthly Reporting to continue
12/23/16-04	The final modifications of the plant to accommodate the use of waste heat, if applicable, shall be submitted to the Council for review and approval.			PSEG will provide an update by January 31, 2018.
12/23/16-05	The final fuel dock rehabilitation plan shall be submitted to the Council for review and approval.			PSEG will provide an update by September 30, 2017.
12/23/16-06	The containment measures for the backup generator engine oil and coolant shall be submitted to the Council.			Completed: Vendor data included in Exhibit 4 of the May 2017 Monthly Progress Report No. 5
12/23/16-07	Prior to testing of start-up of the plant, the Certificate Holder shall submit to the council its final plans to comply with the recommendation and conditions relative to Council Docket No. NT-2010 and conditions (6i through 8iii) Council's Decision and Order for Petition No. 1218 relative to plant safety.			PSEG will provide an update by September 30, 2017 as noted in CSC Requirement Numbers 6i to 8iii above.
12/23/16-undesignated	The Council recommends that PSEG consult with Council staff regarding dust control measures for materials delivered by barge.			PSEG intends to submit information in the June 2017 monthly report to address this recommendation.
* 15 days prior to fuel pipeline/system cleaning operations related to construction or any future facility modifications † Submittal of Emergency Response/Safety Plan developed in cooperation with all local public safety officials, DESPP, and other emergency response officials				

**Connecticut Siting Council  
Bridgeport Harbor Station Unit 5 – Bridgeport, Connecticut  
Monthly Progress Report No. 5 – May 2017**

**Exhibit 2 – Stormwater System Underground Revision Summary**

As discussed in this Monthly Progress Report No. 5, PSEG is preparing a Development and Management Plan Update No. 1 for changes to the underground utilities. As part of this future submittal, detail drawings for the stormwater conveyance system will be provided. A summary of the proposed changes is included below.

The stormwater underground conveyance system design has been simplified to allow for optimization of the underground utilities for the new combined cycle plant and to allow for easier installation, operation and maintenance of the stormwater conveyance system. The modified design has eliminated the need for catch basins and subsurface piping throughout the center of the Unit 5 power block area. The new design includes a rock / gravel filled trench with perforated piping as the conveyance system. This drainage system is located along the interior face of the sheetpile retaining wall. The conveyance system will continue to collect stormwater runoff from inside the power block and direct it through the manufactured treatment device (MTD) (Jellyfish Units) for ultimate discharge into Bridgeport Harbor.

The revised design will not result in a change in the Project's Limit of Disturbance (LOD) or an increase in the contributory drainage area being treated by the MTD. The new design will likely result in a reduction in the stormwater discharged through the MTD, as the perimeter collection system design promotes increased storage, transit time, and infiltration from overland flow across the gravel areas within the sheetpile wall.

No changes have been made to the design of the MTDs or the stormwater outfall structure that were included in the original stormwater design for the new plant. This is consistent with the design submitted to the CSC in D&MP Phase 2.

**Connecticut Siting Council  
Bridgeport Harbor Station Unit 5 – Bridgeport, Connecticut  
Monthly Progress Report No. 5 – May 2017**

**Exhibit 3 - Onsite and Offsite Construction Support Facilities**

Offsite PSEG owned and leased properties are shown below. This drawing was previously provided in D&MP Phase 1. PSEG is leasing the Pine Street and Wordin Avenue properties and owns the offsite properties designated as BH-2, BH-3, and BH-4. Note that BH-1 is onsite.

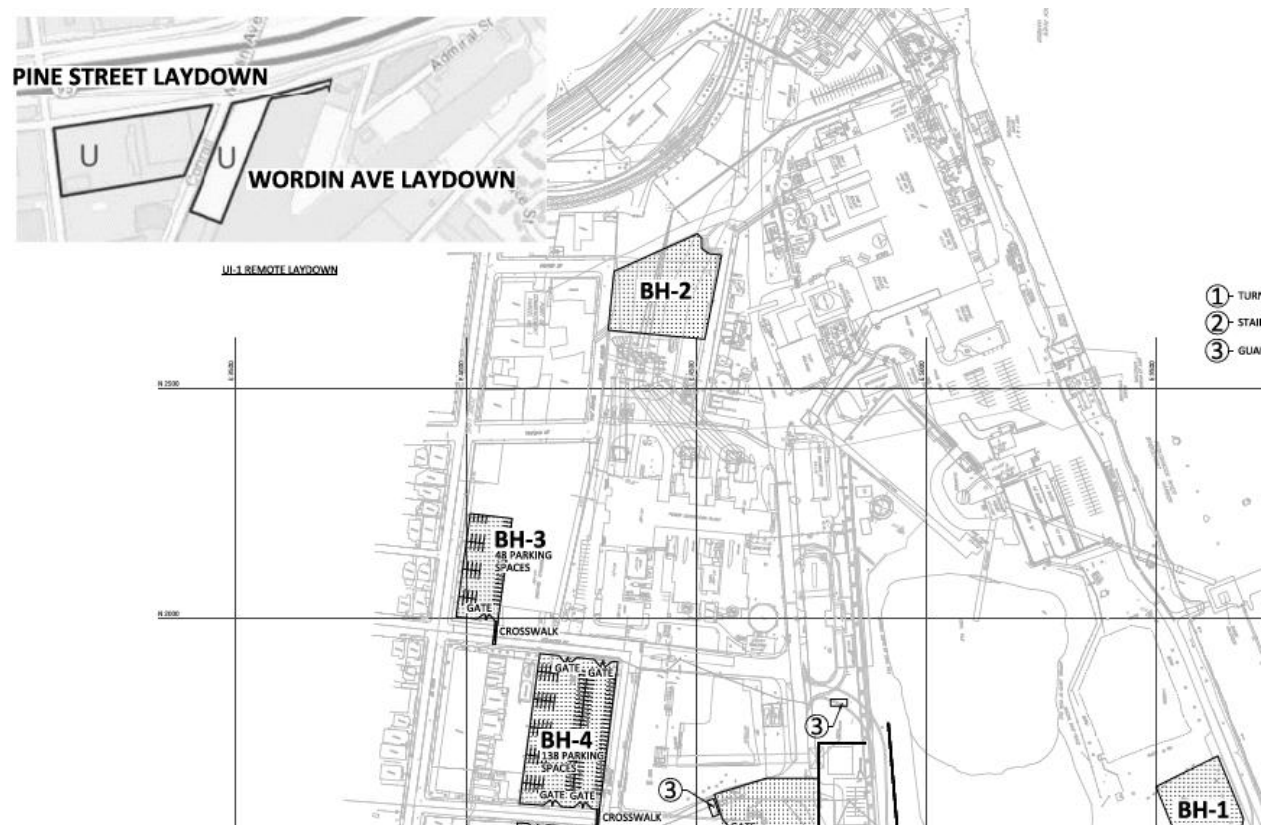

**Connecticut Siting Council  
Bridgeport Harbor Station Unit 5 – Bridgeport, Connecticut  
Monthly Progress Report No. 5 – May 2017**

**Exhibit 3 - Onsite and Offsite Construction Support Facilities (continued)**

The Remington Shaver property is shown below ("R" designated lots). This is consistent with the drawing submitted with D&MP Phase 2.

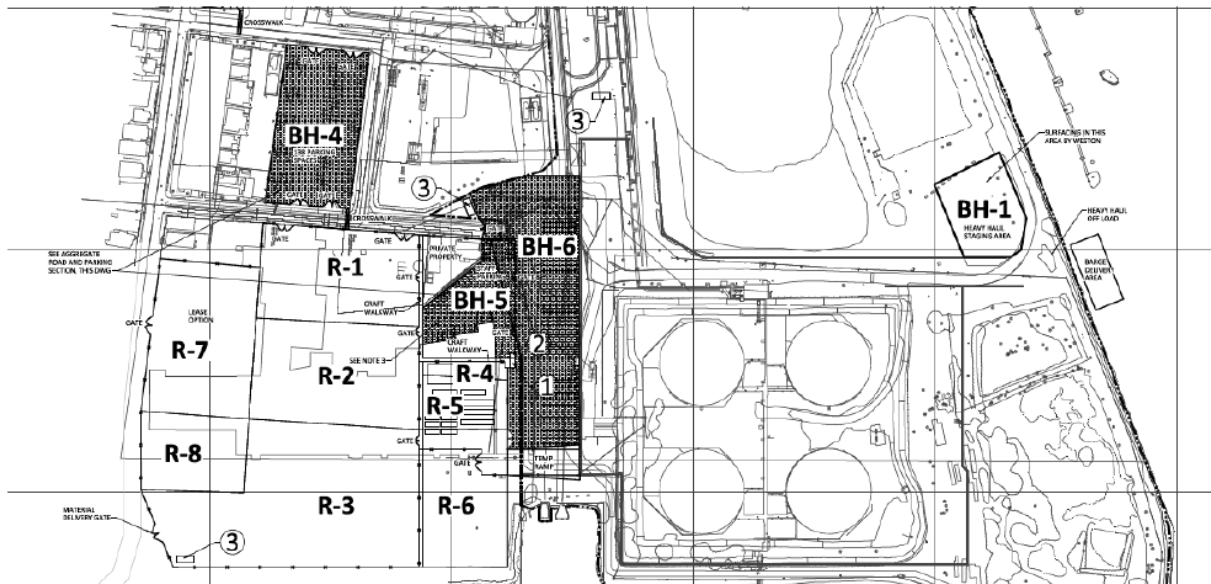



**Connecticut Siting Council  
Bridgeport Harbor Station Unit 5 – Bridgeport, Connecticut  
Monthly Progress Report No. 5 – May 2017**

**Exhibit 4 – Emergency Diesel Generator Enclosure/Containment Drawing**

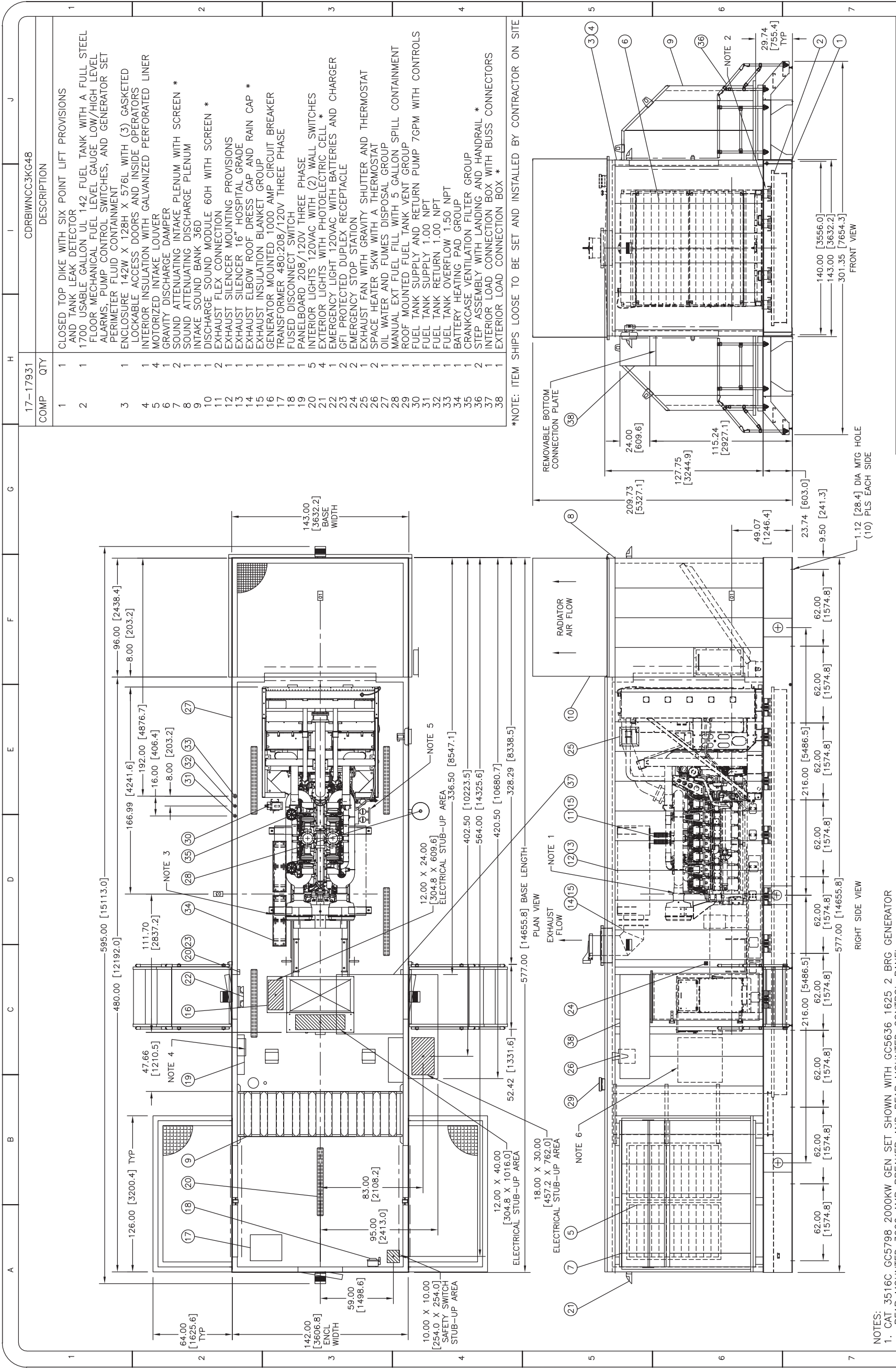

EST. SHIPPING DIMENSIONS  
WIDTH - 149.50 [3797.3]  
HEIGHT - 156.00 [3962.4]  
LENGTH - 582.00 [14782.8]

- NOTES:
- CAT 3516C GC5798 2000KW GEN SET SHOWN WITH GC5636 1625 2 BRG GENERATOR
  - REAR MOUNTED 3000 AMP BREAKER AND REAR MOUNTED CONTROL PANEL
  - CAT 350-2449 VIBRATION ISOLATORS SHOWN
  - CAT BATTERIES RACKS AND CABLE GROUP SHOWN
  - CAT LE0195 PRIMARY FUEL FILTER SHOWN
  - EXL EMERGENCY TRANSFER FUEL LOAD MANAGER SHOWN
  - ENCLOSURE IS DESIGNED TO MEET 2009 INTERNATIONAL BUILDING CODE
  - APPROXIMATE SOUND LEVEL 73 DBA @ 23 FT (FREE FIELD)
  - APPROXIMATE DRY WEIGHT OF PACKAGE = 99500 LB (\* SHIP LOOSE ITEMS = 8750 LB)
  - THIS UNIT IS DESIGNED TO SIT ON A FLAT LEVEL SURFACE NO CROWNING ALLOWED
  - RECOMMEND MINIMUM OF 60.00 [1524.0] BETWEEN THE ENCLOSURE AND ANY OTHER STRUCTURE
  - FOR PROPER VENTILATION REFER TO LOCAL CODE/ORDINANCE FOR ANY FURTHER RESTRICTIONS

ENCLOSURE PACKAGE FOR CAT 3516C GEN SET

THIS PRINT IS THE PROPERTY OF CHILICOthe METAL CO. AND MUST NOT BE USED IN ANY MANNER DETRIMENTAL TO THEIR INTERESTS.		Chilicothe Metal Co. 4507 E. ROME ROAD CHILICOTHE, IL 61523 PH. 309-274-5421 FAX 309-274-4686 WEBSITE: WWW.CMCOUSA.COM	
E	5/12/17	JD	COMP 28, 37, 38 TO BUS
D	5/10/17	AD	COMP 15, 37, 38 TO LHS
C	05/05/17	JB	ADD THREE STUB-UP AREAS
B	05/01/17	JB	ADD COMPS 37 AND 38
A	02/26/17	JB	BASE MOUNTING HOLES WAS (18)
REV	DATE	BY	DESCRIPTION OF CHANGE
REVISION RECORD			
DWG. #		CDBIWNCC3KG48	

ENCLOSURE PACKAGE FOR CAT 3516C GEN SET

Chilicothe Metal Co.  
4507 E. ROME ROAD CHILICOTHE, IL 61523  
PH. 309-274-5421 FAX 309-274-4686  
WEBSITE: WWW.CMCOUSA.COM

W.O. # 17-17931

DATE 02/14/17 ENGR.

DR. JB

CHKD. DURST

DATE 02/14/17 SCALE: 1"=10'SHT 1 OF 1

FILE CD