

January 8, 2019

Melanie Bachman
Acting Executive Director
Connecticut Siting Council
10 Franklin Square
New Britain, CT 06051

RE: NOTICE OF EXEMPT MODIFICATION
239 Middle Turnpike Road, Manchester, CT 06040
AT&T Site CT5448

Dear Ms. Bachman:

Enclosed please find an original and two (2) copies of a Notice of Exempt Modification including drawings, parcel maps, and a check in the amount of six hundred twenty-five dollars (\$625.00) for the filing fee. In addition, I have included three (3) copies of each notification letter to the municipality (which is also the tower and property owner) and to the Department of Planning and Zoning. The proof of delivery is likewise enclosed and consists of a copy of the USPS Tracking Results from the USPS website, acknowledging the date and time of delivery, attached to each letter.

This endeavor merely consists of fiber optic replacement; no work will be performed on the tower or any equipment on the tower. Accordingly, no RF study or structural reports are necessary.

I will submit electronic copies of the filings including proof of delivery to you via e mail this day.

Please feel free to contact me with any questions or comments. Thank you for your kind cooperation in this matter.

Respectfully submitted,

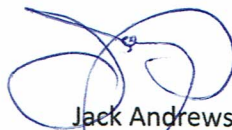

Jack Andrews
Zoning Manager, Empire Telecom
o/b/o AT&T Wireless
10130 Donleigh Drive
Columbia, MD 21046
443-286-4006
jandrews@empiretelecomm.com

Enclosures

10130 Donleigh Drive
Columbia, MD 21046
443-677-0144

January 4, 2019

The Honorable Jay Moran
Town of Manchester
41 Center Street
P.O. Box 191
Manchester, CT 06045-0191

RE: AT&T Wireless Modifications to Telecommunication Facility –
239 Middle Turnpike Road, Manchester, CT 06040

Dear Mayor Moran:

In order to accommodate technological changes, implement the Uniform Mobile Telecommunications System and enhance system performance in the State of Connecticut, AT&T Wireless ("AT&T") will be installing replacement fiber optic cable at the above referenced telecommunications facility. AT&T Wireless currently maintains a wireless telecommunications facility on a 190-foot-tall monopole tower located at 239 Middle Turnpike Road, in Manchester, CT 06040. The tower is owned by the Town of Manchester. The property is owned by Town of Manchester.

AT&T Wireless now seeks to install new fiber optic cable at this site, which requires installing one NID on the existing H-Frame; installing one new handhole; installing new 4 inch PVC pipe/conduit for the proposed telco; installing new 2 inch PVC pipe/conduit for the proposed telco; and installing new 1 inch PVC pipe/conduit for the proposed telco.

No work or alterations will be performed on the tower or on any equipment attached thereto. Empire Telecommunications USA LLC has been tasked with laying the infrastructure for the new fiber optic cable; actual installation of the new fiber optic cable will be performed by a cable provider at a later date.

This letter is intended to serve as the required notice to the Municipality, the tower owner and the property owner. As required by the Regulations of Connecticut State Agencies ("RCSA") section 16-50j-73, the Connecticut Siting Council ("CSC") has been notified of the proposed changes and will review AT&T's proposal. Please accept this letter as notification under RCSA section 16-50j-73 of construction which constitutes an exempt modification pursuant to RCSA section 16-50j-72(b)(2).

The enclosed letter and documents to the CSC fully describes AT&T's proposal for the above referenced site. However, if you have any questions or require any additional information concerning our plans or the CSC procedures, please contact me at 443-677-0144 or contact Melanie Bachman, Acting Executive Director of the CSC at 860-872-2935.

Respectfully submitted,

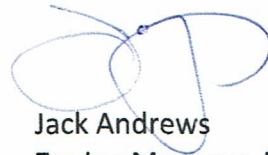

Jack Andrews
Zoning Manager, Empire Telecom
o/b/o AT&T Wireless
10130 Donleigh Drive
Columbia, MD 21046
443-677-0144
jandrews@empiretelecomm.com

Enclosures

cc: Melanie Bachman, Connecticut Siting Council

January 4, 2019

Gary Anderson, Director of Planning
Town of Manchester
41 Center Street
P.O. Box 191
Manchester, CT 06045-0191

RE: AT&T Wireless Modifications to Telecommunication Facility –
239 Middle Turnpike Road, Manchester, CT 06040

Dear Mr. Anderson:

In order to accommodate technological changes, implement the Uniform Mobile Telecommunications System and enhance system performance in the State of Connecticut, AT&T Wireless ("AT&T") will be installing replacement fiber optic cable at the above referenced telecommunications facility. AT&T Wireless currently maintains a wireless telecommunications facility on a 190-foot-tall monopole tower located at 239 Middle Turnpike Road, in Manchester, CT 06040. The tower is owned by the Town of Manchester. The property is owned by Town of Manchester.

AT&T Wireless now seeks to install new fiber optic cable at this site, which requires installing one NID on the existing H-Frame; installing one new handhole; installing new 4 inch PVC pipe/conduit for the proposed telco; installing new 2 inch PVC pipe/conduit for the proposed telco; and installing new 1 inch PVC pipe/conduit for the proposed telco.

No work or alterations will be performed on the tower or on any equipment attached thereto. Empire Telecommunications USA LLC has been tasked with laying the infrastructure for the new fiber optic cable; actual installation of the new fiber optic cable will be performed by a cable provider at a later date.

This letter is intended to serve as the required notice to the Manchester Planning Department. As required by the Regulations of Connecticut State Agencies ("RCSA") section 16-50j-73, the Connecticut Siting Council ("CSC") has been notified of the proposed changes and will review AT&T's proposal. Please accept this letter as notification under RCSA section 16-50j-73 of construction which constitutes an exempt modification pursuant to RCSA section 16-50j-72(b)(2).

The enclosed letter and documents to the CSC fully describes AT&T's proposal for the above referenced site. However, if you have any questions or require any additional information concerning our plans or the CSC procedures, please contact me at 443-677-0144 or contact Melanie Bachman, Acting Executive Director of the CSC at 860-872-2935.

Respectfully submitted,



Jack Andrews
Zoning Manager, Empire Telecom
o/b/o AT&T Wireless
10130 Donleigh Drive
Columbia, MD 21046
443-677-0144
jandrews@empiretelecomm.com

Enclosures

cc: Melanie Bachman, Connecticut Siting Council

Jack Andrews
Zoning Manager, Empire Telecom
o/b/o AT&T Wireless
10130 Donleigh Drive
Columbia, MD 21046
443-286-4007
jandrews@empiretelecomm.com

January 4, 2019

Melanie Bachman
Acting Executive Director
Connecticut Siting Council
10 Franklin Square
New Britain, CT 06051

NOTICE OF EXEMPT MODIFICATION

239 Middle Turnpike Road, Manchester, CT 06040

Lat: 41-47-04 (41.78444444)
Long. 72-30-42 (-72.51166667)

Dear Ms. Bachman:

AT&T Wireless currently maintains a wireless telecommunications facility on a 190-foot-tall monopole tower located at 239 Middle Turnpike Road, in Manchester, CT 06040. The tower is owned by the Town of Manchester. The property is owned by Town of Manchester.

AT&T Wireless now seeks to install new fiber optic cable at this site, which requires installing one NID on the existing H-Frame; installing one new handhole; installing new 4 inch PVC pipe/conduit for the proposed telco; installing new 2 inch PVC pipe/conduit for the proposed telco; and installing new 1 inch PVC pipe/conduit for the proposed telco.

No work or alterations will be performed on the tower or on any equipment attached thereto. Empire Telecommunications USA LLC has been tasked with laying the infrastructure for the new fiber optic cable; actual installation of the new fiber optic cable will be performed by a cable provider at a later date.

The facility was approved by the Connecticut Siting Council in EM-CING-077-150526 on June 15, 20165. Eight (8) conditions were enumerated in the Council's decision: 1) Reinforcements shall be made in accordance with the structural analysis report prepared by Hudson Design Group, stamped/dated April 10, 2015 by Gi Kai Wang and drawings stamped by Daniel Hamm; 2) Within 45 days of installation, AT&T shall provide documentation certified by a Professional Engineer that its installation complied with the recommendations of the structural analysis; 3) Any deviation from the proposed modification as specified in this notice and supporting materials with the Council shall render this acknowledgement invalid; 4) Any material changes to the modification as proposed shall require the filing of a new Notice with the Council; 5) Within 45 days after the completion of construction the Council shall be notified in writing that the

construction has been completed; 6) Any nonfunctioning antenna and associated antenna mounting equipment on this facility owned and operated by New Cingular Wireless (AT&T) shall be removed within 60 days of the date the antenna ceased to function; 7) the validity of the action shall expire one year from the date of the letter; and 8) the applicant may file a request an extension of time beyond the one year deadline provided that such a request is submitted to the Council not less than 60 days prior to the expiration.

Please accept this letter as notification pursuant to Regulations of Connecticut State Agencies section 16-50j-73 for construction that constitutes an exempt modification pursuant to RCSA section 16-50j-72(b)(2). In accordance with RCSA section 16-50j-73, a copy of this letter and attachments is being sent to the Honorable Jay Moran, Mayor of Manchester and property owner; and to Gary Anderson, the Manchester Director of Planning and Economic Development.

The planned modifications to the facility fall squarely within those activities expressly provided for in RCSA section 50j-72(b)(2).

1. The proposed modifications will not result in an increase in height of the existing structure.
2. The proposed modifications will not require an extension of the site boundary.
3. The proposed modifications will not increase noise levels at the facility by six decibels or more, or to levels that will exceed state and local limits.
4. The operation of the replacement antennas will not increase radio frequency emissions at the facility to a level at or above the Federal Communications Commission safety standard.
5. The proposed modifications will not cause a change or alteration in the physical or environmental characteristics of the site.
6. No new tower loading is proposed.

For the foregoing reasons, AT&T Wireless respectfully submits that the proposed modifications to the above referenced telecommunications facility constitute an exempt modification under RCSA section 16-50j-72(b)(2).

Respectfully submitted,

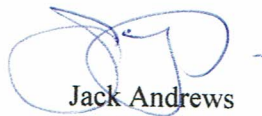

Jack Andrews
Zoning Manager, Empire Telecom
o/b/o AT&T Wireless
10130 Donleigh Drive
Columbia, MD 21046
443-286-4007
jandrews@empiretelecomm.com

Enclosures

cc: Honorable Jay Moran, as Mayor of Manchester and as both tower and property owner
Gary Anderson, the Manchester Director of Planning and Economic Development

PROJECT NOTES

- 1. SITE INFORMATION OBTAINED FROM THE FOLLOWING:
A. PLAN ENTITLED "MANCHESTER CENTRAL" PREPARED BY CENTEK ENGINEERING OF BRANFORD, CT LAST REVISED 06/26/17.
2. THE CONTRACTOR SHALL COMPLY WITH ALL APPLICABLE CODES, ORDINANCES, LAWS AND REGULATIONS OF ALL MUNICIPALITIES, UTILITY COMPANIES OR OTHER PUBLIC/GOVERNING AUTHORITIES.
3. THE CONTRACTOR SHALL BE RESPONSIBLE FOR OBTAINING ALL PERMITS AND INSPECTIONS THAT MAY BE REQUIRED BY ANY FEDERAL, STATE, COUNTY OR MUNICIPAL AUTHORITIES.
4. THE CONTRACTOR SHALL NOTIFY THE CONSTRUCTION MANAGER, IN WRITING, OF ANY CONFLICTS, ERRORS OR OMISSIONS PRIOR TO THE SUBMISSION OF BIDS OR PERFORMANCE OF WORK.
5. THE CONTRACTOR SHALL BE RESPONSIBLE FOR PROTECTING ALL EXISTING SITE IMPROVEMENTS PRIOR TO COMMENCING CONSTRUCTION. THE CONTRACTOR SHALL REPAIR ANY DAMAGE AS A RESULT OF CONSTRUCTION OF THIS FACILITY AT THE CONTRACTOR'S EXPENSE TO THE SATISFACTION OF THE OWNER.
6. THE SCOPE OF WORK FOR THIS PROJECT SHALL INCLUDE PROVIDING ALL MATERIALS, EQUIPMENT AND LABOR REQUIRED TO COMPLETE THIS PROJECT. ALL EQUIPMENT SHALL BE INSTALLED IN ACCORDANCE WITH MANUFACTURER'S RECOMMENDATIONS.
7. THE CONTRACTOR SHALL VISIT THE PROJECT SITE PRIOR TO SUBMITTING THE BID TO VERIFY THAT THE PROJECT CAN BE CONSTRUCTED IN ACCORDANCE WITH THE CONTRACT DOCUMENTS AND CONSTRUCTION DRAWINGS.
8. THE CONTRACTOR SHALL VERIFY ALL EXISTING DIMENSIONS AND CONDITIONS PRIOR TO COMMENCING ANY WORK. ALL DIMENSIONS OF EXISTING CONSTRUCTION SHOWN ON THESE DRAWINGS MUST BE VERIFIED. THE CONTRACTOR SHALL NOTIFY THE CONSTRUCTION MANAGER OF ANY DISCREPANCIES PRIOR TO ORDERING MATERIAL OR PROCEEDING WITH CONSTRUCTION.
9. SINCE THE CELL SITE MAY BE ACTIVE, ALL SAFETY PRECAUTIONS MUST BE TAKEN WHEN WORKING AROUND HIGH LEVELS OF ELECTROMAGNETIC RADIATION. EQUIPMENT SHOULD BE SHUTDOWN PRIOR TO PERFORMING ANY WORK THAT COULD EXPOSE THE WORKERS TO DANGER. PERSONAL RF EXPOSURE MONITORS ARE REQUIRED TO BE WORN TO ALERT OF ANY POTENTIALLY DANGEROUS EXPOSURE LEVELS.
10. THE PROPOSED FACILITY WILL CAUSE NO INCREASE IN STORM WATER RUNOFF, THEREFORE, NO DRAINAGE STRUCTURES ARE PROPOSED.
11. NO NOISE, SMOKE, DUST OR ODOR WILL RESULT FROM THIS FACILITY AS TO CAUSE A NUISANCE.
12. THE FACILITY IS UNMANNED AND NOT FOR HUMAN HABITATION (NO HANDICAP ACCESS IS REQUIRED).
13. THE FACILITY DOES NOT REQUIRE POTABLE WATER OR SANITARY SERVICE.
14. CONTRACTOR SHALL VERIFY ANTENNA ELEVATION AND AZIMUTHS WITH RF ENGINEERING PRIOR TO INSTALLATION.
15. THE TOWER, MOUNTS AND ANTENNAS SHALL BE DESIGNED TO MEET EIA/TIA-222-G AS PER IBC REQUIREMENTS.
16. ALL STRUCTURAL ELEMENTS SHALL BE HOT DIPPED GALVANIZED STEEL.
17. CONTRACTOR MUST FIELD LOCATE ALL EXISTING UNDERGROUND UTILITIES PRIOR TO ANY EXCAVATION.
18. CONSTRUCTION SHALL NOT COMMENCE UNTIL COMPLETION OF A PASSING STRUCTURAL ANALYSIS CERTIFIED BY A LICENSED PROFESSIONAL ENGINEER. THE STRUCTURAL ANALYSIS IS TO BE PERFORMED BY OTHERS.
19. CONTRACTOR SHALL CONTACT STATE SPECIFIC ONE CALL SYSTEM THREE WORKING DAYS PRIOR TO ANY EARTH MOVING ACTIVITIES.



SITE NAME: MANCHESTER CENTRAL
FA NUMBER: 10071105
SITE NUMBER: CT5448
239 MIDDLE TURNPIKE EAST
MANCHESTER, CT 06040
HARTFORD COUNTY

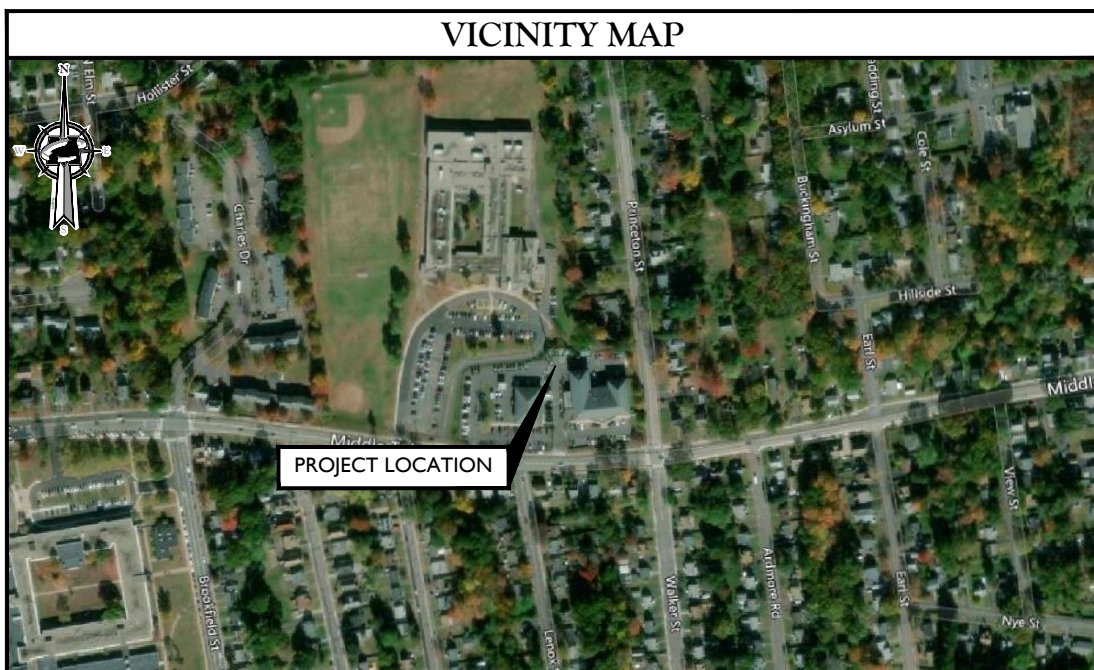

PROJECT LOCATION

PROJECT INFORMATION

SITE INFORMATION

LATITUDE: 41.7844° N
LONGITUDE: 72.51175° W
JURISDICTION: TOWN OF MANCHESTER

APPLICANT/LESSEE

COMPANY: NEW CINGULAR WIRELESS PCS, LLC
ADDRESS: 550 COCHITUATE ROAD
CITY, STATE, ZIP: FRAMINGHAM, MA 01701

STRUCTURE OWNER

COMPANY: T.B.D.
ADDRESS: T.B.D.
CITY, STATE, ZIP: T.B.D.

CLIENT REPRESENTATIVE

COMPANY: EMPIRE TELECOM
ADDRESS: 16 ESQUIRE ROAD
CITY, STATE, ZIP: BILLERICA, MA 01862
CONTACT: DAVID COOPER
E-MAIL: DCOOPER@EMPIRETELECOM.COM

SITE ACQUISITION

COMPANY: EMPIRE TELECOM
ADDRESS: 16 ESQUIRE ROAD
CITY, STATE, ZIP: BILLERICA, MA 01862
CONTACT: DAVID COOPER
E-MAIL: DCOOPER@EMPIRETELECOM.COM

ENGINEER

COMPANY: MASER CONSULTING P.A.
ADDRESS: 331 NEWMAN SPRINGS ROAD, SUITE 203
CITY, STATE, ZIP: RED BANK, NJ 07701-5669
CONTACT: ROBERT ANDREWS
PHONE: (856) 797-0412
E-MAIL: RANDREWS@MASERCONSULTING.COM

SHEET INDEX

Table with columns: SHEET, DESCRIPTION. Rows include T-I (TITLE SHEET), GN-I (GENERAL NOTES), C-I (PARTIAL SITE PLAN AND DETAILS).

SCOPE OF WORK

- INSTALL (1) NID ON EXISTING H-FRAME
• INSTALL (1) NEW HANDHOLE
• INSTALL NEW 4" PVC FOR PROPOSED TELCO
• INSTALL NEW 2" PVC FOR PROPOSED TELCO
• INSTALL NEW 1" PVC FOR PROPOSED TELCO

CODE COMPLIANCE

ALL WORK AND MATERIALS SHALL BE PERFORMED AND INSTALLED IN ACCORDANCE WITH THE CURRENT EDITIONS OF THE FOLLOWING CODES AS ADOPTED BY THE LOCAL GOVERNING AUTHORITIES. NOTHING IN THESE PLANS IS TO BE CONSTRUED TO PERMIT WORK NOT CONFORMING TO THE LATEST EDITIONS OF THE FOLLOWING CODES.

- 1. 2018 CONNECTICUT STATE BUILDING CODE, INCORPORATING THE 2015 IBC
2. 2017 NATIONAL ELECTRICAL CODE - NFPA 70
3. 2017 NFPA 101
4. AMERICAN INSTITUTE OF STEEL CONSTRUCTION 360-10
5. AMERICAN CONCRETE INSTITUTE
6. TIA-222-G
7. TIA 607 FOR GROUNDING
8. INSTITUTE FOR ELECTRICAL AND ELECTRONICS ENGINEERS 81 IEEE C2 LATEST EDITION
9. TELCORDIA GR-1275
10. ANSI T1.311
11. PROPOSED USE: UNMANNED TELECOM FACILITY
12. HANDICAP REQUIREMENTS: FACILITY IS UNMANNED AND NOT FOR HUMAN HABITATION. HANDICAPPED ACCESS NOT REQUIRED.
13. CONSTRUCTION TYPE: IIB
14. USE GROUP: U

COPYRIGHT © 2018

MASER CONSULTING CONNECTICUT
ALL RIGHTS RESERVED

THIS DRAWING AND ALL THE INFORMATION CONTAINED HEREIN IS AUTHORIZED FOR USE ONLY BY THE PARTY FOR WHOM THE WORK WAS CONTRACTED OR TO WHOM IT IS CERTIFIED. THIS DRAWING MAY NOT BE COPIED, REUSED, DISCLOSED, DISTRIBUTED OR RELIED UPON FOR ANY OTHER PURPOSE WITHOUT THE EXPRESS WRITTEN CONSENT OF MASER CONSULTING CONNECTICUT.



Customer Loyalty through Client Satisfaction
www.maserconsulting.com
Engineers ■ Planners ■ Surveyors
Landscape Architects ■ Environmental Scientists

Copyright © 2018 Maser Consulting Connecticut. All Rights Reserved. This drawing and all the information contained herein is authorized for use only by the party for whom the services were contracted or to whom it is certified. This drawing may not be copied, reused, disclosed, distributed or relied upon for any other purpose without the express written consent of Maser Consulting Connecticut.



PROTECT YOURSELF
ALL STATES REQUIRE NOTIFICATION OF EXCAVATORS, DESIGNERS, OR ANY PERSON PREPARING TO DISTURB THE EARTH'S SURFACE ANYWHERE IN ANY STATE.
Know what's below. Call before you dig.
FOR STATE SPECIFIC DIRECT PHONE NUMBERS VISIT: WWW.CALL811.COM

Table with columns: SCALE, JOB NUMBER, AS SHOWN, 18963048A. Includes a grid for revision control with columns for REV, DATE, DESCRIPTION, DRAWN BY, CHECKED BY.

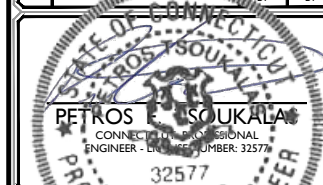

IT IS A VIOLATION OF LAW FOR ANY PERSON, UNLESS THEY ARE ACTING UNDER THE DIRECTION OF THE RESPONSIBLE LICENSED PROFESSIONAL ENGINEER, TO REPRODUCE OR TRANSMIT THIS DOCUMENT.

SITE NAME:

MANCHESTER CENTRAL
FA# 10071105
SITE# CT5448
239 MIDDLE TURNPIKE EAST
MANCHESTER, CT 06040
HARTFORD COUNTY

RED BANK OFFICE
331 Newman Springs Road
Suite 203
Red Bank, NJ 07701-5669
Phone: 732.383.1950
Fax: 732.383.1984
email: solutions@maserconsulting.com

SHEET TITLE: TITLE SHEET
SHEET NUMBER: T-I

GENERAL NOTES:

- THE SUBCONTRACTOR SHALL REVIEW AND INSPECT THE EXISTING FACILITY GROUNDING SYSTEM (AS DESIGNED AND INSTALLED) FOR STRICT COMPLIANCE WITH THE NEC (AS ADOPTED BY THE AHJ), THE SITE-SPECIFIC (UL, LPL OR NFPA) LIGHTING PROTECTION CODE, AND GENERAL COMPLIANCE WITH TELCORDIA AND TIA GROUNDING STANDARDS. THE SUBCONTRACTOR SHALL REPORT ANY VIOLATIONS OR ADVERSE FINDINGS TO THE CONTRACTOR FOR RESOLUTION.
- ALL GROUND ELECTRODE SYSTEMS (INCLUDING TELECOMMUNICATION, RADIO, LIGHTNING PROTECTION, AND AC POWER GES'S) SHALL BE BONDED TOGETHER, AT OR BELOW GRADE, BY TWO OR MORE COPPER BONDING CONDUCTORS IN ACCORDANCE WITH THE NEC.
- THE SUBCONTRACTOR SHALL PERFORM IEEE FALL-OF-POTENTIAL RESISTANCE TO EARTH TESTING (PER IEEE 1100 AND 81) FOR GROUND ELECTRODE SYSTEMS. THE SUBCONTRACTOR SHALL FURNISH AND INSTALL SUPPLEMENTAL GROUND ELECTRODES AS NEEDED TO ACHIEVE A TEST RESULT OF 50 HMS OR LESS.
- THE SUBCONTRACTOR IS RESPONSIBLE FOR PROPERLY SEQUENCING GROUNDING AND UNDERGROUND CONDUIT INSTALLATION AS TO PREVENT ANY LOSS OF CONTINUITY IN THE GROUNDING SYSTEM OR DAMAGE TO THE CONDUIT.
- METAL CONDUIT AND TRAY SHALL BE GROUNDED AND MADE ELECTRICALLY CONTINUOUS WITH LISTED BONDING FITTINGS OR BY BONDING ACROSS THE DISCONTINUITY WITH #6 AWG COPPER WIRE UL APPROVED GROUNDING TYPE CONDUIT CLAMPS.
- METAL RACEWAY SHALL NOT BE USED AS THE NEC REQUIRED EQUIPMENT GROUND CONDUCTOR. STRANDED COPPER CONDUCTORS WITH GREEN INSULATION, SIZED IN ACCORDANCE WITH THE NEC, SHALL BE FURNISHED AND INSTALLED WITH THE POWER CIRCUITS TO BTS EQUIPMENT.
- EACH BTS CABINET FRAME SHALL BE DIRECTLY CONNECTED TO THE EQUIPMENT GROUND RING WITH GREEN INSULATED SUPPLEMENTAL EQUIPMENT GROUND WIRES, 6 AWG STRANDED COPPER OR LARGER FOR INDOOR BTS; 2 AWG STRANDED COPPER FOR OUTDOOR BTS.
- CONNECTIONS TO THE GROUND BUS SHALL NOT BE DOUBLED UP OR STACKED. BACK TO BACK CONNECTIONS ON OPPOSITE SIDES OF THE GROUND BUS ARE PERMITTED.
- ALL EXTERIOR GROUND CONDUCTORS BETWEEN EQUIPMENT/GROUND BARS AND THE GROUND RING, SHALL BE #2 AWG SOLID TINNED COPPER UNLESS OTHERWISE INDICATED.
- ALUMINUM CONDUCTOR OR COPPER CLAD STEEL CONDUCTOR SHALL NOT BE USED FOR GROUNDING CONNECTIONS.
- USE OF 90° BENDS IN THE PROTECTION GROUNDING CONDUCTORS SHALL BE AVOIDED WHEN 45° BENDS CAN BE ADEQUATELY SUPPORTED. ALL BENDS SHALL BE MADE WITH 12" RADIUS OR LARGER.
- EXOTHERMIC WELDS SHALL BE USED FOR ALL GROUNDING CONNECTIONS BELOW GRADE.
- ALL GROUND CONNECTIONS ABOVE GRADE (INTERIOR) SHALL BE FORMED USING HIGH PRESS CRIMPS EXCEPT FOR GROUND BAR CONNECTION FROM MGB TO OUTSIDE EXTERIOR GROUND SHALL ALL BE CADWELD CONNECTIONS.
- COMPRESSION GROUND CONNECTIONS MAY BE REPLACED BY EXOTHERMIC WELD CONNECTIONS.
- ICE BRIDGE BONDING CONDUCTORS SHALL BE EXOTHERMICALLY BONDED TO THE TOWER GROUND BAR.
- APPROVED ANTIOXIDANT COATINGS (I.E. CONDUCTIVE GEL OR PASTE) SHALL BE USED ON ALL COMPRESSION AND BOLTED GROUND CONNECTIONS.
- ALL EXTERIOR AND INTERIOR GROUND CONNECTIONS SHALL BE COATED WITH A CORROSION RESISTANT MATERIAL.
- MISCELLANEOUS ELECTRICAL AND NON-ELECTRICAL METAL BOXES, FRAMES AND SUPPORTS SHALL BE BONDED TO THE GROUND RING, IN ACCORDANCE WITH THE NEC.
- BOND ALL METALLIC OBJECTS WITHIN 6 FT OF MAIN GROUND WIRES WITH 1-#2 AWG TIN-PLATED COPPER GROUND CONDUCTOR.
- GROUND CONDUCTORS USED IN THE FACILITY GROUND AND LIGHTNING PROTECTION SYSTEMS SHALL NOT BE ROUTED THROUGH METALLIC OBJECTS THAT FORM A RING AROUND THE CONDUCTOR, SUCH AS METALLIC CONDUITS, METAL SUPPORT CLIPS OR SLEEVES THROUGH WALLS OR FLOORS. WHEN IT IS REQUIRED TO BE HOUSED IN CONDUIT TO MEET CODE REQUIREMENTS OR LOCAL CONDITIONS, NON-METALLIC MATERIAL SUCH AS PVC PLASTIC CONDUIT SHALL BE USED. WHERE USE OF METAL CONDUIT IS UNAVOIDABLE (E.G. NON-METALLIC CONDUIT PROHIBITED BY LOCAL CODE) THE GROUND CONDUCTOR SHALL BE BONDED TO EACH END OF THE METAL CONDUIT.
- ALL NEW STRUCTURES WITH A FOUNDATION AND/OR FOOTING HAVING 20 FT. OR MORE OF 1/4" IN. OR GREATER ELECTRICALLY CONDUCTIVE REINFORCING STEEL MUST HAVE IT BONDED TO THE GROUND RING USING AN EXOTHERMIC WELD CONNECTION USING #2 AWG SOLID BARE TINNED COPPER GROUND WIRE, PER NEC 250.50.
- FOR THE PURPOSE OF CONSTRUCTION DRAWING, THE FOLLOWING DEFINITIONS SHALL APPLY:
 CONTRACTOR - EMPIRE TELECOM
 SUBCONTRACTOR - GENERAL CONTRACTOR (CONSTRUCTION)
 OWNER - AT&T (NEW CINGULAR WIRELESS PCS, LLC)
- ALL SITE WORK SHALL BE COMPLETED AS INDICATED ON THE DRAWINGS AND PROJECT SPECIFICATIONS.
- DRAWINGS PROVIDED HERE ARE NOT TO BE SCALED AND ARE INTENDED TO SHOW OUTLINE ONLY.
- ALL MATERIALS FURNISHED AND INSTALLED SHALL BE IN STRICT ACCORDANCE WITH ALL APPLICABLE CODES, REGULATIONS, AND ORDINANCES. SUBCONTRACTOR SHALL ISSUE ALL APPROPRIATE NOTICES AND COMPLY WITH ALL LAWS, ORDINANCES, RULES, REGULATIONS, AND LAWFUL ORDERS OF ANY PUBLIC AUTHORITY REGARDING THE PERFORMANCE OF THE WORK.
- ALL WORK CARRIED OUT SHALL COMPLY WITH ALL APPLICABLE MUNICIPAL AND UTILITY COMPANY SPECIFICATIONS AND LOCAL JURISDICTIONAL CODES, ORDINANCES AND APPLICABLE REGULATIONS.
- UNLESS NOTED OTHERWISE, THE WORK SHALL INCLUDE FURNISHING MATERIALS, EQUIPMENT, APPURTENANCES, AND LABOR NECESSARY TO COMPLETE ALL INSTALLATIONS AS INDICATED ON THE DRAWINGS.
- THE SUBCONTRACTOR SHALL INSTALL ALL EQUIPMENT AND MATERIALS IN ACCORDANCE WITH MANUFACTURER'S RECOMMENDATIONS UNLESS SPECIFICALLY STATED OTHERWISE.
- IF THE SPECIFIED EQUIPMENT CANNOT BE INSTALLED AS SHOWN ON THESE DRAWINGS, THE SUBCONTRACTOR SHALL PROPOSE AN ALTERNATIVE INSTALLATION SPACE FOR APPROVAL BY THE CONTRACTOR.
- THE SUBCONTRACTOR SHALL PROTECT EXISTING IMPROVEMENTS, PAVEMENTS, CURBS, LANDSCAPING AND STRUCTURES. ANY DAMAGED PART SHALL BE REPAIRED AT SUBCONTRACTOR'S EXPENSE TO THE SATISFACTION OF OWNER.
- THE SUBCONTRACTOR SHALL CONTACT UTILITY LOCATING SERVICES PRIOR TO THE START OF CONSTRUCTION.
- ALL EXISTING ACTIVE SEWER, WATER, GAS, ELECTRIC, AND OTHER UTILITIES WHERE ENCOUNTERED IN THE WORK, SHALL BE PROTECTED AT ALL TIMES, AND WHERE REQUIRED FOR THE PROPER EXECUTION OF THE WORK, SHALL BE RELOCATED AS DIRECTED BY THE RESPONSIBLE ENGINEER. EXTREME CAUTION SHOULD BE USED BY THE SUBCONTRACTOR WHEN EXCAVATING OR DRILLING PIERS AROUND OR NEAR UTILITIES. SUBCONTRACTOR SHALL PROVIDE SAFETY TRAINING FOR THE WORKING CREW. THIS WILL INCLUDE BUT NOT BE LIMITED TO A) FALL PROTECTION B) CONFINED SPACE C) ELECTRICAL SAFETY D) TRENCHING & EXCAVATION.
- ALL EXISTING INACTIVE SEWER, WATER, GAS, ELECTRIC AND OTHER UTILITIES, WHICH INTERFERE WITH THE EXECUTION OF THE WORK, SHALL BE REMOVED AND/OR CAPPED, PLUGGED OR OTHERWISE DISCONTINUED AT POINTS WHICH WILL NOT INTERFERE WITH THE EXECUTION OF THE WORK, AS DIRECTED BY THE RESPONSIBLE ENGINEER, AND SUBJECT TO THE APPROVAL OF THE OWNER AND/OR LOCAL UTILITIES.

- THE AREAS OF THE OWNER'S PROPERTY DISTURBED BY THE WORK AND NOT COVERED BY THE TOWER, EQUIPMENT OR DRIVEWAY SHALL BE GRADED TO A UNIFORM SLOPE AND STABILIZED TO PREVENT EROSION.
- SUBCONTRACTOR SHALL MINIMIZE DISTURBANCE TO EXISTING SITE DURING CONSTRUCTION. EROSION CONTROL MEASURES, IF REQUIRED DURING CONSTRUCTION, SHALL BE IN CONFORMANCE WITH THE LOCAL GUIDELINES FOR EROSION AND SEDIMENT CONTROL.
- NO FILL OR EMBANKMENT MATERIAL SHALL BE PLACED ON FROZEN GROUND. FROZEN MATERIALS, SNOW OR ICE SHALL NOT BE PLACED IN ANY FILL OR EMBANKMENT.
- THE SUBGRADE SHALL BE COMPACTED AND BROUGHT TO A SMOOTH UNIFORM GRADE PRIOR TO FINISHED SURFACE APPLICATION.
- THE SITE SHALL BE GRADED TO CAUSE SURFACE WATER TO FLOW AWAY FROM THE BTS EQUIPMENT AND TOWER AREAS.
- IF NECESSARY, RUBBISH, STUMPS, DEBRIS, STICKS, STONES AND OTHER REFUSE SHALL BE REMOVED FROM THE SITE AND DISPOSED OF LEGALLY.
- THE SUBCONTRACTOR SHALL PROVIDE SITE SIGNAGE IN ACCORDANCE WITH THE TECHNICAL SPECIFICATION FOR SITE SIGNAGE.
- SUBCONTRACTOR SHALL LEAVE PREMISES IN CLEAN CONDITION.
- PRIOR TO THE SUBMISSION OF BIDS, THE BIDDING SUBCONTRACTOR SHALL VISIT THE CELL SITE TO FAMILIARIZE WITH THE EXISTING CONDITIONS AND TO CONSTRUCTION DRAWINGS. ANY DISCREPANCY FOUND SHALL BE BROUGHT TO THE ATTENTION OF THE CONTRACTOR.
- SUBCONTRACTOR SHALL DETERMINE ACTUAL ROUTING OF CONDUIT, POWER AND T1 CABLES, GROUNDING CABLES AS SHOWN ON THE POWER, GROUNDING AND TELCO PLAN DRAWING. SUBCONTRACTOR SHALL UTILIZE EXISTING TRAYS AND/OR SHALL ADD NEW TRAYS AS NECESSARY. SUBCONTRACTOR SHALL CONFIRM THE ACTUAL ROUTING WITH THE CONTRACTOR.
- ALL CONCRETE REPAIR WORK SHALL BE DONE IN ACCORDANCE WITH AMERICAN CONCRETE INSTITUTE (ACI) 301.
- ANY NEW CONCRETE NEEDED FOR THE CONSTRUCTION SHALL BE AIR-ENTRAINED AND SHALL HAVE 4000 PSI STRENGTH AT 28 DAYS.
- ALL STRUCTURAL STEEL WORK SHALL BE DETAILED, FABRICATED AND ERECTED IN ACCORDANCE WITH AISC SPECIFICATIONS. ALL STRUCTURAL STEEL SHALL BE ASTM A36 (Fy = 36 ksi) UNLESS OTHERWISE NOTED. PIPES SHALL BE ASTM A53 TYPE E (Fy = 36 ksi). ALL STEEL EXPOSED TO WEATHER SHALL BE HOT DIPPED GALVANIZED. TOUCHUP ALL SCRATCHES AND OTHER MARKS IN THE FIELD AFTER STEEL IS ERECTED USING A COMPATIBLE ZINC RICH PAINT.
- CONSTRUCTION SHALL COMPLY WITH SPECIFICATIONS AND "GENERAL CONSTRUCTION SERVICES FOR CONSTRUCTION OF AT&T MOBILITY SITES."
- SUBCONTRACTOR SHALL VERIFY ALL EXISTING DIMENSIONS AND CONDITIONS PRIOR TO COMMENCING ANY WORK. ALL DIMENSIONS OF EXISTING CONSTRUCTION SHOWN ON THE DRAWINGS MUST BE VERIFIED. SUBCONTRACTOR SHALL NOTIFY THE CONTRACTOR OF ANY DISCREPANCIES PRIOR TO ORDERING MATERIAL OR PROCEEDING WITH CONSTRUCTION.
- THE EXISTING CELL SITE IS IN FULL COMMERCIAL OPERATION. ANY CONSTRUCTION WORK BY SUBCONTRACTOR SHALL NOT DISRUPT THE EXISTING NORMAL OPERATION. ANY WORK ON EXISTING EQUIPMENT MUST BE COORDINATED WITH CONTRACTOR. ALSO, WORK SHOULD BE SCHEDULED FOR AN APPROPRIATE MAINTENANCE WINDOW USUALLY IN LOW TRAFFIC PERIODS AFTER MIDNIGHT.
- SINCE THE CELL SITE IS ACTIVE, ALL SAFETY PRECAUTIONS MUST BE TAKEN WHEN WORKING AROUND HIGH LEVELS OF ELECTROMAGNETIC RADIATION. EQUIPMENT SHOULD BE SHUTDOWN PRIOR TO PERFORMING ANY WORK THAT COULD EXPOSE THE WORKERS TO DANGER. PERSONAL RF EXPOSURE MONITORS ARE ADVISED TO BE WORN ALERT OF DANGEROUS EXPOSURE LEVELS.



Customer Loyalty through Client Satisfaction
 www.maserconsulting.com
 Engineers ■ Planners ■ Surveyors
 Landscape Architects ■ Environmental Scientists

Copyright © 2018 Maser Consulting Connecticut All Rights Reserved. This drawing and all the information contained herein is authorized for use only by the party for whom the services were contracted or to whom it is loaned. This drawing may not be copied, reused, disclosed, distributed or relied upon for any other purpose without the express written consent of Maser Consulting Connecticut.



811 PROTECT YOURSELF
 ALL STATES REQUIRE NOTIFICATION OF EXCAVATORS, DESIGNERS, OR ANY PERSON PREPARING TO DISTURB THE EARTH'S SURFACE ANYWHERE IN ANY STATE
 Know what's below. Call before you dig.
 FOR STATE SPECIFIC DIRECT PHONE NUMBERS VISIT: WWW.CALL811.COM

SCALE: AS SHOWN JOB NUMBER: 18963048A

REV	DATE	DESCRIPTION	DRAWN BY	CHECKED BY
0	1/9/18	FOR CONSTRUCTION	AJC	RA
2	12/21/18	REVISED PER COMMENTS	AJC	RA
1	12/13/18	FOR REVIEW	AJC	RA

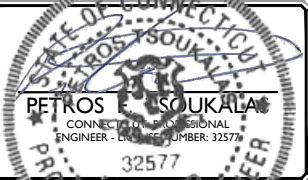

IT IS A VIOLATION OF LAW FOR ANY PERSON UNLESS THEY ARE ACTING UNDER THE DIRECTION OF THE RESPONSIBLE ENGINEER TO SIGN OR INITIAL THIS DOCUMENT.

SITE NAME:
 MANCHESTER CENTRAL
 FA# 10071105
 SITE# CT5448
 239 MIDDLE TURNPIKE EAST
 MANCHESTER, CT 06040
 HARTFORD COUNTY

RED BANK OFFICE
 331 Newman Springs Road
 Suite 203
 Red Bank, NJ 07701-5669
 Phone: 732.383.1950
 Fax: 732.383.1984
 email: solutions@maserconsulting.com

SHEET TITLE:
GENERAL NOTES

SHEET NUMBER:
GN-1



SCALE:	JOB NUMBER:
AS SHOWN	18963048A
0	1/3/18 FOR CONSTRUCTION AJC RA
2	12/21/18 REVISED PER COMMENTS AJC RA
1	12/13/18 FOR REVIEW AJC RA
REV	DATE OF ACTION DRAWN BY CHECKED BY



IT IS A VIOLATION OF LAW FOR ANY PERSON UNLESS THEY ARE ACTING UNDER THE DIRECTION OF THE RESPONSIBLE ENGINEER TO SIGN OR SEAL THIS DOCUMENT.

SITE NAME:
 MANCHESTER CENTRAL
 FA# 10071105
 SITE# CT5448
 239 MIDDLE TURNPIKE EAST
 MANCHESTER, CT 06040
 HARTFORD COUNTY

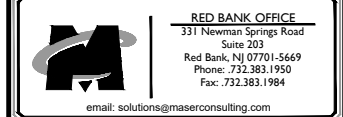

SHEET TITLE:
PARTIAL SITE PLAN AND DETAILS

SHEET NUMBER:
C-1

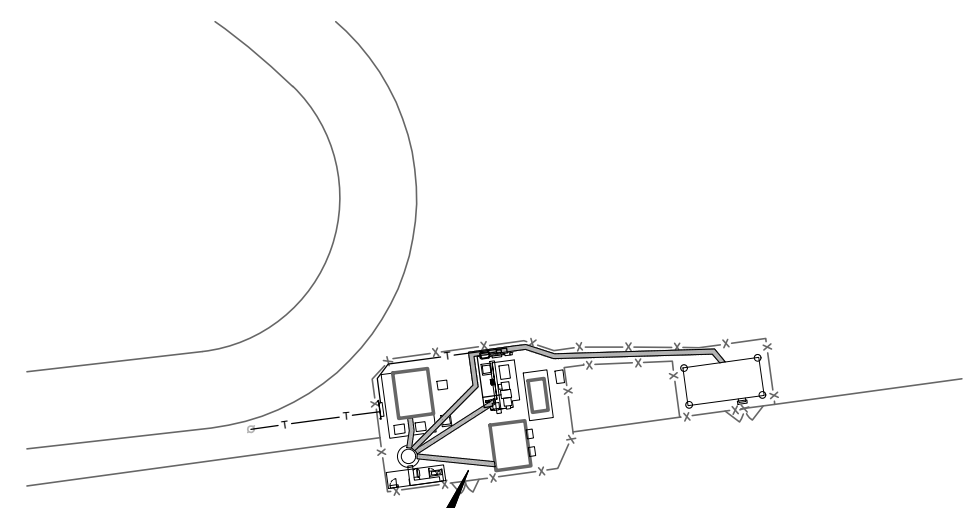
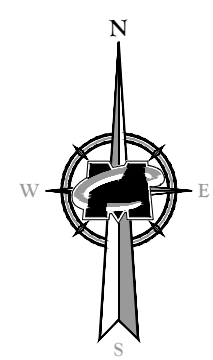
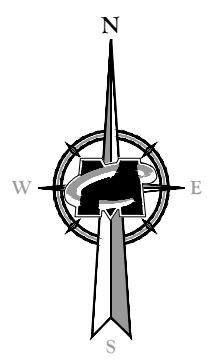

PROJECT LOCATION

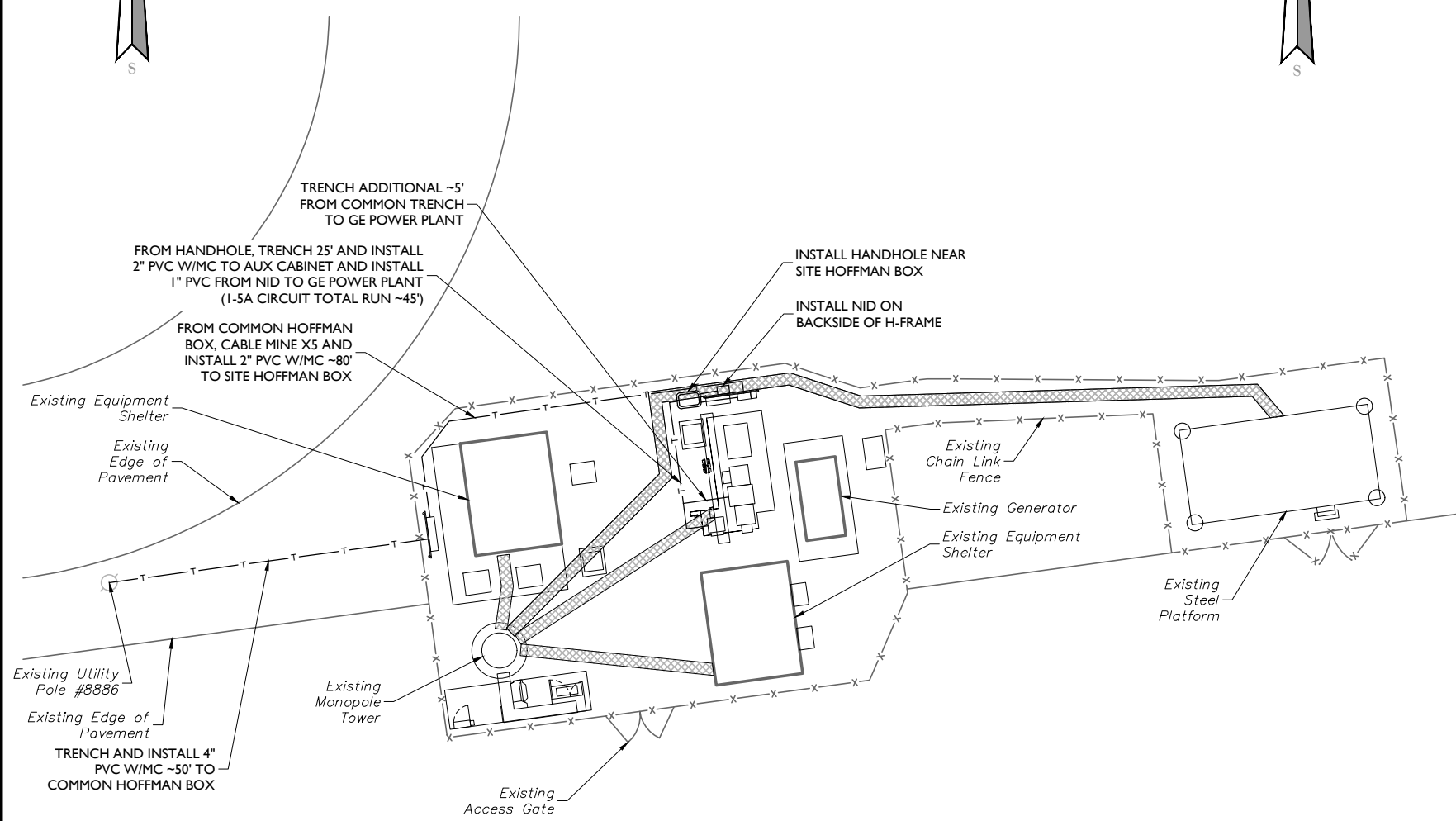

PARTIAL SITE PLAN
 SCALE : 1" = 20' FOR 22"X34"
 (SCALE : 1" = 40' FOR 11"X17")

NOTE:
 ALL PROPOSED UNDERGROUND WORK IS TO BE INSTALLED AND OWNED BY OTHERS.

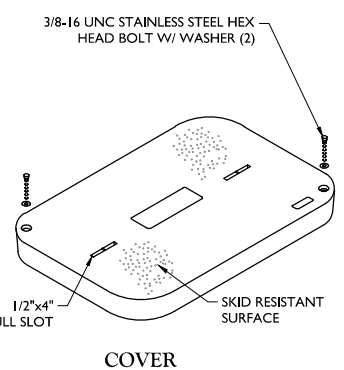

COVER

NOTE:
 1. COVER TO BE MADE OF HEAVY DUTY POLYMER CONCRETE AND RATED FOR 15,000 lbs (MIN.)

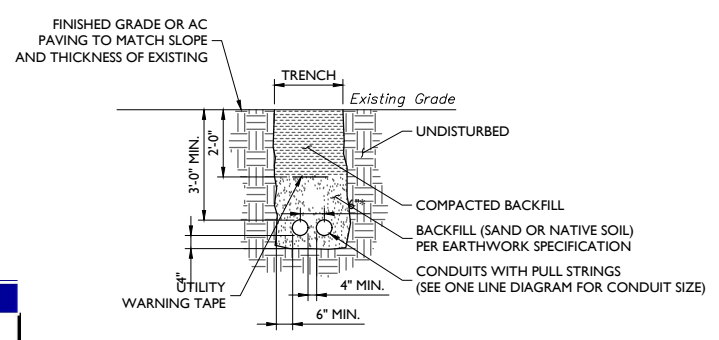

UTILITY CONDUIT RUN
 NOT TO SCALE

NOTE:
 ALL PROPOSED TRENCHING SHALL BE WITHIN AN EXISTING UTILITY EASEMENT

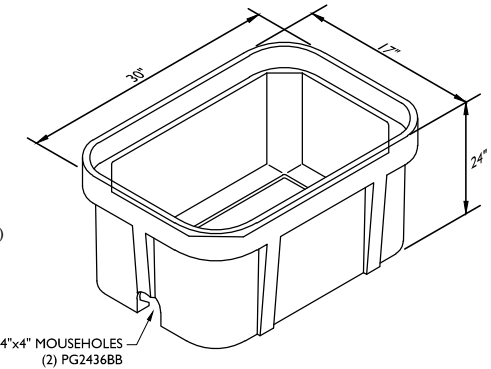

BOX

HANDHOLE DETAIL
 NOT TO SCALE

Path	Power	Space
Xpoint Pole 8886. Install ~50MC in existing 4" PVC Conduit to Common Hoffman Box. From CHB cable mine x5 and install MC ~80' in existing 2" PVC to Site Hoff Box. Place a HH near SHB and install NID on backside of Hframe. From HH trench 25' and install 2" PVC w/MC to AUX Cab.	Trench 5' to hit GE PP into Common Trench. Install 1" PVC from GE PP to NID. 1 5A Circuit total run ~45'	2 RU located in AUX Cab. Remove LMU

USPS Tracking®

Tracking

FAQs >

Track Another Package +

Tracking Number: 9505510391969004338358

Remove X

Expected Delivery on

TUESDAY

8

JANUARY
2019 ⓘ

by

8:00pm ⓘ

Status

✓ Delivered

January 8, 2019 at 7:57 am
Delivered, PO Box
MANCHESTER, CT 06045

Get Updates ▾



Text & Email Updates ▾

Tracking History ▾

Product Information ▾

Feedback



USPS Tracking®

Tracking / [FAQs >](#)

[Track Another Package +](#)

Tracking Number: 9505510391969004338365

[Remove X](#)

On Time

Expected Delivery on

MONDAY

7 JANUARY 2019 ⓘ

by **8:00pm** ⓘ

Status

Delivered

January 7, 2019 at 9:30 am
Delivered, PO Box
MANCHESTER, CT 06045

[Get Updates](#) ▼



Delivered

Feedback