

STATE OF CONNECTICUT

CONNECTICUT SITING COUNCIL

Ten Franklin Square, New Britain, CT 06051

Phone: (860) 827-2935 Fax: (860) 827-2950

E-Mail: siting.council@ct.gov

www.ct.gov/csc

January 21, 2014

Matt Burke
TRM, Inc.
16 Chestnut Street
Foxborough, MA 02035

RE: **EM-AT&T-004-131230** - American Telephone and Telegraph Company notice of intent to modify an existing telecommunications facility located at 277 Huckleberry Hill Road, Avon, Connecticut.

Dear Mr. Burke:

The Connecticut Siting Council (Council) hereby acknowledges your notice to modify this existing telecommunications facility, pursuant to Section 16-50j-73 of the Regulations of Connecticut State Agencies with the following conditions:

- Any deviation from the proposed modification as specified in this notice and supporting materials with the Council shall render this acknowledgement invalid;
- Any material changes to this modification as proposed shall require the filing of a new notice with the Council;
- Within 45 days after completion of construction, the Council shall be notified in writing that construction has been completed;
- The validity of this action shall expire one year from the date of this letter; and
- The applicant may file a request for an extension of time beyond the one year deadline provided that such request is submitted to the Council not less than 60 days prior to the expiration.

The proposed modifications including the placement of all necessary equipment and shelters within the tower compound are to be implemented as specified here and in your notice dated December 30, 2013. The modifications are in compliance with the exception criteria in Section 16-50j-72 (b) of the Regulations of Connecticut State Agencies as changes to an existing facility site that would not increase tower height, extend the boundaries of the tower site, increase noise levels at the tower site boundary by six decibels, and increase the total radio frequencies electromagnetic radiation power density measured at the tower site boundary to or above the standard adopted by the State Department of Environmental Protection pursuant to General Statutes § 22a-162. This facility has also been carefully modeled to ensure that radio frequency emissions are conservatively below State and federal standards applicable to the frequencies now used on this tower.

This decision is under the exclusive jurisdiction of the Council. Please be advised that the validity of this action shall expire one year from the date of this letter. Any additional change to this facility will require explicit notice to this agency pursuant to Regulations of Connecticut State Agencies Section 16-50j-73. Such notice shall include all relevant information regarding the proposed change with cumulative worst-case modeling of radio frequency exposure at the closest point of uncontrolled access to the tower base, consistent with Federal Communications Commission, Office of Engineering and Technology, Bulletin 65. Thank you for your attention and cooperation.



Very truly yours,



Melanie A. Bachman
Acting Executive Director

MAB/RM/cm

c: The Honorable Mark W. Zacchio, Chairman, Town of Avon
Steven V. Kushner, Town Planner, Town of Avon
Sprint Spectrum



STATE OF CONNECTICUT

CONNECTICUT SITING COUNCIL

Ten Franklin Square, New Britain, CT 06051

Phone: (860) 827-2935 Fax: (860) 827-2950

E-Mail: siting.council@ct.gov

www.ct.gov/csc

November 3, 2015

Daniel M. Laub, Esq.
Cuddy & Feder LLP
445 Hamilton Avenue, 14th Floor
White Plains, NY 10601

RE: Request for Extension of Time for Construction for Previously Approved Exempt Modifications. Fixed Generator Deployments.

Dear Attorney Laub:

The Connecticut Siting Council (Council) is in receipt of the request from New Cingular Wireless, PCS, LLC (AT&T) for an extension of construction time for the attached exempt modifications requesting fixed generator deployments, dated October 29, 2015. Pursuant to the Council's decision letters for the attached list of previously approved exempt modifications, I have considered your request for an extension of construction time for these exempt modifications and grant an extension of time until June 30, 2016, to complete the construction of these projects.

This extension is granted with the understanding that the Council will be notified should New Cingular Wireless PCS, LLC (AT&T) decide not to proceed with construction of any of the exempt modifications on the attached list.

Sincerely,

Melanie A. Bachman
Acting Executive Director

MAB/cm

EM-AT&T-001-140131	104 Bunker Hill	Andover
EM-AT&T-003-131209B	142 Fitts Road	Ashford
EM-AT&T-003-131209A	99 Knowlton Hill Road	Ashford
EM-AT&T-003-140127	36 Janoski Road	Ashford
EM-AT&T-004-131230	277 Huckleberry Hill Road	Avon
EM-AT&T-005-140131	127 New Hartford Road	Barkhamsted
EM-AT&T-006-140117	10 Terese Road (aka Rice Lane)	Beacon Falls
EM-AT&T-008-140131	179 Amity Road	Bethany
EM-AT&T-011-140227	28 Brewer Drive	Bloomfield
EM-AT&T-012-140131	49 South Road	Bolton
EM-AT&T-012-131223	130 Vernon Road	Bolton
EM-AT&T-020-140114	719 George Washington Turnpike	Burlington
EM-AT&T-020-140203	12 Nepaug Road	Burlington
EM-AT&T-027-131213	46 Meadow Road	Clinton
EM-AT&T-028-140127	Chestnut Hill Road	Colchester
EM-AT&T-028-140303	856 (812) Middletown Road	Colchester
EM-AT&T-029-140121	382 Colebrook River Road	Colebrook
EM-AT&T-032-140102	400 Riley Mountain Road	Coventry
EM-AT&T-069-140127	43 Connecticut Mills Road	Danielson
EM-AT&T-069-140114	79 Putnam Pike	Dayville
EM-AT&T-036-140127	15 Pent Road	Deep River
EM-AT&T-042-140207	94/96 East High Street	East Hampton
EM-AT&T-065-140303	350 Hartland Boulevard	East Hartland
EM-AT&T-039-140203	35 Old Route 44	Eastford
EM-AT&T-049-140114	188 Moody Road	Enfield
EM-AT&T-050-140203	10 Main Street	Essex
EM-AT&T-052-131209	130 Birdseye Road	Farmington
EM-AT&T-054-131230	2577 Main Street	Glastonbury
EM-AT&T-054-140127	577 Bell Street	Glastonbury
EM-AT&T-057-140130	36 Ritch Avenue West	Greenwich
EM-AT&T-060-140127	360 Rockland Road	Guilford
EM-AT&T-060-140303	145 Manor Road	Guilford
EM-AT&T-061-131209	285 Chamberlain Hill Road	Haddam
EM-AT&T-061-140131	525 Plains Road	Haddam
EM-AT&T-067-131230	107 Buck Road	Hebron
EM-AT&T-067-140106	66 Wall Street	Hebron
EM-AT&T-058-140224	181 A Norman Road	Jewett City
EM-AT&T-077-140117	60 Adams Street	Manchester
EM-AT&T-079-131209	175 South Main Street	Marlborough
EM-AT&T-080-140210	478 West Main Street	Meriden
EM-AT&T-081-140127	1021 Straits Turnpike	Middlebury
EM-AT&T-082-131213	484 Meriden Road	Middlefield
EM-AT&T-082-140102	393 Jackson Hill Road	Middlefield
EM-AT&T-083-131216	1825 South Street	Middletown
EM-AT&T-083-140114	290 Preston Avenue	Middletown
EM-AT&T-083-140203	90 Industrial Park Road	Middletown
EM-AT&T-083-140207	1967 Saybrook Road	Middletown

EM-AT&T-085-140121	1428 Monroe Turnpike	Monroe
EM-AT&T-089-131205A	200 Stanley Street	New Britain
EM-AT&T-089-140121	One Hartford Square	New Britain
EM-AT&T-089-131205B	178 Lester Street	New Britain
EM-AT&T-094-131216	123 Costello Road	Newington
EM-AT&T-094-140127	99 Cedarwood Lane	Newington
EM-AT&T-097-140121	3 Edmond Road	Newtown
EM-AT&T-099-140127	108 Foxon Road	North Branford
EM-AT&T-104-140303	300 Plain Hill Road	Norwich
EM-AT&T-107-140303	525 Orange Center Road	Orange
EM-AT&T-108-140206	338 Oxford Road	Oxford
EM-AT&T-112-140114	62 Babbitt Hill Road	Pomfret
EM-AT&T-113-131209	213 High Street	Portland
EM-AT&T-116-131209	152 Sayle Avenue	Putnam
EM-AT&T-117-140303	22 Wayside Lane	Redding
EM-AT&T-119-131230	47 Inwood Road	Rocky Hill
EM-AT&T-119-140210	699 Old Main Street	Rocky Hill
EM-AT&T-124-140203	6 Progress Avenue	Seymour
EM-AT&T-128-131213	Grist Mill Road	Simsbury
EM-AT&T-132-131230	151 Sand Hill Road	South Windsor
EM-AT&T-134-140110	157 Chestnut Mountain Road	Stafford Springs
EM-AT&T-139-131230	44 Ffylvler Place	Suffield
EM-AT&T-146-140203	47 Main Street	Talcottville (Vernon)
EM-AT&T-142-140127	130 Bald Hill Road	Tolland
EM-AT&T-143-140117	350 Burr Mountain Road	Torrington
EM-AT&T-143-140130	1925 East Main Street	Torrington
EM-AT&T-144-140210	307 Indian Park Ledge Road	Trumbull
EM-AT&T-086-140210	57 Cook Drive	Uncasville
EM-AT&T-146-140114	60 Industrial Park Road	Vernon Rockville
EM-AT&T-155-140131	491 South Quaker Lane	West Hartford
EM-AT&T-163-131209	10 North Ridge Drive	Windham
EM-AT&T-164-131213	482 Pigeon Hill Road	Windsor
EM-AT&T-164-131216	50 Pine Lane	Windsor
EM-AT&T-167-140227	1116 Johnson Road	Woodbridge
EM-AT&T-168-140127	103 Great Hollow Road	Woodbury
EM-AT&T-168-140203	478 Good Hill Road	Woodbury
EM-AT&T-169-140109	215 Coatney Hill Road	Woodstock

October 29, 2015

VIA EMAIL & FIRST CLASS MAIL

Melanie Bachman, Esq.
Executive Director
Connecticut Siting Council
10 Franklin Square
New Britain, CT 06051

Re: New Cingular Wireless PCS, LLC (AT&T)
Exempt Modification Approvals
Extension Request

Dear Executive Director Bachman:

We are writing on behalf of our client, New Cingular Wireless PCS, LLC ("AT&T"), to request another one-year extension of various exempt modification acknowledgements (EM's) issued by the Siting Council in response to AT&T filings during the period of December 2013 through March 2014, which were previously extended to December 31, 2015. These filings all relate to fixed generator deployments by AT&T at tower sites in Connecticut which have largely been deferred until 2016. The list of EM sites is the attachment to your letter dated November 20, 2014. Accordingly, we respectfully request that all of the EM's listed be extended for one-year to the end of 2016.

Thank you in advance for your consideration of this request.

Very truly yours,

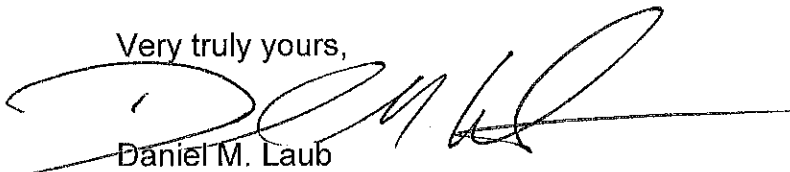

Daniel M. Laub

Enclosures

cc: Michele Briggs, AT&T
Richard Detch, AT&T

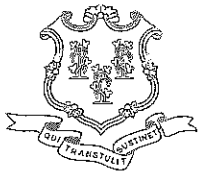

STATE OF CONNECTICUT
CONNECTICUT SITING COUNCIL

Ten Franklin Square, New Britain, CT 06051

Phone: (860) 827-2935 Fax: (860) 827-2950

E-Mail: siting.council@ct.gov

www.ct.gov/csc

November 20, 2014

Christopher B. Fisher, Esq.
Cuddy & Feder LLP
445 Hamilton Avenue, 14th Floor
White Plains, NY 10601

RE: Request for Extension of Time for Construction for Previously Approved Exempt Modifications. Fixed Generator Deployments.

Dear Attorney Fisher:

The Connecticut Siting Council (Council) is in receipt of the request from New Cingular Wireless, PCS, LLC (AT&T) for an extension of construction time for the attached exempt modifications requesting fixed generator deployments, dated November 18, 2014. Pursuant to the Council's decision letters for the attached list of previously approved exempt modifications, I have considered your request for an extension of construction time for these exempt modifications and grant an extension of time until December 31, 2015, to complete the construction of these projects.

This extension is granted with the understanding that the Council will be notified should New Cingular Wireless PCS, LLC (AT&T) decide not to proceed with construction of any of the exempt modifications on the attached list.

Sincerely,

Melanie A. Bachman
Acting Executive Director

MAB/CDM/cm

EM-AT&T-001-140131	104 Bunker Hill	Andover
EM-AT&T-003-131209B	142 Fitts Road	Ashford
EM-AT&T-003-131209A	99 Knowlton Hill Road	Ashford
EM-AT&T-003-140127	36 Janoski Road	Ashford
EM-AT&T-004-131230	277 Huckleberry Hill Road	Avon
EM-AT&T-005-140131	127 New Hartford Road	Barkhamsted
EM-AT&T-006-140117	10 Terese Road (aka Rice Lane)	Beacon Falls
EM-AT&T-008-140131	179 Amity Road	Bethany
EM-AT&T-011-140227	28 Brewer Drive	Bloomfield
EM-AT&T-012-140131	49 South Road	Bolton
EM-AT&T-012-131223	130 Vernon Road	Bolton
EM-AT&T-020-140114	719 George Washington Turnpike	Burlington
EM-AT&T-020-140203	12 Nepaug Road	Burlington
EM-AT&T-027-131213	46 Meadow Road	Clinton
EM-AT&T-028-140127	Chestnut Hill Road	Colchester
EM-AT&T-028-140303	856 (812) Middletown Road	Colchester
EM-AT&T-029-140121	382 Colebrook River Road	Colebrook
EM-AT&T-032-140102	400 Riley Mountain Road	Coventry
EM-AT&T-069-140127	43 Connecticut Mills Road	Danielson
EM-AT&T-069-140114	79 Putnam Pike	Dayville
EM-AT&T-036-140127	15 Pent Road	Deep River
EM-AT&T-042-140207	94/96 East High Street	East Hampton
EM-AT&T-065-140303	350 Hartland Boulevard	East Hartland
EM-AT&T-039-140203	35 Old Route 44	Eastford
EM-AT&T-049-140114	188 Moody Road	Enfield
EM-AT&T-050-140203	10 Main Street	Essex
EM-AT&T-052-131209	130 Birdseye Road	Farmington
EM-AT&T-054-131230	2577 Main Street	Glastonbury
EM-AT&T-054-140127	577 Bell Street	Glastonbury
EM-AT&T-057-140130	36 Ritch Avenue West	Greenwich
EM-AT&T-060-140127	360 Rockland Road	Guilford
EM-AT&T-060-140303	145 Manor Road	Guilford
EM-AT&T-061-131209	285 Chamberlain Hill Road	Haddam
EM-AT&T-061-140131	525 Plains Road	Haddam
EM-AT&T-067-131230	107 Buck Road	Hebron
EM-AT&T-067-140106	66 Wall Street	Hebron
EM-AT&T-058-140224	181 A Norman Road	Jewett City
EM-AT&T-077-140117	60 Adams Street	Manchester
EM-AT&T-079-131209	175 South Main Street	Marlborough
EM-AT&T-080-140210	478 West Main Street	Meriden
EM-AT&T-081-140127	1021 Straits Turnpike	Middlebury
EM-AT&T-082-131213	484 Meriden Road	Middlefield
EM-AT&T-082-140102	393 Jackson Hill Road	Middlefield
EM-AT&T-083-131216	1825 South Street	Middletown
EM-AT&T-083-140114	290 Preston Avenue	Middletown
EM-AT&T-083-140203	90 Industrial Park Road	Middletown
EM-AT&T-083-140207	1967 Saybrook Road	Middletown

EM-AT&T-085-140121	1428 Monroe Turnpike	Monroe
EM-AT&T-089-131205A	200 Stanley Street	New Britain
EM-AT&T-089-140121	One Hartford Square	New Britain
EM-AT&T-089-131205B	178 Lester Street	New Britain
EM-AT&T-094-131216	123 Costello Road	Newington
EM-AT&T-094-140127	99 Cedarwood Lane	Newington
EM-AT&T-097-140121	3 Edmond Road	Newtown
EM-AT&T-099-140127	108 Foxon Road	North Branford
EM-AT&T-104-140303	300 Plain Hill Road	Norwich
EM-AT&T-107-140303	525 Orange Center Road	Orange
EM-AT&T-108-140206	338 Oxford Road	Oxford
EM-AT&T-112-140114	62 Babbitt Hill Road	Pomfret
EM-AT&T-113-131209	213 High Street	Portland
EM-AT&T-116-131209	152 Sayle Avenue	Putnam
EM-AT&T-117-140303	22 Wayside Lane	Redding
EM-AT&T-119-131230	47 Inwood Road	Rocky Hill
EM-AT&T-119-140210	699 Old Main Street	Rocky Hill
EM-AT&T-124-140203	6 Progress Avenue	Seymour
EM-AT&T-128-131213	Grist Mill Road	Simsbury
EM-AT&T-132-131230	151 Sand Hill Road	South Windsor
EM-AT&T-134-140110	157 Chestnut Mountain Road	Stafford Springs
EM-AT&T-139-131230	44 Ffylet Place	Suffield
EM-AT&T-146-140203	47 Main Street	Talcottville (Vernon)
EM-AT&T-142-140127	130 Bald Hill Road	Tolland
EM-AT&T-143-140117	350 Burr Mountain Road	Torrington
EM-AT&T-143-140130	1925 East Main Street	Torrington
EM-AT&T-144-140210	307 Indian Park Ledge Road	Trumbull
EM-AT&T-086-140210	57 Cook Drive	Uncasville
EM-AT&T-146-140114	60 Industrial Park Road	Vernon Rockville
EM-AT&T-155-140131	491 South Quaker Lane	West Hartford
EM-AT&T-163-131209	10 North Ridge Drive	Windham
EM-AT&T-164-131213	482 Pigeon Hill Road	Windsor
EM-AT&T-164-131216	50 Pine Lane	Windsor
EM-AT&T-167-140227	1116 Johnson Road	Woodbridge
EM-AT&T-168-140127	103 Great Hollow Road	Woodbury
EM-AT&T-168-140203	478 Good Hill Road	Woodbury
EM-AT&T-169-140109	215 Coatney Hill Road	Woodstock

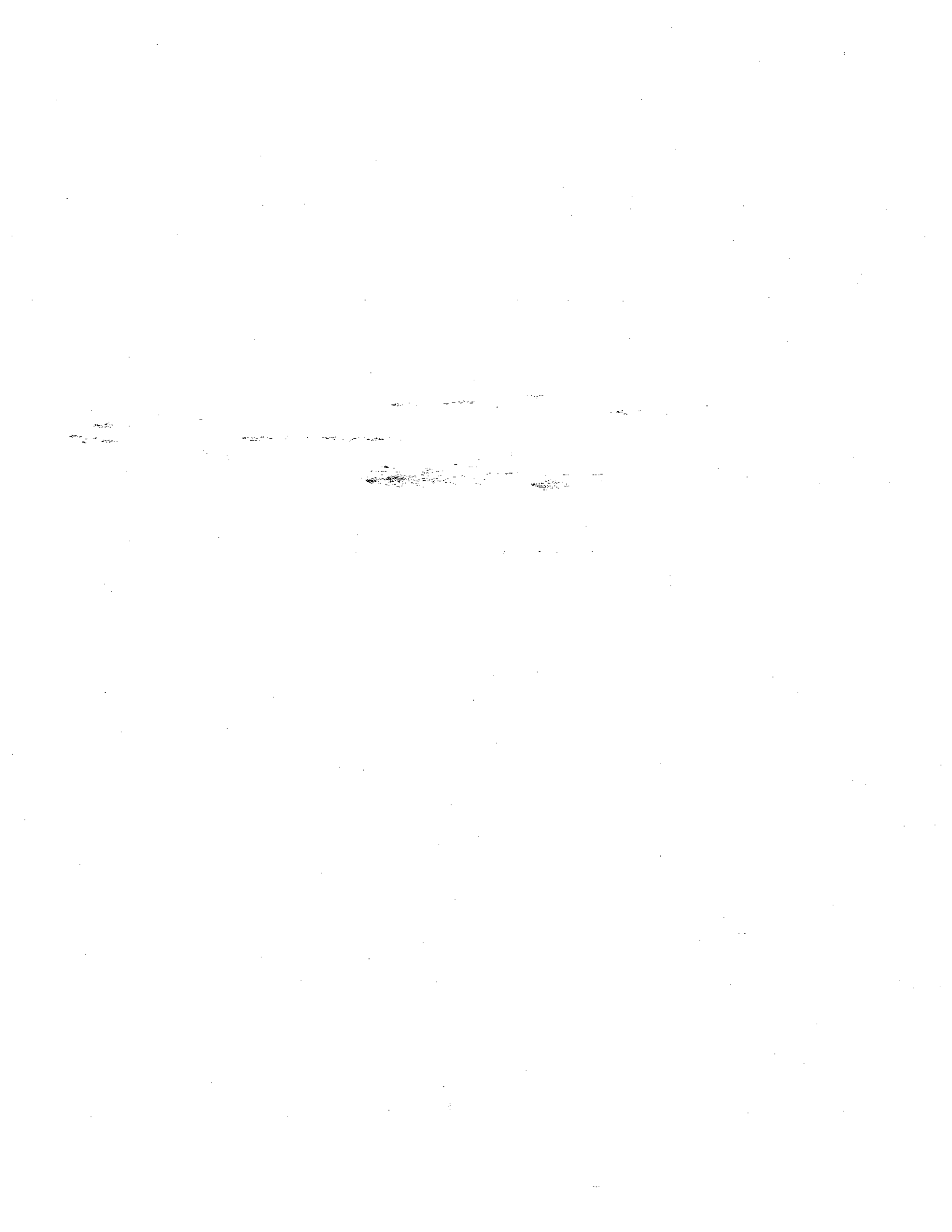

November 18, 2014

VIA EMAIL & FIRST CLASS MAIL

Melanie Bachman, Esq.
Executive Director
Connecticut Siting Council
10 Franklin Square
New Britain, CT 06051

RECEIVED
NOV 21 2014

**CONNECTICUT
SITING COUNCIL**

Re: New Cingular Wireless PCS, LLC (AT&T)
Exempt Modification Approvals
Extension Request

ORIGINAL

Dear Executive Director Bachman:

On behalf of our client, New Cingular Wireless PCS, LLC ("AT&T"), we are writing to request a one-year extension of various exempt modification acknowledgements (EM's) issued by the Siting Council in response to AT&T filings during the period of December 2013 through March 2014. These filings all relate to fixed generator deployments by AT&T at tower sites in Connecticut. Attached is a list of the EM sites with their respective acknowledgement dates. We respectfully request that all of the EM's listed be extended for one-year to the end of 2015.

Thank you in advance for your consideration of this request.

Very truly yours,

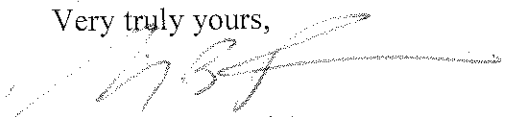
Christopher B. Fisher
Enclosures

cc: Michele Briggs, AT&T
Richard Detch, AT&T

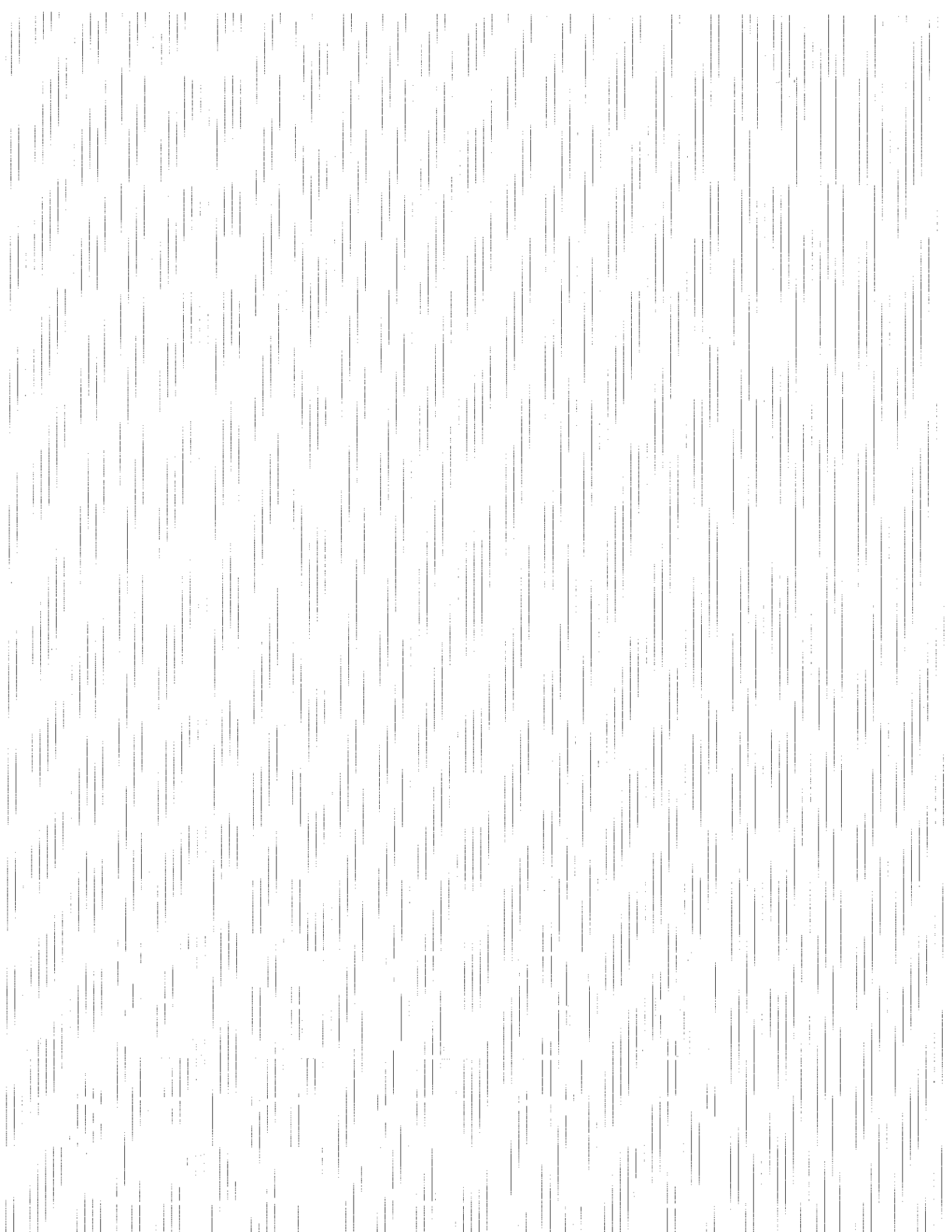

<u>Address</u>	<u>City</u>	<u>CSC Zoning Submit</u>	<u>CSC Zoning Approved</u>	<u>EM#</u>
CHESTNUT HILL ROAD	COLCHESTER	1/23/2014	2/18/2014	028-140127
213 HIGH STREET	PORTLAND	12/6/2013	12/27/2013	113-131209
130 VERNON ROAD	BOLTON	12/17/2013	1/10/2014	012-131223
145 MANOR ROAD	GUILFORD	2/26/2014	3/24/2014	060-140303
525 PLAINS ROAD	HADDAM	1/28/2014	2/18/2014	061-140131
719 AMITY ROAD	BETHANY	1/28/2014	2/19/2014	008-140131
10 MAIN STREET	ESSEX	1/31/2014	2/21/2014	050-140203
290 PRESTON AVENUE	MIDDLETOWN	1/8/2014	2/6/2014	083-140114
47 MAIN STREET	TALCOTTVILLE	1/31/2014	2/21/2014	146-140203
99 CEDARWOOD LANE	NEWINGTON	1/23/2014	2/19/2014	094-140127
57 COOK DRIVE	UNCASVILLE	2/6/2014	3/4/2014	086-140210
28 BREWER DRIVE (CEMETARY)	BLOOMFIELD	2/24/2014	3/19/2014	011-140227
525 ORANGE CENTER ROAD	ORANGE	2/27/2014	3/21/2014	107-140303
90 INDUSTRIAL PARK ROAD	MIDDLETOWN	1/29/2014	2/24/2014	083-140203
60 ADAMS STREET	MANCHESTER	1/14/2014	2/7/2014	077-140117
1021 STRAITS TURNPIKE	MIDDLEBURY	1/23/2014	2/18/2014	081-140127
FFYLER ROAD	SUFFIELD	12/27/2013	1/22/2014	139-131230
482 PIGEON HILL ROAD	WINDSOR	12/19/2013	1/2/2014	164-131213
GRIST MILL ROAD	SIMSBURY	12/11/2013	1/2/2014	128-131213
36 JANOSKI ROAD	ASHFORD	1/23/2014	2/18/2014	003-140127
1967 SAYBROOK ROAD	MIDDLETOWN	2/4/2014	2/24/2014	083-140207
300 PLAIN HILL ROAD	NORWICH	2/25/2014	3/21/2014	104-140303
127 NEW HARTFORD ROAD	BARKHAMSTED	1/28/2014	2/18/2014	005-140131
338 OXFORD ROAD	OXFORD	2/3/2014	2/24/2014	108-140206
104 BUNKER HILL ROAD	ANDOVER	1/28/2014	2/18/2014	001-140131
151 SAND HILL ROAD DUP 1	SOUTH WINDSOR	12/27/2013	1/23/2014	132-131230
BURR MOUNTAIN ROAD	TORRINGTON	1/14/2014	2/7/2014	143-140117
154 SAYLE AVENUE	PUTNAM	12/6/2013	12/27/2013	116-131209
307 INDIAN PARK LEDGE ROAD	TRUMBULL	2/6/2014	3/4/2014	144-140210
1116 JOHNSON ROAD	WOODBIDGE	2/24/2014	3/19/2014	167-140227
94 EAST HIGH STREET	EAST HAMPTON	2/4/2014	2/21/2014	042-140207
400 RILEY MOUNTAIN ROAD	COVENTRY	12/30/2013	1/23/2014	032-140102
103 GREAT HOLLOW ROAD	WOODBURY	1/23/2014	2/18/2014	168-140127
719 GEORGE WASHINGTON TUR	BURLINGTON	1/8/2014	2/6/2014	020-140114
175 SOUTH MAIN STREET	MARLBOROUGH	12/6/2013	12/27/2013	079-131209
1825 SOUTH MAIN STREET	MIDDLETOWN	12/13/2013	1/6/2014	083-131216
123 COSTELLO ROAD	NEWINGTON	12/13/2013	1/6/2014	094-131216
1925 EAST MAIN STREET	TORRINGTON	1/27/2014	2/18/2014	143-140130
50 PINE LANE	WINDSOR	12/13/2013	1/6/2014	164-131216
46 MEADOW ROAD	CLINTON	12/9/2013	2/24/2014	027-131213
856 MIDDLETOWN ROAD	COLCHESTER	2/27/2014	3/21/2014	028-140303
62 BABBITT HILL ROAD	POMFRET	1/8/2014	2/7/2014	112-140114
577 BELL STREET	GLASTONBURY	1/23/2014	2/18/2014	054-140127
215 COATNEY HILL ROAD	WOODSTOCK	1/6/2014	2/7/2014	169-140109
10 NORTH RIDGE DRIVE	WINDHAM	12/6/2013	12/27/2013	163-131209
142 FITTS ROAD	ASHFORD	12/6/2013	12/27/2013	003-131209B
60 RICE LANE	BEACON FALLS	1/14/2014	2/7/2014	006-140117
49 SOUTH ROAD	BOLTON	1/28/2014	2/19/2014	012-140131
47 INWOOD ROAD	ROCKY HILL	12/27/2013	1/22/2014	119-131230
10 PENT ROAD	DEEP RIVER	1/23/2014	2/19/2014	036-140127
130 BIRDSEYE ROAD	FARMINGTON	12/6/2013	12/27/2013	052-131209
2577 MAIN STREET	GLASTONBURY	12/27/2013	1/22/2014	054-131230
36 RITCH AVENUE WEST	GREENWICH	1/27/2014	2/18/2014	057-140130

181 A NORMAN ROAD	JEWETT CITY	2/19/2014	3/19/2014	058-140224
107 BUCK ROAD	HEBRON	12/27/2013	1/23/2014	067-131230
79 PUTnam PIKE	DAYVILLE	1/9/2014	2/6/2014	069-140114
43 CONNECTICUT MILLS ROAD	DANIELSON	1/24/2014	2/19/2014	069-140127
450-478 WEST MAIN STREET	MERIDEN	2/7/2014	3/4/2014	080-140210
393 JACKSON HILL ROAD	MIDDLEFIELD	12/30/2013	1/23/2014	082-140102
484 MERIDEN ROAD	MIDDLEFIELD	12/9/2013	1/2/2014	082-131213
1428 MONROE TURNPIKE	MONROE	1/16/2014	2/7/2014	085-140121
108 FOXON ROAD	NORTH BRANFORD	1/23/2014	2/19/2014	099-140127
ONE HARTFORD SQUARE	NEW BRITAIN	1/16/2014	1/22/2014	089-140121
130 BALD HILL ROAD	TOLLAND	1/23/2014	2/19/2014	142-140127
60 INDUSTRIAL PARK ROAD	VERNON ROCKVILLE	1/8/2014	2/10/2014	146-140114
478 GOOD HILL ROAD	WOODBURY	1/29/2014	2/21/2014	168-140203
491 SOUTH QUAKER LANE	WEST HARTFORD	1/28/2014	2/18/2014	155-140131
99 KNOWLTON HILL ROAD	ASHFORD	12/6/2013	12/27/2013	003-131209A
12 NEPAUG ROAD	BURLINGTON	1/29/2014	2/24/2014	020-140203
66 WALL STREET	HEBRON	1/2/2014	1/28/2014	067-140106
188 MOODY ROAD	ENFIELD	1/9/2014	2/7/2014	049-140114
3 EDMOND ROAD	NEWTOWN	1/16/2014	2/7/2014	097-140121
200 STANLEY STREET	NEW BRITAIN	12/5/2013	12/20/2013	089-131205A
178 LESTER STREET	NEW BRITAIN	12/5/2013	12/27/2013	089-131205B
370 ROCKLAND ROAD	GUILFORD	1/23/2014	2/19/2014	060-140127
6 PROGRESS AVENUE	SEYMOUR	1/29/2014	2/24/2014	124-140203
277 HUCKLEBERRY HILL ROAD	AVON	12/27/2013	1/23/2014	004-131230
350 HARTLAND BOULEVARD	EAST HARTLAND	2/26/2014	3/24/2014	065-140303
22 WAYSIDE LANE	REDDING	2/26/2014	3/24/2014	117-140303
285 CHAMBERLAIN HILL ROAD	HADDAM	12/6/2013	2/24/2014	061-131209
382 COLEBROOK RIVER ROAD	COLEBROOK	1/16/2014	2/7/2014	029-140121
157 CHESTNUT MOUNTAIN ROA	STAFFORD SPRINGS	1/7/2014	2/7/2014	134-140110
35 OLD ROUTE 44	EASTFORD	1/29/2014	2/24/2014	039-140203
699 OLD MAIN STREET	ROCKY HILL	2/6/2014	2/28/2014	119-140210



Matt Burke

16 Chestnut Street, Suite 220
Foxboro, MA 02035
Tel (508) 930-0974
Fax (774) 215-5423

RECEIVED
DEC 30 2013

**CONNECTICUT
SITING COUNCIL**

Melanie Bachman
Acting Executive Director
Connecticut Siting Council
10 Franklin Square
New Britain, CT 06051

Re: Notice of Exempt Modification - Emergency Backup Generator
277 Huckleberry Hill Road, Avon, CT 06001 (FA# 10105807)

Dear Ms. Bachman:

American Telephone and Telegraph Company ("AT&T") currently maintains a wireless telecommunications facility at the above referenced address. AT&T's facility consists of antennas at the 162' level of an existing 180' tower and a 12' x 20' equipment shelter. The tower and AT&T's shelter are located within an existing, fenced-in compound area. The shelter houses AT&T's equipment and space for a back-up generator. AT&T does not currently maintain a generator at this cell site.

In an effort to further enhance multiple tenants' network reliability, AT&T intends to modify its facility by installing a new diesel-fueled generator outside in a designated 4' x 8' ground space. The generator incorporates a built-in fuel tank as part of the unit. The diesel fuel tanks are double walled for added safety and will be filled by a licensed fuel filling company. The proposed modification will remain within the existing, fenced-in compound. The new generator and tank will be surrounded by a security fence and gate and will be placed on a 4' x 8' concrete pad. (See Facility Compound Plan attached).

Please accept this letter as notification pursuant to R.C.S.A Section 16-50j-73, for construction that constitutes modification pursuant to R.C.S.A Section 16-50j-72(b)(2). In accordance with R.C.S.A Section 16-50j-73, a copy of this submission is being sent to the Town of Avon, who also owns the land on which the tower is located.

AT&T's Proposed Wireless Modifications Constitute An "Exempt Modification"

The proposed modification to the above mentioned Facility constitutes an exempt modification of an existing facility provided for in R.C.S.A Section 16-50j-72(b)(2) and Council regulations promulgated pursuant thereto.

- 1) The proposed modification will not result in an increase in the height of the existing tower.

- 2) The generator and attached fuel tank will remain entirely within the limits of the leased area. The modifications therefore, will not require the extension of the boundary.
- 3) The proposed modification does not increase the noise levels at the boundary by six (6) decibels or more under normal conditions. Proposed modification is only used during emergency power failure.
- 4) The installation of a new generator and attached fuel tank will not change, in any way, radio frequency (RF) emissions at the facility.
- 5) The facility has received all municipal zoning approvals and building permits. (Regs., Conn. State Agencies Section 16-50j-72))

For all the foregoing reasons, American Telephone and Telegraph Company respectfully submits that the proposed modifications to the above-referenced telecommunications facility constitutes an exempt modification under R.C.S.A Section 16-50j-72(b)(2)

Respectfully submitted,



Matt Burke 508.930.0974

On behalf of AT&T

c/o Tower Resource Management, Inc.
16 Chestnut Street, Suite 220
Foxboro, MA 02035

cc: **Town of Avon, CT**

Exhibit I

Site Plan

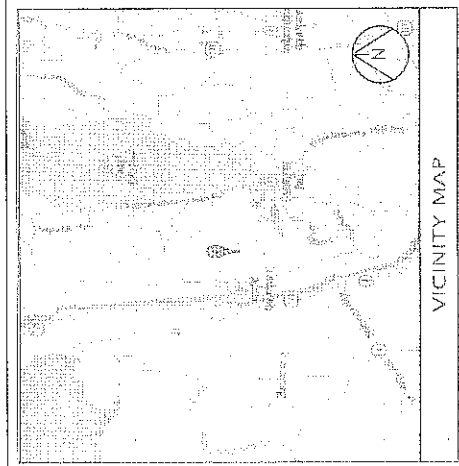

VICINITY MAP



See your map below.
Call before you dig.



BACKUP POWER PROJECT

SITE IDENTIFICATION:

SITE NUMBER: 10105807
 SITE NAME: AVON HUCKLEBERRY HILL ROAD
 SITE ADDRESS: 277 HUCKLEBERRY HILL ROAD
 AVON, CT 06001

PROJECT DESCRIPTION:

THE PROPOSED PROJECT INCLUDES PLACING A 50 KW GENERATOR IN AN EXISTING CELLULAR TOWER COMPOUND.

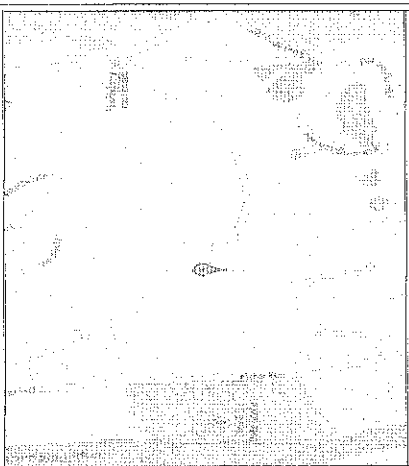

LOCAL MAP

NOTE:
 CONTRACTOR TO VERIFY EXISTING RUX LOCATION. IF RUX LOCATION IS OUTSIDE OF AT&T EQUIPMENT AREA, CONTRACTOR IS TO FIELD VERIFY THE PRESENCE OF EMERGENCY BACK-UP SERVICE TO THE MIX. IF EMERGENCY BACK-UP SERVICE IS NOT PRESENT, CONTRACTOR IS TO ROUTE NEW SERVICE FROM AT&T EQUIPMENT AREA

SHEET INDEX

SHT NO.	DESCRIPTION:	REV.	DATE:	BY:
T-1	TITLE SHEET, VICINITY MAP AND GENERAL INFORMATION	A	11-13-13	RS
A-1	SITE PLAN	A	11-13-13	RS
A-2	CONCRETE PAD DETAILS	A	11-13-13	RS
E-1	WIRING DIAGRAM & H-FRAME LAYOUT	A	11-13-13	RS
E-2	ELECTRICAL DETAILS	A	11-13-13	RS
G-1	COMPOUND GROUNDING	A	11-13-13	RS
	GENERATOR ASSEMBLY AND INSTALLATION SUPPLEMENT			

PROJECT NOTES

1. THE FACILITY IS UNMANNED.
2. A TECHNICIAN WILL VISIT THE SITE APPROXIMATELY ONCE A MONTH FOR ROUTINE INSPECTION AND MAINTENANCE.
3. THE PROJECT WILL NOT RESULT IN ANY SIGNIFICANT LAND DISTURBANCE OR EFFECT OF STORM WATER DRAINAGE.
4. NO SANITARY SEWER; POTABLE WATER OR TRASH DISPOSAL IS REQUIRED.
5. HANDICAP ACCESS IS NOT REQUIRED.

PROJECT LOCATION DIRECTIONS

START OUT GOING NORTHEAST ON ENTERPRISE DR TOWARD CAPITOL BLVD. TURN LEFT ONTO CAPITOL BLVD. TURN LEFT ONTO WEST ST. MERGE ONTO I-91 S VIA THE RAMP ON THE LEFT TOWARD NEW HAVEN. MERGE ONTO CT-9 K VIA EXIT 22A TOWARD NEW BRITAIN 11.1 MILES. MERGE ONTO I-84 W/JUS-6 W VIA EXIT 32 ON THE LEFT TOWARD WATERBURY/CT-4. MERGE ONTO CT-4 W/FARRINGTON AVE VIA EXIT 39 TOWARD FARRINGTON ST. MERGE LEFT ONTO SLIGHT RIGHT ONTO HUCKLEBERRY HILL RD. SLIGHT RIGHT ONTO HUCKLEBERRY HILL RD ON THE LEFT. 277 HUCKLEBERRY HILL RD IS ON THE LEFT.

PROJECT SUMMARY

GEOGRAPHIC COORDINATES:
 LATITUDE: 41° 47' 17.6" N (41.78821 N)
 LONGITUDE: -72° 55' 05.7" W (-72.91825 W)
 GROUND ELEVATION: N/A
 CODE BLOCK:
 BUILDING CODE: 2009 INTERNATIONAL BUILDING CODE
 AT&T OPS FOR POWER CUT OVER:
 NEED 24 HOUR NOTICE
 TO OPEN A TAP TICKET:
 DIAL: 1-800-638-2822
 SELECT OPTION 2, THEN OPTION 2

PROJECT TEAM

CUSTOMER REPRESENTATIVE:
 PEGGY POOR
 SABRE INDUSTRIES
 HANSET LEAD - AT&T NE GENERATOR PROGRAM
 13300 WORNES ROAD, 6TH FLOOR, BLDG 1
 ALPHARETTA, GA 30004
 CELL 770-590-0327
 ppoor@sabreindustries.com

LANDLORD:
 SPRINT SPECTRUM REALTY COMPANY, LLC
 3900 BROKEN SOUND PARKWAY N.W. 2ND FLOOR
 SUITE 800, FT. LAUDERDALE, FL 33309

GROUND OWNER:
 TOWN OF AVON
 100 WALL ST WEST MAIN ST.
 AVON, CONNECTICUT

UTILITIES:

POWER COMPANY:
 NAME: NORTHEAST UTILITIES
 TEL: 1-800-288-2000

500 ENTERPRISE DRIVE, SUITE 200
 ROCKY HILL, CT 06867

SABRE INDUSTRIES

Hudson
 1600 ORCHARD STREET
 BUILDING 20 NORTH, SUITE 1000
 W. WINDOVER, MA 01812
 TEL: (978) 597-5350
 FAX: (978) 394-5826

SITE NUMBER:
10105807

SITE NAME:
AVON HUCKLEBERRY HILL ROAD

SITE ADDRESS:
 277 HUCKLEBERRY HILL ROAD
 AVON, CT 06001

STAMP NUMBER: 185
 CHECKED BY: SS
 DATE DRAWN: 11-13-13
 SHEET TITLE:
 TITLE SHEET
 VICINITY MAP
 AND GENERAL
 INFORMATION

SHEET NUMBER:
 T-1

REV. #
 A

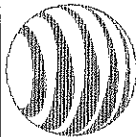

380 ENTERPRISE DRIVE, SUITE 1A
ROCKY HILL, CT 06067

THIS DRAWING IS THE PROPERTY OF AT&T INTELLECTUAL PROPERTY. IT IS TO BE USED ONLY FOR THE PROJECT AND SITE SPECIFICALLY IDENTIFIED HEREIN. IT IS NOT TO BE REPRODUCED, COPIED, OR TRANSMITTED IN ANY FORM OR BY ANY MEANS, ELECTRONIC OR MECHANICAL, INCLUDING PHOTOCOPYING, RECORDING, OR BY ANY INFORMATION STORAGE AND RETRIEVAL SYSTEM, WITHOUT THE WRITTEN PERMISSION OF AT&T INTELLECTUAL PROPERTY. ANY UNAUTHORIZED USE OF THIS DRAWING IS STRICTLY PROHIBITED. THE USER OF THIS DRAWING AGREES TO HOLD AT&T INTELLECTUAL PROPERTY HARMLESS FROM AND AGAINST ALL CLAIMS, DAMAGES, LOSSES AND EXPENSES, INCLUDING REASONABLE ATTORNEY'S FEES, THAT MAY BE ASSERTED AGAINST AT&T INTELLECTUAL PROPERTY AS A RESULT OF SUCH UNAUTHORIZED USE.

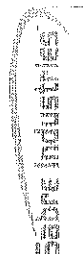

1000 GARWOOD STREET
SUITE 200
M. ANDOVER, MA 01850
TEL: (978) 551-5132
FAX: (978) 551-5160

SITE NUMBER:
10105807

SITE NAME:
AVON HUCKLEBERRY
HILL ROAD

SITE ADDRESS:
277 HUCKLEBERRY HILL ROAD
AVON, CT 06001



STAMP HERE: []
DRAWN BY: AS
CHECKED BY: SS
DATE DRAWN: 11-23-82
JOB NO.: 1173-01
SHEET TITLE:

SITE PLAN

SHEET NUMBER: A-1
REV. # A

NOTE:
CONTRACTOR TO VERIFY EXISTING MUX LOCATION. IF MUX LOCATION IS OUTSIDE OF
ATE™ EQUIPMENT AREA, CONTRACTOR IS TO FIELD VERIFY THE PRESENCE OF
EMERGENCY BACK-UP SERVICE TO THE MUX. IF EMERGENCY BACK-UP SERVICE IS NOT
PRESENT, CONTRACTOR IS TO ROUTE NEW SERVICE FROM AT&T™ EQUIPMENT AREA.

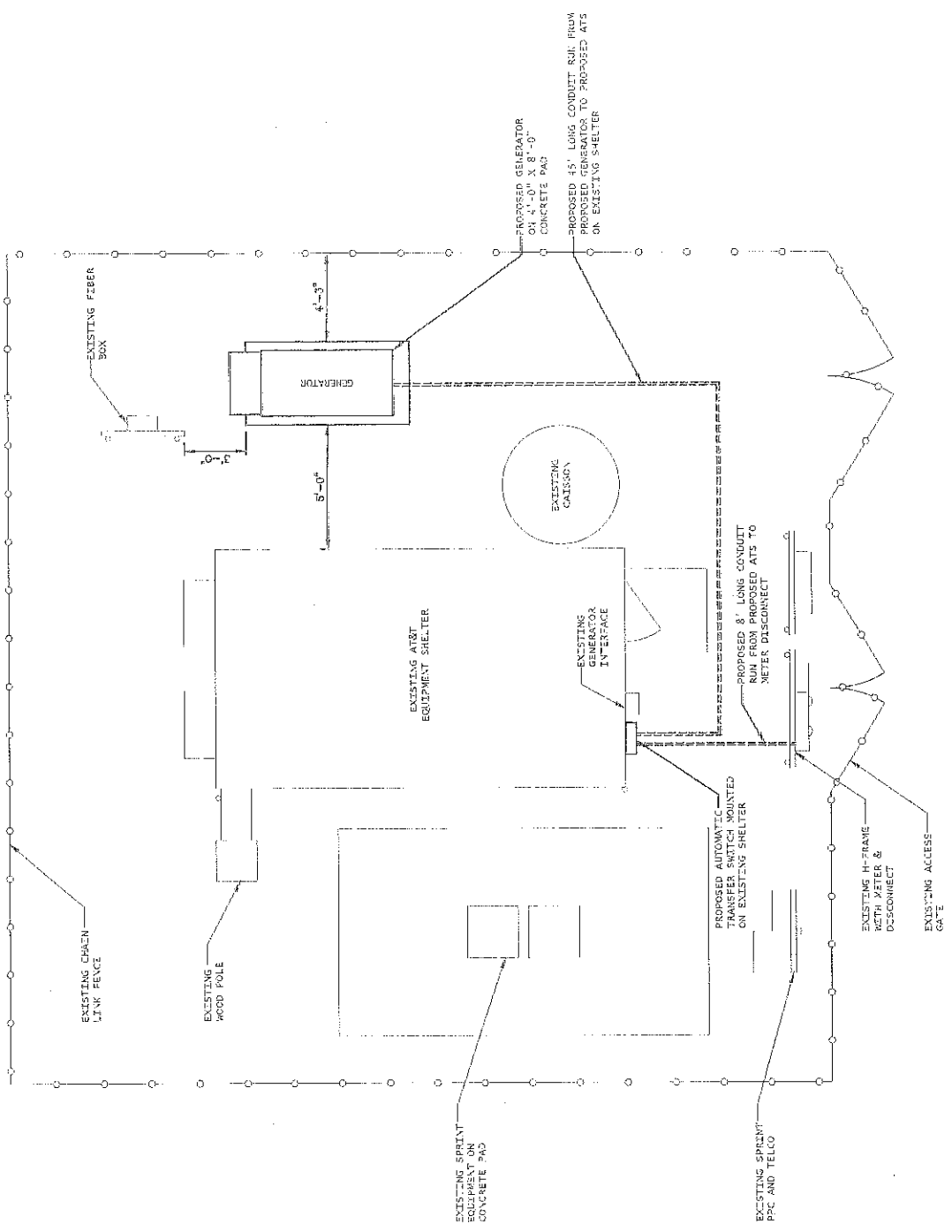

1 SITE PLAN
SCALE: 3/16" = 1'-0" (11"x17")
3/8" = 1'-0" (24"x36")