

INTERSECTION SIGNAL AND CROSSWALK IMPROVEMENTS

REPLACE EXISTING ABUTMENTS AND PIERS (TYP.)

PROPOSED BRIDGE NO. 03612

CONSTRUCTION EASEMENT

APPROXIMATE LIMITS OF PAVING

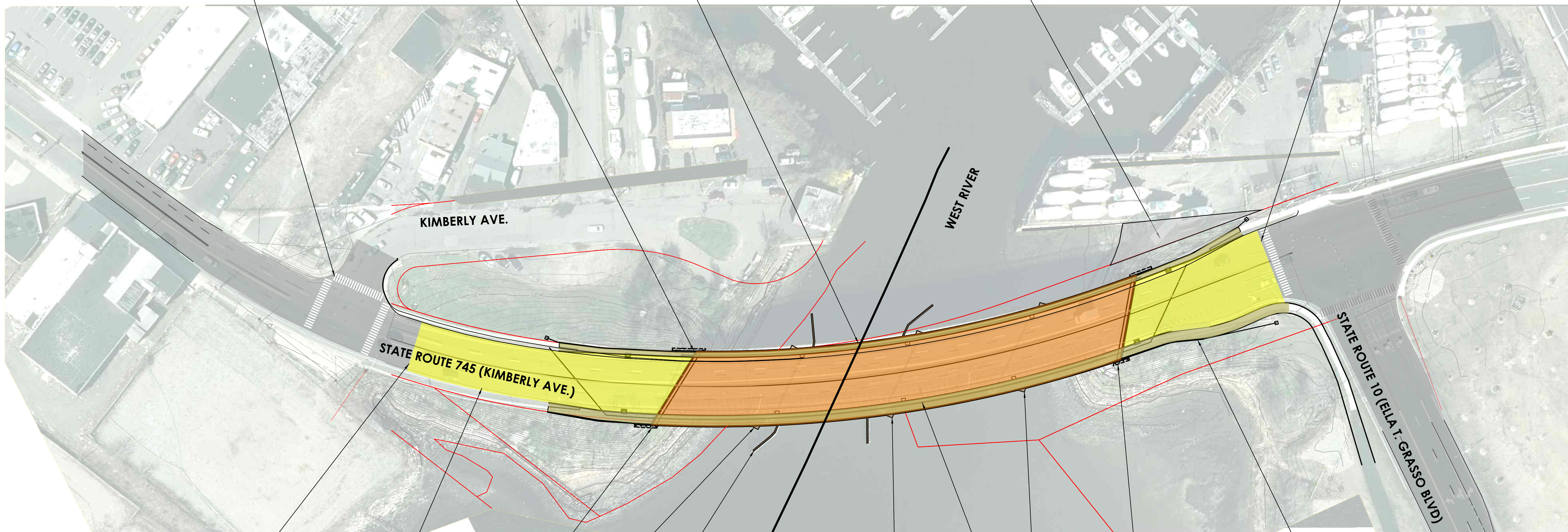

APPROXIMATE LIMITS OF PAVING

RECONSTRUCTED PAVEMENT

BRIDGE ABUTMENT 1

PIER 1

PROPOSED FENDER SYSTEM (TYP.)

WEST HAVEN  
NEW HAVEN

PIER 2

PIER 3

BRIDGE ABUTMENT 2

PROPOSED GUIDERAIL (TYP.)

PROPOSED LOCATION OF RELOCATED WATER MAIN

**LEGEND**

- = RECONSTRUCTED PAVEMENT
- = EXISTING UNDISTURBED PAVEMENT
- = PROPOSED SIDEWALK
- = PROPOSED STRUCTURE
- = RIGHT OF WAY

**OVERALL PLAN**

REV.	DATE	REVISION DESCRIPTION

SIGNATURE/  
BLOCK:

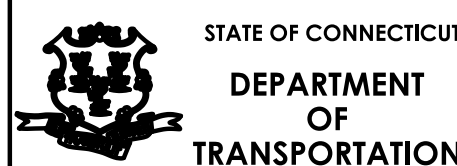



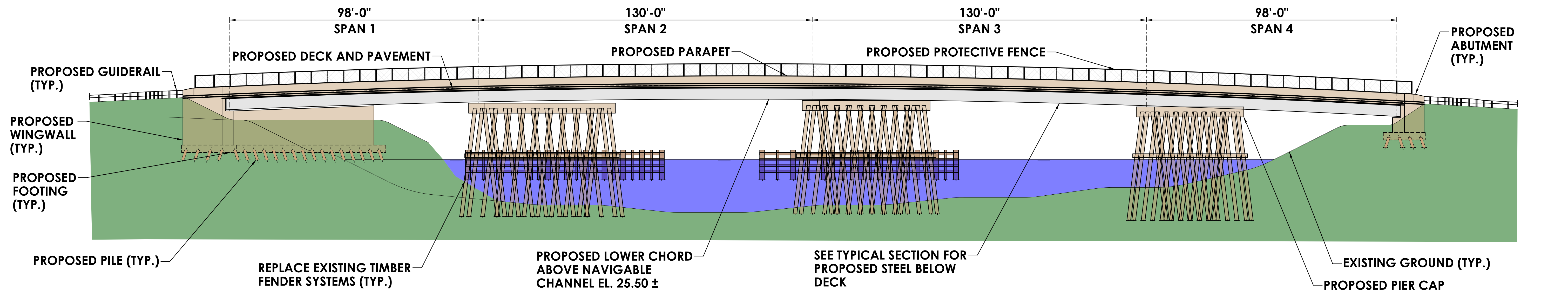
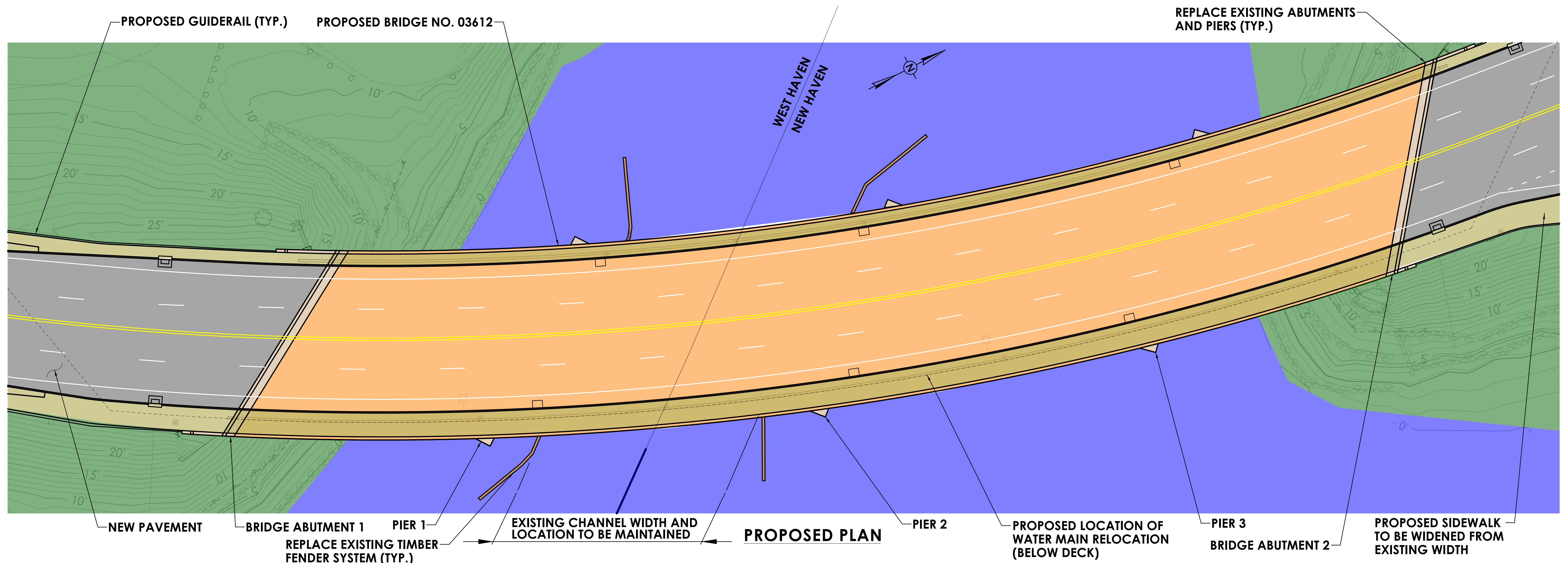

**LEGEND**

- = WATER
- = EXISTING GROUND/BELOW GRADE
- = PROPOSED SIDEWALK
- = PROPOSED STRUCTURE
- = PROPOSED CONCRETE
- = PROPOSED TIMBER
- = NEW PAVEMENT
- = PROPOSED STEEL

**PROPOSED ELEVATION**

<table border="1" style="width: 100%; border-collapse: collapse;"> <tr><th>REV.</th><th>DATE</th><th>REVISION DESCRIPTION</th></tr> <tr><td> </td><td> </td><td> </td></tr> <tr><td> </td><td> </td><td> </td></tr> <tr><td> </td><td> </td><td> </td></tr> </table>	REV.	DATE	REVISION DESCRIPTION										DESIGNER/DRAFTER: D. WELLS CHECKED BY: A. AMARONE LAST SAVED BY: amaronone FILE NAME: c:\users\amaronone\hhprod\dms95242\sb_CP_0156_0184_PIM_02_Elevation.dgn PLOTTED DATE: 5/20/2024	SIGNATURE/BLOCK: 		PROJECT NUMBER: 0156-0184 PROJECT DESCRIPTION: REPLACEMENT OF BRIDGE NO. 03612 - STATE ROUTE 745 (KIMBERLY AVE.) OVER WEST RIVER TOWN(S): NEW HAVEN, WEST HAVEN DRAWING TITLE: GENERAL PLAN AND ELEVATION	DRAWING NO. PIM-02 SHEET NO.
REV.	DATE	REVISION DESCRIPTION															



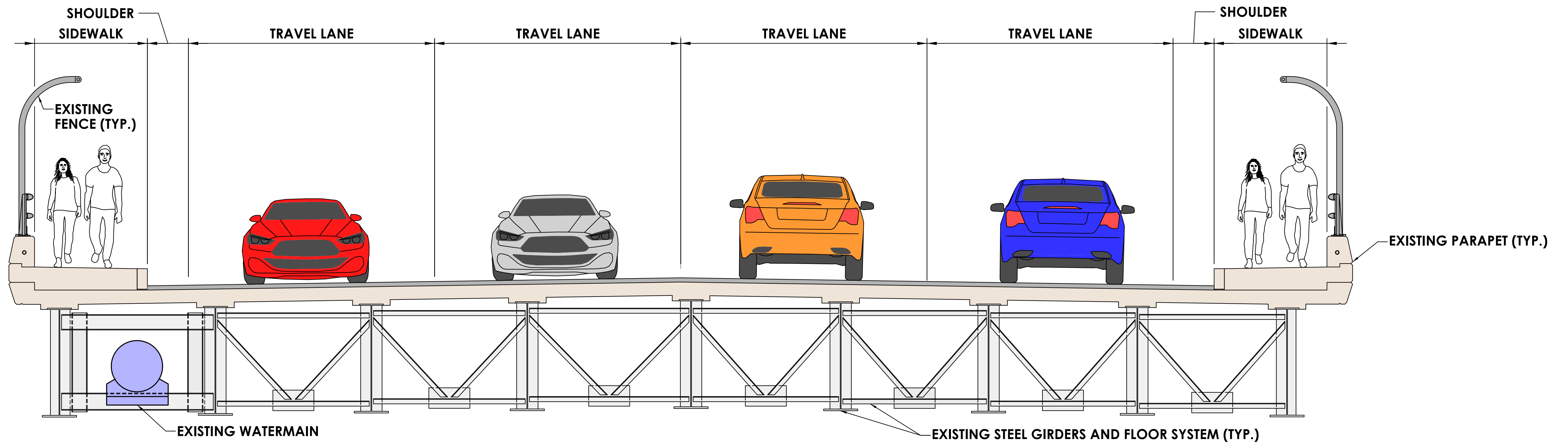

**EXISTING SECTION**

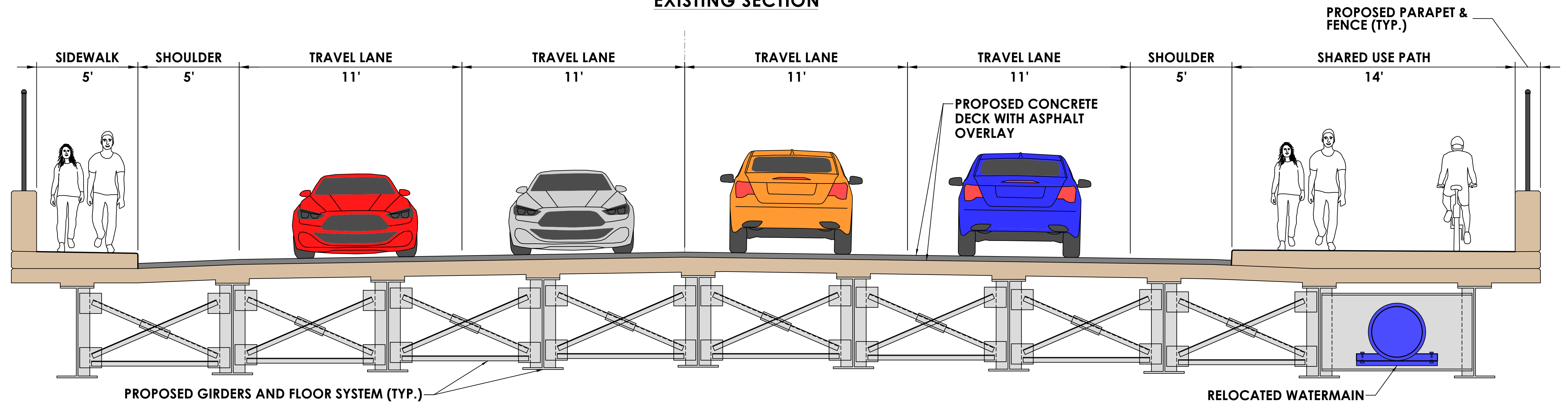

**PROPOSED SECTION**

REV.	DATE	REVISION DESCRIPTION

DESIGNER/DRAFTER: D. WELLS    CHECKED BY: A. AMARONE  
 LAST SAVED BY: dswells    FILE NAME: c:\users\dswells\hnp\prod\dms95242\SB\_CP\_0156\_0184\_PIM.03\_Typical Section.dgn  
 PLOTTED DATE: 6/11/2024

SIGNATURE/BLOCK:

STATE OF CONNECTICUT  
 DEPARTMENT OF TRANSPORTATION

PROJECT NUMBER: 0156-0184  
 PROJECT DESCRIPTION: REPLACEMENT OF BRIDGE NO. 03612 - STATE ROUTE 745 (KIMBERLY AVE.) OVER WEST RIVER  
 TOWN(S): NEW HAVEN, WEST HAVEN  
 DRAWING TITLE: EXISTING AND PROPOSED TYPICAL SECTION

DRAWING NO. PIM-03  
 SHEET NO.



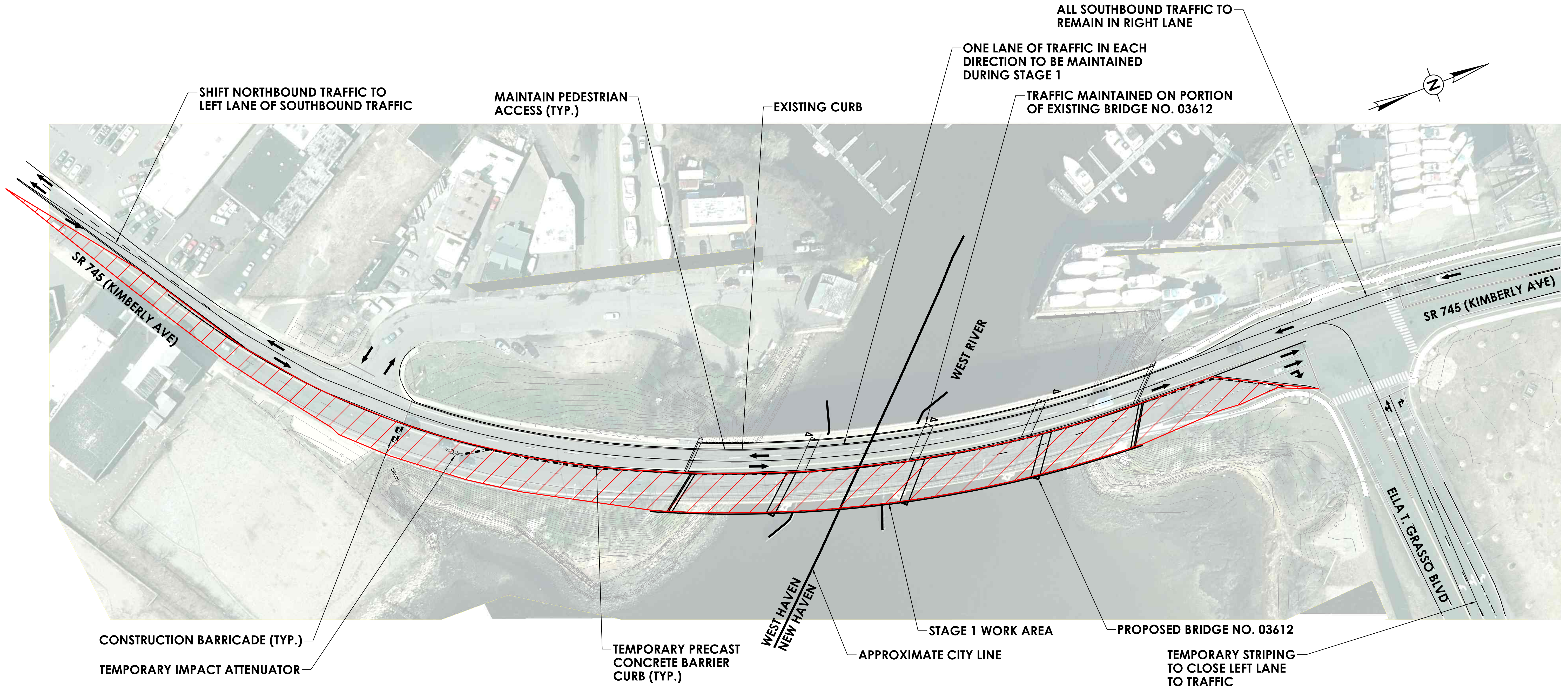

**NOTES:**

1. SIGNALS AT THE KIMBERLY AVE. / ELLA T. GRASSO BLVD AND KIMBERLY AVE. / KIMBERLY AVE. EXT. INTERSECTIONS TO BE ADJUSTED AS NECESSARY.
2. THE NAVIGATION CHANNEL WILL BE MAINTAINED FOR MARITIME TRAFFIC THROUGHOUT CONSTRUCTION

**LEGEND**

= ROAD CLOSURE/WORK ZONE

**MAINTENANCE AND PROTECTION OF TRAFFIC STAGE 1 PLAN**

REV.	DATE	REVISION DESCRIPTION

DESIGNER/DRAFTER: D. WELLS    CHECKED BY: A. AMARONE

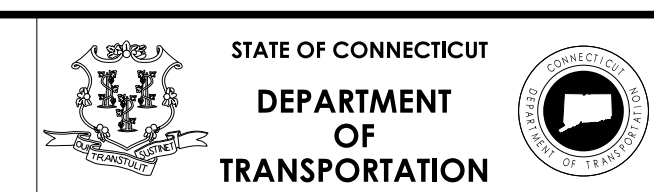
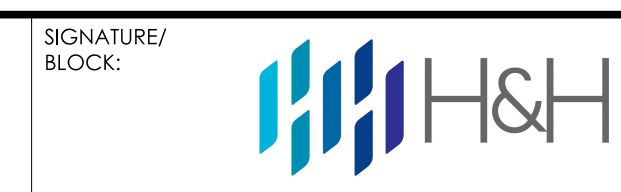

PROJECT NUMBER: 0156-0184  
 PROJECT DESCRIPTION: REPLACEMENT OF BRIDGE NO. 03612 - STATE ROUTE 745 (KIMBERLY AVE.) OVER WEST RIVER  
 TOWN(S): NEW HAVEN, WEST HAVEN  
 DRAWING TITLE: MAINTENANCE AND PROTECTION OF TRAFFIC PLAN STAGE 1

DRAWING NO. PIM-04  
 SHEET NO.



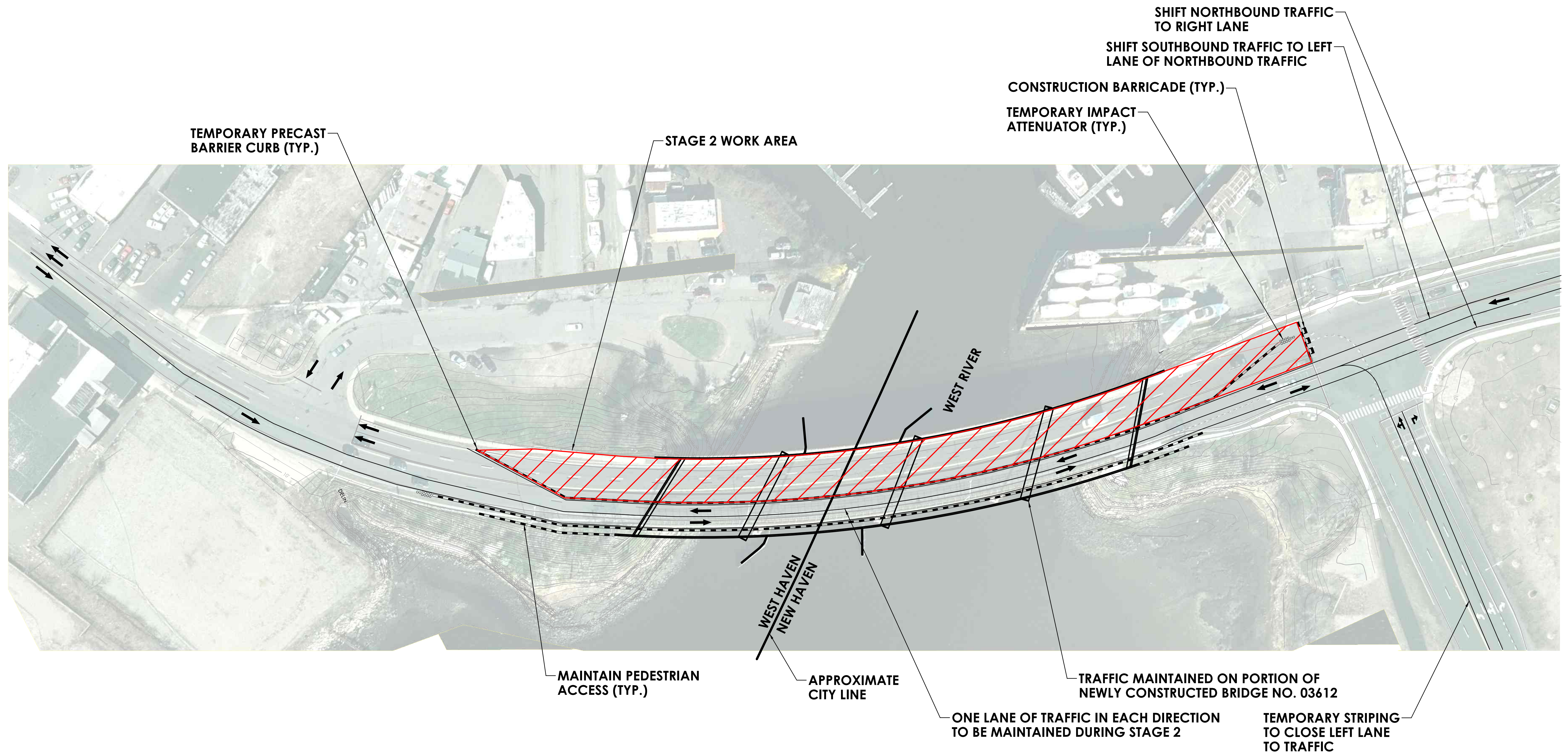

**NOTES:**

1. SIGNALS AT THE KIMBERLY AVE. / ELLA T. GRASSO BLVD AND KIMBERLY AVE. / KIMBERLY AVE. EXT. INTERSECTIONS TO BE ADJUSTED AS NECESSARY.
2. THE NAVIGATION CHANNEL WILL BE MAINTAINED FOR MARITIME TRAFFIC THROUGHOUT CONSTRUCTION

**LEGEND**

= ROAD CLOSURE/WORK ZONE

**MAINTENANCE AND PROTECTION OF TRAFFIC STAGE 2 PLAN**

REV.	DATE	REVISION DESCRIPTION

DESIGNER/DRAFTER: D. WELLS    CHECKED BY: A. AMARONE

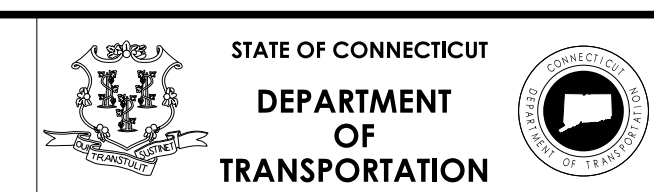
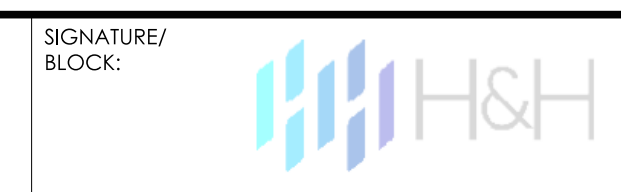

PROJECT NUMBER: 0156-0184  
 PROJECT DESCRIPTION: REPLACEMENT OF BRIDGE NO. 03612 - STATE ROUTE 745 (KIMBERLY AVE.) OVER WEST RIVER  
 TOWN(S): NEW HAVEN, WEST HAVEN  
 DRAWING TITLE: MAINTENANCE AND PROTECTION OF TRAFFIC PLAN STAGE 2

DRAWING NO. PIM-05  
 SHEET NO.



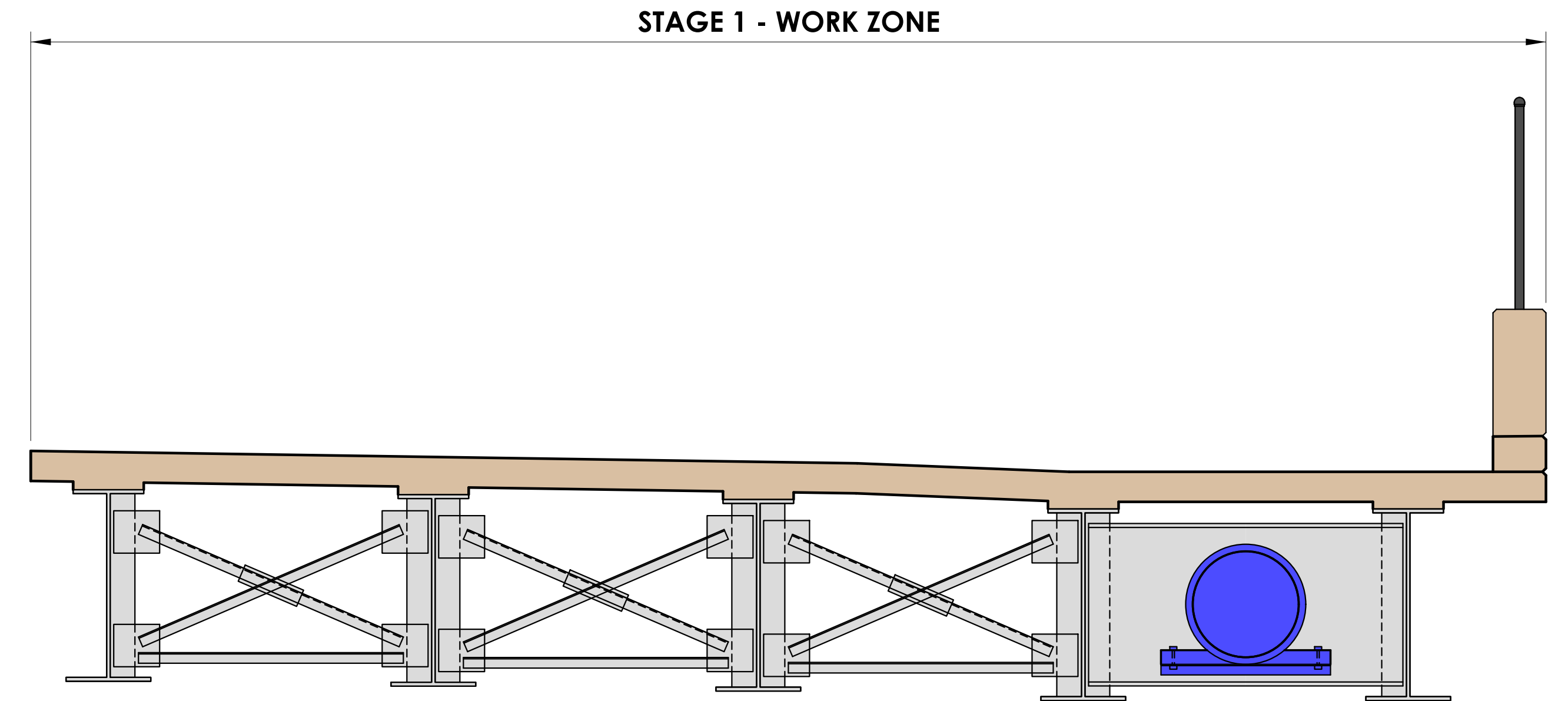
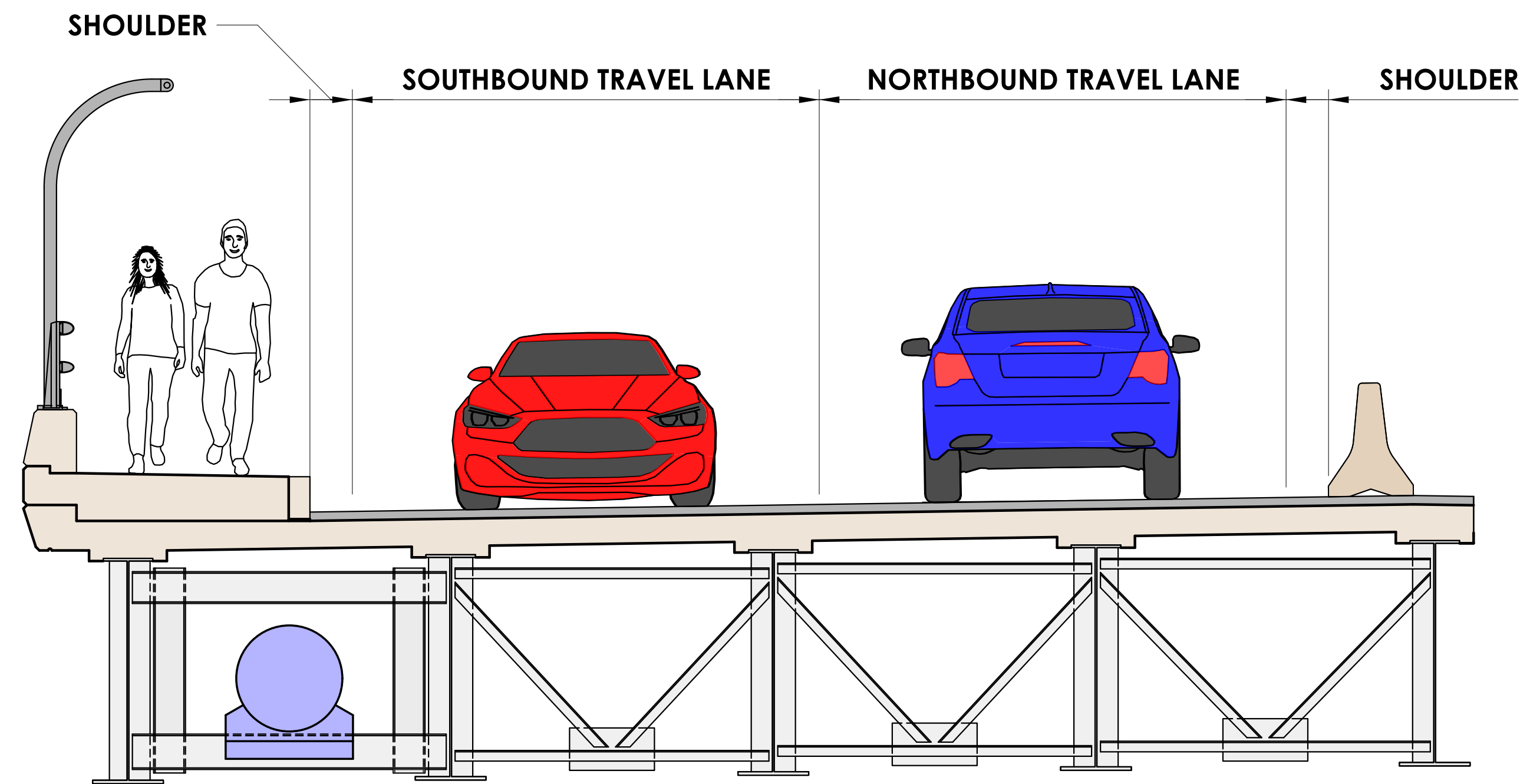

**MAINTENANCE AND PROTECTION OF TRAFFIC STAGING PLAN - STAGE 1**

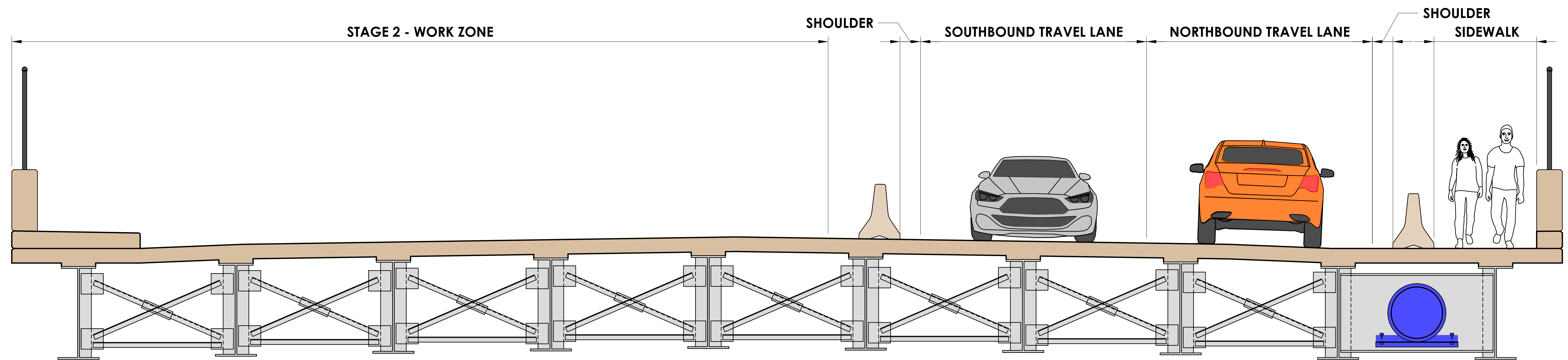

**MAINTENANCE AND PROTECTION OF TRAFFIC STAGING PLAN - STAGE 2**

**NOTES:**

1. ONLY PARAPET AT EAST SIDEWALK TO BE CONSTRUCTED DURING STAGE 1 TO ALLOW 2 LANES OF TRAFFIC DURING STAGE 2. THE REST OF SIDEWALK WILL BE COMPLETED AFTER STAGE 2 IS COMPLETE.

REV.	DATE	REVISION DESCRIPTION

DESIGNER/DRAFTER: D. WELLS    CHECKED BY: A. AMARONE

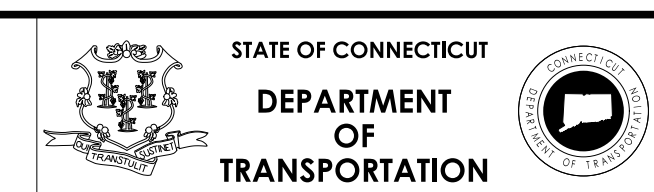
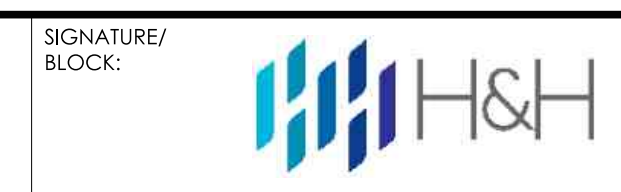

PROJECT NUMBER: 0156-0184  
 PROJECT DESCRIPTION: REPLACEMENT OF BRIDGE NO. 03612 - STATE ROUTE 745 (KIMBERLY AVE.) OVER WEST RIVER  
 TOWN(S): NEW HAVEN, WEST HAVEN  
 DRAWING TITLE: MAINTENANCE AND PROTECTION OF TRAFFIC STAGING SECTIONS

DRAWING NO. PIM-06  
 SHEET NO.