



Office of the Executive Vice President for  
Administration and Chief Financial Officer  
**Scott A. Jordan**  
Executive Vice President  
for Administration  
and Chief Financial Officer

*Via E-Mail Only*

November 20, 2020

Jonathan Kinney, Director of Operations  
Connecticut State Historic Preservation Office  
Department of Economic & Community Development  
450 Columbus Boulevard, Suite 5  
Hartford, CT 06103

RE: Acceptance of Contributing Resource Demolition Mitigation Measures

Dear Director Kinney:

Pursuant to Section 2.2(c)(5) of the April 21, 2017 Memorandum of Understanding and Agreement, your office was notified by the University earlier this year about planned demolition activities within the Mansfield Training School & Hospital Historic Register District. Specifically, the University intends to demolish six (6) contributing resources to that district at our Spring Manor Farm facility that are in extreme disrepair and pose imminent life safety issues if not demolished, or otherwise stabilized.

Since that notification, three UConn offices – University Planning, Design & Construction, Facilities Operations, and Environmental Health & Safety – have collaborated with you and your staff on acceptable mitigation measures in order to proceed with the planned limited demolition. Those proposed measures are:

1. In consultation with the State Historic Preservation Office and Mansfield Historical Society, prepare a short booklet on Spring Manor Farm's history supporting the Mansfield Training School & Hospital including, but not limited to, written and photographic documentation on each resource's location, significance, description and history. A PDF copy will be published on the website of University Planning, Design & Construction and up to 100 printed copies will be available at no cost to the general public attending Spring Valley Student Farm's annual workshops or tours. (Complete by Summer 2021);
2. Salvage up to three (3) pallets of hand-formed concrete block for repurposing them as interpretative seating along the portion of the Midriver Trail on Spring Manor Farm's property that connects Lynch Landing and Merrow Meadow Park. (Complete by Spring 2021); and
3. Raise awareness on epilepsy by including asters and other purple wildflower species in the seed mix used for site restoration. Install an interpretative sign about the Farm's use as occupational therapy intervention on seizure disorders. (Complete by Fall 2021)

Please indicate your acknowledgement and acceptance of these mitigation measures by counter-signing where indicated below. Once you have done so, please furnish a PDF copy to Sean Vasington, PLA, ASLA, UConn's Director of Site Planning & Landscape Architecture, via e-mail to [sean.vasington@uconn.edu](mailto:sean.vasington@uconn.edu).

Upon UConn's receipt of your counter-signed PDF copy of this letter and UConn's completion of its ongoing public scoping process required under the Connecticut Environmental Protection Act, UConn will proceed to demolish the six (6) structures, as the same is described in the attached documentation.

Sincerely,



Scott A. Jordan  
Executive Vice President for Administration and Chief Financial Officer

Encl.

CC: Laura Cruickshank, UConn  
Sean Vasington, UConn

Acknowledged and Accepted:



---

Jonathan Kinney, Director of Operations  
Connecticut State Historic Preservation Office

Date: 11/25/2020

# UCONN Building Demolitions – Spring Manor Farm

## Slaughter House (Building #2191)



# UCONN Building Demolitions – Spring Manor Farm

## Livestock Barn (Building #7122)



# UCONN Building Demolitions – Spring Manor Farm

## Greenhouse (Building #7120)

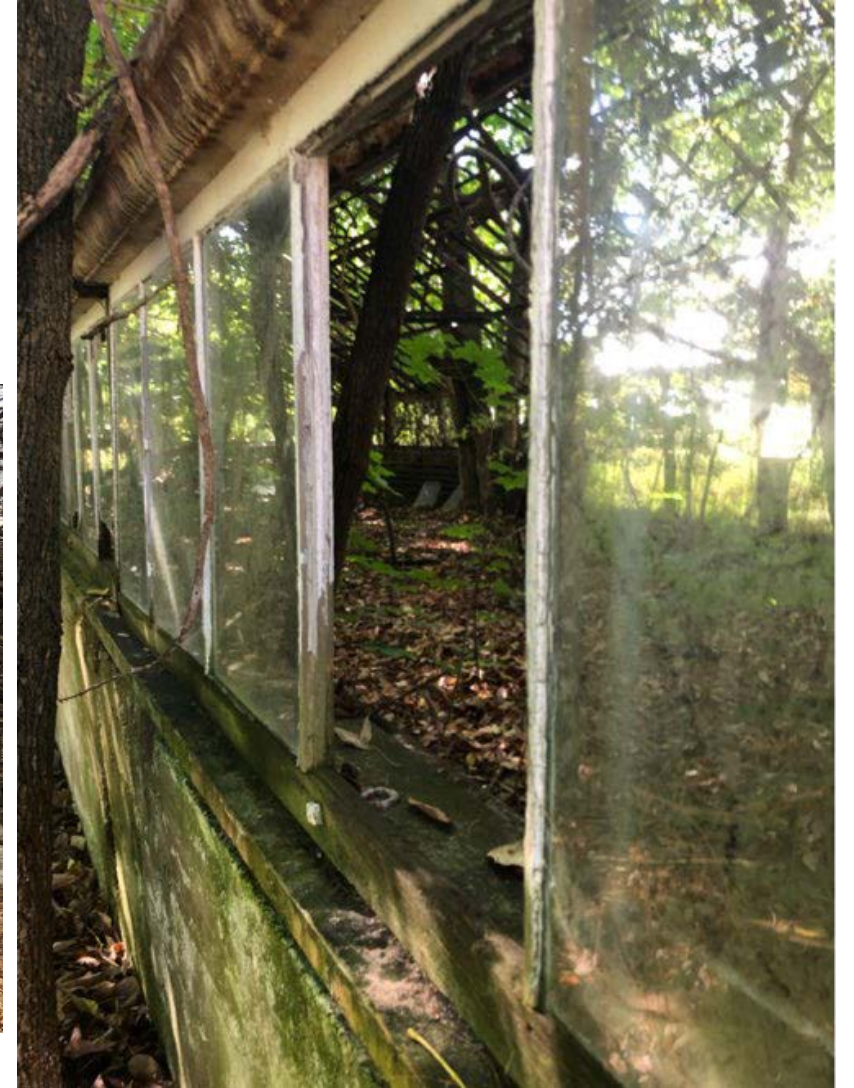

# UCONN Building Demolitions – Spring Manor Farm

## Dairy Processing House (Building #7106)



# UCONN Building Demolitions – Spring Manor Farm

## Dairy Barns and Silos

(Buildings #7104, #7105)



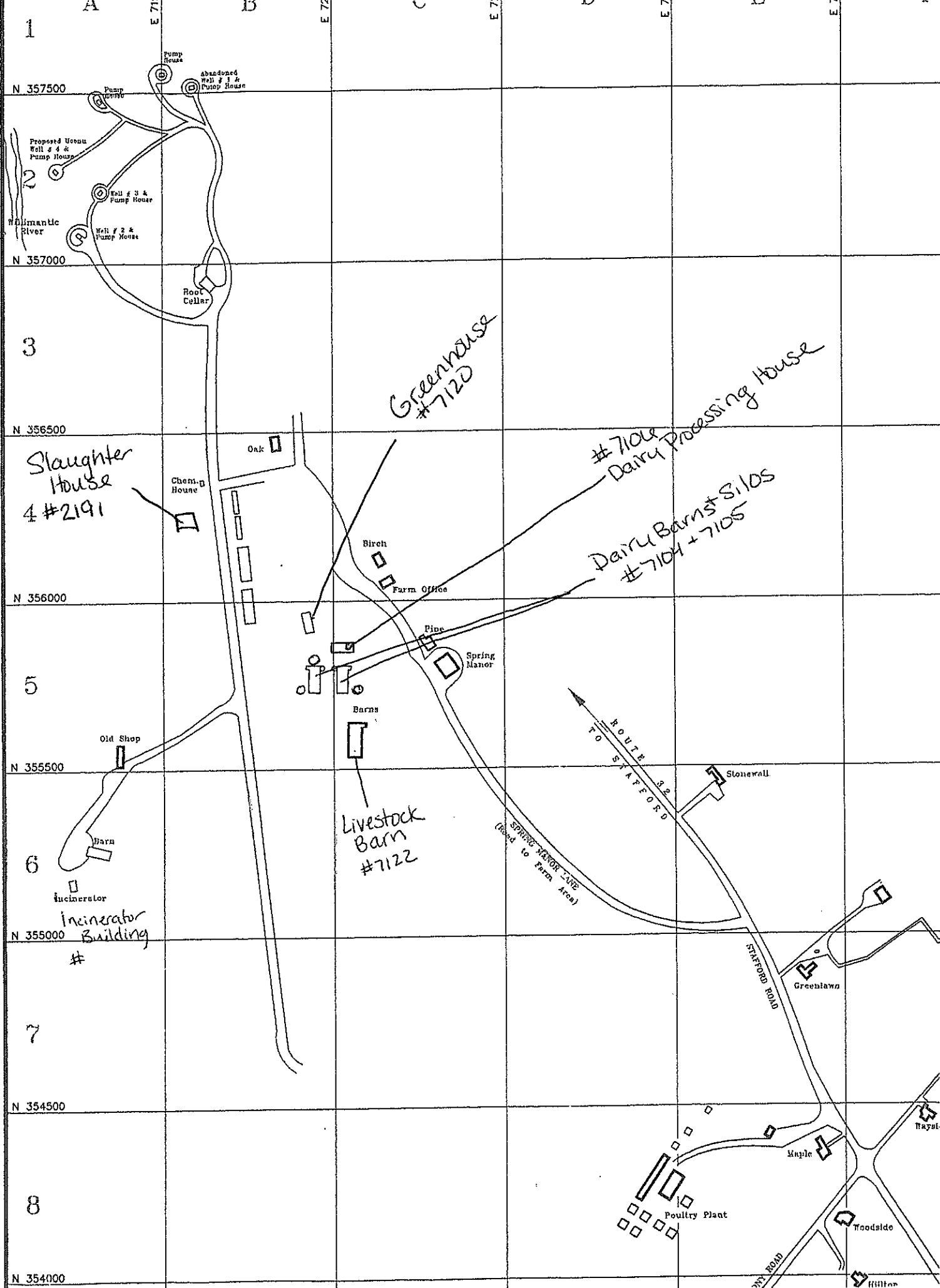

1  
N 357500  
2  
N 357000  
3  
N 356500  
4  
N 356000  
5  
N 355500  
6  
N 355000  
7  
N 354500  
8  
N 354000

A D E7 E7 E7 E7 E7

Slaughter House  
4 #2191

Greenhouse  
#7120

#7104 Dairy Processing House

Dairy Barns + Silos  
#7104 + 7105

Livestock Barn  
#7122

Incinerator Building  
#

Poultry Plant

Greenlawn

Maple

Woodside

Haystack

Millton

Root Cellar

Chem. House

Oak

Birch

Farm Office

Pine

Spring Manor

Barns

Old Shop

Barn

Incinerator

Stonewall

ROUTE 32  
TO STAFFORD

SPRING MANOR DRIVE  
(Road to Farm Area)

STAFFORD ROAD

MILL ROAD



**FIELD INSPECTION REPORT**

Inspection Date: February 21, 2020  
 Project Name: Spring Manor Farm  
 Project Number:  
 Building Name: Various Structures as listed below  
 Inspector: David Houseman Jr.

Scope: The office of FMBIO was asked to evaluate the structures for the feasibility of conservation of historical significant structures. The structures on the list were in various states of structural collapse and have been for a significant period of time. Photos of the structures were taken on each accessible side of the structure. The photos show unstable walls sections and structural decay with no lateral bracing which is subject to further failure from lateral forces such as wind. It is of the opinion of this Building Official that there is the possibility of imminent danger and of further collapse. The structures will be posted immediately at the entrance locations of the structures stating it is unlawful for entrance to such structure without permission from the Building Officials office.

The structures evaluated in this report were found on the Mansfield Town Property record ID# 7.12.5 ACC# 7125 are as follows:

- Slaughter House UConn #2191
- Livestock Barn UConn #7122
- Greenhouse UConn # 7120
- Dairy Processing House UConn #7106
- Dairy Barn and Silo UConn #7104
- Dairy Barn and Silo UConn #7105

C: Condition Compliant / N: Condition Noncompliant

Index #	ISSUE	C/N	CODE	SECT. #
1	<p><b>Observation:</b> Structures identified in the scope above were found to be in various states of collapse and are in imminent danger of further collapse. Photos of the field inspection were up loaded to the property file.</p> <p><b>Conclusion:</b> Signs for posting the property access to the structures were provided for posting as the Building code requires.</p>	N	2018 SBC	117.1

Remarks:

End of Report

Inspector Signature: \_\_\_\_\_