

TIE-BACK WALL PLAN

LEGEND:

- PROPOSED STRUCTURE
- EXISTING STRUCTURE
- EXISTING PAVEMENT
- PAVEMENT RECONSTRUCTION
- PROPOSED GRADING IMPACTS

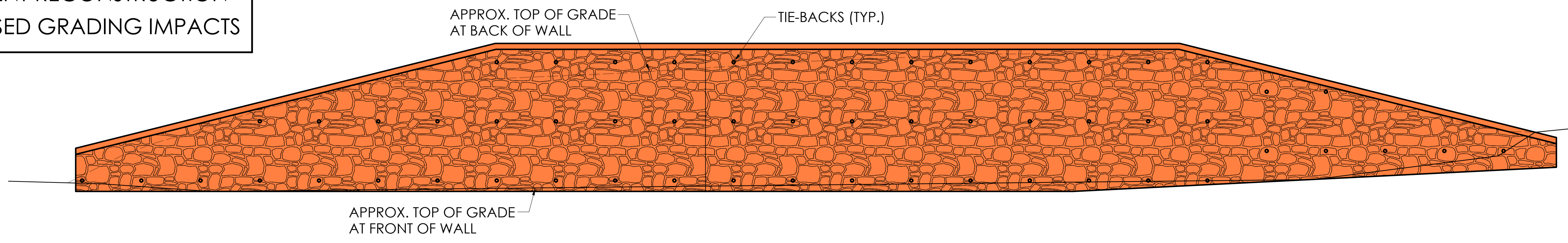

TIE-BACK WALL ELEVATION

RW-157-053-001

REV.	DATE	REVISION DESCRIPTION

SIGNATURE BLOCK:		CONNECTICUT DEPARTMENT OF TRANSPORTATION	PROJECT TITLE:	TOWN(S):	DRAWING TITLE:	PROJECT NO.:	DRAWING NO.:
DESIGNER/DRAFTER: A. BISI	CHECKED BY: M. HABEK		STATEWIDE RETAINING WALL PROGRAM	WESTON	RETAINING WALL PLAN & ELEVATION	0173-0539	SHEET NO.:

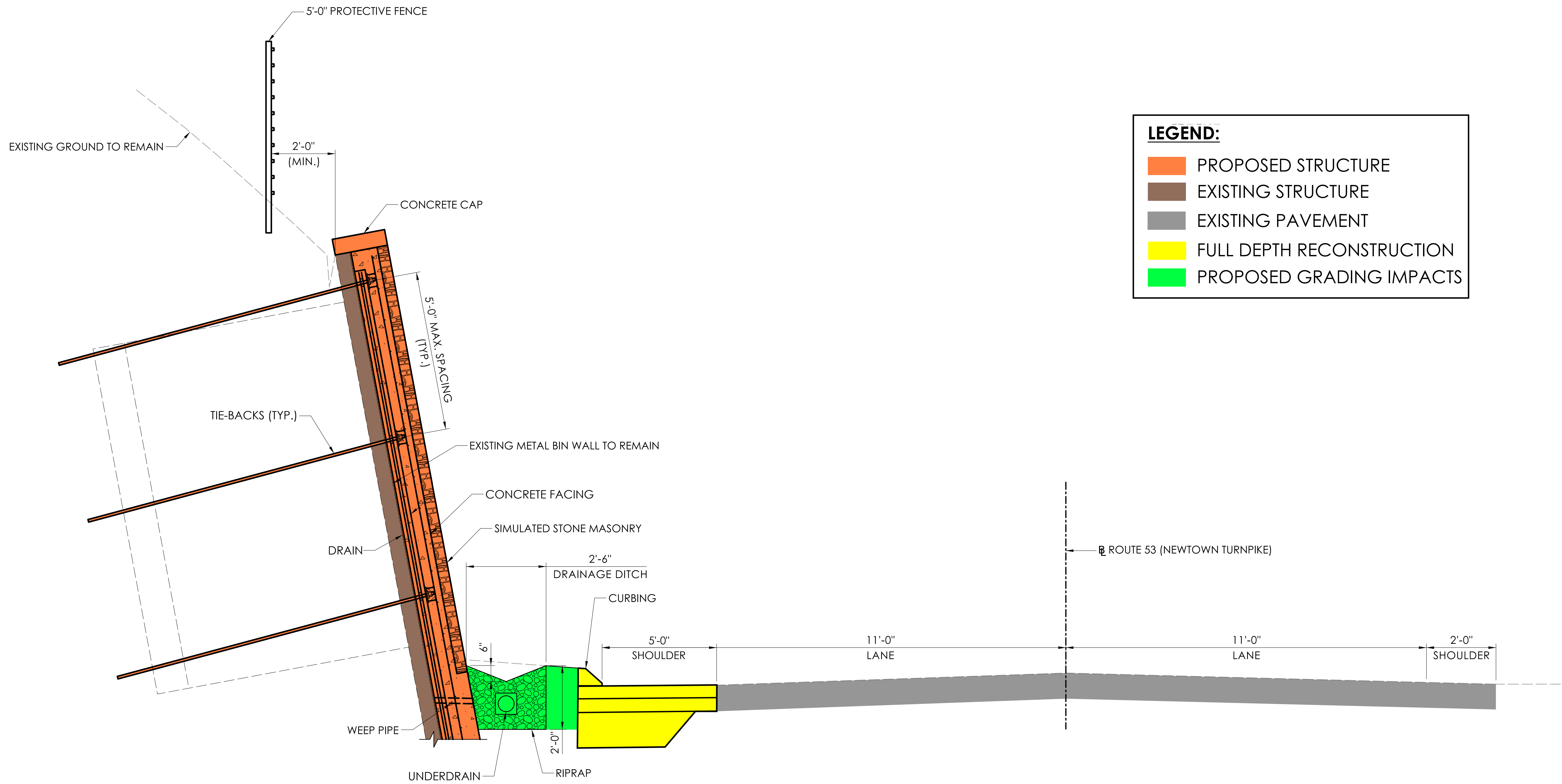

LEGEND:

- PROPOSED STRUCTURE
- EXISTING STRUCTURE
- EXISTING PAVEMENT
- FULL DEPTH RECONSTRUCTION
- PROPOSED GRADING IMPACTS

TIE-BACK WALL SECTION

RW-157-053-001

REV.	DATE	REVISION DESCRIPTION

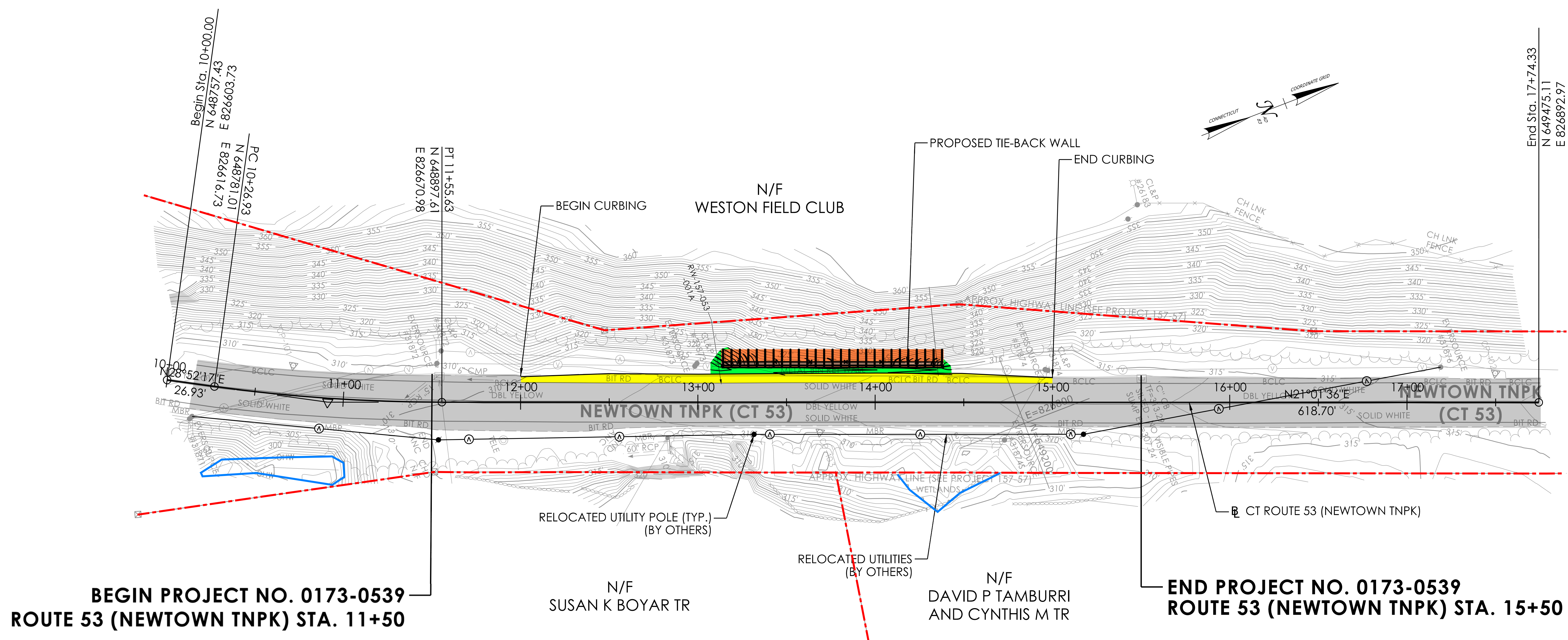

**BEGIN PROJECT NO. 0173-0539
ROUTE 53 (NEWTOWN TPK) STA. 11+50**

**END PROJECT NO. 0173-0539
ROUTE 53 (NEWTOWN TPK) STA. 15+50**

ROADWAY PLAN

RW-157-053-001

LEGEND:

	PROPOSED STRUCTURE
	EXISTING STRUCTURE
	EXISTING PAVEMENT
	FULL DEPTH RECONSTRUCTION
	PROPOSED GRADING
	WETLAND/WATERCOURSE LINE
	PROPERTY LINES

REV.	DATE	REVISION DESCRIPTION

SIGNATURE BLOCK: 		CONNECTICUT DEPARTMENT OF TRANSPORTATION	PROJECT TITLE: STATEWIDE RETAINING WALL PROGRAM	TOWN(S): WESTON	DRAWING TITLE: ROADWAY PLAN RW-157-053-001	PROJECT NO.: 0173-0539	DRAWING NO.: SHEET NO.:
DESIGNER/DRAFTER: NB CHECKED BY: RA		LASTED SAVED BY: njbrown FILE NAME: c:\pwwordr\benesch projects\projects\0245223\HW_CP_0173-0539_Weston_A_PLN-01.dgn PLOTTED DATE: 10/24/2025					



**BEGIN PROJECT NO. 0173-0539
CT ROUTE 53**

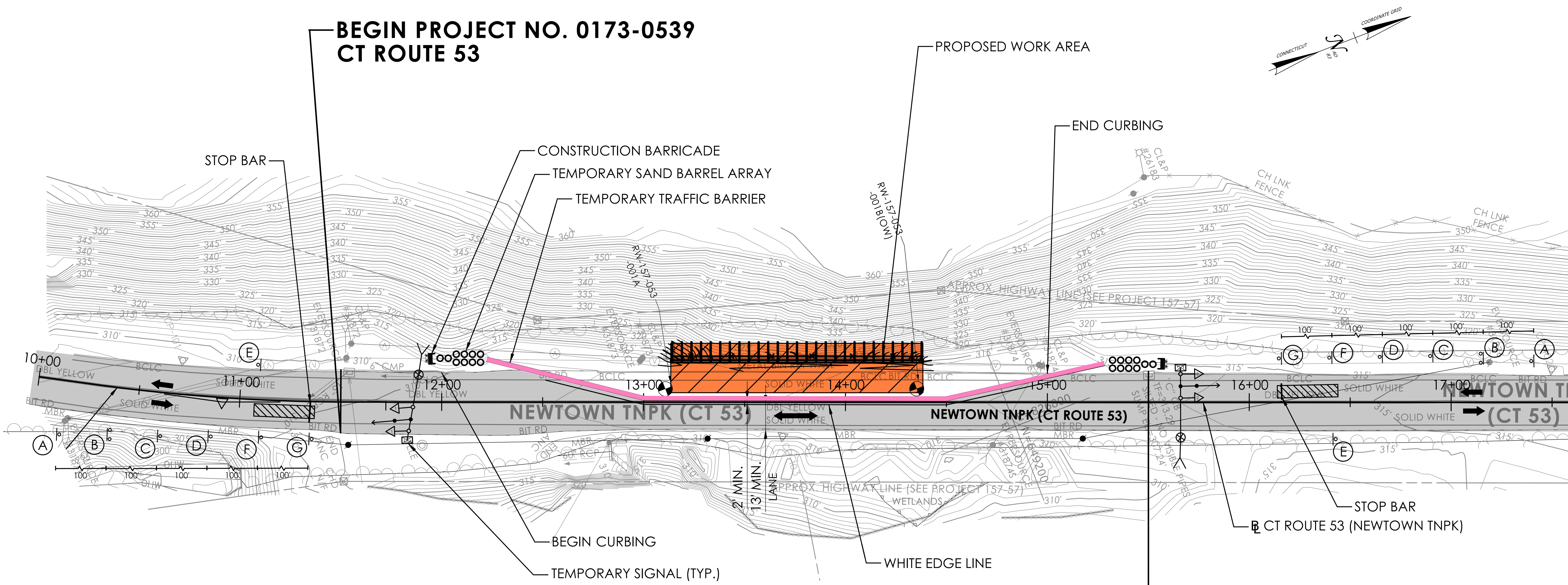

**END PROJECT NO. 0173-0539
CT ROUTE 53**

TRAFFIC PLAN - DURING CONSTRUCTION

LEGEND:

- WORK ZONE
- TRAVELWAY
- TEMPORARY TRAFFIC BARRIER

RW-157-053-001

SIGNATURE BLOCK: 	CONNECTICUT DEPARTMENT OF TRANSPORTATION	PROJECT TITLE:	TOWN(S):	DRAWING TITLE:	PROJECT NO.:	DRAWING NO.:
		STATEWIDE RETAINING WALL PROGRAM	WESTON	MAINTENANCE AND PROTECTION OF TRAFFIC RW-157-053-001	0173-0539	

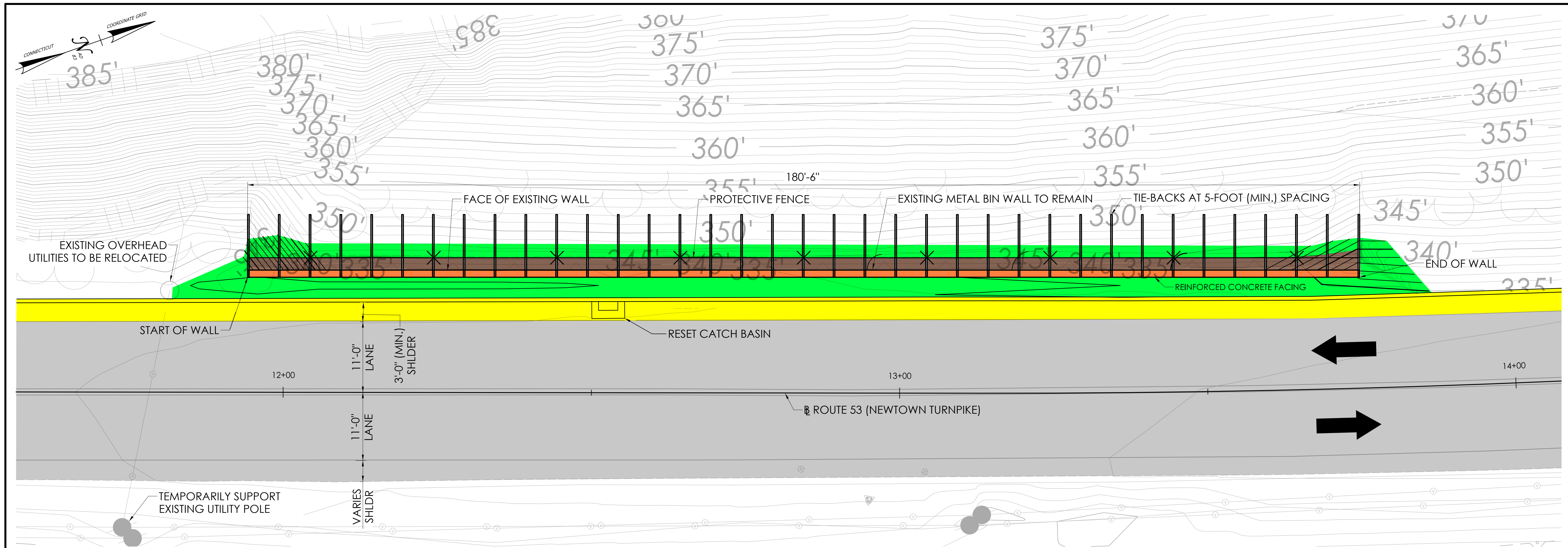

TIE-BACK WALL PLAN

LEGEND:

- PROPOSED STRUCTURE
- EXISTING STRUCTURE
- EXISTING PAVEMENT
- PAVEMENT RECONSTRUCTION
- PROPOSED GRADING IMPACTS

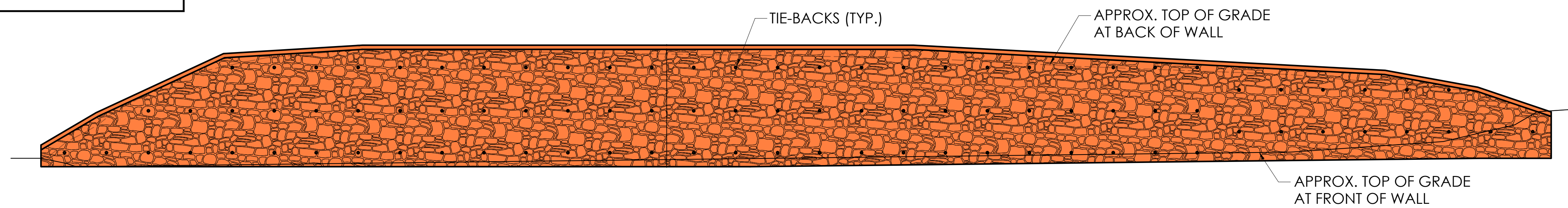

TIE-BACK WALL ELEVATION

RW-157-053-002

REV.	DATE	REVISION DESCRIPTION

SIGNATURE BLOCK:			PROJECT TITLE:	TOWN(S):	DRAWING TITLE:	PROJECT NO.:	DRAWING NO.:
DESIGNER/DRAFTER: A. BISI	CHECKED BY: M. HABEK		STATEWIDE RETAINING WALL PROGRAM	WESTON	RETAINING WALL PLAN & ELEVATION	0173-0539	SHEET NO.:

LEGEND:

- PROPOSED STRUCTURE
- EXISTING STRUCTURE
- EXISTING PAVEMENT
- FULL DEPTH RECONSTRUCTION
- PROPOSED GRADING IMPACTS

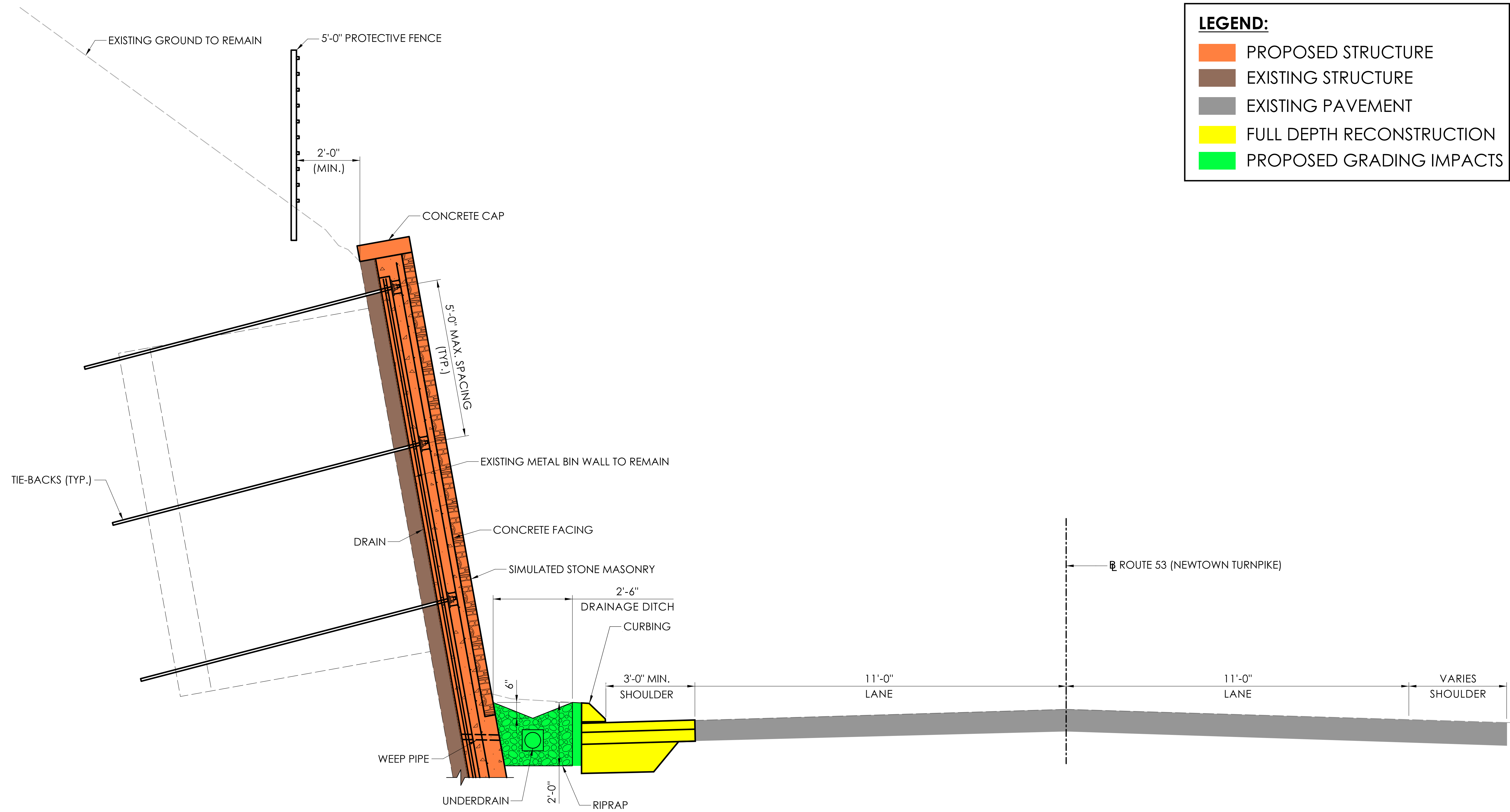

TIE-BACK WALL SECTION

RW-157-053-002

REV.	DATE	REVISION DESCRIPTION

SIGNATURE BLOCK:
 DESIGNER/DRAFTER: A. BISI CHECKED BY: M. HABEK



PROJECT TITLE: **STATEWIDE RETAINING WALL PROGRAM**

TOWN(S): **WESTON**

DRAWING TITLE: **TYPICAL SECTION**

PROJECT NO.: **0173-0539**
 DRAWING NO.:
 SHEET NO.:

LASTED SAVED BY: abisi FILE NAME: c:\pwworkdir\benesch_projects\projects\d0241078\RW-157-053-001&2.dgn
 PLOTTED DATE: 10/24/2025

**BEGIN PROJECT NO. 0173-0539
CT ROUTE 53 (NEWTOWN TNPK) STA. 11+00**

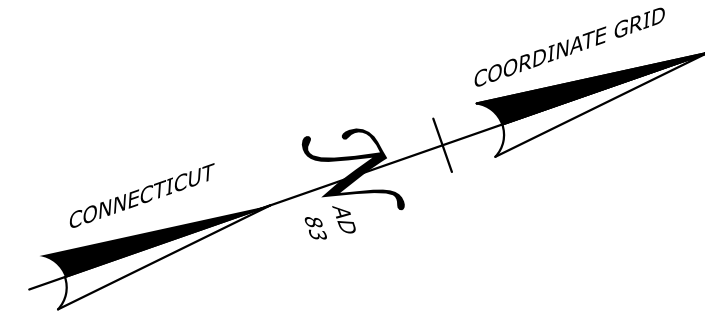

LEGEND:

- PROPOSED STRUCTURE
- EXISTING STRUCTURE
- EXISTING PAVEMENT
- FULL DEPTH RECONSTRUCTION
- PROPOSED GRADING
- WETLAND LINE
- STATE ROW LINE

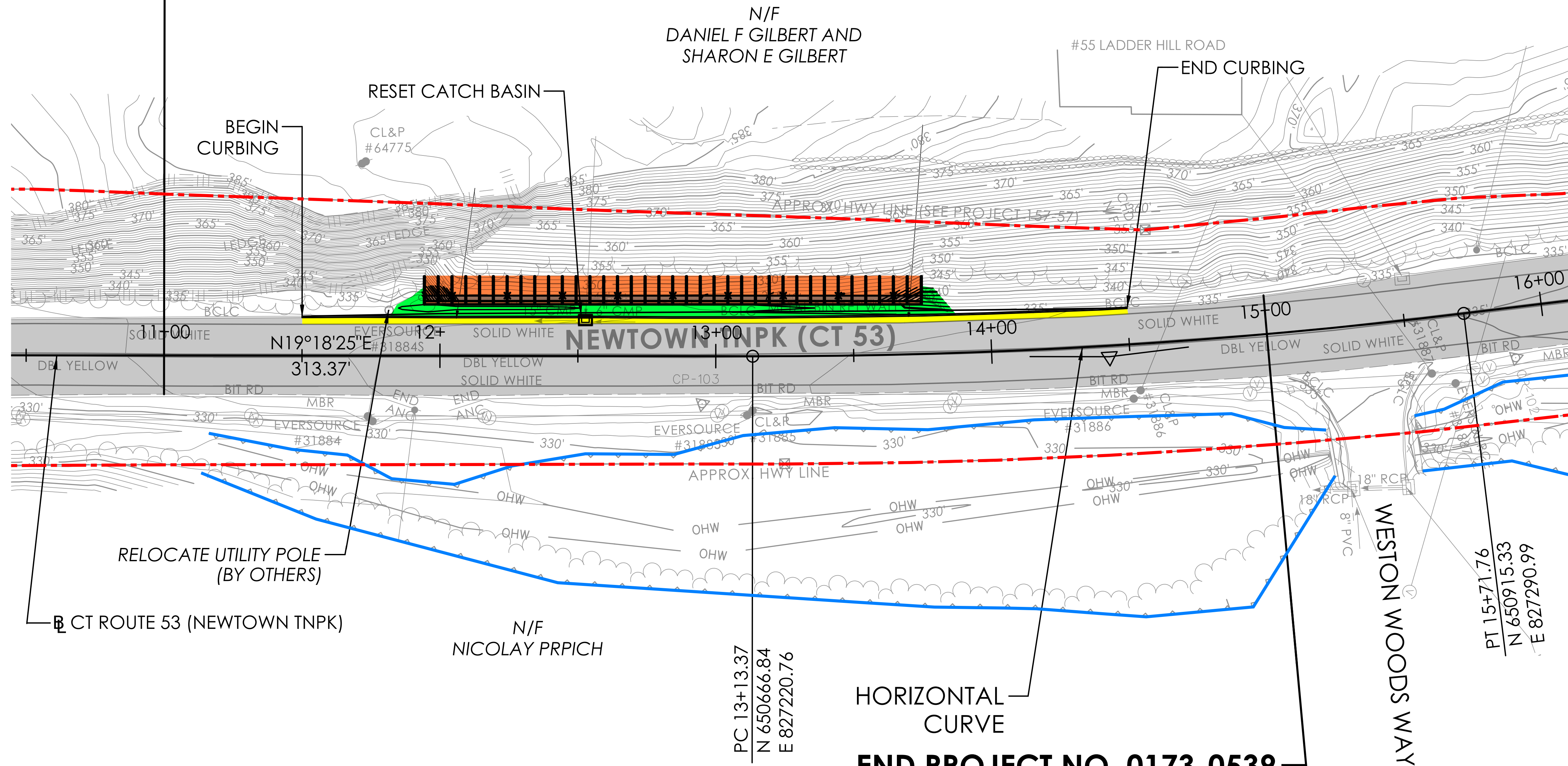

**END PROJECT NO. 0173-0539
CT ROUTE 53 (NEWTOWN TNPK) STA. 15+00**

ROADWAY PLAN

RW-157-053-002

REV.	DATE	REVISION DESCRIPTION

SIGNATURE BLOCK: benesch		<p>CONNECTICUT DEPARTMENT OF TRANSPORTATION</p>	PROJECT TITLE: STATEWIDE RETAINING WALL PROGRAM	TOWN(S): WESTON	DRAWING TITLE: ROADWAY PLAN - RW-157-053-002	PROJECT NO.: 0173-0539	DRAWING NO.: SHEET NO.:
DESIGNER/DRAFTER: NB/LA	CHECKED BY: RA		<p>LASTED SAVED BY: nrbrown FILE NAME: c:\pwword\benesch\projects\projects\d0245226\HW_CP_0173-0539_Weston_B_PLN-01.dgn PLOTTED DATE: 10/24/2025</p>				

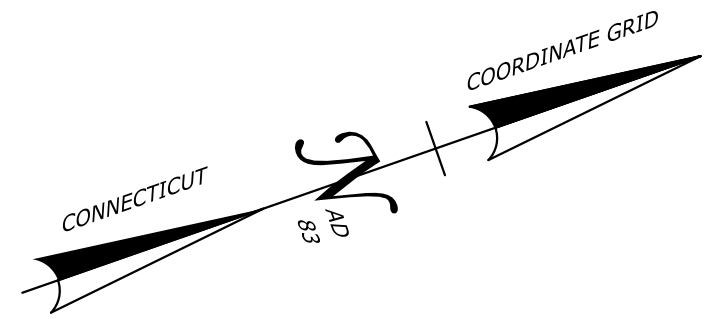
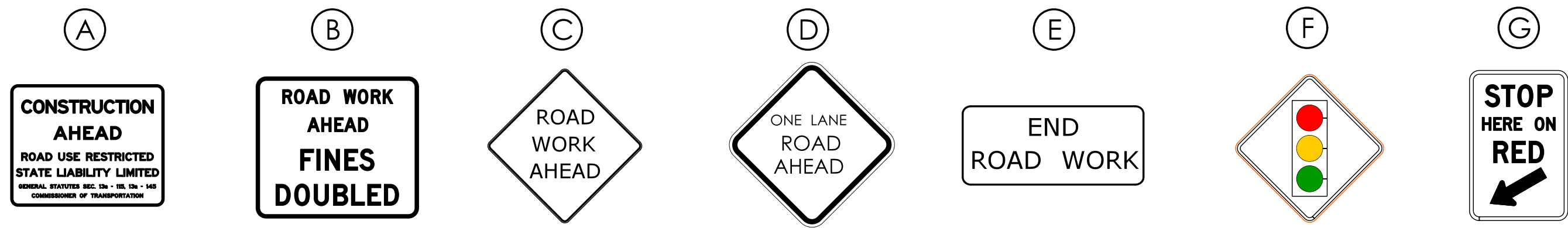

**BEGIN PROJECT NO. 0173-0539
CT ROUTE 53**

**END PROJECT NO. 0173-0539
CT ROUTE 53**

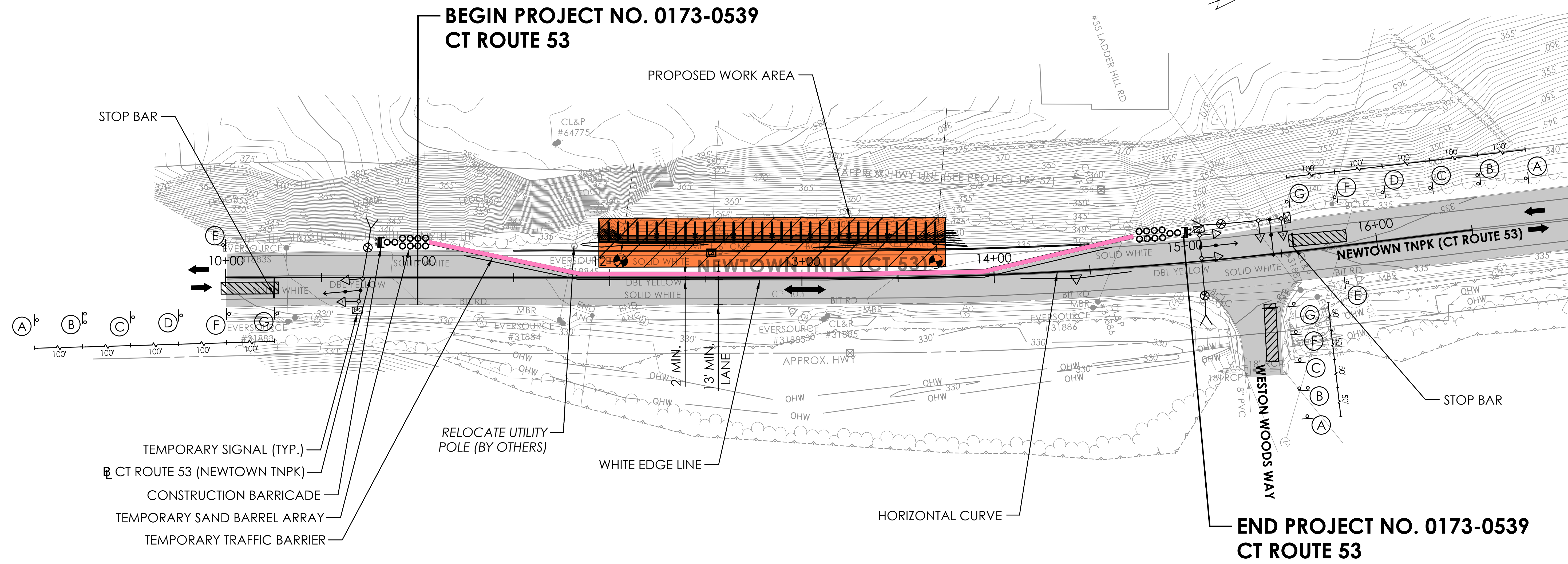

TRAFFIC PLAN - DURING CONSTRUCTION

LEGEND:

- WORK ZONE
- TRAVELWAY
- TEMPORARY TRAFFIC BARRIER

RW-157-053-002

SIGNATURE BLOCK: 	CONNECTICUT DEPARTMENT OF TRANSPORTATION	PROJECT TITLE: STATEWIDE RETAINING WALL PROGRAM	TOWN(S): WESTON	DRAWING TITLE: MAINTENANCE AND PROTECTION OF TRAFFIC RW-157-053-002	PROJECT NO.: 0173-0539	DRAWING NO.: SHEET NO.:
----------------------	--	---	---------------------------	---	----------------------------------	----------------------------