

BEGIN PROJECT NO. 0123-0067  
 SITE NO. 1  
 LIMIT OF FULL DEPTH CONSTRUCTION  
 MATCH EXISTING ROADWAY  
 BROOK ROAD #2 STA. 13+00.00

END PROJECT NO. 0123-0067  
 SITE NO. 1  
 LIMIT OF FULL DEPTH CONSTRUCTION  
 MATCH EXISTING ROADWAY  
 BROOK ROAD #2 STA. 16+50.00

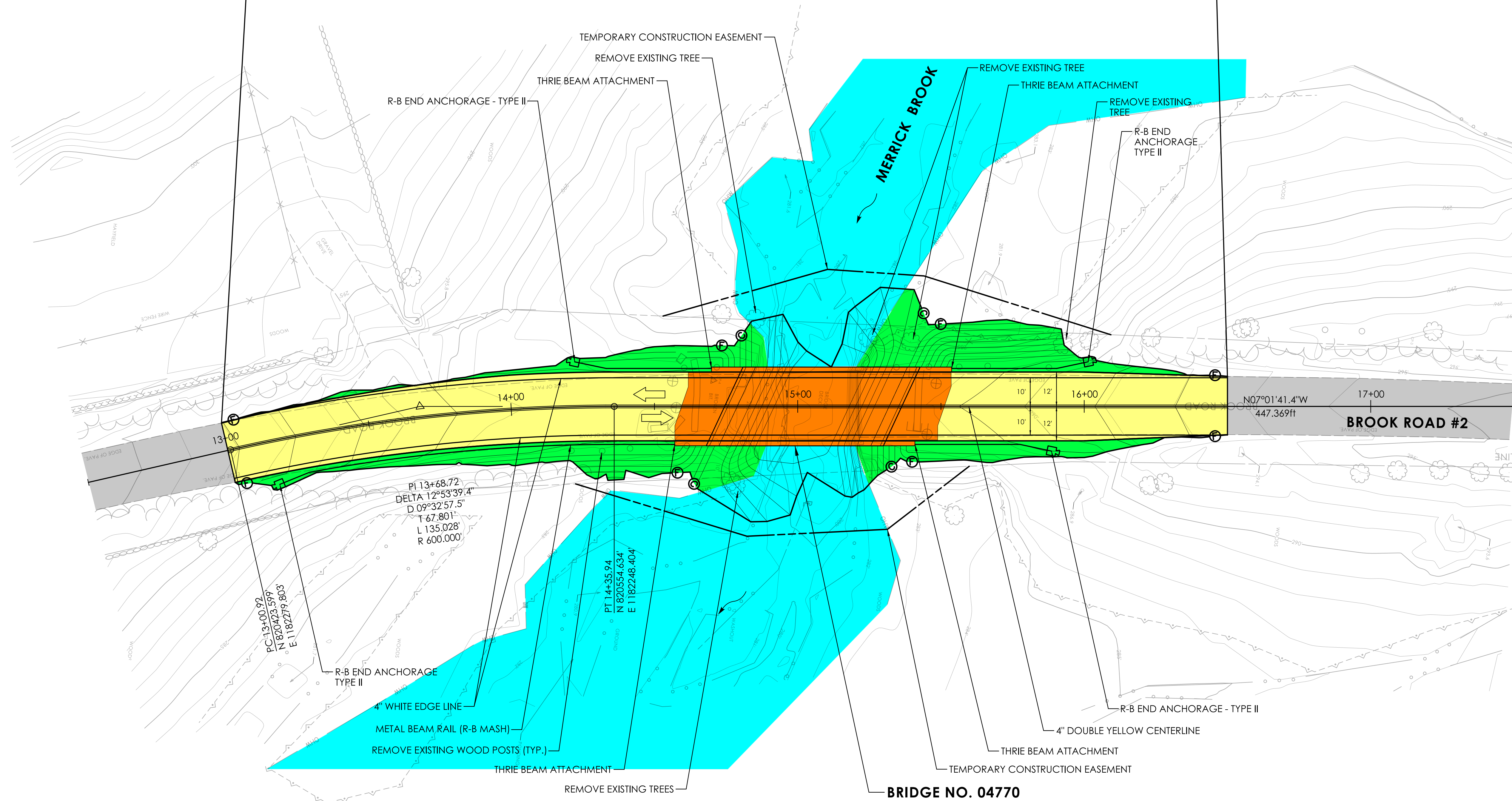
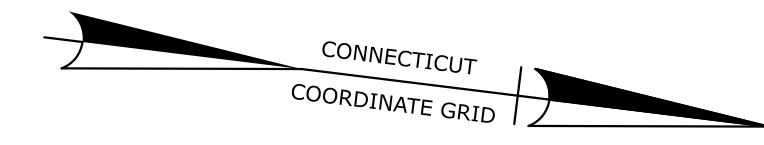

PLAN

**LEGEND**

- PROPOSED BRIDGE
- RECONSTRUCTED ROADWAY
- EXISTING PAVEMENT
- PROPOSED GRADING
- WATERCOURSE

REV.	DATE	REVISION DESCRIPTION

**REHABILITATION STUDY REPORT**

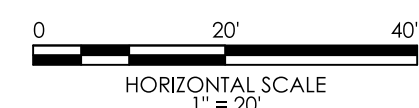

SIGNATURE/  
BLOCK:

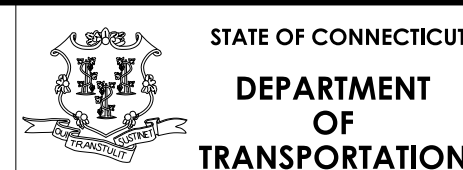

PROJECT NUMBER: 0123-0067 (SITE NO. 1)  
 PROJECT DESCRIPTION: REPLACEMENT OF BRIDGE NO. 04770, BROOK ROAD #2 OVER MERRICK BROOK  
 TOWN(S): SCOTLAND  
 DRAWING TITLE: PROPOSED ROADWAY PLAN

DRAWING NO.  
PLN-01  
SHEET NO.



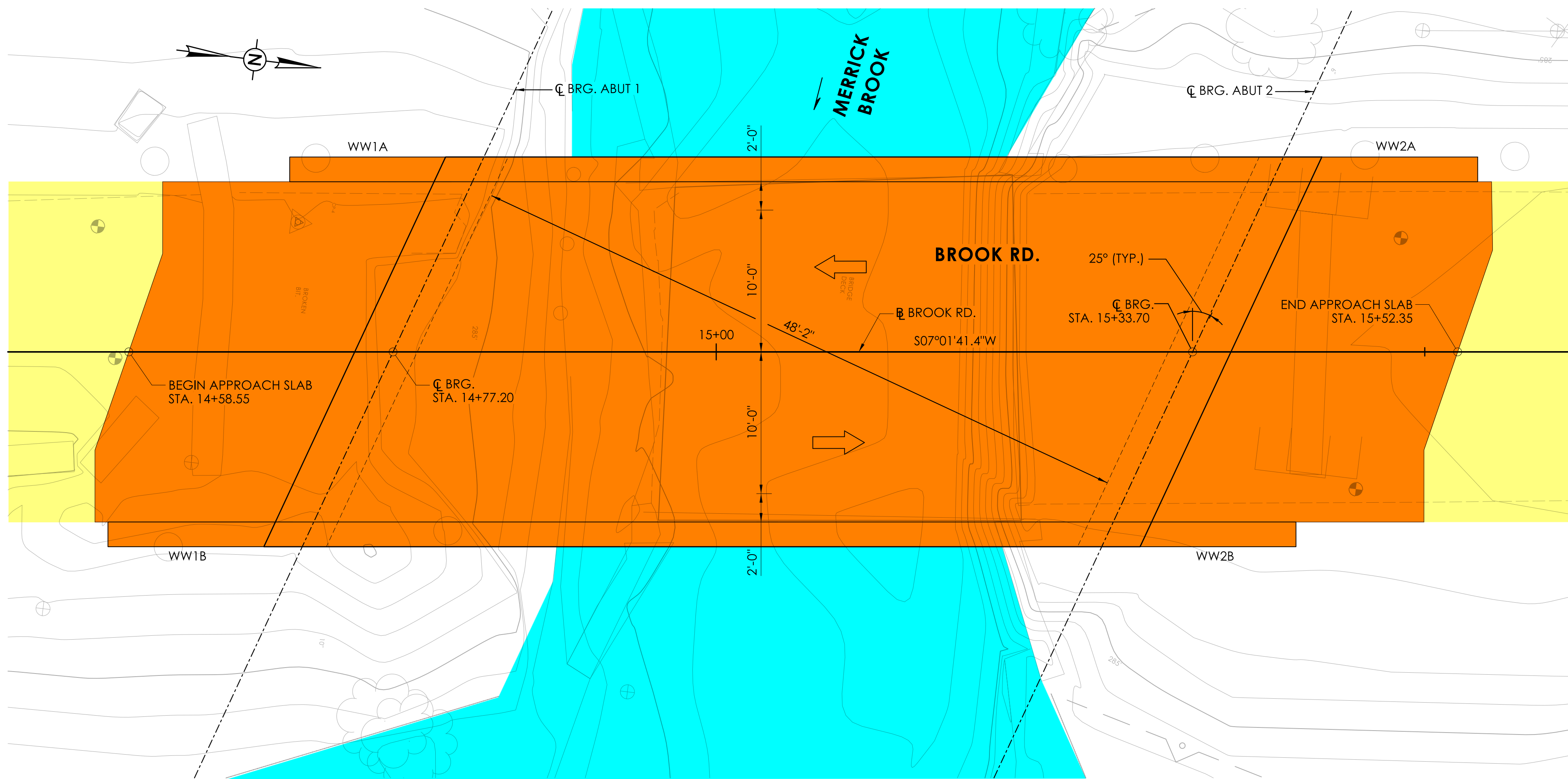

**PLAN LEGEND**  
 [Orange Box] PROPOSED BRIDGE  
 [Yellow Box] RECONSTRUCTED ROADWAY  
 [Cyan Box] WATERCOURSE

**PLAN**  
 SCALE: 3/16" = 1'-0"

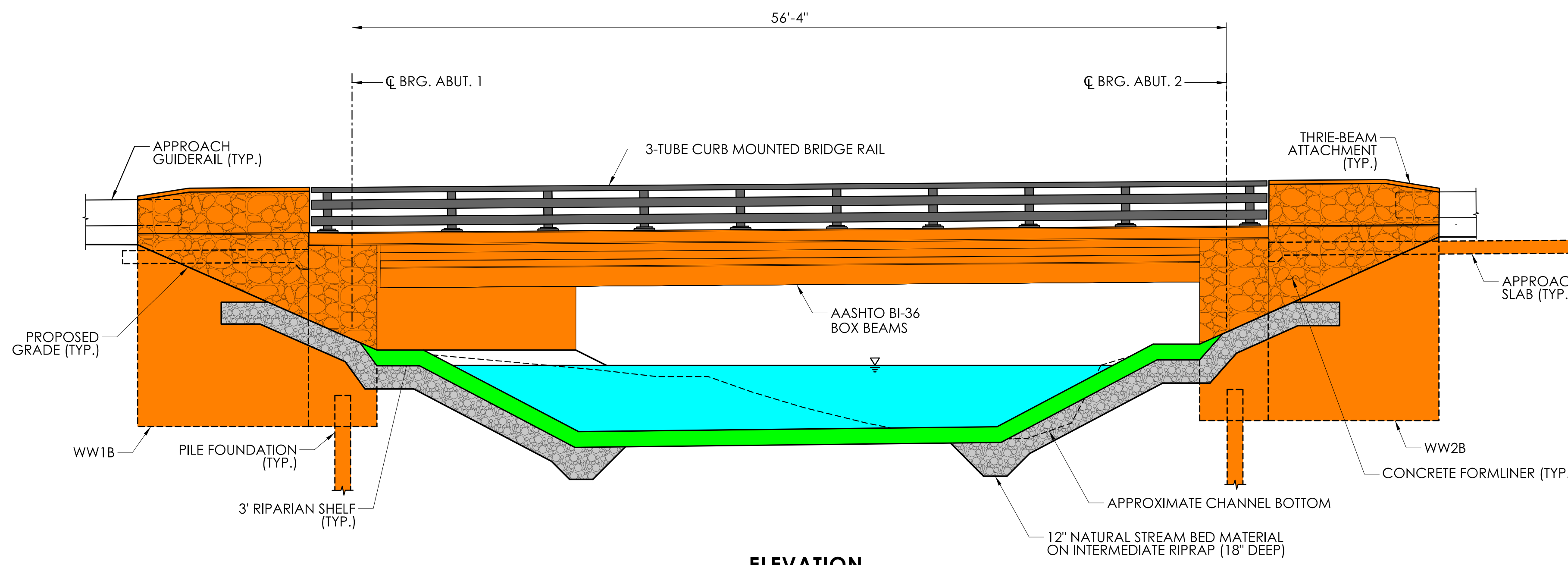

**ELEVATION**  
 SCALE: 3/16" = 1'-0"

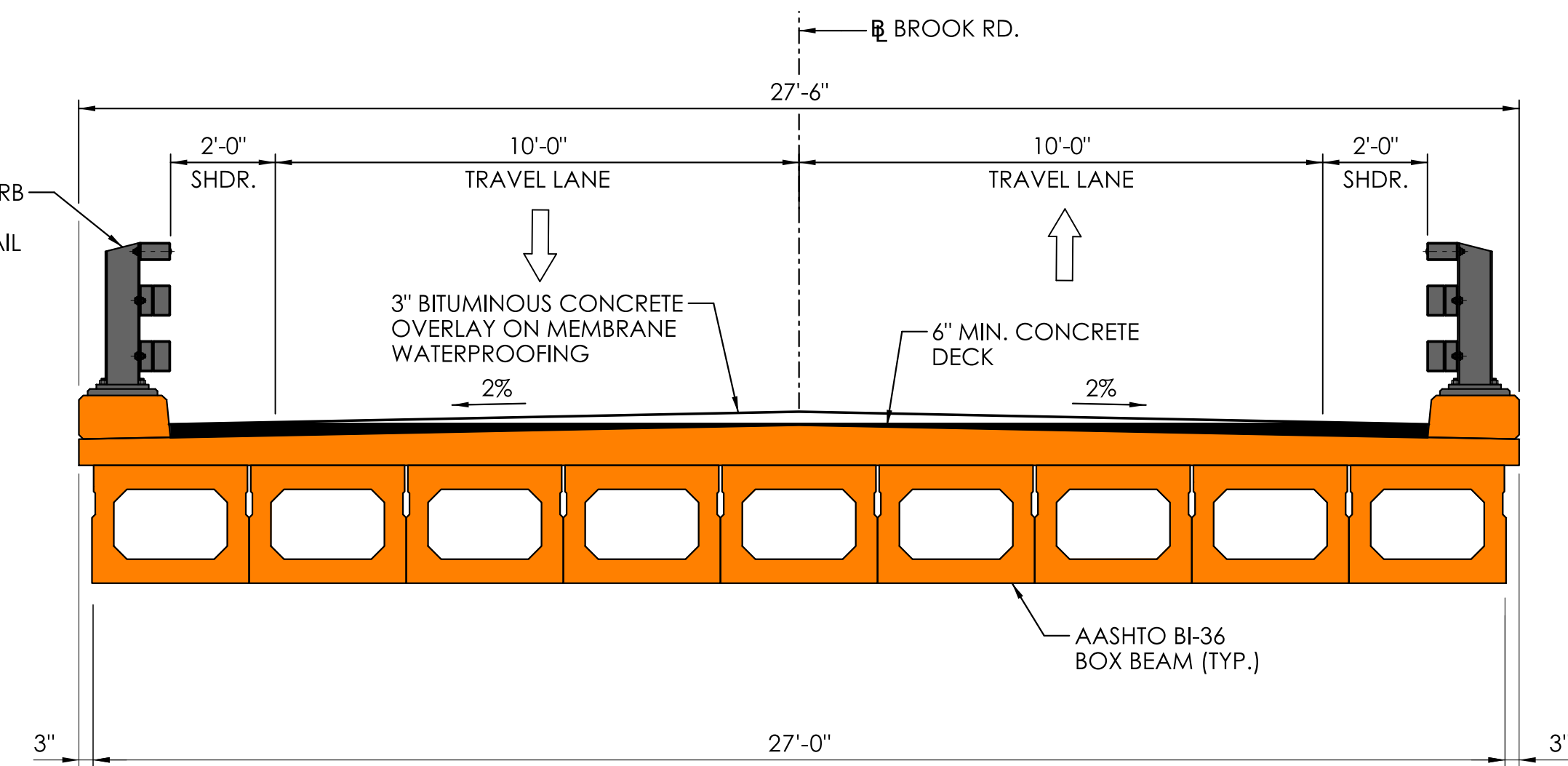

**ELEVATION LEGEND**  
 [Orange Box] PROPOSED BRIDGE  
 [Grey Box] OPEN BRIDGE RAILING  
 [Green Box] PROPOSED GRADING  
 [Light Grey Box] EMBANKMENT PROTECTION  
 [Cyan Box] WATERCOURSE

**TYPICAL SECTION**  
 SCALE: 3/8" = 1'-0"

**SECTION LEGEND**  
 [Orange Box] PROPOSED BRIDGE  
 [Grey Box] PAVEMENT  
 [Black Box] OPEN BRIDGE RAILING

REV.	DATE	REVISION DESCRIPTION

**REHABILITATION STUDY REPORT**

SCALE AS NOTED

SIGNATURE/BLOCK: **GMZ**  
 GMZ ASSOCIATES, INC.  
 115 GLASTONBURY BLVD.  
 GLASTONBURY, CT 06033

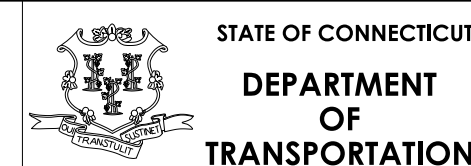

PROJECT NUMBER: 0123-0067 (SITE NO. 1)  
 PROJECT DESCRIPTION: REPLACEMENT OF BRIDGE NO. 04770, BROOK ROAD #2 OVER MERRICK BROOK  
 TOWN(S): SCOTLAND  
 DRAWING TITLE: GENERAL PLAN

DRAWING NO. S-02  
 SHEET NO.



BEGIN PROJECT NO. 0123-0067  
 SITE NO. 2  
 LIMIT OF FULL DEPTH CONSTRUCTION  
 MATCH EXISTING ROADWAY  
 BROOK ROAD #2 STA. 13+50.00

END PROJECT NO. 0123-0067  
 SITE NO. 2  
 LIMIT OF FULL DEPTH CONSTRUCTION  
 MATCH EXISTING ROADWAY  
 BROOK ROAD #2 STA. 17+00.00

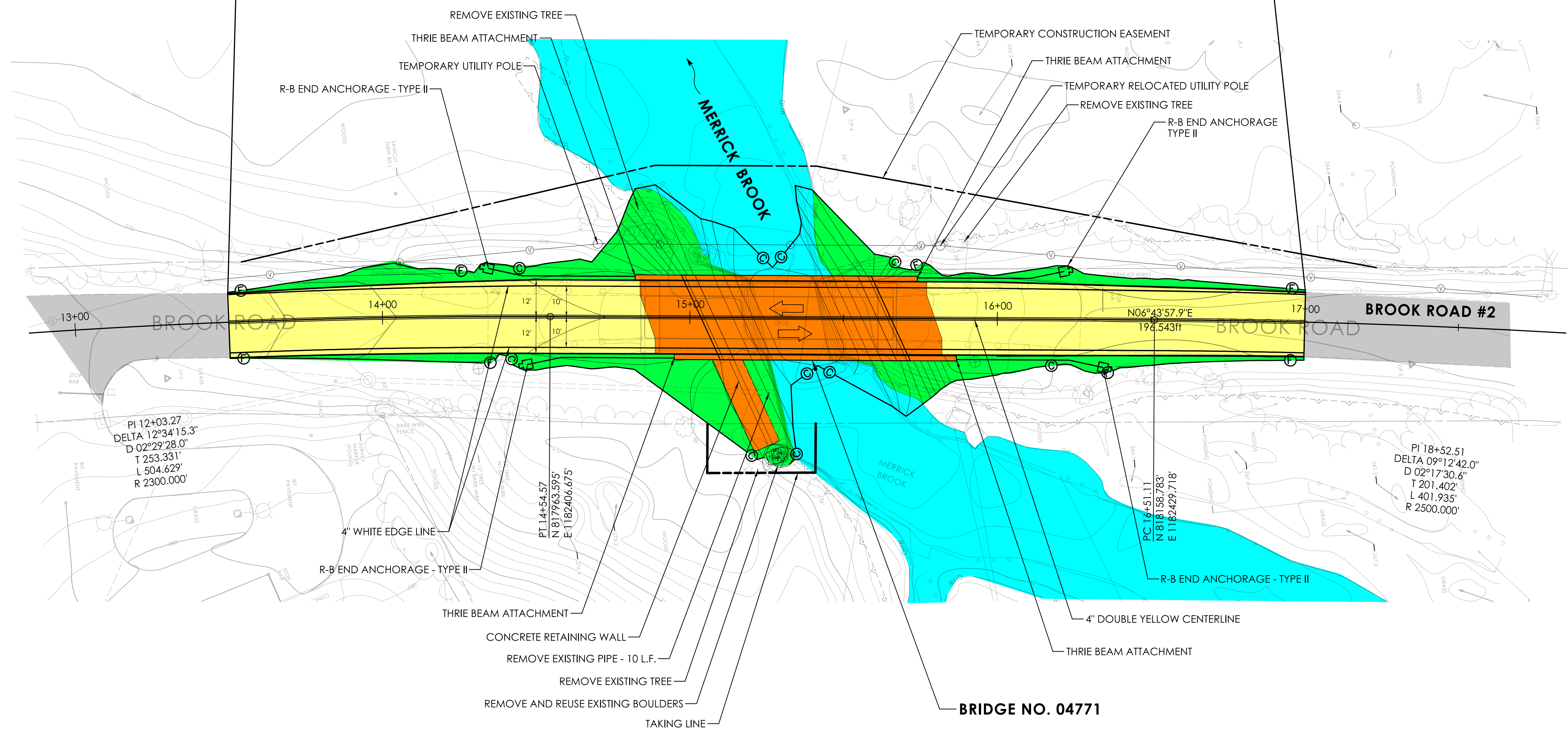

PI 12+03.27  
 DELTA 12°34'15.3"  
 D 02°29'28.0"  
 T 253.331'  
 L 504.629'  
 R 2300.000'

PT 14+54.57  
 N 81°29'43.595"  
 E 1182.406.675'

PC 16+51.11  
 N 81°58'783"  
 E 1182.429.718'

PI 18+52.51  
 DELTA 09°12'42.0"  
 D 02°17'30.6"  
 T 201.402'  
 L 401.935'  
 R 2500.000'

PLAN

**LEGEND**

	PROPOSED BRIDGE
	RECONSTRUCTED ROADWAY
	EXISTING PAVEMENT
	PROPOSED GRADING
	WATERCOURSE

REV.	DATE	REVISION DESCRIPTION

**REHABILITATION STUDY REPORT**

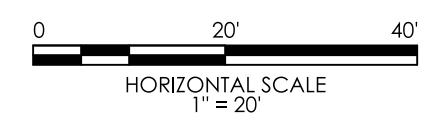

SIGNATURE/  
 BLOCK: GMP ASSOCIATES, INC.  
 115 GLASTONBURY BLVD.  
 GLASTONBURY, CT 06033

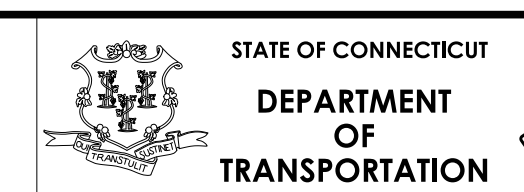

PROJECT NUMBER: 0123-0067 (SITE NO. 2)  
 PROJECT DESCRIPTION: REPLACEMENT OF BRIDGE NO. 04771, BROOK ROAD #2 OVER MERRICK BROOK  
 TOWN(S): SCOTLAND  
 DRAWING TITLE: PROPOSED ROADWAY PLAN

DRAWING NO. PLN-01  
 SHEET NO.



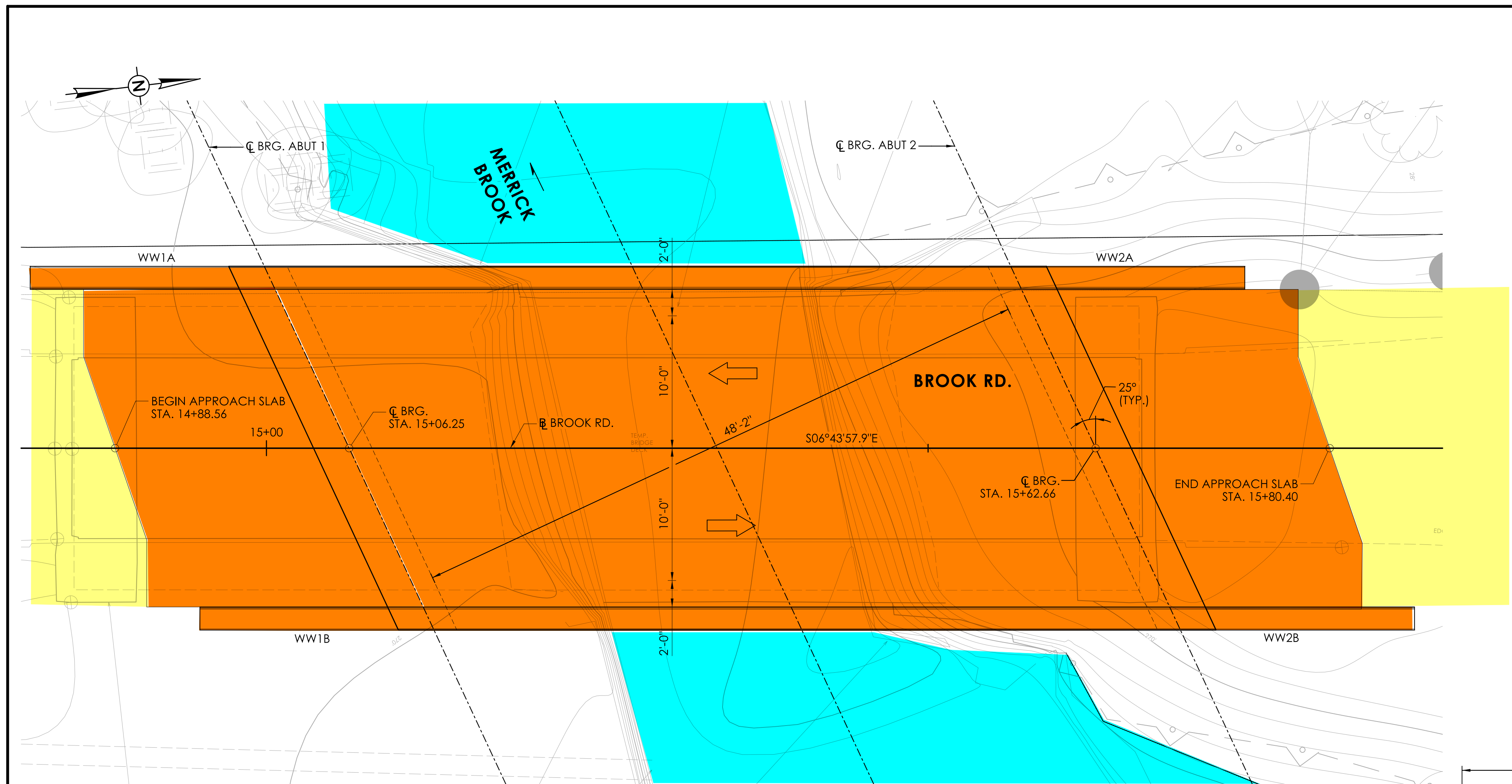

**PLAN LEGEND**  
 PROPOSED BRIDGE  
 RECONSTRUCTED ROADWAY  
 WATERCOURSE

**PLAN**  
 SCALE: 3/16" = 1'-0"

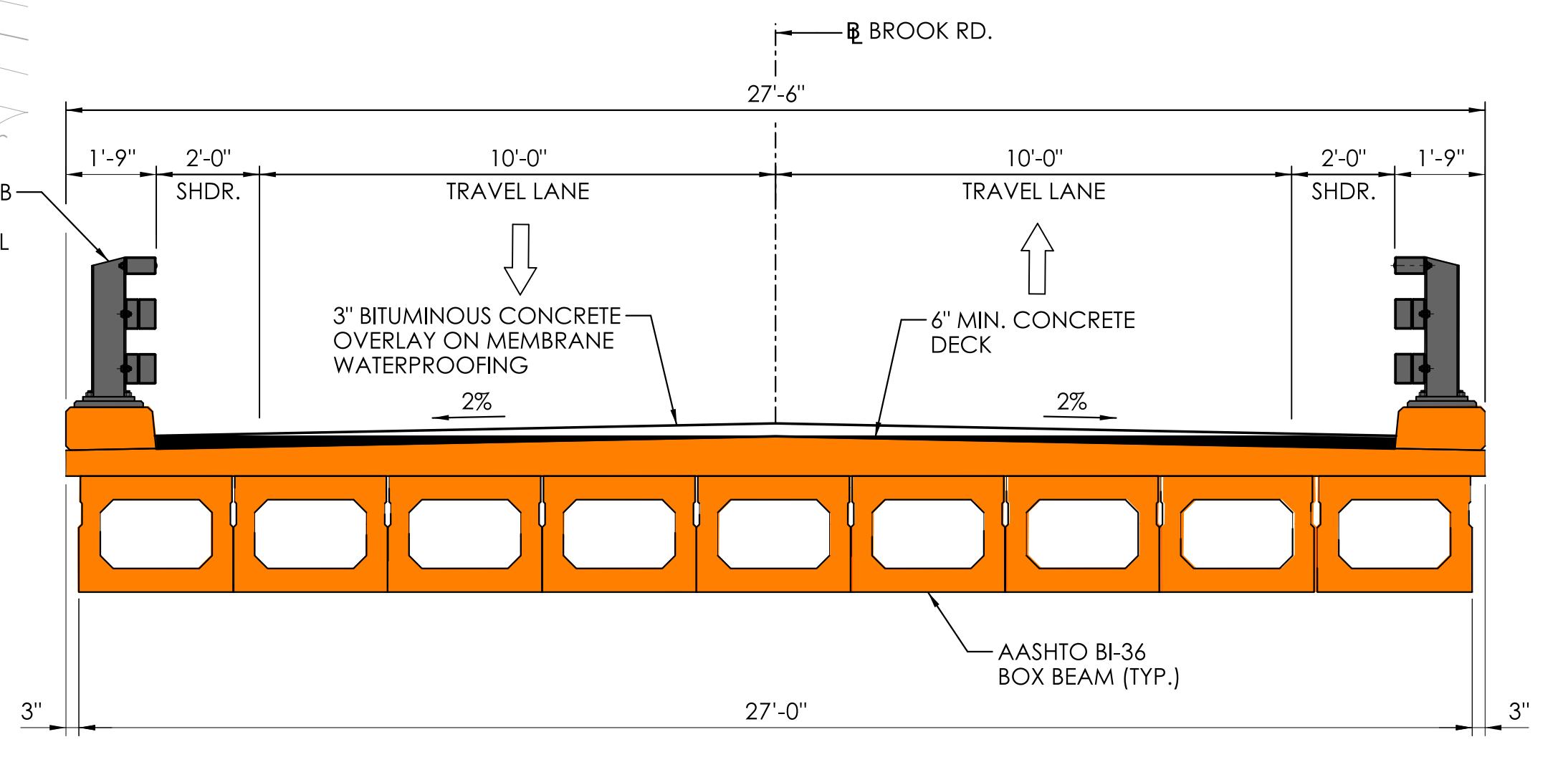

**TYPICAL SECTION**  
 SCALE: 3/16" = 1'-0"

**SECTION LEGEND**  
 PROPOSED BRIDGE  
 PAVEMENT  
 OPEN BRIDGE RAILING

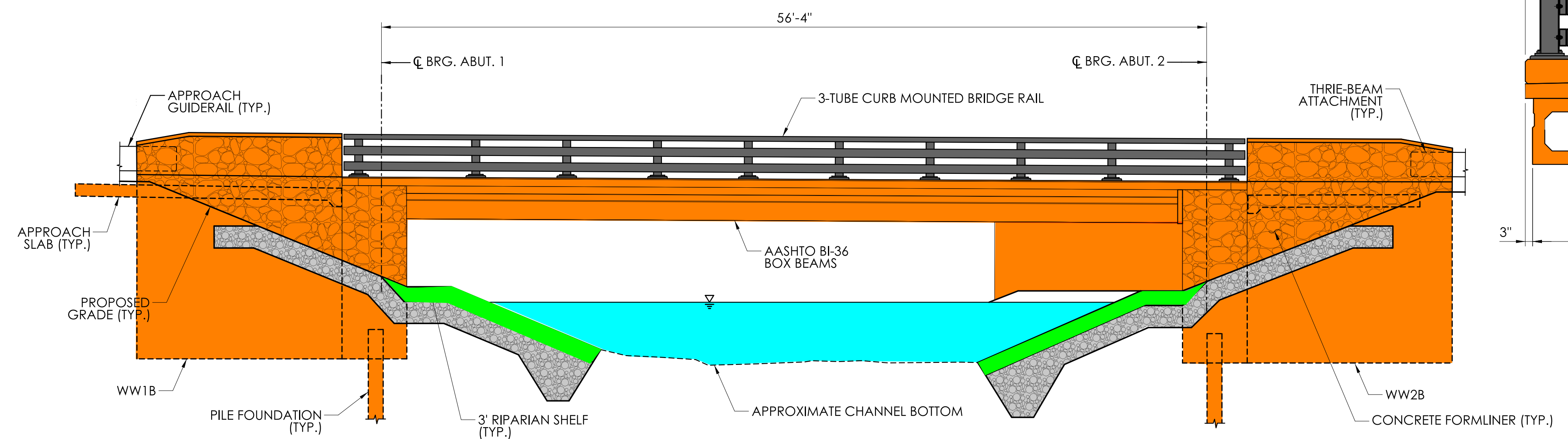

**ELEVATION**  
 SCALE: 3/16" = 1'-0"

**ELEVATION LEGEND**  
 PROPOSED BRIDGE  
 OPEN BRIDGE RAILING  
 PROPOSED GRADING  
 EMBANKMENT PROTECTION  
 WATERCOURSE

REV.	DATE	REVISION DESCRIPTION

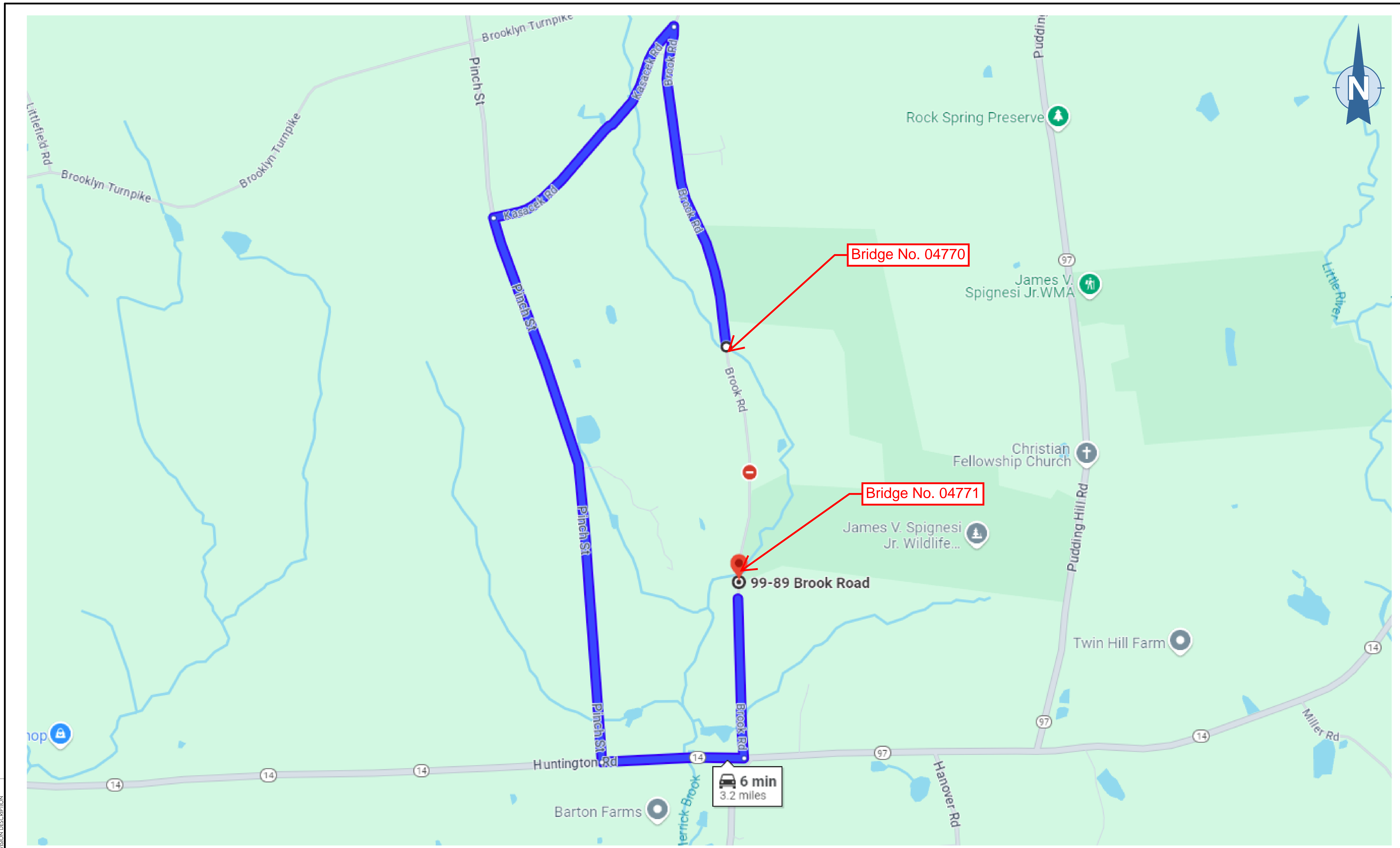

REV.	DATE	REVISION DESCRIPTION

**REHABILITATION STUDY REPORT**

SIGNATURE/BLOCK: **GMP**  
 GM2 ASSOCIATES, INC.  
 115 GLASTONBURY BLVD.  
 GLASTONBURY, CT 06033

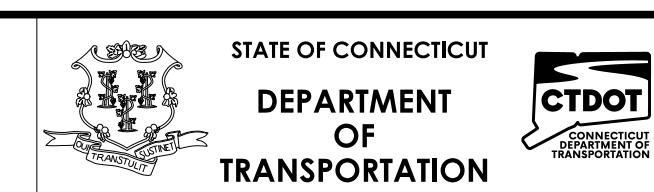

PROJECT NUMBER: 0123-0067 (SITE NO. 1)  
 PROJECT DESCRIPTION: REPLACEMENT OF BRIDGE NO. 04770, BROOK ROAD #2 OVER MERRICK BROOK  
 TOWN(S): SCOTLAND  
 DRAWING TITLE: DETOUR

DRAWING NO. DET-01  
 SHEET NO.