

- LEGEND:**
- RIGHT-OF-WAY LINE
 - OVERHEAD UTILITIES
 - PROPOSED BRIDGE
 - PROPOSED PAVEMENT
 - EXISTING PAVEMENT
 - PROPOSED GRADING
 - PROPOSED DRAINAGE

REV.	DATE	REVISION DESCRIPTION

SIGNATURE BLOCK:
 DESIGNER/DRAFTER: _____ CHECKED BY: _____



PROJECT TITLE:
REPLACEMENT OF BRIDGE NO. 00273 - CRANBERRY POND ROAD OVER I-395

TOWN(S):
NORWICH

DRAWING TITLE:
GENERAL PLAN

PROJECT NO.:
0103-0283

DRAWING NO.:
 SHEET NO.:

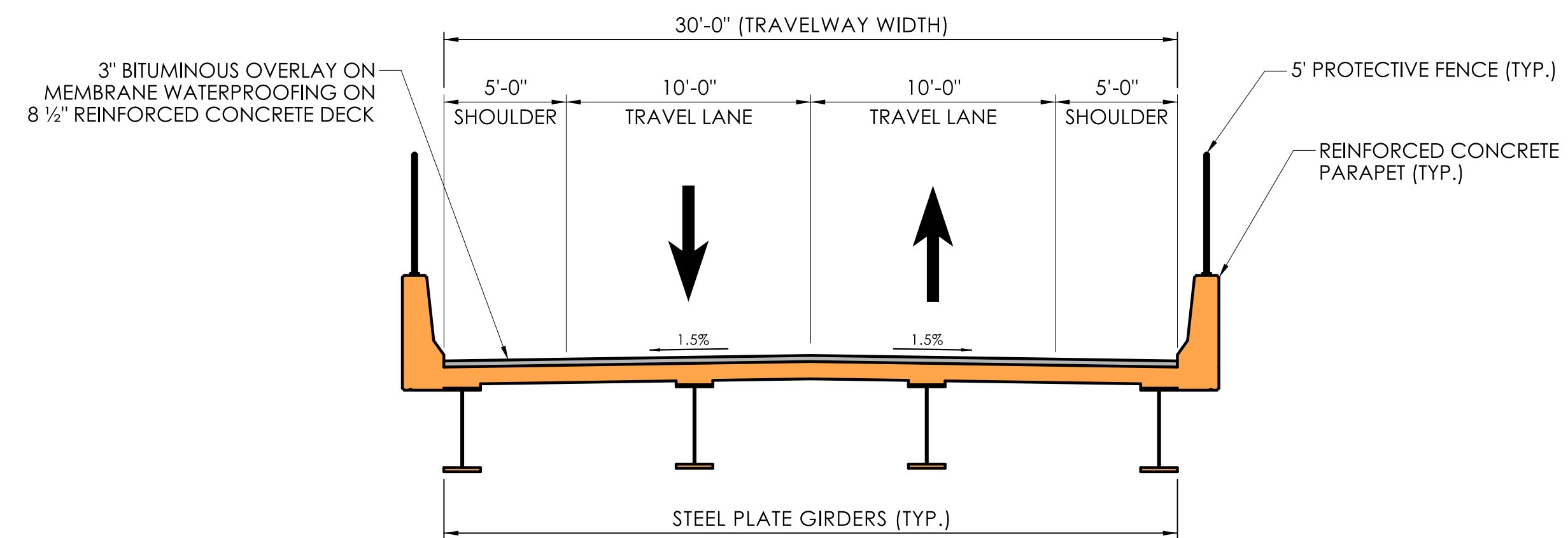

TYPICAL SECTION
SCALE: 1" = 5'

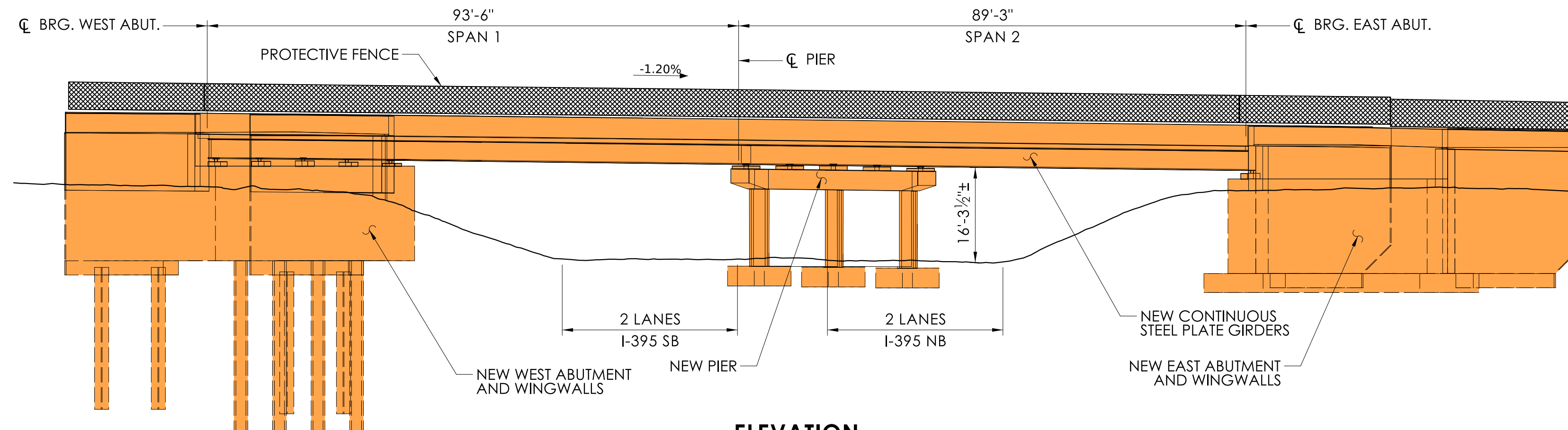

ELEVATION
SCALE: 1/16" = 1'-0"

LEGEND:

- PROPOSED BRIDGE
- PROPOSED PAVEMENT

REV.	DATE	REVISION DESCRIPTION

SIGNATURE BLOCK:	
DESIGNER/DRAFTER:	CHECKED BY:



PROJECT TITLE:
REPLACEMENT OF BRIDGE NO. 00273 - CRANBERRY POND ROAD OVER I-395

TOWN(S):
NORWICH

DRAWING TITLE:
ELEVATION AND SECTION

PROJECT NO.:
0103-0283

DRAWING NO.:
SHEET NO.:

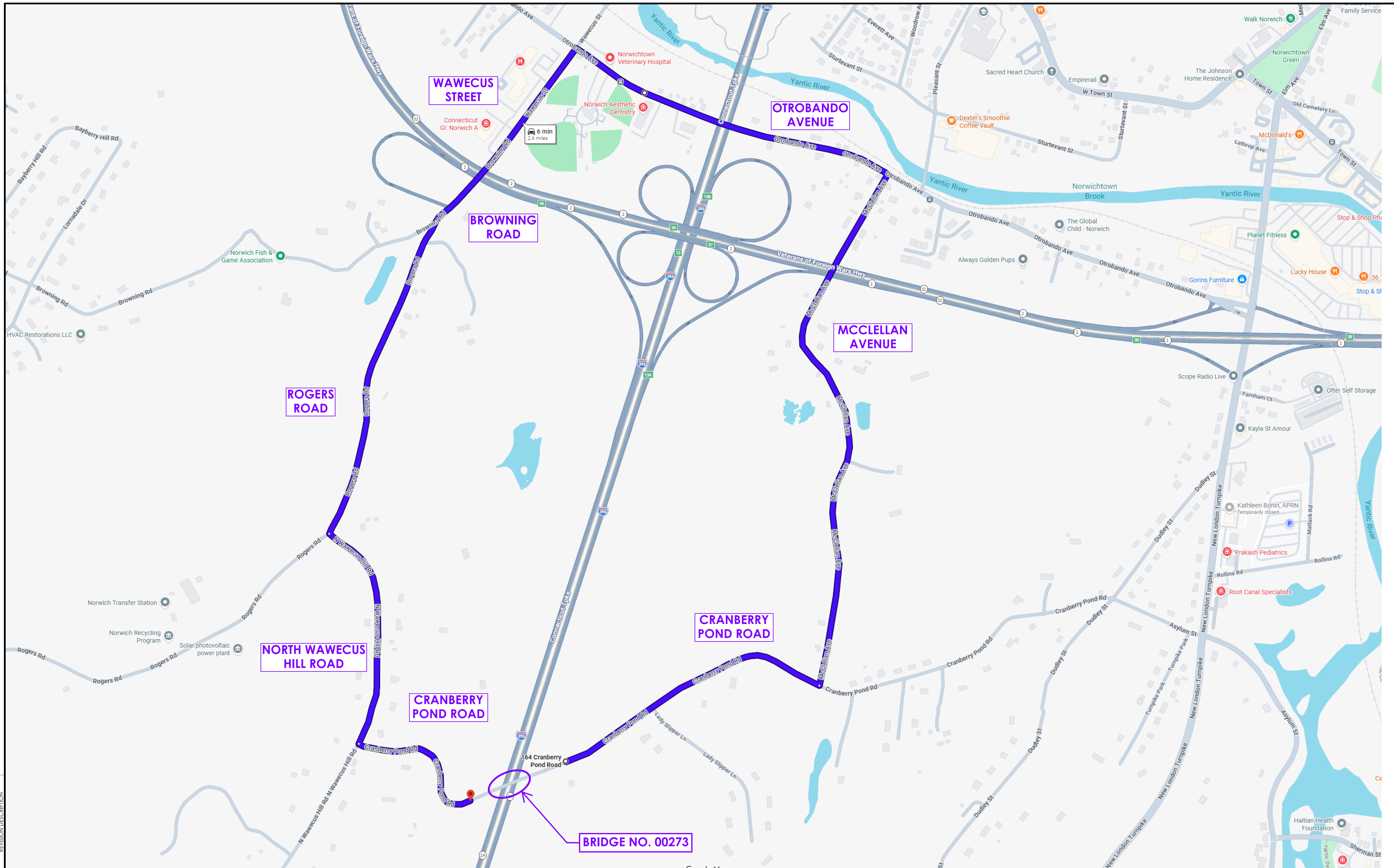

REV.	DATE	REVISION DESCRIPTION

SIGNATURE BLOCK:
 DESIGNER/DRAFTER: _____ CHECKED BY: _____
 LASTED SAVED BY: jcare FILE NAME: E:\CT_Projects\0103-0283\bridge\Contract_Plans\0103-0283_PLAN.dgn
 PLOTTED DATE: 6/16/2026



PROJECT TITLE:
REPLACEMENT OF BRIDGE NO. 00273 - CRANBERRY POND ROAD OVER I-395

TOWN(S):
NORWICH

DRAWING TITLE:
DETOUR PLAN

PROJECT NO.:
0103-0283

DRAWING NO.:
 SHEET NO.: