

BEGIN PROJECT NO.
0055-0148
STA. 100+55.00
N: 907999.392
E: 963534.012

APPROX. HIGHWAY LINE

EXISTING CULVERT TO REMAIN

ENDERS ROAD

APPROX. HIGHWAY LINE

PROPOSED GUIDERAIL REPLACEMENT

WOODS/BRUSH

WOODS/BRUSH

WOODS/BRUSH

100+00

101+00

102+00

103+00

BARKHAMSTED ROAD
ROUTE 219

104+00

105+00

106+00

PROPOSED GUIDERAIL
REPLACEMENT

APPROX. HIGHWAY LINE

PLAN

LEGEND

- PROCESSED AGGREGATE BASE
- EXISTING TRAVELED WAY
- PROPOSED TOPSOIL AND SEED
- EXISTING WATERCOURSE (TO REMAIN)
- R.O.W LINE
- PROPOSED GUIDERAIL

MATCH STATION 106+00

REV.	DATE	REVISION DESCRIPTION

SIGNATURE BLOCK:	
DESIGNER/DRAFTER: JW	CHECKED BY: DEC

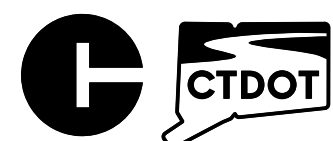
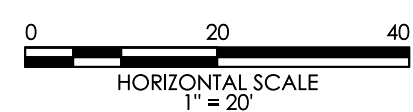

CONNECTICUT
DEPARTMENT OF
TRANSPORTATION

PROJECT TITLE:
REPLACEMENT OF BRIDGE 06680 ROUTE 219 OVER UNNAMED BROOK

TOWN(S):
TOWN OF GRANBY

DRAWING TITLE:
ROADWAY PLAN - 1

PROJECT NO.:	DRAWING NO.:
0055-0148	PLN-01
SHEET NO.:	

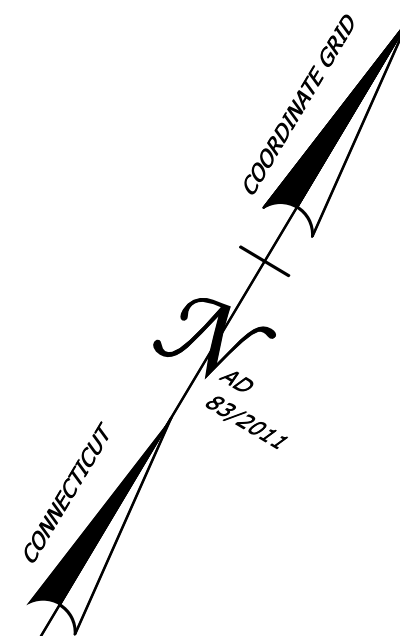

END FINE MILL AND REPAVE
BEGIN FULL DEPTH PAVEMENT
RECONSTRUCTION
STA. 107+50.00

END FULL DEPTH PAVEMENT
RECONSTRUCTION
BEGIN FINE MILL AND REPAVE,
STA. 108+50.00

END PROJECT NO.
0055-0148
STA. 111+71.32
N: 908561.565
E: 964497.717

BEGIN FINE MILL
AND REPAVE
STA 107+00.00

END FINE MILL AND REPAVE
STA 109+00.00

CATCH
BASIN

TEMPORARY EASEMENT
NATURAL STREAMBED
MATERIAL AT INLET
AND OUTLET

12' APPROX.

APPROX. HIGHWAY LINE

WOODS/BRUSH

MATCH STATION 106+00

BRIDGE NO. 06680
EXISTING 72" CMP

BARKHAMSTED ROAD ROUTE 219

110+00

111+00

LEGEND

- WETLANDS
- PROPOSED PAVEMENT
- PROPOSED CULVERT
- PROPOSED ROADWAY DRAINAGE
- PROCESSED AGGREGATE BASE
- PROPOSED TOPSOIL AND SEED
- TREE RESTORATION
- EXISTING WATERCOURSE (TO REMAIN)
- NATURAL STREAMBED MATERIAL
- TEMPORARY ACCESS ROAD
- EXISTING TRAVELED WAY

DRAINAGE OUTFALL

TEMPORARY EASEMENT

PLAN

- R.O.W LINE
- TEMPORARY EASEMENT
- PROPOSED GUIDERAIL

PROCESSED
AGGREGATE
BASE

6'-0"
SHOULDER

12'-0"
LANE

12'-0"
LANE

4'-6"
SHOULDER

REMOVE AND REPLACE
METAL BEAM RAIL

EXISTING GROUND
PROPOSED
GROUND
2:1
MAX

FULL DEPTH RECONSTRUCTION

ROUTE 219 ROADWAY SECTION

NOT TO SCALE

REV.	DATE	REVISION DESCRIPTION

SIGNATURE BLOCK:
DESIGNER/DRAFTER: JW
CHECKED BY: DEC

0 20 40
HORIZONTAL SCALE
1"=20'



CONNECTICUT
DEPARTMENT OF
TRANSPORTATION

PROJECT TITLE:
REPLACEMENT OF BRIDGE 06680 ROUTE 219 OVER
UNNAMED BROOK

TOWN(S):
TOWN OF GRANBY

DRAWING TITLE:
ROADWAY PLAN - 2

PROJECT NO.:
0055-0148
DRAWING NO.:
PLN-02
SHEET NO.:

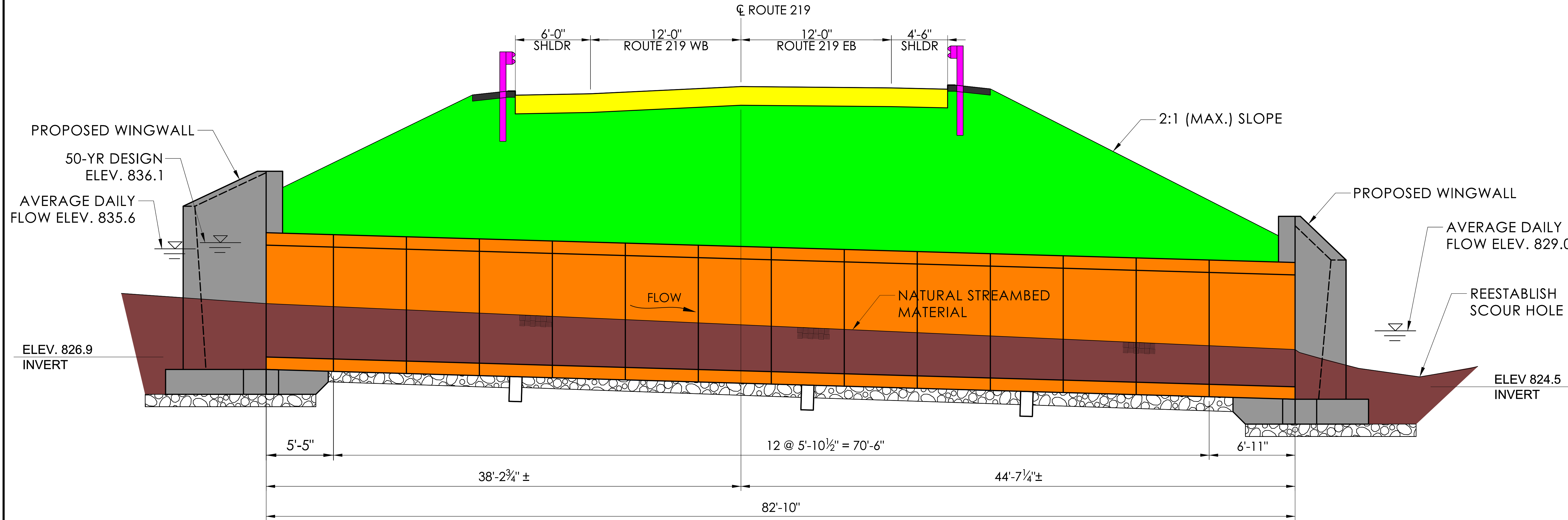

LONGITUDINAL SECTION

SCALE: 1/4" = 1'-0"

LEGEND

- PROPOSED BITUMINOUS PAVEMENT
- PROPOSED GUIDE RAIL
- PROCESSED AGGREGATE BASE
- PROPOSED CULVERT
- PROPOSED HEADWALLS AND WINGWALLS
- PROPOSED EARTHWORK/RIGHT OF WAY RESTORATION
- NATURAL STREAMBED MATERIAL

12'x9' PRECAST
CONCRETE BOX

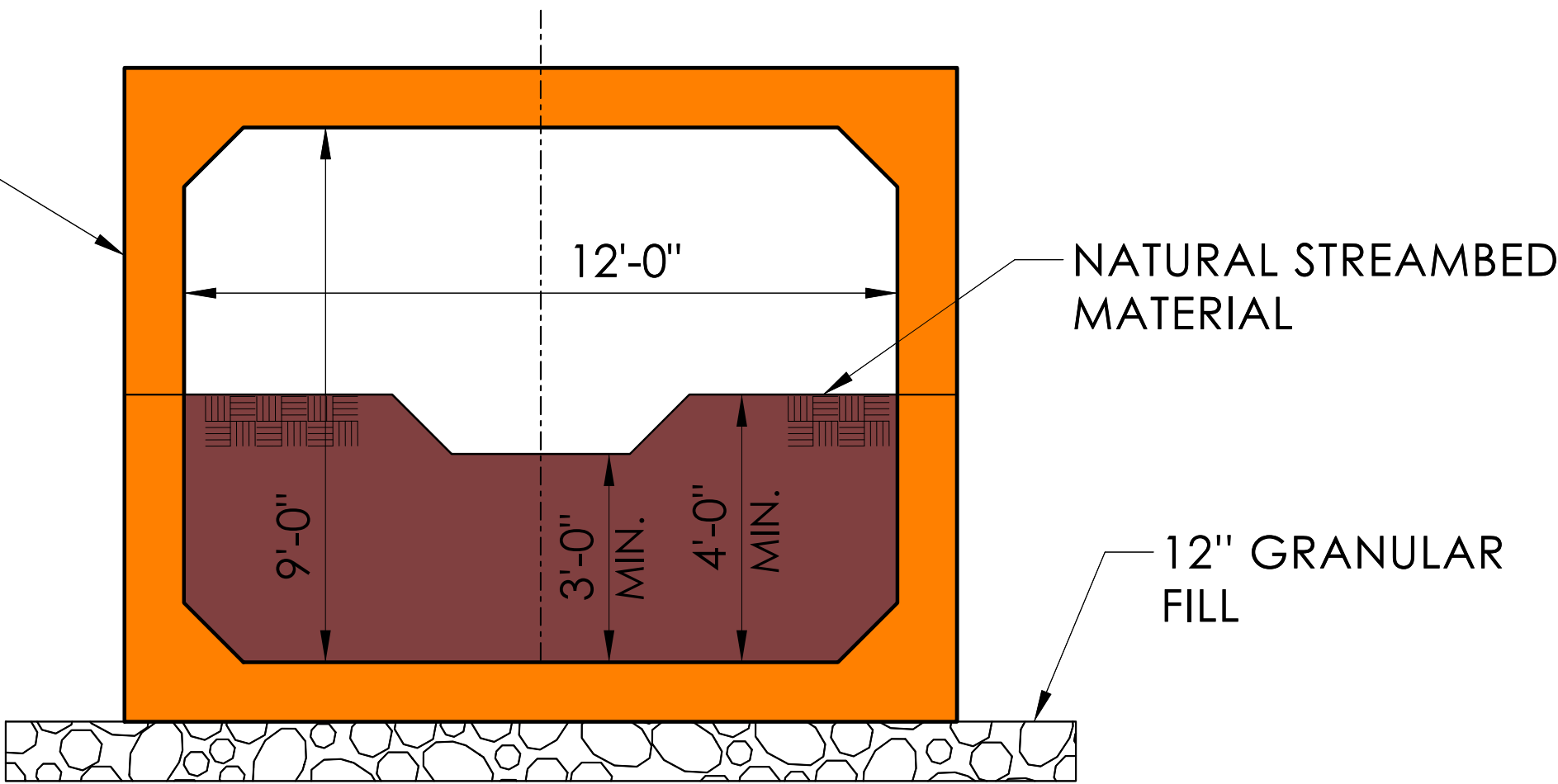

TRANSVERSE SECTION

SCALE: 3/8" = 1'-0"

REV.	DATE	REVISION DESCRIPTION

SIGNATURE BLOCK:				CONNECTICUT DEPARTMENT OF TRANSPORTATION	PROJECT TITLE: REPLACEMENT OF BRIDGE 06680 ROUTE 219 OVER UNNAMED BROOK	TOWN(S): TOWN OF GRANBY	DRAWING TITLE: LONGITUDINAL AND TRANSVERSE SECTIONS	PROJECT NO.: 0055-0148	DRAWING NO.: PLN-03
DESIGNER/DRAFTER: JW CHECKED BY: DEC									SHEET NO.:

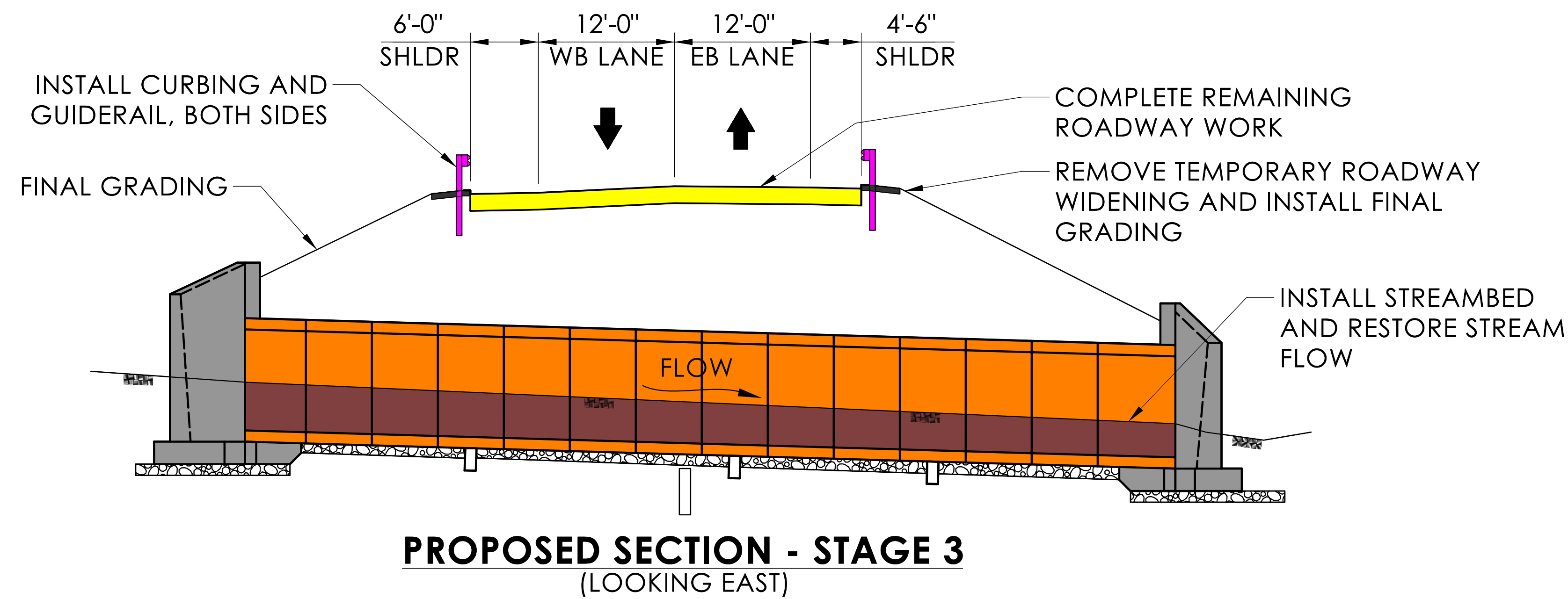
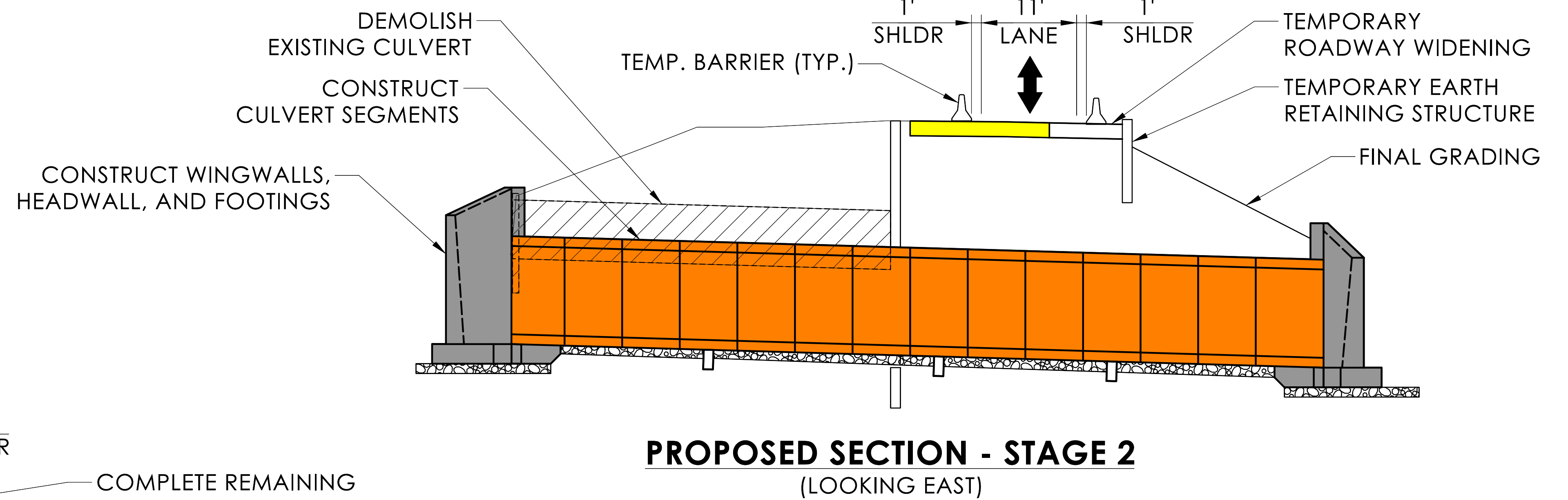
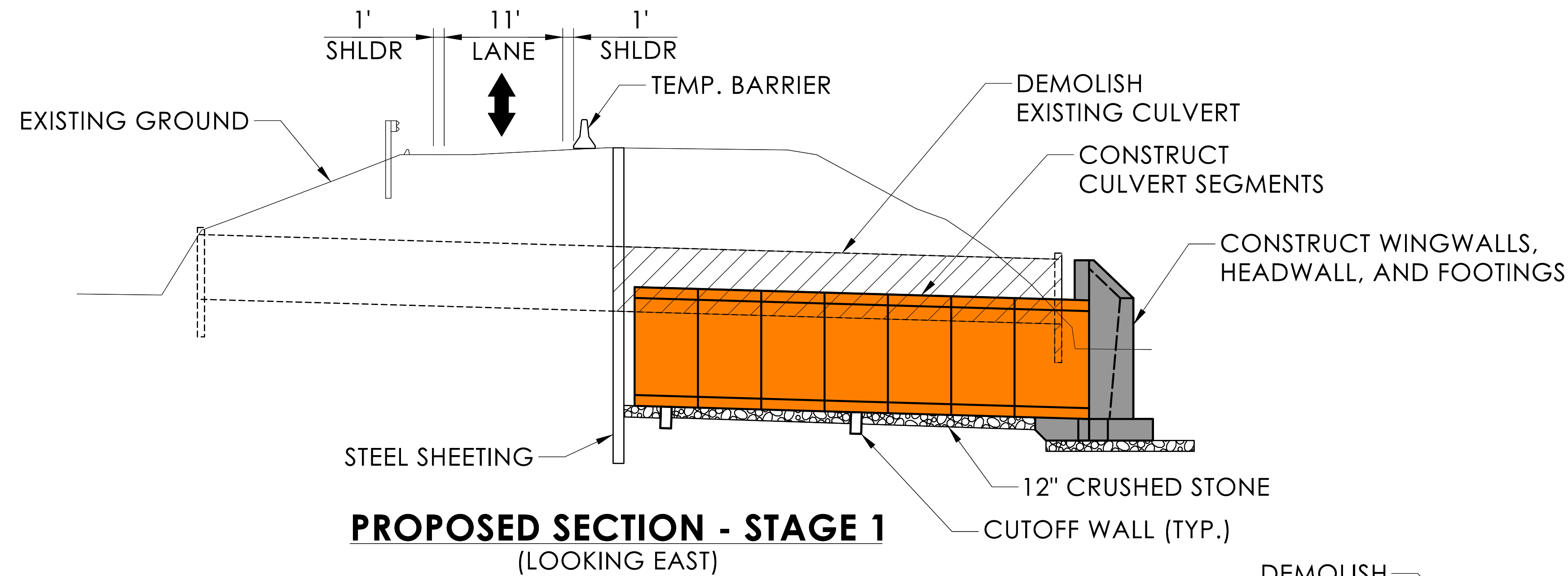

- LEGEND**
- PROPOSED BITUMINOUS PAVEMENT
 - PROPOSED GUIDE RAIL
 - PROCESSED AGGREGATE BASE
 - PROPOSED CULVERT
 - PROPOSED HEADWALLS AND WINGWALLS
 - PROPOSED NATURAL STREAMBED MATERIAL

REV.	DATE	REVISION DESCRIPTION

SIGNATURE BLOCK:		 CONNECTICUT DEPARTMENT OF TRANSPORTATION	PROJECT TITLE: REPLACEMENT OF BRIDGE 06680 ROUTE 219 OVER UNNAMED BROOK	TOWN(S): TOWN OF GRANBY	DRAWING TITLE: CONSTRUCTION STAGING SECTIONS	PROJECT NO.: 0055-0148	DRAWING NO.: PLN-04
DESIGNER/DRAFTER: JW	CHECKED BY: DEC						

LASTED SAVED BY: CLAB0687 FILE NAME: c:\users\clob0687\appdata\local\projectwise\workdir\mot-use-pw-20\0168377\ST_CB_West Granby_VPIM Staging Plan.dgn
PLOTTED DATE: 1/30/2025

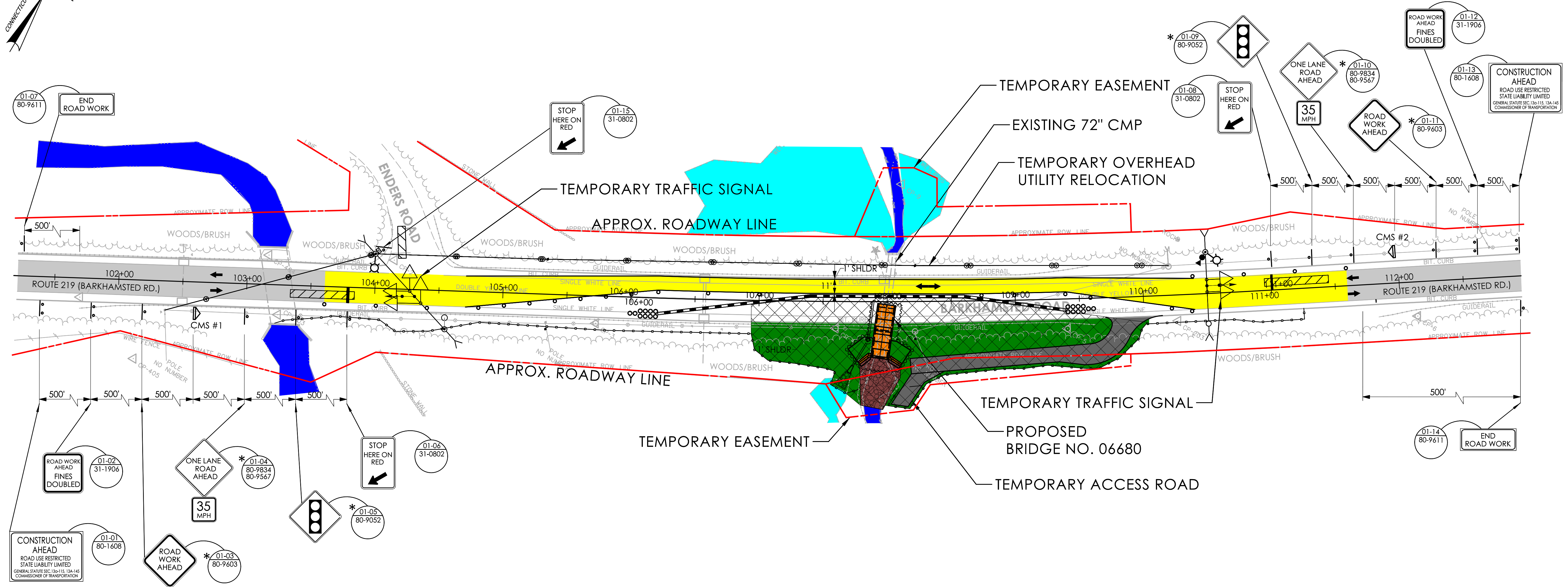
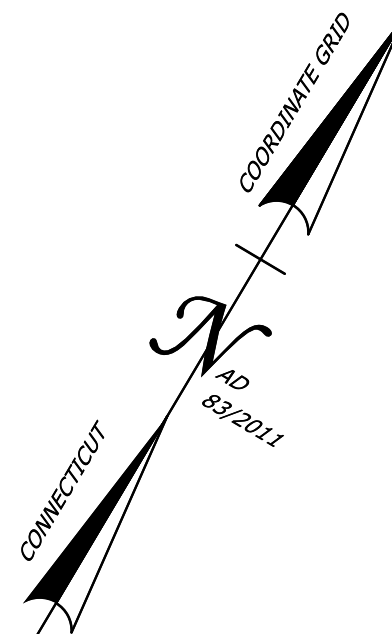

LEGEND

- | | | | |
|--|-----------------------------------|--|------------------------------|
| | EXISTING TRAVELED WAY | | TEMPORARY ACCESS ROAD |
| | PROPOSED TRAFFIC SHIFT | | WORK AREA |
| | PROPOSED CULVERT | | EXISTING WETLANDS |
| | NATURAL STREAMBED MATERIAL | | R.O.W. LINE |
| | PROPOSED TOP SOIL AND SEED | | TEMPORARY EASEMENT |
| | EXISTING WATERCOURSE | | |

CHANGEABLE MESSAGE SIGN #1 & 2:

PRIOR TO CONSTRUCTION MESSAGE 1		DURING CONSTRUCTION MESSAGE 2	
RTE 219 CONST	MM/DD TO MM/DD	ROAD WORK AHEAD	USE CAUTION

MPT LEGEND:

- | | | | |
|--|--------------------------|--|--|
| | TRAFFIC FLOW | | HIGH INTENSITY BARRICADE WARNING LIGHT |
| | SINGLE POST MOUNTED SIGN | | REMOTE CONTROL CHANGEABLE MESSAGE SIGN (CMS) |
| | DOUBLE POST MOUNTED SIGN | | SAND BARREL SYSTEM |
| | TRAFFIC DRUM | | TEMPORARY TRAFFIC BARRIER (TTB) |
| | DETECTION ZONE | | TEMPORARY LUMINAIRE |

PAVEMENT MARKING ABBREVIATIONS:

DYCL - DOUBLE YELLOW CENTER LINE
WEL - WHITE EDGE LINE

REV.	DATE	REVISION DESCRIPTION

SIGNATURE BLOCK:				CONNECTICUT DEPARTMENT OF TRANSPORTATION	PROJECT TITLE: REPLACEMENT OF BRIDGE 06680 ROUTE 219 OVER UNNAMED BROOK	TOWN(S): TOWN OF GRANBY	DRAWING TITLE: MAINTENANCE & PROTECTION OF TRAFFIC STAGE 1	PROJECT NO.: 0055-0148	DRAWING NO.: PLN-05
DESIGNER/DRAFTER: DEC	CHECKED BY: MDG								

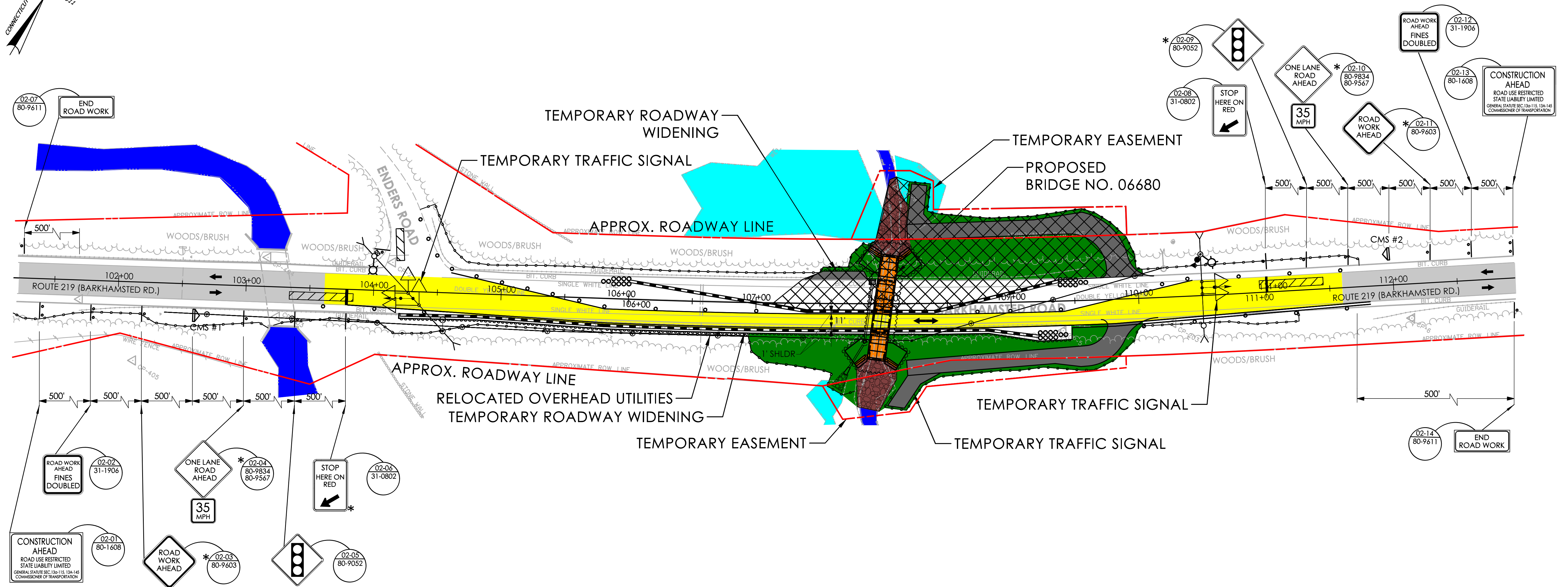
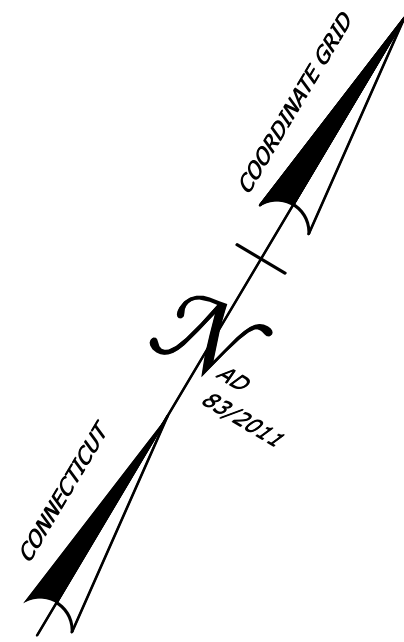

LEGEND

	EXISTING TRAVELED WAY		TEMPORARY ACCESS ROAD
	PROPOSED TRAFFIC SHIFT		WORK AREA
	PROPOSED CULVERT		EXISTING WETLAND
	NATURAL STREAMBED MATERIAL		R.O.W. LINE
	PROPOSED TOP SOIL AND SEED		TEMPORARY EASEMENT
	EXISTING WATERCOURSE		

CHANGEABLE MESSAGE SIGN #1 & 2:

PRIOR TO CONSTRUCTION MESSAGE 1	DURING CONSTRUCTION MESSAGE 2

PAVEMENT MARKING ABBREVIATIONS:

DYCL - DOUBLE YELLOW CENTER LINE
WEL - WHITE EDGE LINE

MPT LEGEND:

	TRAFFIC FLOW		HIGH INTENSITY BARRICADE WARNING LIGHT
	SINGLE POST MOUNTED SIGN		REMOTE CONTROL CHANGEABLE MESSAGE SIGN (CMS)
	DOUBLE POST MOUNTED SIGN		SAND BARREL SYSTEM
	TRAFFIC DRUM		TEMPORARY TRAFFIC BARRIER (TTB)
	DETECTION ZONE		TEMPORARY LUMINAIRE

REV.	DATE	REVISION DESCRIPTION

SIGNATURE BLOCK:	DESIGNER/DRAFTER: DEC	CHECKED BY: MDG	0 40' 80' HORIZONTAL SCALE 1" = 40'		CONNECTICUT DEPARTMENT OF TRANSPORTATION	PROJECT TITLE: REPLACEMENT OF BRIDGE 06680 ROUTE 219 OVER UNNAMED BROOK	TOWN(S): TOWN OF GRANBY	DRAWING TITLE: MAINTENANCE & PROTECTION OF TRAFFIC STAGE 2	PROJECT NO.: 0055-0148	DRAWING NO.: PLN-06
------------------	-----------------------	-----------------	---	--	--	---	-----------------------------------	--	----------------------------------	-------------------------------

LASTED SAVED BY: FUR91561 FILE NAME: c:\users\fur91561\appdata\local\projectwise\workdir\mott-use-pw-20\d0168377\TR_CB_Granby_VPIM_MP12-DEC.dgn
PLOTTED DATE: 05/02/2025