

LEGEND:

- PROPOSED BRIDGES (BRIDGE AND BOX CULVERT)
- PROPOSED SUBSTRUCTURE
- EXISTING PAVEMENT
- PROPOSED APPROACH ROADWAY RECONSTRUCTION
- PROPOSED DRIVEWAY RECONSTRUCTION
- PROPOSED SIDEWALK
- PROPOSED DRAINAGE
- PROPOSED FILL
- PROPOSED CUT
- WATERCOURSE
- WETLANDS
- R.O.W. LINE
- TEMPORARY EASEMENT LINE

- A** PARTIAL TAKE REQUIRED
- B** EASEMENT TO SLOPE FOR THE SUPPORT OF THE HIGHWAY REQUIRED
- C** EASEMENT TO SLOPE FOR THE SAFETY OF THE HIGHWAY REQUIRED
- D** DRAINAGE RIGHT OF WAY (D.R.O.W.) REQUIRED
- E** RIGHT TO CONSTRUCT DRIVEWAY REQUIRED
- F** RIGHT TO GRADE REQUIRED
- G** RIGHT TO INSTALL SEDIMENTATION CONTROL SYSTEM REQUIRED
- H** TEMPORARY CONSTRUCTION EASEMENT REQUIRED

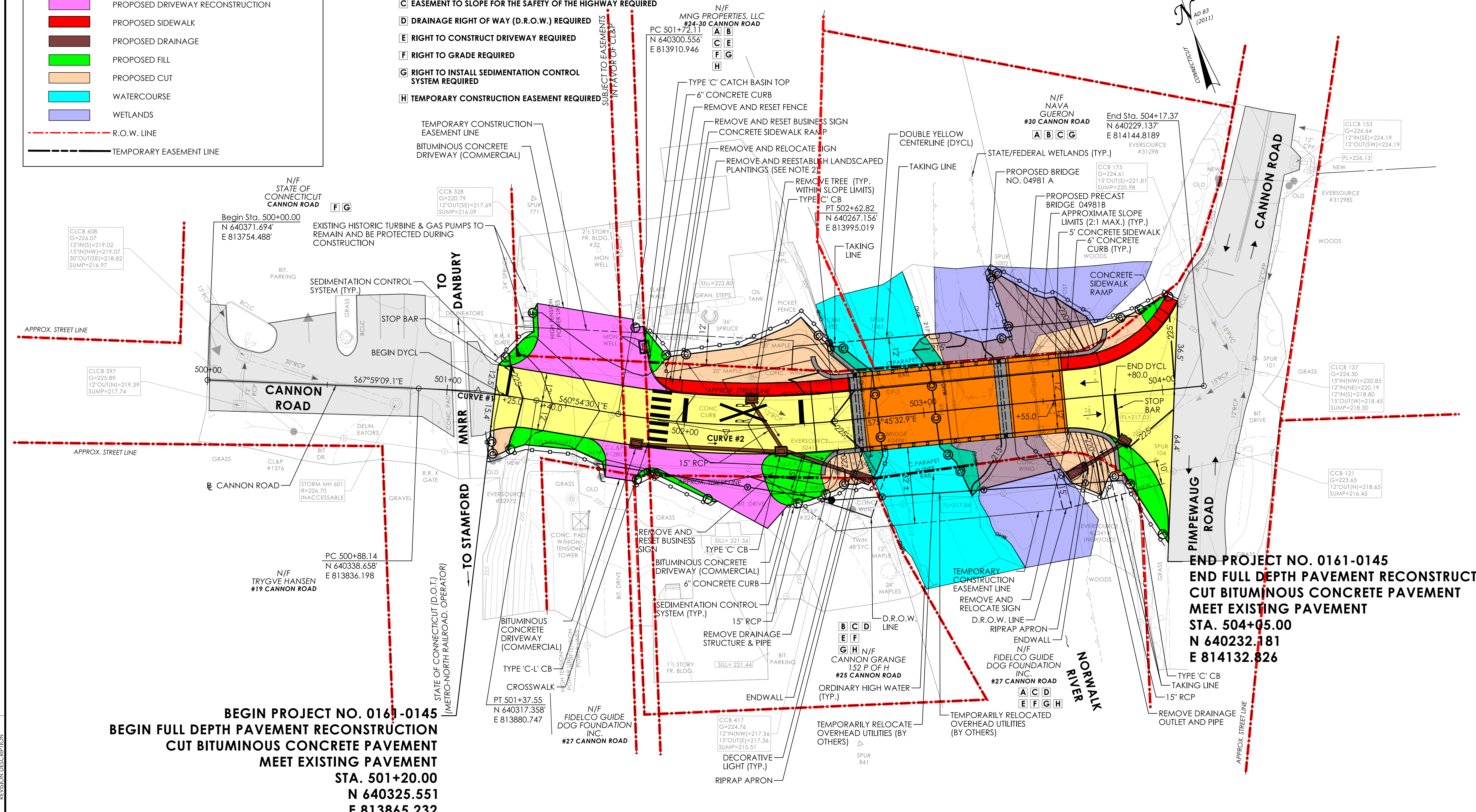

BEGIN PROJECT NO. 0161-0145
BEGIN FULL DEPTH PAVEMENT RECONSTRUCTION
CUT BITUMINOUS CONCRETE PAVEMENT
MEET EXISTING PAVEMENT
STA. 501+20.00
N 640325.551
E 813865.232

END PROJECT NO. 0161-0145
END FULL DEPTH PAVEMENT RECONSTRUCTION
CUT BITUMINOUS CONCRETE PAVEMENT
MEET EXISTING PAVEMENT
STA. 504+05.00
N 640232.181
E 814132.826

REV.	DATE	DESCRIPTION

DESIGNER/DRAFTER: REH
 CHECKED BY: JDL

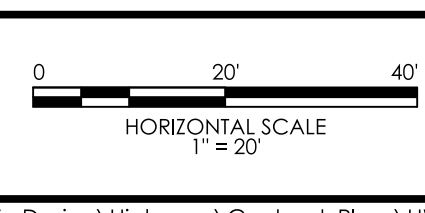

SIGNATURE/
 BLOCK:

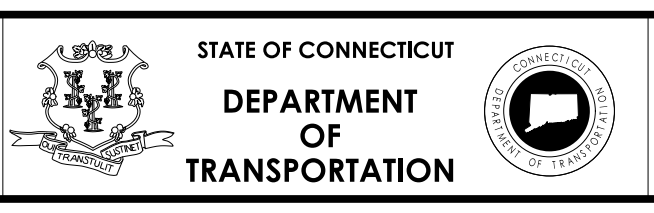

PROJECT NUMBER: 0161-0145
 PROJECT DESCRIPTION: REPLACEMENT OF BRIDGE NO. 04981, CANNON ROAD OVER NORWALK RIVER
 TOWN(S): WILTON
 DRAWING TITLE: ROADWAY PLAN - ALTERNATIVE 2

DRAWING NO.
 HWY-05
 SHEET NO.

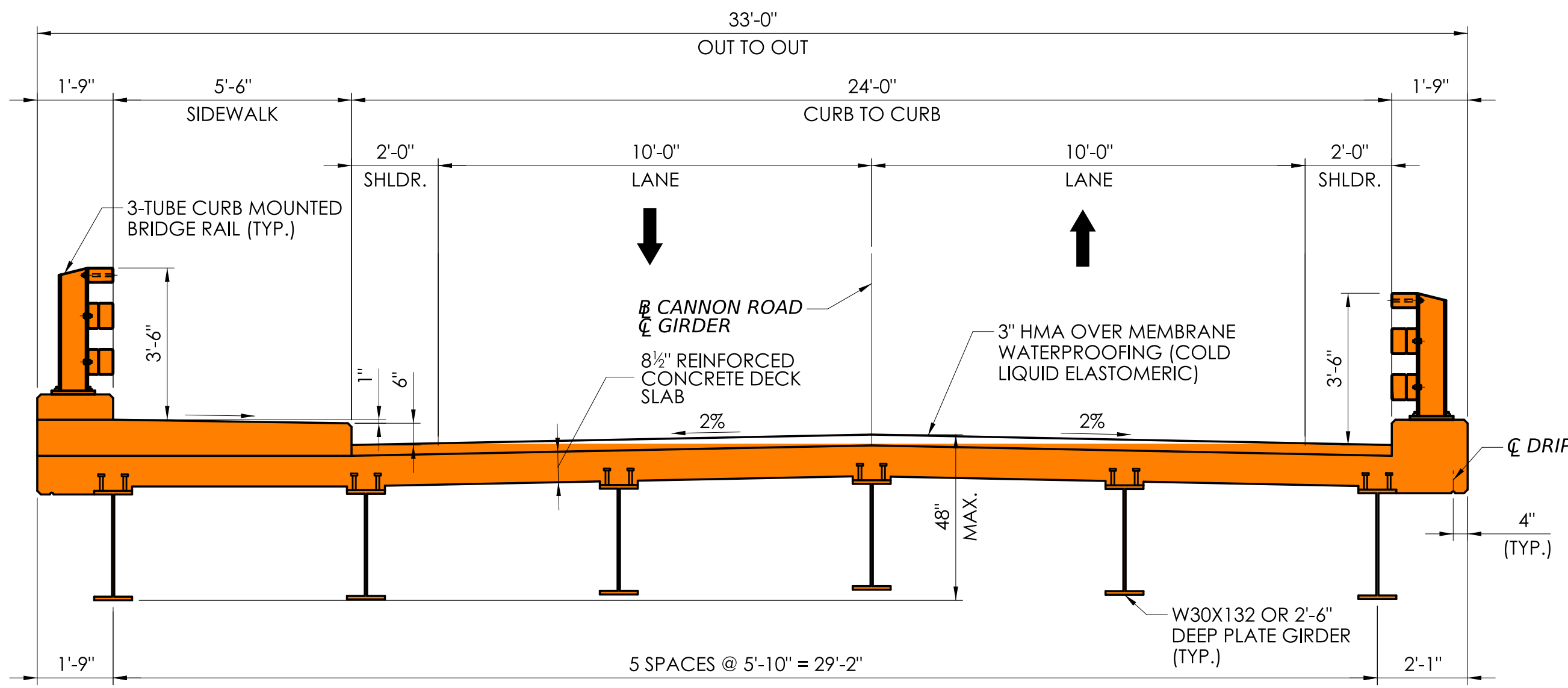

PROPOSED STEEL BEAM BRIDGE SECTION (LOOKING EAST)
SCALE: 3/8" = 1'-0"

LEGEND:	
	PROPOSED BRIDGES (BRIDGE AND BOX CULVERT)
	PROPOSED SUBSTRUCTURE
	PROPOSED APPROACH ROADWAY RECONSTRUCTION
	PROPOSED FILL
	PROPOSED CUT
	WATERCOURSE
	WETLANDS
	PROPOSED APPROACH GUIDERAIL
	R.O.W. LINE
	TEMPORARY CONSTRUCTION EASEMENT LINE

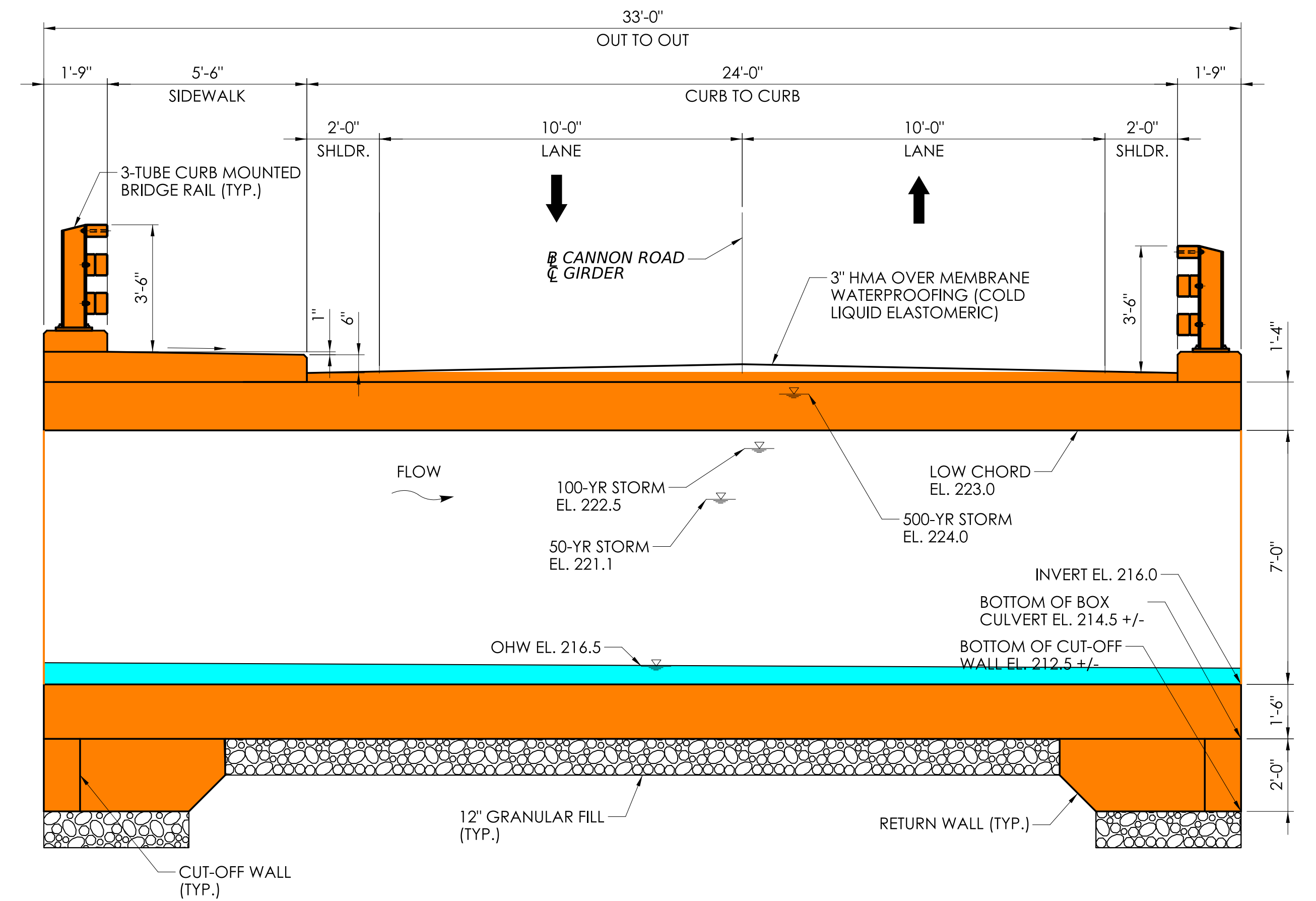

PROPOSED PRECAST CONCRETE BOX CULVERT SECTION (LOOKING EAST)
SCALE: 3/8" = 1'-0"

REV.	DATE	REVISION DESCRIPTION

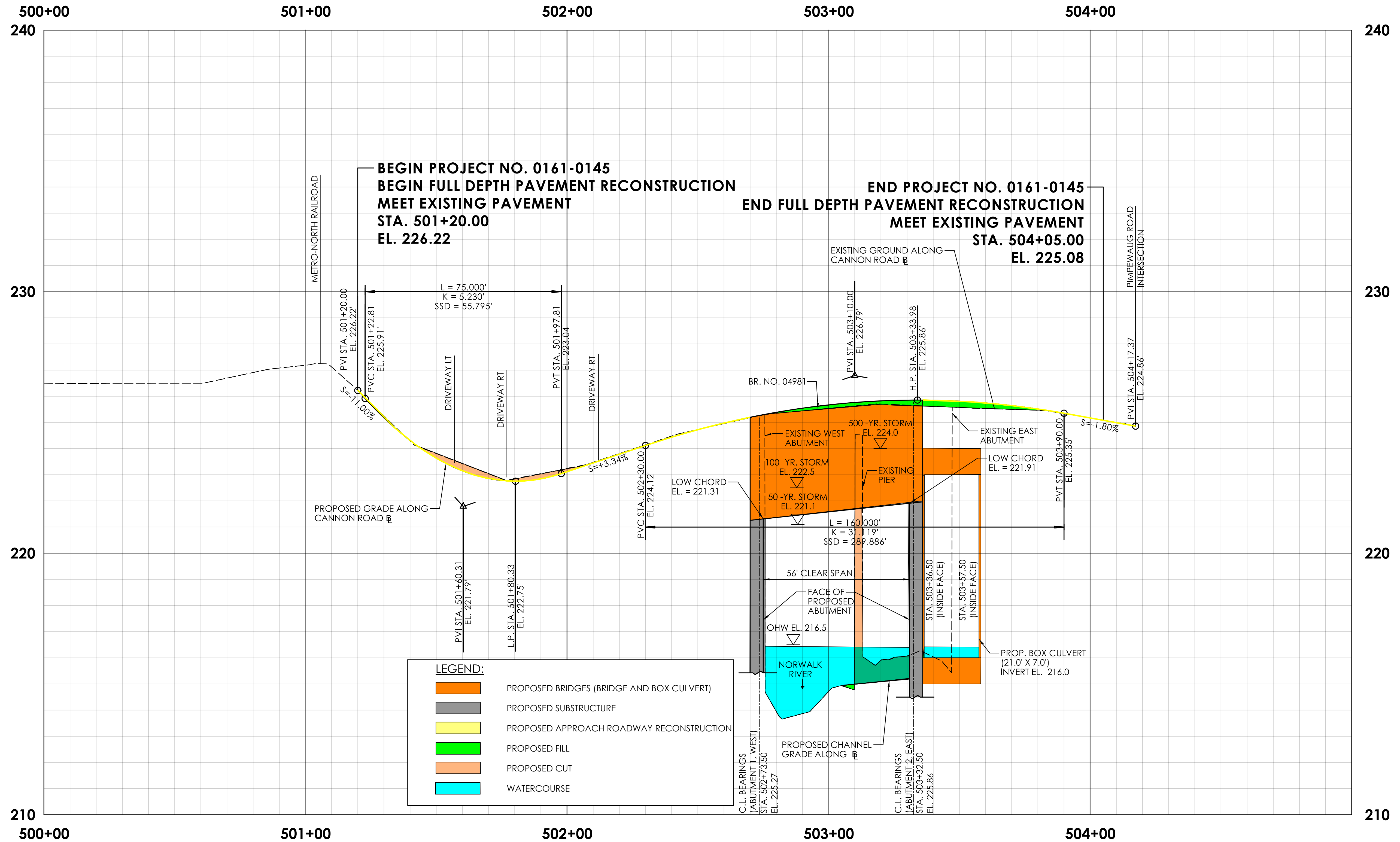

LEGEND:

	PROPOSED BRIDGES (BRIDGE AND BOX CULVERT)
	PROPOSED SUBSTRUCTURE
	PROPOSED APPROACH ROADWAY RECONSTRUCTION
	PROPOSED FILL
	PROPOSED CUT
	WATERCOURSE

REV.	DATE	REVISION DESCRIPTION

DESIGNER/DRAFTER: REH CHECKED BY: JDL

HORIZONTAL SCALE IN FEET: 0, 20, 40

VERTICAL SCALE IN FEET: 0, 2, 4

SIGNATURE/BLOCK: _____

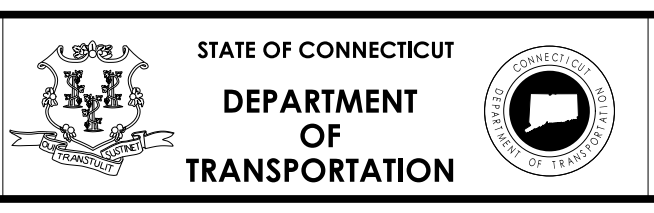

PROJECT NUMBER: 0161-0145

PROJECT DESCRIPTION: REPLACEMENT OF BRIDGE NO. 04981, CANNON ROAD OVER NORWALK RIVER

TOWN(S): WILTON



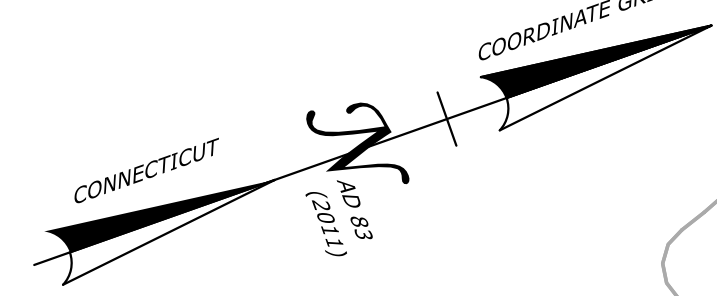
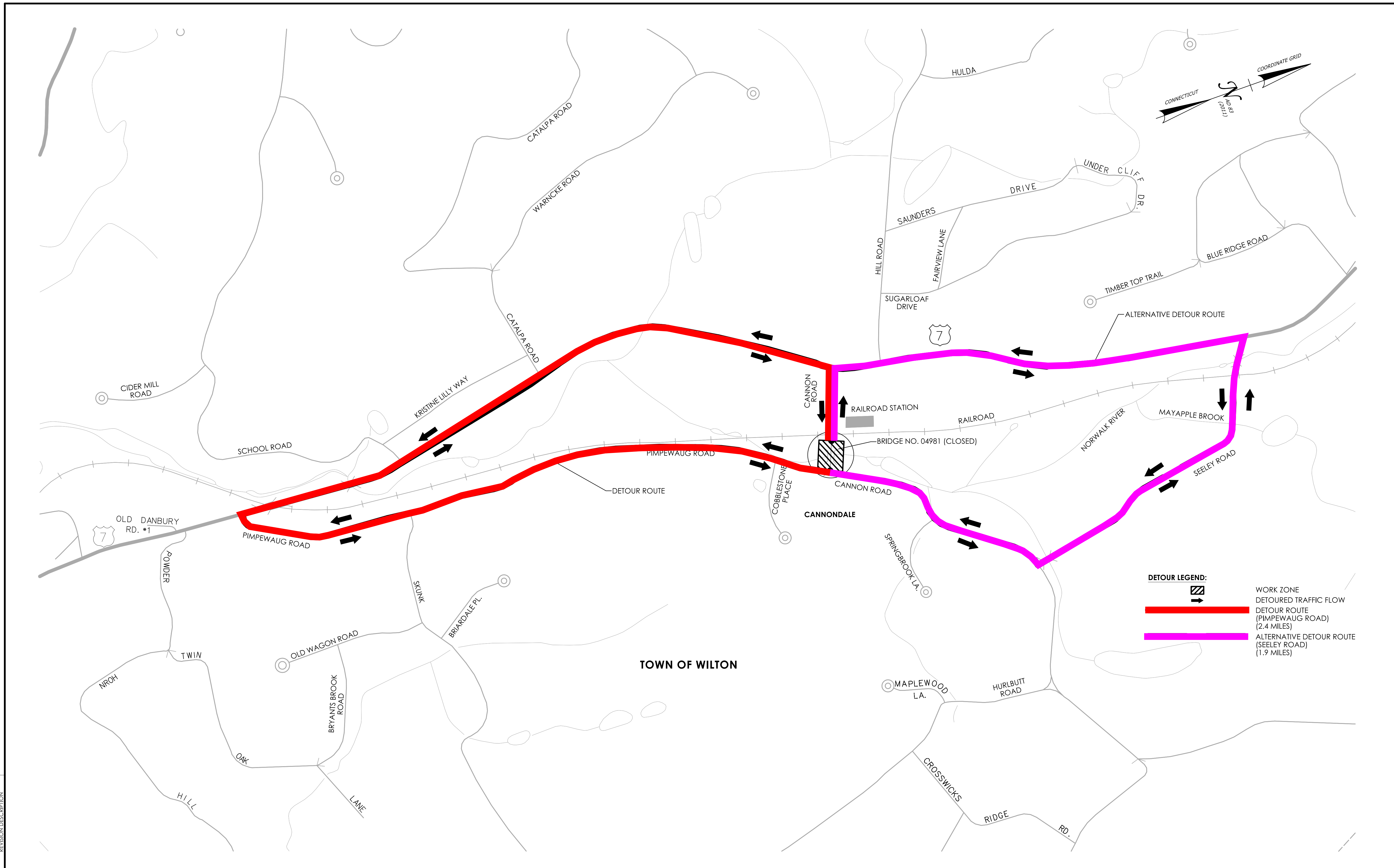

DRAWING TITLE: ROADWAY PROFILE - ALTERNATIVE 2

DRAWING NO. HWY-06

SHEET NO. _____



DETOUR LEGEND:

-  WORK ZONE
-  DETOURED TRAFFIC FLOW
-  DETOUR ROUTE (PIMPEWAUG ROAD) (2.4 MILES)
-  ALTERNATIVE DETOUR ROUTE (SEELEY ROAD) (1.9 MILES)

TOWN OF WILTON

REV.	DATE	REVISION DESCRIPTION

DESIGNER/DRAFTER: REH CHECKED BY: JDL

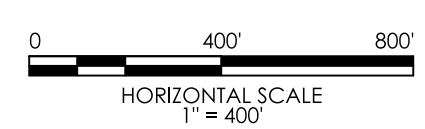

SIGNATURE/BLOCK:

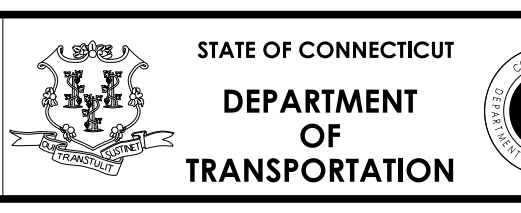

PROJECT NUMBER: 0161-0145
 PROJECT DESCRIPTION: REPLACEMENT OF BRIDGE NO. 04981, CANNON ROAD OVER NORWALK RIVER
 TOWN(S): WILTON
 DRAWING TITLE: CANNON ROAD DETOUR PLAN - ALTERNATIVES 1A, 1B & 2

DRAWING NO. HWY-07
 SHEET NO.