

### Work Instructions for RAPID DNA Instrument Operators

1. Obtain an INTEL sample cartridge from refrigerator.
2. Prepare swab/sample.
3. Open cartridge and insert swab into cartridge.

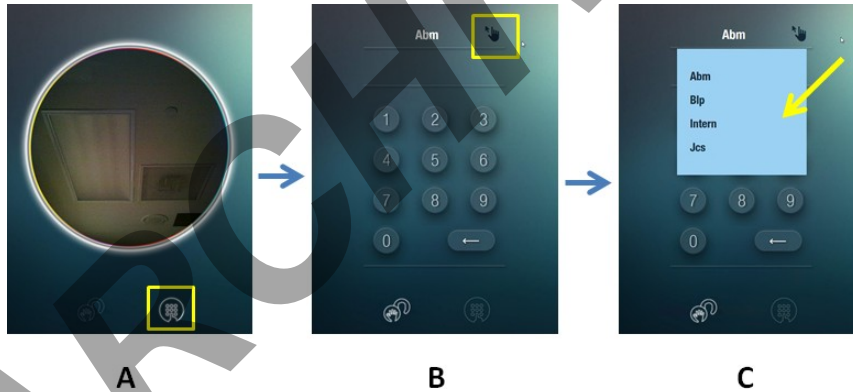

4. Log into Rapid DNA Instrument.



5. Type in sample name. AGENCY-Case Number-Sample #

*Approved by Director: Dr. Guy Vallaro*



6. Insert INTEL Cartridge into instrument.

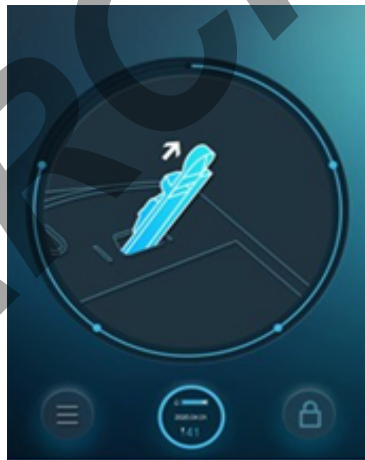

7. Wait for “pop” sound. If no “pop” and timer does not start the countdown, contact Rapid Admin.

8. When run is completed (~90 minutes) remove from instrument and

---



**State of Connecticut Department of Emergency Services and Public Protection  
Division of Scientific Services**

*Documents outside of Qualtrax are considered uncontrolled.*

*Approved by Director: Dr. Guy Vallaro*

discard in biohazard.

9. Results will be displayed as one of the marks below.

Status	DNA profile is generated	Action
Green 	Yes	The DNA profile does not contain quality score flags. The DNA profile is ready for analysis by the RapidLink™ Software. No further action is needed on the instrument.
Yellow 	Yes	The DNA profile generated contains quality score flags. The DNA profile is available for review in the RapidLink™ Software.
Red 	No	The sample failed and no profile was generated.

10. Await communication from RAPID Administrators.

11. An email will be sent out communicating if there was a hit in the Small Pond Database to a specific Database ID.

12. The **Offender Collect Search Confirmation Form** will be filled out using the Database ID, signed and sent to the [CT.RAPIDDNA@ct.gov](mailto:CT.RAPIDDNA@ct.gov) email address.

13. After confirming the form is signed, an email will be sent to the user with the information needed for a COLLECT search.

14. A COLLECT search must be done to document that the individual qualifies to be in the Offender Database.