



## Connecticut Department of Energy and Environmental Protection License\*

### Structures, Dredging & Fill Permit

**Licensee(s):** City of Bridgeport

**Licensee Address(s):** 999 Broad Street, 1<sup>st</sup> Floor  
Bridgeport, CT 06604

**License Number(s):** 202400953-SDF

**Municipality:** Bridgeport

**Project Description:** Reconstruction of boat ramp for public access

**Project Address/Location:** Newfield Avenue Boat Ramp

**Waters:** Bridgeport Harbor

**Authorizing CT Statute(s)** CGS Section 22a-359 to 363g; CGS Section 22a-90 to 112;  
**and/or Federal Law:** Section 401 CWA (33 USC 1341)

**Applicable Regulations of** 22a-426-1 to 9  
**CT State Agencies:**

**Agency Contact:** Land & Water Resources Division,  
Bureau of Water Protection & Land Reuse, 860-424-3019

**License Expiration:** Five (5) years from the date of issuance of this license.

**Project Site Plan Set:** Nine sheets of site plans prepared by GZA Geo Environmental;  
Inc. dated Dec. 2023 and revised in March 2024.

**License Enclosures:** LWRD Compliance Certification Form; Land Record Filing; Site  
Plan Set; LWRD General Conditions; LWRD Work  
Commencement Form

\*Connecticut's Uniform Administrative Procedure Act defines License to include, "the whole or part of any agency permit, certificate, approval, registration, charter or similar form of permission required by law . . ."

**Authorized Activities:**

The Licensee is hereby authorized to conduct the following work as described in application # 202400953 and as depicted on any site plan sheets / sets cited herein:

1. remove existing derelict boat ramp by removing support floats and excavating to remove sediment, stone block wall, and pavement for upland disposal.
2. install a new 41' x 88' boat ramp extending to four feet below mean low water (-7.6' NAVD88) as follows:
  - a. grade to place geotextile fabric and crushed stone base;
  - b. install concrete headwall;
  - c. drive a 64 linear foot sheet pile wall on the western edge of the ramp to replace the existing concrete block;
  - d. install pre-cast concrete planks and curbing; a stone revetment at a slope of 3:1 along the western edge of the ramp; and, a 4' wide scour pad at the base of the ramp; and,
  - e. place five 10'x20' floats supported by five 1' piles to be attached via a transition plate from an existing concrete landing.

***Failure to comply with the terms and conditions of this license shall subject the Licensee and / or the Licensee's contractor(s) to enforcement actions and penalties as provided by law.***

**This license is subject to the following Terms and Conditions:**

1. **License Enclosure(s) and Conditions.** The Licensee shall comply with all applicable terms and conditions as may be stipulated within the License Enclosure(s) listed above.
2. **Discharge of Concrete.** At no time shall the Licensee allow concrete to discharge into Bridgeport Harbor
3. **Turbidity Curtain.** Prior to the commencement of work authorized herein, the Licensee shall install turbidity curtains extending from the water surface to the substrate around the work area. Such erosion and sediment control structures shall be maintained in optimal operating condition until project completion at which time the erosion and sediment controls shall be removed to an upland location.
4. **Height of Tide Restriction.** All work authorized herein shall be conducted during periods of lower water to minimize sedimentation.
5. **Access and Encroachment Approvals.** The Licensee shall, prior to conducting the activities authorized herein, obtain all necessary encroachment agreements and construction access approvals.

Issued under the authority of the Commissioner of Energy and Environmental Protection on:

\_\_\_\_\_  
Date

\_\_\_\_\_  
Emma Cimino  
Deputy Commissioner  
Department of Energy & Environmental Protection

## **LWRD General Conditions**

- 1. Land Record Filing (for *Structures Dredging & Fill, Tidal Wetlands, Certificate of Permission, and Long Island Sound General Permit Licenses only*).** The Licensee shall file the Land Record Filing on the land records of the municipality in which the subject property is located not later than thirty (30) days after license issuance pursuant to Connecticut General Statutes (CGS) Section 22a-363g. A copy of the Notice with a stamp or other such proof of filing with the municipality shall be submitted to [DEEP.LWRDRegulatory@ct.gov](mailto:DEEP.LWRDRegulatory@ct.gov) no later than sixty (60) days after license issuance. If a Land Record Filing form is not enclosed and the work site is not associated with an upland property, no filing is required.
- 2. Contractor Notification.** The Licensee shall give a copy of the license and its attachments to the contractor(s) who will be carrying out the authorized activities prior to the start of construction and shall receive a written receipt for such copy, signed and dated by such contractor(s). The Licensee's contractor(s) shall conduct all operations at the site in full compliance with the license and, to the extent provided by law, may be held liable for any violation of the terms and conditions of the license. At the work site, the contractor(s) shall, whenever work is being performed, have on site and make available for inspection a copy of the license and the authorized plans.
- 3. Work Commencement<sup>1</sup>.** Not later than two (2) weeks prior to the commencement of any work authorized herein, the Licensee shall submit to [DEEP.LWRDRegulatory@ct.gov](mailto:DEEP.LWRDRegulatory@ct.gov), on the Work Commencement Form attached hereto, the name(s) and address(es) of all contractor(s) employed to conduct such work and the expected date for commencement and completion of such work, if any.
  - For water diversion activities authorized pursuant to 22a-377(c)-1 of the Regulations of Connecticut State Agencies, the Licensee shall also notify the Commissioner in writing two weeks prior to initiating the authorized diversion.
  - For emergency activities authorized pursuant Connecticut General Statutes Section 22a-6k, the Licensee shall notify the Commissioner, in writing, of activity commencement at least one (1) day prior to construction and of activity completion no later than five (5) days after conclusion.
- 4. For Coastal Licenses Only - License Notice.** The Licensee shall post the first page of the License in a conspicuous place at the work area while the work authorized therein is undertaken.
- 5. Unauthorized Activities.** Except as specifically authorized, no equipment or material, including but not limited to, fill, construction materials, excavated material or debris, shall be

---

<sup>1</sup> The Work Commencement condition and the need for a Work Commencement Form is not applicable to Flood Management Certification approvals.



deposited, placed or stored in any wetland or watercourse on or off-site. The Licensee may not conduct work within wetlands or watercourses other than as specifically authorized, unless otherwise authorized in writing by the Commissioner. Tidal wetlands means “wetland” as defined by section 22a-29 and “freshwater wetlands and watercourses” means “wetlands” and “watercourses” as defined by section 22a-38.

- 6. Management of Materials.** Any materials removed from the site shall be managed in accordance with all federal, state, and local requirements, including Chapter 446K Water Pollution Control, Chapter 445 Hazardous Waste, and Chapter 446d Solid Waste of the Connecticut General Statutes.
- 7. Unconfined Instream Work.** Unless otherwise noted in a condition of the license, the following conditions apply to projects in non-coastal waters:

  - Unconfined instream work is limited to the period June 1 through September 30.
  - Confinement of a work area by cofferdam techniques using sand bag placement, sheet pile installation (vibratory method only), portadam, or similar confinement devices is allowed any time of the year. The removal of such confinement devices is allowed any time of the year.
  - Once a work area has been confined, in-water work within the confined area is allowed any time of the year.
  - The confinement technique used shall completely isolate and protect the confined area from all flowing water. The use of silt boom/curtain or similar technique as a means for confinement is prohibited.
- 8. For State Actions Only - Material or Equipment Storage in the Floodplain.** Unless approved by a Flood Management Exemption, the storage of any materials at the site which are buoyant, hazardous, flammable, explosive, soluble, expansive, radioactive, or which could in the event of a flood be injurious to human, animal or plant life, below the elevation of the five-hundred (500) year flood is prohibited. Any other material or equipment stored at the site below said elevation by the Licensee or the Licensee's contractor must be firmly anchored, restrained or enclosed to prevent flotation. The quantity of fuel stored below such elevation for equipment used at the site shall not exceed the quantity of fuel that is expected to be used by such equipment in one day. In accordance with the licensee's Flood Contingency Plan, the Licensee shall remove equipment and materials from the floodplain during periods when flood warnings have been issued or are anticipated by a responsible federal, state or local agency. It shall be the Licensee's responsibility to obtain such warnings when flooding is anticipated.
- 9. Temporary Hydraulic Facilities for Water Handling.** If not reviewed and approved as a part of the license application, temporary hydraulic facilities shall be designed by a qualified professional and in accordance with the *Connecticut Guidelines for Soil Erosion and Sediment Control*, the *2004 Connecticut Stormwater Quality Manual*, or the *Department of Transportation's ConnDOT Drainage Manual*, as applicable. Temporary hydraulic facilities may include channels, culverts or bridges which are required for haul roads, channel relocations, culvert installations, bridge construction, temporary roads, or detours.

- 10. Excavated Materials.** Unless otherwise authorized, all excavated material shall be staged and managed in a manner which prevents additional impacts to wetlands and watercourses.
- 11. Best Management Practices.** The Licensee shall not cause or allow pollution of any wetlands or watercourses, including pollution resulting from sedimentation and erosion. In constructing or maintaining any authorized structure or facility or conducting any authorized activity, or in removing any such structure or facility, the Licensee shall employ best management practices to control storm water discharges, to prevent erosion and sedimentation, and to otherwise prevent pollution of wetlands and other waters of the State. For purposes of the license, “pollution” means “pollution” as that term is defined by CGS section 22a-423. Best Management Practices include, but are not limited, to practices identified in the *Connecticut Guidelines for Soil Erosion and Sediment Control* as revised, *2004 Connecticut Stormwater Quality Manual*, Department of Transportation’s *ConnDOT Drainage Manual* as revised, and the Department of Transportation Standard Specifications as revised.
- 12. In-Water Work Vessel Staging and Storage. (for Structures Dredging & Fill, Tidal Wetlands, Certificate of Permission, and Long Island Sound General Permit Licenses only).** For any barge, vessel, skiff or floating work platform (“work vessels”) utilized in the execution of the work authorized herein, the Licensee shall ensure that such work vessels:
- do not rest on, or come in contact with, the substrate at any time, unless specifically authorized in the license.
  - are not stored over intertidal flats, submerged aquatic vegetation or tidal wetland vegetation or in a location that interferes with navigation. In the event any work vessel is grounded, no dragging or prop dredging shall occur to free it.
- 13. Work Site Restoration.** Upon completion of any authorized work, the Licensee shall restore all areas impacted by construction, or used as a staging area or accessway in connection with such work, to their condition prior to the commencement of such work.
- 14. Inspection.** The Licensee shall allow any representative of the Commissioner to inspect the project location at reasonable times to ensure that work is being or has been conducted in accordance with the terms and conditions of this license.
- 15. Change of Use. (Applies only if a use is specified within the License “Project Description”)**
- a. The work specified in the license is authorized solely for the purpose set forth in the license. No change in purpose or use of the authorized work or facilities as set forth in the license may occur without the prior written approval of the Commissioner. The Licensee shall, prior to undertaking or allowing any change in use or purpose from that which is authorized by this license, request permission from the Commissioner for such change. Said request shall be in writing and shall describe the proposed change and the reason for the change.
  - b. A change in the form of ownership of any structure authorized herein from a rental/lease commercial marina to a wholly-owned common interest community or dockominium may constitute a change in purpose as specified in paragraph (a) above.
- 16. De Minimis Alteration.** The Licensee shall not deviate from the authorized activity without

prior written approval from the Commissioner. The Licensee may request a de minimis change to any authorized structure, facility, or activity. A de minimis alteration means a change in the authorized design, construction or operation that individually and cumulatively has minimal additional environmental impact and does not substantively alter the project as authorized.

- For diversion activities authorized pursuant to 22a-377(c)-2 of the Regulations of Connecticut State Agencies, a de minimis alteration means an alteration which does not significantly increase the quantity of water diverted or significantly change the capacity to divert water.

**17. Extension Request.** The Licensee may request an extension of the license expiration date. Such request shall be in writing and shall be submitted to [DEEP.LWRDRegulatory@ct.gov](mailto:DEEP.LWRDRegulatory@ct.gov) at least thirty (30) days prior to the license expiration. Such request shall describe the work done to date, what work still needs to be completed, and the reason for such extension. The Commissioner may extend the expiration date of this license for a period of up to one year, in order for the Licensee to complete the authorized activities. It shall be at the Commissioner's sole discretion to grant or deny such request. No more than three (3) one-year extensions will be granted under this license.

**18. Compliance Certification.** Not later than 90 days after completion of the authorized work, the Licensee shall prepare and submit to [DEEP.LWRDRegulatory@ct.gov](mailto:DEEP.LWRDRegulatory@ct.gov), the attached Compliance Certification Form. Such Compliance Certification shall be completed, signed, and sealed by the Licensee and a Connecticut Licensed Design Professional. If non-compliance is indicated on the form, or the Commissioner has reason to believe the activities and/or structures were conducted in non-compliance with the license, the Commissioner may require the Licensee to submit as-built plans as a condition of this license.

**19. Maintenance.** The Licensee shall maintain all authorized structures or work in optimal condition or shall remove such structures or facility and restore the affected waters to their pre-work condition. Any such maintenance or removal activity shall be conducted in accordance with applicable law and any additional approvals required by law.

**20. No Work After License Expiration.** Work conducted after the license expiration date is a violation of the license and may subject the licensee to enforcement action, including penalties, as provided by law.

**21. License Transfer.** The license is not transferable without prior written authorization of the Commissioner. A request to transfer a license shall be submitted in writing and shall describe the proposed transfer and the reason for such transfer. The Licensee's obligations under the license shall not be affected by the passage of title to the license site to any other person or municipality until such time as a transfer is approved by the Commissioner.

**22. Document Submission.** Any document required to be submitted to the Commissioner under the license or any contact required to be made with the Commissioner shall, unless otherwise specified in writing by the Commissioner, be directed to:

[DEEP.LWRDRegulatory@ct.gov](mailto:DEEP.LWRDRegulatory@ct.gov) or

Regulatory Section  
Land & Water Resources Division  
Department of Energy and Environmental Protection  
79 Elm Street  
Hartford, Connecticut 06106-5127  
860-424-3019

- 23. Date of Document Submission.** The date of submission to the Commissioner of any document required by the license shall be the date such document is received by the Commissioner. The date of any notice by the Commissioner under the license, including but not limited to notice of approval or disapproval of any document or other action, shall be the date such notice is personally delivered or the date three (3) days after it is mailed by the Commissioner, whichever is earlier. Except as otherwise specified in the license, the word “day” as used in the license means calendar day. Any document or action which is required by the license to be submitted or performed by a date which falls on a Saturday, Sunday or a Connecticut or federal holiday shall be submitted or performed on or before the next day which is not a Saturday, Sunday, or a Connecticut or federal holiday.
- 24. Certification of Documents.** Any document, including but not limited to any notice, which is required to be submitted to the Commissioner under the license shall be signed by the Licensee and by the individual or individuals responsible for actually preparing such document, each of whom shall certify in writing as follows: “I have personally examined and am familiar with the information submitted in this document and all attachments and certify that based on reasonable investigation, including my inquiry of those individuals responsible for obtaining the information, the submitted information is true, accurate and complete to the best of my knowledge and belief, and I understand that any false statement made in this document or its attachments may be punishable as a criminal offense.”
- 25. Accuracy of Documentation.** In evaluating the application for the license, the Commissioner has relied on information and data provided by the Licensee and on the Licensee’s representations concerning site conditions, design specifications and the proposed work, including but not limited to representations concerning the commercial, public or private nature of the work or structures, the water-dependency of said work or structures, its availability for access by the general public, and the ownership of regulated structures or filled areas. If such information proves to be false, deceptive, incomplete or inaccurate, the license may be modified, suspended or revoked, and any unauthorized activities may be subject to enforcement action.
- 26. Limits of Liability.** In granting the license, the Commissioner has relied on all representations of the Licensee, including information and data provided in support of the Licensee’s application. Neither the Licensee’s representations nor the issuance of the license shall constitute an assurance by the Commissioner as to the structural integrity, the engineering feasibility or the efficacy of such design.
- 27. Reporting of Violations.** In the event that the Licensee becomes aware that they did not or may not comply, or did not or may not comply on time, with any provision of this license or of any document incorporated into the license, the Licensee shall immediately notify the

agency contact specified within the license and shall take all reasonable steps to ensure that any noncompliance or delay is avoided or, if unavoidable, is minimized to the greatest extent possible. In so notifying the agency contact, the Licensee shall provide, for the agency's review and written approval, a report including the following information:

- a. the provision(s) of the license that has been violated;
- b. the date and time the violation(s) was first observed and by whom;
- c. the cause of the violation(s), if known;
- d. if the violation(s) has ceased, the duration of the violation(s) and the exact date(s) and times(s) it was corrected;
- e. if the violation(s) has not ceased, the anticipated date when it will be corrected;
- f. steps taken and steps planned to prevent a reoccurrence of the violation(s) and the date(s) such steps were implemented or will be implemented; and
- g. the signatures of the Licensee and of the individual(s) responsible for actually preparing such report.

If the violation occurs outside of normal business hours, the Licensee shall contact the Department of Energy and Environmental Protection Emergency Dispatch at 860-424-3333. The Licensee shall comply with any dates which may be approved in writing by the Commissioner.

- 28. Revocation/Suspension/Modification.** The license may be revoked, suspended, or modified in accordance with applicable law.
- 29. Other Required Approvals.** License issuance does not relieve the Licensee of their obligations to obtain any other approvals required by applicable federal, state and local law.
- 30. Rights.** The license is subject to and does not derogate any present or future property rights or powers of the State of Connecticut, and conveys no property rights in real estate or material nor any exclusive privileges, and is further subject to any and all public and private rights and to any federal, state or local laws or regulations pertinent to the property or activity affected hereby.
- 31. Condition Conflicts.** In the case where a project specific special condition listed on the license differs from, or conflicts with, one of the general conditions listed herein, the project specific special condition language shall prevail. It is the licensee's responsibility to contact the agency contact person listed on the license for clarification if needed prior to conducting any further regulated activities.

# BOAT RAMP RECONSTRUCTION CITY OF BRIDGEPORT

## DRAWING LIST

DRAWING No.	DRAWING TITLE
1	TITLE SHEET
2	VICINITY MAP
3	ASSESSOR MAP
4	EXISTING SITE PLAN
5	PROPOSED SITE PLAN
6	EXISTING SECTION A-A
7	EXISTING SECTION B-B
8	PROPOSED SECTION A-A
9	PROPOSED SECTION B-B

### GENERAL NOTES

1. THE PURPOSE OF THESE DRAWINGS ARE FOR REGULATORY REVIEW ONLY.
2. ELEVATIONS REFERENCE NORTH AMERICAN VERTICAL DATUM OF 1988 (NAVD88).
3. EXISTING SITE PLAN TAKEN FROM PLAN TITLED "RIGHT OF WAY & TOPOGRAPHIC SURVEY" PREPARED FOR THE GZA GEOENVIRONMENTAL, INC. BY READNESS & MEAD, INC., DATED 2/2/2023.
4. SUPPLEMENTAL INFORMATION OBTAINED BY GZA ENVIRONMENTAL, INC. ON 12/19/2022.
5. TIDAL INFORMATION TAKEN FROM BENCHMARK SHEET FOR BRIDGEPORT NOAA BENCHMARK

REGULATORY REVIEW ONLY  
NOT FOR CONSTRUCTION



UNLESS SPECIFICALLY STATED BY WRITTEN AGREEMENT, THIS DRAWING IS THE SOLE PROPERTY OF GZA GEOENVIRONMENTAL, INC. (GZA). THE INFORMATION SHOWN ON THE DRAWING IS SOLELY FOR USE BY GZA'S CLIENT OR THE CLIENT'S DESIGNATED REPRESENTATIVE FOR THE SPECIFIC PROJECT AND LOCATION IDENTIFIED ON THE DRAWING. THE DRAWING SHALL NOT BE TRANSFERRED, REUSED, COPIED, OR ALTERED IN ANY MANNER FOR USE AT ANY OTHER LOCATION OR FOR ANY OTHER PURPOSE WITHOUT THE PRIOR WRITTEN CONSENT OF GZA. ANY TRANSFER, REUSE, OR MODIFICATION TO THE DRAWING BY THE CLIENT OR OTHERS, WITHOUT THE PRIOR WRITTEN EXPRESS CONSENT OF GZA, WILL BE AT THE USER'S SOLE RISK AND WITHOUT ANY RISK OR LIABILITY TO GZA.

BOAT RAMP RECONSTRUCTION NEWFIELD AVE. BRIDGEPORT, CT	PREPARED BY: <b>GZA</b> GeoEnvironmental, Inc. Engineers and Scientists www.gza.com		PREPARED FOR: CITY OF BRIDGEPORT 45 LYON TERRACE BRIDGEPORT, CT 06604	
	PROJ MGR: MTT	REVIEWED BY: DDF	CHECKED BY: RJM	DWG
TITLE SHEET	DESIGNED BY: MTT	DRAWN BY: MTT	SCALE: N/A	1
	DATE: MARCH 2024	PROJECT NO. 05.0047089.00	REVISION NO. 1	
				SHEET NO. 1 OF 9



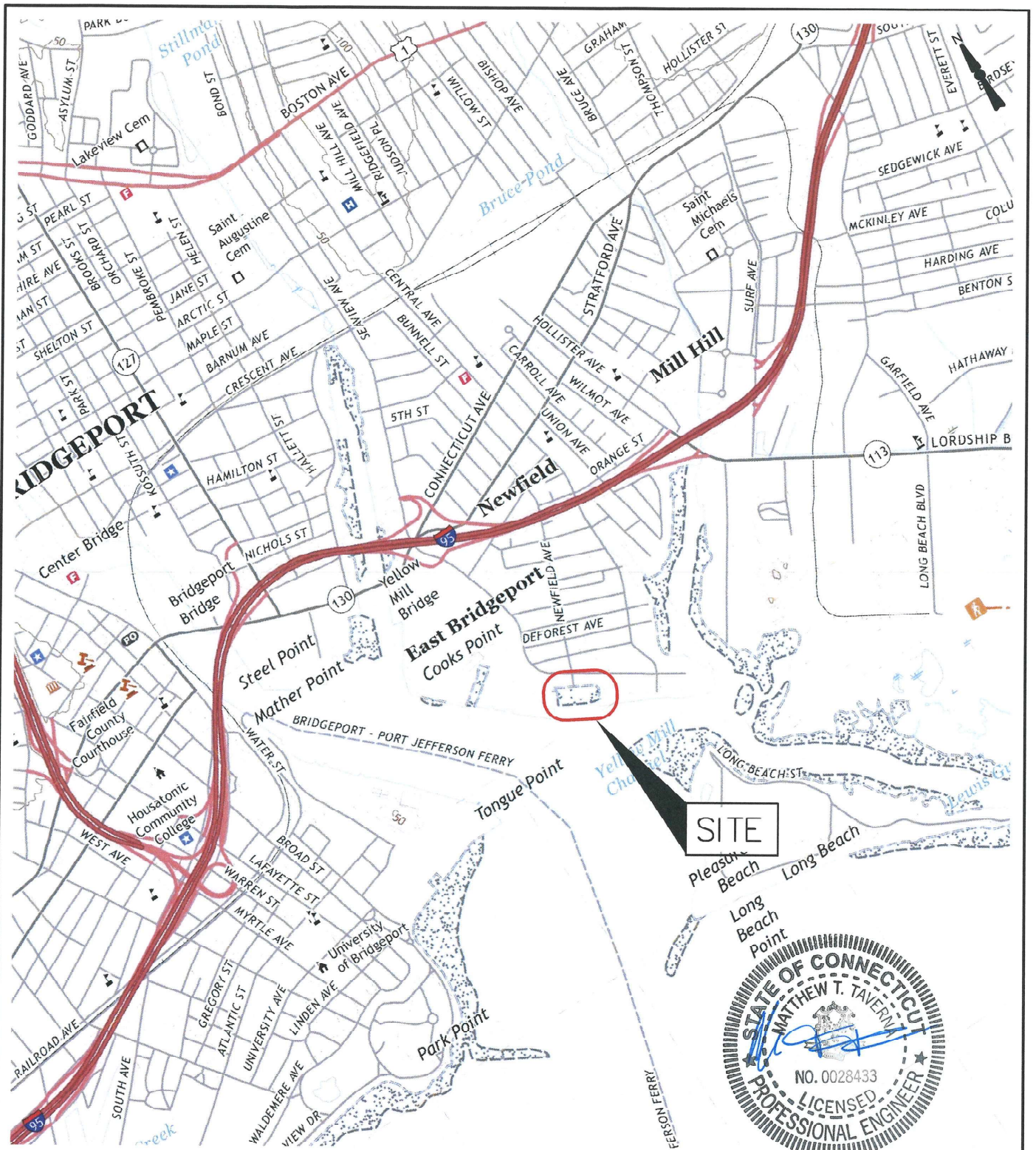

REGULATORY REVIEW ONLY  
NOT FOR CONSTRUCTION

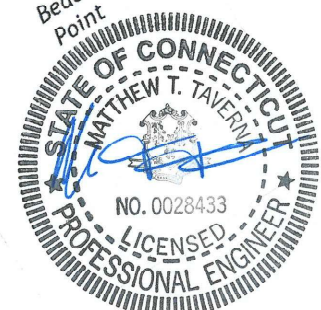

UNLESS SPECIFICALLY STATED BY WRITTEN AGREEMENT, THIS DRAWING IS THE SOLE PROPERTY OF GZA GEOENVIRONMENTAL, INC. (GZA). THE INFORMATION SHOWN ON THE DRAWING IS SOLELY FOR USE BY GZA'S CLIENT OR THE CLIENT'S DESIGNATED REPRESENTATIVE FOR THE SPECIFIC PROJECT AND LOCATION IDENTIFIED ON THE DRAWING. THE DRAWING SHALL NOT BE TRANSFERRED, REUSED, COPIED, OR ALTERED IN ANY MANNER FOR USE AT ANY OTHER LOCATION OR FOR ANY OTHER PURPOSE WITHOUT THE PRIOR WRITTEN CONSENT OF GZA. ANY TRANSFER, REUSE, OR MODIFICATION TO THE DRAWING BY THE CLIENT OR OTHERS, WITHOUT THE PRIOR WRITTEN EXPRESS CONSENT OF GZA, WILL BE AT THE USER'S SOLE RISK AND WITHOUT ANY RISK OR LIABILITY TO GZA.

BOAT RAMP RECONSTRUCTION  
NEWFIELD AVE.  
BRIDGEPORT, CT

VICINITY MAP

PREPARED BY: <b>GZA</b> GeoEnvironmental, Inc. Engineers and Scientists www.gza.com		PREPARED FOR: CITY OF BRIDGEPORT 45 LYON TERRACE BRIDGEPORT, CT 06604	
PROJ MGR: MTT	REVIEWED BY: DDF	CHECKED BY: RJM	DWG
DESIGNED BY: MTT	DRAWN BY: MTT	SCALE: 1" = 2000'	2
DATE: MARCH 2024	PROJECT NO. 05.0047089.00	REVISION NO. 1	SHEET NO. 2 OF 9



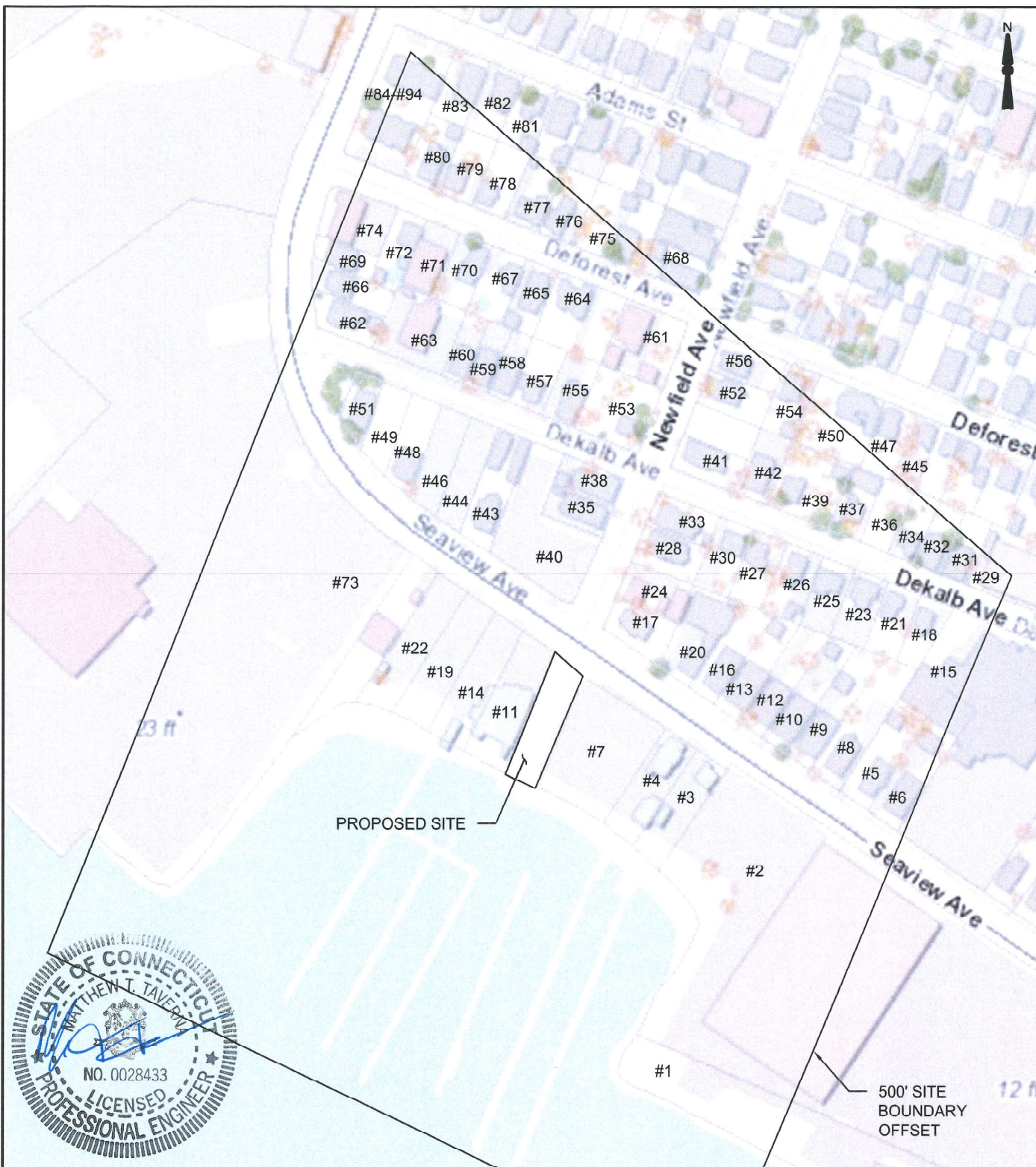

REGULATORY REVIEW ONLY  
NOT FOR CONSTRUCTION

**NOTE:**  
SEE ATTACHMENT 3 FOR  
ADDRESSES CORRESPONDING  
TO NUMBERED PARCELS

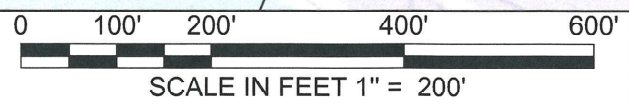

UNLESS SPECIFICALLY STATED BY WRITTEN AGREEMENT, THIS DRAWING IS THE SOLE PROPERTY OF GZA  
GEOENVIRONMENTAL, INC. (GZA). THE INFORMATION SHOWN ON THE DRAWING IS SOLELY FOR USE BY GZA'S  
CLIENT OR THE CLIENT'S DESIGNATED REPRESENTATIVE FOR THE SPECIFIC PROJECT AND LOCATION IDENTIFIED ON  
THE DRAWING. THE DRAWING SHALL NOT BE TRANSFERRED, REUSED, COPIED, OR ALTERED IN ANY MANNER FOR  
USE AT ANY OTHER LOCATION OR FOR ANY OTHER PURPOSE WITHOUT THE PRIOR WRITTEN CONSENT OF GZA. ANY  
TRANSFER, REUSE, OR MODIFICATION TO THE DRAWING BY THE CLIENT OR OTHERS, WITHOUT THE PRIOR WRITTEN  
EXPRESS CONSENT OF GZA, WILL BE AT THE USER'S SOLE RISK AND WITHOUT ANY RISK OR LIABILITY TO GZA.

NO.	ISSUE/DESCRIPTION			BY	DATE
PREPARED BY:		GZA GeoEnvironmental, Inc. Engineers and Scientists www.gza.com		PREPARED FOR: CITY OF BRIDGEPORT 45 LYON TERRACE BRIDGEPORT, CT 06604	
PROJ MGR: MTT		REVIEWED BY: DDF		CHECKED BY: RJM	
DESIGNED BY: MTT		DRAWN BY: MTT		SCALE: 1" = 200'	
DATE: MARCH 2024		PROJECT NO. 05.0047089.00		REVISION NO. 1	
				DWG 3	
				SHEET NO. 3 OF 9	

BOAT RAMP RECONSTRUCTION  
NEWFIELD AVE.  
BRIDGEPORT, CT

**ASSESSOR MAP**

© 2023 - GZA GeoEnvironmental, Inc.



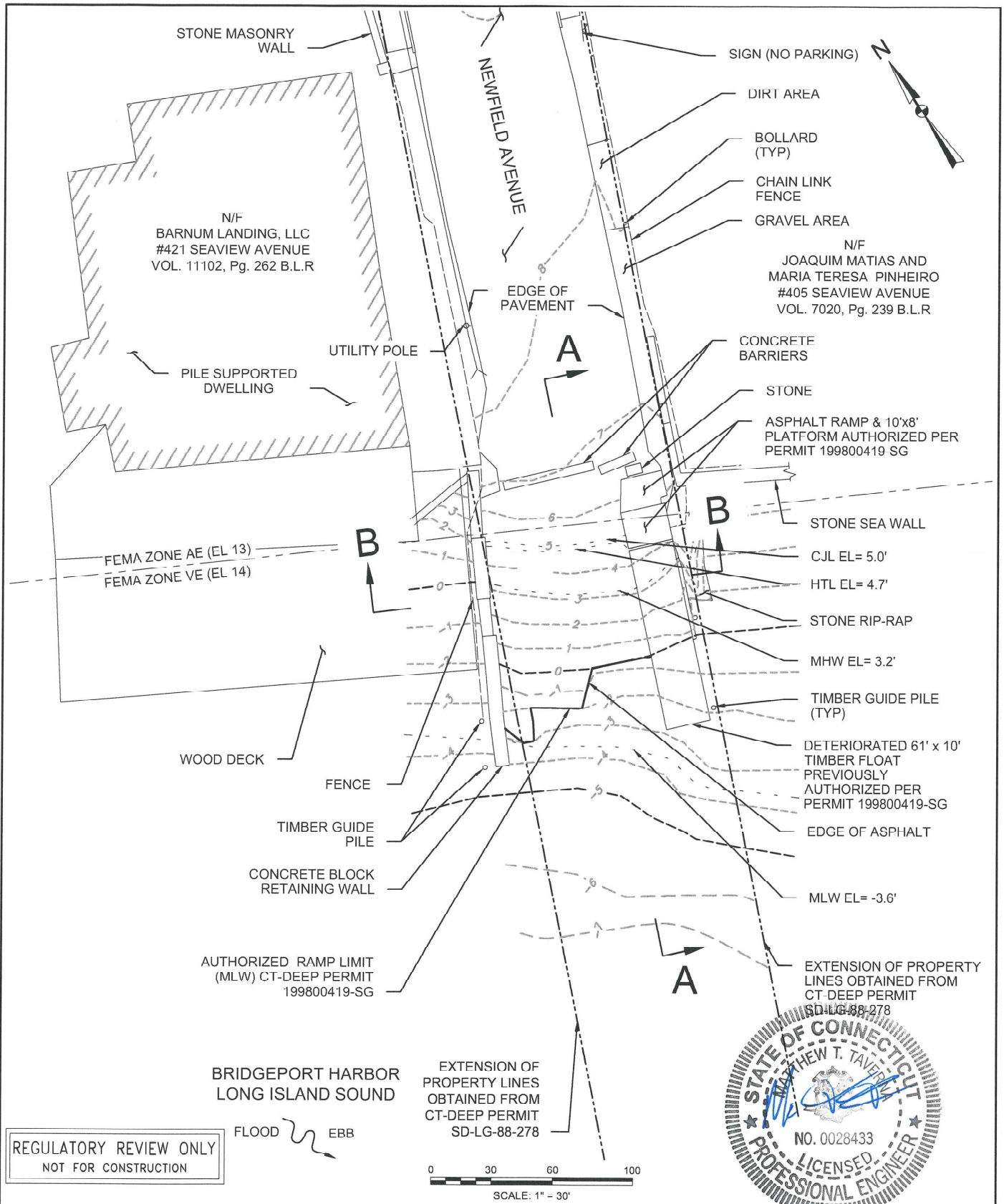

© 2023 - GZA GeoEnvironmental, Inc.

UNLESS SPECIFICALLY STATED BY WRITTEN AGREEMENT, THIS DRAWING IS THE SOLE PROPERTY OF GZA GEOTECHNICAL, INC. (GZA). THE INFORMATION SHOWN ON THE DRAWING IS SOLELY FOR USE BY GZA'S CLIENT OR THE CLIENT'S DESIGNATED REPRESENTATIVE FOR THE SPECIFIC PROJECT AND LOCATION IDENTIFIED ON THE DRAWING. THE DRAWING SHALL NOT BE TRANSFERRED, REUSED, COPIED, OR ALTERED IN ANY MANNER FOR USE AT ANY OTHER LOCATION OR FOR ANY OTHER PURPOSE WITHOUT THE PRIOR WRITTEN CONSENT OF GZA. ANY TRANSFER, REUSE, OR MODIFICATION TO THIS DRAWING BY THE CLIENT OR OTHERS, WITHOUT THE PRIOR WRITTEN EXPRESS CONSENT OF GZA, WILL BE AT THE USER'S SOLE RISK AND WITHOUT ANY RISK OR LIABILITY TO GZA.

BOAT RAMP RECONSTRUCTION NEWFIELD AVE. BRIDGEPORT, CT		PREPARED BY: <b>GZA</b> GeoEnvironmental, Inc. Engineers and Scientists www.gza.com		PREPARED FOR: CITY OF BRIDGEPORT 45 LYON TERRACE BRIDGEPORT, CT 06604	
PROJ MGR: MTT		REVIEWED BY: DDF		CHECKED BY: RJM	
DESIGNED BY: MTT		DRAWN BY: RDS		SCALE: 1" = 30'	
DATE: MARCH 2024		PROJECT NO. 05.0047089.00		REVISION NO. 1	
DWG 4		SHEET NO. 4 OF 9			

EXISTING SITE PLAN





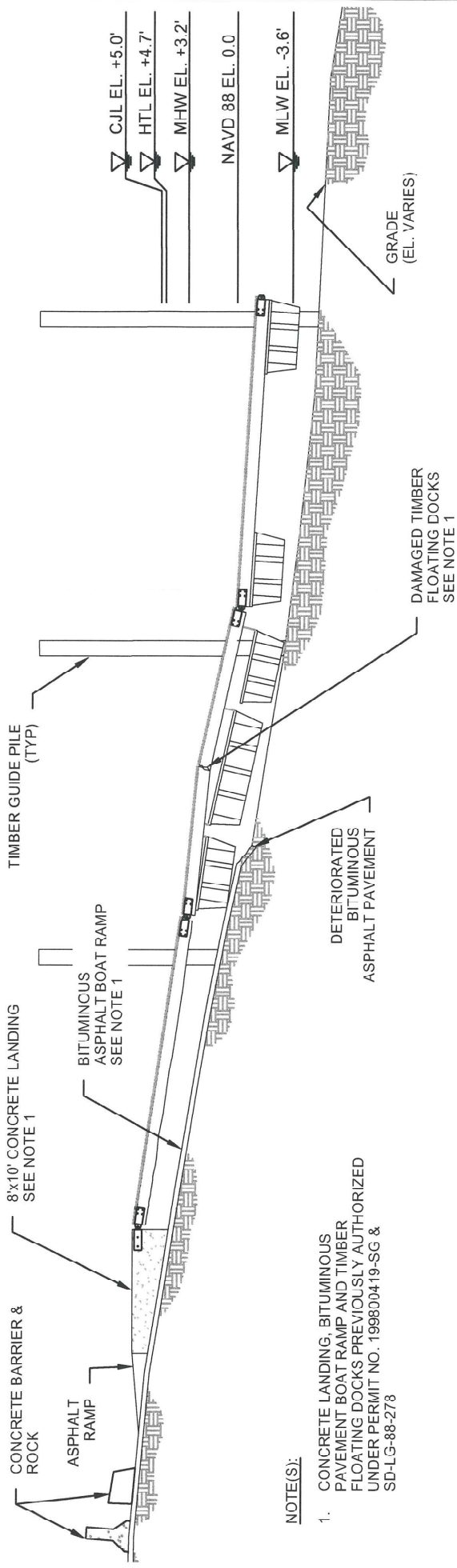

EXISTING SECTION - A-A  
SCALE: 1" = 10'

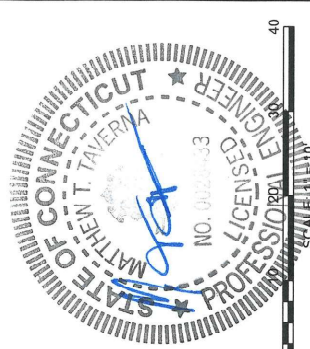

REGULATORY REVIEW ONLY  
NOT FOR CONSTRUCTION

NO.		ISSUE/DESCRIPTION	BY	DATE
UNLESS SPECIFICALLY STATED BY WRITTEN AGREEMENT, THIS DRAWING IS THE SOLE PROPERTY OF GZA GEOENVIRONMENTAL, INC. (GZA). THE INFORMATION SHOWN ON THE DRAWING IS SOLELY FOR USE BY GZA'S CLIENT OR THE CLIENT'S DESIGNATED REPRESENTATIVE FOR THE SPECIFIC PROJECT AND LOCATION IDENTIFIED ON THE DRAWING. THE DRAWING SHALL NOT BE TRANSFERRED, REUSED, REPRODUCED, COPIED, OR OTHERWISE TRANSMITTED IN ANY FORM OR BY ANY MEANS, WITHOUT THE PRIOR WRITTEN CONSENT OF GZA. ANY TRANSMISSION OF THIS DRAWING TO THE CLIENT OR OTHERS, WITHOUT THE PRIOR WRITTEN EXPRESS CONSENT OF GZA, WILL BE AT THE USER'S SOLE RISK AND WITHOUT ANY RISK OR LIABILITY TO GZA.				
BOAT RAMP RECONSTRUCTION NEWFIELD AVE. BRIDGEPORT, CT				
PREPARED BY: GZA GeoEnvironmental, Inc. www.gza.com				
PROJ. MGR: MTT    REVIEWED BY: DDF    DESIGNED BY: MTT    DRAWN BY: ZJT    DATE: MARCH 2024				
CHECKED BY: RJM    SCALE: 1" = 10'    REVISION NO. 1    DWG 6    SHEET NO. 6 OF 9				
EXISTING SECTION A-A				
PROJECT NO. 05 0047089.00				

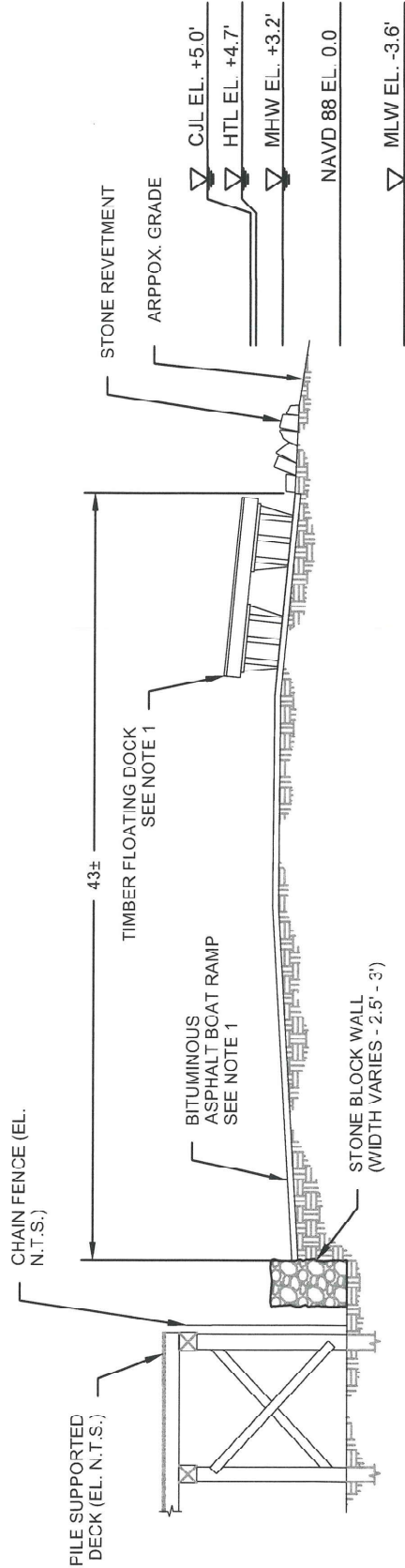

EXISTING SECTION - B-B

NOTE(S):

1. BITUMINOUS PAVEMENT BOAT RAMP AND TIMBER FLOATING DOCKS PREVIOUSLY AUTHORIZED UNDER PERMIT NO. 199800419-SG & SD-LG-88-278

REGULATORY REVIEW ONLY  
NOT FOR CONSTRUCTION

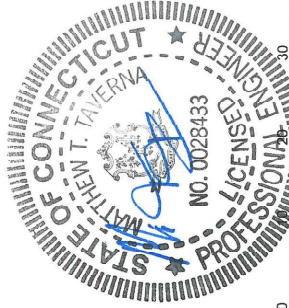

PREPARED BY: <b>GZA</b> GeoEnvironmental, Inc. Engineers and Scientists www.gza.com		CITY OF BRIDGEPORT 46 LYON TERRACE BRIDGEPORT, CT 06604	
PROJ. MGR:	MTT	REVIEWED BY:	DDF
DESIGNED BY:	MTT	DRAWN BY:	ZJT
DATE:	MARCH 2024	PROJECT NO.	05 0047089.00
BOAT RAMP RECONSTRUCTION NEWFIELD AVE. BRIDGEPORT, CT		CHECKED BY:	RJM
EXISTING SECTION B-B		SCALE	1" = 10'
		REVISION NO.	1
		DWG	7
		SHEET NO.	7 OF 9

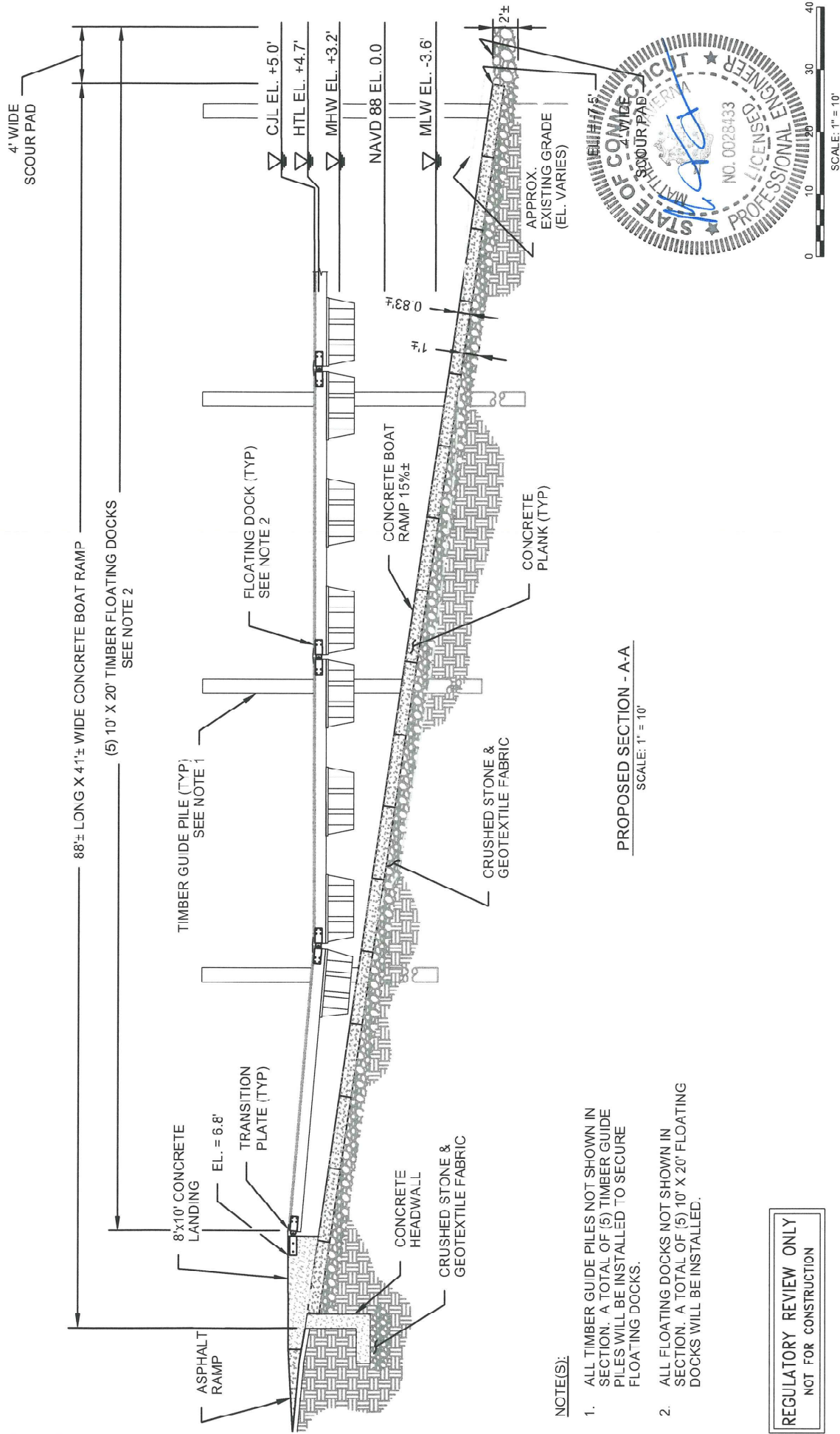

NOTE(S):

1. ALL TIMBER GUIDE PILES NOT SHOWN IN SECTION. A TOTAL OF (5) 10' X 20' TIMBER GUIDE PILES WILL BE INSTALLED TO SECURE FLOATING DOCKS.
2. ALL FLOATING DOCKS NOT SHOWN IN SECTION. A TOTAL OF (5) 10' X 20' FLOATING DOCKS WILL BE INSTALLED.

REGULATORY REVIEW ONLY  
NOT FOR CONSTRUCTION

ISSUE/DESCRIPTION		NO.	BY	DATE
BOAT RAMP RECONSTRUCTION NEWFIELD AVE. BRIDGEPORT, CT				
PREPARED BY: GZA GeoEnvironmental, Inc. Engineers and Scientists www.gza.com		CITY OF BRIDGEPORT 46 LYON TERRACE BRIDGEPORT, CT 06604		
PROJ. MGR: MTT		REVIEWED BY: DDF		CHECKED BY: R.M
DESIGNED BY: MTT		DRAWN BY: ZJT		SCALE: 1" = 10'
DATE: MARCH 2024		PROJECT NO. 05.004.7089.00		REVISION NO. 1
PROPOSED SECTION A-A		DWG		8
		SHEET NO		8 OF 9



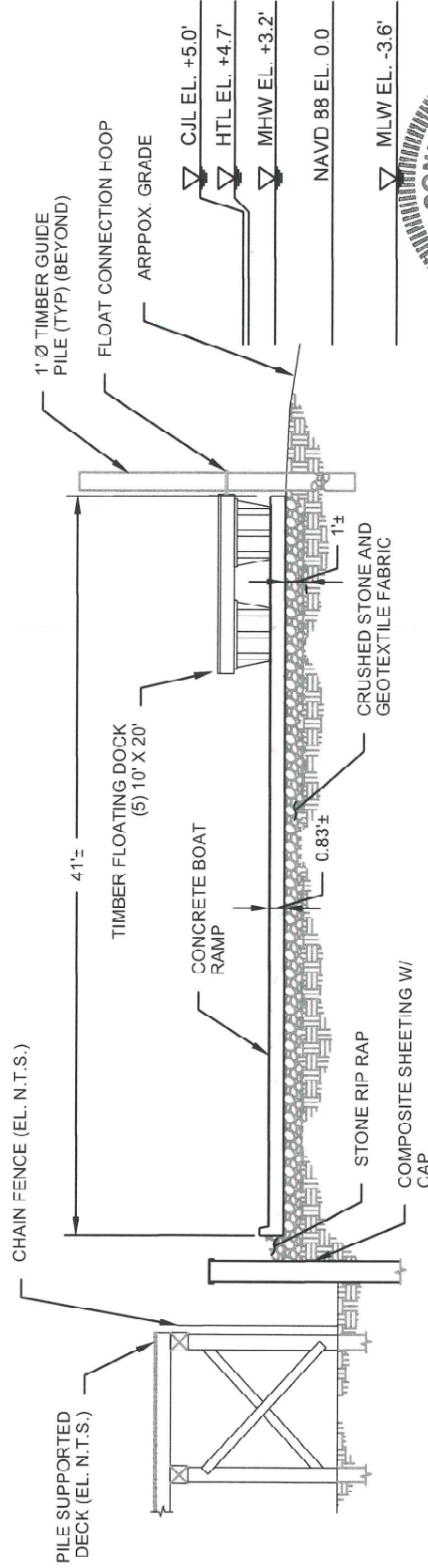

PROPOSED SECTION - B-B

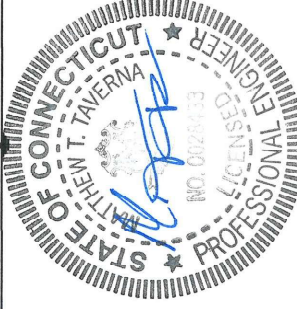

REGULATORY REVIEW ONLY  
NOT FOR CONSTRUCTION

--	--	--	--	--	--	--	--	--	--	--	--	--	--	--	--	--	--	--	--	--	--	--	--	--	--	--	--	--	--	--	--	--	--	--	--	--	--	--	--	--	--	--	--	--	--	--	--	--	--	--	--	--	--	--	--	--	--	--	--	--	--	--	--	--	--	--	--	--	--	--	--	--	--	--	--	--	--	--	--	--	--	--	--	--	--	--	--	--	--	--	--	--	--	--	--	--	--	--	--	--	--	--	--	--	--	--	--	--	--	--	--	--	--	--	--	--	--	--	--	--	--	--	--	--	--	--	--	--	--	--	--	--	--	--	--	--	--	--	--	--	--	--	--	--	--	--	--	--	--	--	--	--	--	--	--	--	--	--	--	--	--	--	--	--	--	--	--	--	--	--	--	--	--	--	--	--	--	--	--	--	--	--	--	--	--	--	--	--	--	--	--	--	--	--	--	--	--	--	--	--	--	--	--	--	--	--	--	--	--	--	--	--	--	--	--	--	--	--	--	--	--	--	--	--	--	--	--	--	--	--	--	--	--	--	--	--	--	--	--	--	--	--	--	--	--	--	--	--	--	--	--	--	--	--	--	--	--	--	--	--	--	--	--	--	--	--	--	--	--	--	--	--	--	--	--	--	--	--	--	--	--	--	--	--	--	--	--	--	--	--	--	--	--	--	--	--	--	--	--	--	--	--	--	--	--	--	--	--	--	--	--	--	--	--	--	--	--	--	--	--	--	--	--	--	--	--	--	--	--	--	--	--	--	--	--	--	--	--	--	--	--	--	--	--	--	--	--	--	--	--	--	--	--	--	--	--	--	--	--	--	--	--	--	--	--	--	--	--	--	--	--	--	--	--	--	--	--	--	--	--	--	--	--	--	--	--	--	--	--	--	--	--	--	--	--	--	--	--	--	--	--	--	--	--	--	--	--	--	--	--	--	--	--	--	--	--	--	--	--	--	--	--	--	--	--	--	--	--	--	--	--	--	--	--	--	--	--	--	--	--	--	--	--	--	--	--	--	--	--	--	--	--	--	--	--	--	--	--	--	--	--	--	--	--	--	--	--	--	--	--	--	--	--	--	--	--	--	--	--	--	--	--	--	--	--	--	--	--	--	--	--	--	--	--	--	--	--	--	--	--	--	--	--	--	--	--	--	--	--	--	--	--	--	--	--	--	--	--	--	--	--	--	--	--	--	--	--	--	--	--	--	--	--	--	--	--	--	--	--	--	--	--	--	--	--	--	--	--	--	--	--	--	--	--	--	--	--	--	--	--	--	--	--	--	--	--	--	--	--	--	--	--	--	--	--	--	--	--	--	--	--	--	--	--	--	--	--	--	--	--	--	--	--	--	--	--	--	--	--	--	--	--	--	--	--	--	--	--	--	--	--	--	--	--	--	--	--	--	--	--	--	--	--	--	--	--	--	--	--	--	--	--	--	--	--	--	--	--	--	--	--	--	--	--	--	--	--	--	--	--	--	--	--	--	--	--	--	--	--	--	--	--	--	--	--	--	--	--	--	--	--	--	--	--	--	--	--	--	--	--	--	--	--	--	--	--	--	--	--	--	--	--	--	--	--	--	--	--	--	--	--	--	--	--	--	--	--	--	--	--	--	--	--	--	--	--	--	--	--	--	--	--	--	--	--	--	--	--	--	--	--	--	--	--	--	--	--	--	--	--	--	--	--	--	--	--	--	--	--	--	--	--	--	--	--	--	--	--	--	--	--	--	--	--	--	--	--	--	--	--	--	--	--	--	--	--	--	--	--	--	--	--	--	--	--	--	--	--	--	--	--	--	--	--	--	--	--	--	--	--	--	--	--	--	--	--	--	--	--	--	--	--	--	--	--	--	--	--	--	--	--	--	--	--	--	--	--	--	--	--	--	--	--	--	--	--	--	--	--	--	--	--	--	--	--	--	--	--	--	--	--	--	--	--	--	--	--	--	--	--	--	--	--	--	--	--	--	--	--	--	--	--	--	--	--	--	--	--	--	--	--	--	--	--	--	--	--	--	--	--	--	--	--	--	--	--	--	--	--	--	--	--	--	--	--	--	--	--	--	--	--	--	--	--	--	--	--	--	--	--	--	--	--	--	--	--	--	--	--	--	--	--	--	--	--	--	--	--	--	--	--	--	--	--	--	--	--	--	--	--	--	--	--	--	--	--	--	--	--	--	--	--	--	--	--	--	--	--	--	--	--	--	--	--	--	--	--	--	--	--	--	--	--	--	--	--	--	--	--	--	--	--	--	--	--	--	--	--	--	--	--	--	--	--	--	--	--	--	--	--	--	--	--	--	--	--	--	--	--	--	--	--	--	--	--	--	--	--	--	--	--	--	--	--	--	--	--	--	--	--	--	--	--	--	--	--	--	--	--	--	--	--	--	--	--	--	--	--	--	--	--	--	--	--	--	--	--	--	--	--	--	--	--	--	--	--	--	--	--	--	--	--	--	--	--	--	--	--	--	--	--	--	--	--	--	--	--	--	--	--	--	--	--	--	--	--	--	--	--	--	--	--	--	--	--	--	--	--	--	--	--	--	--	--	--	--	--	--	--	--	--	--	--	--	--	--	--	--	--	--	--	--	--	--	--	--	--	--	--	--	--	--	--	--	--	--	--	--	--	--	--	--	--	--	--	--	--	--	--

**Land Record Filing\***

**To:** DO NOT FILE

**Signature and**

**NOTE: Due to the electronic delivery of this license and the legal requirement to have a live signature on this document, the “Land Record Filing” as detailed in General Condition #1 will be sent to the Licensee via U.S. Mail for the Licensee to file with the city/town clerk.**

**Date:**

**Subject:** \_\_\_\_\_  
License # \_\_\_\_\_

If you have any questions pertaining to this matter, please contact the Land & Water Resources Division at 860-424-3019.

~~Return to:~~

~~Land & Water Resources Division  
State of Connecticut  
Department of Energy & Environmental Protection  
79 Elm Street  
Hartford, CT 06106-5127~~

\*The Licensee shall file the Land Record Filing on the land records of the municipality in which the subject property is located not later than thirty (30) days after license issuance pursuant to Connecticut General Statutes (CGS) Section 22a-363g. A copy of the Notice with a stamp or other such proof of filing with the municipality shall be submitted to the Commissioner no later than sixty (60) days after license issuance.



## **LWRD Work Commencement Form**

**To:** [DEEP.LWRDRegulatory@ct.gov](mailto:DEEP.LWRDRegulatory@ct.gov) or  
Regulatory Section  
Department of Energy and Environmental Protection  
Land & Water Resources Division  
79 Elm Street  
Hartford, CT 06106-5127

**Licensee Name:** City of Bridgeport  
**Municipality in which the project is occurring:** Bridgeport  
**DEEP License No(s):** 202400953-SDF

### **CONTRACTOR(s):**

# 1 Name: \_\_\_\_\_  
Address: \_\_\_\_\_  
Telephone: \_\_\_\_\_  
E-mail: \_\_\_\_\_

# 2 Name: \_\_\_\_\_  
Address: \_\_\_\_\_  
Telephone: \_\_\_\_\_  
E-mail: \_\_\_\_\_

# 3 Name: \_\_\_\_\_  
Address: \_\_\_\_\_  
Telephone: \_\_\_\_\_  
E-mail: \_\_\_\_\_

Date Contractor(s) received a copy  
of the license and approved plans: \_\_\_\_\_

EXPECTED DATE OF COMMENCEMENT OF WORK: \_\_\_\_\_

EXPECTED DATE OF COMPLETION OF WORK: \_\_\_\_\_

LICENSEE: \_\_\_\_\_  
(Signature) (Date)





## Compliance Certification Form

The following certification must be signed by the licensee working in consultation with a Connecticut-licensed design professional and must be submitted to the address indicated at the end of this form within ninety (90) days of completion of the authorized work.

<p>1. Licensee Name: <u>City of Bridgeport</u></p> <p>DEEP License Number(s): <u>202400953-SDF</u></p> <p>Municipality in which project is occurring: <u>Bridgeport</u></p>																									
<p>2. <b>Check one:</b></p> <p>(a) <input type="checkbox"/> "I certify that the final site conditions and / or structures are in general conformance with the approved site plans". Identify and describe any deviations and attach to this form.</p> <p>(b) <input type="checkbox"/> "The final site conditions and / or structures are not in general conformance with the approved site plans. The enclosed "as-built" plans note the modifications".</p>																									
<p>3. "I understand that any false statement in this certification is punishable as a criminal offence under section 53a-157b of the General Statutes and under any other applicable law."</p> <table style="width: 100%; border: none;"><tr><td style="width: 50%; border-bottom: 1px solid black; height: 20px;"></td><td style="width: 50%; border-bottom: 1px solid black; height: 20px;"></td></tr><tr><td>Signature of Licensee</td><td>Date</td></tr><tr><td colspan="2" style="border-bottom: 1px solid black; height: 20px;"></td></tr><tr><td colspan="2">Name of Licensee (print or type)</td></tr><tr><td colspan="2" style="height: 40px;"></td></tr><tr><td style="border-bottom: 1px solid black; height: 20px;"></td><td style="border-bottom: 1px solid black; height: 20px;"></td></tr><tr><td>Signature of CT-Licensed Design Professional</td><td>Date</td></tr><tr><td colspan="2" style="border-bottom: 1px solid black; height: 20px;"></td></tr><tr><td colspan="2">Name of CT-Licensed Design Professional (print or type)</td></tr><tr><td colspan="2" style="height: 40px;"></td></tr><tr><td style="border-bottom: 1px solid black; height: 20px;"></td><td style="border-bottom: 1px solid black; height: 20px;"></td></tr><tr><td>Professional License Number (if applicable)</td><td>Affix Stamp Here</td></tr></table>				Signature of Licensee	Date			Name of Licensee (print or type)						Signature of CT-Licensed Design Professional	Date			Name of CT-Licensed Design Professional (print or type)						Professional License Number (if applicable)	Affix Stamp Here
Signature of Licensee	Date																								
Name of Licensee (print or type)																									
Signature of CT-Licensed Design Professional	Date																								
Name of CT-Licensed Design Professional (print or type)																									
Professional License Number (if applicable)	Affix Stamp Here																								
<ul style="list-style-type: none"><li>As-built plans shall include: elevations or tidal datums, as applicable, and structures, including any proposed elevation views and cross sections included in the approved license plans. Such as-built plans shall be the original ones and be signed and sealed by an engineer, surveyor or architect, as applicable, who is licensed in the State of Connecticut.</li><li>The Licensee will be notified by staff of the Land and Water Resources Division (LWRD) if further compliance review is necessary. Lack of response by LWRD staff does not imply compliance.</li></ul> <p>Submit this completed form to : <a href="mailto:DEEP.LWRDRegulatory@ct.gov">DEEP.LWRDRegulatory@ct.gov</a> or <b>Regulatory Section</b> <b>Department of Energy and Environmental Protection</b> <b>Land &amp; Water Resources Division</b> <b>79 Elm Street</b> <b>Hartford, CT 06106-5127</b></p>																									