



Connecticut Department of Energy and Environmental Protection License*

Inland Wetlands & Watercourses Permit

Licensee(s): Connecticut Department of
Transportation

Licensee Address(s): 2800 Berlin Turnpike
Newington, CT 06131

License Number(s): 202403948-IW

Municipality: Mansfield

Project Description: Rehabilitation of Bridge No. 06648, Culvert Liner Installation for
infrastructure improvement

Project Address/Location: U.S. Route 6 Eastbound over Unnamed Brook

Waters: Unnamed Brook

**Authorizing CT Statute(s)
and/or Federal Law:** CGS Section 22a-36 to 45

**Applicable Regulations of
CT State Agencies:** 22a-39-1 to 15

Agency Contact: Land & Water Resources Division,
Bureau of Water Protection & Land Reuse, 860-424-3019

License Expiration: Five (5) years from the date of issuance of this license.

Project Site Plan Set: Eight (8) sheets entitled “*Environmental Permit Plans State
Project No. 0077-0244 Rehabilitation of Bridge No. 06648 U.S.
Route 6 Eastbound over Unnamed Brook*” prepared by CHA
Consulting, Inc. dated February 27, 2024.

License Enclosures: LWRD Compliance Certification Form; LWRD General
Conditions; Site Plan Set; LWRD Work Commencement Form

*Connecticut’s Uniform Administrative Procedure Act defines License to include, “*the whole or part of any agency permit, certificate, approval, registration, charter or similar form of permission required by law . . .*”

Authorized Activities:

The Licensee is hereby authorized to conduct the following work as described in application # 202403948 and as depicted on any site plan sheets / sets cited herein:

1. Clear woody vegetation and treat invasive species in accordance with plan sheets herein;
2. Install sediment and erosion control fencing and erosion control matting in accordance with site plan sheets PMT-02 & PMT-03;
3. Extend an existing 15" diameter ACCMP (asphalt coated corrugated metal pipe) approximately 20 feet in the southerly direction in accordance with site plan sheet PMT-03;
4. Install a new, intermediate rip rap outlet apron with a length of 10 feet for the extended 15" ACCMP in accordance with site plan sheet PMT-03;
5. Place fill for southern access road and grade in accordance with site plan sheet PMT-03;
6. Install temporary water handling cofferdams per site plan sheets PMT-03 & PMT-06;
7. Install a new 10'3" wide by 6'9" tall, 102'-long aluminized steel, structural pipe liner within the existing 12'4" wide by 7'9" tall, 102'-long, corrugated ACMP in the dry, including the following activities in accordance with site plan sheets herein:
 - a. Repair voids in the existing corrugated ACMP (PMT-03, PMT-05);
 - b. Install temporary 54" bypass pipe for dewatering within the existing pipe or temporary pump (PMT-06);
 - c. Install the new aluminized steel, structural pipe liner and slip-line grout, via pressure grouting, to the annular space between the liner and existing pipe;
 - d. Install corner angle metal baffles throughout the length of the culvert, spaced 14 feet apart (PMT-05);
8. Remove temporary cofferdams, water handling facilities and bypass pipe or pump;
9. Install 6" of granular fill, 18" of Intermediate rip rap, and 12" of natural streambed material at the outlet to form a scour pool, of approximate bank full width and 16 feet length, in accordance with site plan sheets PMT-03 & PMT-07;
10. Install a cross-vane rock weir spanning bank full width by placement of rounded boulders ranging 1' to 1'6" in diameter in accordance with site plan sheets PMT-03 & PMT-07;
11. Grade and seed in accordance with site plan sheet PMT-08.

Failure to comply with the terms and conditions of this license shall subject the Licensee and / or the Licensee's contractor(s) to enforcement actions and penalties as provided by law.

This license is subject to the following Terms and Conditions:

1. **License Enclosure(s) and Conditions.** The Licensee shall comply with all applicable terms and conditions as may be stipulated within the License Enclosure(s) listed above.
2. **Sediment Control Barriers.** The Project Proponent shall install a minimum of two rows of sediment control barriers between any disturbance area and any downgradient wetland

and/or watercourse. The closest face of any barrier system shall be installed at a distance no greater than 50 feet from the delineated boundary of any wetland and/or watercourse in the upgradient direction.

3. DEEP Fisheries Protections.

- a. **Bypass Pumping.** If bypass pumping is proposed, sizing and screen specifications will be submitted to DEEP Fisheries for approval prior to use during construction.
- b. **Rock Weir.** The Licensee shall notify DEEP Fisheries staff at least 10 business days prior to weir installation to confirm the date of installation and ensure the presence of DEEP Fisheries staff during such installation. The Licensee shall install the fishery enhancements as shown on plan sheet PMT-07, subject to any field modifications as directed by DEEP Fisheries Division staff. A description of any such field directed modification to the fishery enhancement plan shall be submitted to the Land and Water Resources Division within one week of completion.

Issued under the authority of the Commissioner of Energy and Environmental Protection on:

Date

Emma Cimino
Deputy Commissioner
Environmental Quality Branch



LWRD General Conditions

- 1. Land Record Filing (for *Structures Dredging & Fill, Tidal Wetlands, Certificate of Permission, and Long Island Sound General Permit Licenses only*).** The Licensee shall file the Land Record Filing on the land records of the municipality in which the subject property is located not later than thirty (30) days after license issuance pursuant to Connecticut General Statutes (CGS) Section 22a-363g. A copy of the Notice with a stamp or other such proof of filing with the municipality shall be submitted to DEEP.LWRDRegulatory@ct.gov no later than sixty (60) days after license issuance. If a Land Record Filing form is not enclosed and the work site is not associated with an upland property, no filing is required.
- 2. Contractor Notification.** The Licensee shall give a copy of the license and its attachments to the contractor(s) who will be carrying out the authorized activities prior to the start of construction and shall receive a written receipt for such copy, signed and dated by such contractor(s). The Licensee's contractor(s) shall conduct all operations at the site in full compliance with the license and, to the extent provided by law, may be held liable for any violation of the terms and conditions of the license. At the work site, the contractor(s) shall, whenever work is being performed, have on site and make available for inspection a copy of the license and the authorized plans.
- 3. Work Commencement¹.** Not later than two (2) weeks prior to the commencement of any work authorized herein, the Licensee shall submit to DEEP.LWRDRegulatory@ct.gov, on the Work Commencement Form attached hereto, the name(s) and address(es) of all contractor(s) employed to conduct such work and the expected date for commencement and completion of such work, if any.
 - For water diversion activities authorized pursuant to 22a-377(c)-1 of the Regulations of Connecticut State Agencies, the Licensee shall also notify the Commissioner in writing two weeks prior to initiating the authorized diversion.
 - For emergency activities authorized pursuant Connecticut General Statutes Section 22a-6k, the Licensee shall notify the Commissioner, in writing, of activity commencement at least one (1) day prior to construction and of activity completion no later than five (5) days after conclusion.
- 4. For Coastal Licenses Only - License Notice.** The Licensee shall post the first page of the License in a conspicuous place at the work area while the work authorized therein is undertaken.
- 5. Unauthorized Activities.** Except as specifically authorized, no equipment or material, including but not limited to, fill, construction materials, excavated material or debris, shall be deposited, placed or stored in any wetland or watercourse on or off-site. The Licensee may not

¹ The Work Commencement condition and the need for a Work Commencement Form is not applicable to Flood Management Certification approvals.

conduct work within wetlands or watercourses other than as specifically authorized, unless otherwise authorized in writing by the Commissioner. Tidal wetlands means “wetland” as defined by section 22a-29 and “freshwater wetlands and watercourses” means “wetlands” and “watercourses” as defined by section 22a-38.

- 6. Management of Materials.** Any materials removed from the site shall be managed in accordance with all federal, state, and local requirements, including Chapter 446K Water Pollution Control, Chapter 445 Hazardous Waste, and Chapter 446d Solid Waste of the Connecticut General Statutes.
- 7. Unconfined Instream Work.** Unless otherwise noted in a condition of the license, the following conditions apply to projects in non-coastal waters:
 - Unconfined instream work is limited to the period June 1 through September 30.
 - Confinement of a work area by cofferdam techniques using sand bag placement, sheet pile installation (vibratory method only), portadam, or similar confinement devices is allowed any time of the year. The removal of such confinement devices is allowed any time of the year.
 - Once a work area has been confined, in-water work within the confined area is allowed any time of the year.
 - The confinement technique used shall completely isolate and protect the confined area from all flowing water. The use of silt boom/curtain or similar technique as a means for confinement is prohibited.
- 8. For State Actions Only - Material or Equipment Storage in the Floodplain.** Unless approved by a Flood Management Exemption, the storage of any materials at the site which are buoyant, hazardous, flammable, explosive, soluble, expansive, radioactive, or which could in the event of a flood be injurious to human, animal or plant life, below the elevation of the five-hundred (500) year flood is prohibited. Any other material or equipment stored at the site below said elevation by the Licensee or the Licensee's contractor must be firmly anchored, restrained or enclosed to prevent flotation. The quantity of fuel stored below such elevation for equipment used at the site shall not exceed the quantity of fuel that is expected to be used by such equipment in one day. In accordance with the licensee's Flood Contingency Plan, the Licensee shall remove equipment and materials from the floodplain during periods when flood warnings have been issued or are anticipated by a responsible federal, state or local agency. It shall be the Licensee's responsibility to obtain such warnings when flooding is anticipated.
- 9. Temporary Hydraulic Facilities for Water Handling.** If not reviewed and approved as a part of the license application, temporary hydraulic facilities shall be designed by a qualified professional and in accordance with the *Connecticut Guidelines for Soil Erosion and Sediment Control*, the *2004 Connecticut Stormwater Quality Manual*, or the *Department of Transportation's ConnDOT Drainage Manual*, as applicable. Temporary hydraulic facilities may include channels, culverts or bridges which are required for haul roads, channel relocations, culvert installations, bridge construction, temporary roads, or detours.
- 10. Excavated Materials.** Unless otherwise authorized, all excavated material shall be staged and

managed in a manner which prevents additional impacts to wetlands and watercourses.

- 11. Best Management Practices.** The Licensee shall not cause or allow pollution of any wetlands or watercourses, including pollution resulting from sedimentation and erosion. In constructing or maintaining any authorized structure or facility or conducting any authorized activity, or in removing any such structure or facility, the Licensee shall employ best management practices to control storm water discharges, to prevent erosion and sedimentation, and to otherwise prevent pollution of wetlands and other waters of the State. For purposes of the license, “pollution” means “pollution” as that term is defined by CGS section 22a-423. Best Management Practices include, but are not limited, to practices identified in the *Connecticut Guidelines for Soil Erosion and Sediment Control* as revised, *2004 Connecticut Stormwater Quality Manual*, Department of Transportation’s *ConnDOT Drainage Manual* as revised, and the Department of Transportation Standard Specifications as revised.
- 12. In-Water Work Vessel Staging and Storage. (for Structures Dredging & Fill, Tidal Wetlands, Certificate of Permission, and Long Island Sound General Permit Licenses only).** For any barge, vessel, skiff or floating work platform (“work vessels”) utilized in the execution of the work authorized herein, the Licensee shall ensure that such work vessels:

 - do not rest on, or come in contact with, the substrate at any time, unless specifically authorized in the license.
 - are not stored over intertidal flats, submerged aquatic vegetation or tidal wetland vegetation or in a location that interferes with navigation. In the event any work vessel is grounded, no dragging or prop dredging shall occur to free it.
- 13. Work Site Restoration.** Upon completion of any authorized work, the Licensee shall restore all areas temporarily impacted by construction, or used as a staging area or accessway in connection with such work, to their condition prior to the commencement of such work.
- 14. Inspection.** The Licensee shall allow any representative of the Commissioner to inspect the project location at reasonable times to ensure that work is being or has been conducted in accordance with the terms and conditions of this license.
- 15. Change of Use. (Applies only if a use is specified within the License “Project Description”)**

 - a. The work specified in the license is authorized solely for the purpose set forth in the license. No change in purpose or use of the authorized work or facilities as set forth in the license may occur without the prior written approval of the Commissioner. The Licensee shall, prior to undertaking or allowing any change in use or purpose from that which is authorized by this license, request permission from the Commissioner for such change. Said request shall be in writing and shall describe the proposed change and the reason for the change.
 - b. A change in the form of ownership of any structure authorized herein from a rental/lease commercial marina to a wholly-owned common interest community or dockominium may constitute a change in purpose as specified in paragraph (a) above.
- 16. De Minimis Alteration.** The Licensee shall not deviate from the authorized activity without prior written approval from the Commissioner. The Licensee may request a de minimis change

to any authorized structure, facility, or activity. A de minimis alteration means a change in the authorized design, construction or operation that individually and cumulatively has minimal additional environmental impact and does not substantively alter the project as authorized.

- For diversion activities authorized pursuant to 22a-377(c)-2 of the Regulations of Connecticut State Agencies, a de minimis alteration means an alteration which does not significantly increase the quantity of water diverted or significantly change the capacity to divert water.

17. Extension Request. The Licensee may request an extension of the license expiration date. Such request shall be in writing and shall be submitted to DEEP.LWRDRegulatory@ct.gov at least thirty (30) days prior to the license expiration. Such request shall describe the work done to date, what work still needs to be completed, and the reason for such extension. The Commissioner may extend the expiration date of this license for a period of up to one year, in order for the Licensee to complete the authorized activities. It shall be at the Commissioner's sole discretion to grant or deny such request. No more than three (3) one-year extensions will be granted under this license.

18. Compliance Certification². Not later than 90 days after completion of the authorized work, the Licensee shall prepare and submit to DEEP.LWRDRegulatory@ct.gov, the attached Compliance Certification Form. Such Compliance Certification shall be completed, signed, and sealed by the Licensee and a Connecticut Licensed Design Professional. If non-compliance is indicated on the form, or the Commissioner has reason to believe the activities and/or structures were conducted in non-compliance with the license, the Commissioner may require the Licensee to submit as-built plans as a condition of this license.

19. Maintenance. The Licensee shall maintain all authorized structures or work in optimal condition or shall remove such structures or facility and restore the affected waters to their pre-work condition. Any such maintenance or removal activity shall be conducted in accordance with applicable law and any additional approvals required by law.

20. No Work After License Expiration. Work conducted after the license expiration date is a violation of the license and may subject the licensee to enforcement action, including penalties, as provided by law.

21. License Transfer. The license is not transferable without prior written authorization of the Commissioner. A request to transfer a license shall be submitted in writing and shall describe the proposed transfer and the reason for such transfer. The Licensee's obligations under the license shall not be affected by the passage of title to the license site to any other person or municipality until such time as a transfer is approved by the Commissioner.

22. Document Submission. Any document required to be submitted to the Commissioner under the license or any contact required to be made with the Commissioner shall, unless otherwise specified in writing by the Commissioner, be directed to:

DEEP.LWRDRegulatory@ct.gov or

² The Work Commencement condition and the need for a Work Commencement Form is not applicable to Flood Management Certification approvals.

Regulatory Section
Land & Water Resources Division
Department of Energy and Environmental Protection
79 Elm Street
Hartford, Connecticut 06106-5127
860-424-3019

- 23. Date of Document Submission.** The date of submission to the Commissioner of any document required by the license shall be the date such document is received by the Commissioner. The date of any notice by the Commissioner under the license, including but not limited to notice of approval or disapproval of any document or other action, shall be the date such notice is personally delivered or the date three (3) days after it is mailed by the Commissioner, whichever is earlier. Except as otherwise specified in the license, the word “day” as used in the license means calendar day. Any document or action which is required by the license to be submitted or performed by a date which falls on a Saturday, Sunday or a Connecticut or federal holiday shall be submitted or performed on or before the next day which is not a Saturday, Sunday, or a Connecticut or federal holiday.
- 24. Certification of Documents.** Any document, including but not limited to any notice, which is required to be submitted to the Commissioner under the license shall be signed by the Licensee and by the individual or individuals responsible for actually preparing such document, each of whom shall certify in writing as follows: “I have personally examined and am familiar with the information submitted in this document and all attachments and certify that based on reasonable investigation, including my inquiry of those individuals responsible for obtaining the information, the submitted information is true, accurate and complete to the best of my knowledge and belief, and I understand that any false statement made in this document or its attachments may be punishable as a criminal offense.”
- 25. Accuracy of Documentation.** In evaluating the application for the license, the Commissioner has relied on information and data provided by the Licensee and on the Licensee’s representations concerning site conditions, design specifications and the proposed work, including but not limited to representations concerning the commercial, public or private nature of the work or structures, the water-dependency of said work or structures, its availability for access by the general public, and the ownership of regulated structures or filled areas. If such information proves to be false, deceptive, incomplete or inaccurate, the license may be modified, suspended or revoked, and any unauthorized activities may be subject to enforcement action.
- 26. Limits of Liability.** In granting the license, the Commissioner has relied on all representations of the Licensee, including information and data provided in support of the Licensee’s application. Neither the Licensee’s representations nor the issuance of the license shall constitute an assurance by the Commissioner as to the structural integrity, the engineering feasibility or the efficacy of such design.
- 27. Reporting of Violations.** In the event that the Licensee becomes aware that they did not or may not comply, or did not or may not comply on time, with any provision of this license or

of any document incorporated into the license, the Licensee shall immediately notify the agency contact specified within the license and shall take all reasonable steps to ensure that any noncompliance or delay is avoided or, if unavoidable, is minimized to the greatest extent possible. In so notifying the agency contact, the Licensee shall provide, for the agency's review and written approval, a report including the following information:

- a. the provision(s) of the license that has been violated;
- b. the date and time the violation(s) was first observed and by whom;
- c. the cause of the violation(s), if known;
- d. if the violation(s) has ceased, the duration of the violation(s) and the exact date(s) and times(s) it was corrected;
- e. if the violation(s) has not ceased, the anticipated date when it will be corrected;
- f. steps taken and steps planned to prevent a reoccurrence of the violation(s) and the date(s) such steps were implemented or will be implemented; and
- g. the signatures of the Licensee and of the individual(s) responsible for actually preparing such report.

If the violation occurs outside of normal business hours, the Licensee shall contact the Department of Energy and Environmental Protection Emergency Dispatch at 860-424-3333. The Licensee shall comply with any dates which may be approved in writing by the Commissioner.

- 28. Revocation/Suspension/Modification.** The license may be revoked, suspended, or modified in accordance with applicable law.
- 29. Other Required Approvals.** License issuance does not relieve the Licensee of their obligations to obtain any other approvals required by applicable federal, state and local law.
- 30. Rights.** The license is subject to and does not derogate any present or future property rights or powers of the State of Connecticut, and conveys no property rights in real estate or material nor any exclusive privileges, and is further subject to any and all public and private rights and to any federal, state or local laws or regulations pertinent to the property or activity affected hereby.
- 31. Condition Conflicts.** In the case where a project specific special condition listed on the license differs from, or conflicts with, one of the general conditions listed herein, the project specific special condition language shall prevail. It is the licensee's responsibility to contact the agency contact person listed on the license for clarification if needed prior to conducting any further regulated activities.

ENVIRONMENTAL PERMIT PLANS
STATE PROJECT NO. 0077-0244
REHABILITATION OF
BRIDGE NO. 06648 U.S. ROUTE 6 EASTBOUND
OVER UNNAMED BROOK

Digitally signed
by Michael
Steeves
Date: 2024.03.18
11:36:51 -04'00'

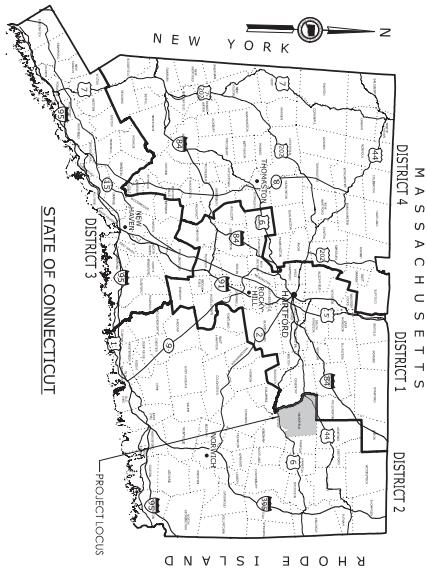

GENERAL NOTES:

1. THESE PLANS ARE NOT FOR CONSTRUCTION PURPOSES AND ARE INTENDED ONLY FOR ENVIRONMENTAL PERMITTING PURPOSES. THESE PLANS HOLD AUTHORITY FOR ALL ACTIVITIES CONCERNING THE REGULATED AREA. FOR DETAILED PLANNING INFORMATION AND FINANCIAL REFERENCES TO THE APPLICABLE CONTRACT DOCUMENTS, THE DEPARTMENT OF TRANSPORTATION WILL ONLY SUBMIT REVIEWS TO DEEP AND UTILITY FOR CHANGES TO THE DESIGN THAN WILL AFFECT REGULATED AREAS.
2. THE DEPARTMENT OF TRANSPORTATION WILL ONLY SUBMIT REVIEWS TO DEEP AND UTILITY FOR CHANGES TO THE DESIGN THAN WILL AFFECT REGULATED AREAS.
3. FOR A DESCRIPTION OF THE WATERCOURSES, WETLANDS AND WETLAND SOILS SEE RELEVANT SECTIONS OF THE PERMIT APPLICATION.
4. 400 FOOT GRID BASED ON CONNECTICUT COORDINATION SYSTEM N.A.D. 1983.
5. VERTICAL DATUM BASED ON NAD 1988.
6. ALL CONSTRUCTION ACTIVITIES WILL BE CONDUCTED IN ACCORDANCE WITH THE REQUIREMENTS OF THE CONNECTICUT DEPARTMENT OF TRANSPORTATION'S REQUIRED BEST MANAGEMENT PRACTICES (BMP) AND SEWAGE AND SEWAGE CONTROL GUIDELINES AND THE 2024 STORMWATER QUALITY MANUAL.

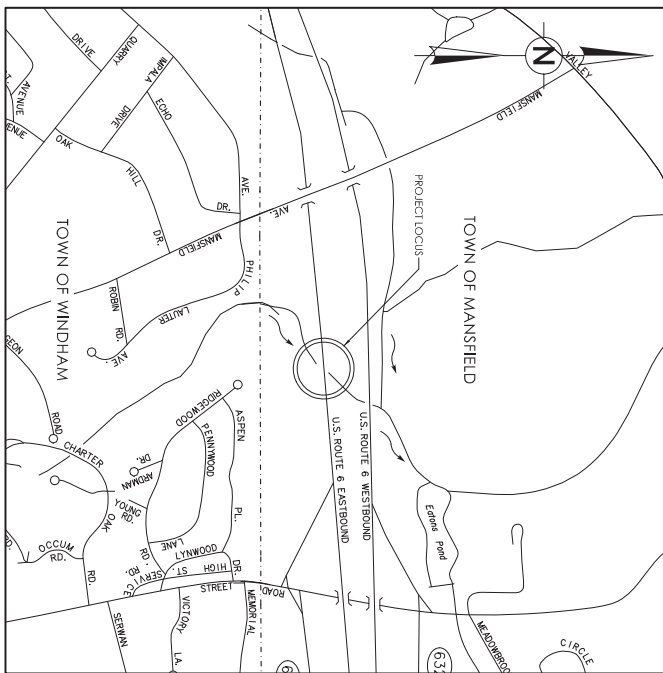

LIST OF DRAWINGS

DRAWING NO.	DRAWING TITLE
PAI-01	GENERAL SITE PLAN
PAI-02	WETLAND AND WATERCOURSE IMPACT PLAN
PAI-03	100-YEAR FLOOD IMPACT PLAN
PAI-04	ELEVATIONS AND SECTION
PAI-05	SUGGESTED SEQUENCE OF CONSTRUCTION AND WATER HANDLING PLAN
PAI-06	ROCK WEBER DETAILS
PAI-07	PERMIT PLANNING PLAN
PAI-08	



ENVIRONMENTAL PERMIT PLANS
PLAN DATE: 02/27/2024



PROJECT NUMBER: 0077-0244
PROJECT LOCATION: 06648 CARRYING U.S. ROUTE 6 E.E. OVER UNNAMED BROOK
TOWNSHIP: MANSFIELD
DRAWING TITLE: TITLE SHEET

PROJECT NO.
SHEET NO.
01.01

ENVIRONMENTAL PERMIT PLANS
PLAN DATE: 02/27/2024
CHECKED BY: CEF
DESIGNED/DRAWN: ABC



ING OF BRIDGE NO. 06648 CARRYING U.S. ROUTE 6 E.B. OVER UNNAMED BROOK

PMT-02	SHEET NO.
	01.02



1. SEDIMENTATION CONTROL SYSTEM TO BE PLACED AT CATCH BASIN(S) AS REQUIRED OR AS DIRECTED BY THE ENGINEER.
2. A DOUBBLE ROW OF SEDIMENT CONTROL BARRIER SHALL BE INSTALLED BETWEEN DISTURBED INTERCOURSE WITHIN 50 FEET, INJUNCTION THERE WOULD BE AN ADVERSE IMPACT TO INSTALLATION OF A DOUBLE ROW OF INTERCOURSE DUE TO LARGER WETLAND/WATERCOURSE IMPACT).
3. ADDITIONAL EROSION CONTROL BARRIERS (DOUBLE ROW OF SCS) MAY ALSO BE REQUIRED WITHIN THE PROJECT AREA. FACTORS TO BE REVIEWED BY THE ENGINEER INCLUDE BUT ARE NOT LIMITED TO: THE CONTRIBUTING DISTURBED AREA, DRAINAGE AREA, SLOPE, LENGTH OF SLOPE, AND FLOOD CAPACITY TO MAINTAIN SHEETFLOW. THE ENGINEER IS RESPONSIBLE FOR THE NECESSARY DESIGN AND SPECIFICATIONS TO INSTALL THE NECESSARY ADDITIONAL ROWS OF EROSION CONTROL BARRIER (OR EQUIVALENT).

ENVIRONMENTAL
PLAN
DESIGNER/DRAWER: ABC

HORIZONTAL SCALE
T = 40'



PROJECT NUMBER: 0077-0244
PROJECT DESCRIPTION: CULVERT
TOWNSHIP: MANSFIELD
DRAWING TITLE: WETLAND AND

IT RELINING OF BRIDGE NO. 06648 CARRYING U.S. ROUTE 6 E.B. OVER UNNAMED BROOK
AND WATERCOURSE IMPACT PLAN

DRAWING NO.	PMT-03
SHEET NO.	01.03

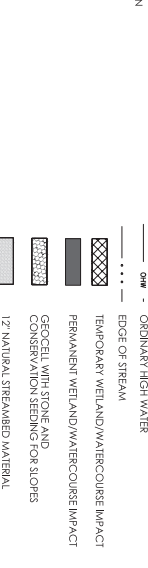

WETLAND IMPACT TABLE		
	WETLAND IMPACTS	TOTAL
PERMANENT IMPACTS	1,326 S.F. (0.020 AC.)	3990 S.F. (0.057 AC.)
TEMPORARY IMPACTS	11,720 S.F. (0.202 AC.)	6255 S.F. (0.090 AC.)
TOTAL IMPACTS	2496 S.F. (0.037 AC.)	1795 S.F. (0.026 AC.)

NOTES

1. THE CONTRACTOR SHALL NOT WORK WITHIN THE LIMITS OF THE WETLANDS AND WATERCOURSE WITH THE EXCEPTION OF THOSE AREAS DelineATED AS TEMPORARY OR PERMANENT IMPACTS TO THE WETLANDS AND WATERCOURSE. ALL DISTURBED AREAS SHALL BE RESTORED.
2. TEMPORARY FILTER FABRIC SHALL BE PLACED ON DESIGNATED TEMPORARY IMPACT AREAS PRIOR TO PLACEMENT OF TEMPORARY FILL. UPON COMPLETION OF CONSTRUCTION, THE TEMPORARY FILTER FABRIC SHALL BE REMOVED AND THE AREA SHALL BE RESTORED.

100-YEAR FLOODPLAIN IMPACTS	
CUT AND FILL	
VOLUME IMPACTS	
EXCAVATION IN FEMA FLOODPLAIN	FILL IN FEMA FLOODPLAIN
72 CY	96 CY

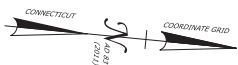
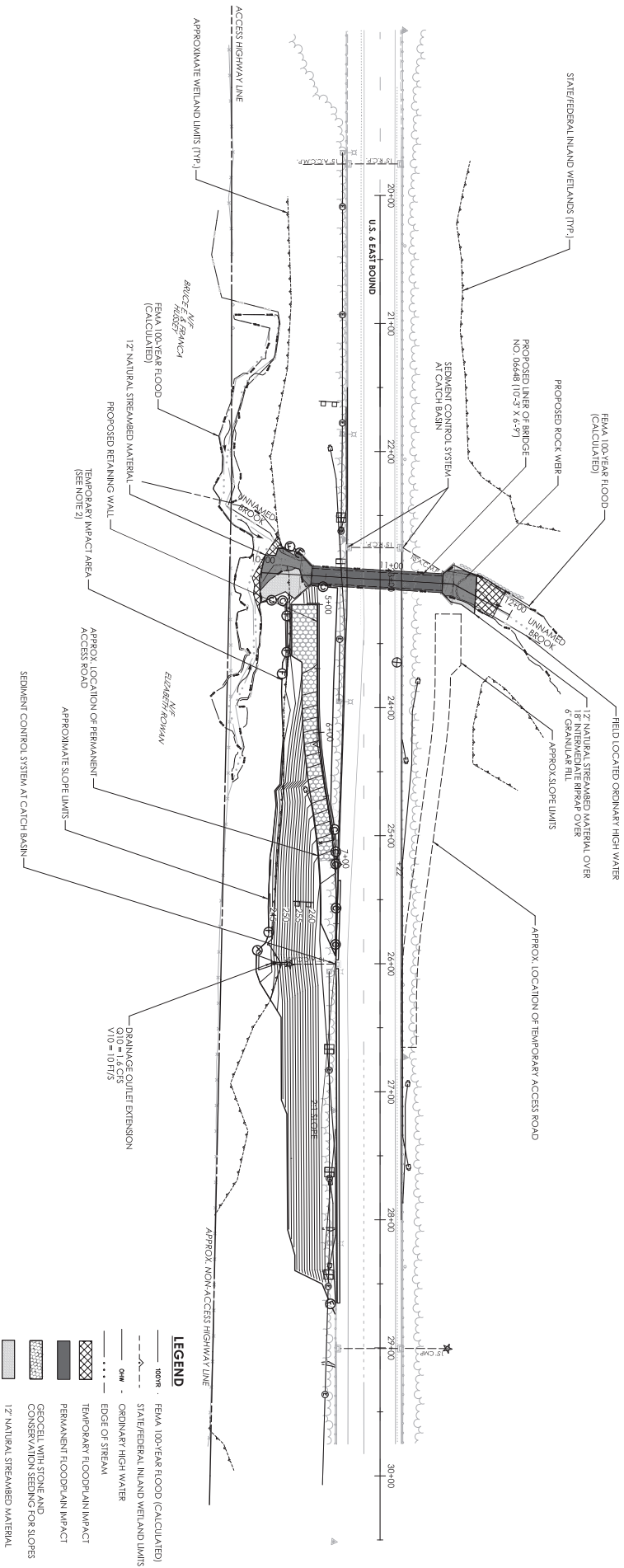

REV	DATE	REVISION DESCRIPTION

ENVIRONMENTAL PERMIT PLANS
PLAN DATE: 02/27/2024

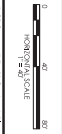

PROJECT NUMBER: 0027-0224
PROJECT DESCRIPTION: CLUTTER RELINING OF BRIDGE NO. 06648 CARRYING U.S. ROUTE 6 E. OVER UNNAMED BROOK
TOWNSHIP: MANSFIELD
DRAWING TITLE: 100-YEAR FLOOD IMPACT PLAN



PROJECT NUMBER: 0027-0224
PROJECT DESCRIPTION: CLUTTER RELINING OF BRIDGE NO. 06648 CARRYING U.S. ROUTE 6 E. OVER UNNAMED BROOK
TOWNSHIP: MANSFIELD
DRAWING TITLE: 100-YEAR FLOOD IMPACT PLAN



PROJECT NUMBER: 0027-0224
PROJECT DESCRIPTION: CLUTTER RELINING OF BRIDGE NO. 06648 CARRYING U.S. ROUTE 6 E. OVER UNNAMED BROOK
TOWNSHIP: MANSFIELD
DRAWING TITLE: 100-YEAR FLOOD IMPACT PLAN

PROJECT NUMBER: 0027-0224
PROJECT DESCRIPTION: CLUTTER RELINING OF BRIDGE NO. 06648 CARRYING U.S. ROUTE 6 E. OVER UNNAMED BROOK
TOWNSHIP: MANSFIELD
DRAWING TITLE: 100-YEAR FLOOD IMPACT PLAN

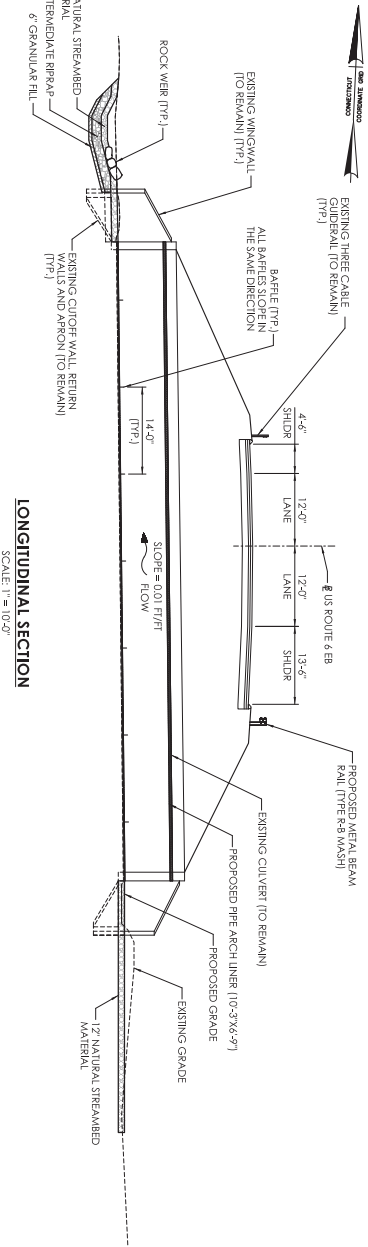

LONGITUDINAL SECTION
SCALE: 1" = 10'-0"

- NATIVE STREAMBED MATERIAL NOTES:**
1. CONTRACTOR SHALL TAKE MEASURES TO MINIMIZE DISTURBANCE TO THE EXISTING STREAMBED DUE TO CONSTRUCTION ACTIVITIES, INCLUDING BUT NOT LIMITED TO THE INSTALLATION AND REMOVAL OF A TEMPORARY BYPASS HOSE AND PUMP, AND COFFDAM. ANY DISTURBANCE TO THE EXISTING STREAMBED DURING CONSTRUCTION SHALL BE RESTORED TO THE EXISTING STREAMBED DURING CONDITIONS OR BETTER.
 2. NATIVE STREAMBED MATERIAL EXCAVATED DURING CONSTRUCTION SHALL BE STOCKPILED AND THEN REPLACED TO THE DEPTH SHOWN ON THE PLANS OR AS DIRECTED BY THE ENGINEER IN ACCORDANCE WITH THE SPECIAL PROVISION FOR EXCAVATION AND REUSE OF EXISTING CHANNEL BOTTOM MATERIAL.
 3. ADDITIONAL STREAMBED MATERIAL, IF REQUIRED, SHALL BE IN ACCORDANCE WITH SPECIAL PROVISION SUPPLEMENTAL STREAMBED CHANNEL MATERIAL.
- OPENNESS RATIO (OR):**
- OR = OPEN AREA / BRIDGE WIDTH
0.6 FT < 0.62 FT (RECOMMENDED MINIMUM)
- BANK FULL WIDTH (BFW):**
- BFW = 12.0 FT
1.2 X BFW = 14.4 FT
10.25 FT (PROPOSED PRE CLEAR SPAN) < 14.4 FT

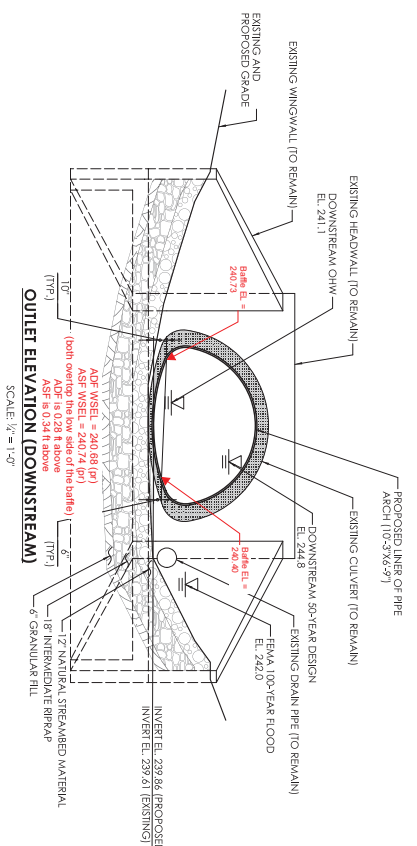

INLET ELEVATION (UPSTREAM)
SCALE: 1/2" = 1'-0"

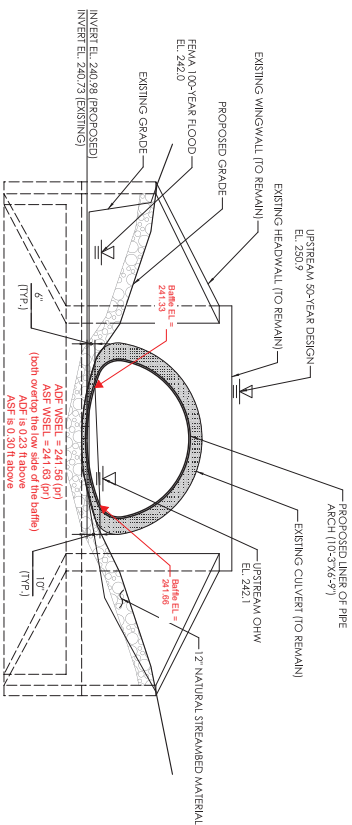

ENVIRONMENTAL PERMIT PLANS
PLAN DATE: 02/27/2024

REV	DATE	REVISION DESCRIPTION
1	02/27/2024	ISSUED FOR PERMIT



PROJECT NUMBER: 0037-2024
PROJECT DESCRIPTION: CULVERT RELINING OF BRIDGE NO. 06648 CARRYING U.S. ROUTE 6 EB. OVER UNPAVED BROOK
TOWNSHIP: MANSFIELD
DRAWING TITLE: ELEVATIONS AND SECTION



1. THE CONTRACTOR SHALL MAINTAIN WATER THROUGH THE TEMPORARY WATER HANDLING SYSTEM AS REQUIRED DURING CONSTRUCTION.

- UNCONFINED IN-STREAM WORK BMP NOTES:

WITH CONSIDERATION OF THE FOLLOWING

- INSTREAM WORK SHALL BE DONE DURING PERIODS OF LOW FLOW

PLAN DATE: 02/27/2024

C
Accounting, Finance
and Insurance



PROJECT NUMBER: 0077-0244
PROJECT DESCRIPTION: CULVERT
TOWNSHIP: MANSFIELD
DRAWING TITLE: SUGGESTED

CONSTRUCTION AND WATER HANDLING PLAN

DRAWING NO.	PMT-06
SHEET NO.	01.06



NOT TO SCALE

FROM THE CONTRACT PLANS

12. REMOVE E&S CONTROLS UPON FINAL STABILIZATION

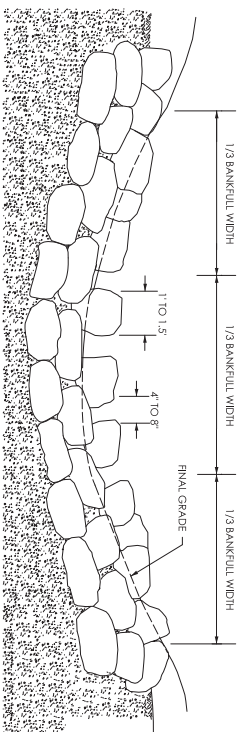
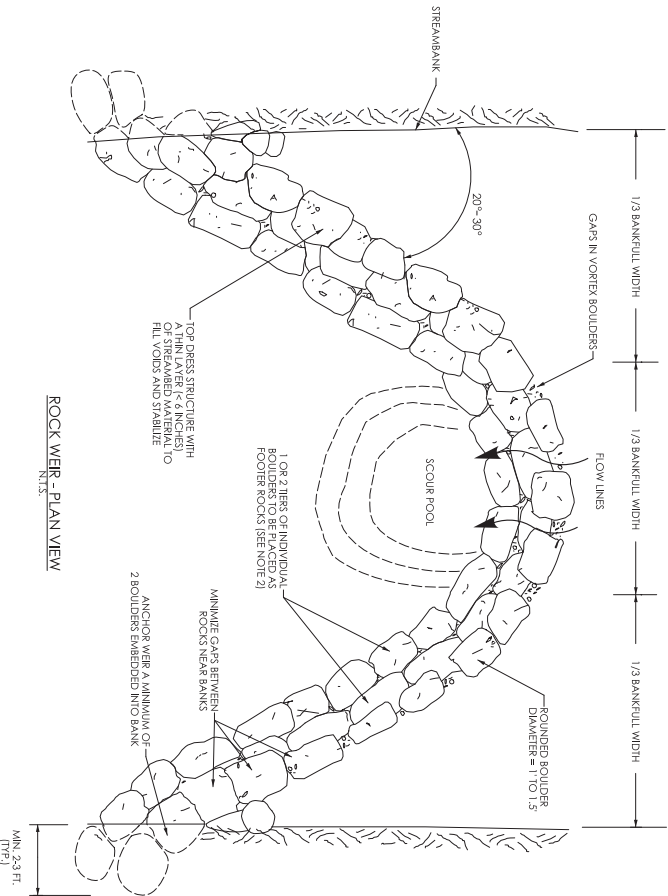

ROCK WEIR NOTES:

1. PLACEMENT OF THE ROCK WEIR SHALL BE UNDER THE SUPERVISION OF CIDEEP FISHERIES DIVISION STAFF (OR THEIR AUTHORIZED DELEGATE). THE CONTRACTOR SHALL COORDINATE THROUGH THE ENGINEER A MINIMUM OF 10 DAYS IN ADVANCE OF THE WEIR INSTALLATION TO ALLOW FOR CIDEEP FISHERIES TO BE ON SITE.
2. FOOTER ROCKS SHALL SERVE AS THE FOUNDATION FOR THE TOP LAYER OF THE WEIR. FOOTER ROCKS SHALL HAVE REASONABLE FLAT TOPS AND BOTTOMS TO ENABLE BETTER PLACEMENT OF THE TOP LAYER OF THE WEIR.
3. BOULDERS SHALL BE ROUNDED, 1 TO 1.5 IN DIAMETER AS SPECIFIED BY DEEP FISHERIES OR AS RECOMMENDED BY THE OFFICE OF ENVIRONMENTAL PLANNING (OEP). CONTRACTOR SHALL COORDINATE TYPE AND SIZE WITH DEEP FISHERIES OR OEP.
4. ALL WORK ASSOCIATED WITH THE INSTALLATION OF THE ROCK WEIR SHALL BE PAID FOR UNDER THE ITEM FOR "ROCK WEIR, EXISTING OR NATURAL STREAMBED MATERIAL SHALL BE PAID FOR UNDER THE ITEM FOR EXCAVATION AND REUSE OF EXISTING CHANNEL BOTTOM MATERIAL" AND SUPPLEMENTAL STREAMBED CHANNEL MATERIAL.
5. BOULDERS SHALL BE PLACED WITHIN THE DEPARTMENT'S RIGHT-OF-WAY OR EASEMENT.

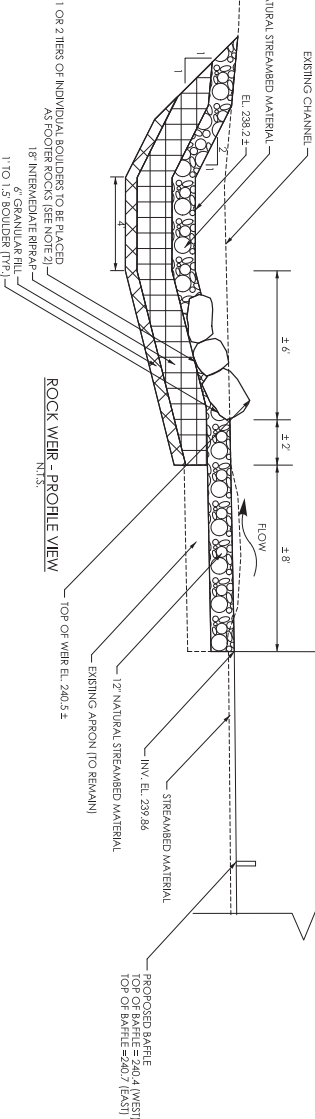

ENVIRONMENTAL PERMIT PLANS
PLAN DATE: 2/27/2024



STATE OF CONNECTICUT
DEPARTMENT OF TRANSPORTATION



PROJECT NUMBER: 0027-0224
PROJECT DESCRIPTION: CULVERT RELINING OF BRIDGE NO. 06448 CARRYING U.S. ROUTE 2 E.B. OVER UNNAMED BROOK
TOWNSHIP: MANSFIELD
DRAWING TITLE: ROCK WEIR DETAILS

CONTRACT NO.
PMT-07
SHEET NO.

BOTANICAL NAME	COMMON NAME	SIZE	QTY.	SPACING	WETLAND INDICATOR
<i>Asclepias incarnata</i>	SWAMP MILKWEED	2' PLUG	50	FIELD LOCATED	ORL
<i>Asclepias tuberosa</i>	BUTTERFLY MILKWEED	2' PLUG	60	FIELD LOCATED	NI
<i>Verbena stricta</i>	VERBENA	2' - 3' HT. B.B.	35	FIELD LOCATED	UPL
<i>Composita perfoliata</i>	SWEETERN	18" - 24" HT. B.B.	35	FIELD LOCATED	UPL
<i>Hemerocallis virginica</i>	WITCH HAZEL	18" - 24" HT. B.B.	35	FIELD LOCATED	UPL
TOTAL			215	FIELD LOCATED	UPL

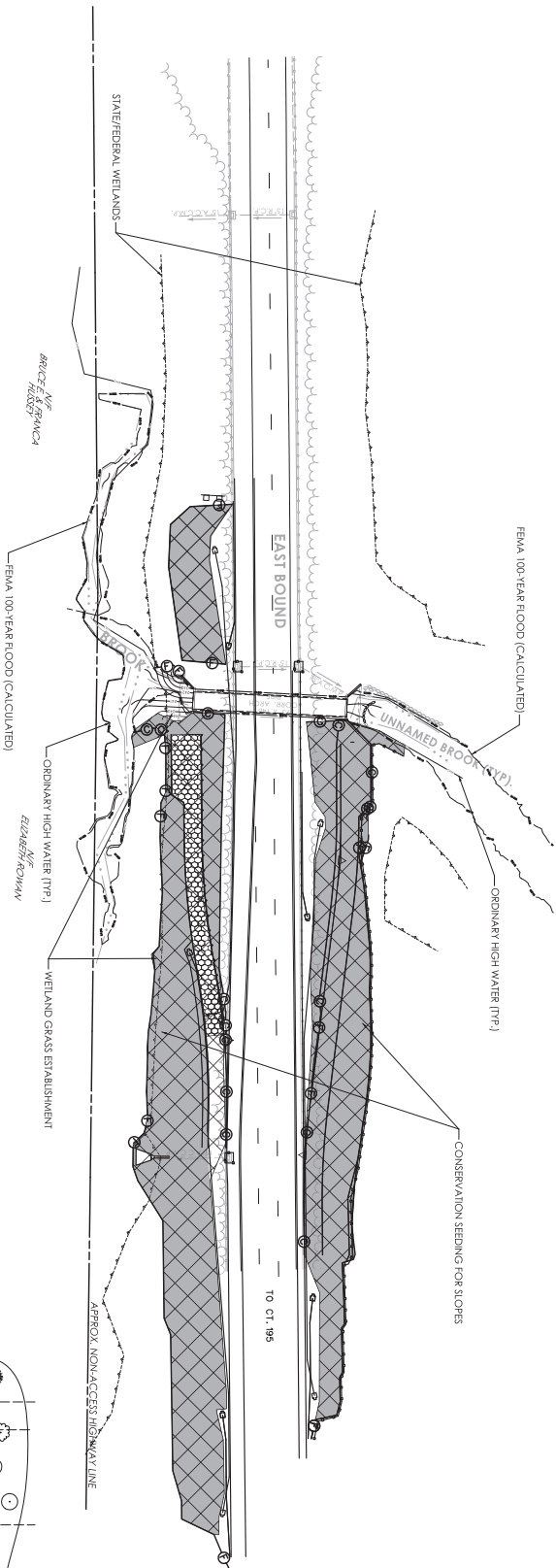

NOTES:

1. THE PLANTINGS ON THIS SHEET ARE FOR ENVIRONMENTAL PERMITTING. ANY SUBSTITUTIONS TO THE PERMIT PLANTINGS SHALL BE COORDINATED WITH THE DEPARTMENT'S OFFICE OF ENVIRONMENTAL PLANNING (OEP).
2. PROPOSED PLANTINGS TO BE FIELD LOCATED BY CIDOT OEP OR THEIR DESIGNATED REPRESENTATIVE.
3. WOOD CHIP MULCH SHALL NOT BE PLACED IN THE WETLAND AREA.
4. DISTURBED AREAS BELOW THE WETLAND LIMIT SHALL BE SEEDING WITH WETLAND GRASS SEED ESTABLISHMENT. DISTURBED AREAS ABOVE THE WETLAND LIMIT SHALL BE SEEDING WITH CONSERVATION SEEDING FOR SLOPES, OR OTHER SEED MIX AS SPECIFIED. ALL DISTURBED AREAS SHALL BE RESTORED.
5. ALL PLANT MATERIAL SHALL BE NURSERY GRADE STRAIGHT SPECIES, CONFORMING TO SECTION 3 OF THE AMERICAN STANDARDS FOR NURSERY STOCK. CIDOT OEP SHALL REVIEW AND APPROVE PROPOSED PLANTINGS.
6. NO PLANTINGS TO BE PLACED IN MOW AREA.
7. AREA TO BE TREATED FOR INVASIVES AND PROPERLY PREPARED FOR FINAL PLANTINGS, SEEDING, AND RESTORATION.
8. THE SOUTHERN CONSTRUCTION ACCESS ROAD WILL REMAIN AFTER RESTORATION AS A MAINTENANCE DRIVE AND WILL NOT BE FULLY RESTORED WITH PLANTINGS.

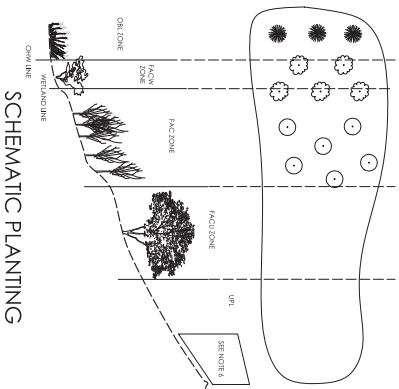
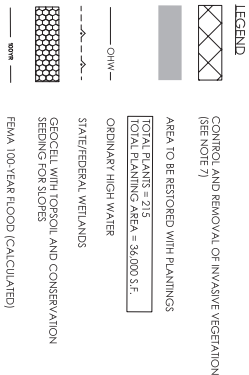

ENVIRONMENTAL PERMIT PLANS
PLAN DATE: 2/27/2024



PROJECT NUMBER: 0027-0224
PROJECT DESCRIPTION: CULVERT RELINING OF BRIDGE NO. 06448 CARRYING U.S. ROUTE 2 E.B. OVER UNNAMED BROOK
TOWNSHIP: MANSFIELD
DRAWING TITLE: PERMIT PLANTING PLAN

DATE: 2/27/2024
DRAWN BY: [Name]
CHECKED BY: [Name]
DESIGNED BY: [Name]
PROJECT NO.: [Number]



LWRD Work Commencement Form

To: DEEP.LWRDRegulatory@ct.gov or
Regulatory Section
Department of Energy and Environmental Protection
Land & Water Resources Division
79 Elm Street
Hartford, CT 06106-5127

Licensee Name: CT Department of Transportation

Municipality in which the project is occurring: Mansfield

DEEP License No(s): 202303948-IW

CONTRACTOR(s):

1 Name: _____
Address: _____
Telephone: _____
E-mail: _____

2 Name: _____
Address: _____
Telephone: _____
E-mail: _____

3 Name: _____
Address: _____

Date Contractor(s) received a copy
of the license and approved plans: _____

EXPECTED DATE OF COMMENCEMENT OF WORK: _____

EXPECTED DATE OF COMPLETION OF WORK: _____

LICENSEE: _____
(Signature) (Date)



Compliance Certification Form

The following certification must be signed by the licensee working in consultation with a Connecticut-licensed design professional and must be submitted to the address indicated at the end of this form within ninety (90) days of completion of the authorized work.

1. Licensee Name: <u>State of Connecticut Department of Transportation</u>	
DEEP License Number(s): <u>202303948-IW</u>	
Municipality in which project is occurring: <u>Mansfield</u>	
2. Check one:	
(a) <input type="checkbox"/> "I certify that the final site conditions and / or structures are in general conformance with the approved site plans". Identify and describe any deviations and attach to this form.	
(b) <input type="checkbox"/> "The final site conditions and / or structures are not in general conformance with the approved site plans. The enclosed "as-built" plans note the modifications".	
3. "I understand that any false statement in this certification is punishable as a criminal offence under section 53a-157b of the General Statutes and under any other applicable law."	
Signature of Licensee	Date
Name of Licensee (print or type)	
Signature of CT-Licensed Design Professional	Date
Name of CT-Licensed Design Professional (print or type)	
Professional License Number (if applicable)	Affix Stamp Here
<ul style="list-style-type: none">As-built plans shall include: elevations or tidal datums, as applicable, and structures, including any proposed elevation views and cross sections included in the approved license plans. Such as-built plans shall be the original ones and be signed and sealed by an engineer, surveyor or architect, as applicable, who is licensed in the State of Connecticut.The Licensee will be notified by staff of the Land and Water Resources Division (LWRD) if further compliance review is necessary. Lack of response by LWRD staff does not imply compliance. <p>Submit this completed form to : DEEP.LWRDRegulatory@ct.gov or Regulatory Section Department of Energy and Environmental Protection Land & Water Resources Division 79 Elm Street Hartford, CT 06106-5127</p>	