



Connecticut Department of Energy and Environmental Protection License*

Structures, Dredging & Fill Permit

Licensee(s): 36 Wallacks Drive LLC

Licensee Address(s): 36 Wallacks Drive
Stamford, CT 06902

License Number(s): 202411530-SDF

Municipality: Stamford

Project Description: Construct a piling supported boat lift for residential boating access

Project Address/Location: 36 Wallacks Drive

Waters: Long Island Sound

**Authorizing CT Statute(s)
and/or Federal Law:** CGS Section 22a-359 to 363g; CGS Section 22a-90 to 112

**Applicable Regulations of
CT State Agencies:**

Agency Contact: Land & Water Resources Division,
Bureau of Water Protection & Land Reuse, 860-424-3019

License Expiration: Five (5) years from the date of issuance of this license.

Project Site Plan Set: Four sheets of site plans prepared by John Hilts dated 11/4/2024,
sheets 3 & 4 revised on 01/09/2025.

License Enclosures: LWRD Compliance Certification Form; Land Record Filing;
LWRD General Conditions; Site Plan Set; LWRD Work
Commencement Form; NDDDB Determination

*Connecticut's Uniform Administrative Procedure Act defines License to include, "the whole or part of any agency permit, certificate, approval, registration, charter or similar form of permission required by law . . ."

Authorized Activities:

The Licensee is hereby authorized to conduct the following work as described in application # 202411530-SDF and as depicted on any site plan sheets / sets cited herein:

install a 21' x 20' boatlift supported by eight steel piles with a step from existing float.

Failure to comply with the terms and conditions of this license shall subject the Licensee and / or the Licensee's contractor(s) to enforcement actions and penalties as provided by law.

This license is subject to the following Terms and Conditions:

1. **License Enclosure(s) and Conditions.** The Licensee shall comply with all applicable terms and conditions as may be stipulated within the License Enclosure(s) listed above.
2. **Time-of-Year Restrictions.** Work authorized herein is prohibited between April 15th and September 30th, inclusive, of any year unless otherwise authorized in writing by the Commissioner. The specific closure dates are as follows: June 1st through September 30th in order to protect spawning shellfish, and April 15th through August 31st in order to protect American Oystercatcher (*Haematopus palliatus*) nesting season.
3. **Barge Staging and Storage.** Any barge utilized in the execution of the work authorized herein shall occur only during periods of higher water to prevent the barge from resting on, or coming into contact with, the substrate at any time.
4. **Shellfishing Signage.** Special Terms and Conditions, paragraph 6., of Permit #200801981-KR required signage be placed on the dock. Such signage is no longer required.
5. **Discharge of Grout.** At no time shall the Licensee allow grout to discharge into Long Island Sound.
6. **Shared Dock.** The structure authorized herein is for the purpose of exercising the riparian rights associated with the entire parcel under common ownership. If the parcel is subdivided in the future, such subdivided parcels may not necessarily be entitled to additional dock structures as an exercise of riparian rights.
7. **Boatlift.** The boat lift authorized herein shall be cradle style with no solid platform.

Issued under the authority of the Commissioner of Energy and Environmental Protection on:

Date

Graham J. Stevens
Bureau Chief
Bureau of Water Protection & Land Reuse



LWRD General Conditions

- 1. Land Record Filing (for *Structures Dredging & Fill, Tidal Wetlands, Certificate of Permission, and Long Island Sound General Permit Licenses only*).** The Licensee shall file the Land Record Filing on the land records of the municipality in which the subject property is located not later than thirty (30) days after license issuance pursuant to Connecticut General Statutes (CGS) Section 22a-363g. A copy of the Notice with a stamp or other such proof of filing with the municipality shall be submitted to DEEP.LWRDRegulatory@ct.gov no later than sixty (60) days after license issuance. If a Land Record Filing form is not enclosed and the work site is not associated with an upland property, no filing is required.
- 2. Contractor Notification.** The Licensee shall give a copy of the license and its attachments to the contractor(s) who will be carrying out the authorized activities prior to the start of construction and shall receive a written receipt for such copy, signed and dated by such contractor(s). The Licensee's contractor(s) shall conduct all operations at the site in full compliance with the license and, to the extent provided by law, may be held liable for any violation of the terms and conditions of the license. At the work site, the contractor(s) shall, whenever work is being performed, have on site and make available for inspection a copy of the license and the authorized plans.
- 3. Work Commencement¹.** Not later than two (2) weeks prior to the commencement of any work authorized herein, the Licensee shall submit to DEEP.LWRDRegulatory@ct.gov, on the Work Commencement Form attached hereto, the name(s) and address(es) of all contractor(s) employed to conduct such work and the expected date for commencement and completion of such work, if any.
 - For water diversion activities authorized pursuant to 22a-377(c)-1 of the Regulations of Connecticut State Agencies, the Licensee shall also notify the Commissioner in writing two weeks prior to initiating the authorized diversion.
 - For emergency activities authorized pursuant Connecticut General Statutes Section 22a-6k, the Licensee shall notify the Commissioner, in writing, of activity commencement at least one (1) day prior to construction and of activity completion no later than five (5) days after conclusion.
- 4. For Coastal Licenses Only - License Notice.** The Licensee shall post the first page of the License in a conspicuous place at the work area while the work authorized therein is undertaken.
- 5. Unauthorized Activities.** Except as specifically authorized, no equipment or material, including but not limited to, fill, construction materials, excavated material or debris, shall be deposited, placed or stored in any wetland or watercourse on or off-site. The Licensee may not

¹ The Work Commencement condition and the need for a Work Commencement Form is not applicable to Flood Management Certification approvals.

conduct work within wetlands or watercourses other than as specifically authorized, unless otherwise authorized in writing by the Commissioner. Tidal wetlands means “wetland” as defined by section 22a-29 and “freshwater wetlands and watercourses” means “wetlands” and “watercourses” as defined by section 22a-38.

- 6. Management of Materials.** Any materials removed from the site shall be managed in accordance with all federal, state, and local requirements, including Chapter 446K Water Pollution Control, Chapter 445 Hazardous Waste, and Chapter 446d Solid Waste of the Connecticut General Statutes.
- 7. Unconfined Instream Work.** Unless otherwise noted in a condition of the license, the following conditions apply to projects in non-coastal waters:
 - Unconfined instream work is limited to the period June 1 through September 30.
 - Confinement of a work area by cofferdam techniques using sand bag placement, sheet pile installation (vibratory method only), portadam, or similar confinement devices is allowed any time of the year. The removal of such confinement devices is allowed any time of the year.
 - Once a work area has been confined, in-water work within the confined area is allowed any time of the year.
 - The confinement technique used shall completely isolate and protect the confined area from all flowing water. The use of silt boom/curtain or similar technique as a means for confinement is prohibited.
- 8. For State Actions Only - Material or Equipment Storage in the Floodplain.** Unless approved by a Flood Management Exemption, the storage of any materials at the site which are buoyant, hazardous, flammable, explosive, soluble, expansive, radioactive, or which could in the event of a flood be injurious to human, animal or plant life, below the elevation of the five-hundred (500) year flood is prohibited. Any other material or equipment stored at the site below said elevation by the Licensee or the Licensee's contractor must be firmly anchored, restrained or enclosed to prevent flotation. The quantity of fuel stored below such elevation for equipment used at the site shall not exceed the quantity of fuel that is expected to be used by such equipment in one day. In accordance with the licensee's Flood Contingency Plan, the Licensee shall remove equipment and materials from the floodplain during periods when flood warnings have been issued or are anticipated by a responsible federal, state or local agency. It shall be the Licensee's responsibility to obtain such warnings when flooding is anticipated.
- 9. Temporary Hydraulic Facilities for Water Handling.** If not reviewed and approved as a part of the license application, temporary hydraulic facilities shall be designed by a qualified professional and in accordance with the *Connecticut Guidelines for Soil Erosion and Sediment Control*, the *2004 Connecticut Stormwater Quality Manual*, or the *Department of Transportation's ConnDOT Drainage Manual*, as applicable. Temporary hydraulic facilities may include channels, culverts or bridges which are required for haul roads, channel relocations, culvert installations, bridge construction, temporary roads, or detours.
- 10. Excavated Materials.** Unless otherwise authorized, all excavated material shall be staged and

managed in a manner which prevents additional impacts to wetlands and watercourses.

- 11. Best Management Practices.** The Licensee shall not cause or allow pollution of any wetlands or watercourses, including pollution resulting from sedimentation and erosion. In constructing or maintaining any authorized structure or facility or conducting any authorized activity, or in removing any such structure or facility, the Licensee shall employ best management practices to control storm water discharges, to prevent erosion and sedimentation, and to otherwise prevent pollution of wetlands and other waters of the State. For purposes of the license, “pollution” means “pollution” as that term is defined by CGS section 22a-423. Best Management Practices include, but are not limited, to practices identified in the *Connecticut Guidelines for Soil Erosion and Sediment Control* as revised, *2004 Connecticut Stormwater Quality Manual*, Department of Transportation’s *ConnDOT Drainage Manual* as revised, and the Department of Transportation Standard Specifications as revised.
- 12. In-Water Work Vessel Staging and Storage. (for Structures Dredging & Fill, Tidal Wetlands, Certificate of Permission, and Long Island Sound General Permit Licenses only).** For any barge, vessel, skiff or floating work platform (“work vessels”) utilized in the execution of the work authorized herein, the Licensee shall ensure that such work vessels:
 - do not rest on, or come in contact with, the substrate at any time, unless specifically authorized in the license.
 - are not stored over intertidal flats, submerged aquatic vegetation or tidal wetland vegetation or in a location that interferes with navigation. In the event any work vessel is grounded, no dragging or prop dredging shall occur to free it.
- 13. Work Site Restoration.** Upon completion of any authorized work, the Licensee shall restore all areas temporarily impacted by construction, or used as a staging area or accessway in connection with such work, to their condition prior to the commencement of such work.
- 14. Inspection.** The Licensee shall allow any representative of the Commissioner to inspect the project location at reasonable times to ensure that work is being or has been conducted in accordance with the terms and conditions of this license.
- 15. Change of Use. (Applies only if a use is specified within the License “Project Description”)**
 - a. The work specified in the license is authorized solely for the purpose set forth in the license. No change in purpose or use of the authorized work or facilities as set forth in the license may occur without the prior written approval of the Commissioner. The Licensee shall, prior to undertaking or allowing any change in use or purpose from that which is authorized by this license, request permission from the Commissioner for such change. Said request shall be in writing and shall describe the proposed change and the reason for the change.
 - b. A change in the form of ownership of any structure authorized herein from a rental/lease commercial marina to a wholly-owned common interest community or dockominium may constitute a change in purpose as specified in paragraph (a) above.
- 16. De Minimis Alteration.** The Licensee shall not deviate from the authorized activity without prior written approval from the Commissioner. The Licensee may request a de minimis change

to any authorized structure, facility, or activity. A de minimis alteration means a change in the authorized design, construction or operation that individually and cumulatively has minimal additional environmental impact and does not substantively alter the project as authorized.

- For diversion activities authorized pursuant to 22a-377(c)-2 of the Regulations of Connecticut State Agencies, a de minimis alteration means an alteration which does not significantly increase the quantity of water diverted or significantly change the capacity to divert water.

17. Extension Request. The Licensee may request an extension of the license expiration date. Such request shall be in writing and shall be submitted to DEEP.LWRDRegulatory@ct.gov at least thirty (30) days prior to the license expiration. Such request shall describe the work done to date, what work still needs to be completed, and the reason for such extension. The Commissioner may extend the expiration date of this license for a period of up to one year, in order for the Licensee to complete the authorized activities. It shall be at the Commissioner's sole discretion to grant or deny such request. No more than three (3) one-year extensions will be granted under this license.

18. Compliance Certification². Not later than 90 days after completion of the authorized work, the Licensee shall prepare and submit to DEEP.LWRDRegulatory@ct.gov, the attached Compliance Certification Form. Such Compliance Certification shall be completed, signed, and sealed by the Licensee and a Connecticut Licensed Design Professional. If non-compliance is indicated on the form, or the Commissioner has reason to believe the activities and/or structures were conducted in non-compliance with the license, the Commissioner may require the Licensee to submit as-built plans as a condition of this license.

19. Maintenance. The Licensee shall maintain all authorized structures or work in optimal condition or shall remove such structures or facility and restore the affected waters to their pre-work condition. Any such maintenance or removal activity shall be conducted in accordance with applicable law and any additional approvals required by law.

20. No Work After License Expiration. Work conducted after the license expiration date is a violation of the license and may subject the licensee to enforcement action, including penalties, as provided by law.

21. License Transfer. The license is not transferable without prior written authorization of the Commissioner. A request to transfer a license shall be submitted in writing and shall describe the proposed transfer and the reason for such transfer. The Licensee's obligations under the license shall not be affected by the passage of title to the license site to any other person or municipality until such time as a transfer is approved by the Commissioner.

22. Document Submission. Any document required to be submitted to the Commissioner under the license or any contact required to be made with the Commissioner shall, unless otherwise specified in writing by the Commissioner, be directed to:

DEEP.LWRDRegulatory@ct.gov or

² The Work Commencement condition and the need for a Work Commencement Form is not applicable to Flood Management Certification approvals.

Regulatory Section
Land & Water Resources Division
Department of Energy and Environmental Protection
79 Elm Street
Hartford, Connecticut 06106-5127
860-424-3019

- 23. Date of Document Submission.** The date of submission to the Commissioner of any document required by the license shall be the date such document is received by the Commissioner. The date of any notice by the Commissioner under the license, including but not limited to notice of approval or disapproval of any document or other action, shall be the date such notice is personally delivered or the date three (3) days after it is mailed by the Commissioner, whichever is earlier. Except as otherwise specified in the license, the word “day” as used in the license means calendar day. Any document or action which is required by the license to be submitted or performed by a date which falls on a Saturday, Sunday or a Connecticut or federal holiday shall be submitted or performed on or before the next day which is not a Saturday, Sunday, or a Connecticut or federal holiday.
- 24. Certification of Documents.** Any document, including but not limited to any notice, which is required to be submitted to the Commissioner under the license shall be signed by the Licensee and by the individual or individuals responsible for actually preparing such document, each of whom shall certify in writing as follows: “I have personally examined and am familiar with the information submitted in this document and all attachments and certify that based on reasonable investigation, including my inquiry of those individuals responsible for obtaining the information, the submitted information is true, accurate and complete to the best of my knowledge and belief, and I understand that any false statement made in this document or its attachments may be punishable as a criminal offense.”
- 25. Accuracy of Documentation.** In evaluating the application for the license, the Commissioner has relied on information and data provided by the Licensee and on the Licensee’s representations concerning site conditions, design specifications and the proposed work, including but not limited to representations concerning the commercial, public or private nature of the work or structures, the water-dependency of said work or structures, its availability for access by the general public, and the ownership of regulated structures or filled areas. If such information proves to be false, deceptive, incomplete or inaccurate, the license may be modified, suspended or revoked, and any unauthorized activities may be subject to enforcement action.
- 26. Limits of Liability.** In granting the license, the Commissioner has relied on all representations of the Licensee, including information and data provided in support of the Licensee’s application. Neither the Licensee’s representations nor the issuance of the license shall constitute an assurance by the Commissioner as to the structural integrity, the engineering feasibility or the efficacy of such design.
- 27. Reporting of Violations.** In the event that the Licensee becomes aware that they did not or may not comply, or did not or may not comply on time, with any provision of this license or

of any document incorporated into the license, the Licensee shall immediately notify the agency contact specified within the license and shall take all reasonable steps to ensure that any noncompliance or delay is avoided or, if unavoidable, is minimized to the greatest extent possible. In so notifying the agency contact, the Licensee shall provide, for the agency's review and written approval, a report including the following information:

- a. the provision(s) of the license that has been violated;
- b. the date and time the violation(s) was first observed and by whom;
- c. the cause of the violation(s), if known;
- d. if the violation(s) has ceased, the duration of the violation(s) and the exact date(s) and times(s) it was corrected;
- e. if the violation(s) has not ceased, the anticipated date when it will be corrected;
- f. steps taken and steps planned to prevent a reoccurrence of the violation(s) and the date(s) such steps were implemented or will be implemented; and
- g. the signatures of the Licensee and of the individual(s) responsible for actually preparing such report.

If the violation occurs outside of normal business hours, the Licensee shall contact the Department of Energy and Environmental Protection Emergency Dispatch at 860-424-3333. The Licensee shall comply with any dates which may be approved in writing by the Commissioner.

- 28. Revocation/Suspension/Modification.** The license may be revoked, suspended, or modified in accordance with applicable law.
- 29. Other Required Approvals.** License issuance does not relieve the Licensee of their obligations to obtain any other approvals required by applicable federal, state and local law.
- 30. Rights.** The license is subject to and does not derogate any present or future property rights or powers of the State of Connecticut, and conveys no property rights in real estate or material nor any exclusive privileges, and is further subject to any and all public and private rights and to any federal, state or local laws or regulations pertinent to the property or activity affected hereby.
- 31. Condition Conflicts.** In the case where a project specific special condition listed on the license differs from, or conflicts with, one of the general conditions listed herein, the project specific special condition language shall prevail. It is the licensee's responsibility to contact the agency contact person listed on the license for clarification if needed prior to conducting any further regulated activities.



Connecticut
Department of Energy &
Environmental Protection

portal.ct.gov/DEEP

11/12/2024

John Hilts
HILTS
PO BOX 47
NORWALK, CT 06853
mrhilts@erols.com

Subject: Steven Cheng Boat Lift

Filing #: 120018

NDDB - New Determination Number: 202411043

Expiration Date: 11/12/2026

I have reviewed Natural Diversity Data Base (NDDB) maps and files regarding the area of work provided for the proposed installation of a boat lift on an existing dock at 36 Wallacks Dr, Stamford, Connecticut.

According to our records there are State Threatened American Oystercatcher (*Haematopus palliatus*) that nest in the area. This bird nests on sandy to rocky beaches, sandbars, off-shore islands, above the high tide. Its nesting season is between mid April-August. Its diet is mostly comprised of shellfish. Potential impacts can be avoided to this species if the project is conducted outside of the peak feeding and nesting activity period (approximately mid-April through August). All work and traffic should keep a 100m buffer of active nesting locations.

Your submission information indicates that your project requires a state permit, license, registration, or authorization, or utilizes state funding or involves state agency action. This NDDB - New determination may be utilized to fulfill the Endangered and Threatened Species requirements for state-issued permit applications, licenses, registration submissions, and authorizations.

Please be aware of the following limitations and conditions:

Natural Diversity Database information includes all information regarding listed species available to us at the time of the request. This information is a compilation of data collected over the years by the Department of Energy and Environmental Protection's Natural History Survey and cooperating units of DEEP, land owners, private conservation groups and the scientific community. This information is not necessarily the result of comprehensive or site-specific field investigations. Current research projects and new contributors continue to identify additional populations of species and locations of habitats of concern, as well as enhance existing data. Such new information is incorporated into the Database and accessed through the ezFile portal as it becomes available. New information may result in additional review, and new or modified restrictions or conditions may be necessary to remain in compliance with certain state permits.

- During your work listed species may be encountered on site. A report must be submitted by the observer to the Natural Diversity Database promptly and additional review and restrictions or conditions

may be necessary to remain in compliance with certain state permits. Please fill out the [appropriate survey form](#) and follow the instructions for submittal.

- Your project involves the state permit application process or other state involvement, including state funding or state agency actions; please note that consultations with your permit analyst or the agency may result in additional requirements. In this situation, additional evaluation of the proposal by the DEEP Wildlife Division may be necessary and additional information, including but not limited to species-specific site surveys, may be required. Any additional review may result in specific restrictions or conditions relating to listed species that may be found at or in the vicinity of the site.
- If your project involves preparing an Environmental Impact Assessment, this NDDDB consultation and determination should not be substituted for biological field surveys assessing on-site habitat and species presence.
- The NDDDB - New determination for the Steven Cheng Boat Lift as described in the submitted information and summarized at the end of this document is valid until 11/12/2026. This determination applies only to the project as described in the submission and summarized at the end of this letter. Please re-submit an updated Request for Review if the project's scope of work and/or timeframe changes, including if work has not begun by 11/12/2026.

If you have further questions, please contact me at the following:

Karen Zyko
CT DEEP Bureau of Natural Resources
Wildlife Division
Natural Diversity Database
79 Elm Street
Hartford, CT 06106-5127
(860) 424-3378
Karen.Zyko@ct.gov

Please reference the Determination Number 202411043 when you e-mail or write. Thank you for consulting the Natural Diversity Data Base.

Karen Zyko
Wildlife Division- Natural Diversity Data Base
79 Elm Street
Hartford, CT 06106-5127
(860) 424-3378
Karen.Zyko@ct.gov

Application Details:

Project involves federal funds or federal permit:	Yes
Project involves state funds, state agency action, or relates to CEPA request:	Yes
Project requires state permit, license, registration, or authorization:	Yes
DEEP enforcement action related to project:	
Project Type:	Docks/Piers/Boat Launches and Aquaculture
Project Sub-type:	New Dock, Pier, Associated structures
Project Name:	Steven Cheng Boat Lift
Project Description:	



ASSESSOR'S MAP

FROM STAMFORD ASSESSOR'S MAP NUMBER 136

BLOCK 150 LOT 1

PURPOSE: IMPROVED RECREATIONAL BOAT BERTHING
DATUM: NORTH AMERICAN VERTICAL DATUM OF 1988
ADJACENT PROPERTY OWNERS: AS NOTED
APPLICATION PREPARED BY: JOHN HILTS P.O. BOX 47, ROWAYTON, CT 06853

PROPOSED PILING-SUPPORTED BOAT LIFT IN LONG ISLAND SOUND AT 36
WALLACKS DRIVE, STAMFORD, FAIRFIELD COUNTY, CONNECTICUT
APPLICANT: 36 WALLACKS DRIVE LLC
DATE: 11/04/24 SHEET 2 OF 4 REVISION NUMBER: DATE:

EXISTING GENERAL PLAN VIEW

SCALE: 1" = 40'

PROPERTY N/F OF 18
WALLACKS DRIVE LLC
411 SOUNDVIEW AVENUE

NOTES:

1. PREPARED FROM AN A2/T2 SURVEY
REVISED TO NOVEMBER 3, 2024 BY
K&A LAND SURVEYORS AND A SITE
INSPECTION ON OCTOBER 28, 2023.
2. COASTAL JURISDICTION LIMIT (EL.
5.5'), HIGH TIDE LINE (EL. 4.6'), AND
MEAN HIGH WATER LINE (EL. 3.4'),
WHERE NOT OTHERWISE SHOWN, ARE
COINCIDENT WITH CONCRETE PIER
AND LEDGES OR BENEATH BUILDINGS.
3. REFER TO PERMIT NO. 200801981-
KB FOR EXISTING PIERS, RAMP AND
FLOATING DOCK AT SITE.
4. ALL DRAWINGS ARE INTENDED FOR
REGULATORY REVIEW ONLY.

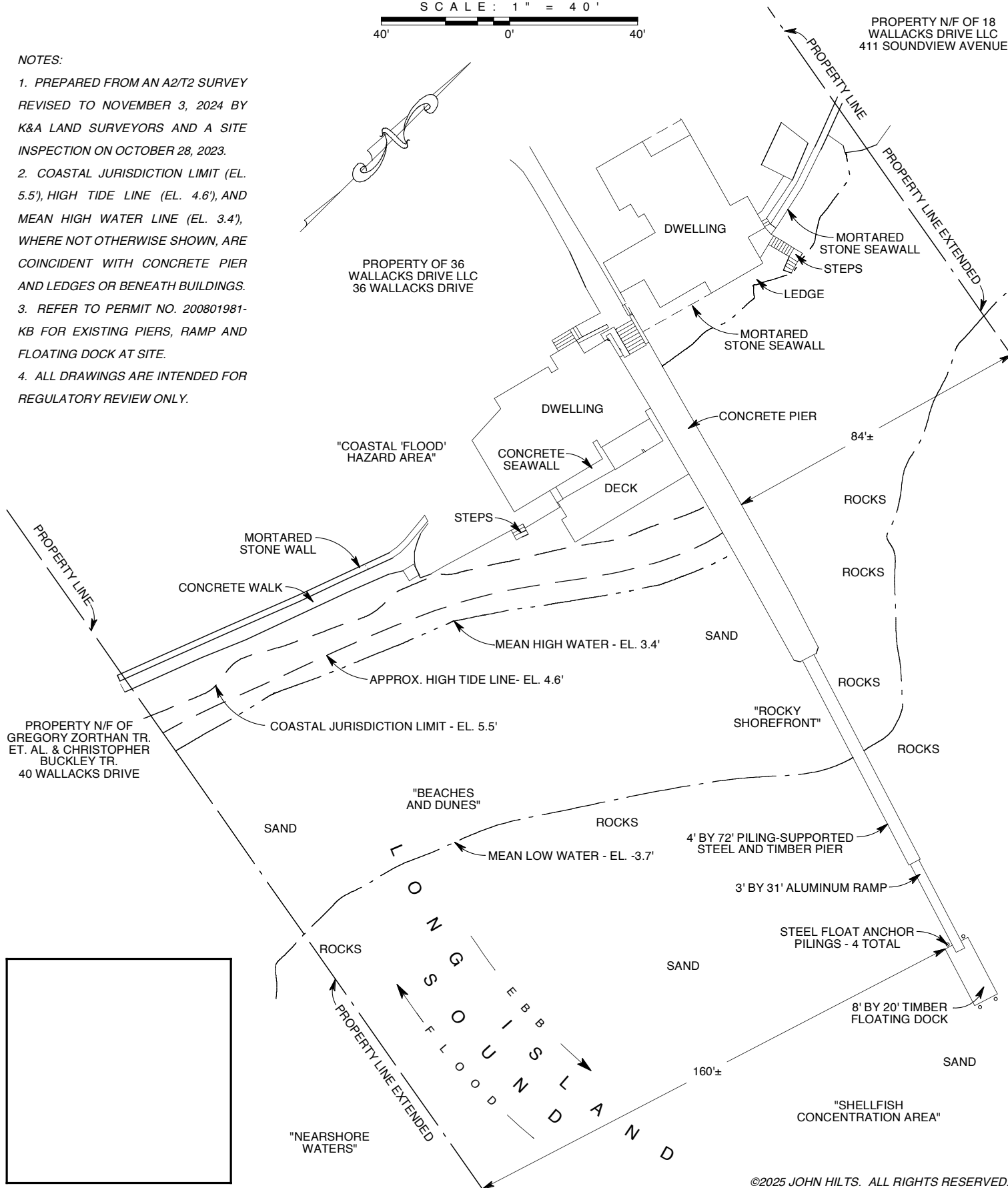

©2025 JOHN HILTS. ALL RIGHTS RESERVED.

PURPOSE: IMPROVED RECREATIONAL BOAT BERTHING
DATUM: NORTH AMERICAN VERTICAL DATUM OF 1988
ADJACENT PROPERTY OWNERS: AS NOTED
APPLICATION PREPARED BY: JOHN HILTS P.O. BOX 47, ROWAYTON, CT 06853

PROPOSED PILING-SUPPORTED BOAT LIFT IN LONG ISLAND SOUND AT 36
WALLACKS DRIVE, STAMFORD, FAIRFIELD COUNTY, CONNECTICUT
APPLICANT: 36 WALLACKS DRIVE LLC
DATE: 11/04/24 SHEET 3 OF 4 REVISION NUMBER: 1 DATE: 1/09/25

PROPOSED DETAIL PLAN VIEW

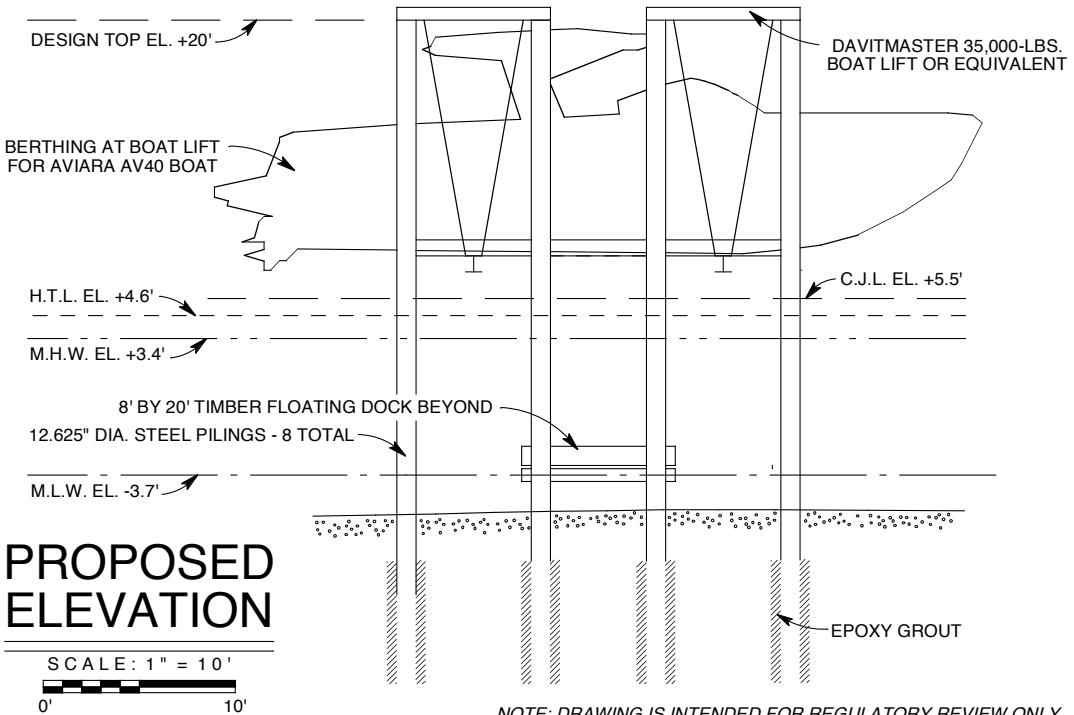
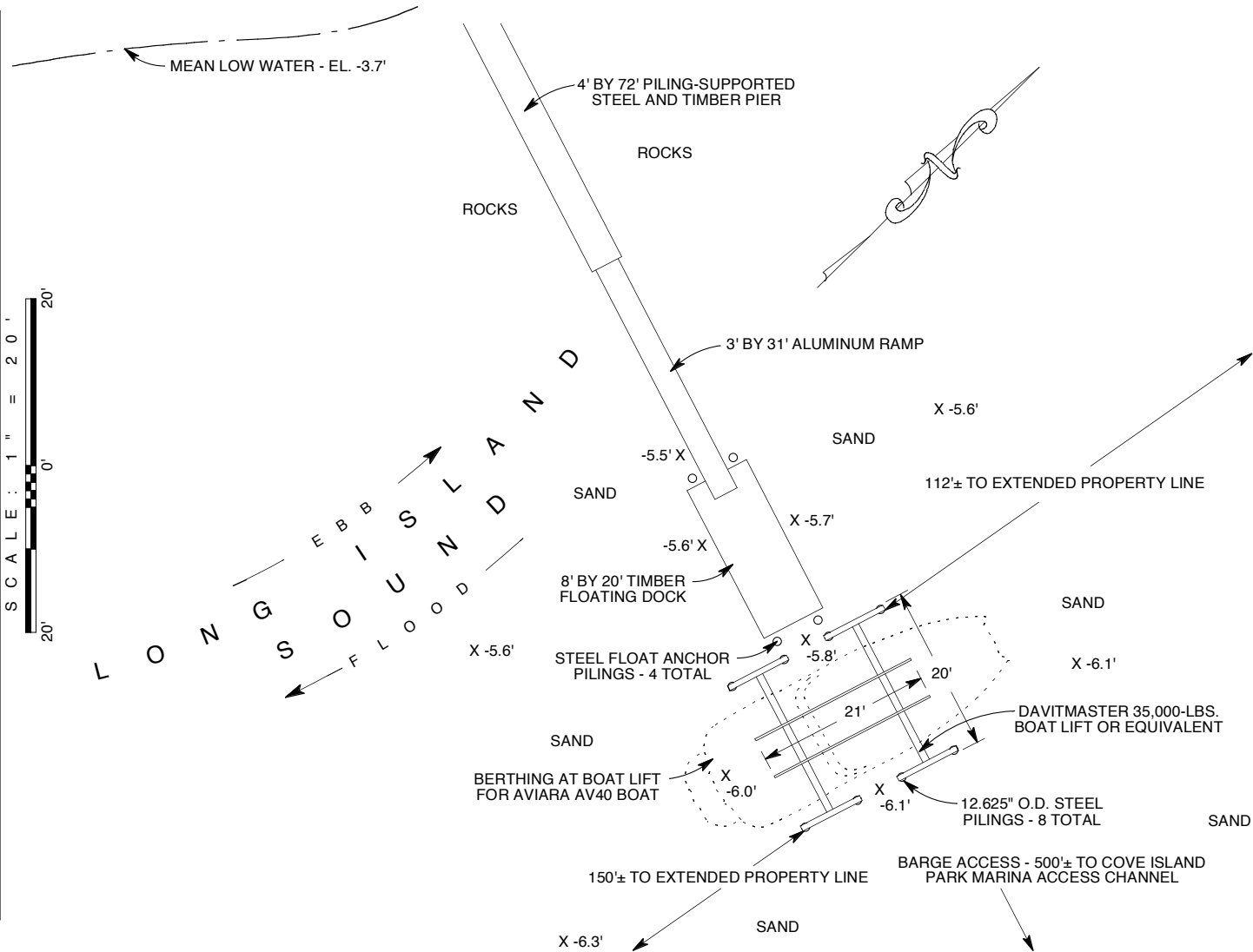

©2025 JOHN HILTS. ALL RIGHTS RESERVED.

NOTE: DRAWING IS INTENDED FOR REGULATORY REVIEW ONLY.

PURPOSE: IMPROVED RECREATIONAL BOAT BERTHING
DATUM: NORTH AMERICAN VERTICAL DATUM OF 1988
ADJACENT PROPERTY OWNERS: AS NOTED
APPLICATION PREPARED BY: JOHN HILTS P.O. BOX 47, ROWAYTON, CT 06853

PROPOSED PILING-SUPPORTED BOAT LIFT IN LONG ISLAND SOUND AT 36 WALLACKS DRIVE, STAMFORD, FAIRFIELD COUNTY, CONNECTICUT
APPLICANT: 36 WALLACKS DRIVE LLC
DATE: 11/04/24 SHEET 4 OF 4 REVISION NUMBER: 1 DATE: 1/09/25



Land Record Filing*

To: DO NOT FILE

Signature and

NOTE: Due to the electronic delivery of this license and the legal requirement to have a live signature on this document, the “Land Record Filing” as detailed in General Condition #1 will be sent to the Licensee via U.S. Mail for the Licensee to file with the city/town clerk.

Date:

Subject: _____
License # _____

If you have any questions pertaining to this matter, please contact the Land & Water Resources Division at 860-424-3019.

Return to:

~~Land & Water Resources Division
State of Connecticut
Department of Energy & Environmental Protection
79 Elm Street
Hartford, CT 06106-5127~~

*The Licensee shall file the Land Record Filing on the land records of the municipality in which the subject property is located not later than thirty (30) days after license issuance pursuant to Connecticut General Statutes (CGS) Section 22a-363g. A copy of the Notice with a stamp or other such proof of filing with the municipality shall be submitted to the Commissioner no later than sixty (60) days after license issuance.



LWRD Work Commencement Form

To: DEEP.LWRDRegulatory@ct.gov or
Regulatory Section
Department of Energy and Environmental Protection
Land & Water Resources Division
79 Elm Street
Hartford, CT 06106-5127

Licensee Name: _____

Municipality in which the project is occurring: _____

DEEP License No(s): _____

CONTRACTOR(s):

1 Name: _____
Address: _____
Telephone: _____
E-mail: _____

2 Name: _____
Address: _____
Telephone: _____
E-mail: _____

3 Name: _____
Address: _____

Date Contractor(s) received a copy
of the license and approved plans: _____

EXPECTED DATE OF COMMENCEMENT OF WORK: _____

EXPECTED DATE OF COMPLETION OF WORK: _____

LICENSEE: _____
(Signature) (Date)



Compliance Certification Form

The following certification must be signed by the licensee working in consultation with a Connecticut-licensed design professional and must be submitted to the address indicated at the end of this form within ninety (90) days of completion of the authorized work.

<p>1. Licensee Name: 36 Wallacks Drive, LLC c/o Steven Cheng _____</p> <p>DEEP License Number(s): 202411530-SDF _____</p> <p>Municipality in which project is occurring: Stamford _____</p>							
<p>2. Check one:</p> <p>(a) <input type="checkbox"/> "I certify that the final site conditions and / or structures are in general conformance with the approved site plans". Identify and describe any deviations and attach to this form.</p> <p>(b) <input type="checkbox"/> "The final site conditions and / or structures are not in general conformance with the approved site plans. The enclosed "as-built" plans note the modifications".</p>							
<p>3. "I understand that any false statement in this certification is punishable as a criminal offence under section 53a-157b of the General Statutes and under any other applicable law."</p> <table style="width: 100%;"><tr><td style="width: 50%;"><p>_____ Signature of Licensee</p></td><td style="width: 50%;"><p>_____ Date</p></td></tr><tr><td colspan="2"><p>_____ Name of Licensee (print or type)</p></td></tr><tr><td style="height: 150px; vertical-align: top;"><p>_____ Signature of CT-Licensed Design Professional</p><p>_____ Name of CT-Licensed Design Professional (print or type)</p><p>_____ Professional License Number (if applicable)</p></td><td style="vertical-align: top;"><p>_____ Date</p><div style="border: 1px solid black; width: 200px; height: 150px; margin: 10px auto; text-align: center; line-height: 150px;">Affix Stamp Here</div></td></tr></table>		<p>_____ Signature of Licensee</p>	<p>_____ Date</p>	<p>_____ Name of Licensee (print or type)</p>		<p>_____ Signature of CT-Licensed Design Professional</p> <p>_____ Name of CT-Licensed Design Professional (print or type)</p> <p>_____ Professional License Number (if applicable)</p>	<p>_____ Date</p> <div style="border: 1px solid black; width: 200px; height: 150px; margin: 10px auto; text-align: center; line-height: 150px;">Affix Stamp Here</div>
<p>_____ Signature of Licensee</p>	<p>_____ Date</p>						
<p>_____ Name of Licensee (print or type)</p>							
<p>_____ Signature of CT-Licensed Design Professional</p> <p>_____ Name of CT-Licensed Design Professional (print or type)</p> <p>_____ Professional License Number (if applicable)</p>	<p>_____ Date</p> <div style="border: 1px solid black; width: 200px; height: 150px; margin: 10px auto; text-align: center; line-height: 150px;">Affix Stamp Here</div>						
<ul style="list-style-type: none">As-built plans shall include: elevations or tidal datums, as applicable, and structures, including any proposed elevation views and cross sections included in the approved license plans. Such as-built plans shall be the original ones and be signed and sealed by an engineer, surveyor or architect, as applicable, who is licensed in the State of Connecticut.The Licensee will be notified by staff of the Land and Water Resources Division (LWRD) if further compliance review is necessary. Lack of response by LWRD staff does not imply compliance. <p>Submit this completed form to : DEEP.LWRDRegulatory@ct.gov or Regulatory Section Department of Energy and Environmental Protection Land & Water Resources Division 79 Elm Street Hartford, CT 06106-5127</p>							