



Connecticut Department of Energy and Environmental Protection License*

Inland Wetlands & Watercourses Permit

Licensee(s): Connecticut Department of
Transportation

Licensee Address(s): 2800 Berlin Turnpike
Newington, CT 06131-7546

License Number(s): 202407001

Municipality: Naugatuck

Project Description: Rehabilitation of Bridge No. 06772 for infrastructure
improvement

Project Address/Location: Route 63 over Straitsville Brook, Naugatuck, CT 06770

Waters: Straitsville Brook

**Authorizing CT Statute(s)
and/or Federal Law:** CGS Section 22a-36 to 45

**Applicable Regulations of
CT State Agencies:** 22a-39-1 to 15

Agency Contact: Land & Water Resources Division,
Bureau of Water Protection & Land Reuse, 860-424-3019

License Expiration: Five (5) years from the date of issuance of this license.

Project Site Plan Set: *Environmental Permit Plans State Project No. 0087-0148:
Rehabilitation of Bridge No. 06772 carrying Route 63 over
Straitsville Brook in the Town of Naugatuck, CT, 7 sheets, dated
May 9, 2024, and prepared by the State of Connecticut
Department of Transportation.*

*Connecticut's Uniform Administrative Procedure Act defines License to include, "the whole or part of any agency permit, certificate, approval, registration, charter or similar form of permission required by law . . ."

License Enclosures: LWRD General Conditions; Site Plan Set; LWRD Work Commencement Form; LWRD Compliance Certification Form

Authorized Activities:

The Licensee is hereby authorized to conduct the following work as described in application # 202407001 and as depicted on any site plan sheets / sets cited herein:

Temporarily and permanently impact 1670 square feet (sf) and 5250 sf of watercourse, respectively, due to the rehabilitation of Bridge No. 06772 which includes:

1. Slip lining the existing 75 ft long, 9 ft wide x 6 ft 5-inch high corrugated steel arch culvert with an 8 ft wide x 5 ft 6 inch height corrugated steel liner and secure with grout between the structures;
2. Regrading 60 linear ft of Straitsville Brook upstream of the culvert inlet by installing a minimum of 12" of natural streambed material over 12" of No. 6 crushed stone as depicted on plan sheet PMT-04;
3. Regrading 10 linear ft of Straitsville Brook downstream of the culvert outlet by installing a minimum of 12" of natural streambed material as depicted on plan sheet PMT-04;
4. Replacing the inlet headwalls and wingwalls, and outlet endwall with associated temporary stabilization measures (earth retaining system) as depicted on plan sheet PMT-04;
5. Installing a 140 ft rip rap revetment approximately 300 ft downstream from the culvert's outlet; and composed of 4 ft of heavy rip rap on 12" of modified rip rap, over 6" of No. 6 crushed stone, with natural streambed material washed in up to the 2-year water surface elevation as depicted on plan sheet PMT-05;
6. Installing a temporary crane-mat platform over Straitsville Brook and temporary 18" diameter bypass pipe for water-handling during the rip rap revetment work as depicted on plan sheet PMT-05; and
7. Installing temporary cofferdams and a temporary 18" diameter bypass pipe for water-handling during the culvert rehabilitation work as depicted on plan sheet PMT-06.

Failure to comply with the terms and conditions of this license shall subject the Licensee and / or the Licensee's contractor(s) to enforcement actions and penalties as provided by law.

This license is subject to the following Terms and Conditions:

1. **License Enclosure(s) and Conditions.** The Licensee shall comply with all applicable terms and conditions as may be stipulated within the License Enclosure(s) listed above.
2. **Discharge of Materials.** At no time shall the Licensee allow grout or low strength material to discharge into Straitsville Brook.

3. **Natural Streambed Material.** The Licensee shall stockpile and contain natural streambed material with a sedimentation control system that is excavated during the pipe relining, rip rap installation, and channel regrading components of the project.
4. **Washing in of Natural Streambed Material.** The Licensee shall wash in natural streambed material up to the 2-year surface elevation within the proposed rip rap revetment as described in Authorized Activity 5.
5. **Large Boulder Stockpiling.** The Licensee shall temporarily stockpile and restore large stones/boulders removed from the immediate downstream side of the bridge during Authorized Activity 3 as described on plan sheet PMT-04 of the site plan set.
6. **Invasive Species Management.** The Licensee shall manage invasive species within the clearing limits and impact areas, including but not limited to Japanese barberry (*Berberis thunbergia*), Japanese knotweed (*Reynoutria japonica*), Oriental bittersweet (*Celastrus orbiculatus*), mugwort (*Artemisia vulgaris*), and multiflora rose (*Rosa multiflora*), as depicted on plan sheet PMT-07 of the site plan set.
7. **Management of Materials.** All wastewaters produced from the cleaning, preparation, and/or installation for slip-lining shall be managed in accordance with all federal, state, and local requirements, including Chapter 446K Water Pollution Control, Chapter 445 Hazardous Waste, and Chapter 446d Solid Waste of the Connecticut General Statutes.
8. **Temporary Removal of Bypass Pipe.** For any storm (greater or equal to the 2-year event) predicted to occur on the project site, the Licensee shall halt all activities within Straitsville Brook and remove the 18” temporary bypass pipe at both the existing arch culvert and proposed rip rap revetment locations to allow adequate flow to pass through the channel. The Licensee shall also make sure that the proper sedimentation and erosion control measures are secured after removal of the temporary water-handling systems. The Licensee shall restore any damaged or compromised sedimentation and erosion controls after the storm event and then may resume construction.

Issued under the authority of the Commissioner of Energy and Environmental Protection on:

Date

Emma Cimino
Deputy Commissioner
Environmental Quality Branch

LWRD General Conditions

- 1. Land Record Filing (for Structures Dredging & Fill, Tidal Wetlands, Certificate of Permission, and Long Island Sound General Permit Licenses only).** The Licensee shall file the Land Record Filing on the land records of the municipality in which the subject property is located not later than thirty (30) days after license issuance pursuant to Connecticut General Statutes (CGS) Section 22a-363g. A copy of the Notice with a stamp or other such proof of filing with the municipality shall be submitted to DEEP.LWRDRegulatory@ct.gov no later than sixty (60) days after license issuance. If a Land Record Filing form is not enclosed and the work site is not associated with an upland property, no filing is required.
- 2. Contractor Notification.** The Licensee shall give a copy of the license and its attachments to the contractor(s) who will be carrying out the authorized activities prior to the start of construction and shall receive a written receipt for such copy, signed and dated by such contractor(s). The Licensee's contractor(s) shall conduct all operations at the site in full compliance with the license and, to the extent provided by law, may be held liable for any violation of the terms and conditions of the license. At the work site, the contractor(s) shall, whenever work is being performed, have on site and make available for inspection a copy of the license and the authorized plans.
- 3. Work Commencement¹.** Not later than two (2) weeks prior to the commencement of any work authorized herein, the Licensee shall submit to DEEP.LWRDRegulatory@ct.gov, on the Work Commencement Form attached hereto, the name(s) and address(es) of all contractor(s) employed to conduct such work and the expected date for commencement and completion of such work, if any.
 - For water diversion activities authorized pursuant to 22a-377(c)-1 of the Regulations of Connecticut State Agencies, the Licensee shall also notify the Commissioner in writing two weeks prior to initiating the authorized diversion.
 - For emergency activities authorized pursuant Connecticut General Statutes Section 22a-6k, the Licensee shall notify the Commissioner, in writing, of activity commencement at least one (1) day prior to construction and of activity completion no later than five (5) days after conclusion.
- 4. For Coastal Licenses Only - License Notice.** The Licensee shall post the first page of the License in a conspicuous place at the work area while the work authorized therein is undertaken.
- 5. Unauthorized Activities.** Except as specifically authorized, no equipment or material, including but not limited to, fill, construction materials, excavated material or debris, shall be

¹ The Work Commencement condition and the need for a Work Commencement Form is not applicable to Flood Management Certification approvals.

deposited, placed or stored in any wetland or watercourse on or off-site. The Licensee may not conduct work within wetlands or watercourses other than as specifically authorized, unless otherwise authorized in writing by the Commissioner. Tidal wetlands means “wetland” as defined by section 22a-29 and “freshwater wetlands and watercourses” means “wetlands” and “watercourses” as defined by section 22a-38.

- 6. Management of Materials.** Any materials removed from the site shall be managed in accordance with all federal, state, and local requirements, including Chapter 446K Water Pollution Control, Chapter 445 Hazardous Waste, and Chapter 446d Solid Waste of the Connecticut General Statutes.
- 7. Unconfined Instream Work.** Unless otherwise noted in a condition of the license, the following conditions apply to projects in non-coastal waters:

 - Unconfined instream work is limited to the period June 1 through September 30.
 - Confinement of a work area by cofferdam techniques using sand bag placement, sheet pile installation (vibratory method only), portadam, or similar confinement devices is allowed any time of the year. The removal of such confinement devices is allowed any time of the year.
 - Once a work area has been confined, in-water work within the confined area is allowed any time of the year.
 - The confinement technique used shall completely isolate and protect the confined area from all flowing water. The use of silt boom/curtain or similar technique as a means for confinement is prohibited.
- 8. For State Actions Only - Material or Equipment Storage in the Floodplain.** Unless approved by a Flood Management Exemption, the storage of any materials at the site which are buoyant, hazardous, flammable, explosive, soluble, expansive, radioactive, or which could in the event of a flood be injurious to human, animal or plant life, below the elevation of the five-hundred (500) year flood is prohibited. Any other material or equipment stored at the site below said elevation by the Licensee or the Licensee's contractor must be firmly anchored, restrained or enclosed to prevent flotation. The quantity of fuel stored below such elevation for equipment used at the site shall not exceed the quantity of fuel that is expected to be used by such equipment in one day. In accordance with the licensee’s Flood Contingency Plan, the Licensee shall remove equipment and materials from the floodplain during periods when flood warnings have been issued or are anticipated by a responsible federal, state or local agency. It shall be the Licensee’s responsibility to obtain such warnings when flooding is anticipated.
- 9. Temporary Hydraulic Facilities for Water Handling.** If not reviewed and approved as a part of the license application, temporary hydraulic facilities shall be designed by a qualified professional and in accordance with the *Connecticut Guidelines for Soil Erosion and Sediment Control*, the *2004 Connecticut Stormwater Quality Manual*, or the *Department of Transportation’s ConnDOT Drainage Manual*, as applicable. Temporary hydraulic facilities may include channels, culverts or bridges which are required for haul roads, channel relocations, culvert installations, bridge construction, temporary roads, or detours.

- 10. Excavated Materials.** Unless otherwise authorized, all excavated material shall be staged and managed in a manner which prevents additional impacts to wetlands and watercourses.
- 11. Best Management Practices.** The Licensee shall not cause or allow pollution of any wetlands or watercourses, including pollution resulting from sedimentation and erosion. In constructing or maintaining any authorized structure or facility or conducting any authorized activity, or in removing any such structure or facility, the Licensee shall employ best management practices to control storm water discharges, to prevent erosion and sedimentation, and to otherwise prevent pollution of wetlands and other waters of the State. For purposes of the license, “pollution” means “pollution” as that term is defined by CGS section 22a-423. Best Management Practices include, but are not limited, to practices identified in the *Connecticut Guidelines for Soil Erosion and Sediment Control* as revised, *2004 Connecticut Stormwater Quality Manual*, Department of Transportation’s *ConnDOT Drainage Manual* as revised, and the Department of Transportation Standard Specifications as revised.
- 12. In-Water Work Vessel Staging and Storage. (for Structures Dredging & Fill, Tidal Wetlands, Certificate of Permission, and Long Island Sound General Permit Licenses only).** For any barge, vessel, skiff or floating work platform (“work vessels”) utilized in the execution of the work authorized herein, the Licensee shall ensure that such work vessels:
- do not rest on, or come in contact with, the substrate at any time, unless specifically authorized in the license.
 - are not stored over intertidal flats, submerged aquatic vegetation or tidal wetland vegetation or in a location that interferes with navigation. In the event any work vessel is grounded, no dragging or prop dredging shall occur to free it.
- 13. Work Site Restoration.** Upon completion of any authorized work, the Licensee shall restore all areas impacted by construction, or used as a staging area or accessway in connection with such work, to their condition prior to the commencement of such work.
- 14. Inspection.** The Licensee shall allow any representative of the Commissioner to inspect the project location at reasonable times to ensure that work is being or has been conducted in accordance with the terms and conditions of this license.
- 15. Change of Use. (Applies only if a use is specified within the License “Project Description”)**
- a. The work specified in the license is authorized solely for the purpose set forth in the license. No change in purpose or use of the authorized work or facilities as set forth in the license may occur without the prior written approval of the Commissioner. The Licensee shall, prior to undertaking or allowing any change in use or purpose from that which is authorized by this license, request permission from the Commissioner for such change. Said request shall be in writing and shall describe the proposed change and the reason for the change.
 - b. A change in the form of ownership of any structure authorized herein from a rental/lease commercial marina to a wholly-owned common interest community or dockominium may constitute a change in purpose as specified in paragraph (a) above.
- 16. De Minimis Alteration.** The Licensee shall not deviate from the authorized activity without

prior written approval from the Commissioner. The Licensee may request a de minimis change to any authorized structure, facility, or activity. A de minimis alteration means a change in the authorized design, construction or operation that individually and cumulatively has minimal additional environmental impact and does not substantively alter the project as authorized.

- For diversion activities authorized pursuant to 22a-377(c)-2 of the Regulations of Connecticut State Agencies, a de minimis alteration means an alteration which does not significantly increase the quantity of water diverted or significantly change the capacity to divert water.

17. Extension Request. The Licensee may request an extension of the license expiration date. Such request shall be in writing and shall be submitted to DEEP.LWRDRegulatory@ct.gov at least thirty (30) days prior to the license expiration. Such request shall describe the work done to date, what work still needs to be completed, and the reason for such extension. The Commissioner may extend the expiration date of this license for a period of up to one year, in order for the Licensee to complete the authorized activities. It shall be at the Commissioner's sole discretion to grant or deny such request. No more than three (3) one-year extensions will be granted under this license.

18. Compliance Certification. Not later than 90 days after completion of the authorized work, the Licensee shall prepare and submit to DEEP.LWRDRegulatory@ct.gov, the attached Compliance Certification Form. Such Compliance Certification shall be completed, signed, and sealed by the Licensee and a Connecticut Licensed Design Professional. If non-compliance is indicated on the form, or the Commissioner has reason to believe the activities and/or structures were conducted in non-compliance with the license, the Commissioner may require the Licensee to submit as-built plans as a condition of this license.

19. Maintenance. The Licensee shall maintain all authorized structures or work in optimal condition or shall remove such structures or facility and restore the affected waters to their pre-work condition. Any such maintenance or removal activity shall be conducted in accordance with applicable law and any additional approvals required by law.

20. No Work After License Expiration. Work conducted after the license expiration date is a violation of the license and may subject the licensee to enforcement action, including penalties, as provided by law.

21. License Transfer. The license is not transferable without prior written authorization of the Commissioner. A request to transfer a license shall be submitted in writing and shall describe the proposed transfer and the reason for such transfer. The Licensee's obligations under the license shall not be affected by the passage of title to the license site to any other person or municipality until such time as a transfer is approved by the Commissioner.

22. Document Submission. Any document required to be submitted to the Commissioner under the license or any contact required to be made with the Commissioner shall, unless otherwise specified in writing by the Commissioner, be directed to:

DEEP.LWRDRegulatory@ct.gov or

Regulatory Section
Land & Water Resources Division
Department of Energy and Environmental Protection
79 Elm Street
Hartford, Connecticut 06106-5127
860-424-3019

- 23. Date of Document Submission.** The date of submission to the Commissioner of any document required by the license shall be the date such document is received by the Commissioner. The date of any notice by the Commissioner under the license, including but not limited to notice of approval or disapproval of any document or other action, shall be the date such notice is personally delivered or the date three (3) days after it is mailed by the Commissioner, whichever is earlier. Except as otherwise specified in the license, the word “day” as used in the license means calendar day. Any document or action which is required by the license to be submitted or performed by a date which falls on a Saturday, Sunday or a Connecticut or federal holiday shall be submitted or performed on or before the next day which is not a Saturday, Sunday, or a Connecticut or federal holiday.
- 24. Certification of Documents.** Any document, including but not limited to any notice, which is required to be submitted to the Commissioner under the license shall be signed by the Licensee and by the individual or individuals responsible for actually preparing such document, each of whom shall certify in writing as follows: “I have personally examined and am familiar with the information submitted in this document and all attachments and certify that based on reasonable investigation, including my inquiry of those individuals responsible for obtaining the information, the submitted information is true, accurate and complete to the best of my knowledge and belief, and I understand that any false statement made in this document or its attachments may be punishable as a criminal offense.”
- 25. Accuracy of Documentation.** In evaluating the application for the license, the Commissioner has relied on information and data provided by the Licensee and on the Licensee’s representations concerning site conditions, design specifications and the proposed work, including but not limited to representations concerning the commercial, public or private nature of the work or structures, the water-dependency of said work or structures, its availability for access by the general public, and the ownership of regulated structures or filled areas. If such information proves to be false, deceptive, incomplete or inaccurate, the license may be modified, suspended or revoked, and any unauthorized activities may be subject to enforcement action.
- 26. Limits of Liability.** In granting the license, the Commissioner has relied on all representations of the Licensee, including information and data provided in support of the Licensee’s application. Neither the Licensee’s representations nor the issuance of the license shall constitute an assurance by the Commissioner as to the structural integrity, the engineering feasibility or the efficacy of such design.
- 27. Reporting of Violations.** In the event that the Licensee becomes aware that they did not or may not comply, or did not or may not comply on time, with any provision of this license or of any document incorporated into the license, the Licensee shall immediately notify the

agency contact specified within the license and shall take all reasonable steps to ensure that any noncompliance or delay is avoided or, if unavoidable, is minimized to the greatest extent possible. In so notifying the agency contact, the Licensee shall provide, for the agency's review and written approval, a report including the following information:

- a. the provision(s) of the license that has been violated;
- b. the date and time the violation(s) was first observed and by whom;
- c. the cause of the violation(s), if known;
- d. if the violation(s) has ceased, the duration of the violation(s) and the exact date(s) and times(s) it was corrected;
- e. if the violation(s) has not ceased, the anticipated date when it will be corrected;
- f. steps taken and steps planned to prevent a reoccurrence of the violation(s) and the date(s) such steps were implemented or will be implemented; and
- g. the signatures of the Licensee and of the individual(s) responsible for actually preparing such report.

If the violation occurs outside of normal business hours, the Licensee shall contact the Department of Energy and Environmental Protection Emergency Dispatch at 860-424-3333. The Licensee shall comply with any dates which may be approved in writing by the Commissioner.

- 28. Revocation/Suspension/Modification.** The license may be revoked, suspended, or modified in accordance with applicable law.
- 29. Other Required Approvals.** License issuance does not relieve the Licensee of their obligations to obtain any other approvals required by applicable federal, state and local law.
- 30. Rights.** The license is subject to and does not derogate any present or future property rights or powers of the State of Connecticut, and conveys no property rights in real estate or material nor any exclusive privileges, and is further subject to any and all public and private rights and to any federal, state or local laws or regulations pertinent to the property or activity affected hereby.
- 31. Condition Conflicts.** In the case where a project specific special condition listed on the license differs from, or conflicts with, one of the general conditions listed herein, the project specific special condition language shall prevail. It is the licensee's responsibility to contact the agency contact person listed on the license for clarification if needed prior to conducting any further regulated activities.

ENVIRONMENTAL PERMIT PLANS STATE PROJECT NO. 0087-0148 REHABILITATION OF BRIDGE NO. 06772 CARRYING ROUTE 63 OVER STRAITSVILLE BROOK IN THE TOWN OF NAUGATUCK, CT

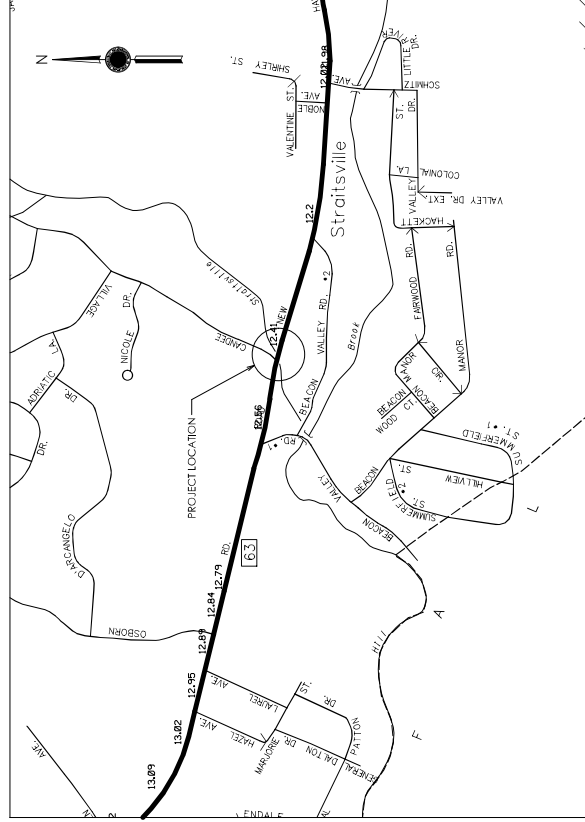
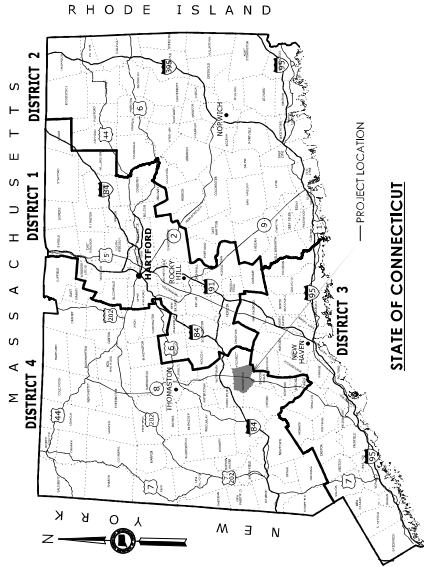

LOCATION PLAN
1" = 800'

DRAWING NO.	DRAWING TITLE
PM1-01	TITLE SHEET
PM1-02	GENERAL SITE PLAN
PM1-03	WETLAND WATERCOURSE IMPACT PLAN
PM1-04	ELEVATIONS AND SECTION PLAN
PM1-05	REVELMENT SECTION PLAN
PM1-06	PERMIT HANDLING PLAN
PM1-07	PERMIT PLANNING PLAN

GENERAL NOTES

1. THESE PLANS ARE NOT FOR CONSTRUCTION AND ARE INTENDED ONLY FOR ENVIRONMENTAL PERMITTING PURPOSES. THESE PLANS INCLUDE INFORMATION FOR ALL ACTIVITIES CONCERNING THE REGULATED AREA FOR DETAILED PLANNING INFORMATION AND PAYMENT REFER TO THE APPLICABLE CONTRACT DOCUMENTS.
2. THE DEPARTMENT OF TRANSPORTATION WILL ONLY SUBMIT REVISIONS TO THE PLANS FOR CORRECTIONS OF CLERICAL MISTAKES AND CHANGES TO THE DESIGN THAT WILL EFFECT THE REGULATED AREA.
3. FOR A DESCRIPTION OF THE WATERCOURSE, WETLANDS, AND WETLAND SOILS, SEE RELEVANT SECTIONS OF THE PERMIT APPLICATION.
4. 400 FOOT GRID BASED ON CONNECTICUT COORDINATE SYSTEM N.A.D. 1927 VERTICAL DATUM BASED ON NGVD OF 1929.
5. ALL CONSTRUCTION ACTIVITIES WILL BE CONDUCTED IN ACCORDANCE WITH THE DEPARTMENT OF TRANSPORTATION'S STANDARD SPECIFICATIONS AND INCIDENTAL CONSTRUCTION FORM 18, SECTION 110 AND WILL ALSO FOLLOW REQUIRED BEST MANAGEMENT PRACTICES (BMPs) AND SEDIMENT CONTROL MEASURES AS REQUIRED BY THE DEPARTMENT OF TRANSPORTATION AND SEPTERATION CONTROL GUIDELINES AND THE 2004 STORMWATER QUALITY MANUAL.

ENVIRONMENTAL PERMIT PLANS
PLAN DATE: May 9, 2024

PROJECT NUMBER: 0087-0148 PROJECT DESCRIPTION: REHABILITATION OF BRIDGE NO. 06772 CARRYING ROUTE 63 OVER STRAITSVILLE BROOK TOWN: NAUGATUCK DRAWING TITLE: TITLE SHEET	DRAWING NO.: PM1-01 SHEET NO.: 001 OF 001
	STATE OF CONNECTICUT DEPARTMENT OF TRANSPORTATION
REVISIONS NO. DATE DESCRIPTION	REVISIONS NO. DATE DESCRIPTION
DRAWN BY: [Name] CHECKED BY: [Name] DATE: 5/9/2024	REVISIONS NO. DATE DESCRIPTION

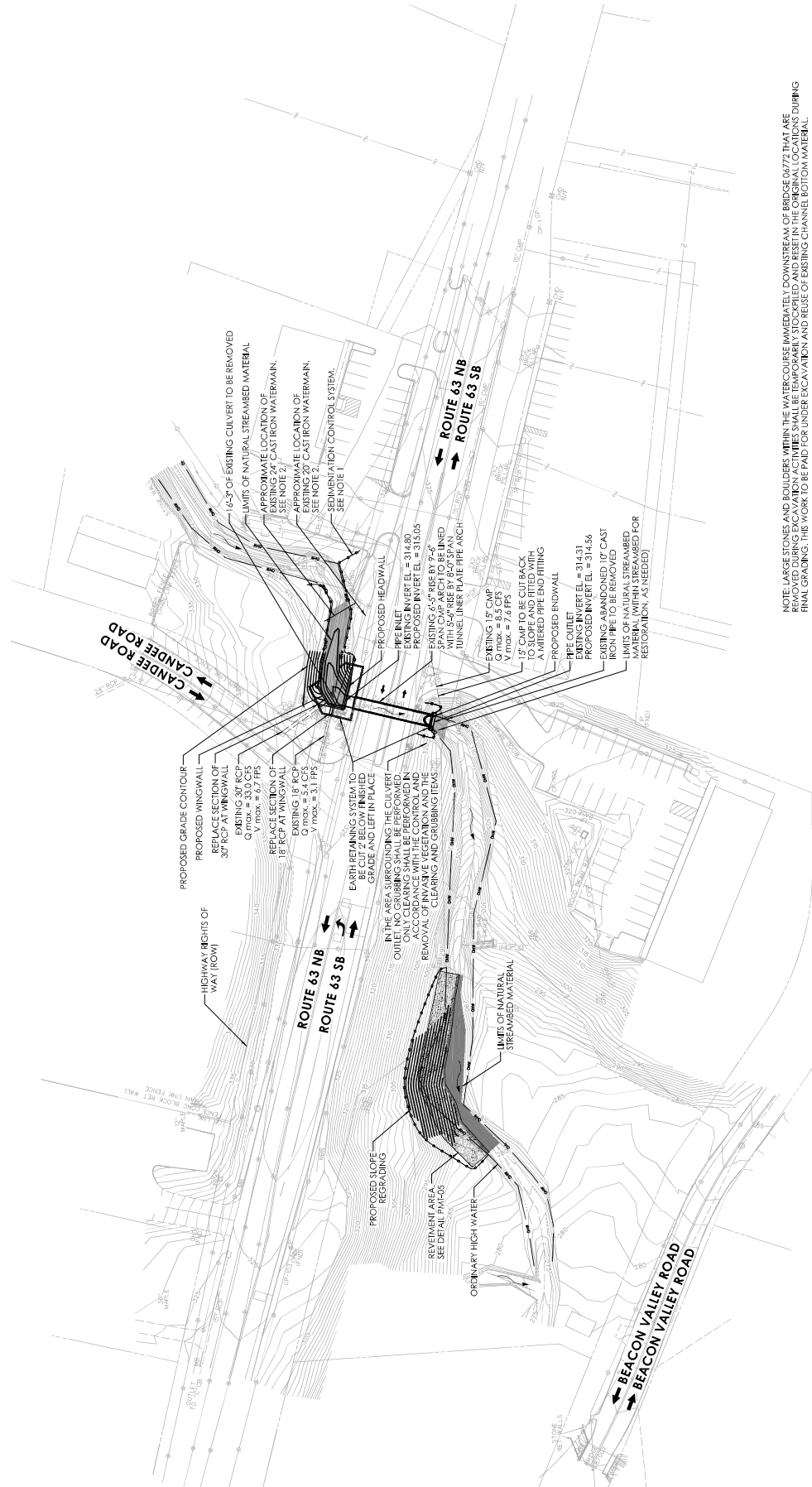
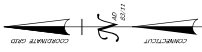

NOTE: LARGE STONES AND BOULDERS WITHIN THE WATERCOURSE IMMEDIATELY DOWNSTREAM OF BRIDGE 06772 THAT ARE BEING REMOVED DURING THE RESTORATION WORK SHALL BE TEMPORARILY STORED AT THE ORIGINAL LOCATION DURING BRIDGE CONSTRUCTION. THE COST OF THIS STORAGE AND REUSE OF EXISTING CHANNEL BOTTOM MATERIAL.

BRIDGE NO. 06772 GENERAL SITE PLAN
SCALE: 1" = 40'

NOTES:

1. SYSTEM SHALL BE LOCATED ON RESTORATION CONTROL SYSTEM WITHIN THE CONTROL AREA.
2. LOCATION OF EXISTING WATERMANS ARE UNKNOWN IF ENCOUNTERED DURING CONSTRUCTION THE ABANDONED WATERMANS WITHIN THE REGULATED AREA WILL BE RESTORED WITH NATURAL STREAMBED MATERIAL.
3. SEDIMENTATION CONTROL SYSTEM TO BE PLACED AT CATCH BASIN(S) AS NEEDED OR AS DIRECTED BY THE ENGINEER.

LEGEND

- DWM
- ORDINARY HIGH WATER
- SURVEYED EDGE OF WATER
- SEDIMENTATION CONTROL SYSTEM

REV	DATE	REVISION DESCRIPTION

PROJECT NUMBER: 058224148
 PROJECT DESCRIPTION: REHABILITATION OF BRIDGE NO. 06772 CARRYING ROUTE 63 OVER STRAITSVILLE BROOK
 TOWNSHIP: NAUGATUCK
 DRAWING TITLE: GENERAL SITE PLAN

STATE OF CONNECTICUT
 DEPARTMENT OF TRANSPORTATION

DESIGNED BY: JAS
 CHECKED BY: JAS
 DATE: 5/17/2024

PROJECT NO. PM1-02
 SHEET NO.

ENVIRONMENTAL PERMIT PLANS
 PLAN DATE: May 9, 2024

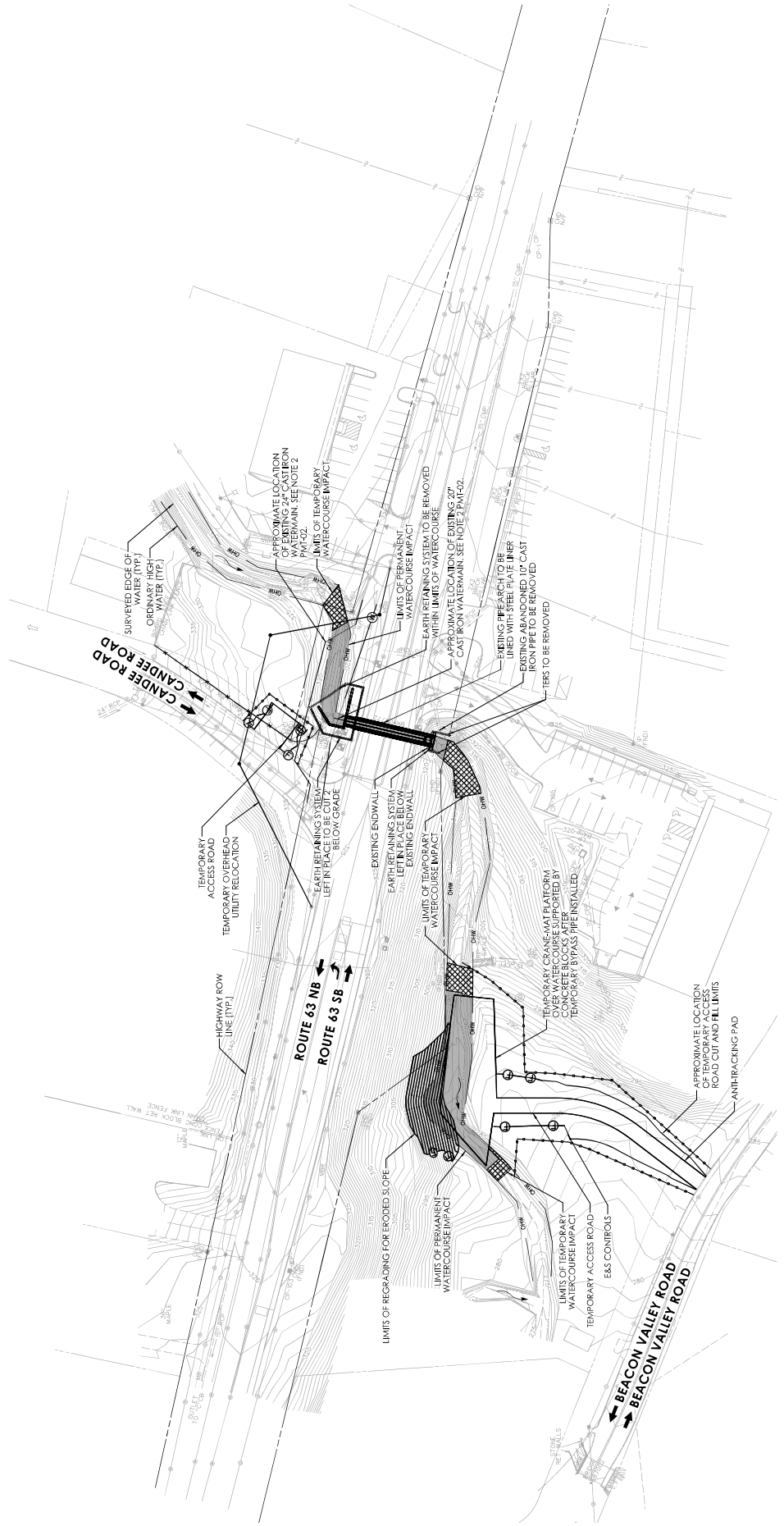
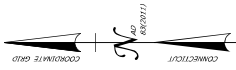

WETLAND/WATERCOURSE IMPACT TABLE			
	WETLAND IMPACTS	WATERCOURSE IMPACTS	TOTAL
PERMANENT IMPACTS	0 S.F. (0 AC.)	5250 S.F. (0.121 AC.)	5250 S.F. (0.121 AC.)
TEMPORARY IMPACTS	0 S.F. (0 AC.)	1670 S.F. (0.038 AC.)	1670 S.F. (0.038 AC.)
TOTAL IMPACTS	0 S.F. (0 AC.)	6920 S.F. (0.159 AC.)	6920 S.F. (0.159 AC.)

BRIDGE NO. 06772 IMPACT PLAN
SCALE: 1" = 40'

NOTE:
THE CONTRACTOR SHALL NOT WORK WITHIN THE LIMITS OF THE WETLANDS AND WATERCOURSE WITH THE EXISTING PERMANENT IMPACTS TO THE WETLANDS AND WATERCOURSE. ALL DISTURBED AREAS SHALL BE RESTORED.

LEGEND

	TEMPORARY WETLAND/WATERCOURSE IMPACT
	PERMANENT WETLAND/WATERCOURSE IMPACT

ENVIRONMENTAL PERMIT PLANS
PLAN DATE: May 9, 2024

PROJECT NUMBER: 035224148	PROJECT DESCRIPTION: REHABILITATION OF BRIDGE NO. 06772 CARRYING ROUTE 63 OVER STRAITSVILLE BROOK TOWARD NAUGATUCK DRAWINGS TITLE: WATERCOURSE IMPACT PLAN
STATE OF CONNECTICUT DEPARTMENT OF TRANSPORTATION	DESIGNED BY: JAS
REVIEWED BY: JAS	CHECKED BY: JAS
DATE: 5/9/2024	DATE: 5/9/2024

HYDRAULIC DATA	
DRAINAGE AREA	0.69 SQ. MILE
DESIGN FREQUENCY	50 YEAR
DESIGN DISCHARGE	220 CFS
UPSTREAM AVERAGE DAILY FLOW ELEVATION	315.4 FT
DOWNSTREAM AVERAGE DAILY FLOW ELEVATION	306.9 FT
UPSTREAM DESIGN WATER SURFACE ELEVATION	320.6 FT
DOWNSTREAM DESIGN ELEVATION	311.4 FT

NATIVE STREAMBED MATERIAL NOTES:

1. NATIVE STREAMBED MATERIAL EXCAVATED DURING THE PIPE REPAIR INSTALLATION AND CHANNEL REGRADING SHALL REMAIN IN PLACE AND CHANNEL REGRADING SHALL BE REPAIRED AS NECESSARY TO THE DEPTH SHOWN ON THE PLANS OR AS DIRECTED BY THE ENGINEER IN ACCORDANCE WITH THE STANDARD SPECIFICATIONS FOR CONSTRUCTION OF CHANNEL BOTTOM MATERIAL. SOIL AND REUSE OF EXISTING STREAMBED MATERIAL.
2. ADDITIONAL STREAMBED MATERIAL IS REQUIRED TO BE IN ACCORDANCE WITH SPECIAL PROVISION SUPPLEMENTAL STREAMBED CHANNEL MATERIAL.
3. THE STOCKPILE SHALL BE LOCATED OUTSIDE THE WETLAND LIMITS AND PROTECTED WITH SEDIMENTATION CONTROL SYSTEM.
4. LARGE STONES AND BOULDERS WITHIN THE WATERCOURSE IMMEDIATELY DOWNSTREAM OF BRIDGE 06772 THAT ARE REMOVED DURING THE REPAIR WORK SHALL BE STORED IN A STOCKPILE TO BE REUSED IN THE ORIGINAL LOCATIONS DURING FINAL GRADING. THIS WORK TO BE PAID FOR UNDER EXCAVATION AND RELIEF OF EXISTING CHANNEL BOTTOM MATERIAL.

OPENNESS RATIO (OR):

OR = OPEN AREA / STRUCTURE LENGTH
 OR = 23.335 / 17.9 FT = 0.31
 0.31 FT < 0.02 FT (RECOMMENDED MIN.)

BANKFULL WIDTH (BFW):

BFW = 102 FT
 12.6 BFW / 4.3 FT
 12.3 FT > 6.1 FT PROPOSED CULVERT SPAN*

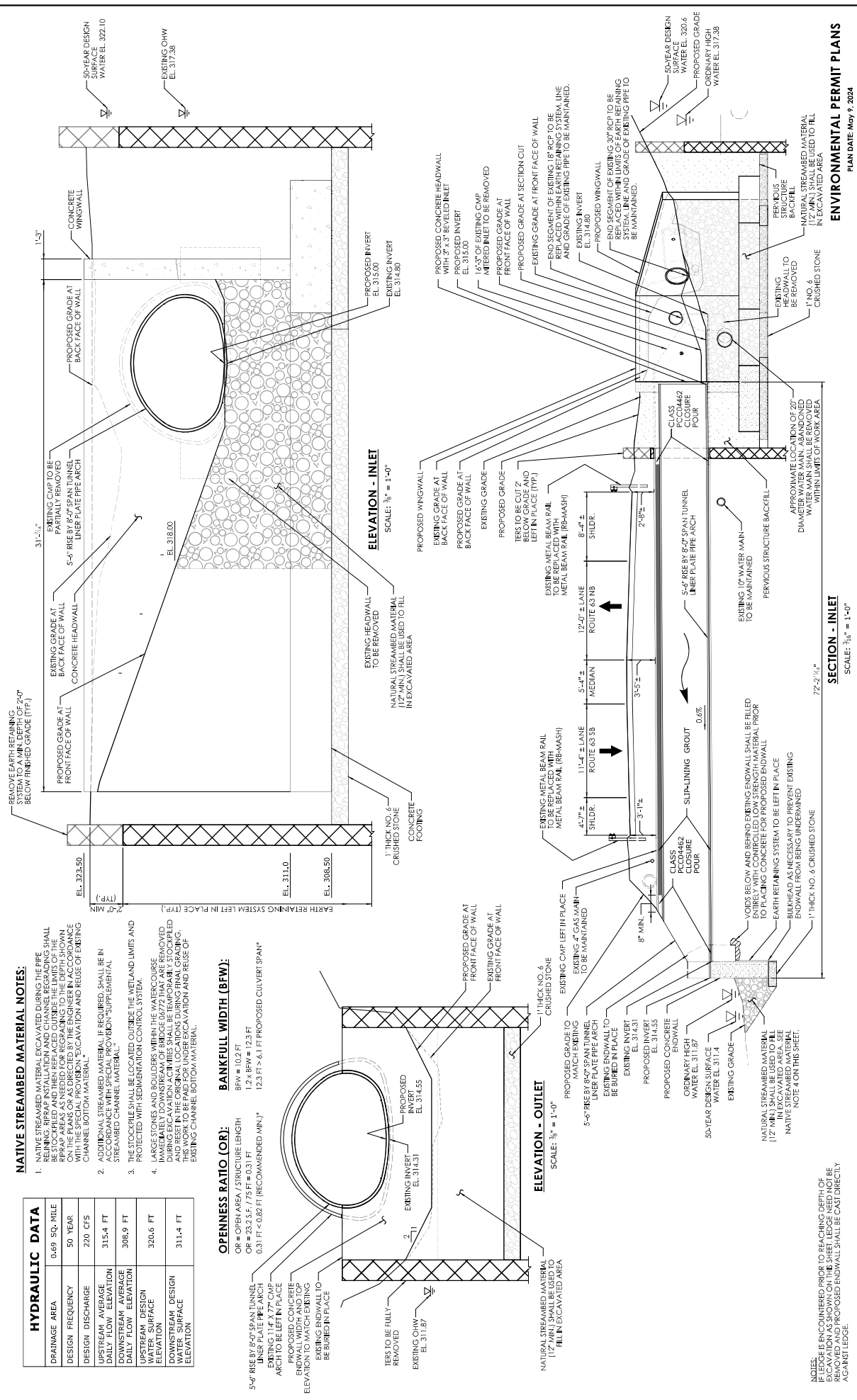

NOTES:
 IF EDGE IS ENCOUNTERED PRIOR TO REACHING DEPTH OF EXCAVATION AS SHOWN ON THIS SHEET, EDGE NEED NOT BE EXCAVATED. PROPOSED ENDWALL SHALL BE CAST DIRECTLY AGAINST LEDGE.

SECTION - INLET
 SCALE: 3/8" = 1'-0"

ENVIRONMENTAL PERMIT PLANS
 PLAN DATE: May 9, 2024

PROJECT NUMBER: 03522418
 PROJECT DESCRIPTION: REHABILITATION OF BRIDGE NO. 06772 CARRYING ROUTE 63 OVER STRAITSVILLE BROOK
 TOWNSHIP: NAUGATUCK
 DRAWING TITLE: ELEVATION AND SECTION PLAN

STATE OF CONNECTICUT
 DEPARTMENT OF TRANSPORTATION

DESIGNER: [Firm Name]
 CHECKED BY: [Name]
 DATE: [Date]

SCALE: 3/8" = 1'-0"

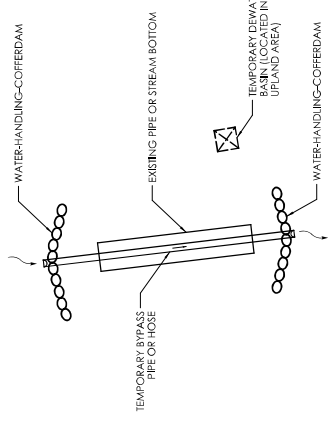

TEMPORARY PIPE
(NOT TO SCALE)

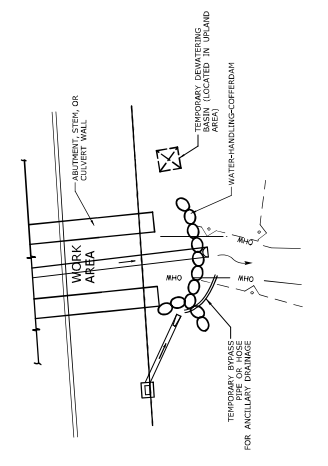

ANCILLARY STORM DRAINAGE NEAR WORK AREA
(NOT TO SCALE)

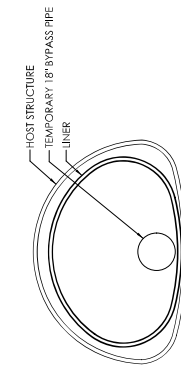

WATER HANDLING
SCALE: N.T.S.

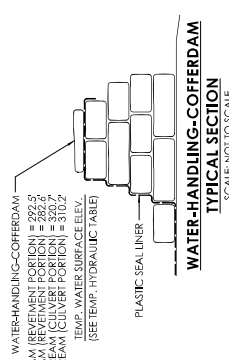

WATER-HANDLING-COFFERDAM
TYPICAL SECTION
SCALE: NOT TO SCALE

TEMPORARY HYDRAULIC DATA	
AVERAGE DAILY FLOW	1.3 CFS
AVERAGE SPRING FLOW	2.5 CFS
2-YEAR FREQUENCY DISCHARGE	45 CFS
TEMPORARY DESIGN FREQUENCY	3 X A.S.F.
LOW FLOW PUMPING	7.5 CFS
TEMPORARY DESIGN DISCHARGE	7.5 CFS
GRAVITY FLOW BYPASS PIPE	7.5 CFS
TEMPORARY DESIGN DISCHARGE	7.5 CFS
UPSTREAM WATER SURFACE ELEVATION (CULVERT PORTION)	319.7 FT
DOWNSTREAM WATER SURFACE ELEVATION (CULVERT PORTION)	309.2 FT
UPSTREAM WATER SURFACE ELEVATION (REVEMENT PORTION)	291.5 FT
DOWNSTREAM WATER SURFACE ELEVATION (REVEMENT PORTION)	280.5 FT

NOTES:
1. TABLE APPLICABLE FOR BOTH CULVERT AND WATER HANDLING.
2. VALUES AND ELEVATIONS MAY VARY SLIGHTLY FROM THE CONTRACT PLANS.

SUGGESTED CONSTRUCTION SEQUENCE - SLOPE REVETMENT

1. INSTALL SEDIMENTATION CONTROL SYSTEM.
2. PERFORM CLEARING AND GRUBBING AND CONTROL AND REMOVAL OF INVASIVE VEGETATION.
3. CONSTRUCT TEMPORARY ACCESS ROAD FROM BEACON VALLEY ROAD TO THE WORK AREA.
4. INSTALL TEMPORARY WATER HANDLING SYSTEM INCLUDING WATER-HANDLING-COFFERDAMS AND TEMPORARY BYPASS PIPE.
5. DIVERT WATER THROUGH THE TEMPORARY BYPASS PIPE TO DRY THE WORK AREA.
6. CONSTRUCT ACCESS PLATFORM WITH CRANE MATS AND CONCRETE BLOCKS TO SPAN THE TEMPORARY BYPASS PIPE AS NEEDED FOR ACCESS TO THE DOWNSTREAM REVEMENT WORK AREA.
7. CONSTRUCT SLOPE REVETMENT.
8. REMOVE TEMPORARY ACCESS ROADS, CRANE MATS, AND PERFORM FINAL GRADING.
9. REMOVE TEMPORARY WATER-HANDLING-COFFERDAMS AND BYPASS PIPE.
10. CONSERVATION SEEDING FOR SLOPES, PERMIT PLANTINGS, REMOVE SEDIMENTATION CONTROL SYSTEMS UPON FINAL STABILIZATION.

SUGGESTED CONSTRUCTION SEQUENCE - PIPE RELINING

1. RELOCATE OVERHEAD UTILITIES TEMPORARILY.
2. INSTALL SEDIMENTATION CONTROL SYSTEM.
3. PERFORM CLEARING AND GRUBBING AND CONTROL AND REMOVAL OF INVASIVE VEGETATION.
4. CONSTRUCT TEMPORARY ACCESS ROAD FROM CANDIE ROAD TO CULVERT INLET.
5. INSTALL TEMPORARY WATER HANDLING SYSTEM INCLUDING WATER-HANDLING-COFFERDAMS AND TEMPORARY BYPASS PIPE.
6. DIVERT WATER THROUGH THE TEMPORARY BYPASS PIPE TO DRY THE HOST STRUCTURE.
7. REMOVE SEDIMENT AND REGRADE AREA AT HOST STRUCTURE INLET.
8. CLEAN HOST STRUCTURE BY HAND THROUGH REMOVAL OF DEBRIS. THE CULVERT CLEANING AND THE GROUTING PROCESS SHALL NOT CAUSE TURBIDITY OF THE EXISTING WATER COURSE.
9. GROUT ALL VOIDS AND PERFORATIONS TO ENSURE FULL BEARING OF MATERIAL TO THE EXTRADOS OF THE EXISTING PIPE ARCH.
10. PLACE TEMPORARY EARTH RETAINING SYSTEM. REMOVE END SECTION OF EXISTING STRUCTURE AT THE INLET. REPLACE END SECTIONS OF 30" RCP AND INSTALL TUNNEL LINER PLATE SECTIONS WITHIN THE HOST STRUCTURE. THE CONTRACTOR SHALL TAKE THE NECESSARY MEANS TO ENSURE THAT DEBRIS DOES NOT ENTER THE CULVERT SYSTEM DURING INSTALLATION OF THE CORRUGATED STEEL STRUCTURAL PLATE LINER.
11. INSTALL PCC00462 BULKHEADS AT THE INLET AND OUTLET.
12. PLACE SUMP-LINING GROUT.
13. EXCAVATE AND CONSTRUCT WINGWALLS, HEADWALL, AND ENDWALL ON NO. 4 CRUSHED STONE. REMOVE ABANDONED WATER MAINS IF ENCOUNTERED. CUT LEFT IN PLACE EARTH RETAINING SYSTEM AT 2 FEET BELOW GRADE. BACKFILL AND REMOVE REMAINING TEMPORARY EARTH RETAINING SYSTEM.
14. PLACE NATURAL STREAMBED MATERIAL AND PERFORM FINAL GRADING. LARGE STONES AND Boulders WITHIN THE WATERCOURSE IMMEDIATELY DOWNSTREAM OF BRIDGE 06772 THAT ARE REMOVED DURING EXCAVATION ACTIVITIES SHALL BE TEMPORARILY STOCKPILED AND RESET IN THE ORIGINAL LOCATIONS DURING FINAL GRADING. THE WORK TO BE PAID FOR UNDER SECTION AND REUSE OF EXISTING CHANNEL BOTTOM MATERIAL.
15. REMOVE TEMPORARY WATER-HANDLING-COFFERDAMS AND BYPASS PIPE AT BOTH INLET AND OUTLET. RETURN FLOW TO HOST STRUCTURE.
16. REMOVE TEMPORARY ACCESS ROAD AND RESTORE IMPACTED AREAS.
17. CONSERVATION SEEDING FOR SLOPES, PERMIT PLANTINGS, REMOVE SEDIMENTATION CONTROL SYSTEMS UPON FINAL STABILIZATION.
18. RELOCATE OVERHEAD UTILITIES TO FINAL POSITIONING.

WATER HANDLING NOTES:

1. THE CONTRACTOR SHALL MAINTAIN WATER THROUGH THE TEMPORARY GRAVITY FLOW BYPASS PIPE OR PUMP AND HOSE SYSTEM DESIGNED BY THE CONTRACTOR AS SHOWN ON THE SHEET DURING CLEANING AND REPAIR OF THE HOST STRUCTURE. GROUTING OF STAGE CONSTRUCTION SEQUENCES, THE CONTRACTOR SHALL MAINTAIN WATER THROUGH THE TEMPORARY GRAVITY FLOW BYPASS PIPE OR PUMP AND HOSE SYSTEM.
2. A DEWATERING BASIN SHALL BE ESTABLISHED OUTSIDE OF THE WELAND LIMITS. THE LOCATION OF THE DEWATERING BASIN IS APPROXIMATE. THE EXACT POSITION MAY VARY BASED ON THE PUMPING DESIGN SUBMISSION AND APPROVED BY THE ENGINEER.
3. TEMPORARY WATER HANDLING SYSTEMS SHALL BE DESIGNED TO HANDLE THE EXPECTED FLOWS AND TO BE CAPABLE OF HANDLING STORM DRAINAGE FLOWS THROUGH THE CONSTRUCTION AREA. SHALL BE ABLE TO SUPPORT CONSTRUCTION ACTIVITY AND SHALL CONFORM TO PERMITS.
4. ANY WATER HANDLING SCHEME DETECTED WITHIN THE DEPARTMENT'S HANDLING WATER TYPICAL SCHEMATICS MAY BE UTILIZED UNLESS OTHERWISE APPROVED BY THE ENGINEER. A MEANS AND METHOD FOR WATER HANDLING SYSTEM SHALL BE SUBMITTED BY THE CONTRACTOR TO THE ENGINEER FOR APPROVAL.
5. WATER HANDLING MEASURES SHALL NOT EXCEED IMPACT AREAS SHOWN ON THE WELAND SHEET OF THE PERMIT PLANS.
6. ANY STORM DRAINAGE DISCHARGING INTO A CONFINED WORK AREA FROM EXISTING OR PROPOSED STORM DRAINAGE PIPES SHALL BE DIVERTED OR PUMPED OUTSIDE THE CONFINED AREAS. PUMPS/PIPES SHALL BE SIZED BY THE CONTRACTOR TO HANDLE THE EXPECTED FLOWS AND TO BE CAPABLE OF HANDLING STORM DRAINAGE FLOWS THROUGH THE CONSTRUCTION AREA. MEANS AND METHODS OF HANDLING STORM DRAINAGE TO THE ENGINEER FOR APPROVAL AND IS INCLUDED AS PART OF WATER HANDLING.
7. IF A SHORT DURATION PUMP SYSTEMS PROPOSED DURING LOW FLOW CONDITIONS, THE PUMP SYSTEM SHALL BE DESIGNED BY THE CONTRACTOR AND HAVE A MINIMUM CAPACITY AS SHOWN IN THE TEMPORARY HYDRAULIC TABLE. PUMP SYSTEM PLAN SHALL BE SUBMITTED TO THE ENGINEER FOR REVIEW AND APPROVAL.
8. ANY UNCONFINED IN-WATER WORK SHALL BE MINOR IN NATURE, AND DIRECTED WEATHER CONDITIONS. THE ENGINEER MAY APPROVE A WATER HANDLING PLAN WITH LOWER PUMPING FLOWS, PROVIDED THAT THIS INCLUDES A CONTINGENCY PLAN, WHICH MINIMIZES NEGATIVE IMPACTS AND SAFELY CONVEYS LARGER FLOWS THROUGH THE WORK AREA.

UNCONFINED IN-STREAM WORK BMP NOTE:

ANY UNCONFINED IN-STREAM WORK WITHIN THE WATERCOURSE SHALL BE RESTRICTED TO THE PERIOD FROM JUNE 1 TO SEPTEMBER 30, INCLUSIVE, UNLESS OTHERWISE INCLUDED AS A SPECIAL PROVISION OF THE LICENSE. THE CONDITION SHALL APPLY TO PROJECTS IN NON-COASTAL WATERS. THE DEPARTMENT WILL REVIEW AND MAY APPROVE THE METHODS OF UNCONFINED IN-WATER WORK WITH CONSIDERATION OF THE FOLLOWING:

- PROPOSED SCHEDULE FOR WORK OPERATIONS
- ALL UNCONFINED IN-WATER WORK SHALL BE MINOR IN NATURE
- DISTURBANCE SHALL BE LIMITED TO AREAS THAT HAVE BEEN APPROVED FOR TEMPORARY AND PERMANENT IMPACT
- BEST MANAGEMENT PRACTICES SHALL BE UTILIZED WHEREVER POSSIBLE TO MINIMIZE TURBIDITY/SEDIMENT TRANSPORT DOWNSTREAM
- DISTURBED AREAS AND THE DURATION OF DISTURBANCE SHALL BE MINIMIZED TO THE EXTENT POSSIBLE
- IN-STREAM WORK SHALL BE DONE DURING PERIODS OF LOW FLOW

PROJECT NUMBER: 058242148	ISSUANCE NO: PM1-06
PROJECT DESCRIPTION: REHABILITATION OF BRIDGE NO. 06772 CARRYING ROUTE 63 OVER STRATSVILLE BROOK	SHEET NO:
TOWNSHIP: NAUGATUCK	
DRAWING TITLE: STAGING AND WATER HANDLING	
STATE OF CONNECTICUT DEPARTMENT OF TRANSPORTATION	
DESIGNED BY: JAS	REVISIONS:
CHECKED BY:	
DATE: 5/9/2024	

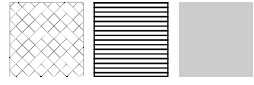
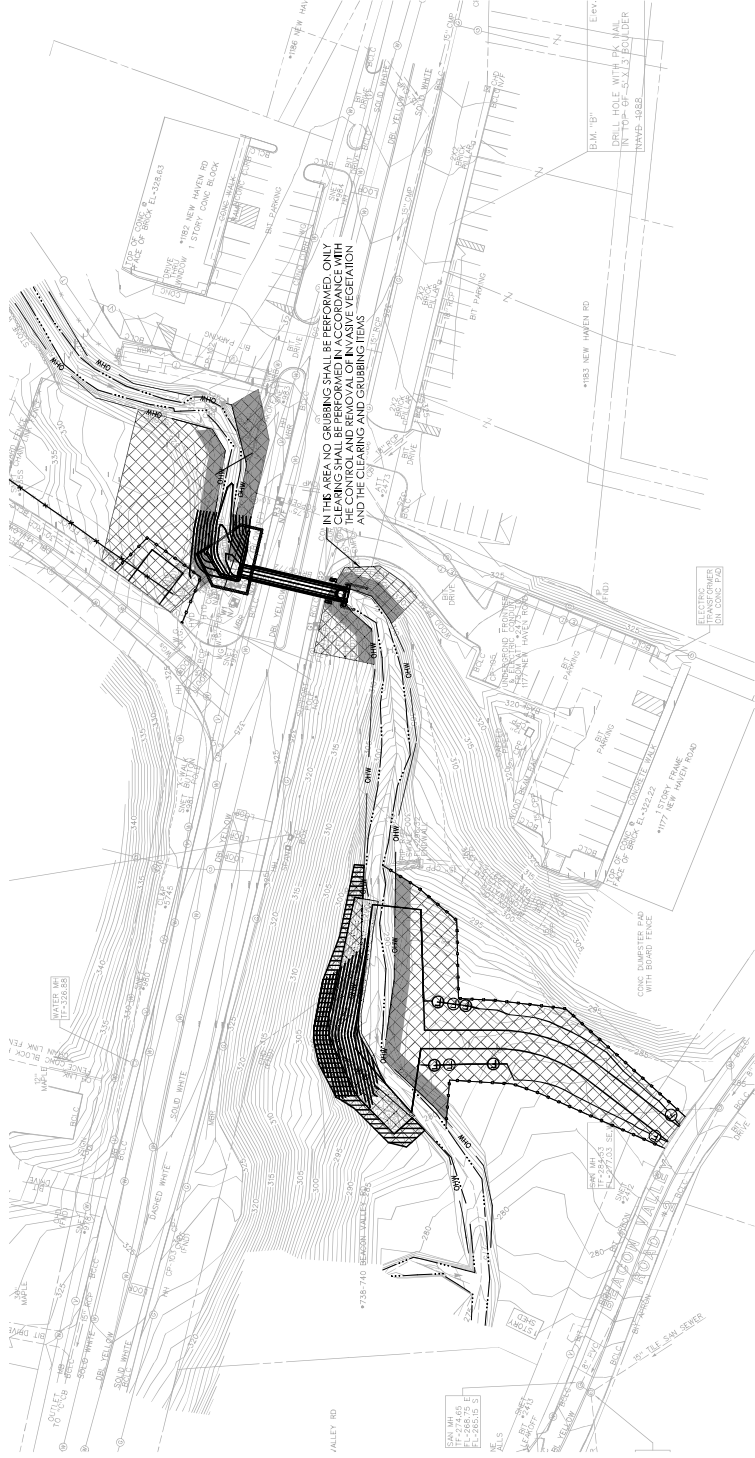
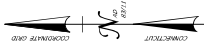

TOTAL PLANTS = 56
TOTAL PLANTING AREA = 1800 S.F.

TOTAL PLANTS = 238
TOTAL PLANTING AREA = 5060 S.F.

PERMIT PLANTING PLAN
SCALE: 1" = 40'

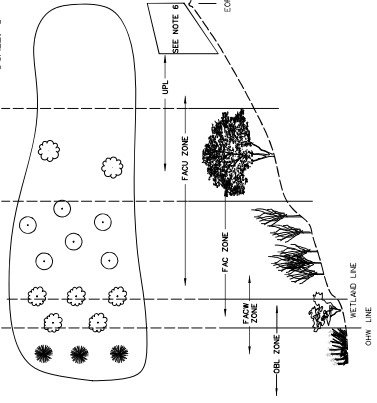

SCHEMATIC PLANTING

NOTES

- PLANTINGS ON THIS SHEET ARE FOR ENVIRONMENTAL RESTORATION PURPOSES AND SHALL BE COORDINATED WITH THE DEPARTMENT'S OFFICE OF ENVIRONMENTAL PLANNING (OEP).
- PROPOSED PLANTINGS TO BE FIELD LOCATED BY CIDOT OEP OR THEIR DESIGNATED REPRESENTATIVE.
- WOOD CHIP MULCH SHALL NOT BE PLACED IN THE WETLAND AREA.
- DISTURBED AREAS BELOW THE WETLAND LIMIT SHALL BE SEEDED WITH WETLAND GRASS ESTABLISHMENT. DISTURBED AREAS ABOVE THE WETLAND LIMIT SHALL BE SEEDED WITH MIX AS SPECIFIED. ALL AREAS SHALL BE RESTORED.
- ALL PLANTING MATERIALS TO BE ORDERED FROM A NURSERY GRADE STRAIGHT STOCKS TO BE REGISTERED WITH THE STATE OF MISSISSIPPI AMERICAN STANDARDS FOR NURSERY STOCK. CIDOT OEP WILL REVIEW AND APPROVE PROPOSED PLANTINGS.
- NO PLANTINGS SHALL BE PLACED IN MOW AREA.
- AREA TO BE RESTORED FOR INVASIVE AND PROPERLY PREPARED FOR FINAL PLANTING, SEEDING, AND RESTORATION.

LANDSCAPE ITEMS

KEY	BOTANICAL NAME	COMMON NAME	SIZE	QTY.	SPACING	WETLAND INDICATOR
A.G.	Azalea	abouffolia	18"-24" HT. BB.	9	5' ON CENTER	FACW
C.L.	Cornus rosmarino	Red Chokeberry	2' - 3' HT. B.B.	14	5' ON CENTER	FACU
H.V.	Hibiscus	virginiana	2' - 3' HT. B.B.	11	5' ON CENTER	UPL
V.B.	Viburnum dentatum	Arrowwood	24"-36" HT. NO. 3 Container	10	5' ON CENTER	FAC

NOTE: FOR INFORMATION ONLY. CONTRACTOR SHALL REFER TO THE CONTRACT PLANS FOR BIDDING PURPOSES.
NOTE: LANDSCAPE ITEMS FOR SLOPE STABILIZATION PLANTINGS TO BE FIELD LOCATED BY DOT LANDSCAPE DESIGN

PERMIT PLANT LIST

BOTANICAL NAME	COMMON NAME AND SIZE	QTY.	SPACING	WETLAND INDICATOR
ACER RUBRUM	RED MAPLE 2 1/2" GAL. BB	8	FIELD LOCATE	FAC
ACER RUBRUM	RED MAPLE 4 1/2" HT. 3 GAL. CONT.	20	FIELD LOCATE	FAC
ACER RUBRUM	RED MAPLE 4 1/2" HT. 3 GAL. CONT.	20	FIELD LOCATE	FAC
LEHRERA BARKOBI	SWEET PEPPERBUSH 2-3' HT. BB	50	5'	FACW
CORNUS RACEMOSA	GRAY DOGWOOD 3-4" HT. BB	50	5'	FACW
ALNUS INCANCA	SPECKLED ALDER 4.5" HT. BB	40	5'	FACW
ASCLEPIAS TUBEROSA	BUTTERFLY MILKWORT 1 GALLON CONTAINER	40	1-5' ON CENTER	NI
CONSERVATION SEEDING		25970 SF.	SEE HATCHING AND NOTE 7.	
CONTROL AND REMOVAL OF INVASIVE VEGETATION				

NOTE: ACER RUBRUM 3-4" HT. 1 GAL. CONT. AND ACER RUBRUM 4-8" HT. 3 GAL. CONT. TO BE PAID FOR UNDER ITEM #0949875A - WETLAND PLANTINGS

ENVIRONMENTAL PERMIT PLANS
PLAN DATE: May 9, 2024

PROJECT NO. PM1-07
SHEET NO.

PROJECT NUMBER: 035224148
PROJECT DESCRIPTION: REHABILITATION OF BRIDGE NO. 06772 CARRYING ROUTE 63 OVER STRAITSVILLE BROOK
TOWNSHIP: NAUGHTICK
DRAWING TITLE: PERMIT PLANTING PLAN



REVISIONS
BLOCK

DATE: 5/9/2024
DRAWN BY: [Name]
CHECKED BY: [Name]
DATE: 5/9/2024



LWRD Work Commencement Form

To: DEEP.LWRDRegulatory@ct.gov or
Regulatory Section
Department of Energy and Environmental Protection
Land & Water Resources Division
79 Elm Street
Hartford, CT 06106-5127

Licensee Name: Connecticut Department of Transportation
Municipality in which the project is occurring: Naugatuck
DEEP License No(s): 202407001-IW

CONTRACTOR(s):

1 Name: _____
Address: _____
Telephone: _____
E-mail: _____

2 Name: _____
Address: _____
Telephone: _____
E-mail: _____

3 Name: _____
Address: _____
Telephone: _____
E-mail: _____

Date Contractor(s) received a copy
of the license and approved plans: _____

EXPECTED DATE OF COMMENCEMENT OF WORK: _____

EXPECTED DATE OF COMPLETION OF WORK: _____

LICENSEE: _____
(Signature) (Date)



Compliance Certification Form

The following certification must be signed by the licensee working in consultation with a Connecticut-licensed design professional and must be submitted to the address indicated at the end of this form within ninety (90) days of completion of the authorized work.

1. Licensee Name: <u>Connecticut Department of Transportation</u>	
DEEP License Number(s): <u>202407001-IW</u>	
Municipality in which project is occurring: <u>Naugatuck</u>	
2. Check one:	
(a) <input type="checkbox"/> "I certify that the final site conditions and / or structures are in general conformance with the approved site plans". Identify and describe any deviations and attach to this form.	
(b) <input type="checkbox"/> "The final site conditions and / or structures are not in general conformance with the approved site plans. The enclosed "as-built" plans note the modifications".	
3. "I understand that any false statement in this certification is punishable as a criminal offence under section 53a-157b of the General Statutes and under any other applicable law."	
_____ Signature of Licensee	_____ Date
_____ Name of Licensee (print or type)	
_____ Signature of CT-Licensed Design Professional	_____ Date
_____ Name of CT-Licensed Design Professional (print or type)	
_____ Professional License Number (if applicable)	Affix Stamp Here
<ul style="list-style-type: none"> As-built plans shall include: elevations or tidal datums, as applicable, and structures, including any proposed elevation views and cross sections included in the approved license plans. Such as-built plans shall be the original ones and be signed and sealed by an engineer, surveyor or architect, as applicable, who is licensed in the State of Connecticut. The Licensee will be notified by staff of the Land and Water Resources Division (LWRD) if further compliance review is necessary. Lack of response by LWRD staff does not imply compliance. <p>Submit this completed form to : DEEP.LWRDRegulatory@ct.gov or Regulatory Section Department of Energy and Environmental Protection Land & Water Resources Division 79 Elm Street Hartford, CT 06106-5127</p>	