



Connecticut Department of Energy and Environmental Protection License*

Flood Management Certification & Exemption Request Approval

Licensee(s): Connecticut Department of
Transportation

Licensee Address(s): 2800 Berlin Turnpike,
Newington, CT 06131

License Number(s): 202306916-FME

Municipality: Windsor

Project Description: Rehabilitation of Bridge No 06574 over Mill Brook

Project Address/Location: Route 159 (Palisado Avenue) over Mill Brook, Windsor, CT
06095

Waters: Mill Brook

**Authorizing CT Statute(s)
and/or Federal Law:** CGS Section 25-68b to h

**Applicable Regulations of
CT State Agencies:** 25-68h-1 to 3

Agency Contact: Land & Water Resources Division,
Bureau of Water Protection & Land Reuse, 860-424-3019

License Expiration: Five (5) years from the date of issuance of this license.

Project Site Plan Set: *Environmental Permit Plans State Project No. 0164-0242:
Rehabilitation of Bridge No. 06574 State Route 159 (Palisado
Avenue) over Mill Brook in the Town of Windsor, CT, 7 sheets,
dated August 22, 2023, and prepared by the State of Connecticut
Department of Transportation.*

*Connecticut’s Uniform Administrative Procedure Act defines License to include, “the whole or part of any agency permit, certificate, approval, registration, charter or similar form of permission required by law . . .”

License Enclosures: LWRD General Conditions; Site Plan Set; LWRD Compliance Certification Form

Authorized Activities:

The Licensee is hereby authorized to conduct the following work as described in application # 202306916 and as depicted on any site plan sheets / sets cited herein:

1. Rehabilitate Bridge No. 06574 per site plans cited herein as follows;
 - a. install sedimentation and erosion control systems;
 - b. construct temporary access road and work areas along Pleasant Street northeast of Bridge No. 06574;
 - c. install temporary water handling system, consisting of a 48" temporary bypass pipe, upstream and downstream cofferdams and additional piping for roadway drainage per sheet PMT-06 of the site plans cited herein;
 - d. complete host pipe preparation;
 - e. reline existing pipe with a 9' – 6" diameter polymer coated corrugated steel pipe and grout the angular space between existing and proposed pipes;
 - f. repair exposed concrete on the existing headwall and construct intermediate riprap slope protection upstream and downstream per sheet PMT-05 of the site plans cited herein;
 - g. regrade both the inlet and outlet with intermediate riprap and 12" of natural streambed material per sheet PMT-05 of the site plans cited herein;
 - h. remove temporary water handling systems;
 - i. remove temporary construction access road, work areas and sedimentation and erosion systems; and
 - j. restore disturbed areas to pre-construction condition.

Failure to comply with the terms and conditions of this license shall subject the Licensee and / or the Licensee's contractor(s) to enforcement actions and penalties as provided by law.

This license is subject to the following Terms and Conditions:

1. **License Enclosure(s) and Conditions.** The Licensee shall comply with all applicable terms and conditions as may be stipulated within the License Enclosure(s) listed above.
2. **Time-of-Year Restriction.** In-water work, including the installation and removal of water handling cofferdams is prohibited from April 1 to June 30, inclusive, unless otherwise authorized in writing by the Commissioner. The specific closure date is so that the culvert remains open and prevents interference with the diadromous fish migratory period.
3. **Follow-Up Letter of Map Revision.** The Licensee shall follow FEMA requirements and submit follow-up information for a Letter of Map Revision (LOMR) in order for a final

determination on revising the effective FIRM and FIS report upon completion of the project per page 4 of the Conditional Letter of Map Revision, dated July 14, 2023.

4. **Water Quality Protection Measure for Storm Events.** Once the Water Handling System, as shown on PMT-06 of the site plan set attached herein, has been installed, and at least one week prior to the instillation of the grout within the annular space around the proposed culvert, the Licensee shall monitor the National Weather Service precipitation forecast for the next seven (7) days for any predicted rain event that would exceed the capacity of the water handling cofferdams (2 X Average Spring Flow). Upon finding that a predicted storm event will exceed the cofferdam, the Licensee shall cease all grout work with 24 hours of such precipitation event occurring at the site. Such work shall only resume once the said precipitation event has ended, and the Water Handling System has been inspected and determined to be functioning properly.
5. **Discharge of Grout.** At no time shall the Licensee allow grout to discharge into Mill Brook.
6. **Natural Streambed Material.** The Licensee shall use angular native stone as found in the stream area. No broken rip rap should be used. Streambed material should match that as what is found along the upstream and downstream sections and properly sized so that it will not flush away during high velocity flows.
7. **State-Listed Species Protection.**

Northern leopard frog

To mitigate adverse impacts to the state species of special concern Northern leopard frog (*Rana pipiens*), the Licensee shall avoid active work during the species dormant period which is from November 1 – April 1. Silt fencing shall not be embedded with netting and construction workers shall be instructed to use caution when moving large equipment within the project vicinity.

Eastern Box Turtle

To protect Eastern box turtles, the Licensee shall adhere to the following protocols for any work conducted during the species' active period between April 1 – October 31:

- a. All areas within the project limits shall be surveyed and cleared of any turtles immediately prior to commencement of initial clearing and grubbing activities.
- b. All construction workers must be notified of the species description and possible presence within the work area.
- c. Exclusionary fencing shall be at least 20" tall and must be secured to and remain in contact with the ground. Fencing shall be regularly inspected/maintained to prevent any openings at ground level.
- d. Any individual turtles encountered within the immediate work area shall be carefully moved to an adjacent area outside of the excluded area and the project Engineer shall immediately be informed in order to contact OEP with the location.
- e. No heavy machinery or vehicles may be parked in any unapproved box turtle habitat. All staging and storage areas in the vicinity of turtle habitat, outside of previously paved locations, regardless of the duration of time they will be utilized, must be reviewed by, and receive written approval from OEP through the project Engineer.

Work may also take place during the Eastern box turtle's dormant period between November 1 to March 31 as long as the additional precautionary measure is followed: Exclusionary fencing must be installed, and the area inspected for turtles by the Engineer or Engineer's approved representative prior to October 1.

8. **Management of Materials.** All wastewaters produced from the cleaning, preparation, and/or installation for slip lining shall be managed in accordance with all federal, state, and local requirements, including Chapter 446K Water Pollution Control, Chapter 445 Hazardous Waste, and Chapter 446d Solid Waste of the Connecticut General Statutes.

Issued under the authority of the Commissioner of Energy and Environmental Protection on:

Date

Emma Cimino
Acting Deputy Commissioner
Environmental Quality Branch



LWRD General Conditions

1. **Land Record Filing (for Structures Dredging & Fill, Tidal Wetlands, Certificate of Permission, and Long Island Sound General Permit Licenses only).** The Licensee shall file the Land Record Filing on the land records of the municipality in which the subject property is located not later than thirty (30) days after license issuance pursuant to Connecticut General Statutes (CGS) Section 22a-363g. A copy of the Notice with a stamp or other such proof of filing with the municipality shall be submitted to DEEP.LWRDRegulatory@ct.gov no later than sixty (60) days after license issuance. If a Land Record Filing form is not enclosed and the work site is not associated with an upland property, no filing is required.
2. **Contractor Notification.** The Licensee shall give a copy of the license and its attachments to the contractor(s) who will be carrying out the authorized activities prior to the start of construction and shall receive a written receipt for such copy, signed and dated by such contractor(s). The Licensee's contractor(s) shall conduct all operations at the site in full compliance with the license and, to the extent provided by law, may be held liable for any violation of the terms and conditions of the license. At the work site, the contractor(s) shall, whenever work is being performed, have on site and make available for inspection a copy of the license and the authorized plans.
3. **Work Commencement¹.** Not later than two (2) weeks prior to the commencement of any work authorized herein, the Licensee shall submit to DEEP.LWRDRegulatory@ct.gov, on the Work Commencement Form attached hereto, the name(s) and address(es) of all contractor(s) employed to conduct such work and the expected date for commencement and completion of such work, if any.
 - For water diversion activities authorized pursuant to 22a-377(c)-1 of the Regulations of Connecticut State Agencies, the Licensee shall also notify the Commissioner in writing two weeks prior to initiating the authorized diversion.
 - For emergency activities authorized pursuant Connecticut General Statutes Section 22a-6k, the Licensee shall notify the Commissioner, in writing, of activity commencement at least one (1) day prior to construction and of activity completion no later than five (5) days after conclusion.
4. **For Coastal Licenses Only - License Notice.** The Licensee shall post the first page of the License in a conspicuous place at the work area while the work authorized therein is undertaken.
5. **Unauthorized Activities.** Except as specifically authorized, no equipment or material, including but not limited to, fill, construction materials, excavated material or debris, shall be

¹ The Work Commencement condition and the need for a Work Commencement Form is not applicable to Flood Management Certification approvals.

deposited, placed or stored in any wetland or watercourse on or off-site. The Licensee may not conduct work within wetlands or watercourses other than as specifically authorized, unless otherwise authorized in writing by the Commissioner. Tidal wetlands means “wetland” as defined by section 22a-29 and “freshwater wetlands and watercourses” means “wetlands” and “watercourses” as defined by section 22a-38.

- 6. Management of Materials.** Any materials removed from the site shall be managed in accordance with all federal, state, and local requirements, including Chapter 446K Water Pollution Control, Chapter 445 Hazardous Waste, and Chapter 446d Solid Waste of the Connecticut General Statutes.
- 7. Unconfined Instream Work.** Unless otherwise noted in a condition of the license, the following conditions apply to projects in non-coastal waters:

 - Unconfined instream work is limited to the period June 1 through September 30.
 - Confinement of a work area by cofferdam techniques using sand bag placement, sheet pile installation (vibratory method only), portadam, or similar confinement devices is allowed any time of the year. The removal of such confinement devices is allowed any time of the year.
 - Once a work area has been confined, in-water work within the confined area is allowed any time of the year.
 - The confinement technique used shall completely isolate and protect the confined area from all flowing water. The use of silt boom/curtain or similar technique as a means for confinement is prohibited.
- 8. For State Actions Only - Material or Equipment Storage in the Floodplain.** Unless approved by a Flood Management Exemption, the storage of any materials at the site which are buoyant, hazardous, flammable, explosive, soluble, expansive, radioactive, or which could in the event of a flood be injurious to human, animal or plant life, below the elevation of the five-hundred (500) year flood is prohibited. Any other material or equipment stored at the site below said elevation by the Licensee or the Licensee's contractor must be firmly anchored, restrained or enclosed to prevent flotation. The quantity of fuel stored below such elevation for equipment used at the site shall not exceed the quantity of fuel that is expected to be used by such equipment in one day. In accordance with the licensee’s Flood Contingency Plan, the Licensee shall remove equipment and materials from the floodplain during periods when flood warnings have been issued or are anticipated by a responsible federal, state or local agency. It shall be the Licensee’s responsibility to obtain such warnings when flooding is anticipated.
- 9. Temporary Hydraulic Facilities for Water Handling.** If not reviewed and approved as a part of the license application, temporary hydraulic facilities shall be designed by a qualified professional and in accordance with the *Connecticut Guidelines for Soil Erosion and Sediment Control*, the *2004 Connecticut Stormwater Quality Manual*, or the *Department of Transportation’s ConnDOT Drainage Manual*, as applicable. Temporary hydraulic facilities may include channels, culverts or bridges which are required for haul roads, channel relocations, culvert installations, bridge construction, temporary roads, or detours.

- 10. Excavated Materials.** Unless otherwise authorized, all excavated material shall be staged and managed in a manner which prevents additional impacts to wetlands and watercourses.
- 11. Best Management Practices.** The Licensee shall not cause or allow pollution of any wetlands or watercourses, including pollution resulting from sedimentation and erosion. In constructing or maintaining any authorized structure or facility or conducting any authorized activity, or in removing any such structure or facility, the Licensee shall employ best management practices to control storm water discharges, to prevent erosion and sedimentation, and to otherwise prevent pollution of wetlands and other waters of the State. For purposes of the license, “pollution” means “pollution” as that term is defined by CGS section 22a-423. Best Management Practices include, but are not limited, to practices identified in the *Connecticut Guidelines for Soil Erosion and Sediment Control* as revised, *2004 Connecticut Stormwater Quality Manual*, Department of Transportation’s *ConnDOT Drainage Manual* as revised, and the Department of Transportation Standard Specifications as revised.
- 12. In-Water Work Vessel Staging and Storage. (for Structures Dredging & Fill, Tidal Wetlands, Certificate of Permission, and Long Island Sound General Permit Licenses only).** For any barge, vessel, skiff or floating work platform (“work vessels”) utilized in the execution of the work authorized herein, the Licensee shall ensure that such work vessels:
- do not rest on, or come in contact with, the substrate at any time, unless specifically authorized in the license.
 - are not stored over intertidal flats, submerged aquatic vegetation or tidal wetland vegetation or in a location that interferes with navigation. In the event any work vessel is grounded, no dragging or prop dredging shall occur to free it.
- 13. Work Site Restoration.** Upon completion of any authorized work, the Licensee shall restore all areas impacted by construction, or used as a staging area or accessway in connection with such work, to their condition prior to the commencement of such work.
- 14. Inspection.** The Licensee shall allow any representative of the Commissioner to inspect the project location at reasonable times to ensure that work is being or has been conducted in accordance with the terms and conditions of this license.
- 15. Change of Use. (Applies only if a use is specified within the License “Project Description”)**
- a. The work specified in the license is authorized solely for the purpose set forth in the license. No change in purpose or use of the authorized work or facilities as set forth in the license may occur without the prior written approval of the Commissioner. The Licensee shall, prior to undertaking or allowing any change in use or purpose from that which is authorized by this license, request permission from the Commissioner for such change. Said request shall be in writing and shall describe the proposed change and the reason for the change.
 - b. A change in the form of ownership of any structure authorized herein from a rental/lease commercial marina to a wholly-owned common interest community or dockominium may constitute a change in purpose as specified in paragraph (a) above.
- 16. De Minimis Alteration.** The Licensee shall not deviate from the authorized activity without

prior written approval from the Commissioner. The Licensee may request a de minimis change to any authorized structure, facility, or activity. A de minimis alteration means a change in the authorized design, construction or operation that individually and cumulatively has minimal additional environmental impact and does not substantively alter the project as authorized.

- For diversion activities authorized pursuant to 22a-377(c)-2 of the Regulations of Connecticut State Agencies, a de minimis alteration means an alteration which does not significantly increase the quantity of water diverted or significantly change the capacity to divert water.

17. Extension Request. The Licensee may request an extension of the license expiration date. Such request shall be in writing and shall be submitted to DEEP.LWRDRegulatory@ct.gov at least thirty (30) days prior to the license expiration. Such request shall describe the work done to date, what work still needs to be completed, and the reason for such extension. The Commissioner may extend the expiration date of this license for a period of up to one year, in order for the Licensee to complete the authorized activities. It shall be at the Commissioner's sole discretion to grant or deny such request. No more than three (3) one-year extensions will be granted under this license.

18. Compliance Certification. Not later than 90 days after completion of the authorized work, the Licensee shall prepare and submit to DEEP.LWRDRegulatory@ct.gov, the attached Compliance Certification Form. Such Compliance Certification shall be completed, signed, and sealed by the Licensee and a Connecticut Licensed Design Professional. If non-compliance is indicated on the form, or the Commissioner has reason to believe the activities and/or structures were conducted in non-compliance with the license, the Commissioner may require the Licensee to submit as-built plans as a condition of this license.

19. Maintenance. The Licensee shall maintain all authorized structures or work in optimal condition or shall remove such structures or facility and restore the affected waters to their pre-work condition. Any such maintenance or removal activity shall be conducted in accordance with applicable law and any additional approvals required by law.

20. No Work After License Expiration. Work conducted after the license expiration date is a violation of the license and may subject the licensee to enforcement action, including penalties, as provided by law.

21. License Transfer. The license is not transferable without prior written authorization of the Commissioner. A request to transfer a license shall be submitted in writing and shall describe the proposed transfer and the reason for such transfer. The Licensee's obligations under the license shall not be affected by the passage of title to the license site to any other person or municipality until such time as a transfer is approved by the Commissioner.

22. Document Submission. Any document required to be submitted to the Commissioner under the license or any contact required to be made with the Commissioner shall, unless otherwise specified in writing by the Commissioner, be directed to:

DEEP.LWRDRegulatory@ct.gov or

Regulatory Section
Land & Water Resources Division
Department of Energy and Environmental Protection
79 Elm Street
Hartford, Connecticut 06106-5127
860-424-3019

- 23. Date of Document Submission.** The date of submission to the Commissioner of any document required by the license shall be the date such document is received by the Commissioner. The date of any notice by the Commissioner under the license, including but not limited to notice of approval or disapproval of any document or other action, shall be the date such notice is personally delivered or the date three (3) days after it is mailed by the Commissioner, whichever is earlier. Except as otherwise specified in the license, the word “day” as used in the license means calendar day. Any document or action which is required by the license to be submitted or performed by a date which falls on a Saturday, Sunday or a Connecticut or federal holiday shall be submitted or performed on or before the next day which is not a Saturday, Sunday, or a Connecticut or federal holiday.
- 24. Certification of Documents.** Any document, including but not limited to any notice, which is required to be submitted to the Commissioner under the license shall be signed by the Licensee and by the individual or individuals responsible for actually preparing such document, each of whom shall certify in writing as follows: “I have personally examined and am familiar with the information submitted in this document and all attachments and certify that based on reasonable investigation, including my inquiry of those individuals responsible for obtaining the information, the submitted information is true, accurate and complete to the best of my knowledge and belief, and I understand that any false statement made in this document or its attachments may be punishable as a criminal offense.”
- 25. Accuracy of Documentation.** In evaluating the application for the license, the Commissioner has relied on information and data provided by the Licensee and on the Licensee’s representations concerning site conditions, design specifications and the proposed work, including but not limited to representations concerning the commercial, public or private nature of the work or structures, the water-dependency of said work or structures, its availability for access by the general public, and the ownership of regulated structures or filled areas. If such information proves to be false, deceptive, incomplete or inaccurate, the license may be modified, suspended or revoked, and any unauthorized activities may be subject to enforcement action.
- 26. Limits of Liability.** In granting the license, the Commissioner has relied on all representations of the Licensee, including information and data provided in support of the Licensee’s application. Neither the Licensee’s representations nor the issuance of the license shall constitute an assurance by the Commissioner as to the structural integrity, the engineering feasibility or the efficacy of such design.
- 27. Reporting of Violations.** In the event that the Licensee becomes aware that they did not or may not comply, or did not or may not comply on time, with any provision of this license or of any document incorporated into the license, the Licensee shall immediately notify the

agency contact specified within the license and shall take all reasonable steps to ensure that any noncompliance or delay is avoided or, if unavoidable, is minimized to the greatest extent possible. In so notifying the agency contact, the Licensee shall provide, for the agency's review and written approval, a report including the following information:

- a. the provision(s) of the license that has been violated;
- b. the date and time the violation(s) was first observed and by whom;
- c. the cause of the violation(s), if known;
- d. if the violation(s) has ceased, the duration of the violation(s) and the exact date(s) and times(s) it was corrected;
- e. if the violation(s) has not ceased, the anticipated date when it will be corrected;
- f. steps taken and steps planned to prevent a reoccurrence of the violation(s) and the date(s) such steps were implemented or will be implemented; and
- g. the signatures of the Licensee and of the individual(s) responsible for actually preparing such report.

If the violation occurs outside of normal business hours, the Licensee shall contact the Department of Energy and Environmental Protection Emergency Dispatch at 860-424-3333. The Licensee shall comply with any dates which may be approved in writing by the Commissioner.

- 28. Revocation/Suspension/Modification.** The license may be revoked, suspended, or modified in accordance with applicable law.
- 29. Other Required Approvals.** License issuance does not relieve the Licensee of their obligations to obtain any other approvals required by applicable federal, state and local law.
- 30. Rights.** The license is subject to and does not derogate any present or future property rights or powers of the State of Connecticut, and conveys no property rights in real estate or material nor any exclusive privileges, and is further subject to any and all public and private rights and to any federal, state or local laws or regulations pertinent to the property or activity affected hereby.
- 31. Condition Conflicts.** In the case where a project specific special condition listed on the license differs from, or conflicts with, one of the general conditions listed herein, the project specific special condition language shall prevail. It is the licensee's responsibility to contact the agency contact person listed on the license for clarification if needed prior to conducting any further regulated activities.



ENVIRONMENTAL PERMIT PLANS STATE PROJECT NO. 0164-0242

REHABILITATION OF BRIDGE NO. 06574 STATE ROUTE 159 (PALISADO AVENUE) OVER MILL BROOK

Town of
WINDSOR, CT

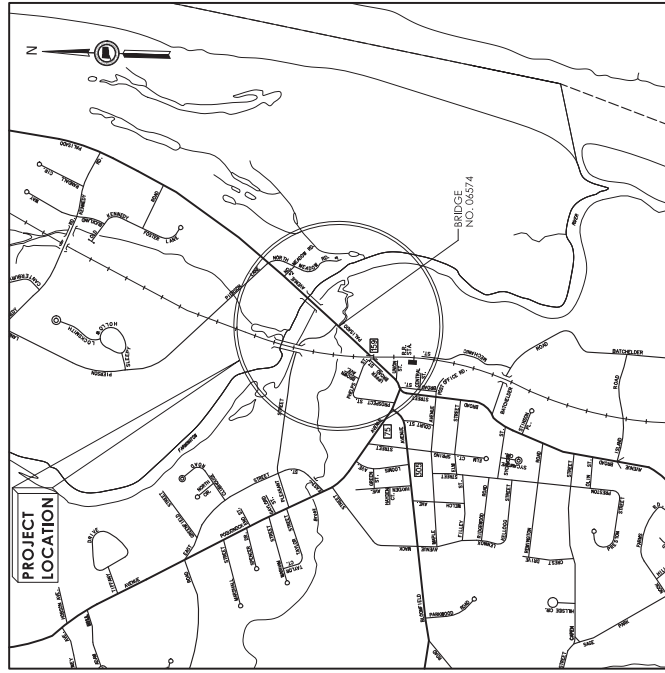
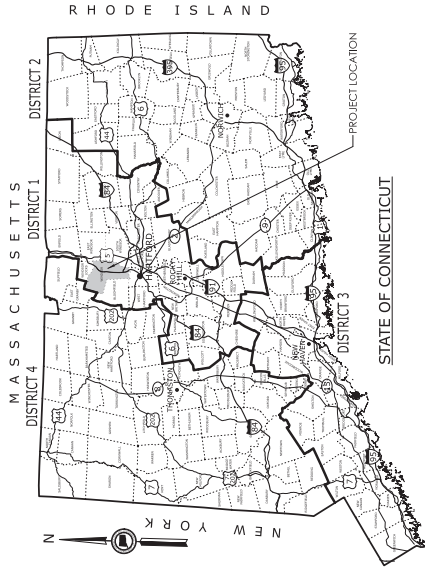

LOCATION PLAN
1" = 1000'

GENERAL NOTES

1. THESE PLANS ARE NOT FOR CONSTRUCTION AND ARE INTENDED ONLY FOR ENVIRONMENTAL PERMITTING PURPOSES. THESE PLANS HOLD AUTHORITY FOR ALL ACTIVITIES CONCERNING THE REGULATED AREA. FOR DETAILED PLANNING INFORMATION AND PAYMENT REFER TO THE APPLICABLE CONTRACT DOCUMENTS.
2. THE DEPARTMENT OF TRANSPORTATION WILL ONLY SUBMIT REVISIONS TO DEEP AND USACE FOR CHANGES TO THE DESIGN THAT WILL AFFECT REGULATED AREAS.
3. FOR A DESCRIPTION OF THE WATERCOURSES, WETLAND AND WELAND SOILS SEE RELEVANT SECTIONS OF THE PERMIT APPLICATION.
4. 400 FOOT GRID BASED ON CONNECTICUT COORDINATE SYSTEM N.A.D. 1983 - VERTICAL DATUM BASED ON NAVD 1988.
5. ALL CONSTRUCTION ACTIVITIES WILL BE CONDUCTED IN ACCORDANCE WITH THE DEPARTMENT'S STANDARD SPECIFICATIONS FOR ROADS, BRIDGE FACILITIES, AND INCIDENTAL CONSTRUCTION ACTIVITIES (SSR) AND THE FEDERAL HIGHWAY ADMINISTRATION'S STANDARD PRACTICES (SM&S) AND SEEDING AND EROSION CONTROL MEASURES IN ACCORDANCE WITH THE 2002 EROSION & SEDIMENTATION CONTROL GUIDELINES AND THE 2004 STORMWATER QUALITY MANUAL.
6. FEDERAL AID PROJECT NO. 015991010
7. F.H.W.A. REGION NO. 1
8. CONSTRUCTION SPECIFICATIONS: STANDARD SPECIFICATIONS FOR ROADS, BRIDGE FACILITIES, AND INCIDENTAL CONSTRUCTION ACTIVITIES (SSR) AND SUPPLEMENTAL SPECIFICATIONS, DATED JANUARY 2023, AND SPECIAL PROVISIONS.

LIST OF DRAWINGS

DRAWING NO.	DRAWING TITLE
PM1-01	ENVIRONMENTAL PERMIT PLANS COVER
PM1-02	GENERAL PLAN
PM1-03	ENVIRONMENTAL IMPACT PLAN - WETLANDS
PM1-04	ENVIRONMENTAL IMPACT PLAN - FLOODPLAIN
PM1-05	TYPICAL SECTIONS
PM1-06	WATER HANDLING PLAN
PM1-07	PERMIT PLANTING PLAN

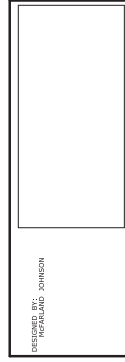

PROJECT NUMBER: 0164-0242
 PROJECT DESCRIPTION: REHABILITATION OF BRIDGE NO. 06574 CARRYING ROUTE 159 OVER MILL BROOK
 TOWN: WINDSOR
 DRAWING TITLE: ENVIRONMENTAL PERMIT PLANS COVER



STATE OF CONNECTICUT
 DEPARTMENT OF TRANSPORTATION

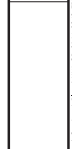

ENVIRONMENTAL PERMIT PLANS
 DATE: 08/22/2023
 CHECKED BY: ENM
 LAST SAVED BY: RJOHNSON FILE NAME: \\S:\2023\Windsor\ACT001\0164-0242\0164-0242_P001.dwg
 PLOTTED DATE: 12/22/2023

REV	DATE	REVISION DESCRIPTION

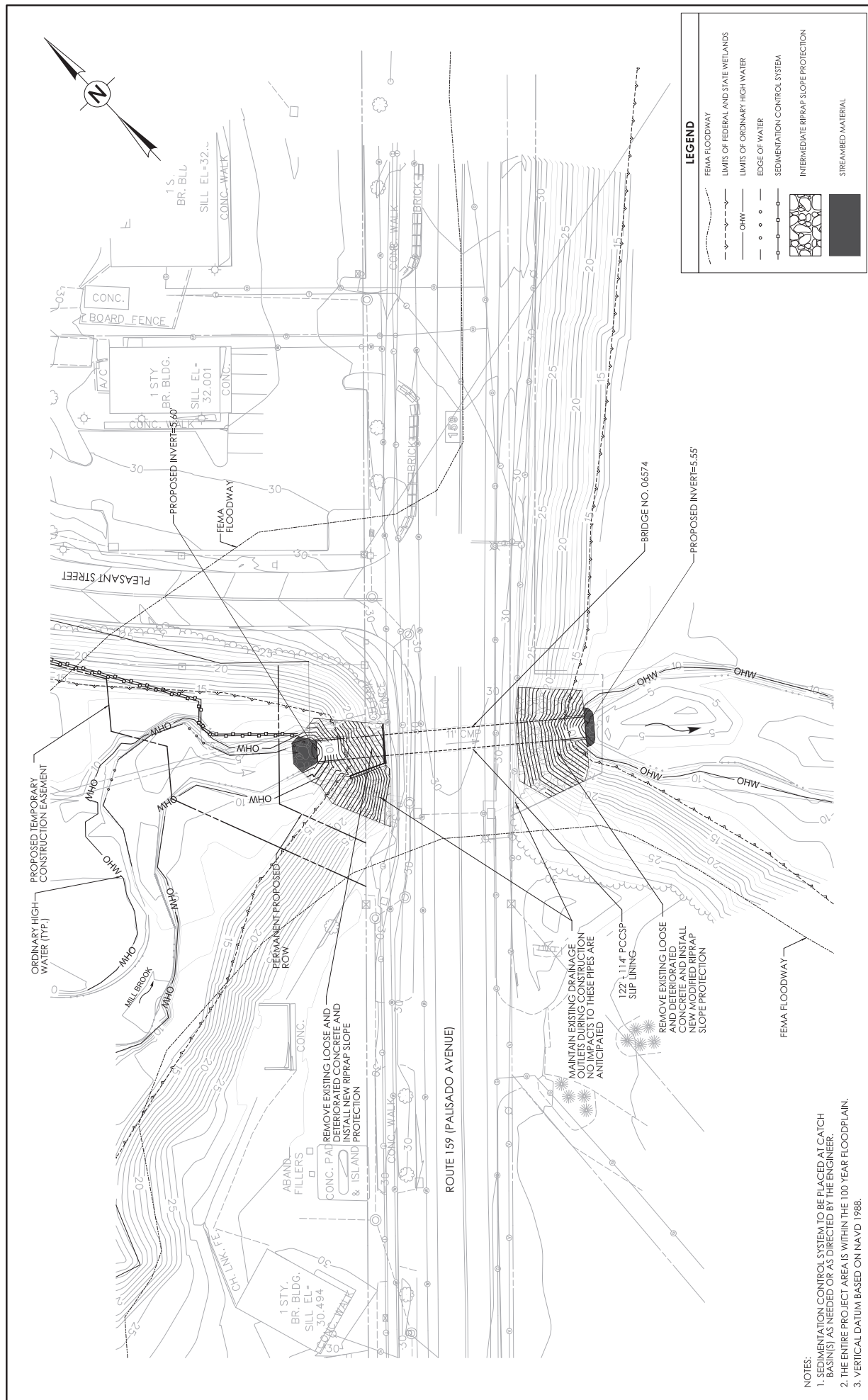

LEGEND	
	FEMA FLOODWAY
	LIMITS OF FEDERAL AND STATE WETLANDS
	LIMITS OF ORDINARY HIGH WATER
	EDGE OF WATER
	SEDIMENTATION CONTROL SYSTEM
	INTERMEDIATE RIPRAP SLOPE PROTECTION
	STREAMBED MATERIAL

- NOTES:
1. SEDIMENTATION CONTROL SYSTEM TO BE PLACED AT CATCH BASIN(S) AS NEEDED OR AS DIRECTED BY THE ENGINEER.
 2. THE ENTIRE PROJECT AREA IS WITHIN THE 100 YEAR FLOODPLAIN.
 3. VERTICAL DATUM BASED ON NAVD 1988.

PROJECT NUMBER: 014420436
 PROJECT DESCRIPTION: REHABILITATION OF BRIDGE NO. 06574 CARRYING ROUTE 159 OVER MILL BROOK
 TOWNSHIP: WINDSOR
 DRAWING TITLE: GENERAL PLAN

STATE OF CONNECTICUT
 DEPARTMENT OF TRANSPORTATION

REVISIONS:
 NO. DATE DESCRIPTION
 1 08/22/2023
 2 08/22/2023

DRAWING SCALE: 1" = 20'
 SHEET NO. 47
 TOTAL SHEETS: 47

ENVIRONMENTAL PERMIT PLANS
 DATE: 08/22/2023
 CHECKED BY: ENM
 LAST SAVED BY: mcdonogh
 FILE NAME: \\A:\GIS\workspace\CD02\014420436\Project\Drawings\CD02_014420436_General Plan.dwg
 PLOTTED DATE: 8/22/2023

PROJECT NO.: PM1-02
 SHEET NO.:

FLOODPLAIN IMPACT TABLE			
	CUT IMPACT (CY)	FILL IMPACT (CY)	NET IMPACT (CY)
PERMANENT IMPACTS	32.3	100.9	68.6



LEGEND

- FEMA FLOODWAY
- LIMITS OF FEDERAL AND STATE WETLANDS
- LIMITS OF ORDINARY HIGH WATER
- EDGE OF WATER
- SEDIMENTATION CONTROL SYSTEM
- INTERMEDIATE RIPRAP SLOPE PROTECTION

LEGEND

- PERMANENT IMPACTS
- TEMPORARY IMPACTS

NOTES:
 1. THE ENTIRE PROJECT AREA IS WITHIN THE 100 YEAR FLOODPLAIN.
 2. VERTICAL DATUM BASED ON NAVD 1988.

PROJECT NUMBER: 01442242
 PROJECT DESCRIPTION: REHABILITATION OF BRIDGE NO. 06574 CARRYING ROUTE 159 OVER MILL BROOK
 TOWN: WINDSOR
 DRAWING TITLE: ENVIRONMENTAL IMPACT PLAN - FLOODPLAIN

STATE OF CONNECTICUT
 DEPARTMENT OF TRANSPORTATION

DESIGNER: [Logo]
 CONTRACT NO.: [Logo]

REVISIONS:
 REV. DATE DESCRIPTION

LAST SAVER BY: [Name]
 CHECKED BY: [Name]
 PLOTTED DATE: 02/22/2023

SCALE: 1" = 20'

ENVIRONMENTAL PERMIT PLANS
 DATE: 08/22/2023

PROJECT NO.: PM-F-04
 SHEET NO.:

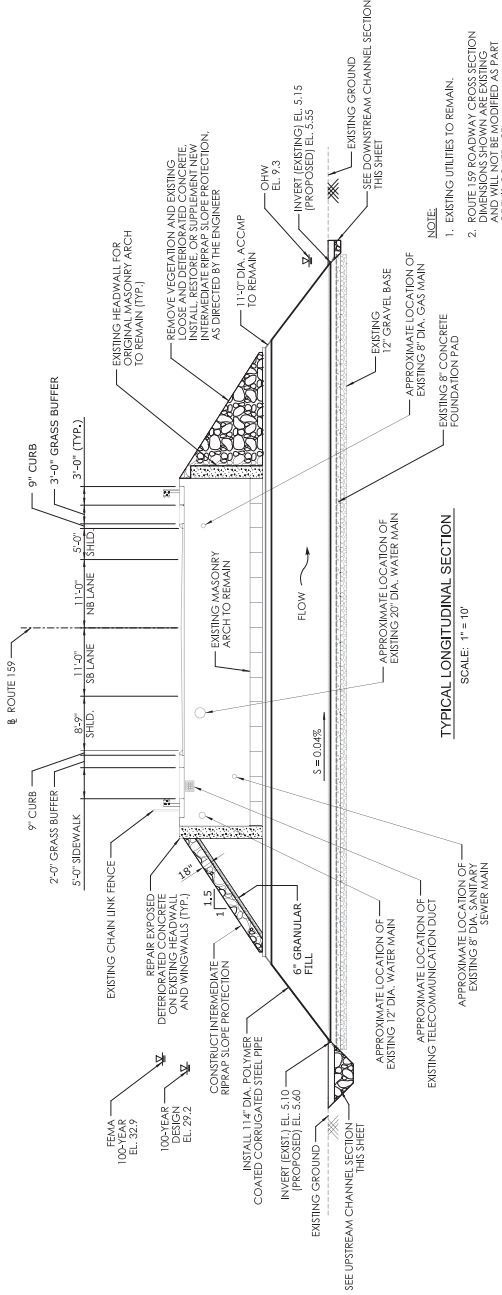

- NOTE:**
- EXISTING UTILITIES TO REMAIN.
 - ROUTE 159 ROADWAY CROSS SECTION DIMENSIONS SHOWN ARE EXISTING DIMENSIONS UNLESS NOTED OTHERWISE AS PART OF THIS CONTRACT.

TYPICAL LONGITUDINAL SECTION
SCALE: 1" = 10'

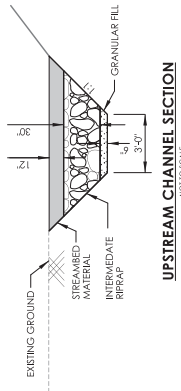

UPSTREAM CHANNEL SECTION
NOT TO SCALE

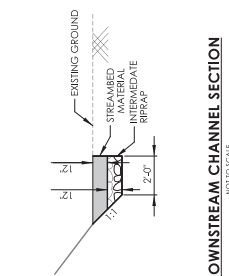

DOWNSTREAM CHANNEL SECTION
NOT TO SCALE

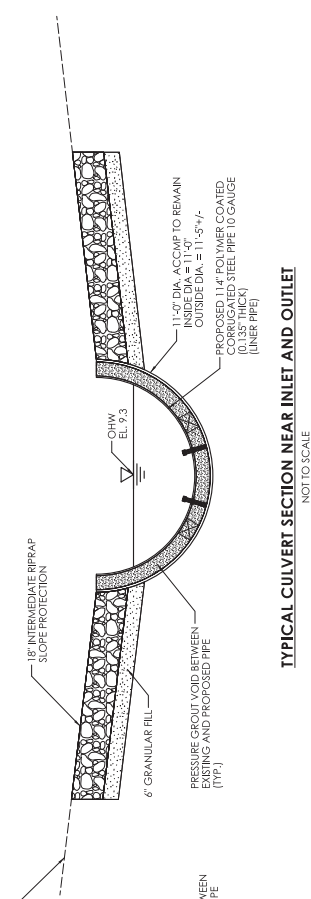

TYPICAL CULVERT SECTION NEAR INLET AND OUTLET
NOT TO SCALE

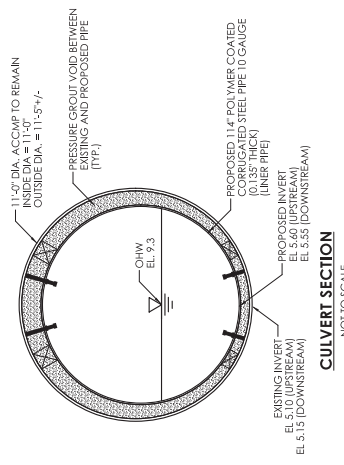

CULVERT SECTION
NOT TO SCALE

- NOTES:**
- THE ENTIRE PROJECT AREA IS WITHIN THE 100 YEAR FLOODPLAIN.
 - VERTICAL DATUM BASED ON NAVD 1988.

ENVIRONMENTAL PERMIT PLANS

DESIGNED BY: [Name] CHECKED BY: [Name]
DATE: 08/22/2023
LAST SAVER BY: [Name] FILE NAME: [Path] PLOT DATE: 12/22/2023

PROJECT NUMBER: 01-14-0246-03
PROJECT DESCRIPTION: REHABILITATION OF BRIDGE NO. 06574 CARRIAGE ROUTE 159 OVER MILL BROOK
TOWNSHIP: WINDSOR
DRAWING TITLE: TYPICAL SECTIONS



STATE OF CONNECTICUT
DEPARTMENT OF TRANSPORTATION
DESIGNED BY: [Name] CHECKED BY: [Name]
DATE: 08/22/2023
LAST SAVER BY: [Name] FILE NAME: [Path] PLOT DATE: 12/22/2023



REV	DATE	REVISION DESCRIPTION



Compliance Certification Form

The following certification must be signed by the licensee working in consultation with a Connecticut-licensed design professional and must be submitted to the address indicated at the end of this form within ninety (90) days of completion of the authorized work.

1. Licensee Name: <u>CT Department of Transportation</u> DEEP License Number(s): <u>202306916-FME</u> Municipality in which project is occurring: <u>Windsor</u>	
2. Check one: (a) <input type="checkbox"/> "I certify that the final site conditions and / or structures are in general conformance with the approved site plans". Identify and describe any deviations and attach to this form. (b) <input type="checkbox"/> "The final site conditions and / or structures are not in general conformance with the approved site plans. The enclosed "as-built" plans note the modifications".	
3. "I understand that any false statement in this certification is punishable as a criminal offence under section 53a-157b of the General Statutes and under any other applicable law."	
_____ Signature of Licensee	_____ Date
_____ Name of Licensee (print or type)	
_____ Signature of CT-Licensed Design Professional	_____ Date
_____ Name of CT-Licensed Design Professional (print or type)	
_____ Professional License Number (if applicable)	Affix Stamp Here <div style="border: 1px solid black; width: 150px; height: 100px; display: inline-block; vertical-align: middle;"></div>
<ul style="list-style-type: none"> • As-built plans shall include: elevations or tidal datums, as applicable, and structures, including any proposed elevation views and cross sections included in the approved license plans. Such as-built plans shall be the original ones and be signed and sealed by an engineer, surveyor or architect, as applicable, who is licensed in the State of Connecticut. • The Licensee will be notified by staff of the Land and Water Resources Division (LWRD) if further compliance review is necessary. Lack of response by LWRD staff does not imply compliance. <p>Submit this completed form to : DEEP.LWRDRegulatory@ct.gov or Regulatory Section Department of Energy and Environmental Protection Land & Water Resources Division 79 Elm Street Hartford, CT 06106-5127</p>	