

EROSION CONTROL NOTES:

- 1 SILT FENCE ON DOWN SLOPE ALONG CONSTRUCTION AREA & AROUND SPOIL PILE (IF APPLICABLE). SPOIL PILE IN UPLANDS IF POSSIBLE.
- 2 (IF GRADING OR CREATING ACCESS ROADS) TERRACING OR WATER BARS AND/OR SILT FENCE PERPENDICULAR TO SLOPE ON ACCESS ROAD AT BASE OF SLOPE
- 3 SILT FENCE ON DOWNSLOPE OR ALONG BOTH SIDES OF ACCESS ROAD IF SLOPING IN BOTH DIRECTIONS
- 4 INCLUDES 1 OR 3 AND TEMPORARY FILL/MAT DEPENDING ON TIME OF YEAR (WETNESS) (REQUIRES STREAM/WETLAND RESTORATION)
- 5 INCLUDES 4 AND POTENTIAL USE OF CULVERTS/FLUME PIPE CROSSING DEPENDING ON TIME OF YEAR (WETNESS) (REQUIRES STREAM/WETLAND RESTORATION)
- 6 ENVIRONMENTALLY SENSITIVE AREA
- 7 RESTRICTED ACCESS
- 8 TREE CLEARING REQUIRED (CUT OFF AT BASE & KEEP ROOT SYSTEM INTACT)
- 9 PERMANENT FILL REQUIRED (STONE OR WOOD SLAB BASE)
- 10 INSTALL INLET PROTECTION (IF APPLICABLE)

STRUCTURE DATA SUMMARY				
STR	DESCRIPTION	HEIGHT	FINISH	FOUNDATION
24096	345-kV Single Circuit Split Phase Tangent (0-2 deg)	145	GALVANIZED	84" DIA DRILLED SHAFT
24097	345-kV Single Circuit Split Phase Tangent (0-2 deg)	130	GALVANIZED	84" DIA DRILLED SHAFT
24098	345-kV Single Circuit Split Phase Tangent (0-2 deg)	130	GALVANIZED	84" DIA DRILLED SHAFT
24099	345-kV Single Circuit Compact Split Phase Angle (0-10 deg)	145	GALVANIZED	84" DIA DRILLED SHAFT
24100	345-kV Single Circuit Split Phase Tangent (0-2 deg)	140	GALVANIZED	84" DIA DRILLED SHAFT
24101	345-kV Single Circuit Split Phase Tangent (0-2 deg)	125	GALVANIZED	84" DIA DRILLED SHAFT
24102	345-kV Single Circuit Split Phase Tangent (0-2 deg)	120	GALVANIZED	84" DIA DRILLED SHAFT
24103	345-kV Single Circuit Compact Split Phase Angle (0-10 deg)	115	GALVANIZED	84" DIA DRILLED SHAFT
24104	345-kV Single Circuit Split Phase Tangent (0-2 deg)	115	GALVANIZED	84" DIA DRILLED SHAFT
24105	345-kV Single Circuit Split Phase Tangent (0-2 deg)	125	GALVANIZED	96" DIA DRILLED SHAFT
24106	345-kV Split Phase Compact Vertical Deadend (70-80 deg)	115	GALVANIZED	84" DIA DRILLED SHAFT
3909	115-kV Double Circuit Tangent (0-2 deg)	125	GALVANIZED	84" DIA DRILLED SHAFT
3910	115-kV Double Circuit Tangent (0-2 deg)	110	GALVANIZED	84" DIA DRILLED SHAFT
3911	115-kV Double Circuit Tangent (0-2 deg)	110	GALVANIZED	84" DIA DRILLED SHAFT
3912	115-kV Double Circuit Angle (0-10 deg)	120	GALVANIZED	84" DIA DRILLED SHAFT
3913	115-kV Double Circuit Tangent (0-2 deg)	115	GALVANIZED	84" DIA DRILLED SHAFT
3914	115-kV Double Circuit Tangent (0-2 deg)	100	GALVANIZED	84" DIA DRILLED SHAFT
3915	115-kV Double Circuit Tangent (0-2 deg)	100	GALVANIZED	84" DIA DRILLED SHAFT
3916	115-kV Double Circuit Angle (0-10 deg)	95	GALVANIZED	84" DIA DRILLED SHAFT
3917	115-kV Double Circuit Tangent (0-2 deg)	90	GALVANIZED	84" DIA DRILLED SHAFT
3918	115-kV Double Circuit Tangent (0-2 deg)	105	GALVANIZED	84" DIA DRILLED SHAFT
3919	115-kV Double Circuit Compact Vertical Deadend (69-79 deg)	85	GALVANIZED	96" DIA DRILLED SHAFT

Line List Number	Owner Name (Now or Formerly)	Assess. Parcel Number
1221	Hack, Jacob Isidore & Cylla	3001 440 4
1222	Rieger, Judith A.	3001 230 21
1223	Tein, David & Callie & Surv.	3001 230 25
1224	Iovino, Vincent & Nina & Surv.	3001 1660 9
1225	Zhang, Shaomin	3001 1660 13
1226	Cybrivsky, Natalie	3001 1660 17
1227	Switzer, Michael D. & Sandy R. & Surv.	3001 1660 20
1228	Zhang, Tingbin & Ni Li & Surv.	3001 220 14
1229	Boltax, Sandra P. AKA Stern, Sandra P.	2504 50 78
1230	Wolfe, Helen	3001 220 10
1231	Zawidniak, Emil & Ewa & Surv.	2603 50 76
1232	United Illuminating Co.	2603 50 70
1233	Holland, Daniel R. & Roberta J. & Surv.	2603 220 6
1234	Sabellco, Evelyn	2603 220 2
1235	Ingenito, Thomas J.	2603 110 1

Line List Number	Owner Name (Now or Formerly)	Assess. Parcel Number
1236	Foster, Laurie Stone & Stuart & Surv.	2603 50 65
1237	Rice, W. James	2603 50 59
1238	Niezelski, Marilyn	2603 110 5
1239	Lassiter, John H Sr.	2603 1070 24
1240	Shufro, Cathy	2603 110 9
1241	Berger, Harriet B.	2603 110 15
1242	Perez, Miguel & Betty O. & Surv.	2603 1070 23
1243	Goodman, Cathy Bennett	2603 110 19
1244	Mattei, Angela	2603 110 25
1245	Morgan, Peter T.	2603 1590 52
1246	Hovey, Scott	2601 110 27
1246.01	Stepto, Robert B. & Michele L.	2601 1590 80
1247	Connecticut Light & Power Co.	2601 1590 72
1248	Cogregation Bnai Jacob	2601 1590 75

PREDOMINANT WETLAND VEGETATION
 133: ROSE, GRAPE, GREENBRIER, BITTERSWEET, ALDER, OLIVE, HONEYSUCKLE, SILKY DOGWOOD, PHRAGMITES, SUMAC, RED OSIER DOGWOOD, HAZELNUT, BLUEBERRY, EUONYMUS, JAPANESE KNOTWEED, CEDAR, SHADBUSH, FLOWERING DOGWOOD
 134: SUMAC, ROSE, BARBERRY, GREENBRIER, HONEYSUCKLE, BITTERSWEET

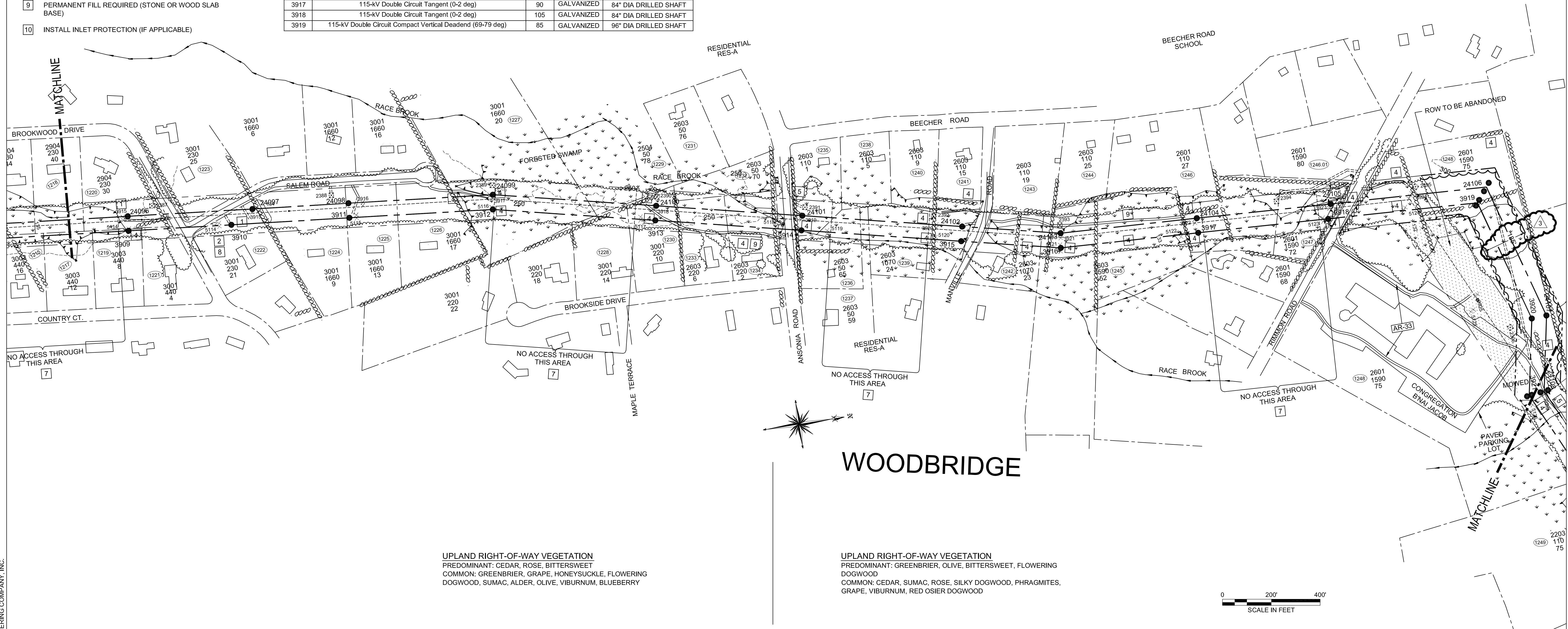

UPLAND RIGHT-OF-WAY VEGETATION
 PREDOMINANT: CEDAR, ROSE, BITTERSWEET
 COMMON: GREENBRIER, GRAPE, HONEYSUCKLE, FLOWERING DOGWOOD, SUMAC, ALDER, OLIVE, VIBURNUM, BLUEBERRY

UPLAND RIGHT-OF-WAY VEGETATION
 PREDOMINANT: GREENBRIER, OLIVE, BITTERSWEET, FLOWERING DOGWOOD
 COMMON: CEDAR, SUMAC, ROSE, SILKY DOGWOOD, PHRAGMITES, GRAPE, VIBURNUM, RED OSIER DOGWOOD

LEGEND

- | | | | | | | | |
|--|------------------------------|--|--|--|-----------------------|--|--|
| | SELECTIVE CLEARING AREAS | | NEW STRUCTURE CENTERLINE | | TRAIL | | EXISTING ACCESS ROAD |
| | EDGE OF PROPOSED CLEARING | | MONUMENT CENTERLINE | | CONTOUR LINE | | TEMPORARY ACCESS ROAD (APPROXIMATE LOCATION) |
| | EDGE OF EXISTING CLEARING | | EXISTING WORKING EDGE OF R.O.W. | | PROPERTY LINE | | PROPOSED ACCESS ROAD (APPROXIMATE LOCATION) |
| | FENCE | | PROPOSED EDGE OF R.O.W. (INCLUDING WORKING EDGE) | | CL&P PROPERTY LINE | | TOWN LINE |
| | NEW POLE | | WETLAND AREA | | STREAM FLOW DIRECTION | | STONE WALL |
| | EXISTING POLE TO BE REMOVED | | WETLAND BOUNDARY | | EXISTING CULVERT | | UTILITY POLE |
| | EXISTING POLE TO REMAIN | | | | MARKETABLE TIMBER | | R.O.W. GATE |
| | EXISTING TOWER TO BE REMOVED | | | | | | |
| | EXISTING TOWER TO REMAIN | | | | | | |



38565
 date AUG 4, 2005 detailed J. BOYER
 designed J. BOYER checked J. HOGAN
 MAKE NO MANUAL CHANGES

NO.	DATE	REVISIONS	BY	CHK	APP	APP
3	7/11/06	REVISED NEW & EXISTING ROW FROM RIMMON RD THROUGH B'NAI JACOB PROP	JPB	JMH		
2	6/15/06	ISSUED FOR CSC REVIEW	JPB	JMH		
1	4/18/06	ISSUED FOR TOWN REVIEW	JPB	JMH		

NORTHEAST UTILITIES SERVICE CO.			
FOR THE CONNECTICUT LIGHT & POWER CO.			
TITLE EAST DEVON S/S - BESECK S/S 345KV LINE			
DEVELOPMENT & MANAGEMENT PLAN SEGMENT 2B			
BY	JPB	CHKD	-
APP	-	APP	-
DATE	11/4/2005	DATE	-
SCALE	1"=200'	DWG. NO.	01229-15001

COPYRIGHT © 2006 BURNS & MCDONNELL ENGINEERING COMPANY, INC.