

EROSION CONTROL NOTES:

- 1 SILT FENCE ON DOWN SLOPE ALONG CONSTRUCTION AREA & AROUND SPOIL PILE (IF APPLICABLE), SPOIL PILE IN UPLANDS IF POSSIBLE.
- 2 (IF GRADING OR CREATING ACCESS ROADS) TERRACING OR WATER BARS AND/OR SILT FENCE PERPENDICULAR TO SLOPE ON ACCESS ROAD AT BASE OF SLOPE
- 3 SILT FENCE ON DOWNSLOPE OR ALONG BOTH SIDES OF ACCESS ROAD IF SLOPING IN BOTH DIRECTIONS
- 4 INCLUDES 1 OR 3 AND TEMPORARY FILL/MAT DEPENDING ON TIME OF YEAR (WETNESS) (REQUIRES STREAM/WETLAND RESTORATION)
- 5 INCLUDES 4 AND POTENTIAL USE OF CULVERTS/FLUME PIPE CROSSING DEPENDING ON TIME OF YEAR (WETNESS) (REQUIRES STREAM/WETLAND RESTORATION)
- 6 ENVIRONMENTALLY SENSITIVE AREA
- 7 RESTRICTED ACCESS
- 8 TREE CLEARING REQUIRED (CUT OFF AT BASE & KEEP ROOT SYSTEM INTACT)
- 9 PERMANENT FILL REQUIRED (STONE OR WOOD SLAB BASE)

Line List Number	Owner Name (Now or Formerly)	Assess. Parcel Number
92	Beaudoin, Yvon	12 6
94	Lyman Farm, Inc.	13 1
95	Lyman Farm, Inc.	4 1
96	Czaja, Joachim and Jeannette C.	14 2

PREDOMINANT WETLAND VEGETATION

38: SILKY DOGWOOD, PHRAGMITES, VIBURNUM, PURPLE LOOSTRIFE, ROSE, BITTERSWEET, ALDER, HONEYSUCKLE
38A: NO LISTED SPECIES

MIDDLEFIELD

TOWN OF MIDDLEFIELD
100 YEAR FLOOD HAZARD AREA

AGRICULTURE
AG-2

LYMAN ORCHARDS GOLF COURSE

* WILL WORK WITH GOLF COURSE TO DETERMINE ACCESS AND CONSTRUCTION AREAS

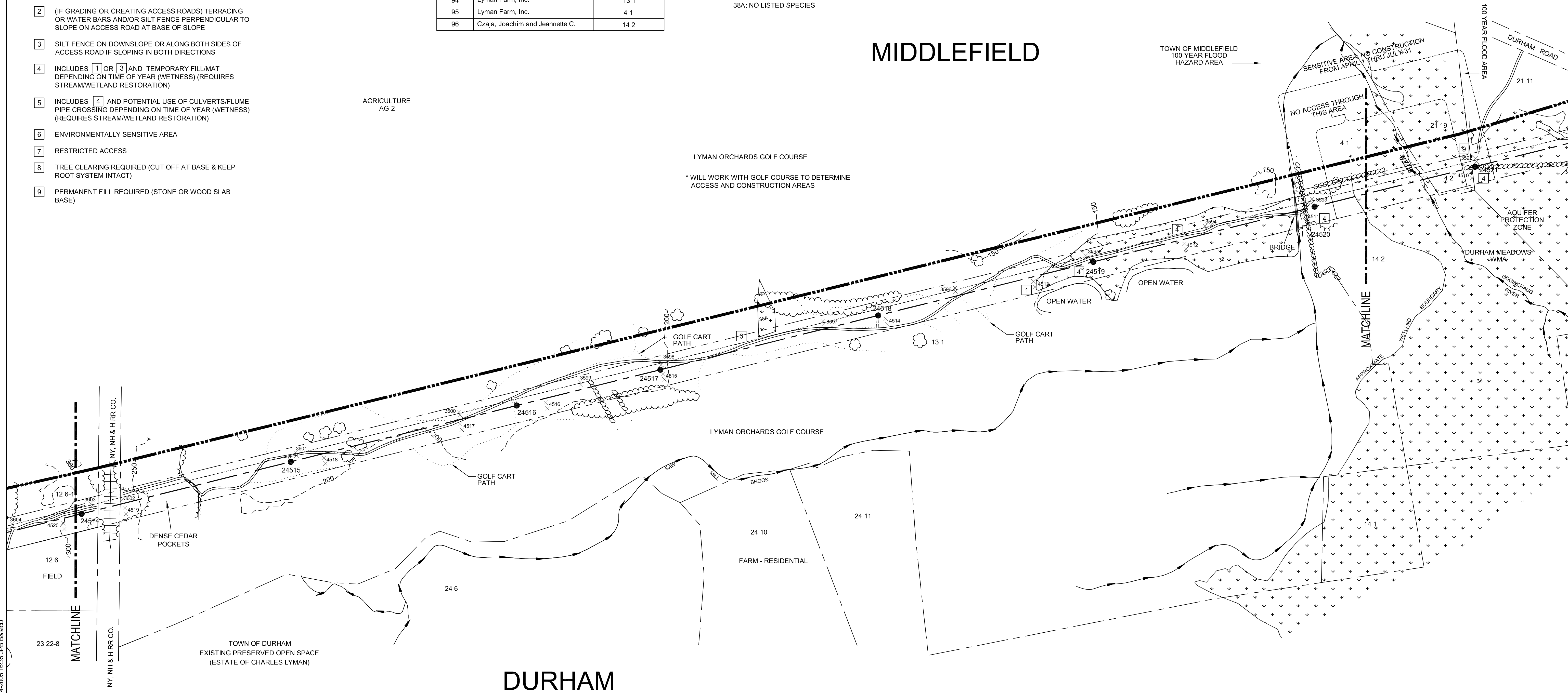

STRUCTURE DATA SUMMARY

STR	DESCRIPTION	HEIGHT	FINISH	FOUNDATION
24514	345/115-KV COMPOSITE TANGENT (0-2 DEG)	115'	WEATHERING	84" DIA DRILLED SHAFT
24515	345/115-KV COMPOSITE TANGENT (0-1 DEG)	135'	WEATHERING	84" DIA DRILLED SHAFT
24516	345/115-KV COMPOSITE TANGENT (0-1 DEG)	125'	WEATHERING	84" DIA DRILLED SHAFT
24517	345/115-KV COMPOSITE TANGENT (0-2 DEG)	110'	WEATHERING	84" DIA DRILLED SHAFT
24518	345/115-KV COMPOSITE TANGENT (0-2 DEG)	125'	WEATHERING	84" DIA DRILLED SHAFT
24519	345/115-KV COMPOSITE TANGENT (0-1 DEG)	130'	WEATHERING	84" DIA DRILLED SHAFT
24520	345/115-KV COMPOSITE TANGENT (0-2 DEG)	125'	WEATHERING	84" DIA DRILLED SHAFT

UPLAND RIGHT-OF-WAY VEGETATION

COMMON: EASTERN RED CEDAR, HONEYSUCKLE, ROSE, SUMAC, BARBERRY, BITTERSWEET, OLIVE

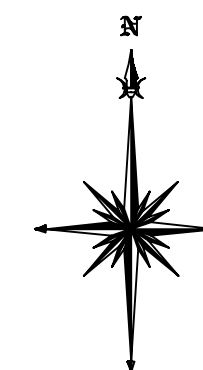

N:\USCO\38565\Cadd\OHD-M_PLANS\Segment 1\Seg 1 D-M Plan.dwg (01225-15001p003) 11-14-2005 16:35 JPB B&M&D

- SELECTIVE CLEARING AREAS
- EDGE OF PROPOSED CLEARING
- EDGE OF EXISTING CLEARING
- FENCE
- NEW POLE
- EXISTING POLE TO BE REMOVED
- EXISTING POLE TO REMAIN

- NEW STRUCTURE CENTERLINE
- MONUMENT CENTERLINE
- EXISTING WORKING EDGE OF R.O.W.
- PROPOSED EDGE OF R.O.W. (INCLUDING WORKING EDGE)
- WETLAND AREA
- WETLAND BOUNDARY

- TRAIL
- CONTOUR LINE
- PROPERTY LINE
- CL&P PROPERTY LINE
- STREAM FLOW DIRECTION
- EXISTING CULVERT
- MARKETABLE TIMBER

- EXISTING ACCESS ROAD
- TEMPORARY ACCESS ROAD (APPROXIMATE LOCATION)
- PROPOSED ACCESS ROAD (APPROXIMATE LOCATION)
- TOWNLINE
- STONE WALL
- UTILITY POLE
- R.O.W. GATE

CAD GENERATED DWG
MAKE NO MANUAL CHANGES



38565

date AUGUST 4, 2005
designed M. COLLINS
detailed J. BOYER
checked J. HOGAN

NO.	DATE	REVISIONS	BY	CHK	APP	APP

NORTHEAST UTILITIES SERVICE CO.

FOR THE CONNECTICUT LIGHT & POWER CO.
TITLE BESECK S/S - OXBOW JCT 345/115KV LINE
DEVELOPMENT & MANAGEMENT PLAN
SEGMENT 1A

BY MEC - BMCD CHKD - APP - APP -
DATE AUG 2005 DATE - DATE - DATE -
SCALE 1"=200'
D DWG. NO. 01225-15001