

PREDOMINANT WETLAND VEGETATION

- 50: SILKY DOGWOOD, ALDER
 51: SILKY DOGWOOD, ALDER
 52: ROSE, CAT TAIL
 52A, 52B: OUTSIDE ROW
 54: SILKY DOGWOOD, ALDER, ROSE
 55: NO LISTED SPECIES

WEST LINE STRUCTURE DATA SUMMARY

STR	DESCRIPTION	HEIGHT	FINISH	FOUNDATION
24408	345/115-KV DOUBLE CIRCUIT ANGLE (10-20 DEG)	140	GALVANIZED	84" DIA DRILLED SHAFT
24409	345/115-KV DOUBLE CIRCUIT TANGENT (0-2 DEG)	135	GALVANIZED	84" DIA DRILLED SHAFT
24410	345/115-KV DOUBLE CIRCUIT TANGENT (0-2 DEG)	125	GALVANIZED	84" DIA DRILLED SHAFT
24411	345/115-KV DOUBLE CIRCUIT ANGLE (10-20 DEG)	140	GALVANIZED	84" DIA DRILLED SHAFT
24412	345-KV SINGLE CIRCUIT VERTICAL DEADEND (0-10 DEG)	140	GALVANIZED	96" DIA DRILLED SHAFT
24413	345-KV SINGLE CIRCUIT TANGENT (0-2 DEG) VERTICAL	155	GALVANIZED	84" DIA DRILLED SHAFT
24414	345-KV SINGLE CIRCUIT TANGENT (0-2 DEG) VERTICAL	130	GALVANIZED	84" DIA DRILLED SHAFT
24415	345-KV SINGLE CIRCUIT TANGENT (0-2 DEG) VERTICAL	130	GALVANIZED	84" DIA DRILLED SHAFT
24416	345-KV SINGLE CIRCUIT ANGLE (10-20 DEG) VERTICAL	130	GALVANIZED	84" DIA DRILLED SHAFT
24417	345-KV SINGLE CIRCUIT TANGENT (0-2 DEG) VERTICAL	130	GALVANIZED	84" DIA DRILLED SHAFT
6391	115-KV SINGLE CIRCUIT DE (0-10 DEG)	100	GALVANIZED	84" DIA DRILLED SHAFT
6392	115-KV SINGLE CIRCUIT 3-POLE DE (90-100 DEG)	70	GALVANIZED	84" DIA DRILLED SHAFT

MIDDLE LINE STRUCTURE DATA SUMMARY

STR	DESCRIPTION	HEIGHT	FINISH	FOUNDATION
8749	345-KV SINGLE CIRCUIT ANGLE (10-20 DEG) VERTICAL	125	GALVANIZED	84" DIA DRILLED SHAFT
8746	345-KV SINGLE CIRCUIT ANGLE (10-20 DEG) VERTICAL	135	GALVANIZED	84" DIA DRILLED SHAFT
24461	345-KV SINGLE CIRCUIT VERTICAL DEADEND (0-10 DEG)	135	GALVANIZED	96" DIA DRILLED SHAFT
24462	345-KV SINGLE CIRCUIT TANGENT (0-2 DEG) VERTICAL	135	GALVANIZED	84" DIA DRILLED SHAFT
24463	345-KV SINGLE CIRCUIT TANGENT (0-2 DEG) VERTICAL	125	GALVANIZED	84" DIA DRILLED SHAFT
24464	345-KV SINGLE CIRCUIT TANGENT (0-2 DEG) VERTICAL	120	GALVANIZED	84" DIA DRILLED SHAFT
24465	345-KV SINGLE CIRCUIT ANGLE (10-20 DEG) VERTICAL	125	GALVANIZED	84" DIA DRILLED SHAFT
24466	345-KV SINGLE CIRCUIT TANGENT (0-2 DEG) VERTICAL	135	GALVANIZED	84" DIA DRILLED SHAFT

EAST LINE STRUCTURE DATA SUMMARY

STR	DESCRIPTION	HEIGHT	FINISH	FOUNDATION
24456	345/115-KV DOUBLE CIRCUIT ANGLE (10-20 DEG)	195'	GALVANIZED	96" DIA DRILLED SHAFT
24457	345/115-KV DOUBLE CIRCUIT ANGLE (0-10 DEG)	140	GALVANIZED	84" DIA DRILLED SHAFT
24458	345/115-KV DOUBLE CIRCUIT TANGENT (0-2 DEG)	120	GALVANIZED	84" DIA DRILLED SHAFT
24459	345/115-KV DOUBLE CIRCUIT ANGLE (10-20 DEG)	140	GALVANIZED	84" DIA DRILLED SHAFT
9411	345/115-KV DOUBLE CIRCUIT COMPOSITE DE (0-10 DEG)	130	GALVANIZED	96" DIA DRILLED SHAFT
9407	345-KV SINGLE CIRCUIT ANGLE (10-20 DEG) VERTICAL	130	GALVANIZED	84" DIA DRILLED SHAFT

SEARCH AND DEVELOPMENT
M-4

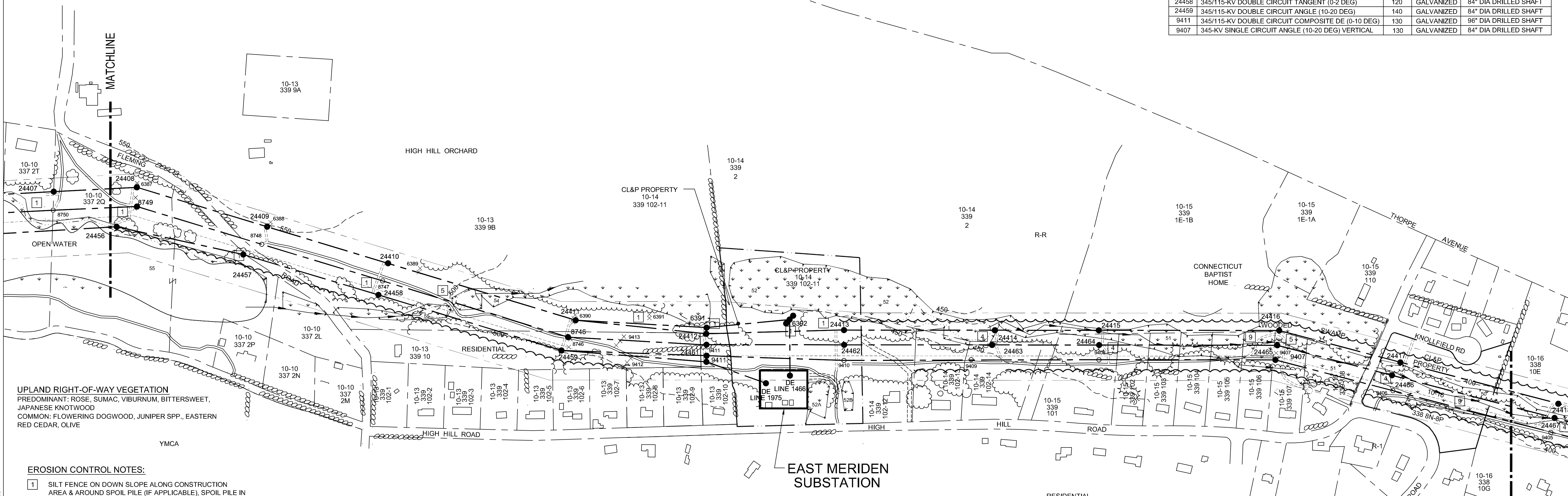

UPLAND RIGHT-OF-WAY VEGETATION
 PREDOMINANT: ROSE, SUMAC, VIBURNUM, BITTERSWEET, JAPANESE KNOTWOOD
 COMMON: FLOWERING DOGWOOD, JUNIPER SPP., EASTERN RED CEDAR, OLIVE

EROSION CONTROL NOTES:

- SILT FENCE ON DOWN SLOPE ALONG CONSTRUCTION AREA & AROUND SPOIL PILE (IF APPLICABLE). SPOIL PILE IN UPLANDS IF POSSIBLE.
- (IF GRADING OR CREATING ACCESS ROADS) TERRACING OR WATER BARS AND/OR SILT FENCE PERPENDICULAR TO SLOPE ON ACCESS ROAD AT BASE OF SLOPE
- SILT FENCE ON DOWNSLOPE OR ALONG BOTH SIDES OF ACCESS ROAD IF SLOPING IN BOTH DIRECTIONS
- INCLUDES [1] OR [3] AND TEMPORARY FILL/MAT DEPENDING ON TIME OF YEAR (WETNESS) (REQUIRES STREAM/WETLAND RESTORATION)
- INCLUDES [4] AND POTENTIAL USE OF CULVERTS/FLUME PIPE CROSSING DEPENDING ON TIME OF YEAR (WETNESS) (REQUIRES STREAM/WETLAND RESTORATION)
- ENVIRONMENTALLY SENSITIVE AREA
- RESTRICTED ACCESS
- TREE CLEARING REQUIRED (CUT OFF AT BASE & KEEP ROOT SYSTEM INTACT)
- PERMANENT FILL REQUIRED (STONE OR WOOD SLAB BASE)

Line List Number	Owner Name (Now or Formerly)	Assess. Parcel Number
230	Shoneck, Ronald and Bernadette	10-10 337 2Q
232	Todd A. Shoneck	10-10 337 2L
233	High Hill Orchard Company	10-13 339 9B
234	Lopez, Luis A. and Daisy Y.	10-13 339 10
235	Scott & Andrea Pavelkops	10-13 339 102 4
236	Wiktor, Benjamin P. & Helen	10-13 339 102 5
237	Grasso, Joseph S. & Mary E.	10-13 339 102 6
238	City of Meriden	10-14 339 2-7
239	Asselin, Raymond R. and Leah C.	10-13 339 102 8
240	Stott, Gary E.	10-13 339 102 9
241	Goodwin, Evelyn L.	10-13 339 102 10
242	Connecticut Light and Power Company	10-14 339 0102 11
243	Couturier, Ino A. and Murielle	10-14 339 102 12
244	Swistak, John P. and Nancy A.	10-14 339 102 13

Line List Number	Owner Name (Now or Formerly)	Assess. Parcel Number
245	Wedman, Gregory G.	10-14 339 102 14
247	Green, Joann S.	10-15 339 101
248	Connecticut Baptists Homes Inc Medical Care Home	10-15 339 1E 1B
249	Ball, Christopher M. and Julie S.	10-15 339 102
250	Lloyd, Robert R. and Donna Fulton	10-15 339 103
251	Nessing, Christopher B.	10-15 339 104
252	Hurst, Frederick and Martha	10-15 339 105
253	Papadopoulos, George	10-15 339 106
254	Bennett, Richard M. and Rosemary	10-15 339 107
255	Magyar, Robert J. and Jeanne E.	10-15 339 108
257	Connecticut Light and Power Company	10-16 338 8N-8P
260	Alusitz William O. & Nancy M.	10-16 338 10G
261	King, Jean Johnson	10-16 338 10E

LEGEND

	SELECTIVE CLEARING AREAS		NEW STRUCTURE CENTERLINE		TRAIL		EXISTING ACCESS ROAD
	EDGE OF PROPOSED CLEARING		MONUMENT CENTERLINE		CONTOUR LINE		TEMPORARY ACCESS ROAD (APPROXIMATE LOCATION)
	EDGE OF EXISTING CLEARING		EXISTING WORKING EDGE OF R.O.W.		PROPERTY LINE		PROPOSED ACCESS ROAD (APPROXIMATE LOCATION)
	FENCE		PROPOSED EDGE OF R.O.W. (INCLUDING WORKING EDGE)		CL&P PROPERTY LINE		TOWNLIN
	NEW POLE		WETLAND AREA		STREAM FLOW DIRECTION		STONE WALL
	EXISTING POLE TO BE REMOVED		WETLAND BOUNDARY		EXISTING CULVERT		UTILITY POLE
	EXISTING POLE TO REMAIN				MARKETABLE TIMBER		R.O.W. GATE

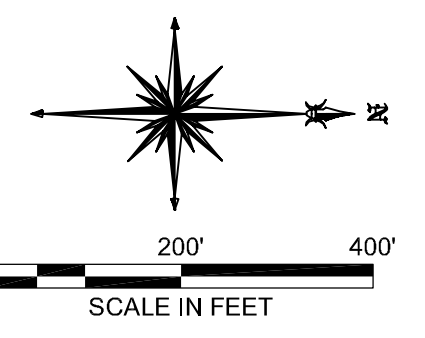

38565
 date AUGUST 4, 2005 detailed J. BOYER
 designed M. COLLINS checked J. HOGAN

NO.	DATE	REVISIONS	BY	CHK	APP	APP

NORTHEAST UTILITIES SERVICE CO.

FOR THE CONNECTICUT LIGHT & POWER CO.
 TITLE BESECK S/S - BLACK POND JCT 345/115KV LINE
 DEVELOPMENT & MANAGEMENT PLAN SEGMENT 1A

BY MEC - BMCD	CHKD -	APP -	APP -
DATE AUG 2005	DATE -	DATE -	DATE -
SCALE 1"=200'	D	DWG. NO.	01227-15001