

EXHIBIT K

Remote Field Review



Proposed Solar Energy Facility
270 Preston Road
Plymouth, Connecticut

Prepared For:
Terryville Solar One, LLC

Prepared By:
Solli Engineering

Site Visits : March & May 2025



Approximate location
of proposed
interconnection point

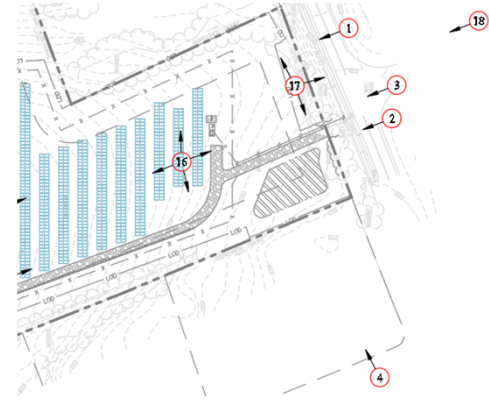

Preston Road



Photo 1: Facing North

Access Drive

Preston Road



Photo 1: Facing North

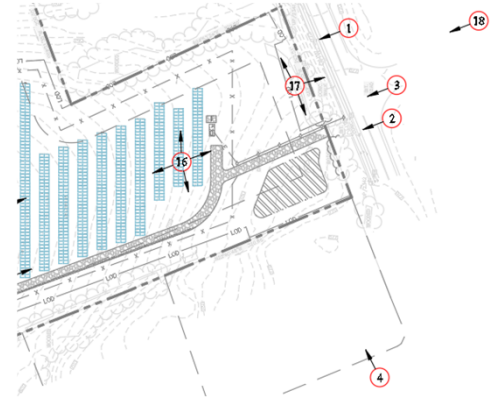

Access Drive

Preston Road

Old Farm Road

Abutting Residence



Photo 3: Facing North

Photo 4: Facing East

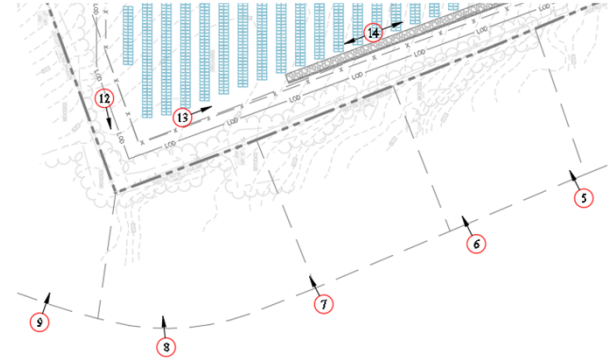

Abutting Residence

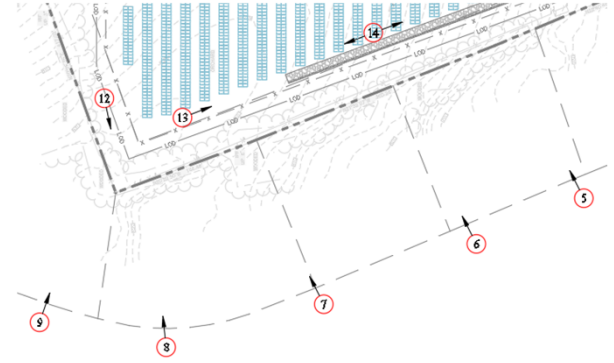

Photo 5: Facing East

Abutting Residence



Photo 6: Facing East



Abutting Residence

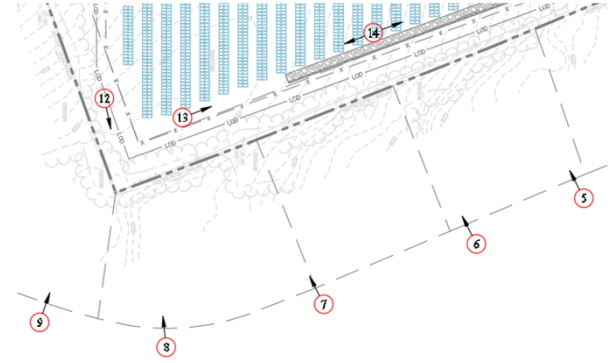

Photo 7: Facing East

Abutting Residence



Photo 8: Facing East



Abutting Residence



Photo 9: Facing East



Photo 10: Facing South

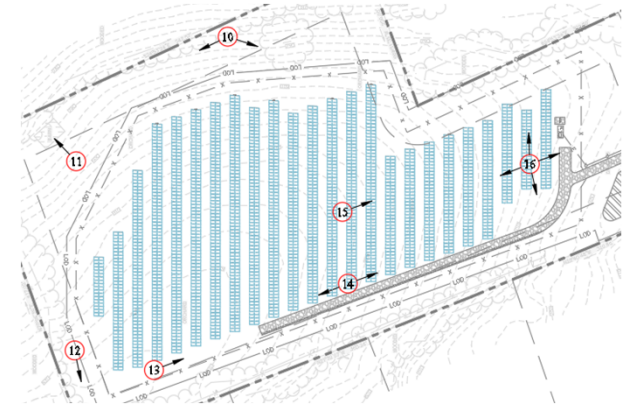

Existing Structure To Remain

Evergreen Trees to be transplanted



Photo 10: Facing North



Photo 11: Facing Northeast

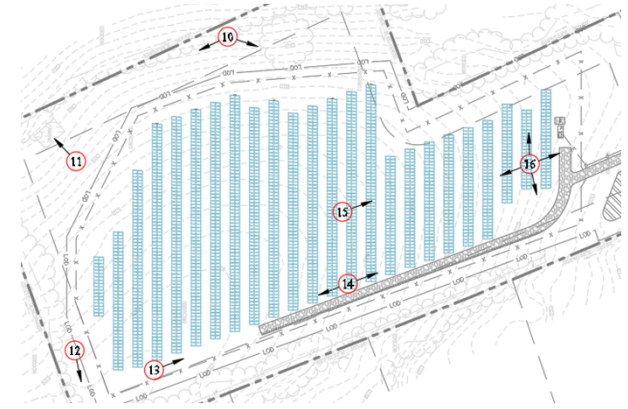

Photo 12: Facing West



Photo 13: South

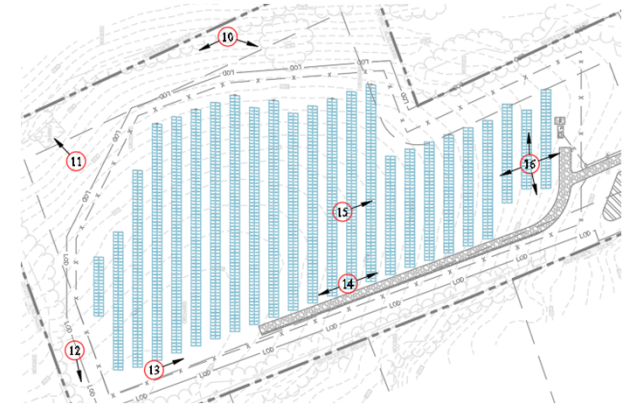

Photo 14: North



Photo 14: South

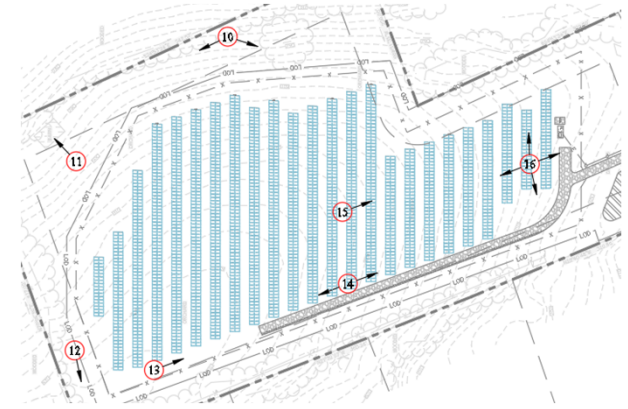

Photo 15: Facing South



Photo 16: Facing East

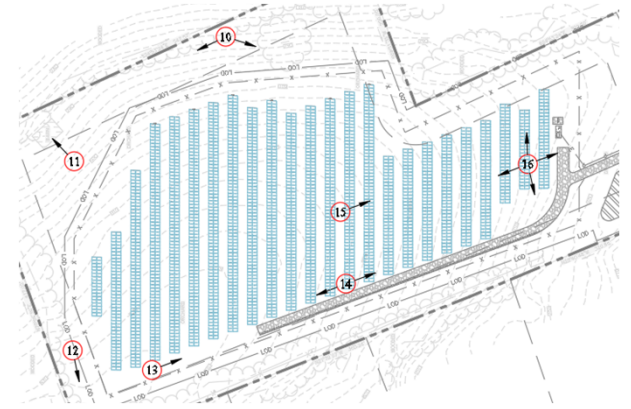

Photo 16: Facing South



Photo 16: Facing West

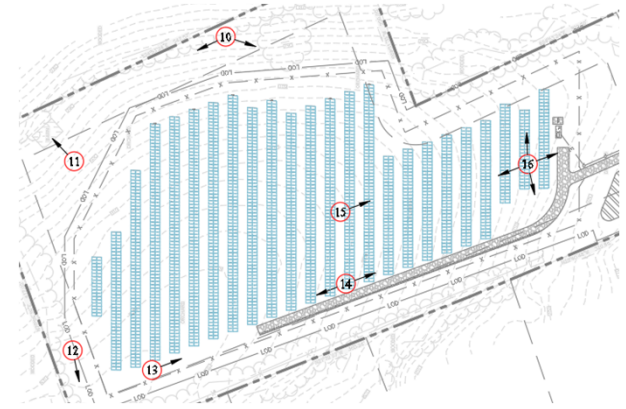
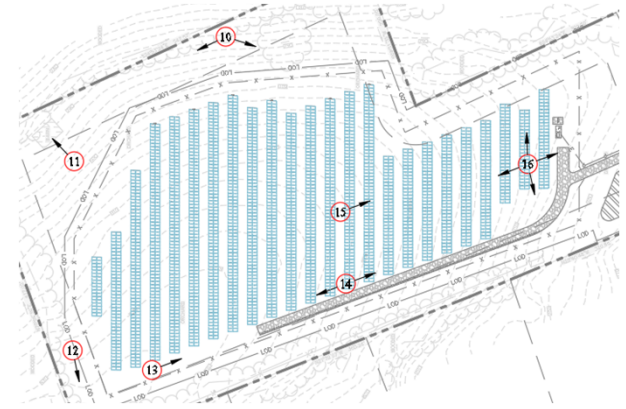

Photo 16: Facing North



Photo 17: Facing East



Approximate location of proposed utility poles

Approximate location of proposed stormwater basin

Proposed Access Drive

Preston Road



Photo 17: Facing West



Photo 17: Facing South

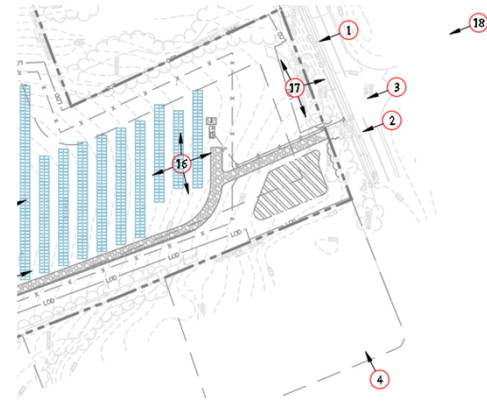

Old Farm Road

Approximate location of proposed solar array

Abutting Residences

Abutting Residence



Approximate location of proposed basin

Access Drive

Preston Road

Approximate location of proposed interconnection point

Photo 18: Looking North (From Drone)