

## Appendix B – Project Plans

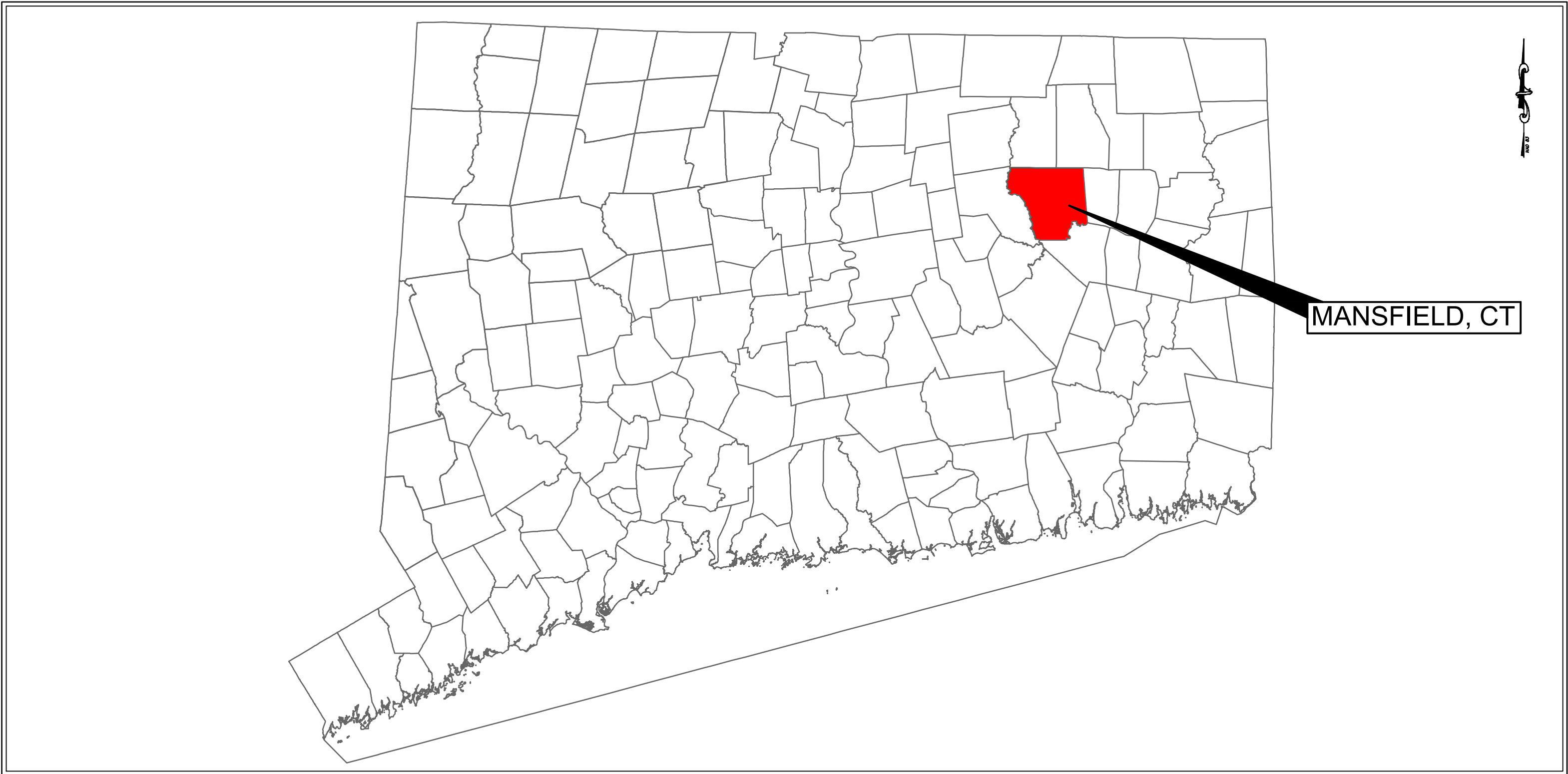

# TOWN OF MANSFIELD LANDFILL SOLAR PV DEVELOPMENT

221 WARRENVILLE ROAD, MANSFIELD, CONNECTICUT



CONNECTICUT MUNICIPAL MAP

NOT TO SCALE

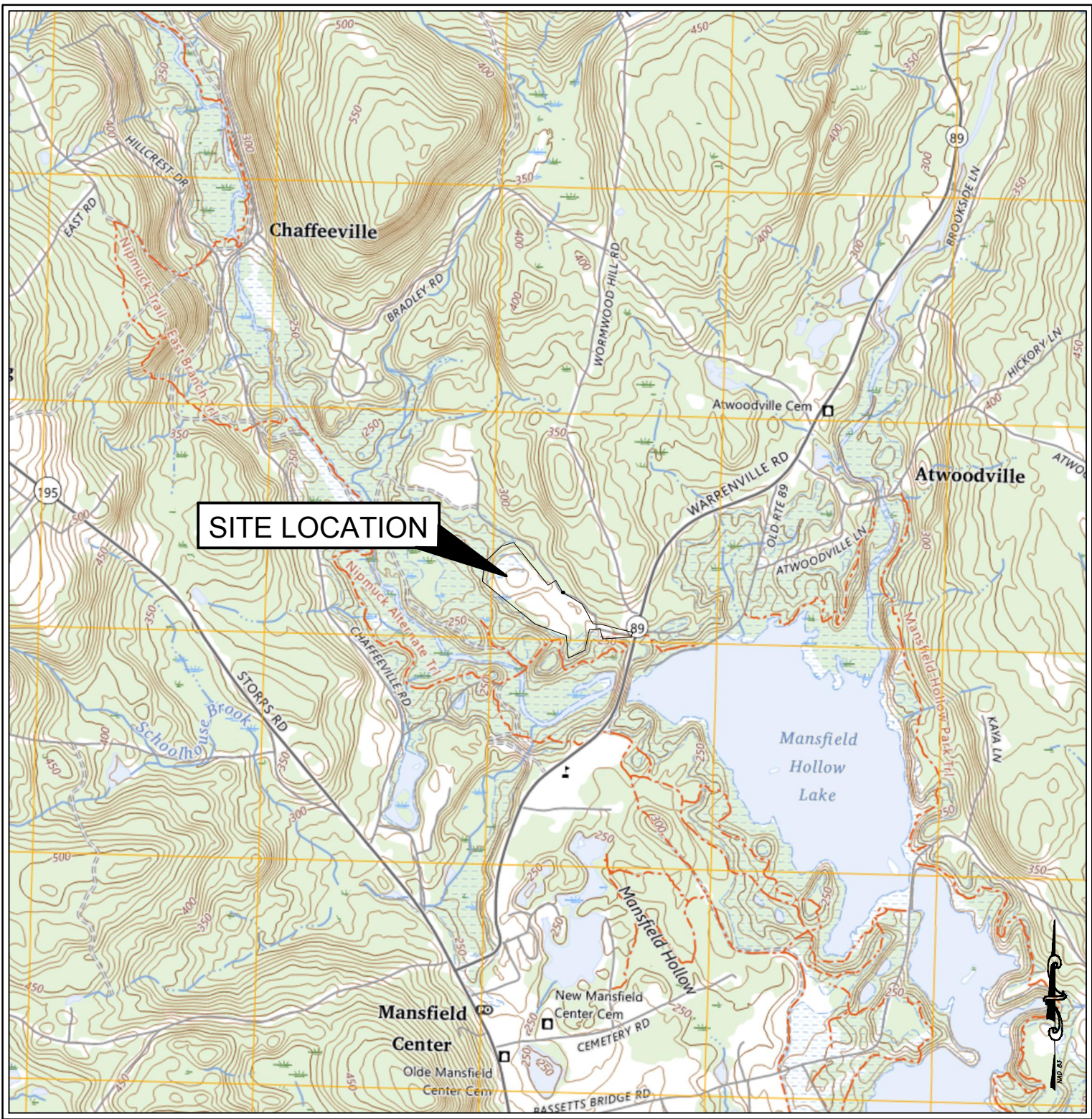

SITE LOCUS MAP

1" = 2,000'



SITE AERIAL MAP

1" = 500'

DRAWING INDEX	
SHEET NUMBER	SHEET TITLE
GENERAL	
G000	COVER SHEET
SURVEY	
	PLAN OF LAND IN MANSFIELD, CT
CIVIL	
C001	NOTES AND SPECIFICATIONS
C101	PROPOSED SITE PLAN
C501	DETAILS I
C502	DETAILS II

SITE INFORMATION	
LAND OWNER:	TOWN OF MANSFIELD
BOOK:	114
PAGE:	621
TAX MAP:	24
LOT:	68-14
PARCEL ID	24.68.14
PARCEL AREA:	26.74 ACRES
ZONING CODE :	RURAL AGRICULTURAL RESIDENCE 90 ZONE (RAR-90)
MINIMUM LOT AREA:	90,000 ACRES
MINIMUM LOT FRONTGE:	200 FEET
MINIMUM FRONT SETBACK LINE:	60 FEET
MINIMUM SIDE SETBACK LINE:	35 FEET
MINIMUM REAR SETBACK LINE:	50 FEET
MAXIMUM HEIGHT:	35 FEET

LAND OWNER:



Town of Mansfield  
Audrey P. Beck Municipal Building  
4 S Eagleville Road  
Storrs Mansfield, CT 06268  
Tel: (860) 429-3302

PROJECT DEVELOPER:



VCP Mansfield LF, LLC  
124 LaSalle Road  
2nd Floor  
West Hartford, CT 06107  
Tel: (860) 288-7215  
www.verogy.com

CONSULTANT:



Weston & Sampson Engineers, INC.  
712 Brook Street, Suite 103  
Rocky Hill, CT 06067  
860.513.1473  
800.SAMPSON  
www.westonandsampson.com

0	ISSUED FOR PERMITTING	10/09/2024
REV #	DESCRIPTION	DATE



Issued For:	PERMITTING	Drawn By:	DED
Issued Date:	10/09/2024	Reviewed By:	MRC
Approved By:	RJB	Job No:	ENG24-1027
Drawing Title:	COVER SHEET	Sheet Number:	G001







GENERAL NOTES:

- THE CONTRACTOR SHALL ABIDE BY ALL LOCAL, STATE, AND FEDERAL LAWS, RULES AND REGULATIONS WHICH APPLY TO THE CONSTRUCTION OF THESE IMPROVEMENTS, INCLUDING STATE AND FEDERAL REQUIREMENTS WITH RESPECT TO STORMWATER DISCHARGE.
- THE CONTRACTOR IS RESPONSIBLE FOR PROTECTING ALL EXISTING UTILITY LINES WITHIN OR ADJACENT TO THE CONSTRUCTION AREA. ANY DAMAGE TO EXISTING FACILITIES CAUSED BY CONSTRUCTION ACTIVITY SHALL BE REPAIRED OR REPLACED AT THE CONTRACTOR'S EXPENSE.
- CONSTRUCTION SHALL NOT OCCUR IN ANY PUBLIC RIGHTS OF WAY, PUBLIC OR PRIVATE EASEMENTS, BEYOND THE LIMITS OF DISTURBANCE, OR OUTSIDE THE PROPERTY LIMITS WITHOUT NECESSARY PERMITS. ANY PUBLIC OR PRIVATE PROPERTY OR IMPROVEMENTS DAMAGED DURING CONSTRUCTION SHALL BE REPAIRED TO THE SATISFACTION OF THE OWNER AND TOWN OF MANSFIELD AT THE COST OF THE CONTRACTOR.
- OVERNIGHT PARKING OF CONSTRUCTION EQUIPMENT SHALL NOT OBSTRUCT DRIVEWAYS OR DESIGNATED TRAFFIC LANES. THE CONTRACTOR SHALL NOT STORE ANY EQUIPMENT OR MATERIAL WITHIN THE PUBLIC RIGHT OF WAY. OVERNIGHT PARKING OF CONSTRUCTION VEHICLES ON PRIVATE PROPERTY IS THE SOLE RESPONSIBILITY OF THE CONTRACTOR.
- ALL PROPERTY CORNERS OR MONUMENTS DESTROYED DURING CONSTRUCTION SHALL BE REPLACED AT THE CONTRACTOR'S EXPENSE. ALL PROPERTY CORNERS MUST BE RESET BY A PROFESSIONAL LAND SURVEYOR LICENSED IN THE STATE OF CONNECTICUT.
- CONTRACTOR SHALL COMPLY WITH ALL FEDERAL, STATE, AND LOCAL LAWS AND REGULATIONS CONTROLLING THE POLLUTION OF THE ENVIRONMENT.
- CONTRACTOR TO ENSURE ALL WORK PERFORMED IS IN ACCORDANCE WITH EXISTING PROJECT PERMITS, STUDIES, AND REPORTS PROVIDED IN THE CONTRACT DOCUMENTS.
- IT IS THE INTENT OF THESE PLANS THAT THE CONTRACTOR SHALL NOT PERFORM ANY WORK OUTSIDE THE IDENTIFIED PROJECT BOUNDARIES AND CLEARING LIMITS.
- CONTRACTOR TO AVOID THE DELINEATED WETLAND AREAS AND NATURAL RESOURCES ONSITE.
- CONTRACTOR IS RESPONSIBLE FOR MAINTAINING DRAINAGE THROUGHOUT THE CONSTRUCTION OF THE PROJECT.
- ALL WORK IN THE PUBLIC RIGHTS OF WAY SHALL CONFORM WITH THE CONNECTICUT DEPARTMENT OF TRANSPORTATION "STANDARD SPECIFICATIONS"
- HERBICIDES SHALL NOT BE USED FOR VEGETATION MANAGEMENT.
- THE CONTRACTOR SHALL PROPERLY DISPOSE OF ALL REFUSE IN A TIMELY AND SAFE MANNER.
- THE SITE SHALL EMPLOY BEST MANAGEMENT PRACTICES FOR SOIL EROSION AND SEDIMENTATION CONTROL.

CONSTRUCTION NOTES:

- THE CONTRACTOR SHALL "CALL BEFORE YOU DIG" AT 811 OR 1-800-922-4455 AT LEAST 72 HOURS, SATURDAYS, SUNDAYS, AND HOLIDAYS EXCLUDED, PRIOR TO EXCAVATING AT ANY LOCATION. A COPY OF THE DIG SAFE PROJECT REFERENCE NUMBER(S) SHALL BE GIVEN TO THE OWNER PRIOR TO EXCAVATION.
- LOCATIONS OF EXISTING PIPES, CONDUITS, UTILITIES, FOUNDATIONS AND OTHER UNDERGROUND OBJECTS ARE NOT WARRANTED TO BE CORRECT AND THE CONTRACTOR SHALL HAVE NO CLAIM ON THAT ACCOUNT SHOULD THEY BE OTHER THAN SHOWN.
- STONE WALLS, FENCES, CURBS, ETC., SHALL BE REMOVED AND REPLACED AS NECESSARY TO PERFORM THE WORK, UNLESS OTHERWISE INDICATED. ALL SUCH WORK SHALL BE INCIDENTAL TO CONSTRUCTION OF THE PROJECT.
- ALL AREAS DISTURBED BY THE CONTRACTOR BEYOND THE PROJECT AREA SHALL BE RESTORED AT NO ADDITIONAL COST TO THE OWNER.
- NOTHING SHOWN OR OMITTED FROM THE DOCUMENTS PROVIDED SHALL RELIEVE THE CONTRACTOR FROM FULL COMPLIANCE WITH ALL APPLICABLE CODES, REGULATIONS, BYLAWS, AND ORDINANCES.
- TOPSOIL SHALL NOT BE MIXED WITH SUBGRADE MATERIALS. TOPSOIL SHALL NOT BE BURIED.

MATERIAL SPECIFICATIONS AND PLACEMENT REQUIREMENTS:

- 1.1 COURSE AGGREGATE (2-1/2-INCH STONE)

THIS MATERIAL SHALL MEET THE REQUIREMENTS OF CTDOT M.01.02 COARSE AGGREGATES NO.3.

SIEVE DESIGNATION	PERCENT PASSING
2-1/2 INCH	100
2-INCH	90-100
1-1/2-INCH	55-70
1-INCH	0-15
1/2-INCH	0-5

- 1.2 DENSE GRADED CRUSHED STONE

THIS MATERIAL SHALL CONSIST OF CLEAN HARD, DURABLE CRUSHED ROCK OR CRUSHED GRAVEL STONE, FREE FROM LOAM AND CLAY AND DELETERIOUS MATERIAL. THIS MATERIAL SHALL MEET THE FOLLOWING GRADATION: NOTE THIS MATCHES CTDOT FORM 818 M.02.01 GRANULAR FILL - BROKEN/CRUSHED STONE WITH GRADATION M.02.06 "A".

SIEVE DESIGNATION	PERCENT PASSING
3.5-INCH	100
1.5-INCH	55-100
1/4-INCH	25-60
NO. 10	15-45
NO. 40	5-25
NO. 100	0-10
NO. 200	0-5

PRIOR TO USE, THE DENSE GRADED CRUSHED STONE SHALL BE TESTED FOR APPROVAL AS DESCRIBED BELOW IN SECTION 2.0 AND SHALL BE PLACED AS DESCRIBED BELOW IN SECTION 3.0.

- 1.3 3/4" CRUSHED STONE

THIS MATERIAL SHALL CONSIST OF SOUND, TOUGH, DURABLE BROKEN STONE AND BE FREE OF LOAM, CLAY, AND OTHER DELETERIOUS MATERIAL. THE MATERIAL SHALL SATISFY THE AASHTO SPECIFICATION FOR #67 STONE (3/4-INCH STONE).

PRIOR TO USE, THE 3/4" CRUSHED STONE SHALL BE TESTED FOR APPROVAL AS DESCRIBED BELOW IN SECTION 2.0 AND SHALL BE PLACED AS DESCRIBED BELOW IN SECTION 3.0. NOTE FORM 818 CALLS FOR GRADING "A" EXCEPT FOR TOP COURSE SHALL BE "C".

- 1.4 TOPSOIL

TOPSOIL SHALL CONSIST OF CTDOT MATERIAL M.13.01, TOPSOIL, OR APPROVED EQUAL. TOPSOIL SHALL NOT CONTAIN LESS THAN 5% NOR MORE THAN 20% ORGANIC MATERIAL AS DETERMINED BY LOSS ON IGNITION OF OVEN-DRIED SAMPLES DRIED AT 221 DEG. F (105 DEG C). TOPSOIL SHALL BE LOOSE AND FRABLE AND FREE OF FROM REFUSE, STUMPS, ROOTS, BRUSH, WEEDS, ROCKS AND STONES OVER 1-1/4-INCHES IN DIAMETER. TOPSOIL SHALL ALSO BE FREE FROM ANY MATERIAL THAT WILL PREVENT THE FORMATION OF A SUITABLE SEEDED OR PREVENT SEED GERMINATION AND PLANT GROWTH.

- 1.5 GEOSYNTHETICS:

- GENERAL: INSTALLATION OF GEOTEXTILE FABRICS SHALL BE IN STRICT ACCORDANCE WITH MANUFACTURER'S INSTRUCTIONS AND SPECIFIC LAYOUT PLANS AND DETAILS REVIEWED BY ENGINEER.
- WOVEN GEOTEXTILE: THE WOVEN GEOTEXTILE SHALL BE MIRAFI HP 270 FABRIC, BY MIRAFI INC., OR APPROVED EQUIVALENT. THE WOVEN GEOTEXTILE SHALL BE COMPOSED OF POLYPROPYLENE STABILIZED WITH CARBON BLACK TO RESIST ULTRAVIOLET DEGRADATION AND BE RESISTANT TO BIOLOGICAL AND CHEMICAL DEGRADATION DUE TO ALL NATURALLY OCCURRING ORGANISMS OR REAGENTS NORMALLY ENCOUNTERED IN NATURAL SOIL ENVIRONMENTS.
- NON-WOVEN GEOTEXTILE: THE NON-WOVEN GEOTEXTILE SHALL BE MIRAFI 140N FABRIC, BY MIRAFI INC., OR APPROVED EQUIVALENT. THE WOVEN GEOTEXTILE SHALL BE COMPOSED OF POLYPROPYLENE STABILIZED WITH CARBON BLACK TO RESIST ULTRAVIOLET DEGRADATION AND BE RESISTANT TO BIOLOGICAL AND CHEMICAL DEGRADATION DUE TO ALL NATURALLY OCCURRING ORGANISMS OR REAGENTS NORMALLY ENCOUNTERED IN NATURAL SOIL ENVIRONMENTS.

- 2.0 BORROW SOURCE TESTING REQUIREMENTS

PRIOR TO USE, BORROW SOURCE TESTING, INCLUDING GEOTECHNICAL CHARACTERIZATION REQUIREMENTS, SHALL BE CONDUCTED ON ALL SOIL MATERIALS PROPOSED FOR CONSTRUCTION AND SUBMITTED TO THE ENGINEER TO ASSESS CONFORMANCE TO MATERIAL SPECIFICATIONS.

- 3.0 MATERIAL PLACEMENT AND FIELD QUALITY CONTROL REQUIREMENTS

- DO NOT PLACE FILL MATERIAL ON SURFACES THAT ARE MUDDY, FROZEN, OR CONTAIN FROST OR ICE.
- SURFACES ON WHICH THE GEOTEXTILE WILL BE PLACED SHALL BE PREPARED TO A RELATIVELY SMOOTH SURFACE CONDITION. SURFACES SHALL BE FREE FROM OBSTRUCTION, DEBRIS, DEPRESSIONS, OR EROSION FEATURES. VEGETATION SHALL BE MOWED AS SHORT AS POSSIBLE PRIOR TO PLACEMENT OF GEOTEXTILE FABRIC. ANY IRREGULARITIES SHALL BE REMOVED SO AS TO ENSURE CONTINUOUS, INTIMATE CONTACT OF THE GEOTEXTILE WITH THE SURFACE. ANY LOOSE MATERIAL, SOFT OR LOW DENSITY POCKETS OF MATERIAL, SHALL BE REMOVED, FILLED WITH SUITABLE SUBGRADE FILL, AND COMPACTED. EROSION FEATURES SUCH AS RILLS AND GULLIES MUST BE GRADED OUT OF THE SURFACE BEFORE GEOTEXTILE PLACEMENT.
- AT THE TIME OF INSTALLATION, FABRIC SHALL BE REJECTED IF IT HAS DEFECTS, RIPS, HOLES, FLAWS, DETERIORATION OR DAMAGE INCURRED DURING MANUFACTURE, TRANSPORTATION OR STORAGE.
- PLACE FABRIC WITH THE LONG DIMENSION PARALLEL TO THE CENTERLINE OF THE ACCESS ROAD AND LAY SMOOTH AND FREE OF TENSION, STRESS, FOLDS, WRINKLES, OR CREASES.
- THE CONTRACTOR SHALL PLACE AND COMPACT MATERIALS IN CONTINUOUS HORIZONTAL LAYERS UNTIL FIRM. LIFT THICKNESSES SHALL NOT EXCEED THE FOLLOWING THICKNESS:

ACCESS ROADS - 8-INCHES  
EQUIPMENT PADS-6-INCHES  
BALLAST LEVELING FILL - 6-INCHES
- IF THE MATERIAL REMOVED FROM THE EXCAVATION IS SUITABLE FOR BACKFILL WITH THE EXCEPTION THAT IT CONTAINS STONES LARGER THAN PERMITTED, THE CONTRACTOR HAS THE OPTION TO REMOVE THE OVERSIZED STONES AND USE THE MATERIAL FOR BACKFILL OR TO PROVIDE REPLACEMENT BACKFILL AT NO ADDITIONAL COST TO THE OWNER.

CLEARING NOTES:

- INSTALL EROSION AND SEDIMENTATION CONTROLS PRIOR TO CLEARING.
- CONTRACTOR SHALL LIMIT THE AREA OF LAND WHICH IS EXPOSED AND FREE FROM VEGETATION DURING CONSTRUCTION. IN AREAS WHERE THE PERIOD OF EXPOSURE WILL BE GREATER THIRTY (30) DAYS, MULCHING, EROSION CONTROL MATS, TEMPORARY SEEDING, OR OTHER PROTECTIVE MEASURES SHALL BE PROVIDED WITHIN 2 WEEKS OF INITIAL SOIL DISTURBANCE. THE CONTRACTOR SHALL TAKE ACCOUNT OF THE CONDITIONS OF THE SOIL WHERE EROSION CONTROL SEEDING WILL TAKE PLACE TO INSURE THAT MATERIALS USED FOR RE-VEGETATION ARE ADAPTIVE TO THE SEDIMENT CONTROL.

EROSION AND SEDIMENTATION CONTROL PLAN:

THIS PLAN HAS BEEN DEVELOPED TO PROVIDE A STRATEGY FOR CONTROLLING SOIL EROSION AND SEDIMENTATION DURING AND AFTER CONSTRUCTION OF THE PROPOSED PROJECT.

THIS PLAN IS BASED ON STANDARDS AND SPECIFICATIONS FOR EROSION PREVENTION IN DEVELOPING AREAS AS CONTAINED IN THE MOST CURRENT VERSION OF THE CONNECTICUT GUIDELINES FOR SOIL EROSION AND SEDIMENT CONTROL.

- EROSION AND SEDIMENTATION CONTROLS SHALL BE INSPECTED AT LEAST ONCE EVERY 7 CALENDAR DAYS, OR EVERY 14 CALENDAR DAYS AND WITHIN 24 HOURS OF THE END OF A STORM EVENT OF 0.50 INCHES OR GREATER. ALL STRUCTURES DAMAGED BY CONSTRUCTION EQUIPMENT, VANDALS, OR THE ELEMENTS SHALL BE REPAIRED IMMEDIATELY. ALL DAMAGED STRUCTURES SHALL BE REPAIRED AND/OR ADDITIONAL EROSION CONTROL STRUCTURES SHALL BE INSTALLED PRIOR TO CONTINUING THE CONSTRUCTION. TRAPPED SEDIMENT SHALL BE REMOVED BEFORE IT HAS ACCUMULATED TO ONE-HALF FOOT DEEP AT THE INSTALLED SEDIMENT BARRIER. DEVICES NO LONGER SERVICEABLE DUE TO SEDIMENT ACCUMULATION SHALL ALSO BE REPAIRED AND/OR REPLACED AS REQUIRED. RUTTING OR EXPOSED SOIL SHALL BE REPAIRED TO PREVENT EROSION AND OTHERWISE MITIGATED AS NECESSARY TO MINIMIZE FUTURE EROSION.
- ACCUMULATED SEDIMENT SHALL BE REMOVED FROM BEHIND FEATURE WHEN ACCUMULATIONS HAVE ADVERSELY AFFECTED IT'S FUNCTION.
- ALL DISTURBED AREAS SHALL BE STABILIZED PER THESE SPECIFICATIONS TO MAINTAIN VIGOROUS, DENSE VEGETATION. THE TOTAL DISTURBED AREA SHALL NOT BE GREATER THAN 5 ACRES AT ANY ONE TIME DURING CONSTRUCTION. ANY ERODED SLOPE OR GROUND SURFACE SHALL BE REPAIRED BY REAPPLYING TOPSOIL RESEEDING AND STABILIZING AREA AS REQUIRED FOR PERMANENT OR TEMPORARY MEANS USING CT DEEP PERMANENT SEED MIX NO. 1. REPAIR SOIL AREAS DAMAGED BY EROSION OR CONSTRUCTION EQUIPMENT.
- IMMEDIATELY REPAIR ANY DAMAGE CAUSED BY CONSTRUCTION EQUIPMENT, MAINTENANCE OR OTHER ACTIVITY TO ANY EROSION AND SEDIMENTATION CONTROL MEASURE, BEST MANAGEMENT PRACTICE (BMP) OR DEVICE.
- THE PRIME CONTRACTOR IS RESPONSIBLE FOR THE PERFORMANCE AND COMPLIANCE OF ITS SUBCONTRACTORS ACTIVITIES RELATING TO THE SWPPP. THEY SHALL MAKE FREQUENT INSPECTIONS OF THEIR WORK AND COORDINATE APPROPRIATE INSTALLATION AND MAINTENANCE OF EROSION AND SEDIMENTATION CONTROL DEVICES.
- EMPLOY POLLUTION PREVENTION MEASURES TO CONTROL LITTER, CONSTRUCTION CHEMICALS, SEDIMENT AND CONSTRUCTION DEBRIS INCLUDING, BUT NOT LIMITED TO THE FOLLOWING: SALVAGE AND REUSE OF MATERIALS; MINIMIZING PACKAGING WASTE; RECYCLING; PROPER DISPOSAL AT FREQUENT INTERVALS IN ACCORDANCE WITH PREVAILING LAWS; ONSITE INSTRUCTION REGARDING APPROPRIATE SEPARATION / HANDLING / RECYCLING; PROPER MAINTENANCE OF SEDIMENT / EROSION CONTROL SYSTEMS; ROUTINE AND EVENT RELATED INSPECTIONS BMPs; PROVIDE APPROPRIATE SANITARY FACILITIES FOR ONSITE PERSONNEL; PICK UP TRASH AND DEBRIS FREQUENTLY AND USE DUST CONTROL MEASURES AS NEEDED.
- FOLLOWING THE FINAL SEEDING, THE SITE SHALL BE INSPECTED TO ENSURE THAT THE VEGETATION HAS BEEN ESTABLISHED (70% COVER ACHIEVED), IN THE EVENT OF ANY UNSATISFACTORY GROWTH, RESEEDING WILL BE CARRIED OUT, WITH FOLLOW-UP INSPECTION.
- AFTER THE CONSTRUCTION INSPECTOR HAS DETERMINED THAT THE PROJECT AREA HAS BEEN STABILIZED, THE CONTRACTOR SHALL REMOVE ALL SEDIMENT BARRIERS, TEMPORARY SEDIMENTATION CONTROL RISERS, AND ANY OTHER TEMPORARY EROSION CONTROL MEASURES.

TYPICAL SEQUENCE OF CONSTRUCTION:

PRIOR TO THE DEVELOPMENT OF THE SITE, EROSION AND SEDIMENTATION CONTROL MEASURES SHALL BE INSTALLED AS NOTED ON THE PLANS. SITE DEVELOPMENT SCHEDULING SHALL TAKE INTO CONSIDERATION THE GROWING SEASON, SUCH THAT BULK OF THE EARTHWORK IS NOT INITIATED DURING A PERIOD WHEN VEGETATIVE STABILIZATION CANNOT BE ACHIEVED WITHIN 14 DAYS OF COMPLETING THE EARTHWORK IN A GIVEN AREA. A TYPICAL SEQUENCE OF CONSTRUCTION IS:

- CONTRACTOR SHALL CONFIRM FLAGGING FOR WETLANDS, BUFFERS, STREAMS, AND /OR OTHER CRITICAL AREAS. IF FLAGGING IS NOT AVAILABLE, CONTRACTORS OR CONTRACTOR'S REPRESENTATIVE SHALL FLAG WETLANDS, BUFFERS, STREAMS AND/OR OTHER CRITICAL AREAS PRIOR TO STARTING ANY WORK ON SITE.
- PRIOR TO STARTING ANY WORK ON THE SITE, THE CONTRACTOR SHALL NOTIFY APPROPRIATE AGENCIES AND SHALL INSTALL EROSION AND SEDIMENTATION CONTROL MEASURES AS SHOWN ON THE PLANS. THE CONTRACTOR SHALL OBTAIN ALL PERMITS, NOTIFY APPROPRIATE OFFICIALS OF CONSTRUCTION COMMENCEMENT, AND SUBMIT CONSTRUCTION TIMETABLE.
- ON-SITE CONSTRUCTION SHALL START WITH THE MINIMUM AMOUNT OF CLEARING REQUIRED TO INSTALL EROSION AND SEDIMENTATION CONTROL MEASURES AS NOTED ON SHEET C101. THIS INCLUDES COMPOST SOCKS, CONSTRUCTION ENTRANCE/EXIT, AND OTHER MEASURES NOTED ON THE PLAN. NO WORK SHALL TAKE PLACE UNTIL THE ENGINEER HAS INSPECTED AND APPROVED INSTALLED MEASURES.
- CUT TREES WITHIN THE DEFINED CLEARING LIMITS AND REMOVE CUT WOOD AS SHOWN ON THE PLANS. STUMPS SHALL BE REMOVED OR GROUND IN-PLACE OR LEFT IN PLACE AS SHOWN ON THE PLANS.
- REMOVE AND STOCKPILE TOPSOIL AS REQUIRED TO CONSTRUCT GRAVEL ACCESS ROADS. STOCKPILED TOPSOIL SHALL BE SEEDED AND MULCHED WHEN IT IS TO BE STORED MORE THAN 30 DAYS FROM TIME OF STOCKPILING. STOCKPILES SHALL NOT BE PLACED WITHIN THE WETLAND BUFFER ZONE. SEE SHEET C501 FOR A TYPICAL TEMPORARY STOCKPILE DETAIL. THE CONTRACTOR SHALL COORDINATE STOCKPILE LOCATIONS WITH THE LANDOWNER.
- CONSTRUCT GRAVEL ACCESS ROADS. INSTALL ADDITIONAL EROSION AND SEDIMENTATION CONTROL MEASURES AS REQUIRED TO PREVENT EROSION OF GRAVEL SURFACE AND STORMWATER MANAGEMENT FEATURES.
- PROCEED WITH SOLAR PHOTOVOLTAIC (PV) SYSTEM INSTALLATION/CONSTRUCTION WORK.
- REPAIR ALL DISTURBED AREAS AND REAPPLY LOAM WHERE NECESSARY.
- SEED ALL AREAS WITH CT DEEP PERMANENT SEED MIX NO.1 AND STABILIZE SLOPES IN ACCORDANCE WITH THE CONSTRUCTION SITE PLAN DRAWINGS EROSION AND SEDIMENT CONTROL PLAN.
- EROSION AND SEDIMENTATION CONTROL MEASURES SHALL NOT BE REMOVED UNTIL AFTER THE SITE IS STABILIZED IN ACCORDANCE WITH THE SWPPP.

FROST PROTECTION AND SNOW REMOVAL:

- THE CONTRACTOR SHALL, AT ITS OWN EXPENSE, KEEP EARTHWORK OPERATIONS CLEAR AND FREE OF ACCUMULATIONS OF SNOW AS REQUIRED TO CARRY OUT THE WORK.
- THE CONTRACTOR SHALL PROTECT THE SUBGRADE BENEATH NEW STRUCTURES AND PIPES FROM FROST PENETRATION WHEN FREEZING TEMPERATURES ARE EXPECTED.

SOIL STABILIZATION NOTES:

- THE MAXIMUM ALLOWABLE SLOPE IS 3:1. ALL 3:1 SLOPES SHALL BE STABILIZED WITH A TEMPORARY EROSION CONTROL BLANKET (SEE SHEET C501).
- ALL DISTURBED AREAS SHALL HAVE LOAM AND SEED AND STABILIZED WITH GRASS COVER (SEE SHEET C501).
- IF SUFFICIENT STABILIZATION CANNOT BE ACCOMPLISHED AFTER SEEDING, AT THE CONTRACTOR'S SOLE EXPENSE, SHALL BE RESPONSIBLE FOR ADDING THE NECESSARY SOIL AMENDMENTS AND/OR LOAM UNTIL STABILIZATION IS ACHIEVED IN ACCORDANCE WITH THE REQUIREMENTS OF THE PROJECT STORMWATER POLLUTION PREVENTION PLAN (SWPPP).

EQUIPMENT:

- THE CONTRACTOR SHALL PROVIDE A LIST OF ALL EQUIPMENT PROPOSED TO BE WORKING ON THE LANDFILL. THE LIST SHALL INCLUDE THE EQUIPMENT WEIGHT, GROUND PRESSURE, AND ANY RESTRICTIONS THAT WILL BE IMPOSED ON THE VEHICLE (I.E., LIMITED TO TEMPORARY ACCESS ROADS, LIMITED TO CARRYING 1/2 LOADS, ETC.).
- ALL EQUIPMENT IS SUBJECT TO REVIEW AND APPROVAL BY THE ENGINEER. AS A GENERAL RULE, EQUIPMENT SHALL HAVE A MAXIMUM GROUND PRESSURE OF LESS THAN 10 PSI ON THE EXISTING LANDFILL SYSTEM (OFF THE PROPOSED ACCESS ROAD).

SPECIFICATIONS FOR WORK ON LANDFILL:

- THE CONTRACTOR SHALL BE AWARE THAT THE WORK IS LOCATED ON A LANDFILL AND IS SUBJECT TO THE REGULATIONS OF CONNECTICUT STATE AGENCIES (RCSA) 22A-209-7.
- THE CONTRACTOR SHALL TAKE ALL NECESSARY PRECAUTIONS TO NOT DISRUPT THE LANDFILL CAP PROFILE.
- WORK SHALL BE COMPLETED IN ACCORDANCE WITH THE CONNECTICUT DEPARTMENT OF ENERGY & ENVIRONMENTAL PROTECTION (CTDEEP) "AUTHORIZATION FOR THE DISRUPTION AND POST CLOSURE USE OF A CLOSED SOLID WASTE DISPOSAL AREA" APPROVAL.
- THE CONTRACTOR SHALL HAVE A HEALTH AND SAFETY PLAN WHILE WORKING ON THE LANDFILL.

GENERAL EROSION AND SEDIMENTATION CONSTRUCTION DETAIL NOTES:

DURING CONSTRUCTION THE CONTRACTOR SHALL TAKE ALL REASONABLE MEASURES TO SCHEDULE EARTHWORK OPERATIONS SUCH THAT THE AREA OF EXPOSED AND DISTURBED SOIL IS MINIMIZED. CONSTRUCTION SHALL BE PHASED TO REDUCE THE AREA OF DISTURBED SOIL AT ANY ONE TIME. UPGRADIENT STORMWATER DIVERSION AND DISPERSION MEASURES SHALL BE INSTALLED WHERE APPROPRIATE AFTER ACHIEVING ROUGH GRADE OF A PORTION OF THE SITE AND PRIOR TO EXTENDING EARTHWORK OPERATIONS. THE CONTRACTOR SHALL STABILIZE DISTURBED AREAS BY LAYING DOWN TEMPORARY MULCH UNTIL FINAL GRADE IS REACHED. ALL CUT AND FILL SLOPES SHALL BE STABILIZED UPON COMPLETION. THE FOLLOWING MEASURES WILL BE UNDERTAKEN TO PROVIDE MAXIMUM PROTECTION TO THE SOIL, WATER, AND ABUTTING LANDS:

- PRIOR TO GRUBBING OR ANY EARTH MOVING OPERATION, SEDIMENT BARRIERS, OR OTHER APPROPRIATE BEST MANAGEMENT PRACTICE (BMP) SHALL BE INSTALLED ACROSS THE SLOPE ON THE CONTOUR AT THE DOWNHILL LIMIT OF THE WORK AS PROTECTION AGAINST CONSTRUCTION RELATED EROSION. INSTALL ALL NECESSARY STORMWATER DIVERSIONS AND DISPERSION MEASURES.
- PERMANENT SOIL EROSION CONTROL MEASURES FOR ALL SLOPES, OR ANY DISTURBED LAND AREA SHALL BE COMPLETED WITHIN FOURTEEN (14) CALENDAR DAYS AFTER FINAL GRADING HAS BEEN COMPLETED. WHEN IT IS NOT POSSIBLE OR PRACTICAL TO PERMANENTLY STABILIZE DISTURBED LAND, TEMPORARY EROSION CONTROL MEASURES SHALL BE IMPLEMENTED ON DISTURBED AREAS INCLUDING STOCKPILES WITHIN FOURTEEN (14) CALENDAR DAYS OF EXPOSURE OF SOIL OR FORMATION OF PILES UNLESS THESE AREAS ARE TO BE SUBSEQUENTLY SURFACED. ALL DISTURBED AREAS SHALL BE MULCHED FOR EROSION CONTROL UPON COMPLETION OF ROUGH GRADING.
- ANY EXPOSED SLOPES 3:1 OR GREATER SHALL BE STABILIZED WITH EROSION CONTROL BLANKET TO PREVENT EROSION DURING CONSTRUCTION AND TO FACILITATE REVEGETATION AFTER TOPSOILING AND SEEDING. SEE DRAWING C501.
- EXISTING TOPSOIL SHALL BE SAVED, STOCKPILED, AND REUSED AS MUCH AS POSSIBLE ON SITE. SEDIMENT BARRIER SHALL BE INSTALLED AT THE BASES OF STOCKPILES AT THE DOWNHILL LIMITS TO PROTECT AGAINST EROSION. STOCKPILES SHALL BE STABILIZED BY SEEDING AND MULCHING UPON FORMATION OF THE PILES. UPGRADIENT OF THE STOCKPILES, STABILIZED DITCHES AND/OR BERMS SHALL BE CONSTRUCTED TO DIVERT STORMWATER RUNOFF AWAY FROM THE PILES.
- INTERCEPTED SEDIMENT SHALL BE REMOVED AND SHALL BE DEPOSITED TO AN AREA THAT SHALL NOT CONTRIBUTE TO OFF-SITE SEDIMENTATION, AND SHALL BE PERMANENTLY STABILIZED.
- ADDITIONAL EROSION CONTROL METHODS SHALL BE IMPLEMENTED IF CONSTRUCTION OCCURS AFTER DECEMBER 15TH. ALL DISTURBED AREAS SHALL BE MINIMIZED TO THE EXTENT POSSIBLE. PRIOR TO FREEZING, ADDITIONAL EROSION CONTROL DEVICES SHALL BE INSTALLED AS APPROVED BY THE ENGINEER. INSPECTION OF THESE EROSION CONTROL ITEMS SHALL BE FREQUENT, WITH PARTICULAR ATTENTION PAID TO WEATHER PREDICTIONS TO ENSURE THAT THESE MEASURES ARE PROPERLY IN PLACE TO HANDLE LARGE QUANTITIES OF RUNOFF RESULTING FROM HEAVY RAINS AND/OR EXCESSIVE THAWS.
- GENERAL EROSION AND SEDIMENTATION CONTROL ACTIONS SHALL INCLUDE THE FOLLOWING:
  - MARK SOIL DISTURBANCE LIMITS
  - INSTALL SEDIMENT BARRIERS BEFORE DISTURBING ANY SOILS
  - DIVERT AND DISPERSE STORM WATER RUNOFF TO UNDISTURBED AREAS WHEREVER POSSIBLE
  - MULCH DISTURBED AREAS
  - PROTECT STEEP SLOPES
  - INSPECT AND REPAIR EROSION CONTROLS AND SEDIMENT BARRIERS
  - REMOVE ACCUMULATED SEDIMENT

DUST CONTROL:

- CONSTRUCTION ACTIVITIES SHALL BE SCHEDULED SO THAT A MINIMUM AMOUNT OF OF DISTURBED SOIL IS EXPOSED AT ONE TIME.
- DUST SHALL BE CONTROLLED ON CONSTRUCTION ROUTES AND OTHER DISTURBED AREAS SUBJECT TO SURFACE DUST MOVEMENT AND DUST BLOWING.
- MAINTAIN DUST CONTROL MEASURES PROPERLY THROUGH DRY WEATHER PERIODS UNTIL ALL DISTURBED AREAS HAVE BEEN PERMANENTLY STABILIZED.
- DUST CONTROL METHODS SHALL INCLUDE VEGETATIVE COVER, MULCH, WATER SPRINKLING, STONE, AND BARRIERS.
- VEGETATIVE COVER - FOR DISTURBED AREAS NOT SUBJECT TO TRAFFIC, VEGETATION PROVIDES THE MOST PRACTICAL METHOD OF DUST CONTROL.
- MULCH - WHEN PROPERLY APPLIED, MULCH OFFERS A FAST, EFFECTIVE MEANS OF CONTROLLING DUST.
- SPRINKLING - THE SITE MAY BE SPRINKLED WITH WATER UNTIL THE SURFACE IS WET. SPRINKLING IS ESPECIALLY EFFECTIVE FOR DUST CONTROL ON HAUL ROADS AND OTHER TRAFFIC ROUTES. THE GROUND SURFACE SHALL NOT BE WATERED EXCESSIVELY, RUNOFF SHALL NOT OCCUR.
- STONE - USED TO STABILIZE CONSTRUCTION ROADS; CAN ALSO BE EFFECTIVE FOR DUST CONTROL.
- BARRIERS - A BOARD FENCE, WIND FENCE, SEDIMENT FENCE, OR SIMILAR BARRIER CAN CONTROL AIR CURRENTS AND BLOWING SOIL. ALL OF THESE FENCES ARE NORMALLY CONSTRUCTED OF WOOD AND THEY PREVENT EROSION BY OBSTRUCTING THE WIND NEAR THE GROUND AND PREVENTING THE SOIL FROM BLOWING OFFSITE.

SEEDING AND REVEGETATION PLAN:

UPON COMPLETION OF SITE CONSTRUCTION, ALL AREAS PREVIOUSLY DISTURBED SHALL BE TREATED AS STATED BELOW. THESE AREAS WILL BE CLOSELY MONITORED BY THE CONTRACTOR UNTIL SUCH TIME AS A SATISFACTORY GROWTH OF VEGETATION IS ESTABLISHED. SATISFACTORY GROWTH SHALL MEAN A MINIMUM OF 70% OF THE AREA IS VEGETATED WITH VIGOROUS GROWTH.

- TOPSOIL WILL BE SPREAD OVER ALL DISTURBED AREAS TO BE REVEGETATED AND SHALL BE GRADED TO A DEPTH OF FOUR (4) TO SIX (6) INCHES.
- FERTILIZER AT A 10-10-10 PROPORTION SHALL BE MIXED WITH HYDROSEED (AND LIME, IF REQUIRED) AT A RATE OF 300 LBS. PER ACRE.
- WOOD FIBER MULCH SHALL BE APPLIED AT A RATE OF 2,000 LBS. PER ACRE FOR MAXIMUM MOISTURE RETENTION RESULTS.
- NO SEEDING OR SOIL PREPARATION SHALL BE DONE IF SOILS ARE MUDDY, DRY, AND/OR COMPACTED. BARE SOILS SHALL BE RAKED TO REMOVE STILL CLODS, LUMPS, BRUSH, ROOTS, STUMPS, LITTLE AND OTHER FOREIGN MATTER. MAJOR RUTS AND DEPRESSIONS FROM CONSTRUCTION ACTIVITIES SHALL BE FILLED WITH ADDITIONAL LOAM AND THE SOIL SHALL BE RE-GRADED TO A RELATIVELY SMOOTH FINISH CORRESPONDING TO THE REQUIRED GRADES.
- DISTURBED AREAS SHALL BE SEEDED USING ONE OF THE FOLLOWING MIXES AS DIRECTED BY THE OWNER AND ENGINEER DEPENDING ON THE TIME OF YEAR AND AMOUNT OF SEEDING REQUIRED:
  - CT PERMANENT SEED MIX: AT THE RATE OF 1 LB. PER 1,000 SQ. FT. OF THE FOLLOWING MIXTURE: 45% KENTUCKY BLUEGRASS, 45% CREEPING RED FESCUE, AND 10% PERENNIAL RYEGRASS (CTDEEP PERMANENT SEED MIX NO. 1).
  - SEEDING SHOULD BE PLANTED TO A DEPTH OF 1/4 TO 1/2 INCHES.
  - SEEDING METHODS MAY BE DRILL SEEDINGS, BROADCASTS AND ROLLED, CULTPACKED, OR TRACKED WITH A SMALL TRACK PIECE OF CONSTRUCTION EQUIPMENT, OR HYDROSEEDING, WITH SUBSEQUENT TRACKING. TACKIFIER SHALL BE USED IN HYDROSEED TO HELP IT ADHERE TO THE SOIL AND ANY SLOPES PROPERLY.
- SEEDING SHALL BE COMPLETED BETWEEN THE DATES OF APRIL 1 THROUGH JUNE 15 AND AUGUST 15 THROUGH OCTOBER 1. WATERING MAY BE REQUIRED DURING DRY PERIODS.
- WINTER EROSION CONTROL SHALL CONSIST OF TEMPORARY SEEDING USING THE CT PERMANENT SEED MIX NO. 1 WITH WINTER RYE ADDED, AND EROSION CONTROL BLANKET, AS NEEDED.
- STEEP SLOPES (3:1 AND STEEPER), IF ENCOUNTERED, SHALL BE STABILIZED BY INSTALLING EROSION CONTROL BLANKET (NORTH AMERICAN GREEN, BIONET SC150BN OR EQUAL. ECB SHALL BE INSTALLED USING STAPLE PATTERN C IN ACCORDANCE WITH THE INSTALLATION DETAIL INCLUDED ON C501).
- IF FINAL SEEDING OF THE DISTURBED AREA IS NOT COMPLETED BY OCTOBER 1ST OF THE YEAR OF CONSTRUCTION THEN, WITHIN THE NEXT 10 CALENDAR DAYS, THESE AREAS SHALL BE GRADED AND SMOOTHED, THEN SEEDED TO A WINTER COVER CROP OF WINTER RYE AT A RATE OF 3 LBS. PER 1,000 SQ. FT. THE FOLLOWING SHALL BE INCORPORATED INTO THE SOIL PRIOR TO WINTER RYE SEEDING: GROUND LIMESTONE AT A RATE OF 100 LBS. PER 1,000 SQ. FT., FOLLOWED BY A 10-10-10 FERTILIZER AT A RATE OF 14 LBS. PER 1,000 SQ. FT. HAY MULCH SHALL BE APPLIED AT A RATE OF 100 LBS. PER 1,000 SQ. FT. FOLLOWING SEEDING. IF THE WINTER RYE SEEDING CANNOT BE COMPLETED BY OCTOBER 1, OR DOES NOT MAKE ADEQUATE GROWTH BY NOVEMBER 1, THEN ON THAT DATE, HAY MULCH SHALL BE APPLIED AT THE RATE OF 100 LBS. PER 1,000 SQ. FT. A SUITABLE BINDER SUCH AS CURASOL OR RMB PLUS SHALL BE USED ON HAY MULCH FOR WIND CONTROL. EROSION CONTROL BLANKET WILL BE INSTALLED ON STEEP SLOPES (3:1 AND STEEPER) AND ON AREAS OF CONCENTRATED FLOWS.
- INSPECT SEEDED AREAS FOR FAILURE AND MAKE NECESSARY REPAIRS AND RESEED IMMEDIATELY. CONDUCT A FOLLOW-UP SURVEY AFTER ONE YEAR AND RESEED USING CT DEEP PERMANENT SEED MIX NO. 1 WHERE NECESSARY TO ESTABLISH PERMANENT SEEDING AND STABILIZATION.
- IF THERE ARE AREAS WITH LESS THAN 40% COVER, REEVALUATE CHOICE OF PLANT MATERIALS AND QUANTITIES OF LIME AND FERTILIZER. IF THE SEASON PREVENTS RESOWING, MULCH OR JUTE NETTING IS AN EFFECTIVE TEMPORARY COVER.
- SEEDED AREAS SHOULD BE FERTILIZED DURING THE SECOND GROWING SEASON.
- LIME AND FERTILIZE THEREAFTER AT PERIODIC INTERVALS, AS NEEDED.
- ALL SEDIMENT CONTROL STRUCTURES WILL REMAIN IN PLACE UNTIL VEGETATION IS ESTABLISHED. ESTABLISHED MEANS A MINIMUM OF 80% OF THE AREA IS VEGETATED WITH VIGOROUS GROWTH AS DETERMINED BY THE ENGINEER.
- THE CONTRACTOR SHALL MAINTAIN THE ENTIRE SEEDED AREAS UNTIL FINAL ACCEPTANCE AT THE COMPLETION OF THE PROJECT OR FOR 90 DAYS, WHICHEVER IS LONGER. MAINTENANCE SHALL INCLUDE WATERING ON AN AS-NEEDED BASIS SUCH THAT ESTABLISHMENT OF AT LEAST 80% OF THE SEEDED AREAS IS ACHIEVED AFTER ONE GROWING SEASON. THE CONTRACTOR SHALL FURNISH ALL REQUIRED WATER AT NO EXPENSE TO THE OWNER.
- ALL BARE SPOTS, WHICH BECOME APPARENT AS THE GRASS GERMINATES, SHALL BE RESEDED BY THE CONTRACTOR AT HIS/HER OWN EXPENSE AS MANY TIMES AS NECESSARY TO SECURE AN ADEQUATE GROWTH, AND THE ENTIRE AREA SHALL BE MAINTAINED AND CUT UNTIL ALL WORK HAS BEEN COMPLETED AND FINAL ACCEPTANCE HAS OCCURRED. RESEEDING SHALL BE ACCOMPLISHED BY MECHANICAL MEANS AS DETERMINED BY THE AREA OF RESEEDING TO BE ACCOMPLISHED.
- THE CONTRACTOR SHALL TAKE WHATEVER MEASURES ARE NECESSARY TO PROTECT THE GRASS WHILE IT IS GERMINATING. THESE MEASURES SHALL INCLUDE SPRINKLING STRAW OR WOOD FIBER MULCH TO COVER THE AREA, AND/OR FURNISHING OF WARNING SIGNS, BARRIERS, TEMPORARY FENCE OR ANY OTHER NECESSARY MEASURES OF PROTECTION.
- CONTRACTOR SHALL FURNISH, PROTECT, AND MAINTAIN ALL TEMPORARY BARRIERS UNTIL FINAL ACCEPTANCE OF THE SEEDED AREAS BY THE OWNER AND SHALL REMOVE THEM UPON SUCH FINAL ACCEPTANCE. THE BARRIERS SHALL REMAIN THE PROPERTY OF THE CONTRACTOR AT ALL TIMES.
- AFTER THE ENGINEER HAS DETERMINED THAT THE PROJECT AREA HAS STABILIZED, THE CONTRACTOR SHALL REMOVE ALL SEDIMENT BARRIERS AND ANY OTHER TEMPORARY EROSION CONTROL MEASURES WITHIN 30 DAYS.

Project:

PROPOSED SOLAR  
PV DEVELOPMENT

221 WARRENVILLE ROAD  
MANSFIELD, CT 06268

Weston & Sampson

WESTON & SAMPSON ENGINEERS, INC.  
712 BROOK STREET, SUITE 103  
ROCKY HILL, CT 06067  
860.513.1473 800.SAMPSON  
www.westonandsampson.com

Applicant:

VEROGY

VCP Mansfield LF, LLC  
124 LaSalle Road  
2nd Floor  
West Hartford, CT 06107  
TEL (860) 288-7215  
WWW.VEROGY.COM

Revisions:

No.	Date	Description
0	10/09/2024	ISSUED FOR PERMITTING

Seal:



Issued For:

PERMITTING

Scale:	AS SHOWN
Date Created:	10/09/2024
Drawn By:	DEC
Reviewed By:	MRC
Approved By:	RJB
W&S Project No.:	ENG24-1027
W&S File No.:	VEROGY MANSFIELD

Drawing Title:

NOTES AND  
SPECIFICATIONS

Sheet Number:

C001

NOT FOR CONSTRUCTION



P:\Planning\100\100-0000\100-0000-0000\100-0000-0000-0000.dwg

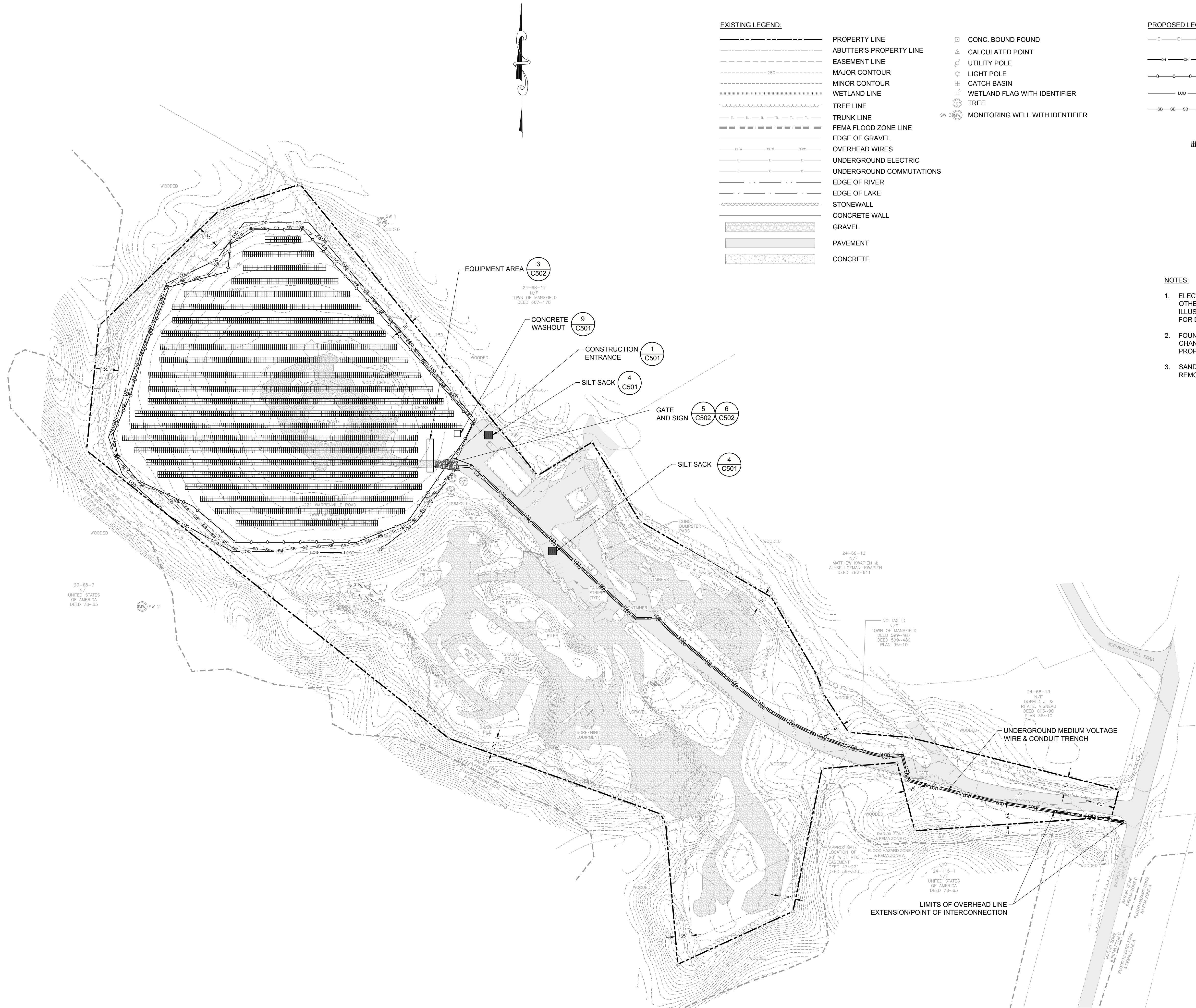

EXISTING LEGEND:

	PROPERTY LINE
	ABUTTER'S PROPERTY LINE
	EASEMENT LINE
	MAJOR CONTOUR
	MINOR CONTOUR
	WETLAND LINE
	TREE LINE
	TRUNK LINE
	FEMA FLOOD ZONE LINE
	EDGE OF GRAVEL
	OVERHEAD WIRES
	UNDERGROUND ELECTRIC
	UNDERGROUND COMMUNICATIONS
	EDGE OF RIVER
	EDGE OF LAKE
	STONEWALL
	CONCRETE WALL
	GRAVEL
	PAVEMENT
	CONCRETE

PROPOSED LEGEND:

	ELECTRIC CONDUIT
	OVERHEAD ELECTRIC
	FENCE
	LIMIT OF DISTURBANCE
	SEDIMENT BARRIER
	UTILITY POLE
	SOLAR PV RACK & PANELS

NOTES:

- ELECTRICAL DESIGN, INCLUDING UTILITY POLES, PERFORMED BY OTHERS. ELECTRICAL EQUIPMENT AND COMPONENTS SHOWN TO ILLUSTRATE LOCATIONS ONLY. REFER TO ELECTRICAL DRAWINGS FOR DETAILED ELECTRICAL SYSTEM INFORMATION.
- FOUNDATION LOCATIONS AND ARRAY ORIENTATION SUBJECT TO CHANGE BASED ON FINAL DESIGN BUT WILL BE WITHIN THE PROPOSED LIMIT OF WORK.
- SAND/GRAVEL STOCKPILES AND WOODED AREAS ON CAP TO BE REMOVED BY OTHERS PRIOR TO SOLAR ARRAY CONSTRUCTION.

Project:

PROPOSED SOLAR  
PV DEVELOPMENT

221 WARRENVILLE ROAD  
MANSFIELD, CT 06268

Weston & Sampson

WESTON & SAMPSON ENGINEERS, INC.  
712 BROOK STREET, SUITE 103  
ROCKY HILL, CT 06067  
860.513.1473 800.SAMPSON  
www.westonandsampson.com

Applicant:

VEROGY

VCP Mansfield LF, LLC  
124 LaSalle Road  
2nd Floor  
West Hartford, CT 06107  
TEL: (860) 288-7215  
WWW.VEROGY.COM

Revisions:

No.	Date	Description
0	10/09/2024	ISSUED FOR PERMITTING

Seal:

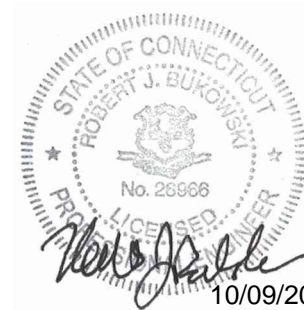

Issued For:

PERMITTING

Scale: AS SHOWN

Date Created: 10/09/2024

Drawn By: DED

Reviewed By: MRC

Approved By: RJB

W&S Project No.: ENG24-1027

W&S File No.: VEROGY MANSFIELD

Drawing Title:

PROPOSED  
SITE PLAN

Sheet Number:

C101



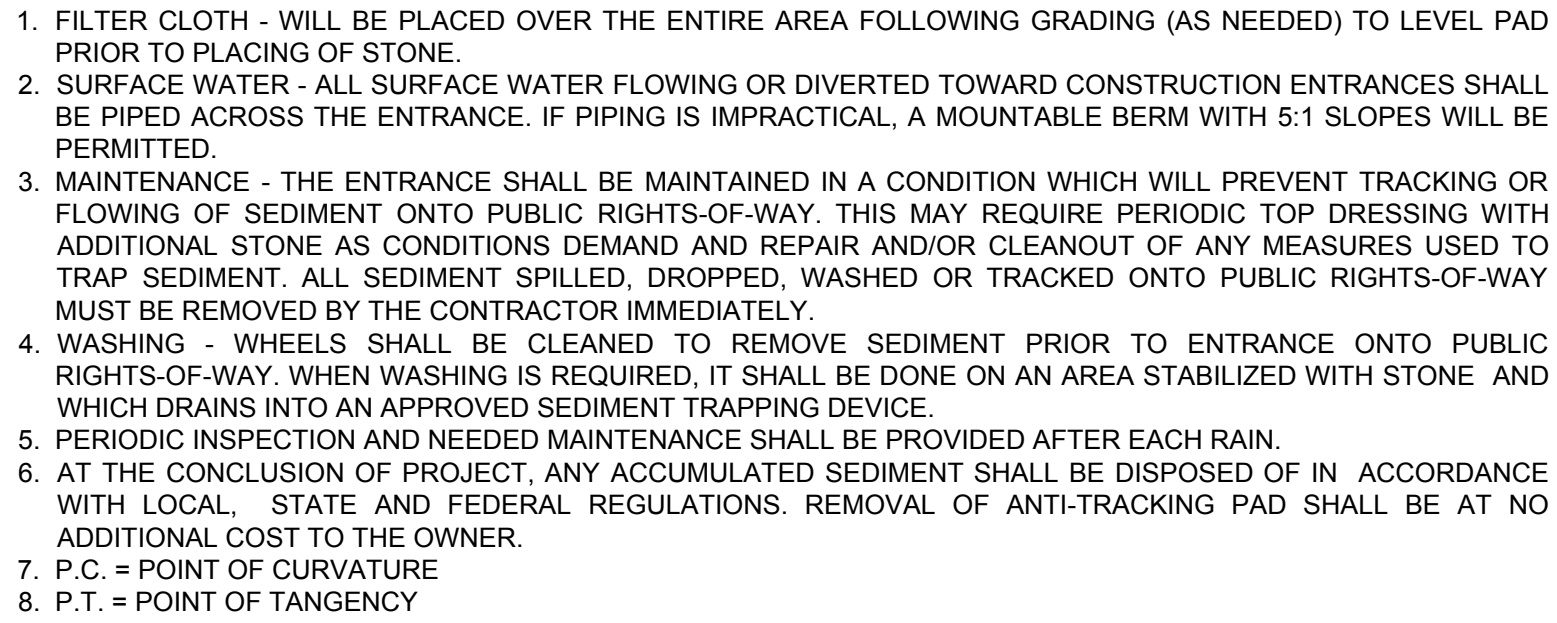

SCALE: N.T.S

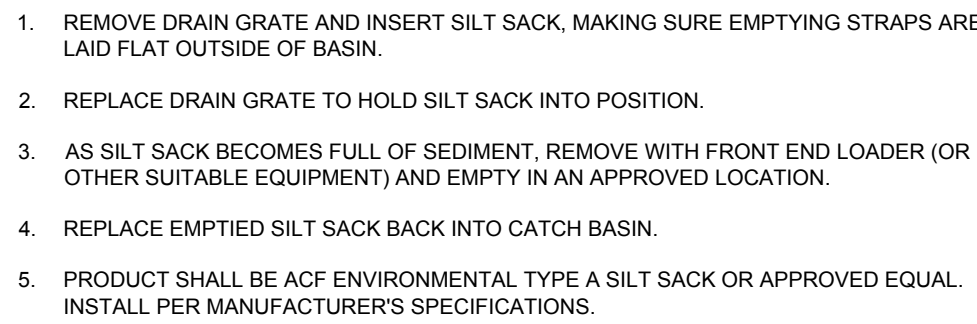

SCALE: N.T.S

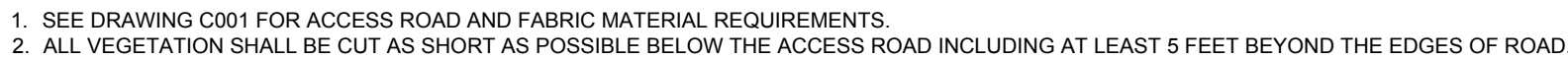

SCALE: N.T.S.



SCALE: N.T.S

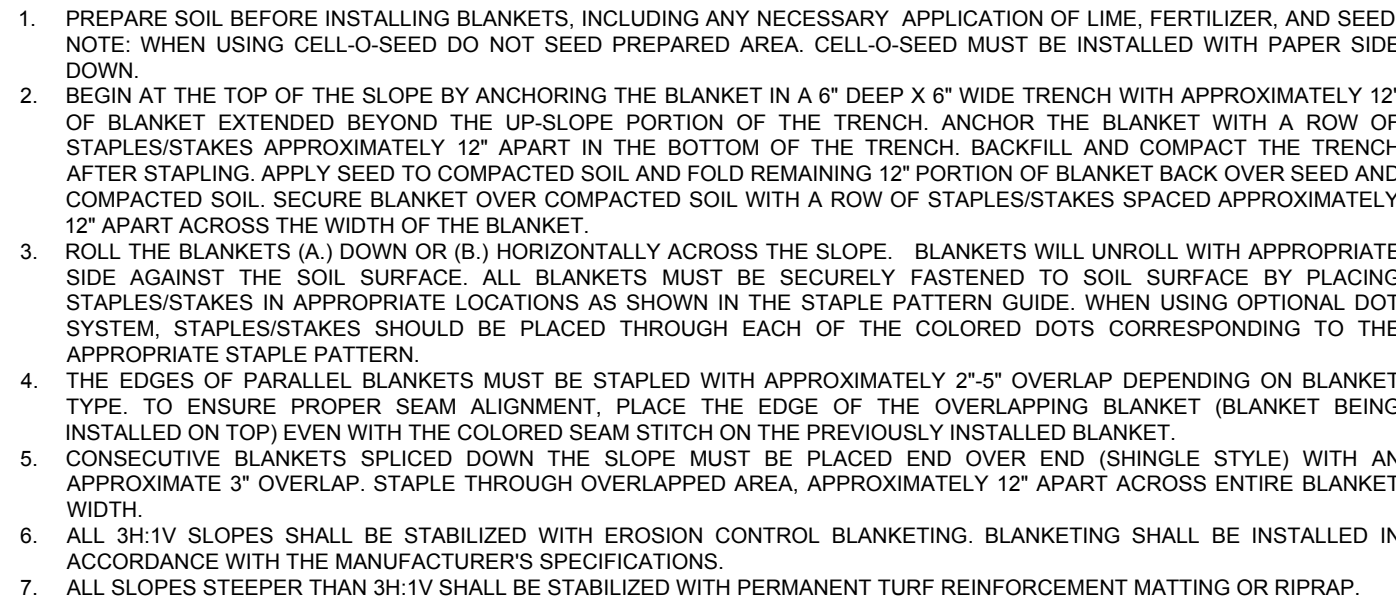

SCALE: N.T.S.

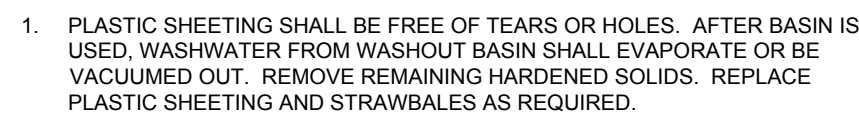

SCALE: N.T.S.

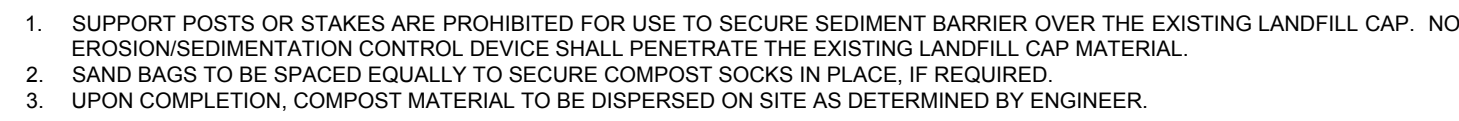

## SCALE: N.T.S.

COPYRIGHT © 2024 WESTON & SAMPSON, INC.

NOT FOR CONSTRUCTION



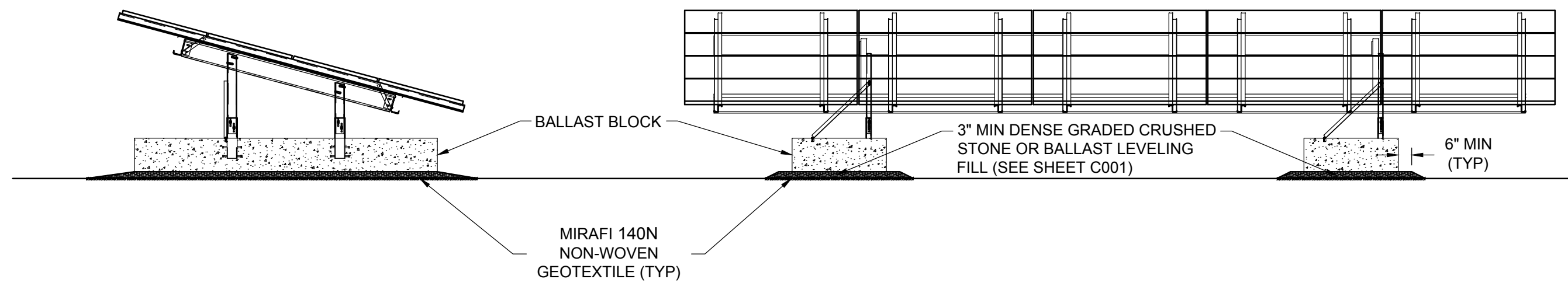

- NOTES:
- DESIGN FOR FOUNDATIONS, RACKING, AND MODULES BY OTHERS. DETAILS SHOWN FOR ILLUSTRATION PURPOSES ONLY.

1 BALLAST MOUNTED SOLAR PV ARRAY  
SCALE: N.T.S.

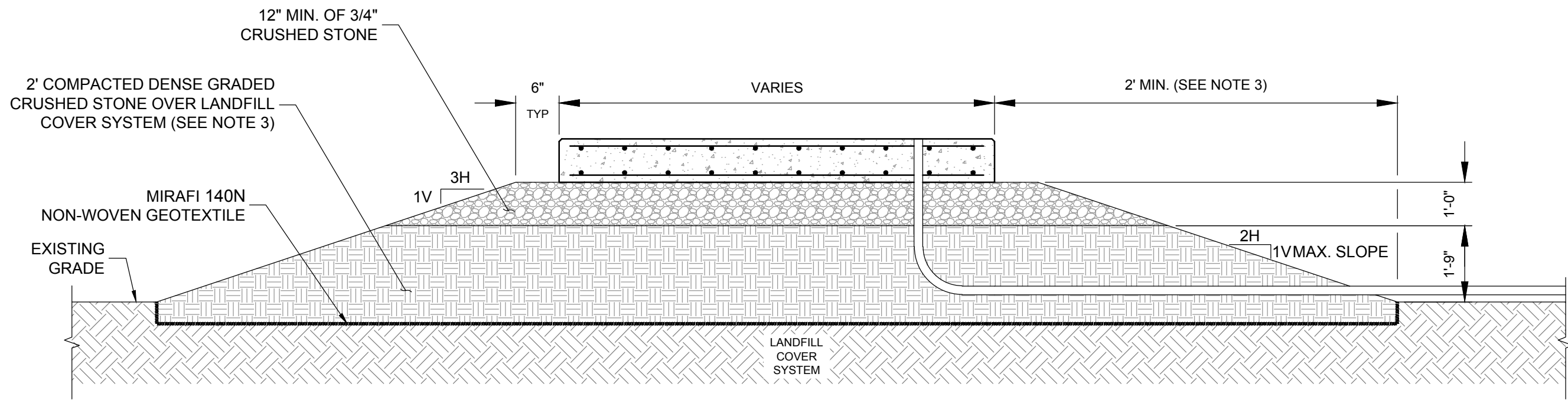

- NOTES:
- SLAB DIMENSIONS, DESIGN, AGGREGATE MATERIAL BELOW THE PAD IS SUBJECT TO CHANGE BASED ON FINAL STRUCTURAL ENGINEERED DESIGN.
  - DETAIL IS SHOWN FOR REPRESENTATIVE PURPOSES ONLY.
  - THE VEGETATIVE SUPPORT LAYER SHALL BE REMOVED BELOW AND A MINIMUM OF 2' AROUND THE LIMITS OF THE PAD LOCATIONS.
  - COMPACT UNTIL A FIRM AND STABLE CONDITIONS IS ACHIEVED, AS APPROVED BY THE ENGINEER.

3 TYPICAL CONCRETE EQUIPMENT PAD  
SCALE: N.T.S.

- NOTES:
- FENCE SHOWN FOR ILLUSTRATIVE PURPOSES ONLY. FINAL POST AND BALLAST BLOCK DESIGN TO BE PROVIDED PRIOR TO CONSTRUCTION.
  - THE DISTANCE BETWEEN THE FINISHED GRADE AND BOTTOM OF FENCE SHALL BE FLUSH WITH THE GROUND SURFACE FOR THE FENCE SURROUNDING THE LANDFILL ARRAYS.
  - SECURITY FENCE AROUND THE SITE SHALL BE CONTINUOUS AND 7'-0" (MINIMUM) PER THE NEC 110.31.
  - THE SECURITY FENCE SHALL BE GROUNDED IN ALL AREAS WHERE THE PV MODULES ARE LOCATED LESS THAN 10'-0" FROM THE FENCE TO LIMIT THE RISE OF HAZARDOUS VOLTAGE (IF APPLICABLE).
  - THE "HIGH VOLTAGE KEEP OUT" SIGN SHALL BE MOUNTED ON FENCE AND HAVE A MAX SPACING OF 16 FEET.

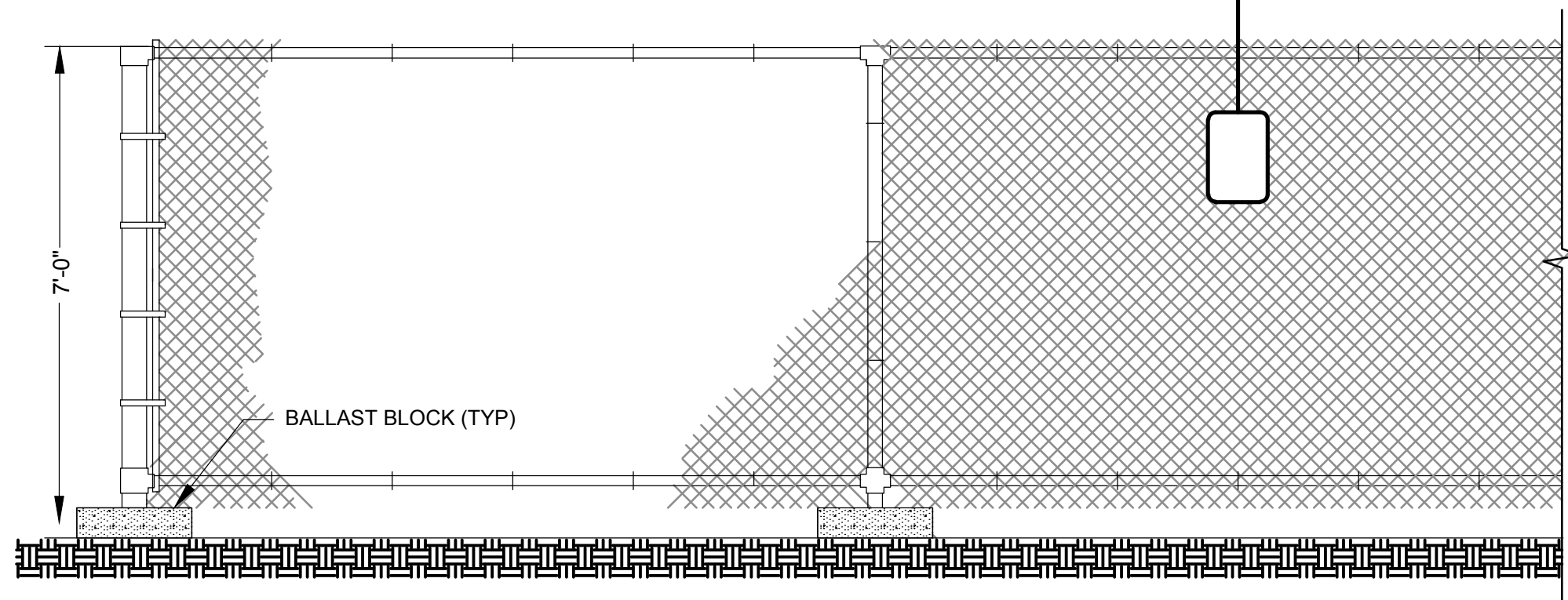

5 BALLAST CHAIN LINK FENCE AND GATE  
SCALE: N.T.S.

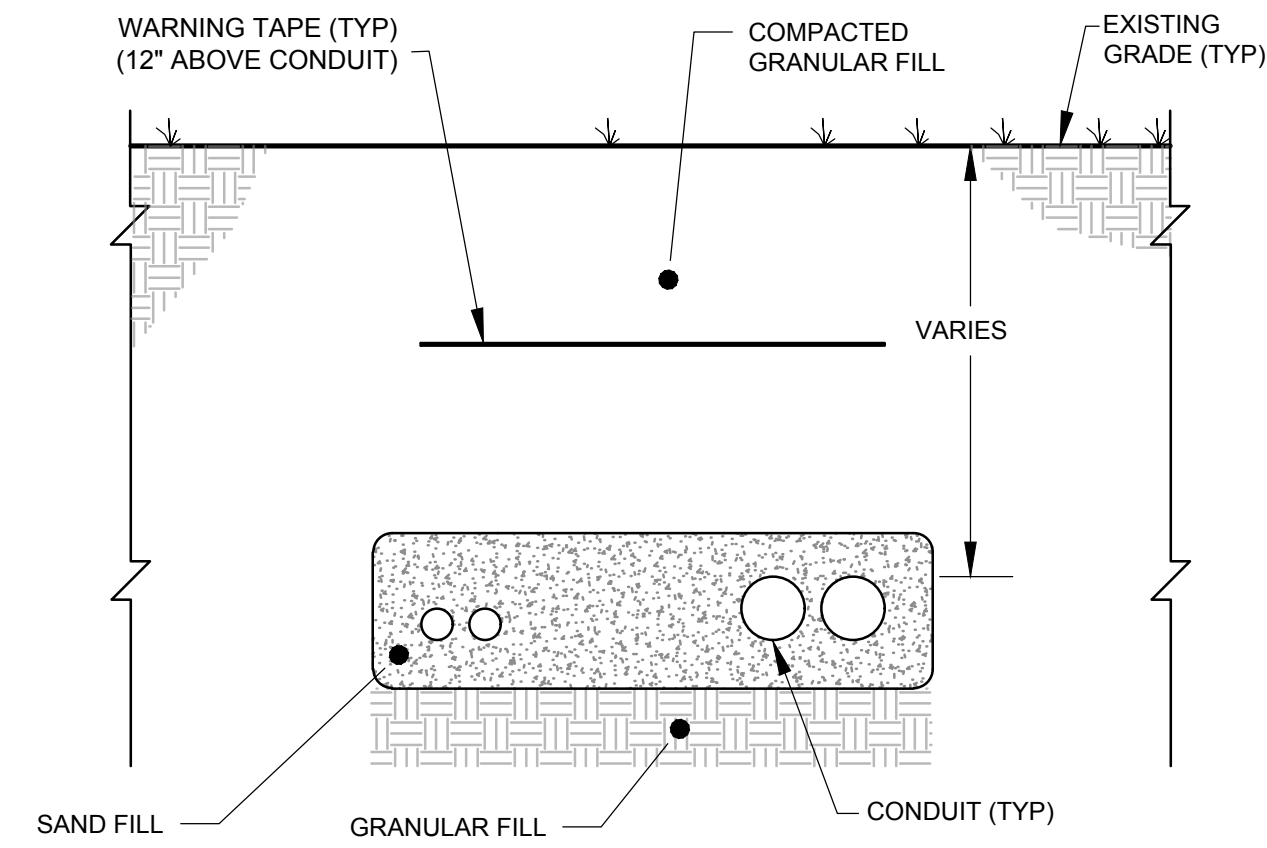
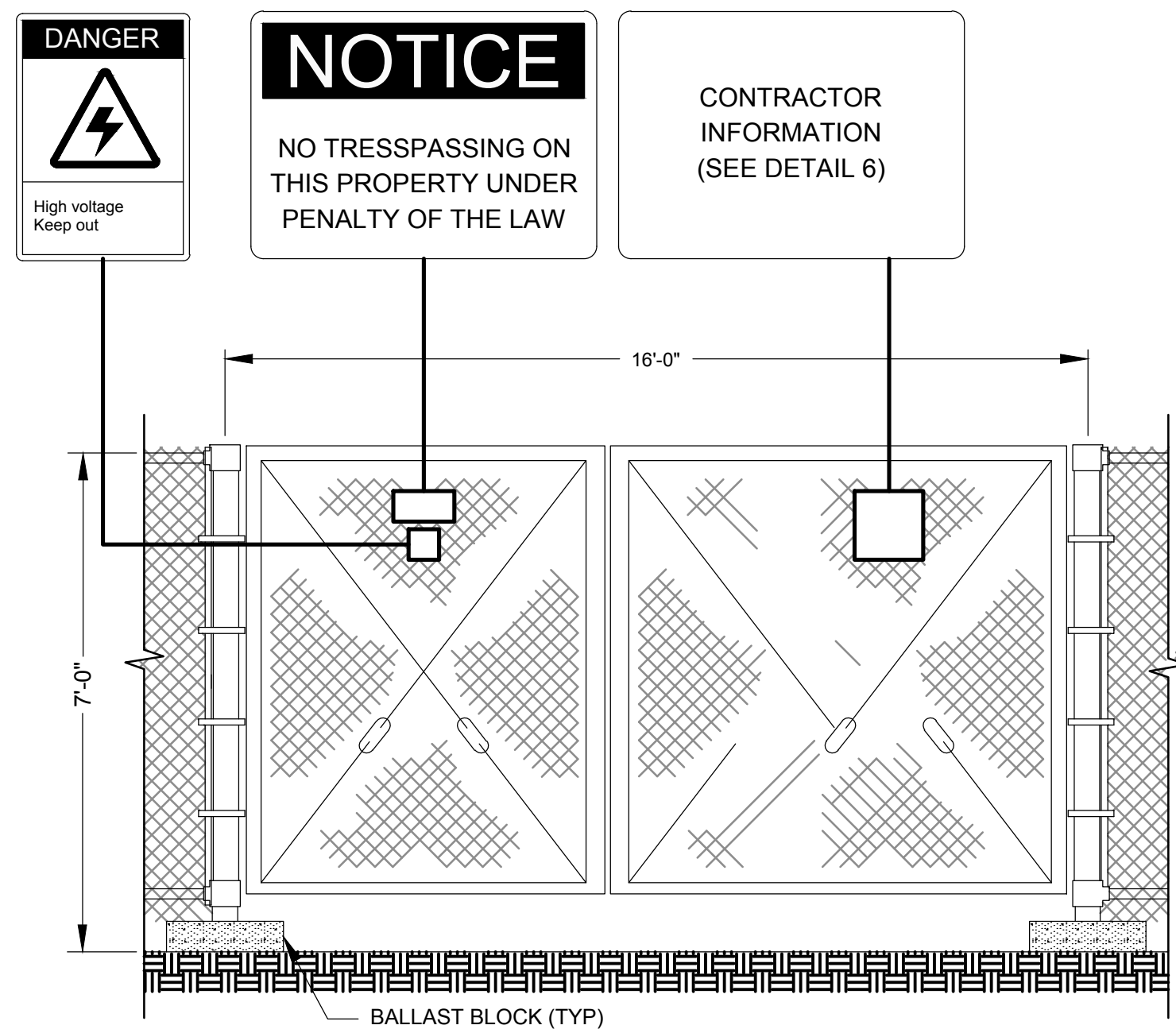

- NOTES:
- TRENCH SHOWN FOR ILLUSTRATIVE PURPOSES ONLY. ELECTRICAL DESIGN AND CONFORMANCE WITH ELECTRICAL CODE REQUIREMENTS BY OTHERS.

2 TYPICAL BELOW GRADE CONDUIT DETAIL  
SCALE: N.T.S.

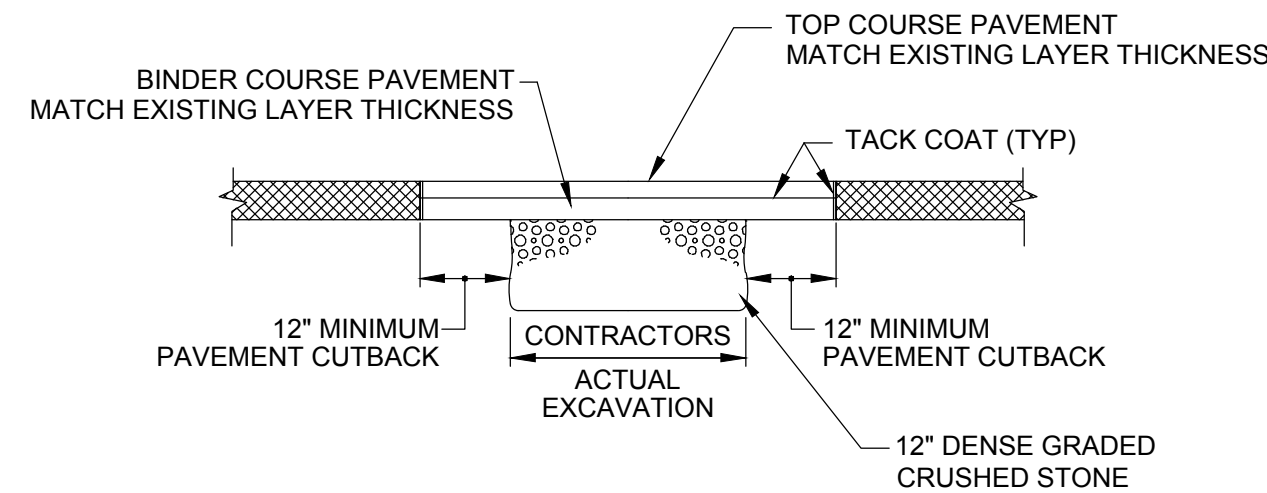

- NOTE:
- ASPHALT REPAIR SHALL MATCH EXISTING PAVEMENT LAYERS.

4 PAVEMENT REPAIR  
SCALE: N.T.S.

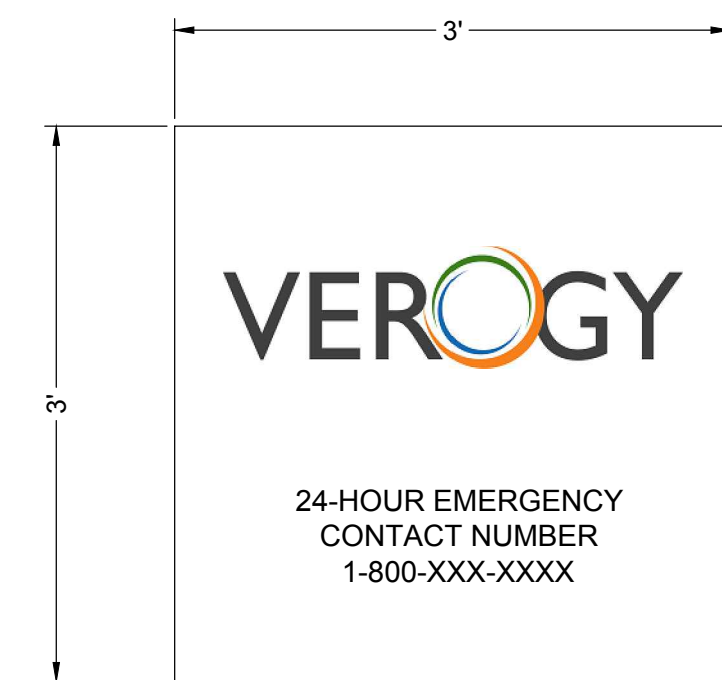

- NOTES:
- CONTRACTOR SHALL VERIFY CONTACT INFORMATION PRIOR TO CONSTRUCTION.

6 CONTRACTOR INFORMATION SIGN  
SCALE: N.T.S.

Project:  
PROPOSED SOLAR  
PV DEVELOPMENT

221 WARRENVILLE ROAD  
MANSFIELD, CT 06268

Weston & Sampson

WESTON & SAMPSON ENGINEERS, INC.  
712 BROOK STREET, SUITE 103  
ROCKY HILL, CT 06067  
860.513.1473 800.SAMPSON  
www.westonandsampson.com

Applicant:

VEROGY  
VCP Mansfield LF, LLC  
124 LaSalle Road  
2nd Floor  
West Hartford, CT 06107  
TEL: (860) 288-7215  
WWW.VEROGY.COM

Revisions:		
0	10/09/2024	ISSUED FOR PERMITTING
No.	Date	Description



Issued For:  
**PERMITTING**

Scale: AS SHOWN  
Date Created: 10/09/2024  
Drawn By: DED  
Reviewed By: MRC  
Approved By: RJB  
W&S Project No.: ENG24-1027  
W&S File No.: VEROGY MANSFIELD

Drawing Title:  
**DETAILS II**

Sheet Number:  
**C502**

NOT FOR CONSTRUCTION