

CSC PERMIT SET

NO	DATE	REVISION
0		
1		
2		
3		
4		
5		
6		

DESIGN PROFESSIONAL OF RECORD

PROF: THOMAS E. LITTLE, P.E.
COMP: ALL-POINTS TECHNOLOGY CORPORATION P.C.
ADD: 567 VAUXHALL STREET EXTENSION - SUITE 311
WATERFORD, CT 06385

OWNER: CITY OF HARTFORD

ADDRESS: 550 MAIN STREET, SUITE 200
HARTFORD, CT 06103

HARTFORD LANDFILL

SITE 180 LIEBERT ROAD
ADDRESS: HARTFORD, CT 06120

APT FILING NUMBER: CT481510

DRAWN BY: TEL

DATE: 10/20/2023 CHECKED BY: SMC

SHEET TITLE:

OVERALL LOCUS MAP

SHEET NUMBER:

OP-1

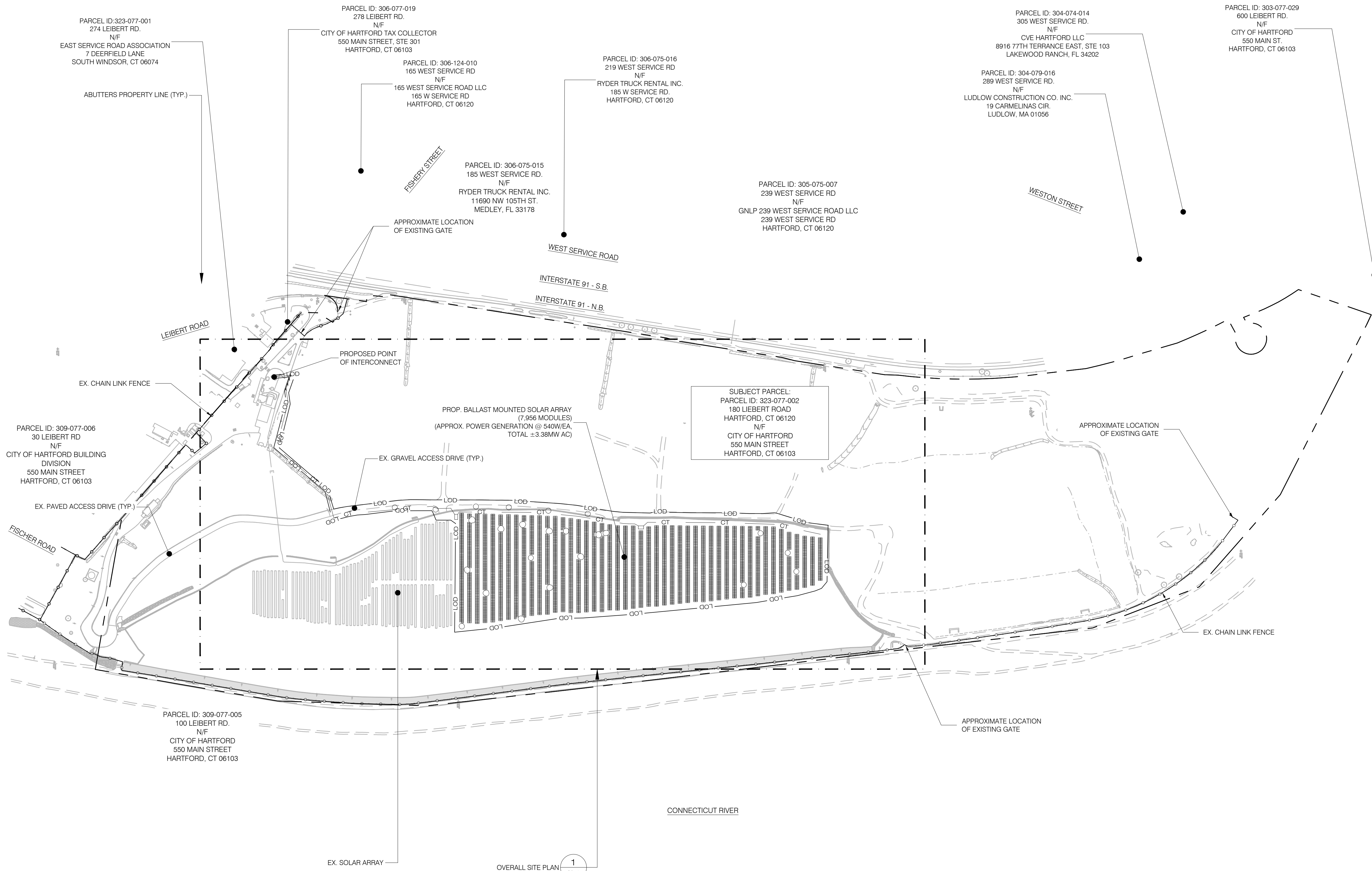

1 OVERALL LOCUS MAP
SCALE: 1" = 200'-0"

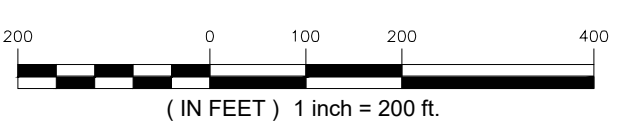

OVERALL SITE PLAN
1 SP-0