

**EXHIBIT H**

Photographic Site Documentation

# Remote Field Review



Proposed Solar Energy Facility  
0 Spencer Street  
Suffield, Connecticut

Prepared For:  
TRITEC Americas, LLC

Prepared By:  
Solli Engineering, LLC  
501 Main Street #2A  
Monroe, CT 06468



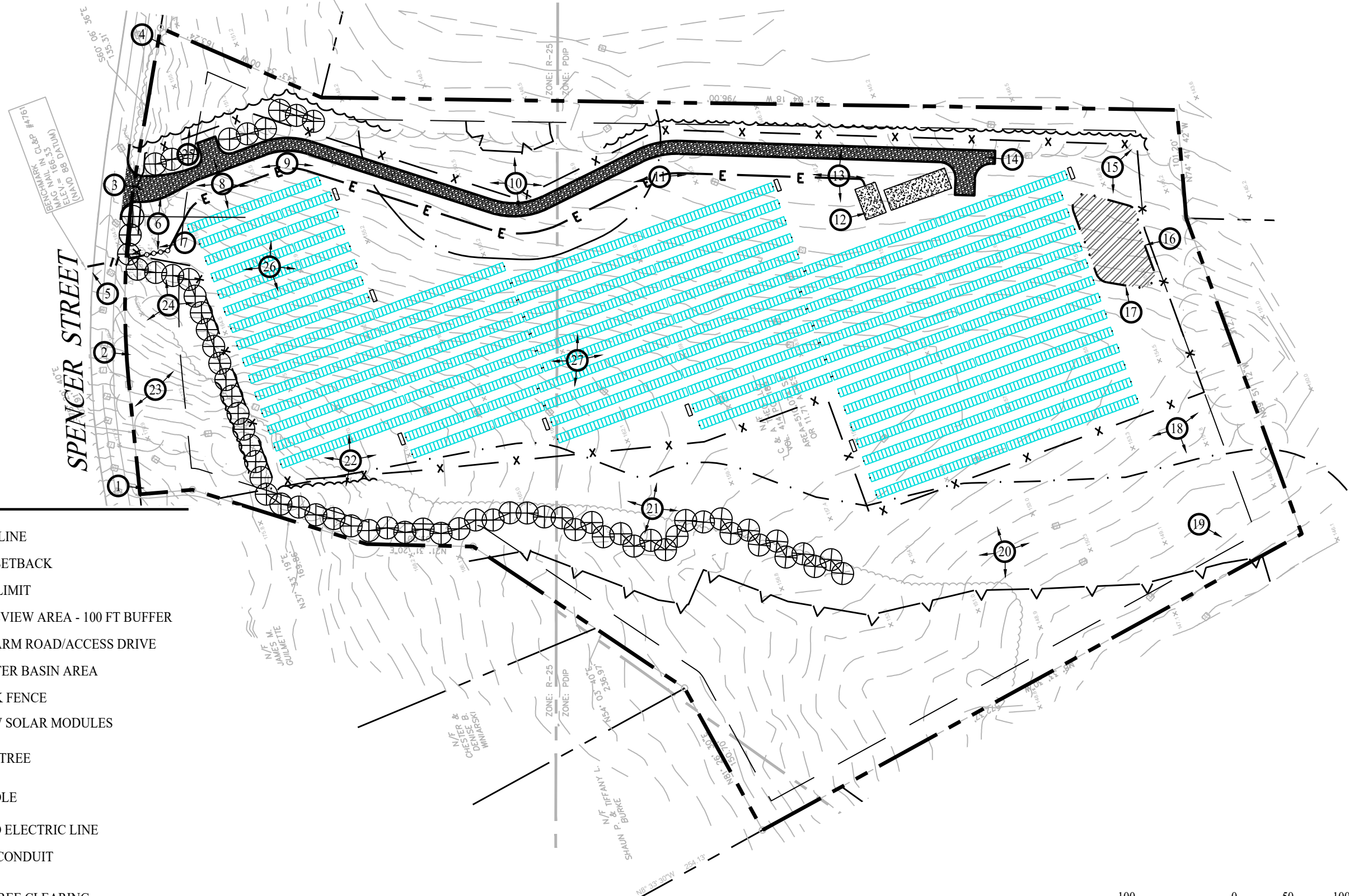

**LEGEND**

- PROPERTY LINE
- BUILDING SETBACK
- WETLAND LIMIT
- UPLAND REVIEW AREA - 100 FT BUFFER
- EDGE OF FARM ROAD/ACCESS DRIVE
- STORMWATER BASIN AREA
- CHAIN LINK FENCE
- TRINA 540W SOLAR MODULES
- PROPOSED TREE
- UTILITY POLE
- OVERHEAD ELECTRIC LINE
- ELECTRIC CONDUIT
- LIMIT OF TREE CLEARING
- PHOTO POINT LOCATION



| Rev. #: | Date | Description |
|---------|------|-------------|
|         |      |             |
|         |      |             |
|         |      |             |

**SOLLI**  
ENGINEERING  
501 Main Street, Monroe, CT 06468  
T: (203) 880-5455 | F: (203) 880-9695

|             |           |
|-------------|-----------|
| Drawn By:   | SFU       |
| Checked By: | KMS       |
| Project #:  | 23101901  |
| Plan Date:  | 09/27/23  |
| Scale:      | 1" = 100' |

Project: **PROPOSED SOLAR PHOTOVOLTAIC ARRAY**  
0 SPENCER STREET  
SUFFIELD, CONNECTICUT

Sheet Title: **REMOTE FIELD REVIEW FIGURE**

SHEET #: **FIG.1**





Photo 1: Spencer Street looking South



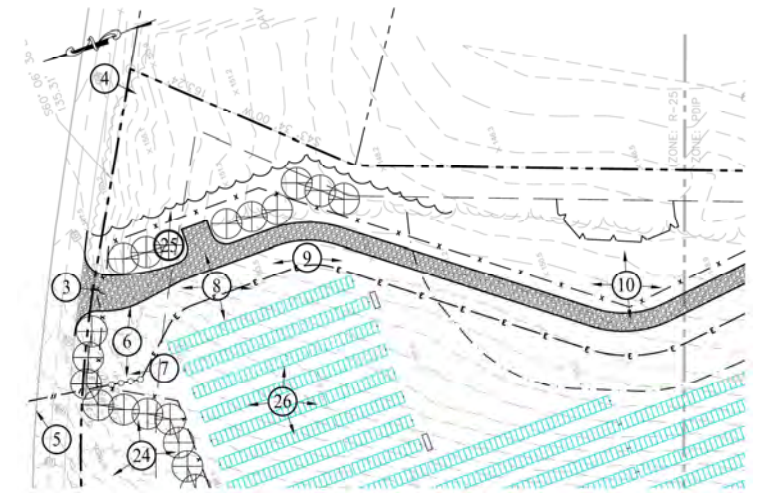



Photo 2: Spencer Street looking South







Proposed Gravel Road  
Access onto Spencer  
Street

Photo 3: Spencer Street looking South





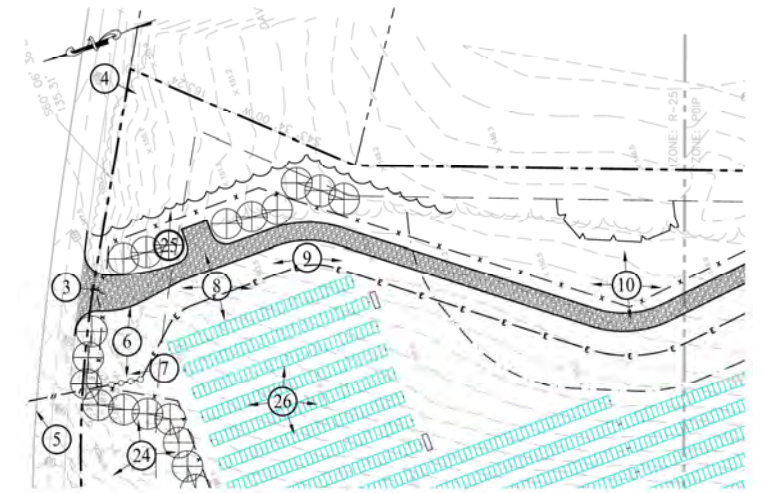
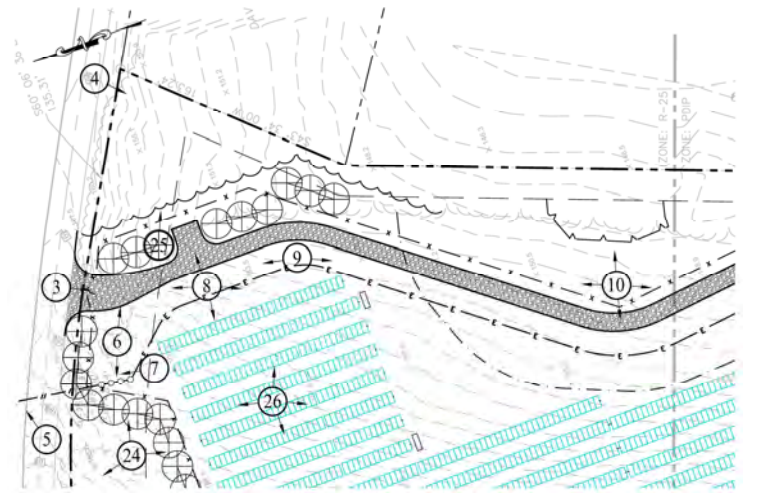

Photo 4: Spencer Street looking South







Proposed Interconnection Point

Photo 5: Looking Northeast





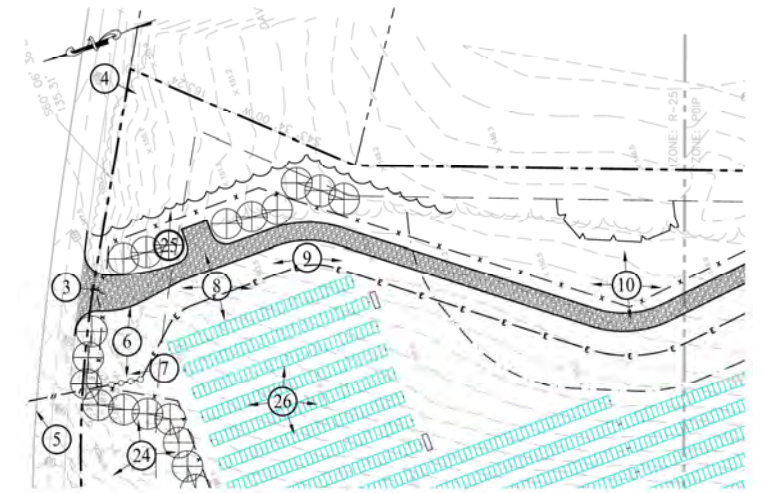

Proposed Chain Link  
Fence

Proposed Utility Pole

Photo 6: Looking West





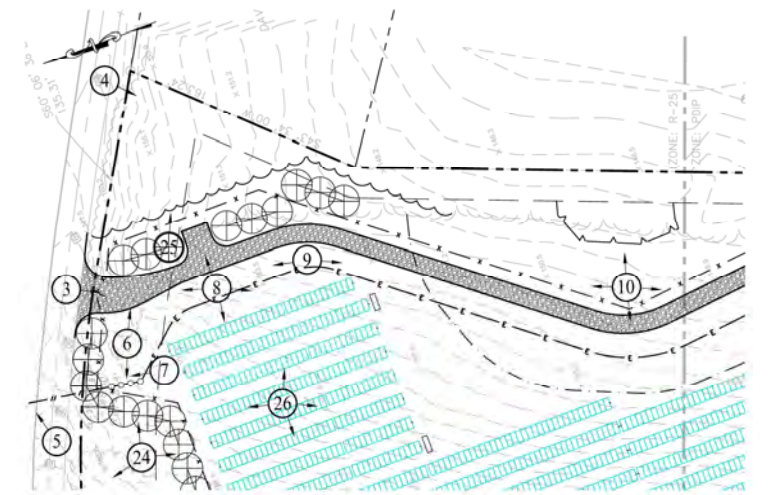

Proposed Tree Planting

Proposed Gravel Road

Photo 6: Looking East





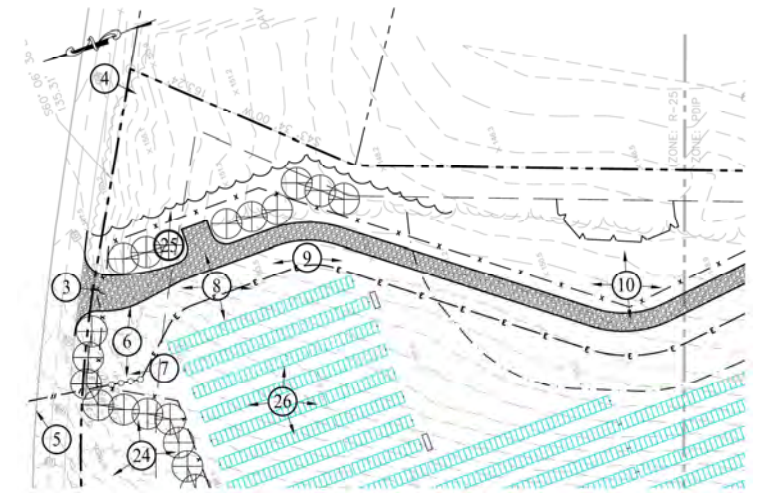

Proposed Interconnection Point

Proposed Utility Pole

Photo 7: Looking North





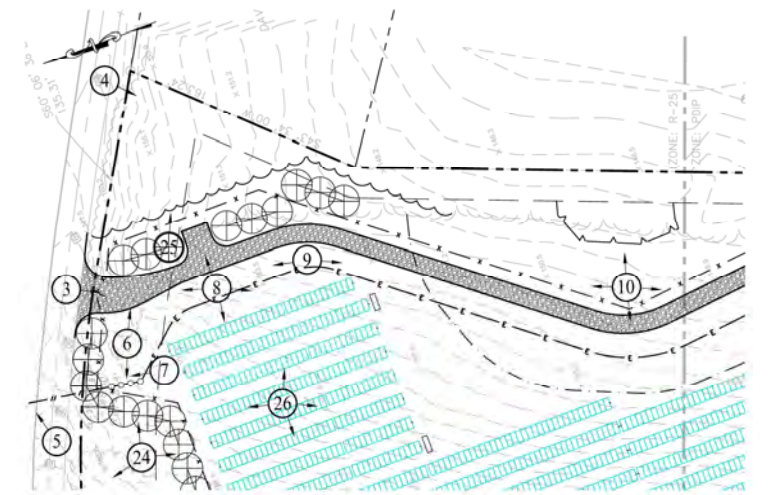

Proposed Gravel Road

Proposed Utility Pole

Photo 8: Looking North





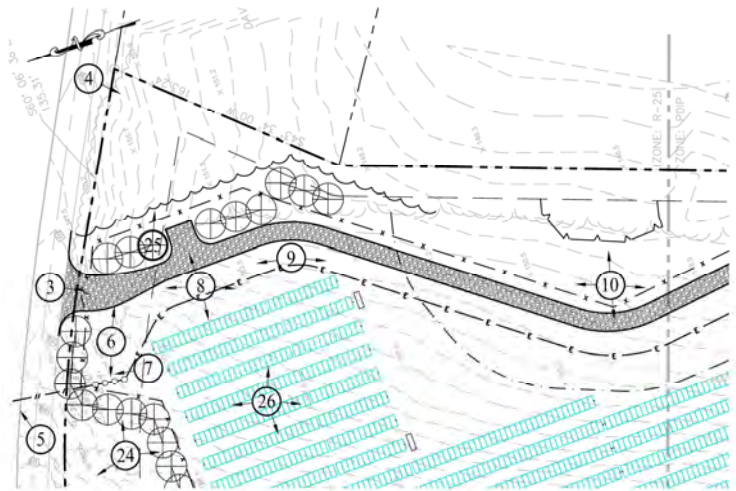

Proposed Gravel Road  
Parking Space

Photo 8: Looking East





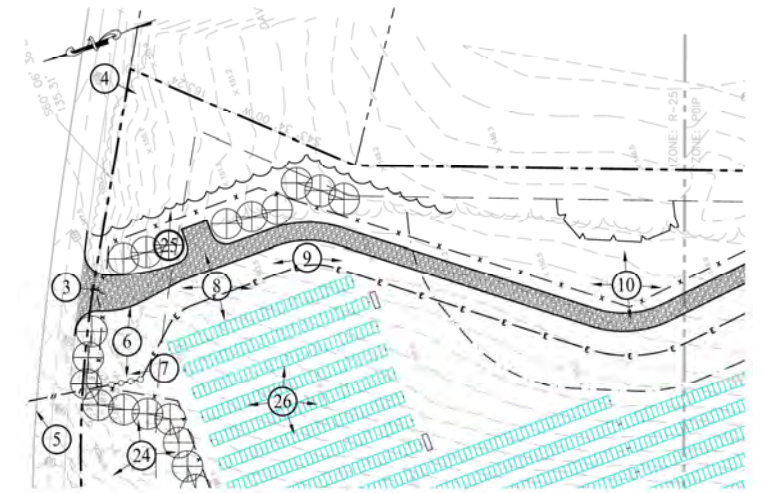

Photo 8: Looking South





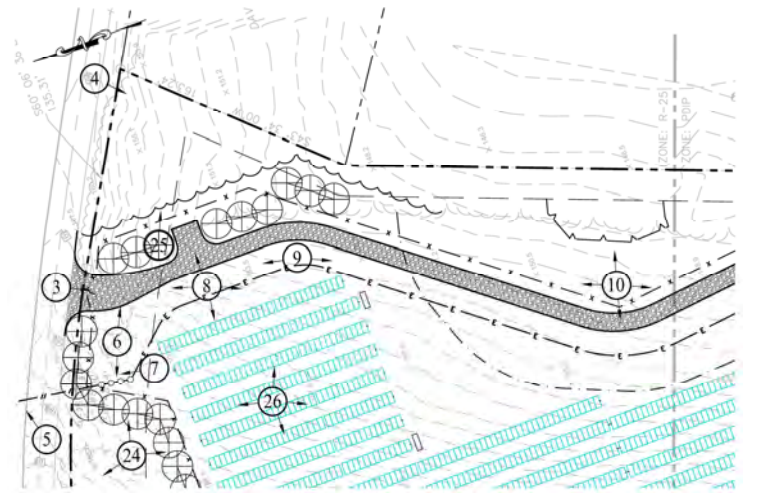

Photo 8: Looking West





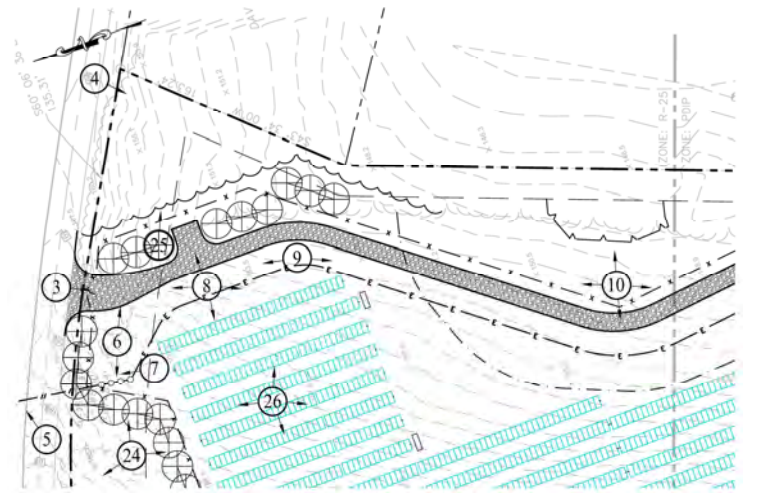

Photo 9: Looking North





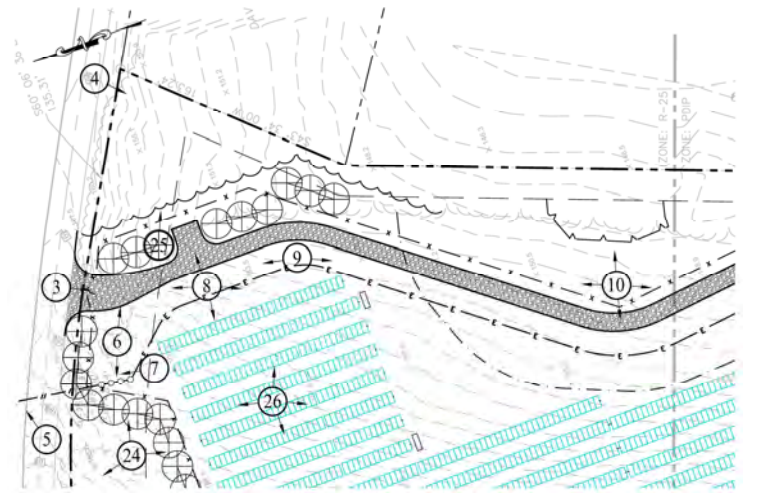

Photo 9: Looking South





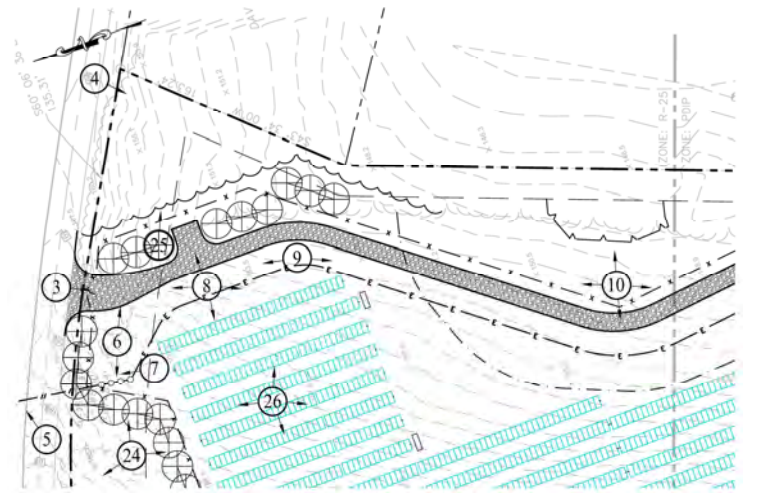
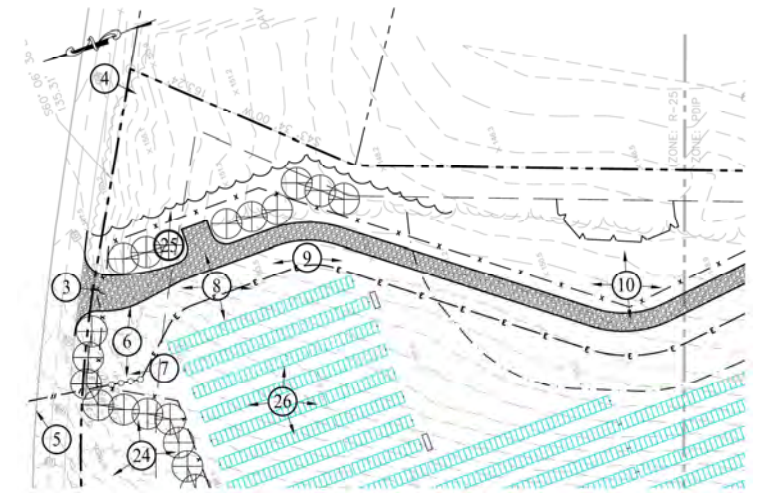

Photo 10: Looking North







Existing Wetlands

Photo 10: Looking East





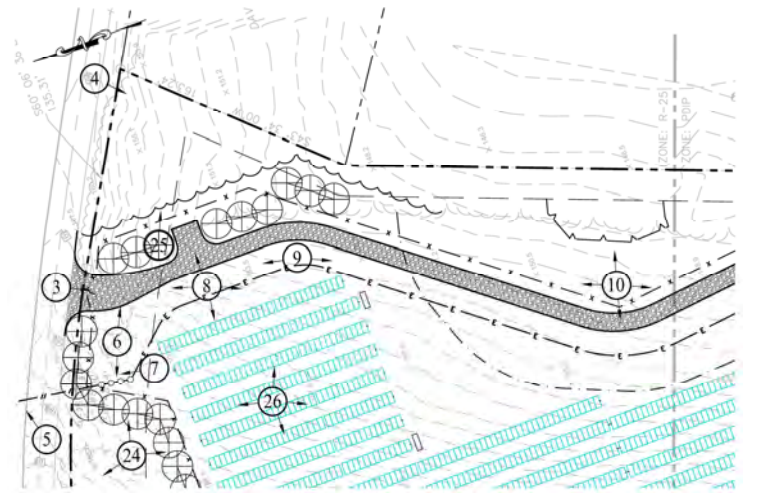
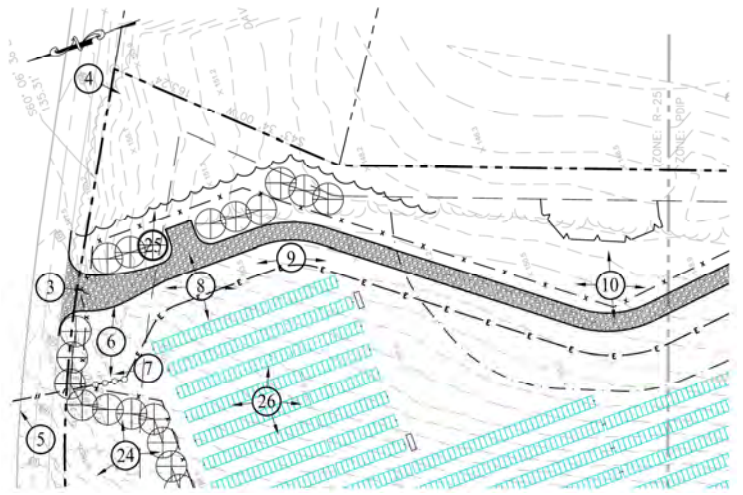

Photo 10: Looking South







Proposed Electric Line

Proposed Gravel Road

Proposed Chain Link Fence

Photo 10: Looking West





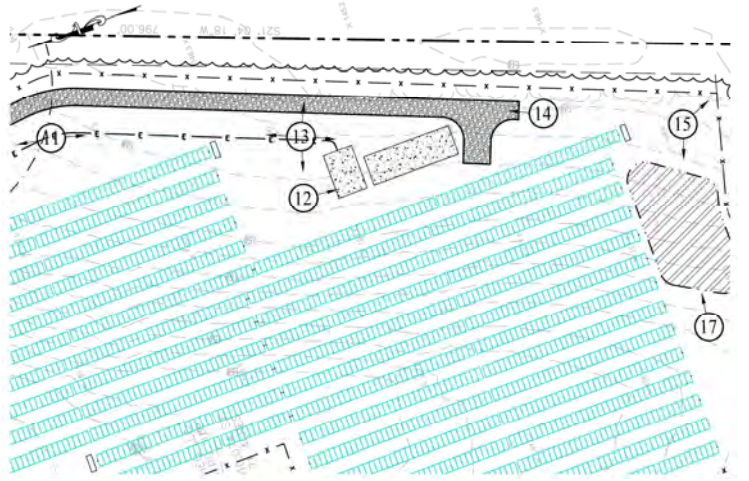

Photo 11: Looking North





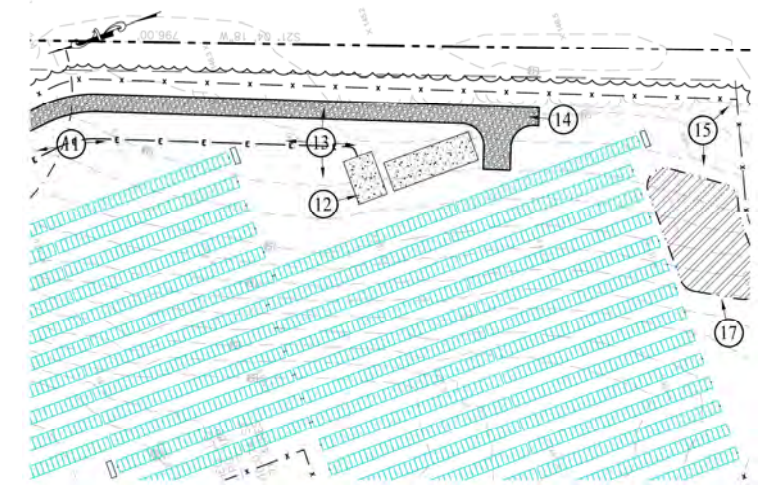
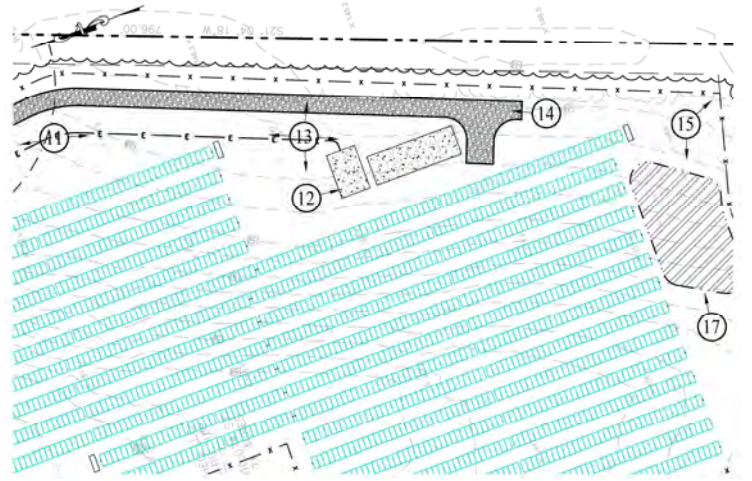

Photo 11: Looking South







Proposed Concrete Pad Area

Photo 12: Looking South





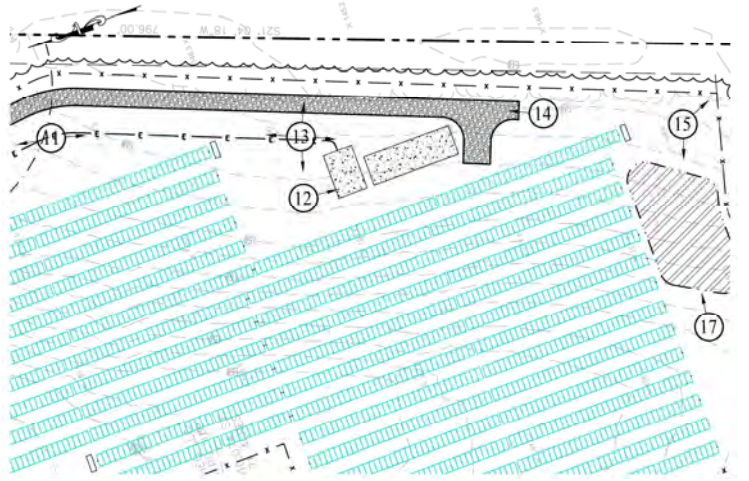

Photo 13: Looking North





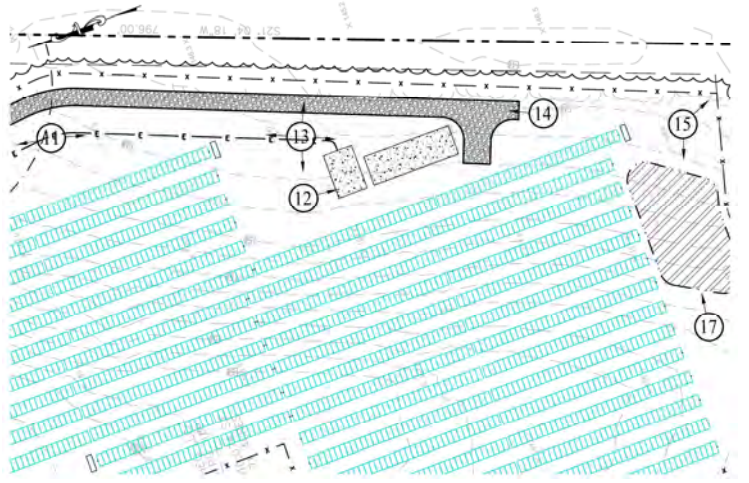
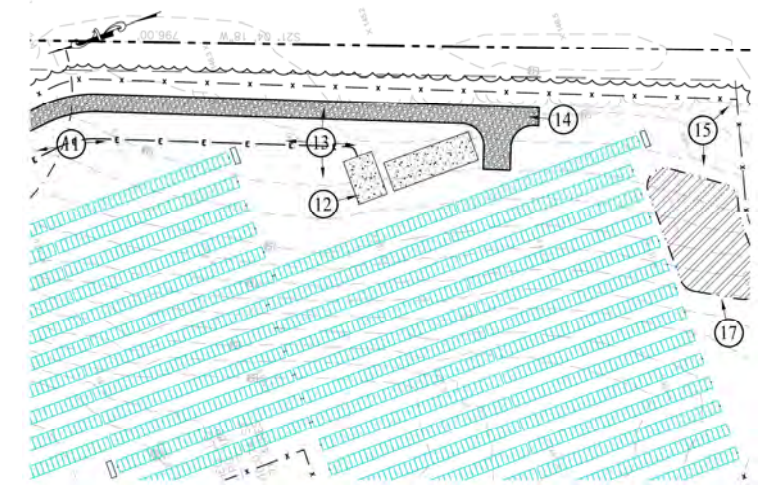

Photo 13: Looking East







Approximate End of Proposed Gravel Road

Photo 13: Looking South





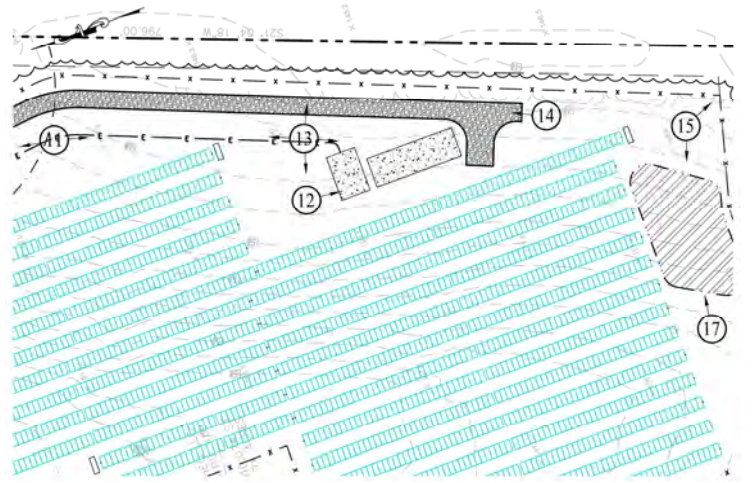

Proposed Concrete Pad Area

Photo 13: Looking West





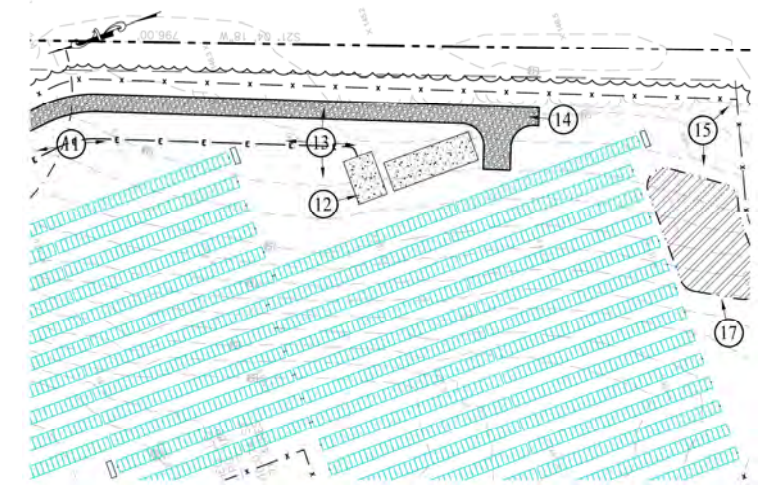

Approximate End of Proposed Gravel Road

Photo 14: Looking North





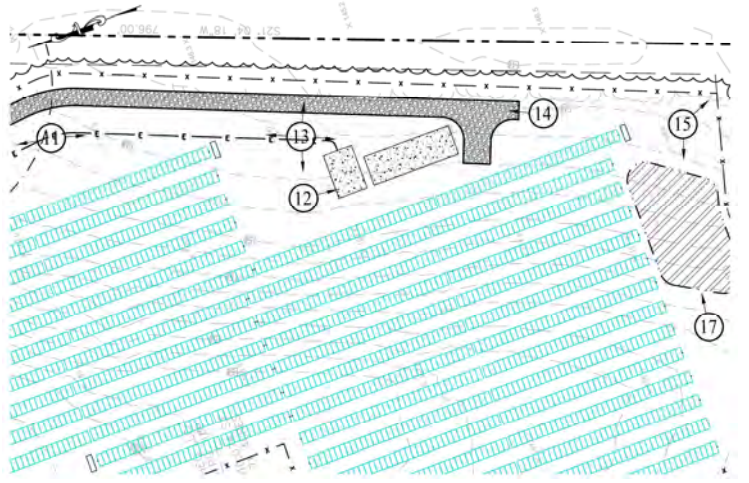

Approximate Edge of  
Proposed Stormwater  
Basin

Photo 15: Looking West





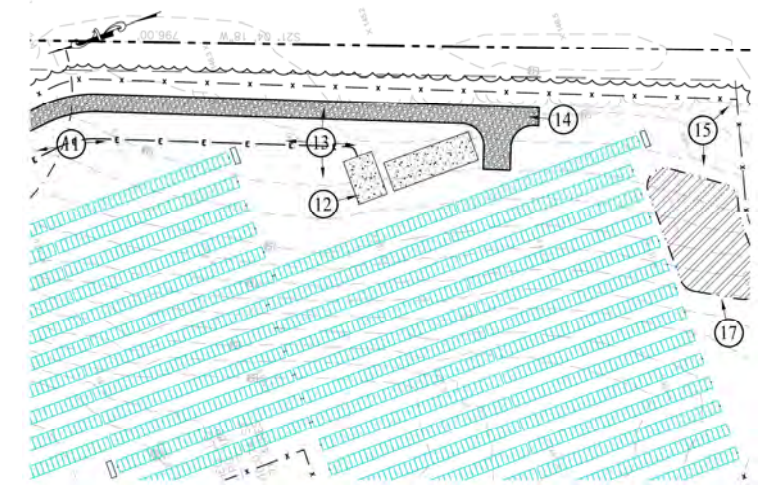
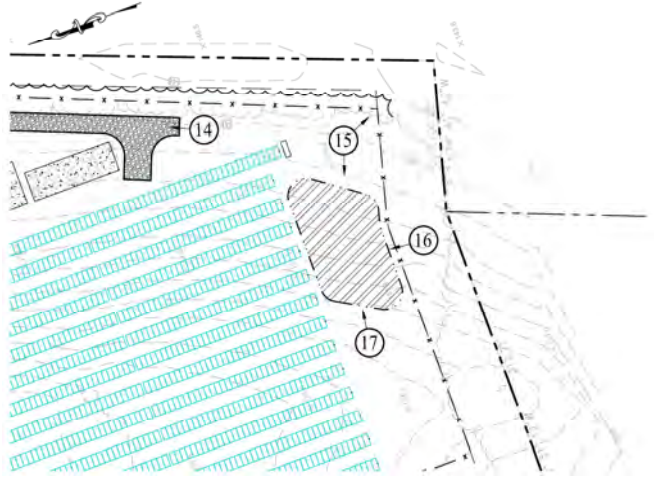

Photo 15: Looking South







Approximate Edge of  
Proposed Stormwater  
Basin

Photo 16: Looking North





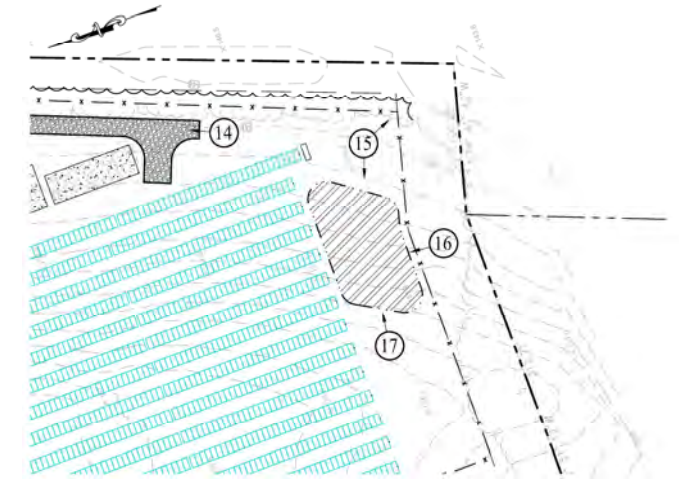

Approximate Edge of  
Proposed Stormwater  
Basin

Photo 17: Looking East







Photo 18: Looking North







Abutting Agricultural  
Fields & Abandoned  
Barn

Photo 18: Looking South







Photo 18: Looking West







Photo 19: Looking West







Photo 20: Looking North







Photo 20: Looking East







Photo 20: Looking South







Existing Wetlands

Photo 20: Looking West





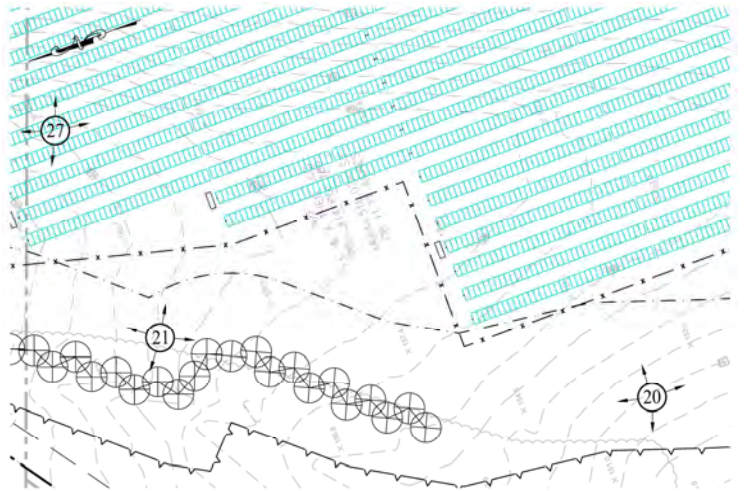

Photo 21: Looking North





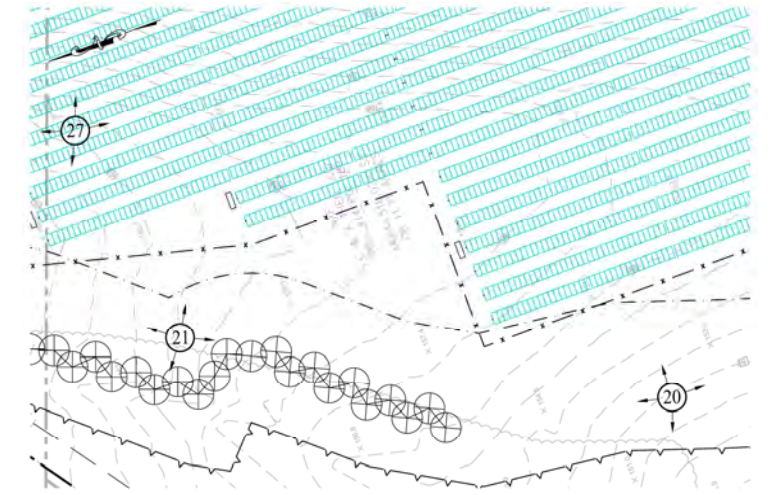

Photo 21: Looking East





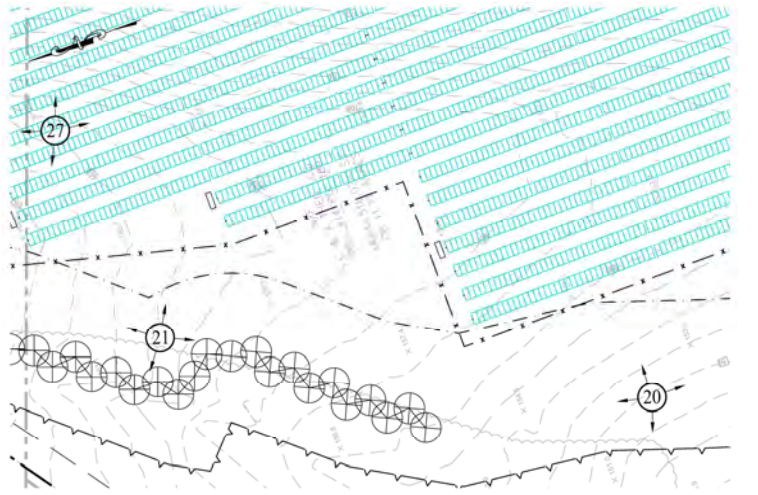
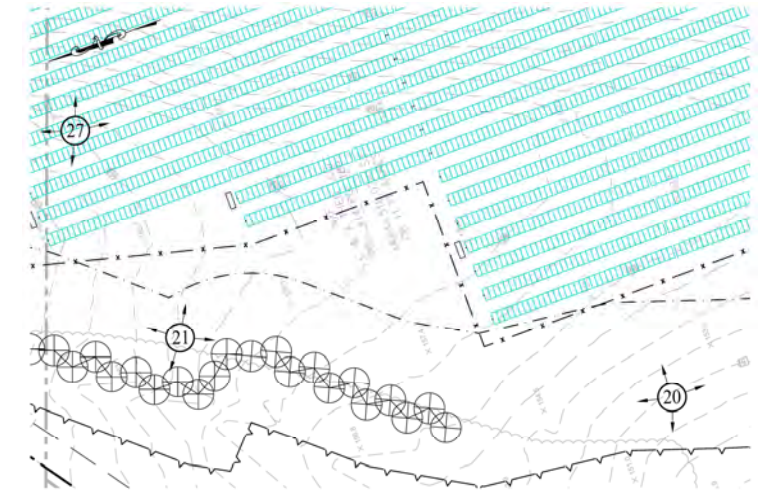

Photo 21: Looking South







Abutting Residential Properties

Proposed Treeline

Photo 21: Looking West



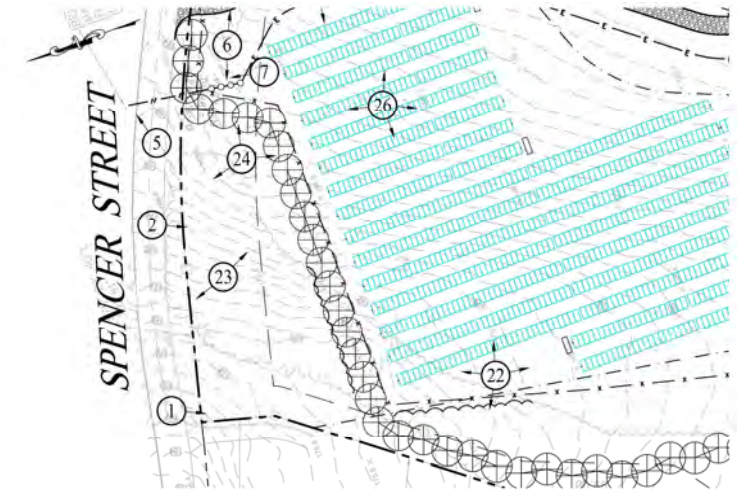

Photo 22: Looking North







Photo 22: Looking East



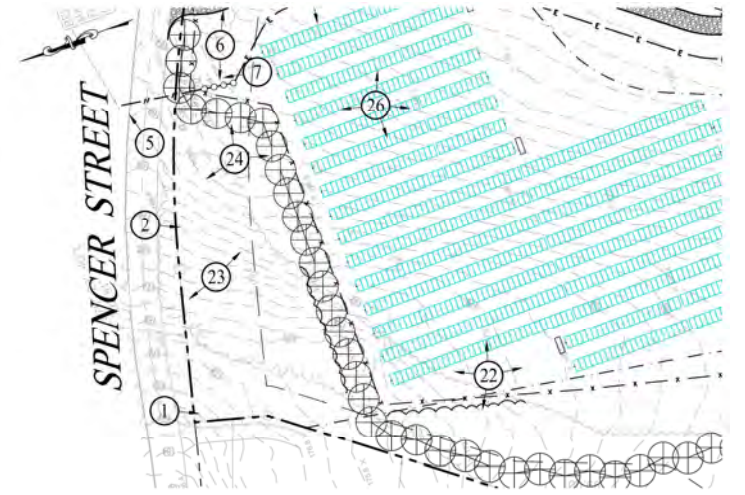



Photo 22: Looking South







Abutting Residential Properties

Proposed Treeline

Photo 22: Looking West





Photo 23: Looking North







Photo 23: Looking South







Photo 24: Looking North







Proposed Utility Pole

Proposed Chain Link  
Fence

Photo 24: Looking East

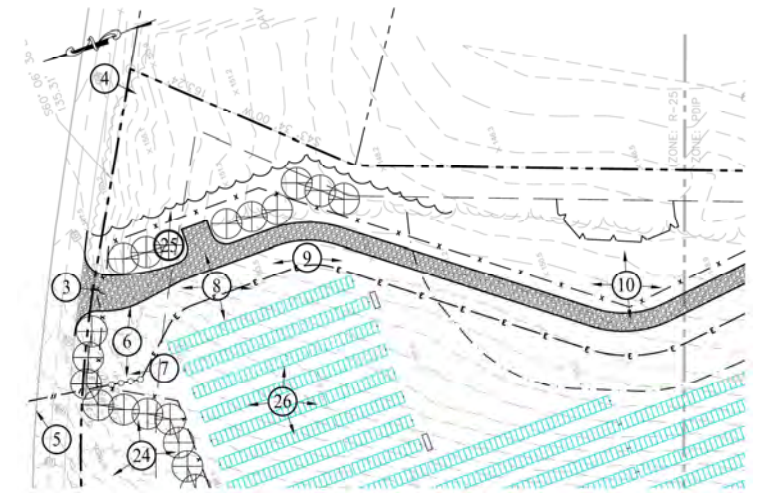



Photo 24: Looking South







Abutting Residential Property

Proposed Treeline

Photo 25: Looking East





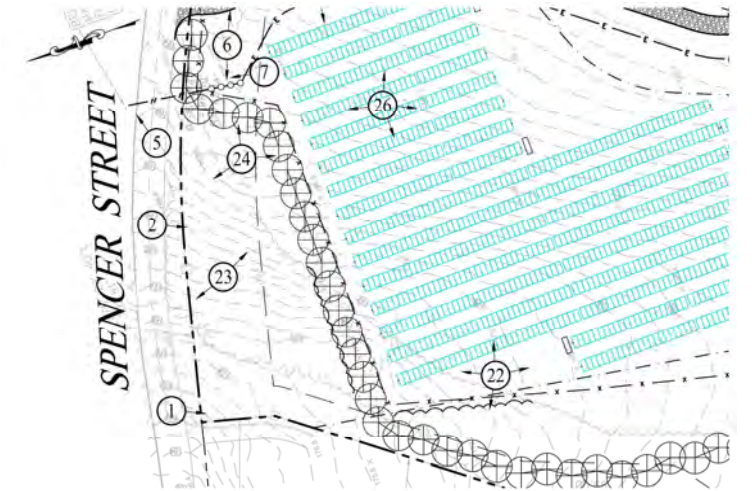

Photo 26: Looking North







Photo 26: Looking East







Photo 26: Looking South







Photo 26: Looking West





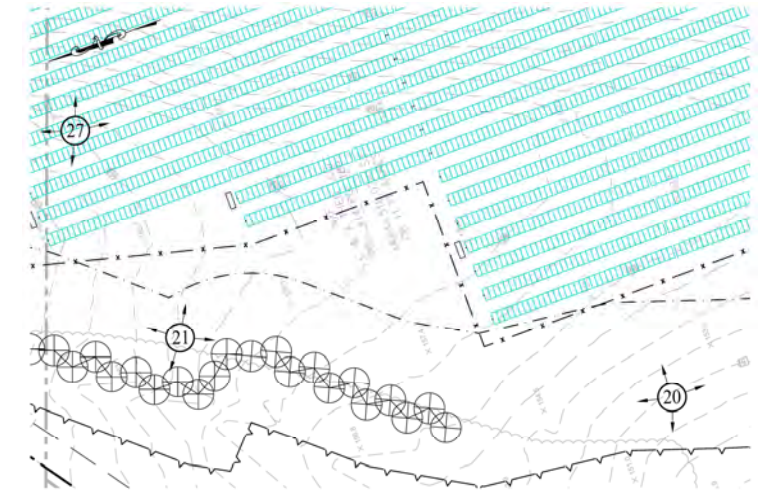

Photo 27: Looking North





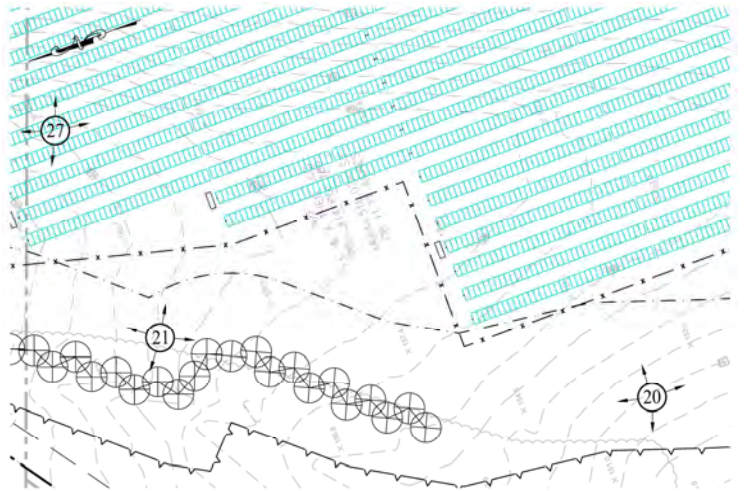

Photo 27: Looking East





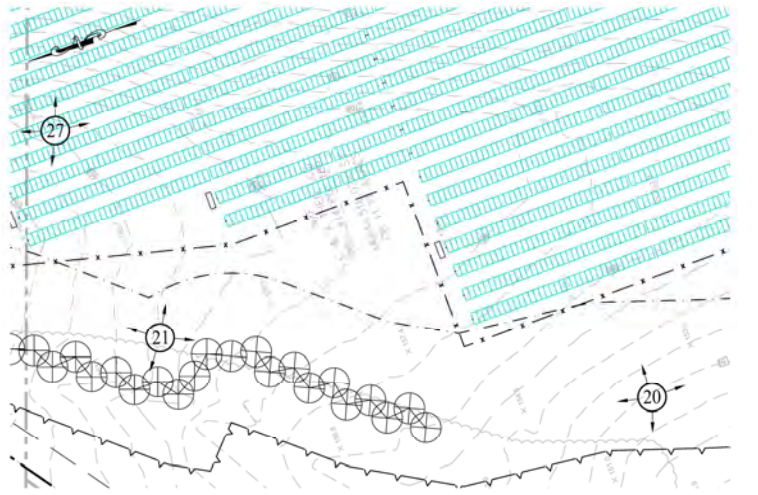

Photo 27: Looking South





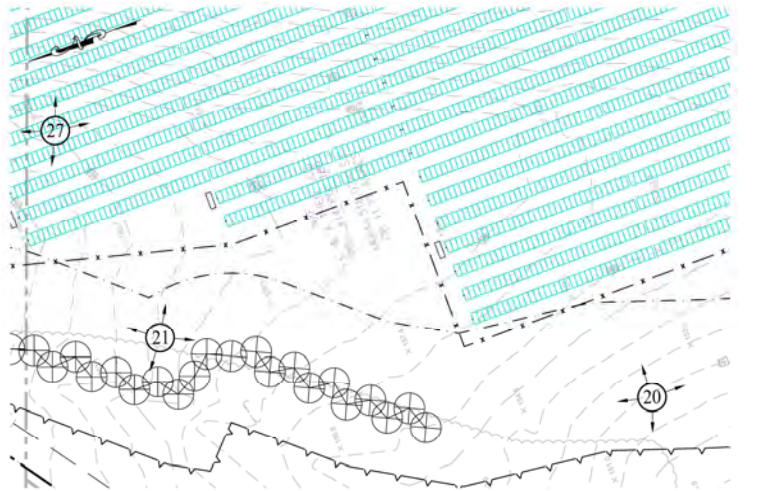

Photo 27: Looking West

