

What Powers You

June 13, 2022

Melanie Bachman, Esq.
Executive Director
Connecticut Siting Council
10 Franklin Square
New Britain, CT 06051

RE: PETITION NO. 1510 –Bloom Energy Corporation petition for a declaratory ruling, pursuant to Connecticut General Statutes §4-176 and §16-50k, for the proposed construction, maintenance and operation of a customer-side 1-megawatt fuel cell facility and associated equipment to be located at Bozzuto's Inc., 400 Industrial Avenue, Cheshire, Connecticut.

Dear Ms. Bachman:

Please see the attached responses to the interrogatories provided to Bloom Energy on June 8th, 2022.

Respectfully,



Kristen Grillo
Senior Permitting Specialist | East Coast Field Office
Customer Installations Group | North America
(917) 803-4511
Kristen.Grillo@bloomenergy.com



Bloom Energy Corporation
4353 North First Street, San Jose, CA 95134
408 543 1500
www.bloomenergy.com

**Petition No. 1510
Bloom Energy Corporation
Bozzuto's Inc. – 400 Industrial Avenue, Cheshire
Interrogatories**

1. What is the estimated cost of the proposed project?

Response: The estimated cost of the project is \$1,202,616.82.

2. Referencing page 10 of the Petition, has the Town of Cheshire, and/or abutters provided comments to Bloom since the Petition filing? If yes, summarize the comments.

Response: No comments have been provided by the Town of Cheshire and/or the abutters notified since the Petition has been filed.

3. Referencing page 4 of the Petition, identify the media to be used for pipe cleaning procedures at the proposed facility in accordance with Public Act 11-101, An Act Adopting Certain Safety Recommendations of the Thomas Commission and Connecticut General Statutes § 16-50ii.

Response: The media to be used for the pipe cleaning procedures at the proposed facility would be compressed air.

4. Referencing Drawing C1.1 of the Petition, existing and proposed "Jersey barriers" would surround the fuel cell facility on three sides. How tall are the existing and proposed barriers? Provide sample photographs or drawings to depict what the existing and proposed barriers look like. Would the proposed barriers match or be comparable in appearance to the existing barriers? Explain.

Response: The existing Jersey barriers are 32" and the proposed Jersey barriers will be the same type. Please see Attachment #1, highlighting all the Jersey barriers and how they will be used. Photos of existing Jersey barriers are included as well in this attachment.

5. Referencing Drawing C1.1 of the Petition, would the water line connection be run underground from the fuel cell facility to the electrical room?

Response: Only a very short portion of the water line run will be underground. This would be the portion that runs under our cast-in-place ancillary pad. The rest of the run would be located above ground.

Attachment 1: Site Plan Detail & Photos of Jersey Barriers

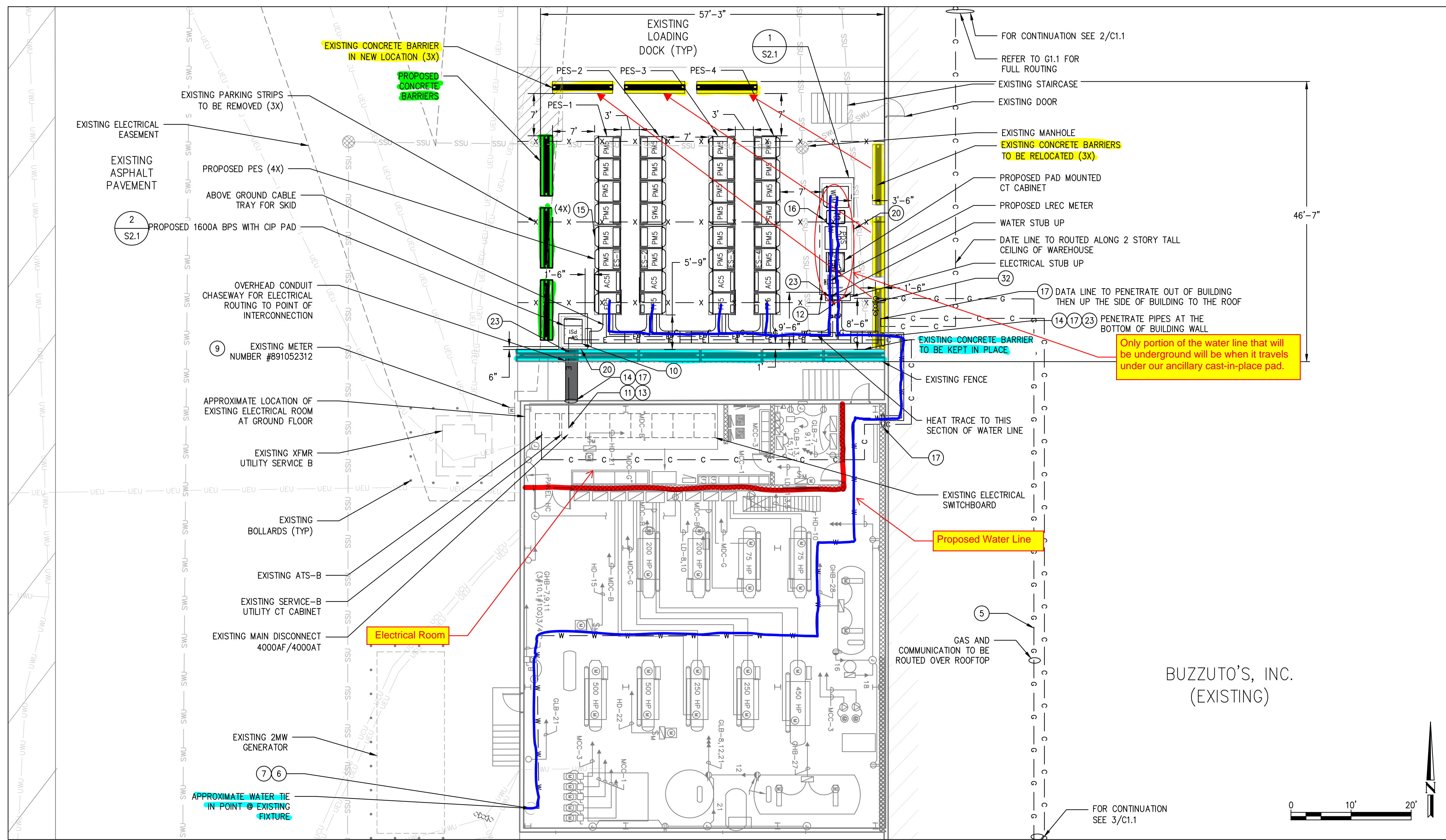

DETAILED SITE PLAN
SCALE: 1" = 10'

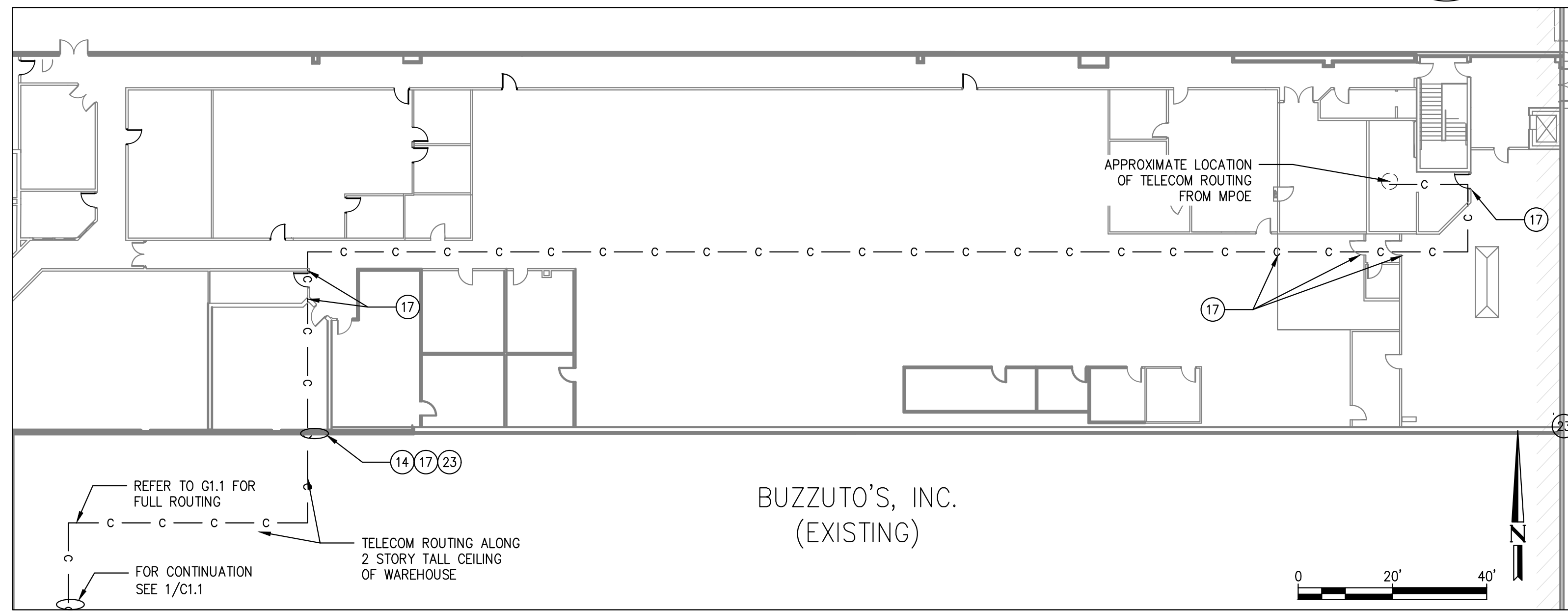

DETAILED SITE PLAN
SCALE: 1" = 20'

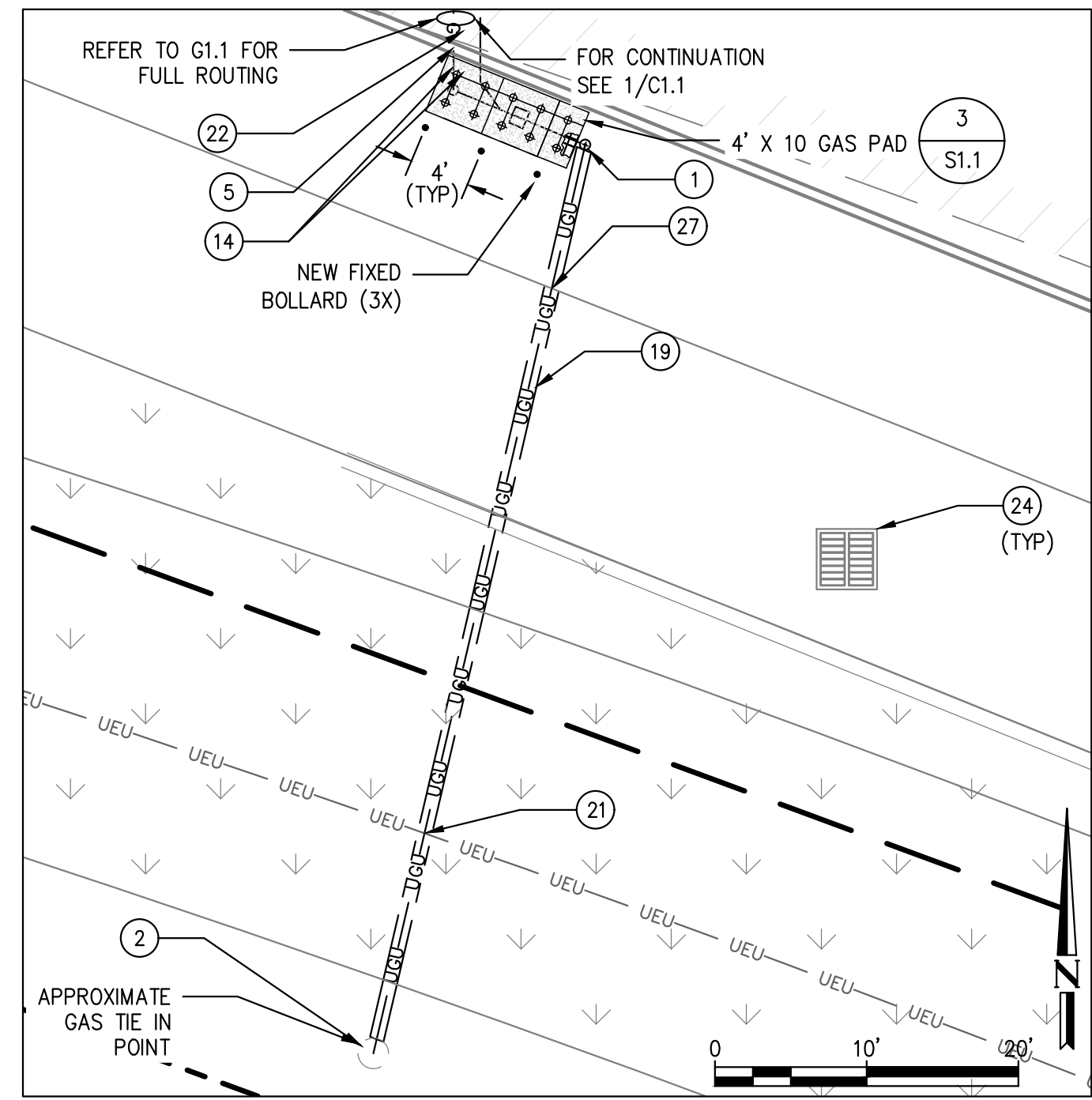

DETAILED SITE PLAN
SCALE: 1" = 10'

GENERAL NOTES

- CLEAN AND PRIME ALL NEW WALL MOUNTED PIPING. PIPING SHALL BE PAINTED WITH EXTERIOR GRADE PAINT TO MATCH EXISTING.
- PIPES MOUNTED TO BUILDING WALL SHALL BE SUPPORTED AS PER LOCAL CODE, RUN AT HEIGHT ABOVE DOORWAYS, AND STAND OFF WALL TO AVOID EXISTING PIPES.
- SEE BLOOM ENERGY PRODUCT INSTALLATION DRAWINGS FOR UTILITY CONNECTIONS TO ANCILLARY EQUIPMENT AND ENERGY SERVER.
- ALL PULL BOXES AND VAULTS REQUIRED ARE NOT SHOWN. CONTRACTOR SHALL PROVIDE PULL BOX OR VAULT FOR CONDUIT RUNS WITH MORE THAN 360-DEG BENDS OR OTHERWISE REQUIRED PER CABLE PULLING TENSION OR SIDEWALL PRESSURE LIMITATIONS. CONTRACTOR SHALL SIZE PULL BOX OR VAULT IN COMPLIANCE WITH NEC REQUIREMENTS.
- ALL EXISTING FEATURES SHALL REMAIN AND PROTECTED THROUGHOUT THE CONSTRUCTION, UNLESS OTHERWISE NOTED ON PLAN.
- ALL FROST LINE SECTIONS OF WATER PIPES SHALL HAVE POWERED HEAT TRACE AND INSULATION, ENSURE UNDERGROUND WATER DEPTHS ARE BELOW FROST LINE.

REFERENCE SHEET NOTES

- UTILITY SHALL FURNISH AND INSTALL GAS METER & REGULATOR ASSEMBLY WITH SHUT-OFF VALVE. CONTRACTOR SHALL FURNISH AND INSTALL PAD PROVIDE PAD PER DETAILS. COORDINATE ALL CONNECTIONS WITH GAS UTILITY.
- UTILITY SHALL FURNISH AND INSTALL AN UNDERGROUND GAS SERVICE TAP. COORDINATE WITH GAS UTILITY. CONTRACTOR SHALL PERFORM COMPACTION AND MATCH EXISTING SURFACE AND GRADE. CONTRACTOR SHALL COORDINATE GAS PIPE SIZING AND INSTALLATION REQUIREMENTS WITH UTILITY.
- FURNISH AND INSTALL GAS PIPE. REFER TO GAS RISER DETAIL FOR ADDITIONAL REQUIREMENTS.
- TAP EXISTING WATER LINE AT NEAREST ACCESSIBLE LOCATION IN BUILDING AS SHOWN WITH A LOCAL SHUT-OFF VALVE. REFER TO DOMESTIC WATER CONNECTION DETAIL FOR ADDITIONAL REQUIREMENTS.
- FURNISH AND INSTALL WATER PIPE. REFER TO WATER RISER DETAIL FOR ADDITIONAL REQUIREMENTS.
- EXISTING UTILITY ELECTRIC METER. REFER TO ELECTRICAL SINGLE LINE DIAGRAM FOR ADDITIONAL REQUIREMENTS.
- BLOOM ENERGY SHALL FURNISH AND CONTRACTOR SHALL INSTALL DISCONNECT SWITCH. MOUNT DISCONNECT SWITCH TO CIP PAD PER MANUFACTURER AND UTILITY SPECIFICATIONS.
- CONTRACTOR SHALL TERMINATE ELECTRIC FEEDER AS SHOWN. REFER TO ELECTRICAL SINGLE LINE DIAGRAM FOR ADDITIONAL REQUIREMENTS.
- CONTRACTOR SHALL FURNISH AND INSTALL TWO GROUNDING RODS PLACED A MINIMUM OF 6' APART. REFER TO ELECTRICAL SINGLE LINE DIAGRAM FOR ADDITIONAL REQUIREMENTS.
- CONTRACTOR SHALL FURNISH AND INSTALL ELECTRICAL FEEDER. REFER TO ELECTRICAL SINGLE LINE DIAGRAM FOR ADDITIONAL REQUIREMENTS.
- MOUNT CONDUIT/PIPE TO EXTERIOR WALL. COORDINATE EXACT ROUTING WITH CUSTOMER REPRESENTATIVE IN THE FIELD. REFER TO WALL MOUNTING DETAIL FOR ADDITIONAL REQUIREMENTS.
- PROPOSED BLOOM ENERGY SERVER. REFER TO BLOOM ENERGY STANDARD INSTALLATION DRAWING SET FOR ADDITIONAL BLOOM ENERGY SERVER DETAILS.
- FACTORY WIRED BLOOM ENERGY SERVER EMERGENCY POWER-OFF SWITCH (EPO).
- CONTRACTOR SHALL CORE CONDUIT AND/OR PIPE THROUGH WALL. SCAN WALL PRIOR TO CORING TO AVOID COLLATERAL DAMAGE TO EXISTING PLUMBING AND WIRING. REFER TO WALL PENETRATION DETAIL FOR ADDITIONAL REQUIREMENTS.
- UTILITY SHALL SAWCUT TRENCH FOR UNDERGROUND UTILITIES IN THIS LOCATION AND HAND DIG TRENCHES WHERE THEY CROSS EXISTING UTILITIES. REFER TO UNDERGROUND/TRENCH CONDUIT AND PIPING DETAIL FOR ADDITIONAL REQUIREMENTS.
- CONTRACTOR SHALL SAWCUT TO ALLOW FOR EXCAVATION UNDER ANCILLARY PAD LOCATIONS. REFER TO PAD DETAIL FOR ADDITIONAL EXCAVATION AND BACKFILL REQUIREMENTS.
- PROTECT EXISTING UNDERGROUND UTILITY LINES FROM DAMAGE WHEN CROSSING WITH NEW UNDERGROUND UTILITIES. CONTRACTOR SHALL BE RESPONSIBLE FOR REPAIR OR REPLACEMENT OF ANY DAMAGED LINES.
- CONTRACTOR SHALL FURNISH AND INSTALL CONDUITS AND CABLES FROM THE PROPOSED GAS MSA TO CUSTOMER MPOE FOR UTILITY BILLING. REFER TO BLOOM ENERGY PRODUCT INSTALLATION DRAWINGS FOR CONNECTION REQUIREMENTS.
- CONTRACTOR SHALL TRANSITION ALL ABOVEGROUND PROPOSED LINES TO UNDERGROUND TOWARD ANCILLARY EQUIPMENT. ABOVE GROUND UTILITIES SHALL BE PROTECTED AS NECESSARY, THEN ROUTED UNDERGROUND TO EQUIPMENT STUB-UP LOCATIONS PER MECHANICAL DETAIL.
- FURNISH AND INSTALL A "DANDY SACK" OR AN APPROVED EQUAL WITH OUTFLOW PORTS AT STORM DRAIN INLET. REFER TO STORM DRAIN PROTECTION DETAIL FOR ADDITIONAL REQUIREMENTS.
- CONTRACTOR SHALL UNDER-CUT EXISTING CURB FOR TRENCHING UTILITY LINES AND BACKFILL WITH CONCRETE SLURRY. IF CURB IS DAMAGED, REPAIR TO MATCH EXISTING.
- FURNISH AND INSTALL PRIVATE SHUT-OFF VALVE FOR BLOOM ENERGY SERVER. REFER TO GAS RISER DETAIL FOR ADDITIONAL REQUIREMENTS.

EXISTING UTILITY NOTE:
THE LOCATION OF EXISTING UTILITIES IS SHOWN FOR THE CONTRACTOR'S REFERENCE. EXACT LOCATION, DEPTH AND SIZE OF ALL EXISTING UTILITIES IS NOT KNOWN. CONTRACTOR SHALL ASSUME RESPONSIBILITY FOR ALL EXISTING UTILITIES NOT SHOWN ON THESE DRAWINGS. CONTRACTOR TO FIELD VERIFY LOCATION OF EXISTING UNDERGROUND UTILITIES AND PROTECT THE EXISTING UNDERGROUND UTILITIES FROM DAMAGE WHEN CROSSING WITH NEW UNDERGROUND UTILITIES. CONTRACTOR SHALL BE RESPONSIBLE FOR REPAIR OR REPLACEMENT OF ANY DAMAGED LINES. THE CONTRACTOR SHALL NOTIFY THE ENGINEER IMMEDIATELY IF ANY FIELD CONDITIONS ENCOUNTERED DIFFER FROM THOSE REPRESENTED HEREON. SUCH CONDITIONS COULD RENDER THE DESIGN HEREON INAPPROPRIATE AND MAY REQUIRE ADJUSTMENTS TO AVOID CONFLICTS.

Bloomenergy
4353 N. FIRST STREET
SAN JOSE, CA 95134
PROPRIETARY AND CONFIDENTIAL
BLOOM ENERGY CORPORATION ALL RIGHTS RESERVED. THIS DOCUMENT IS FOR REFERENCE ONLY AND MAY NOT BE USED WITHOUT THE WRITTEN PERMISSION OF BLOOM ENERGY. ANY REPRODUCTION IN PART OR AS A WHOLE WITHOUT PERMISSION OF BLOOM ENERGY IS PROHIBITED.

Bloomenergy
4353 N. FIRST STREET
SAN JOSE, CA 95134
t: (408) 543-1500

ENGINEER OF RECORD
CARSON TURNER, P.E.
LICENSE # 22700

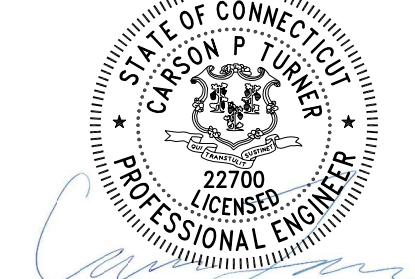

Digitally signed by
Carson Turner
DN: CN=Carson Turner
Date: 2022.06.06
23:59:04-07'00'

CUSTOMER SITE
BOZZUTO'S, INC.
400 INDUSTRIAL AVE,
BLDG B CHESHIRE,
CT 06410



REVISION HISTORY		
REV	REVISION ISSUE	DATE
-	REVISION PER INITIAL RELEASE	06/03/2022

DESIGNED BY
BRIAN CURTIS

REVIEWED BY
KATE TAYLOR

DRAWN BY
THARA SRINIVASACHARI

APPROVED BY
CARSON TURNER

SHEET TITLE	
DETAILED SITE PLAN	
DRAWING NUMBER	C1.1
BLOOM DOCUMENT	DOC-1014755
THIS DRAWING IS 24" X 36" AT FULL SIZE	
SITE ID: BZZ000.0	SHEET 04 OF 17

SITE REFERENCE NOTE:
EXISTING SITE CONDITIONS TAKEN FROM AS BUILT SITE PLAN AND COMPRESSOR / GAURD HOUSE / PUMP / HOUSE POWER FLOOR PLANS DATED 04-28-95



THESE JERSEY BARRIERS
TO BE REMOVED

THESE JERSEY BARRIERS TO
STAY IN CURRENT LOCATION

COMPRESSOR
ROOM
NO DETECTOR

77

78

DEWALK
NO T
ONLY