

March 15th, 2022

Melanie Bachman, Esq.
Executive Director
Connecticut Siting Council
10 Franklin Square
New Britain, CT 06051

RE: PETITION NO. 1479 - Bloom Energy Corporation petition for a declaratory ruling, pursuant to Connecticut General Statutes §4-176 and §16-50k, for the proposed construction, maintenance and operation of a customer-side 1.5-megawatt fuel cell facility and associated equipment to be located at the NBC Sports Group building, 1 Blachley Road, Stamford, Connecticut

Dear Attorney Bachman:

On March 10th, 2022, the Connecticut Siting Council (“Council”) approved by declaratory ruling a proposed Bloom Energy Corporation (“Bloom”) fuel cell facility (the “Facility”) at the NBC Sports Group building, 1 Blachley Road, Stamford, **Connecticut** (the “Site”).

During an on-site meeting with Bloom and the Utility (Eversource), Eversource rejected the use of a guard rail as protection around the gas meter location only. They are requesting that we utilize 6-inch bollards, placed every 3 feet, to protect from all traffic directions. Attached please find our updated site plan, highlighting this change. We are respectfully requesting the Council’s review and approval of this change.

Should you have any questions, concerns, or require additional information, please contact me at (917) 803-4511. Thank you.

Sincerely,
Bloom Energy



Kristen Grillo
Senior Permitting Specialist
kristen.grillo@bloomenergy.com
(917) 803-4511



GENERAL NOTES

- CLEAN AND PRIME ALL NEW WALL MOUNTED PIPING AND CONDUIT. PIPING AND CONDUIT SHALL BE PAINTED WITH EXTERIOR GRADE PAINT TO MATCH EXISTING.
- CONDUITS AND PIPES MOUNTED TO BUILDING WALL SHALL BE SUPPORTED AS PER LOCAL CODE, RUN AT HEIGHT ABOVE DOORWAYS, AND STAND OFF WALL TO AVOID EXISTING CONDUITS AND PIPES.
- SEE BLOOM ENERGY PRODUCT INSTALLATION DRAWINGS FOR UTILITY CONNECTIONS TO ANCILLARY EQUIPMENT AND ENERGY SERVER.
- ALL PULL BOXES AND VAULTS REQUIRED ARE NOT SHOWN. CONTRACTOR SHALL PROVIDE PULL BOX OR VAULT FOR CONDUIT RUNS WITH MORE THAN 360-DEG BENDS OR OTHERWISE REQUIRED PER CABLE PULLING TENSION OR SIDEWALL PRESSURE LIMITATIONS. CONTRACTOR SHALL SIZE PULL BOX OR VAULT IN COMPLIANCE WITH NEC REQUIREMENTS.
- ALL EXISTING FEATURES SHALL REMAIN AND PROTECTED THROUGHOUT THE CONSTRUCTION, UNLESS OTHERWISE NOTED ON PLAN.
- ALL THE ABOVE FROST LINE SECTIONS OF WATER PIPES SHALL HAVE POWERED HEAT TRACE AND INSULATION, ENSURE UNDERGROUND WATER DEPTHS ARE BELOW FROST LINE.

REFERENCE SHEET NOTES

- NEW UTILITY PROVIDED AND INSTALLED GAS METER & REGULATOR ASSEMBLY WITH SHUT-OFF VALVE. CONTRACTOR SHALL PROVIDE PAD PER DETAILS AS REQUIRED BY UTILITY COMPANY. COORDINATE ALL CONNECTIONS WITH GAS UTILITY.
- NEW UNDERGROUND GAS SERVICE TAP BY UTILITY COMPANY. COORDINATE WITH GAS UTILITY. CONTRACTOR SHALL PERFORM COMPACTION AND SURFACE RESTORATION, MATCH EXISTING SURFACE AND GRADE. CONTRACTOR SHALL COORDINATE GAS PIPE SIZING AND INSTALLATION REQUIREMENTS WITH UTILITY.
- NEW GAS PIPE, DOWNSTREAM OF METER TO ENERGY SERVERS, SHALL BE FURNISHED AND INSTALLED BY THE CONTRACTOR. REFER TO GAS RISER DETAIL FOR ADDITIONAL REQUIREMENTS.
- TAP EXISTING WATER LINE AT NEAREST ACCESSIBLE LOCATION IN BUILDING AS SHOWN WITH A LOCAL SHUT-OFF VALVE. REFER TO DOMESTIC WATER CONNECTION DETAIL FOR ADDITIONAL REQUIREMENTS.
- NEW WATER PIPE SHALL BE FURNISHED AND INSTALLED BY THE CONTRACTOR. REFER TO WATER RISER CONNECTION DETAIL FOR ADDITIONAL REQUIREMENTS.
- EXISTING UTILITY ELECTRIC METER. REFER TO ELECTRICAL SINGLE LINE DIAGRAM FOR ADDITIONAL REQUIREMENTS.
- NEW BLOOM ENERGY FURNISHED, CONTRACTOR INSTALLED, DISCONNECT SWITCH. MOUNT TO PAD/WALL PER MANUFACTURER AND UTILITY SPECIFICATIONS.
- CONTRACTOR SHALL TERMINATE ELECTRIC FEEDER AS SHOWN. REFER TO ELECTRICAL SINGLE LINE DIAGRAM FOR ADDITIONAL REQUIREMENTS.
- NEW ELECTRICAL FEEDER SHALL BE FURNISHED AND INSTALLED BY THE CONTRACTOR. REFER TO ELECTRICAL SINGLE LINE DIAGRAM FOR ADDITIONAL REQUIREMENTS.
- MOUNT NEW CONDUIT/PIPE TO EXTERIOR/INTERIOR WALL. COORDINATE EXACT ROUTING WITH CUSTOMER REPRESENTATIVE IN THE FIELD. REFER TO WALL MOUNTING DETAIL FOR ADDITIONAL REQUIREMENTS.
- BLOOM FURNISHED, CONTRACTOR INSTALLED SKID-MOUNTED BLOOM ENERGY SERVER.
- FACTORY WIRED BLOOM ENERGY SERVER EMERGENCY POWER-OFF SWITCH (EPO).
- CONTRACTOR SHALL CORE CONDUIT AND/OR PIPE THROUGH WALL. SCAN WALL PRIOR TO CORING TO AVOID COLLATERAL DAMAGE TO EXISTING PLUMBING AND WIRING. REFER TO WALL PENETRATION DETAIL FOR ADDITIONAL REQUIREMENTS.
- CONTRACTOR SHALL PROVIDE SAWCUT TRENCH FOR UNDERGROUND UTILITIES IN THIS LOCATION AND HAND DIG TRENCHES WHERE THEY CROSS EXISTING UTILITIES. REFER TO UNDERGROUND/TRENCH CONDUIT AND PIPING DETAIL FOR ADDITIONAL REQUIREMENTS.
- PROTECT EXISTING UNDERGROUND UTILITY LINES FROM DAMAGE WHEN CROSSING WITH NEW UNDERGROUND UTILITIES. CONTRACTOR SHALL BE RESPONSIBLE FOR REPAIR OR REPLACEMENT OF ANY DAMAGED LINES.
- CONTRACTOR SHALL TRANSITION ALL ABOVEGROUND NEW LINES TO UNDERGROUND TOWARD ANCILLARY EQUIPMENT. ABOVE GROUND UTILITIES SHALL BE PROTECTED AS NECESSARY, THEN ROUTED UNDERGROUND TO EQUIPMENT STUB-UP LOCATIONS PER MECHANICAL DETAIL.
- PROVIDE "DANDY SACK" OR EQUAL WITH OUTFLOW PORTS AT STORM DRAIN INLET. REFER TO EROSION CONTROL DETAIL FOR ADDITIONAL REQUIREMENTS.
- MINIMUM WORKING SPACE CLEARANCE OF 4' TO BE MAINTAINED IN FRONT OF SW-PS3 AND SW-PS4.

EXISTING UTILITY NOTE:
THE LOCATION OF EXISTING UTILITIES IS SHOWN FOR THE CONTRACTOR'S REFERENCE. EXACT LOCATION, DEPTH AND SIZE OF ALL EXISTING UTILITIES IS NOT KNOWN. CONTRACTOR SHALL ASSUME RESPONSIBILITY FOR ALL EXISTING UTILITIES NOT SHOWN ON THESE DRAWINGS. CONTRACTOR TO FIELD VERIFY LOCATION OF EXISTING UNDERGROUND UTILITIES AND PROTECT THE EXISTING UNDERGROUND UTILITIES FROM DAMAGE WHEN CROSSING WITH NEW UNDERGROUND UTILITIES. CONTRACTOR SHALL BE RESPONSIBLE FOR REPAIR OR REPLACEMENT OF ANY DAMAGED LINES. THE CONTRACTOR SHALL NOTIFY THE ENGINEER IMMEDIATELY IF ANY FIELD CONDITIONS ENCOUNTERED DIFFER FROM THOSE REPRESENTED HEREON. SUCH CONDITIONS COULD RENDER THE DESIGN HEREON INAPPROPRIATE AND MAY REQUIRE ADJUSTMENTS TO AVOID CONFLICTS.

REVISION HISTORY

REV	REVISION ISSUE	DATE
-	INITIAL RELEASE	03/10/2022

DESIGNED BY KATE TAYLOR	REVIEWED BY CARSON TURNER
DRAWN BY THARA SRINIVASACHARI	APPROVED BY CARSON TURNER

SHEET TITLE

DETAILED
SITE PLAN

DRAWING NUMBER

C1.1

BLOOM DOCUMENT

DOC-1014147

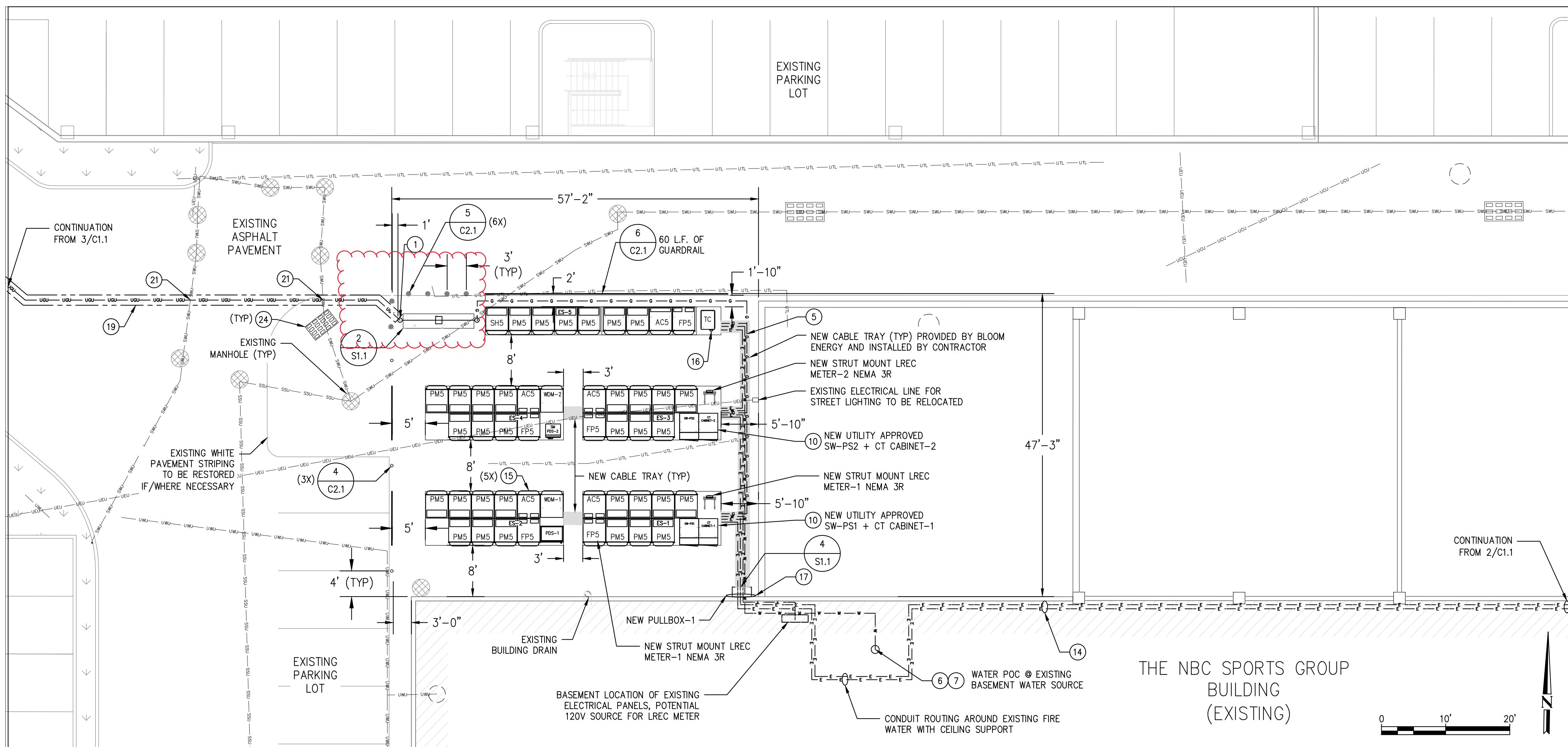

DETAILED SITE PLAN

SCALE: 1" = 10'

1
C1.1

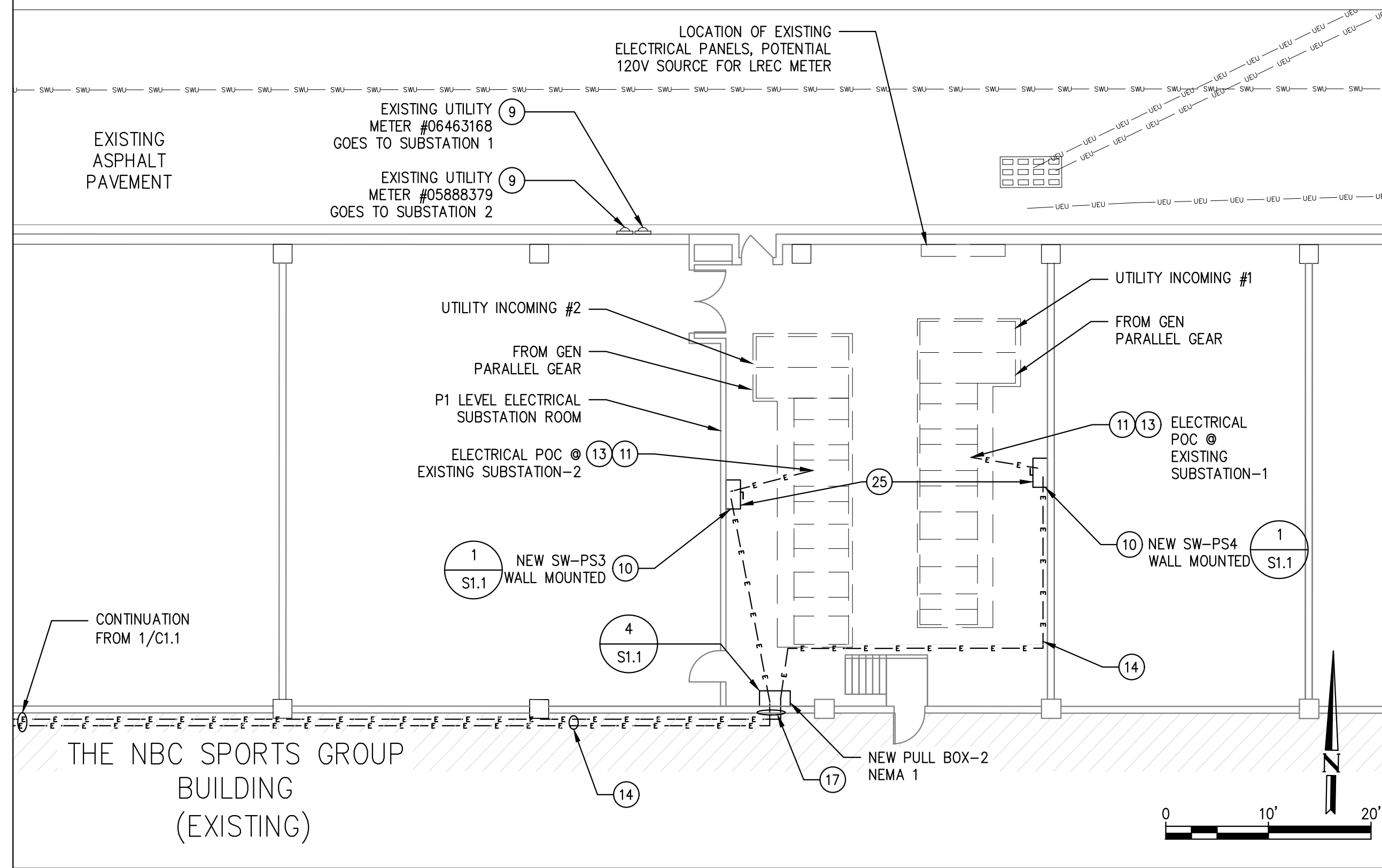

DETAILED SITE PLAN

SCALE: 1" = 10'

2
C1.1

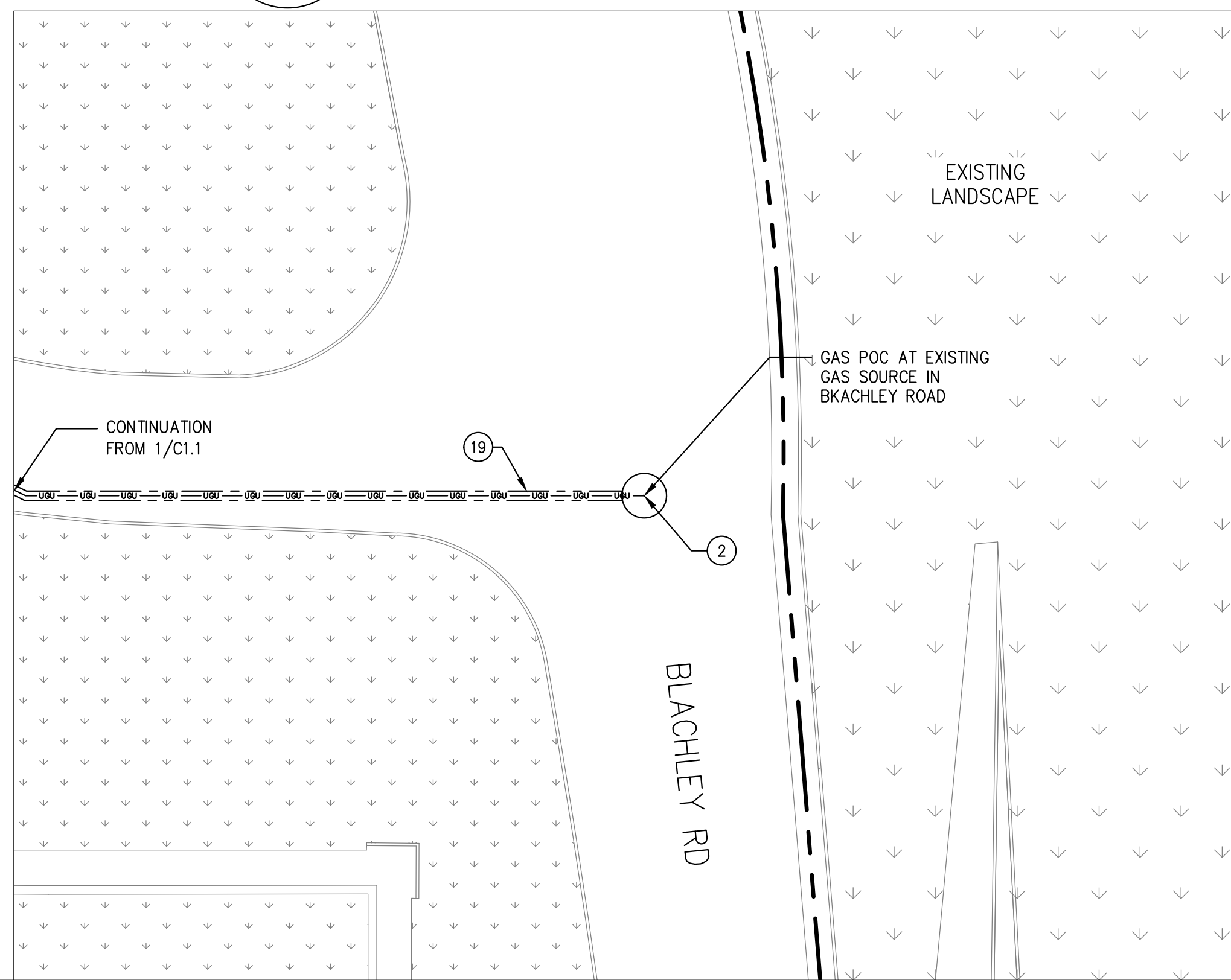

DETAILED SITE PLAN

SCALE: 1" = 20'

3
C1.1