

December 2, 2021

Melanie Bachman, Esq.  
Executive Director  
Connecticut Siting Council  
Ten Franklin Square  
New Britain, CT 06051

Re: **PETITION NO. 1454** - The Connecticut Light and Power Company d/b/a Eversource Energy petition for a declaratory ruling, pursuant to Connecticut General Statutes §4-176 and §16-50k, for the proposed modifications to its existing Mansfield Substation located at 140 North Eagleville Road, Mansfield, Connecticut and related transmission line structure improvements – **Planting Plan**.

Dear Ms. Bachman,

On July 29, 2021 the Connecticut Siting Council (“Council”) considered and ruled that the above-referenced project would not have a substantial adverse environmental effect, and pursuant to Connecticut General Statutes § 16-50k, would not require a Certificate of Environmental Compatibility and Public Need. Condition #2 of the Council’s ruling required that Eversource Energy (“Eversource”) submit the final planting plan for the staging/laydown areas off of North Eagleville Road to the Council.

- Eversource respectfully submits the attached planting plan (“Plan”) in response to the Council’s directive. The Plan was developed with the University of Connecticut.

Should you have any questions regarding this submission, please do not hesitate to contact me via e-mail at [kathleen.shanley@eversource.com](mailto:kathleen.shanley@eversource.com) or telephone at (860) 728-4527.

Sincerely,



Kathleen M. Shanley  
Manager – Transmission Siting

Enclosure



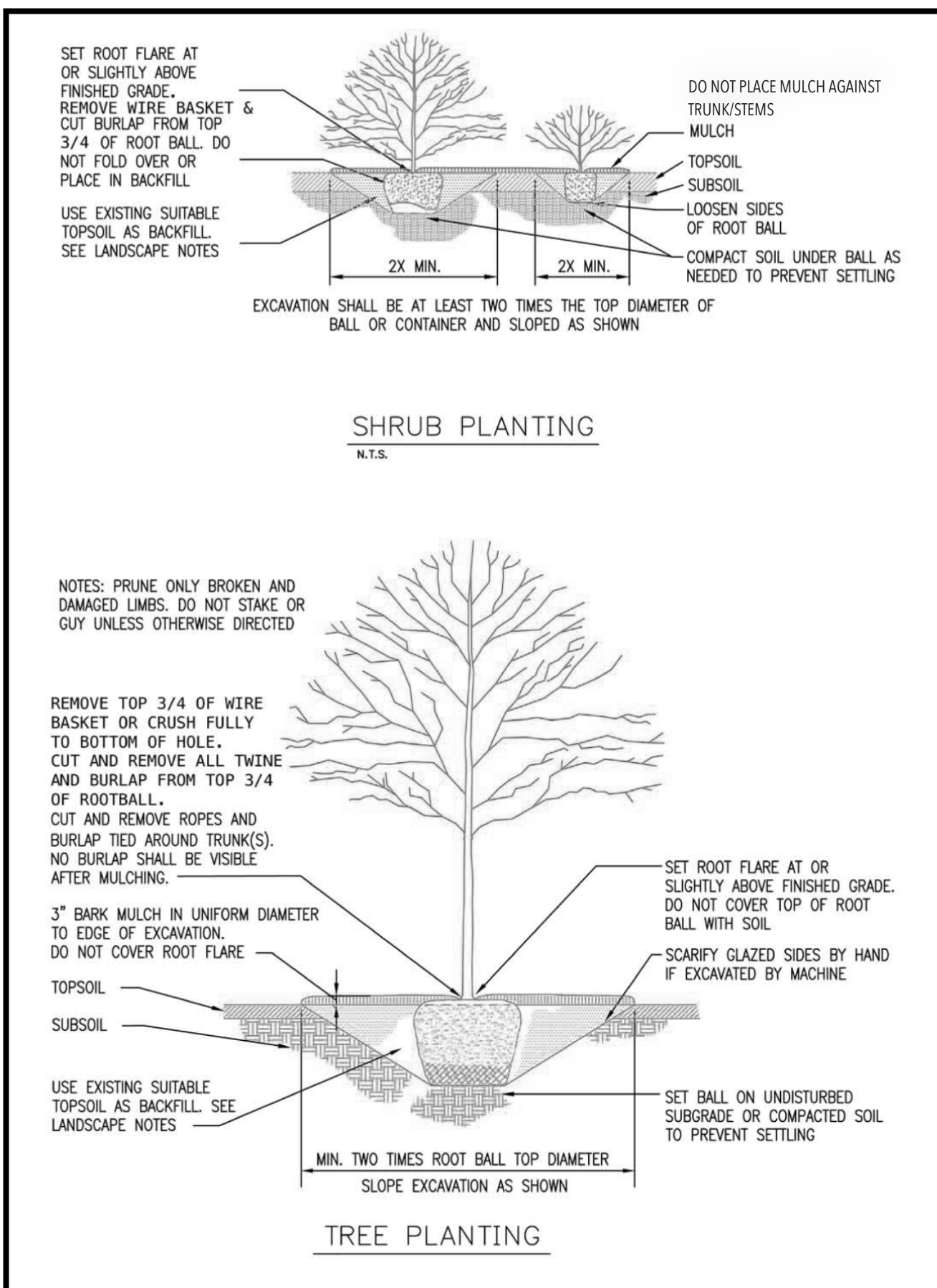
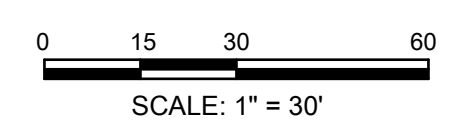
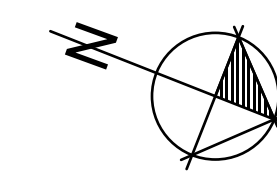
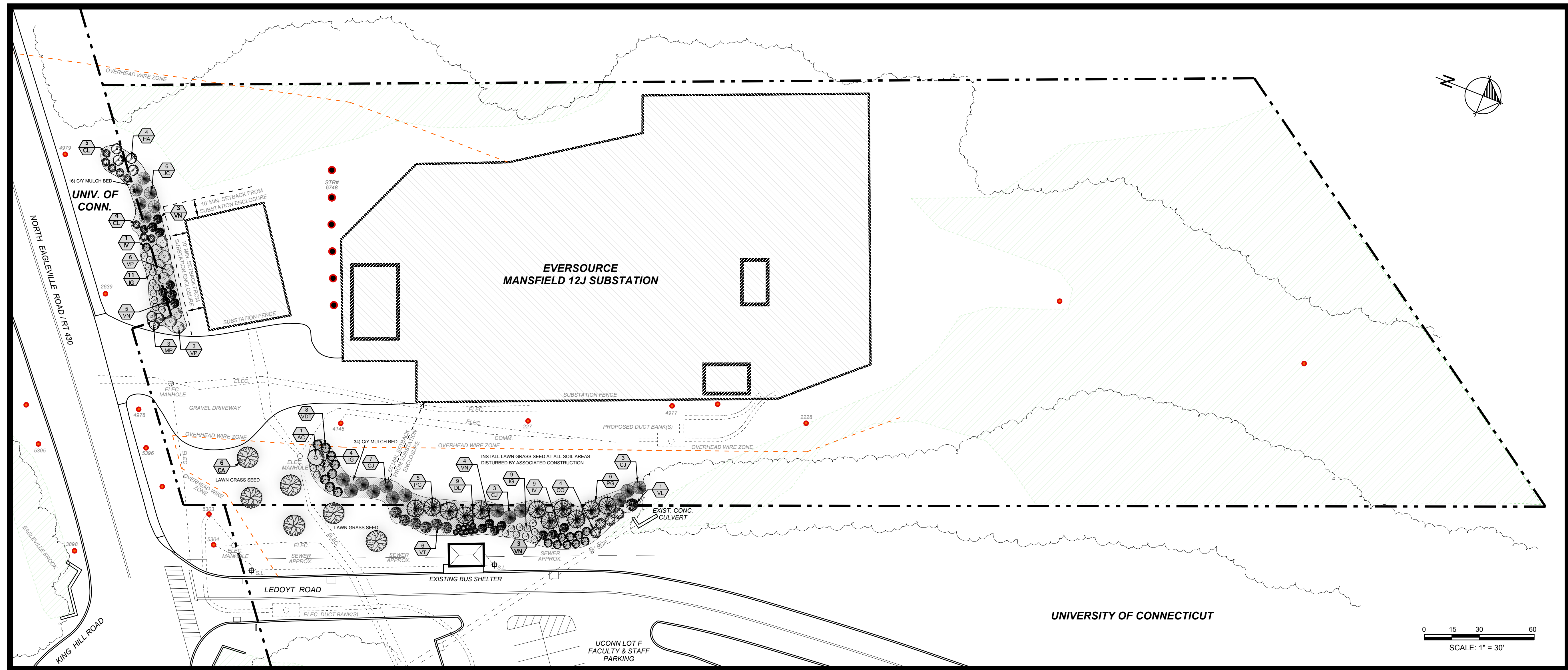

**NOTE:** Eversource Designer may approve changes to plant types or sizes based upon availability. Proposed plant locations shown are approximate and may vary based upon site and utility conditions. Boundary lines and existing conditions shown are approximate. All dimensions are subject to verification in field by Contractor(s). Not a survey.

After the expiration of any warranty or maintenance period listed hereunder or on associated project contract documents, all plant watering, care, maintenance, protection from animals, and weed control are the sole responsibilities of the Property Owner.

**LANDSCAPING NOTES**

- Contractor shall obtain CBYD ticket(s) to verify locations of all underground utilities prior to start of work, and shall excavate with caution and within all CBYD guidelines. This plan is not to be considered a reference for any utility locations.
- Proposed planting locations shown are subject to adjustments due to site conditions.
- All plants shall be legibly tagged for scientific name upon delivery to site.
- All plants shall be in accordance with the American Standard for Nursery Stock, ANSI Z60.1 latest edition and shall be free of disease, insects, girdling roots, and bark damage. All plants shall be heavily branched, and evergreens shall be densely foliated. All plants are subject to inspection and approval by the Eversource Designer. Plants specified by height shall be measured from the top of the root ball (or top of roots in the container) to the top of plant.
- Mulch for all proposed plants shall be shredded natural mulch, brown in color (consult UCONN representative for mulch specification where mulch is applied on UCONN property) applied at minimum 3" thickness under each plant, and not applied against the main stem(s). Unless mulched beds are indicated, mulch shall be installed as an individual mulch ring around each plant. Only where plant spacing results in a mulch ring being less than 20 inches from another mulch ring will the area between those plants be mulched to produce a continuous mulched planting bed. Clean wood chips may be used as mulch only when approved by Eversource Designer. No landscape fabrics, weed mat, or geotextiles will be installed under this Plan unless specifically noted.
- Substitutions: No plant substitutions may be made by the Contractor without prior approval by the Eversource Designer.
- During construction, all above ground nursery stock on-site shall be thoroughly watered every week day. All plants shall be thoroughly watered by the Contractor initially after planting, and shall be thoroughly watered afterwards by the Contractor on a once-weekly basis for 18 months following installation, not to include the period between November 15 and June 1. It is the Contractor's sole responsibility to supply all necessary water, tanks, hoses, pumps, labor, and transportation.
- Existing planting pit soil shall be used as planting backfill unless otherwise specified on the Plan. Rocks over 2", roots, sod, wood chips, or any debris shall not be included in the planting backfill. Should supplemental topsoil be required, it is the planting Contractor's responsibility to provide and install clean, screened topsoil as necessary.
- Contractor shall observe correct planting depth. All plant root flares shall be exposed by carefully removing excess soil, and the root flares shall be placed level with, or slightly above the adjacent finish grade level.
- Contractor shall supply all plants, labor, and materials in quantities sufficient to complete the work shown on the Plan and Schedule(s).
- Contractor shall restore all bare lawn areas, and lawn ruts and/or lawn damage caused during associated planting and/or mitigation activities, using clean screened topsoil, lawn grass seed as specified hereunder, and seed establishment mulch as necessary.
- Lawn grass seed mixture installed on University of Connecticut property shall consist of 40% Kentucky Bluegrass, 30% Creeping Red fescue, 30% Perennial Ryegrass, with all grass seed cultivars to be Turfgrass Water Conservation Alliance (TCWA) qualified. Seed not installed by hydroseeding equipment shall be properly incorporated into prepared soil surface by raking seed 1/8" min. depth into soil, and shall be lightly covered with chopped straw mulch.
- Lawn grass seed mixture installed on Eversource substation property shall consist of Perennial Ryegrass/Turf Type Tall Fescue/Fine Fescue. Seed not installed by hydroseeding equipment shall be properly incorporated into prepared soil surface by raking seed 1/8" min. depth into soil, and shall be lightly covered with chopped straw mulch.
- Contractor is responsible to establish and maintain all lawn grass seeded areas under this plan for a period of 60 days from installation or upon acceptance of the Owner(s).
- All new plants installed on this plan shall be under a replacement warranty provided by the Contractor for a period of eighteen (18) months following the date of final acceptance by Owner(s). The Contractor shall remove and replace, at no expense to the Owner(s), any plants that are dead or visibly unhealthy within the first eighteen (18) months, with the same plant(s) as originally specified under this plan.

PROPOSED PLANT SCHEDULE FOR INSTALLATION					
KEY	QUANTITY	SCIENTIFIC NAME	COMMON NAME	SIZE AT INSTALLATION	HEIGHT AT MATURITY
AC	1	<i>Amelanchier canadensis</i>	Shadblow Serviceberry	8' - 9' clump	15'
CA	6	<i>Cornus x 'Aurora'</i>	Aurora Hybrid Dogwood	2.5 - 3" cal	25'
CJ	13	<i>Cryptomeria japonica 'Yoshino'</i>	Yoshino Japanese Cryptomeria	8' - 10'	50'
CL	9	<i>Clethra alnifolia</i>	Summersweet	10 gal	8'
CO	4	<i>Cephalanthus occidentalis</i>	Buttonbush	5 gal	10'
DL	9	<i>Diervilla 'Kodiak Orange'</i>	Kodiak Orange Bush Honeysuckle	5 gal	3'
HA	4	<i>Hamamelis x inter. 'Arnold Promise'</i>	Arnold Promise Witchhazel	6' - 7'	12'
IG	24	<i>Ilex glabra</i>	Inkberry	10 gal	6'
IV	10	<i>Ilex verticillata 'Red Sprite'</i>	Red Sprite Winterberry	10 gal	5'
JC	6	<i>Juniperus chinensis 'Blue Point'</i>	Blue Point Chinese Juniper	6' - 7'	15'
MP	3	<i>Myrica pensylvanica</i>	Northern Bayberry	10 gal	10'
PG	11	<i>Picea glauca 'Densata'</i>	Black Hills (White) Spruce	8' - 10'	40'
VDT	8	<i>Viburnum dentatum</i>	Arowwood Viburnum	4' - 5'	10'
VL	1	<i>Viburnum lentago</i>	Nannyberry	4' - 5'	25'
VN	15	<i>Viburnum nudum</i>	Smooth Witherod	4' - 5'	10'
VP	9	<i>Viburnum 'Pragens'</i>	Prague Viburnum	4' - 5'	10'
VT	6	<i>Viburnum trilobum</i>	Cranberrybush Viburnum	4' - 5'	10'
LANDSCAPE WORK & MATERIALS SCHEDULE					
	50	C/Y bark mulch installed at planting beds. (Consult UCONN for mulch specification.)			
Finish-grade & rake all soil disturbed by associated construction, install lawn grass seed as-specified.					

PROPOSED PLANT SCHEDULE FOR SUPPLY AND DELIVERY ONLY			
QUANTITY	SCIENTIFIC NAME	COMMON NAME	SIZE AT DELIVERY
1	<i>Aesculus flava</i>	Yellow Buckeye	1.5" - 2" cal
1	<i>Aesculus x carnea 'Briotii' or 'Fort McNair'</i>	Red Horsechestnut	1.5" - 2" cal
1	<i>Carya ovata</i>	Shagbark Hickory	2.5" - 3" cal
1	<i>Chamaecyparis thyoides</i>	Atlantic Whitecedar	8' - 10'
1	<i>Corylus colurna</i>	Turkish Hazelnut	1.5" - 2" cal
1	<i>Heptacodium miconioides</i>	Seven-Son Flower	6' - 7'
1	<i>Maackia amurensis</i>	Amur Maackia	2.5" - 3" cal
1	<i>Pinus cembra</i>	Swiss Stone Pine	6' - 7'
1	<i>Quercus bicolor</i>	Swamp White Oak	3" - 3.5" cal

Contractor shall source, supply and deliver the plants listed in this schedule to UCONN between the dates of 4/15/2024 and 5/15/2024, and shall consult UCONN representative for coordination, location and instructions for delivery to the UCONN Depot Campus, Mansfield, CT (not shown on this Plan). Contractor shall be responsible for all delivery arrangements and communications with UCONN regarding all freight for plants shown in this schedule when delivered by the Contractor, common carrier, or plant supplier/plant supplier's agent.

At delivery to UCONN, all plants shall be in accordance with the American Standard for Nursery Stock, ANSI Z60.1 latest edition and shall be free of disease, insects, girdling roots, and bark damage. All plants shall be heavily branched, and evergreens shall be densely foliated.

The plants listed in this schedule (or any necessary substitutions) do not include plant installation, watering, maintenance, or warranty. All plants are subject to availability.

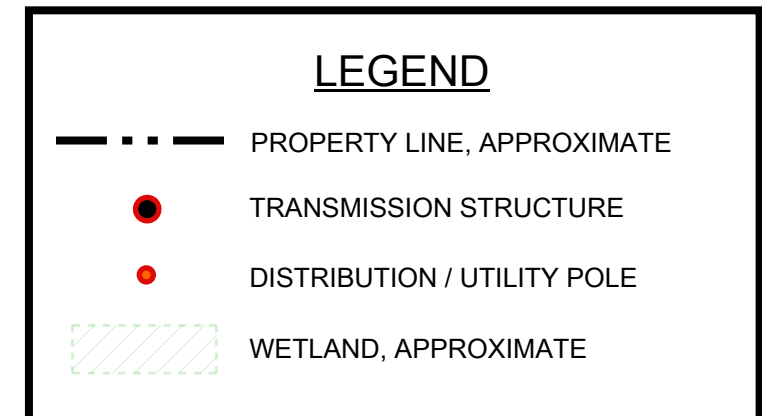

**CAUTION:** ENERGIZED OVERHEAD CONDUCTORS.  
**CAUTION:** UNDERGROUND CONDUITS WITH ENERGIZED CONDUCTORS.  
ALL WORK MUST BE PERFORMED WITH CAUTION. CONSULT CBYD, EVERSOURCE ENGINEERING, AND UCONN ENGINEERING TO VERIFY ALL UTILITY LOCATIONS. THIS PLAN IS NOT TO BE CONSIDERED AS A REFERENCE FOR ANY UTILITY LOCATIONS.

BURNS & MCDONNELL

**EVERSOURCE ENERGY**

**PLANTING PLAN**  
EVERSOURCE MANSFIELD 12J SUBSTATION  
AND  
UNIVERSITY OF CONNECTICUT LOT F ENTRANCE  
164 NORTH EAGLEVILLE ROAD, MANSFIELD, CONNECTICUT

BY	GGG	CHKD	APP	APP
DATE	11/4/2021	DATE	DATE	DATE
SCALE	1" = 30'		SIZE	ARCH - D 24X36
PROJ.	MANSFIELD SUBSTATION EXPANSION		DRAWING NO.	REVISION 4