

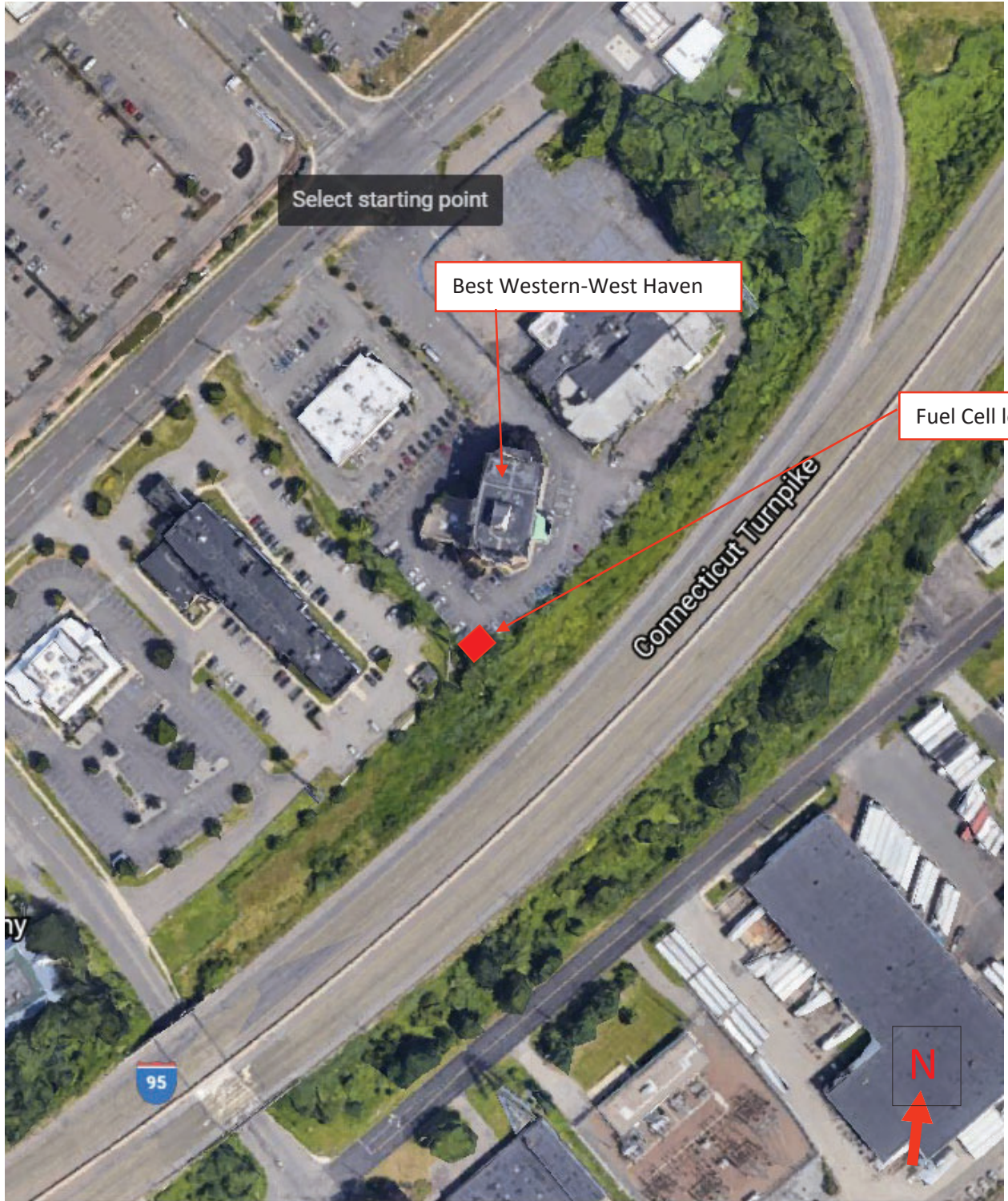

Attachment #1: Fuel Cell Site Location: Aerial Photos and a Class A-2 Certified Survey

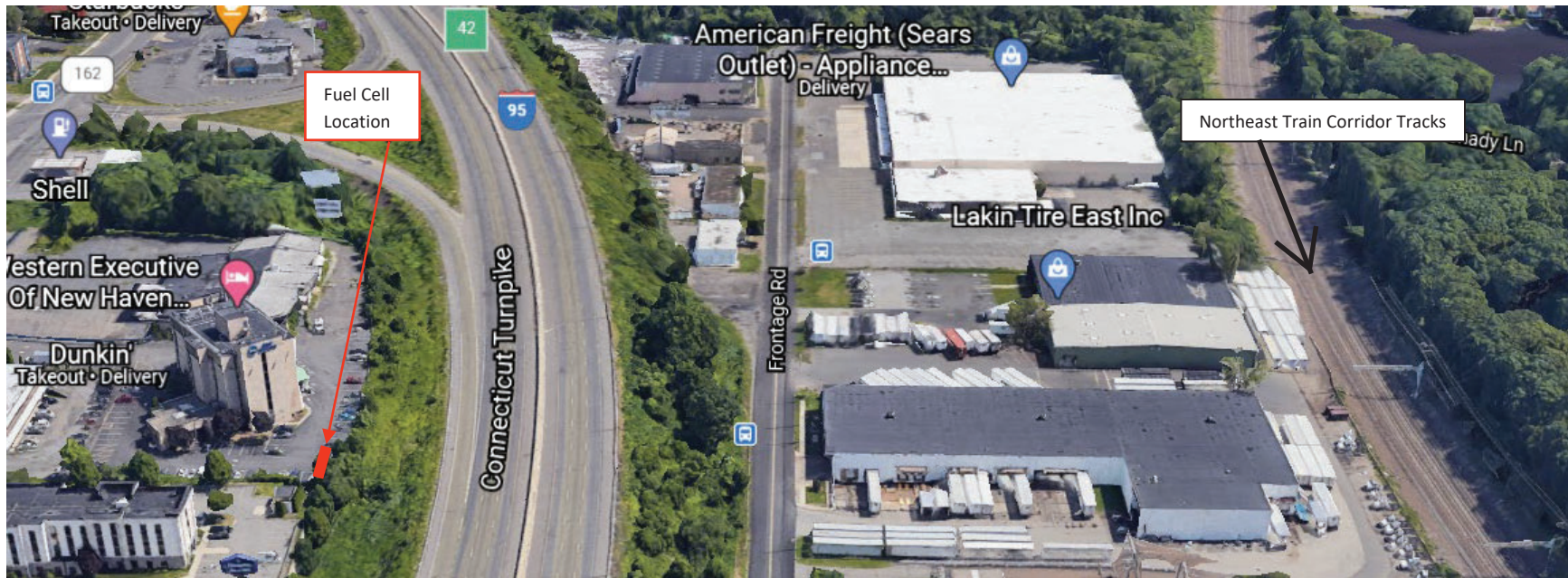

Arial View of Fuel Cell location-490 Saw Mill Road, West Haven, CT



North View of Fuel Cell site

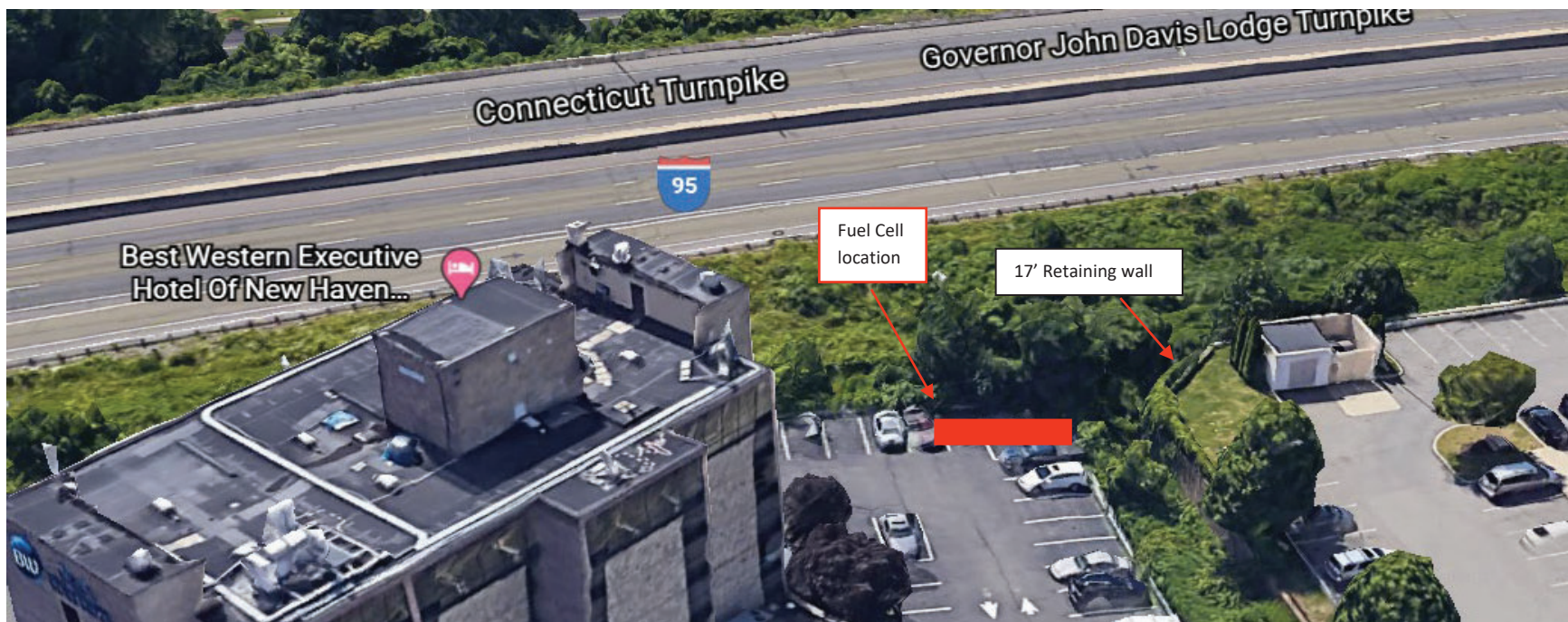

East View of Fuel Cell Site



Fuel Cell Location

View South towards Fuel Cell

STANDARD	MINIMUM/REQUIRED/ MAXIMUM ALLOWED	EXISTING CONDITIONS	PROPOSED CONDITIONS
Minimum Lot Area	20000 SF	625074	
Minimum Lot Area Per Unit	16000 SF	625074	
Minimum Street Frontage	100'	100.0'	
Number of Dwelling Unit Per Lot	N/A	625074	
Minimum Setback From Street Line	50'	41.8'	
Min. Setback From One Side Property Line	25'	18.6' / 54.7'	SAME
Minimum Setback From Rear Property Line	50'	44.9'	
Minimum Rear Inner Yard	N/A	N/A	
Maximum Height for a Building or Structure	4-6 STORY & 45'-75'	7 STORY & 80'	
Minimum Open Space	10%	16%	15.7%
Maximum Building Coverage on a Percentage of Lot Area	60%	17.0%	17.0%
Maximum Lot Coverage	95%	84%	84.3%

BUILDING ZONE: C2 ASSESSOR'S MAP & LOT NO. # 033-0014

EXISTING PARKING SPACE = 84 (INCLUDING 3 HANDICAP PARKING SPACES)

PROPOSED PARKING SPACE = 89 (INCLUDING 3 HANDICAP PARKING SPACES)

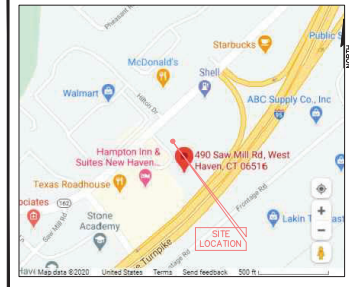
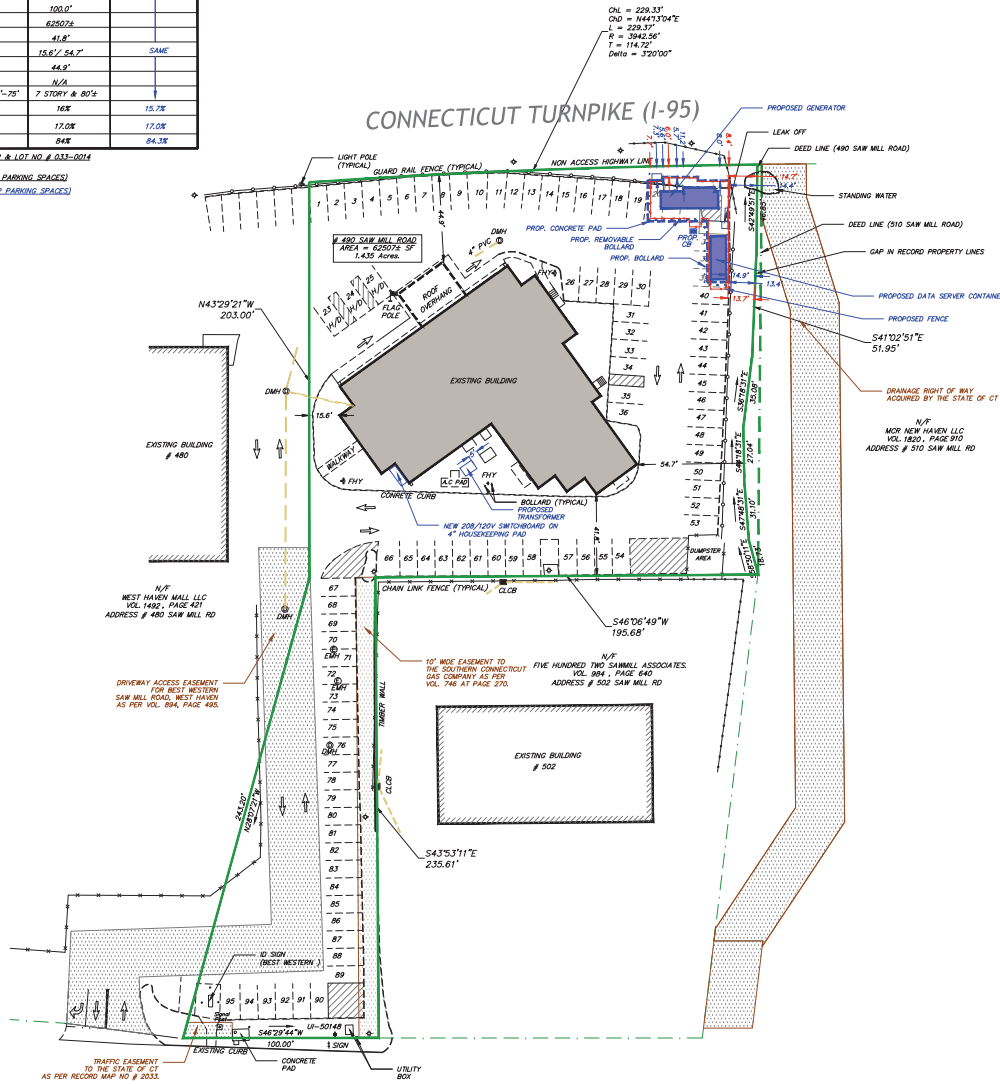

LOCATION MAP  
NOT TO SCALE

**SURVEY NOTES**

- This Map was prepared pursuant to the Resolution of Connecticut State Agencies Section 20-300a-1 through 20-300a-20 and the Standards for Surveys and Maps in the State of Connecticut as adopted by the Connecticut Association of Land Surveyors, Inc. on Sept. 26, 1996.
- This Survey conforms to Class A-2.
- The Type of survey performed is a Limited Property / Boundary Survey, and is intended to be improvement Location Survey.
- Boundary determination is based upon a Dependent Survey (see MAP REFERENCES and Record Deeds.)
- North Arrow is based on Map Reference # 1.
- This map is NOT VALID without a LIVE SIGNATURE and EMBOSSED SEAL.
- This map is NOT VALID if altered or used by any party other than the one depicted in the title block of this map.
- Property Lines Established According to Record Deeds as exist.
- Physical Features Such as Stone Walls, Wire Fences, Monumental Iron Pins or Pipes, Etc. taken under consideration to establish current deed lines.
- Underground (UTG) Structure and Facility Locations depicted and noted herein have been compiled in part, from record mapping supplied by the respective utility companies or government agencies, from parcel testimony and from other sources. These Locations must be considered as approximate in nature. Additionally, other such features may exist on the site, the existence of which are unknown to this firm. The size, location and existence of all such features must be field determined and verified by the appropriate authorities prior to construction. CALL BEFORE YOU DIG 1-800-922-4455.

**MAP REFERENCES**

- RECORD MAP NO. # 858
- RECORD MAP NO. # 2006
- RECORD MAP NO. # 2033
- RECORD MAP NO. # 1032
- CT DOT Right of Way Map Town of West Haven Saw Mill Road, Map no # 156-16, Sheet 1 of 2, Scale 1" = 40'
- CT DOT Right of Way Map Town of West Haven CT Turnpike, Map no # 156-15, Sheet 1 of 8, Scale 1" = 80'

**PROPERTY SUBJECT TO:**

- TOGETHER WITH BENEFITS AS CONTAINED IN APURTENNANT EASEMENT AS CONTAINED IN A DEED CLAIM DEED FROM VALLE'S STEAK HOUSE, INC. TO KOLA-WEST HAVEN ASSOCIATED LIMITED PARTNERSHIP DATED MAY 18, 1994 AND RECORDED IN VOL. 715 AT PAGE 424 OF WEST HAVEN RECORDS AS AMENDED BY INSTRUMENT DATED MARCH 16, 1995 AND RECORDED IN VOL. 730 AT PAGE 1116 OF SAID LAND RECORDS AS FURTHER AMENDED BY INSTRUMENT DATED SEPTEMBER 26, 1996 AND RECORDED IN VOL. 894 AT PAGE 495 OF SAID LAND RECORDS AS FURTHER AMENDED BY AGREEMENT BETWEEN AMU HOSPITALITY, INC. AND GRANTEE CAPITAL PARTNERS LLC AND DAVID S. ZWISLOCKMAN TRUSTS DATED JULY 26, 2008 AND RECORDED IN VOL. 1491, PAGE 5 OF WEST HAVEN LAND RECORDS, AND ASSIGNED TO WEST HAVEN MALL LLC BY ASSIGNMENT DATED AS SEPTEMBER 05, 2008 AND RECORDED IN VOL. 1492, PAGE 427 OF WEST HAVEN LAND RECORDS.
- SUCH FLOWAGE RIGHTS AS MAY EXIST IN FAVOR OF THE WEST HAVEN WATER COMPANY AS GRANTED IN DEED DATED JANUARY 12, 1929 AND RECORDED IN VOL. 47 AT PAGE 448 OF WEST HAVEN LAND RECORDS.
- CERTAIN PROVISIONS AND AGREEMENTS, PERTAINING TO DRAINAGE RIGHTS AND RIGHT OF ACCESS AS CONTAINED IN A DEED TO THE STATE OF CT DATED MARCH 21, 1957 AND RECORDED IN VOL. 391, PAGE 535.
- CERTAIN RIGHTS IN FAVOR OF THE STATE OF CT AS CONTAINED IN A CERTIFICATE OF CONDEMNATION DATED JULY 6, 1976 RECORDED IN VOL. 593, PAGE 674.
- EASEMENT IN FAVOR OF THE SOUTHERN CT GAS COMPANY DATED OCTOBER 11, 1965 AND RECORDED IN VOL. 746, PAGE 674.
- MEMORANDUM OF LEASE BY AND BETWEEN AMU HOSPITALITY INC. AND SPRINT SPECTRUM LP DATED SEPTEMBER 1, 1996 AND RECORDED IN VOL. 1031, PAGE 622.
- NOTICE OF MANAGEMENT AGREEMENT BY AND BETWEEN AMU HOSPITALITY, INC. AND MESSAGE CENTER MANAGEMENT INC. DATED OCTOBER 5, 2008 AND RECORDED IN VOL. 1137, PAGE 41.
- EASEMENT IN FAVOR OF THE STATE OF CT DATED NOVEMBER 20, 2009 AND RECORDED IN VOL. 1639, PAGE 124.
- EASEMENTS, RESTRICTIONS, RIGHTS AND ENCUMBRANCES AS OF RECORD APPEAR IN THE WEST HAVEN LAND RECORDS.

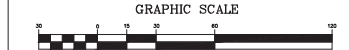

**IMPORTANT! READ!**  
WARNING AND DISCLAIMER OF LIABILITY  
UNDERGROUND UTILITIES

The user of this document is WARNED NOT TO RELY on the purported accuracy, scale, dimension, measurement, description, or existence of any underground structure. The Underground structures depicted herein are for informational purposes only. The Preparer of this document DISCLAIMS ANY LIABILITY whatsoever to the user. There are no warranties or representations, expressed or implied and any use other than for informational purposes is excessive, unintended and an impermissible misuse of this document. Before Excavating Call Toll Free 1-800-922-4455 for Underground Utility Information.

1 inch = 30' FL  
1" = 30'

NO DECLARATION IS EXPRESSED OR IMPLIED BY THIS MAP OR COPIES THEREOF UNLESS IT BEARS THE IMPRESSION TYPE SEAL AND ORIGINAL LIVE SIGNATURE OF THE SURVEYOR WHOSE NAME AND REGISTRATION NUMBER APPEAR BELOW. ANY CHANGES MADE TO THIS PLAN WITHOUT THE KNOWLEDGE OF THE SURVEYOR INVALIDATES THESE DECLARATIONS.

TO THE BEST OF MY KNOWLEDGE AND BELIEF THIS MAP IS SUBSTANTIALLY CORRECT AS DEPICTED AND NOTED HEREON.

JONESHAW & SONS, P.L.L.C. 70386



PREPARED FOR  
SABMILL HAVEN LLC  
490 SAW MILL ROAD  
WEST HAVEN, CT

DRAWN BY  
SABMILL HAVEN LLC  
490 SAW MILL ROAD  
WEST HAVEN, CT

NO.	DATE	DESCRIPTION
1	07/17/2020	PROPOSED GENERATOR
2		AS NOTED



CT LAND SURVEYING, LLC

58 OLD TAVERN ROAD  
ORANGE, CT 06477  
P: (203)503-1193  
FAX: (203)404-0411  
EMAIL: JONESHAW@LANDSURV.COM

IMPROVEMENT LOCATION SURVEY  
PREPARED FOR  
SABMILL HAVEN LLC  
490 SAW MILL ROAD,  
WEST HAVEN, CONNECTICUT

DRAWN: CAD  
APPROVED: J.S.  
SCALE: 1" = 30'  
PROJECT NO: 201204  
DATE: 12/25/2020  
CAD FILE: 201204

TITLE:  
IMPROVEMENT LOCATION SURVEY

SHEET NUMBER:  
EX-1 OF 1



Attachment #2: Doosan PureCell® Model 400 Data sheet Attachment



# PureCell® Model 400

## PURECELL SYSTEM BENEFITS

### Energy Security

Proven PAFC fuel cell technology that is setting durability records

### Energy Productivity

Increased efficiency and continuous on-site generation reduces energy costs

### Energy Responsibility

Ultra-low emissions equals sustainability

## PURECELL SYSTEM COMPETITIVE ADVANTAGES

### Long Life

Industry leading 10-year cell stack life assures high availability and low service cost

### Modular & Scalable

Solutions for multi-megawatt applications to meet growing energy demand

### Experience

Most knowledgeable and experienced team in the industry

### High Efficiency

Up to 90% total CHP Efficiency

### Grid-Independence

Proven performance delivering power when the utility grid fails

### Load Following

Capable of dispatching power to match building needs

### Small Footprint

Highest power density among clean generation technologies

### Flexible Siting

Indoor, outdoor, rooftop, multi-unit

## RATED POWER OUTPUT: 460KW, 480VAC, 50/60HZ

Characteristic	Units	Operating Mode	
		Power 460kW	Eco 440kW
Electric Power Output <sup>1</sup>	kW/kVA	460/532	440/518
Electrical Efficiency	%, LHV	43%	45%
Peak Overall Efficiency	%, LHV	90%	90%
Gas Consumption <sup>1</sup>	MMBtu/h, HHV (kW)	4.09 (1,200)	3.77 (1,104)
Gas Consumption <sup>1,2</sup>	SCFH (Nm <sup>3</sup> /h)	3,995 (107)	3,674 (98.4)
High Grade Heat Output @ up to 250°F <sup>1</sup>	MMBtu/h (kW)	0.72 (212)	0.55 (162)
Low Grade Heat Output @ up to 140°F <sup>1</sup>	MMBtu/h (kW)	1.03 (301)	1.00 (292)

## FUEL

Supply..... Natural Gas  
Inlet Pressure ..... 10 to 14 in. water (2.5 - 3.5 mbar)

## EMISSIONS<sup>3,4</sup>

NOx ..... 0.02 lbs/MWh (0.009 kg/MWh)  
CO ..... 0.01 lbs/MWh (0.005 kg/MWh)  
VOC ..... 0.01 lbs/MWh (0.005 kg/MWh)  
SO<sub>2</sub>..... Negligible  
Particulate Matter..... Negligible  
CO<sub>2</sub><sup>1</sup> (electric only) ..... 998 lbs/MWh (454 kg/MWh)  
(with High-Grade heat recovery) ..... 815 lbs/MWh<sup>5</sup> (371 kg/MWh)  
(with full heat recovery) ..... 485 lbs/MWh<sup>5</sup> (220 kg/MWh)

## OTHER

Ambient Operating Temp ..... -20°F to 104°F (-29°C to 40°C)  
Relative Humidity ..... 0 to 100%  
Sound Level ..... <65 dBA @ 33 ft. (10m)  
Water Consumption ..... None (up to 86°F (30°C) Ambient Temp.)  
Water Discharge ..... None (Normal Operating Conditions)

## CODES AND STANDARDS

ANSI/CSA FC1-2014: Stationary Fuel Cell Power Systems  
UL1741-2010: Inverters for Use With Distributed Energy Resources

### NOTES

1. Average performance during 1st year of operation.
2. Based on natural gas higher heating value of 1025 Btu/SCF (40.4 MJ/Nm<sup>3</sup>)
3. Emissions based on 440 kW operation.
4. Fuel cells are exempt from air permitting in many U.S. states.
5. Includes CO<sub>2</sub> emissions savings due to reduced on-site boiler gas consumption



**Doosan Fuel Cell America, Inc.**  
Corporate Headquarters  
195 Governor's Highway  
South Windsor, CT 06074  
860.727.2253  
www.doosanfuelcell.com

The manufacturer reserves the right to change or modify, without notice, the design or equipment specifications without incurring any obligation either with respect to equipment previously sold or in the process of construction. The manufacturer does not warrant the data on this document.

Copyright © 2018 by Doosan Fuel Cell America, Inc. All rights reserved. This document contains no technical information subject to U.S. Export Regulations. Rev. 6/2018

## SYSTEM DIMENSIONS

### Power Module

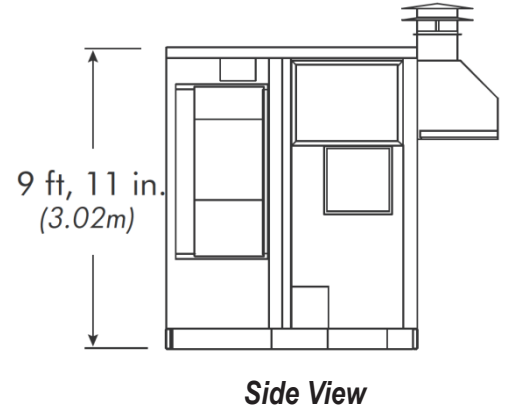
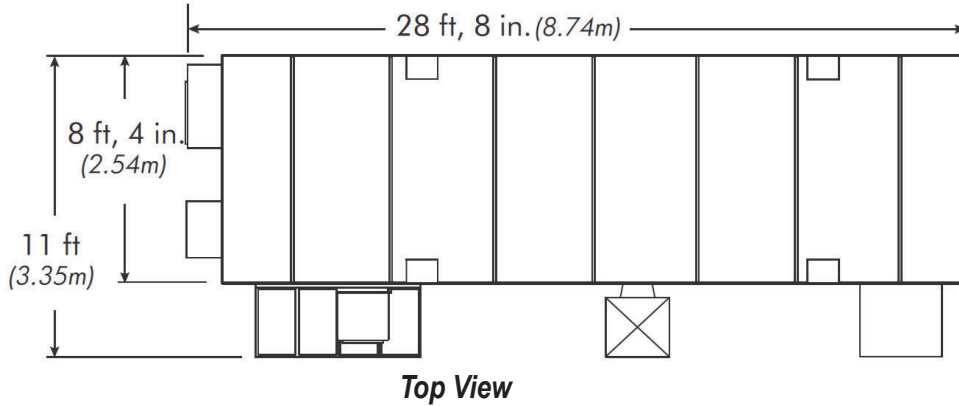

### Cooling Module

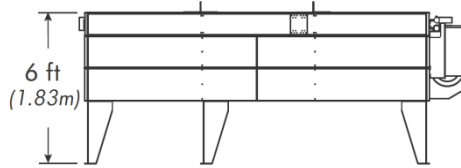
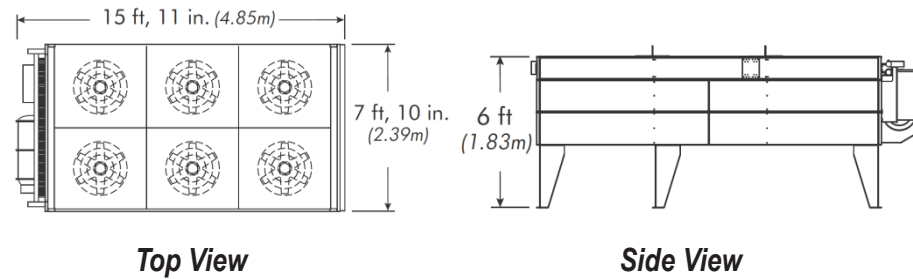

### PHYSICAL SPECIFICATIONS

	Power Module	Cooling Module
Length	28' 11" (8.74m)	15' 11" (4.85m)
Width	8' 4" (2.54m)	7' 10" (2.39m)
Height	9' 11" (3.02m)	6' 0" (1.83m)
Weight	57,000 lb (27,216 kg)	3,190lb (1,447 kg)

## PURECELL ADVANTAGE

### OFFSET 3x MORE CO<sub>2</sub>



### CAPACITY FACTOR

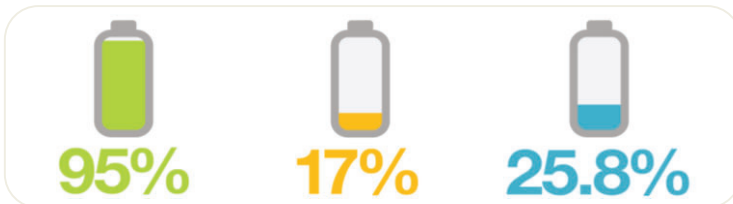

### CO<sub>2</sub> OFFSET



### USE LESS LAND

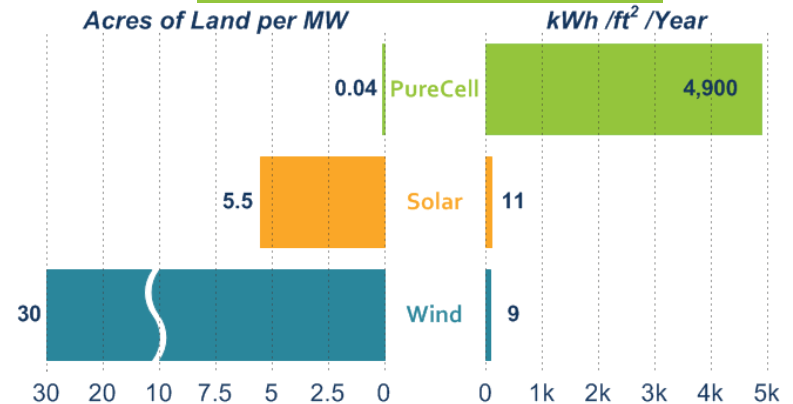

Doosan Fuel Cell America, Inc.  
Corporate Headquarters  
195 Governor's Highway  
South Windsor, CT 06074  
860.727.2253  
www.doosanfuelcell.com





Attachment #3: General Fuel Cell Arrangement Drawings

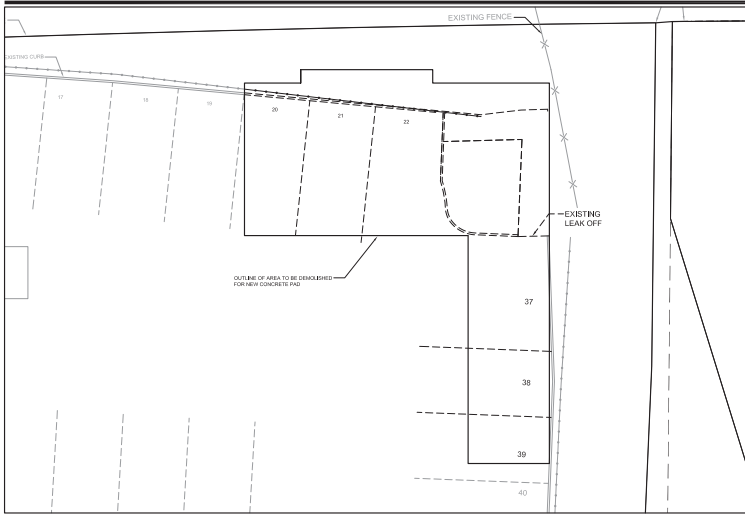

4 PARTIAL DEMO PLAN  
Scale: 1/8" = 1'-0"

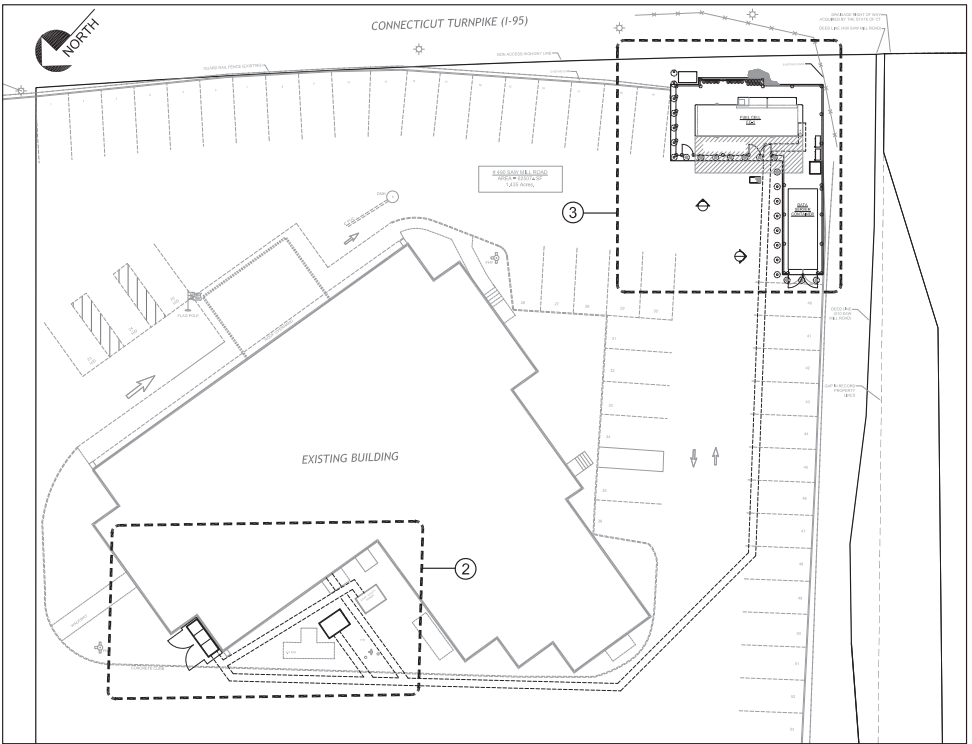

1 GENERAL ARRANGEMENT  
Scale: 3/16" = 1'-0"

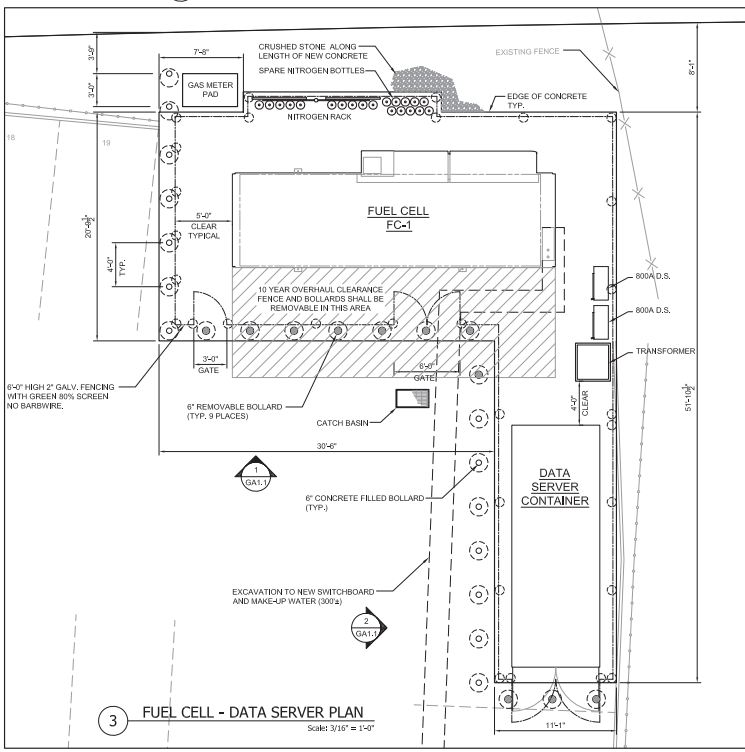

3 FUEL CELL - DATA SERVER PLAN  
Scale: 3/16" = 1'-0"

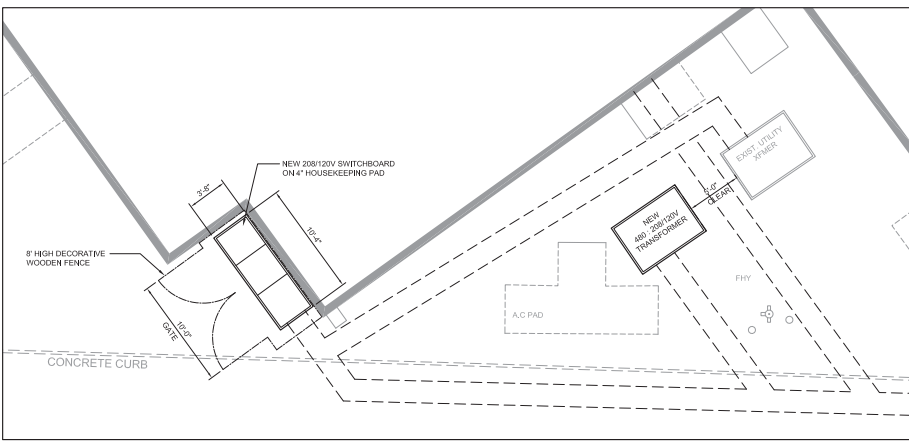

2 SWITCHBOARD AND TRANSFORMER PLAN  
Scale: 3/16" = 1'-0"

REFERENCE DRAWING:  
IMPROVEMENT LOCATION SURVEY DWG EL-10F-1  
BY CT LAND SURVEYING, LLC, DATED 01/11/2021

<p>4 USA Whittford Street Gallant, CT 06437 Phone: (203) 444-6600 Innovative Construction &amp; Design Solutions, LLC</p>	
<h1>ICDS</h1> <p>Innovative Construction &amp; Design Solutions, LLC</p>	
<p><b>CLEARCELL POWER, INC.</b> NATURAL GAS FUEL CELL GENERATOR BEST WESTERN 490 SAW MILL ROAD, WEST HAVEN, CT</p>	
<p><b>GENERAL ARRANGEMENT</b></p>	
Project No.:	Drawn By: KFH
Date: 01/18/21	Design By: KFH
Scale: AS NOTED	Check By: DSF
Drawing No.:	
<h1>GA1.0</h1>	





Attachment #4: United Illuminating Company's LREC contract

**Year 9**

**STANDARD CONTRACT FOR THE PURCHASE AND  
SALE OF CONNECTICUT CLASS I RENEWABLE  
ENERGY CREDITS**

**from**

**Low or Zero Emission Projects**

**by and between**

**The United Illuminating Company**

**and**

**Clearcell Power, Inc.**

**LL-09-24391**

**dated as of October 22, 2020**

**STANDARD CONTRACT FOR THE PURCHASE AND SALE OF  
CONNECTICUT CLASS I RENEWABLE ENERGY CREDITS**

**COVER SHEET**

This *Standard Contract for the Purchase and Sale of Connecticut Class I Renewable Energy Credits from Low and Zero Emission Projects* ("Agreement") in accordance with Conn. Gen. Stat. § 16-244(r) and 16-244(s), or 16-244(t) , as applicable, is entered into as of the following date: **October 22, 2020** (the "Effective Date"). This Agreement includes this Cover Sheet together with the appendices hereto. The Parties to this Agreement are the following:

SELLER		BUYER
Clearcell Power, Inc.	<i>Party Name</i>	The United Illuminating Company ("UI")
111 E Jericho Turnpike, 2nd FL Mineola, NY 11501	<i>Address</i>	180 Marsh Hill Road Orange, CT 06477
	<i>Business Website</i>	<a href="http://www.uinet.com">www.uinet.com</a>
New York	<i>Jurisdiction of Organization</i>	Connecticut
<input checked="" type="checkbox"/> Corporation <input type="checkbox"/> Limited Partnership <input type="checkbox"/> LLP <input type="checkbox"/> LLC <input type="checkbox"/> Partnership  <input type="checkbox"/> Individual <input type="checkbox"/> Other _____	<i>Company Type</i>	<input checked="" type="checkbox"/> Corporation <input type="checkbox"/> Limited Partnership <input type="checkbox"/> LLP <input type="checkbox"/> LLC <input type="checkbox"/> Partnership  <input type="checkbox"/> Individual <input type="checkbox"/> Other _____

CONTACT INFORMATION		
SELLER		BUYER
Clearcell Power, Inc. 338 Jericho Turnpike, Suite 325 Syosset, NY 11791 516-216-3218 alina@clearcellpower.com	<i>General</i>  <i>(day to day/ administrative)</i>	180 Marsh Hill Road Orange, CT 06477 Mail Stop: AD-2A ATTN: Director, Wholesale Power Contracts <a href="mailto:Lrec.zrec@uinet.com">Lrec.zrec@uinet.com</a>
ClearCell Power, Inc. C/O Alina Mezh 338 Jericho Turnpike, Suite 325 Syosset, NY 11791 516-216-3218 646-661-5588 alina@clearcellpower.com	<i>Contract</i>	180 Marsh Hill Road Orange, CT 06477 Mail Stop: AD-2A ATTN: Director, Wholesale Power Contracts <a href="mailto:Lrec.zrec@uinet.com">Lrec.zrec@uinet.com</a>

LL-09-24391

<p>Clearcell Power, Inc. 338 Jericho Turnpike, Suite 325 Syosset, NY 11791 516-216-3218 alina@clearcellpower.com</p>	<p><i>Legal Notices</i></p>	<p>180 Marsh Hill Road Orange, CT 06477 ATTN: General Counsel <a href="mailto:Lrec.zrec@uinet.com">Lrec.zrec@uinet.com</a></p>
<p>ClearCell Power, Inc. C/O Alina Mezh 338 Jericho Turnpike, Suite 325 Syosset, NY 11791 516-216-3218 646-661-5588 alina@clearcellpower.com</p>	<p><i>Performance Assurance</i></p>	<p>180 Marsh Hill Road Orange, CT 06477 Mail Stop: AD-2A ATTN: Director, Wholesale Power Contracts <a href="mailto:Lrec.zrec@uinet.com">Lrec.zrec@uinet.com</a></p>

<p><b>ACCOUNTING INFORMATION</b></p>		
<p>Clearcell Power, Inc. 338 Jericho Turnpike, Suite 325 Syosset, NY 11791 516-216-3218 alina@clearcellpower.com</p>	<p><i>· Invoices · Payments · Settlements</i></p>	<p>180 Marsh Hill Road Orange, CT 06477 Mail Stop: AD-2A ATTN: Director, Wholesale Power Contracts <a href="mailto:Lrec.zrec@uinet.com">Lrec.zrec@uinet.com</a></p>
<p>JPMorgan Chase 220 Jericho Turnpike Syosset, NY 11791 ABA# 021000021 Account# 733608918 Checking</p>	<p><i>Wire Transfer Numbers (IF APPLICABLE)</i></p>	<p>The United Illuminating Company  180 Marsh Hill Road Orange, CT 06477 JPMorganChase Bank ABA #021000021 The United Illuminating Company Account Number: 304295078</p>
	<p><i>Checks (IF APPLICABLE)</i></p>	<p>The United Illuminating Company  180 Marsh Hill Road Orange, CT 06477 Mail Stop: AD-2A ATTN: Director, Wholesale Power Contracts <a href="mailto:Lrec.zrec@uinet.com">Lrec.zrec@uinet.com</a></p>
<p>ABA# Account#</p>	<p><i>ACH Numbers (IF APPLICABLE)</i></p>	<p>The United Illuminating Company  180 Marsh Hill Road Orange, CT 06477 JPMorganChase Bank ABA #021000021</p>

LL-09-24391

		The United Illuminating Company Account Number: 304295078
--	--	--

The Parties hereby agree to the following provisions offered in Appendix A, the General Terms and Conditions. Select the appropriate box(es) and/or fill in the required information from each section:

<b>Cover Sheet Elections</b>		
Section 3.1 Facility Description	Facility Site/Location (including Street, City or Town)	490 Saw Mill Road WEST HAVEN CT 06516
	Customer Billing Account Number POD ID	010-0001595-5015 1240030224020
	Technology	Fuel Cell
	Project Size (kW)	<b>Applicable to LREC Projects only</b> <input checked="" type="checkbox"/> Less than 2,000 kW  <b>Applicable to ZREC Projects</b> <input type="checkbox"/> Greater than 100 kW, but less than 250 kW <input type="checkbox"/> Between 250 kW and 1,000 kW
	Installed Capacity	kW (AC) 460.00
Section 5.2 LREC/ZREC Product	<b>LREC</b>	
Section 6.2 Interconnecting Utility	The United Illuminating Company	
Section 7.1 Maximum Annual Quantity	Maximum Annual Quantity LRECs/ZRECs 3,808	
Section 7.4 Purchase Price	\$ 100.00 per LREC or ZREC, as elected above in Section 5.2	
<b>Section 9.1 Performance Assurance (amount)</b>	<b>\$ 76,160</b>	
Section 10.3.5 Facility Uses Connecticut Manufactured, Researched or Developed Technologies	Manufactured - Y Researched - Y Developed Technologies - Y	



LL-09-24391

Section 2.2 Delivery Term Start Date	<input checked="" type="checkbox"/> July 1, 2021 <input type="checkbox"/> October 1, 2021 <input type="checkbox"/> January 1, 2022 <input type="checkbox"/> April 1, 2022
---	--

IN WITNESS WHEREOF, the Parties hereto have executed this Agreement as of the Effective Date.

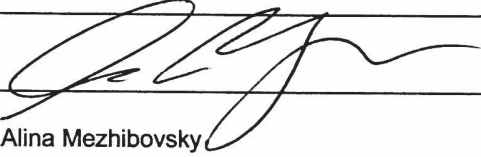
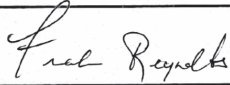
<b>Clearcell Power, Inc.</b>	<i>Party Name</i>	<b>The United Illuminating Company</b>
	<i>Signature</i>	
Alina Mezhibovsky	<i>Printed Name</i>	<div style="background-color: black; width: 100px; height: 15px; display: inline-block;"></div> Franklyn Reynolds
CEO	<i>Title</i>	<div style="background-color: black; width: 100%; height: 15px; display: inline-block;"></div>

President of UIL Holdings Corporation



Attachment #5: 490 Saw Mill Road Emergency Response Plan

# ClearCell Power, Inc. and Doosan Fuel Cell America Fuel Cell Emergency Response Guide

Best Western Hotel  
490 Saw Mill Road,  
West Haven, CT 06516



## DISCLAIMER

Doosan Fuel Cell America reserves the right to change or modify, without notice, the design or equipment specifications of the PureCell® system Model 400 without obligation with respect to equipment either previously sold or to be sold. This guide is provided by Doosan Fuel Cell America, and no liability will accrue to Doosan Fuel Cell America based on the information or specifications included herein. No warranties or representations are made by this guide and no warranties or representations shall apply to the equipment except as stated in Doosan Fuel Cell America's standard terms and conditions of sale applicable at the time of purchase, a copy of

COPYRIGHTED WORK © DOOSAN FUEL CELL AMERICA. THIS DOCUMENT CONTAINS THE PROPERTY OF DOOSAN FUEL CELL AMERICA. YOU MAY NOT POSSESS, USE, COPY OR DISCLOSE THIS DOCUMENT OR ANY INFORMATION IN IT FOR ANY PURPOSE, INCLUDING WITHOUT LIMITATION TO DESIGN, MANUFACTURE, OR REPAIR PARTS, WITHOUT EXPRESS WRITTEN PERMISSION. NEITHER RECEIPT FROM ANY SOURCE, NOR POSSESSION OF THIS DOCUMENT, CONSTITUTES SUCH PERMISSION. POSSESSION, USE, COPYING OR DISCLOSURE BY ANYONE WITHOUT EXPRESS WRITTEN PERMISSION OF DOOSAN FUEL CELL AMERICA CORPORATION IS NOT AUTHORIZED AND MAY RESULT IN CIVIL LIABILITY.

which will be provided upon request. The Model 400 is designed to provide safe and reliable service when operated within design specifications, according to all applicable instructions, and with the appropriate operating materials. When operating this equipment, use good judgment and follow safety precautions to avoid damage to equipment and property or injury to personnel. Be sure to understand and follow the procedures and safety precautions contained in all applicable instructions, operating materials, and those listed in this guide.

## Policy

The following plan has been developed to minimize the severity of damage to human health, the environment, and property in the event of an unexpected failure.

## Scope

***This Emergency Response Guide shall be integrated into the site Emergency Response Plan.*** Information contained in this document shall be customized to meet local requirements and shall be shared with local responders as necessary. This guide is only a template and in no way assumes or transfers liability or ownership. Doosan Fuel Cell America should be contacted if clarification is needed.

# Fuel Cell, Best Western Hotel, 490 Saw Mill Road, West Haven, CT

## Emergency Contacts and Numbers

Local Emergency Number	<b>911</b>
Doosan Fuel Cell America Control Center	<b>(860) 727-2847</b>
Fire Department – Non-emergency number	West Haven Fire Department (203) 937-3710
Hospital – Non-emergency number	Yale New Haven Hospital 20 York St, New Haven, CT 06510 (203) 688-4242
Electric Utility Name: United Illuminating, Co	<b>(800) 722-5584</b>
Gas Utility  Name: Southern Connecticut Gas Co.	<b>(866) 268-2887</b>  <b>*Gas Leaks Only: 800-513-8898</b>
Local Oil & Chemical Spill Response Division	<b>800-645-8265</b>
Connecticut Oil & Chemical Spill Response Division	<b>860-424-3338</b>
EPA - Environmental Protection Agency Region 1	<b>(800) 424-8802</b> Environmental Emergency
OSHA - Occupational Safety and Health Admin.  Emergency Number	<b>(800) 321-6742</b> National Emergency Number
Poison Control Center	<b>(800) 222-1222</b> National Emergency Number



### Fuel Cell Hazard Overview

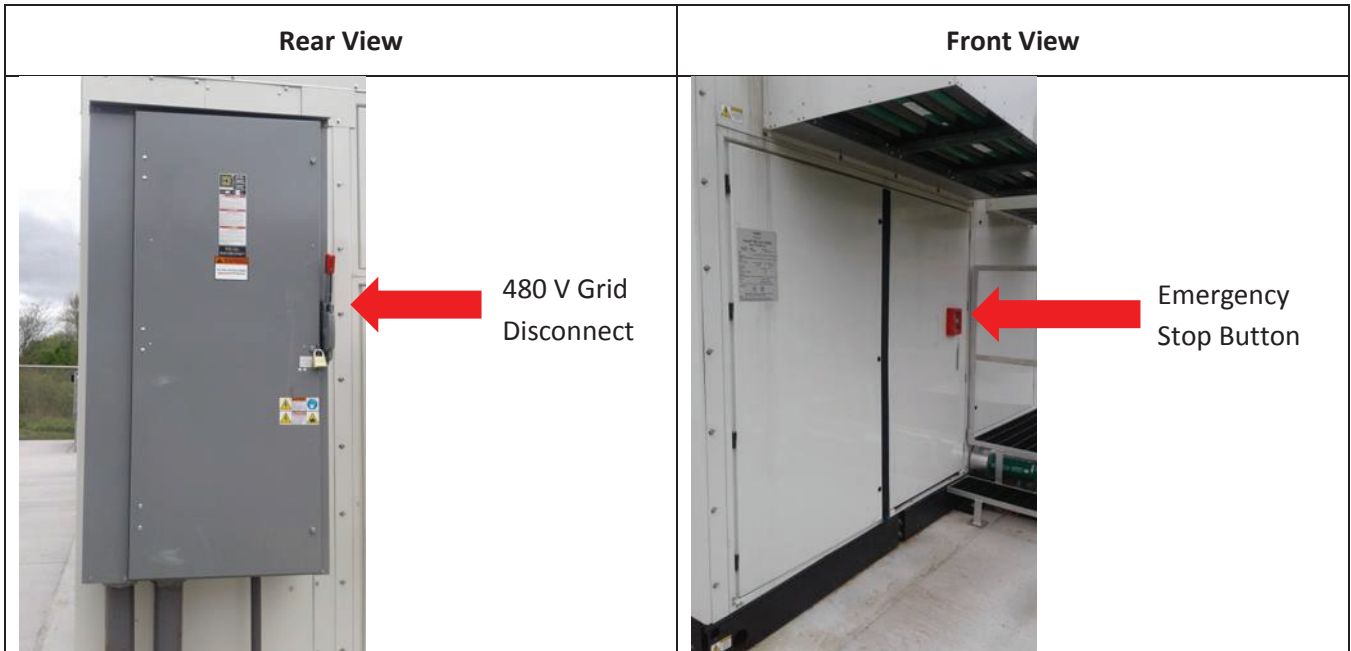
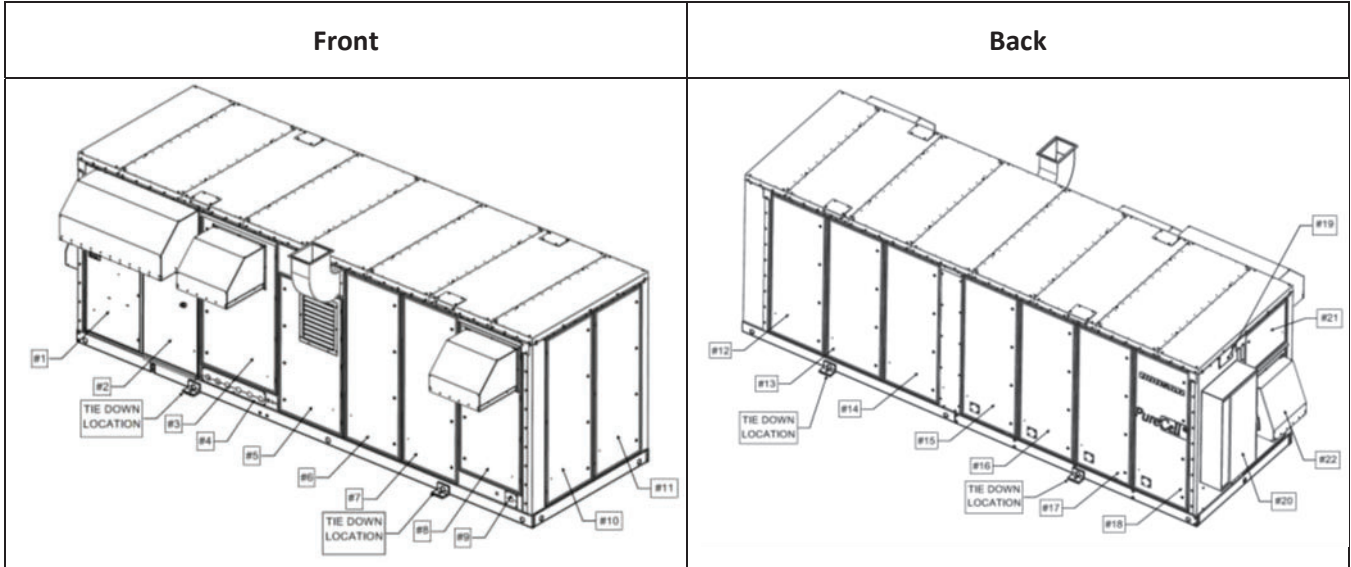



Rear View Panel	Primary Hazard	Front View Panel	Primary Hazard
<b>1 (Computer Terminal)</b>	Electrical = 120 VAC	<b>12 (Reformer)</b>	Electrical = 480 VAC Chemical = Air sensitive catalyst / combustibles Thermal = 600°F Reformer Pressure = 150 psi steam
		<b>13 (Reformer)</b>	Electrical = 480 VAC Chemical = Air sensitive catalyst / combustibles Thermal = 600°F Reformer Pressure = 150 psi steam
<b>2 (Swing Door)</b>	Electrical = 480 VAC	<b>14 (Reformer)</b>	Electrical = 480 VAC Chemical = Air sensitive catalyst / combustibles Thermal = 600°F Reformer Pressure = 150 psi steam
<b>3 (Mechanical Entry)</b>	Electrical = 480 VAC Chemical = Propylene Glycol Thermal = 350°F Steam Pressure = 150 psi Steam	<b>15 (DC Cell Stack)</b>	Electrical = 300 VDC Chemical = Solid phosphoric acid / combustibles
<b>4 (Mechanical Entry)</b>	Chemical = Propylene Glycol Thermal = 350°F Steam Pressure = 150 psi Steam	<b>16 (DC Cell Stack)</b>	Electrical = 300 VDC Chemical = Solid phosphoric acid / combustibles
<b>5 (TMS)</b>	Electrical = 480 VAC Chemical = Propylene Glycol / Deionized Water / Resin Thermal = 350oF Steam Pressure = 150 psi Steam	<b>17 (DC Cell Stack)</b>	Electrical = 300 VDC Chemical = Solid phosphoric acid / combustibles
<b>6 (ILS)</b>	Electrical = 480 VAC Chemical = Air sensitive catalyst / combustibles Thermal = 600°F Reformer Pressure = 150 psi steam	<b>18 (DC Cell Stack)</b>	Electrical = 300 VDC Chemical = Solid phosphoric acid / combustibles
<b>7 (Fuel Processing Area)</b>	Electrical = 480 VAC Chemical = Air sensitive catalyst / combustibles Thermal = 600°F Reformer Pressure = 150 psi steam	<b>19</b>	Not accessible
<b>8 (Fuel Processing Area)</b>	Electrical = 480 VAC Chemical = Air sensitive catalyst / combustibles Thermal = 600°F Reformer Pressure = 150 psi steam	<b>20 (Grid Connect Disconnect)</b>	Electrical = 480 VAC
<b>9 (Gas/Nitrogen Inlet)</b>	Chemical = combustibles	<b>21 (Blower 110)</b>	Electrical = 300 VDC Mechanical = Blower
<b>10 (Reformer)</b>	Electrical = 480 VAC Chemical = Air sensitive catalyst / combustibles Thermal = 600°F Reformer Pressure = 150 psi steam	<b>22</b>	Electrical = 1400 VDC / 480 VAC
<b>11 (Reformer)</b>	Electrical = 480 VAC Chemical = Air sensitive catalyst / combustibles Thermal = 600°F Reformer Pressure = 150 psi steam	<b>ALL Roof Panels</b>	Multiple Hazards DO NOT WALK ON ROOF!



## Conditional Assessment

Normal Condition	Potential Abnormal Condition	Response
<p><b>Fuel Cell</b></p> <p>White steam exiting power plant at exhaust chimney, above panel #6 (It can be a large amount of white steam depending on ambient conditions)</p>	Dark colored smoke exiting chimney or any other part of enclosure	<ol style="list-style-type: none"> <li>1. Establish safe perimeter</li> <li>2. Contact Doosan Fuel Cell America Control Center <b>(860) 727-2847</b></li> </ol>
	Observable fire or heavy smoke at any point on fuel cell	<ol style="list-style-type: none"> <li>1. Press Fuel Cell 'Stop Button' – Only if safely accessible!</li> <li>2. Dial 911 or Local Emergency Response Number</li> <li>3. Establish safe perimeter</li> <li>4. Contact Doosan Fuel Cell America Control Center <b>(860) 727-2847</b></li> </ol>
<p><b>Fuel Cell</b></p> <p>Moderate humming, clicking and fan sounds</p>	Grinding or loud intermittent noises	<ol style="list-style-type: none"> <li>1. Contact Doosan Fuel Cell America Control Center <b>(860) 727-2847</b></li> </ol>
	Observable fire or heavy smoke at any point on fuel cell	<ol style="list-style-type: none"> <li>1. Press Fuel Cell 'Stop Button' – Only if safely accessible!</li> <li>2. Dial 911 or Local Emergency Response Number</li> <li>3. Establish safe perimeter</li> <li>4. Contact Doosan Fuel Cell America Control Center <b>(860) 727-2847</b></li> </ol>
<p><b>Cooling Module</b></p> <p>Fan humming</p>	Smoke or fire coming from module	<ol style="list-style-type: none"> <li>1. Press Fuel Cell 'Stop Button' – Only if safely accessible!</li> <li>2. Dial 911 or Local Emergency Response Number</li> <li>3. Establish safe perimeter</li> <li>4. Contact Doosan Fuel Cell America Control Center <b>(860) 727-2847</b></li> </ol>





	Grinding or loud noise coming from fans	1. Contact Doosan Fuel Cell America Control Center <b>(860) 727-2847</b>
<b>Cooling Module</b>	Small leak dripping from joint, valve or connection	1. Contact Doosan Fuel Cell America Control Center <b>(860) 727-2847</b>
No leaking from cooling loop piping or coils	Medium to large leak	1. Follow local spill response protocol or contact Clean Harbors Emergency Cleanup Response <b>(800) 645-8265</b> 2. Contact Doosan Fuel Cell America Control Center <b>(860) 727-2847</b>
<b>Mechanical Hi/Lo Grade Piping</b>	Small leak dripping from joint, valve or connection	1. Contact Doosan Fuel Cell America Control Center <b>(860) 727-2847</b>
Small amounts of condensate dripping from piping	Medium to large leak	1. Follow local spill response protocol or contact Clean Harbors Emergency Cleanup Response <b>(800) 645-8265</b> 2. Contact Doosan Fuel Cell America Control Center <b>(860) 727-2847</b>
<b>Disconnects/Other Equipment</b>	Smoke or fire coming from equipment	1. Dial 911 or Local Emergency Response Number 2. Establish safe perimeter 3. Contact Doosan Fuel Cell America Control Center <b>(860) 727-2847</b>
No leaks or smoke		
<b>Compressed Gas Manifold (N2/H2)</b>	Leaks – may be able to hear hissing sound.	1. <b>If Indoors – Evacuate Immediately!</b> Dial 911 or Local Emergency Response Number 2. Establish safe perimeter 3. Contact Doosan Fuel Cell America Control Center <b>(860) 727-2847</b>
No leaks, May hear intermittent gas flow during purges		



## Fuel Cell Related Safety Data Sheets (SDS)

1	Propylene Glycol – DowFrost®
2	Phosphoric Acid – Solid
3	Reformer/ILS Catalysts
4	Anion/Cation Resin
5	Nitrogen / Hydrogen Compressed Gas Mixture (non-flammable)

## Inspections

Inspection Type	Equipment Requirements	Frequency Required
General Maintenance	Laptop, Service Vehicle	Monthly
General Housekeeping	N/A	Monthly
Waste and Chemical Storage*	N/A	Weekly
Internal Combustible Gas Monitor	AT-160 Calibration Kit	Annual
Fire Prevention	N/A	Monthly

\*When applicable

Fuel Cell operation is monitored and controlled remotely 24 hours a day 7 days a week by the Doosan Fuel Cell America Control Center. Upset or abnormal occurrences outside of normal operating parameters are immediately identified and service technicians are dispatched within 24 hours to respond when required.

## Emergency Procedures

Alarms	There are no audible or visual alarms on Fuel Cell. Alarm conditions are relayed immediately to the Doosan Fuel Cell America Control Center. The Doosan Fuel Cell America Control Center will then contact the appropriate site personnel on the site's emergency contact list.
Emergency Shut Down Onsite	Actuate Fuel Cell Stop Button
Emergency Area Egress - Gas Odor	Evacuate 330 Feet in all directions
Emergency Area Egress - Fire	Evacuate 330 Feet in all directions – CV000 automatic natural gas supply shut off
Emergency Egress - General	Fuel cell is unmanned remotely monitored and controlled. No Doosan Fuel Cell America employees attending unit unless service or maintenance is required.



## Signage and labeling

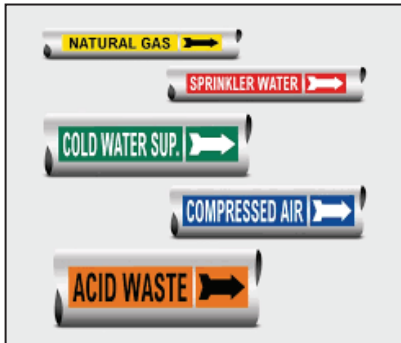

### General:

#### Safety Hazard Analysis

The PureCell® Model 400 fuel cell system has been designed to meet strict ANSI/CSA safety standards to protect against risks from electrical, mechanical, chemical, and combustion safety hazards. The following items are a few of the safety measures incorporated into the design.

#### Fire Detection and Protection:

The power plant design incorporates a combustible gas sensor as well as thermal fuses located throughout the power module cabinet to detect fire. The detection of a potential flammable gas mixture, a fire, or the failure of this detection circuit will result in a power plant shutdown and a subsequent inert gas (nitrogen) purge of the fuel cell stack and fuel processing system. This event will also result in an alarm callout notification to Doosan Fuel Cell America service personnel. The power plant is designed with an integral emergency-stop button on the outside of the enclosure to enable immediate shutdown in the event of an emergency. There is also a gas shut-off valve and electrical disconnect switch easily accessible to emergency personnel. There are no restrictions for type of fire suppression equipment.

#### Gas Leak:

Augmenting the internal combustible gas sensor, the power plant also monitors the flow rate of natural gas. If the gas flow rate exceeds the equivalent power production of the power plant then a shutdown will result. The largest possible accumulation from a leak prior to shutdown is below combustible limits. Fuel valves inside the power plant are “fail safe” and will return to their normally closed position upon loss of power. The power plant is designed to have a physical barrier that separates the equipment handling combustible gases (fuel compartment) from electrical or potential spark-creating equipment (motor compartment). The fuel compartment is kept at a negative pressure to contain and remove any potential gas leaks, whereas the motor compartment is pressurized by a fan source to prevent combustible gases from entering.



### **Hydrogen:**

Hydrogen is lighter than air and thus does not pool like other fuels and will readily dissipate with proper ventilation making it less likely to ignite. Although hydrogen has low self-ignition characteristics, the fuel in the power plant is not pure hydrogen. Also, the power plant is not producing or storing hydrogen, it consumes hydrogen-rich gas equal to what it requires to produce power. The fuel cell stack is wrapped in a fire retardant blanket. There are no materials inside the unit that would sustain a flame. There is no large volume of gas or any ignition that occurs within the cell stack.

### **Phosphoric Acid:**

Phosphoric acid is integral part of the fuel cell system, acting as the electrolyte within the fuel cell stack. Phosphoric acid is a surprisingly common substance that is contained in common cola drinks. A leak of phosphoric acid is not possible because phosphoric acid is not in liquid form once applied in the equipment. There is no reservoir of liquid. Phosphoric acid is contained in the porous structure of the fuel cell stack material by capillary action, similar to how ink is absorbed into a blotter.

### **Fluid Leak:**

All pressurized water vessels are designed to ASME boiler codes and inspected annually. All piping, welds, etc. meet pressurized piping standards. There are three fluid sources inside the fuel cell power module:

- 1) Water produced through the electrochemical process is “pure” water and is reclaimed and reused by the process.
- 2) Fluid used in the external cooling module, which is water mixed with a polypropylene glycol and a rust inhibitor to prevent rust and freezing in colder climates.
- 3) Fluid used in the heat recovery loops, this is the same glycol solution used in the external cooling module.

If a leak is observed around the fuel cell power module or absorption use a gray or blue absorbent mat, pad, or boom to contain the leak and prevent it from entering any drains. Contact Doosan Fuel Cell America, Inc Control Center for further assistance in identifying the leak source.

### **Hazardous Waste:**

The fuel cell does not produce any hazardous waste. Standard Material Safety Data Sheets (MSDS) are available upon request.



## APPENDIX 1 – SAFETY DATA SHEETS



# SAFETY DATA SHEET

## 1. Identification

Product identifier: PHOSPHORIC ACID

### Other means of identification

Synonyms: Ortho-Phosphoric Acid, White Phosphoric Acid  
Product No.: 0240, 6908, 2798, 2797, 5854, 2796, 5804, 2788, 0259, 5372, 0274, 0269, 0268, 0265, 0264, 0262, 0260, 0255, 0251

### Recommended use and restriction on use

Recommended use: Not available.  
Restrictions on use: Not known.

### Manufacturer/Importer/Supplier/Distributor information

#### Manufacturer

Company Name: Avantor Performance Materials, Inc.  
Address: 3477 Corporate Parkway, Suite 200  
Center Valley, PA 18034  
Telephone: Customer Service: 855-282-6867  
Fax:  
Contact Person: Environmental Health & Safety  
e-mail: info@avantormaterials.com

Emergency telephone number:  
24 Hour Emergency: 908-859-2151  
Chemtrec: 800-424-9300

## 2. Hazard(s) identification

### Hazard classification

#### Physical hazards

Corrosive to metals Category 1

#### Health hazards

Acute toxicity (Oral) Category 4  
Skin corrosion/irritation Category 1  
Serious eye damage/eye irritation Category 1  
Specific target organ toxicity - single exposure Category 3

#### Unknown toxicity

Acute toxicity, oral 0 %  
Acute toxicity, dermal 0 %  
Acute toxicity, inhalation, vapor 100 %  
Acute toxicity, inhalation, dust or mist 100 %

#### Unknown toxicity

Acute hazards to the aquatic environment 84 %  
Chronic hazards to the aquatic environment 84 %

### Label elements

SDS\_US - SDSMIX000331

**Hazard symbol:**



**Signal word:** Danger

**Hazard statement:** May be corrosive to metals.  
Harmful if swallowed.  
Causes severe skin burns and eye damage.  
May cause respiratory irritation.

**Precautionary statement**

**Prevention:** Keep only in original container. Do not breathe dust/fume/mist/vapors. Do not eat, drink or smoke when using this product. Use only outdoors or in a well-ventilated area. Wear protective gloves/protective clothing/eye protection/face protection. Wash thoroughly after handling.

**Response:** Absorb spillage to prevent material damage. IF SWALLOWED: Rinse mouth. Do NOT induce vomiting. IF ON SKIN (or hair): Remove/take off immediately all contaminated clothing. Rinse skin with water/shower. Wash contaminated clothing before reuse. IF IN EYES: Rinse cautiously with water for several minutes. Remove contact lenses, if present and easy to do. Continue rinsing. IF INHALED: Remove victim to fresh air and keep at rest in a position comfortable for breathing. Immediately call a POISON CENTER or doctor/physician.

**Storage:** Store locked up. Store in a well-ventilated place. Keep container tightly closed. Store in corrosive resistant container with a resistant inner liner.

**Disposal:** Dispose of contents/container to an appropriate treatment and disposal facility in accordance with applicable laws and regulations, and product characteristics at time of disposal.

**Other hazards which do not result in GHS classification:** None.

**3. Composition/information on ingredients**

**Mixtures**

Chemical identity	Common name and synonyms	CAS number	Content in percent (%) <sup>*</sup>
PHOSPHORIC ACID		7664-38-2	80 - 90%

<sup>\*</sup> All concentrations are percent by weight unless ingredient is a gas. Gas concentrations are in percent by volume.

**4. First-aid measures**

**General information:** Get medical advice/attention if you feel unwell. Show this safety data sheet to the doctor in attendance.



<b>Ingestion:</b>	Do NOT induce vomiting. Call a physician or poison control center immediately. If vomiting occurs, keep head low so that stomach content doesn't get into the lungs.
<b>Inhalation:</b>	Move to fresh air. Call a physician or poison control center immediately. Apply artificial respiration if victim is not breathing. If breathing is difficult, give oxygen.
<b>Skin contact:</b>	Immediately flush with plenty of water for at least 15 minutes while removing contaminated clothing and shoes. Call a physician or poison control center immediately. Wash contaminated clothing before reuse. Destroy or thoroughly clean contaminated shoes.
<b>Eye contact:</b>	Immediately flush with plenty of water for at least 15 minutes. If easy to do, remove contact lenses. Call a physician or poison control center immediately. In case of irritation from airborne exposure, move to fresh air. Get medical attention immediately.

**Most important symptoms/effects, acute and delayed**

**Symptoms:** Causes severe skin and eye burns. Causes digestive tract burns.

**Indication of immediate medical attention and special treatment needed**

**Treatment:** Treat symptomatically. Symptoms may be delayed.

**5. Fire-fighting measures**

**General fire hazards:** No data available.

**Suitable (and unsuitable) extinguishing media**

**Suitable extinguishing media:** The product is non-combustible. Use fire-extinguishing media appropriate for surrounding materials.

**Unsuitable extinguishing media:** None known.

**Specific hazards arising from the chemical:** Not combustible, but if involved in a fire decomposes to produce toxic gases.

**Special protective equipment and precautions for firefighters**

**Special fire fighting procedures:** Move containers from fire area if you can do so without risk. Use water spray to keep fire-exposed containers cool.

**Special protective equipment for fire-fighters:** Firefighters must use standard protective equipment including flame retardant coat, helmet with face shield, gloves, rubber boots, and in enclosed spaces, SCBA. Product is highly acidic. Wear protective gear if spilled during fire fighting.

**6. Accidental release measures**

**Personal precautions, protective equipment and emergency procedures:** See Section 8 of the MSDS for Personal Protective Equipment. Do not touch damaged containers or spilled material unless wearing appropriate protective clothing. Keep unauthorized personnel away. Keep upwind. Ventilate closed spaces before entering them.





Version: 1.0  
Revision date: 04-07-2014

**Methods and material for containment and cleaning up:** Neutralize with lime or soda ash. Absorb spill with vermiculite or other inert material, then place in a container for chemical waste. Clean surface thoroughly to remove residual contamination. Dike far ahead of larger spill for later recovery and disposal.

**Notification Procedures:** Inform authorities if large amounts are involved.

**Environmental precautions:** Do not contaminate water sources or sewer. Prevent further leakage or spillage if safe to do so.

### 7. Handling and storage

**Precautions for safe handling:** Do not get in eyes, on skin, on clothing. Do not taste or swallow. Wash thoroughly after handling. Do not eat, drink or smoke when using the product. Use caution when adding this material to water. Add material slowly when mixing with water. Do not add water to the material; instead, add the material to the water.

**Conditions for safe storage, including any incompatibilities:** Do not store in metal containers. Keep container tightly closed. Store in a well-ventilated place.

### 8. Exposure controls/personal protection

#### Control parameters

##### Occupational exposure limits

Chemical identity	Type	Exposure Limit values	Source
PHOSPHORIC ACID	TWA	1 mg/m <sup>3</sup>	US. ACGIH Threshold Limit Values (2011)
	STEL	3 mg/m <sup>3</sup>	US. ACGIH Threshold Limit Values (2011)
	REL	1 mg/m <sup>3</sup>	US. NIOSH: Pocket Guide to Chemical Hazards (2010)
	STEL	3 mg/m <sup>3</sup>	US. NIOSH: Pocket Guide to Chemical Hazards (2010)
	PEL	1 mg/m <sup>3</sup>	US. OSHA Table Z-1 Limits for Air Contaminants (29 CFR 1910.1000) (02 2006)
	TWA	1 mg/m <sup>3</sup>	US. OSHA Table Z-1-A (29 CFR 1910.1000) (1989)
	STEL	3 mg/m <sup>3</sup>	US. OSHA Table Z-1-A (29 CFR 1910.1000) (1989)
	TWA	1 mg/m <sup>3</sup>	US. Tennessee. OELs. Occupational Exposure Limits, Table Z1A (08 2008)
	STEL	3 mg/m <sup>3</sup>	US. Tennessee. OELs. Occupational Exposure Limits, Table Z1A (08 2008)
	ST ESL	10 µg/m <sup>3</sup>	US. Texas. Effects Screening Levels (Texas Commission on Environmental Quality) (12 2010)
	AN ESL	1 µg/m <sup>3</sup>	US. Texas. Effects Screening Levels (Texas Commission on Environmental Quality) (12 2010)
	TWA PEL	1 mg/m <sup>3</sup>	US. California Code of Regulations, Title 8, Section 5155. Airborne Contaminants (08 2010)
	STEL	3 mg/m <sup>3</sup>	US. California Code of Regulations, Title 8, Section 5155. Airborne Contaminants (08 2010)

**Appropriate engineering controls** No data available.



Version: 1.0  
Revision date: 04-07-2014

#### Individual protection measures, such as personal protective equipment

<b>General information:</b>	Good general ventilation (typically 10 air changes per hour) should be used. Ventilation rates should be matched to conditions. If applicable, use process enclosures, local exhaust ventilation, or other engineering controls to maintain airborne levels below recommended exposure limits. If exposure limits have not been established, maintain airborne levels to an acceptable level. An eye wash and safety shower must be available in the immediate work area.
<b>Eye/face protection:</b>	Wear safety glasses with side shields (or goggles) and a face shield.
<b>Skin protection</b>	
<b>Hand protection:</b>	Chemical resistant gloves
<b>Other:</b>	Wear suitable protective clothing and gloves.
<b>Respiratory protection:</b>	In case of inadequate ventilation use suitable respirator. Respirator type: Chemical respirator with acid gas cartridge.
<b>Hygiene measures:</b>	Provide eyewash station and safety shower. Observe good industrial hygiene practices. Wash hands before breaks and immediately after handling the product. Wash contaminated clothing before reuse. Avoid contact with eyes. Avoid contact with skin.

### 9. Physical and chemical properties

#### Appearance

<b>Physical state:</b>	Liquid
<b>Form:</b>	Liquid
<b>Color:</b>	Colorless
<b>Odor:</b>	Odorless
<b>Odor threshold:</b>	No data available.
<b>pH:</b>	1.5 0.1 N Aqueous solution
<b>Melting point/freezing point:</b>	21.1 °C
<b>Initial boiling point and boiling range:</b>	158 °C
<b>Flash Point:</b>	Not applicable
<b>Evaporation rate:</b>	No data available.
<b>Flammability (solid, gas):</b>	No data available.
<b>Upper/lower limit on flammability or explosive limits</b>	
<b>Flammability limit - upper (%):</b>	No data available.
<b>Flammability limit - lower (%):</b>	No data available.
<b>Explosive limit - upper (%):</b>	No data available.
<b>Explosive limit - lower (%):</b>	No data available.
<b>Vapor pressure:</b>	0.3 kPa
<b>Vapor density:</b>	No data available.
<b>Relative density:</b>	1.69 (20 °C)
<b>Solubility(ies)</b>	
<b>Solubility in water:</b>	Miscible with water.
<b>Solubility (other):</b>	No data available.
<b>Partition coefficient (n-octanol/water):</b>	No data available.
<b>Auto-ignition temperature:</b>	No data available.
<b>Decomposition temperature:</b>	No data available.
<b>Viscosity:</b>	No data available.



Version: 1.0  
Revision date: 04-07-2014

## 10. Stability and reactivity

<b>Reactivity:</b>	No dangerous reaction known under conditions of normal use.
<b>Chemical stability:</b>	Material is stable under normal conditions.
<b>Possibility of hazardous reactions:</b>	Hazardous polymerization does not occur.
<b>Conditions to avoid:</b>	Avoid contact with oxidizing agents. Avoid contact with strong reducing agents. Contact with alkalis.
<b>Incompatible materials:</b>	Strong reducing agents. Alkalies. Strong oxidizing agents. Metals.
<b>Hazardous decomposition products:</b>	oxides of phosphorus

## 11. Toxicological information

### Information on likely routes of exposure

<b>Ingestion:</b>	Harmful if swallowed.
<b>Inhalation:</b>	Severely irritating to respiratory system.
<b>Skin contact:</b>	Causes severe skin burns.
<b>Eye contact:</b>	Causes serious eye damage.

### Information on toxicological effects

#### Acute toxicity (list all possible routes of exposure)

<b>Oral</b>	
<b>Product:</b>	ATEmix (Rat): 1,700 mg/kg
<b>Dermal</b>	
<b>Product:</b>	ATEmix (): 3,044.44 mg/kg
<b>Inhalation</b>	
<b>Product:</b>	No data available.
<b>Repeated dose toxicity</b>	
<b>Product:</b>	No data available.
<b>Skin corrosion/irritation</b>	
<b>Product:</b>	Causes severe skin burns.
<b>Serious eye damage/eye irritation</b>	
<b>Product:</b>	Causes serious eye damage.
<b>Respiratory or skin sensitization</b>	
<b>Product:</b>	Not a skin sensitizer.
<b>Carcinogenicity</b>	
<b>Product:</b>	This substance has no evidence of carcinogenic properties.

**IARC Monographs on the Evaluation of Carcinogenic Risks to Humans:**  
No carcinogenic components identified

**US. National Toxicology Program (NTP) Report on Carcinogens:**  
No carcinogenic components identified



Version: 1.0  
Revision date: 04-07-2014

**US. OSHA Specifically Regulated Substances (29 CFR 1910.1001-1050):**  
No carcinogenic components identified

**Germ cell mutagenicity**

**In vitro**  
Product: No mutagenic components identified

**In vivo**  
Product: No mutagenic components identified

**Reproductive toxicity**  
Product: No components toxic to reproduction

**Specific target organ toxicity - single exposure**  
Product: None known.

**Specific target organ toxicity - repeated exposure**  
Product: None known.

**Aspiration hazard**  
Product: Not classified

**Other effects:** Not known.

**12. Ecological information**

**Ecotoxicity:**

**Acute hazards to the aquatic environment:**

**Fish**  
Product: No data available.

**Aquatic invertebrates**  
Product: No data available.

**Chronic hazards to the aquatic environment:**

**Fish**  
Product: No data available.

**Aquatic invertebrates**  
Product: No data available.

**Toxicity to Aquatic Plants**  
Product: No data available.

**Persistence and degradability**

**Biodegradation**  
Product: Expected to be readily biodegradable.

**BOD/COD ratio**  
Product: No data available.

**Bioaccumulative potential**

**Bioconcentration factor (BCF)**  
Product: No data available on bioaccumulation.

**Partition coefficient n-octanol / water (log Kow)**  
Product: No data available.



Version: 1.0  
Revision date: 04-07-2014

**Mobility in soil:** The product is water soluble and may spread in water systems.  
**Other adverse effects:** The product may affect the acidity (pH-factor) in water with risk of harmful effects to aquatic organisms.

### 13. Disposal considerations

**Disposal instructions:** Discharge, treatment, or disposal may be subject to national, state, or local laws.  
**Contaminated packaging:** Since emptied containers retain product residue, follow label warnings even after container is emptied.

### 14. Transport information

#### DOT

UN number: UN 1805  
UN proper shipping name: Phosphoric acid solution  
Transport hazard class(es):  
Class(es): 8  
Label(s): 8  
Packing group: III  
Marine Pollutant: No

#### IMDG

UN number: UN 1805  
UN proper shipping name: PHOSPHORIC ACID SOLUTION  
Transport hazard class(es):  
Class(es): 8  
Label(s): 8  
EmS No.: F-A, S-B  
Packing group: III  
Marine Pollutant: No

#### IATA

UN number: UN 1805  
Proper Shipping Name: Phosphoric acid, solution  
Transport hazard class(es):  
Class(es): 8  
Label(s): 8  
Marine Pollutant: No  
Packing group: III

### 15. Regulatory information

#### US federal regulations

**TSCA Section 12(b) Export Notification (40 CFR 707, Subpt. D)**  
**US. OSHA Specifically Regulated Substances (29 CFR 1910.1001-1050)**  
None present or none present in regulated quantities.

**CERCLA Hazardous Substance List (40 CFR 302.4):**  
PHOSPHORIC ACID Reportable quantity: 5000 lbs.



**Superfund amendments and reauthorization act of 1986 (SARA)**

**Hazard categories**

Acute (Immediate)  Chronic (Delayed)  Fire  Reactive  Pressure Generating

**SARA 302 Extremely hazardous substance**

None present or none present in regulated quantities.

**SARA 304 Emergency release notification**

Chemical identity	RQ
PHOSPHORIC ACID	5000 lbs.

**SARA 311/312 Hazardous chemical**

Chemical identity	Threshold Planning Quantity
PHOSPHORIC ACID	500 lbs

**SARA 313 (TRI reporting)**

None present or none present in regulated quantities.

**Clean Water Act Section 311 Hazardous Substances (40 CFR 117.3)**

PHOSPHORIC ACID Reportable quantity: 5000 lbs.

**Clean Air Act (CAA) Section 112(r) Accidental Release Prevention (40 CFR 68.130):**

None present or none present in regulated quantities.

**US state regulations**

**US. California Proposition 65**

No ingredient regulated by CA Prop 65 present.

**US. New Jersey Worker and Community Right-to-Know Act**

PHOSPHORIC ACID Listed

**US. Massachusetts RTK - Substance List**

PHOSPHORIC ACID Listed

**US. Pennsylvania RTK - Hazardous Substances**

PHOSPHORIC ACID Listed

**US. Rhode Island RTK**

PHOSPHORIC ACID Listed

**Inventory Status:**

Australia AICS:	On or in compliance with the inventory
Canada DSL Inventory List:	On or in compliance with the inventory
EINECS, ELINCS or NLP:	On or in compliance with the inventory
Japan (ENCS) List:	On or in compliance with the inventory
China Inv. Existing Chemical Substances:	Not in compliance with the inventory.
Korea Existing Chemicals Inv. (KECI):	On or in compliance with the inventory
Canada NDSL Inventory:	Not in compliance with the inventory.
Philippines PICCS:	On or in compliance with the inventory
US TSCA Inventory:	On or in compliance with the inventory
New Zealand Inventory of Chemicals:	On or in compliance with the inventory
Japan ISHL Listing:	Not in compliance with the inventory.
Japan Pharmacopoeia Listing:	Not in compliance with the inventory.

**16. Other information, including date of preparation or last revision**



Version: 1.0  
Revision date: 04-07-2014

**NFPA Hazard ID**

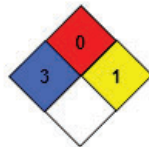

-  Flammability
-  Health
-  Reactivity
-  Special hazard.

Hazard rating: 0 - Minimal; 1 - Slight; 2 - Moderate; 3 - Serious; 4 - Severe

**Issue date:** 04-07-2014  
**Revision date:** No data available.  
**Version #:** 1.0  
**Further information:** No data available.

**Disclaimer:** THE INFORMATION PRESENTED IN THIS MATERIAL SAFETY DATA SHEET (MSDS/SDS) WAS PREPARED BY TECHNICAL PERSONNEL BASED ON DATA THAT THEY BELIEVE IN THEIR GOOD FAITH JUDGMENT IS ACCURATE. HOWEVER, THE INFORMATION PROVIDED HEREIN IS PROVIDED "AS IS," AND AVANTOR PERFORMANCE MATERIALS MAKES AND GIVES NO REPRESENTATIONS OR WARRANTIES WHATSOEVER, AND EXPRESSLY DISCLAIMS ALL WARRANTIES REGARDING SUCH INFORMATION AND THE PRODUCT TO WHICH IT RELATES, WHETHER EXPRESS, IMPLIED, OR STATUTORY, INCLUDING WITHOUT LIMITATION, WARRANTIES OF ACCURACY, COMPLETENESS, MERCHANTABILITY, NON-INFRINGEMENT, PERFORMANCE, SAFETY, SUITABILITY, STABILITY, AND FITNESS FOR A PARTICULAR PURPOSE, AND ANY WARRANTIES ARISING FROM COURSE OF DEALING, COURSE OF PERFORMANCE, OR USAGE OF TRADE. THIS MSDS/SDS IS INTENDED ONLY AS A GUIDE TO THE APPROPRIATE PRECAUTIONARY HANDLING OF THE MATERIAL BY A PROPERLY TRAINED PERSON USING THIS PRODUCT, AND IS NOT INTENDED TO BE COMPREHENSIVE AS TO THE MANNER AND CONDITIONS OF USE, HANDLING, STORAGE, OR DISPOSAL OF THE PRODUCT. INDIVIDUALS RECEIVING THIS MSDS/SDS MUST ALWAYS EXERCISE THEIR OWN INDEPENDENT JUDGMENT IN DETERMINING THE APPROPRIATENESS OF SUCH ISSUES. ACCORDINGLY, AVANTOR PERFORMANCE MATERIALS ASSUMES NO LIABILITY WHATSOEVER FOR THE USE OF OR RELIANCE UPON THIS INFORMATION. NO SUGGESTIONS FOR USE ARE INTENDED AS, AND NOTHING HEREIN SHALL BE CONSTRUED AS, A RECOMMENDATION TO INFRINGE ANY EXISTING PATENTS OR TO VIOLATE ANY FEDERAL, STATE, LOCAL, OR FOREIGN LAWS. AVANTOR PERFORMANCE MATERIALS REMINDS YOU THAT IT IS YOUR LEGAL DUTY TO MAKE ALL INFORMATION IN THIS MSDS/SDS AVAILABLE TO YOUR EMPLOYEES.



860727866

LTC Power Shipping

09:55:17 a.m. 04-30-2009

1/7

NN53

### MATERIAL SAFETY DATA SHEET

**PRODUCT NAME:** Shift Max 230, Reduced Heterogeneous Catalyst, FC72372

#### SECTION 1. CHEMICAL PRODUCT AND COMPANY IDENTIFICATION

Doosan Fuel Cell America, Inc. 195 Governors Hwy. South Windsor, CT 06074 USA	TELEPHONE: 24 HOUR EMERGENCY: 1-800-424-9300 (CHEMTREC) PRODUCT INFORMATION: 860-727-2300
--	--

MSDS NO: NN53	INITIAL RELEASE DATE: 4/23/2009	REVISION DATE:
---------------	---------------------------------	----------------

<b>GENERIC DESCRIPTION:</b>	Reduced catalyst
<b>PHYSICAL FORM:</b>	Cylindrical tablets
<b>COLOR:</b>	Dark brown
<b>ODOR:</b>	None

NFPA 704 CODES: HEALTH: 1 FLAMMABILITY: 4 REACTIVITY: 2

NOTE: NFPA = NATIONAL FIRE PROTECTION ASSOCIATION

#### SECTION 2. COMPOSITION / INFORMATION ON INGREDIENTS

CAS NUMBER	%WT/VOL	COMPONENTS	EXPOSURE LIMITS	
			OSHA	AGGIH

The following is the composition of the packed tablets:

1344-28-1	9-12	Aluminum oxide	15 mg/m3 5 mg/m3 (respirable)	1 mg/m <sup>3</sup> (respirable)
7440-50-8	55-62	Copper	1 mg/m3	1 mg/m <sup>3</sup> (dust)
1314-13-2	28-33	Zinc oxide	15 mg/m3 5 mg/m3 (respirable)	2 mg/m <sup>3</sup> (respirable)





### MATERIAL SAFETY DATA SHEET

**PRODUCT NAME:** Shift Max 230, Reduced Heterogeneous Catalyst, FC72372

**SECTION 3. EFFECTS OF OVEREXPOSURE**

**ACUTE EFFECTS:**

**EYE:** May cause irritation

**SKIN:** Frequent or prolonged contact may irritate the skin and cause a skin rash (dermatitis).

**INHALATION:** Prolonged or repeated inhalation may cause lung damage. Prolonged or excessive inhalation may cause respiratory tract irritation.

**ORAL:** Moderately toxic and may be harmful if swallowed; may damage the liver, pancreas, kidney or nervous systems.

**REPEATED EXPOSURE EFFECTS:**

**EYE:** Signs and symptoms of overexposure may include scratch or abrasion, damage to cornea (necrosis).

**SKIN:** Overexposure may cause skin rash, dermatitis and or itching.

**INHALATION:** Overexposure may cause coughing, wheezing, shortness of breath, difficult breathing, chest pain.

**ORAL:** Ingestion may cause upset stomach and intestinal distress.

**SECTION 3. EFFECTS OF OVEREXPOSURE**

**NOTE TO PHYSICIANS:** N/D

THIS MATERIAL CONTAINS THE FOLLOWING COMPONENTS WITH THE SPECIAL HAZARDS LISTED BELOW.

<u>CARCINOGENS</u>	N/A
<u>TERATOGENS</u>	N/A
<u>MUTAGENS</u>	N/A
<u>REPRODUCTIVE TOXINS</u>	N/A
<u>SENSITIZERS</u>	N/A
<u>COMMENTS:</u>	None
<u>NTP CLASSIFICATION:</u>	N/A
<u>IARC CLASSIFICATION:</u>	N/A
<u>OSHA CLASSIFICATION:</u>	N/A

**MATERIAL SAFETY DATA SHEET****PRODUCT NAME:** Shift Max 230, Reduced Heterogeneous Catalyst, FC72372**SECTION 4. FIRST AID MEASURES**

**EYE:** Immediately flush eyes with plenty of water for at least 30 minutes. Get immediate medical attention.

**SKIN:** Wash with plenty of soap and water. Get medical attention if irritation develops or persists.

**INHALATION:** Remove to fresh air. If breathing is difficult seek immediate medical attention.

**ORAL:** If swallowed, do NOT induce vomiting. Give victim large quantities of water. Call a physician or poison control center immediately. Never give anything by mouth to an unconscious person.

**COMMENTS:** Exposure to fumes of the metal oxides may cause metal fume fever including irritation of eyes and respiratory tract and flu-like symptoms.

**SECTION 5. FIRE FIGHTING MEASURES**

**FLASH POINT (METHOD):** N/A

**AUTOIGNITION TEMPERATURE:** N/A

**FLAMMABILITY LIMITS IN AIR:** N/A

**EXTINGUISHING MEDIA:** Protect exposures; cool with water fog. For small fires use Class D extinguishing media.

**UNSUITABLE EXTINGUISHING MEDIA:** N/D

**FIRE FIGHTING PROCEDURES:** Wear full protective clothing and SCBA's.

**UNUSUAL FIRE HAZARDS:** Packed material will spontaneously oxidize in air, producing significant heat. Keep away from combustible materials.

**HAZARDOUS DECOMPOSITION PRODUCTS:** Toxic metal fumes may be emitted if thermally decomposed.

**SECTION 6. ACCIDENTAL RELEASE MEASURES****CONTAINMENT / CLEAN UP:**

**Small spill** With shovel or scoop, place material onto clean, dry non-flammable surface to allow catalyst to oxidize. Place oxidized catalyst into container and cover loosely. Remove containers from spill area. Protect against inhalation of dusts or fumes, Wear eye protection.

**Large spill** Wet methods of cleanup are preferred. Keep airborne particulates to a minimum. Protect against inhalation of dusts or fumes, Wear eye protection. Place in appropriate containers for disposal.

**MATERIAL SAFETY DATA SHEET****PRODUCT NAME:** Shift Max 230, Reduced Heterogeneous Catalyst, FC72372**SECTION 7. HANDLING AND STORAGE****HANDLING:** No special precautions for intact containers.**STORAGE:** Store in dry area. Prevent exposure to air by maintaining under an inert gas atmosphere such as nitrogen. Use additional precautions to prevent asphyxiant hazards due to inert gas usage.**SECTION 8. EXPOSURE CONTROLS / PERSONAL PROTECTION****ENGINEERING CONTROLS****LOCAL EXHAUST:** If user operations generate dust or fume, use ventilation to keep exposure to airborne contaminants below the exposure limits.**GENERAL VENTILATION:** N/A**PERSONAL PROTECTIVE EQUIPMENT FOR ROUTINE HANDLING****EYES:** Wear safety glasses with side shields or goggles.**SKIN:** Wear protective clothing, including long sleeves and gloves to prevent skin contact.**SUITABLE GLOVES:** Impermeable, such as latex, Nitrile, etc.**INHALATION:** Wear NIOSH approved respirator with particulate filter.**PERSONAL PROTECTIVE EQUIPMENT FOR SPILLS****EYES:** Chemical goggles**SKIN:** Chemical resistant gloves**INHALATION / SUITABLE RESPIRATOR:** (Min) Use NIOSH-approved respirator with particulate filter**PRECAUTIONARY MEASURES:** N/D

**MATERIAL SAFETY DATA SHEET****PRODUCT NAME:** Shift Max 230, Reduced Heterogeneous Catalyst, FC72372**SECTION 9. PHYSICAL AND CHEMICAL PROPERTIES****TYPICAL PHYSICAL PROPERTIES ARE GIVEN BELOW.**

APPEARANCE: Cylindrical tablets	POUR POINT C (F): N/A
COLOR: Dark brown	FREEZING POINT C (F): N/A
ODOR: None	VOLATILE ORGANIC COMPOUND:
ODOR THRESHOLD: N/A	SPECIFIC GRAVITY: (H <sub>2</sub> O = 1) >8
pH: N/A	VAPOR PRESSURE - mmHg: N/A
BOILING POINT C (F): N/A	VAPOR DENSITY @ TEMP:____: N/A
MELTING POINT C (F): N/A	EVAPORATION RATE RELATIVE TO____: N/A
SOLUBILITY IN WATER: Insoluble	EXPLOSIVE PROPERTIES: Will not explode
VISCOSITY AT____: N/A	OXIDIZING PROPERTIES: Not an oxidizer
VISCOSITY AT____:	
RELATIVE DENSITY TO: 65-85 lb./CF (bulk)	

**SECTION 10. STABILITY AND REACTIVITY**

**STABILITY (THERMAL, LIGHT, ETC.):** Generally considered stable when contained under an inert atmosphere.

**CONDITIONS TO AVOID:** Exposure to air.

**INCOMPATIBILITY (MATERIALS TO AVOID):** Combustible materials.

**HAZARDOUS DECOMPOSITION PRODUCTS:** Thermal decomposition may produce metal oxide fumes.

**HAZARDOUS POLYMERIZATION:** Not expected to occur.

**MATERIAL SAFETY DATA SHEET****PRODUCT NAME:** Shift Max 230, Reduced Heterogeneous Catalyst, FC72372**SECTION 11. TOXICOLOGICAL DATA**

Exposure to metal oxide fume may produce "metal fume fever" which is characterized by flu-like symptoms including fever, chills and general aches.

**SECTION 12. ECOLOGICAL INFORMATION**

No data available.

**SECTION 13. DISPOSAL CONSIDERATIONS**

Local regulations may vary; all waste must be disposed/recycled/reclaimed in accordance with federal, state and local environmental control regulations.

**SECTION 14. TRANSPORT INFORMATION****PROPER SHIPPING NAME:** Self-heating solid, inorganic, N.O.S.**HAZARD TECHNICAL NAME:** Reduced copper catalysts.**HAZARD CLASS:** 4.2**UN NUMBER:** 3190**PACKING GROUP:** II**SECTION 15. REGULATORY INFORMATION****TSCA STATUS:** Component materials are in the TSCA inventory.**EPA SARA TITLE III CHEMICAL LISTINGS:****SECTION 302 HAZARDOUS SUBSTANCES:** No**SECTION 355 EXTREMELY HAZARDOUS SUBSTANCES:** No



8607277666

UTC Power Shipping

09:58:20 a.m. 04-30-2009

7/7

### MATERIAL SAFETY DATA SHEET

**PRODUCT NAME:** Shift Max 230, Reduced Heterogeneous Catalyst, FC72372

#### SECTION 15. REGULATORY INFORMATION, CONTINUED

##### SECTION 312 HAZARD CLASS:

**ACUTE:** Yes  
**CHRONIC:** Yes  
**FIRE:** Yes  
**PRESSURE:** No  
**REACTIVE:** No

**SECTION 372 TOXIC CHEMICALS:** Copper.

#### SECTION 16. OTHER INFORMATION

**COMMENTS:** N/D = Not Determined  
N/A = Not Applicable

As a unit, the materials do not pose a hazard. However, should the container be compromised and the packed catalyst become available, measures must be taken to prevent exposure to air.

**PREPARED BY:** D. Black, J. Preston  
Revision By:

**DATE:** 4/23/2009

INFORMATION GIVEN HEREIN IS OFFERED IN GOOD FAITH AS ACCURATE, BUT WITHOUT GUARANTEE. CONDITIONS OF USE AND SUITABILITY OF THE PRODUCT FOR PARTICULAR USES ARE BEYOND OUR CONTROL; ALL RISKS OF USE OF THE PRODUCT ARE THEREFORE ASSUMED BY THE USER AND WE EXPRESSLY DISCLAIM ALL WARRANTIES OF EVERY KIND AND NATURE, INCLUDING WARRANTIES OF MERCHANTABILITY AND FITNESS FOR A PARTICULAR PURPOSE IN RESPECT TO THE USE OR SUITABILITY OF THE PRODUCT. NOTHING IS INTENDED AS A RECOMMENDATION FOR USES WHICH INFRINGE VALID PATENTS OR AS EXTENDING LICENSE UNDER VALID PATENTS. APPROPRIATE WARNINGS AND SAFE HANDLING PROCEDURES SHOULD BE PROVIDED TO HANDLERS AND USERS.

THIS DOCUMENT OR  
COPYRIGHT FROM ANY  
SOURCE, NOR POSSESSION OF THIS DOCUMENT, CONSTITUTES SUCH PERMISSION, POSSESSION, USE, CONTROL OR DISCLOSURE BY ANYONE WITHOUT EXPRESS WRITTEN PERMISSION OF DOOSAN FUEL CELL

AMERICA CORPORATION IS NOT AUTHORIZED AND MAY RESULT IN CIVIL LIABILITY.



Attachment #6: West Haven, CT Zoning Map

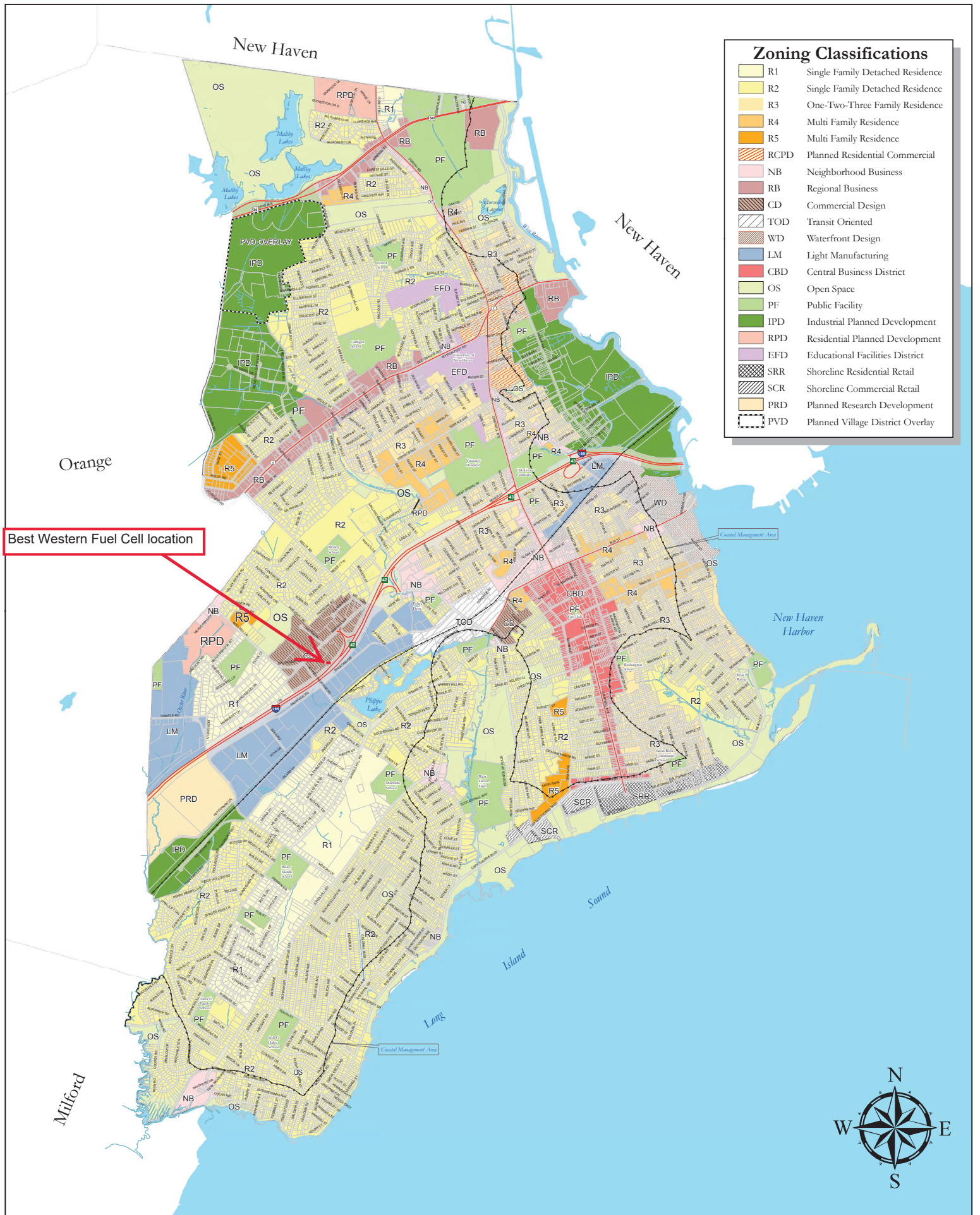

### Zoning Classifications

R1	Single Family Detached Residence
R2	Single Family Detached Residence
R3	One-Two-Three Family Residence
R4	Multi Family Residence
R5	Multi Family Residence
RCPD	Planned Residential Commercial
NB	Neighborhood Business
RB	Regional Business
CD	Commercial Design
TOD	Transit Oriented
WD	Waterfront Design
LM	Light Manufacturing
CBD	Central Business District
OS	Open Space
PF	Public Facility
IPD	Industrial Planned Development
RPD	Residential Planned Development
EFD	Educational Facilities District
SRR	Shoreline Residential Retail
SCR	Shoreline Commercial Retail
PRD	Planned Research Development
PVD	Planned Village District Overlay

Best Western Fuel Cell location

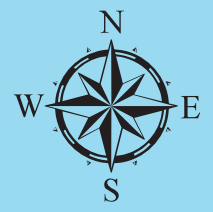





Nearest residential homes to the Best Western Hotel Fuel Cell



Attachment #7: Zoning Board and Planning and Zoning Commission Certificates of Approval



# CITY OF WEST HAVEN, CONNECTICUT

## ZONING BOARD OF APPEALS

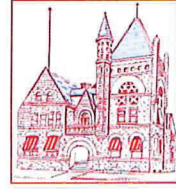

City Hall | 355 Main Street | First Floor West Haven, Connecticut 06516-0312  
Phone 203.937.3580 Fax 203.937.3742

### CERTIFICATE OF DECISION

February 24, 2021

Josh Abrams  
17 Stanton Avenue  
South Hadley, MA. 01075

**490 Saw Mill Road** Several variances to place a Fuel Cell generator and data server in the Southwest corner of the Best Western Hotel property. 1. To permit 89 parking spaces where 95 exist. 2. A side yard variance to permit 14.9' where 25' is required and, 3. A rear yard variance to permit 11.2' where 50' is required. In the CD Commercial Design district pursuant to Section 60, 20.1 of the West Haven Zoning Regulations. Owner: Eshagh Malekan / Applicant: Clear Cell Power, Inc. File# 028-21 V

**APPLICANT:** ClearCell  
**OWNER:** Eshagh Malekan  
**DATE OF MEETING:** February 17, 2021  
**FILE:** #028-21 V  
**ACTION:** Approved  
**EFFECTIVE DATE:** March 15, 2021  
**APPROVED PLAN :** Improvement Location Survey Ct Land Surveying, LLC. Prepared for Sawmill Haven, LLC. EX-1 dated 01-11-21. Clearcell Power, INC. Natural Gas Fuel Cell Generator GA1.0 - GA1.1, dated 01-18-2021  
**CONDITIONS:** None

The above referenced matter was approved on the date stated above and a Notice of Decision was published in the New Haven Register on February 26, 2021

**PLEASE NOTE Per Section 92.3.7 of the West Haven Zoning Regulations:**

**Applicant Certificate of Decision to be recorded.** An application approval shall be effective upon recording of the Certificate of Decision for the zoning relief granted in the West Haven Land Records. Any approval for which a Certificate of Decision has been issued but not recorded shall automatically be null and void.

Sincerely,

Catherine Conniff  
Assistant City Planner /Zoning Enforcement Officer/ Inland Wetlands



# CITY OF WEST HAVEN, CONNECTICUT

## Planning and Zoning Commission

City Hall | 355 Main Street | First Floor West Haven, Connecticut 06516-0312  
Phone 203.937.4202 Fax 203.937.3742  
CITY HALL 1898-1967

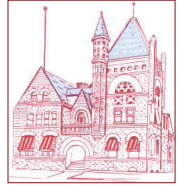

### CERTIFICATE OF DECISION

March 4, 2021

Eshagh Malekan  
111 E. Jericho Turnpike  
Mineola, NY. 11501

**490 Sawmill Road** – Special Permit and Site Plan Review applications to install a Fuel Cell Generator and Data Server at the Best Western Hotel. Owner: Eshagh Malekan Applicant: ClearCell Power, Inc. File # SP 21-05, SR 21-06

**APPLICANT:** ClearCell Power, Inc.  
**OWNER:** Eshagh Malekan  
**DATE OF MEETING:** February 23, 2021  
**FILE:** SP 21-05, SR 21-06  
**ACTION:** Approved  
**EFFECTIVE DATE:** March 15, 2021  
**APPROVED PLANS:** Improvement Location Survey drawn by CT land Surveying, LLC EX-1 dated 12/25/20, Clearcell Power, INC Natural Gas Fuel Cell Generator General Arrangement and Elevation, drawn by Innovative Construction & Design Solutions, LLC, GA1.0-GA1.1, dated 01/18/2021

The above referenced matter was approved on the date stated above and a Notice of Decision was published in the New Haven Register on March 5, 2021

**PLEASE NOTE, Per Section 92.3.7 of the West Haven Zoning Regulations:**

**Applicant Certificate of Decision to be recorded.** An application approval shall be effective upon recording of the Certificate of Decision for the zoning relief granted **in the West Haven Land Records.** **Any approval for which a Certificate of Decision has been issued but not recorded shall automatically be null and void.**

Sincerely,  
Catherine Conniff  
Assistant City Planner

**From:** Frank Gladwin

**Sent:** Sunday, February 7, 2021 3:54 PM

**To:** Cathy Conniff <[conniff@westhaven-ct.gov](mailto:conniff@westhaven-ct.gov)>

**Cc:** Kimberly L. Leindorf <[leindorf@westhaven-ct.gov](mailto:leindorf@westhaven-ct.gov)>; Lloyd Adams <[ladams@westhaven-ct.gov](mailto:ladams@westhaven-ct.gov)>

**Subject:** 490 SMRd Site Plan Review (Fuel Cell)

Cathy, I have provided by comments for the Site Plan Review for the proposed Fuel Cell at 490 SMRd see below:

1. Clarify the distance of the fence from the south and west lot line--see the attached updated survey 2-8-2021 REV-490 SAW MILL for added dimension.
2. Clarify the catch basin water discharge: the catch basin is to allow site drainage under the fuel cell pad to the existing point of discharge. The size and details will be address during design phase.
3. Clarify emergency access to the fuel cell, any fire lanes? A knox box can be provided to allow access to disc. switch MD-1. There will be no change to the exiting fire lanes.
4. What is the status of the CT Siting Council? In process of filing
5. Clarify the type transformer located inside the fence between the fuel cell and the DATA Server Container, (liquid filled or dry type)? The 300 kva dry type transformer is to supply required operation voltage for the Data server. Cut sheets will be part of the submittal phase.

Please contact the WHBD at 203-937-3590 if you have any questions regarding this matter.

**Special Permit Criteria**

85.4.1 The principal vehicular access for such **use** is not located on a minor street (local), but is located on an arterial street or collector street within one-quarter mile of an arterial street. \_\_\_\_\_  
*The generator is located in the rear parking area off of Saw Mill Road* \_\_\_\_\_  
\_\_\_\_\_  
\_\_\_\_\_

85.4.2 Such **use** is so located as to draw a minimum of vehicular traffic to and through local streets within any surrounding residential development. \_\_\_\_\_  
*It is not near a residential development* \_\_\_\_\_  
\_\_\_\_\_  
\_\_\_\_\_

85.4.3 The architectural and landscaping treatment of such **use** will blend harmoniously with the rest of the area. \_\_\_\_\_  
*Yes-the green slates screen in the fence and the ground cover will blend in with the surrounding environment.* \_\_\_\_\_  
\_\_\_\_\_  
\_\_\_\_\_

85.4.4 Provisions have been made to minimize any disturbances or nuisance to surrounding properties arising out of the creation of such **use**, including the provision of landscaped screens and buffers. \_\_\_\_\_  
*The green slate screen surrounding the units and the siting in the corner closest to the I-95 with plantings and ground cover to blend in with surroundings* \_\_\_\_\_  
\_\_\_\_\_  
\_\_\_\_\_

85.5.5 Reservoir space at vehicular entrances and exits are provided to prevent traffic congestion and vehicular entrances and exits for

such **use** are separately provided. \_\_\_\_\_ Once installed, there will only be biweekly maintenance checks. \_\_\_\_\_

85.4.6 Provision is made with respect to drainage, outside lighting or illumination and signs so as to minimize any adverse effect on the character of the surrounding area.

\_\_\_\_\_ Providing a catch basin which directs flow under the new concrete pad and directly to the existing outflow area; Only one light internal to fence area for safety. \_\_\_\_\_

85.4.7 Provision is made with respect to requirements for soundproofing, construction of fences, barriers, or other safety devices.

\_\_\_\_\_ Safety: bollards to be located around the fence area to protect from wayward vehicles. Fencing and screen slates to keep general public from work area—there are no moving parts and we have these near schools and offices without fencing. \_\_\_\_\_



Attachment #8: California Air Resources Board Emission Certification



**State of California  
AIR RESOURCES BOARD**

**Executive Order DG-040-A**

**Distributed Generation Certification of  
Doosan Fuel Cell America Corporation  
440 kW PureCell® System Model 400**

WHEREAS, the Air Resources Board (ARB) was given the authority under California Health and Safety Code section 41514.9 to establish a statewide Distributed Generation (DG) Certification Program to certify electrical generation technologies that are exempt from the permit requirements of air pollution control or air quality management districts;

WHEREAS, this DG Certification does not constitute an air pollution permit or eliminate the responsibility of the end user to comply with all federal, state, and local laws, rules and regulations;

WHEREAS, UTC Power Corporation applied for a DG Certification of its 440 kW PureCell® System Model 400 fuel cell and whose application was deemed complete on December 10, 2012;

WHEREAS, UTC Power Corporation was issued DG Certificate DG-040 on December 26, 2012, for its 440 kW PureCell® System Model 400 fuel cell;

WHEREAS, UTC Power Corporation had demonstrated, according to test methods specified in California Code of Regulations (CCR), title 17, §94207, that its natural-gas-fueled 440 kW PureCell® System Model 400 has complied with the following emission standards:

1. Emissions of oxides of nitrogen no greater than 0.07 pounds per megawatt-hour;
2. Emissions of carbon monoxide no greater than 0.10 pounds per megawatt-hour; and
3. Emissions of volatile organic compounds no greater than 0.02 pounds per megawatt-hour.

WHEREAS, UTC Power Corporation had demonstrated that its 440 kW PureCell® System Model 400 fuel cell complies with the emissions durability requirements in CCR, title 17, §94207(d);

WHEREAS, UTC Power, a division of United Technologies Corporation, sold its fuel cell operation to ClearEdge Power, Inc. Subsequently, ClearEdge Power Inc. declared bankruptcy and Doosan Corporation purchased the assets of ClearEdge Power on July 2014, and re-organization into Doosan Fuel Cell

America; wherein it was noted that no material changes to model form, fit, or function were made;

WHEREAS, on February 13, 2017, Doosan Fuel Cell America applied for a change in ownership for the 440 kW PureCell® System Model 400;

WHEREAS, Doosan Fuel Cell America, Corporation was issued DG Certificate DG-040-A on April 26, 2017, for its 440 kW PureCell® System Model 400 fuel cell;

WHEREAS, Doosan Fuel Cell America, Corporation applied for recertification of its DG certificate for the 440 kW PureCell® System Model 400 fuel cell and whose application was deemed complete on December 22, 2017; and

WHEREAS, I find that the Applicant, Doosan Fuel Cell America, has met the requirements specified in CCR, title 17, article 3, Distributed Generation Certification Program and has satisfactorily demonstrated that the 440 kW PureCell® System Model 400 fuel cell meets the DG Certification Regulation 2007 Fossil Fuel Emission Standards.

NOW THEREFORE, IT IS HEREBY ORDERED, that a DG Certification, Executive Order DG-040-A, is hereby extended.

This DG Certification:

- 1) Is subject to all conditions and requirements of CCR, title 17, article 3, Distributed Generation Certification Program, including the provisions relating to inspection, denial, suspension, and revocation;
- 2) Shall be void if any manufacturer's modification results in an increase in emissions or changes the efficiency or operating conditions of a model, such that the model no longer meets the 2007 DG Certification emission standards; and
- 3) Shall expire on the 26th day of December 2022.

Executed at Sacramento, California, this 24th day of January 2018.

/S/

Floyd V. Vergara, Esq., P.E.  
Chief, Industrial Strategies Division

































Attachment #9: West Haven DEEP Diversity Database Areas Map/ DEP Wetland Soils

# NATURAL DIVERSITY DATA BASE AREAS

## WEST HAVEN, CT

### LEGEND

-  State and Federal Listed Species
-  Critical Habitat
-  State Boundary
-  County Boundary
-  Town Boundary
-  Interstate
-  US Route
-  State Route
-  Ramp
-  Street
-  Ferry
-  Railroad
-  Watercourse
-  Intermittent Watercourse
-  Shore
-  Drainage Ditch
-  Dam
-  Dredged Channel
-  Aqueduct
-  Water
-  Intermittent Water
-  Flats
-  Rocks
-  Inundated Area
-  Marsh
-  Cranberry Bog
-  Dam
-  Fish Hatchery
-  Aqueduct
-  Sewage Pond
-  Water Tank

### EXPLANATION

This map depicts general locations of state and federal listed species and critical habitats. The map is intended to be used as a pre-screening tool to determine the potential for impacts on state listed species and the need for a Natural Diversity Data Base review. To use the map, locate the project boundaries and any additional affected areas on the map. If the project is within a shaded area there may be a potential conflict with a listed species or natural community. For more information complete a Request for Natural Diversity Data Base State Listed Species Review form (DEP-APP-007) and submit to the Natural Diversity Data Base along with the required maps and information. More detailed instructions are available along with the request form on the Department of Energy and Environmental Protection (DEEP) webpage: [www.ct.gov/deep/addressrequest](http://www.ct.gov/deep/addressrequest)

Use the CTECO Interactive Map Viewers at <http://cteco.scom.edu> to more precisely search for and locate sites and to view NDDDB Areas with aerial imagery.  
Date of Map: December 2020  
Natural Diversity Data Base Digital Data  
For more information about State Listed Species, contact DEEP, Bureau of Natural Resources, Wildlife Division, email: [deep.addressrequest@ct.gov](mailto:deep.addressrequest@ct.gov) Tel: 860-424-3011

### DATA SOURCES

**\*NDDDB Information** - Locations of state and federal listed species and critical habitats are based on data collected by the Connecticut Department of Energy & Environmental Protection, private conservation groups and the scientific community and compiled by the Natural Diversity Data Base (NDDDB). The information is not necessarily the result of comprehensive or site-specific field investigations; in some cases locations have been derived from literature or museum searches or historic records. Exact locations have been buffered to produce generalized locations. The exact species or community location falls somewhere within the shaded area and not necessarily in the center. Information on this map does not include National Area Preserves, designated wetland areas or wildlife concentration areas.

**BASE MAP DATA** - Based on data originally from 1:24,000-scale USGS 7.5 minute topographic quadrangle maps published between 1969 and 1992; it includes political boundaries, railroads, airports, hydrography, geographic names and geographic places. Streets and street names are from Tele Atlas copyrighted data. Base map information is neither current nor complete.

**RELATED INFORMATION**  
This map is intended to be printed at its original dimensions in order to maintain the 1:24,000 scale (1 inch = 2000 feet).

**MAPS AND DIGITAL DATA** - Visit the CT ECO website ([www.cteco.scom.edu](http://www.cteco.scom.edu)) for this map and a variety of others. Visit the DEEP website ([www.ct.gov/deep](http://www.ct.gov/deep)) to download the base map digital spatial data shown on this map.



State Plane Coordinate System of 1983, Zone 1558  
Latitude: Continental Geoid Heights  
North American Datum of 1983

Map prepared by CT DEEP  
Map is not suitable  
Project Street light and signage



Best Western  
Fuel Cell Location

Location for Fuel Cell: 490 Saw Mill Road, West Haven, CT

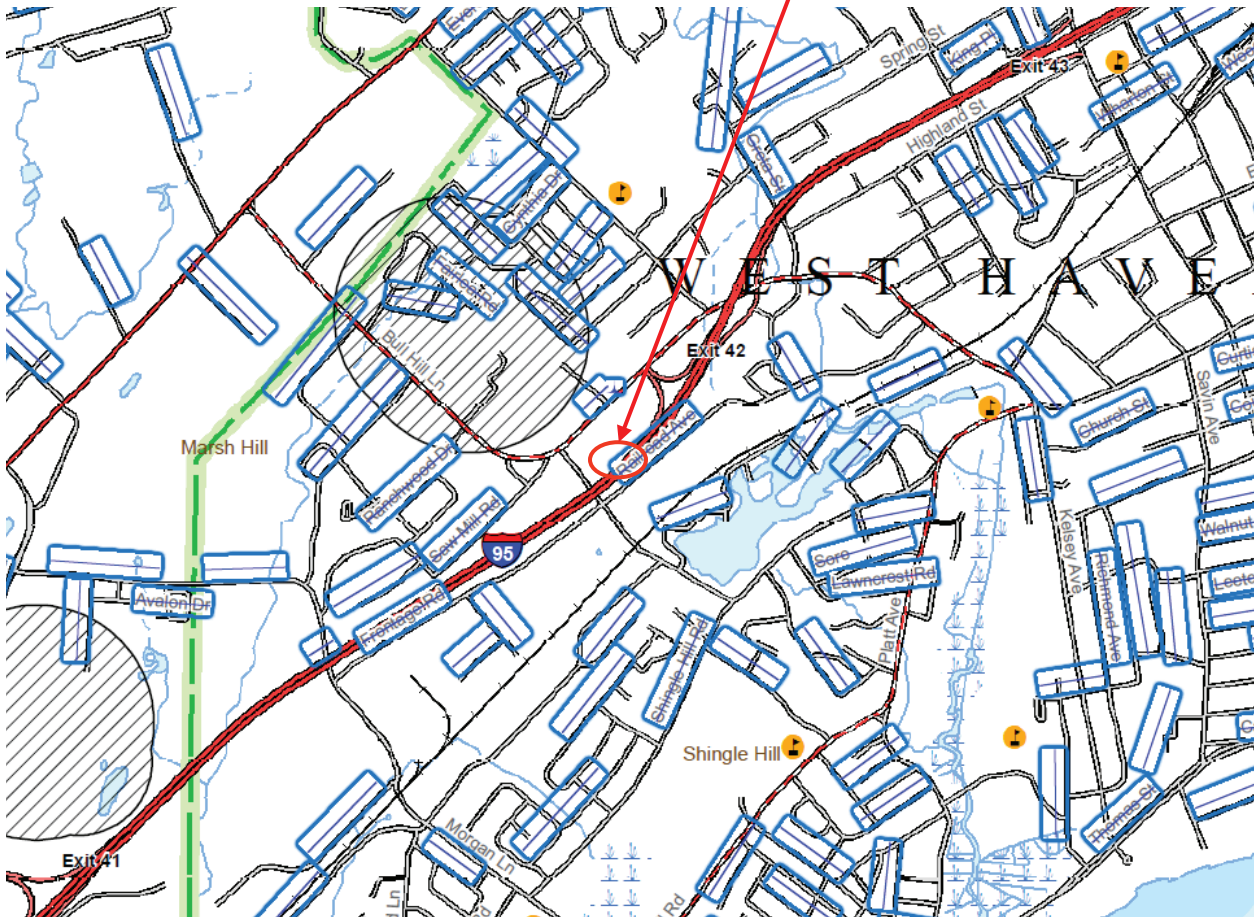

Enlargement of the Natural Diversity Data Base Map-West Haven, CT



# City of West Haven, Connecticut DEP Wetland Soils

**Best Western  
Fuel Cell  
location**



**DEP Wetland Soils**

- Wetlands





Attachment #10: Notification Letter, Abutters Map--Certified Mail Receipts



March 27, 2021

**RE: Petition of ClearCell Power, Inc. for a declaratory ruling for the location and construction of a 0.46 Megawatt Fuel Cell customer-side distributed energy resource at 490 Saw Mill Road, West Haven, Connecticut**

Dear Recipient:

Pursuant to Section 16-50j-40 of the Connecticut Siting Council's (the "Council") Rules of Practice, we are notifying you that ClearCell Power, Inc. intends to file a petition for declaratory ruling with the Connecticut Siting Council ("Council") on or about March 27, 2021. The petition will request the Council's approval to install one (1) 460 kW fuel cell and ancillary equipment in support of a customer-sided, distributed generation project at 490 Saw Mill Road, West Haven, CT 061010. The fuel cell will be powered by natural gas, and the generated electricity will be consumed on-site. If there is any excess electricity generated, as agreed upon with United Illuminating Co., the power will be distributed to the grid.

The fuel cell's proposed placement is located in the Best Western hotel parking lot in the southern corner closest to the I-95. The proposed fuel cell plant will be approximately 29 feet long, 8 feet wide, and 10 feet high. Some ancillary equipment, such as the cooling module, will be installed on the fuel cell roof to minimize the installation's footprint.

Should you have any questions, concerns, or require additional information, please contact any of the following:

**ClearCell Power, Inc.**  
C/O Ai-Builders-New England, LLC  
Josh Abrams  
413-388-3805  
[AiBuildersNE@gmail.com](mailto:AiBuildersNE@gmail.com)

**Connecticut Siting Council**  
10 Franklin Square  
New Britain, CT 06051  
860-827-2935

Sincerely,

ClearCell Power, Inc.  
Josh Abrams  
(413) 388-3805  
[AiBuildersNE@gmail.com](mailto:AiBuildersNE@gmail.com)



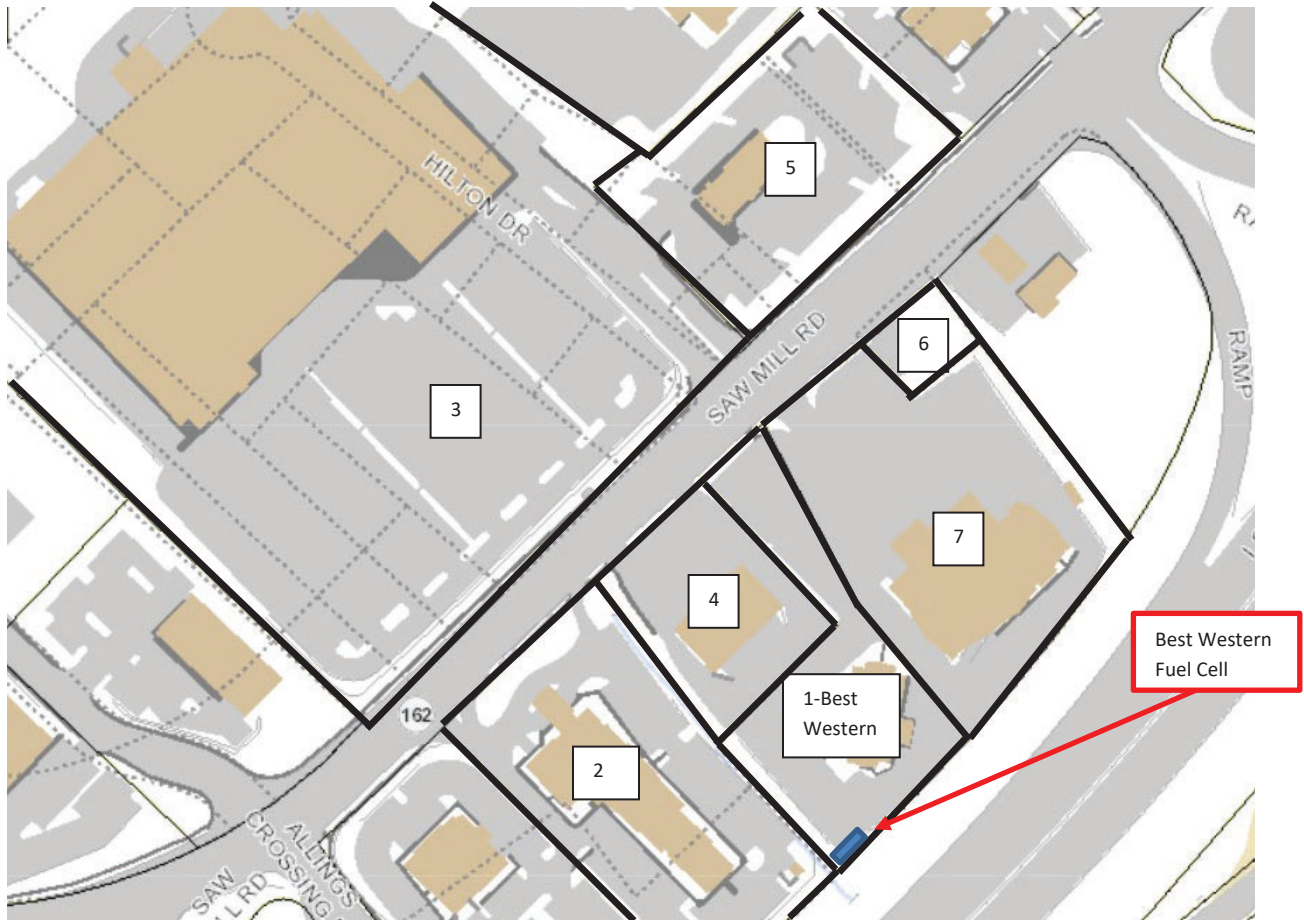

Abutters to Best Western, 490 Saw Mill Road, West Haven, CT

033-0014--0-0000  
 BEST WESTERN  
 111 E JERIKO TURNPIKE  
 MINEOLA, NY 11501

[Map #1]

033-0012-0-0000  
 WEST HAVEN MALL, LLC  
 2321 KENNEDY BLVD  
 NORTH BERGEN, NJ 07047

[Map #6]

032-0067-0-0000  
 MCR NEW HAVEN LLC  
 510 SAWMILL RD  
 WEST HAVEN, CT 06516

[Map #2]

033-0013-0-0000  
 WEST HAVEN MALL LLC  
 PO BOX 5200  
 WEEHAWKEN, NJ 070S6

[Map #7]

032-0039--0--0000  
 WAL-MART REAL ESTATE BUSINESS  
 PO BOX 8050 MS0555  
 BENTONVILLE AR 72712

[Map #3]

032-0066-0--0000  
 FIVE HUNDRED TWO SAW MILL ASSOC  
 PO BOX 4797  
 STAMFORD CT 06907

[Map #4]

032--0039-0-0008  
 MCDONALDS USA LLC  
 ONE MCDONALDS PLAZA  
 OAKBROOK IL 60523

[Map #5]



Name and Address of Sender  
ClearCell Power, Inc.  
C/O Ai Builders-New England, LLC  
17 Stanton Avenue,  
South Hadley, MA 01075

- Check type of mail or service
- Adult Signature Required
  - Adult Signature Restricted Delivery
  - Certified Mail
  - Certified Mail Restricted Delivery
  - Collect on Delivery (COD)
  - Insured Mail
  - Priority Mail
  - Priority Mail Express
  - Registered Mail
  - Return Receipt for Merchandise
  - Signature Confirmation
  - Signature Confirmation Restricted Delivery

Affix  
(for additional postage)



U.S. POSTAGE PAID  
SOUTH HADLEY, MA  
01075  
MAR 30, 21  
AMOUNT  
**\$1.55**  
R2305K134567-01

USPS Tracking/Article Number

Addressee (Name, Street, City, State, & ZIP Code™)

Postage

1.

032-0039--0-0000  
WAL-MART REAL ESTATE BUSINESS  
PO BOX 8050 MS0555  
Bentonville, AR 72712



U.S. POSTAGE PAID  
SOUTH HADLEY, MA  
01075  
MAR 30, 21  
AMOUNT  
**\$1.55**  
R2305K134567-01

2.

033-0012-0-0000  
WEST HAVEN MALL, LLC  
2321 KENNEDY BLVD  
NORTH BERGEN, NJ 07047



U.S. POSTAGE PAID  
SOUTH HADLEY, MA  
01075  
MAR 30, 21  
AMOUNT  
**\$1.55**  
R2305K134567-01

3.

032--0039-0-0008  
MCDONALDS USA LLC  
ONE MCDONALDS PLAZA  
OAKBROOK IL 60523



U.S. POSTAGE PAID  
SOUTH HADLEY, MA  
01075  
MAR 30, 21  
AMOUNT  
**\$1.55**  
R2305K134567-01

4.

032-0066-0-0000  
FIVE HUNDRED TWO SAW MILL ASSOC  
PO BOX 4797  
STAMFORD CT 06907



U.S. POSTAGE PAID  
SOUTH HADLEY, MA  
01075  
MAR 30, 21  
AMOUNT  
**\$1.55**  
R2305K134567-01

5.

033-0013-0-0000  
WEST HAVEN MALL LLC  
PO BOX 5200  
WEEHAWKEN, NJ 07056 07086



U.S. POSTAGE PAID  
SOUTH HADLEY, MA  
01075  
MAR 30, 21  
AMOUNT  
**\$1.55**  
R2305K134567-01

6.

032-0067-0-0000  
MCR NEW HAVEN LLC  
510 SAWMILL RD  
WEST HAVEN, CT 06516



7.

033-0014--0-0000  
Best Western  
111 E JERIKO TURNPIKE  
MINEOLA, NY 11501

8.

Postmaster, Per (Name of receiving employee)

Total Number of Pieces Listed by Sender 8

Total Number of Pieces Received at Post Office 8

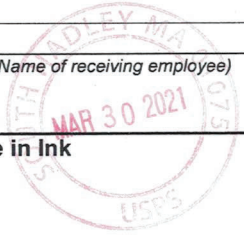

Complete in Ink

Privacy No

U.S. POSTAGE PAID  
SOUTH HADLEY, MA  
01075  
MAR 30, 21  
AMOUNT  
**\$1.55**  
R2305K134567-01



U.S. POSTAGE PAID  
SOUTH HADLEY, MA  
01075  
MAR 30, 21  
AMOUNT  
**\$1.55**  
R2305K134567-01



7019 2280 0001 3493 9882

# U.S. Postal Service™ CERTIFIED MAIL® RECEIPT

Domestic Mail Only

For delivery information, visit our website at [www.usps.com](http://www.usps.com)®.

Bentonville, AR 72712

Certified Mail Fee	\$3.60
Extra Services & Fees (check box, add fee as appropriate)	\$0.00
<input type="checkbox"/> Return Receipt (hardcopy)	\$0.00
<input type="checkbox"/> Return Receipt (electronic)	\$0.00
<input type="checkbox"/> Certified Mail Restricted Delivery	\$0.00
<input type="checkbox"/> Adult Signature Required	\$0.00
<input type="checkbox"/> Adult Signature Restricted Delivery	\$0.00

Postage \$0.55

Total \$4.15  
032-0039-0-0000  
WAL-MART REAL ESTATE BUSINESS  
PO BOX 8050 MS0555  
Bentonville, AR 72712

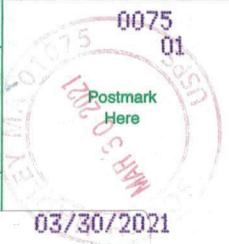

PS Form 3800, April 2015 PSN 7530-02-000-9047 See Reverse for Instructions

7019 2280 0001 3493 9899

# U.S. Postal Service™ CERTIFIED MAIL® RECEIPT

Domestic Mail Only

For delivery information, visit our website at [www.usps.com](http://www.usps.com)®.

North Bergen, NJ 07047

Certified Mail Fee	\$3.60
Extra Services & Fees (check box, add fee as appropriate)	\$0.00
<input type="checkbox"/> Return Receipt (hardcopy)	\$0.00
<input type="checkbox"/> Return Receipt (electronic)	\$0.00
<input type="checkbox"/> Certified Mail Restricted Delivery	\$0.00
<input type="checkbox"/> Adult Signature Required	\$0.00
<input type="checkbox"/> Adult Signature Restricted Delivery	\$0.00

Postage \$0.55

Total \$4.15  
033-0012-0-0000  
WEST HAVEN MALL, LLC  
2321 KENNEDY BLVD  
NORTH BERGEN, NJ 07047



PS Form 3800, April 2015 PSN 7530-02-000-9047 See Reverse for Instructions

7019 2280 0001 3493 9905

# U.S. Postal Service™ CERTIFIED MAIL® RECEIPT

Domestic Mail Only

For delivery information, visit our website at [www.usps.com](http://www.usps.com)®.

Oak Brook, IL 60523

Certified Mail Fee	\$3.60
Extra Services & Fees (check box, add fee as appropriate)	\$0.00
<input type="checkbox"/> Return Receipt (hardcopy)	\$0.00
<input type="checkbox"/> Return Receipt (electronic)	\$0.00
<input type="checkbox"/> Certified Mail Restricted Delivery	\$0.00
<input type="checkbox"/> Adult Signature Required	\$0.00
<input type="checkbox"/> Adult Signature Restricted Delivery	\$0.00

Postage \$0.55

Total \$4.15  
032-0039-0-0000  
MCDONALDS USA LLC  
ONE MCDONALDS PLAZA  
OAKBROOK IL 60523

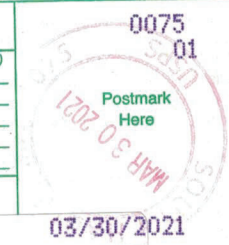

PS Form 3800, April 2015 PSN 7530-02-000-9047 See Reverse for Instructions

7019 2280 0001 3493 9912

# U.S. Postal Service™ CERTIFIED MAIL® RECEIPT

Domestic Mail Only

For delivery information, visit our website at [www.usps.com](http://www.usps.com)®.

Stamford, CT 06907

Certified Mail Fee	\$3.60
Extra Services & Fees (check box, add fee as appropriate)	\$0.00
<input type="checkbox"/> Return Receipt (hardcopy)	\$0.00
<input type="checkbox"/> Return Receipt (electronic)	\$0.00
<input type="checkbox"/> Certified Mail Restricted Delivery	\$0.00
<input type="checkbox"/> Adult Signature Required	\$0.00
<input type="checkbox"/> Adult Signature Restricted Delivery	\$0.00

Postage \$0.55

Total \$4.15  
032-0066-0-0000  
FIVE HUNDRED TWO SAW MILL ASSOC  
PO BOX 4797  
STAMFORD CT 06907



PS Form 3800, April 2015 PSN 7530-02-000-9047 See Reverse for Instructions

7019 2280 0001 3493 9929

# U.S. Postal Service™ CERTIFIED MAIL® RECEIPT

Domestic Mail Only

For delivery information, visit our website at [www.usps.com](http://www.usps.com)®.

Weehawken, NJ 07086

Certified Mail Fee	\$3.60
Extra Services & Fees (check box, add fee as appropriate)	\$0.00
<input type="checkbox"/> Return Receipt (hardcopy)	\$0.00
<input type="checkbox"/> Return Receipt (electronic)	\$0.00
<input type="checkbox"/> Certified Mail Restricted Delivery	\$0.00
<input type="checkbox"/> Adult Signature Required	\$0.00
<input type="checkbox"/> Adult Signature Restricted Delivery	\$0.00

Postage \$0.55

Total \$4.15  
033-0013-0-0000  
WEST HAVEN MALL LLC  
PO BOX 5200  
WEEHAWKEN, NJ 07086



PS Form 3800, April 2015 PSN 7530-02-000-9047 See Reverse for Instructions

7019 2280 0001 3493 9936

# U.S. Postal Service™ CERTIFIED MAIL® RECEIPT

Domestic Mail Only

For delivery information, visit our website at [www.usps.com](http://www.usps.com)®.

West Haven, CT 06516

Certified Mail Fee	\$3.60
Extra Services & Fees (check box, add fee as appropriate)	\$0.00
<input type="checkbox"/> Return Receipt (hardcopy)	\$0.00
<input type="checkbox"/> Return Receipt (electronic)	\$0.00
<input type="checkbox"/> Certified Mail Restricted Delivery	\$0.00
<input type="checkbox"/> Adult Signature Required	\$0.00
<input type="checkbox"/> Adult Signature Restricted Delivery	\$0.00

Postage \$0.55

Total \$4.15  
032-0067-0-0000  
MCR NEW HAVEN LLC  
510 SAWMILL RD  
WEST HAVEN, CT 06516



PS Form 3800, April 2015 PSN 7530-02-000-9047 See Reverse for Instructions

U.S. Postal Service™  
CERTIFIED MAIL® RECEIPT  
Domestic Mail Only

For delivery information, visit our website at [www.usps.com](http://www.usps.com)®.

Mineola, NY 11501

OFFICIAL USE

7019 2280 0001 3493 9943

Certified Mail Fee	\$3.60
Extra Services & Fees (check box, add fee as appropriate)	\$0.00
<input type="checkbox"/> Return Receipt (hardcopy)	\$0.00
<input type="checkbox"/> Return Receipt (electronic)	\$0.00
<input type="checkbox"/> Certified Mail Restricted Delivery	\$0.00
<input type="checkbox"/> Adult Signature Required	\$0.00
<input type="checkbox"/> Adult Signature Restricted Delivery	\$0.00

Postage \$0.55

Total \$4.15

033-0014-0-000  
Best Western  
111 E JERIKO TURNPIKE  
MINEOLA, NY 11501

0075  
01  
Postmark  
Here  
MAR 30 2021  
03/30/2021



Attachment #11: West Haven and Connecticut State Officials-Certified Mail Receipts



Name and Address of Sender  
ClearCell Power, Inc.  
C/O Ai Builders-New England, LLC  
17 Stanton Avenue,  
South Hadley, MA 01075

- Check type of mail or service
- Adult Signature Required
  - Adult Signature Restricted Delivery
  - Certified Mail
  - Certified Mail Restricted Delivery
  - Collect on Delivery (COD)
  - Insured Mail
  - Priority Mail
  - Priority Mail Express
  - Registered Mail
  - Return Receipt for Merchandise
  - Signature Confirmation
  - Signature Confirmation Restricted Delivery



0000

U.S. POSTAGE PAID  
SOUTH HADLEY, MA  
01075  
MAR 30, 21  
AMOUNT  
**\$1.55**  
R2305K134567-01

U.S. POSTAGE PAID  
SOUTH HADLEY, MA  
01075  
MAR 30, 21  
AMOUNT

USPS Tracking/Article Number

Addressee (Name, Street, City, State, & ZIP Code™)

1.

United State Senator  
Richard Blumenthal  
State House Square  
Hartford, CT 06103



0000

U.S. POSTAGE PAID  
SOUTH HADLEY, MA  
01075  
MAR 30, 21  
AMOUNT  
**\$1.55**  
R2305K134567-01

2.

United State Senator  
Chris Murphy  
One Constitution Plaza, 7th Floor  
Hartford, CT 06103

3.

United States Congressman  
Rosa L. Delauro-Congress Woman  
59 Elm Street  
New Haven, CT 06106



0000

U.S. POSTAGE PAID  
SOUTH HADLEY, MA  
01075  
MAR 30, 21  
AMOUNT  
**\$1.55**  
R2305K134567-01



4.

State Senate James Maroney  
Legislative Office Building  
Room 2000  
Hartford, CT 06106-1591

5.

State Senate Gary Winfield  
Senate District 10  
Legislative Office Building  
Room 2500  
Hartford, CT 06106-1591



0000

U.S. POSTAGE PAID  
SOUTH HADLEY, MA  
01075  
MAR 30, 21  
AMOUNT  
**\$1.55**  
R2305K134567-01

U.S. POSTAGE PAID  
SOUTH HADLEY, MA  
01075  
MAR 30, 21  
AMOUNT

6.

State House Charles Ferraro-Representative  
House District 117  
Legislative Office Building, Room 4200  
300 Capitol Avenue  
Hartford, CT 06106

7.

State House Dorinda Borer-Representative  
House District 115  
Legislative Office Building, Room 3201  
Hartford, CT 06106-1591



0000

U.S. POSTAGE PAID  
SOUTH HADLEY, MA  
01075  
MAR 30, 21  
AMOUNT  
**\$1.55**  
R2305K134567-01



8.

William Tong, Attorney General  
Office of the Attorney General  
165 Capital Avenue  
Hartford, CT 06106



0000

U.S. POSTAGE PAID  
SOUTH HADLEY, MA  
01075  
MAR 30, 21  
AMOUNT  
**\$1.55**  
R2305K134567-01

Total Number of Pieces Listed by Sender

Total Number of Pieces Received at Post Office

Postmaster, Per (Name of receiving employee)

8

8

*[Signature]*

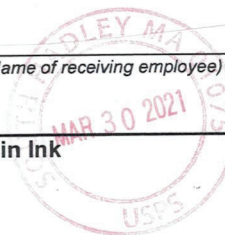

Complete in Ink

Privac

7019 2280 0001 3493 9622

**U.S. Postal Service™**  
**CERTIFIED MAIL® RECEIPT**  
*Domestic Mail Only*

For delivery information, visit our website at [www.usps.com](http://www.usps.com)®.

Hartford, CT 06103

**OFFICIAL USE**

Certified Mail Fee	\$3.60
Extra Services & Fees (check box, add fee as appropriate)	\$0.00
<input type="checkbox"/> Return Receipt (hardcopy)	\$0.00
<input type="checkbox"/> Return Receipt (electronic)	\$0.00
<input type="checkbox"/> Certified Mail Restricted Delivery	\$0.00
<input type="checkbox"/> Adult Signature Required	\$0.00
<input type="checkbox"/> Adult Signature Restricted Delivery	\$0.00
Postage	\$0.55
<b>Total</b>	<b>\$4.15</b>

Postmark Here  
 MAR 30 2021 0075 01  
 03/30/2021

United State Senator  
 Richard Blumenthal  
 State House Square  
 Hartford, CT 06103

PS Form 3800, April 2015 PSN 7530-02-000-9047 See Reverse for Instructions

7019 2280 0001 3493 9653

**U.S. Postal Service™**  
**CERTIFIED MAIL® RECEIPT**  
*Domestic Mail Only*

For delivery information, visit our website at [www.usps.com](http://www.usps.com)®.

Hartford, CT 06106

**OFFICIAL USE**

Certified Mail Fee	\$3.60
Extra Services & Fees (check box, add fee as appropriate)	\$0.00
<input type="checkbox"/> Return Receipt (hardcopy)	\$0.00
<input type="checkbox"/> Return Receipt (electronic)	\$0.00
<input type="checkbox"/> Certified Mail Restricted Delivery	\$0.00
<input type="checkbox"/> Adult Signature Required	\$0.00
<input type="checkbox"/> Adult Signature Restricted Delivery	\$0.00
Postage	\$0.55
<b>Total</b>	<b>\$4.15</b>

Postmark Here  
 MAR 30 2021 0075 01  
 03/30/2021

State Senate James Maroney  
 Legislative Office Building  
 Room 2000  
 Hartford, CT 06106-1591

PS Form 3800, April 2015 PSN 7530-02-000-9047 See Reverse for Instructions

7019 2280 0001 3493 9639

**U.S. Postal Service™**  
**CERTIFIED MAIL® RECEIPT**  
*Domestic Mail Only*

For delivery information, visit our website at [www.usps.com](http://www.usps.com)®.

Hartford, CT 06103

**OFFICIAL USE**

Certified Mail Fee	\$3.60
Extra Services & Fees (check box, add fee as appropriate)	\$0.00
<input type="checkbox"/> Return Receipt (hardcopy)	\$0.00
<input type="checkbox"/> Return Receipt (electronic)	\$0.00
<input type="checkbox"/> Certified Mail Restricted Delivery	\$0.00
<input type="checkbox"/> Adult Signature Required	\$0.00
<input type="checkbox"/> Adult Signature Restricted Delivery	\$0.00
Postage	\$0.55
<b>Total</b>	<b>\$4.15</b>

Postmark Here  
 MAR 30 2021 0075 01  
 03/30/2021

United State Senator  
 Chris Murphy  
 One Constitution Plaza, 7th Floor  
 Hartford, CT 06103

PS Form 3800, April 2015 PSN 7530-02-000-9047 See Reverse for Instructions

7019 2280 0001 3493 9660

**U.S. Postal Service™**  
**CERTIFIED MAIL® RECEIPT**  
*Domestic Mail Only*

For delivery information, visit our website at [www.usps.com](http://www.usps.com)®.

Hartford, CT 06106

**OFFICIAL USE**

Certified Mail Fee	\$3.60
Extra Services & Fees (check box, add fee as appropriate)	\$0.00
<input type="checkbox"/> Return Receipt (hardcopy)	\$0.00
<input type="checkbox"/> Return Receipt (electronic)	\$0.00
<input type="checkbox"/> Certified Mail Restricted Delivery	\$0.00
<input type="checkbox"/> Adult Signature Required	\$0.00
<input type="checkbox"/> Adult Signature Restricted Delivery	\$0.00
Postage	\$0.55
<b>Total</b>	<b>\$4.15</b>

Postmark Here  
 MAR 30 2021 0075 01  
 03/30/2021

State Senate Gary Winfield  
 Senate District 10  
 Legislative Office Building  
 Room 2500  
 Hartford, CT 06106-1591

PS Form 3800, April 2015 PSN 7530-02-000-9047 See Reverse for Instructions

7019 2280 0001 3493 9646

**U.S. Postal Service™**  
**CERTIFIED MAIL® RECEIPT**  
*Domestic Mail Only*

For delivery information, visit our website at [www.usps.com](http://www.usps.com)®.

Hartford, CT 06106

**OFFICIAL USE**

Certified Mail Fee	\$3.60
Extra Services & Fees (check box, add fee as appropriate)	\$0.00
<input type="checkbox"/> Return Receipt (hardcopy)	\$0.00
<input type="checkbox"/> Return Receipt (electronic)	\$0.00
<input type="checkbox"/> Certified Mail Restricted Delivery	\$0.00
<input type="checkbox"/> Adult Signature Required	\$0.00
<input type="checkbox"/> Adult Signature Restricted Delivery	\$0.00
Postage	\$0.55
<b>Total</b>	<b>\$4.15</b>

Postmark Here  
 MAR 30 2021 0075 01  
 03/30/2021

United States Congressman  
 Rosa L. Delauro-Congress Woman  
 59 Elm Street  
 New Haven, CT 06106

PS Form 3800, April 2015 PSN 7530-02-000-9047 See Reverse for Instructions

7019 2280 0001 3493 9677

**U.S. Postal Service™**  
**CERTIFIED MAIL® RECEIPT**  
*Domestic Mail Only*

For delivery information, visit our website at [www.usps.com](http://www.usps.com)®.

Hartford, CT 06106

**OFFICIAL USE**

Certified Mail Fee	\$3.60
Extra Services & Fees (check box, add fee as appropriate)	\$0.00
<input type="checkbox"/> Return Receipt (hardcopy)	\$0.00
<input type="checkbox"/> Return Receipt (electronic)	\$0.00
<input type="checkbox"/> Certified Mail Restricted Delivery	\$0.00
<input type="checkbox"/> Adult Signature Required	\$0.00
<input type="checkbox"/> Adult Signature Restricted Delivery	\$0.00
Postage	\$0.55
<b>Total</b>	<b>\$4.15</b>

Postmark Here  
 MAR 30 2021 0075 01  
 03/30/2021

State House Charles Ferraro-Representative  
 House District 117  
 Legislative Office Building, Room 4200  
 300 Capitol Avenue  
 Hartford, CT 06106

PS Form 3800, April 2015 PSN 7530-02-000-9047 See Reverse for Instructions

7019 2280 0001 3493 9684

U.S. Postal Service™  
CERTIFIED MAIL® RECEIPT  
Domestic Mail Only

For delivery information, visit our website at [www.usps.com](http://www.usps.com)®.

Hartford, CT 06106

OFFICIAL USE

Certified Mail Fee	\$3.60
Extra Services & Fees (check box, add fee as appropriate)	\$0.00
<input type="checkbox"/> Return Receipt (hardcopy)	\$0.00
<input type="checkbox"/> Return Receipt (electronic)	\$0.00
<input type="checkbox"/> Certified Mail Restricted Delivery	\$0.00
<input type="checkbox"/> Adult Signature Required	\$0.00
<input type="checkbox"/> Adult Signature Restricted Delivery	\$0.00

Postage \$0.55

Total \$4.15



Sent State House Dorinda Borer-Representative  
House District 115  
Legislative Office Building, Room 3201  
Hartford, CT 06106-1591

PS Form 3800, April 2015 PSN 7530-02-000-9047 See Reverse for Instructions

7019 2280 0001 3493 9691

U.S. Postal Service™  
CERTIFIED MAIL® RECEIPT  
Domestic Mail Only

For delivery information, visit our website at [www.usps.com](http://www.usps.com)®.

Hartford, CT 06106

OFFICIAL USE

Certified Mail Fee	\$3.60
Extra Services & Fees (check box, add fee as appropriate)	\$0.00
<input type="checkbox"/> Return Receipt (hardcopy)	\$0.00
<input type="checkbox"/> Return Receipt (electronic)	\$0.00
<input type="checkbox"/> Certified Mail Restricted Delivery	\$0.00
<input type="checkbox"/> Adult Signature Required	\$0.00
<input type="checkbox"/> Adult Signature Restricted Delivery	\$0.00

Postage \$0.55

Total \$4.15



Sent William Tong, Attorney General  
Office of the Attorney General  
165 Capital Avenue  
Hartford, CT 06106

PS Form 3800, April 2015 PSN 7530-02-000-9047 See Reverse for Instructions





Firm Mailing Book For Accountable

Name and Address of Sender  
 ClearCell Power, Inc.  
 C/O Ai Builders-New England, LLC  
 17 Stanton Avenue,  
 South Hadley, MA 01075

Check type of mail or service  
 Adult Signature Required     Priority Mail Express  
 Adult Signature Restricted Delivery     Registered Mail  
 Certified Mail     Return Receipt for Merchandise  
 Certified Mail Restricted Delivery     Signature Confirmation  
 Collect on Delivery (COD)     Signature Confirmation Restricted Delivery  
 Insured Mail  
 Priority Mail

USPS Tracking/Article Number    Addressee (Name, Street, City, State, & ZIP Code™)    F

1.	State Council on Environmental Quality Peter B. Hearn, Executive Director 79 Elm street Hartford, CT 06106
2.	State Department of Public Health Dr. Deidre S. Gifford Commissioner 410 Capitol Avenue, P.O. Box 340308, Hartford, Connecticut 06134-0308
3.	Department of Administrative Services Josh Geballe Commissioner 450 Columbus Boulevard – Suite 1101 Hartford, CT 06103
4.	Department of Labor Kurt Westby, Commissioner 200 Folly Brook Blvd Westersfield, CT 06109
5.	Department of Emergency Services and Public Protection James C. Rovella, Commissioner 1111 Country Club Road Middletown, CT 06457
6.	Department of Transportation Joseph J. Giulietti, Commissioner 2800 Berlin Turnpike, P.O. Box 317546 Newington, CT 06111
7.	Department of Planning and Development Fred A. Messore, Commissioner City Hall 355 Main Street West Haven, CT 06516
8.	

Total Number of Pieces Listed by Sender    Total Number of Pieces Received at Post Office    Postmaster, Per (Name of receiving employee)

7    7   



0000

U.S. POSTAGE PAID  
 SOUTH HADLEY, MA  
 01075  
 MAR 30, 21  
 AMOUNT  
**\$1.55**  
 R2305K134567-01



0000

U.S. POSTAGE PAID  
 SOUTH HADLEY, MA  
 01075  
 MAR 30, 21  
 AMOUNT  
**\$1.55**  
 R2305K134567-01



0000

U.S. POSTAGE PAID  
 SOUTH HADLEY, MA  
 01075  
 MAR 30, 21  
 AMOUNT  
**\$1.55**  
 R2305K134567-01



0000

U.S. POSTAGE PAID  
 SOUTH HADLEY, MA  
 01075  
 MAR 30, 21  
 AMOUNT  
**\$1.55**  
 R2305K134567-01



0000

U.S. POSTAGE PAID  
 SOUTH HADLEY, MA  
 01075  
 MAR 30, 21  
 AMOUNT  
**\$1.55**  
 R2305K134567-01

U.S. POSTAGE PAID  
 SOUTH HADLEY, MA  
 01075  
 MAR 30, 21  
 AMOUNT



U.S. POSTAGE PAID  
 SOUTH HADLEY, MA  
 01075  
 MAR 30, 21  
 AMOUNT

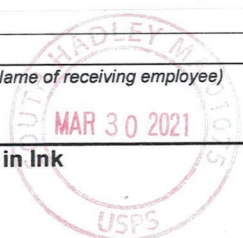

Complete in Ink

Privacy Notice: For more information on USPS privacy policies, visit us

7019 2280 0001 3493 9783

# U.S. Postal Service™ CERTIFIED MAIL® RECEIPT

Domestic Mail Only

For delivery information, visit our website at [www.usps.com](http://www.usps.com)®.

Hartford, CT 06106

Certified Mail Fee	\$3.60
Extra Services & Fees (check box, add fee as appropriate)	\$0.00
<input type="checkbox"/> Return Receipt (hardcopy)	\$0.00
<input type="checkbox"/> Return Receipt (electronic)	\$0.00
<input type="checkbox"/> Certified Mail Restricted Delivery	\$0.00
<input type="checkbox"/> Adult Signature Required	\$0.00
<input type="checkbox"/> Adult Signature Restricted Delivery	\$0.00

Postage \$0.55

Total \$4.15

Sent State Council on Environmental Quality  
Peter B. Hearn, Executive Director  
79 Elm street  
Hartford, CT 06106



03/30/2021

Instructions

7019 2280 0001 3493 9790

# U.S. Postal Service™ CERTIFIED MAIL® RECEIPT

Domestic Mail Only

For delivery information, visit our website at [www.usps.com](http://www.usps.com)®.

Hartford, CT 06134

Certified Mail Fee	\$3.60
Extra Services & Fees (check box, add fee as appropriate)	\$0.00
<input type="checkbox"/> Return Receipt (hardcopy)	\$0.00
<input type="checkbox"/> Return Receipt (electronic)	\$0.00
<input type="checkbox"/> Certified Mail Restricted Delivery	\$0.00
<input type="checkbox"/> Adult Signature Required	\$0.00
<input type="checkbox"/> Adult Signature Restricted Delivery	\$0.00

Postage \$0.55

Total \$4.15

Sent State Department of Public Health  
Dr. Deidre S. Gifford Commissioner  
410 Capitol Avenue,  
P.O. Box 340308,  
Hartford, Connecticut 06134-0308



03/30/2021

See Reverse for Instructions

7019 2280 0001 3493 9813

# U.S. Postal Service™ CERTIFIED MAIL® RECEIPT

Domestic Mail Only

For delivery information, visit our website at [www.usps.com](http://www.usps.com)®.

Westersfield, CT 06109

Certified Mail Fee	\$3.60
Extra Services & Fees (check box, add fee as appropriate)	\$0.00
<input type="checkbox"/> Return Receipt (hardcopy)	\$0.00
<input type="checkbox"/> Return Receipt (electronic)	\$0.00
<input type="checkbox"/> Certified Mail Restricted Delivery	\$0.00
<input type="checkbox"/> Adult Signature Required	\$0.00
<input type="checkbox"/> Adult Signature Restricted Delivery	\$0.00

Postage \$0.55

Total \$4.15

Sent Department of Environment  
Kurt Westby, Commissioner  
200 Folly Brook Blvd  
Westersfield, CT 06109



03/30/2021

PS Form 3800, April 2015 PSN 7530-02-000-9047 See Reverse for Instructions

7019 2280 0001 3493 9820

# U.S. Postal Service™ CERTIFIED MAIL® RECEIPT

Domestic Mail Only

For delivery information, visit our website at [www.usps.com](http://www.usps.com)®.

Middletown, CT 06457

Certified Mail Fee	\$3.60
Extra Services & Fees (check box, add fee as appropriate)	\$0.00
<input type="checkbox"/> Return Receipt (hardcopy)	\$0.00
<input type="checkbox"/> Return Receipt (electronic)	\$0.00
<input type="checkbox"/> Certified Mail Restricted Delivery	\$0.00
<input type="checkbox"/> Adult Signature Required	\$0.00
<input type="checkbox"/> Adult Signature Restricted Delivery	\$0.00

Postage \$0.55

Total \$4.15

Sent Department of Emergency Services and Public Protection  
James C. Rovella, Commissioner  
1111 Country Club Road  
Middletown, CT 06457



03/30/2021

PS Form 3800, April 2015 PSN 7530-02-000-9047 See Reverse for Instructions

7019 2280 0001 3493 9806

# U.S. Postal Service™ CERTIFIED MAIL® RECEIPT

Domestic Mail Only

For delivery information, visit our website at [www.usps.com](http://www.usps.com)®.

Hartford, CT 06103

Certified Mail Fee	\$3.60
Extra Services & Fees (check box, add fee as appropriate)	\$0.00
<input type="checkbox"/> Return Receipt (hardcopy)	\$0.00
<input type="checkbox"/> Return Receipt (electronic)	\$0.00
<input type="checkbox"/> Certified Mail Restricted Delivery	\$0.00
<input type="checkbox"/> Adult Signature Required	\$0.00
<input type="checkbox"/> Adult Signature Restricted Delivery	\$0.00

Postage \$0.55

Total \$4.15

Sent Department of Administrative Services  
Josh Geballe Commissioner  
450 Columbus Boulevard - Suite 1101  
Hartford, CT 06103



03/30/2021

See Reverse for Instructions

7019 2280 0001 3493 9837

# U.S. Postal Service™ CERTIFIED MAIL® RECEIPT

Domestic Mail Only

For delivery information, visit our website at [www.usps.com](http://www.usps.com)®.

Newington, CT 06111

Certified Mail Fee	\$3.60
Extra Services & Fees (check box, add fee as appropriate)	\$0.00
<input type="checkbox"/> Return Receipt (hardcopy)	\$0.00
<input type="checkbox"/> Return Receipt (electronic)	\$0.00
<input type="checkbox"/> Certified Mail Restricted Delivery	\$0.00
<input type="checkbox"/> Adult Signature Required	\$0.00
<input type="checkbox"/> Adult Signature Restricted Delivery	\$0.00

Postage \$0.55

Total \$4.15

Sent Department of Transportation  
Joseph J. Giulietti, Commissioner  
2800 Berlin Turnpike, P.O. Box 317546  
Newington, CT 06111



03/30/2021

PS Form 3800, April 2015 PSN 7530-02-000-9047 See Reverse for Instructions

7019 2280 0001 3493 9844

U.S. Postal Service™  
CERTIFIED MAIL® RECEIPT  
Domestic Mail Only

For delivery information, visit our website at [www.usps.com](http://www.usps.com)®.

West Haven, CT 06516

OFFICIAL USE

Certified Mail Fee	\$3.60
Extra Services & Fees (check box, add fee as appropriate)	
<input type="checkbox"/> Return Receipt (hardcopy)	\$0.00
<input type="checkbox"/> Return Receipt (electronic)	\$0.00
<input type="checkbox"/> Certified Mail Restricted Delivery	\$0.00
<input type="checkbox"/> Adult Signature Required	\$0.00
<input type="checkbox"/> Adult Signature Restricted Delivery	\$0.00



Postage \$0.55

Total \$4.13  
Department of Planning and Development  
Fred A. Messore, Commissioner

City Hall  
355 Main Street  
West Haven, CT 06516



Name and Address of Sender  
**ClearCell Power, Inc.**  
**C/O Ai Builders-New England, LLC**  
**17 Stanton Avenue,**  
**South Hadley, MA 01075**

Check type of mail or service  
 Adult Signature Required  
 Adult Signature Restricted Delivery  
 Certified Mail  
 Certified Mail Restricted Delivery  
 Collect on Delivery (COD)  
 Insured Mail  
 Priority Mail  
 Priority Mail Express  
 Registered Mail  
 Return Receipt for Merchandise  
 Signature Confirmation  
 Signature Confirmation Restricted Delivery

USPS Tracking/Article Number  
 1.

Addressee (Name, Street, City, State, & ZIP Code™)

Department of Consumer Protection  
 Michelle Seagull Commissioner  
 165 Capital Avenue  
 Hartford, CT 06106

State Department of Energy Environmental Protection  
 Katie Dykes, Commissioner  
 79 Elm Street  
 Hartford, CT 06103

State Department of Economic and Community Development  
 David Lehman, Commissioner  
 450 Columbus Boulevard, Suite 5, Hartford, CT 06103

Office of Policy and Management  
 Melissa McCaw, Secretary  
 450 Capitol Avenue  
 Hartford, CT 06106

Southern Central Regional Council of Governments  
 FS Michael Freda, Chairman  
 127 Washington Avenue, 4th Floor West  
 North Haven CT 06473

Public Utilities Regulatory Authority  
 c/o Marissa Paslick Gillett, Chairman  
 10 Franklin Square  
 New Britain, CT 06051

State House Michael DiMasse-Representative  
 House District 116  
 Legislative Office Building, Room 5006  
 Hartford, CT 06106-1591

State Department of Agriculture  
 Bryan P. Hurlburt, Commissioner  
 450 Columbus Blvd, Suite 701  
 Hartford, CT 06103

Total Number of Pieces Listed by Sender: 8  
 Total Number of Pieces Received at Post Office: 8  
 Postmaster, Per (Name of receiving employee): [Signature]

Complete in Ink Pri

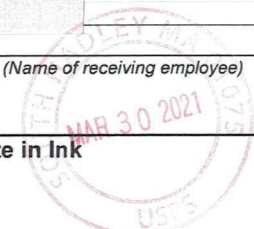

0000

U.S. POSTAGE PAID  
 SOUTH HADLEY, MA  
 01075  
 MAR 30, 21  
 AMOUNT  
**\$1.55**  
 R2305K134567-01



0000

U.S. POSTAGE PAID  
 SOUTH HADLEY, MA  
 01075  
 MAR 30, 21  
 AMOUNT  
**\$1.55**  
 R2305K134567-01



0000

U.S. POSTAGE PAID  
 SOUTH HADLEY, MA  
 01075  
 MAR 30, 21  
 AMOUNT  
**\$1.55**  
 R2305K134567-01



0000

U.S. POSTAGE PAID  
 SOUTH HADLEY, MA  
 01075  
 MAR 30, 21  
 AMOUNT  
**\$1.55**  
 R2305K134567-01



0000

U.S. POSTAGE PAID  
 SOUTH HADLEY, MA  
 01075  
 MAR 30, 21  
 AMOUNT  
**\$1.55**  
 R2305K134567-01



0000

U.S. POSTAGE PAID  
 SOUTH HADLEY, MA  
 01075  
 MAR 30, 21  
 AMOUNT  
**\$1.55**  
 R2305K134567-01

U.S. POSTAGE PAID  
 SOUTH HADLEY, MA  
 01075  
 MAR 30, 21  
 AMOUNT

**\$1.55**  
 R2305K134567-01



0000

U.S. POSTAGE PAID  
 SOUTH HADLEY, MA  
 01075  
 MAR 30, 21  
 AMOUNT

**\$1.55**  
 R2305K134567-01



0000

7019 2280 0001 3493 9707

# U.S. Postal Service™ CERTIFIED MAIL® RECEIPT

Domestic Mail Only

For delivery information, visit our website at [www.usps.com](http://www.usps.com)®.

Hartford, CT 06106

Certified Mail Fee	\$3.60
Extra Services & Fees (check box, add fee as appropriate)	\$0.00
<input type="checkbox"/> Return Receipt (hardcopy)	\$0.00
<input type="checkbox"/> Return Receipt (electronic)	\$0.00
<input type="checkbox"/> Certified Mail Restricted Delivery	\$0.00
<input type="checkbox"/> Adult Signature Required	\$0.00
<input type="checkbox"/> Adult Signature Restricted Delivery	\$0.00

Postage \$0.55

Total \$4.15

Department of Consumer Protection  
Michelle Seagull, Commissioner  
165 Capital Avenue  
Hartford, CT 06106

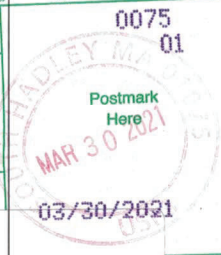

PS Form 3800, April 2015 PSN 7530-02-000-5047 See reverse for Instructions

7019 2280 0001 3493 9730

# U.S. Postal Service™ CERTIFIED MAIL® RECEIPT

Domestic Mail Only

For delivery information, visit our website at [www.usps.com](http://www.usps.com)®.

Hartford, CT 06106

Certified Mail Fee	\$3.60
Extra Services & Fees (check box, add fee as appropriate)	\$0.00
<input type="checkbox"/> Return Receipt (hardcopy)	\$0.00
<input type="checkbox"/> Return Receipt (electronic)	\$0.00
<input type="checkbox"/> Certified Mail Restricted Delivery	\$0.00
<input type="checkbox"/> Adult Signature Required	\$0.00
<input type="checkbox"/> Adult Signature Restricted Delivery	\$0.00

Postage \$0.55

Total \$4.15

Office of Policy and Management  
Melissa McCaw, Secretary  
450 Capitol Avenue  
Hartford, CT 06106

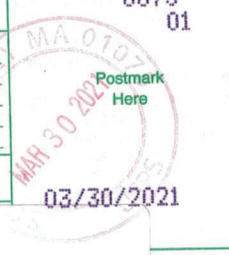

PS Form 3800, April 2015 PSN 7530-02-000-5047 See reverse for Instructions

7019 2280 0001 3493 9714

# U.S. Postal Service™ CERTIFIED MAIL® RECEIPT

Domestic Mail Only

For delivery information, visit our website at [www.usps.com](http://www.usps.com)®.

Hartford, CT 06103

Certified Mail Fee	\$3.60
Extra Services & Fees (check box, add fee as appropriate)	\$0.00
<input type="checkbox"/> Return Receipt (hardcopy)	\$0.00
<input type="checkbox"/> Return Receipt (electronic)	\$0.00
<input type="checkbox"/> Certified Mail Restricted Delivery	\$0.00
<input type="checkbox"/> Adult Signature Required	\$0.00
<input type="checkbox"/> Adult Signature Restricted Delivery	\$0.00

Postage \$0.55

Total \$4.15

State Department of Energy Environmental  
Protection  
Katie Dykes, Commissioner  
79 Elm Street  
Hartford, CT 06103

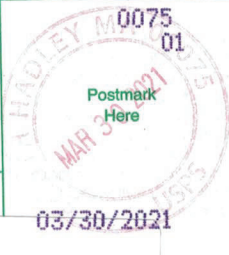

PS Form 3800, April 2015 PSN 7530-02-000-5047 See reverse for Instructions

7019 2280 0001 3493 9745

# U.S. Postal Service™ CERTIFIED MAIL® RECEIPT

Domestic Mail Only

For delivery information, visit our website at [www.usps.com](http://www.usps.com)®.

North Haven, CT 06473

Certified Mail Fee	\$3.60
Extra Services & Fees (check box, add fee as appropriate)	\$0.00
<input type="checkbox"/> Return Receipt (hardcopy)	\$0.00
<input type="checkbox"/> Return Receipt (electronic)	\$0.00
<input type="checkbox"/> Certified Mail Restricted Delivery	\$0.00
<input type="checkbox"/> Adult Signature Required	\$0.00
<input type="checkbox"/> Adult Signature Restricted Delivery	\$0.00

Postage \$0.55

Total \$4.15

Southern Central Regional Council of Governments  
FS Michael Freda, Chairman  
127 Washington Avenue, 4th Floor West  
North Haven CT 06473



PS Form 3800, April 2015 PSN 7530-02-000-5047 See reverse for Instructions

7019 2280 0001 3493 9721

# U.S. Postal Service™ CERTIFIED MAIL® RECEIPT

Domestic Mail Only

For delivery information, visit our website at [www.usps.com](http://www.usps.com)®.

Hartford, CT 06103

Certified Mail Fee	\$3.60
Extra Services & Fees (check box, add fee as appropriate)	\$0.00
<input type="checkbox"/> Return Receipt (hardcopy)	\$0.00
<input type="checkbox"/> Return Receipt (electronic)	\$0.00
<input type="checkbox"/> Certified Mail Restricted Delivery	\$0.00
<input type="checkbox"/> Adult Signature Required	\$0.00
<input type="checkbox"/> Adult Signature Restricted Delivery	\$0.00

Postage \$0.55

Total \$4.15

State Department of Economic and Community Development  
David Lehman, Commissioner  
450 Columbus Boulevard, Suite 5, Hartford, CT 06103



PS Form 3800, April 2015 PSN 7530-02-000-5047 See reverse for Instructions

7019 2280 0001 3493 9752

# U.S. Postal Service™ CERTIFIED MAIL® RECEIPT

Domestic Mail Only

For delivery information, visit our website at [www.usps.com](http://www.usps.com)®.

New Britain, CT 06051

Certified Mail Fee	\$3.60
Extra Services & Fees (check box, add fee as appropriate)	\$0.00
<input type="checkbox"/> Return Receipt (hardcopy)	\$0.00
<input type="checkbox"/> Return Receipt (electronic)	\$0.00
<input type="checkbox"/> Certified Mail Restricted Delivery	\$0.00
<input type="checkbox"/> Adult Signature Required	\$0.00
<input type="checkbox"/> Adult Signature Restricted Delivery	\$0.00

Postage \$0.55

Total \$4.15

Public Utilities Regulatory Authority  
c/o Marissa Paslick Gillett, Chairman  
10 Franklin Square  
New Britain, CT 06051



PS Form 3800, April 2015 PSN 7530-02-000-5047 See reverse for Instructions

7019 2280 0001 3493 9769

# U.S. Postal Service™ CERTIFIED MAIL® RECEIPT

Domestic Mail Only

For delivery information, visit our website at [www.usps.com](http://www.usps.com)®.  
Hartford, CT 06106

## OFFICIAL USE

Certified Mail Fee	\$3.60
Extra Services & Fees (check box, add fee as appropriate)	\$0.00
<input type="checkbox"/> Return Receipt (hardcopy)	\$0.00
<input type="checkbox"/> Return Receipt (electronic)	\$0.00
<input type="checkbox"/> Certified Mail Restricted Delivery	\$0.00
<input type="checkbox"/> Adult Signature Required	\$0.00
<input type="checkbox"/> Adult Signature Restricted Delivery	\$0.00

Postage \$0.55

To: State House Middlesex-Representative  
House District 116  
Legislative Office Building, Room 5006  
Hartford, CT 06106-1591



03/30/2021

PS Form 3800, April 2015 PSN 7530-02-000-9047 See Reverse for Instructions

7019 2280 0001 3493 9776

# U.S. Postal Service™ CERTIFIED MAIL® RECEIPT

Domestic Mail Only

For delivery information, visit our website at [www.usps.com](http://www.usps.com)®.  
Hartford, CT 06103

## OFFICIAL USE

Certified Mail Fee	\$3.60
Extra Services & Fees (check box, add fee as appropriate)	\$0.00
<input type="checkbox"/> Return Receipt (hardcopy)	\$0.00
<input type="checkbox"/> Return Receipt (electronic)	\$0.00
<input type="checkbox"/> Certified Mail Restricted Delivery	\$0.00
<input type="checkbox"/> Adult Signature Required	\$0.00
<input type="checkbox"/> Adult Signature Restricted Delivery	\$0.00

Postage \$0.55

To: State Department of Agriculture  
Bryan P. Hurlbur, Commissioner  
450 Columbus Blvd, Suite 701  
Hartford, CT 06103



03/30/2021

PS Form 3800, April 2015 PSN 7530-02-000-9047 See Reverse for Instructions



Firm Mailing Book For Accountable Mail

Name and Address of Sender  
 ClearCell Power, Inc.  
 C/O Ai Builders-New England, LLC  
 17 Stanton Avenue,  
 South Hadley, MA 01075

- Check type of mail or service
- Adult Signature Required
  - Adult Signature Restricted Delivery
  - Certified Mail
  - Certified Mail Restricted Delivery
  - Collect on Delivery (COD)
  - Insured Mail
  - Priority Mail
  - Priority Mail Express
  - Registered Mail
  - Return Receipt for Merchandise
  - Signature Confirmation
  - Signature Confirmation Restricted Delivery



U.S. POSTAGE PAID  
 SOUTH HADLEY, MA  
 01075  
 MAR 30, 21  
 AMOUNT  
**\$1.55**  
 R2305K134567-01



U.S. POSTAGE PAID  
 SOUTH HADLEY, MA  
 01075  
 MAR 30, 21  
 AMOUNT  
**\$1.55**  
 R2305K134567-01



U.S. POSTAGE PAID  
 SOUTH HADLEY, MA  
 01075  
 MAR 30, 21  
 AMOUNT  
**\$1.55**  
 R2305K134567-01

USPS Tracking/Article Number	Addressee (Name, Street, City, State, & ZIP Code™)	SC Fee	SCRD Fee	SH Fee
1.	Office of the Mayor Nancy Rossi City Hall 355 Main Street West Haven, CT 06516			
2.	Building Department Building Official: Frank Gladwin City Hall 355 Main Street West Haven, CT 06516			
3.	Zoning Department Zoning Enforcement Official: Catherine Conniff City Hall 355 Main Street West Haven, CT 06516			
4.				
5.				
6.				
7.				
8.				

Handling Charge - if Registered

Adult Signatu

Adult Signature Re

Restricted

Return F

Signature Confirmation

Signature Confirmation Restricted Delivery

Special Handling

Total Number of Pieces Listed by Sender **3**

Total Number of Pieces Received at Post Office **3**

Postmaster, Per (Name of receiving employee)

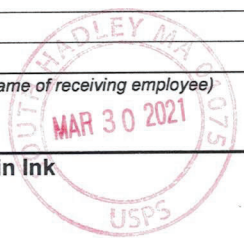

7019 2280 0001 3493 9851

U.S. Postal Service™  
**CERTIFIED MAIL® RECEIPT**  
Domestic Mail Only

For delivery information, visit our website at [www.usps.com](http://www.usps.com)®.

West Haven, CT 06516

**OFFICIAL USE**

Certified Mail Fee	\$3.60
Extra Services & Fees (check box, add fee as appropriate)	\$0.00
<input type="checkbox"/> Return Receipt (hardcopy)	\$0.00
<input type="checkbox"/> Return Receipt (electronic)	\$0.00
<input type="checkbox"/> Certified Mail Restricted Delivery	\$0.00
<input type="checkbox"/> Adult Signature Required	\$0.00
<input type="checkbox"/> Adult Signature Restricted Delivery	\$0.00

Postage \$0.55

Total \$4.15

Office of the Mayor  
Nancy Rossi  
City Hall  
355 Main Street  
West Haven, CT 06516



03/30/2021

PS Form 3800, April 2015 PSN 7530-02-000-9047 See Reverse for Instructions

7019 2280 0001 3493 9868

U.S. Postal Service™  
**CERTIFIED MAIL® RECEIPT**  
Domestic Mail Only

For delivery information, visit our website at [www.usps.com](http://www.usps.com)®.

West Haven, CT 06516

**OFFICIAL USE**

Certified Mail Fee	\$3.60
Extra Services & Fees (check box, add fee as appropriate)	\$0.00
<input type="checkbox"/> Return Receipt (hardcopy)	\$0.00
<input type="checkbox"/> Return Receipt (electronic)	\$0.00
<input type="checkbox"/> Certified Mail Restricted Delivery	\$0.00
<input type="checkbox"/> Adult Signature Required	\$0.00
<input type="checkbox"/> Adult Signature Restricted Delivery	\$0.00

Postage \$0.55

Total \$4.15

Building Department  
Building Official: Frank Gladwin  
City Hall  
355 Main Street  
West Haven, CT 06516



03/30/2021

PS Form 3800, April 2015 PSN 7530-02-000-9047 See Reverse for Instructions

7019 2280 0001 3493 9875

U.S. Postal Service™  
**CERTIFIED MAIL® RECEIPT**  
Domestic Mail Only

For delivery information, visit our website at [www.usps.com](http://www.usps.com)®.

West Haven, CT 06516

**OFFICIAL USE**

Certified Mail Fee	\$3.60
Extra Services & Fees (check box, add fee as appropriate)	\$0.00
<input type="checkbox"/> Return Receipt (hardcopy)	\$0.00
<input type="checkbox"/> Return Receipt (electronic)	\$0.00
<input type="checkbox"/> Certified Mail Restricted Delivery	\$0.00
<input type="checkbox"/> Adult Signature Required	\$0.00
<input type="checkbox"/> Adult Signature Restricted Delivery	\$0.00

Postage \$0.55

Total \$4.15

Zoning Department  
Zoning Enforcement Official: Catherine Conniff  
City Hall 355 Main Street  
West Haven, CT 06516



03/30/2021

PS Form 3800, April 2015 PSN 7530-02-000-9047 See Reverse for Instructions





Attachment #12: West Haven FEMA Flood Map



# City of West Haven, Connecticut



## 100 Yr FEMA Flood Zones



Location of Best Western Fuel Cell

### 100 Yr Flood Zone Classifications

\* Source: FEMA website <http://www.fema.gov> and CT DEP website <http://dep.state.ct.us>

-  Area inundated by 100 Yr Flood. Elevation is below the Base Flood Elevation & waves are expected to be less than 3 ft high during a 100 Yr flood episode)
-  Area inundated by 100 Yr Flood. Base Flood Elevations are shown
-  Alluvial fan inundated by 100 Yr Flood. Base Flood Elevations are shown. Flood depth range between 1 and 3 ft





Attachment #13: Doosan Natural Gas Desulfurization Process Memorandum

## PureCell Model 400 Fuel Processing System (FPS)

The FPS converts pipeline-quality natural gas into hydrogen reformate – a hydrogen-rich gas that is delivered to the anode side of the fuel cell stacks. This module includes a condenser to recover water generated in the fuel cell reaction by condensing water vapor from the process exhaust. This eliminates the need for makeup water under most operating conditions. The recovered water is used in the steam reformation process. The main components of the FPS include the following:

### Hydro-Desulfurizer

The desulfurizer system removes sulfur used as an odorant in natural gas, which is a poison to the catalysts used in the fuel cell systems. Sulfur is converted to zinc-sulfide, a non-hazardous waste, within the desulfurizer and remains there until an overhaul is required, nominally after 10 years. This system will also remove small amounts of oxygen in the gas.

### Steam Reformer

Steam (H<sub>2</sub>O) generated in the cell stack cooling loop of the TMS is combined in the reformer with methane (CH<sub>4</sub>) in the natural gas to generate a gas composed of hydrogen (H<sub>2</sub>), carbon monoxide (CO), and carbon dioxide (CO<sub>2</sub>).

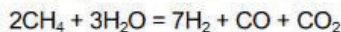

Equation 1

### Integrated Low-Temperature Shift Converter

The integrated low-temperature shift converter (ILS) generates additional hydrogen through a water-gas reaction in which CO and water is converted to hydrogen and CO<sub>2</sub>. The reduced CO content minimizes its adverse effect on fuel cell stack performance.

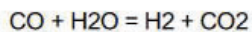

Equation 2

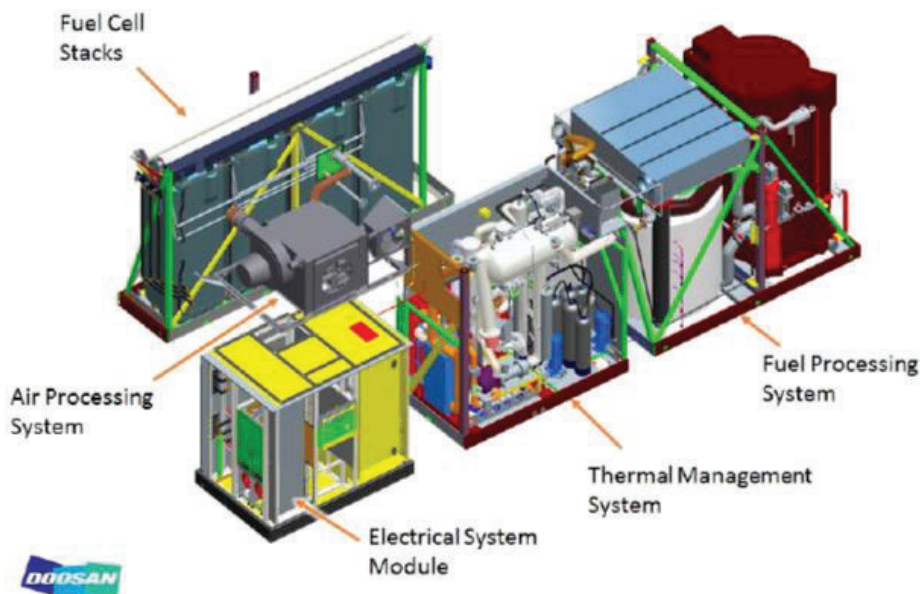

Figure 1. PureCell Model 400 Subsystems



**Sulfur Background**

Sulfur is present in pipeline natural gas. It is primarily used as an odorant so leaks can be detected. Unfortunately, sulfur is also a poison to fuel cell systems and exposure to sulfur will drastically reduce the life and efficiency of the fuel cell.

Types of sulfur found in natural gas vary from region to region. Some common examples are:

- Hydrogen Sulfide (H<sub>2</sub>S)
- Tetrahydrothiophene (THT)
- Mercaptain – (MCP) - Broad family of sulfur molecules characterized by a sulfur atom attached to a hydrocarbon molecule or chain

The majority of the odorants are organic with the exception of hydrogen sulfide. Standard pipeline natural gas contains up to 6 parts per million by volume (ppmv) sulfur on average with spikes as high as 30 ppmv possible. In order to successfully maintain operation of the fuel cell for a period of 10 years, the sulfur levels must be reduced to less than 0.02 ppmv, or a 99.7% removal rate. An additional benefit of this is that it removes sulfur dioxide from the emissions of the fuel cell power plant.

**Sulfur Removal Techniques**

Sulfur removal can be broken down into two main techniques, physical capture and reactive capture.

Physical capture involves using porous media such as activated carbon or molecular sieves to capture and concentrate the odorant before it enters the fuel cell. Doosan elected not to pursue this path due to several factors, including:

- The process concentrates the odorant and turned it into hazardous waste
- The concentrated odorant is highly toxic and requires specially trained personnel to handle the waste
- Would result in more service being required at customer sites to maintain the system

Reactive capture is the method used by Doosan to remove sulfur. It involves chemically reacting the odorant over a catalyst bed in order to separate the sulfur molecule. Once the sulfur molecule is separated from the odorant, the remaining odorant is destroyed in another catalyst bed. The sulfur molecule is then captured and converted to a compound called Zinc Sulfide.

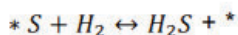

*Equation 4*

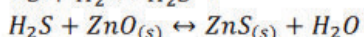

*Equation 5*

Note: \* represents the non-sulfur odorant components

Doosan's system has been sized such that it will run for the 10 year service life of the unit and not need to be changed out. When the unit is removed from service, the decommissioning or refurbishment of the unit will be carried out by trained personnel and a company specializing in removal of the waste Zinc Sulfide will recover the spent material. Zinc sulfide has some commercial value, so that company will either process it and sell it or split it into Zinc and Sulfur and sell them separately.

Respectfully,  
Jesse Hayes, Director, Product Management, Doosan Fuel Cell  
195 Governors Highway  
South Windsor, CT 06074  
[Jesse.hayes@doosan.com](mailto:Jesse.hayes@doosan.com)  
(860) 560-3309