

STATE OF CONNECTICUT  
CONNECTICUT SITING COUNCIL

IN RE:	:	PETITION NO. 1443A
	:	
SR NORTH STONINGTON, LLC	:	
DECLARATORY RULING, PURSUANT TO	:	
CONNECTICUT GENERAL STATUTES §4-	:	
176 AND §16-50K, FOR THE PROPOSED	:	
CONSTRUCTION, MAINTENANCE AND	:	
OPERATION OF A 9.9-MEGAWATT AC	:	
SOLAR PHOTOVOLTAIC ELECTRIC	:	
GENERATING FACILITY ON FIVE	:	
PARCELS LOCATED NORTH AND SOUTH	:	
OF PROVIDENCE NEW LONDON	:	
TURNPIKE (STATE ROUTE 184), WEST OF	:	
BOOMBRIDGE ROAD AND NORTH OF	:	
INTERSTATE 95 IN NORTH	:	
STONINGTON, CONNECTICUT, AND	:	
ASSOCIATED ELECTRICAL	:	
INTERCONNECTION. REOPENING OF	:	
THIS PETITION BASED ON CHANGED	:	
CONDITIONS PURSUANT TO	:	
CONNECTICUT GENERAL STATUTES §4-	:	
181A(B).	:	OCTOBER 2, 2024
	:	

**FINAL REPORT**

In accordance with the Connecticut Siting Council’s (“Council”) May 12, 2022 Decision and Order in the above-referenced docket (“Decision”) and the Council’s October 27, 2022 approval of Development and Management Plan Phase I and February 17, 2023 approval of Development and Management Plan Phase II, SR North Stonington, LLC hereby submits this Final Report regarding its 8.35MWac solar photovoltaic electric generating facility located at 450 Providence New London Turnpike, North Stonington, Connecticut (the “Facility”).

The Facility does not have any agreements in place with abutters or other property owners regarding special maintenance precautions. There have been no significant changes to the D&M Plan. The location of construction materials which have been left in place are shown in Exhibit A. Please note that a forty-foot (40’) material storage conex is located east

of Stormwater Basin 1A inside the Facility fence line, which is highlighted in red on Exhibit A. These items can also be seen in the aerial photograph of the completed Facility from April 2024, included as Exhibit C.

The locations where special planting and reseeding have been done are shown in Exhibit B, highlighted in green.

The actual construction cost of the facility was **REDACTED**. The Facility completed construction and reached its Commercial Operation Date with ISO-NE on March 30, 2024.



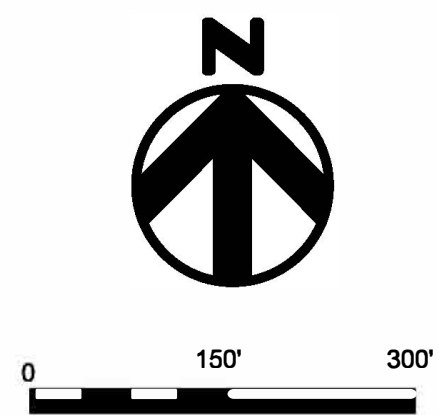

AS  
RECORDED

NORTH  
STONINGTON  
SOLAR

428, PROVIDENCE-NEW LONDON TURNPIKE  
NORTH STONINGTON, CT 06359, USA

LAT: 41.431830°N  
LON: 71.821514°W

NORTH STONINGTON, CT

14	AS-BUILT	05/09/24
13	FENCE AND POI REVISION	08/04/23
12	POND 1C REVISION	04/20/23
11	ISSUED FOR CONSTRUCTION	03/22/23
10	FENCE REVISION	12/14/22
9	RE-ISSUED FOR PERMIT	11/07/22
8	RE-ISSUED FOR PERMIT	10/18/22
REV. NO	DESCRIPTION	DATE

SHEET TITLE:

OVERALL SITE PLAN

PROJ. MGR.  
CM

PROJ. ENGR.  
MB

DATE:  
05/09/24

DRAWN BY:  
JP

CHECKED BY:  
CP

SCALE:  
1:200

DRAWING NO.

AS RECORDED

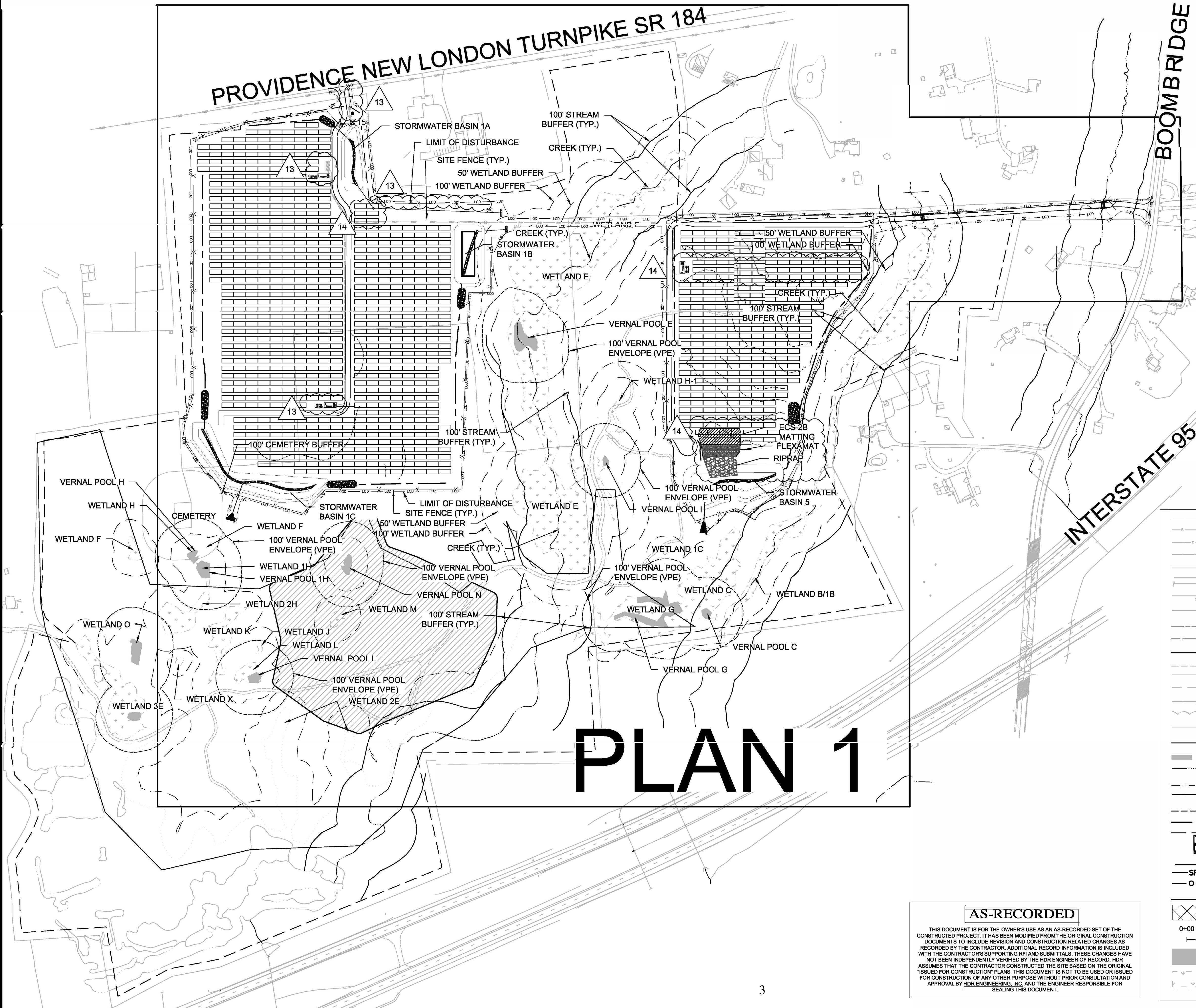

**AS-RECORDED**

THIS DOCUMENT IS FOR THE OWNER'S USE AS AN AS-RECORDED SET OF THE CONSTRUCTED PROJECT. IT HAS BEEN MODIFIED FROM THE ORIGINAL CONSTRUCTION DOCUMENTS TO INCLUDE REVISION AND CONSTRUCTION RELATED CHANGES AS RECORDED BY THE CONTRACTOR. ADDITIONAL RECORD INFORMATION IS INCLUDED WITH THE CONTRACTOR'S SUPPORTING RFI AND SUBMITTALS. THESE CHANGES HAVE NOT BEEN INDEPENDENTLY VERIFIED BY THE HDR ENGINEER OF RECORD. HDR ASSUMES THAT THE CONTRACTOR CONSTRUCTED THE SITE BASED ON THE ORIGINAL "ISSUED FOR CONSTRUCTION" PLANS. THIS DOCUMENT IS NOT TO BE USED OR ISSUED FOR CONSTRUCTION OF ANY OTHER PURPOSE WITHOUT PRIOR CONSULTATION AND APPROVAL BY HDR ENGINEERING, INC. AND THE ENGINEER RESPONSIBLE FOR SEALING THIS DOCUMENT.

- EXISTING WATER
- EXISTING SANITARY SEWER
- EXISTING ELECTRICAL
- EXISTING GAS LINE
- PIPELINE
- LARGE PIPELINE
- UTILITY OVERHEAD LINE
- PROPERTY LINE
- ADJOINING PROPERTY LINE
- EASEMENT
- RIGHT OF WAY
- EXISTING CONTOUR (MINOR)
- PROPOSED CONTOUR (MINOR)
- EXISTING CONTOUR (MAJOR)
- PROPOSED CONTOUR (MAJOR)
- EXISTING TREE LINE
- EXISTING FENCE
- PROPOSED SECURITY FENCE
- FLOOD LIMIT (100 YEAR)
- STREAM/CREEK
- WETLAND
- LIMITS OF DISTURBANCE
- 100' VERNAL POOL ENVELOPE
- 50' WETLAND BUFFER
- 100' WETLAND BUFFER
- OUTLET PROTECTION
- PIPE CULVERT
- SILT FENCE
- COMPOST FILTER SOCK
- PERMANENT DRAINAGE DITCH
- TREE CLEARING
- ALIGNMENT
- VERNAL POOL
- WETLAND



Exhibit B

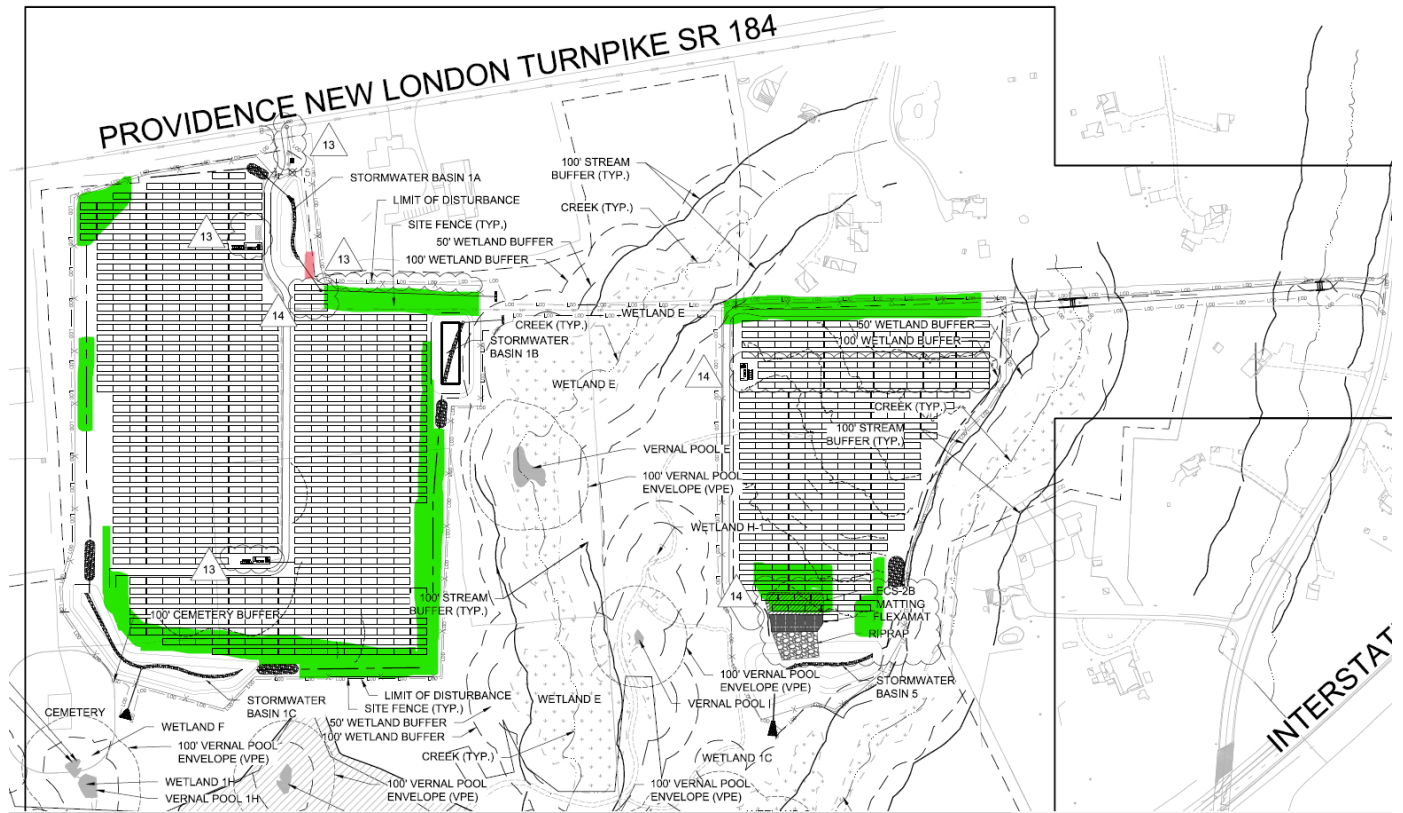

Exhibit C

