

**STATE OF CONNECTICUT
CONNECTICUT SITING COUNCIL**

East Windsor Solar One, LLC Petition for a Declaratory Ruling, pursuant to Connecticut General Statutes §4-176 and §16-50k, for the proposed construction, maintenance and operation of a 4.9-megawatt AC solar photovoltaic electric generating facility located west of the Ellington town boundary at 341 East Road, East Windsor, and associated electrical interconnection.

Petition No. 1426

February 26, 2021

EAST WINDSOR SOLAR ONE, LLC'S RESPONSES TO THE CONNECTICUT SITING COUNCIL'S (SET THREE) FEBRUARY 19, 2021 INTERROGATORIES

The petitioner, East Windsor Solar One, LLC ("East Windsor Solar One" or "the Petitioner"), respectfully submits this response to the Council's (Set Three) Interrogatories, dated February 19, 2021, in the above-referenced Petition. In response to the Council's Interrogatories, East Windsor Solar One states as follows:

66. Please provide drawings of the electrical interconnection

The current Interconnection design is highlighted on the drawing attached hereto as Exhibit A. The project has received Eversource's approval for this design.

67. Referencing response to Council interrogatory 26, please explain why three separate meters (i.e. three electrical services) are proposed for the electrical interconnection rather than one meter (or service) for the entire site.

This project has three separate meters to support the potential of three separate LREC/ZREC contracts. The LREC/ZREC program dictates that there be no more than one LREC/ZREC contract at a given revenue meter in any given solicitation. The LREC/ZREC program is structured as a reverse auction and seeks to deploy the maximum amount of zero and low carbon emission generating resources for the lowest cost. In order to be awarded an LREC/ZREC contract, a particular bid must comply with program rules and be the low bid when compared to alternative bids in the subject auction. This competitive process allows for projects that provide the lowest cost to ratepayers per MWh be successful, while denying other more costly projects. Thus, in order for the project to be successful in the LREC/ZREC program, it must have its meters configured in this fashion.

Respectfully Submitted,
East Windsor Solar One, LLC

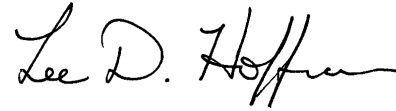

By: _____

Lee D. Hoffman
Amanda G. Gurren
Pullman & Comley, LLC
90 State House Square
Hartford, CT 06103-3702
Juris No. 409177
860-424-4300 (p)
860-424-4370 (f)
lhoffman@pullcom.com
Its Attorneys

LINE	BEARING	DISTANCE
1	S 03°11'41" W	66.03
2	S 08°33'54" W	32.31
3	S 01°50'24" E	50.42
4	S 03°22'23" W	78.22
5	S 02°54'17" W	85.77
6	S 03°47'23" W	39.31
7	S 05°11'36" W	44.31
8	S 02°43'13" W	106.11
9	S 05°17'51" W	28.24
10	S 15°55'03" E	28.97
11	S 86°25'54" E	41.02
12	N 88°31'47" E	35.64
13	S 89°08'03" E	37.91
14	N 89°45'26" E	49.12
15	S 85°04'23" E	70.31

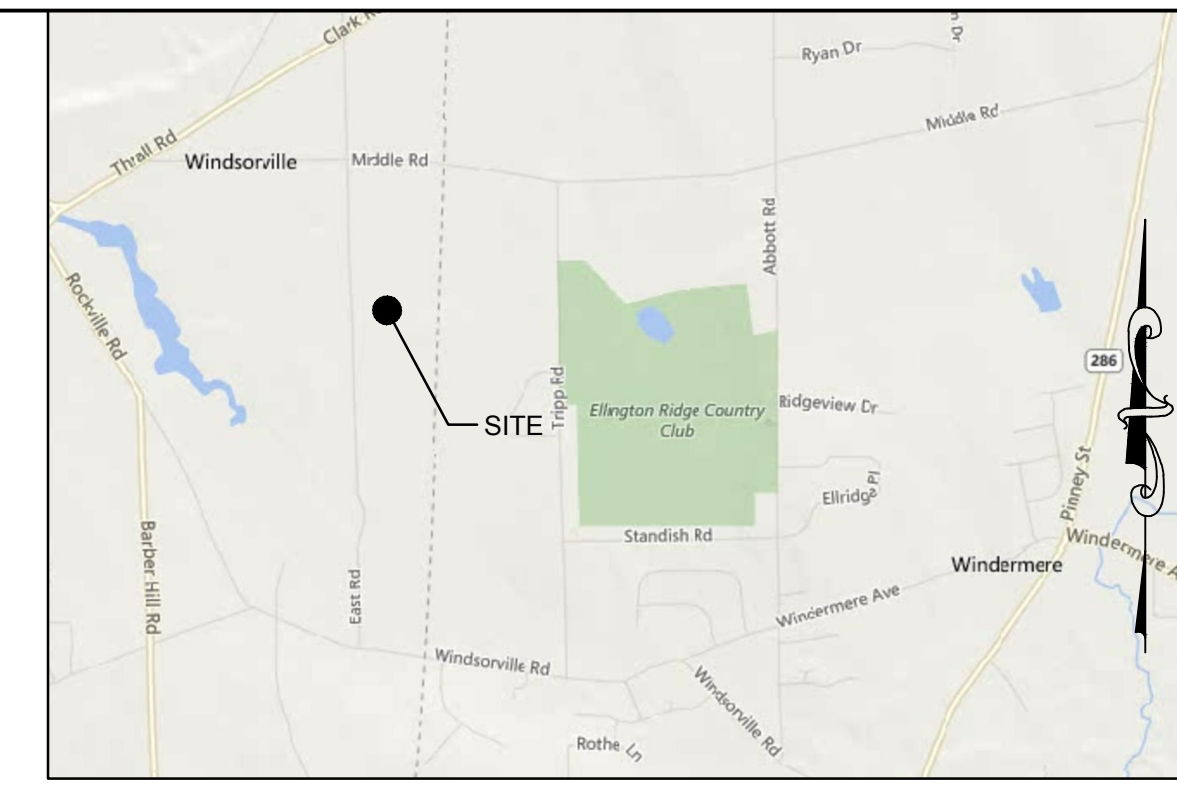

SITE LOCATION MAP (NOT TO SCALE)

- LEGEND:
- IRON PIN (FOUND)
 - Rebar/Drill Hole (To Be Set)
 - MANHOLE (FOUND)
 - ⊙ DRAINAGE MANHOLE
 - ⊙ SANITARY MANHOLE
 - ⊙ ELEC. MANHOLE
 - ⊙ TELE. MANHOLE
 - "C" CATCH BASIN
 - ⊙ "C-L" CATCH BASIN
 - ⊙ DECIDUOUS TREES
 - ★ EVERGREEN TREES
 - ☀ SHRUB/BUSH
 - ⊙ FLAG POLE
 - ⊙ TRAFFIC CONTROL BOX
 - △ SIGN
 - POST
 - ☆ LIGHT POLE
 - ⊙ GUY ANCHOR
 - ⊙ UTILITY POLE
 - ⊙ WATER GATE
 - ⊙ WATER METER
 - ⊙ GAS VALVE
 - ⊙ GAS METER
 - ⊙ TRANSFORMER
 - ⊙ ELEC. METER
 - ⊙ MAIL BOX
 - ⊙ HAND HOLE
 - ⊙ BUTTON BOX
 - ⊙ A.C. UNIT
 - ⊙ TRAFFIC LIGHT POLE

MAP NOTES:

- THIS MAP AND SURVEY HAVE BEEN PREPARED PURSUANT TO THE REGULATIONS OF CONNECTICUT STATE AGENCIES SECTIONS 20-300b-1 THROUGH 20-300b-20 AND "THE MINIMUM STANDARDS FOR SURVEYS AND MAPS IN THE STATE OF CONNECTICUT" ADOPTED JUNE 21, 1996; AMENDED OCTOBER 26, 2018.
- THE TYPE OF SURVEY PERFORMED AND THE MAPPED FEATURES DEPICTED HEREON ARE IN ACCORDANCE WITH THE REQUIREMENTS OF A TOPOGRAPHIC SURVEY AND IS INTENDED TO DEPICT EXISTING CONDITIONS FOR THE CONSIDERATION OF A PROPOSED SOLAR FARM.
- THE PROPERTY/BOUNDARY LINES DEPICTED HEREON CONFORM TO A CLASS 'D' AND HAVE BEEN COMPILED FROM OTHER MAPS, LIMITED RESEARCH, AND OTHER SOURCES OF INFORMATION. IT IS NOT TO BE CONSTRUED AS HAVING BEEN OBTAINED AS A RESULT OF A FIELD SURVEY AND IS SUBJECT TO SUCH CHANGE AS AN ACCURATE FIELD SURVEY MAY DISCLOSE.
- ACCESS TO PUBLIC RECORDS HAS BEEN LIMITED DUE TO THE COVID-19 PANDEMIC OF 2020. FURTHER RESEARCH AND A RE-EVALUATION OF THE PROPERTY LINES DEPICTED HEREON IS RECOMMENDED AT A LATER DATE WHEN SAID RECORDS BECOME PUBLICLY AVAILABLE.
- THE HORIZONTAL BASELINE CONFORMS TO A CLASS A-2 ACCURACY. THE VERTICAL BASELINE CONFORMS TO A CLASS V-2 ACCURACY. THE TOPOGRAPHIC FEATURES CONFORM TO A CLASS T-2 ACCURACY.
- THE GROUND RELIEF CONTOURS DEPICTED HEREON ARE BASED UPON THE ORTHOPHOTOGRAHY DATA SET OF 2016 BY THE STATE OF CONNECTICUT AVAILABLE AT CTGEO.UCONN.EDU.
- THE NORTH ARROW AND BEARINGS ARE BASED UPON THE CONNECTICUT STATE COORDINATE SYSTEM N.A.D. 1983 (2011). THE ELEVATIONS ARE BASED UPON THE NORTH AMERICAN VERTICAL DATUM OF 1988 (NAVD 88) USING GEOID 12B. COORDINATES AND ELEVATIONS WERE DETERMINED FROM RTK GPS OBSERVATIONS MADE ON APRIL 16, 2020, USING THE CT DOT RTK NETWORK KNOWN AS ACORN (CTEG BASE), HAVING THE FOLLOWING VALUES:
 LATITUDE = N 41° 55' 24.34700"
 LONGITUDE = 72° 41' 55.88092"
 ELLIPSOID HEIGHT = 30.2939M
- THE TOPOGRAPHIC FEATURES DEPICTED HEREON ARE THE RESULT OF A FIELD SURVEY CONDUCTED IN APRIL, 2020
- UNDERGROUND UTILITIES, STRUCTURES AND FACILITY LOCATIONS DEPICTED AND NOTED HEREON HAVE BEEN COMPILED, IN PART FROM RECORD MAPPING SUPPLIED BY THE RESPECTIVE COMPANIES OR GOVERNMENTAL AGENCIES AND FROM OTHER SOURCES. THESE LOCATIONS MUST BE CONSIDERED AS APPROXIMATE IN NATURE. ADDITIONALLY, OTHER SUCH FEATURES MAY EXIST ON THE SITE, THE EXISTENCE WHICH IS UNKNOWN TO MARTIN SURVEYING ASSOCIATES, LLC. ALL CONTRACTORS ARE REQUIRED TO CONTACT CALL-BEFORE-YOU-DIG AT 1-800-922-4455 FOR LOCATION AND OR STAKEOUT OF ANY UTILITY PRIOR TO ANY EXCAVATION.
- THE WETLANDS DEPICTED HEREON HAVE BEEN DELINEATED BY ALL-POINTS TECHNOLOGY CORPORATION ON JANUARY 2, 2020.

MAP REFERENCES:

- "PLAN PREPARED FOR CATHOLIC CEMETERIES ASSOCIATION OF THE ARCHDIOCESE OF HARTFORD MIDDLE, EAST AND TRIPP ROADS EAST WINDSOR AND ELLINGTON, CONNECTICUT" SHEET 3 OF 3. SCALE: 1"=200'. PREPARED BY MEHAN & GOODIN ENGINEERS-SURVEYORS, P.C., DATED DECEMBER 04, 2009.
- "SUBDIVISION AND TOPOGRAPHIC PLAN RIDGE COUNTRY ESTATES SECTION II TRIP AND MIDDLE ROADS ELLINGTON, CONNECTICUT." SCALE: 1"=40'. PREPARED BY GARDNER & PETERSON ASSOCIATES, DATED JUNE 11, 1999 AND REVISED TO NOVEMBER 23, 1999.
- "MAP OF ELDORADO ESTATES FOR GARDNER L. CHAPMAN & RALPH L. WETHERELL JR. TRIPP ROAD ELLINGTON." SCALE: 1"=100'. PREPARED BY WILLIAM J. CARRINGTON, DATED JUNE 1970.
- "SUBDIVISION PLAN COUNTRY CLUB ESTATES TRIPP ROAD ELLINGTON, CONNECTICUT" SCALE: 1"=40', PREPARED BY A.R. LOMBARDI ASSOCIATES, INC. DATED FEBRUARY 1989 AND REVISED TO JUNE 27, 1989.
- "THE CONNECTICUT LIGHT & POWER COMPANY BERLIN, CONNECTICUT LAND TO BE ACQUIRED FROM RUTH M. MCCANN TOWN OF ELLINGTON." SCALE: 1"=200' PREPARED BY HENRY BRAUN, DATED JULY 23, 1962 AND REVISED TO MARCH 14, 1963.
- "LOCATION OF RIGHT OF WAY OF THE CONNECTICUT LIGHT & POWER COMPANY ACROSS THE PROPERTY OF STEPHEN & HELEN HAYDUSKI TOWN OF ELLINGTON COUNTY OF TOLLAND STATE OF CONNECTICUT." SCALE 1"=200'. PREPARED BY HENRY BRAUN, DATED JUNE 1963.
- "LOCATION OF RIGHT OF WAY OF THE CONNECTICUT LIGHT & POWER COMPANY ACROSS THE PROPERTY OF ROBERT L. NORTON ET AL TOWN OF ELLINGTON COUNTY OF TOLLAND STATE OF CONNECTICUT." SCALE 1"=200'. PREPARED BY HENRY BRAUN, DATED AUGUST 1964.

SUBJECT PARCEL
 6,438,503 S.F. ± (TOTAL)
 148.81 ACRES ± (TOTAL)
 VOL. 340 PG. 681 (EAST WINDSOR)
 VOL. 409 PG. 1033 (ELLINGTON)

TO MY KNOWLEDGE AND BELIEF, THIS MAP IS SUBSTANTIALLY CORRECT AS NOTED HEREON.

DEAN MARTIN
 70147
 LICENSE NO.

THIS DOCUMENT AND COPIES THEREOF ARE VALID ONLY IF THEY BEAR THE SIGNATURE AND EMPRESSED SEAL OF THE DESIGNATED LICENSED PROFESSIONAL UNAUTHORIZED ALTERATIONS TO THIS PLAN RENDER THE DECLARATION HEREON NULL AND VOID.

- BOUNDARY LINE
- GUARD RAIL
- UNDERGROUND PIPING (Son., Strm.)
- U/G GAS LINE
- U/G ELEC. LINE
- WATER LINE
- OVERHEAD UTILITIES
- U/G TELE. LINE
- CHAIN LINK FENCE
- TREE LINE



Martin
 Surveying Associates, LLC
 201 CHRISTIAN LANE BERLIN, CT 06037
 860-832-9328 860-357-4604 (FAX)

REVISIONS:

**TOPOGRAPHIC SURVEY
 LAND OF
 ASSOCIATION OF THE
 CATHOLIC CEMETERIES
 PREPARED FOR
 EAST WINDSOR SOLAR ONE, LLC
 341 EAST ROAD
 EAST WINDSOR AND ELLINGTON, CONNECTICUT**

MSA PROJECT NO: 20-017
 SCALE: 1"=150'
 DATE: 4/22/2020

DRAWN BY: G.S.D.
 CHECKED BY: D.G.M.

SHEET:
 1 OF 1