



20 Church Street  
20th Floor  
Hartford, CT 06103  
Telephone: 860-525-5065  
Fax: 860-527-4198  
www.lockelord.com

David W. Bogan  
Direct Telephone: 860-541-7711  
Direct Fax: 866-877-2145  
david.bogan@lockelord.com

October 16, 2020

***Via Electronic Mail and First Class Mail***

Melanie A. Bachman, Esq.  
Executive Director  
Connecticut Siting Council  
10 Franklin Square  
New Britain, CT 06051

Re: ***Petition 1352*** - Nutmeg Solar, LLC, petition for a declaratory ruling, pursuant to Connecticut General Statutes §4-176 and §16-50k, for the proposed construction, maintenance and operation of a 19.6-megawatt AC solar photovoltaic electric generating facility on approximately 162 acres comprised of 9 separate parcels located generally south of Bailey Road and east of Route 191 (Broad Brook Road), and associated electrical interconnection to Eversource Energy's Scitico Substation at 20 Bailey Road in Enfield, Connecticut - ***Request for D&M Plan Modification***

Dear Ms. Bachman:

On April 26, 2019, the Connecticut Siting Council ("Council") approved the above-referenced Petition, permitting the establishment of a 19.6 MWac solar photovoltaic electric generating facility in Enfield, Connecticut. The Council approved the facility's Development and Management Plan ("D&M Plan") on January 17, 2020, wherein it delegated approval of any changes to the D&M Plan to Council staff in accordance with Regulations of Connecticut State Agencies ("RCSA") §16-50j-62(b).

In the Petition, Nutmeg Solar, LLC ("Nutmeg Solar") proposed to enclose most of the perimeter of the development area with 7-foot tall chain link fence, with a six-inch gap to allow for passage of wildlife. The Council approved the proposed installation of the perimeter fencing, including along the northwest portion of the Eastern Array development area. The section of fencing highlighted in yellow in the attached map has yet to be installed. Nutmeg Solar proposes to no longer install this section of fencing, and instead install the perimeter fence line to

Melanie A. Bachman, Esq.  
October 16, 2020  
Page 2

incorporate two existing structures on the property: a house and a structure previously used as a horse stable.<sup>1</sup> The modified perimeter fence line is reflected in the attached map in red.

Nutmeg Solar plans to use the existing house and horse stable located in the northern portion of the project site as operations facilities. These facilities will be substantially unchanged, and are expected to be utilized 1-4 days per week. To ensure site security, Nutmeg Solar proposes to relocate approximately 400' of fence line around the project site to encompass the buildings. These modifications are described above and shown in the attached map. The fence Nutmeg Solar plans to install will be consistent with the style, requirements, and wildlife considerations of the perimeter fencing used for the remainder of the site. Accordingly, pursuant to RCSA §16 50j 62(b), the Petitioner requests Council staff approval of the relocation of the perimeter fence to include the existing structures to be used as operations facilities.

Please do not hesitate to contact the undersigned should you require further information.

Very truly yours,

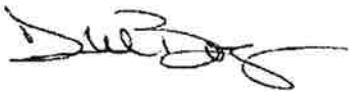

David W. Bogan

DWB:

---

<sup>1</sup> For clarity, neither of these structures are the tobacco barns contemplated in the Petition and the Council's decision.

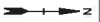
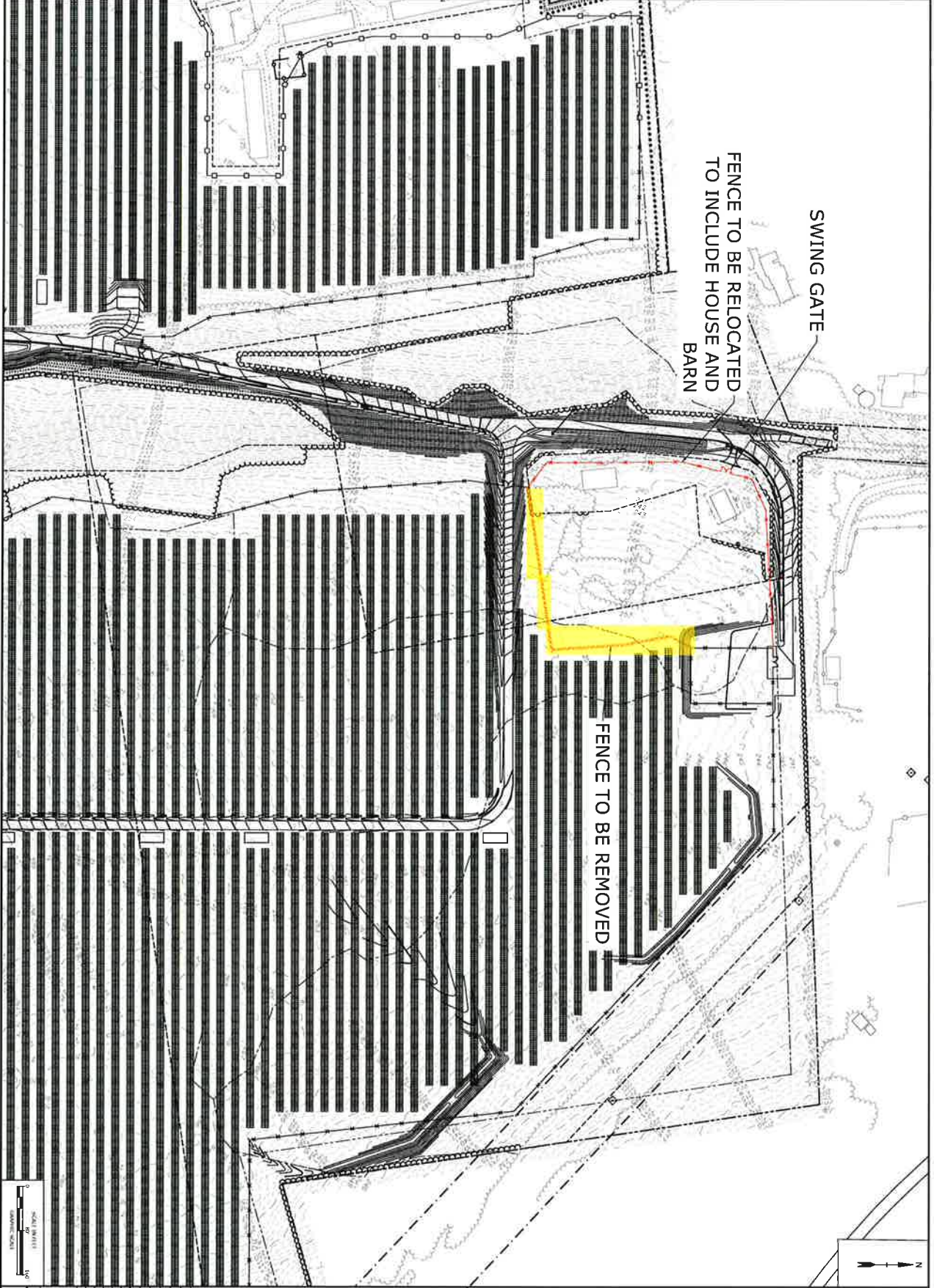

**PERMIT DRAWINGS- NOT FOR CONSTRUCTION**

**Tighte&Bond**  
 Engineers | Environmental Scientists

**Nutmeg Solar Project**

Nutmeg Solar, LLC

Enfield, Connecticut

**VERIFY SCALE**  
 DATE: 10/20/2018  
 TIME: 10:20:18 AM  
 USER: [unreadable]

NO.	DESCRIPTION	DATE	BY
1	ISSUED FOR PERMIT	10/20/2018	[unreadable]
2	REVISED	10/20/2018	[unreadable]
3	REVISED	10/20/2018	[unreadable]
4	REVISED	10/20/2018	[unreadable]
5	REVISED	10/20/2018	[unreadable]
6	REVISED	10/20/2018	[unreadable]
7	REVISED	10/20/2018	[unreadable]
8	REVISED	10/20/2018	[unreadable]
9	REVISED	10/20/2018	[unreadable]
10	REVISED	10/20/2018	[unreadable]
11	REVISED	10/20/2018	[unreadable]
12	REVISED	10/20/2018	[unreadable]
13	REVISED	10/20/2018	[unreadable]
14	REVISED	10/20/2018	[unreadable]
15	REVISED	10/20/2018	[unreadable]
16	REVISED	10/20/2018	[unreadable]
17	REVISED	10/20/2018	[unreadable]
18	REVISED	10/20/2018	[unreadable]
19	REVISED	10/20/2018	[unreadable]
20	REVISED	10/20/2018	[unreadable]
21	REVISED	10/20/2018	[unreadable]
22	REVISED	10/20/2018	[unreadable]
23	REVISED	10/20/2018	[unreadable]
24	REVISED	10/20/2018	[unreadable]
25	REVISED	10/20/2018	[unreadable]
26	REVISED	10/20/2018	[unreadable]
27	REVISED	10/20/2018	[unreadable]
28	REVISED	10/20/2018	[unreadable]
29	REVISED	10/20/2018	[unreadable]
30	REVISED	10/20/2018	[unreadable]
31	REVISED	10/20/2018	[unreadable]
32	REVISED	10/20/2018	[unreadable]
33	REVISED	10/20/2018	[unreadable]
34	REVISED	10/20/2018	[unreadable]
35	REVISED	10/20/2018	[unreadable]
36	REVISED	10/20/2018	[unreadable]
37	REVISED	10/20/2018	[unreadable]
38	REVISED	10/20/2018	[unreadable]
39	REVISED	10/20/2018	[unreadable]
40	REVISED	10/20/2018	[unreadable]
41	REVISED	10/20/2018	[unreadable]
42	REVISED	10/20/2018	[unreadable]
43	REVISED	10/20/2018	[unreadable]
44	REVISED	10/20/2018	[unreadable]
45	REVISED	10/20/2018	[unreadable]
46	REVISED	10/20/2018	[unreadable]
47	REVISED	10/20/2018	[unreadable]
48	REVISED	10/20/2018	[unreadable]
49	REVISED	10/20/2018	[unreadable]
50	REVISED	10/20/2018	[unreadable]

**FIGURE 1**  
 SCALE: 1" = 80'