



Monday, October 8, 2018

Connecticut Siting Council  
Fred Cunliffe  
10 Franklin Square  
New Britain, CT 06051

**RE: Notice of Exempt Modification- 50 Pine Lane, Town of Windsor, CT, 06095- SITE ID: CT52XC025**

To Whom It May Concern;

SAC Wireless, on behalf of Sprint is requesting the necessary approvals for our scope of work for an existing Sprint facility located at 99 Day Hill Road, Town of Windsor, CT, 06095. We will be installing a H-frame, new fiber and utilizing new and existing conduit to our existing telecommunication facility located near the Self Support Tower.

RF Engineers have determined this minor modification is required to help increase the network for the residents and the workforce within the Town of Bloomfield by offering faster data transfer speeds, fewer dropped calls and higher capacity.

Enclosed in this package you will find the following:

- (1) cover letter
- (1) Narrative Letter
- (1) \$625.000 Check Number 78447
- (1) Document of Tower Construction Approval from Municipality
- (1) Wet Stamped Construction Drawing
- (2) Electronic Stamped Construction Drawings
- (4) shipping receipts for Narrative Letters sent to the Municipalities' First Selectman, Local Zoning Officer, Local Permitting Officer and the Underlying Property Owner
- (1) returning shipping label

We greatly appreciate your help with this proposed Sprint facility upgrade. **Please e-mail me any receipts for application fees and/or fees due after plan review, but prior to permit issuance.** Please contact me at 312-858-6544 if you have any questions.

Sincerely,

A handwritten signature in blue ink that reads 'Samantha Young'.

**Samantha Young**

Samantha Young | Zoning and Permitting Specialist |  
SAC Wireless, 540 W. Madison, 9<sup>th</sup> Floor, Chicago, IL 60661  
[samantha.young@sacw.com](mailto:samantha.young@sacw.com) | [www.sacw.com](http://www.sacw.com)



Monday, October 8, 2018

Connecticut Siting Council  
Fred Cunliffe  
10 Franklin Square  
New Britain, CT 06051

**RE: Notice of Exempt Modification- 50 Pine Lane, Town of Windsor, CT, 06095- SITE ID: CT52XC025**

To Whom It May Concern:

- SAC Wireless, on behalf of Sprint, is requesting the necessary approvals from Connecticut Siting Council (CSC) our scope of work for an existing Sprint facility located at 50 Pine Line, Town of Windsor, CT, 06095. Scope of work is as follows:
  - Sprint is proposing to install fiber at the telecommunication facility located at the above address.
  - Sprint is proposing to install a new H-frame at the existing telecommunication facility
  - *No tower work will be performed; only ground work.* Therefore, no structural analysis or RF analysis required
  - Site is located at the coordinates 41.81985100 / -72.66717100
  - The underlying property owner of the site is the Town of Windsor
- RF Engineers have determined this minor modification is required to help increase the network for the residents and the workforce within the local jurisdiction by offering faster data transfer speeds, fewer dropped calls and higher capacity.
- CSC, please e-mail me any receipts for application fees and/or fees due after plan review, prior to permit issuance. If any questions or concerns arise, please contact me at 312-858-6544.
- We greatly appreciate your help with this proposed Sprint facility upgrade.

CC:

<b>First Selectman:</b> Donald S. Trinks	<b>Local Zoning Officer:</b> Eric Barz	<b>Local Permitting Officer:</b> Robert Ruzzo	<b>Underlying Property Owner:</b> The Town of Windsor
---	---	--	--

Sincerely,

Samantha Young | Zoning and Permitting Specialist | Phone: (312) 858-6544  
SAC Wireless, LLC- 540 W. Madison, 9<sup>th</sup> Floor, Chicago, IL 60661  
[samantha.young@sacw.com](mailto:samantha.young@sacw.com) | [www.sacw.com](http://www.sacw.com)

ORIGIN:ID:CHIA (312) 858-6544  
SAMANTHA YOUNG  
SAC WIRELESS  
540 W MADISON  
FLOOR 9  
CHICAGO, IL 60661  
UNITED STATES US

SHIP DATE: 08OCT18  
ACTWGT: 1.00 LB  
CAD: 103287817INMET4040  
BILL SENDER

TO **MELANIE A. BACHMAN**  
**CONNECTICUT SITING COUNCIL**  
**10 FRANKLIN SQUARE**

**NEW BRITAIN CT 06051**

(312) 858-6544 REF: CT52X025\_TO\_CSCG  
P.O. #0605 CT52X025 DEPT:

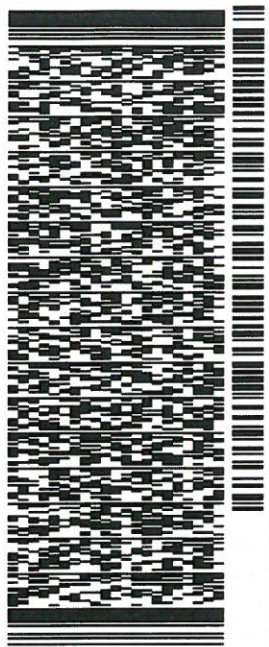

552J188FB/DCA5

WED - 10 OCT 4:30P

\*\* 2DAY \*\*

TRK# 7734 2328 2610  
0201

**SEBDLA**

06051  
CT-US BDL



**After printing this label:**

1. Use the 'Print' button on this page to print your label to your laser or inkjet printer.
2. Fold the printed page along the horizontal line.
3. Place label in shipping pouch and affix it to your shipment so that the barcode portion of the label can be read and scanned.

**Warning:** Use only the printed original label for shipping. Using a photocopy of this label for shipping purposes is fraudulent and could result in additional billing charges, along with the cancellation of your FedEx account number.

Use of this system constitutes your agreement to the service conditions in the current FedEx Service Guide, available on fedex.com. FedEx will not be responsible for any claim in excess of \$100 per package, whether the result of loss, damage, delay, non-delivery, misdelivery, or misinformation, unless you declare a higher value, pay an additional charge, document your actual loss and file a timely claim. Limitations found in the current FedEx Service Guide apply. Your right to recover from FedEx for any loss, including intrinsic value of the package, loss of sales, income interest, profit, attorney's fees, costs, and other forms of damage whether direct, incidental, consequential, or special is limited to the greater of \$100 or the authorized declared value. Recovery cannot exceed actual documented loss. Maximum for items of extraordinary value is \$1,000, e.g. jewelry, precious metals, negotiable instruments and other items listed in our Service Guide. Written claims must be filed within strict time limits, see current FedEx Service Guide.

ORIGIN ID:BDLA (312) 858-6544  
MELANIE A. BACHMAN  
CONNECTICUT SITING COUNCIL  
10 FRANKLIN SQUARE  
NEW BRITAIN, CT 06051  
UNITED STATES US

SHIP DATE: 08OCT18  
ACTWGT: 1.00 LB  
CAD: 103287817IN/ET4040

TO **SAMANTHA YOUNG**

**SAC WIRELESS**  
**540 W MADISON**  
**FLOOR 9**

**CHICAGO IL 60661**

(312) 858-6544 REF: CT152X0025\_TO\_ZONING  
INV: ER0602 CT152X0025 DEPT:

RMA:

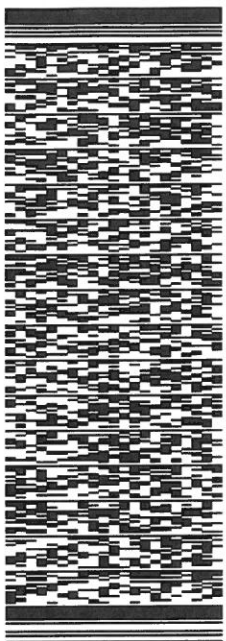

552.J168FB/DCA5

RETURNS MON-FRI

\*\* 2DAY \*\*

TRK# 7908 8326 7961  
0221

60661

IL-US



1. Select the 'Print' button to print 1 copy of each label.
2. The Return Shipment instructions, which provide your recipient with information on the returns process, will be printed with the label(s).
3. After printing, select your next step by clicking one of the displayed buttons.

**Note:** To review or print individual labels, select the Label button under each label image above.

Use of this system constitutes your agreement to the service conditions in the current FedEx Service Guide, available on fedex.com. FedEx will not be responsible for any claim in excess of \$100 per package, whether the result of loss, damage, delay, non-delivery, misdelivery, or misinformation, unless you declare a higher value, pay an additional charge, document your actual loss and file a timely claim. Limitations found in the current FedEx Service Guide apply. Your right to recover from FedEx for any loss, including intrinsic value of the package, loss of sales, income interest, profit, attorney's fees, costs, and other forms of damage whether direct, incidental, consequential, or special is limited to the greater of \$100 or the authorized declared value. Recovery cannot exceed actual documented loss. Maximum for items of extraordinary value is \$500, e.g. jewelry, precious metals, negotiable instruments and other items listed in our Service Guide. Written claims must be filed within strict time limits, see current FedEx Service Guide.

ORIGIN ID: CHIA (312) 858-6544  
SAMANTHA YOUNG  
SAC WIRELESS  
540 W MADISON  
FLOOR 9  
CHICAGO, IL 60661  
UNITED STATES US

SHIP DATE: 08OCT18  
ACTWGT: 1.00 LB  
CAD: 103287817INET4040  
BILL SENDER

TO **ROBERT RUZZO**  
**BUILDING DEPARTMENT**  
**275 BROAD STREET**

**WINDSOR CT 06095**  
(312) 858-6544

REF: CT52X025\_TO\_BUILDING

PO: ER0502 CT52X025

DEPT:

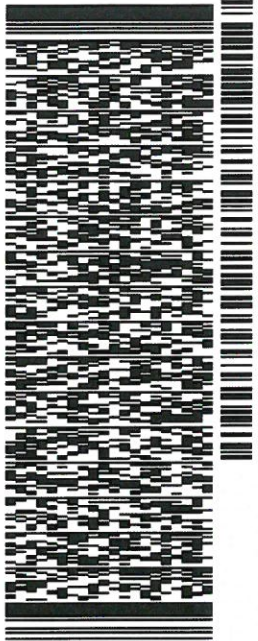

552J1/88FB/DCA5

WED - 10 OCT 4:30P

\*\* 2DAY \*\*

TRK# 7734 2320 0252  
0201

**SE EHTA**

06095  
CT-US BDL

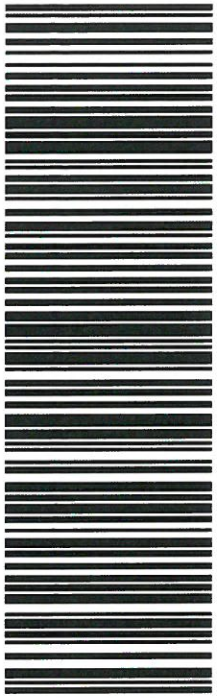

**After printing this label:**

1. Use the 'Print' button on this page to print your label to your laser or inkjet printer.
2. Fold the printed page along the horizontal line.
3. Place label in shipping pouch and affix it to your shipment so that the barcode portion of the label can be read and scanned.

**Warning:** Use only the printed original label for shipping. Using a photocopy of this label for shipping purposes is fraudulent and could result in additional billing charges, along with the cancellation of your FedEx account number.

Use of this system constitutes your agreement to the service conditions in the current FedEx Service Guide, available on fedex.com. FedEx will not be responsible for any claim in excess of \$100 per package, whether the result of loss, damage, delay, non-delivery, misdelivery, or misinformation, unless you declare a higher value, pay an additional charge, document your actual loss and file a timely claim. Limitations found in the current FedEx Service Guide apply. Your right to recover from FedEx for any loss, including intrinsic value of the package, loss of sales, income interest, profit, attorney's fees, costs, and other forms of damage whether direct, incidental, consequential, or special is limited to the greater of \$100 or the authorized declared value. Recovery cannot exceed actual documented loss. Maximum for items of extraordinary value is \$1,000, e.g. jewelry, precious metals, negotiable instruments and other items listed in our Service Guide. Written claims must be filed within strict time limits, see current FedEx Service Guide.

ORIGIN: CHIA (312) 858-6544  
SAC WIRELESS  
540 W MADISON  
FLOOR 9  
CHICAGO, IL 60661  
UNITED STATES US

SHIP DATE: 08OCT18  
ACTWGT: 1.00 LB  
CAD: 103287817INET4040  
BILL SENDER

TO **ERIC BARZ**  
**PLANNING AND ZONING DEPARTMENT**  
**275 BROAD STREET**

**WINDSOR CT 06095**

REF: CT152XC025\_TO\_ZONING

PO: ER0302 CT152XC025

DEPT:

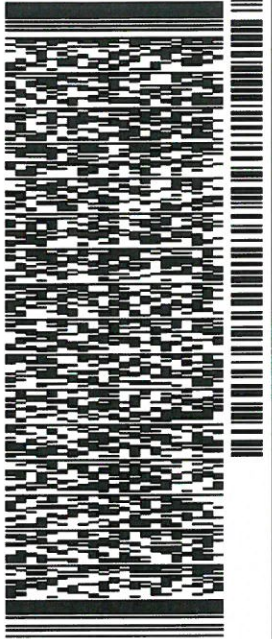

552.J1/88FB/DCA5

TRK# **7734 2316 3633**

WED - 10 OCT 4:30P  
\*\* 2DAY \*\*

**SE EHTA**

06095  
CT-US BDL



**After printing this label:**

1. Use the 'Print' button on this page to print your label to your laser or inkjet printer.
2. Fold the printed page along the horizontal line.
3. Place label in shipping pouch and affix it to your shipment so that the barcode portion of the label can be read and scanned.

**Warning:** Use only the printed original label for shipping. Using a photocopy of this label for shipping purposes is fraudulent and could result in additional billing charges, along with the cancellation of your FedEx account number.

Use of this system constitutes your agreement to the service conditions in the current FedEx Service Guide, available on fedex.com. FedEx will not be responsible for any claim in excess of \$100 per package, whether the result of loss, damage, delay, non-delivery, misdelivery, or misinformation, unless you declare a higher value, pay an additional charge, document your actual loss and file a timely claim. Limitations found in the current FedEx Service Guide apply. Your right to recover from FedEx for any loss, including intrinsic value of the package, loss of sales, income interest, profit, attorney's fees, costs, and other forms of damage whether direct, incidental, consequential, or special is limited to the greater of \$100 or the authorized declared value. Recovery cannot exceed actual documented loss. Maximum for items of extraordinary value is \$1,000, e.g. jewelry, precious metals, negotiable instruments and other items listed in our Service Guide. Written claims must be filed within strict time limits, see current FedEx Service Guide.

TRK# 7734 2310 8239  
 0201  
**SE EHTA**  
 CT-US BDL  
 06095  
 WED - 10 OCT 4:30P  
 \*\* 2DAY \*\*

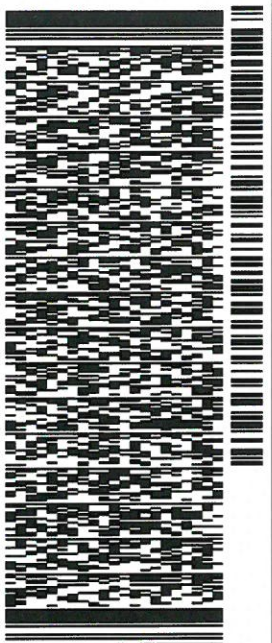

ORIGIN ID: CHIA (312) 858-6544  
 SAMANTHA YOUNG  
 SAC WIRELESS  
 540 W MADISON  
 FLOOR 9  
 CHICAGO, IL 60661  
 UNITED STATES US

TO DONALD S. TRINKS  
 FIRST SELECTMAN TOWN OF WINDSOR  
 275 BROAD STREET  
 WINDSOR CT 06095  
 (312) 858-6544  
 REF: CT152X0025\_TO\_SELECTMAN  
 DEPT: PO: ER0502 CT152X0025

SHIP DATE: 08OCT18  
 ACTWGT: 1.00 LB  
 CAD: 103287817/NET4040  
 BILL SENDER

552J1/88FB/DCA5

**After printing this label:**

1. Use the 'Print' button on this page to print your label to your laser or inkjet printer.
2. Fold the printed page along the horizontal line.
3. Place label in shipping pouch and affix it to your shipment so that the barcode portion of the label can be read and scanned.

**Warning:** Use only the printed original label for shipping. Using a photocopy of this label for shipping purposes is fraudulent and could result in additional billing charges, along with the cancellation of your FedEx account number.

Use of this system constitutes your agreement to the service conditions in the current FedEx Service Guide, available on fedex.com. FedEx will not be responsible for any claim in excess of \$100 per package, whether the result of loss, damage, delay, non-delivery, misdelivery, or misinformation, unless you declare a higher value, pay an additional charge, document your actual loss and file a timely claim. Limitations found in the current FedEx Service Guide apply. Your right to recover from FedEx for any loss, including intrinsic value of the package, loss of sales, income interest, profit, attorney's fees, costs, and other forms of damage whether direct, incidental, consequential, or special is limited to the greater of \$100 or the authorized declared value. Recovery cannot exceed actual documented loss. Maximum for items of extraordinary value is \$1,000, e.g. jewelry, precious metals, negotiable instruments and other items listed in our Service Guide. Written claims must be filed within strict time limits, see current FedEx Service Guide.



H25

STATE OF CONNECTICUT

CONNECTICUT SITING COUNCIL  
Ten Franklin Square, New Britain, CT 06051  
Phone: (860) 827-2935 Fax: (860) 827-2950  
E-Mail: [siting.council@ct.gov](mailto:siting.council@ct.gov)  
Internet: [ct.gov/csc](http://ct.gov/csc)

Daniel F. Caruso  
Chairman  
March 24, 2010

Thomas F. Flynn III  
Site Development Project Manager  
Maxton Technology Inc.  
1296 Blue Hills Avenue  
Bloomfield, CT 06002

RE: **EM-CLEARWIRE-164-100218** – Clearwire Corporation notice of intent to modify an existing telecommunications facility located at 50 Pine Lane, Windsor, Connecticut.

Dear Mr. Flynn:

The Connecticut Siting Council (Council) hereby acknowledges your notice to modify this existing telecommunications facility, pursuant to Section 16-50j-73 of the Regulations of Connecticut State Agencies.

The proposed modifications are to be implemented as specified here and in your notice dated February 18, 2010, including the placement of all necessary equipment and shelters within the tower compound. The modifications are in compliance with the exception criteria in Section 16-50j-72 (b) of the Regulations of Connecticut State Agencies as changes to an existing facility site that would not increase tower height, extend the boundaries of the tower site, increase noise levels at the tower site boundary by six decibels, and increase the total radio frequencies electromagnetic radiation power density measured at the tower site boundary to or above the standard adopted by the State Department of Environmental Protection pursuant to General Statutes § 22a-162. This facility has also been carefully modeled to ensure that radio frequency emissions are conservatively below State and federal standards applicable to the frequencies now used on this tower.

This decision is under the exclusive jurisdiction of the Council. Please be advised that the validity of this action shall expire one year from the date of this letter. Any additional change to this facility will require explicit notice to this agency pursuant to Regulations of Connecticut State Agencies Section 16-50j-73. Such notice shall include all relevant information regarding the proposed change with cumulative worst-case modeling of radio frequency exposure at the closest point of uncontrolled access to the tower base, consistent with Federal Communications Commission, Office of Engineering and Technology, Bulletin 65. Any deviation from this format may result in the Council implementing enforcement proceedings pursuant to General Statutes § 16-50u including, without limitation, imposition of expenses resulting from such failure and of civil penalties in an amount not less than one thousand dollars per day for each day of construction or operation in material violation.

Thank you for your attention and cooperation.

Very truly yours,

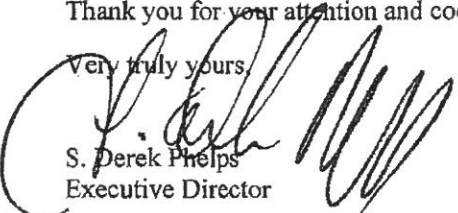
  
S. Derek Phelps  
Executive Director

SDP/MP/laf

c: The Honorable Donald Trinks, Mayor, Town of Windsor  
Peter Souza, Town Manager, Town of Windsor  
Eric Barz, Town Planner, Town of Windsor  
Christopher B. Fisher, Esq., Cuddy & Feder LLP

G:\EM\Clearwire\Windsor\032210\PineLane.DOC





# Sprint



# Sprint



AUGMENT ID: CT-HFD0025F18.1  
 SPRINT SITE CASCADE: CT52XC025/CT-HFD0025F18.1  
 SPRINT SITE NAME: AT&T PINE LANE  
 SITE TYPE: MONOPOLE  
 LANDLORD SITE ID: N/A

SITE ADDRESS: 50 PINE LANE  
 WINDSOR, CT 06095  
 COUNTY: HARTFORD  
 JURISDICTION: TOWN OF WINDSOR

**SPRINT CLEARWIRE MW-TO-LIT FIBER**



WIRELESS

540 W. MADISON ST., 9TH FLOOR  
 CHICAGO, IL 60661

**FULLERTON**  
 ENGINEERING DESIGN

1100 E. WOODFIELD ROAD, SUITE 500  
 SCHAUMBURG, ILLINOIS 60173  
 TEL: 847-908-8400  
 COA# PEC.0001444  
 www.FullertonEngineering.com

**PROJECT INFORMATION**

**DRAWING INDEX**

**SITE LOCATION MAP**

**SPRINT SITE CASCADE:** CT52XC025/CT-HFD0025F18.1  
**SPRINT SITE NAME:** AT&T PINE LANE  
**LANDLORD SITE ID:** N/A  
**SITE ADDRESS:** 50 PINE LANE  
 WINDSOR, CT 06095  
**COUNTY:** HARTFORD  
**MAP/PARCEL #:** -  
**LATITUDE:** 41.819842°  
**LONGITUDE:** -72.667287°  
**LAT/LONG TYPE:** NAD83  
**GROUND ELEV. (A.M.S.L.):** 89'  
**CURRENT ZONING:** -  
**JURISDICTION:** TOWN OF WINDSOR  
**OCCUPANCY CLASSIFICATION:** -  
**CONSTRUCTION TYPE:** MONOPOLE  
**A.D.A. COMPLIANCE:** FACILITY IS UNMANNED AND NOT FOR HUMAN HABITATION  
**PROPERTY OWNER:** TOWN OF WINDSOR  
 275 BROAD STREET  
 WINDSOR, CT 06095  
**CARRIER/APPLICANT:** SPRINT  
 6391 SPRINT PARKWAY  
 OVERLAND PARK, KS 66251-2650  
**ELECTRIC PROVIDER:** -  
**FIBER PROVIDER:** COMCAST  
**PROPOSED USE:** TELECOMMUNICATIONS FACILITY

T-1	TITLE SHEET
AAV-1	CLEARWIRE MW-TO-LIT FIBER SITE PLANS
AAV-2	CLEARWIRE MW-TO-LIT FIBER EQUIPMENT DETAILS
AAV-3	CLEARWIRE MW-TO-LIT FIBER EQUIPMENT DETAILS
AAV-4	SITE PHOTOS

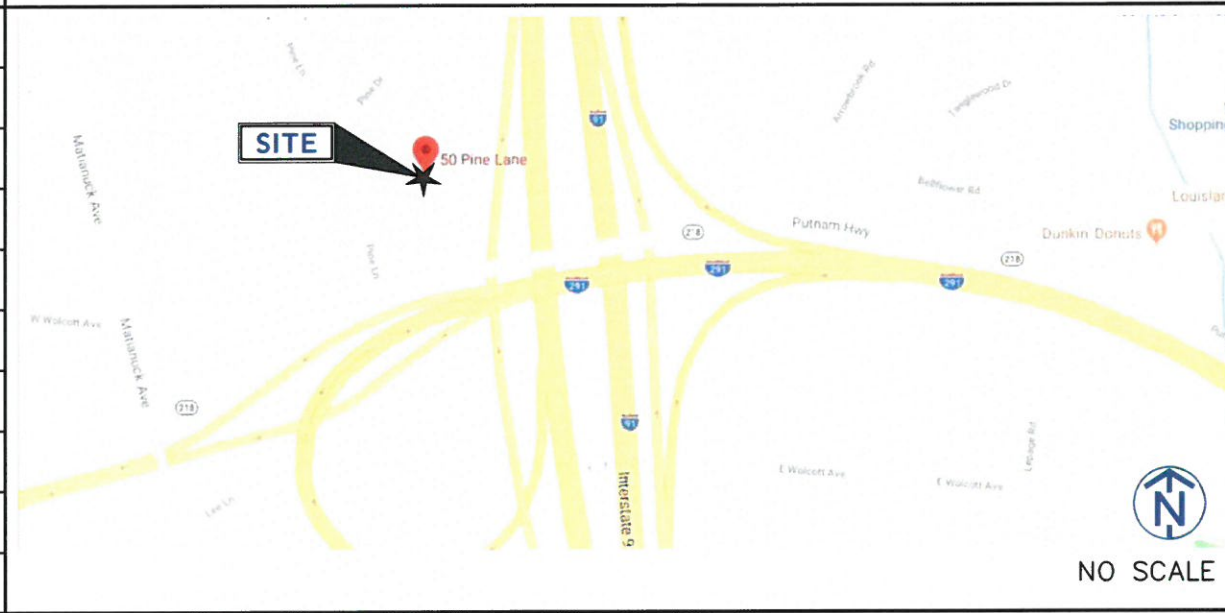

REV	DATE	DESCRIPTION	BY
A	7/12/18	90% REVIEW	KV
B	7/31/18	100% REVIEW	EM
0	8/17/18	FINAL	PK
1	9/13/18	REVISED FINAL	PK

I HEREBY CERTIFY THAT THESE DRAWINGS WERE PREPARED BY ME OR UNDER MY DIRECT SUPERVISION AND CONTROL, AND TO THE BEST OF MY KNOWLEDGE AND BELIEF COMPLY WITH THE REQUIREMENTS OF ALL APPLICABLE CODES.



**PROJECT CONSULTANTS**

**SAC CONTACTS:** SAC WIRELESS  
 540 W. MADISON ST., 9TH FLOOR  
 CHICAGO, IL 60661  
 ERIC LEE (815) 793-0730  
 eric.lee@sacw.com  
**SPRINT CONTACT:** ARRIN ARENSMAN  
 (913) 481-7344  
 arrin.arensman@sprint.com  
**ENGINEER/ARCHITECT:** FULLERTON ENGINEERING  
 1100 E. WOODFIELD ROAD, SUITE 500  
 SCHAUMBURG, ILLINOIS 60173  
**CONTACT:** POLINA KOSEVA  
 (847) 908-8476  
 pkoseva@fullertonengineering.com  
**PHONE:**  
**EMAIL:**

**SCOPE OF WORK**

THE SCOPE OF WORK CONSISTS OF:

SPRINT:

- INSTALL NEW H-FRAME NEXT TO EXISTING CLEARWIRE CABINET.
- INSTALL NEW PURCELL CABINET ON NEW H-FRAME.
- INSTALL 7' OF NEW (2) 2"Ø CONDUITS AND FIBER FROM EXISTING CLEARWIRE CABINET TO NEW NID INSIDE NEW PURCELL TELCO CABINET ON NEW H-FRAME.
- INSTALL 15' NEW 3" CONDUIT W/ (2) 1" INNER-DUCTS FROM NEW NID ON NEW H-FRAME TO EXISTING COMMUNITY BOX/NEW MMP.

FIBER VENDOR:

- INSTALL 15' NEW FIBER WITHIN NEW 3" CONDUIT W/ (2) 1" INNER-DUCTS FROM NEW NID ON NEW H-FRAME TO EXISTING COMMUNITY BOX/NEW MMP.
- INSTALL NEW NID INSIDE NEW PURCELL TELCO CABINET ON NEW H-FRAME.

- CONTRACTOR SHALL FURNISH ALL MATERIAL WITH THE EXCEPTION OF SPRINT SUPPLIED MATERIAL.
- ALL MATERIAL SHALL BE INSTALLED BY THE CONTRACTOR, UNLESS STATED OTHERWISE.

NOTE: DRAWING SCALES ARE FOR 11"x17" SHEETS UNLESS OTHERWISE NOTED

**APPLICABLE BUILDING CODES AND STANDARDS**

ALL WORK AND MATERIALS SHALL BE PERFORMED AND INSTALLED IN ACCORDANCE WITH THE CURRENT EDITIONS OF THE FOLLOWING CODES AS ADOPTED BY THE LOCAL GOVERNING AUTHORITIES. NOTHING IN THESE PLANS IS TO BE CONSTRUCTED TO PERMIT WORK NOT CONFORMING TO THESE CODES.

- 2012 INTERNATIONAL BUILDING CODE
- 2012 INTERNATIONAL ENERGY CONSERVATION CODE
- 2012 INTERNATIONAL EXISTING BUILDING CODE
- 2012 INTERNATIONAL FIRE CODE
- 2012 INTERNATIONAL MECHANICAL CODE
- 2012 INTERNATIONAL PLUMBING CODE
- 2012 INTERNATIONAL RESIDENTIAL CODE

**DRIVING DIRECTIONS:**  
 DEPART BRADLEY INTERNATIONAL AIRPORT ON TERMINAL RD ROAD NAME CHANGES TO BRADLEY FIELD CONNECTOR CT-20/I-91/HARTFORD/ SPRINGFIELD ROAD NAME CHANGES TO CT-20 TAKE RAMP ONTO I-91 S/HARTFORD AT EXIT 35B, TURN LEFT ONTO RAMP CT-218/WINDSOR/BLOOMFIELD TURN RIGHT ONTO CT-218 TURN RIGHT ONTO LOCAL ROAD(S) ARRIVE AT SITE.

**GENERAL ABBREVIATIONS**

FV	FIBER VENDOR
DFV	DARK FIBER VENDER
MMP	MEET ME POINT
NID	NETWORK INTERFACE DEVICE
MMBTS	MULTI MODAL BASE TRANSMISSION STATION
AGL	ABOVE GRADE LEVEL
APPROX	APPROXIMATE
BLDG	BUILDING
CL	CENTERLINE
CND	CONDUIT
FT	FOOT(FEET)
ELEV	ELEVATION
EQUIP	EQUIPMENT
(E)	EXISTING
N.T.S.	NOT TO SCALE
PPC	POWER PROTECTION CABINET
TELCO	TELCO
ROW	RIGHT OF WAY

- FACILITY IS UNMANNED AND NOT FOR HUMAN HABITATION.
- ADA ACCESS REQUIREMENTS ARE NOT REQUIRED.
- THIS FACILITY DOES NOT REQUIRE POTABLE WATER AND WILL NOT PRODUCE ANY SEWAGE



**SITE NAME**  
 AT&T PINE LANE

**SITE NUMBER:**  
 CT52XC025/  
 CT-HFD0025F18.1

**SITE ADDRESS**  
 50 PINE LANE  
 WINDSOR, CT 06095

**SHEET TITLE**  
 TITLE SHEET

**SHEET NUMBER**  
 T-1

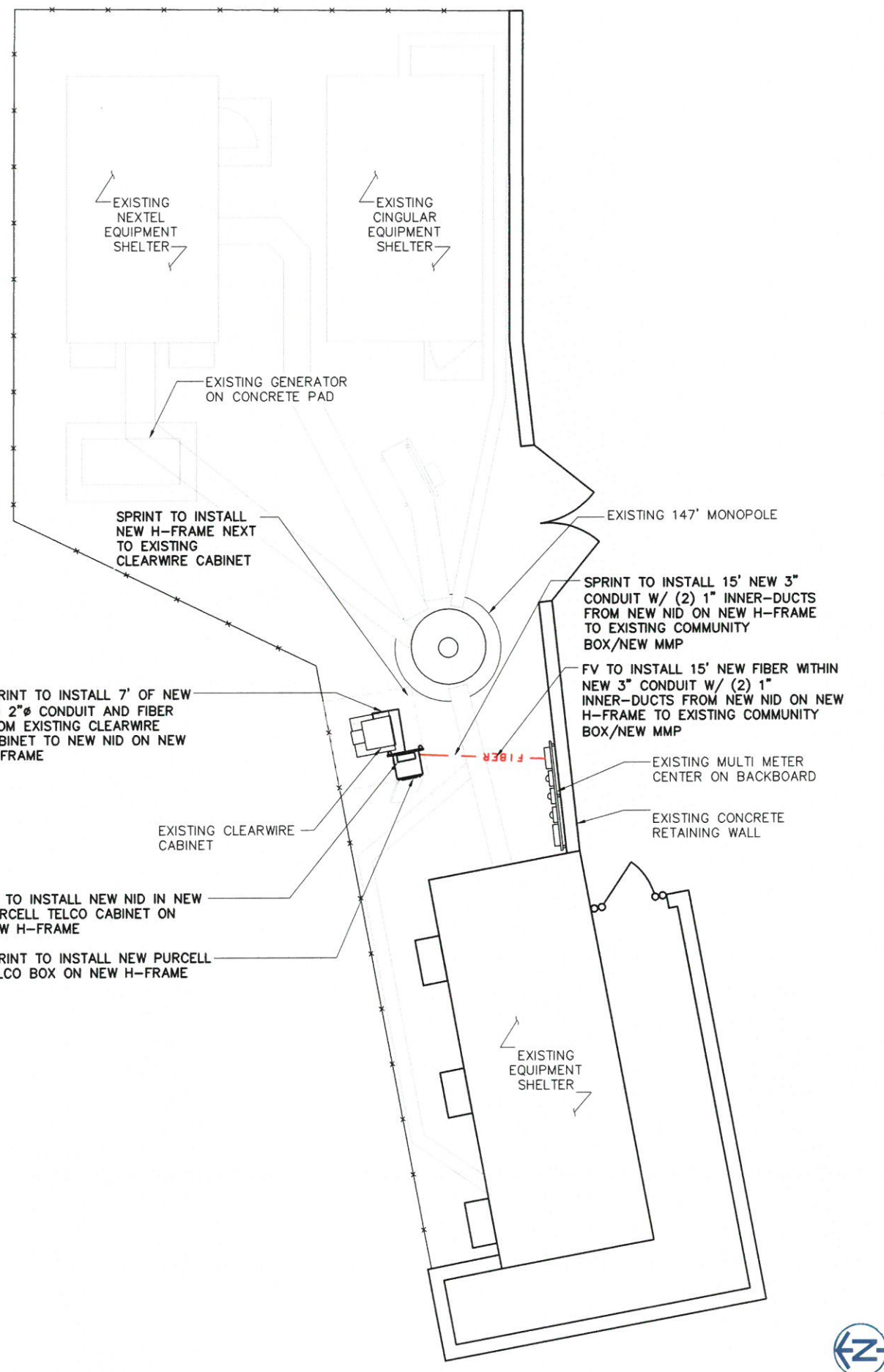

DETAILED SITE PLAN

SCALE: 3/32" = 1'-0"

1

**PROJECT SCOPE:**

**SPRINT:**

1. INSTALL NEW H-FRAME NEXT TO EXISTING CLEARWIRE CABINET.
2. INSTALL NEW PURCELL CABINET ON NEW H-FRAME.
3. INSTALL 7' OF NEW (2) 2" CONDUITS AND FIBER FROM EXISTING CLEARWIRE CABINET TO NEW NID INSIDE NEW PURCELL TELCO CABINET ON NEW H-FRAME.
4. INSTALL 15' NEW 3" CONDUIT W/ (2) 1" INNER-DUCTS FROM NEW NID ON NEW H-FRAME TO EXISTING COMMUNITY BOX/NEW MMP.

**FIBER VENDOR:**

1. INSTALL 15' NEW FIBER WITHIN NEW 3" CONDUIT W/ (2) 1" INNER-DUCTS FROM NEW NID ON NEW H-FRAME TO EXISTING COMMUNITY BOX/NEW MMP.
2. INSTALL NEW NID INSIDE NEW PURCELL TELCO CABINET ON NEW H-FRAME.

**SITE NOTES:**

1. SITE INFORMATION WAS PREPARED USING EXISTING DOCUMENTATION AND /OR SITE MEASUREMENTS AND SHOULD NOT BE INTERPRETED AS AN ACCURATE BOUNDARY SURVEY.
2. THIS SITE PLAN WAS PREPARED WITHOUT THE BENEFIT OF A TITLE REPORT AND IS SUBJECT TO ALL THE EASEMENTS AND RESTRICTIONS OF RECORD
3. CONTRACTOR SHALL MAKE A UTILITY "ONE CALL" TO LOCATE ALL UTILITIES PRIOR TO CONSTRUCTION. CONTRACTOR SHALL BE RESPONSIBLE FOR COORDINATING A PRIVATE UTILITY LOCATE IF NEEDED TO DETERMINE THE UNDERGROUND STRUCTURES ON PRIVATE PROPERTY. THESE DRAWINGS DO NOT DEPICT ALL UNDERGROUND UTILITIES IN THE PROJECT AREA.
4. LATITUDE AND LONGITUDE COORDINATES ASSOCIATED WITH NEW EQUIPMENT/INFRASTRUCTURE WERE BASED UPON GOOGLE EARTH AND WERE NOT FIELD VERIFIED FOR PRECISION. THE EXACT LOCATION OF NEW EQUIPMENT/INFRASTRUCTURE SHALL BE FIELD VERIFIED WITH SPRINT, SAC AND/OR FV.

**ROLES AND RESPONSIBILITIES:**

**SPRINT R&R:**

1. SPRINT TO PERFORM ALL NEW CONDUIT INSTALLATIONS FROM THE MMP TO THE PPC AND FROM PPC TO MMBTS.
2. SPRINT TO PROVIDE ITS TELCO CABINET TO FV FOR THE NEW NID IF SPACE ALLOWS.
3. SPRINT TO PROVIDE POWER TO FV NID.

**FIBER VENDOR R&R:**

1. FIBER VENDOR RESPONSIBLE FOR ANY NEW CONDUIT INSTALLATION, FIBER WORK OR MMP CONSTRUCTION REQUIRED FROM THE ROW TO THE MMP.
2. FIBER VENDOR RESPONSIBLE FOR PULLING FIBER FROM MMP TO NID.
3. FIBER VENDOR RESPONSIBLE FOR PULLING FIBER FROM NID TO MMBTS.
4. FIBER VENDOR RESPONSIBLE FOR INSTALL OF NID WHETHER IT BE IN THE TELCO CABINET OR ELSEWHERE. NID TO BE INSTALLED IN TELCO CABINET UNLESS SPACE IS UNAVAILABLE AND THEREFORE SPECIFIED OTHERWISE.

**GENERAL NOTES**

SCALE: N.T.S. 2

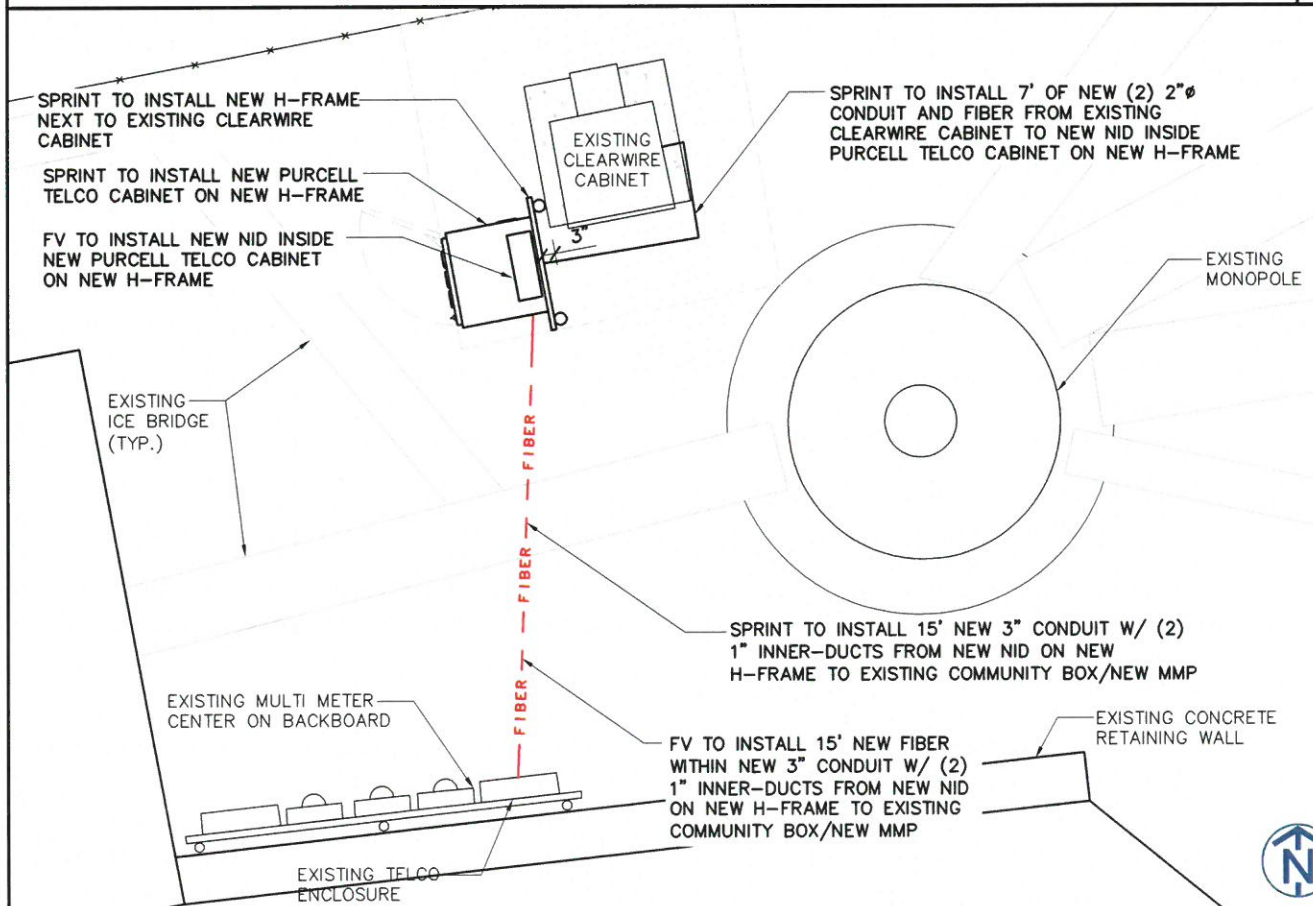

EQUIPMENT PLAN

SCALE: 1/4" = 1'-0"

3



WIRELESS

540 W. MADISON ST., 9TH FLOOR  
CHICAGO, IL 60661



1100 E. WOODFIELD ROAD, SUITE 500  
SCHAUMBURG, ILLINOIS 60173  
TEL: 847-908-8400  
COA# PEC.0001444  
www.FullertonEngineering.com

REV	DATE	DESCRIPTION	BY
A	7/12/18	90% REVIEW	KV
B	7/31/18	100% REVIEW	EM
O	8/17/18	FINAL	PK
1	9/13/18	REVISED FINAL	PK

I HEREBY CERTIFY THAT THESE DRAWINGS WERE PREPARED BY ME OR UNDER MY DIRECT SUPERVISION AND CONTROL, AND TO THE BEST OF MY KNOWLEDGE AND BELIEF COMPLY WITH THE REQUIREMENTS OF ALL APPLICABLE CODES.



SITE NAME  
**AT&T PINE LANE**

SITE NUMBER:  
**CT52XC025/  
CT-HFD0025F18.1**

SITE ADDRESS  
**50 PINE LANE  
WINDSOR, CT 06095**

SHEET TITLE  
**CLEARWIRE  
MW-TO-LIT FIBER  
SITE PLANS**

SHEET NUMBER  
**AAV-1**

**NOTES:**  
 1. SPRINT TO INSTALL ALL NEW CONDUIT FOR PROJECT  
 2. FIBER VENDOR TO INSTALL ALL NEW FIBER THROUGH EXISTING AND PROPOSED CONDUIT

POWER — FIBER — GROUND —

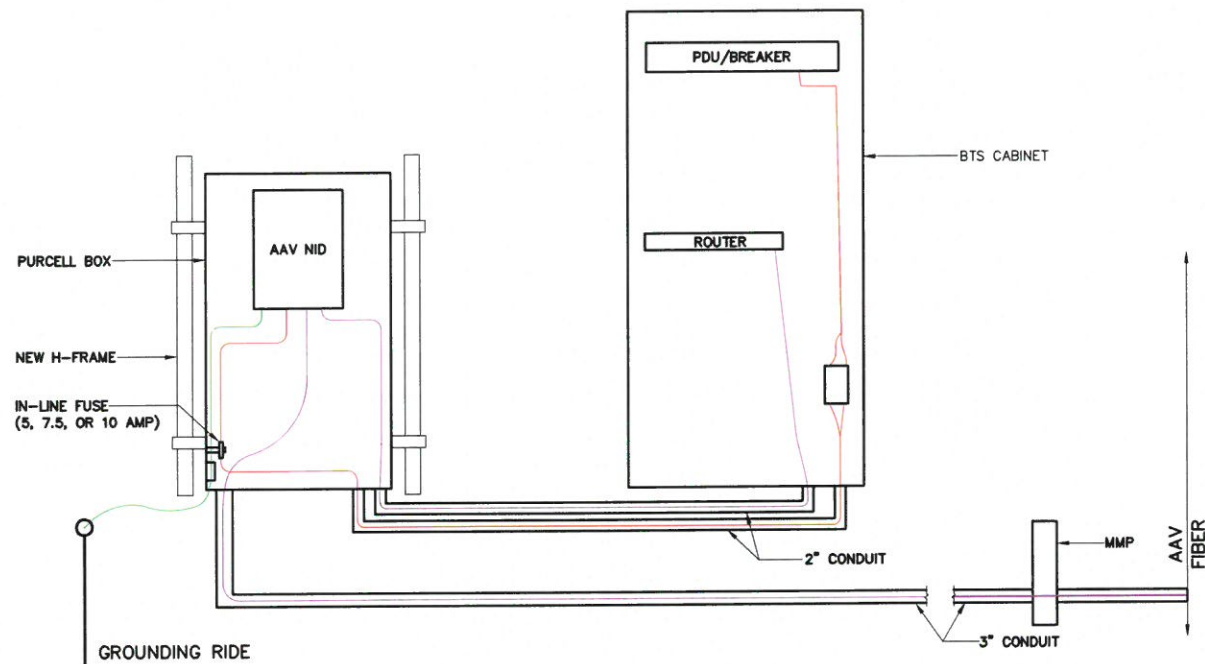

PLUMBING DIAGRAM

SCALE: N.T.S.

1

H-FRAME DETAIL

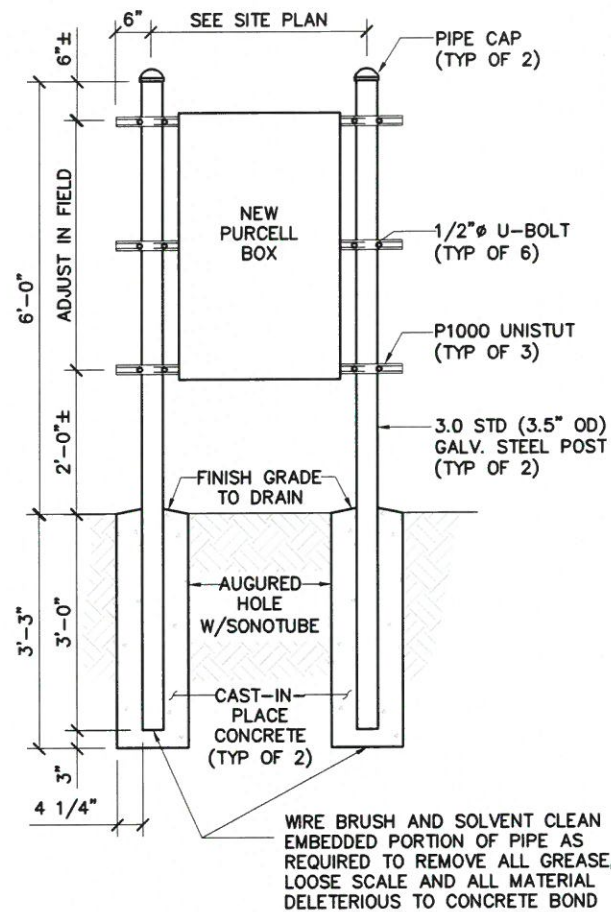

SCALE: N.T.S.

2

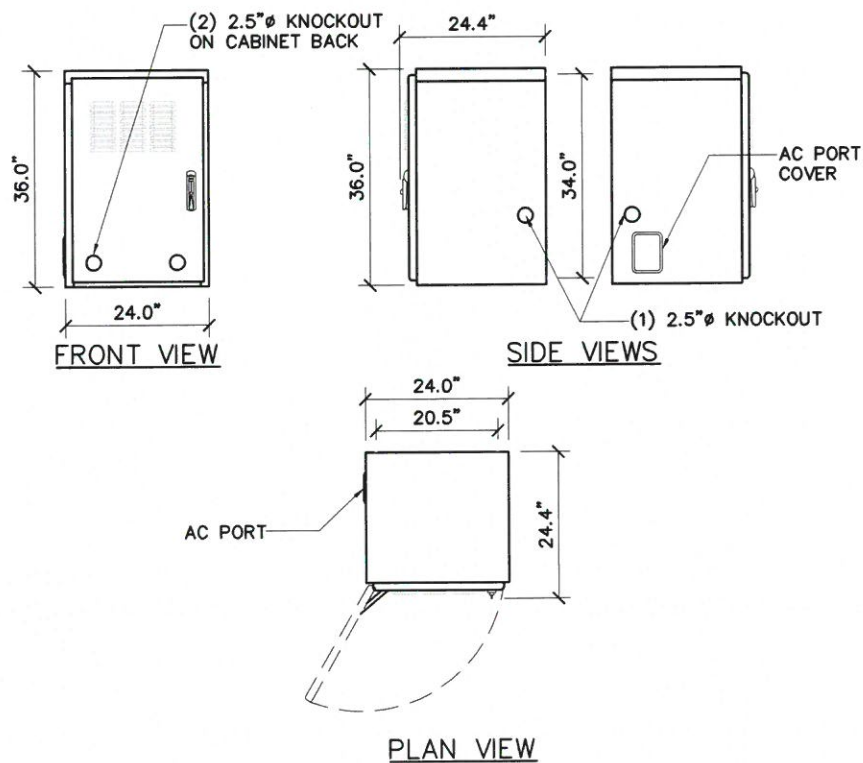

PURCELL TELCO BOX SPECS

SCALE: 3/8" = 1'-0"

3

NOT USED

SCALE: N.T.S.

4



WIRELESS

540 W. MADISON ST., 9TH FLOOR  
 CHICAGO, IL 60661

**FULLERTON**  
 ENGINEERING DESIGN

1100 E. WOODFIELD ROAD, SUITE 500  
 SCHAUMBURG, ILLINOIS 60173  
 TEL: 847-908-8400  
 COA# PEC.0001444  
 www.FullertonEngineering.com

REV	DATE	DESCRIPTION	BY
A	7/12/18	90% REVIEW	KV
B	7/31/18	100% REVIEW	EM
0	8/17/18	FINAL	PK
1	9/13/18	REVISED FINAL	PK

I HEREBY CERTIFY THAT THESE DRAWINGS WERE PREPARED BY ME OR UNDER MY DIRECT SUPERVISION AND CONTROL, AND TO THE BEST OF MY KNOWLEDGE AND BELIEF COMPLY WITH THE REQUIREMENTS OF ALL APPLICABLE CODES.



SITE NAME

AT&T PINE LANE

SITE NUMBER:

CT52XC025/  
 CT-HFD0025F18.1

SITE ADDRESS

50 PINE LANE  
 WINDSOR, CT 06095

SHEET TITLE

CLEARWIRE  
 MW-TO-LIT FIBER  
 EQUIPMENT DETAILS

SHEET NUMBER

AAV-2

REV	DATE	DESCRIPTION	BY
A	7/12/18	90% REVIEW	KV
B	7/31/18	100% REVIEW	EM
0	8/17/18	FINAL	PK
1	9/13/18	REVISED FINAL	PK

I HEREBY CERTIFY THAT THESE DRAWINGS WERE PREPARED BY ME OR UNDER MY DIRECT SUPERVISION AND CONTROL, AND TO THE BEST OF MY KNOWLEDGE AND BELIEF COMPLY WITH THE REQUIREMENTS OF ALL APPLICABLE CODES.



SITE NAME

**AT&T PINE LANE**

SITE NUMBER:

**CT52XC025/  
CT-HFD0025F18.1**

SITE ADDRESS

50 PINE LANE  
WINDSOR, CT 06095

SHEET TITLE

**CLEARWIRE  
MW-TO-LIT FIBER  
EQUIPMENT DETAILS**

SHEET NUMBER

**AAV-3**

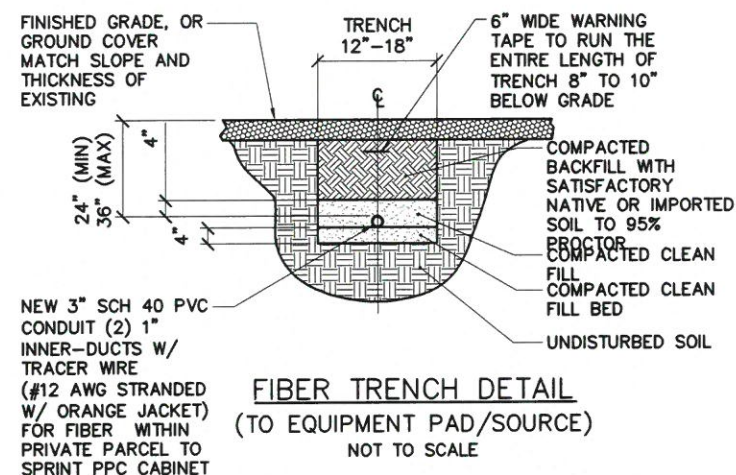

**UTILITY TRENCH NOTES:**

1. CONDUIT SIZE, TYPE, QUANTITY, AND SEPARATION DIMENSION TO BE VERIFIED WITH LOCAL UTILITY.
2. ALL UTILITY TRENCHES WITHIN THE FENCED COMPOUND OR UNDER ANY PORTION OF A GRAVEL DRIVE AND/OR ROADWAY SHALL BE BACKFILLED WITH COMPACTED AGGREGATE.
3. ALL CONDUITS SHALL BE INSTALLED WITH 3/16" POLYPROPYLENE ROPE (PULL STRING) OR MULE TAPE SUITABLE FOR PULLING CABLE THROUGH DUCT.
4. ALL CONDUITS THAT ARE TO BE USED FOR FIBER/ALARM SHALL BE INSTALLED WITH A TRACER WIRE (#12 AWG STRANDED W/ ORANGE JACKET).
5. ALL CONDUITS SHALL BE CLEAN INSIDE WITH NO DIRT OR ANY OTHER OBSTRUCTIONS.
6. ALL BENDS MUST SWEEP 36" RADIUS AND MAXIMUM OF 3 SWEEPS. ANY ADDITIONAL SWEEPS MUST BE APPROVED BY THE UTILITY COMPANY.
7. THE CONTRACTOR SHALL VERIFY AND FOLLOW THE UTILITY COMPANY SPECIFICATIONS FOR INSTALLATIONS.
8. THE CONTRACTOR SHALL LOCATE ALL EXISTING UTILITIES WITHIN THE COMPOUND AND INSTALL PULL BOXES WHERE NEEDED TO AVOID ANY EXISTING UTILITIES. CONTRACTOR MUST EXERCISE EXTREME CAUTION WHEN TRENCHING AND HAND DIG AROUND EXISTING UTILITIES AS REQUIRED.
9. CONTRACTOR SHALL LOCATE ALL EXISTING UTILITIES WITHIN THE COMPOUND AND INSTALL PULLBOXES WHERE NEEDED TO AVOID ANY EXISTING UTILITIES. CONTRACTOR MUST EXERCISE EXTREME CAUTION WHEN TRENCHING AND HAND DIG AROUND EXISTING UTILITIES AS REQUIRED.

**TRENCH DETAIL**

SCALE: N.T.S. 1

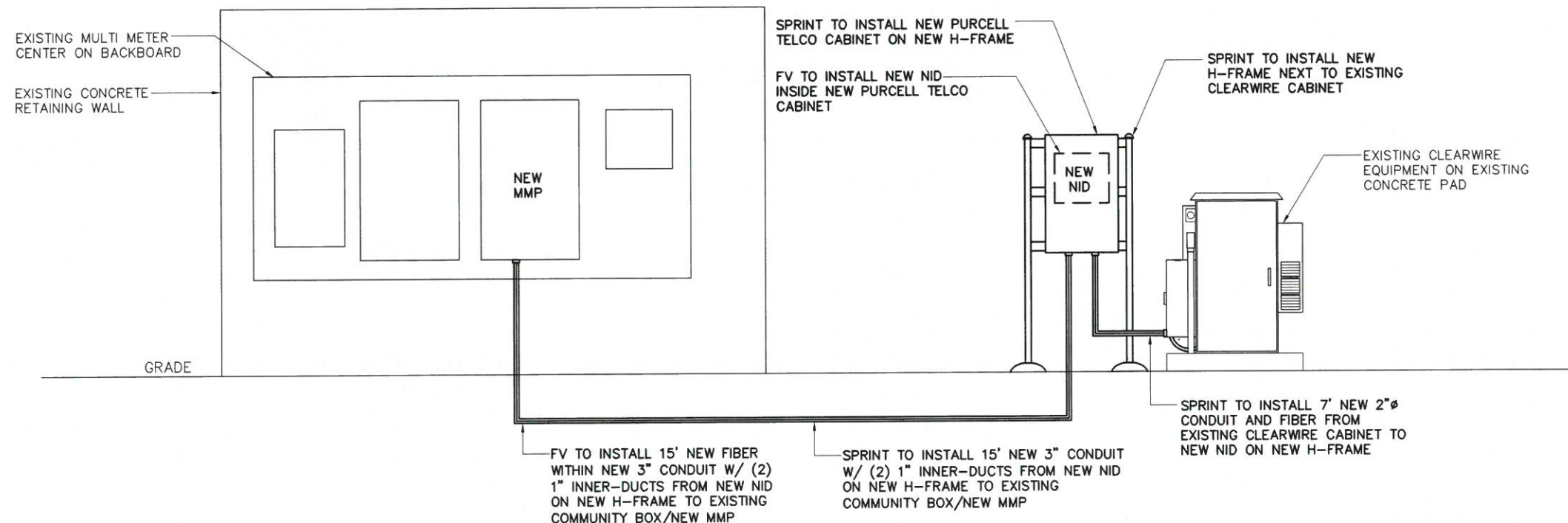

**FIBER SCHEMATIC**

SCALE: N.T.S. 2



540 W. MADISON ST., 9TH FLOOR  
CHICAGO, IL 60661



1100 E. WOODFIELD ROAD, SUITE 500  
SCHAUMBURG, ILLINOIS 60173  
TEL: 847-908-8400  
COA# PEC.0001444  
www.FullertonEngineering.com



NEW MMP SCALE: N.T.S. 1 NOT USED SCALE: N.T.S. 2 NEW H-FRAME SCALE: N.T.S. 3

REV	DATE	DESCRIPTION	BY
A	7/12/18	90% REVIEW	KV
B	7/31/18	100% REVIEW	EM
0	8/17/18	FINAL	PK
1	9/13/18	REVISED FINAL	PK

I HEREBY CERTIFY THAT THESE DRAWINGS WERE PREPARED BY ME OR UNDER MY DIRECT SUPERVISION AND CONTROL, AND TO THE BEST OF MY KNOWLEDGE AND BELIEF COMPLY WITH THE REQUIREMENTS OF ALL APPLICABLE CODES.



INSIDE CLEARWIRE CABINET SCALE: N.T.S. 4 CONDUIT RUN BEHIND MMBTS SCALE: N.T.S. 5 NEW CONDUIT PATH SCALE: N.T.S. 6

SITE NAME  
**AT&T PINE LANE**

SITE NUMBER:  
**CT52XC025/  
CT-HFD0025F18.1**

SITE ADDRESS  
**50 PINE LANE  
WINDSOR, CT 06095**

SHEET TITLE  
**SITE PHOTOS**

SHEET NUMBER  
**AAV-4**



NOT USED SCALE: N.T.S. 7 SITE OVERVIEW SCALE: N.T.S. 8 NOT USED SCALE: N.T.S. 9



TRACK ANOTHER SHIPMENT

773423108239



Shipping label has been created. The status will be updated when shipment begins to travel.

Scheduled delivery:  
Wednesday 10/10/2018 by 4:30 pm



LABEL CREATED

Shipment information sent to FedEx

GET STATUS UPDATES

FROM

SAC Wireless  
Samantha Young  
Floor 9  
540 W Madison  
CHICAGO, IL US 60661  
312 858-6544

TO

First Selectman Town of Windsor  
Donald S. Trinks  
275 Broad Street  
WINDSOR, CT US 06095  
312 858-6544

TRACKING NUMBER

773423108239

SERVICE

FedEx 2Day

WEIGHT

0.5 lbs / 0.23 kgs

TOTAL PIECES

1

TOTAL SHIPMENT WEIGHT

0.5 lbs / 0.23 kgs

TERMS

Not Available

DIIDCHASE ORDER NUMBER





TRACK ANOTHER SHIPMENT

773423200252



Shipping label has been created. The status will be updated when shipment begins to travel.

Scheduled delivery:  
Wednesday 10/10/2018 by 4:30 pm



LABEL CREATED

Shipment information sent to FedEx

GET STATUS UPDATES

FROM

SAC Wireless  
Samantha Young  
Floor 9  
540 W Madison  
CHICAGO, IL US 60661  
312 858-6544

TO

Building Department  
Robert Ruzzo  
275 Broad Street  
WINDSOR, CT US 06095  
312 858-6544

TRACKING NUMBER

773423200252

SERVICE

FedEx 2Day

WEIGHT

0.5 lbs / 0.23 kgs

TOTAL PIECES

1

TOTAL SHIPMENT WEIGHT

0.5 lbs / 0.23 kgs

TERMS

Not Available

DIIDCHASE ODDER NUMBER





SHIPMENT REFERENCE  
CT52XC025\_to\_building

**PACKAGING**

FedEx Envelope

**SPECIAL HANDLING SECTION**

Deliver Weekday

**ANTICIPATED SHIP DATE**



Mon 10/08/2018

**SCHEDULED DELIVERY**



Wed 10/10/2018 by 4:30 pm

**OUR COMPANY**

- About FedEx
- Our Portfolio
- Investor Relations
- Careers
- FedEx Blog
- Corporate Responsibility
- Newsroom
- Contact Us

**MORE FROM FEDEX**

- FedEx Compatible
- Developer Resource Center
- FedEx Cross Border

**LANGUAGE**

Change Country

**FOLLOW FEDEX**

Ask FedEx





**SHIPMENT REFERENCE**  
CT52XC025\_to\_selectman

**PACKAGING**  
FedEx Envelope

**SPECIAL HANDLING SECTION**  
Deliver Weekday

**ANTICIPATED SHIP DATE**  
 Mon 10/08/2018

**SCHEDULED DELIVERY**  
 Wed 10/10/2018 by 4:30 pm

**OUR COMPANY**

- About FedEx
- Our Portfolio
- Investor Relations
- Careers
- FedEx Blog
- Corporate Responsibility
- Newsroom
- Contact Us

**MORE FROM FEDEX**

- FedEx Compatible
- Developer Resource Center
- FedEx Cross Border

**LANGUAGE**

Change Country

English

**FOLLOW FEDEX**

Ask FedEx



TRACK ANOTHER SHIPMENT

773423163633



Shipping label has been created. The status will be updated when shipment begins to travel.

Scheduled delivery:  
Wednesday 10/10/2018 by 4:30 pm



LABEL CREATED

Shipment information sent to FedEx

GET STATUS UPDATES

FROM

SAC Wireless  
Samantha Young  
Floor 9  
540 W Madison  
CHICAGO, IL US 60661  
312 858-6544

TO

Planning and Zoning Department  
Eric Barz  
275 Broad Street  
WINDSOR, CT US 06095  
312 858-6544

TRACKING NUMBER

773423163633

SERVICE

FedEx 2Day

WEIGHT

0.5 lbs / 0.23 kgs

TOTAL PIECES

1

TOTAL SHIPMENT WEIGHT

0.5 lbs / 0.23 kgs

TERMS

Not Available

DIIDCHASE ORDER NUMBER





SHIPMENT REFERENCE  
CT52XC025\_to\_zoning

**PACKAGING**

FedEx Envelope

**SPECIAL HANDLING SECTION**

Deliver Weekday

**ANTICIPATED SHIP DATE**



Mon 10/08/2018

**SCHEDULED DELIVERY**



Wed 10/10/2018 by 4:30 pm

**OUR COMPANY**

- About FedEx
- Our Portfolio
- Investor Relations
- Careers
- FedEx Blog
- Corporate Responsibility
- Newsroom
- Contact Us

**MORE FROM FEDEX**

- FedEx Compatible
- Developer Resource Center
- FedEx Cross Border

**LANGUAGE**

Change Country

**FOLLOW FEDEX**

Ask FedEx



TRACK ANOTHER SHIPMENT

773423243093



Shipping label has been created. The status will be updated when shipment begins to travel.

Scheduled delivery:  
Wednesday 10/10/2018 by 4:30 pm



LABEL CREATED

Shipment information sent to FedEx

GET STATUS UPDATES

FROM

SAC Wireless  
Samantha Young  
Floor 9  
540 W Madison  
CHICAGO, IL US 60661  
312 858-6544

TO

Underlying Property Owner  
275 Broad Street  
WINDSOR, CT US 06095  
312 858-6544

TRACKING NUMBER

773423243093

SERVICE

FedEx 2Day

WEIGHT

0.5 lbs / 0.23 kgs

TOTAL PIECES

1

TOTAL SHIPMENT WEIGHT

0.5 lbs / 0.23 kgs

TERMS

Not Available

PURCHASE ORDER NUMBER

ER0502 CT52XC025





**PACKAGING**

FedEx Envelope

**SPECIAL HANDLING SECTION**

Deliver Weekday

**ANTICIPATED SHIP DATE**



Mon 10/08/2018

**SCHEDULED DELIVERY**



Wed 10/10/2018 by 4:30 pm

**OUR COMPANY**

- About FedEx
- Our Portfolio
- Investor Relations
- Careers
- FedEx Blog
- Corporate Responsibility
- Newsroom
- Contact Us

**MORE FROM FEDEX**

- FedEx Compatible
- Developer Resource Center
- FedEx Cross Border

**LANGUAGE**

Change Country

English

**FOLLOW FEDEX**

Ask FedEx