

Mathews, Lisa A

pm - t - mobile - 151-160518

From: Hanlon, Dashanna <Dashanna.Hanlon@crowncastle.com>
Sent: Tuesday, May 24, 2016 2:26 PM
To: CSC-DL Siting Council
Cc: Myl, Kimberly
Subject: RE: City of Waterbury - T-Mobile CT11269B - Exempt Modification
Attachments: TMO700_CT11269B_Zoning App_CT Siting Council Package_05.24.16_City of Waterbury.pdf

Good afternoon,

Please see the attached revision of the Exempt Modification CT11269B. According to the attached communication, we need to provide you with a parcel map of the property. A parcel map and the assessor's information has been included in this PDF. If you require a resubmission by mail, please let me know and I will send out a revised package tomorrow.

Thank you,
Dashanna

DASHANNA HANLON
 Real Estate Project Coordinator
 T: (781) 970-0067 | M: (571) 241-0984

 **CROWN CASTLE**
 12 Gill Street, Suite 5800, Woburn, MA 01801
 Crowncastle.com

From: Nardi, Rebecca
Sent: Tuesday, May 17, 2016 4:15 PM
To: CSC-DL Siting Council
Cc: Pelon, Tricia; Myl, Kimberly; Hanlon, Dashanna
Subject: City of Waterbury - T-Mobile CT11269B - Exempt Modification

Good Afternoon -

Exempt Modification package was sent via FedEx for 5/18/16 delivery for T-Mobi

This email may contain confidential or privileged material. Use or disclosure of it by anyone other than the recipient is unauthorized. If you are not an intended recipient, please delete this email.

This map is for informational purposes only and does not constitute a warranty of accuracy. The City of Waterbury, Connecticut, and its employees, officers, agents, and contractors do not warrant, represent, or guarantee the accuracy of the information shown on this map. The information is provided as a public service and is subject to change without notice.



486	491	492
493	498	499
498	497	498

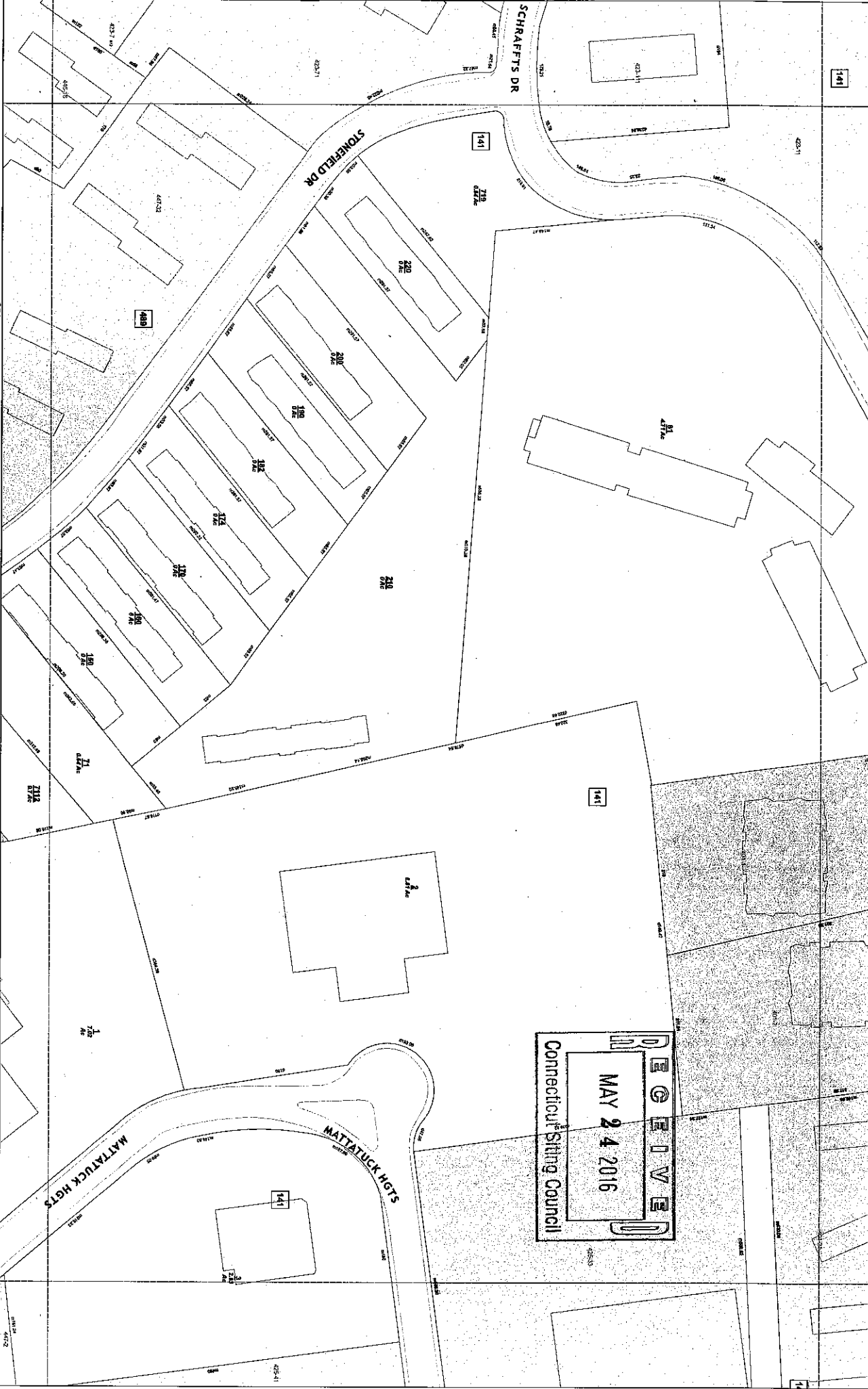

Connecticut Siting Council
MAY 24 2016

Receipt # 112028



Instr # 2012-01801

Antoinette C Spinelli, Waterbury Town Clerk

VOL 6896 PG 152

02/14/2012 03:33:30 PM

17 Pages

EASEMENT

Clerk:BG

Prepared out of State.

Return to:

Old Republic Title

Attn: Post Closing

530 South Main Street

Suite 1031 J.Hill

Akron, OH 44311

01-11176104-03E

SPACE ABOVE THIS LINE RESERVED FOR RECORDER'S USE

GRANT OF EASEMENT AND ASSIGNMENT OF LEASE

Facilities: 876317
Street Address: 150 Mattatuck Heights
City: Waterbury
County: New Haven
State: Connecticut
Tax Parcel: WATE-000424-000141-000001

between

GLOBAL SIGNAL ACQUISITIONS IV LLC,
a Delaware limited liability company ("GSA IV" or "Grantee")

and

150 MH, LLC, a Connecticut limited liability company, and
WATERBURY TWIN LLC, a Connecticut limited liability company
(collectively, "Grantor")