

February 1, 2019

Melanie Bachman, Executive Director
Connecticut Siting Council
Ten Franklin Square
New Britain, CT 06051

RE: The Connecticut Light and Power Company's Notice of Exempt Modification Pursuant to RCSA § 16-50j-57(a) to Existing Energy Facility Site at 90 Casterbridge Crossing in the Town of Simsbury, Connecticut ("Notice of Exempt Modification")

Dear Melanie Bachman:

The Connecticut Light and Power Company dba Eversource Energy ("Eversource") hereby gives notice to the Connecticut Siting Council of its intent to undertake an exempt modification in accordance with Section 16-50j-57(a) of the Regulations of Connecticut State Agencies ("RCSA") for the modification to Eversource's Northeast Simsbury Substation described herein.

Proposed Modification

The proposed modification would take place within the existing fenced area at Eversource's Northeast Simsbury Substation ("Substation"), located on Eversource property at 90 Casterbridge Crossing in the Town of Simsbury, Connecticut. The Substation is a 115- to 23-kV facility with one 115- to 23-kV transformer, two 115-kV transmission circuits and two 23-kV circuits.

Eversource proposes the following modification to the Substation:

- Installation of one new step down 115- to 23-kV (62.5 megavolt ampere) transformer.
- Installation of one new 115-kV circuit switcher.
- Installation of 23-kV distribution equipment (double-bus switchgear enclosure, tie breakers, relays, and potential transformers).

- Installation of a concrete fire wall/sound wall (approximately 33 feet long by 1 foot wide by 18 feet high) due to the proximity of the new transformer to the 23-kV switchgear enclosure.
- Removal of three existing 23-kV voltage transformers.
- Installation of foundations and relay/control cables to accommodate the new equipment.

The existing substation arrangement with the proposed modification is shown on Attachment A, Drawing No. 22805-92001 – Northeast Simsbury - Connecticut Siting Council Plan & Sections.

The proposed modification would not have a substantial adverse environmental effect or cause a significant adverse change or alteration in the physical or environmental characteristics of the Substation because:

- The modification would be made within the Substation's existing fenced area and would not impair the structural integrity of the facility.
- The new equipment would be shorter than the tallest existing structure within the Substation and would not cause any significant adverse change in the physical or environmental characteristics of the Substation.
- The work would not affect wetlands or waterways. The Substation is not located in a flood zone.
- Eversource's review of the Department of Energy and Environmental Protection's Natural Diversity Data Base ("NDDB") identified no state-listed endangered, threatened, or special concern species in the vicinity of the Substation.
- There would be no increase in television or radio interference resulting from the modification.
- Sound-pressure levels at all points along the perimeter of the property line would continue to meet state regulations.
- Electric and magnetic field levels at the Substation boundary would not change as a result of the modification.

Eversource proposes to commence construction in March 2019.

Enclosed are two (2) copies of this Notice of Exempt Modification along with the filing fee of \$625.00.

A notice of the exempt modification filing has been provided to the First Selectman of Simsbury.

Communications regarding this Notice of Exempt Modification should be directed to Kathleen M. Shanley at (860) 728-4527.

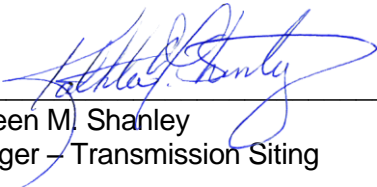
By: 
Kathleen M. Shanley
Manager – Transmission Siting

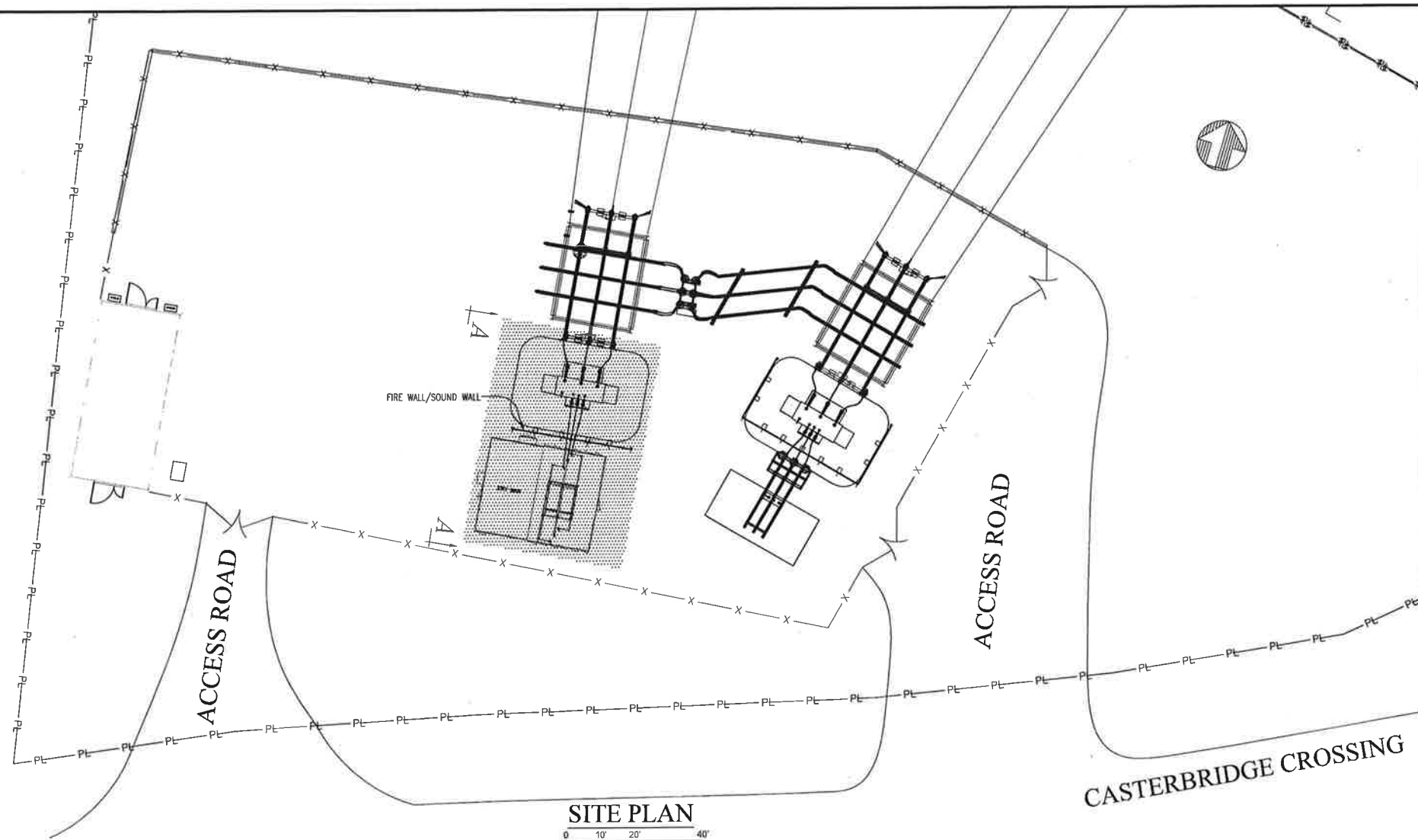

SITE PLAN

0 10' 20' 40'
SCALE: 1"=20'

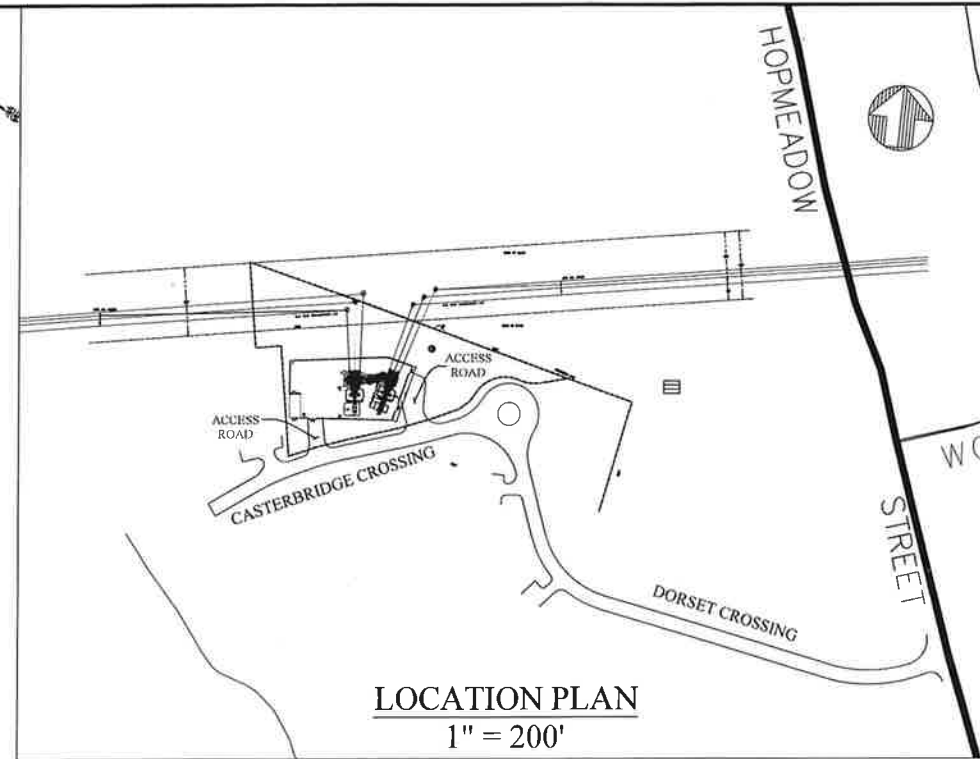

LOCATION PLAN
1" = 200'

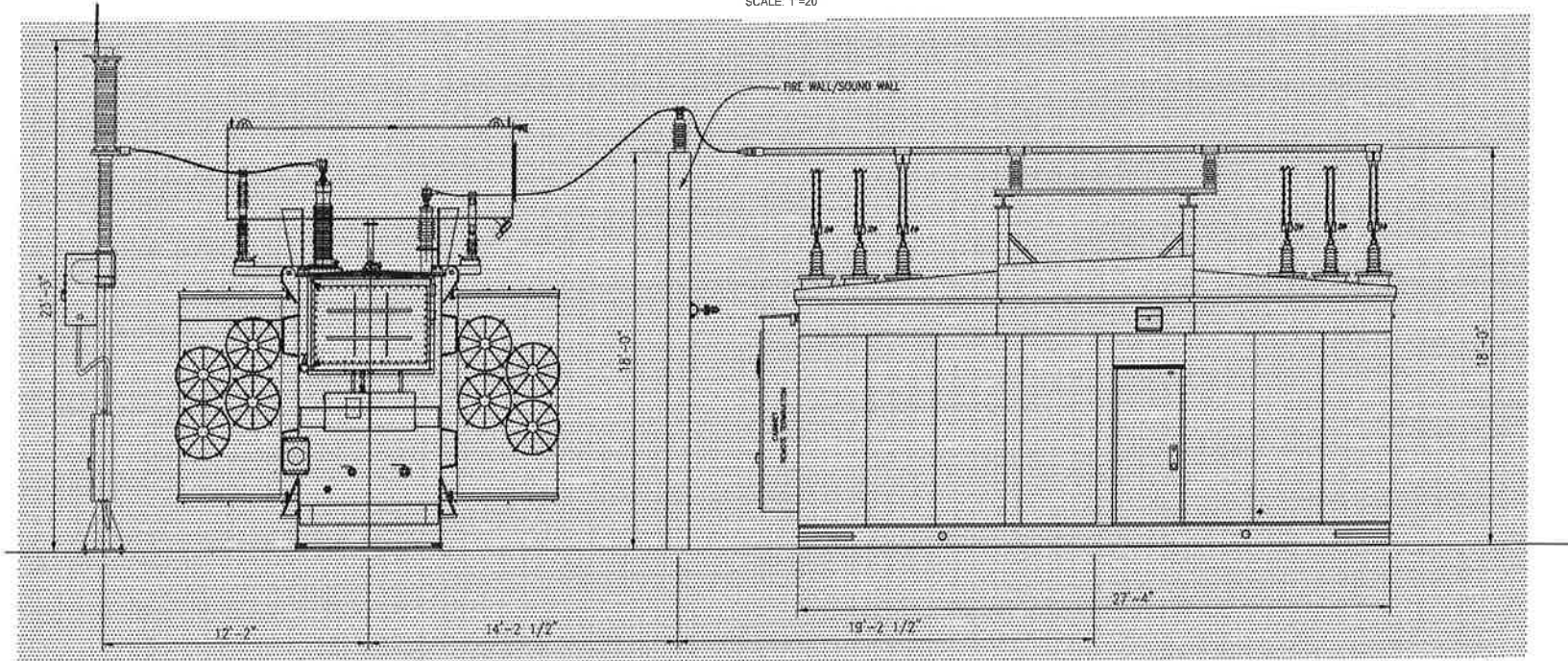

SECTION A-A

0 6" 1' 2'
SCALE: 1/4" = 1'-0"

LEGEND

- EXISTING SUBSTATION FENCE
- EXISTING SUBSTATION FENCE
- PROPOSED ADDITION

REVISIONS DURING CONSTRUCTION							
EVERSOURCE ENERGY							
NORTHEAST SIMSBURY CONNECTICUT SITING COUNCIL PLAN & SECTIONS SIMSBURY, CT							
BY	KPK	CHKD	KPK	APP	RAS	APP	RAS
DATE	10/97	DATE	10/97	DATE	10/97	DATE	10/97
H-SCALE	AS NOTED	SIZE	D	FIELD MARK & PHOTOS			
V-SCALE	AS NOTED	FILE		FILE			
NO.	1	DATE	1/14	TRANSMISSION UPGRADE WD 403727SS AS BUILT REVISIONS	WSP	WSP	ARK
BY	CHK	APP	APP				
FILE MARKER							
							DWG NO. 22805-92001