

*The United Illuminating Company  
157 Church Street  
P.O. Box 1564  
New Haven, CT 06506-0901  
203.499.2000*



**VIA ELECTRONIC MAIL AND U.S. MAIL**

June 7, 2013

Mr. Robert Stein  
Chairman  
The Connecticut Siting Council  
Ten Franklin Square  
New Britain, CT 06051

**Re: The United Illuminating Company's Notice of Exempt Modification Pursuant to R.C.S.A. § 16-50j-58 to Existing Energy Facility Site at 524 and 532 Grand Avenue, New Haven, Connecticut ("Notice of Exempt Modification")**

Dear Chairman Stein:

Pursuant to Regulations of Connecticut State Agencies ("R.C.S.A.") §16-50j-58, The United Illuminating Company ("UI" or "Company") hereby notifies the Connecticut Siting Council (the "Council") of its intent to make exempt modifications to its substations at 524 and 532 Grand Avenue, New Haven, Connecticut ("Facility" or "Energy Facility Site"). The \$625 filing fee, along with 25 copies of this Notice of Exempt Modification, are enclosed herewith.

Existing Energy Facility

The site is located at 524/532 Grand Avenue in the City of New Haven, CT at  $L41^{\circ}18'31.9464''N$  and  $\Lambda73^{\circ}54'31.9572''W$  and is bounded as follows, which description recites the deed:

Grand Avenue and Mill River Substations were acquired via several deeds and have been combined into one parcel; as follows:

Beginning at a point in the Southwest corner of the land herein described:

Thence running  $N 84^{\circ}48'10'' W$  233.02 feet along N/F Simkins Industries, Inc.;

Thence running  $S 12^{\circ}35'53'' W$  628.17 feet along the west channel of the Mill River;

Thence running  $S 82^{\circ}23'10'' E$  229.09 feet thence  $S 86^{\circ}34'13'' E$  110.00 feet along Grand Avenue;

Thence running  $N 02^{\circ}55'55'' E$  629.70 feet along N/F Providence & Worcester Railroad

Deeds recorded at the City of New Haven as follows:

Volume 972 at page 348 on April 7, 1923

Volume 1096 at page 332 on May 7, 1926

Volume 1096 at page 333 on May 7, 1926  
Volume 1103 at page 157 on July 29, 1926  
Volume 1342 at page 540 on August 20, 1936  
Volume 1348 at page 392 on February 20, 1927

Existing yard structures are approximately 81 feet high and are enclosed in a fenced and graveled area of 4.1 acres +/-.

#### Proposed Modifications

As part of UI's short term substation storm hardening efforts, UI is proposing to install emergency backup generation for AC station service. A Drawing of UI's Yard Plan with generator location is attached hereto. As the proposed modifications relate solely to backing up the AC station service, the changes will not impact the existing Facility's structural capability or impact electric and magnetic fields or noise levels.

#### Compliance with R.C.S.A. § 16-50j-57(b)

Pursuant to R.C.S.A. §16-50j-57, UI believes that the proposed changes do not constitute a modification to an existing facility that may have a substantial adverse environmental effect and is exempt from the requirement to obtain a certificate pursuant to Section 16-50k of the Connecticut General Statutes. Specifically, consistent with R.C.S.A. § 16-50j-57(b), the proposed changes to the existing site do not:

- (A) Extend the boundaries of the site beyond the existing fenced compound;
- (B) Increase the height of existing associated equipment;
- (C) Increase noise levels at the site boundary by 6 decibels or more, or to levels that exceed state and local criteria;
- (D) Manage electric and magnetic field levels at the site boundary in a manner that is inconsistent with the Council's Best Management practices for Electric and Magnetic Fields at the site boundary;
- (E) Cause a significant adverse change or alteration in the physical or environmental characteristics of the site; or
- (F) Impair the structural integrity of the facility, as determined in a certification provided by a professional engineer licensed in Connecticut, where applicable.

UI intends to install the emergency generator on or after the Council's acknowledgement that the proposed activities are exempt.

Do not hesitate to contact me at (203) 499-2422 should you have any questions regarding this notice.

Very truly yours,

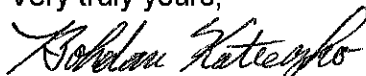

Bohdan Katreczko  
Senior Environmental Program Manager  
UIL Holdings Corporation  
As Agent for The United Illuminating Company

Attachments

Cc: Mayor John DeStefano, City of New Haven  
Melanie Bachman, Esq., Connecticut Siting Council

**Proof of Service**

The undersigned hereby certifies, in accordance with Regulations of Connecticut State Agencies ("R.C.S.A.") §16-50j-58, that this Notice of Exempt Modification was mailed by first class mail, postage prepaid on June 11, 2013 to the chief elected official of the City of New Haven, CT.

By: *Bohdan Katreczko*

Bohdan Katreczko  
Senior Environmental Program Manager  
UIL Holdings Corporation  
As Agent for The United Illuminating Company



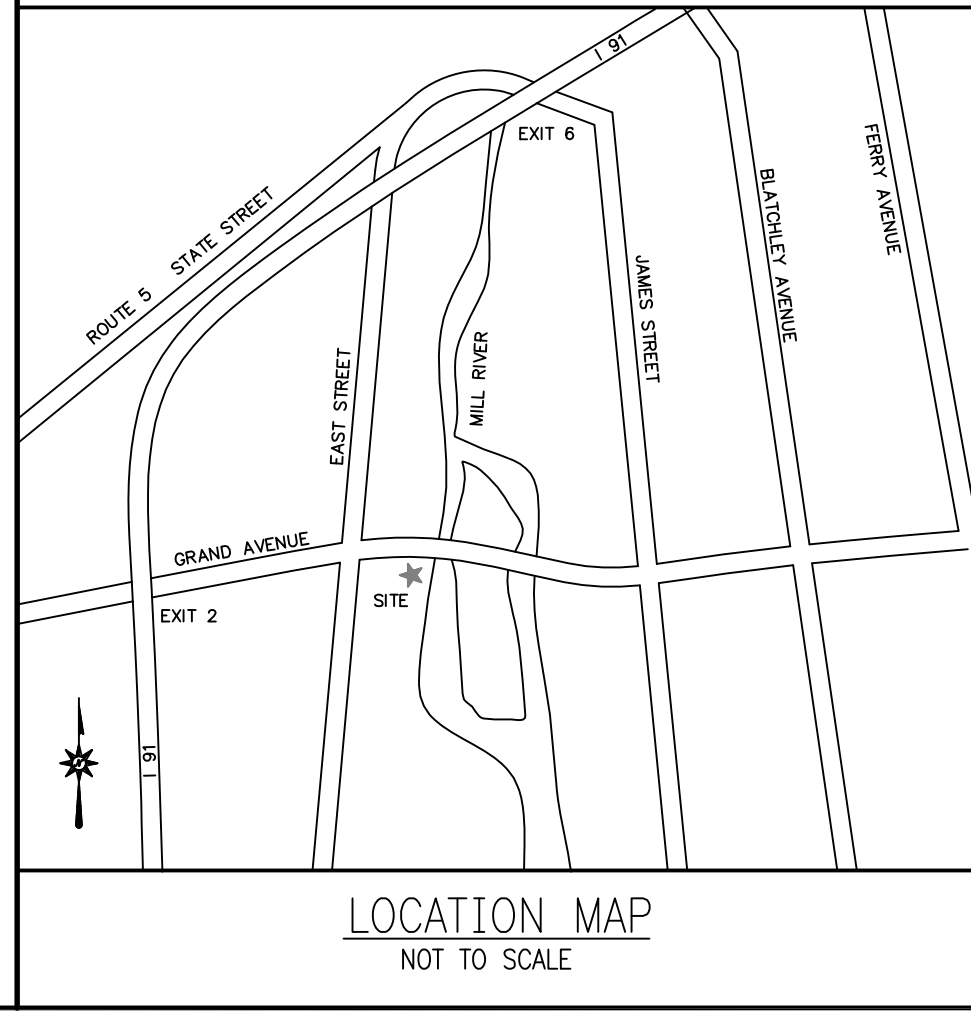
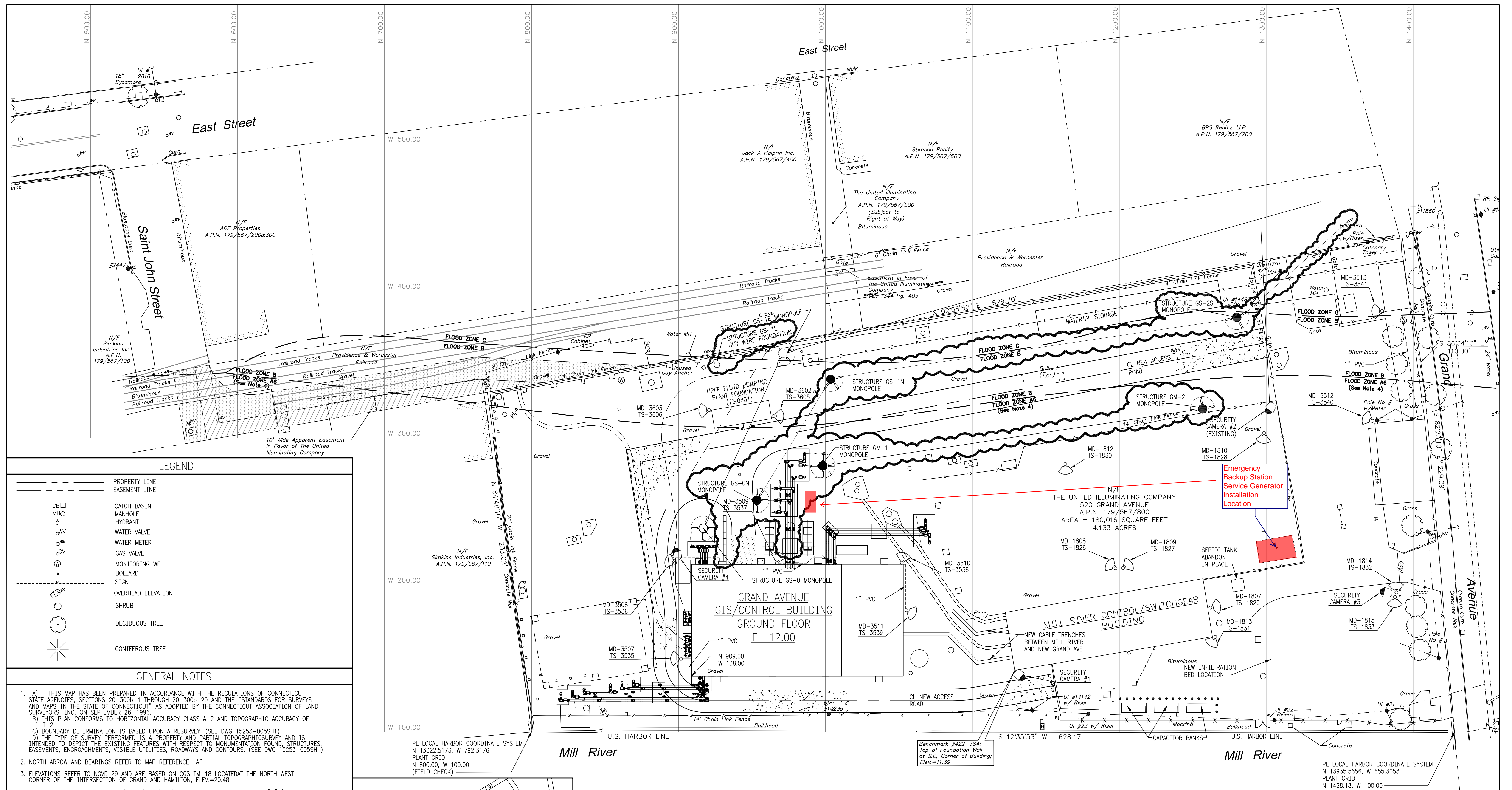

**INFORMATION ONLY**

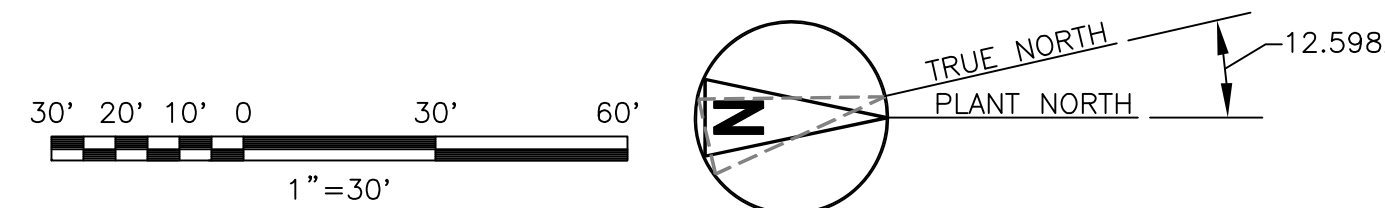

CONTAINS CRITICAL ENERGY INFRASTRUCTURE INFORMATION SUBJECT TO NON-DISCLOSURE PROVISIONS OF ISO-9E SCHEDULE 22 AND NEW ENGLAND POLICIES PERTAINING TO CONFIDENTIAL INFORMATION (CEI) DO NOT DISTRIBUTE

AREAS BACKCIRCLED ON THIS DRAWING INDICATES WORK ASSOCIATED WITH PROJECT 174114

**BLACK & VEATCH**

PROJECT NO. 164468

DRAWN	BD
DESIGNED	KAD
APPROVED	ALL
CHECKED	MAS

No	Date	Revision	By	Chkd.	Engr.	Supv.
C	05/14/2012	APPROVED FOR CONSTRUCTION PROJECT 174114	BD	JAH	BRH	ALL
B	03/23/2012	ISSUED FOR UI REVIEW	BD	-	BRH	ALL
A	02/03/2012	ISSUED FOR UI REVIEW	BD	-	KAD	ALL
T	04/29/11	CONFORMED TO CONSTRUCTION RECORDS	WDS	-	KAD	ALL
O	05/24/10	APPROVED FOR CONSTRUCTION	BD	MAS	KAD	ALL

**ui** The United Illuminating Company  
157 Church St. New Haven, Ct. 06506

Drawn \_\_\_\_\_ Date \_\_\_\_\_ Scale: 1"=30'-0"  
Chkd. \_\_\_\_\_ Design Engr. \_\_\_\_\_ Design Supv. \_\_\_\_\_

**SITE ARRANGEMENT PLAN AND GENERAL NOTES**

**GRAND AVENUE SWITCHING STATION**

CAD FILE NAME	SEQUENCE No.	DRAWING NUMBER
		15253-401SH1

*The United Illuminating Company  
157 Church Street  
P.O. Box 1564  
New Haven, CT 06506-0901  
203.499.2000*



**VIA ELECTRONIC MAIL AND U.S. MAIL**

June 14, 2013

Mr. Robert Stein  
Chairman  
The Connecticut Siting Council  
Ten Franklin Square  
New Britain, CT 06051

**Re: The United Illuminating Company's Notice of Exempt Modification Pursuant to R.C.S.A. § 16-50j-58 to Existing Energy Facility Site at 524 Grand Avenue, New Haven, Connecticut ("Notice of Exempt Modification")**

Dear Chairman Stein:

Pursuant to Regulations of Connecticut State Agencies ("R.C.S.A.") §16-50j-58, The United Illuminating Company ("UI" or "Company") hereby notifies the Connecticut Siting Council (the "Council") of its intent to make exempt modifications to its substations at 524 Grand Avenue, New Haven, Connecticut ("Facility" or "Energy Facility Site"). The \$625 filing fee, along with 2 copies of this Notice of Exempt Modification, are enclosed herewith.

Existing Energy Facility

The site is located at 524 Grand Avenue in the City of New Haven, CT at  $L41^{\circ}18'31.9464''N$  and  $\Lambda73^{\circ}54'31.9572''W$  and is bounded as follows, which description recites the deed:

Grand Avenue Substation was acquired via several deeds and has been combined into one parcel:  
Beginning at a point in the Southwest corner of the land herein described:  
Thence running N  $84^{\circ}48'10''$  W 233.02 feet along N/F Simkins Industries, Inc.;  
Thence running S  $12^{\circ}35'53''$  W 628.17 feet along the west channel of the Mill River;  
Thence running S  $82^{\circ}23'10''$  E 229.09 feet thence S  $86^{\circ}34'13''$  E 110.00 feet along Grand Avenue;  
Thence running N  $02^{\circ}55'55''$  E 629.70 feet along N/F Providence & Worcester Railroad

Existing yard structures are approximately 81 feet high and are enclosed in a fenced and graveled area of 2.1 acres +/-.

### Proposed Modifications

As part of UI's short term substation storm hardening efforts, UI is proposing to install emergency backup generation for AC station service. A Drawing of UI's Yard Plan with generator location is attached hereto. As the proposed modifications relate solely to backing up the AC station service, the changes will not impact the existing Facility's structural capability or impact electric and magnetic fields or noise levels.

### Compliance with R.C.S.A. § 16-50j-57(b)

Pursuant to R.C.S.A. §16-50j-57, UI believes that the proposed changes do not constitute a modification to an existing facility that may have a substantial adverse environmental effect and is exempt from the requirement to obtain a certificate pursuant to Section 16-50k of the Connecticut General Statutes. Specifically, consistent with R.C.S.A. § 16-50j-57(b), the proposed changes to the existing site do not:

- (A) Extend the boundaries of the site beyond the existing fenced compound;
- (B) Increase the height of existing associated equipment;
- (C) Increase noise levels at the site boundary by 6 decibels or more, or to levels that exceed state and local criteria;
- (D) Manage electric and magnetic field levels at the site boundary in a manner that is inconsistent with the Council's Best Management practices for Electric and Magnetic Fields at the site boundary;
- (E) Cause a significant adverse change or alteration in the physical or environmental characteristics of the site; or
- (F) Impair the structural integrity of the facility, as determined in a certification provided by a professional engineer licensed in Connecticut, where applicable.

UI intends to install the emergency generator on or after the Council's acknowledgement that the proposed activities are exempt.

Do not hesitate to contact me at (203) 926-4737 should you have any questions regarding this notice.

Very truly yours,

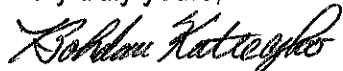

Bohdan Katreczko  
Senior Environmental Program Manager  
UIL Holdings Corporation  
As Agent for The United Illuminating Company

### Attachments

Cc: Mayor John DeStefano, City of New Haven  
Melanie Bachman, Esq., Connecticut Siting Council



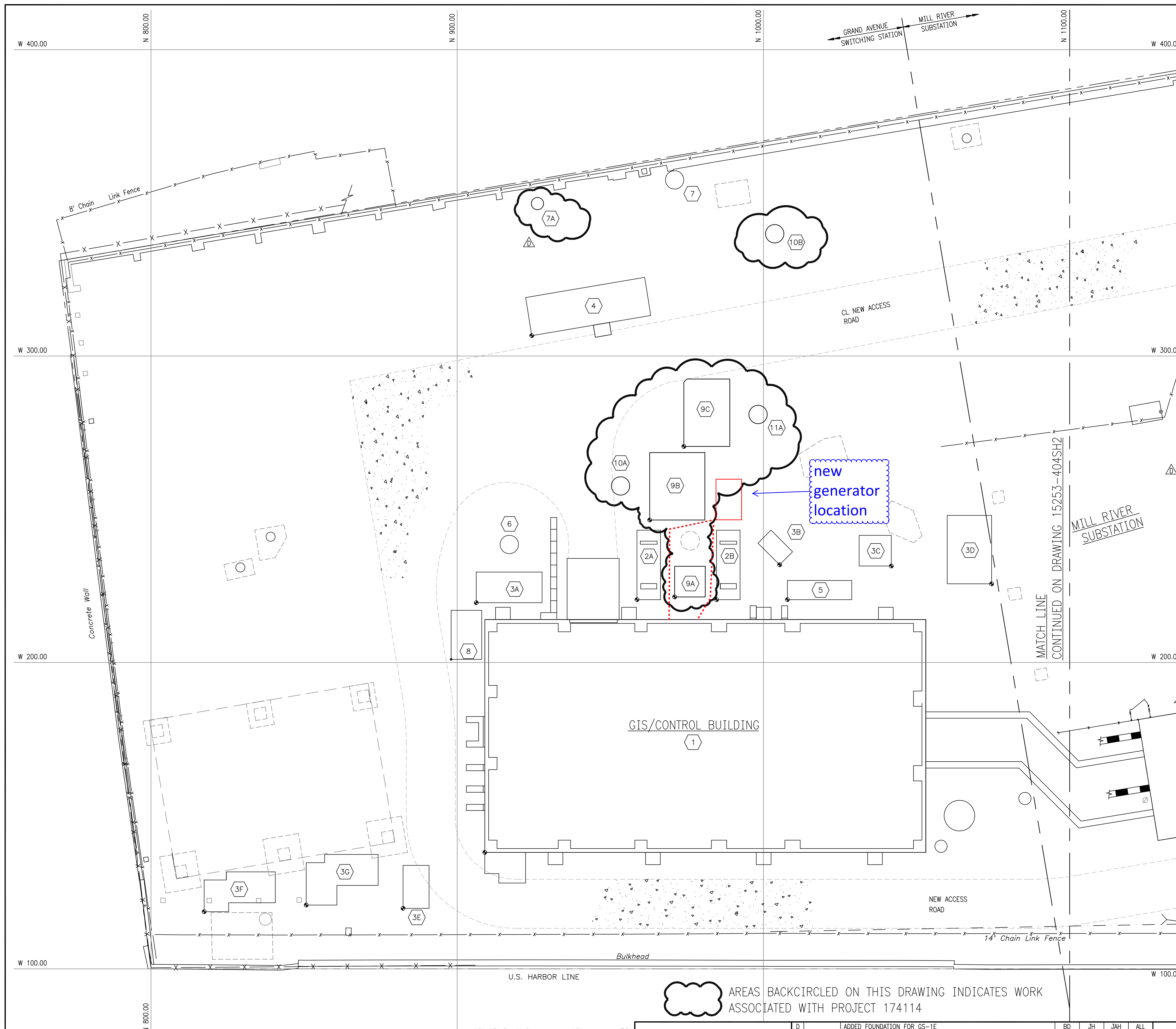

FOUNDATION IDENTIFICATION

FOUND NO	FOUNDATION DESCRIPTION	DRAWING NUMBER	TIE DOWN LOCATION	TIE DOWN COORDINATES	
				NORTH	WEST
1	GIS/CONTROL BUILDING	15253-405SH1	SOUTHEAST CORNER OF SLAB	909.00	138.00
2A	STATION SERVICE EQUIPMENT	15253-407SH1	SOUTHEAST CORNER OF SLAB	958.20	220.50
2B	STATION SERVICE EQUIPMENT	15253-407SH1	SOUTHEAST CORNER OF SLAB	984.20	220.50
3A	GIL BUS SUPPORT	15253-407SH2	SOUTHEAST CORNER OF SLAB	906.21	219.51
3B	GIL BUS SUPPORT	15253-407SH2	EAST CORNER OF SLAB	1005.28	231.87
3C	GIL BUS SUPPORT	15253-407SH2	NORTHEAST CORNER OF SLAB	1041.751	231.47
3D	GIL BUS SUPPORT	15253-407SH2	NORTHEAST CORNER OF SLAB	1074.50	225.67
3E	GIL BUS SUPPORT	15253-407SH2	SOUTHEAST CORNER OF SLAB	882.31	119.75
3F	GIL BUS SUPPORT	15253-407SH3	SOUTHEAST CORNER OF SLAB	817.36	118.64
3G	GIL BUS SUPPORT	15253-407SH3	SOUTHEAST CORNER OF SLAB	850.69	120.81
4	FLUID PUMP HOUSE	15253-407SH4	CENTER OF FOUNDATION WALL AT SOUTHEAST CORNER	924.50	306.50
5	HVAC EQUIPMENT PAD	15253-407SH1	SOUTHEAST CORNER OF SLAB	1007.67	220.50
6	115KV MONOPOLE STRUCTURE GS-0	14202-312	CENTERLINE OF PIER	917.00	238.50
7	115KV MONOPOLE STRUCTURE GS-1	14202-312	CENTERLINE OF PIER	971.00	357.50
7A	GUY WIRE FOUNDATION GS-1E	14202-312	CENTERLINE OF PIER	926.03	349.77
8	FLUID RESERVOIR SUPPORT STRUCTURE	15253-407SH1	SOUTHEAST CORNER OF SLAB	898.00	201.00
9A	GIL BUS SUPPORT (BY 174114.71.200)	15253-408SH1	SOUTHEAST CORNER OF SLAB	970.99	221.37
9B	GIL BUS SUPPORT (BY 174114.71.0200)	15253-408SH1	SOUTHEAST CORNER OF SLAB	962.85	246.50
9C	GIL BUS SUPPORT (BY 174114.71.0200)	15253-408SH1	SOUTHEAST CORNER OF SLAB	974.00	270.50
10A	115KV MONOPOLE STRUCTURE GS-0N (BY 174114.71.0401)	14202A-300	CENTERLINE OF PIER	954.00	257.50
10B	115KV MONOPOLE STRUCTURE GS-1N (BY 174114.71.0401)	14202A-300	CENTERLINE OF PIER	1003.68	339.92
10C	115KV MONOPOLE STRUCTURE GS-2S (SEE DWG 15253-404SH2) (BY 174114.71.0401)	14202A-300	CENTERLINE OF PIER	1280.00	382.00
11A	115KV MONOPOLE STRUCTURE GM-1 (BY 174114.71.0401)	14216-300	CENTERLINE OF PIER	998.01	281.50
11B	115KV MONOPOLE STRUCTURE GM-2 (SEE DWG 15253-404SH2) (BY 174114.71.0401)	14216-300	CENTERLINE OF PIER	1256.75	319.72

- GENERAL NOTES**
- MINIMUM STRENGTH OF CONCRETE AT 28 DAY TESTING (f'c) SHALL BE 4000 PSI.
  - ALL REINFORCING STEEL SHALL BE ASTM A615 GRADE 60.
  - SEE SITE PLAN (DWG 15253-401SH1) FOR LOCATION OF PLANT GRID.
  - "SIKAGARD 701W" CONCRETE SEALER SHALL BE APPLIED TO TOP AND SIDE ABOVE GRADE SURFACES OF ALL THE FOUNDATIONS

**REFERENCE DRAWINGS**

FOUNDATION PLAN	15253-404SH2
GIS/CONTROL BUILDING FOUNDATION PLAN	15253-405SH1
GIS/CONTROL BUILDING FOUNDATION EMBEDMENT PLAN & MISCELLANEOUS STEEL	15253-405SH2
GIS/CONTROL BUILDING TRENCH COVER PLAN	15253-405SH3
GIS/CONTROL BUILDING SECTIONS AND DETAILS	15253-405SH4 THRU 405SH7
YARD FOUNDATIONS PLANS, SECTIONS & DETAILS	15253-407SH1 THRU 407SH3
FLUID PUMP HOUSE FOUNDATION PLAN, SECTIONS & DETAILS	15253-407SH4
YARD FOUNDATIONS PLANS, SECTIONS AND DETAILS	15253-408SH1
YARD RACEWAY PLAN	15253-415

**APPROVED FOR CONSTRUCTION**  
 THE DISTRIBUTION AND USE OF THE NATIVE FORMAT CAD FILE OF THIS DRAWING IS UNCONTROLLED. THE USER SHALL VERIFY TRACEABILITY OF THIS DRAWING TO THE LATEST CONTROLLED VERSION.

AREAS BACKCIRCLED ON THIS DRAWING INDICATES WORK ASSOCIATED WITH PROJECT 174114

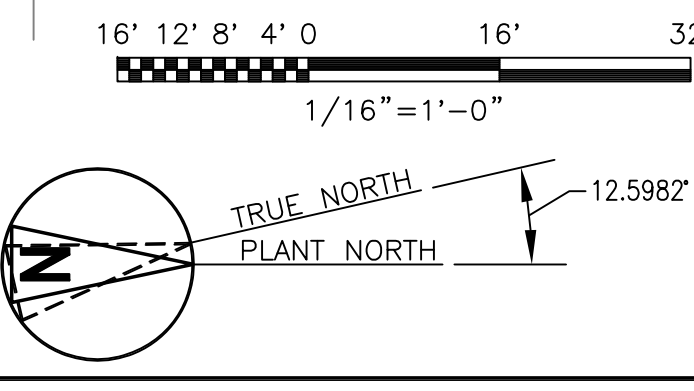

<b>BLACK &amp; VEATCH</b>		PROJECT NO. 164468	
DRAWN	BD	DESIGNED	ACF
APPROVED	ALL	CHECKED	JAH
No	Date	Revision	
1	05/14/2012	ADDED FOUNDATION FOR GS-1E	BD JH JAH ALL
2	03/23/2012	APPROVED FOR CONSTRUCTION PROJECT 174114	BD - JAH ALL
3	02/03/2012	ISSUED FOR UI REVIEW	BD - JAH ALL
4	04/29/11	CONFORMED TO CONSTRUCTION RECORDS	WDS - KAD ALL
5	08/05/10	REVISED PER ECN N-0009	BD JAH ACF ALL
6	07/07/10	REVISED PER ECN N-0006	BD JAH ACF ALL
7	06/21/10	REVISED PER ECN N-0002	BD JAH ACF ALL
8	05/24/10	APPROVED FOR CONSTRUCTION	BD JAH ACF ALL

**ui**  
 The United Illuminating Company  
 157 Church St. New Haven, Ct. 06506

Drawn: \_\_\_\_\_ Date: \_\_\_\_\_ Scale: 1/16"=1'-0"  
 Chkd. \_\_\_\_\_ Design Engr. \_\_\_\_\_ Design Supv. \_\_\_\_\_

<b>FOUNDATION PLAN</b>		
GRAND AVENUE SWITCHING STATION		
CAD FILE NAME	SEQUENCE No.	DRAWING NUMBER
		15253-404

*The United Illuminating Company  
157 Church Street  
P.O. Box 1564  
New Haven, CT 06506-0901  
203.499.2000*



**VIA ELECTRONIC MAIL AND U.S. MAIL**

June 14, 2013

Mr. Robert Stein  
Chairman  
The Connecticut Siting Council  
Ten Franklin Square  
New Britain, CT 06051

**Re: The United Illuminating Company's Notice of Exempt Modification Pursuant to R.C.S.A. § 16-50j-58 to Existing Energy Facility Site at 532 Grand Avenue, New Haven, Connecticut ("Notice of Exempt Modification")**

Dear Chairman Stein:

Pursuant to Regulations of Connecticut State Agencies ("R.C.S.A.") §16-50j-58, The United Illuminating Company ("UI" or "Company") hereby notifies the Connecticut Siting Council (the "Council") of its intent to make exempt modifications to its substations at 532 Grand Avenue, New Haven, Connecticut ("Facility" or "Energy Facility Site"). The \$625 filing fee, along with 2 copies of this Notice of Exempt Modification, are enclosed herewith.

Existing Energy Facility

The site is located at 532 Grand Avenue in the City of New Haven, CT at  $L41^{\circ}18'31.9464''N$  and  $\Lambda73^{\circ}54'31.9572''W$  and is bounded as follows, which description recites the deed:

Mill River Substation was acquired via several deeds and has been combined into one parcel; as follows:

Deeds recorded at the City of New Haven as follows:

Volume 972 at page 348 on April 7, 1923

Volume 1096 at page 332 on May 7, 1926

Volume 1096 at page 333 on May 7, 1926

Volume 1103 at page 157 on July 29, 1926

Volume 1342 at page 540 on August 20, 1936

Volume 1348 at page 392 on February 20, 1927

Existing yard structures are approximately 81 feet high and are enclosed in a fenced and graveled area of 2.0 acres +/-.

### Proposed Modifications

As part of UI's short term substation storm hardening efforts, UI is proposing to install emergency backup generation for AC station service. A Drawing of UI's Yard Plan with generator location is attached hereto. As the proposed modifications relate solely to backing up the AC station service, the changes will not impact the existing Facility's structural capability or impact electric and magnetic fields or noise levels.

### Compliance with R.C.S.A. § 16-50j-57(b)

Pursuant to R.C.S.A. §16-50j-57, UI believes that the proposed changes do not constitute a modification to an existing facility that may have a substantial adverse environmental effect and is exempt from the requirement to obtain a certificate pursuant to Section 16-50k of the Connecticut General Statutes. Specifically, consistent with R.C.S.A. § 16-50j-57(b), the proposed changes to the existing site do not:

- (A) Extend the boundaries of the site beyond the existing fenced compound;
- (B) Increase the height of existing associated equipment;
- (C) Increase noise levels at the site boundary by 6 decibels or more, or to levels that exceed state and local criteria;
- (D) Manage electric and magnetic field levels at the site boundary in a manner that is inconsistent with the Council's Best Management practices for Electric and Magnetic Fields at the site boundary;
- (E) Cause a significant adverse change or alteration in the physical or environmental characteristics of the site; or
- (F) Impair the structural integrity of the facility, as determined in a certification provided by a professional engineer licensed in Connecticut, where applicable.

UI intends to install the emergency generator on or after the Council's acknowledgement that the proposed activities are exempt.

Do not hesitate to contact me at (203) 926-4737 should you have any questions regarding this notice.

Very truly yours,

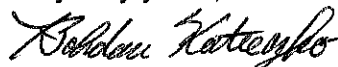

Bohdan Katreczko  
Senior Environmental Program Manager  
UIL Holdings Corporation  
As Agent for The United Illuminating Company

### Attachments

Cc: Mayor John DeStefano, City of New Haven  
Melanie Bachman, Esq., Connecticut Siting Council

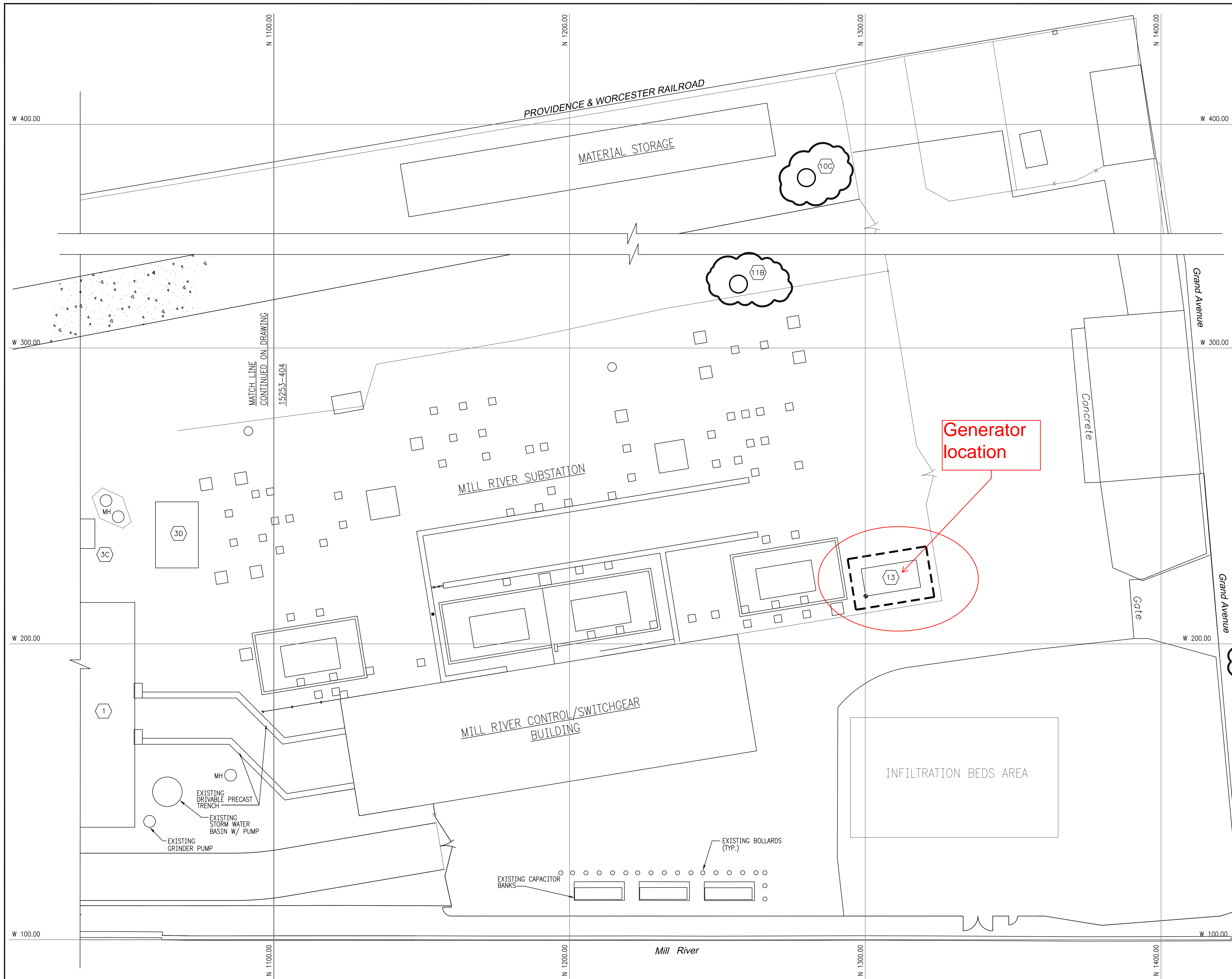

--- AREAS BACKCIRCLED ON THIS DRAWING INDICATES WORK ASSOCIATED WITH PROJECT 180060 (MILL RIVER SHORT TERM STORM HARDENING)

☁ AREAS BACKCIRCLED ON THIS DRAWING INDICATES WORK ASSOCIATED WITH PROJECT 174114 (8300 LINE RECONFIGURATION)

**NOTES**

- SEE DRAWING 15253-404 FOR GENERAL NOTES AND FOUNDATION LIST.
- "SIKAGARD 701W" CONCRETE SEALER SHALL BE APPLIED TO TOP AND SIDES OF ABOVE GRADE SURFACES OF ALL THE FOUNDATIONS

**REFERENCE DRAWINGS**

FOUNDATION PLAN	15253-404
GIS/CONTROL BUILDING FOUNDATION PLAN	15253-405SH1
GIS/CONTROL BUILDING FOUNDATION EMBEDMENT PLAN & MISCELLANEOUS STEEL	15253-405SH2
GIS/CONTROL BUILDING TRENCH COVER PLAN	15253-405SH3
GIS/CONTROL BUILDING SECTIONS AND DETAILS	15253-405SH4 THRU 405SH7
YARD FOUNDATIONS PLANS, SECTIONS & DETAILS	15253-407SH1 THRU 407SH3
FLUID PUMP HOUSE FOUNDATION PLAN, SECTIONS & DETAILS	15253-407SH4
100KW GENERATOR PLANS, SECTIONS & DETAILS	15250-425SH3

**APPROVED FOR CONSTRUCTION**

THE DISTRIBUTION AND USE OF THE NATIVE FORMAT CAD FILE OF THIS DRAWING IS UNCONTROLLED. THE USER SHALL VERIFY TRACEABILITY OF THIS DRAWING TO THE LATEST CONTROLLED VERSION.

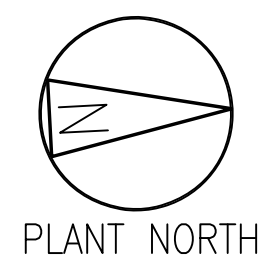
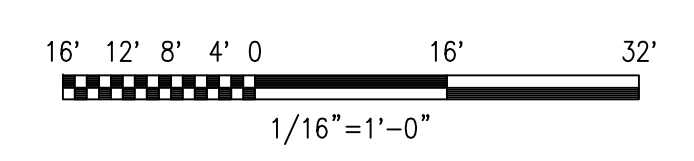
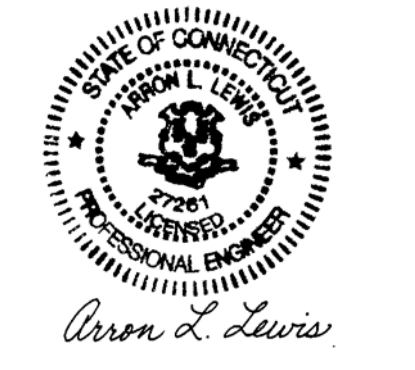

**BLACK & VEATCH**

PROJECT NO. 174114

DESIGNED	JAH
APPROVED	ALL
CHECKED	PJH

No	Date	Revision	By	Chkd.	Engr.	Supv.
E	05/23/2013	APPROVED FOR CONSTRUCTION - PROJECT 180060	BD	PJH	JZ	ALL
D	05/15/2013	ISSUED FOR 90% UI REVIEW-PROJECT 180060	BD	-	JZ	ALL
C	05/14/2012	APPROVED FOR CONSTRUCTION PROJECT 174114	BD	JH	JAH	ALL
B	03/23/2012	ISSUED FOR UI REVIEW	BD	-	JAH	ALL
A	02/03/2012	ISSUED FOR UI REVIEW	BD	-	JAH	ALL

**ui**  
The United Illuminating Company

Drawn	Date	Scale: 1/16"=1'-0"
Chkd.	Design Engr.	Design Supv.

FOUNDATION PLAN		
GRAND AVENUE SWITCHING STATION		
CAD FILE NAME	SEQUENCE No.	DRAWING NUMBER
		15253-404SH2