



Via FedEx

May 19th, 2022

Connecticut Siting Council
ATTN: Melanie A. Bachman – Executive Director
10 Franklin Square
New Britain, CT 06051

RE: Notice of Exempt Modification
Facility Address: 305 West Service Road, Hartford, CT
Facility Coordinates: 41.79955155, -72.65667578

Dear Ms. Bachman,

American Tower Corporation (ATC) currently maintains an existing Cellular Tower Facility (150' Monopole) at 305 West Service Road, Hartford, CT. The property is owned by 305 West Services Rd. Assoc., LLC. ATC intends to install an 80 kW Diesel Generator within the leased and fenced ground space of the facility. The purpose of this generator installation is to allow for shared back up emergency power option for current and future wireless carrier tenants.

The Cellular Tower Facility was originally approved by the City of Hartford Planning and Zoning, the Certificate of Occupancy from and original drawings submitted to the City of Hartford for the Tower Facility have been submitted to reflect the original conditions of approval.

Because this proposed generator is with the existing, approved compound space, and the applicant is NOT requesting an expansion of the ground space beyond approved dimensions, please accept this letter as notification pursuant to Regulations of Connecticut State Agencies @16-50j-73, for construction that constitutes and exempt modification pursuant to R.C.S.A. @16-50j-72(b)(2). In accordance with R.C.S.A. @16-50j-73, a copy of this letter is being sent to Luke Bronin, Mayor of the City of Hartford, 305 W. Service Rd. Associates as property owner, and American Tower Corporation as tower owner.



ATTACHMENT A

The planned modifications to the facility fall squarely within those activities explicitly provided for in R.C.S.A @ 16-50j-72(b)(2).

1. The proposed modifications will not result in an increase in the height of the existing structure.
2. The proposed modifications will not require the extension of the site boundary
3. The proposed modifications will not increase noise levels at the facility by six decibels or more, or to levels that exceed state and local criteria.
4. The operation of the generator back up power facility will not increase radio frequency emissions at the facility to the level at or above the Federal Communications Commission safety standard.
5. The proposed modifications will not cause a change or alteration in the physical or environmental characteristics of the site.
6. The existing structure and its foundation can support the proposed loading if the tower will be re-enforced to support them. <<< NOTE – This condition is N/A. The proposed Generator is based on the ground, and not associated or loaded onto the tower or foundation.

For the foregoing reasons, American Tower Corporation (ATC) respectfully submits that the proposed modifications to the above referenced telecommunications facility constitute an exempt modification under R.C.S.A. @16-50j-72(b)(2).

If you have any questions, please contact me at JLehman@airosmithdevelopment.com or (518) 932-7049

Sincerely,

Jake Lehman
Site Acquisition Specialist I
Airosmith Development, Inc.
318 West Ave.
Saratoga Springs, NY 12866
(518) 306-1711 fax
(518) 932-7049 cell
jlehman@airosmithdevelopment.com

318 West Ave., Saratoga Springs, NY 12866
Office 518-306-1711 – Fax 518-306-1711
www.airosmithdevelopment.com





AMERICAN TOWER®
CORPORATION
LETTER OF AUTHORIZATION

SITE NO/PROJECT NO: 302466 / ATC990325

SITE NAME: West Service Road

**ADDRESS 305 W SERVICE RD
HARTFORD, CT 06120-1207**

APN: HTFD M:304 B:0

I, Margaret Robinson, Senior Counsel, US Tower Division on behalf of American Tower*, owner of the tower facility located at the address identified above (the "Tower Facility"), do hereby authorize **Airosmith Development** its successors and assigns, to act as American Tower's non-exclusive agent for the purpose of filing and securing any zoning, land-use, building permit and/or electrical permit application(s) and approvals of the applicable jurisdiction for and to conduct the construction of the installation of antennas and related telecommunications equipment on the Tower Facility located at the above address. This installation shall not affect adjoining lands and will occur only within the area leased by American Tower.

American Tower understands that the application may be denied, modified or approved with conditions. The above authorization is limited to the acceptance by American Tower of conditions related to American Tower's installation. Any such conditions of approval or modifications will not be effective unless approved in writing by American Tower.

The above authorization does not permit **Airosmith Development** to modify or alter any existing permit(s) and/or zoning or land-use conditions or impose any additional conditions unrelated to American Tower's installation of telecommunications equipment without the prior written approval of American Tower.

Signature: _____

Margaret Robinson, Senior Counsel
US Tower Division

NOTARY BLOCK

COMMONWEALTH OF MASSACHUSETTS
County of Middlesex

This instrument was acknowledged before me by Margaret Robinson, Senior Counsel of American Tower (Tower Facility owner and/or operator), personally known to me (or proved to me on the basis of satisfactory evidence) to be the person whose name is subscribed to the within instrument and acknowledged to me that he/she executed the same.

WITNESS my hand and official seal, this 14th day of April 2022.

NOTARY SEAL

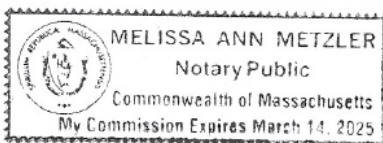

Notary Public
My Commission Expires: March 14, 2025

* American Tower as used herein is defined as American Tower Corporation and any of its affiliates or subsidiaries.



City of Hartford Assessor Map

Legend

▲ Parcel ID	161507165 Parcel ID
● Duplicate Parcel ID	7500 sf or Ac Parcel Area
■ Exempt ID	88 Street Address
■ Building ID	11-19 Condo Lot Range
○ Parcels	11D Condo Unit
■ Tax Map Grid	■ Driveway and Parking Lot Paved
■ City Boundary Line	■ Driveway and Parking Lot Unpaved
■ Building	■ Sidewalk
■ Foundation	■ Stairs and Ramps
■ Greenhouse	■ Runway
■ Cement Pad	■ Bridge
■ Deck	■ Road Edge Paved
■ Patio	■ Road Edge Unpaved
■ Pool	■ Wharf and Pier
■ Tunnel	■ Tank
■ Trail	■ Golf Course
■ Railroad	■ Fairway
■ Fence	■ Green
■ Ruins	■ Sand Trap
● Coniferous Tree	■ Deciduous Tree
● Deciduous Tree	■ Hedge and Brush
● Hedge and Brush	■ Treeline
● Treeline	■ Water
■ Water	■ River or Stream

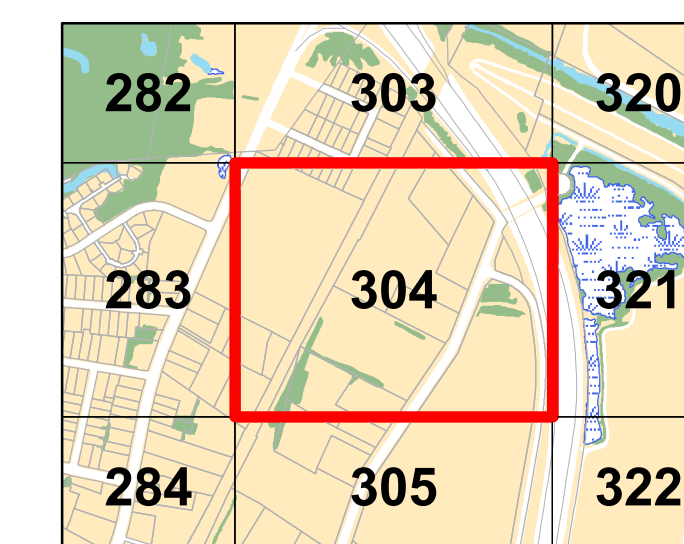

DISCLAIMER:

The planimetric information depicted on this map was compiled by The Sanborn Map Company and is based on an aerial flight performed in April 2015. In addition, the City's GIS staff has been updating limited planimetric features based on information on file in various City departments. The parcel and property information depicted on this map has been compiled from recorded deeds, maps, assessor records, and other public records on file in the City of Hartford. The intent of this map is to depict a graphical representation of real property information relative to the planimetric features for the City of Hartford and is subject to change as a more accurate survey may disclose.

The City of Hartford and the mapping company assume no legal responsibility for the information contained in this data.

THIS MAP IS NOT TO BE USED FOR THE TRANSFER OF PROPERTY.

Horizontal Datum: Connecticut State Plane Coordinates (NAD 83 feet)

Date: October 1, 2019

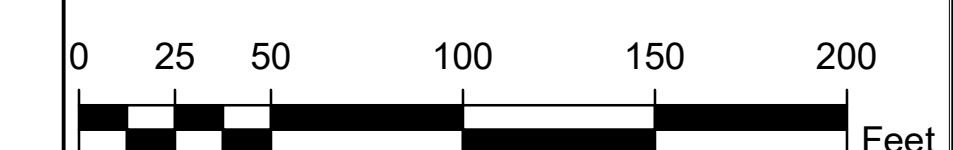

1 inch = 50 feet

Map Sheet 304

Unofficial Property Record Card - Hartford, CT

General Property Data

Parcel ID **304-074-014**
Prior Parcel ID
Property Owner **305 W SERVICE RD ASSOC LLC**
Mailing Address **206 DORAL DR**
City **BLACKWOOD**
Mailing State **NJ** Zip **08012-9555**
ParcelZoning **ID-1**

Account Number
Property Location **305 WEST SERVICE RD**
Property Use **AUTO REPAIR**
Most Recent Sale Date **5/29/1998**
Legal Reference **03960 0282**
Grantor
Sale Price **280,000**
Land Area **85,813.000 acres**

Current Property Assessment

Card 1 Value Building Value **291,200** Xtra Features Value **4,760** Land Value **246,120** Total Value **542,080**

Building Description

Building Style **AUTO SERVICE**
of Living Units **0**
Year Built **1960**
Building Grade **Average**
Building Condition **N/A**
Finished Area (SF) **N/A**
Number Rooms **0**
of 3/4 Baths **0**

Foundation Type **Concrete**
Frame Type **Steel**
Roof Structure **FLAT**
Roof Cover **Membrane**
Siding **Conc Block**
Interior Walls **DRYWALL**
of Bedrooms **0**
of 1/2 Baths **0**

Flooring Type **CONCRETE**
Basement Floor **CONCRETE**
Heating Type **Warm Air**
Heating Fuel **Gas**
Air Conditioning **0%**
of Bsmt Garages **0**
of Full Baths **0**
of Other Fixtures **0**

Legal Description

Narrative Description of Property

This property contains 85,813.000 acres of land mainly classified as AUTO REPAIR with a(n) AUTO SERVICE style building, built about 1960 , having Conc Block exterior and Membrane roof cover, with 0 commercial unit(s) and 0 residential unit(s), 0 room(s), 0 bedroom(s), 0 bath(s), 0 half bath(s).

Property Images



Disclaimer: This information is believed to be correct but is subject to change and is not warranted.



VICINITY MAP



AMERICAN TOWER®

ATC SITE NAME: WEST SERVICE ROAD
 SITE NUMBER: 302466
 SITE ADDRESS: 305 W. SERVICE RD.
 HARTFORD, CT 06120



LOCATION MAP

**SHARED GENERATOR PROGRAM
 ANCHOR TENANT**

AMERICAN TOWER®
A.T. ENGINEERING SERVICE, PLLC
 3500 REGENCY PARKWAY
 SUITE 100
 CARY, NC 27518
 PHONE: (919) 468-0112
 COA: PEC.0001553

THESE DRAWINGS AND/OR THE ACCOMPANYING SPECIFICATION AS INSTRUMENTS OR SERVICE ARE THE EXCLUSIVE PROPERTY OF AMERICAN TOWER. THEIR USE AND PUBLICATION SHALL BE RESTRICTED TO THE ORIGINAL SITE FOR WHICH THEY ARE PREPARED. ANY USE OR DISCLOSURE OTHER THAN THAT WHICH RELATES TO AMERICAN TOWER OR THE SPECIFIED CARRIER IS STRICTLY PROHIBITED. TITLE TO THESE DOCUMENTS SHALL REMAIN THE PROPERTY OF AMERICAN TOWER WHETHER OR NOT THE PROJECT IS EXECUTED. NEITHER THE ARCHITECT NOR THE ENGINEER WILL BE PROVIDING ON-SITE CONSTRUCTION REVIEW OF THIS PROJECT. CONTRACTOR(S) MUST VERIFY ALL DIMENSIONS AND ADVISE AMERICAN TOWER OF ANY DISCREPANCIES. ANY PRIOR ISSUANCE OF THIS DRAWING IS SUPERSEDED BY THE LATEST VERSION ON FILE WITH AMERICAN TOWER.

REV.	DESCRIPTION	BY	DATE
0	FOR CONSTRUCTION	DE	05/18/22

ATC SITE NUMBER:
 302466

ATC SITE NAME:
 WEST SERVICE ROAD

SITE ADDRESS:
 305 W. SERVICE RD.
 HARTFORD, CT 06120



DRAWN BY: AM
 DATE DRAWN: 05/18/22
 ATC JOB NO: 14098396_M4

TITLE SHEET

SHEET NUMBER: **G-001**
 REVISION: **0**

COMPLIANCE CODE	PROJECT SUMMARY	PROJECT DESCRIPTION	SHEET INDEX				
ALL WORK SHALL BE PERFORMED AND MATERIALS INSTALLED IN ACCORDANCE WITH THE CURRENT EDITIONS OF THE FOLLOWING CODES AS ADOPTED BY THE LOCAL GOVERNMENT AUTHORITIES. NOTHING IN THESE PLANS IS TO BE CONSTRUED TO PERMIT WORK NOT CONFORMING TO THESE CODES. 1. INTERNATIONAL BUILDING CODE (IBC) 2. NATIONAL ELECTRIC CODE (NEC) 3. LOCAL BUILDING CODE 4. CITY/COUNTY ORDINANCES	<u>SITE ADDRESS:</u> 305 W. SERVICE RD. HARTFORD, CT 06120 COUNTY: HARTFORD <u>GEOGRAPHIC COORDINATES:</u> LATITUDE: 41.79955155 LONGITUDE: -72.65667578 GROUND ELEVATION: 20' AMSL <u>ZONING INFORMATION:</u> JURISDICTION: HARTFORD PARCEL NUMBER: HTFD M:304 B:074 L:014	THE PROPOSED PROJECT INSTALLS AN OPTIONAL STANDBY GENERATOR SYSTEM, AUTOMATIC TRANSFER SWITCH, GENERATOR AUXILIARY POWER DISTRIBUTION, AND REMOTE MONITORING COMMUNICATIONS CIRCUITRY FOR A COMMUNICATION TOWER TENANT.	SHEET NO:	DESCRIPTION:	REV:	DATE:	BY:
	<u>PROJECT TEAM</u> <u>ATC REGIONAL NETWORK DEVELOPMENT PROJECT MANAGER:</u> MICHAEL JOYCE (508) 326-5522 <u>ATC NETWORK OPERATIONS CENTER:</u> (877) 518-6937 <u>TOWER OWNER:</u> AMERICAN TOWER 10 PRESIDENTIAL WAY WOBURN, MA 01801 <u>PROPERTY OWNER:</u> 305 WEST SERVICES RD ASSOC LLC 153 ROSEMARY RD SOUTH WINDSOR, CT 06074 <u>ENGINEERED BY:</u> ATC TOWER SERVICES 3500 REGENCY PARKWAY SUITE 100 CARY, NC 27518	<u>PROJECT NOTES</u> 1. THE FACILITY IS UNMANNED. 2. A TECHNICIAN WILL VISIT THE SITE APPROXIMATELY ONCE A MONTH FOR ROUTINE INSPECTION AND MAINTENANCE. 3. THE PROJECT WILL NOT RESULT IN ANY SIGNIFICANT LAND DISTURBANCE OR EFFECT OF STORM WATER DRAINAGE. 4. NO SANITARY SEWER, POTABLE WATER OR TRASH DISPOSAL IS REQUIRED. 5. HANDICAP ACCESS IS NOT REQUIRED. 6. THE PROJECT DEPICTED IN THESE PLANS QUALIFIES AS AN ELIGIBLE FACILITIES REQUEST ENTITLED TO EXPEDITED REVIEW UNDER 47 U.S.C. § 1455(A) AS A MODIFICATION OF AN EXISTING WIRELESS TOWER THAT INVOLVES THE COLLOCATION, REMOVAL, AND/OR REPLACEMENT OF TRANSMISSION EQUIPMENT THAT IS NOT A SUBSTANTIAL CHANGE UNDER CFR § 1.61000 (B)(7).	E-601	ELECTRICAL ONE-LINE AND WIRING DETAILS	0	05/17/22	DE
	<u>PROJECT LOCATION DIRECTIONS</u> DIRECTIONS FROM NEXTEL WHITE PLAINS OAK OFC: 5 BROADWAY (HWY 119) NORTH TO WESTCHESTER AVE. TO I-287 EAST (CROSS WESTCHESTER EXPWAY) TO I-684 NORTH APPROX. 28 MILES TO I-84 EAST. TAKE I-84 EAST 63.6 MILES TO HIGH ST./HARTFORD EXIT) BEAR LEFT ONTO MAIN ST. FOR 1.8 MILES THEN TURN RIGHT ONTO FISHFREY ST. FOR .2 MILES TURN LEFT ON WESTON ST. .5 MILES AND THEN LEFT ONTO WEST SERVICE RD. SITE IS SOUTHWEST CORNER OF LARGER VACANT LOT AT CURVE OF RD ADJACENT TO KOHLER EQUIP. DISTRUBUTOR.	R-601	SUPPLEMENTAL				
<u>UTILITY COMPANIES</u> POWER COMPANY: EVERSOURCE PHONE: (877) 659-6326 TELEPHONE COMPANY: AT&T PHONE: (800) 288-2020	<u>PROJECT LOCATION DIRECTIONS</u> DIRECTIONS FROM NEXTEL WHITE PLAINS OAK OFC: 5 BROADWAY (HWY 119) NORTH TO WESTCHESTER AVE. TO I-287 EAST (CROSS WESTCHESTER EXPWAY) TO I-684 NORTH APPROX. 28 MILES TO I-84 EAST. TAKE I-84 EAST 63.6 MILES TO HIGH ST./HARTFORD EXIT) BEAR LEFT ONTO MAIN ST. FOR 1.8 MILES THEN TURN RIGHT ONTO FISHFREY ST. FOR .2 MILES TURN LEFT ON WESTON ST. .5 MILES AND THEN LEFT ONTO WEST SERVICE RD. SITE IS SOUTHWEST CORNER OF LARGER VACANT LOT AT CURVE OF RD ADJACENT TO KOHLER EQUIP. DISTRUBUTOR.	R-602	SUPPLEMENTAL				
	<u>PROJECT LOCATION DIRECTIONS</u> DIRECTIONS FROM NEXTEL WHITE PLAINS OAK OFC: 5 BROADWAY (HWY 119) NORTH TO WESTCHESTER AVE. TO I-287 EAST (CROSS WESTCHESTER EXPWAY) TO I-684 NORTH APPROX. 28 MILES TO I-84 EAST. TAKE I-84 EAST 63.6 MILES TO HIGH ST./HARTFORD EXIT) BEAR LEFT ONTO MAIN ST. FOR 1.8 MILES THEN TURN RIGHT ONTO FISHFREY ST. FOR .2 MILES TURN LEFT ON WESTON ST. .5 MILES AND THEN LEFT ONTO WEST SERVICE RD. SITE IS SOUTHWEST CORNER OF LARGER VACANT LOT AT CURVE OF RD ADJACENT TO KOHLER EQUIP. DISTRUBUTOR.	R-603	SUPPLEMENTAL				

Copyright © 2022 ATC IP LLC, All Rights Reserved.

GENERAL CONSTRUCTION NOTES:

1. ALL WORK SHALL CONFORM TO ALL CURRENT APPLICABLE FEDERAL, STATE, AND LOCAL CODES, INCLUDING ANSIEIA/ITIA-222, AND COMPLY WITH ATC CONSTRUCTION SPECIFICATIONS.
2. CONTRACTOR SHALL CONTACT LOCAL 811 FOR IDENTIFICATION OF UNDERGROUND UTILITIES PRIOR TO START OF CONSTRUCTION.
3. CONTRACTOR SHALL BE RESPONSIBLE FOR COORDINATING ALL REQUIRED INSPECTIONS.
4. ALL DIMENSIONS TO, OF, AND ON EXISTING BUILDINGS, DRAINAGE STRUCTURES, AND SITE IMPROVEMENTS SHALL BE VERIFIED IN FIELD BY CONTRACTOR WITH ALL DISCREPANCIES REPORTED TO THE ENGINEER.
5. DO NOT CHANGE SIZE OR SPACING OF STRUCTURAL ELEMENTS.
6. DETAILS SHOWN ARE TYPICAL; SIMILAR DETAILS APPLY TO SIMILAR CONDITIONS UNLESS OTHERWISE NOTED.
7. THESE DRAWINGS DO NOT INCLUDE NECESSARY COMPONENTS FOR CONSTRUCTION SAFETY WHICH SHALL BE THE SOLE RESPONSIBILITY OF THE CONTRACTOR.
8. CONTRACTOR SHALL BRACE STRUCTURES UNTIL ALL STRUCTURAL ELEMENTS NEEDED FOR STABILITY ARE INSTALLED. THESE ELEMENTS ARE AS FOLLOWS: LATERAL BRACING, ANCHOR BOLTS, ETC.
9. CONTRACTOR SHALL DETERMINE EXACT LOCATION OF EXISTING UTILITIES, GROUNDS DRAINS, DRAIN PIPES, VENTS, ETC. BEFORE COMMENCING WORK.
10. INCORRECTLY FABRICATED, DAMAGED, OR OTHERWISE MISFITTING OR NONCONFORMING MATERIALS OR CONDITIONS SHALL BE REPORTED TO THE ATC CM PRIOR TO REMEDIAL OR CORRECTIVE ACTION. ANY SUCH REMEDIAL ACTION SHALL REQUIRE WRITTEN APPROVAL BY THE ATC CM PRIOR TO PROCEEDING.
11. EACH CONTRACTOR SHALL COOPERATE WITH THE ATC CM, AND COORDINATE HIS WORK WITH THE WORK OF OTHERS.
12. CONTRACTOR SHALL REPAIR ANY DAMAGE CAUSED BY CONSTRUCTION OF THIS PROJECT TO MATCH EXISTING PRE-CONSTRUCTION CONDITIONS TO THE SATISFACTION OF THE ATC CONSTRUCTION MANAGER.
13. ALL CABLE/CONDUIT ENTRY/EXIT PORTS SHALL BE WEATHERPROOFED DURING INSTALLATION USING A SILICONE SEALANT.
14. WHERE EXISTING CONDITIONS DO NOT MATCH THOSE SHOWN IN THIS PLAN SET, CONTRACTOR SHALL NOTIFY THE ATC CONSTRUCTION MANAGER IMMEDIATELY.
15. CONTRACTOR SHALL ENSURE ALL SUBCONTRACTORS ARE PROVIDED WITH A COMPLETE AND CURRENT SET OF DRAWINGS AND SPECIFICATIONS FOR THIS PROJECT.
16. CONTRACTOR SHALL REMOVE ALL RUBBISH AND DEBRIS FROM THE SITE AT THE END OF EACH DAY.
17. CONTRACTOR SHALL COORDINATE WORK SCHEDULE WITH LANDLORD AND TAKE PRECAUTIONS TO MINIMIZE IMPACT AND DISRUPTION OF OTHER OCCUPANTS OF THE FACILITY.
18. CONTRACTOR SHALL FURNISH ATC WITH A PDF MARKED UP AS-BUILT SET OF DRAWINGS UPON COMPLETION OF WORK.
19. PRIOR TO SUBMISSION OF BID, CONTRACTOR SHALL COORDINATE WITH ATC CM TO DETERMINE WHAT, IF ANY, ITEMS WILL BE PROVIDED. ALL ITEMS NOT PROVIDED SHALL BE PROVIDED AND INSTALLED BY THE CONTRACTOR. CONTRACTOR WILL INSTALL ALL ITEMS PROVIDED.
20. PRIOR TO SUBMISSION OF BID, CONTRACTOR SHALL COORDINATE WITH ATC CONSTRUCTION MANAGER TO DETERMINE IF ANY PERMITS WILL BE OBTAINED BY ATC. ALL REQUIRED PERMITS NOT OBTAINED BY ATC MUST BE OBTAINED, AND PAID FOR, BY THE CONTRACTOR.
21. CONTRACTOR SHALL INSTALL ALL SITE SIGNAGE IN ACCORDANCE WITH ATC SPECIFICATIONS AND REQUIREMENTS.
22. CONTRACTOR SHALL SUBMIT ALL SHOP DRAWINGS TO ATC FOR REVIEW AND APPROVAL PRIOR TO FABRICATION.
23. ALL EQUIPMENT SHALL BE INSTALLED ACCORDING TO MANUFACTURER'S SPECIFICATIONS AND LOCATED ACCORDING TO ATC SPECIFICATIONS, AND AS SHOWN IN THESE PLANS.
24. THE CONTRACTOR SHALL SUPERVISE AND DIRECT THE PROJECT DESCRIBED HEREIN. THE CONTRACTOR SHALL BE SOLELY RESPONSIBLE FOR ALL THE CONSTRUCTION MEANS, METHODS, TECHNIQUES, SEQUENCES AND PROCEDURES AND FOR COORDINATING ALL PORTIONS OF THE WORK UNDER THE CONTRACT.
25. CONTRACTOR SHALL NOTIFY ATC CM A MINIMUM OF 48 HOURS IN ADVANCE OF POURING CONCRETE OR BACKFILLING ANY UNDERGROUND UTILITIES, FOUNDATIONS OR SEALING ANY WALL, FLOOR OR ROOF PENETRATIONS FOR ENGINEERING REVIEW AND APPROVAL.
26. CONTRACTOR SHALL BE RESPONSIBLE FOR SITE SAFETY INCLUDING COMPLIANCE WITH ALL APPLICABLE OSHA STANDARDS AND RECOMMENDATIONS AND SHALL PROVIDE ALL NECESSARY SAFETY DEVICES INCLUDING PPE AND PPM AND CONSTRUCTION DEVICES SUCH AS WELDING AND FIRE PREVENTION, TEMPORARY SHORING, SCAFFOLDING, TRENCH BOXES/SLOPING, BARRIERS, ETC.
27. THE CONTRACTOR SHALL PROTECT AT HIS OWN EXPENSE, ALL EXISTING FACILITIES AND SUCH OF HIS NEW WORK LIABLE TO INJURY DURING THE CONSTRUCTION PERIOD. ANY DAMAGE CAUSED BY NEGLIGENCE ON THE PART OF THIS CONTRACTOR OR HIS REPRESENTATIVES, OR BY THE ELEMENTS DUE TO NEGLIGENCE ON THE PART OF THIS CONTRACTOR OR HIS

REPRESENTATIVES, EITHER TO THE EXISTING WORK, OR TO HIS WORK OR THE WORK OF ANY OTHER CONTRACTOR, SHALL BE REPAIRED AT HIS EXPENSE TO THE OWNER'S SATISFACTION.

28. ALL WORK SHALL BE INSTALLED IN A FIRST CLASS, NEAT AND WORKMANLIKE MANNER BY MECHANICS SKILLED IN THE TRADE INVOLVED. THE QUALITY OF WORKMANSHIP SHALL BE SUBJECT TO THE APPROVAL OF THE ATC CM. ANY WORK FOUND BY THE ATC CM TO BE OF INFERIOR QUALITY AND/OR WORKMANSHIP SHALL BE REPLACED AND/OR REWORKED AT CONTRACTOR EXPENSE UNTIL APPROVAL IS OBTAINED.
29. IN ORDER TO ESTABLISH STANDARDS OF QUALITY AND PERFORMANCE, ALL TYPES OF MATERIALS LISTED HEREINAFTER BY MANUFACTURER'S NAMES AND/OR MANUFACTURER'S CATALOG NUMBER SHALL BE PROVIDED BY THESE MANUFACTURERS AS SPECIFIED.

CONCRETE AND REINFORCING STEEL NOTES:

1. DESIGN AND CONSTRUCTION OF ALL CONCRETE ELEMENTS SHALL CONFORM TO THE LATEST EDITIONS OF ALL APPLICABLE CODES INCLUDING: ACI 301 "SPECIFICATIONS FOR STRUCTURAL CONCRETE FOR BUILDINGS", ACI 117 "SPECIFICATIONS FOR TOLERANCES FOR CONCRETE CONSTRUCTION AND MATERIALS", AND ACI 318 "BUILDING CODE REQUIREMENTS FOR REINFORCED CONCRETE."
2. MIX DESIGN SHALL BE APPROVED BY ATC CM PRIOR TO PLACING CONCRETE.
3. CONCRETE SHALL BE NORMAL WEIGHT, 6 % AIR ENTRAINED (+/- 1.5%) WITH A SLUMP RANGE OF 3-5" AND HAVE A MINIMUM 28-DAY COMPRESSIVE STRENGTH OF 4000 PSI UNLESS OTHERWISE NOTED.
4. THE FOLLOWING MATERIALS SHALL BE USED:
 - PORTLAND CEMENT: ASTM C150, TYPE 2
 - REINFORCEMENT: ASTM A185, PLAIN STEEL WELDED WIRE FABRIC
 - REINFORCEMENT BARS: ASTM A615, GRADE 60, DEFORMED
 - NORMAL WEIGHT AGGREGATE: ASTM C33
 - WATER: ASTM C 94/C 94M
 - ADMIXTURES:
 - WATER-REDUCING AGENT: ASTM C 494/C 494M, TYPE A
 - AIR-ENTERING AGENT: ASTM C 260/C 260M
 - SUPERPLASTICIZER: ASTM C494, TYPE F OR TYPE G
 - RETARDING: ASTM C 494/C 494M, TYPE B
5. MINIMUM CONCRETE COVER FOR REINFORCING STEEL SHALL BE NO LESS THAN 3".
6. A 3/4" CHAMFER SHALL BE PROVIDED AT ALL EXPOSED EDGES OF CONCRETE IN ACCORDANCE WITH ACI 301 SECTION 4.2.4, UNLESS NOTED OTHERWISE.
7. INSTALLATION OF CONCRETE EXPANSION/WEDGE ANCHOR SHALL BE PER MANUFACTURER'S WRITTEN RECOMMENDED PROCEDURE. THE ANCHOR BOLT, DOWEL, OR ROD SHALL CONFORM TO MANUFACTURER'S RECOMMENDATION FOR EMBEDMENT DEPTH OR AS SHOWN ON THE DRAWINGS. NO REBAR SHALL BE CUT WITHOUT PRIOR ATC CM APPROVAL WHEN DRILLING HOLES IN CONCRETE.
8. ADMIXTURES SHALL CONFORM TO THE APPROPRIATE ASTM STANDARD AS REFERENCED IN "METHOD 1" OF ACI 301.
9. DO NOT WELD OR TACK WELD REINFORCING STEEL.
10. ALL DOWELS, ANCHOR BOLTS, EMBEDDED STEEL, ELECTRICAL CONDUITS, PIPE SLEEVES, GROUNDS AND ALL OTHER EMBEDDED ITEMS AND FORMED DETAILS SHALL BE IN PLACE BEFORE START OF CONCRETE PLACEMENT.
11. REINFORCEMENT SHALL BE COLD BENT WHENEVER BENDING IS REQUIRED.
12. DO NOT PLACE CONCRETE IN WATER, ICE, OR ON FROZEN GROUND.
13. DO NOT ALLOW REINFORCEMENT, CONCRETE OR SUBBASE TO FREEZE DURING CONCRETE CURING AND SETTING PERIOD, OR FOR A MINIMUM OF 3 DAYS AFTER PLACEMENT.
14. FOR COLD-WEATHER(ACI 306) AND HOT-WEATHER(ACI 301M) CONCRETE PLACEMENT, CONFORM TO APPLICABLE ACI CODES AND RECOMMENDATIONS. IN EITHER CASE, MATERIALS CONTAINING CHLORIDE, CALCIUM, SALTS, ETC. SHALL NOT BE USED. PROTECT FRESH CONCRETE FROM WEATHER FOR 7 DAYS, MINIMUM.
15. ALL CONCRETE SHALL HAVE A "SMOOTH FORM FINISH."
16. UNLESS OTHERWISE NOTED:
 - A. ALL REINFORCING STEEL SHALL BE DEFORMED BARS CONFORMING TO ASTM A615/A 615M/A-996, GRADE 60.
 - B. WELDED WIRE FABRIC SHALL CONFORM TO ASTM A185.
17. SPLICING OF REINFORCEMENT IS PERMITTED ONLY AT LOCATIONS SHOWN IN THE CONTRACT DRAWINGS OR AS ACCEPTED BY THE ENGINEER. UNLESS OTHERWISE SHOWN OR NOTED REINFORCING STEEL SHALL BE SPLICED TO DEVELOP ITS FULL TENSILE CAPACITY (CLASS A) IN ACCORDANCE WITH ACI 318.
18. REINFORCING BAR DEVELOPMENT LENGTHS, AS COMPUTED IN ACCORDANCE WITH ACI 318, FORM THE BASIS FOR BAR EMBEDMENT LENGTHS AND BAR SPLICED LENGTHS SHOWN IN THE

DRAWINGS. APPLY APPROPRIATE MODIFICATION FACTORS FOR TOP STEEL, BAR SPACING, COVER AND THE LIKE.

19. DETAILING OF REINFORCING STEEL SHALL CONFORM TO "ACI MANUAL OF STANDARD PRACTICE FOR DETAILING REINFORCED CONCRETE STRUCTURES" (ACI 315).
20. ALL SLAB CONSTRUCTION SHALL BE CAST MONOLITHICALLY WITHOUT HORIZONTAL CONSTRUCTION JOINTS, UNLESS SHOWN IN THE CONTRACT DRAWINGS.
21. LOCATION OF ALL CONSTRUCTION JOINTS ARE SUBJECT TO THE REQUIREMENTS OF THE CONTRACT DOCUMENTS, CONFORMANCE WITH ACI 318, AND ACCEPTANCE OF THE ENGINEER. DRAWINGS SHOWING LOCATION OF DETAILS OF THE PROPOSED CONSTRUCTION JOINTS SHALL BE SUBMITTED WITH REINFORCING STEEL PLACEMENT DRAWINGS.
22. SPLICES OF WWF, AT ALL SPLICED EDGES, SHALL BE SUCH THAT THE OVERLAP MEASURED BETWEEN OUTERMOST CROSS WIRES OF EACH FABRIC SHEET IS NOT LESS THAN THE SPACING OF THE CROSS WIRE PLUS 2 INCHES, NOR LESS THAN 6".
23. BAR SUPPORTS SHALL BE ALL-GALVINIZED METAL WITH PLASTIC TIPS.
24. ALL REINFORCEMENT SHALL BE SECURELY TIED IN PLACE TO PREVENT DISPLACEMENT BY CONSTRUCTION TRAFFIC OR CONCRETE. TIE WIRE SHALL BE OF SUFFICIENT STRENGTH FOR INTENDED PURPOSE, BUT NOT LESS THAN NO. 18 GAUGE.
25. SLAB ON GROUND:
 - A. COMPACT SUBGRADE AND ENSURE THERE IS PLACE 6" GRAVEL BENEATH SLAB.
 - B. PROVIDE VAPOR BARRIER BENEATH SLAB ON GROUND.

STRUCTURAL STEEL NOTES:

1. STRUCTURAL STEEL SHALL CONFORM TO THE LATEST EDITION OF THE AISC "SPECIFICATION FOR THE DESIGN, FABRICATION AND ERECTION OF STRUCTURAL STEEL FOR BUILDINGS."
2. STRUCTURAL STEEL ROLLED SHAPES, PLATES AND BARS SHALL CONFORM TO THE FOLLOWING ASTM DESIGNATIONS:
 - A. ASTM A-572, GRADE 50 - ALL W SHAPES, UNLESS NOTED OR A992 OTHERWISE
 - B. ASTM A-36 - ALL OTHER ROLLED SHAPES, PLATES AND BARS UNLESS NOTED OTHERWISE
 - C. ASTM A-500, GRADE B - HSS SECTION (SQUARE, RECTANGULAR, AND ROUND)
 - D. ASTM A-325, TYPE SC OR N - ALL BOLTS FOR CONNECTING STRUCTURAL MEMBERS
 - E. ASTM F-1554 07 - ALL ANCHOR BOLTS, UNLESS NOTED OTHERWISE
3. ALL EXPOSED STRUCTURAL STEEL MEMBERS SHALL BE HOT-DIPPED GALVANIZED AFTER FABRICATION PER ASTM A123. EXPOSED STEEL HARDWARE AND ANCHOR BOLTS SHALL BE GALVANIZED PER ASTM A153 OR B695.
4. ALL FIELD CUT SURFACES, FIELD DRILLED HOLES AND GROUND SURFACES WHERE EXISTING PAINT OR GALVANIZATION REMOVAL WAS REQUIRED SHALL BE REPAIRED WITH (2) BRUSHED COATS OF ZRC GALVILITE COLD GALVANIZING COMPOUND PER ASTM A780 AND MANUFACTURER'S RECOMMENDATIONS.
5. DO NOT DRILL HOLES THROUGH STRUCTURAL STEEL MEMBERS EXCEPT AS SHOWN AND DETAILED ON STRUCTURAL DRAWINGS.
6. CONNECTIONS:
 - A. ALL WELDING TO BE PERFORMED BY AWS CERTIFIED WELDERS AND CONDUCTED IN ACCORDANCE WITH THE LATEST EDITION OF THE AWS WELDING CODE D1.1.
 - B. ALL WELDS SHALL BE INSPECTED VISUALLY. 25% OF WELDS SHALL BE INSPECTED WITH DYE PENETRANT OR MAGNETIC PARTICLE TO MEET THE ACCEPTANCE CRITERIA OF AWS D1.1. REPAIR ALL WELDS AS NECESSARY.
 - C. INSPECTION SHALL BE PERFORMED BY AN AWS CERTIFIED WELD INSPECTOR.
 - D. IT IS THE CONTRACTORS RESPONSIBILITY TO PROVIDE BURNING/WELDING PERMITS AS REQUIRED BY LOCAL GOVERNING AUTHORITY AND IF REQUIRED SHALL HAVE FIRE DEPARTMENT DETAIL FOR ANY WELDING ACTIVITY.
 - E. ALL ELECTRODES TO BE LOW HYDROGEN, MATCHING FILLER METAL, PER AWS D1.1, UNLESS NOTED OTHERWISE.
 - F. MINIMUM WELD SIZE TO BE 0.1875 INCH FILLET WELDS, UNLESS NOTED OTHERWISE.
 - G. PRIOR TO FIELD WELDING GALVANIZING MATERIAL, CONTRACTOR SHALL GRIND OFF GALVANIZING 1/2" BEYOND ALL FIELD WELD SURFACES. AFTER WELD AND WELD INSPECTION IS COMPLETE, REPAIR ALL GROUND AND WELDED SURFACES WITH ZRC GALVILITE COLD GALVANIZING COMPOUND PER ASTM A780 AND MANUFACTURERS RECOMMENDATIONS.



THESE DRAWINGS AND/OR THE ACCOMPANYING SPECIFICATION AS INSTRUMENTS OR SERVICE ARE THE EXCLUSIVE PROPERTY OF AMERICAN TOWER. THEIR USE AND PUBLICATION SHALL BE RESTRICTED TO THE ORIGINAL SITE FOR WHICH THEY ARE PREPARED. ANY USE OR DISCLOSURE OTHER THAN THAT WHICH RELATES TO AMERICAN TOWER OR THE SPECIFIED CARRIER IS STRICTLY PROHIBITED. TITLE TO THESE DOCUMENTS SHALL REMAIN THE PROPERTY OF AMERICAN TOWER WHETHER OR NOT THE PROJECT IS EXECUTED. NEITHER THE ARCHITECT NOR THE ENGINEER WILL BE PROVIDING ON-SITE CONSTRUCTION REVIEW OF THIS PROJECT. CONTRACTOR(S) MUST VERIFY ALL DIMENSIONS AND ADVISE AMERICAN TOWER OF ANY DISCREPANCIES. ANY PRIOR ISSUANCE OF THIS DRAWING IS SUPERSEDED BY THE LATEST VERSION ON FILE WITH AMERICAN TOWER.

REV.	DESCRIPTION	BY	DATE
0	FOR CONSTRUCTION	DE	05/18/22

ATC SITE NUMBER:
302466

ATC SITE NAME:
WEST SERVICE ROAD

SITE ADDRESS:
305 W. SERVICE RD.
HARTFORD, CT 06120

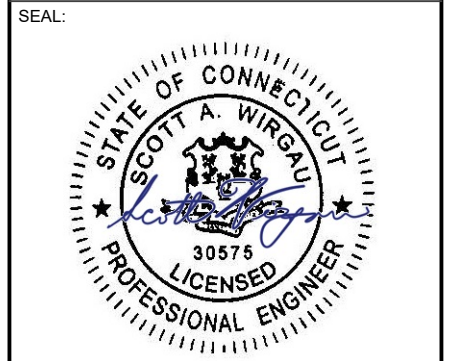

DRAWN BY:	AM
DATE DRAWN:	05/18/22
ATC JOB NO:	14098396_M4

GENERAL NOTES

SHEET NUMBER:
G-002

REVISION:
0

Copyright © 2022 ATC IP, LLC. All Rights Reserved.



AMERICAN TOWER®
A.T. ENGINEERING SERVICE, PLLC
 3500 REGENCY PARKWAY
 SUITE 100
 CARY, NC 27518
 PHONE: (919) 468-0112
 COA: PEC.0001553

THESE DRAWINGS AND/OR THE ACCOMPANYING SPECIFICATION AS INSTRUMENTS OR SERVICE ARE THE EXCLUSIVE PROPERTY OF AMERICAN TOWER. THEIR USE AND PUBLICATION SHALL BE RESTRICTED TO THE ORIGINAL SITE FOR WHICH THEY ARE PREPARED. ANY USE OR DISCLOSURE OTHER THAN THAT WHICH RELATES TO AMERICAN TOWER OR THE SPECIFIED CARRIER IS STRICTLY PROHIBITED. TITLE TO THESE DOCUMENTS SHALL REMAIN THE PROPERTY OF AMERICAN TOWER WHETHER OR NOT THE PROJECT IS EXECUTED. NEITHER THE ARCHITECT NOR THE ENGINEER WILL BE PROVIDING ON-SITE CONSTRUCTION REVIEW OF THIS PROJECT. CONTRACTOR(S) MUST VERIFY ALL DIMENSIONS AND ADVISE AMERICAN TOWER OF ANY DISCREPANCIES. ANY PRIOR ISSUANCE OF THIS DRAWING IS SUPERSEDED BY THE LATEST VERSION ON FILE WITH AMERICAN TOWER.

REV.	DESCRIPTION	BY	DATE
0	FOR CONSTRUCTION	DE	05/18/22

ATC SITE NUMBER:
302466

ATC SITE NAME:
WEST SERVICE ROAD

SITE ADDRESS:
305 W. SERVICE RD.
HARTFORD, CT 06120

SEAL:

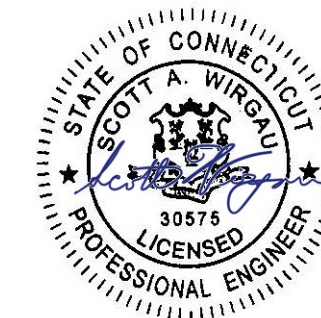

DRAWN BY:	AM
DATE DRAWN:	05/18/22
ATC JOB NO:	14098396_M4

DETAILED SITE PLAN

SHEET NUMBER:	REVISION:
C-102	0

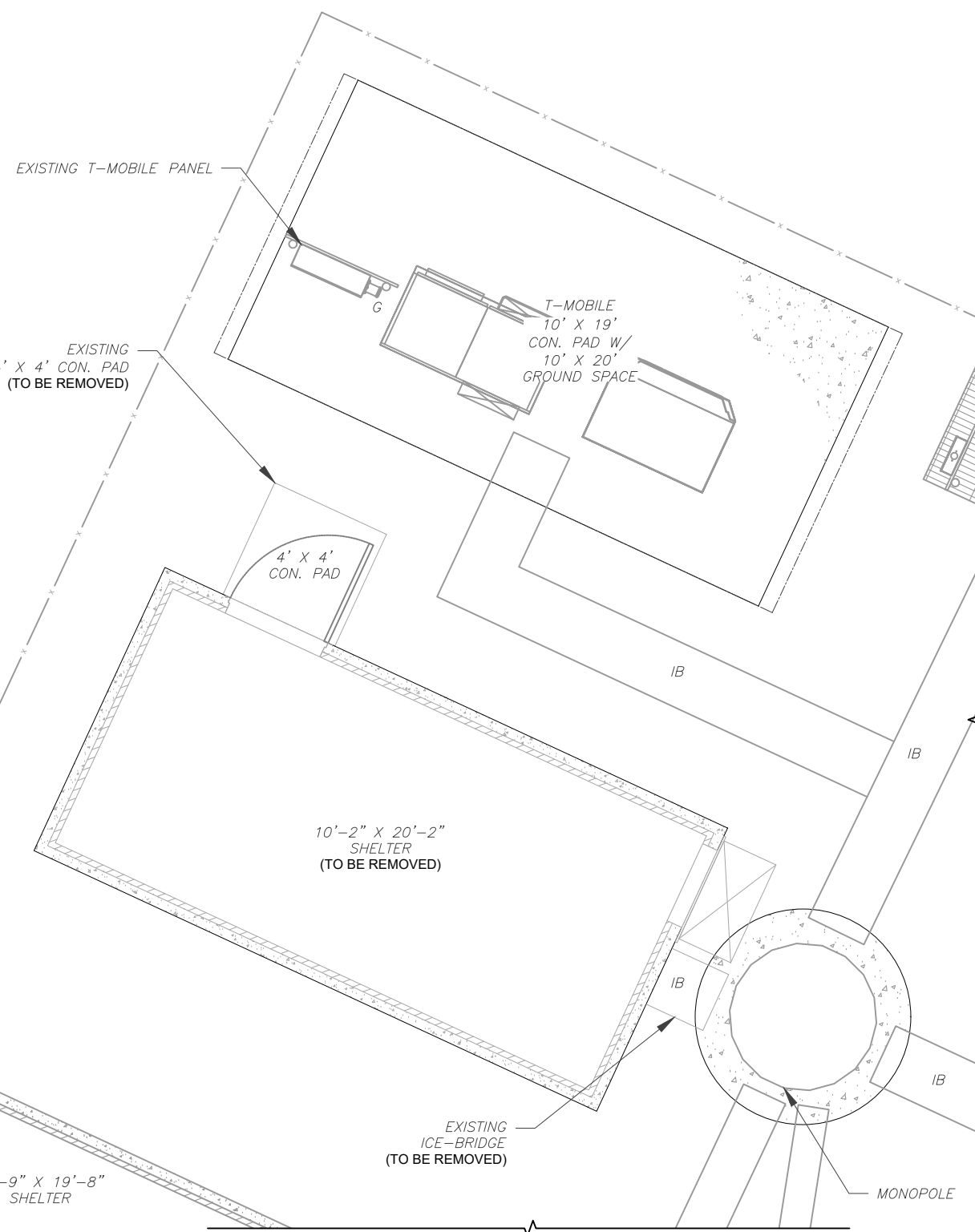

1 EXISTING GROUND EQUIPMENT LAYOUT

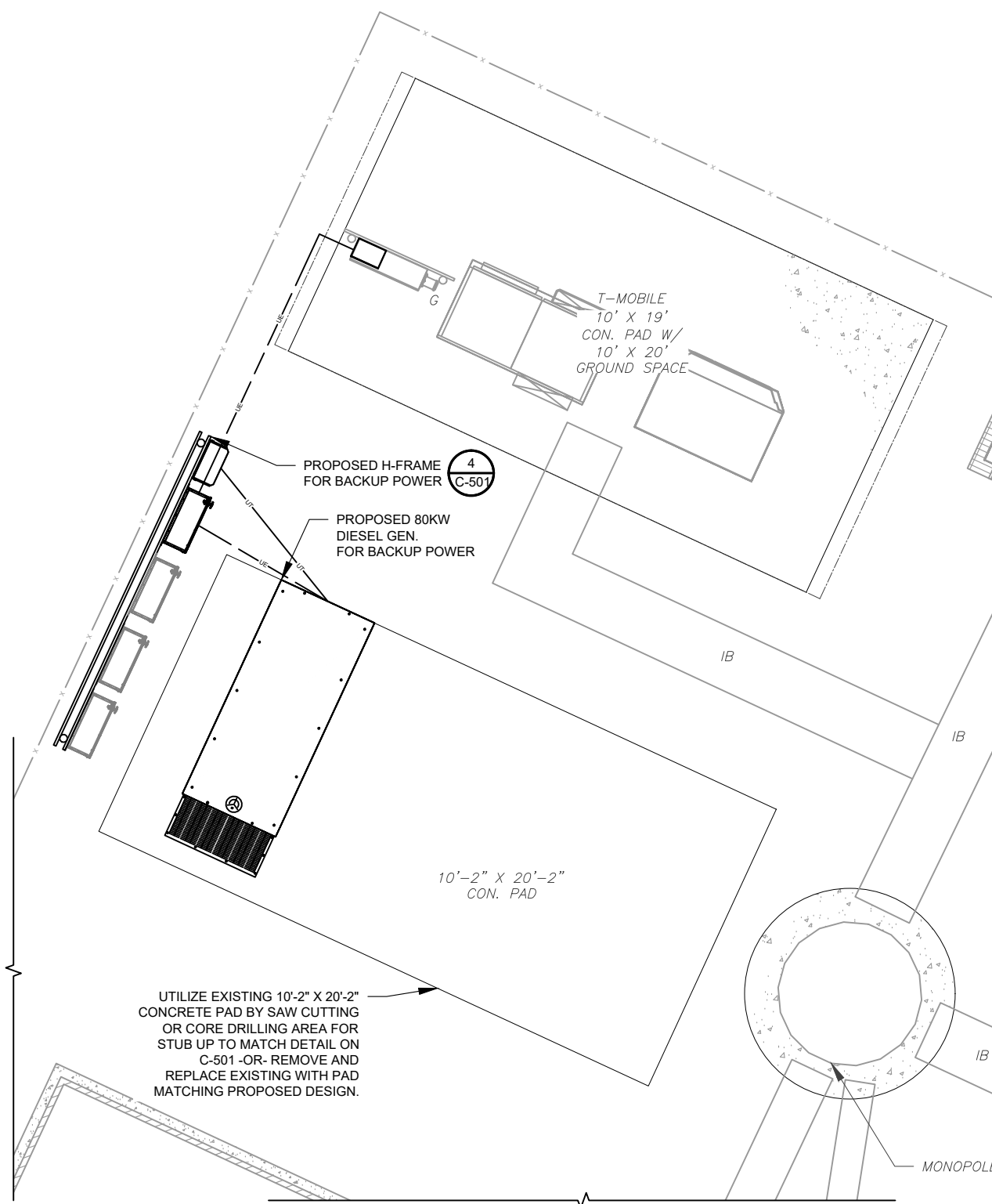
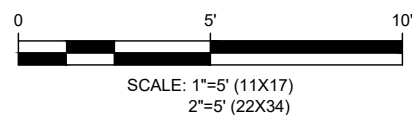

2 PROPOSED GROUND EQUIPMENT LAYOUT

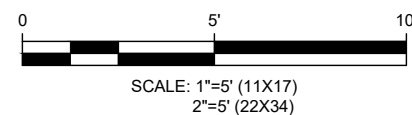

Copyright © 2022 ATC IP, LLC. All Rights Reserved.

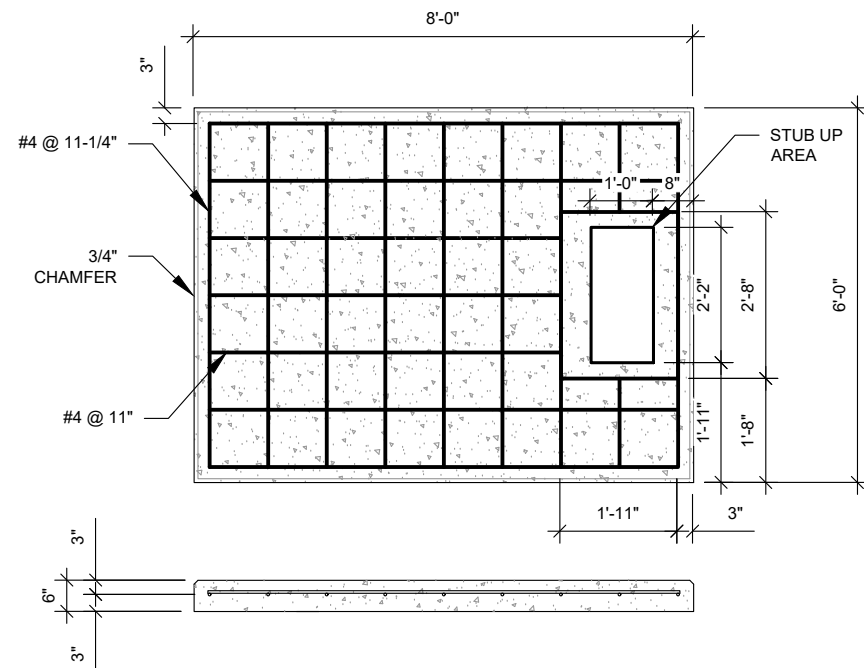

PAD NOTES:

1. PADS SHALL BE PRE-CAST MATCHING THIS DESIGN WHERE ALLOWED BY LOCAL JURISDICTION.
2. PADS SHALL HAVE A MIN 28 DAY COMPRESSIVE STRENGTH AS SPECIFIED ON G-002, CONCRETE AND REINFORCING STEEL NOTES #3
3. REFER TO CONCRETE & REINFORCED STEEL NOTES ON SHEET G-002 & ATC CONSTRUCTION SPECIFICATION 033000 FOR CAST-IN-PLACE PADS.
4. STUB UP AREA SHALL BE FILLED WITH QUIKRETE, OR APPROVED EQUAL, PRIOR TO FINAL SET OF GENERATOR ON PAD.
5. AFTER FINAL SET OF GENERATOR ON PAD, GROUT ALL EXTERIOR OPENINGS AT PAD INTERFACE SO THAT FINISHED MAXIMUM OPENING SHALL BE 1/4 INCH.
6. GROUT SHALL BE PER ATC CONSTRUCTION SPECIFICATION DIVISION 03, CONCRETE.

1 REINFORCED PAD LAYOUT

SCALE: N.T.S.

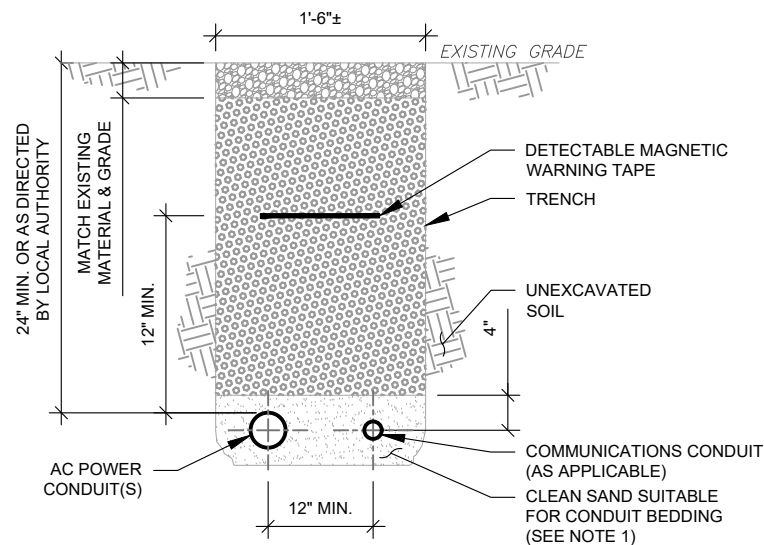

TRENCH NOTES:

1. IF FREE OF ORGANIC OR OTHER DELETERIOUS MATERIAL, EXCAVATED MATERIAL MAY BE USED FOR BACKFILL. IF NOT, PROVIDE CLEAN, COMPACTIBLE MATERIAL.
2. COMPACT IN 8" LIFTS USING A MECHANICAL PLATE TAMPER, MIN 3 PASSES. REMOVE ANY LARGE ROCKS PRIOR TO BACKFILLING. CONTRACTOR TO VERIFY LOCATION OF EXISTING U/G UTILITIES PRIOR TO DIGGING. SEE ATC CONSTRUCTION SPECIFICATION 312000 SECTION 3.15.
3. IF CURRENT AS-BUILT DRAWINGS ARE NOT AVAILABLE CONTRACTOR SHALL HAND DIG U/G TRENCHING.
4. CONFIRM SPACING AND DEPTH WITH NEC OR LOCAL CODE REQUIREMENTS

3 CONDUIT TRENCH DETAILS

SCALE: N.T.S.

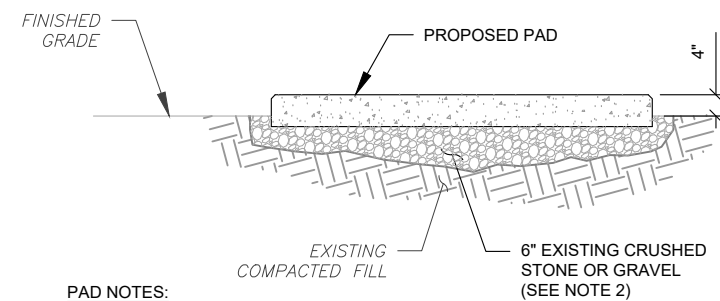
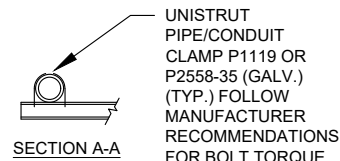

PAD NOTES:

1. SUBGRADE AND FILL SHALL CONSIST OF CLEAN SOIL. DELETRIOUS MATERIAL AND ORGANICS SHALL BE REMOVED.
2. MECHANICALLY COMPACT FOOTPRINT OF PAD PLUS 2' PERIMETER USING A MECHANICAL PLATE TAMPER, MIN 3 PASSES. SEE ATC CONSTRUCTION SPECIFICATION 312000 ACCESS ROAD AND EARTH WORK.
3. USE GALVANIZED HILTI EXPANSION ANCHORS OR, APPROVED EQUAL, FOR EQUIPMENT ANCHORAGE.
4. FOR SIZE AND LOCATION OF ANCHORS AND OTHER REQUIREMENT, SEE EQUIPMENT VENDOR DRAWINGS.

2 GRAVEL PREPARATION

SCALE: N.T.S.

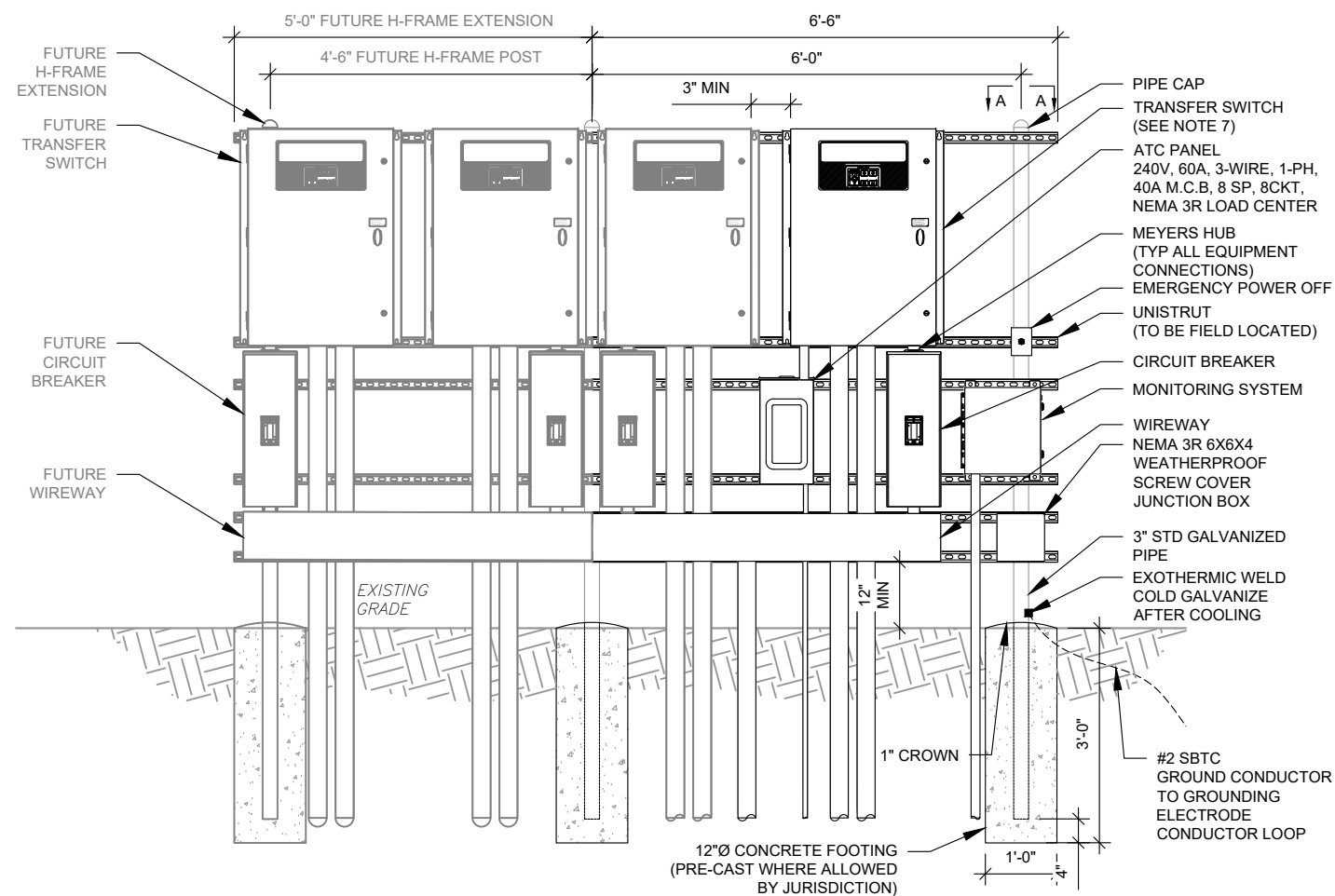

H-FRAME NOTES:

1. IF IT IS NECESSARY TO EXTEND THE H-FRAME, AN ADDITIONAL POST SHALL BE REQUIRED.
2. PROPOSED UNISTRUTS TO BE FIELD CUT AND SHALL NOT EXTEND MORE THAN 6 INCHES BEYOND THE LAST POST.
3. SPRAY ENDS OF UNISTRUT WITH COLD GALVANIZING SPRAY PAINT, ALLOW TO DRY, THEN COVER WITH RUBBER PROTECTIVE CAPS FOR SAFETY.
4. UNISTRUT TO BE CUT FLUSH WITH NO SHARP OR JAGGED EDGES.
5. ALL PROPOSED HARDWARE TO BE MOUNTED AND GROUNDED PER MANUFACTURERS SPECS
6. ALL ITEMS ARE PROPOSED UNLESS OTHERWISE NOTED.
7. LAYOUT H-FRAME & PROPOSED EQUIPMENT EXACTLY AS SHOWN TO ALLOW FOR FUTURE EQUIPMENT. ANY DEVIATIONS MUST BE APPROVED BY ATC CM, IN WRITING, NO EXCEPTIONS.
8. FOOTINGS SHALL BE ONE OF THE FOLLOWING: USS POLECRETE STABILIZER SYSTEM, PRECAST CONCRETE (WHERE ALLOWED BY JURISDICTION) OR CAST IN PLACE. FOR PRECAST FOOTINGS, CONTRACTORS SHALL THOROUGHLY COMPACT THE PERIMETER (2' MIN) OF FOOTING WITH MECHANICAL PLATE TAMPER.

4 H-FRAME

SCALE: N.T.S.

THESE DRAWINGS AND/OR THE ACCOMPANYING SPECIFICATION AS INSTRUMENTS OR SERVICE ARE THE EXCLUSIVE PROPERTY OF AMERICAN TOWER. THEIR USE AND PUBLICATION SHALL BE RESTRICTED TO THE ORIGINAL SITE FOR WHICH THEY ARE PREPARED. ANY USE OR DISCLOSURE OTHER THAN THAT WHICH RELATES TO AMERICAN TOWER OR THE SPECIFIED CARRIER IS STRICTLY PROHIBITED. TITLE TO THESE DOCUMENTS SHALL REMAIN THE PROPERTY OF AMERICAN TOWER WHETHER OR NOT THE PROJECT IS EXECUTED. NEITHER THE ARCHITECT NOR THE ENGINEER WILL BE PROVIDING ON-SITE CONSTRUCTION REVIEW OF THIS PROJECT. CONTRACTOR(S) MUST VERIFY ALL DIMENSIONS AND ADVISE AMERICAN TOWER OF ANY DISCREPANCIES. ANY PRIOR ISSUANCE OF THIS DRAWING IS SUPERSEDED BY THE LATEST VERSION ON FILE WITH AMERICAN TOWER.

REV.	DESCRIPTION	BY	DATE
0	FOR CONSTRUCTION	DE	05/18/22

ATC SITE NUMBER:
302466

ATC SITE NAME:
WEST SERVICE ROAD

SITE ADDRESS:
305 W. SERVICE RD.
HARTFORD, CT 06120

SEAL:

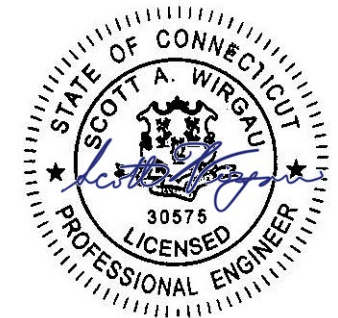

DRAWN BY:	AM
DATE DRAWN:	05/18/22
ATC JOB NO:	14098396_M4

CONCRETE PAD DETAILS

SHEET NUMBER:	REVISION:
C-501	0

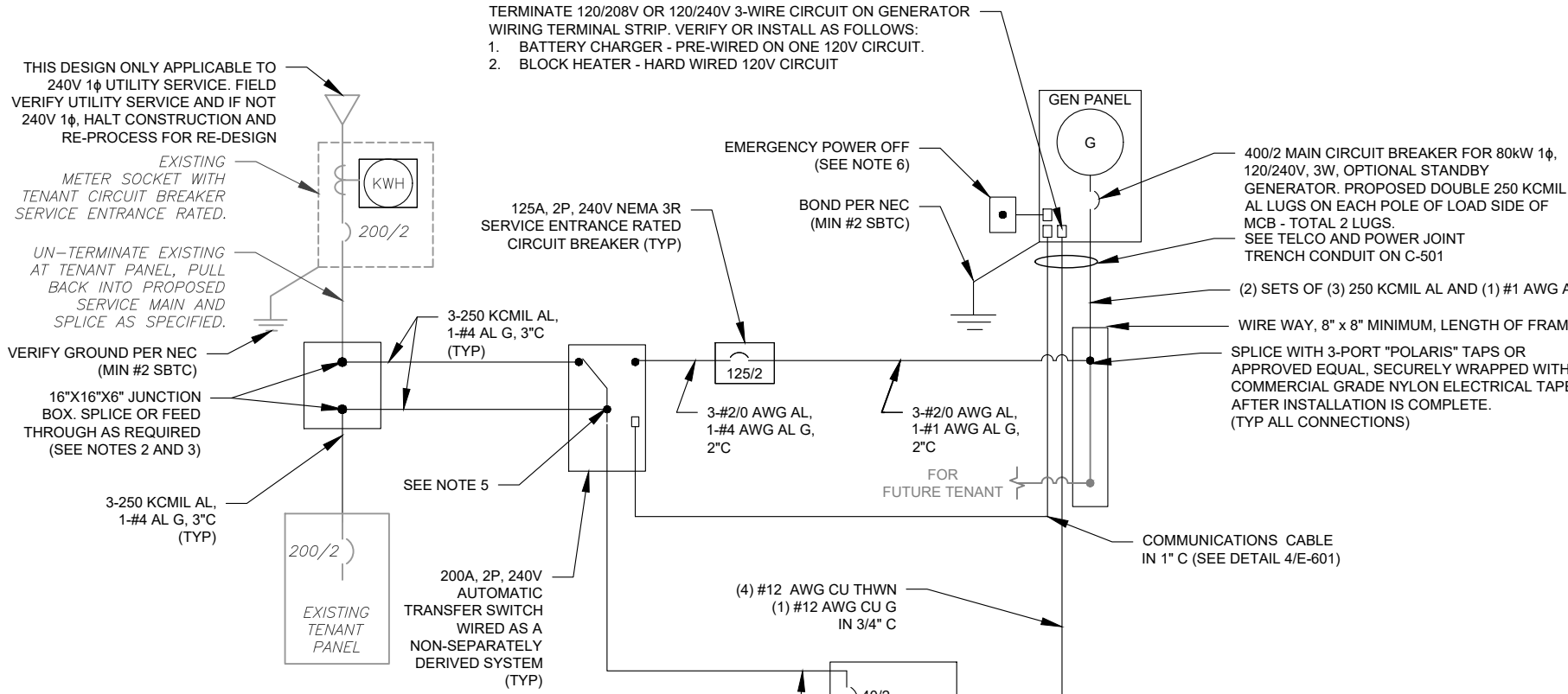

- ONE-LINE NOTES:**
- CONNECT CT'S PER HTS OWNERS MANUAL-SECTION 3.11.2 INSTRUMENT PACKAGE
 - SPLICE WITH "POLARIS" TAPS OR APPROVED EQUAL, SECURELY WRAPPED WITH COMMERCIAL GRADE NYLON ELECTRICAL TAPE AFTER INSTALLATION IS COMPLETE.
 - UTILIZE EXISTING ENCLOSURES FOR SPLICING (PER NEC 312.8) OR INSTALL NEW JUNCTION BOX AS APPLICABLE PER SITE CONDITIONS AND CODES. SIZE JUNCTION BOX AS PER NEC 314.28
 - IF TAPPING AT TENANT EQUIPMENT, NO TAPS MAY BE MADE WITHIN THEIR EXISTING EQUIPMENT, INCLUDING PPC.
 - TAP GENERATOR PANEL CIRCUIT TO LUGS ON T-TERMINALS (LOAD SIDE) WITH AUXILIARY TAP SCREW. TERMINATE CONDUCTOR ON EACH LUG WITH INSULATED RING TERMINAL PROPERLY SIZED.
 - EMERGENCY POWER OFF PUSHBUTTON IN WEATHERPROOF ENCLOSURE FOR REMOTE SHUTDOWN OF GENERATOR ENCLOSURE. FURNISHED BY GENERATOR MANUFACTURER AND INSTALLED BY CONTRACTOR. CONNECT TO Y TERMINALS LOCATED NEAR TB2 VIA 2#18 AWG WIRES IN 1/2" LFMC.

1 ELECTRICAL ONE-LINE DIAGRAM
SCALE: NOT TO SCALE

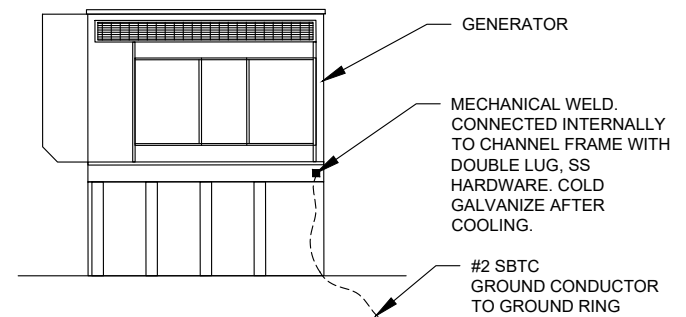

GENERATOR INSTALLATION NOTE:

INSTALL GENERATOR AND TRANSFER SWITCH WITH ALL SUPPLIED ACCESSORIES PER MANUFACTURER'S INSTALLATION INSTRUCTIONS AND SPECIFICATIONS. THIS INCLUDES, BUT IS NOT LIMITED TO, ACCESSORIES FOR THE EXHAUST SYSTEM, FUEL SYSTEM, ENCLOSURE INTEGRITY (CAPS, PLUGS, COVERS, ETC.), ELECTRICAL CONNECTIONS, AND GROUNDING CONNECTIONS.

2 GENERATOR GROUNDING
SCALE: NOT TO SCALE

DEMAND LOAD CALCULATION

GENERATOR LOADS	2.5 KW
TENANT PANEL DEMAND LOADS	25.0 KW
TOTAL DEMAND LOADS (KW)	27.5 KW
TOTAL DEMAND CURRENT (A)	114.5 A
AT 120/240V, 1PH, 3W	

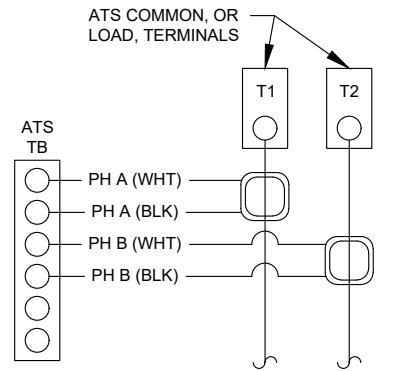

- CT NOTES:**
- CT'S FURNISHED BY GENERATOR MANUFACTURER WITH LEAD WIRE OPTION, 200:1 AMP RATIO.
 - WIRING SHOWN FOR SINGLE PHASE TENANT LOAD ON PHASES A-B. ADJUST ACCORDINGLY FOR INDIVIDUAL SITES THAT ARE BALANCING THREE PHASE SERVICES.
 - 1-PHASE: MOUNT ONE CT WITH WHITE DOT FACING AWAY FROM, AND OTHER CT WITH WHITE DOT FACING TOWARDS, THE ATS TERMINAL CONNECTIONS
 - 3-PHASE: MOUNT ALL CT'S WITH WHITE DOTS ALL FACING AWAY FROM THE ATS TERMINAL CONNECTIONS

3 CT WIRING DIAGRAM
SCALE: NOT TO SCALE

- NOTES:**
- INSTALL NETWORK OPERATING CENTER (NOC) MONITORING COMMUNICATION SYSTEM (RMC-700) ON MAIN UTILITY H-FRAME. THE RMC-700 IS FURNISHED BY ATC, COMPLETE WITH MOUNTING BRACKETS.
 - INSTALL EXTERNAL ANTENNA KIT (FURNISHED BY ATC). ANTENNA MOUNTS TO KENTROX ENCLOSURE OR MOUNTED TO H-FRAME. FEED CABLE THROUGH RMC-700 ENTRY PORT #3 AND CONNECT TO ANTENNA PORT TX/RX. HAND TIGHTEN ONLY. LEAVE POWER AND DATA CABLES IN RMC-700 UNCONNECTED FOR COMMISSIONING TEAM
 - BRANCH CIRCUIT WIRING FOR MONITORING DEVICE SHALL BE 2-#12 AWG CU, 1-#12 AWG CU G, IN 3/4" C.

5 PROPOSED MONITORING
SCALE: NOT TO SCALE

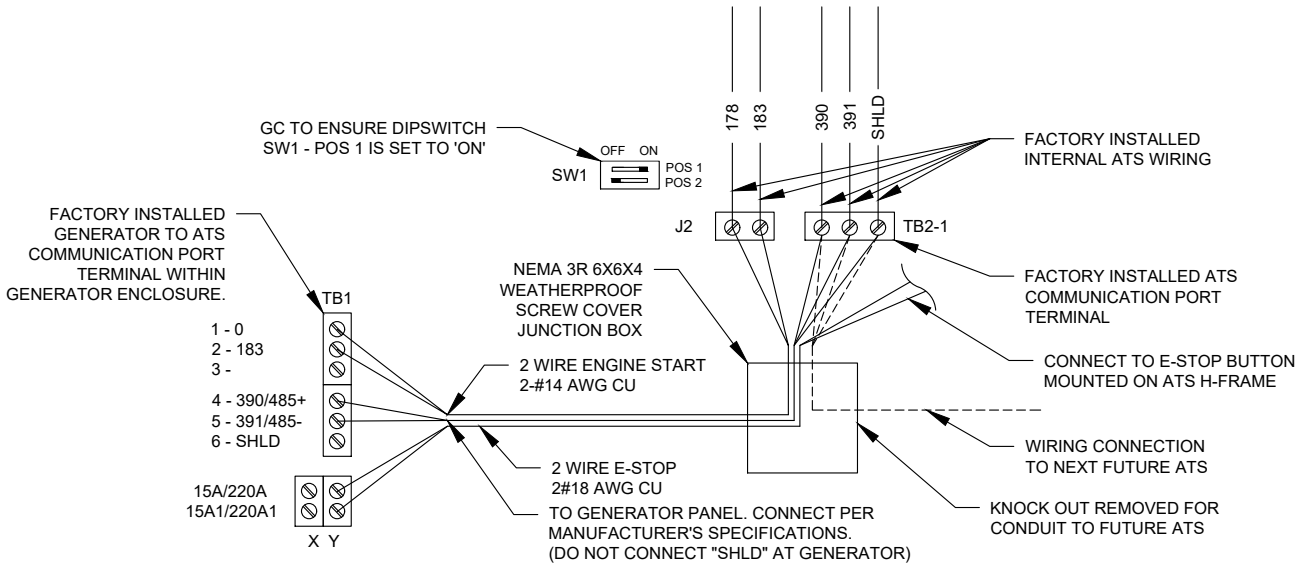

4 COMMUNICATIONS CABLE DETAIL
SCALE: NOT TO SCALE

AMERICAN TOWER®
A.T. ENGINEERING SERVICE, PLLC
 3500 REGENCY PARKWAY
 SUITE 100
 CARY, NC 27518
 PHONE: (919) 468-0112
 COA: PEC.0001553

THESE DRAWINGS AND/OR THE ACCOMPANYING SPECIFICATION AS INSTRUMENTS OR SERVICE ARE THE EXCLUSIVE PROPERTY OF AMERICAN TOWER. THEIR USE AND PUBLICATION SHALL BE RESTRICTED TO THE ORIGINAL SITE FOR WHICH THEY ARE PREPARED. ANY USE OR DISCLOSURE OTHER THAN THAT WHICH RELATES TO AMERICAN TOWER OR THE SPECIFIED CARRIER IS STRICTLY PROHIBITED. TITLE TO THESE DOCUMENTS SHALL REMAIN THE PROPERTY OF AMERICAN TOWER WHETHER OR NOT THE PROJECT IS EXECUTED. NEITHER THE ARCHITECT NOR THE ENGINEER WILL BE PROVIDING ON-SITE CONSTRUCTION REVIEW OF THIS PROJECT. CONTRACTOR(S) MUST VERIFY ALL DIMENSIONS AND ADVISE AMERICAN TOWER OF ANY DISCREPANCIES. ANY PRIOR ISSUANCE OF THIS DRAWING IS SUPERSEDED BY THE LATEST VERSION ON FILE WITH AMERICAN TOWER.

REV.	DESCRIPTION	BY	DATE
0	FOR CONSTRUCTION	DE	05/18/22

ATC SITE NUMBER:
302466

ATC SITE NAME:
WEST SERVICE ROAD

SITE ADDRESS:
305 W. SERVICE RD.
HARTFORD, CT 06120

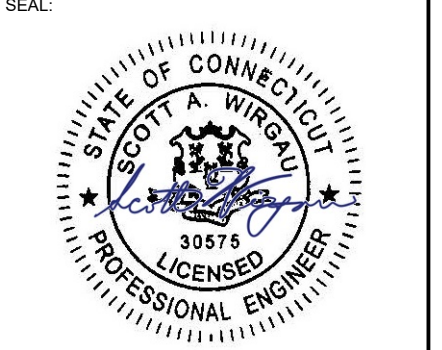

DRAWN BY:	AM
DATE DRAWN:	05/18/22
ATC JOB NO:	14098396_M4

ELECTRICAL ONE-LINE AND WIRING DETAILS

SHEET NUMBER:	REVISION:
E-601	0

REMOTE EMERGENCY STOP SWITCH SURFACE MOUNT, H-PANEL

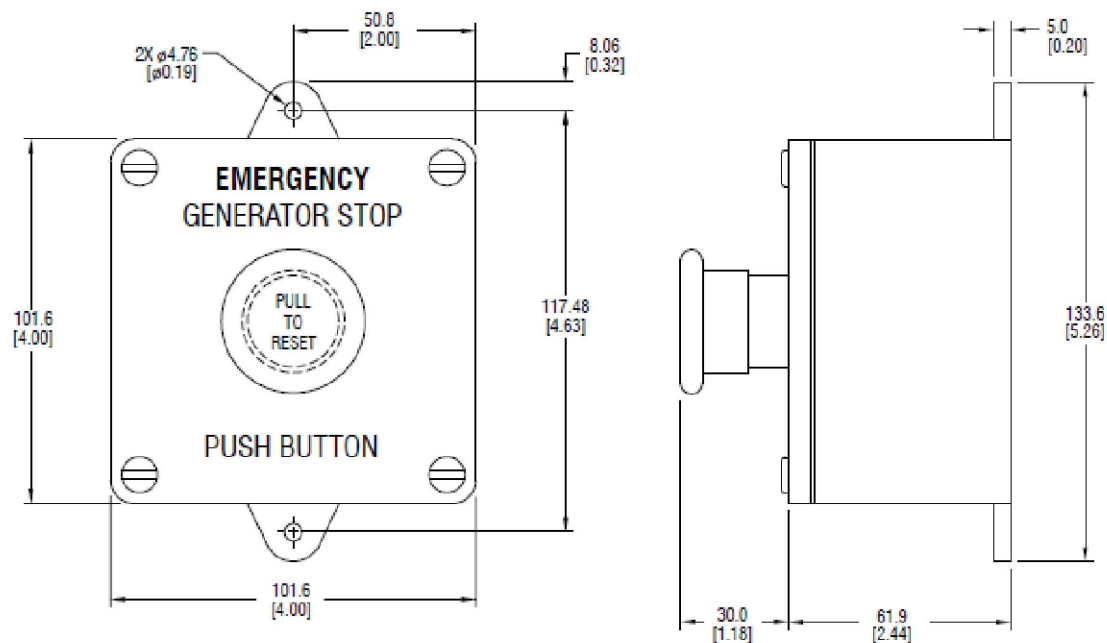

- MANUFACTURER: PILLA ELECTRICAL PRODUCTS, INC.
- MODEL SG120
- GENERAC PART NUMBER 061120E
- SURFACE MOUNT, NEMA 4X
- NONMETALLIC BACKBOX

DIMENSIONS: mm [INCHES]

GENSET CONTROLS

1 OF 2

REMOTE EMERGENCY STOP SWITCH SURFACE MOUNT, H-PANEL

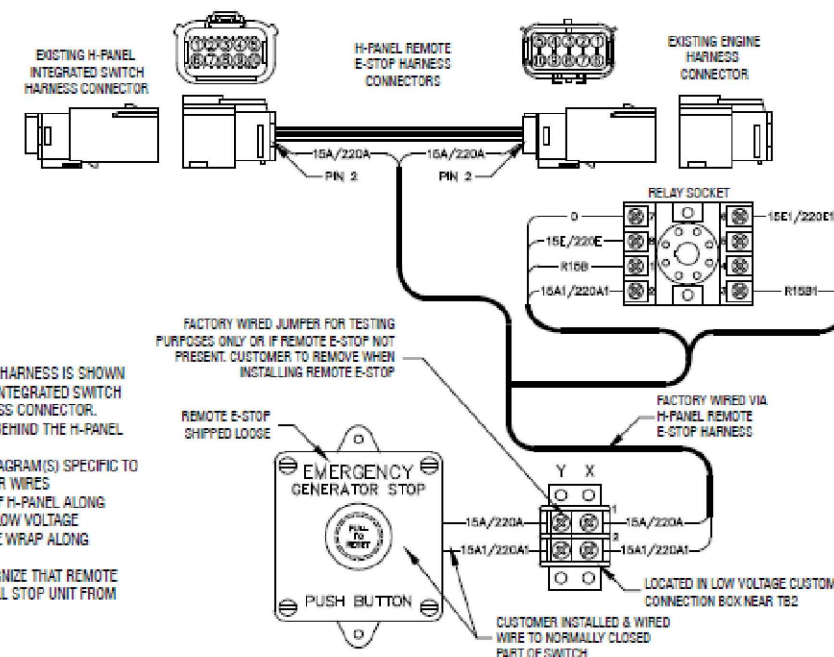

- NOTES:
- 1) THE H-PANEL REMOTE E-STOP HARNESS IS SHOWN IN POSITION BETWEEN EXISTING INTEGRATED SWITCH CONNECTOR AND ENGINE HARNESS CONNECTOR. CONNECTION POINT IS LOCATED BEHIND THE H-PANEL HINGED COVER
 - 2) SEE WIRING OR SCHEMATIC DIAGRAM(S) SPECIFIC TO UNIT FOR INFORMATION ON OTHER WIRES
 - 3) FACTORY RUNS WIRING OUT OF H-PANEL ALONG ENGINE HARNESS THAT ENTERS LOW VOLTAGE CUSTOMER CONNECTION BOX. TIE WRAP ALONG HARNESS AS NEEDED.
 - 4) THE H-PANEL WILL NOT RECOGNIZE THAT REMOTE E-STOP WAS ACTIVATED, BUT WILL STOP UNIT FROM RUNNING

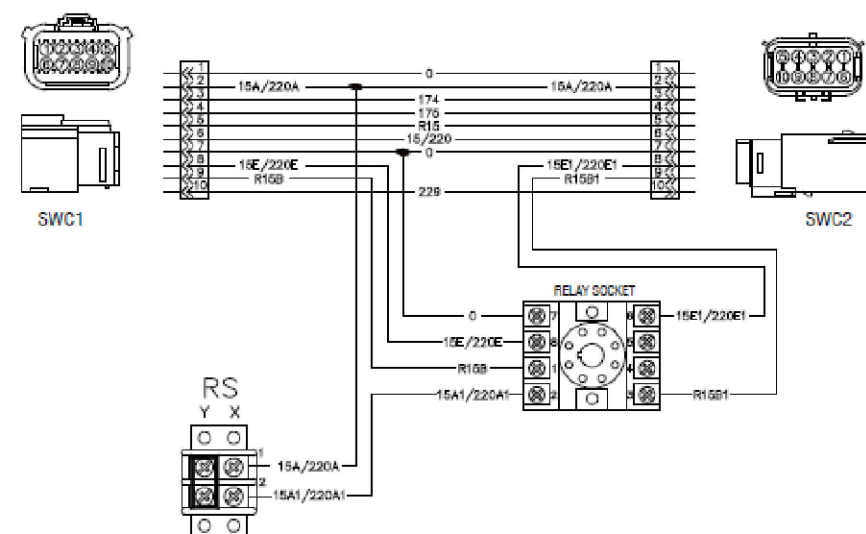

GENSET CONTROLS

2 OF 2

SD080 | 4.5L | 80 kW
INDUSTRIAL DIESEL GENERATOR SET
 EPA Certified Stationary Emergency



STANDBY POWER RATING
 80 kW, 100 kVA, 60 Hz

PRIME POWER RATING*
 72 kW, 90 kVA, 60 Hz

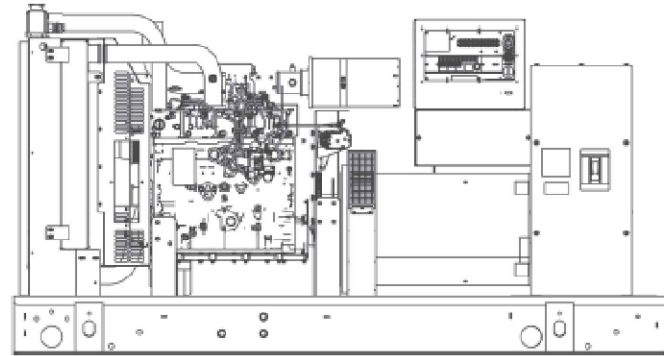

Image used for illustration purposes only



*Built in the USA using domestic and foreign parts

*EPA Certified Prime ratings are not available in the U.S. or its Territories.

**Certain options or customization may not hold certification valid.

CODES AND STANDARDS

Generac products are designed to the following standards:

UL2200, UL508, UL142, UL498

NFPA70, 99, 110, 37

NEC700, 701, 702, 708

ISO9001, 8528, 3046, 7637, Pluses #2b, 4

NEMA ICS10, MG1, 250, ICS6, AB1

ANSI C62.41

POWERING AHEAD

For over 50 years, Generac has led the industry with innovative design and superior manufacturing.

Generac ensures superior quality by designing and manufacturing most of its generator components, including alternators, enclosures and base tanks, control systems and communications software.

Generac's gensets utilize a wide variety of options, configurations and arrangements, allowing us to meet the standby power needs of practically every application.

Generac searched globally to ensure the most reliable engines power our generators. We choose only engines that have already been proven in heavy-duty industrial application under adverse conditions.

Generac is committed to ensuring our customers' service support continues after their generator purchase.

SD080 | 4.5L | 80 kW
INDUSTRIAL DIESEL GENERATOR SET
 EPA Certified Stationary Emergency



DIMENSIONS AND WEIGHTS*

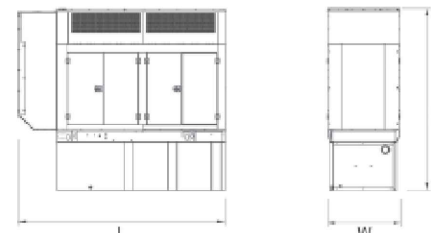
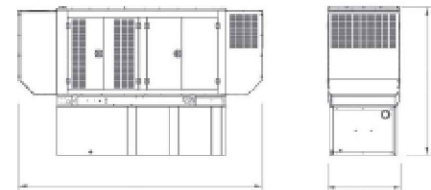
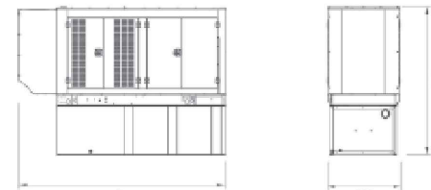
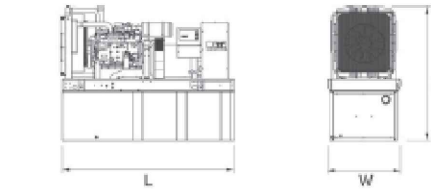

YOUR FACTORY RECOGNIZED GENERAC INDUSTRIAL DEALER

OPEN SET

RUN TIME HOURS	USABLE CAPACITY GAL (L)	L x W x H in (mm)	WT lbs (kg) - Tank & Open Set	
			Steel	Aluminum
NO TANK	-	93 (2362.2) x 40 (1016) x 49 (1244.6)	2425 (1100)	
13	79 (299)	93 (2362.2) x 40 (1016) x 62 (1574.8)	2947 (1201)	
30	189 (715.4)	93 (2362.2) x 40 (1016) x 74 (1879.6)	3183 (1444)	
48	300 (1135.6)	93 (2362.2) x 40 (1016) x 86 (2184.4)	3407 (1545)	
56	350 (1325)	110 (2794) x 40 (1016) x 86 (2184.4)	NA	
81	510 (1930.5)	117 (2971.8) x 47 (1193.8) x 86 (2184.4)	3790 (1719)	
93	589 (2229.6)	128 (3251.2) x 49 (1244.6) x 86 (2184.4)	4269 (1936)	

STANDARD ENCLOSURE

RUN TIME HOURS	USABLE CAPACITY GAL (L)	L x W x H in (mm)	WT lbs (kg) - Enclosure Only	
			Steel	Aluminum
NO TANK	-	112 (2844.8) x 41 (1041.4) x 56 (1422.4)		
13	79 (299)	112 (2844.8) x 41 (1041.4) x 69 (1752.6)		
30	189 (715.4)	112 (2844.8) x 41 (1041.4) x 81 (2057.4)		
48	300 (1135.6)	112 (2844.8) x 41 (1041.4) x 93 (2362.2)	425 (193)	155 (70)
56	350 (1325)	112 (2844.8) x 41 (1041.4) x 93 (2362.2)		
81	510 (1930.5)	117 (2971.8) x 47 (1193.8) x 93 (2362.2)		
93	589 (2229.6)	128 (3251.2) x 49 (1244.6) x 93 (2362.2)		

LEVEL 1 ACOUSTIC ENCLOSURE

RUN TIME HOURS	USABLE CAPACITY GAL (L)	L x W x H in (mm)	WT lbs (kg) - Enclosure Only	
			Steel	Aluminum
NO TANK	-	130 (3302) x 41 (1041.4) x 56 (1422.4)		
13	79 (299)	130 (3302) x 41 (1041.4) x 69 (1752.6)		
30	189 (715.4)	130 (3302) x 41 (1041.4) x 81 (2057.4)		
48	300 (1135.6)	130 (3302) x 41 (1041.4) x 93 (2362.2)	450 (204)	285 (129)
56	350 (1325)	130 (3302) x 41 (1041.4) x 93 (2362.2)		
81	510 (1930.5)	130 (3302) x 47 (1193.8) x 93 (2362.2)		
93	589 (2229.6)	130 (3302) x 49 (1244.6) x 93 (2362.2)		

LEVEL 2 ACOUSTIC ENCLOSURE

RUN TIME HOURS	USABLE CAPACITY GAL (L)	L x W x H in (mm)	WT lbs (kg) - Enclosure Only	
			Steel	Aluminum
NO TANK	-	112 (2844.8) x 41 (1041.4) x 69 (1752.6)		
13	79 (299)	112 (2844.8) x 41 (1041.4) x 82 (2082.8)		
30	189 (715.4)	112 (2844.8) x 41 (1041.4) x 94 (2387.5)		
48	300 (1135.6)	112 (2844.8) x 41 (1041.4) x 106 (2692.4)	625 (284)	395 (180)
56	350 (1325)	112 (2844.8) x 41 (1041.4) x 106 (2692.4)		
81	510 (1930.5)	117 (2971.8) x 47 (1193.8) x 106 (2692.4)		
93	589 (2229.6)	128 (3251.2) x 49 (1244.6) x 106 (2692.4)		

*All measurements are approximate and for estimation purposes only. Sound dBA can be found on the sound data sheet. Enclosure Only weight is added to Tank & Open Set weight to determine total weight.

Specification characteristics may change without notice. Dimensions and weights are for preliminary purposes only. Please consult a Generac Power Systems Industrial Dealer for detailed installation drawings.

Generac Power Systems, Inc. | P.O. Box 8 | Waukegan, WI 53187
 P: (262) 544-4811 | © 2017 Generac Power Systems, Inc. All rights reserved. All specifications are subject to change without notice.

Part No. DK5092
 Rev. F 01/26/17

SPEC SHEET

1 OF 6

SPEC SHEET

6 OF 6

I/N	TANK FITTING	FUNCTION
1	3/8" NPT COUPLING	FUEL SUPPLY
2	3/8" NPT COUPLING	FUEL RETURN
3	4" NPT WELD FLANGE	EMERGENCY VENT
4		FUEL VENT
5	2" NPT WELD FLANGE	FUEL FILL
6	4" NPT WELD FLANGE	EMERGENCY VENT (INNER)
7	2" NPT WELD FLANGE	VENT
8	3/4" NPT COUPLING	DRAIN
9	Ø 22 MM HOLE	LEAK DETECTOR

CAPACITY SHOWN: LITER [GALLONS]
 WEIGHT SHOWN: KILOGRAMS [POUNDS]
 LENGTH SHOWN: MM [INCH]
 UL #142 LISTED
 ULC-S601 LISTED

NOTES:
 1. MOUNTING BOLTS OR STUDS TO MOUNT BASETANK TO CONCRETE SHALL BE 5/8-11 GRADE 5. (USE STANDARD SAE TORQUE SPECS)

LOW VOLTAGE STUB-UP
 HIGH VOLTAGE STUB-UP

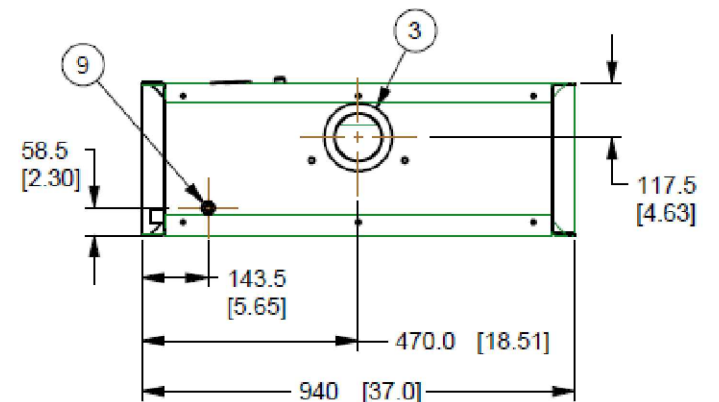
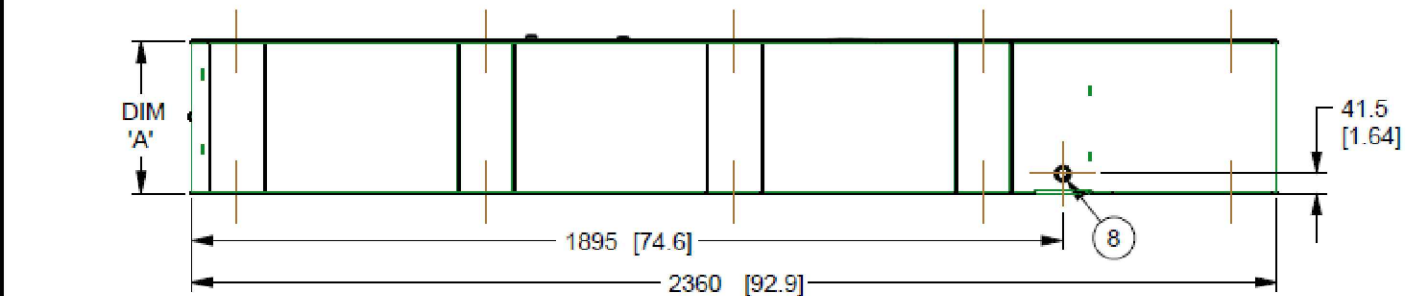
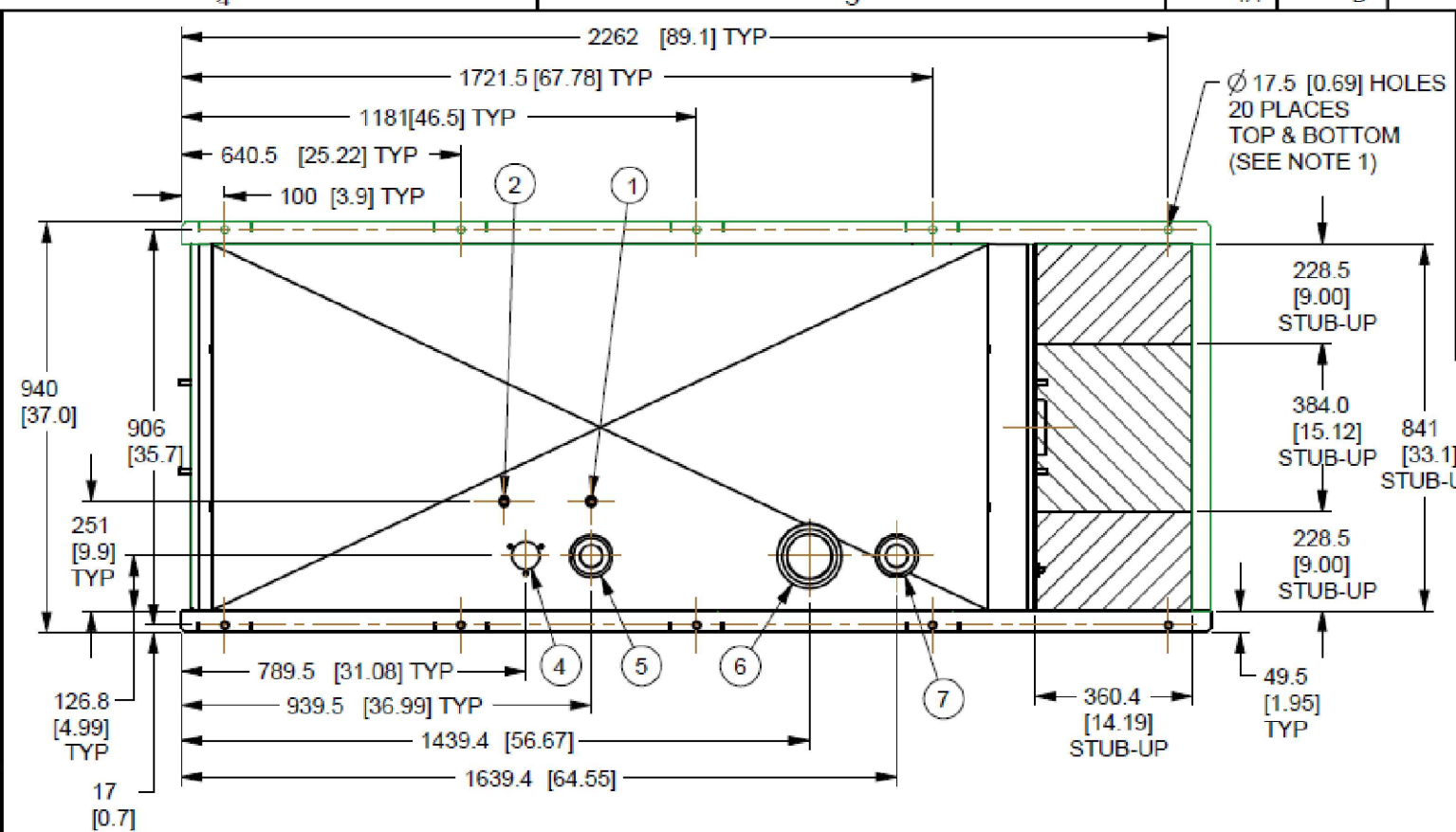

TANK P/N	OJ18430ST03	OJ18440ST03	OJ18450ST03
DIM 'A'	330 [13]	635 [25]	940 [37]
TOTAL TANK CAPACITY	318 [84]	734 [194]	1154 [305]
USABLE TANK CAPACITY	299 [79]	716 [189]	1134 [300]
DRY WEIGHT (EST)	237 [522]	344 [758]	445 [982]

DRAWING CREATED FROM PRO/ENGINEER 3D FILE. ECO MODIFICATION TO BE APPLIED TO SOLID MODEL ONLY.

GENERAC

TITLE
 INSTALL B-GROUP BASETANKS

ISSUE DATE: 02/04/11

SIZE B	CAGE NO N/A	DWG NO OJ4211	REV D
SCALE 0.075	WT-KG 240.954	SHEET 1 of 1	

ELECTRONICALLY APPROVED
 INSIDE WINDCHILL

GENERAC POWER SYSTEMS OWNS THE COPYRIGHT OF THIS DRAWING WHICH IS SUPPLIED IN CONFIDENCE AND MUST NOT BE USED FOR ANY PURPOSE OTHER THAN FOR WHICH IT IS SUPPLIED WITHOUT THE EXPRESS WRITTEN CONSENT OF GENERAC POWER SYSTEMS. ©GENERAC POWER SYSTEMS 2013

INSTALLATION DRAWING

1 TANK

SUPPLEMENTAL

SHEET NUMBER:
R-603

REVISION:
0

BUREAU OF LICENSES AND PERMITS
CITY OF HARTFORD

No. 13070

CERTIFICATE OF OCCUPANCY

Zone I-2 Dated June 16, 1999

THIS IS TO CERTIFY THAT building at 305 West Service Road
as constructed under Permit No. B 19995170 HC 12/15/99 conforms substantially to the
requirements of the Building Code and the Zone Ordinance of the City of Hartford and is hereby approved for occupancy
as indicated below.

Approved for occupancy Telecommunication Tower

Use Group Business

Joseph M. James a/b Building Supervisor

Notice: — If this certificate is lost or destroyed, a duplicate should be immediately obtained from the Department of Licenses and
Inspections. Any change or extension of the use herein approved requires a new certificate of occupancy.
Copies of this certificate may be obtained at the Department of Licenses and Inspections at a charge of seventy-five cents each.

Receipt No. 0000011715 100.00 Check 06 16 99

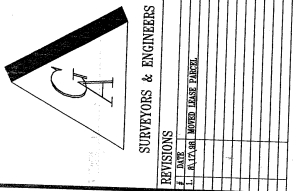

SURVEYORS & ENGINEERS
 REVISIONS
 1. INITIAL WORK PERFORMED

NEXTEL COMMUNICATIONS OF THE MID-ATLANTIC, INC.
 100 CORPORATE PLACE
 ROCK HILL, CONNECTICUT 06067
 (860) 513-5400 FAX (860) 513-5444

CT-0767 HARTFORD NORTH
 305 WEST SERVICE ROAD
 HARTFORD, CONN.

NexTel Project #
 CT - 0767 Hartford North

Existing Conditions of
 305 West Service Road
 Hartford, Connecticut
 Prepared for
 NexTel Communications
 of The Mid-Atlantic, Inc.

August 3, 1998

S-1

NexTel Project #

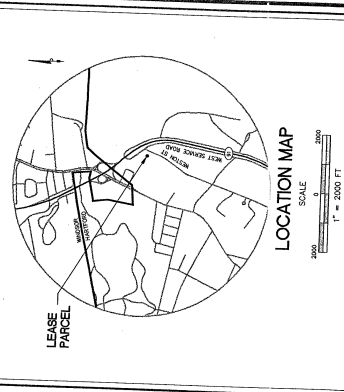

REFERENCE MAPS

1. NEXTEL COMMUNICATIONS INC. SERVICE ROAD (WEST BRANCH) ADDRESS - 305 WEST SERVICE ROAD, HARTFORD, CT 06115. CHILD REC. 1977-2001 PLAN 10000

NOTES

1. THIS SURVEY AND MAP HAS BEEN PREPARED IN ACCORDANCE WITH SECTIONS 20-21 OF THE CONSTITUTION OF THE STATE OF CONNECTICUT AND THE STATUTES THEREUNDER. THE SURVEYOR HAS CONDUCTED A VISUAL INSPECTION OF THE SITE AND HAS FOUND THAT THE INFORMATION FURNISHED TO HIM IS TRUE AND CORRECT.
2. THE SURVEYOR HAS BEEN ADVISED THAT THE PROPERTY IS SUBJECT TO A DEED DATED 1977-2001 PLAN 10000.
3. ELEVATION DATA IS BASED ON THE POSITION OF A PROPOSED ACCURACY CONTROL POINT (CP) LOCATED AT THE CORNER OF THE PARCEL.
4. FROM A POINT PROVIDED BY GEORGE & ASSOCIATES P.C. (G&A) AND THE POSITION OF A PROPOSED ACCURACY CONTROL POINT (CP) LOCATED AT THE CORNER OF THE PARCEL.
5. SUBJECT TO AN ACCURATE UP-TO-DATE ABSTRACT OF TITLE.
6. APPROX 5000 BARS DED. 4, 1986. 2 PER COMPANY PLAN.
7. SUBJECT TO ALL RIGHTS, EASEMENTS, COVENANTS OR RESTRICTIONS OF RECORD.

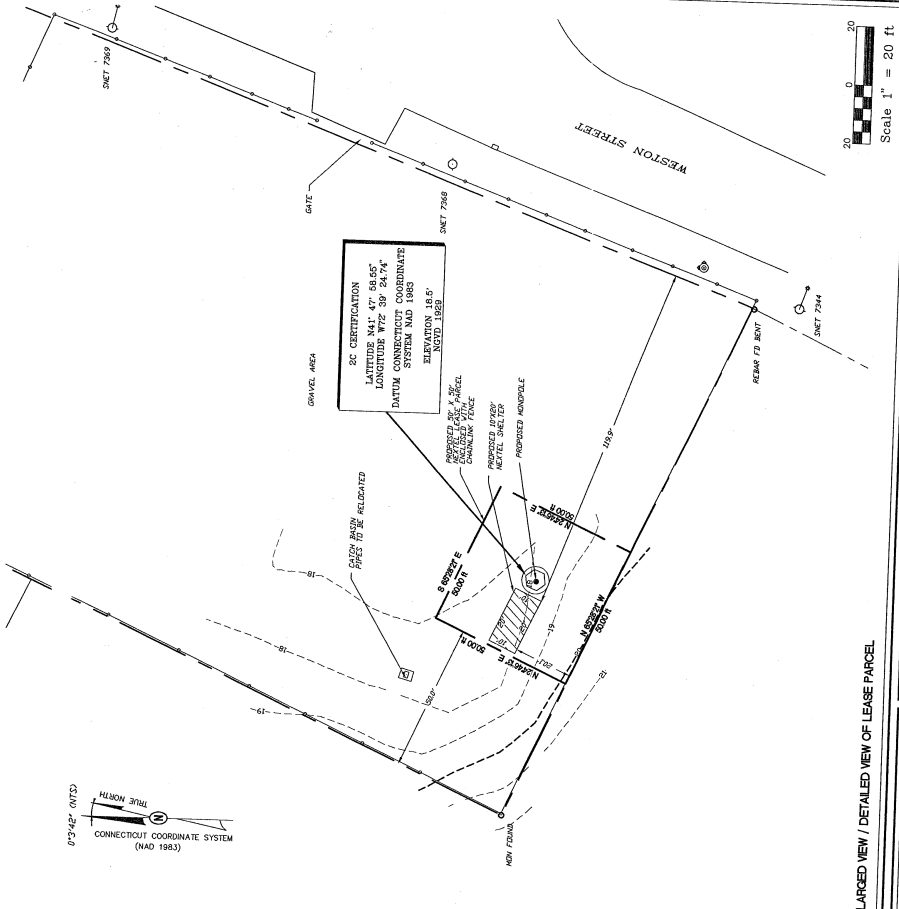

LEGEND

SYM	DESCRIPTION	SYM	DESCRIPTION
•	PROPERTY CORNER	—	BOUNDARY
○	P/DM TO SET	—	PROPERTY TO SET
□	MONUMENT TO SET	—	NOT TO SCALE
⊕	BENCH MARK	—	BOUNDARY
⊙	SPOT ELEV.	—	BOUNDARY
—	REELINE	—	BOUNDARY
—	METLANDS	—	BOUNDARY

Gesick & Associates P.C.
 SURVEYORS & ENGINEERS
 19 Cedar Island Ave.
 Chilton, CT 06413
 (860) 669-7799
 FAX (860) 669-6833
 e-mail: Gesick@aol.com

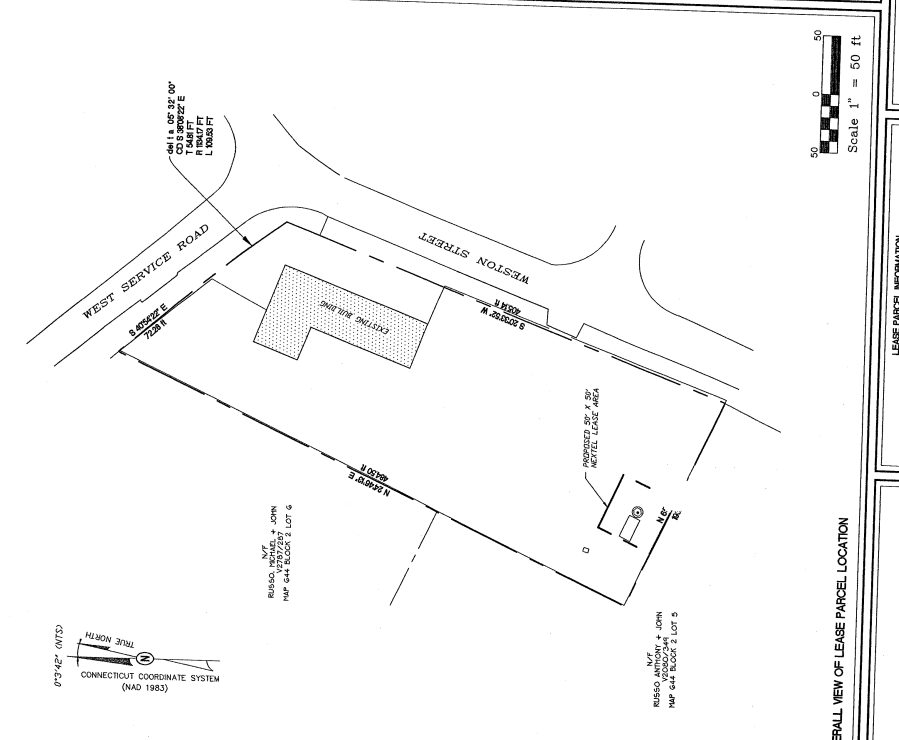

LEASE PARCEL INFORMATION

ADDRESS	305 WEST SERVICE ROAD HARTFORD, CT
DEED/DEED OWNER	305 WEST SERVICE ROAD ASSOCIATES, LLC
DEED/DEED NO.	VOL 3960/282
ASSESSORS ID	M04 644 BLOCK 6, LOT 7
FLOOD ZONE	ZONE X
AREA OF LEASE PARCEL	2493.88 SQ FT. 0.05739 ACRES +/-

To the best of my knowledge and belief, this map is substantially correct as stated herein.

Donald L. Gesick Jr., P.E. Reg. No. 19417

SURVEYORS CERTIFICATION

07342' (N12D)
 TRUE NORTH
 CONNECTICUT COORDINATE SYSTEM (NAD 1983)

07342' (N12D)
 TRUE NORTH
 CONNECTICUT COORDINATE SYSTEM (NAD 1983)

07342' (N12D)
 TRUE NORTH
 CONNECTICUT COORDINATE SYSTEM (NAD 1983)

07342' (N12D)
 TRUE NORTH
 CONNECTICUT COORDINATE SYSTEM (NAD 1983)

07342' (N12D)
 TRUE NORTH
 CONNECTICUT COORDINATE SYSTEM (NAD 1983)

NO.	DATE	DESCRIPTION
1	08/27/08	ISSUE: DETAILS
2		
3		
4		
5		
6		
7		
8		
9		
10		

DATE: 08/03/08 DRAWN BY: RJG
 SCALE: AS SHOWN

**NEXTEL
 COMMUNICATIONS, INC.**
 OF THE
MID-ATLANTIC, INC.
 100 CORPORATE PLACE
 ROCKY HILL, CONNECTICUT 06067
 (860) 513-5400 FAX (860) 513 5444

NEXTEL COMMUNICATIONS SITE:
 #0767 HARTFORD NORTH
 305 WEST SERVICE ROAD
 HARTFORD, CONNECTICUT
 G&A PROJECT #98-0828

Sheet title:
**Site Plan &
 Elevations**

DRAWING NUMBER:
C-2

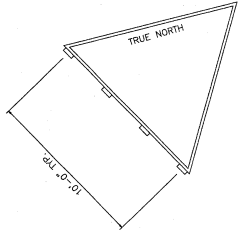

PLAN ANTENNA PLAN

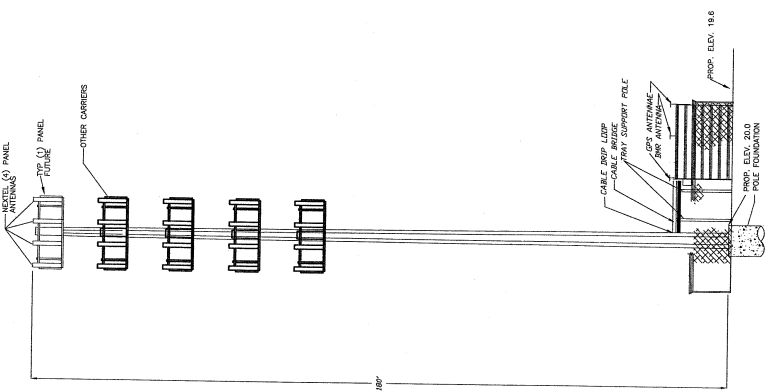

MONOPOLE TOWER DETAIL
 1 NOT TO SCALE
 2

ANTENNA DETAILS

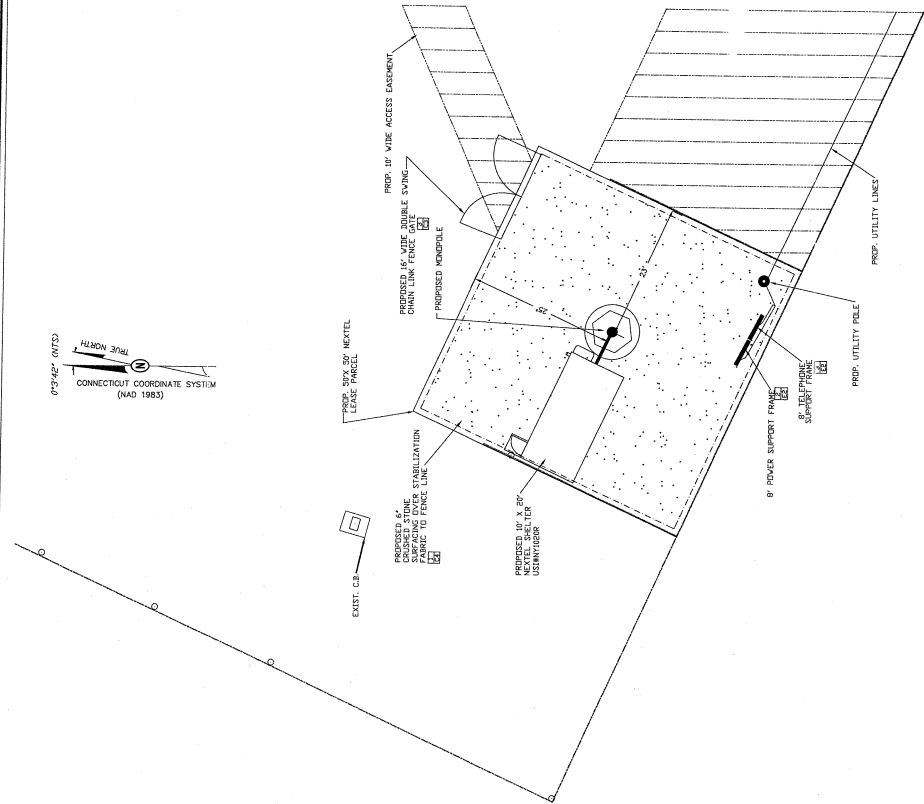

Scale 1" = 10 ft

SITE LAYOUT

NO.	DATE	DESCRIPTION	INITIALS
1	08/03/98	SCALE: AS SHOWN	RJG
REVISIONS			

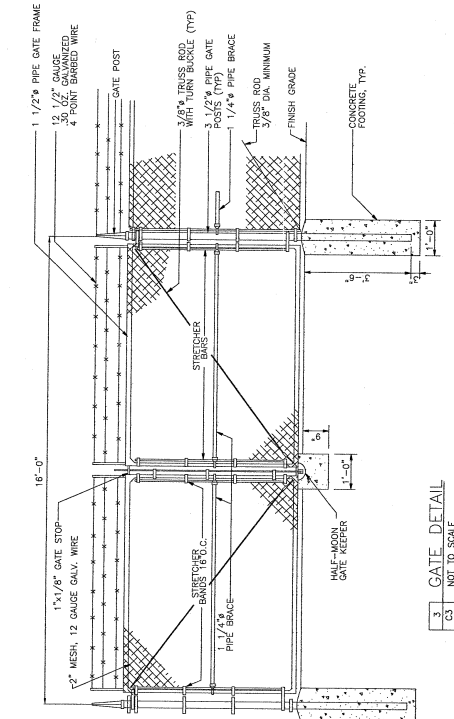

3 GATE DETAIL
 C3 NOT TO SCALE

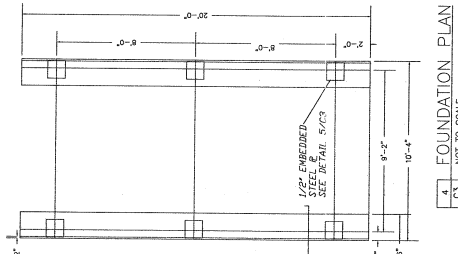

4 FOUNDATION PLAN
 C3 NOT TO SCALE

- FENCE NOTES:**
1. FENCING MATERIALS SHALL BE OF GALVANIZED STEEL.
 2. POSTS, BRACES AND GATE FRAMES SHALL BE SCHEDULE 40 (STANDARD WEIGHT) PIPE. SIZES SPECIFIED ARE NOMINAL DIMENSIONS.
 3. DOUBLE SWING GATE SHALL BE PROVIDED WITH TUBULAR PLUNGER AND 2 FORK CATCHES. 1 CATCH FOR PLUNGER BAR, AND 2 GATE STOPS LOCATED AS DIRECTED BY THE ENGINEER.
 4. MANUFACTURER AND OTHER NECESSARY FENCE FITTINGS SHALL BE AS SHOWN ON DRAWING. ALL MATERIALS SHALL BE OF GALVANIZED STEEL.
 5. POSTS SHALL BE SPACED EQUIDISTANT BUT NOT MORE THAN 10' O.C. ANY SECTION.
 6. BOTTOM OF FENCE SHALL BE NO MORE THAN 3" ABOVE GRADE AT ANY SECTION.
 7. CONTRACTOR SHALL BE RESPONSIBLE FOR THE DESIGN, FABRICATION AND ERECTION OF A "HARK" FIELD REPRESENTATIVE.

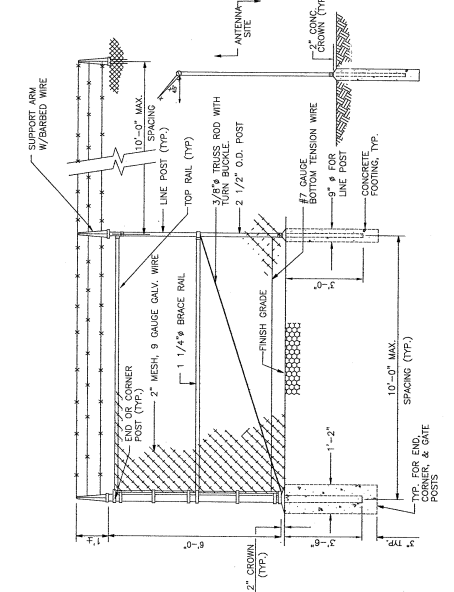

2 FENCE DETAIL
 C3 NOT TO SCALE

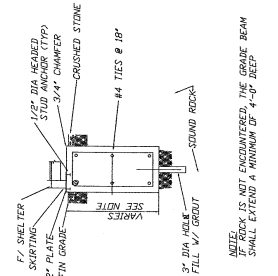

5 SECTION
 C3 NOT TO SCALE

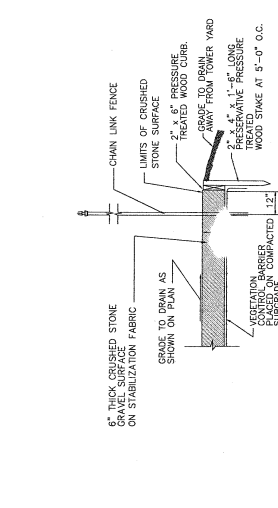

1 SECTION THROUGH TOWER YARD
 C3 NOT TO SCALE



6 DETAIL
 C3 NOT TO SCALE



ORIGIN ID: SCH4 (518) 932-7049
JAKE LEHMAN
AIROSMITH DEVELOPMENT INC.
318 WEST AVENUE
SARATOGA SPRINGS, NY 12886
UNITED STATES US

SHIP DATE: 19MAY22
ACTWGHT: 0.25 LB
CAD: 10763113IN/ET4490

BILL SENDER

TO **AMERICAN TOWER CORPORATION**

10 PRESIDENTIAL WAY

WOBURN MA 01801

REF: ATC BUP GEN EAST 202204

(518) 932-7049
INV:
PO: DEPT:

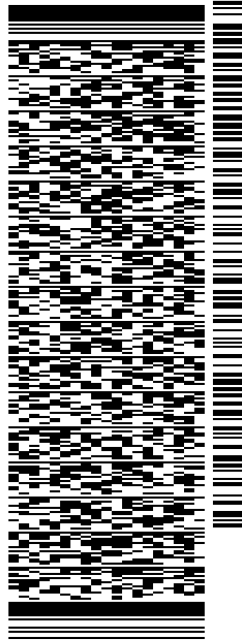

J222022041201uv

577J51BD6/FE4A

TRK# 7769 0836 7980
#0201

TUE - 24 MAY 4:30P
EXPRESS SAVER

SE BEDA

01801
MA-US BOS

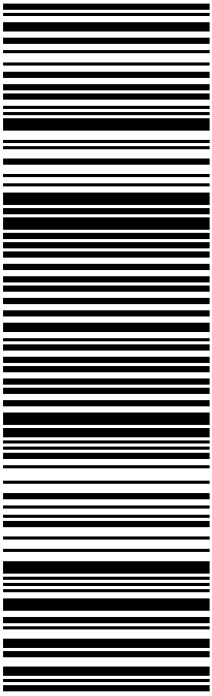

After printing this label:

1. Use the 'Print' button on this page to print your label to your laser or inkjet printer.
2. Fold the printed page along the horizontal line.
3. Place label in shipping pouch and affix it to your shipment so that the barcode portion of the label can be read and scanned.

Warning: Use only the printed original label for shipping. Using a photocopy of this label for shipping purposes is fraudulent and could result in additional billing charges, along with the cancellation of your FedEx account number.

Use of this system constitutes your agreement to the service conditions in the current FedEx Service Guide, available on fedex.com. FedEx will not be responsible for any claim in excess of \$100 per package, whether the result of loss, damage, delay, non-delivery, misdelivery, or misinformation, unless you declare a higher value, pay an additional charge, document your actual loss and file a timely claim. Limitations found in the current FedEx Service Guide apply. Your right to recover from FedEx for any loss, including intrinsic value of the package, loss of sales, income interest, profit, attorney's fees, costs, and other forms of damage whether direct, incidental, consequential, or special is limited to the greater of \$100 or the authorized declared value. Recovery cannot exceed actual documented loss. Maximum for items of extraordinary value is \$1,000, e.g. jewelry, precious metals, negotiable instruments and other items listed in our Service Guide. Written claims must be filed within strict time limits, see current FedEx Service Guide.

ORIGIN ID: SCH4 (518) 932-7049
JAKE LEHMAN
AIROSMITH DEVELOPMENT INC.
318 WEST AVENUE
SARATOGA SPRINGS, NY 12886
UNITED STATES US

SHIP DATE: 19MAY22
ACTWG: 0.25 LB
CAD: 10763113INNET4490
BILL SENDER

TO **ATTN: LUKE BRONIN**
CITY OF HARTFORD
550 MAIN STREET
SECOND FLOOR, ROOM 200
HARTFORD CT 06103
(860) 757-9500
REF: ATC BUP GEN EAST 202204
INV: DEPT:
PO:

577J5/1BD6/FE4A

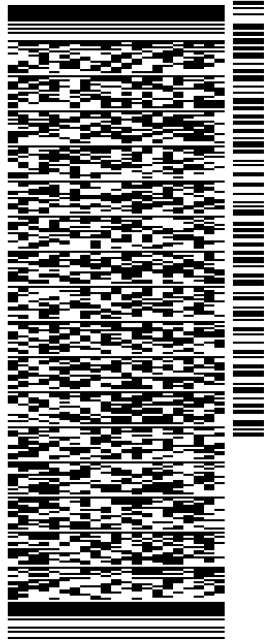

J222022041201uv

TRK# 7769 0822 8225
0201

TUE - 24 MAY 4:30P
EXPRESS SAVER

SE KXAA

06103
CT-US BDL

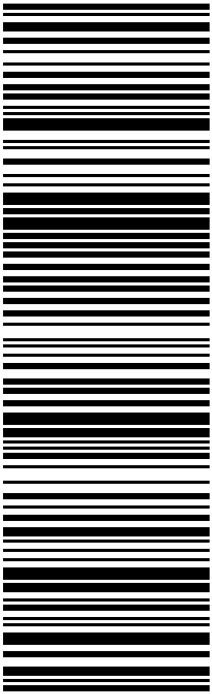

After printing this label:

1. Use the 'Print' button on this page to print your label to your laser or inkjet printer.
2. Fold the printed page along the horizontal line.
3. Place label in shipping pouch and affix it to your shipment so that the barcode portion of the label can be read and scanned.

Warning: Use only the printed original label for shipping. Using a photocopy of this label for shipping purposes is fraudulent and could result in additional billing charges, along with the cancellation of your FedEx account number.

Use of this system constitutes your agreement to the service conditions in the current FedEx Service Guide, available on fedex.com. FedEx will not be responsible for any claim in excess of \$100 per package, whether the result of loss, damage, delay, non-delivery, misdelivery, or misinformation, unless you declare a higher value, pay an additional charge, document your actual loss and file a timely claim. Limitations found in the current FedEx Service Guide apply. Your right to recover from FedEx for any loss, including intrinsic value of the package, loss of sales, income interest, profit, attorney's fees, costs, and other forms of damage whether direct, incidental, consequential, or special is limited to the greater of \$100 or the authorized declared value. Recovery cannot exceed actual documented loss. Maximum for items of extraordinary value is \$1,000, e.g. jewelry, precious metals, negotiable instruments and other items listed in our Service Guide. Written claims must be filed within strict time limits, see current FedEx Service Guide.

ORIGIN ID: SCH4 (518) 932-7049
JAKE LEHMAN
AIROSMITH DEVELOPMENT INC.
318 WEST AVENUE
SARATOGA SPRINGS, NY 12886
UNITED STATES US

SHIP DATE: 19MAY22
ACTWGST: 0.25 LB
CAD: 10763113INNET4490
BILL SENDER

TO 305 W. SERVICE RD. ASSOC LLC

206 DORAL DRIVE

BLACKWOOD NJ 08012

(518) 932-7049 REF: ATC: BUP GEN EAST 202204
INV. PO. DEPT.



J222022041201uv

577J51BD6/FE4A

TRK# 7769 0831 6485
0201

TUE - 24 MAY 4:30P
EXPRESS SAVER

SEWRRIA

08012
NJ-US PHL

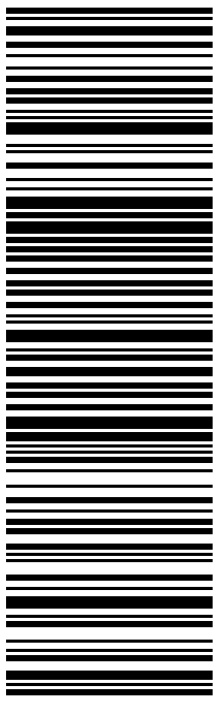

After printing this label:

1. Use the 'Print' button on this page to print your label to your laser or inkjet printer.
2. Fold the printed page along the horizontal line.
3. Place label in shipping pouch and affix it to your shipment so that the barcode portion of the label can be read and scanned.

Warning: Use only the printed original label for shipping. Using a photocopy of this label for shipping purposes is fraudulent and could result in additional billing charges, along with the cancellation of your FedEx account number.

Use of this system constitutes your agreement to the service conditions in the current FedEx Service Guide, available on fedex.com. FedEx will not be responsible for any claim in excess of \$100 per package, whether the result of loss, damage, delay, non-delivery, misdelivery, or misinformation, unless you declare a higher value, pay an additional charge, document your actual loss and file a timely claim. Limitations found in the current FedEx Service Guide apply. Your right to recover from FedEx for any loss, including intrinsic value of the package, loss of sales, income interest, profit, attorney's fees, costs, and other forms of damage whether direct, incidental, consequential, or special is limited to the greater of \$100 or the authorized declared value. Recovery cannot exceed actual documented loss. Maximum for items of extraordinary value is \$1,000, e.g. jewelry, precious metals, negotiable instruments and other items listed in our Service Guide. Written claims must be filed within strict time limits, see current FedEx Service Guide.

